

1
2
3
4
5
6
7
8
9
10
11
12
13
14
15
16
17
18
19
20
21
22
23
24
25
26
27
28

IN THE SUPERIOR COURT OF THE STATE OF ARIZONA
IN AND FOR THE COUNTY OF MARICOPA

IN RE THE GENERAL
ADJUDICATION OF ALL RIGHTS
TO USE WATER IN THE GILA
RIVER SYSTEM AND SOURCE

W-1, W-2, W-3, W-4 (Consolidated)
Contested Case No. W1-11-2783

ORDER TO INITIATE CONTESTED CASE
AND
ORDER TO SET A TELEPHONIC STATUS
CONFERENCE

CONTESTED CASE NAME: *In re Reesor G. Woodling*
HSR INVOLVED: San Pedro River Watershed Hydrographic Survey Report
DESCRIPTIVE SUMMARY: Telephonic Status Conference shall be held on **October 23, 2020**
at 1:30 p.m.
NUMBER OF PAGES: 16
DATE OF FILING: August 10, 2020

This contested case is one of the many cases in the General Stream Adjudication for the San Pedro River watershed. Other cases in which claims have been made to water in the San Pedro River watershed have been completed, are in the process of determining water rights, or awaiting initiation. The purpose of the General Adjudication is to determine the water rights of those persons who filed statements of claimant to use water from the San Pedro watershed. The

1 General Adjudication will also determine water rights in the Upper Salt, Verde, Upper Gila,
2 Lower Gila, Agua Fria, and Upper Santa Cruz watersheds.

3 This contested case shall determine the claims for water rights listed in and resolve the
4 objections to Watershed File Report 113-14-AA-001 (“WFR”) published in the Final San Pedro
5 River Watershed Hydrographic Survey Report (1991). The WFR identified potential water
6 rights for domestic, irrigation, and small reservoir uses for the land described in the WFR located
7 in Township 13S Range 20E, Township 14S Range 20E, and Township 17S Range 20E. The
8 identified sources of water for the claimed uses are eleven wells. The Arizona Department of
9 Water Resources has determined that all of the wells are located within the subflow zone except
10 Well 08 located in Section 8 T14S R20E. A copy of the watershed file report is attached as
11 Attachment A. A copy of the map prepared for the WFR is attached as Attachment B on which
12 the land investigated is labelled with “(1)”.

13 14 15 **Claimants & Landowners**

16
17 The WFR identified 16 Statements of Claimant (SOC) relevant to the potential water
18 rights. The Claimants in this case are Cascabel Land and Cattle Co., the Nature Conservancy,
19 and E. Lamar Smith, who filed or were assigned SOCs claiming rights to water for stock
20 watering, irrigation, and domestic uses. The Arizona Department of Water Resources listed
21 Reesor G. Woodling as the owner of the property described in the WFR. According to the public
22 records of Cochise County Treasurer’s Office, the property including within the boundaries of
23 the WFR now consists of 17 different tax parcels as follows:

24
25
26
27
28

Tax Parcel	Owner Name	Address	City	State	Zip Code
20802003B	Rogers Heaven Sent Ranch LLC	3334 E Milber St	Tucson	Az	85714
20802011C	Randall Mason Pension Fund	2200 E 5th St	Tucson	Az	85719
20802011E	Nature Conservancy	1510 E Fort Lowell Rd	Tucson	Az	85719
20802011H	Linden St Properties LLC	1701 N Tanque Verde Loop	Tucson	Az	85749
20802011L	Rogers Heaven Sent Ranch LLC	3334 E Milber St	Tucson	Az	85714
20802011M	Bell Janis C	4824 N Cascabel Rd	Benson	Az	85602
20802011N	Rogers Heaven Sent Ranch LLC	3334 E Milber St	Tucson	Az	85714
20802011P	Bell Janis C	4824 N Cascabel Rd	Benson	Az	85602
20802011Q	Nature Conservancy	1510 East Ft Lowell Road	Tucson	Az	85719
20803001	Rogers Heaven Sent Ranch LLC	3334 E Milber St	Tucson	AZ	85714
20804004	C-Spear LLC	P.O Box 699	Stanfield	AZ	85172
20804005A	Mason Randall P & Betsy J	2200 E 5th St-	Tucson	Az	85719
20804005B	Lancaster Louis J Rev Liv Trust	2222 172nd Ave Ne	Bellevue	WA	98008
20805005A	C-Spear LLC	P.O Box 699	Stanfield	Az	85172
20807002A	W & K LLC	P.O Box 1299	Benson	Az	85602
20807002B	Three Bar K LLC	P.O Box 1299	Benson	Az	85602
20807003	Three Bar K LLC	P.O Box 1299	Benson	Az	85602

A copy of the current tax parcel map is attached as Attachment C.

IT IS ORDERED:

1. Contested Case. This contested case shall be known as *In re Reesor G. Woodling* and it will address the Statements of Claimant listed in and objections that were filed to Watershed File Report 113-14-AA-001 published in the Final San Pedro River Watershed Hydrographic Survey Report (1991). Copies of objections can be found under the case name and number on the following website:

<http://www.superiorcourt.maricopa.gov/SuperiorCourt/GeneralStreamAdjudication/ActiveCases.asp>

1 2. Litigants. The litigants in this contested case, are the Claimants, current
2 landowners who are listed on page 3, all persons who filed objections to Watershed File Report
3 113-14-AA-001, who are listed on Attachment D, and claimants who are allowed to intervene
4 by order.

5 3. Court-Approved Mailing List.

6
7 A. The initial Court-approved mailing list for this case shall include the
8 landowners and all persons listed on Attachment D to this order. The list may be
9 modified only by filing a motion with the Special Master to amend the Court-
10 approved mailing list. Litigants are responsible for using the current Court-
11 approved mailing list.

12
13 B. A copy of any pleading filed with the Clerk of the Maricopa County
14 Superior Court in this case shall be served upon each person listed on the Court-
15 approved mailing list.

16 C. Claimants wishing to be added or removed from the mailing list shall file
17 a motion with the Special Master. Parties allowed to intervene will be
18 automatically added to the mailing list.

19
20 4. Courtesy Email List.

21 The Special Master's office will email courtesy copies of orders and minute
22 entries entered in this case to persons listed on Attachment D. Requests for
23 inclusions on the email list should be sent to Barbara Brown at
24 brownb099@superiorcourt.maricopa.gov.

25
26 5. Status Conference. An initial status conference shall be held to describe the
27 purpose of this case and determine whether the Claimants or the current landowners intend to
28 pursue water rights for the property. If so, then a discussion will be held to determine whether

1 the objections to the potential water rights can be settled. If the objections cannot be settled, then
2 a subsequent date will be set for a scheduling conference to identify issues, file disclosure
3 statements, conduct discovery, submit prehearing motions, and hold a trial. The Telephonic
4 Status Conference shall be held on **October 23, 2020 at 1:30 p.m.**

5
6 Instructions for telephonic appearance:
7 Dial: 602-506-9695 (local)
8 1-855-506-9695 (toll free long distance)
9 Dial Participant Pass Code 357264#

10
11 
12 SUSAN WARD HARRIS
13 Special Master

14 On August 10, 2020, the original of the foregoing was
15 delivered to the Clerk of the Maricopa County Superior
16 Court for filing and distributing a copy to all persons
17 listed on the Court-approved mailing list for W1-11-2783,
18 a copy of which is attached hereto as Attachment D, and
19 to all persons listed on the Court-approved mailing list for
20 W-1, W-2, W-3, and W-4 (Consolidated).

21
22
23
24
25
26
27
28

29 Barbara Brown

1
2
3
4
5
6
7
8
9
10
11
12
13
14
15
16
17
18
19
20
21
22
23
24
25
26
27
28

ATTACHMENT A

LAND OWNER

 WOODLING, REESOR G.

WATERSHED FILE
 REPORT NUMBER

 113-14-AA-001

APPLICABLE FILINGS AND DECREES

CLEARLY STATED INFORMATION FROM FILINGS AND DECREES

WI-11-2783

FILING NUMBER	FILING STATUS	USES	QUANTITY IN AFA	USE LOCATION SECTION	TWNP	RNGE	CLAIM DATE	DIVERSION LOCATION SECTION	TWNP	RNGE
10-0207355.1100		IRRIGATION		NESE06	140S	200E	1903	NWSENW28	140S	200E
				SESE06	140S	200E				
				NENW17	140S	200E				
36-0020907		STOCK	.31	NWSW08	140S	200E	1977	NWSW08	140S	200E
		DOMESTIC								
36-0020908		IRRIGATION	640.00	SWNE20	140S	200E	1977	SWSWNE20	140S	200E
36-0020909		IRRIGATION	680.00	SWNE17	140S	200E	1977	SWNE17	140S	200E
36-0020911		IRRIGATION	340.00	SWSW08	140S	200E	1977	SWSW08	140S	200E
36-0020912		IRRIGATION	380.00	SWNE08	140S	200E	1977	SENW08	140S	200E
36-0020913		IRRIGATION	440.00	SESWSE08	140S	200E	1977	SWSE08	140S	200E
36-0020914		IRRIGATION	1020.00	NESW08	140S	200E	1977	NESW08	140S	200E
36-0020919		STOCK	.22	SESE07	140S	200E	1977	NENSW08	140S	200E
36-0020923		STOCK	.84	SESE13	140S	190E	1977	SWNE17	140S	200E
				SWSE13	140S	190E				
				NENW13	140S	190E				
39-0003649	AMENDED	STOCK	.56				1913	SENESE06	140S	200E
39-0003653	AMENDED	STOCK	1.00				1965	SWSWNE17	140S	200E
39-0003654	AMENDED	IRRIGATION	340.00	SESE07	140S	200E	1902	NESWSW08	140S	200E
				SWSW08	140S	200E				
39-0003655	AMENDED	IRRIGATION	440.00	SESWSE08	140S	200E	1885	SESWSE08	140S	200E
39-0003656	AMENDED	IRRIGATION	640.00	NWSWNE20	140S	200E	1903	SESWNE20	140S	200E
39-0003657	AMENDED	IRRIGATION	640.00	SENE17	140S	200E	1962	SWSWNE17	140S	200E
39-0003658	AMENDED	IRRIGATION	1020.00	SW08	140S	200E	1885	NENSW08	140S	200E
39-0003659	AMENDED	IRRIGATION	380.00	NWSE08	140S	200E	1885	NWSWNE08	140S	200E
				SENW08	140S	200E				
39-0003660	AMENDED	DOMESTIC	.61				1902	SENWNW08	140S	200E
39-0003661	AMENDED	STOCK	.46				1953	SWSESE06	140S	200E
39-0003662	AMENDED	IRRIGATION	1000.00	SENE06	140S	200E	1902	SENESE06	140S	200E
39-0003669	AMENDED	STOCK	.11	SWSE17	140S	200E	1903	SWSE17	140S	200E
39-0003676	AMENDED	STOCK	.22				1903	SESWW08	140S	200E
39-0003679	AMENDED	DOMESTIC	.31				1903	NWNWSW08	140S	200E
		STOCK	.31							
39-0003680	AMENDED	IRRIGATION	600.00	NENE07	140S	200E	1893	NWSWNW08	140S	200E
				NWNW08	140S	200E				
39-0003681	AMENDED	IRRIGATION	650.00	SESE31	130S	200E	1914	NWNWNE06	140S	200E
				NWNE06	140S	200E				

DWR ANALYSIS OF FILINGS AND DECREES

FILING NUMBER	USES CLAIMED OR REFERENCED	USES FOUND BY DWR	APPLIES TO DIVERSIONS	APPLIES TO PWR NUMBERS
10-0207355.1100	IRRIGATION	IRRIGATION		IROO1, IROO2, IROO4 IROO6, IROO9, IRO10
36-0020907	DOMESTIC STOCK	DOMESTIC INCIDENTAL	W09	DMOO1
36-0020908	IRRIGATION	IRRIGATION	W01	IROO8
36-0020909	IRRIGATION	IRRIGATION	W02	IROO9
36-0020911	IRRIGATION	IRRIGATION	W04	IRO12
36-0020912	IRRIGATION	IRRIGATION	W06	IRO13
36-0020913	IRRIGATION	IRRIGATION	W03	IROO3, IROO7, IRO11
36-0020914	IRRIGATION	IRRIGATION	W05	IROO3, IROO7, IRO11
36-0020919	STOCK	INCIDENTAL	W04	
36-0020923	STOCK	INCIDENTAL	W02	
39-0003649	STOCK	INCIDENTAL	W01	SROO8
39-0003653	STOCK	INCIDENTAL	W02	SROO1
39-0003654	IRRIGATION	IRRIGATION	W04	IRO12
39-0003655	IRRIGATION	IRRIGATION	W03	IROO3, IROO7, IRO11
39-0003656	IRRIGATION	IRRIGATION	W01	IROO8
39-0003657	IRRIGATION	IRRIGATION	W02	IROO9
39-0003658	IRRIGATION	IRRIGATION	W05	IROO3, IROO7, IRO11
39-0003659	IRRIGATION	IRRIGATION	W06	IRO13
39-0003660	DOMESTIC	DOMESTIC		DMOO2
39-0003661	STOCK	STOCKWELL		
39-0003662	IRRIGATION	IRRIGATION	W10	IROO1, IROO4

FILING NUMBER	USES CLAIMED OR REFERENCED	USES FOUND BY DWR	APPLIES TO DIVERSIONS	APPLIES TO PWR NUMBERS
39-0003669	STOCK	STOCKWELL		
39-0003676	STOCK	STOCKWELL		
39-0003679	DOMESTIC	DOMESTIC	W09	DM001
	STOCK	INCIDENTAL		
39-0003680	IRRIGATION	IRRIGATION	W07	IR010
39-0003681	IRRIGATION	IRRIGATION	W11	IR005

D I V E R S I O N S

DIV #	SECTION	TWNP	RNGE	DIVERSION NAME	WATER SOURCE AND CLASSIFICATION
W01	SESWNE20	140S	200E	UNNAMED	GROUNDWATER : ZONE 1 OF THE SAN PEDRO RIVER
W02	SWSWNE17	140S	200E	UNNAMED	GROUNDWATER : ZONE 1 OF THE SAN PEDRO RIVER SHARED
W03	SESWSE08	140S	200E	UNNAMED	GROUNDWATER : ZONE 1 OF THE SAN PEDRO RIVER
W04	NESWSW08	140S	200E	UNNAMED	GROUNDWATER : ZONE 1 OF THE SAN PEDRO RIVER SHARED
W05	NENESW08	140S	200E	UNNAMED	GROUNDWATER : ZONE 2
W06	NWSWNE08	140S	200E	UNNAMED	GROUNDWATER : ZONE 2 SHARED
W07	NWSWNW08	140S	200E	UNNAMED	GROUNDWATER : ZONE 1 OF THE SAN PEDRO RIVER
W08	NENWNW08	140S	200E	UNNAMED	GROUNDWATER : ZONE 1 OF THE SAN PEDRO RIVER
W09	NWNWSW08	140S	200E	UNNAMED	GROUNDWATER : ZONE 1 OF THE SAN PEDRO RIVER
W10	SESE06	140S	200E	UNNAMED	GROUNDWATER : ZONE 1 OF THE SAN PEDRO RIVER
W11	SENWNE06	140S	200E	UNNAMED	GROUNDWATER : ZONE 1 OF THE SAN PEDRO RIVER

U S E S

PWR #	SECTION	TWNP	RNGE	SUPPLIED BY DIVERSIONS	WATER SOURCES	PHOTO DATE	SOURCE CHANGE	FACILITY NAME
DM001	NENWNW08	140S	200E	W08, W09	GROUNDWATER : ZONE 1		NO	
	NWNWSW08	140S	200E					
IR001	NENE06	140S	200E	W10	GROUNDWATER : ZONE 1	1935	NO	
	NESE06	140S	200E					
	SENE06	140S	200E					
IR002	SESE06	140S	200E	W07, W08	GROUNDWATER : ZONE 1	1935	NO	
	SWSW05	140S	200E					
IR003	NESE07	140S	200E	W03, W05	GROUNDWATER : ZONE 1	1935	NO	
	NWSW08	140S	200E		GROUNDWATER : ZONE 2			
	SENE07	140S	200E					
	SWNW08	140S	200E					
	SWSE08	140S	200E					
IR004	NE06	140S	200E	W10	GROUNDWATER : ZONE 1	1955	NO	
	SE06	140S	200E					
IR005	NE06	140S	200E	W11	GROUNDWATER : ZONE 1	1955	NO	
	SE31	130S	200E					
IR006	SWSW05	140S	200E	W07, W08	GROUNDWATER : ZONE 1	1955	NO	
IR007	NESW08	140S	200E	W03, W05	GROUNDWATER : ZONE 1	1955	NO	
	NWSW08	130S	200E		GROUNDWATER : ZONE 2			
	SENE07	140S	200E					
	SESW08	140S	200E					
	SWNW08	130S	200E					
	SWSE08	130S	200E					
IR008	NE20	140S	200E	W01	GROUNDWATER : ZONE 1	1955	NO	
	NW20	140S	200E					
	SE17	140S	200E					
IR009	NENW17	140S	200E	W02	GROUNDWATER : ZONE 1	1972	NO	
	NWNE17	140S	200E					
	NWSE17	140S	200E					
	SWNE17	140S	200E					
IR010	NE07	140S	200E	W07, W08	GROUNDWATER : ZONE 1	1972	NO	
	NW08	140S	200E					
	SE06	140S	200E					
	SW05	140S	200E					
IR011	NW08	140S	200E	W03, W05	GROUNDWATER : ZONE 1	1972	NO	
	SE08	140S	200E		GROUNDWATER : ZONE 2			
	SW08	140S	200E					
IR012	NESE07	170S	200E	W04	GROUNDWATER : ZONE 1	1972	NO	
	SWSW08	170S	200E					
IR013	NESW08	140S	200E	W06	GROUNDWATER : ZONE 2	1972	NO	

PWR #	LOCATION SECTION	TWNP	RNGE	SUPPLIED BY DIVERSIONS	WATER SOURCES	PHOTO DATE	SOURCE CHANGE	FACILITY NAME
IRO13	NWSE08	140S	200E					
	SENW08	140S	200E					
IRO14	NWNW08	140S	200E	WO7,W08	GROUNDWATER : ZONE 1	1990	NO	
	SWSW05	140S	200E					

R E S E R V O I R S

PWR #	LOCATION SECTION	TWNP	RNGE	SUPPLIED BY DIVERSIONS	WATER SOURCES	PHOTO DATE	RESERVOIR NAME	STORAGE PURPOSE
SRO01	NWNWNE17	140S	200E	WO2	GRNDWTR : ZONE 1	1972	UNNAMED	STOCKWATERING WILDLIFE
SRO02	NWSESW08	140S	200E	WO5	GRNDWTR : ZONE 2	1972	UNNAMED	STOCKWATERING WILDLIFE
SRO03	SESENE07	140S	200E	WO5	GRNDWTR : ZONE 2	1972	UNNAMED	STOCKWATERING WILDLIFE
SRO04	SWNWSW08	140S	200E	WO5	GRNDWTR : ZONE 2	1972	UNNAMED	STOCKWATERING WILDLIFE
SRO05	NWSWSW05	140S	200E	WO7,W08	GRNDWTR : ZONE 1	1984	UNNAMED	STOCKWATERING WILDLIFE
SRO06	SENESE06	140S	200E	W10	GRNDWTR : ZONE 1	1955	UNNAMED	STOCKWATERING WILDLIFE
SRO07	NESENE06	140S	200E	W10	GRNDWTR : ZONE 1	1972	UNNAMED	STOCKWATERING WILDLIFE
SRO08	SENWNE20	140S	200E	WO1	GRNDWTR : ZONE 1	1955	UNNAMED	STOCKWATERING WILDLIFE

S H A R E D U S E S A N D D I V E R S I O N S

** WATER FROM WO2 IS SHARED WITH THESE ADDITIONAL FILES:
113-14-AA-9

** WATER FROM WO4 IS SHARED WITH THESE ADDITIONAL FILES:
113-14-AA-9

** WATER FROM WO6 FOUND IN FILE (113-14-AA-9) IS USED IN THIS FILE

P W R S U M M A R Y

PWR #	APPLICABLE ADJ FILINGS	APPLICABLE PRE FILINGS	*APPARENT FIRST USE DATE*	DATE BASIS FOR DATE	WATER SOURCES AND CLASSIFICATIONS
DM001	39-0003679	36-0020907			GROUNDWATER : ZONE 1 OF THE SAN PEDRO RIVER
IRO01	39-0003662	10-0207355.1100	1903	FILING 10-0207355-11	GROUNDWATER : ZONE 1 OF THE SAN PEDRO RIVER
IRO02	39-0003680	10-0207355.1100	1903	FILING 10-0207355-11	GROUNDWATER : ZONE 1 OF THE SAN PEDRO RIVER
IRO03	39-0003655	36-0020913	1921	1921 STATE SURVEY	GROUNDWATER : ZONE 1 OF THE SAN PEDRO RIVER
	39-0003658	36-0020914			GROUNDWATER : ZONE 2
IRO04	39-0003662	10-0207355.1100	1955	1955 AERIAL PHOTO	GROUNDWATER : ZONE 1 OF THE SAN PEDRO RIVER
IRO05	39-0003681	NDNE	1955	1955 AERIAL PHOTO	GROUNDWATER : ZONE 1 OF THE SAN PEDRO RIVER
IRO06	39-0003680	10-0207355.1100	1955	1955 AERIAL PHOTO	GROUNDWATER : ZONE 1 OF THE SAN PEDRO RIVER
IRO07	39-0003655	36-0020913	1955	1955 AERIAL PHOTO	GROUNDWATER : ZONE 1 OF THE SAN PEDRO RIVER
	39-0003658	36-0020914			GROUNDWATER : ZONE 2
IRO08	39-0003649	36-0020908	1955	1955 AERIAL PHOTO	GROUNDWATER : ZONE 1 OF THE SAN PEDRO RIVER
	39-0003656				GROUNDWATER : ZONE 2
IRO09	39-0003653	10-0207355.1100	1972	1972 AERIAL PHOTO	GROUNDWATER : ZONE 1 OF THE SAN PEDRO RIVER
	39-0003657	36-0020909			GROUNDWATER : ZONE 1 OF THE SAN PEDRO RIVER
		36-0020909			
		36-0020923			
IRO10	39-0003680	10-0207355.1100	1972	1972 AERIAL PHOTO	GROUNDWATER : ZONE 1 OF THE SAN PEDRO RIVER
IRO11	39-0003655	36-0020913	1972	1972 AERIAL PHOTO	GROUNDWATER : ZONE 1 OF THE SAN PEDRO RIVER
	39-0003658	36-0020914			GROUNDWATER : ZONE 2
IRO12	39-0003654	36-0020911	1972	1972 AERIAL PHOTO	GROUNDWATER : ZONE 1 OF THE SAN PEDRO RIVER
		36-0020919			

PWR #	APPLICABLE ADJ FILINGS	APPLICABLE PRE FILINGS	*APPARENT FIRST USE DATE*	DATE BASIS FOR DATE	WATER SOURCES AND CLASSIFICATIONS
IRO13	39-0003659	36-0020912	1972	1972 AERIAL PHOTO	GROUNDWATER : ZONE 2
IRO14	39-0003680	NONE	1990	1990 AERIAL PHOTO.	GROUNDWATER : ZONE 1 OF THE SAN PEDRO RIVER
SRO01	39-0003653	36-0020909	1972	1972 AERIAL PHOTO	GROUNDWATER : ZONE 1 OF THE SAN PEDRO RIVER
	39-0003657	36-0020923			
SRO02	39-0003658	36-0020914	1972	1972 AERIAL PHOTO	GROUNDWATER : ZONE 2
SRO03	39-0003658	36-0020914	1972	1972 AERIAL PHOTO	GROUNDWATER : ZONE 2
SRO04	39-0003658	36-0020914	1972	1972 AERIAL PHOTO	GROUNDWATER : ZONE 2
SRO05	39-0003680	NONE	1984	1984 AERIAL PHOTO	GROUNDWATER : ZONE 1 OF THE SAN PEDRO RIVER
SRO06	39-0003662	NONE	1955	1955 AERIAL PHOTO	GROUNDWATER : ZONE 1 OF THE SAN PEDRO RIVER
SRO07	39-0003662	NONE	1972	1972 AERIAL PHDOTO	GROUNDWATER : ZONE 1 OF THE SAN PEDRO RIVER
SRO08	39-0003649	36-0020908	1955	1955 AERIAL PHOTO	GROUNDWATER : ZONE 1 OF THE SAN PEDRO RIVER
	39-0003656				
NONE	39-0003660	NONE			
	39-0003661				
	39-0003669				
	39-0003676				

Q U A N T I T I E S O F U S E

PWR #	QUANTIFICATION TYPE	ACRES	CROP TYPE	EFF	WATER DUTY	ESTIMATED VOLUME	REMARKS
DM001							SEE VOLUME 1 - GENERAL ASSESSMENT
IRO01	MAX. OBSERVED REGIONAL	36.3	ALFALFA	45%	7.4 AF/AC	268.6 AFA	
	MAX. POTENTIAL	36.3	AVE. CROP	50%	5.4 AF/AC	196.0 AFA	
IRO02	MAX. OBSERVED REGIONAL	4.7	FALL GRAINS	38%	1.1 AF/AC	5.2 AFA	
	MAX. POTENTIAL	4.7	AVE. CROP	50%	5.4 AF/AC	25.4 AFA	
IRO03	MAX. OBSERVED REGIONAL	18.7	MULTI. CROPS	47%	5.9 AF/AC	110.3 AFA	
	MAX. POTENTIAL	18.7	AVE. CROP	50%	5.4 AF/AC	101.0 AFA	
IRO04	MAX. OBSERVED REGIONAL	52.5	ALFALFA	45%	7.4 AF/AC	388.5 AFA	
	MAX. POTENTIAL	52.5	AVE. CROP	50%	5.4 AF/AC	283.5 AFA	
IRO05	MAX. OBSERVED REGIONAL	46.9	MULTI. CROPS	45%	7.2 AF/AC	337.7 AFA	
	MAX. POTENTIAL	46.9	AVE. CROP	50%	5.4 AF/AC	253.3 AFA	
IRO06	MAX. OBSERVED REGIONAL	2.0	FALL GRAINS	38%	1.1 AF/AC	2.2 AFA	
	MAX. POTENTIAL	2.0	AVE. CROP	50%	5.4 AF/AC	10.8 AFA	
IRO07	MAX. OBSERVED REGIONAL	26.4	MULTI. CROPS	42%	5.7 AF/AC	150.5 AFA	
	MAX. POTENTIAL	26.4	AVE. CROP	50%	5.4 AF/AC	142.6 AFA	
IRO08	MAX. OBSERVED REGIONAL	66.9	PERM. PSTR	58%	5.4 AF/AC	361.3 AFA	
	MAX. POTENTIAL	66.9	AVE. CROP	50%	5.4 AF/AC	361.3 AFA	
IRO09	MAX. OBSERVED REGIONAL	35.1	PERM. PSTR	58%	5.4 AF/AC	189.5 AFA	
	MAX. POTENTIAL	35.1	AVE. CROP	50%	5.4 AF/AC	189.5 AFA	
IRO10	MAX. OBSERVED REGIONAL	49.0	MULTI. CROPS	38%	5.3 AF/AC	259.7 AFA	
	MAX. POTENTIAL	49.0	AVE. CROP	50%	5.4 AF/AC	264.6 AFA	
IRO11	MAX. OBSERVED REGIONAL	93.9	MULTI. CROPS	41%	5.6 AF/AC	525.8 AFA	
	MAX. POTENTIAL	93.9	AVE. CROP	50%	5.4 AF/AC	507.1 AFA	
IRO12	MAX. OBSERVED REGIONAL	18.2	PERM. PSTR	58%	5.4 AF/AC	98.3 AFA	
	MAX. POTENTIAL	18.2	AVE. CROP	50%	5.4 AF/AC	98.3 AFA	
IRO13	MAX. OBSERVED REGIONAL	30.1	FALL GRAINS	58%	.7 AF/AC	21.1 AFA	
	MAX. POTENTIAL	30.1	AVE. CROP	50%	5.4 AF/AC	162.5 AFA	
IRO14	MAX. OBSERVED REGIONAL	5.4	PERM. PSTR	58%	5.4 AF/AC	29.2 AFA	
	MAX. POTENTIAL	5.4	AVE. CROP	50%	5.4 AF/AC	29.2 AFA	
SRO01	MAX. AREA/CAP	LT 2.0				LTE 15.0 AF	
SRO02	MAX. AREA/CAP	LT 2.0				LTE 15.0 AF	
SRO03	MAX. AREA/CAP	LT 2.0				LTE 15.0 AF	
SRO04	MAX. AREA/CAP	LT 2.0				LTE 15.0 AF	

PWR #	QUANTIFICATION			CROP TYPE	EFF	WATER DUTY	ESTIMATED VOLUME	REMARKS
	TYPE	ACRES						
SRO05	MAX.	AREA/CAP	LT 2.0				LTE 15.0 AF	
SRO06	MAX.	AREA/CAP	LT 2.0				LTE 15.0 AF	
SRO07	MAX.	AREA/CAP	LT 2.0				LTE 15.0 AF	
SRO08	MAX.	AREA/CAP	LT 2.0				LTE 15.0 AF	

E X P L A N A T I O N

FILINGS AND DECREES

FILINGS 36-20919, 36-20923, 39-3649 & 39-3653 - CLAIM STOCKWATERING USE ONLY FROM WELLS W1, W2 & W4. WELLS W1, W2 & W4 ALSO PROVIDE WATER FOR IRRIGATION USES.

DIVERSIONS

W1-W7 - WELLS PROVIDE WATER FOR IRRIGATION, STOCKWATERING, AND WILDLIFE USES.
 W8 - WELL PROVIDES WATER FOR IRRIGATION, DOMESTIC, AND STOCKWATERING USES.
 W9 - WELL PROVIDES WATER FOR DOMESTIC USES.

USES AND RESERVOIRS

DM1 - DOMESTIC USE.
 IR1-IR14 - IRRIGATED PASTURE, ALFALFA, AND SMALL GRAINS.
 SR1 - SMALL RESERVOIR, SUPPLIED BY WELL W2, IS USED FOR STOCKWATERING AND WILDLIFE PURPOSES.
 SR2-SR4 - SMALL RESERVOIRS, SUPPLIED BY WELL W5, IS USED FOR STOCKWATERING AND WILDLIFE PURPOSES.
 SR5 - SMALL RESERVOIR, SUPPLIED BY WELLS W7 & W8, IS USED FOR STOCKWATERING AND WILDLIFE PURPOSES.
 SR6 & SR7 - SMALL RESERVOIR, SUPPLIED BY WELL W10, IS USED FOR STOCKWATERING AND WILDLIFE PURPOSES.
 SR8 - SMALL RESERVOIR, SUPPLIED BY WELL W1, IS USED FOR STOCKWATERING AND WILDLIFE PURPOSES.

SHARED USES AND DIVERSIONS

W2, W4 & W6 - WELLS ARE SHARED WITH W.F.R. #113-14-AA-9.

LAND OWNER	ZONE 2 WELL REPORT NUMBER
-----	-----
WOODLING, REESOR G.	113-14-AA-001

WELLS	WELL NAMES	WELL LOCATION			WATER USES SERVED	REMARKS
		SECTION	TWNP	RNGE		
W05	UNNAMED	NENESW08	140S	200E	IRO03, IRO07, IRO11 SRO02, SRO03, SRO04	W1-11-2783 SHARED
W06	UNNAMED	NWSWNE08	140S	200E	IRO13	

WATER USE NUMBERS	WATER USE LOCATION			*** APPARENT FIRST USE ***		APPAR. ANNUAL VOLUME USED	ACRES IRRIGATED
	SECTION	TWNP	RNGE	DATE	BASIS FOR DATE		
IRO03	NESE07	140S	200E	1921	1921 STATE SURVEY	101.0 AFA	18.7
	NWSW08	140S	200E				
	SENE07	140S	200E				
	SWNW08	140S	200E				
	SWSE08	140S	200E				
IRO07	NESW08	140S	200E	1955	1955 AERIAL PHOTO	142.6 AFA	26.4
	NWSW08	130S	200E				
	SENE07	140S	200E				
	SESW08	140S	200E				
	SWNW08	130S	200E				
IRO11	SWSE08	130S	200E	1972	1972 AERIAL PHOTO	507.1 AFA	93.9
	NW08	140S	200E				
	SE08	140S	200E				
IRO13	SW08	140S	200E	1972	1972 AERIAL PHOTO	162.0 AFA	30.1
	NESW08	140S	200E				
	NWSE08	140S	200E				
SRO02	SENW08	140S	200E	1972	1972 AERIAL PHOTO	LTE 15.0 AF	
SRO03	SESENE07	140S	200E	1972	1972 AERIAL PHOTO	LTE 15.0 AF	
SRO04	SWNWSW08	140S	200E	1972	1972 AERIAL PHOTO	LTE 15.0 AF	

APPLICABLE STATEMENTS OF CLAIMANT	APPLIES TO: WELLS	APPLIES TO: WATER USES
-----	-----	-----
39-0003655		IRO03, IRO07, IRO11
39-0003658	W05	IRO03, IRO07, IRO11
39-0003659	W06	IRO13

EXPLANATION

THE APPARENT ANNUAL VOLUME REPORTED FOR IRO03 IS PARTIALLY SUPPLIED BY ZONE 1 GROUNDWATER.
 THE APPARENT ANNUAL VOLUME REPORTED FOR IRO07 IS PARTIALLY SUPPLIED BY ZONE 1 GROUNDWATER.
 THE APPARENT ANNUAL VOLUME REPORTED FOR IRO11 IS PARTIALLY SUPPLIED BY ZONE 1 GROUNDWATER.

** WATER FROM W06 FOUND IN FILE (113-14-AA-9) IS USED IN THIS FILE.

W5 & W6 - WELLS PROVIDE WATER FOR IRRIGATION, STOCKWATERING, AND WILDLIFE USES.

IR3, IR7, IR11 & IR13 - IRRGATED PASTURE, ALFALFA, AND SMALL GRAINS.

SR2-SR4 - SMALL RESERVOIRS ARE USED FOR STOCKWATERING AND WILDLIFE PURPOSES.

ATTACHMENT B

1
2
3
4
5
6
7
8
9
10
11
12
13
14
15
16
17
18
19
20
21
22
23
24
25
26
27
28

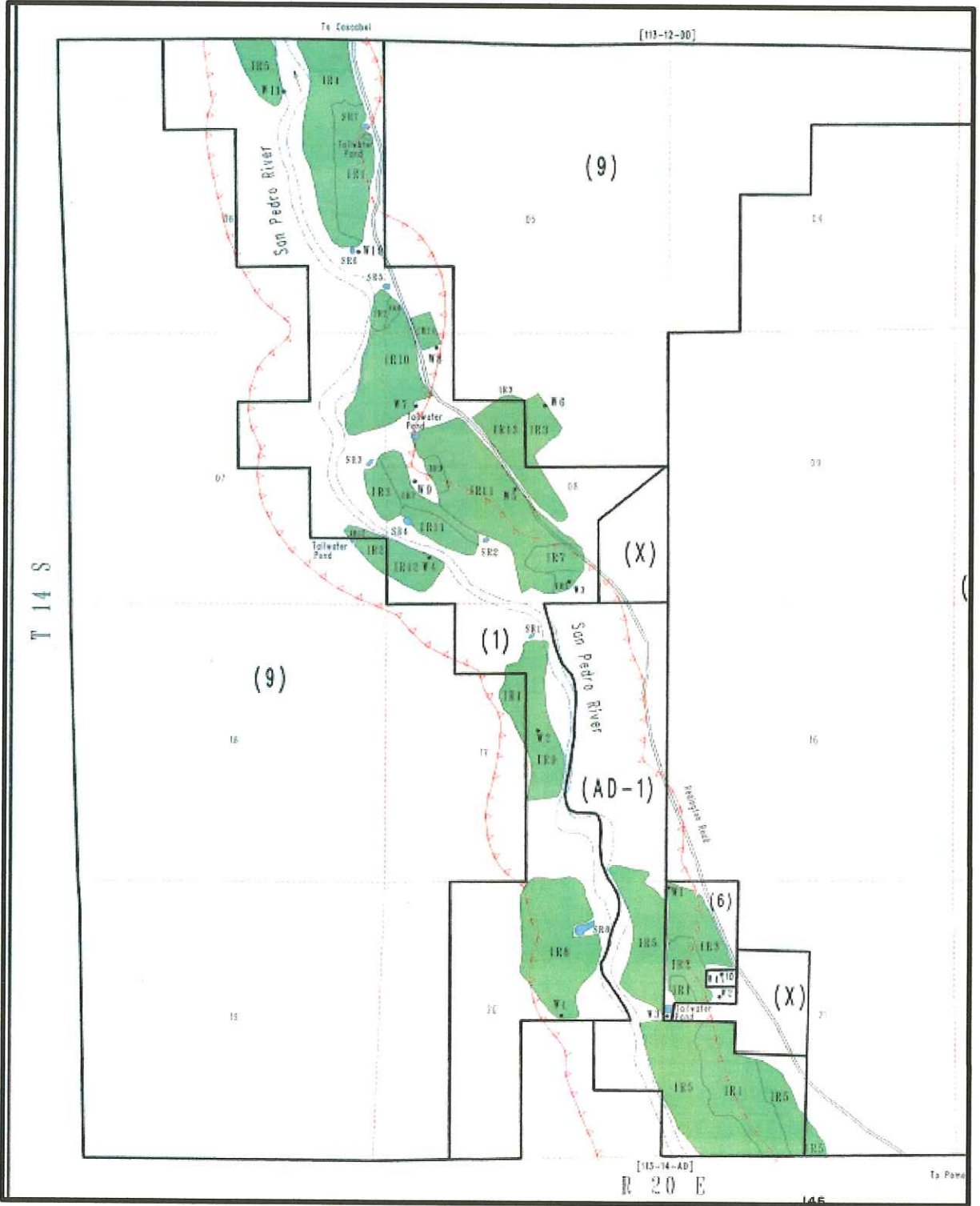

ATTACHMENT C

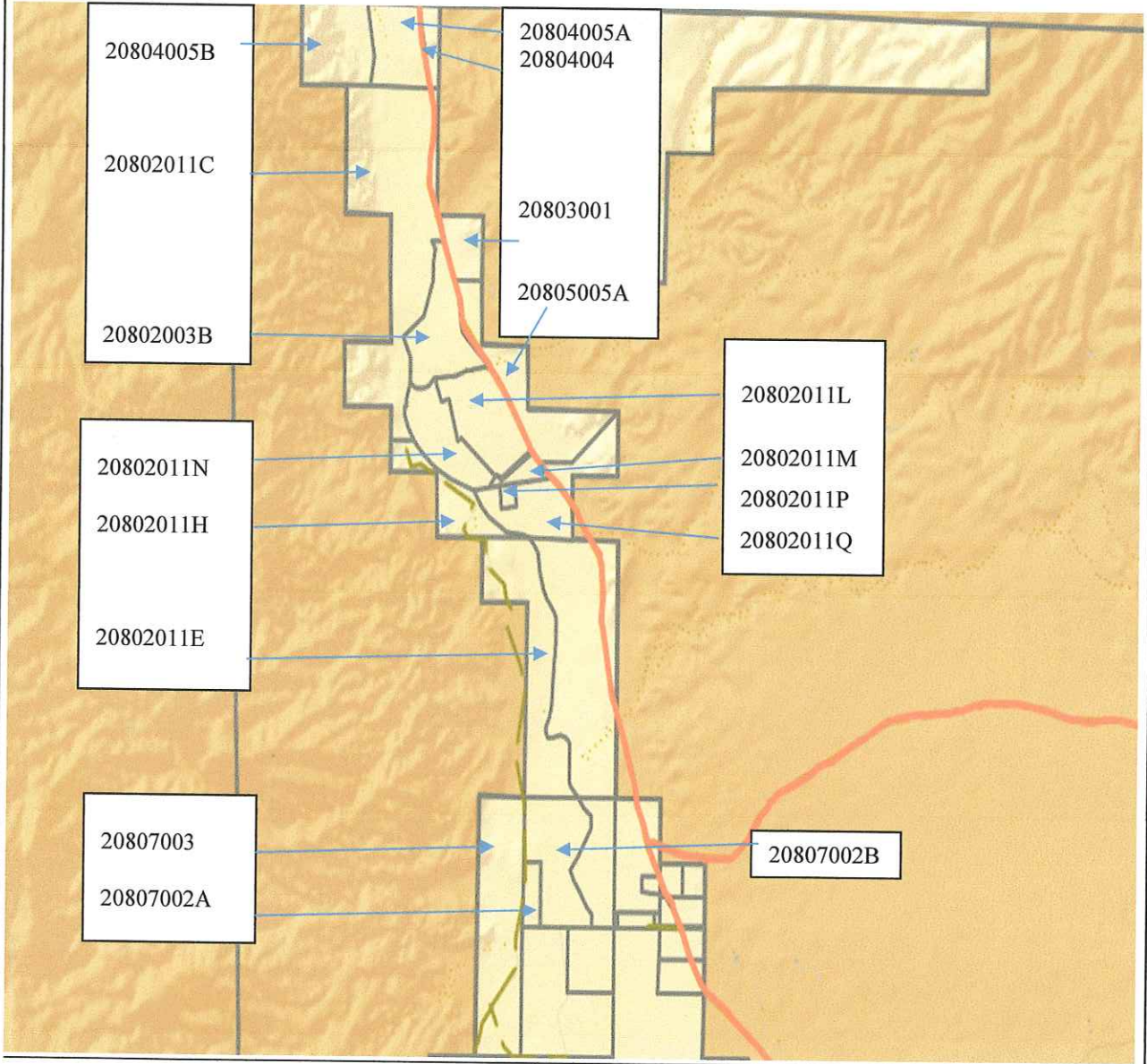

1
2
3
4
5
6
7
8
9
10
11
12
13
14
15
16
17
18
19
20
21
22
23
24
25
26
27
28

ATTACHMENT D

1
2
3
4 Arizona Department of Water Resources
5 Kimberly Parks
6 P. O. Box 36020
7 Phoenix, AZ 85067

8 ASARCO Incorporated
9 Lauren J. Caster
10 Fennemore Craig, P.C.
11 2394 East Camelback Road
12 Suite 600
13 Phoenix, AZ 85016-3429

14 Cascabel Land & Cattle Co.
15 Star Rt.
16 Box 40
17 Benson AZ 85602

18 Cascabel Land & Cattle Co.
19 5970 E. San Leandro
20 Tucson, AZ 85715

21 Clerk of the Superior Court
22 Maricopa County
23 Attn: Water Case
24 601 West Jackson Street
25 Phoenix, AZ 85003

26 E. Lamar Smith
27 HCR 701
28 Benson, AZ 85602

Gila River Indian Community
Linus Everling and Thomas L. Murphy
Office of the General Counsel
P. O. Box 97
Sacaton, AZ 85147

Janice I. Carder and Linda M. Giddings
2235 Capistrano Avenue
Las Vegas, NV 89109

1 Joe P. Sparks and Laurel A. Herrmann
the Sparks Law Firm, P.C.
2 7503 First Street
Scottsdale, Az 85251-4573
3

4 Lucas T. Christian, Julian Nava
Richard J. Palmer & Jeremiah Weiner
5 Rosette, LLP
565 W. Chandler Blvd. Suite 212
6 Chandler, AZ 85225

7 S. Montgomery, R. Interpreter, J. Tomkus,
8 Mia A. Montoya Hammersley
Montgomery & Interpreter, Plc
9 3301 E. Thunderbird Road
Phoenix, AZ 85032

10 Salt River Valley Water Users Association,
11 Salt River Project Agricultural Improvement and Power District
12 John B. Weldon, Jr. and Mark A. McGinnis
Salmon, Lewis & Weldon PLC
13 2850 E Camelback Rd, Ste. 200
Phoenix, AZ 85016

14 Special Master Susan Ward Harris
15 Superior Court of Arizona
16 201 W. Jefferson Street
Courtroom 301
17 Phoenix, AZ 85003

18 U. S. Department of Justice
19 Patrick Barry, Yosef Negose, and Emmi Blades
Environment and Natural Resources
20 P. O. Box 7611
Washington, D.C. 20044-7611
21
22
23
24
25
26
27
28