

1
2
3
4
5
6
7
8
9
10
11
12
13
14
15
16
17
18
19
20
21
22
23
24
25
26

**IN THE SUPERIOR COURT OF THE STATE OF ARIZONA
IN AND FOR THE COUNTY OF MARICOPA**

IN RE: THE GENERAL
ADJUDICATION OF ALL RIGHTS
TO USE WATER IN THE GILA
RIVER SYSTEM AND SOURCE

CIVIL NO. W1-11-3313

**[PROPOSED] ORDER ON
STIPULATION, WITHDRAWAL OF
OBJECTIONS, AND REQUEST THAT
THE SPECIAL MASTER APPROVE
PROPOSED WATER RIGHT
ABSTRACTS FOR ARAVAIPA CANYON
RANCH, LLC**

(Assigned to the Special Master Susan Ward
Harris)

The Court, having reviewed the Stipulation, Withdrawal of Objections, and Request that the Special Master Approve Proposed Water Right Abstracts for Aravaipa Canyon Ranch, LLC, and good cause appearing,

IT IS ORDERED approving the proposed irrigation, domestic, and other water right abstracts attached hereto as Appendix A. The abstracts will be included in a Catalog of Proposed Water Rights created pursuant to § 15 of the Rules for Proceedings before the Special Master.

SIGNED this 4th day of June, 2019.

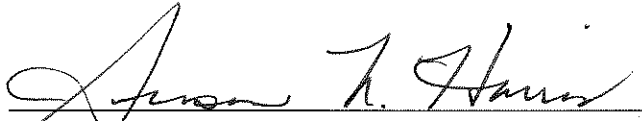

Susan Ward Harris
SPECIAL MASTER

1
2
3
4
5
6
7
8
9
10
11
12
13
14
15
16
17
18
19
20
21
22
23
24
25
26

ORIGINAL of the foregoing delivered to the Clerk
of the Maricopa County Superior Court on the
4th day of June, 2019, for filing
and distribution to all persons listed on the Court-
Approved Mailing List for Case No. W1-11-3313
dated November 19, 2018.

Barbara Brown

APPENDIX A

Abstract of Water Right San Pedro Watershed

| | |
|-----------------------------------|--|
| 1. Proposed Water Right: | 115-04-ADB-002-IR001 |
| 2. Owner of Right: | Aravaipa Canyon Ranch, LLC 135 West Washington Street Tucson, Arizona 85701 |
| 3. Landowner: | Aravaipa Canyon Ranch, LLC |
| 4. Statement of Claimant No.(s): | 39-0006579 |
| 5. Statement of Claimant Name(s): | Aravaipa Canyon Ranch, LLC |
| 6. Lessee or Permittee: | None |
| 7. Basis of Right: | 36-0068562 55-215765 55-528178 55-648741 55-648742 55-907420 |
| 8. Beneficial Use: | Irrigation |
| 9. Priority Date: | December 15, 1905 |
| 10. Quantity: | Field 2: 29.74 AFA (5.31 acres) Field 3: 4.09 AFA (0.73 acres) Field 4: 4.09 AFA (0.73 acres) Field 5: 6.16 AFA (1.1 acres) Field 6: 8.51 AFA (1.52 acres) Total: 52.59 AFA (9.39 acres) Maximum diversion rate = 1.5 CFS (673 gpm) |
| 11. Place of Use:* | NE SW NE Section 34 T06S R17E NW SW NE Section 34 T06S R17E SW SW NE Section 34 T06S R17E |
| 12. Point of Diversion:* | 55-215765: NW SW NE Section 34 T06S R17E 55-528178: SW SW NE Section 34 T06S R17E 55-648741: NE SW NE Section 34 T06S R17E 55-648742: NE SW NE Section 34 T06S R17E 55-907420: NW SW NE Section 34 T06S R17E Instream pump: NE SW NE Section 34 T06S R17E |
| 13. Source of Water: | Aravaipa Creek |
| 14. GPS coordinates for PODs:* | 55-215765: 32°52'13.25"N, 110°35'42.15"W 55-528178: 32°52'9.71"N, 110°35'42.48"W |

| | |
|--|--|
| | 55-648741: 32°52'15.72"N, 110°35'36.50"W 55-648742: 32°52'15.10"N, 110°35'37.50"W 55-907420: 32°52'11.67"N, 110°35'43.54"W Instream pump: 32°52'14.35"N, 110°35'35.75"W |
|--|--|

Additional Information

| |
|--------------------|
| *See attached map. |
|--------------------|

In re Barassi
 Contested Case W1-11-3313
 Watershed File Report
 115-04-ADB-002

IR001
 Points of Diversion & Places of Use
 T6S R17E Section 34

Revised May 2019

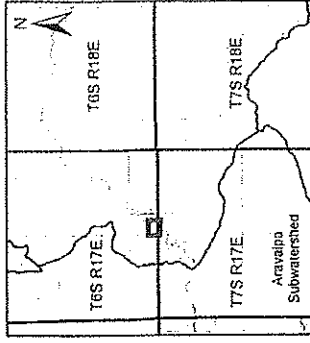

Legend

- Well Locations & GPS Points
- Township Range
- Section
- Irrigated Area
- Pinal County
- Parcels
- QQQ

GPS coordinates, Well identification, & boundaries of irrigated areas as provided by Claimant

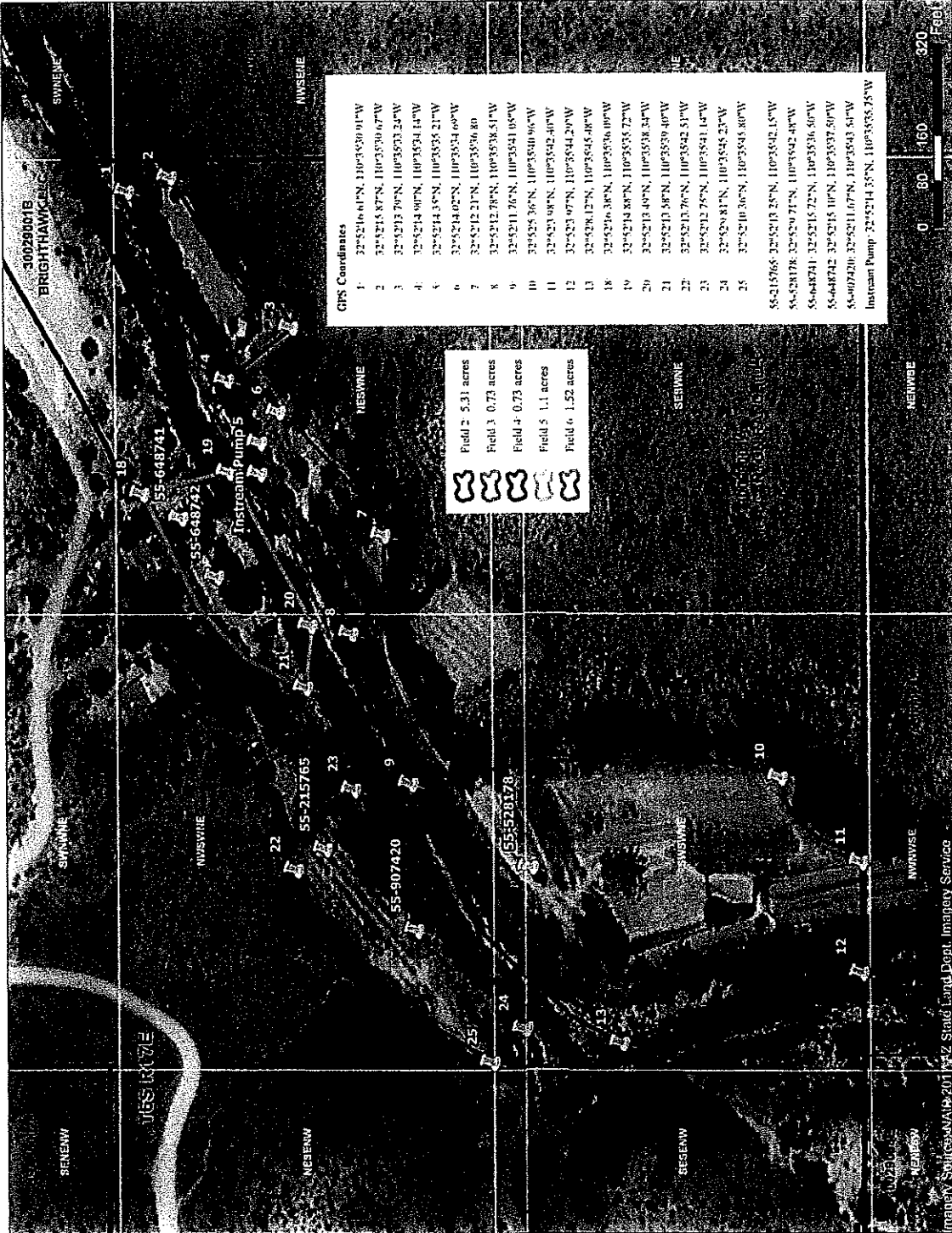

Abstract of Water Right San Pedro Watershed

| | |
|-----------------------------------|--|
| 1. Proposed Water Right: | 115-04-ADB-002-OT001 |
| 2. Owner of Right: | Aravaipa Canyon Ranch, LLC 135 West Washington Street Tucson, Arizona 85701 |
| 3. Landowner: | Aravaipa Canyon Ranch, LLC |
| 4. Statement of Claimant No.(s): | 39-0006579 |
| 5. Statement of Claimant Name(s): | Aravaipa Canyon Ranch, LLC |
| 6. Lessee or Permittee: | None |
| 7. Basis of Right: | 36-0068562 55-215765 55-648741 55-648742 |
| 8. Beneficial Use: | Irrigation |
| 9. Priority Date: | December 15, 1905 |
| 10. Quantity: | 1.57 AFA (0.28 acres) Maximum diversion rate = 1.5 CFS (673 gpm) |
| 11. Place of Use:* | SW NW NE Section 34 T06S R17E NW SW NE Section 34 T06S R17E |
| 12. Point of Diversion:* | 55-215765: NW SW NE Section 34 T06S R17E 55-648741: NE SW NE Section 34 T06S R17E 55-648742: NE SW NE Section 34 T06S R17E Instream pump: NE SW NE Section 34 T06S R17E |
| 13. Source of Water: | Aravaipa Creek |
| 14. GPS coordinates for PODs:* | 55-215765: 32°52'13.25"N, 110°35'42.15"W 55-648741: 32°52'15.72"N, 110°35'36.50"W 55-648742: 32°52'15.10"N, 110°35'37.50"W Instream pump: 32°52'14.35"N, 110°35'35.75"W |

Additional Information

*See attached map.

In re Barassi

Contested Case W1-11-3313
Watershed File Report
115-04-ADB-002

OT001

Points of Diversion & Places of Use

T6S R17E, Section 34



ADWR April 2019

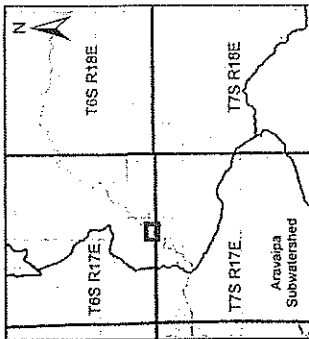

Legend

- Well Locations & GPS Points
- Township/Range
- Section
- Irrigated Area
- Pinal County
- Parcels
- QQQ

GPS coordinates, Well identification, & boundaries of irrigated areas as provided by Claimant

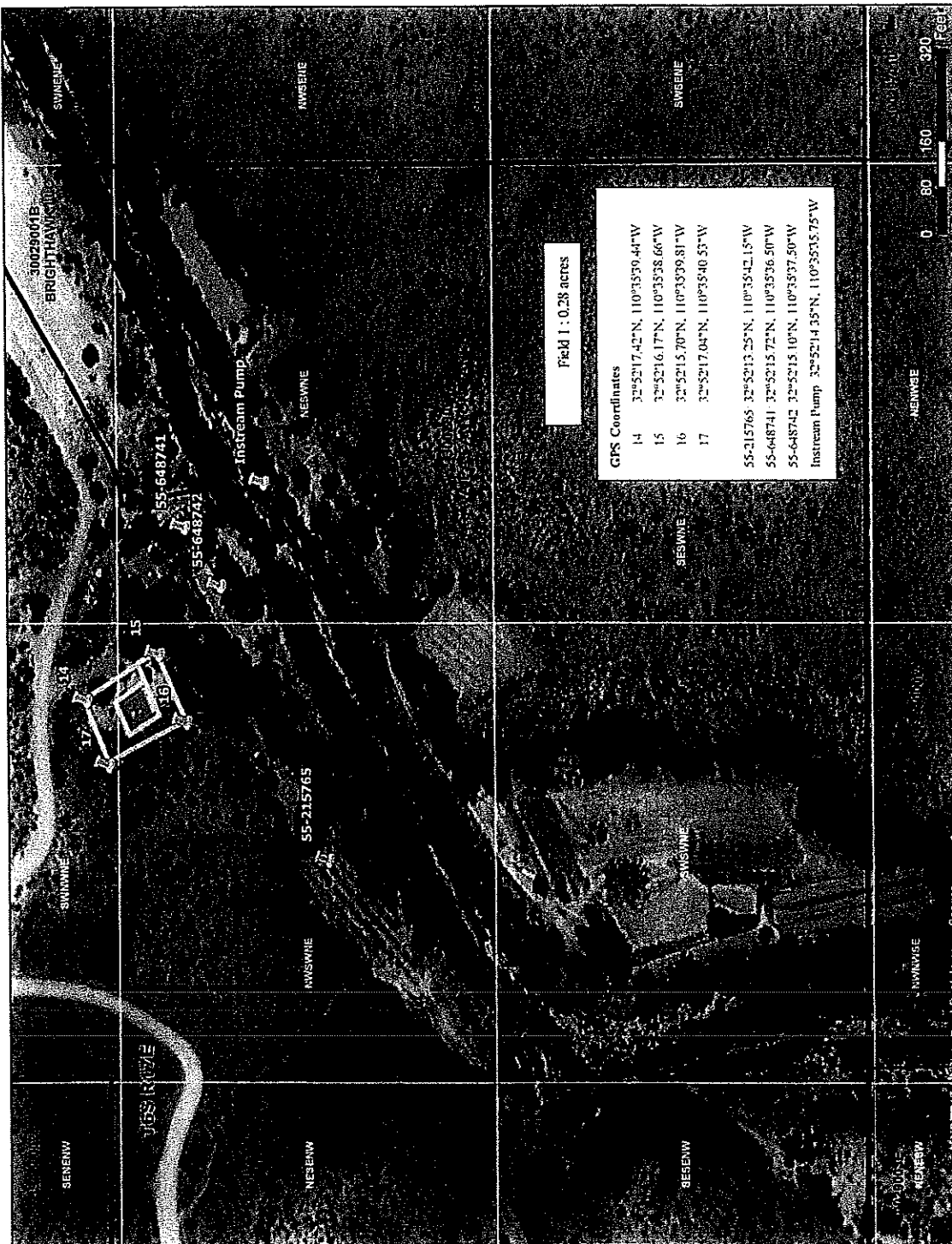

Field 1: 0.28 acres

| GPS Coordinates | |
|---|-------------------------------|
| 14 | 32°52'17.42"N, 110°35'39.44"W |
| 15 | 32°52'16.17"N, 110°35'58.66"W |
| 16 | 32°52'15.70"N, 110°35'39.81"W |
| 17 | 32°52'17.04"N, 110°35'40.53"W |
| 55-215765 32°52'13.25"N, 110°35'42.15"W | |
| 55-648741 32°52'15.72"N, 110°35'56.50"W | |
| 55-648742 32°52'15.10"N, 110°35'37.50"W | |
| Instream Pump 32°52'14.35"N, 110°35'55.75"W | |



Abstract of Water Right San Pedro Watershed

| | |
|--|--|
| 1. Proposed Water Right: | 115-04-ADB-002-DM001 |
| 2. Owner of Right: | Aravaipa Canyon Ranch, LLC 135 West Washington Street Tucson, Arizona 85701 |
| 3. Landowner: | Aravaipa Canyon Ranch, LLC |
| 4. Statement of Claimant No.(s): | 39-0006579 |
| 5. Statement of Claimant Name(s): | Aravaipa Canyon Ranch, LLC |
| 6. Lessee or Permittee: | None |
| 7. Basis of Right: | 36-0068562 55-215765 55-648741 55-648742 |
| 8. Beneficial Use: | Domestic, including stockwatering |
| 9. Priority Date: | December 15, 1905 |
| 10. Quantity: | 2 AFA |
| 11. Place of Use:* | NE SW NE Section 34 T06S R17E NW SW NE Section 34 T06S R17E |
| 12. Point of Diversion:* | 55-215765: NW SW NE Section 34 T06S R17E 55-648741: NE SW NE Section 34 T06S R17E 55-648742: NE SW NE Section 34 T06S R17E |
| 13. Source of Water: | Aravaipa Creek |
| 14. GPS Coordinates for PODs: | 55-215765: 32°52'13.25"N, 110°35'42.15"W 55-648741: 32°52'15.72"N, 110°35'36.50"W 55-648742: 32°52'15.10"N, 110°35'37.50"W |

Additional Information

*See attached map.

In re Barassi
 Contested Case W1-11-3313
 Watershed File Report
 115-04-ADB-002

DM001
 Points of Diversion
 T6S R17E, Section 34



ADWR April 2019

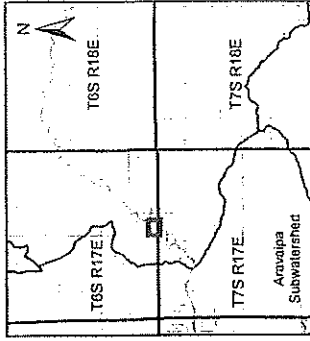

Legend

- Well
- Location
- Pinal County
- Parcel
- Township/Range
- Section
- QQQ

GPS coordinates, Well identification, & boundaries of irrigated areas as provided by Claimant.

