

1  
2  
3  
4  
5  
6  
7  
8  
9  
10  
11  
12  
13  
14  
15  
16  
17  
18  
19  
20  
21  
22  
23  
24  
25  
26  
27  
28

IN THE SUPERIOR COURT OF THE STATE OF ARIZONA  
IN AND FOR THE COUNTY OF MARICOPA

IN RE THE GENERAL ADJUDICATION  
OF ALL RIGHTS TO USE WATER IN  
THE GILA RIVER SYSTEM AND  
SOURCE

W-1, W-2, -W-3, W-4 (Consolidated)  
Contested Case No. W1-11-1481  
ORDER TO INITIATE CONTESTED  
CASE

CONTESTED CASE NAME: *In re H. Clifford Dobson Jr. Ranch*  
HSR INVOLVED: San Pedro River Watershed Hydrographic Survey Report  
DESCRIPTIVE SUMMARY: Contested case initiated and status conference set for **February 3, 2022 at 2:00 PM**  
NUMBER OF PAGES: 23  
DATE OF FILING: December 3, 2021

**General Explanation**

This Order begins the process necessary to adjudicate claims made for rights to appropriable water for use on land previously owned by H. Clifford Dobson, Jr. This contested case is one of the many cases in the General Stream Adjudication for the San Pedro River

1 Watershed to determine legal rights to water. Other cases in which claims have been made for  
2 legal rights to water in the San Pedro River Watershed have been completed, are in the process  
3 of determining water rights, or are awaiting initiation. The purpose of the General Adjudication  
4 is to determine the rights of those persons who filed statements of claimant for rights to use  
5 appropriable water in Arizona. The General Adjudication will also determine water rights in the  
6 Upper Salt, Verde, Upper Gila, Lower Gila, Agua Fria, and Upper Santa Cruz watersheds.  
7

8 In this case, White House Ranch, Mo and Darlene Grenier, and Thomas G. and Karen  
9 Ann Baker (“Claimants”) collectively filed ten Statements of Claimant for rights to water in  
10 Sections 28, 29, 31, and 32 of Township 15S Range 20E. The Arizona Department of Water  
11 Resources (“ADWR”) investigated the claims. It found potential water rights for four irrigation  
12 uses and two domestic uses and prepared Watershed File Report and Zone 2 Well Report 112-  
13 14-DAC-001 (“Reports”) published in the Final San Pedro River Watershed Hydrographic  
14 Survey Report (1991). The Watershed File Report (“WFR”) reported a notice of appropriation  
15 for irrigation with an 1893 priority date. Statement of Claimant 39-3891 also claims a priority  
16 date of 1891. The Watershed File Report 112-14-DAC-001 lists the source of water for the  
17 potential water rights as eight wells identified as W01-W08. According to ADWR, all eight  
18 wells listed on the WFR are located within the boundaries of the subflow zone of the San Pedro  
19 River. A copy of the Reports is attached as Attachment A. A copy of the map of 112-14-DAC-  
20 001 prepared by ADWR for the Reports is attached as Attachment B with the land associated  
21 with this case labeled as “(1)” and “(DAC-1)”.

22 After ADWR issued the Reports, objections were filed to the findings made in the  
23 Reports. The purpose of this case is to consider the claims made for water rights that are the  
24 subject of the Reports and resolve the objections to the Reports.  
25  
26  
27  
28

1 **Claimants & Landowners**

2 The Reports identified 10 Statements of Claimant (“SOC”) relevant to the potential water  
3 rights. The Statements of Claimant and the corresponding Claimants are listed in the table below.  
4

5 <b>Statement of Claim No.</b>	<b>Claimant</b>
6 39-2808	White House Ranch
7 39-2809	White House Ranch
8 39-2810	White House Ranch
9 39-2811	White House Ranch
10 39-2829	White House Ranch
11 39-3891	Mo & Darlene Grenier
12 39-4838	White House Ranch
13 39-4839	White House Ranch
14 39-4840	White House Ranch
15 39-11305	Thomas G. and Karen Ann Baker

16  
17 The Reports list H. Clifford Dobson Jr. as the owner of the property described as located in  
18 Sections 28, 29, 31, and 32 of Township 15S Range 20E. The public records of the Arizona  
19 Department of Water Resources do not contain an assignment of any of the SOCs. However,  
20 the public records of the Arizona Department of Water Resources do contain four SOCs filed by  
21 Dan White for irrigation use on the property described in the Reports: 39-17888, 39-17889, 39-  
22 17890, and 39-18120. Statement of Claimant 39-17888 was filed on October 20, 2016 for  
23 irrigation use from a well in the SESWSW Section 31 T15S R20E. Statement of Claimant 39-  
24 17889 was filed on October 20, 2016 for water for irrigation use from a well located SENWSE  
25 Section 29 T15S R20E. Statement of Claimant 39-17890 was also filed on October 20, 2016 for  
26  
27  
28

1 water for irrigation use from a well located SWSESE Section 29 T15S R20E registered as 55-  
2 224376. Statement of Claimant 39-18120 was filed on July 28, 2020 for water for irrigation use  
3 from a well located in SENWNE Section 29 T15S R20E registered as 55-230771.

4 The Cochise County Assessor lists Daniel M. and Gwen R. White and David C. and  
5 Susan A. Kennedy as the current owners of the land described in the Reports. Daniel M. and  
6 Gwen R. White own tax parcel no. 208-10-066A. David C. and Susan A. Kennedy own tax  
7 parcel no. 208-10-003A. A copy of a map prepared by the Cochise County Assessor showing  
8 these tax parcels is attached as Attachment C.  
9

10  
11 **IT IS ORDERED:**

12 1. Contested Case. This contested case shall be known as *In re H. Clifford Dobson*  
13 *Jr. Ranch* and it will determine appropriable water rights asserted in the Statements of Claimant  
14 and objections that were filed to Watershed File Report and Zone 2 Well Report 112-14-DAC-  
15 001 published in the Final San Pedro River Watershed Hydrographic Survey Report (1991).  
16 Copies of objections can be found under the case name and number on the following website:  
17 [http://www.superiorcourt.maricopa.gov/SuperiorCourt/GeneralStreamAdjudication/whatsNew.](http://www.superiorcourt.maricopa.gov/SuperiorCourt/GeneralStreamAdjudication/whatsNew.asp)  
18 [asp](http://www.superiorcourt.maricopa.gov/SuperiorCourt/GeneralStreamAdjudication/whatsNew.asp)

19 2. Litigants. The litigants in this contested case are the Claimants, the current  
20 landowners, all persons who filed objections to the Reports who are listed on Attachment D, and  
21 parties who are allowed to intervene by order.

22 3. Court-Approved Mailing List.

23  
24 A. The initial Court-approved mailing list for this case shall include all  
25 persons listed on Attachment D to this order. The list may be modified only by  
26 filing a motion with the Special Master to amend the Court-approved mailing list.  
27 Litigants are responsible for using the current Court-approved mailing list.  
28

1 B. A copy of any pleading filed with the Clerk of the Maricopa County  
2 Superior Court in this case shall be served upon each person listed on the Court-  
3 approved mailing list.

4 C. Claimants wishing to be added to or removed from the mailing list shall  
5 file a motion with the Special Master. Parties allowed to intervene will be  
6 automatically added to the Court-approved mailing list.

7 D. The Clerk of the Court will send copies of all minute entries and orders  
8 issued in this case to the parties listed on the Court-approved mailing list. Upon  
9 request, the Clerk of the Court will provide copies by email. Parties may request  
10 emailed copies of minute entries and orders by completing and submitting a  
11 CONSENT FOR ELECTRONIC RECEIPT OF WATER CASE DOCUMENTS,  
12 which is attached as Attachment E.  
13

14  
15 4. Status Conference. An initial status conference shall be held to determine whether  
16 the claimants or current landowners intend to pursue claims for rights to appropriable  
17 water for irrigation and domestic uses. If the current landowners intend to assert  
18 rights to water they shall be prepared to provide the registration number for all wells  
19 that are intended to serve as the source of water.  
20

21 a. The Status Conference shall be held on **February 3, 2022 at 2:00 p.m.**

22 b. The Status Conference shall be held using Court Connect. Instructions for  
23 Court Connect are attached as Attachment F. If you receive this Order by  
24 email, click on the red box “Join Court Connect Hearing” on the attached  
25 instructions to make an appearance. If you do not receive this Order by email,  
26 log into the Court Connect program on the internet by typing  
27 <https://tinyurl.com/specialwatermaster>. If you do not have access to the  
28

1  
2  
3  
4  
5  
6  
7  
8  
9  
10  
11  
12  
13  
14  
15  
16  
17  
18  
19  
20  
21  
22  
23  
24  
25  
26  
27  
28

internet, you may attend telephonically using the telephone number and access code included in the instructions for Court Connect.

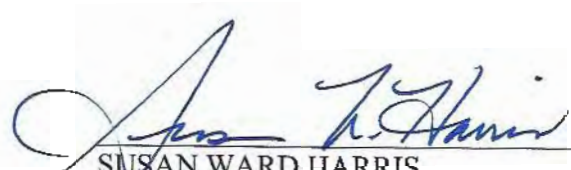
  
SUSAN WARD HARRIS  
Special Master

On December 3, 2021, the original of the foregoing was delivered to the Clerk of the Maricopa County Superior Court for filing and distributing a copy to all persons listed on the Court-approved mailing list for this contested case, a copy of which is attached hereto as Attachment D, and to all persons listed on the Court-approved mailing list for W-1, W-2, W-3, and W-4 (Consolidated).

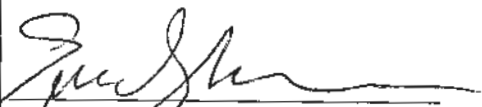
  
Emily Natale

1  
2  
3  
4  
5  
6  
7  
8  
9  
10  
11  
12  
13  
14  
15  
16  
17  
18  
19  
20  
21  
22  
23  
24  
25  
26  
27  
28

# **ATTACHMENT A**

LAND OWNER	WATERSHED FILE
-----	REPORT NUMBER
DOBSON, JR., H. CLIFFORD	112-14-DAC-001
RANCH	

A P P L I C A B L E F I L I N G S A N D D E C R E E S

CLEARLY STATED INFORMATION FROM FILINGS AND DECREES

W1-11-1481

FILING NUMBER	FILING STATUS	USES	QUANTITY IN AFA	USE LOCATION SECTION	TWNP	RNGE	CLAIM DATE	DIVERSION LOCATION SECTION	TWNP	RNGE
10-0203360.1100		IRRIGATION OTHER	9050.00	N2NE29 E2SE29 NWSE29	150S	200E	1893	32	150S	200E
39-0002808		IRRIGATION	2216.00	W2NWSW28 S2NE29 S2NE31	150S	200E	1979	SESWNW32	150S	200E
39-0002809		IRRIGATION	2216.00	W2NWSW28 S2NE29 S2NE31	150S	200E	1979	SEENW32	150S	200E
39-0002810		IRRIGATION	2216.00	W2NWSW28 S2NE29 S2NE31	150S	200E	1965	SEENW32	150S	200E
39-0002811		IRRIGATION	2180.00	S2NE29 S2NE31 NW32	150S	200E	1965	SWSENE31	190S	200E
39-0002829		DOMESTIC STOCK	.92 2.15	NWNWSE29	150S	200E	1950	NWNWSE29	150S	200E
39-0003891	QUE.RECD	IRRIGATION DOMESTIC	1279.00 .50	N2SE31 S2SE31	150S	200E	1891	NENWSE31 NWNWSE31 NESWSE31	150S	200E
39-0004838		IRRIGATION	320.00	N2N2SE29 S2S2NE29	150S	200E	1979	NENESE29	150S	200E
39-0004839		IRRIGATION	680.00	NWNW29 S2SW29 NENW32	150S	200E	1980	SESESW29	150S	200E
39-0004840		IRRIGATION	2216.00	W2NWSW28 S2NE29 S2NE31	150S	200E	1980	NESENW32	190S	200E
39-0011305	QUE.RECD	DOMESTIC		NWSWNE31	150S	200E	1984	NWSWNE31	150S	200E

D W R A N A L Y S I S O F F I L I N G S A N D D E C R E E S

FILING NUMBER	USES CLAIMED OR REFERENCED	USES FOUND BY DWR	APPLIES TO DIVERSIONS	APPLIES TO PWR NUMBERS
10-0203360.1100	IRRIGATION OTHER	IRRIGATION NONE		IROO1, IROO2, IROO3 IROO4
39-0002808	IRRIGATION	IRRIGATION	W04	IROO1, IROO2, IROO3 IROO4
39-0002809	IRRIGATION	IRRIGATION	W01	IROO1, IROO2, IROO3 IROO4
39-0002810	IRRIGATION	IRRIGATION	W02	IROO1, IROO2, IROO3 IROO4
39-0002811	IRRIGATION	IRRIGATION	W05	IROO1, IROO2, IROO3 IROO4
39-0002829	DOMESTIC STOCK	CATALOGUED WELL CATALOGUED WELL	W06	DMOO1
39-0003891	IRRIGATION DOMESTIC	IRRIGATION DOMESTIC	W07, W08	IROO1, DMOO2
39-0004838	IRRIGATION	IRRIGATION		IROO1, IROO2, IROO3 IROO4
39-0004839	IRRIGATION	IRRIGATION		IROO1, IROO3, IROO4
39-0004840	IRRIGATION	IRRIGATION	W03	IROO1, IROO2, IROO3 IROO4
39-0011305	DOMESTIC	CATALOGUED WELL	W06	DMOO1



DIV #	LOCATION			DIVERSION NAME	WATER SOURCE AND CLASSIFICATION
	SECTION	TWNP	RNGE		
WO1	SEENW32	150S	200E	UNNAMED	GROUNDWATER : ZONE 2 SHARED
WO2	SEENW32	150S	200E	UNNAMED	GROUNDWATER : ZONE 2 SHARED
WO3	NESENW32	150S	200E	UNNAMED	GROUNDWATER : ZONE 1 OF THE SAN PEDRO RIVER SHARED
WO4	SESWNW32	150S	200E	UNNAMED	GROUNDWATER : ZONE 2 SHARED
WO5	SWSENE31	150S	200E	UNNAMED	GROUNDWATER : ZONE 2 SHARED
WO6	NWNWSE29	150S	200E	UNNAMED	GROUNDWATER : CATALOGUED
WO7	NWNWSE31	150S	200E	UNNAMED	GROUNDWATER : ZONE 2
WO8	SENWSE31	150S	200E	UNNAMED	GROUNDWATER : ZONE 2

U S E S

PWR #	LOCATION			SUPPLIED BY		PHOTO DATE	SOURCE CHANGE	FACILITY NAME
	SECTION	TWNP	RNGE	DIVERSIONS	WATER SOURCES			
DMOO1	NWNWSE29	150S	200E	WO6, WO7	GROUNDWATER : ZONE 2 GROUNDWATER : CATALOGUED		NO	
DMOO2	NWNWSE31	150S	200E	WO6	GROUNDWATER : CATALOGUED		NO	
IROO1	28	150S	200E	WO1, WO2, WO3	GROUNDWATER : ZONE 1	1967	YES	
	29	150S	200E	WO4, WO5, WO7	GROUNDWATER : ZONE 2			
	31	150S	200E	WO8				
	32	150S	200E					
IROO2	NE29	150S	200E	WO1, WO2, WO3	GROUNDWATER : ZONE 1	1972	YES	
	NE31	150S	200E	WO4, WO5	GROUNDWATER : ZONE 2			
	SE29	150S	200E					
	SW28	150S	200E					
IROO3	NW32	150S	200E	WO1, WO2, WO3	GROUNDWATER : ZONE 1	1983	YES	
	SE29	150S	200E	WO4, WO5	GROUNDWATER : ZONE 2			
	SW29	150S	200E					
IROO4	NE29	150S	200E	WO1, WO2, WO3	GROUNDWATER : ZONE 1	1986	YES	
	SE29	150S	200E	WO4, WO5	GROUNDWATER : ZONE 2			
	SW29	150S	200E					
	SW32	150S	200E					

S H A R E D U S E S A N D D I V E R S I O N S

- \*\* WATER FROM WO1 IS SHARED WITH THESE ADDITIONAL FILES:  
112-14-DAD-2
- \*\* WATER FROM WO2 IS SHARED WITH THESE ADDITIONAL FILES:  
112-14-DAD-2
- \*\* WATER FROM WO3 IS SHARED WITH THESE ADDITIONAL FILES:  
112-14-DAD-2
- \*\* WATER FROM WO4 IS SHARED WITH THESE ADDITIONAL FILES:  
112-14-DAD-2
- \*\* WATER FROM WO5 IS SHARED WITH THESE ADDITIONAL FILES:  
112-14-DAD-2

P W R S U M M A R Y

PWR #	APPLICABLE	APPLICABLE	*APPARENT FIRST USE DATE*		WATER SOURCES AND CLASSIFICATIONS
	ADJ FILINGS	PRE FILINGS	DATE BASIS FOR	DATE	
DMOO1	39-0002829 39-0003891 39-0011305	NONE			GROUNDWATER : ZONE 2 GROUNDWATER : CATALOGUED
DMOO2	39-0002829 39-0003891 39-0011305	NONE			GROUNDWATER : CATALOGUED
IROO1	39-0002808 39-0002809	10-0203360.1100	1967	1967 AERIAL PHOTO	GROUNDWATER : ZONE 1 OF THE SAN PEDRO RIVER GROUNDWATER : ZONE 2
	39-0002810 39-0002811 39-0003891 39-0004838 39-0004839 39-0004840				

PWR #	APPLICABLE ADJ FILINGS	APPLICABLE PRE FILINGS	*APPARENT FIRST USE DATE*	DATE BASIS FOR DATE	WATER SOURCES AND CLASSIFICATIONS
IROO2	39-0002808 39-0002809	10-0203360.1100	1972	1972 AERIAL PHOTO	GROUNDWATER : ZONE 1 OF THE SAN PEDRO RIVER GROUNDWATER : ZONE 2
	39-0002810 39-0002811 39-0004838 39-0004840				
IROO3	39-0002808 39-0002809	10-0203360.1100	1983	1983 AERIAL PHOTO	GROUNDWATER : ZONE 1 OF THE SAN PEDRO RIVER GROUNDWATER : ZONE 2
	39-0002810 39-0002811 39-0004838 39-0004839 39-0004840				
IROO4	39-0002808 39-0002809	10-0203360.1100	1986	1986 AERIAL PHOTO	GROUNDWATER : ZONE 1 OF THE SAN PEDRO RIVER GROUNDWATER : ZONE 2
	39-0002810 39-0002811 39-0004838 39-0004839 39-0004840				

Q U A N T I T I E S O F U S E

PWR #	QUANTIFICATION TYPE	ACRES	CROP TYPE	EFF	WATER DUTY	ESTIMATED VOLUME	REMARKS
DMOO1							SEE VOLUME 1 - GENERAL ASSESSMENT
DMOO2							SEE VOLUME 1 - GENERAL ASSESSMENT DEFICIT IRRIGATION
IROO1	MAX. OBSERVED REGIONAL	471.6 512.7	MULTI.-DBL. AVE. CROP	67% 50%	3.0 AF/AC 5.4 AF/AC	1414.8 AFA 2768.6 AFA	
IROO2	MAX. POTENTIAL MAX. OBSERVED REGIONAL	512.7 58.3 58.3	ALFALFA DBL.CROPPED AVE. CROP	67% 53% 50%	5.0 AF/AC 5.5 AF/AC 5.4 AF/AC	2563.5 AFA 320.7 AFA 314.8 AFA	
IROO3	MAX. POTENTIAL MAX. OBSERVED REGIONAL	58.3 58.3 142.1	ALFALFA MULTI.-DBL. AVE. CROP	53% 56% 50%	6.3 AF/AC 5.3 AF/AC 5.4 AF/AC	367.3 AFA 753.1 AFA 767.3 AFA	
IROO4	MAX. POTENTIAL MAX. OBSERVED REGIONAL MAX. POTENTIAL	142.1 142.1 63.3 63.3	ALFALFA MULTI.-DBL. AVE. CROP ALFALFA	56% 63% 50% 63%	6.0 AF/AC 3.8 AF/AC 5.4 AF/AC 5.3 AF/AC	852.6 AFA 240.5 AFA 341.8 AFA 335.5 AFA	

E X P L A N A T I O N

FILINGS AND DECREES

FILING 10-0203360-11 - CLAIMS IRRIGATION AND OTHER WATER USES FROM THE SAN PEDRO RIVER. NO OTHER WATER USES WERE FOUND AT THE CLAIMED LOCATION.  
 FILINGS 39-3891 & 39-11305 - UNIFORM QUESTIONNAIRES WERE RECEIVED WHICH REFLECT INFORMATION PREVIOUSLY PROVIDED IN THE ORIGINAL STATEMENTS OF CLAIMANT.

DIVERSIONS

W1-W5 & W8 - WELLS PROVIDE WATER FOR IRRIGATION USES.  
 W6 - A CATALOGUED WELL PROVIDES WATER FOR DOMESTIC USES.  
 W7 - WELL PROVIDES WATER FOR IRRIGATION AND DOMESTIC USES.

USES AND RESERVOIRS

DM1 & DM2 - DOMESTIC USES.  
 IR1, IR3 & IR4 - IRRIGATED MULTIPLE-DOUBLE CROPS.  
 IR2 - IRRIGATED DOUBLE CROPS.

SHARED USES AND DIVERSIONS

W1-W5 - WELLS ARE SHARED WITH W.F.R. #112-17-DAD-2.

DISPOSITION OF LAND OWNER/CLAIMANT COMMENTS

A COMMENT WAS RECEIVED WHICH INDICATED THAT FOUR ADDITIONAL WELLS ARE REGISTERED AND LINKED BY PIPELINES. A SUBSEQUENT FIELD INVESTIGATION DID NOT LOCATE THESE WELLS. THE COMMENTOR ALSO CITED A DISCREPANCY IN PRIORITY DATES. D.W.R. CRITERIA FOR DETERMINING PRIORITY CLAIM DATES

LAND OWNER	ZONE 2 WELL
-----	REPORT NUMBER
DOBSON, JR., H. CLIFFORD	112-14-DAC-001
RANCH	

WELLS	WELL NAMES	WELL LOCATION			WATER USES SERVED	REMARKS
		SECTION	TWNP	RNGE		
WO1	UNNAMED	SENENW32	150S	200E	IROO1, IROO2, IROO3 IROO4	SHARED
WO2	UNNAMED	SENENW32	150S	200E	IROO1, IROO2, IROO3 IROO4	SHARED
WO4	UNNAMED	SESWNW32	150S	200E	IROO1, IROO2, IROO3 IROO4	SHARED
WO5	UNNAMED	SWSENE31	150S	200E	IROO1, IROO2, IROO3 IROO4	SHARED
WO7	UNNAMED	NWNWSE31	150S	200E	DMOO1, IROO1	
WO8	UNNAMED	SENWSE31	150S	200E	IROO1	

WI-11-1481

WATER USE NUMBERS	WATER USE LOCATION			*** APPARENT FIRST USE ***			APPAR. ANNUAL VOLUME USED	ACRES IRRIGATED
	SECTION	TWNP	RNGE	DATE	BASIS FOR DATE			
DMOO1	NWNWSE29	150S	200E					
IROO1	28	150S	200E	1967	1967 AERIAL PHOTO		2,768.6 AFA	512.7
	29	150S	200E					
	31	150S	200E					
	32	150S	200E					
IROO2	NE29	150S	200E	1972	1972 AERIAL PHOTO		314.8 AFA	58.3
	NE31	150S	200E					
	SE29	150S	200E					
	SW28	150S	200E					
IROO3	NW32	150S	200E	1983	1983 AERIAL PHOTO		767.3 AFA	142.1
	SE29	150S	200E					
	SW29	150S	200E					
IROO4	NE29	150S	200E	1986	1986 AERIAL PHOTO		341.8 AFA	63.3
	SE29	150S	200E					
	SW29	150S	200E					
	SW32	150S	200E					

APPLICABLE STATEMENTS OF CLAIMANT	APPLIES TO: WELLS	APPLIES TO: WATER USES
39-0002808	WO4	IROO1, IROO2, IROO3 IROO4
39-0002809	WO1	IROO1, IROO2, IROO3 IROO4
39-0002810	WO2	IROO1, IROO2, IROO3 IROO4
39-0002811	WO5	IROO1, IROO2, IROO3 IROO4
39-0002829		DMOO1
39-0003891	WO7, WO8	DMOO1, IROO1
39-0004838		IROO1, IROO2, IROO3 IROO4
39-0004839		IROO1, IROO3, IROO4
39-0004840		IROO1, IROO2, IROO3 IROO4
39-0011305		DMOO1

EXPLANATION

THE APPARENT ANNUAL VOLUME REPORTED FOR IROO1 IS PARTIALLY SUPPLIED BY ZONE 1 GROUNDWATER.  
 THE APPARENT ANNUAL VOLUME REPORTED FOR IROO2 IS PARTIALLY SUPPLIED BY ZONE 1 GROUNDWATER.  
 THE APPARENT ANNUAL VOLUME REPORTED FOR IROO3 IS PARTIALLY SUPPLIED BY ZONE 1 GROUNDWATER.  
 THE APPARENT ANNUAL VOLUME REPORTED FOR IROO4 IS PARTIALLY SUPPLIED BY ZONE 1 GROUNDWATER.  
 \*\* WATER FROM WO1 IS SHARED WITH THESE ADDITIONAL FILES:

\*\* WATER FROM WO2 IS SHARED WITH THESE ADDITIONAL FILES:

112-14-DAD-2

\*\* WATER FROM WO4 IS SHARED WITH THESE ADDITIONAL FILES:

112-14-DAD-2

\*\* WATER FROM WO5 IS SHARED WITH THESE ADDITIONAL FILES:

112-14-DAD-2

W1, W2, W4, W5 & W8 - WELLS PROVIDE WATER FOR IRRIGATION USES.

W7 - WELL PROVIDES WATER FOR IRRIGATION AND DOMESTIC USES.

DM1 - DOMESTIC USE.

IR1, IR3 & IR4 - IRRIGATED MULTIPLE-DOUBLE CROPS.

IR2 - IRRIGATED DOUBLE-CROPS.

LAND OWNER	ZONE 2 WELL
-----	REPORT NUMBER
DOBSON, JR., H. CLIFFORD	112-14-DAC-001
RANCH	

WELLS	WELL NAMES	WELL LOCATION			WATER USES SERVED	REMARKS
		SECTION	TWNP	RNGE		
WO1	UNNAMED	SENENW32	150S	200E	IROO1, IROO2, IROO3 IROO4	SHARED
WO2	UNNAMED	SENENW32	150S	200E	IROO1, IROO2, IROO3 IROO4	SHARED
WO4	UNNAMED	SESWNW32	150S	200E	IROO1, IROO2, IROO3 IROO4	SHARED
WO5	UNNAMED	SWSENE31	150S	200E	IROO1, IROO2, IROO3 IROO4	SHARED
WO7	UNNAMED	NWNWSE31	150S	200E	DMOO1, IROO1	
WO8	UNNAMED	SENWSE31	150S	200E	IROO1	

WI-11-1481

WATER USE NUMBERS	WATER USE LOCATION			*** APPARENT FIRST USE ***		APPAR. ANNUAL VOLUME USED	ACRES IRRIGATED
	SECTION	TWNP	RNGE	DATE	BASIS FOR DATE		
DMOO1	NWNWSE29	150S	200E				
IROO1	28	150S	200E	1967	1967 AERIAL PHOTO	2,768.6 AFA	512.7
	29	150S	200E				
	31	150S	200E				
	32	150S	200E				
IROO2	NE29	150S	200E	1972	1972 AERIAL PHOTO	314.8 AFA	58.3
	NE31	150S	200E				
	SE29	150S	200E				
	SW28	150S	200E				
IROO3	NW32	150S	200E	1983	1983 AERIAL PHOTO	767.3 AFA	142.1
	SE29	150S	200E				
	SW29	150S	200E				
IROO4	NE29	150S	200E	1986	1986 AERIAL PHOTO	341.8 AFA	63.3
	SE29	150S	200E				
	SW29	150S	200E				
	SW32	150S	200E				

APPLICABLE STATEMENTS OF CLAIMANT	APPLIES TO: WELLS	APPLIES TO: WATER USES
-----	-----	-----
39-0002808	WO4	IROO1, IROO2, IROO3 IROO4
39-0002809	WO1	IROO1, IROO2, IROO3 IROO4
39-0002810	WO2	IROO1, IROO2, IROO3 IROO4
39-0002811	WO5	IROO1, IROO2, IROO3 IROO4
39-0002829		DMOO1
39-0003891	WO7, WO8	DMOO1, IROO1
39-0004838		IROO1, IROO2, IROO3 IROO4
39-0004839		IROO1, IROO3, IROO4
39-0004840		IROO1, IROO2, IROO3 IROO4
39-0011305		DMOO1

EXPLANATION

THE APPARENT ANNUAL VOLUME REPORTED FOR IROO1 IS PARTIALLY SUPPLIED BY ZONE 1 GROUNDWATER.  
 THE APPARENT ANNUAL VOLUME REPORTED FOR IROO2 IS PARTIALLY SUPPLIED BY ZONE 1 GROUNDWATER.  
 THE APPARENT ANNUAL VOLUME REPORTED FOR IROO3 IS PARTIALLY SUPPLIED BY ZONE 1 GROUNDWATER.  
 THE APPARENT ANNUAL VOLUME REPORTED FOR IROO4 IS PARTIALLY SUPPLIED BY ZONE 1 GROUNDWATER.

\*\* WATER FROM WO1 IS SHARED WITH THESE ADDITIONAL FILES:

\*\* WATER FROM WO2 IS SHARED WITH THESE ADDITIONAL FILES:

112-14-DAD-2

\*\* WATER FROM WO4 IS SHARED WITH THESE ADDITIONAL FILES:

112-14-DAD-2

\*\* WATER FROM WO5 IS SHARED WITH THESE ADDITIONAL FILES:

112-14-DAD-2

W1, W2, W4, W5 & W8 - WELLS PROVIDE WATER FOR IRRIGATION USES.

W7 - WELL PROVIDES WATER FOR IRRIGATION AND DOMESTIC USES.

DM1 - DOMESTIC USE.

IR1, IR3 & IR4 - IRRIGATED MULTIPLE-DOUBLE CROPS.

IR2 - IRRIGATED DOUBLE-CROPS.

# ATTACHMENT B

1  
2  
3  
4  
5  
6  
7  
8  
9  
10  
11  
12  
13  
14  
15  
16  
17  
18  
19  
20  
21  
22  
23  
24  
25  
26  
27  
28

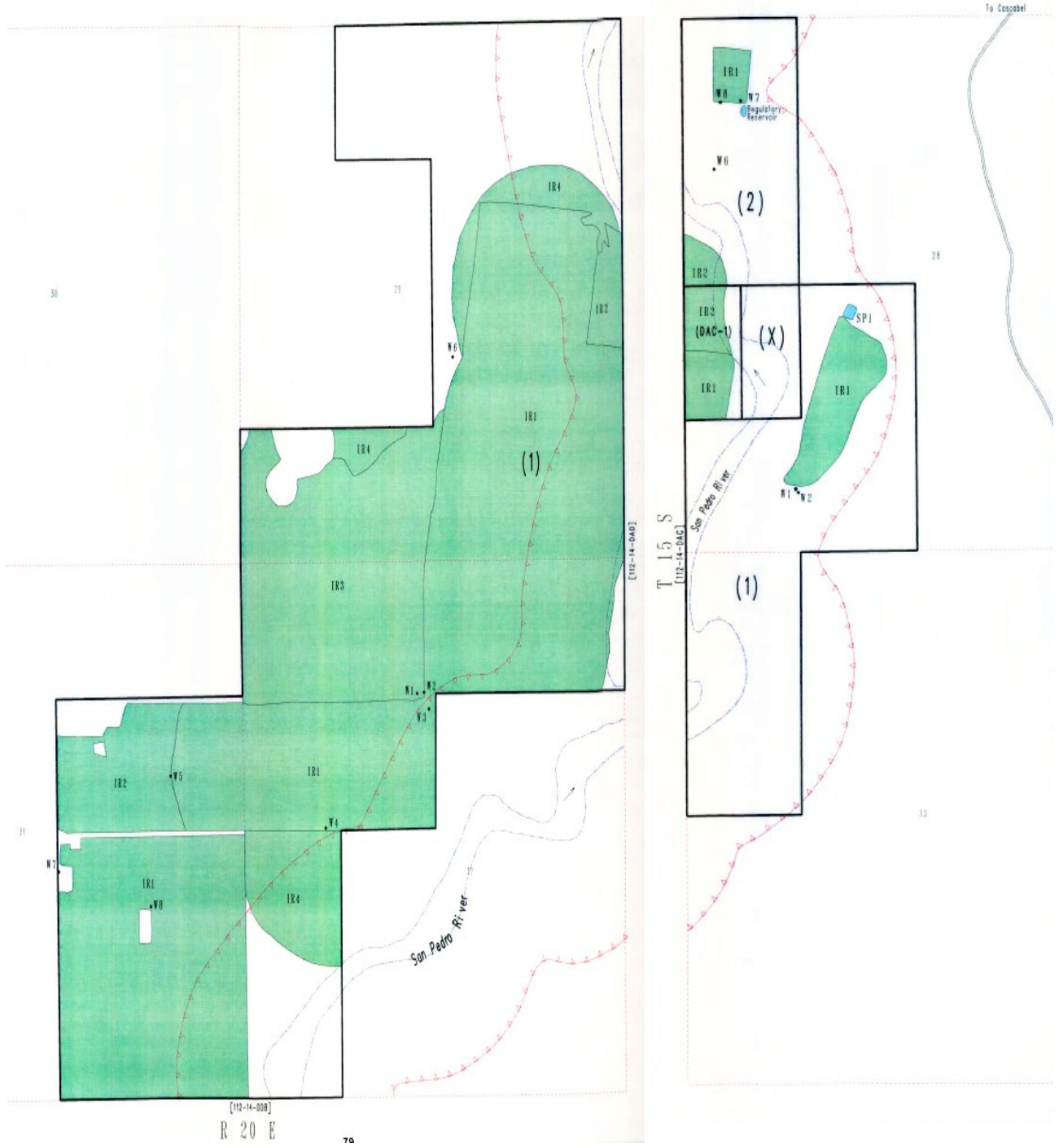

# ATTACHMENT C

1  
2  
3  
4  
5  
6  
7  
8  
9  
10  
11  
12  
13  
14  
15  
16  
17  
18  
19  
20  
21  
22  
23  
24  
25  
26  
27  
28

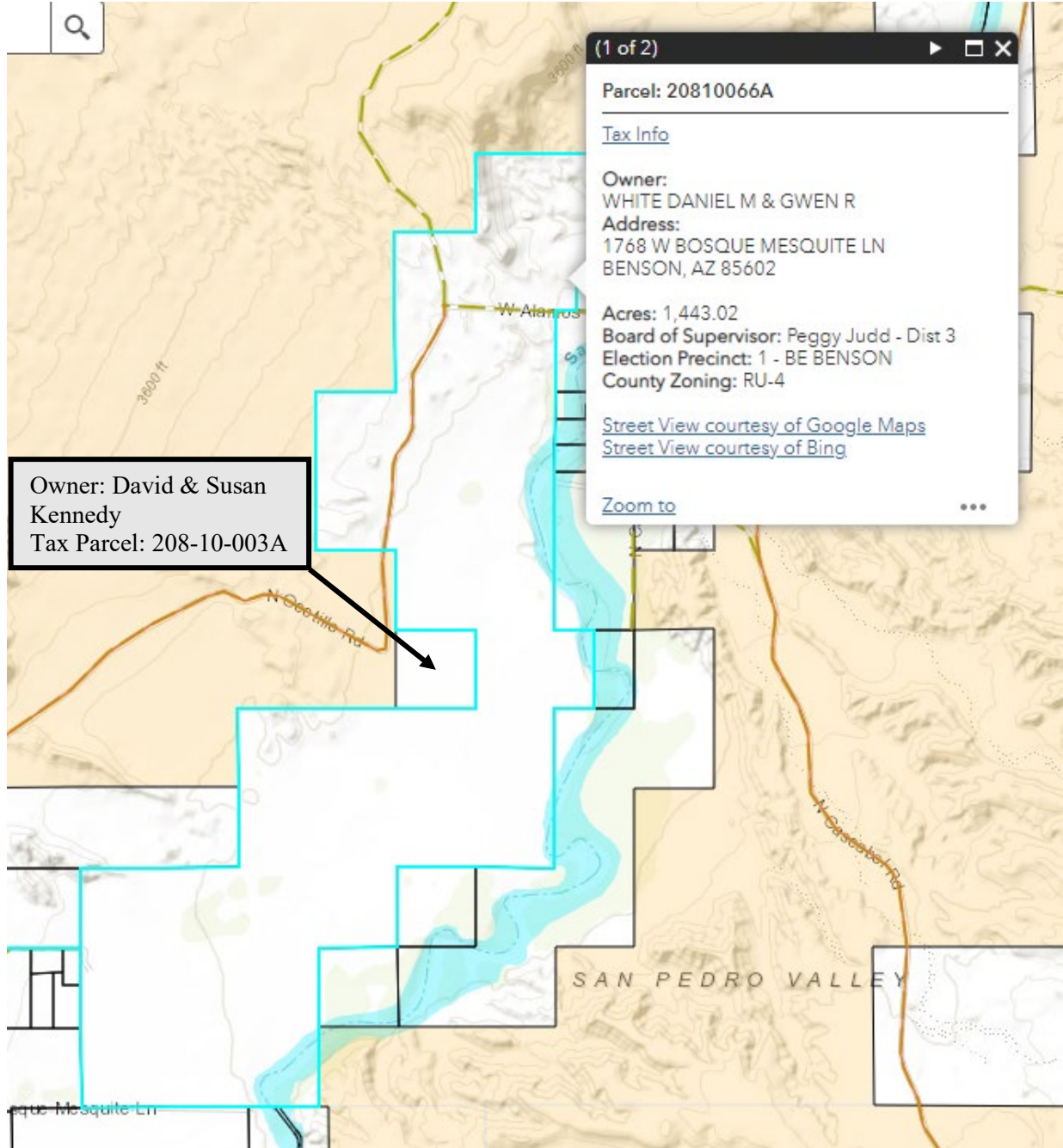



# ATTACHMENT D

1  
2  
3  
4  
5  
6  
7  
8  
9  
10  
11  
12  
13  
14  
15  
16  
17  
18  
19  
20  
21  
22  
23  
24  
25  
26  
27  
28

Arizona Department of Water Resources  
Kimberly Parks  
Janet L. Miller  
P. O. Box 36020  
Phoenix, AZ 85067

ASARCO Incorporated  
Lauren J. Caster  
Fennemore Craig, P.C.  
2394 East Camelback Road  
Suite 600  
Phoenix, AZ 85016-3429

BHP Copper, Inc.  
John D. Burnside  
Snell & Wilmer, L.L.P.  
400 E. Van Buren Street, Ste 1900  
Phoenix AZ 85004

Clerk of the Superior Court  
Maricopa County  
Attn: Water Case  
601 West Jackson Street  
Phoenix, AZ 85003

Daniel and Gwen White  
1786 W. Bosque Mesquite Ln.  
Benson, AZ 85602

David and Susan Kennedy  
P.O. Box 2378  
Benson, AZ 85602

Gila River Indian Community  
Linus Everling and Thomas L. Murphy  
Office of the General Counsel  
P. O. Box 97  
Sacaton, AZ 85147

H. Clifford Dobson Jr.  
Carolyn Dobson  
Rural Route 1, Box 1546  
Willcox, AZ 85643

Mo and Darlene Grenier  
Box 562  
Benson, AZ 85602

San Carlos Apache Tribe  
Joe P. Sparks and Laurel A. Herrmann  
The Sparks Law Firm, P.C.  
7503 First Street  
Scottsdale, AZ 85251-4573

Salt River Project  
John B. Weldon, Jr., Mark A. McGinnis,  
and Michael Foy  
Salmon, Lewis & Weldon, PLC  
2850 E Camelback Rd.  
Suite 200  
Phoenix, AZ 85016

Special Master Susan Ward Harris  
Superior Court of Arizona  
201 W. Jefferson Street  
Courtroom 301  
Phoenix, AZ 85003

United States  
F. Patrick Barry  
U.S. Department of Justice  
P. O. Box 7611  
Washington, DC 20044-7611

Thomas and Karen Ann Baker  
4651 S. Elkridge Dr.  
Tucson, AZ 85730

Tonto Apache Tribe  
Richard Palmer, Jr., Jeremiah Weiner  
and Lauren Mulhern  
Rosette, LLP  
565 W. Chandler Blvd. Suite 212  
Chandler, AZ 85225

1  
2  
3  
4  
5  
6  
7  
8  
9  
10  
11  
12  
13  
14  
15  
16  
17  
18  
19  
20  
21  
22  
23  
24  
25  
26  
27  
28

White House Ranch  
2621 E. Camelback Road  
Suite 190  
Phoenix, AZ 85016

White House Ranch, LLC  
16651 S. Lone Heart Rd.  
P.O. Box 1641  
Sahuarita, AZ 85629

Yavapai-Apache Nation  
S. Montgomery, R. Interpreter, J. Tomkus  
Montgomery & Interpreter, Plc  
3301 E. Thunderbird Road  
Phoenix, AZ 85032

1  
2  
3  
4  
5  
6  
7  
8  
9  
10  
11  
12  
13  
14  
15  
16  
17  
18  
19  
20  
21  
22  
23  
24  
25  
26  
27  
28

# **ATTACHMENT E**

**CLERK OF THE COURT  
SUPERIOR COURT OF ARIZONA**

Jeff Fine  
Clerk

**MARICOPA COUNTY  
Customer Service Center  
601 West Jackson  
Phoenix, AZ 85003**

602 372-4115  
Water Case Clerk

**CONSENT FOR ELECTRONIC RECEIPT OF WATER CASE DOCUMENTS**

In an effort to provide more timely and cost effective distribution of copies of filed Water Case documents, the Clerk of the Superior Court would like implement electronic distribution via email. To do so, we require your consent to receive copies of documents electronically at an email address provided to our office.

This consent is voluntary and can be rescinded if you so choose. If you no longer wish to receive Water Case documents from the Clerk of Superior Court electronically, please send written notification to the Clerk of the Superior Court Water Case Specialist at the email address below requesting that all future records be sent in paper form.

Please note that if you consent to receive documents via email, you must notify the Clerk's Office of any change to your email address to avoid delay in receiving future filings. In the event there is no valid email address on file with the Clerk of the Superior Court Water Case Specialist, documents will be mailed to the address provided.

If you wish to consent to receive future documents via email, please either fill out the information below and mail to our office or provide the below information to [Mayra.Antelo@Maricopa.Gov](mailto:Mayra.Antelo@Maricopa.Gov).

Preferred email address:

---

Alternate email address:

---

Physical address:

---

Phone number:

---

Firm Name:

---

Name [Printed]:

---

Signature:

---

Date:

---

Thank you,

Mayra Antelo  
Clerk of the Superior Court  
Water Case Specialist  
(602) 372-5375 options 7,1,3,4

1  
2  
3  
4  
5  
6  
7  
8  
9  
10  
11  
12  
13  
14  
15  
16  
17  
18  
19  
20  
21  
22  
23  
24  
25  
26  
27  
28

# **ATTACHMENT F**



## Court Connect Hearing Notice for In re H. Clifford Dobson Jr. Ranch

*This hearing will be conducted through the new Court Connect program offered by the Superior Court of Arizona in Maricopa County. This new and innovative program allows Court participants to appear online, rather than in a physical courtroom. Hearings are preferably conducted by videoconference but can also be conducted by phone. Lawyers (and self-representing litigants) are responsible for distributing this notice to anyone who will be appearing on their behalf.*

*All participants must use the JOIN COURT CONNECT HEARING button or the dial in information below to participate.*

**Participants:** Please follow the steps below to participate in the remote proceeding.

1. Click the JOIN COURT CONNECT HEARING button below.
2. Enter your full name and role in name field.
3. Wait for the facilitator to admit you to the proceeding.

Remember to keep this email handy so you can use it to participate in the following proceeding.

**Case Name: In re H. Clifford Dobson Jr. Ranch Contested Case No. W1-11-1481**

**Start Date/Time: February 3, 2022 at 2:00 p.m.**

**JOIN COURT CONNECT HEARING**

**Dial-in Information:** +1 917-781-4590

**Private Dial-in Information:** for privacy purposes, you can block your phone number by dialing \*67 +1 917-781-4590

**Dial-in Access Code:** 688 970 203#

Tiny URL: <https://tinyurl.com/specialwatermaster>

To ensure an optimal experience, please review the brief Court Connect training prior to the hearing: [Here](#)

