



OFFICIAL SEAL
Michele E. Stine

Emmet Register of Deeds
04/16/2008 09:34A

L-1101 P-634

DISSOLUTION OF RECIPROCAL EASEMENT AGREEMENT

1. The Little Traverse Bay Bands of Odawa Indians, Dare III LLC, and, Mariner's Cove LP d/b/a Independence Village, Inc., collectively "the Parties", hereby execute this Agreement to dissolve to the Reciprocal Easement Agreement ("REA") that is currently in place and in force between the above mentioned parties and any easements created or granted by the REA.

DEFINITIONS

2. The term "Agreement" as it is used throughout this document means this Agreement for Dissolution of the REA.

3. All Liber and Page numbers in this Agreement reference documents on file with the Emmet County, Michigan Register of Deeds.

4. The term "Reciprocal Easement Agreement or ("REA")" as it is used throughout this document means the Declaration of Reciprocal Easements and Covenants, Conditions and Restrictions between Healthshare Real Estate, Inc., and Independence Village of Bear River, LP dated November 4, 1996 Liber 588 Page 310, as amended by First Amendment to Declaration of Reciprocal Easements and Covenants, Conditions and Restrictions filed on Feb. 19, 1997 Liber 595 Page 379, and the First Supplemental Agreement to Declaration of Reciprocal Easements and Covenants, Conditions and Restrictions filed on January 16, 2004 Liber 1038 Page 431. The Little Traverse Bay Bands of Odawa Indians by virtue of the deed recorded at Liber 1051 Page 837, Mariner's Cove LP d/b/a Independence Village of Bear River by virtue of the deed recorded at Liber 604 Page 369, and DARE III LLC by virtue of the deed recorded at Liber 1032 Page 426, are the sole owners of the property subject to the REA so are now the sole parties to the REA.

5. The term "Hagar Drive" as it is referred to throughout this document shall mean the property described in the deed recorded at Liber 1051 Page 837, also described as Parcel Five (5), a sixty-six (66) foot wide private road, also referred to as the "Access Road" in the REA.

6. The term "Parties" as used throughout this document shall mean The Little Traverse Bay Bands of Odawa Indians, Dare III LLC, and Mariner's Cove LP.

RECEIVED
2008 APR 16 10:05



L-1101 P-634
04/16/2008 09:34A
Page: 1 of 4

TERMS AND CONDITIONS

7. Improvement of Hagar Drive. The Little Traverse Bay Bands of Odawa Indians ("LTBB") shall improve Hagar Drive from its present condition as a private road to a public federal highway meeting all applicable standards.

A. Driveway access. Dare III LLC and Mariner's Cove LLC, their heirs, successors and assigns, shall have a legal right of driveway ingress and egress to the public road that will replace Hagar Drive. LTBB will issue permits to confirm this right, but hereby agree that such right permanently exists with or without such permits.

B. Creation of Right-of Way. A right-of-way for construction, improvement, operation, and maintenance of the public road is granted by Dare III LLC and Mariner's Cove LLC across their respective properties in accordance with the easements attached hereto as Exhibits A and B.

8. Dissolution of REA. The Parties hereby agree to dissolve the REA and the obligations contained therein:

A. Release of Easements. Pursuant to Article II, § 2.1(B) of the REA the Parties hereby agree to release any and all easements granted through, or created by the REA; including easements described in § 2.2, § 2.3, § 2.4, § 2.5, § 2.6, § 2.7 and § 2.8 and any other easements created by the REA not specifically described herein.

B. Dissolution of Cost Sharing. Each of the Parties shall be responsible after the dissolution of the REA for their own utility costs and property maintenance costs. Dare III LLC and Mariner's Cove LLC, their heirs, successors and assigns, shall bear no responsibility for the construction, improvement, operation and maintenance of the public road that will replace Hagar Drive.

C. Dissolution of all Other Provisions. All other provisions, and any obligations or restrictions contained therein, of the REA are hereby dissolved.

9. Sewer System. LTBB will continue to operate the lift station located on its parcel at LTBB's expense for sewer services for all of the Parties' parcels unless and until the current sewer system is replaced by a system operated by another governmental entity.

10. Effective Date. This document only takes effect upon completion of the public road that will replace the private Hagar Drive as evidenced by the recording of an easement granting a public road right of way to the Bureau of Indian Affairs, and acceptance of the final completed project by the Bureau of Indian Affairs.



L-1101 P-634

04/16/2008 09:34A

Page: 2 of 4

Emmet County, Michigan E.D 23.00 5054047

[The remainder of this page left intentionally blank.]

 L-1101 P-634
04/16/2008 09:34A
Page: 3 of 4
Emmet County, Michigan E.D 23.00 5054047

IN WITNESS WHEREOF, the Little Traverse Bay Bands of Odawa Indians, Mariner's Cove LP, and DARE III LLC, execute this Agreement on the terms and conditions herein stated, and the acknowledge receipt of a copy of this Agreement.

LITTLE TRAVERSE BAY BANDS OF ODAWA INDIANS

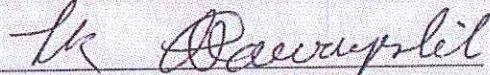
Frank Ettawageshik, Chairman

4-9-2008
Date

MARINER'S COVE LP, a Michigan Limited Partnership, d/b/a Independence Village of Bear River

By: Midwest Investments of Petoskey, LLC
a Michigan Limited Liability Company,
General Partner

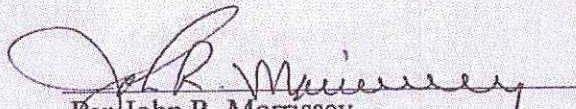
By: John R. Morrissey
Managing Member

3-26-2008
Date

DARE III LLC

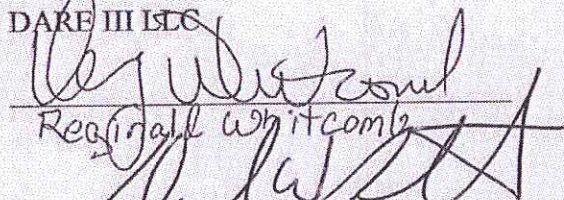
Daniel W. Stust
Prepared by:

4/15/08
Date

James A. Bransky (P38713)
9393 Lake Leelanau Drive
Traverse City, Michigan 49684

When recorded return to:

✓ Frank Ettawageshik, Tribal Chairperson
Little Traverse Bay Bands of Odawa Indians
7500 Odawa Circle
Harbor Springs, MI 49740



L-1101 P-634
04/16/2008 09:34A
Page: 4 of 4
5054047



OFFICIAL SEAL
Michele E. Stine

Emmet Register of Deeds
04/16/2008 09:34A

L-1101 P-635

Grant of Easement and Right of Way for Public Road

This Grant of Easement is made on this April 15, 2008, by DARE III, LLC, with offices at 1301 US-131 South, Petoskey, Emmet County, Michigan referred to in this instrument as "Grantor," to the Little Traverse Bay Bands of Odawa Indians, with offices at located at 7500 Odawa Circle, Harbor Springs, Emmet County, Michigan, referred to in this instrument as "Grantee."

Grantor is the owner of the property described in the deed recorded at Liber 1032 Page 426, Emmet County Register of Deeds, which deed is attached as Exhibit B.

Grantee is the owner of the property described in the deed recorded at Liber 1051 Page 837, Emmet County Register of Deeds, which deed is attached as Exhibit C, part of which Grantee will develop into a public road as described in Exhibit A.

In consideration of \$1.00, and other good and valuable consideration, receipt of which is acknowledged, Grantor grants and conveys to Grantee and its heirs, successors, and assigns, for the purpose of an easement and right of way for the construction, improvement, operation, and maintenance of a public road over that portion of Grantor's property encompassed in Exhibit A.

This Grant of Easement will run with the land and will bind and inure to the benefit of the parties to this instrument, their heirs, successors and assigns.

Grantor has executed this instrument at Petoskey, Michigan on the date first written above.

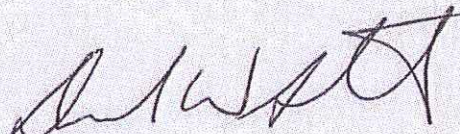
DANIEL W. STURT

DARE III, LLC

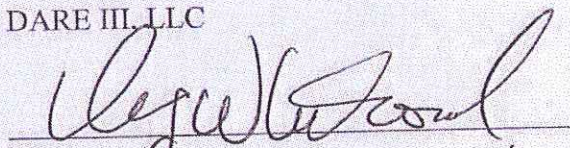
By: Reginald Whitcomb

RECEIVED
2008 APR 16 A 9:05



L-1101 P-635
04/16/2008 09:34A
Page: 1 of 10

STATE OF MICHIGAN

)

COUNTY OF EMMET

)ss

)

The foregoing instrument was acknowledged before me this 15 th day of April, 2008 by Daniel W Stort and Reginald Whitcomb act and deed as a duly authorized official DARE III, LLC.

Catherine J. Green

Notary Public
Emmet County, Michigan
My Commission Expires: 2-19-2014

CATHERINE J. GREEN
NOTARY PUBLIC, STATE OF MI
COUNTY OF EMMET
MY COMMISSION EXPIRES Feb 19, 2014
ACTING IN COUNTY OF Emmet

Prepared by:

James A. Bransky (P38713)
9393 Lake Leelanau Drive
Traverse City, Michigan 49684

When recorded return to:

*Frank Ettawageshik, Tribal Chairperson
Little Traverse Bay Bands of Odawa Indians
7500 Odawa Circle
Harbor Springs, MI 49740



L-1101 P-635
04/16/2008 09:34A
Page: 2 of 10

L-1101 P-635

04/16/2008 09:34R
Page: 3 of 10
5654048



Emmet County, Michigan
LITTLE TRAVERSE
BAY BANDS OF
ODAWA INDIANS
(MOR PARCEL DESC.
IN L588, P361 AND
HEALTH PARK MEDICAL
OFFICE CONDOMINIUM
PLAN NO. 176)

LITTLE TRAVERSE
BAY BANDS OF
ODAWA INDIANS
(REMANINDER PARCEL
L588, P310, L595
P379, & L1038 P431
& 2004 BENCHMARK
ENG. ALTA SURVEY)

Ex-A
ENTIRE NORTHWESTERLY BOUNDARIES OF CAPITAL
HILLS APT. DARE III LLC AND INDEPENDENCE VILLAGE
MARINER'S COVE LIMITED PARTNERSHIP, HEAVY
ROAD BORDER IS "NEW" HAGER DRIVE ROW. DASHED
LINE REPRESENTS ORIGINAL HAGER DRIVE ROW.

N88°53'16"E 2600.56' (R)
N88°53'07"E 2600.40'

NO CORNERS
SET ON THIS
SURVEY

EAST 1/4 CORNER
SECTION 7, T34N R5W
COMMON TO SEC. 7 & 8
FOUND 1/2" ROD
SOUTH 1/16 CORNER
FOUND 1/2" ROD

SOUTH 1/4 CORNER
SECTION 7, T34N R5W
FOUND EMMET COUNTY
REMONUMENTATION CORNER

SOUTH LINE OF SECTION 7, T34N R5W S88°48'25"W 2604.23' (R)
S88°48'15"E 2604.24'

PREPARED BY *Thomas Swenor*
4-14-08
NORTH STAR LAND SURVEYING
THOMAS D. SWENOR PS 37282
2202 MITCHELL PARK DRIVE, STE. 001
PETOSKEY, MICHIGAN 49770



NO.	RADIUS	ARC	CHORD BEARING	LENGTH
1	360.00'	390.32'	N67°41'06"E	371.48'
2	460.00'	248.47'	N42°06'54"E	245.46'
3	360.00'	209.43'	N40°55'24"E	206.49'
4	460.00'	465.77'	N53°15'52"E	446.13'
5	360.00'	171.02'	N68°39'46"E	169.42'
6	460.00'	271.61'	N71°58'06"E	267.68'
7	360.00'	212.56'	S71°58'06"W	209.49'
8	460.00'	218.53'	S68°39'46"W	216.48'
9	360.00'	364.52'	S53°15'52"W	349.15'
10	274.00'	13.10'	S26°39'24"W	13.10'
11	274.00'	147.33'	S43°25'50"W	145.56'
12	274.00'	41.09'	S63°07'51"W	41.05'
13	360.00'	194.46'	S42°06'54"W	192.10'
14	498.00'	148.87'	S07°26'30"W	148.31'

(R) - AS RECORDED ON
DECLARATION OF "REA"
(L588, P310, AMENDED
L595, P379, & SUPPLE-
MENTAL L1038, P431), AND
ALTA / ACSU LAND TITLE
SURVEY BY BENCHMARK
ENG. INC. FOR LTBBOI
AS DATED APRIL 21, 2004

SURVEY FOR DESCRIPTION OF "NEW" HAGER DRIVE
RIGHT-OF-WAY OVER PART OF THE SOUTHEAST 1/4
OF SECTION 7, T34N R5W, BEAR CREEK TOWNSHIP,
EMMET COUNTY, MICHIGAN;
FOR: LITTLE TRAVERSE BAY BANDS OF ODAWA INDIANS
FOR: NORTHWEST DESIGN GROUP, LUCAS PORATH
DATE: JULY 25, 2007
REVISED: FEBRUARY 13, 2008
REVISED: APRIL 14, 2008

SOUTHEAST CORNER
SECTION 7, T34N R5W
FOUND EMMET COUNTY
REMONUMENTATION CORNER

EAST LINE SECTION 7, T34N R5W S00°01'17"E 1316.37' (R)
S00°01'55"E 1316.36'

S00°06'07"W 1318.97' (R)
S00°05'29"W 1318.97'

DESCRIPTION OF "NEW" HAGER DRIVE RIGHT-OF-WAY
OVER PART OF THE SOUTHEAST ¼ OF SECTION 7,
T34N R5W, BEAR CREEK TOWNSHIP, EMMET COUNTY,
MICHIGAN:

SHEET 2 OF 2

FOR: LITTLE TRAVERSE BAY BANDS OF ODAWA INDIANS
NORTHWEST DESIGN GROUP, LUCAS PORATH

DATE: JULY 25, 2007
REVISED: FEBRUARY 13, 2008
REVISED: APRIL 14, 2008

DESCRIPTION:

Part of the Southeast ¼ of Section 7, T34N R5W, Bear Creek Township, Emmet County, Michigan. Commencing at an Emmet County Remonumentation Corner of the South ¼ Corner of said Section 7; Thence N00°07'55"E 32.78 feet to the Point of Beginning; Thence along the right-of-way of Hager Drive the following courses and distances; Thence N00°07'55"E 17.00 feet; Thence N88°44'45"E 222.75 feet; Thence along the arc of a 360.00 foot radius curve to the left, 390.32 feet, (the long chord of which bears N57°41'06"E 371.48 feet); Thence N26°38'27"E 123.22 feet; Thence along the arc of a 460.00 foot radius curve to the right, 248.47 feet, (the long chord of which bears N42°06'54"E 245.46 feet); Thence N57°35'22"E 102.23 feet; Thence along the arc of a 360.00 foot radius curve to the left, 209.43 feet, (the long chord of which bears N40°55'24"E 206.49 feet); Thence N24°15'25"E 128.43 feet; Thence along the arc of a 460.00 foot radius curve to the right, 465.77 feet, (the long chord of which bears N53°15'52"E 446.13 feet); Thence N82°16'19"E 80.00 feet; Thence along the arc of a 360.00 foot radius curve to the left, 171.02 feet, (the long chord of which bears N68°39'46"E 169.42 feet); Thence N55°03'12"E 79.31 feet; Thence along the arc of a 460.00 foot radius curve to the right, 271.61 feet, (the long chord of which bears N71°58'06"E 267.68 feet); Thence N88°53'00"E 624.96 feet to the westerly right-of-way of Howard Road; Thence along said Howard Road right-of-way S00°01'55"E 100.02 feet; Thence S88°53'00"W 623.07 feet; Thence along the arc of a 360.00 foot radius curve to the left, 212.56 feet, (the long chord of which bears S71°58'06"W 209.49 feet); Thence S55°03'12"W 79.31 feet; Thence along the arc of a 460.00 foot radius curve to the right, 218.53 feet, (the long chord of which bears S68°39'46"W 216.48 feet); Thence S82°16'19"W 80.00 feet; Thence along the arc of a 360.00 foot radius curve to the left, 364.52 feet, (the long chord of which bears S53°15'52"W 349.15 feet); Thence S24°15'25"W 71.46 feet; Thence N39°51'06"W 4.74 feet; Thence S25°17'13"W 126.41 feet; Thence along the arc of a non-tangential 274.00 foot radius curve to the right, 13.10 feet, (the long chord of which bears S26°39'24"W 13.10 feet); Thence continuing along said arc of a non-tangential 274.00 foot Radius curve to the right, 147.33 feet, (the long chord of which bears S43°25'50"W 145.56 feet); Thence continuing along said arc of a non-tangential 274.00 foot radius curve to the right, 41.09 feet, (the long chord of which bears S63°07'51"W 41.05 feet); Thence S67°25'32"W 39.70 feet; Thence S32°24'38"E 12.54 feet; Thence S57°35'22"W 62.79 feet; Thence along the arc of a 360.00 foot radius curve to the left, 194.46 feet, (the long chord of which bears S42°06'54"W 192.10 feet); Thence S26°38'27"W 122.84 feet; Thence along the arc of a non-tangential 498.00 foot radius curve to the left, 148.87 feet, (the long chord of which bears S07°26'30"W 148.31 feet); Thence S01°07'19"E 15.63 feet to the northerly right of way of Lears Road, as monumented; Thence along said northerly right-of-way of Lears Road as monumented, S88°44'45"W 607.49 feet to the Point of Beginning.

Prepared By:
Thomas D. Swenor
North Star Land Surveying, Inc.
Thomas D. Swenor, P.S. 37282
2202 Mitchell Park Drive, Suite 001
Petoskey, Michigan 49770

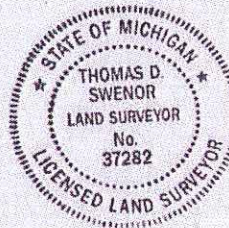

L-1101 P-635
04/16/2008 09:34A
Page: 4 of 10
Emmet County, Michigan E 41.00 5054048

STATE OF MICHIGAN
EMMET COUNTY

03 DEC 18 PM 3:03

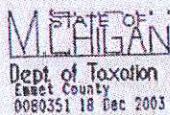

REAL ESTATE
TRANSFER TAX
\$412.50-C
\$2,612.50-S
#0016984

Alanna B. Lipe
REGISTER OF DEEDS

WARRANTY DEED

Ex-B

The Grantor: Healthshare Real Estate, Inc., a Michigan non-profit corporation
whose address is: 416 Connable Ave., Petoskey, MI 49770
conveys and warrants to: Dare III, LLC, a Michigan limited liability company
whose address is: 1301 US 131 South, Petoskey, MI 49770
the following described premises:



L-1101 P-635
04/16/2008 09:34A
Page: 5 of 10
Emmet County, Michigan E. 41.00 5054048

Land situated in the Township of Bear Creek, Emmet County, Michigan, to-wit:

Commencing at the South 1/4 corner of Section 7, Township 34 North, Range 5 West; thence along the South line of said Section 7 and the centerline of Lears Road, North 88°48'25" East, 608.21 feet to the PLACE OF BEGINNING; thence continuing along the South line of said Section 7 and the centerline of Lears Road and its Easterly extension, North 88°48'25" East, 1153.38 feet; thence North 00°01'30" West, 349.33 feet; thence South 89°58'31" West, 350.21 feet; thence North 39°50'02" West, 501.22 feet; thence along the Southerly line of Hagar Drive in the following 7 courses: South 25°17'23" West, 126.42 feet; 201.51 feet along the arc of a circular curve to the right, radius 274.00 feet, delta 42°08'18", chord South 46°21'35" West, 197.01 feet; South 67°25'42" West, 87.35 feet; 148.59 feet along the arc of a circular curve to the left, radius 207.97 feet, delta 40°56'13", chord South 46°57'37" West, 145.45 feet; South 26°29'28" West, 105.20 feet; 239.98 feet along the arc of a circular curve to the left, radius 498.00 feet, delta 27°36'36", chord South 12°41'10" West, 237.67 feet, and South 01°07'09" East, 49.02 feet to the Place of Beginning; being a part of the South 1/2 of the Southeast 1/4 of said Section 7.

Together with the Declaration of Reciprocal Easements and Covenants, Conditions and Restrictions dated November 4, 1996, and recorded November 6, 1996, in Liber 588, Page 310, Emmet County Records; and First Amendment thereto recorded February 19, 1997, in Liber 595, Page 379, Emmet County Records..

ALSO granted is the right to make 1 division under the Land Division Act.

for the full consideration of: Three Hundred Seventy Five Thousand and 00/100 Dollars (U.S. \$375,000.00)

SUBJECT TO: Easements and restrictions of record and to the lien of property taxes not yet due and payable. Unplatted lands may be regulated by the Michigan Right to Farm Act.

Dated this 10 day of December, 2003

Healthshare Real Estate, Inc., a Michigan non-profit corporation

Joseph A. Schradde
BY: Joseph A. Schradde
Its: CFO

State of Michigan
County of Emmet

MARY F. LEDINGHAM
Notary Public, Emmet Co., Mich.
My Comm. Expires July 9, 2005

The foregoing instrument was acknowledged before me this 10th day of DECEMBER, 2003, by JOSEPH A. SCHRADDE of Healthshare Real Estate, Inc., a Michigan non-profit corporation.

My commission expires 7-9-04

Mary F. Ledingham
Notary Public
Emmet County, Michigan

Instrument drafted by and Return to: William B. Conn, Esq., 616 Petoskey Street, Petoskey, MI 49770 EM-55043

County Treasurer's Certificate
Tax parcel #: part of 24 01 19 07 400 028

OFFICE OF
Treasurer of Emmet County Petoskey, Mich. 12-18-03
I hereby certify that I have examined the records in my office and it appears that the taxes on the within description have been paid for the past five years and that there are no tax liens or titles held by the state or any individual for the past five years. Prior to 12/18/03
William B. Conn
County Treasurer

(Pt of)
TAX PARCEL # 011907400028

412.50 ✓
2612.50 ✓
3225.00 ✓

Attachment to Warranty Deed, dated December 10, 2003
Between Healthshare Real Estate, Inc., a Michigan non-profit corporation./Dare III, LLC, a Michigan limited liability
company

PRIVATE ROAD DISCLOSURE

To: Dare III, LLC, a Michigan limited liability company

Land situated in the Township of Bear Creek, Emmet County, Michigan, to-wit:

Commencing at the South 1/4 corner of Section 7, Township 34 North, Range 5 West; thence along the South line of said Section 7 and the centerline of Lears Road, North 88°48'25" East, 608.21 feet to the PLACE OF BEGINNING; thence continuing along the South line of said Section 7 and the centerline of Lears Road and its Easterly extension, North 88°48'25" East, 1153.38 feet; thence North 00°01'30" West, 349.33 feet; thence South 89°58'31" West, 350.21 feet; thence North 39°50'02" West, 501.22 feet; thence along the Southerly line of Hager Drive in the following 7 courses: South 25°17'23" West, 126.42 feet; 201.51 feet along the arc of a circular curve to the right, radius 274.00 feet, delta 42°08'18", chord South 46°21'35" West, 197.01 feet; South 67°25'42" West, 87.35 feet; 148.59 feet along the arc of a circular curve to the left, radius 207.97 feet, delta 40°56'13", chord South 46°57'37" West, 145.45 feet; South 26°29'28" West, 105.20 feet; 239.98 feet along the arc of a circular curve to the left, radius 498.00 feet, delta 27°36'36", chord South 12°41'10" West, 237.67 feet, and South 01°07'09" East, 49.02 feet to the Place of Beginning; being a part of the South 1/2 of the Southeast 1/4 of said Section 7.

You are hereby advised that the above described property does not abut a street or road that has been accepted as a public road. The above said property abuts Hager Drive, which is private road. Hager Drive connects to Lears Road, which connects to US 131. This private road is not required to be maintained by the Emmet County Road Commission, Bear Creek Township or any other governmental authority; according to the terms and conditions of a certain Declaration of Reciprocal Easements and Covenants, Conditions and Restrictions dated November 4, 1996, and recorded November 6, 1996, in Liber 588, Page 310, Emmet County Records; and First Amendment thereto recorded February 19, 1997, in Liber 595, Page 379, Emmet County Records.

Healthshare Real Estate Inc., a Michigan
non-profit organization-

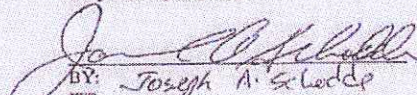
BY: Joseph A. Scheldt
ITS: CFO

The undersigned is the purchaser of
above described property and
does hereby acknowledge receiving
this Disclosure prior to the date of
this Disclosure.

Dare III, LLC, a Michigan limited liability company

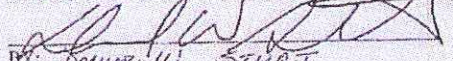
BY: DANIEL W. STURT
ITS: MEMBER

Date: 11/20/03



L-1101 P-635
04/16/2008 09:34A
Page: 6 of 10

MAY 27 REC'D



OFFICIAL SEAL
A. Sipe, ROD

Emmet Register of Deeds
06/04/2004 02:15P

L-1051 P-837

WARRANTY DEED

Ex - C

The Grantor: Healthshare Real Estate, Inc., a Michigan non-profit corporation
whose address is: 416 Connable, Petoskey, MI 49770
conveys and warrants to: Little Traverse Bay Bands of Odawa Indians
whose address is: 7500 Odawa Circle, Harbor Springs, MI 49740
the following described premises:

SEE ATTACHED LEGAL DESCRIPTION

4 Also granted is the right to make all divisions according to the Land Division Act.
for the full consideration of: REAL ESTATE TRANSFER VALUATION AFFIDAVIT FILED

SUBJECT TO: Easements and restrictions of record and to the lien of property taxes not yet due and payable.
Unplatted Lands may be regulated by the Michigan Right to Farm Act.

Dated this 26th day of MAY, 2004

Healthshare Real Estate, Inc., a Michigan non-profit corporation

Joseph A. Schodde
By: Joseph A. Schodde
ITS: CFO

State of Michigan
County of Emmet

The foregoing instrument was acknowledged before me this 26th day of MAY, 2004, by Joseph A. Schodde, CFO of Healthshare Real Estate, Inc., a Michigan non-profit corporation.

My commission expires
MARCH 23, 2005

Laura M. Silvain
Notary Public LAURA M. SILVAIN
Acting in Emmet County, Michigan

Instrument drafted by and Return to: William B. Conn, Esq., 616 Petoskey Street, Petoskey, MI 49770
EM-56071/lms
County Treasurer's Certificate

Tax parcel #: 01 19 07 451 101 AND 01 19 07 451 102 AND 01 19 07 451 103 AND 01 19 07 400 031

REAL ESTATE VALUATION
AFFIDAVIT FILED

L-1051 P-837
06/04/2004 02:15P
Page: 1 of 4
Emmet County, Michigan 04 23 00 5083896

OFFICE OF
Treasurer of Emmet County Petoskey, Mich 6-4-20-04
I hereby certify that I have examined the records in my office and it appears that the taxes on the within description have been paid for the past five years and that there are no tax liens or titles note on the acre of any individual in the east five years. Prior to date of 6-4-20-04
William B. Conn
County Treasurer

01-19-07-451-001
01-19-07-451-103
01-19-07-451-102
TAX PARCEL # 01-19-07-451-101
MET 01-19-07-400-031 (3 Parcels)

L-1101 P-635
04/16/2008 09:34A
Page: 7 of 10
Emmet County, Michigan 04 16 00 5054048

Land situated in the Township of Bear Creek, Emmet County, Michigan, to-wit:

PARCEL 1 (AMBULATORY HEALTH CARE PARCEL): Units 1, 2 and 3, HEALTH PARK MEDICAL OFFICE CONDOMINIUM, according to the Master Deed recorded in Liber 630, pages 586 through 624, inclusive, Emmet County Records, and designated as Emmet County Condominium Subdivision Plan No. 176; together with rights in general common elements and limited common elements as set forth in said Master Deed; and as described in Act 59 of the Public Acts of 1978 as amended.

PARCEL 2 (BUFFER AREA ADJACENT TO INDEPENDENCE VILLAGE): Commencing at the South 1/4 corner of Section 7, Township 34 North, Range 5 West; thence along the South line of said Section 7 and the centerline of Lears Road North 88°48'25" East 1761.59 feet; thence North 00°01'30" West 343.33 feet to the Place of Beginning; thence continuing North 00°01'30" West 793.05 feet; thence North 88°53'00" East 842.69 feet; thence along the East line of said Section 7 and the centerline of Howard Road, North 00°01'17" West 51.01 feet; thence along the Southerly line of Hagar Drive in the following 8 courses: South 89°58'43" West 106.47 feet, 95.93 feet along the arc of a circular curve to the right, radius 454.36 feet, delta 12°05'47", chord North 83°58'43" West 95.75 feet, 126.73 feet along the arc of a circular curve to the left, radius 320.14 feet, delta 22°40'52", chord North 89°15'46" West, 125.91 feet, 220.33 feet along the arc of a circular curve to the right, radius 687.72 feet, delta 18°21'22", chord South 88°34'19" West, 219.39 feet, 77.39 feet along the arc of a circular curve to the left, radius 366.96 feet, delta 12°05'01", chord North 88°17'41" West, 77.25 feet, South 85°40'02" West, 169.01 feet; 125.08 feet along the arc of a circular curve to the left, radius 166.99 feet, delta 42°54'59" chord South 64°12'35" West, 122.17 feet and South 42°45'07" West, 15.44 feet; thence North 88°53'00" East, 20.77 feet; thence South 00°01'30" East 792.10 feet; thence North 89°58'31" East, 49.87 feet to the Place of Beginning.

PARCEL 3 (BUFFER AREA ADJACENT TO HEALTH PARK): Beginning at the South 1/4 corner of Section 7, Township 34 North, Range 5 West; thence along the South line of said Section 7 and the centerline of Lears Road, North 88°48'25" East 542.21 feet; thence along the Westerly line of Hagar Drive in the following two courses: North 01°07'09" West 49.10 feet and 33.96 feet along the arc of a circular curve to the left, radius 564.00 feet, delta 03°26'59", chord North 00°37'18" East 33.95 feet; thence South 88°48'25" West 491.41 feet; thence North 00°08'05" East 651.39 feet; thence South 89°38'08" West 50.00 feet; thence along the North and South 1/4 line of said Section 7, South 00°08'05" West 735.17 feet to the Place of Beginning; being a part of the South 1/2 of the Southeast 1/4 of said Section 7 (Also known as Parcel B).



L-1101 P-635
04/16/2008 09:34A
Page: 8 of 10

Emmet County, Michigan E. 41.00 5054048



L-1051 P-837
05/04/2004 02:15P
Page: 2 of 4

Emmet County, Michigan D.W. 23.00 5003855



L-1101 P-635

04/16/2008 09:34A

Page: 9 of 10

Emmet County, Michigan E. 41.00 5054048

PARCEL 4 (REMAINDER PARCEL NORTH OF HAGER DRIVE): Commencing at the South 1/4 corner of Section 7, Township 34 North, Range 5 West; thence along the North and South 1/4 line of said Section 7, North 00°08'05" East 735.17 feet to the Place of Beginning; thence North 89°38'08" East 50.00 feet; thence along the boundary of HEALTH PARK MEDICAL OFFICE CONDOMINIUM, according to the Master Deed recorded in Liber 630, pages 586 through 624, inclusive, Emmet County Records, and designated as Emmet County Condominium Subdivision Plan No. 176, in the following 5 courses: North 89°38'08" East 146.80 feet, North 00°08'05" East 50.00 feet, North 89°38'08" East 269.27 feet, South 35°26'39" East 241.59 feet, and South 45°45'12" East 136.88 feet; thence along the Northerly line of Hager Drive in the following 15 courses: 96.94 feet along the arc of a circular curve to the right, radius 273.97 feet, delta 20°16'23", chord North 57°17'32" East 96.43 feet, North 67°25'42" East 87.35 feet, 152.97 feet along the arc of a circular curve to the left, radius 208.00 feet, delta 42°08'18", chord North 46°21'35" East 149.55 feet, North 25°17'23" East 314.10 feet, 313.12 feet along the arc of a circular curve to the right, radius 274.00 feet, delta 65°28'31", chord North 58°01'39" East 296.35 feet, South 89°14'07" East 95.40 feet, 174.28 feet along the arc of a circular curve to the left, radius 207.98 feet, delta 48°00'45", chord North 66°45'28" East 169.23 feet, North 42°45'07" East 58.24 feet, 174.52 feet along the arc of a circular curve to the right, radius 232.99 feet, delta 42°54'59", chord North 64°12'35" East 170.46 feet, North 85°40'02" East 169.01 feet, 91.31 feet along the arc of a circular curve to the right, radius 432.96 feet, delta 12°05'01", chord South 88°17'41" East 91.14 feet, 199.18 feet along the arc of a circular curve to the left, radius 621.72 feet, delta 18°21'22", chord North 88°34'19" East 198.33 feet, 152.86 feet along the arc of a circular curve to the right, radius 386.14 feet, delta 22°40'52", chord South 89°15'46" East 151.86 feet, 81.99 feet along the arc of a circular curve to the left, radius 388.36 feet, delta 12°05'47", chord South 83°58'43" East 81.84 feet, and North 89°58'43" East 106.47 feet; thence along the East line of said Section 7 and the centerline of Howard Road, North 00°01'17" West 58.09 feet; thence along the North line of the South 1/2 of the Southeast 1/4 of said Section 7, as monumented, South 88°53'16" West 2600.56 feet; thence along the North and South 1/4 line of said Section 7, South 00°08'05" West 584.95 feet to the Place of Beginning; being a part of the South 1/2 of the Southeast 1/4 of said Section 7.

PARCEL 5 [66-FOOT WIDE PRIVATE ROAD - HAGER DRIVE]: Commencing at the South 1/4 corner of Section 7, Township 34 North, Range 5 West; thence along the South line of said Section 7 and the centerline of Lears Road, North 88°48'25" East, 542.21 feet to the PLACE OF BEGINNING; thence North 01°07'09" West, 49.10 feet; thence 271.78 feet along the arc of a circular curve to the right, radius 564.00 feet, delta 27°36'36", chord North 12°41'10" East, 269.17 feet; thence North 26°29'28" East, 105.20 feet; thence 195.75 feet along the arc of a circular curve to the right, radius 273.97 feet, delta 40°56'13", chord North 46°57'37" East, 191.61 feet; thence North 67°25'42" East, 87.35 feet; thence 152.97 feet along the arc of a circular curve to the left, radius 208.00 feet, delta 42°08'18", chord North 46°21'35" East, 149.55 feet; thence North 25°17'23" East, 314.10 feet; thence 313.12 feet along the arc of a circular curve to the right, radius 274.00 feet, delta 65°28'31", chord North 58°01'39" East, 296.35 feet; thence South 89°14'07" East, 95.40 feet; thence 174.28 feet along the arc of a circular curve to the left, radius 207.98 feet, delta 48°00'45", chord North 66°45'28" East, 169.23 feet; thence North 42°45'07" East, 58.24 feet; thence 174.52 feet along the arc of a circular curve to the right, radius 232.99 feet, delta 42°54'59", chord North 64°12'35" East, 170.46 feet; thence North 85°40'02" East, 169.01 feet; thence 91.31 feet along the arc of a circular curve to the right, radius 432.96 feet, delta 12°05'01", chord South 88°17'41" East, 91.14 feet; thence 199.18 feet along the arc of a circular curve to the left, radius 621.72 feet, delta 18°21'22", chord North 88°34'19" East, 198.33 feet; thence 152.86 feet along the arc of a circular curve to the right, radius 386.14 feet, delta 22°40'52", chord South 89°15'46" East, 151.86 feet; thence 81.99 feet along the arc of a circular curve to the left, radius 388.36 feet, delta 12°05'47", chord South 83°58'43" East, 81.84 feet; thence North 89°58'43" East, 106.47 feet; thence along the East line of said Section 7 and the centerline of Howard Road, South 00°01'17" East, 66.00 feet; thence South 89°58'43" West, 106.47 feet; thence 95.93 feet along the arc of a circular curve to the right, radius 454.36 feet, delta 12°05'47", chord North 83°58'43" West, 95.75 feet; thence 126.73 feet along the arc of a circular curve to the left, radius 320.14 feet, delta 22°40'52", chord North 89°15'46" West, 125.91 feet; thence 220.33 feet along the arc of a circular curve to the right, radius 687.72 feet, delta 18°21'22", chord South 88°34'19" West, 219.39 feet; thence 77.39 feet along the arc of a circular curve to the left, radius 366.96 feet, delta 12°05'01", chord North 88°17'41" West, 77.25 feet; thence South 85°40'02" West, 169.01 feet; thence 125.08 feet along the arc of a circular curve to the left, radius 166.99 feet, delta 42°54'59", chord South 64°12'35" West, 122.17 feet; thence South 42°45'07" West, 58.24 feet; thence 229.59 feet along the arc of a circular curve to the right, radius 273.98 feet, delta 48°00'45", chord South 66°45'28" West, 222.93 feet; thence North 89°14'07" West, 95.40 feet; thence 237.69 feet along the arc of a circular curve to the left, radius 208.00 feet, delta 65°28'31", chord South 58°01'39" West, 224.97 feet; thence South 25°17'23" West, 314.10 feet; thence 201.51 feet along the arc of a circular curve to the right, radius 274.00 feet, delta 42°08'18", chord South 46°21'35" West, 197.01 feet; thence South 67°25'42" West, 87.35 feet; thence 148.59 feet along the arc of a circular curve to the left, radius 207.97 feet, delta 40°56'13", chord South 46°57'37" West, 145.45 feet; thence South 26°29'28" West, 105.20 feet; thence 239.98 feet along the arc of a circular curve to the left, radius 498.00 feet, delta 27°36'36", chord South 12°41'10" West, 237.67 feet; thence South 01°07'09" East, 49.02 feet; thence along the South line of said Section 7 and the centerline of Lears Road, South 88°48'25" West, 66.00 feet to the Place of Beginning; being a part of the South 1/2 of the Southeast 1/4 of said Section 7.



L-1051 P-837

06/04/2004 02:15P

Page: 3 of 4

Emmet County, Michigan D.H. 23.00 5003856

NOTIFICATION OF PRIVATE ROAD

Attachment to Warranty Deed dated May 26, 2004, whereas Healthshare Real Estate, Inc., a Michigan non-profit corporation, is the Grantor and Little Traverse Bay Bands of Odawa Indians, is the Grantee. Above named Grantor hereby informs above named Grantee that the road servicing the land described in said Warranty Deed, of which the property conveyed to above named Grantee by above named Grantor, is a private road that is not required to be maintained by the Board of County Road Commissioners.

This notification is given as required by Section 261 of Act 288 of P.A. 1967 (MCLA 560.261)

Acknowledged by:

Healthshare Real Estate, Inc., a Michigan non-profit corporation

BY: Joseph A Schodde
HRS: CFO

Little Traverse Bay Bands of Odawa Indians

BY: Frank Ettawageshik, Chairman

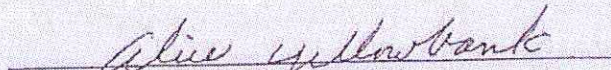
BY: Alice Yellowbank, Treasurer

 L-1101 P-635
04/16/2008 09:34A
Page: 10 of 10
Emmet County, Michigan E. 41.00 5054048

 L-1051 P-837
06/04/2004 02:15P
Page: 4 of 4
Emmet County, Michigan 23.00 5003856



OFFICIAL SEAL
Michele E. Stine

Emmet Register of Deeds
04/16/2008 09:34A

L-1101 P-636

Grant of Easement and Right of Way for Public Road

This Grant of Easement is made on this March 26, 2008, by Mariner's Cove LP d/b/a Independence Village, Inc with offices at 965 Hager Drive, Petoskey, Emmet County, Michigan, referred to in this instrument as "Grantor," to the Little Traverse Bay Bands of Odawa Indians, with offices at located at 7500 Odawa Circle, Harbor Springs, Emmet County, Michigan, referred to in this instrument as "Grantee."

Grantor is the owner of the property described in the deed recorded at Liber 604 Page 369, Emmet County Register of Deeds, which deed is attached as Exhibit B.

Grantee is the owner of the property described in the deed recorded at Liber 1051 Page 837, Emmet County Register of Deeds, which deed is attached as Exhibit C, part of which Grantee will develop into a public road as described in Exhibit A.

In consideration of \$1.00, and other good and valuable consideration, receipt of which is acknowledged, Grantor grants and conveys to Grantee and its heirs, successors, and assigns, for the purpose of an easement and right of way for the construction, improvement, operation, and maintenance of a public road over that portion of Grantor's property encompassed in Exhibit A.

This Grant of Easement will run with the land and will bind and inure to the benefit of the parties to this instrument, their heirs, successors and assigns.

Grantor has executed this instrument at Lansing, Michigan on the date first written above.

MARINER'S COVE LP

By: Midwest Investments of Petoskey, LLC
a Michigan Limited Liability Company,
General Partner

John R. Morrissey 9-26-08
By: John R. Morrissey
Its: Managing Member

RECEIVED
2008 APR 16 A 9:05

12



L-1101 P-636
04/16/2008 09:34A
Page: 1 of 12

STATE OF MICHIGAN

)

)ss

COUNTY OF INGHAM

)

The foregoing instrument was acknowledged before me this 26th day of March, 2008 by Midwest Investments of Petoskey, LLC, a Michigan Limited Liability Company, General Partner, by John R. Morrissey, Managing Member, as a duly authorized official of Mariner's Cove LP.

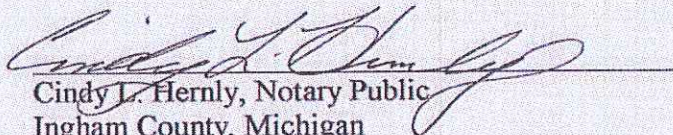

Cindy L. Hernly, Notary Public
Ingham County, Michigan
My Commission Expires: 09/12/2008

Prepared by:

James A. Bransky (P38713)
9393 Lake Leelanau Drive
Traverse City, Michigan 49684

When recorded return to:

* Frank Ettawageshik, Tribal Chairperson
Little Traverse Bay Bands of Odawa Indians
7500 Odawa Circle
Harbor Springs, MI 49740



L-1101 P-636

04/16/2008 09:34A

Page: 2 of 12

Emmet County, Michigan E. 47.00 5054049

N00°07'55"E 1320.14' NORTH AND SOUTH 1/4 LINE, SECTION 7, T34N R5W

Ex - A

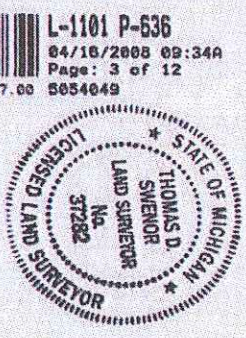

L-1101 P-536
04/16/2008 09:34A
Page: 3 of 12
8654049

Little Traverse Bay Bands of Odawa Indians (M08 Parcel Desc. in L588, P310 and Health Park Medical Office Condominium Plan No. 176)

Little Traverse Bay Bands of Odawa Indians (Remainder Parcel L588, P310, L595 P379, & L1038 P431 & 2004 Benchmark Eng. Alta Survey)

ENTIRE NORTHWESTERLY BOUNDARIES OF CAPITAL HILLS APT DARE III LLC, AND INDEPENDENCE VILLAGE MARINER'S COVE LIMITED PARTNERSHIP, HEAVY ROAD BORDER IS NEW HAGER DRIVE ROW. DASHED LINE REPRESENTS ORIGINAL HAGER DRIVE ROW.

N88°53'16"E 2600.56' (R)
N88°53'07"E 2600.40'

NO CORNERS SET ON THIS SURVEY

EAST 1/4 CORNER SOUTH 1/16 CORNER SECTION 7, T34N R5W COMMON TO SEC. 7 & 8 FOUND 1/2" ROD FOUND 1/2" ROD

SOUTH 1/4 CORNER SECTION 7, T34N R5W FOUND EMMETT COUNTY REMONUMENTATION CORNER

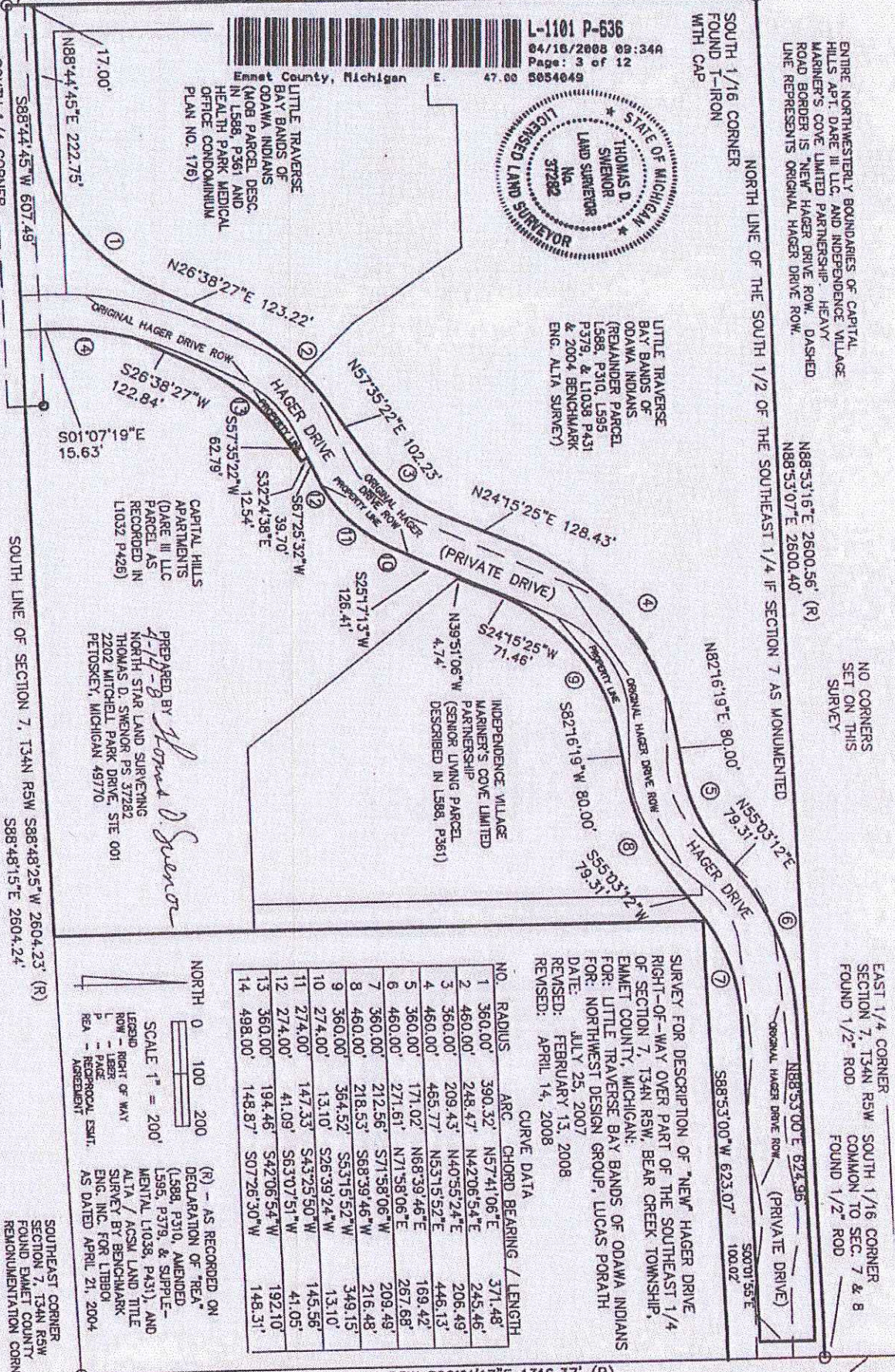

SURVEY FOR DESCRIPTION OF "NEW" HAGER DRIVE RIGHT-OF-WAY OVER PART OF THE SOUTHEAST 1/4 OF SECTION 7, T34N R5W, BEAR CREEK TOWNSHIP, EMMETT COUNTY, MICHIGAN; FOR: LITTLE TRAVERSE BAY BANDS OF ODAWA INDIANS FOR: NORTHWEST DESIGN GROUP, LUCAS PORATH DATE: JULY 25, 2007 REVISED: FEBRUARY 13, 2008 APRIL 14, 2008

NO.	RADIUS	ARC	CHORD BEARING	LENGTH
1	360.00'	390.32'	N57°41'06"E	371.48'
2	460.00'	248.47'	N42°06'54"E	245.46'
3	360.00'	209.43'	N40°55'24"E	206.49'
4	460.00'	465.77'	N53°15'52"E	446.13'
5	360.00'	171.02'	N68°39'46"E	169.42'
6	460.00'	271.61'	N71°58'06"E	267.68'
7	360.00'	212.56'	S71°58'06"W	209.49'
8	460.00'	218.53'	S68°39'46"W	216.48'
9	360.00'	364.52'	S53°15'52"W	349.15'
10	274.00'	13.10'	S28°39'24"W	13.10'
11	274.00'	147.33'	S43°25'50"W	145.56'
12	274.00'	41.09'	S63°07'51"W	41.05'
13	360.00'	194.46'	S42°06'54"W	192.10'
14	498.00'	148.87'	S07°26'30"W	148.31'

LEGEND
ROW - RIGHT OF WAY
L - LINE
P - PAGE
REA - RECORDING AGREEMENT

SCALE 1" = 200'

(R) - AS RECORDED ON DECLARATION OF TRUST (L588, P310, AMENDED L595, P379, & SUPPLEMENTAL L1038, P431), AND ALTA / ACSM LAND TITLE SURVEY BY BENCHMARK ENG. INC. FOR LIBBOL AS DATED APRIL 21, 2004

PREPARED BY Thomas D. Swenor
4-11-08
NORTH STAR LAND SURVEYING
THOMAS D. SWENOR FS 37282
2202 MITCHELL PARK DRIVE, STE 001
PETOSKEY, MICHIGAN 49770

SOUTHEAST CORNER SECTION 7, T34N R5W FOUND EMMETT COUNTY REMONUMENTATION CORNER

CAVAcadsoft/AltaAcadsoft, current: b-c75072\dwg\bc75072.dwg 4/14/2008 10:13 PM EST

DESCRIPTION OF "NEW" HAGER DRIVE RIGHT-OF-WAY
OVER PART OF THE SOUTHEAST ¼ OF SECTION 7,
T34N R5W, BEAR CREEK TOWNSHIP, EMMET COUNTY,
MICHIGAN:

SHEET 2 OF 2

FOR: LITTLE TRAVERSE BAY BANDS OF ODAWA INDIANS
NORTHWEST DESIGN GROUP, LUCAS PORATH

DATE: JULY 25, 2007
REVISED: FEBRUARY 13, 2008
REVISED: APRIL 14, 2008

DESCRIPTION:

Part of the Southeast ¼ of Section 7, T34N R5W, Bear Creek Township, Emmet County, Michigan. Commencing at an Emmet County Remonumentation Corner of the South ¼ Corner of said Section 7; Thence N00°07'55"E 32.78 feet to the Point of Beginning; Thence along the right-of-way of Hager Drive the following courses and distances; Thence N00°07'55"E 17.00 feet; Thence N88°44'45"E 222.75 feet; Thence along the arc of a 360.00 foot radius curve to the left, 390.32 feet, (the long chord of which bears N57°41'06"E 371.48 feet); Thence N26°38'27"E 123.22 feet; Thence along the arc of a 460.00 foot radius curve to the right, 248.47 feet, (the long chord of which bears N42°06'54"E 245.46 feet); Thence N57°35'22"E 102.23 feet; Thence along the arc of a 360.00 foot radius curve to the left, 209.43 feet, (the long chord of which bears N40°55'24"E 206.49 feet); Thence N24°15'25"E 128.43 feet; Thence along the arc of a 460.00 foot radius curve to the right, 465.77 feet, (the long chord of which bears N53°15'52"E 446.13 feet); Thence N82°16'19"E 80.00 feet; Thence along the arc of a 360.00 foot radius curve to the left, 171.02 feet, (the long chord of which bears N68°39'46"E 169.42 feet); Thence N55°03'12"E 79.31 feet; Thence along the arc of a 460.00 foot radius curve to the right, 271.61 feet, (the long chord of which bears N71°58'06"E 267.68 feet); Thence N88°53'00"E 624.96 feet to the westerly right-of-way of Howard Road; Thence along said Howard Road right-of-way S00°01'55"E 100.02 feet; Thence S88°53'00"W 623.07 feet; Thence along the arc of a 360.00 foot radius curve to the left, 212.56 feet, (the long chord of which bears S71°58'06"W 209.49 feet); Thence S55°03'12"W 79.31 feet; Thence along the arc of a 460.00 foot radius curve to the right, 218.53 feet, (the long chord of which bears S68°39'46"W 216.48 feet); Thence S82°16'19"W 80.00 feet; Thence along the arc of a 360.00 foot radius curve the left, 364.52 feet, (the long chord of which bears S53°15'52"W 349.15 feet); Thence S24°15'25"W 71.46 feet; Thence N39°51'06"W 4.74 feet; Thence S25°17'13"W 126.41 feet; Thence along the arc of a non-tangential 274.00 foot radius curve to the right, 13.10 feet, (the long chord of which bears S26°39'24"W 13.10 feet); Thence continuing along said arc of a non-tangential 274.00 foot Radius curve to the right, 147.33 feet, (the long chord of which bears S43°25'50"W 145.56 feet); Thence continuing along said arc of a non-tangential 274.00 foot radius curve to the right, 41.09 feet, (the long chord of which bears S63°07'51"W 41.05 feet); Thence S67°25'32"W 39.70 feet; Thence S32°24'38"E 12.54 feet; Thence S57°35'22"W 62.79 feet; Thence along the arc of a 360.00 foot radius curve to the left, 194.46 feet, (the long chord of which bears S42°06'54"W 192.10 feet); Thence S26°38'27"W 122.84 feet; Thence along the arc of a non-tangential 498.00 foot radius curve to the left, 148.87 feet, (the long chord of which bears S07°26'30"W 148.31 feet); Thence S01°07'19"E 15.63 feet to the northerly right of way of Lears Road, as monumented; Thence along said northerly right-of-way of Lears Road as monumented, S88°44'45"W 607.49 feet to the Point of Beginning.

Prepared By:
Thomas D. Swenor
North Star Land Surveying, Inc.
Thomas D. Swenor, P.S. 37282
2202 Mitchell Park Drive, Suite 001
Petoskey, Michigan 49770



L-1101 P-636
04/18/2008 09:34A
Page: 4 of 12

97 JUN -5 PM 2:30

William C. Aizer
REGISTRAR OF DEEDS

Ex B

WARRANTY DEED

The GRANTOR, Independence Village of Bear River Limited Partnership, a Michigan limited partnership, whose address is 8137 W. Grand River, Suite 10, Brighton, MI 48116, conveys and warrants to GRANTEE, Mariners' Cove Limited Partnership, a Michigan limited partnership, whose address is 8137 W. Grand River, Suite 10, Brighton, MI 48116, the following described premises situated in the Township of Bear Creek, County of Emmet, and State of Michigan:

See Exhibit A attached hereto and made a part hereof.

Three Million, Forty Seven Thousand, for the sum of Six Hundred Fourteen Dollars (\$614,047.61) Dollars subject to easements and building and use restrictions of record and further subject to that certain Mortgage, Assignment of Rents and Leases, and Security Agreement dated November 4, 1996 given by Grantor to Community First Bank, a Federal Savings Bank, and recorded on November 6, 1996 at Liber 588, Pages 380-398, Emmet County Records, which Mortgage Grantee assumes and agrees to pay.

Dated this 21 day of May, 1997

Signed in presence of:

INDEPENDENCE VILLAGE OF BEAR RIVER LIMITED PARTNERSHIP, a Michigan limited partnership

By: 9603 INVESTMENT L.L.C., a Michigan limited liability company. General Partner

Aleta M. Taylor
Aleta M. Taylor
Becky L. Phelps
Becky L. Phelps

By: *John J. Hayes*
John J. Hayes, Member

STATE OF MICHIGAN REAL ESTATE TRANSFER TAX
Dept of Taxation
Emmet County
9020765 05 Jun 1997
\$3,352.80-C
\$22,800.00-5
#0004420

STATE OF MICHIGAN)
COUNTY OF Livingston) SS

The foregoing instrument was acknowledged before me this 21st day of May, 1997 by John J. Hayes, as a Member of 9603 Investment L.L.C., a Michigan limited liability company, the General Partner of Grantor.

OFFICE OF
Treasurer of Emmet County Petoskey, Mich. 6-5-97
I hereby certify that I have examined the records in my office and it appears that the taxes on the within description have been paid for the past five years and that there are no tax liens or titles held by the State or any individual for the past five years. Priority date of deed.
John H. Blythe
County Treasurer

Becky L. Phelps
Notary Public, Livingston County
State of Michigan
My commission expires: BECKY L. PHELPS
NOTARY PUBLIC - LIVINGSTON COUNTY, MI
MY COMMISSION EXPIRES 05/04/00

County Treasurer's Certificate

City Treasurer's Certificate

When Recorded Return To: Karl L. Gotting, Esq. 232 S. Capitol Avenue, Suite 1000 Lansing, MI 48933-1525	Send Subsequent Tax Bills To: Mariners' Cove Limited Partnership 8137 W. Grand River, Suite 10 Brighton, MI 48116	Drafted By: Karl L. Gotting, Esq. 232 S. Capitol Avenue, Suite 1000 Lansing, MI 48933-1525
------------------------------------------------------------------------------------------------------------------	----------------------------------------------------------------------------------------------------------------------------	-----------------------------------------------------------------------------------------------------

Tax Parcel # 24-19-07-400-025 Recording Fee 400-025/01B/019/023/015 Transfer Tax 3352.80 ✓
22,800.00 ✓
26,152.80 ✓

APPENDIX A (No. 82-313207)

Parcel I

Situated in the Township of Bear Creek, Emmet County, Michigan: Commencing at the South one-quarter corner of Section 7, Township 34 North, Range 5 West; thence along the South line of said Section 7 and the centerline of Lears Road North 88 degrees 48 minutes 25 seconds East 1761.59 feet; thence North 00 degrees 01 minutes 30 seconds West 1142.38 feet; thence South 88 degrees 53 minutes 00 seconds West 49.98 feet to the Place of Beginning; thence South 00 degrees 01 minutes 30 seconds East 792.10 feet; thence South 89 degrees 58 minutes 31 seconds West 300.34 feet; thence North 39 degrees 50 minutes 02 seconds West 501.22 feet; thence North 25 degrees 17 minutes 23 seconds East 187.68 feet; thence 237.69 feet along the arc of a circular curve to the right, radius 208.00 feet, delta 65 degrees 28 minutes 31 seconds, chord North 58 degrees 01 minutes 39 seconds East 224.97 feet; thence South 89 degrees 14 minutes 07 seconds East 95.40 feet; thence 229.59 feet along the arc of a circular curve to the left, radius 273.98 feet, delta 48 degrees 00 minutes 45 seconds, chord North 66 degrees 45 minutes 28 seconds East 222.93 feet; thence North 42 degrees 45 minutes 07 seconds East 42.80 feet; thence North 88 degrees 53 minutes 00 seconds East 20.77 feet to the Place of Beginning; being part of the South one-half of the Southeast one-quarter of said Section 7.

PARCEL II

A non-exclusive easement for 66 foot wide Private Road: Part of the South one-half of the Southeast one-quarter of Section 7, Town 34 North, Range 5 West, Bear Creek Township, Emmet County, Michigan described as: Commencing at the South one-quarter corner of Section 7, Town 34 North, Range 5 West, Emmet County, Michigan; thence along the South line of said Section 7 and the centerline of Lears Road North 88 degrees 48 minutes 25 seconds East 542.21 feet; to the place of beginning; thence North 01 degrees 07 minutes 09 seconds West 49.10 feet; thence 271.78 feet along the arc of a circular curve to the right, radius 564.00 feet, delta 27 degrees 36 minutes 36 seconds, chord North 12 degrees 41 minutes 10 seconds East 269.17 feet; thence North 26 degrees 29 minutes 28 seconds East 105.20 feet; thence 195.75 feet along the arc of a circular curve to the right, radius 273.97 feet, delta 40 degrees 56 minutes 13 seconds, chord North 46 degrees 57 minutes 37 seconds East 191.61 feet; thence North 67 degrees 25 minutes 42 seconds East 87.35 feet; thence 152.97 feet along the arc of a circular curve to the left, radius 208.00 feet, delta 41 degrees 08 minutes 18 seconds, chord North 46 degrees 21 minutes 35 seconds East 149.55 feet; thence North 25 degrees 17 minutes 23 seconds East 314.10 feet; thence 313.12 feet along the arc of a circular curve to the right, radius 274.00 feet, delta 65 degrees 28 minutes 31 seconds, chord North 58 degrees 01 minutes 39 seconds East 296.35 feet; thence South 89 degrees 14 minutes 07 seconds East 95.40 feet; thence 174.28 feet along the arc of a circular curve to the left, radius 207.98 feet, delta 48 degrees 00 minutes 45 seconds, chord North 66 degrees 45 minutes 28 seconds East 169.23 feet; thence North 42 degrees 45 minutes 07 seconds East 58.24 feet; thence 174.52 feet along the arc of a circular curve to the right, radius 232.99 feet, delta 42 degrees 54 minutes 59 seconds, chord North 64 degrees 12 minutes 35 seconds East 170.46 feet; thence North 88 degrees 40 minutes 02 seconds East 169.01 feet; thence 91.31 feet along the arc of a circular curve to the right, radius 432.96 feet, delta 12 degrees 05 minutes 01 seconds, chord



APPENDIX A (No. 82-313207) continued

South 88 degrees 17 minutes 41 seconds East 91.14 feet; thence 199.18 feet along the arc of a circular curve to the left, radius 621.72 feet, delta 18 degrees 21 minutes 22 seconds, chord North 88 degrees 34 minutes 19 seconds East 198.33 feet; thence 152.86 feet along the arc of a circular curve to the right, radius 386.14 feet, delta 22 degrees 40 minutes 52 seconds, chord South 89 degrees 15 minutes 46 seconds East 151.86 feet; thence 81.99 feet along the arc of a circular curve to the left, radius 388.36 feet, delta 12 degrees 05 minutes 47 seconds, chord South 83 degrees 58 minutes 43 seconds East 81.84 feet; thence North 89 degrees 58 minutes 43 seconds East 106.47 feet; thence along the East line of said Section 7 and the centerline of Howard Road South 00 degrees 01 minutes 17 seconds East 66.00 feet; thence South 89 degrees 58 minutes 43 seconds West 106.47 feet; thence 95.93 feet along the arc of a circular curve to the right, radius 454.36 feet, delta 12 degrees 05 minutes 47 seconds, chord North 83 degrees 58 minutes 43 seconds West 95.75 feet; thence 126.73 feet along the arc of a circular curve to the left, radius 320.14 feet, delta 22 degrees 40 minutes 52 seconds, chord North 89 degrees 15 minutes 46 seconds West 126.91 feet; thence 220.33 feet along the arc of a circular curve to the right, radius 687.72 feet, delta 18 degrees 21 minutes 22 seconds, chord South 88 degrees 34 minutes 19 seconds West 219.39 feet; thence 77.39 feet along the arc of a circular curve to the left, radius 366.96 feet, delta 12 degrees 05 minutes 01 seconds, chord North 88 degrees 17 minutes 41 seconds West 77.25 feet; thence South 85 degrees 40 minutes 02 seconds West 169.01 feet; thence 125.08 feet along the arc of a circular curve to the left, radius 166.99 feet, delta 42 degrees 54 minutes 59 seconds, chord South 64 degrees 12 minutes 35 seconds West 122.17 feet; thence South 42 degrees 45 minutes 07 seconds West 58.24 feet; thence 229.59 feet along the arc of a circular curve to the right, radius 273.98 feet, delta 48 degrees 00 minutes 45 seconds, chord South 66 degrees 45 minutes 28 seconds West 222.93 feet; thence North 89 degrees 14 minutes 07 seconds West 95.40 feet; thence 237.69 feet along the arc of a circular curve to the left, radius 208.00 feet, delta 65 degrees 26 minutes 31 seconds, chord South 58 degrees 01 minutes 37 seconds West 224.97 feet; thence South 25 degrees 17 minutes 23 seconds West 314.10 feet; thence 201.51 feet along the arc of a circular curve to the right, radius 274.00 feet, delta 42 degrees 08 minutes 18 seconds, chord South 46 degrees 21 minutes 35 seconds West 197.01 feet; thence South 67 degrees 25 minutes 42 seconds West 87.35 feet; thence 148.59 feet along the arc of a circular curve to the left, radius 207.97 feet, delta 40 degrees 56 minutes 13 seconds, chord South 46 degrees 57 minutes 37 seconds West 145.45 feet; thence South 26 degrees 29 minutes 28 seconds West 105.20 feet; thence 239.98 feet along the arc of a circular curve to the left, radius 498.00 feet, delta 27 degrees 36 minutes 36 seconds, chord South 12 degrees 41 minutes 10 seconds West 237.67 feet; thence South 01 degrees 07 minutes 09 seconds East 49.02 feet; thence along the South line of said Section 7 and the centerline of Lears Road South 88 degrees 48 minutes 25 seconds West 66.00 feet to the place of beginning.



L-1101 P-636

04/16/2008 09:34A

Page: 7 of 12

Emmet County, Michigan E. 47.00 5054049

Page 3

MAY 27 REC'D



OFFICIAL SEAL
A. Sipe, ROD

Emmet Register of Deeds
05/04/2004 02:15P

L-1051 P-837

WARRANTY DEED

Ex - C

The Grantor: Healthshare Real Estate, Inc., a Michigan non-profit corporation

whose address is: 416 Connable, Petoskey, MI 49770

conveys and warrants to: Little Traverse Bay Bands of Odawa Indians

whose address is: 7500 Odawa Circle, Harbor Springs, MI 49740

the following described premises:

SEE ATTACHED LEGAL DESCRIPTION

4 Also granted is the right to make all divisions according to the Land Division Act.
for the full consideration of: REAL ESTATE TRANSFER VALUATION AFFIDAVIT FILED

SUBJECT TO: Easements and restrictions of record and to the lien of property taxes not yet due and payable.
Unplatted Lands may be regulated by the Michigan Right to Farm Act.

Dated this 26th day of MAY, 2004

Healthshare Real Estate, Inc., a Michigan non-profit corporation

Joseph A Schodde
By: Joseph A Schodde
ITS: CFO

State of Michigan
County of Emmet



L-1101 P-636
04/16/2003 09:34A
Page: 8 of 12
5054049

Emmet County, Michigan E. 47.00

The foregoing instrument was acknowledged before me this 26th day of MAY, 2004, by Joseph A. Schodde, CFO of Healthshare Real Estate, Inc., a Michigan non-profit corporation.

My commission expires
MARCH 23, 2005

Laura M. Salzman
Notary Public LAURA M. SALZMAN
Acting in Emmet County, Michigan

Instrument drafted by and Return to: William B. Conn, Esq., 616 Petoskey Street, Petoskey, MI 49770

EM-56071/lms
County Treasurer's Certificate

Tax parcel #: 01 19 07 451 101 AND 01 19 07 451 102 AND 01 19 07 451 103 AND 01 19 07 400 031

L-1051 P-837
05/04/2004 02:15P
Page: 1 of 4
Emmet County, Michigan O.U. 29.00 5003858

OFFICE OF
Treasurer of Emmet County Petoskey, Mich 6-4-20-04
I hereby certify that I have examined the records in my office and it appears that the taxes on the within description have been paid for the past five years and that there are no tax liens or titles held in fee or in any individual in the last five years. Prior to date of 6-4-20-04
William B. Conn
County Treasurer

REAL ESTATE VALUATION

TAX PARCEL # 01-19-07-451-001
MET 01-19-07-451-103
01-19-07-451-102
01-19-07-451-101
01-19-07-400-031 (3 Parcels)

NOTIFICATION OF PRIVATE ROAD

Attachment to Warranty Deed dated May 26, 2004, whereas Healthshare Real Estate, Inc., a Michigan non-profit corporation, is the Grantor and Little Traverse Bay Bands of Odawa Indians, is the Grantee. Above named Grantor hereby informs above named Grantee that the road servicing the land described in said Warranty Deed, of which the property conveyed to above named Grantee by above named Grantor, is a private road that is not required to be maintained by the Board of County Road Commissioners.

This notification is given as required by Section 261 of Act 288 of P.A. 1967 (MCLA 560.261)

Acknowledged by:

Healthshare Real Estate, Inc., a Michigan non-profit corporation

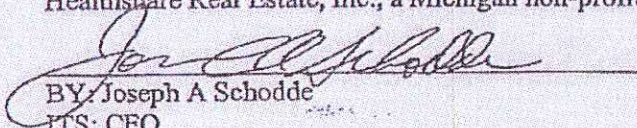
BY: Joseph A Schodde
ITS: CFO

Little Traverse Bay Bands of Odawa Indians

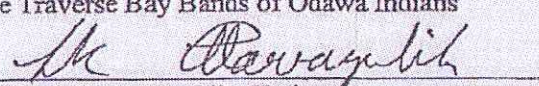
BY: Frank Ettawageshik, Chairman

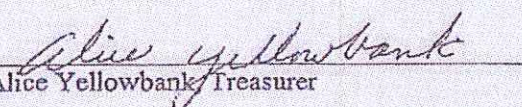
BY: Alice Yellowbank Treasurer

 L-1101 P-636
04/16/2008 09:34A
Page: 9 of 12
Emmet County, Michigan E. 47.00 5054049

 L-1051 P-837
06/04/2004 02:15P
Page: 4 of 4
Emmet County, Michigan 23.00 5083856

DESCRIPTION OF "NEW" HAGER DRIVE RIGHT-OF-WAY
OVER PART OF THE SOUTHEAST ¼ OF SECTION 7,
T34N R5W, BEAR CREEK TOWNSHIP, EMMET COUNTY,
MICHIGAN:
FOR: LITTLE TRAVERSE BAY BANDS OF ODAWA INDIANS
NORTHWEST DESIGN GROUP, LUCAS PORATH
DATE: JULY 25, 2007
REVISED: FEBRUARY 13, 2008

SHEET 2 OF 2

DESCRIPTION:

Part of the Southeast ¼ of Section 7, T34N R5W, Bear Creek Township, Emmet County, Michigan. Commencing at an Emmet County Remonumentation Corner of the South ¼ Corner of said Section 7; thence N00°07'55"E 32.78 feet to the Point of Beginning; thence along the right-of-way of Hager Drive the following courses and distances; thence N00°07'55"E 17.00 feet; thence N88°44'45"E 222.75 feet; thence along the arc of a 360.00 foot radius curve to the left, 390.32 feet, (the long chord of which bears N57°41'06"E 371.48 feet); thence N26°38'27"E 123.22 feet; thence along the arc of a 460.00 foot radius curve to the right, 248.47 feet, (the long chord of which bears N42°06'54"E 245.46 feet); thence N57°35'22"E 102.23 feet; thence along the arc of a 360.00 foot radius curve to the left, 209.43 feet, (the long chord of which bears N40°55'24"E 206.49 feet); thence N24°15'25"E 128.43 feet; thence along the arc of a 460.00 foot radius curve to the right, 465.77 feet, (the long chord of which bears N53°15'52"E 446.13 feet); thence N82°16'19"E 80.00 feet; thence along the arc of a 360.00 foot radius curve to the left, 171.02 feet, (the long chord of which bears N68°39'46"E 169.42 feet); thence N55°03'12"E 79.31 feet; thence along the arc of a 460.00 foot radius curve to the right, 271.61 feet, (the long chord of which bears N71°58'06"E 267.68 feet); thence N88°53'00"E 624.96 feet to the westerly right-of-way of Howard Road; thence along said Howard Road right-of-way S00°01'55"E 100.02 feet; thence S88°53'00"W 623.07 feet; thence along the arc of a 360.00 foot radius curve to the left, 212.56 feet, (the long chord of which bears S71°58'06"W 209.49 feet); thence S55°03'12"W 79.31 feet; thence along the arc of a 460.00 foot radius curve to the right, 218.53 feet, (the long chord of which bears S68°39'46"W 216.48 feet); thence S82°16'19"W 80.00 feet; thence along the arc of a 360.00 foot radius curve to the left, 364.52 feet, (the long chord of which bears S53°15'52"W 349.15 feet); thence S24°15'25"W 128.43 feet; thence along the arc of a 460.00 foot radius curve to the right, 80.85 feet, (the long chord of which bears S29°17'31"W 80.74 feet); thence along the arc of a non-tangential 274.00 foot Radius curve to the right, 147.33 feet, (the long chord of which bears S43°25'50"W 145.56 feet); thence along the arc of a non-tangential 460.00 foot radius curve to the right, 40.59 feet, (the long chord of which bears S55°03'42"W 40.57 feet); thence S57°35'22"W 102.23 feet; thence along the arc of a 360.00 foot radius curve to the left, 194.46 feet, (the long chord of which bears S42°06'54"W 192.10 feet); thence S26°38'27"W 122.84 feet; thence along the arc of a non-tangential 498.00 foot radius curve to the left, 148.87 feet, (the long chord of which bears S07°26'30"W 148.31 feet); thence S01°07'19"E 15.63 feet to the northerly right of way of Lears Road, as monumented; thence along said northerly right-of-way of Lears Road as monumented, S88°44'45"W 607.49 feet to the Point of Beginning.

Prepared By:

Thomas D. Swenor
North Star Land Surveying, Inc.
Thomas D. Swenor, P.S. 37282
2202 Mitchell Park Drive, Suite 001
Petoskey, Michigan 49770

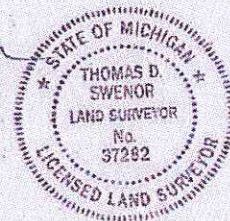

L-1101 P-636

04/16/2008 09:34A

Page: 10 of 12

Emmet County, Michigan E. 47.00 5054049



L-1101 P-636

04/16/2008 09:34A

Page: 11 of 12

Emmet County, Michigan E. 47.00 5054049

PARCEL 4 (REMAINDER PARCEL NORTH OF HAGER DRIVE): Commencing at the South 1/4 corner of Section 7, Township 34 North, Range 5 West; thence along the North and South 1/4 line of said Section 7, North 00°08'05" East 735.17 feet to the Place of Beginning; thence North 89°38'08" East 50.00 feet; thence along the boundary of HEALTH PARK MEDICAL OFFICE CONDOMINIUM, according to the Master Deed recorded in Liber 630, pages 586 through 624, inclusive, Emmet County Records, and designated as Emmet County Condominium Subdivision Plan No. 176, in the following 5 courses: North 89°38'08" East 146.80 feet, North 00°08'05" East 50.00 feet, North 89°38'08" East 269.27 feet, South 35°26'39" East 241.59 feet, and South 45°45'12" East 136.88 feet; thence along the Northerly line of Hager Drive in the following 15 courses: 96.94 feet along the arc of a circular curve to the right, radius 273.97 feet, delta 20°16'23", chord North 57°17'32" East 96.43 feet, North 67°25'42" East 87.35 feet, 152.97 feet along the arc of a circular curve to the left, radius 208.00 feet, delta 42°08'18", chord North 46°21'35" East 149.55 feet, North 25°17'23" East 314.10 feet, 313.12 feet along the arc of a circular curve to the right, radius 274.00 feet, delta 65°28'31", chord North 58°01'39" East 296.35 feet, South 89°14'07" East 95.40 feet, 174.28 feet along the arc of a circular curve to the left, radius 207.98 feet, delta 48°00'45", chord North 66°45'28" East 169.23 feet, North 42°45'07" East 58.24 feet, 174.52 feet along the arc of a circular curve to the right, radius 232.99 feet, delta 42°54'59", chord North 64°12'35" East 170.46 feet, North 85°40'02" East 169.01 feet, 91.31 feet along the arc of a circular curve to the right, radius 432.96 feet, delta 12°05'01", chord South 88°17'41" East 91.14 feet, 199.18 feet along the arc of a circular curve to the left, radius 621.72 feet, delta 18°21'22", chord North 88°34'19" East 198.33 feet, 152.86 feet along the arc of a circular curve to the right, radius 386.14 feet, delta 22°40'52", chord South 89°15'46" East 151.86 feet, 81.99 feet along the arc of a circular curve to the left, radius 388.36 feet, delta 12°05'47", chord South 83°58'43" East 81.84 feet, and North 89°58'43" East 106.47 feet; thence along the East line of said Section 7 and the centerline of Howard Road, North 00°01'17" West 58.09 feet; thence along the North line of the South 1/2 of the Southeast 1/4 of said Section 7, as monumented, South 88°53'16" West 2600.56 feet; thence along the North and South 1/4 line of said Section 7, South 00°08'05" West 584.95 feet to the Place of Beginning; being a part of the South 1/2 of the Southeast 1/4 of said Section 7.

PARCEL 5 [66-FOOT WIDE PRIVATE ROAD - HAGER DRIVE]: Commencing at the South 1/4 corner of Section 7, Township 34 North, Range 5 West; thence along the South line of said Section 7 and the centerline of Lears Road, North 88°48'25" East, 542.21 feet to the PLACE OF BEGINNING; thence North 01°07'09" West, 49.10 feet; thence 271.78 feet along the arc of a circular curve to the right, radius 564.00 feet, delta 27°36'36", chord North 12°41'10" East, 269.17 feet; thence North 26°29'28" East, 105.20 feet; thence 195.75 feet along the arc of a circular curve to the right, radius 273.97 feet, delta 40°56'13", chord North 46°57'37" East, 191.61 feet; thence North 67°25'42" East, 87.35 feet; thence 152.97 feet along the arc of a circular curve to the left, radius 208.00 feet, delta 42°08'18", chord North 46°21'35" East, 149.55 feet; thence North 25°17'23" East, 314.10 feet; thence 313.12 feet along the arc of a circular curve to the right, radius 274.00 feet, delta 65°28'31", chord North 58°01'39" East, 296.35 feet; thence South 89°14'07" East, 95.40 feet; thence 174.28 feet along the arc of a circular curve to the left, radius 207.98 feet, delta 48°00'45", chord North 66°45'28" East, 169.23 feet; thence North 42°45'07" East, 58.24 feet; thence 174.52 feet along the arc of a circular curve to the right, radius 232.99 feet, delta 42°54'59", chord North 64°12'35" East, 170.46 feet; thence North 85°40'02" East, 169.01 feet; thence 91.31 feet along the arc of a circular curve to the right, radius 432.96 feet, delta 12°05'01", chord South 88°17'41" East, 91.14 feet; thence 199.18 feet along the arc of a circular curve to the left, radius 621.72 feet, delta 18°21'22", chord North 88°34'19" East, 198.33 feet; thence 152.86 feet along the arc of a circular curve to the right, radius 386.14 feet, delta 22°40'52", chord South 89°15'46" East, 151.86 feet; thence 81.99 feet along the arc of a circular curve to the left, radius 388.36 feet, delta 12°05'47", chord South 83°58'43" East, 81.84 feet; thence North 89°58'43" East, 106.47 feet; thence along the East line of said Section 7 and the centerline of Howard Road, South 00°01'17" East, 66.00 feet; thence South 89°58'43" West, 106.47 feet; thence 95.93 feet along the arc of a circular curve to the right, radius 454.36 feet, delta 12°05'47", chord North 83°58'43" West, 95.75 feet; thence 126.73 feet along the arc of a circular curve to the left, radius 320.14 feet, delta 22°40'52", chord North 89°15'46" West, 125.91 feet; thence 220.33 feet along the arc of a circular curve to the right, radius 687.72 feet, delta 18°21'22", chord South 88°34'19" West, 219.39 feet; thence 77.39 feet along the arc of a circular curve to the left, radius 366.96 feet, delta 12°05'01", chord North 88°17'41" West, 77.25 feet; thence South 85°40'02" West, 169.01 feet; thence 125.08 feet along the arc of a circular curve to the left, radius 166.99 feet, delta 42°54'59", chord South 64°12'35" West, 122.17 feet; thence South 42°45'07" West, 58.24 feet; thence 229.59 feet along the arc of a circular curve to the right, radius 273.98 feet, delta 48°00'45", chord South 66°45'28" West, 222.93 feet; thence North 89°14'07" West, 95.40 feet; thence 237.69 feet along the arc of a circular curve to the left, radius 208.00 feet, delta 65°28'31", chord South 58°01'39" West, 224.97 feet; thence South 25°17'23" West, 314.10 feet; thence 201.51 feet along the arc of a circular curve to the right, radius 274.00 feet, delta 42°08'18", chord South 46°21'35" West, 197.01 feet; thence South 67°25'42" West, 87.35 feet; thence 148.59 feet along the arc of a circular curve to the left, radius 207.97 feet, delta 40°56'13", chord South 46°57'37" West, 145.45 feet; thence South 26°29'28" West, 105.20 feet; thence 239.98 feet along the arc of a circular curve to the left, radius 498.00 feet, delta 27°36'36", chord South 12°41'10" West, 237.67 feet; thence South 01°07'09" East, 49.02 feet; thence along the South line of said Section 7 and the centerline of Lears Road, South 88°48'25" West, 66.00 feet to the Place of Beginning; being a part of the South 1/2 of the Southeast 1/4 of said Section 7.



L-1051 P-837

05/04/2004 02:15P

Page: 3 of 4

Emmet County, Michigan D.W. 23.00 5003856