

REF'S USED FOR THIS DWG.

PLOTTED: 01/20/03

LAYER NOS:

DRAWING NAME: 01159-01164.dwg
PROJECT No. & LCTR. No. 01159-01 Working Drawings/Code Drawings

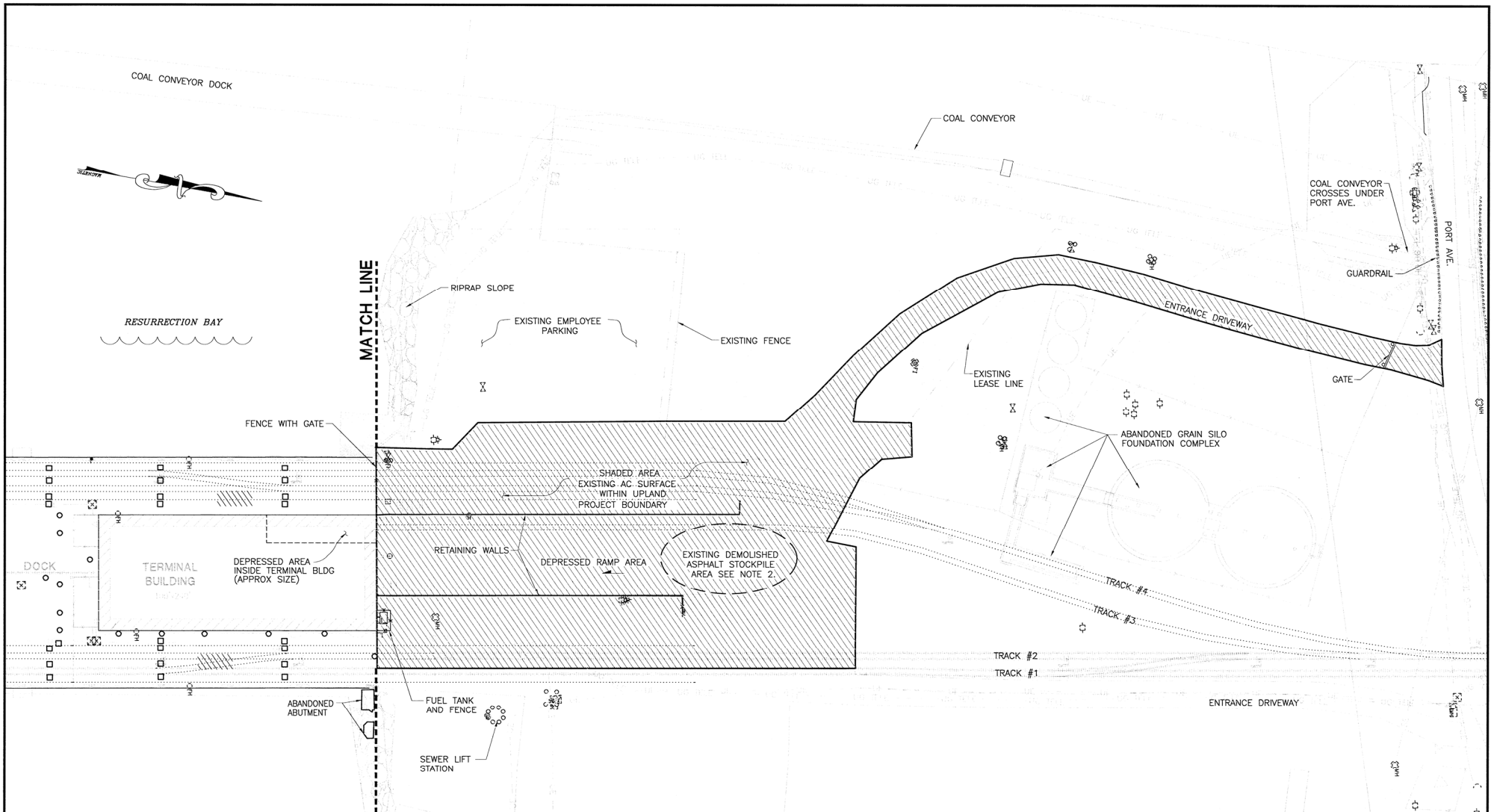

- NOTES:**
- RAILROAD TRACK IN PAVED AREAS IS TYPE 128# GIRDER RAIL. RAILROAD TRACK IN UNPAVED AREAS IS TYPE 132# RE RAIL.
 - ASPHALT REMOVED BY ARRC DURING TRACK DEMOLITION WILL BE STOCKPILED WHERE SHOWN. ALL TRACK AND TIES IN PROJECT AREA EXCEPT TRACK #1 AND A PORTION OF TRACK #2 HAVE RECENTLY BEEN REMOVED BY ARRC. SOME PAVEMENT HAS BEEN REMOVED INCIDENTAL TO THIS TRACK REMOVAL. FIELD VERIFY EXISTING CONDITIONS.

BEFORE YOU DIG CALL FOR FREE UNDERGROUND LOCATION

City of Seward Utility Inventory Locations
 Engineering.....907-224-4049
 ATT Telecom Fiber Optic Cable
 Alan Fowler.....907-264-8464
 Shoreline Petroleum
 Doug Lechner.....907-224-8040
 Locate Call Center of Alaska
 Statewide.....800-478-3121
 who will notify subscribed utilities only.
 Other utilities need to be contacted individually.

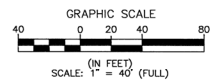

INH
 ENGINEERS/PLANNERS/SURVEYORS
 & LANDSCAPE ARCHITECTS
 TRYCK NYMAN HAYES, INC.

SHEET G4	
REV	DATE BY REVISION

ALASKA RAILROAD CORPORATION OFFICE OF THE CHIEF ENGINEER P.O. BOX 107500, ANCHORAGE, ALASKA 99510-7500 (907) 265-2456	
PROJECT : SEWARD INTERMODAL FACILITY DOCK AND UPLAND RENOVATION	
TITLE : EXISTING SITE UPLANDS	
DESIGNED BY: —	FILE: 01159-01164.DWG
DRAWN BY: SJ	DWG NO. 5 OF 68
APPROVED BY: JD	DATE : 1/17/03