

HURRICANE FIBER BUILD

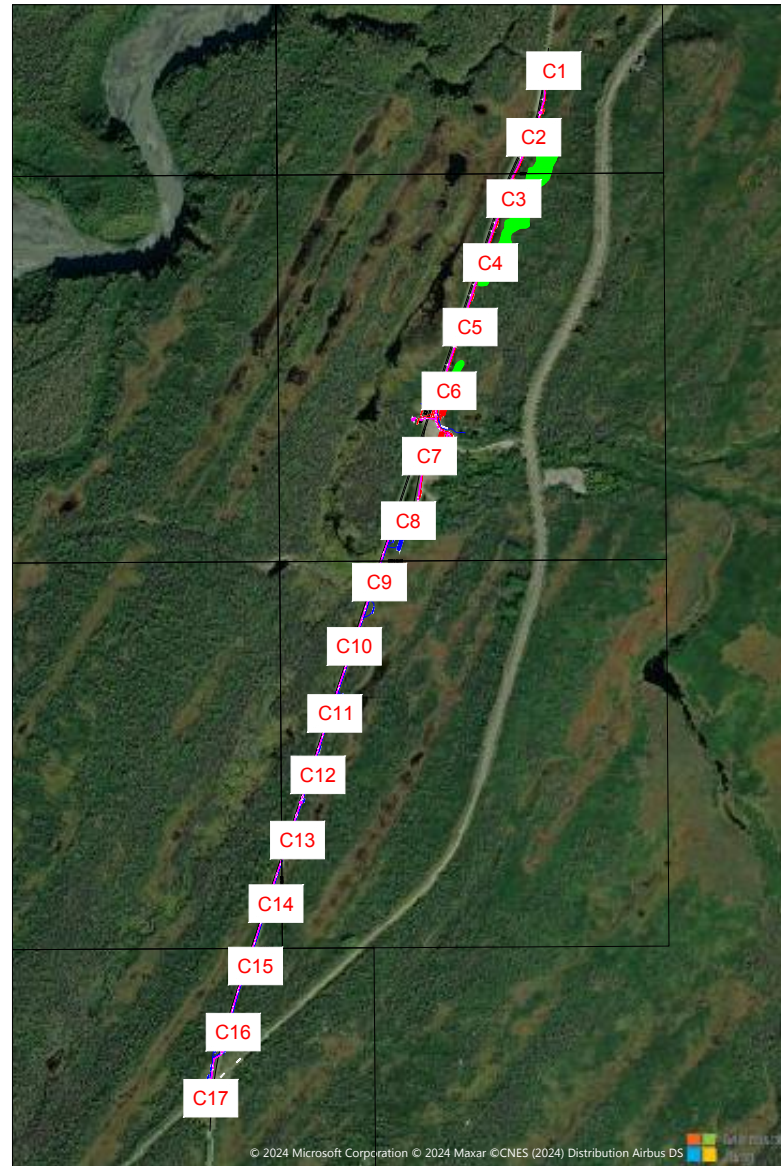

AREA MAP

ARRC PROJECT DRAWINGS

DATE: 3/19/2024



ONE-CALL NOTIFICATION SYSTEM
CALL BEFORE YOU DIG!
1-907-278-3121



DRAWING INDEX	SHEET
COVER SHEET	01
GENERAL NOTES & SPLICING	N1-N2
CONSTRUCTION PLANS	C1-C17
BUILDING ENTRANCES	--
TYPICAL DETAILS	T1-T2

CONTACT INFORMATION	
ARRC CONTACT (NAME):	RICK WILLIAMS
PHONE:	(907) 265-2300
EMAIL:	WILLIAMSRW@AKRR.COM
WILLIAMS CONTACT (NAME):	NICK WILLIAMS
PHONE:	(907) 868-8848
EMAIL:	NICK.WILLIAMS@WILCOMM.COM



4701 BUSINESS PARK BLVD, #J-12
ANCHORAGE, AK 99503
PHONE: (907) 868-8848
www.wilcomm.com



ALASKA RAILROAD NOTES:

1. CONTRACTOR TO CALL IN LOCATES THROUGH ALASKA 811 AND RAILROAD UTILITIES (CONFIRMATION REQUIRED) A MINIMUM (10) DAYS PRIOR TO EXCAVATION. (1-907-278-3121)
2. CONTRACTOR TO CALL DEVELOPMENT SERVICES AT 903-237-1074 FOR SITE INSPECTION
3. CONTRACTOR TO MAINTAIN THREE (3) FEET MINIMUM HORIZONTAL AND TWO (2) FEET MINIMUM VERTICAL CLEARANCE FROM OTHER FACILITIES.
4. ALL UTILITY CROSSINGS MUST HAVE DEPTH VERIFIED BY POTHOLING.
5. ALL DIRECTIONAL BORING SHALL HAVE THE LOCATOR PLACE BORE MARKS AND DEPTHS WHILE THE BORE IS IN PROGRESS. LOCATOR SHALL PLACE A MARK AT EACH STEM WITH A PAINT DOT AND DEPTH AT LEAST EVERY OTHER STEM.
6. CONTRACTOR MUST CLEAN SEDIMENT AND MUD FROM STREETS AND OTHER PAVED SURFACES BY PICKING IT UP AND SWEEPING. WASHING DOWN STREETS IS NOT PERMITTED.
7. CONTRACTOR MUST PICK UP CONSTRUCTION DEBRIS AND TRASH DAILY
8. CONTRACTOR MUST STABILIZE DISTURBED AREAS IN ESTABLISHED LAWN AREAS WITH WHOLE BLOCK SOD. EROSION CONTROL MATTING AND/OR HYDRO-MULCH SEEDING AND FERTILIZING ARE PERMISSIBLE IN OTHER AREAS.
9. CONTRACTOR WILL NOT BE PERMITTED TO CLOSE TRAFFIC LANES BETWEEN 7:00AM AND 9:00AM OR BETWEEN 3:30PM AND 6:30PM UNLESS OTHERWISE APPROVED IN ADVANCE BY THE PERMITTING AUTHORITY OR ARRC.
12. CONTRACTOR IS PERMITTED TO WORK BETWEEN 6:00AM AND 6:00PM ON MONDAY THROUGH FRIDAY. SATURDAY WORK IS PERMITTED BETWEEN THE HOURS OF 8:00AM AND 5:00PM, ONLY IF AN ARRANGEMENT FOR INSPECTION HAS BEEN MADE WITH THE ARRC INSPECTOR NO LATER THAN THE PRECEDING THURSDAY AT 9:00AM. THE CONTRACTOR IS NOT PERMITTED TO WORK ON SUNDAYS OR CITY HOLIDAYS EXCEPT IN THE EVENT OF AN EMERGENCY.

COMMON ABBREVIATIONS

- | | |
|------------------------------------|-------------------|
| AC - ASPHALT CUT | HD - HAND DIG |
| BA - BRIDGE ATTACHMENT | HB - HOG BORE |
| CIC - CABLE IN CONDUIT | JB - JOINT BORE |
| DBC - DIRECT BURIED CABLE | JT - JOINT TRENCH |
| DB - DIRECTIONAL BORE | OH - OVERHEAD |
| EHS - EXTRA HIGH STRENGTH (STRAND) | TR - TRENCH |

TYPICAL CONSTRUCTION DETAILS

PROJECT NAME:
HURRICANE
FIBER BUILD

PROJECT LOCATION:
HURRICANE, AK
MATANUSKA
BOROUGH

GENERAL NOTES:

1. All existing utility locations shown are approximate and may not be accurate. It is the contractor's responsibility to locate (horizontally and vertically) within the area of construction) and repair any utilities damaged during this construction described herein.
2. Call 811 locate service at least 10 days prior to construction.
3. Contractor is responsible for "potholing", locating and probing all utilities in the work area prior to construction to prevent damage.
4. All underground facility road crossings must be at least 60" minimum depth below grade.
5. All underground facility rail crossings must be at least 60" minimum depth below the rail.

SPECIAL CONSTRUCTION METHODS

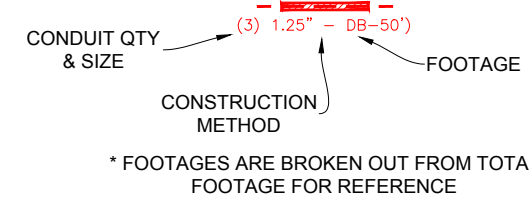

GENERAL NOTES

1. RIGHT OF WAY DATA USED FOR PERMITTING PURPOSES ONLY, NOT TO BE USED FOR SURVEYING PURPOSES.
2. ABOVE GROUND UTILITY FEATURES SHOWN FROM GIS DATA SOURCES PROVIDED BY OTHER UTILITIES AND ARRC. ALL SUBSURFACE UTILITIES SHOWN ARE APPROXIMATE. UTILITY LOCATES WILL BE PERFORMED PRIOR TO CONSTRUCTION.
3. SECTION LINES GENERATED BY GIS DATA SOURCES.
4. ALL BORES WILL BEGIN AND END AT A MINIMUM OF 50' FROM CENTERLINE OF TRACKS, AND MINIMUM 10' FROM EDGE OF PAVEMENT.
5. PAVED DRIVEWAYS, AND PARKING LOTS CAN BE TRENCHED, WITH ASPHALT REPAIR IN LIKE NEW CONDITION.
6. UTILITY FACILITIES INSTALLED IN A DITCH LINE MUST MAINTAIN AT LEAST 36" OF COVER FROM THE CROWN OF THE CONDUIT TO THE BOTTOM OF THE DITCH LINE DESIGN DEPTH.
7. CONTRACTOR SHALL OBTAIN FORMAL APPROVAL FOR ANY INSTALLATION OF FACILITIES OUTSIDE OF PUBLIC RIGHT-OF-WAY PRIOR TO COMMENCEMENT OF ANY CONSTRUCTION.
8. 100 YEAR FLOOD PLAIN DATA DEPICTED FROM GIS DATA SOURCES

SYMBOLS KEY

	Utility Pole		Right of Way
	Pole Anchor Lead		Edge of Pavement
	Proposed Manhole		Centerline
	Proposed FO Vault		Proposed Aerial Path
	Bore Pit		Proposed Underground Path
	Comm Ped		Comm Path
	Sanitary MH		Gas Path
	Stormwater MH		Sanitary Path
	Stormwater Drain		Stormwater Path
	Street Light		SL/TS
	Transformer		Power UG Path
	Water Hydrant/Valve		Water Path
	100 Year Flood Plain Boundary		



--	--	--
--	N1	--
--	--	--

CALL BEFORE YOU DIG! 1-907-278-3121
ALL POLE ATTACHMENTS ARE TO EXISTING POLES EXCEPT WHERE OTHERWISE INDICATED

- | | | | |
|--|--------------|--|-----------------|
| | POWER POLE | | JOINT USE POLE |
| | TELCO POLE | | EXISTING ANCHOR |
| | NEW HANDHOLE | | PROPOSED ANCHOR |

- | | |
|--|------------------------------------------|
| | PROPOSED FIBER OPTIC CABLE (AERIAL) |
| | PROPOSED FIBER OPTIC CABLE (UNDERGROUND) |
| | FIBER OPTIC SPLICE CASE |
| | FIBER STORAGE/SLACK LOOP |

DATE: 3/19/2024
SCALE: N.T.S.
CITY: HURRICANE, AK

DRAFTED BY: WILLIAMS
COUNTY/PARISH: MATANUSKA

PROJECT DESCRIPTION
SHEET N1 OF N2



PROPOSED CONSTRUCTION PLANS

PROJECT NAME:
HURRICANE
FIBER BUILD

PROJECT LOCATION:
HURRICANE, AK
MATANUSKA
BOROUGH

GENERAL NOTES:

1. All existing utility locations shown are approximate and may not be accurate. It is the contractor's responsibility to locate (horizontally and vertically) within the area of construction) and repair any utilities damaged during this construction described herein.
2. Call 811 locate service at least 10 days prior to construction.
3. Contractor is responsible for "potholing", locating and probing all utilities in the work area prior to construction to prevent damage.
4. All underground facility road crossings must be at least 60" minimum depth below grade.
5. All underground facility rail crossings must be at least 60" minimum depth below the rail.



WILLIAMS
COMMUNICATIONS INC.
SINCE 1979
4701 BUSINESS PARK BLVD., J-12
ANCHORAGE, AK, 99503
(907) 868-8848
www.wilcomm.com

--	--	--
C2	C1	-
--	--	--

CALL BEFORE YOU DIG! 1-907-278-3121
ALL POLE ATTACHMENTS ARE TO EXISTING POLES
EXCEPT WHERE OTHERWISE INDICATED

- ⊗ POWER POLE
- ⊗ JOINT USE POLE
- ⊗ POWER POLE (WITH TRANSFORMER)
- ⊗ JOINT USE POLE (WITH TRANSFORMER)
- TELCO POLE
- ➔ EXISTING ANCHOR
- ⊗ NEW HANDHOLE
- ➔ PROPOSED ANCHOR

- PROPOSED FIBER OPTIC CABLE (AERIAL)
- - - PROPOSED FIBER OPTIC CABLE (UNDERGROUND)
- ⊕ FIBER OPTIC SPLICE CASE
- ∞ FIBER STORAGE/SLACK LOOP

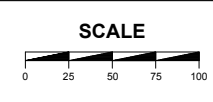

DATE: 3/19/2024
SCALE: 1" = 100' (APPROX.)
CITY: HURRICANE, AK

DRAFTED BY: WILLIAMS
COUNTY/PARISH: MSB

HURRICANE
FIBER BUILD
SHEET C1 OF C17

PROPOSED CONSTRUCTION PLANS

PROJECT NAME:
HURRICANE
FIBER BUILD

PROJECT LOCATION:
HURRICANE, AK
MATANUSKA
BOROUGH

GENERAL NOTES:

1. All existing utility locations shown are approximate and may not be accurate. It is the contractor's responsibility to locate (horizontally and vertically) within the area of construction) and repair any utilities damaged during this construction described herein.
2. Call 811 locate service at least 10 days prior to construction.
3. Contractor is responsible for "potholing", locating and probing all utilities in the work area prior to construction to prevent damage.
4. All underground facility road crossings must be at least 60" minimum depth below grade.
5. All underground facility rail crossings must be at least 60" minimum depth below the rail.



WILLIAMS
COMMUNICATIONS INC.
SINCE 1978
4701 BUSINESS PARK BLVD, J-12
ANCHORAGE, AK, 99503
(907) 868-8848
www.wilcomm.com

--	--	--
C3	C2	C1
--	--	--



CALL BEFORE YOU DIG! 1-907-278-3121
ALL POLE ATTACHMENTS ARE TO EXISTING POLES
EXCEPT WHERE OTHERWISE INDICATED

- | | |
|------------------------------------|----------------------------------------|
| ⊗ POWER POLE
(WITH TRANSFORMER) | ⊗ JOINT USE POLE
(WITH TRANSFORMER) |
| ○ TELCO POLE | ➔ EXISTING ANCHOR |
| ⊞ NEW HANDHOLE | ➔ PROPOSED ANCHOR |

- | |
|------------------------------------------------|
| — PROPOSED FIBER OPTIC CABLE (AERIAL) |
| - - - PROPOSED FIBER OPTIC CABLE (UNDERGROUND) |
| ⊕ FIBER OPTIC SPLICE CASE |
| ∞ FIBER STORAGE/SLACK LOOP |

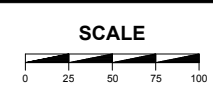

DATE: 3/19/2024
SCALE: 1" = 100' (APPROX.)
CITY: HURRICANE, AK

DRAFTED BY: WILLIAMS
COUNTY/PARISH: MSB

HURRICANE
FIBER BUILD
SHEET C2 OF C17

PROPOSED CONSTRUCTION PLANS

PROJECT NAME:
HURRICANE
FIBER BUILD

PROJECT LOCATION:
HURRICANE, AK
MATANUSKA
BOROUGH

GENERAL NOTES:

1. All existing utility locations shown are approximate and may not be accurate. It is the contractor's responsibility to locate (horizontally and vertically) within the area of construction) and repair any utilities damaged during this construction described herein.
2. Call 811 locate service at least 10 days prior to construction.
3. Contractor is responsible for "potholing", locating and probing all utilities in the work area prior to construction to prevent damage.
4. All underground facility road crossings must be at least 60" minimum depth below grade.
5. All underground facility rail crossings must be at least 60" minimum depth below the rail.



WILLIAMS
COMMUNICATIONS INC.
SINCE 1979
4701 BUSINESS PARK BLVD, J-12
ANCHORAGE, AK, 99503
(907) 868-8848
www.wilcomm.com

--	--	--
C4	C3	C2
--	--	--

HURRICANE
FIBER BUILD
SHEET C3 OF C17



CALL BEFORE YOU DIG! 1-907-278-3121
ALL POLE ATTACHMENTS ARE TO EXISTING POLES
EXCEPT WHERE OTHERWISE INDICATED

- ⊗ POWER POLE
- ⊗ JOINT USE POLE
- TELCO POLE
- ⊞ NEW HANDHOLE
- ⊗ JOINT USE POLE (WITH TRANSFORMER)
- ➔ EXISTING ANCHOR
- ➔ PROPOSED ANCHOR

- PROPOSED FIBER OPTIC CABLE (AERIAL)
- - - PROPOSED FIBER OPTIC CABLE (UNDERGROUND)
- ⊞ FIBER OPTIC SPLICE CASE
- ∞ FIBER STORAGE/SLACK LOOP

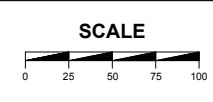

DATE: 3/19/2024
SCALE: 1" = 100' (APPROX.)
CITY: HURRICANE, AK

DRAFTED BY: WILLIAMS
COUNTY/PARISH: MSB

PROPOSED CONSTRUCTION PLANS

PROJECT NAME:
HURRICANE
FIBER BUILD

PROJECT LOCATION:
HURRICANE, AK
MATANUSKA
BOROUGH

GENERAL NOTES:

1. All existing utility locations shown are approximate and may not be accurate. It is the contractor's responsibility to locate (horizontally and vertically) within the area of construction) and repair any utilities damaged during this construction described herein.
2. Call 811 locate service at least 10 days prior to construction.
3. Contractor is responsible for "potholing", locating and probing all utilities in the work area prior to construction to prevent damage.
4. All underground facility road crossings must be at least 60" minimum depth below grade.
5. All underground facility rail crossings must be at least 60" minimum depth below the rail.



WILLIAMS
COMMUNICATIONS INC.
SINCE 1979
4701 BUSINESS PARK BLVD, J-12
ANCHORAGE, AK, 99503
(907) 868-8848
www.wilcomm.com

--	--	--
C5	C4	C3
--	--	--



CALL BEFORE YOU DIG! 1-907-278-3121
ALL POLE ATTACHMENTS ARE TO EXISTING POLES
EXCEPT WHERE OTHERWISE INDICATED

- ⊗ POWER POLE
- ⊗ JOINT USE POLE
- ⊗ POWER POLE (WITH TRANSFORMER)
- ⊗ JOINT USE POLE (WITH TRANSFORMER)
- TELCO POLE
- EXISTING ANCHOR
- ⊞ NEW HANDHOLE
- ⊞ PROPOSED ANCHOR

- PROPOSED FIBER OPTIC CABLE (AERIAL)
- - - PROPOSED FIBER OPTIC CABLE (UNDERGROUND)
- ⊞ FIBER OPTIC SPLICE CASE
- ∞ FIBER STORAGE/SLACK LOOP

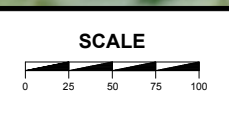

DATE: 3/19/2024
SCALE: 1" = 100' (APPROX.)
CITY: HURRICANE, AK

DRAFTED BY: WILLIAMS
COUNTY/PARISH: MSB

HURRICANE
FIBER BUILD
SHEET C4 OF C17



PROPOSED CONSTRUCTION PLANS

PROJECT NAME:
HURRICANE
FIBER BUILD

PROJECT LOCATION:
HURRICANE, AK
MATANUSKA
BOROUGH

GENERAL NOTES:

1. All existing utility locations shown are approximate and may not be accurate. It is the contractor's responsibility to locate (horizontally and vertically) within the area of construction) and repair any utilities damaged during this construction described herein.
2. Call 811 locate service at least 10 days prior to construction.
3. Contractor is responsible for "potholing", locating and probing all utilities in the work area prior to construction to prevent damage.
4. All underground facility road crossings must be at least 60" minimum depth below grade.
5. All underground facility rail crossings must be at least 60" minimum depth below the rail.



WILLIAMS
COMMUNICATIONS INC.
SINCE 1978
4701 BUSINESS PARK BLVD., J-12
ANCHORAGE, AK, 99503
(907) 868-8848
www.wilcomm.com

--	--	--
C6	C5	C4
--	--	--

CALL BEFORE YOU DIG! 1-907-278-3121
ALL POLE ATTACHMENTS ARE TO EXISTING POLES
EXCEPT WHERE OTHERWISE INDICATED

- ⊗ POWER POLE (WITH TRANSFORMER)
- ⊗ JOINT USE POLE (WITH TRANSFORMER)
- TELCO POLE
- ⊞ NEW HANDHOLE
- ⊗ JOINT USE POLE (WITH TRANSFORMER)
- ➔ EXISTING ANCHOR
- PROPOSED ANCHOR

- PROPOSED FIBER OPTIC CABLE (AERIAL)
- - - PROPOSED FIBER OPTIC CABLE (UNDERGROUND)
- ⊕ FIBER OPTIC SPLICE CASE
- ∞ FIBER STORAGE/SLACK LOOP

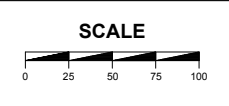

DATE: 3/19/2024
SCALE: 1" = 100' (APPROX.)
CITY: HURRICANE, AK

DRAFTED BY: WILLIAMS
COUNTY/PARISH: MSB

HURRICANE
FIBER BUILD
SHEET C5 OF C17



**MID-SHEATH ENTRY,
DO NOT CUT 144CT**

**PROPOSED
CONSTRUCTION
PLANS**

PROJECT NAME:
HURRICANE
FIBER BUILD

PROJECT LOCATION:
HURRICANE, AK
MATANUSKA
BOROUGH

GENERAL NOTES:

1. All existing utility locations shown are approximate and may not be accurate. It is the contractor's responsibility to locate (horizontally and vertically) within the area of construction) and repair any utilities damaged during this construction described herein.
2. Call 811 locate service at least 10 days prior to construction.
3. Contractor is responsible for "potholing", locating and probing all utilities in the work area prior to construction to prevent damage.
4. All underground facility road crossings must be at least 60" minimum depth below grade.
5. All underground facility rail crossings must be at least 60" minimum depth below the rail.



WILLIAMS
COMMUNICATIONS INC.
SINCE 1977

4701 BUSINESS PARK BLVD, J-12
ANCHORAGE, AK, 99503
(907) 868-8848
www.wilcomm.com

--	--	--
C7	C6	C5
--	--	--

CALL BEFORE YOU DIG! 1-907-278-3121
ALL POLE ATTACHMENTS ARE TO EXISTING POLES
EXCEPT WHERE OTHERWISE INDICATED

- ⊗ POWER POLE
- ⊗ JOINT USE POLE
- ⊗ JOINT USE POLE (WITH TRANSFORMER)
- TELCO POLE
- ⊞ NEW HANDHOLE
- ➔ EXISTING ANCHOR
- ➔ PROPOSED ANCHOR

- PROPOSED FIBER OPTIC CABLE (AERIAL)
- - - PROPOSED FIBER OPTIC CABLE (UNDERGROUND)
- ⊕ FIBER OPTIC SPLICE CASE
- ∞ FIBER STORAGE/SLACK LOOP

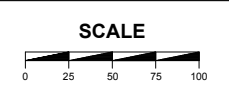

DATE: 3/19/2024
SCALE: 1" = 100' (APPROX.)
CITY: HURRICANE, AK

DRAFTED BY: WILLIAMS
COUNTY/PARISH: MSB

HURRICANE
FIBER BUILD
SHEET C6 OF C17



PROPOSED CONSTRUCTION PLANS

PROJECT NAME:
HURRICANE FIBER BUILD

PROJECT LOCATION:
HURRICANE, AK
MATANUSKA BOROUGH

GENERAL NOTES:

1. All existing utility locations shown are approximate and may not be accurate. It is the contractor's responsibility to locate (horizontally and vertically) within the area of construction) and repair any utilities damaged during this construction described herein.
2. Call 811 locate service at least 10 days prior to construction.
3. Contractor is responsible for "potholing", locating and probing all utilities in the work area prior to construction to prevent damage.
4. All underground facility road crossings must be at least 60" minimum depth below grade.
5. All underground facility rail crossings must be at least 60" minimum depth below the rail.

**MID-SHEATH ENTRY,
DO NOT CUT 144CT**



WILLIAMS COMMUNICATIONS INC.
SINCE 1978

4701 BUSINESS PARK BLVD, J-12
ANCHORAGE, AK, 99503
(907) 868-8848
www.wilcomm.com

--	--	--
C8	C7	C6
--	--	--

CALL BEFORE YOU DIG! 1-907-278-3121
ALL POLE ATTACHMENTS ARE TO EXISTING POLES EXCEPT WHERE OTHERWISE INDICATED

- ⊗ POWER POLE
- ⊗ JOINT USE POLE
- TELCO POLE
- ⊞ NEW HANDHOLE
- ⊗ JOINT USE POLE (WITH TRANSFORMER)
- ➔ EXISTING ANCHOR
- PROPOSED ANCHOR

- PROPOSED FIBER OPTIC CABLE (AERIAL)
- - - PROPOSED FIBER OPTIC CABLE (UNDERGROUND)
- ⊞ FIBER OPTIC SPLICE CASE
- ∞ FIBER STORAGE/SLACK LOOP

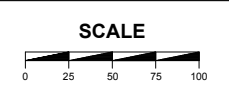

DATE: 3/19/2024
SCALE: 1" = 100' (APPROX.)
CITY: HURRICANE, AK

DRAFTED BY: WILLIAMS
COUNTY/PARISH: MSB

HURRICANE FIBER BUILD
SHEET C7 OF C17

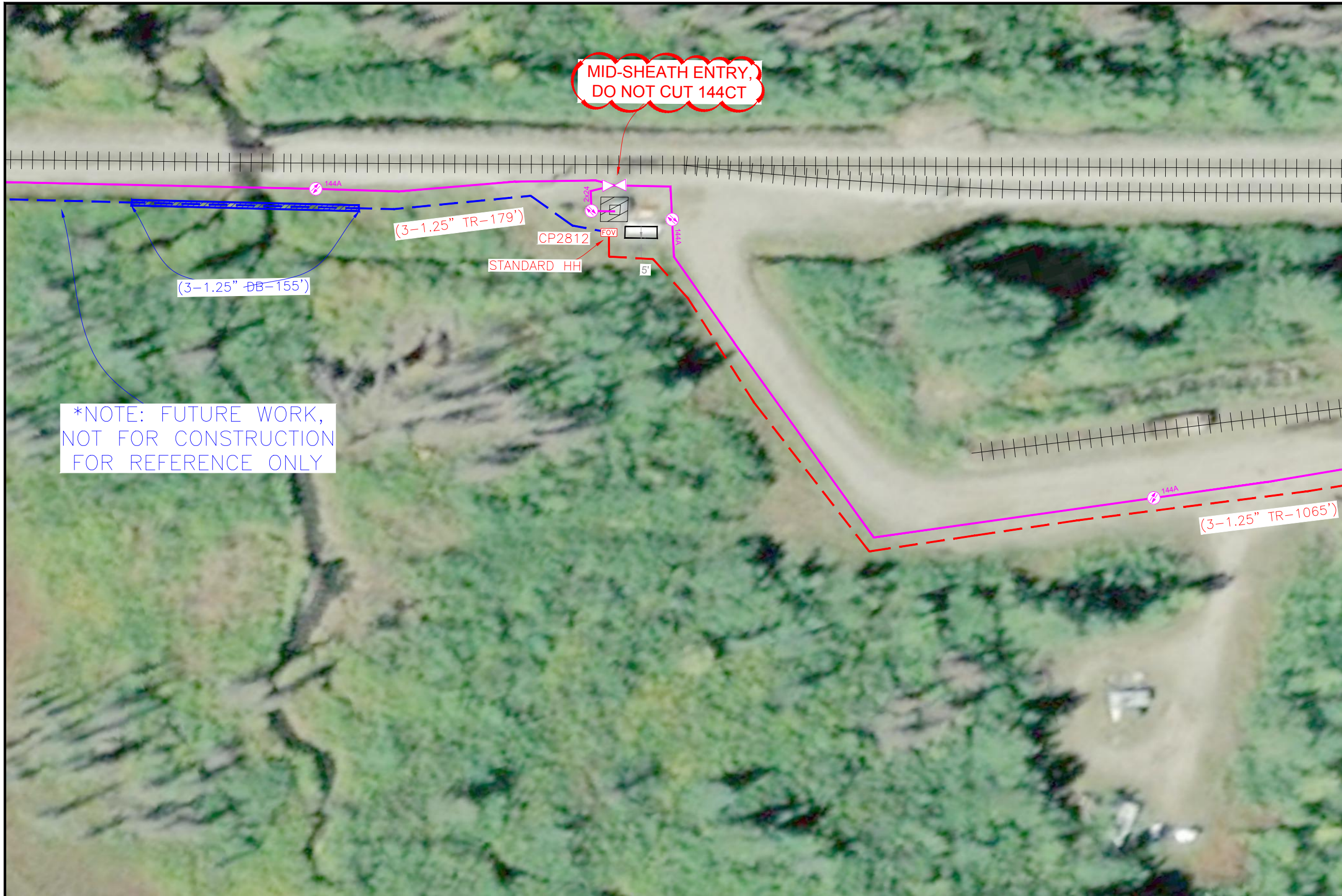

PROPOSED CONSTRUCTION PLANS

PROJECT NAME:
HURRICANE FIBER BUILD

PROJECT LOCATION:
HURRICANE, AK
MATANUSKA BOROUGH

GENERAL NOTES:

1. All existing utility locations shown are approximate and may not be accurate. It is the contractor's responsibility to locate (horizontally and vertically) within the area of construction) and repair any utilities damaged during this construction described herein.
2. Call 811 locate service at least 10 days prior to construction.
3. Contractor is responsible for "potholing", locating and probing all utilities in the work area prior to construction to prevent damage.
4. All underground facility road crossings must be at least 60" minimum depth below grade.
5. All underground facility rail crossings must be at least 60" minimum depth below the rail.

*NOTE: FUTURE WORK, NOT FOR CONSTRUCTION FOR REFERENCE ONLY



WILLIAMS COMMUNICATIONS INC.
SINCE 1979

4701 BUSINESS PARK BLVD., J-12
ANCHORAGE, AK, 99503
(907) 868-8848
www.wilcomm.com

--	--	--
C9	C8	C7
--	--	--

CALL BEFORE YOU DIG! 1-907-278-3121
ALL POLE ATTACHMENTS ARE TO EXISTING POLES EXCEPT WHERE OTHERWISE INDICATED

- ⊗ POWER POLE
- ⊗ JOINT USE POLE
- ⊗ POWER POLE (WITH TRANSFORMER)
- ⊗ JOINT USE POLE (WITH TRANSFORMER)
- TELCO POLE
- ➔ EXISTING ANCHOR
- ⊞ NEW HANDHOLE
- ➔ PROPOSED ANCHOR

- PROPOSED FIBER OPTIC CABLE (AERIAL)
- - - PROPOSED FIBER OPTIC CABLE (UNDERGROUND)
- ⊞ FIBER OPTIC SPLICE CASE
- ∞ FIBER STORAGE/SLACK LOOP

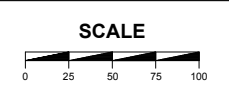

DATE: 3/19/2024
SCALE: 1" = 100' (APPROX.)
CITY: HURRICANE, AK

DRAFTED BY: WILLIAMS
COUNTY/PARISH: MSB

HURRICANE FIBER BUILD
SHEET C8 OF C17

PROPOSED CONSTRUCTION PLANS

PROJECT NAME:
HURRICANE
FIBER BUILD

PROJECT LOCATION:
HURRICANE, AK
MATANUSKA
BOROUGH

GENERAL NOTES:

1. All existing utility locations shown are approximate and may not be accurate. It is the contractor's responsibility to locate (horizontally and vertically) within the area of construction) and repair any utilities damaged during this construction described herein.
2. Call 811 locate service at least 10 days prior to construction.
3. Contractor is responsible for "potholing", locating and probing all utilities in the work area prior to construction to prevent damage.
4. All underground facility road crossings must be at least 60" minimum depth below grade.
5. All underground facility rail crossings must be at least 60" minimum depth below the rail.



WILLIAMS
COMMUNICATIONS INC.
SINCE 1978
4701 BUSINESS PARK BLVD, J-12
ANCHORAGE, AK, 99503
(907) 868-8848
www.wilcomm.com

--	--	--
C10	C9	C8
--	--	--

HURRICANE
FIBER BUILD
SHEET C9 OF C17



CALL BEFORE YOU DIG! 1-907-278-3121
ALL POLE ATTACHMENTS ARE TO EXISTING POLES
EXCEPT WHERE OTHERWISE INDICATED

- ⊗ POWER POLE
- ⊗ JOINT USE POLE
- ⊗ POWER POLE (WITH TRANSFORMER)
- ⊗ JOINT USE POLE (WITH TRANSFORMER)
- TELCO POLE
- ➔ EXISTING ANCHOR
- ➔ PROPOSED ANCHOR
- ⊞ NEW HANDHOLE

- PROPOSED FIBER OPTIC CABLE (AERIAL)
- - - PROPOSED FIBER OPTIC CABLE (UNDERGROUND)
- ⊞ FIBER OPTIC SPLICE CASE
- ∞ FIBER STORAGE/SLACK LOOP

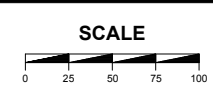

DATE: 3/19/2024
SCALE: 1" = 100' (APPROX.)
CITY: HURRICANE, AK

DRAFTED BY: WILLIAMS
COUNTY/PARISH: MSB



PROPOSED CONSTRUCTION PLANS

PROJECT NAME:
HURRICANE
FIBER BUILD

PROJECT LOCATION:
HURRICANE, AK
MATANUSKA
BOROUGH

GENERAL NOTES:

1. All existing utility locations shown are approximate and may not be accurate. It is the contractor's responsibility to locate (horizontally and vertically) within the area of construction) and repair any utilities damaged during this construction described herein.
2. Call 811 locate service at least 10 days prior to construction.
3. Contractor is responsible for "potholing", locating and probing all utilities in the work area prior to construction to prevent damage.
4. All underground facility road crossings must be at least 60" minimum depth below grade.
5. All underground facility rail crossings must be at least 60" minimum depth below the rail.

*NOTE: FUTURE WORK,
NOT FOR CONSTRUCTION
FOR REFERENCE ONLY



WILLIAMS
COMMUNICATIONS INC.
SINCE 1978
4701 BUSINESS PARK BLVD., J-12
ANCHORAGE, AK, 99503
(907) 868-8848
www.wilcomm.com

--	--	--
C11	C10	C9
--	--	--

CALL BEFORE YOU DIG! 1-907-278-3121
ALL POLE ATTACHMENTS ARE TO EXISTING POLES
EXCEPT WHERE OTHERWISE INDICATED

- ⊗ POWER POLE
- ⊗ JOINT USE POLE
- ⊗ POWER POLE (WITH TRANSFORMER)
- ⊗ JOINT USE POLE (WITH TRANSFORMER)
- TELCO POLE
- ➔ EXISTING ANCHOR
- ⊠ NEW HANDHOLE
- ➔ PROPOSED ANCHOR

- PROPOSED FIBER OPTIC CABLE (AERIAL)
- - - PROPOSED FIBER OPTIC CABLE (UNDERGROUND)
- ⊕ FIBER OPTIC SPLICE CASE
- ∞ FIBER STORAGE/SLACK LOOP

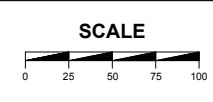

DATE: 3/19/2024
SCALE: 1" = 100' (APPROX.)
CITY: HURRICANE, AK

DRAFTED BY: WILLIAMS
COUNTY/PARISH: MSB

HURRICANE
FIBER BUILD
SHEETC10OF C17



PROPOSED CONSTRUCTION PLANS

PROJECT NAME:
HURRICANE FIBER BUILD

PROJECT LOCATION:
HURRICANE, AK
MATANUSKA BOROUGH

GENERAL NOTES:

1. All existing utility locations shown are approximate and may not be accurate. It is the contractor's responsibility to locate (horizontally and vertically) within the area of construction) and repair any utilities damaged during this construction described herein.
2. Call 811 locate service at least 10 days prior to construction.
3. Contractor is responsible for "potholing", locating and probing all utilities in the work area prior to construction to prevent damage.
4. All underground facility road crossings must be at least 60" minimum depth below grade.
5. All underground facility rail crossings must be at least 60" minimum depth below the rail.

*NOTE: FUTURE WORK,
NOT FOR CONSTRUCTION
FOR REFERENCE ONLY



WILLIAMS
COMMUNICATIONS INC.
SINCE 1978

4701 BUSINESS PARK BLVD, J-12
ANCHORAGE, AK, 99503
(907) 868-8848
www.wilcomm.com

--	--	--
C12	C11	C10
--	--	--

CALL BEFORE YOU DIG! 1-907-278-3121
ALL POLE ATTACHMENTS ARE TO EXISTING POLES EXCEPT WHERE OTHERWISE INDICATED

- ⊗ POWER POLE
- ⊗ JOINT USE POLE
- ⊗ POWER POLE (WITH TRANSFORMER)
- ⊗ JOINT USE POLE (WITH TRANSFORMER)
- TELCO POLE
- ➔ EXISTING ANCHOR
- ⊗ NEW HANDHOLE
- ➔ PROPOSED ANCHOR

- PROPOSED FIBER OPTIC CABLE (AERIAL)
- - - PROPOSED FIBER OPTIC CABLE (UNDERGROUND)
- ⊕ FIBER OPTIC SPLICE CASE
- ∞ FIBER STORAGE/SLACK LOOP

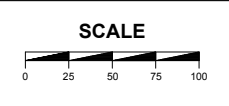

DATE: 3/19/2024
SCALE: 1" = 100' (APPROX.)
CITY: HURRICANE, AK

DRAFTED BY: WILLIAMS
COUNTY/PARISH: MSB

HURRICANE FIBER BUILD
SHEETC11OF C17

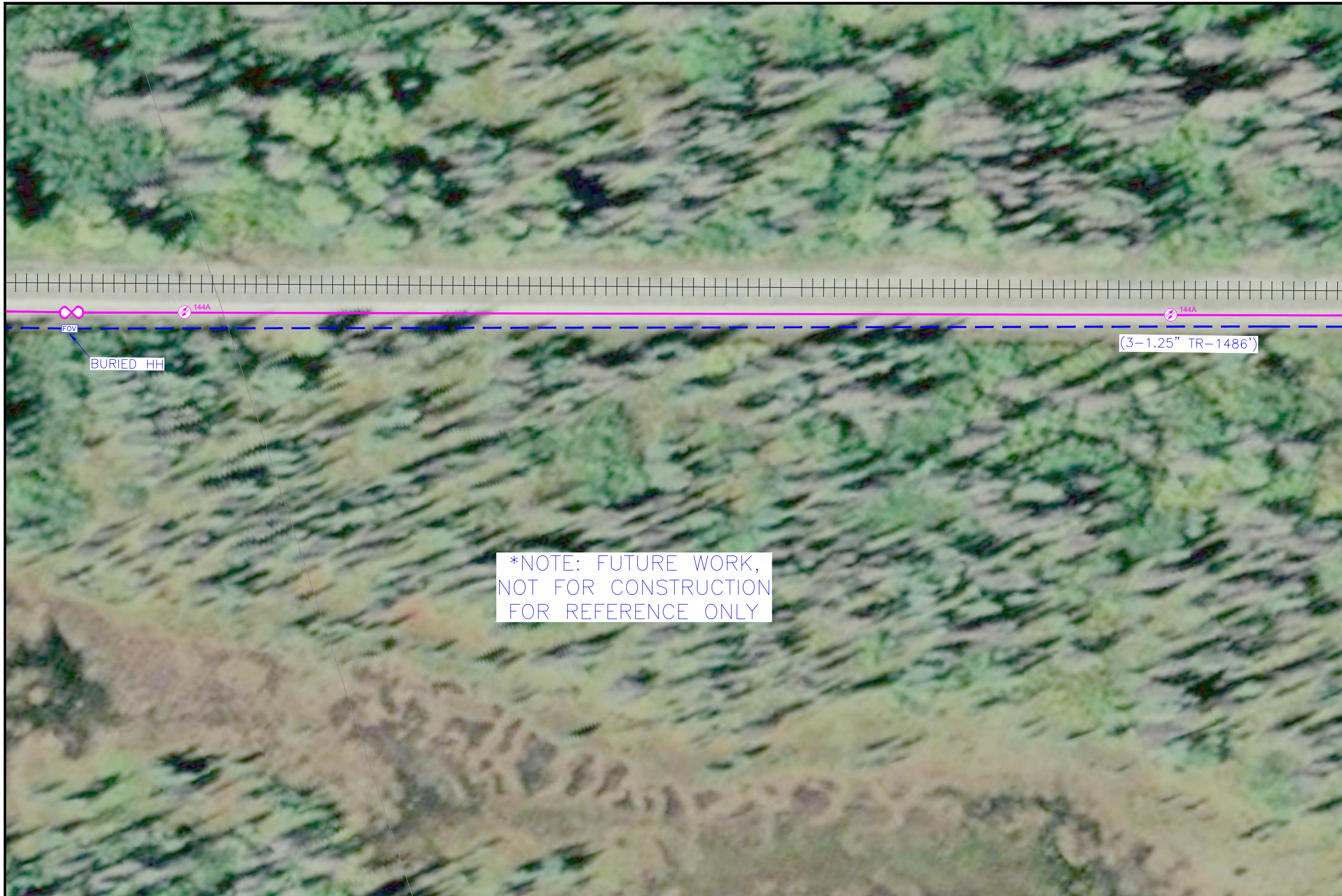

*NOTE: FUTURE WORK,
NOT FOR CONSTRUCTION
FOR REFERENCE ONLY

PROPOSED CONSTRUCTION PLANS

PROJECT NAME:
HURRICANE
FIBER BUILD

PROJECT LOCATION:
HURRICANE, AK
MATANUSKA
BOROUGH

GENERAL NOTES:

1. All existing utility locations shown are approximate and may not be accurate. It is the contractor's responsibility to locate (horizontally and vertically) within the area of construction) and repair any utilities damaged during this construction described herein.
2. Call 811 locate service at least 10 days prior to construction.
3. Contractor is responsible for "potholing", locating and probing all utilities in the work area prior to construction to prevent damage.
4. All underground facility road crossings must be at least 60" minimum depth below grade.
5. All underground facility rail crossings must be at least 60" minimum depth below the rail.



WILLIAMS
COMMUNICATIONS INC.
SINCE 1978
4701 BUSINESS PARK BLVD, J-12
ANCHORAGE, AK, 99503
(907) 868-8848
www.wilcomm.com

--	--	--
C13	C12	C11
--	--	--

CALL BEFORE YOU DIG! 1-907-278-3121
ALL POLE ATTACHMENTS ARE TO EXISTING POLES
EXCEPT WHERE OTHERWISE INDICATED

- ⊗ POWER POLE
- ⊗ JOINT USE POLE
- ⊗ JOINT USE POLE (WITH TRANSFORMER)
- TELCO POLE
- ⊞ NEW HANDHOLE
- ⊞ EXISTING ANCHOR
- ⊞ PROPOSED ANCHOR

- PROPOSED FIBER OPTIC CABLE (AERIAL)
- - - PROPOSED FIBER OPTIC CABLE (UNDERGROUND)
- ⊞ FIBER OPTIC SPLICE CASE
- ∞ FIBER STORAGE/SLACK LOOP

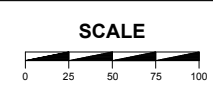

DATE: 3/19/2024
SCALE: 1" = 100' (APPROX.)
CITY: HURRICANE, AK

DRAFTED BY: WILLIAMS
COUNTY/PARISH: MSB

HURRICANE
FIBER BUILD
SHEETC12OF C17



PROPOSED CONSTRUCTION PLANS

PROJECT NAME:
HURRICANE
FIBER BUILD

PROJECT LOCATION:
HURRICANE, AK
MATANUSKA
BOROUGH

GENERAL NOTES:

1. All existing utility locations shown are approximate and may not be accurate. It is the contractor's responsibility to locate (horizontally and vertically) within the area of construction) and repair any utilities damaged during this construction described herein.
2. Call 811 locate service at least 10 days prior to construction.
3. Contractor is responsible for "potholing", locating and probing all utilities in the work area prior to construction to prevent damage.
4. All underground facility road crossings must be at least 60" minimum depth below grade.
5. All underground facility rail crossings must be at least 60" minimum depth below the rail.



WILLIAMS
COMMUNICATIONS INC.
SINCE 1979
4701 BUSINESS PARK BLVD, J-12
ANCHORAGE, AK, 99503
(907) 868-8848
www.wilcomm.com

--	--	--
C14	C13	C12
--	--	--

CALL BEFORE YOU DIG! 1-907-278-3121
ALL POLE ATTACHMENTS ARE TO EXISTING POLES
EXCEPT WHERE OTHERWISE INDICATED

- ⊗ POWER POLE
- ⊗ JOINT USE POLE
- ⊗ POWER POLE (WITH TRANSFORMER)
- ⊗ JOINT USE POLE (WITH TRANSFORMER)
- TELCO POLE
- EXISTING ANCHOR
- ⊠ NEW HANDHOLE
- ⊠ PROPOSED ANCHOR

- PROPOSED FIBER OPTIC CABLE (AERIAL)
- - - PROPOSED FIBER OPTIC CABLE (UNDERGROUND)
- ⊠ FIBER OPTIC SPLICE CASE
- ∞ FIBER STORAGE/SLACK LOOP

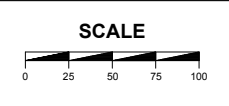

DATE: 3/19/2024
SCALE: 1" = 100' (APPROX.)
CITY: HURRICANE, AK

DRAFTED BY: WILLIAMS
COUNTY/PARISH: MSB

HURRICANE
FIBER BUILD
SHEETC13OF C17



*NOTE: FUTURE WORK,
NOT FOR CONSTRUCTION
FOR REFERENCE ONLY

PROPOSED CONSTRUCTION PLANS

PROJECT NAME:
HURRICANE
FIBER BUILD

PROJECT LOCATION:
HURRICANE, AK
MATANUSKA
BOROUGH

GENERAL NOTES:

1. All existing utility locations shown are approximate and may not be accurate. It is the contractor's responsibility to locate (horizontally and vertically) within the area of construction) and repair any utilities damaged during this construction described herein.
2. Call 811 locate service at least 10 days prior to construction.
3. Contractor is responsible for "potholing", locating and probing all utilities in the work area prior to construction to prevent damage.
4. All underground facility road crossings must be at least 60" minimum depth below grade.
5. All underground facility rail crossings must be at least 60" minimum depth below the rail.



WILLIAMS
COMMUNICATIONS INC.
SINCE 1979
4701 BUSINESS PARK BLVD, J-12
ANCHORAGE, AK, 99503
(907) 868-8848
www.wilcomm.com

--	--	--
C15	C14	C13
--	--	--

CALL BEFORE YOU DIG! 1-907-278-3121
ALL POLE ATTACHMENTS ARE TO EXISTING POLES
EXCEPT WHERE OTHERWISE INDICATED

- ⊗ POWER POLE
- ⊗ JOINT USE POLE
- ⊗ POWER POLE (WITH TRANSFORMER)
- ⊗ JOINT USE POLE (WITH TRANSFORMER)
- TELCO POLE
- ➔ EXISTING ANCHOR
- ➔ PROPOSED ANCHOR
- ⊞ NEW HANDHOLE

- PROPOSED FIBER OPTIC CABLE (AERIAL)
- - - PROPOSED FIBER OPTIC CABLE (UNDERGROUND)
- ⊞ FIBER OPTIC SPLICE CASE
- ∞ FIBER STORAGE/SLACK LOOP

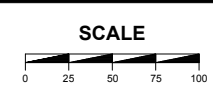

DATE: 3/19/2024
SCALE: 1" = 100' (APPROX.)
CITY: HURRICANE, AK

DRAFTED BY: WILLIAMS
COUNTY/PARISH: MSB

HURRICANE
FIBER BUILD
SHEETC14OF C17

PROPOSED CONSTRUCTION PLANS

PROJECT NAME:
HURRICANE
FIBER BUILD

PROJECT LOCATION:
HURRICANE, AK
MATANUSKA
BOROUGH

GENERAL NOTES:

1. All existing utility locations shown are approximate and may not be accurate. It is the contractor's responsibility to locate (horizontally and vertically) within the area of construction) and repair any utilities damaged during this construction described herein.
2. Call 811 locate service at least 10 days prior to construction.
3. Contractor is responsible for "potholing", locating and probing all utilities in the work area prior to construction to prevent damage.
4. All underground facility road crossings must be at least 60" minimum depth below grade.
5. All underground facility rail crossings must be at least 60" minimum depth below the rail.

*NOTE: FUTURE WORK,
NOT FOR CONSTRUCTION
FOR REFERENCE ONLY

(3-1.25" TR-2245')

SECTION 16, T35N, R2W
SECTION 13, T22S, R11W



WILLIAMS
COMMUNICATIONS INC.
SINCE 1979
4701 BUSINESS PARK BLVD, J-12
ANCHORAGE, AK, 99503
(907) 868-8848
www.wilcomm.com

--	--	--
C16	C15	C14
--	--	--

CALL BEFORE YOU DIG! 1-907-278-3121
ALL POLE ATTACHMENTS ARE TO EXISTING POLES
EXCEPT WHERE OTHERWISE INDICATED

- ⊗ POWER POLE
- ⊗ JOINT USE POLE
- ⊗ POWER POLE (WITH TRANSFORMER)
- ⊗ JOINT USE POLE (WITH TRANSFORMER)
- TELCO POLE
- ➔ EXISTING ANCHOR
- ⊞ NEW HANDHOLE
- ➔ PROPOSED ANCHOR

- PROPOSED FIBER OPTIC CABLE (AERIAL)
- - - PROPOSED FIBER OPTIC CABLE (UNDERGROUND)
- ⊞ FIBER OPTIC SPLICE CASE
- ∞ FIBER STORAGE/SLACK LOOP

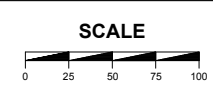

DATE: 3/19/2024
SCALE: 1" = 100' (APPROX.)
CITY: HURRICANE, AK

DRAFTED BY: WILLIAMS
COUNTY/PARISH: MSB

HURRICANE
FIBER BUILD
SHEETC15OF C17



PROPOSED CONSTRUCTION PLANS

PROJECT NAME:
HURRICANE FIBER BUILD

PROJECT LOCATION:
HURRICANE, AK
MATANUSKA BOROUGH

GENERAL NOTES:

1. All existing utility locations shown are approximate and may not be accurate. It is the contractor's responsibility to locate (horizontally and vertically) within the area of construction) and repair any utilities damaged during this construction described herein.
2. Call 811 locate service at least 10 days prior to construction.
3. Contractor is responsible for "potholing", locating and probing all utilities in the work area prior to construction to prevent damage.
4. All underground facility road crossings must be at least 60" minimum depth below grade.
5. All underground facility rail crossings must be at least 60" minimum depth below the rail.



WILLIAMS COMMUNICATIONS INC.
SINCE 1979
4701 BUSINESS PARK BLVD, J-12
ANCHORAGE, AK, 99503
(907) 868-8848
www.wilcomm.com

--	--	--
C17	C16	C15
--	--	--

CALL BEFORE YOU DIG! 1-907-278-3121
ALL POLE ATTACHMENTS ARE TO EXISTING POLES EXCEPT WHERE OTHERWISE INDICATED

- ⊗ POWER POLE
- ⊗ JOINT USE POLE
- ⊗ POWER POLE (WITH TRANSFORMER)
- ⊗ JOINT USE POLE (WITH TRANSFORMER)
- TELCO POLE
- ➔ EXISTING ANCHOR
- ⊞ NEW HANDHOLE
- ➔ PROPOSED ANCHOR

- PROPOSED FIBER OPTIC CABLE (AERIAL)
- - - PROPOSED FIBER OPTIC CABLE (UNDERGROUND)
- ⊞ FIBER OPTIC SPLICE CASE
- ∞ FIBER STORAGE/SLACK LOOP

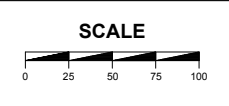

DATE: 3/19/2024
SCALE: 1" = 100' (APPROX.)
CITY: HURRICANE, AK

DRAFTED BY: WILLIAMS
COUNTY/PARISH: MSB

HURRICANE FIBER BUILD
SHEET C16 OF C17



*NOTE: FUTURE WORK,
NOT FOR CONSTRUCTION
FOR REFERENCE ONLY

**PROPOSED
CONSTRUCTION
PLANS**

PROJECT NAME:
HURRICANE
FIBER BUILD

PROJECT LOCATION:
HURRICANE, AK
MATANUSKA
BOROUGH

GENERAL NOTES:

1. All existing utility locations shown are approximate and may not be accurate. It is the contractor's responsibility to locate (horizontally and vertically) within the area of construction) and repair any utilities damaged during this construction described herein.
2. Call 811 locate service at least 10 days prior to construction.
3. Contractor is responsible for "potholing", locating and probing all utilities in the work area prior to construction to prevent damage.
4. All underground facility road crossings must be at least 60" minimum depth below grade.
5. All underground facility rail crossings must be at least 60" minimum depth below the rail.



WILLIAMS
COMMUNICATIONS INC.
SINCE 1978

4701 BUSINESS PARK BLVD, J-12
ANCHORAGE, AK, 99503
(907) 868-8848
www.wilcomm.com

--	--	--
--	C17	C16
--	--	--

CALL BEFORE YOU DIG! 1-907-278-3121
ALL POLE ATTACHMENTS ARE TO EXISTING POLES
EXCEPT WHERE OTHERWISE INDICATED

- ⊗ POWER POLE
- ⊗ JOINT USE POLE
- ⊗ POWER POLE (WITH TRANSFORMER)
- ⊗ JOINT USE POLE (WITH TRANSFORMER)
- TELCO POLE
- ➔ EXISTING ANCHOR
- ⊞ NEW HANDHOLE
- ➔ PROPOSED ANCHOR

- PROPOSED FIBER OPTIC CABLE (AERIAL)
- - - PROPOSED FIBER OPTIC CABLE (UNDERGROUND)
- ⊞ FIBER OPTIC SPLICE CASE
- ∞ FIBER STORAGE/SLACK LOOP

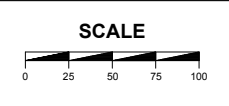

DATE: 3/19/2024
SCALE: 1" = 100' (APPROX.)
CITY: HURRICANE, AK

DRAFTED BY: WILLIAMS
COUNTY/PARISH: MSB

HURRICANE
FIBER BUILD
SHEET C17 OF C17

BORE PROFILE TYPICAL ARRC CROSSING

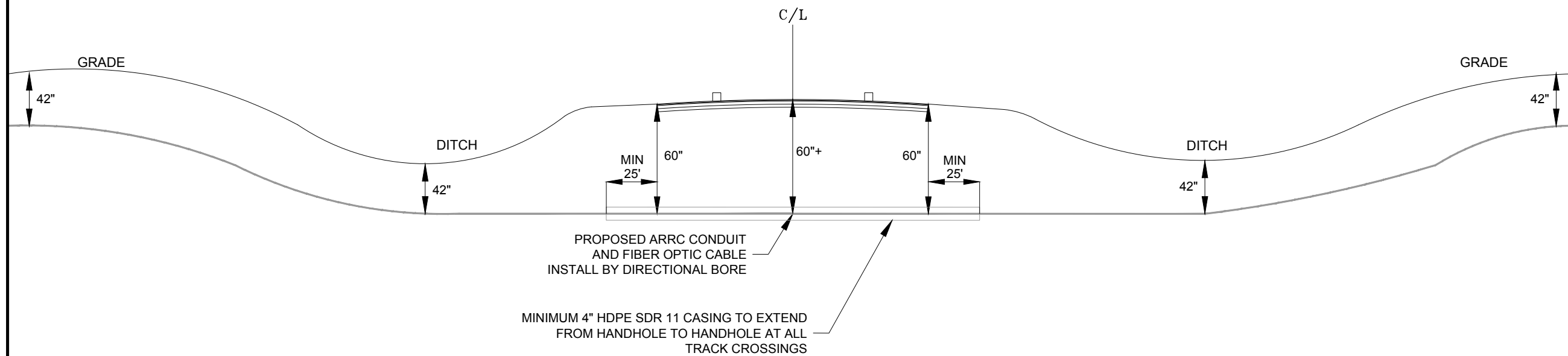

* REFER TO DESIGN FOR NUMBER OF FIBER OPTIC CABLES AND CONDUITS AT EACH CROSSING

TYPICAL CONSTRUCTION DETAILS

PROJECT NAME:
HURRICANE
FIBER BUILD

PROJECT LOCATION:
HURRICANE, AK
ANCHORAGE
BOROUGH

GENERAL NOTES:

1. All existing utility locations shown are approximate and may not be accurate. It is the contractor's responsibility to locate (horizontally and vertically) within the area of construction) and repair any utilities damaged during this construction described herein.
2. Call 811 locate service at least 10 days prior to construction.
3. Contractor is responsible for "potholing", locating and probing all utilities in the work area prior to construction to prevent damage.
4. All underground facility road crossings must be at least 60" minimum depth below grade.
5. All underground facility rail crossings must be at least 60" minimum depth below the rail.



WILLIAMS
COMMUNICATIONS INC.
SINCE 1978
4701 BUSINESS PARK BLVD, J-12
ANCHORAGE, AK, 99503
(907) 868-8848
www.wilcomin.com

--	--	--
--	T1	--
--	--	--

CALL BEFORE YOU DIG! 1-907-278-3121
ALL POLE ATTACHMENTS ARE TO EXISTING POLES
EXCEPT WHERE OTHERWISE INDICATED

	POWER POLE		JOINT USE POLE		PROPOSED FIBER OPTIC CABLE (AERIAL)
	POWER POLE (WITH TRANSFORMER)		JOINT USE POLE (WITH TRANSFORMER)		PROPOSED FIBER OPTIC CABLE (UNDERGROUND)
	TELCO POLE		EXISTING ANCHOR		FIBER OPTIC SPLICE CASE
	NEW HANDHOLE		PROPOSED ANCHOR		FIBER STORAGE/SLACK LOOP

DATE: 3/19/2024	DRAFTED BY: WILLIAMS
SCALE: N.T.S.	COUNTY/PARISH: ANCHORAGE
CITY: HURRICANE, AK	

HURRICANE
FIBER BUILD
SHEET T1 OF T3

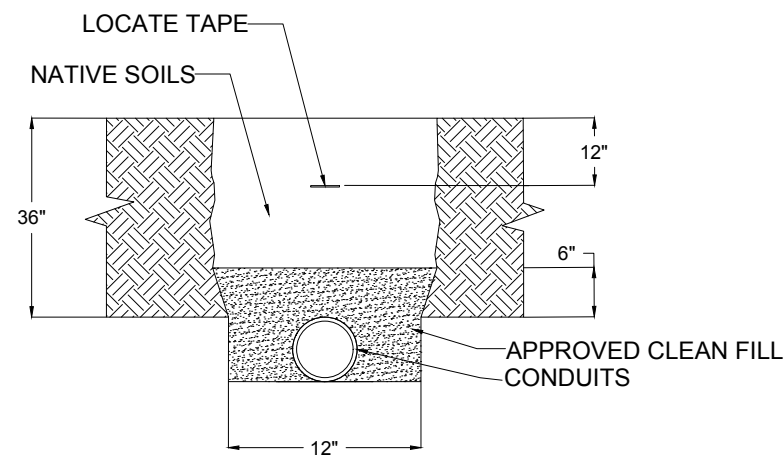

STANDARD TRENCH DETAIL - 36" DEPTH

NOTE: CONTRACTOR TO POTHOLE ALL UTILITIES TO CONFIRM DEPTH BEFORE CROSSING.
 CONTRACTOR TO POTHOLE TO A MINIMUM OF 12" BELOW PROPOSED BORE DEPTH TO CONFIRM SEPARATION FROM UTILITIES BELOW

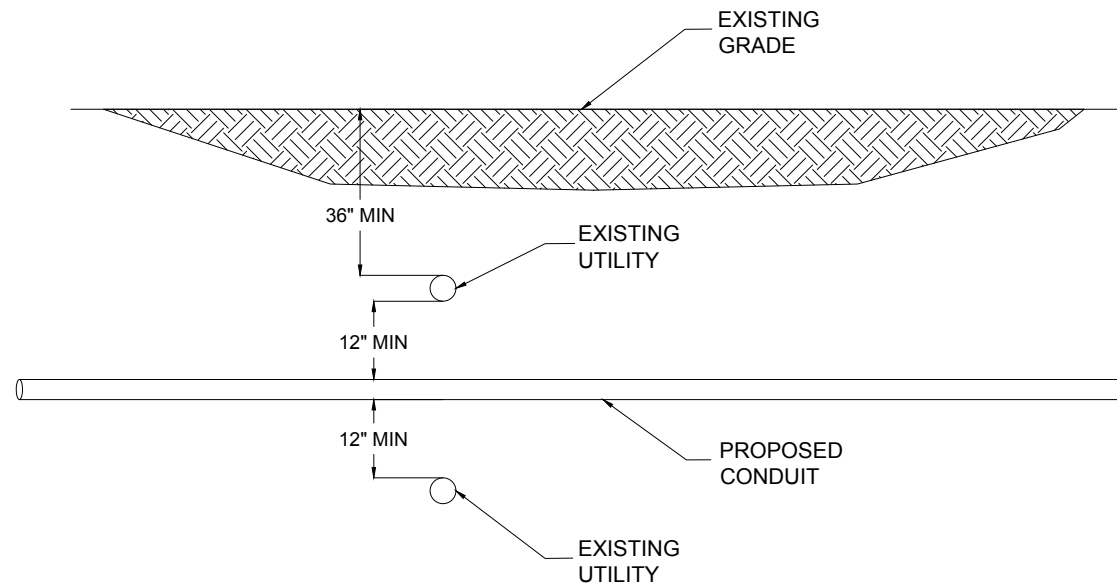

SEPARATION FROM OTHER UTILITIES

TYPICAL CONSTRUCTION DETAILS

PROJECT NAME:
 HURRICANE FIBER BUILD
PROJECT LOCATION:
 HURRICANE, AK
 ANCHORAGE BOROUGH

GENERAL NOTES:

1. All existing utility locations shown are approximate and may not be accurate. It is the contractor's responsibility to locate (horizontally and vertically) within the area of construction) and repair any utilities damaged during this construction described herein.
2. Call 811 locate service at least 10 days prior to construction.
3. Contractor is responsible for "potholing", locating and probing all utilities in the work area prior to construction to prevent damage.
4. All underground facility road crossings must be at least 60" minimum depth below grade.
5. All underground facility rail crossings must be at least 60" minimum depth below the rail.

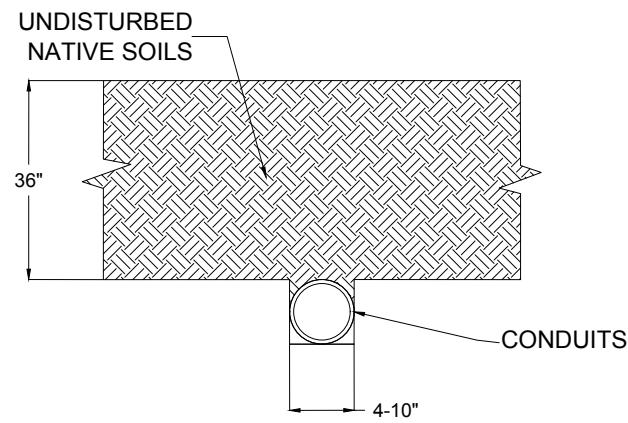

STANDARD DIRECTIONAL BORE DETAIL - (NON TRACK CROSSINGS ONLY)

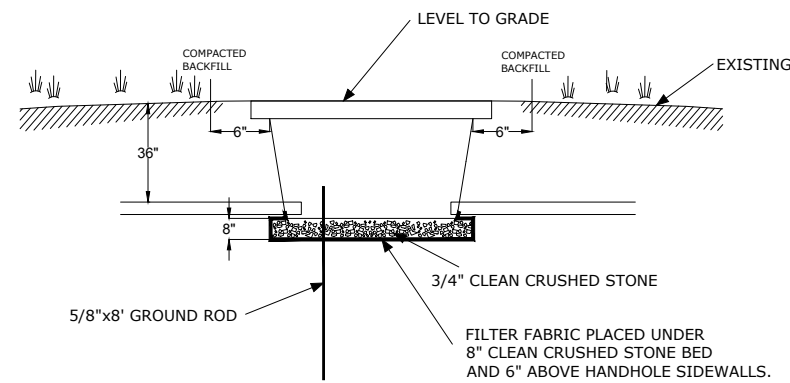

STANDARD 30x48x36 HANDHOLE DETAIL

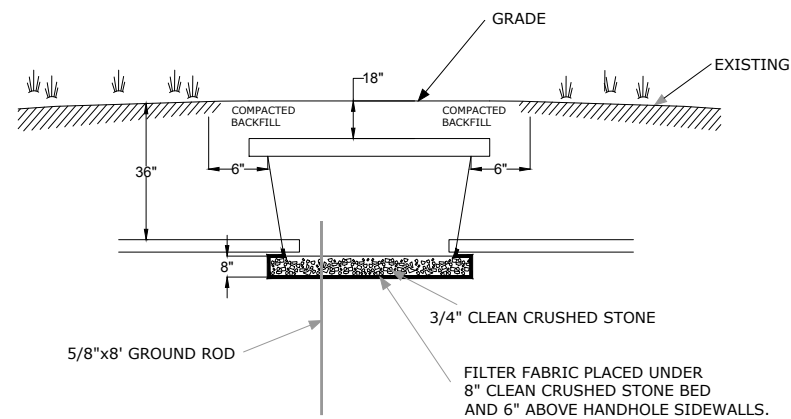

BURIED 30x48x24 HANDHOLE DETAIL



WILLIAMS COMMUNICATIONS INC.
 SINCE 1978
 4701 BUSINESS PARK BLVD, J-12
 ANCHORAGE, AK, 99503
 (907) 868-8848
 www.wilcomin.com

--	--	--
--	T2	--
--	--	--

CALL BEFORE YOU DIG! 1-907-278-3121
 ALL POLE ATTACHMENTS ARE TO EXISTING POLES EXCEPT WHERE OTHERWISE INDICATED

<p>⊗ POWER POLE ⊗ POWER POLE (WITH TRANSFORMER) ○ TELCO POLE □ NEW HANDHOLE</p>	<p>⊗ JOINT USE POLE ⊗ JOINT USE POLE (WITH TRANSFORMER) → EXISTING ANCHOR < PROPOSED ANCHOR</p>	<p>— PROPOSED FIBER OPTIC CABLE (AERIAL) - - - PROPOSED FIBER OPTIC CABLE (UNDERGROUND) ⊕ FIBER OPTIC SPLICE CASE ∞ FIBER STORAGE/SLACK LOOP</p>
------------------------------------------------------------------------------------------------------------------------	-------------------------------------------------------------------------------------------------------------------------------------------	-----------------------------------------------------------------------------------------------------------------------------------------------------------------------------------------

DATE: 3/19/2024
 SCALE: N.T.S.
 CITY: HURRICANE, AK
 DRAFTED BY: WILLIAMS
 COUNTY/PARISH: ANCHORAGE

HURRICANE FIBER BUILD
SHEET T2 OF T3

TYPICAL HANDHOLE/VAULT INSTALLATION WITH SMART POST (SPLICE LOCATIONS)

TYPICAL SMART POST INSTALLATION

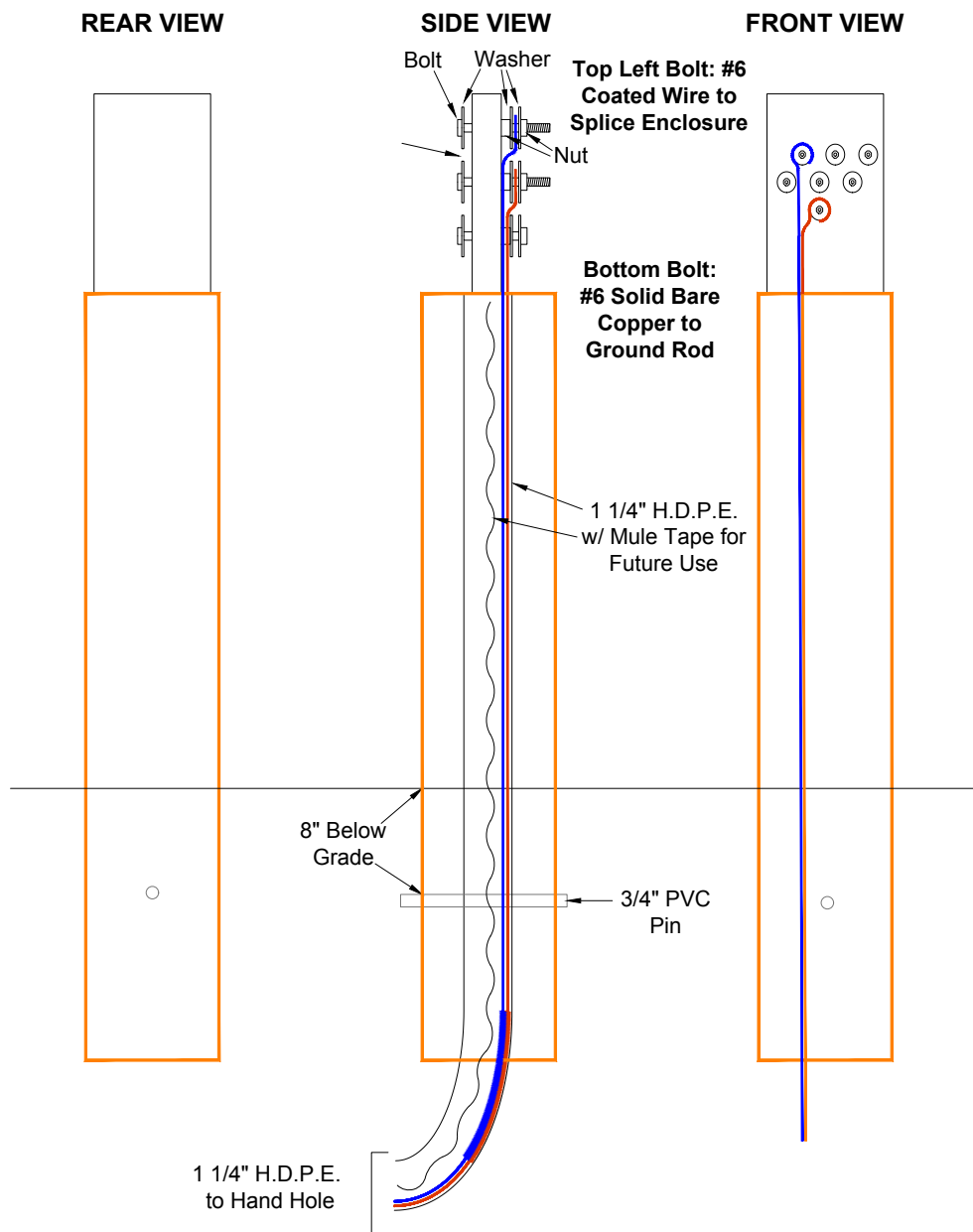

TYPICAL HANDHOLE / VAULT INSTALLATION
(30"x48")

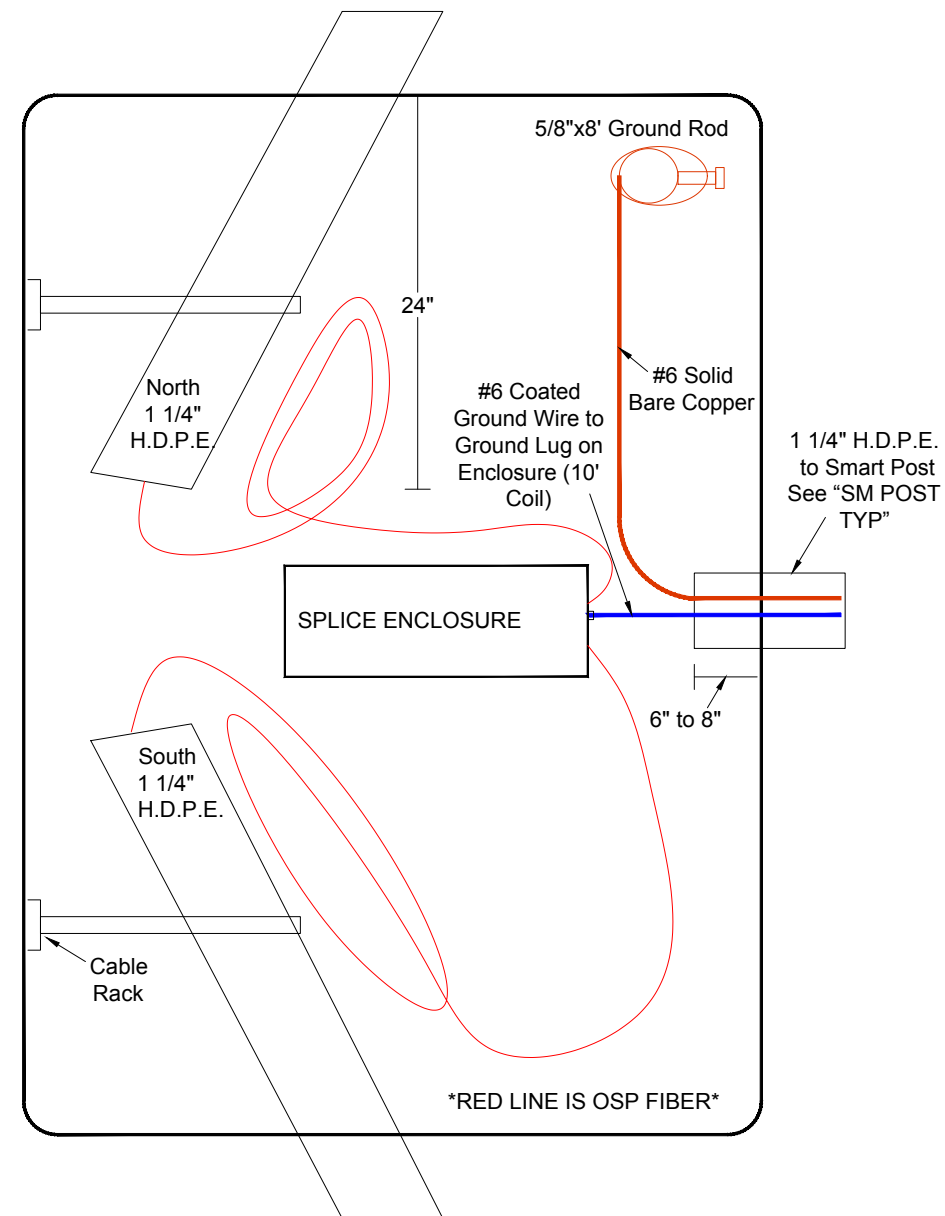

TYPICAL CONSTRUCTION DETAILS

PROJECT NAME:
HURRICANE
FIBER BUILD

PROJECT LOCATION:
HURRICANE, AK
ANCHORAGE
BOROUGH

GENERAL NOTES:

- All existing utility locations shown are approximate and may not be accurate. It is the contractor's responsibility to locate (horizontally and vertically) within the area of construction) and repair any utilities damaged during this construction described herein.
- Call 811 locate service at least 10 days prior to construction.
- Contractor is responsible for "potholing", locating and probing all utilities in the work area prior to construction to prevent damage.
- All underground facility road crossings must be at least 60" minimum depth below grade.
- All underground facility rail crossings must be at least 60" minimum depth below the rail.



WILLIAMS
COMMUNICATIONS INC.
SINCE 1978

4701 BUSINESS PARK BLVD., J-12
ANCHORAGE, AK, 99503
(907) 868-8848
www.wilcomm.com

--	--	--
--	T2	--
--	--	--

CALL BEFORE YOU DIG! 1-907-278-3121
ALL POLE ATTACHMENTS ARE TO EXISTING POLES
EXCEPT WHERE OTHERWISE INDICATED

⊗ POWER POLE
⊗ JOINT USE POLE
○ TELCO POLE
NEW HANDHOLE

⊗ JOINT USE POLE (WITH TRANSFORMER)
➔ EXISTING ANCHOR
➔ PROPOSED ANCHOR

— PROPOSED FIBER OPTIC CABLE (AERIAL)
- - - PROPOSED FIBER OPTIC CABLE (UNDERGROUND)
— FIBER OPTIC SPLICE CASE
— FIBER STORAGE/SLACK LOOP

DATE: 3/19/2024

SCALE: N.T.S.

CITY: HURRICANE, AK

DRAFTED BY: WILLIAMS

COUNTY/PARISH: ANCHORAGE

HURRICANE
FIBER BUILD
SHEET T3 OF T3