

File: J:\JobsData\31103.01_ARCC_Depot_Drive_Development\00_CADD\01_Working_Set\01_Civil\31103.01_TCP_Figure.dwg PLOT DATE: 1/7/2020 10:26 AM

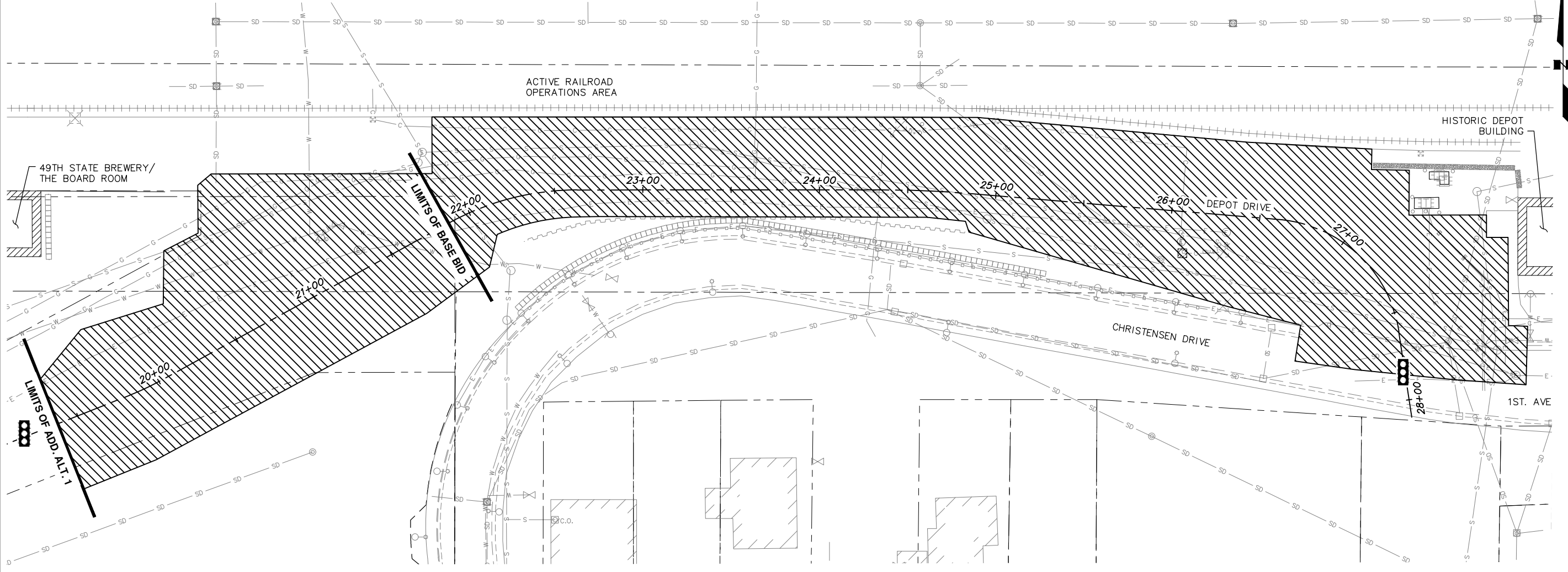

1
1

TRAFFIC CONTROL PLAN

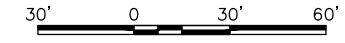

GRAPHIC



TRAFFIC CONTROL PLAN

- UTILIZE HALF-WIDTH CONSTRUCTION AND ONE LANE ROAD AS NEEDED WITH APPROPRIATE SIGNING, BARRICADES, TRAFFIC CONTROL DEVICES, CHANNELIZATION, AND ACTIVE WORK AREA BARRICADES IN ACCORDANCE WITH THE LATEST MUTCD & ALASKA TRAFFIC MANUAL
- UTILIZE TEMPORARY SIGNALIZATION FOR HALF-WIDTH/ONE LANE ROAD.
- PROVIDE CONTINUED ACCESS FOR VEHICLES TO THE BOARD ROOM AND 49TH STATE BREWERY.
- PROVIDE CONTINUED ACCESS FOR TOUR BUSES TO THE ACTIVE RAILROAD OPERATIONS AREA. COORDINATE WITH ARRC FOR ANTICIPATED TIMES AND DATES FOR TOUR BUSES.
- MAINTAIN 25.0' CLEAR SPACE BETWEEN RAILROAD TRACKS AND ACTIVE DETOUR ROUTE.

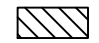
LEGEND

-  WORK AREA
-  TEMPORARY SIGNAL

PROJECT NO.	31103.01
CITY GRID	1230
WATER GRID	1230
SEWER GRID	1230

**ARRC DEPOT DRIVE IMPROVEMENTS
 TRAFFIC CONTROL PLAN**

PROJECT NO: 31103.01
 STATUS: 65% DESIGN
 DATE: JAN 2020

SCALE	HOR.	GRAPHIC	REV	DATE	DESCRIPTION	BY
VER.	N/A					
DESIGNED BY						
DRAWN BY						
CHECKED BY						
APPROVED BY						

SHEET NO.