



Alaska Railroad Corporation  
327 W. Ship Creek Ave.  
Anchorage, AK 99501

April 4, 2022,

**Addendum 1**  
**ITB#22-21-209686**  
**Fairbanks Yard: Drainage Rehabilitation**

Addendum number 1 has been issued for questions/ clarification.

**The Closing Date for this ITB has not changed.**  
**Bids will be received until Thursday April 21, 2022 @ 3:00 PM Alaska time.**

---

**Questions:**

1. The 48" dia. catch basins have 6" thick walls. There are no forms that can make this size. Will this be changed?  
**Yes, the maximum wall thickness of the forms will be adjusted to 5".**
2. Could you provide clarification on the reinforcing required for the bases? 7 ea. 5' long bars won't fit in a circular base. Is that supposed to be something like 7 ea. bars equally spaced with 2" clear minimum?  
**Correct, the noted length of 5' for the #6 bars has been removed from the base. Please replace sheet 8 with the one attached herein.**

All other terms and conditions remain unchanged.  
If there are any questions regarding this addendum please let me know.

Thank you,

***Greg C Goemer***  
Sr. Contract Administrator  
Alaska Railroad Corporation

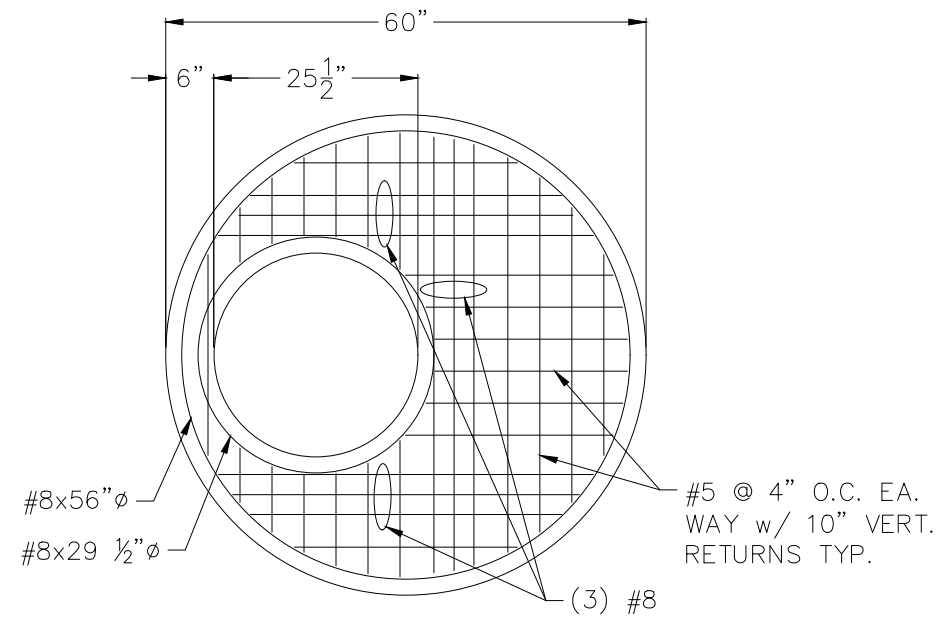

PROPOSED FLAT MANHOLE LID  
NO SCALE

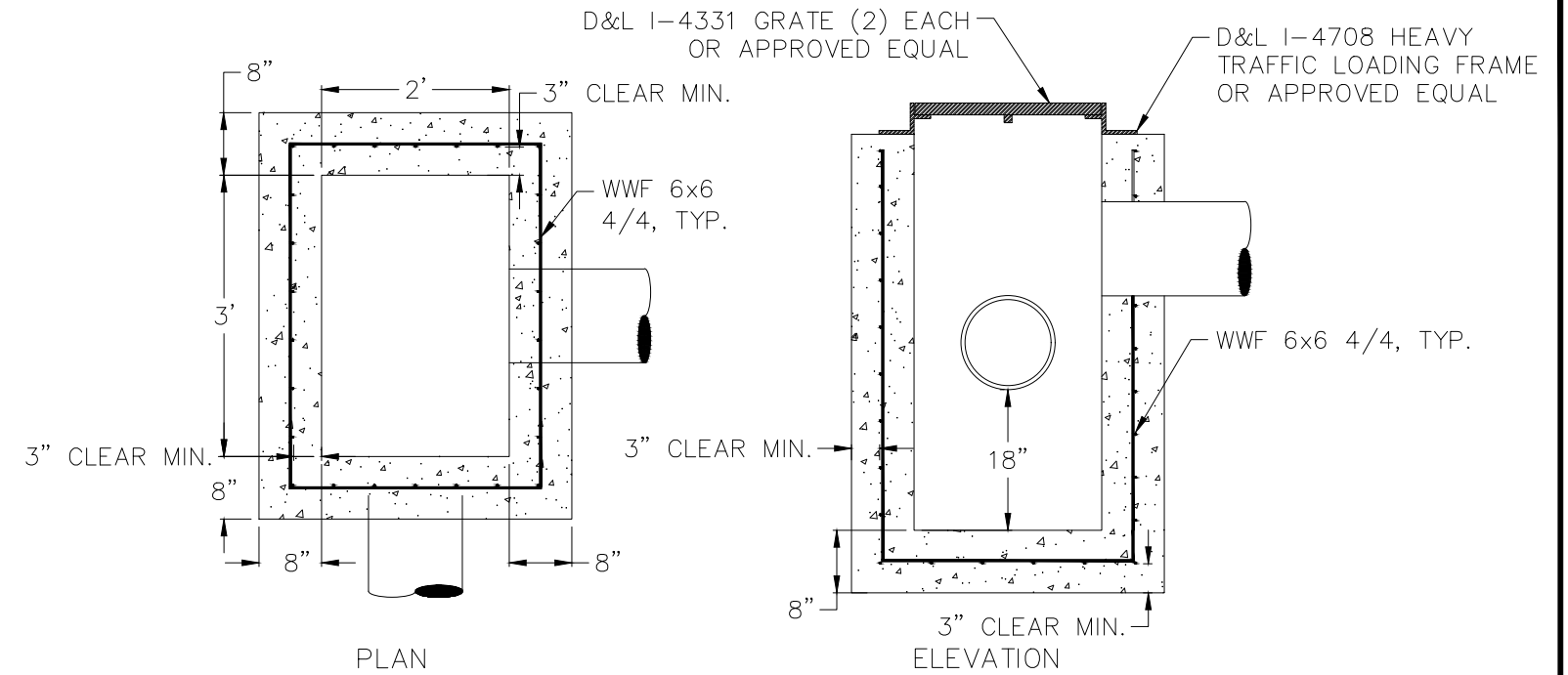

PROPOSED PRECAST CATCH BASIN INLET,  
TYPE A  
NO SCALE

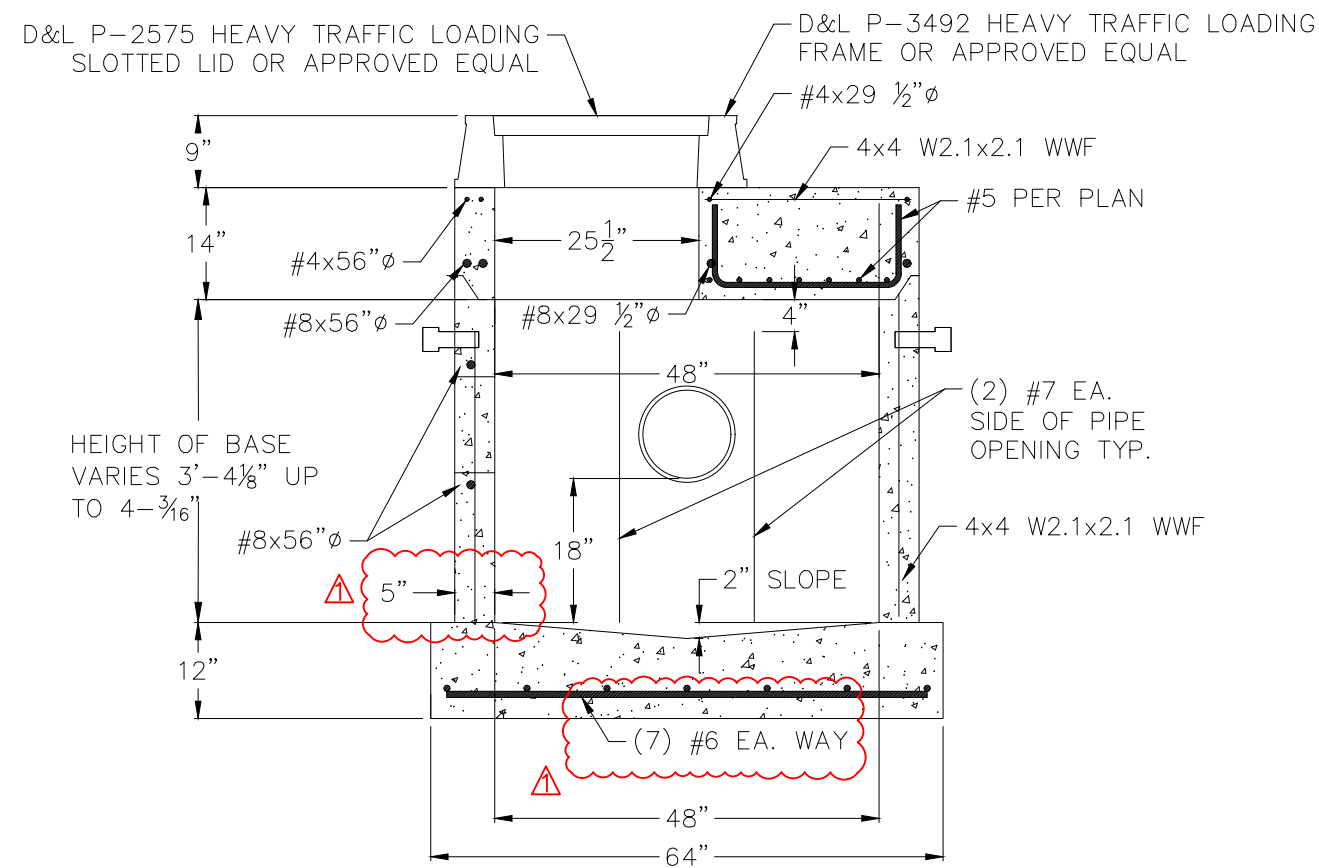

PROPOSED PRECAST CATCH BASIN  
MANHOLE  
NO SCALE

NOTES:

1. PROPOSED CATCH BASIN MANHOLES TO MEET REQUIRED LOAD RATING OF DESIGN VEHICLE TOYOTA LOAD HANDLER - LH3.
2. PROPOSED CATCH BASIN INLET TO MEET HS-20 LOAD RATING.

REV.	DATE	BY	REVISION
1	3/31/22	BLG	ADDENDUM #1

<b>ALASKA RAILROAD CORPORATION</b> ENGINEERING SERVICES P.O. BOX 107500, ANCHORAGE, ALASKA 99510-7500		
PROJECT : <b>FAIRBANKS RAILYARD DRAINAGE REHABILITATION</b>		
TITLE: <b>PROPOSED STORM DRAIN DETAILS</b>		
DESIGNED BY: ARRC	SCALE : AS NOTED	AFE NO.: 10918
DRAWN BY: BLG	DATE : 2/1/2022	ACAD FILE:
CHECKED BY: CDR		DWG NO. <b>8</b> OF <b>9</b>
APPROVED BY: ARRC		