

Madison, Wisconsin

CITY OF MADISON

CITY ENGINEERING DIVISION

DEPARTMENT OF PUBLIC WORKS

PLAN OF PROPOSED IMPROVEMENT

PUBLIC IMPROVEMENT PROJECT APPROVED

SEPTEMBER 20, 2016

BY THE COMMON COUNCIL OF MADISON, WISCONSIN

PUBLIC IMPROVEMENT DESIGN APPROVED BY:

[Signature] 12/22/16
City Engineer Date

INDEX OF SHEETS

SHEET NO.	TITLE
1	
D1	DETAILS
D2	TYPICAL SECTION
P1	STREET PLAN
U1	UTILITY PLAN
RG1	RAIN GARDEN PLAN
L1	LANDSCAPING PLAN

418 DIVISION STREET

CITY PROJECT NO. 11456
CITY CONTRACT NO. 7789
MUNIS NO. 11456

STREET DESIGNED BY:



UTILITIES DESIGNED BY:

SEE INDIVIDUAL SHEETS

RAINGARDEN DESIGNED BY:

SEE INDIVIDUAL SHEETS

CONVENTIONAL SIGNS

FIELD VERIFY ALL UTILITY LOCATIONS

GAS	
STORM SEWER	
SANITARY SEWER	
WATER	
OVERHEAD ELECTRIC	
POWER POLE	
ADA COMPLIANT RAMP W/ DETECTABLE WARNING FIELD	
COMBUSTIBLE FLUIDS	

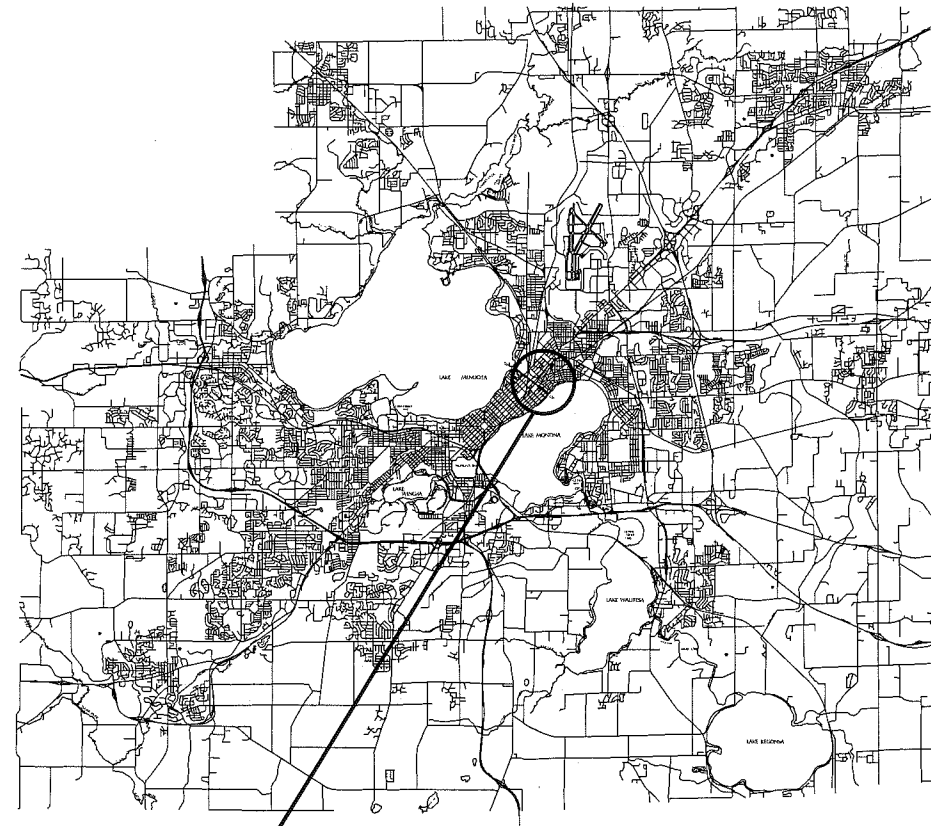
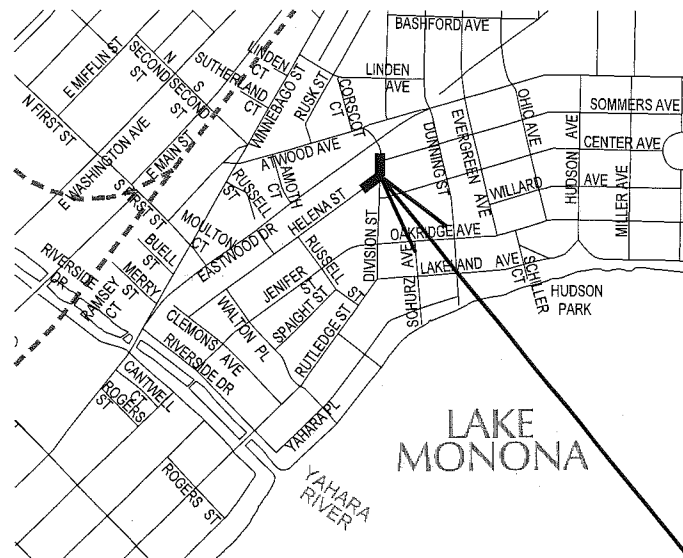
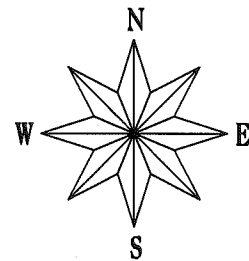

PROJECT LOCATION

PLOT SCALE:

PLOT NAME:

REV. DATE:

ORIGINATOR: CITY OF MADISON, STREETS DIVISION

DETAIL

STANDARD NOTES
AND COMMENTS

CITY OF MADISON

CONTRACTOR/DEVELOPER SHALL SUBMIT A TRAFFIC CONTROL PLAN TO CITY TRAFFIC ENGINEERING AT LEAST 10 WORKING DAYS PRIOR TO THE START OF WORK. WORK WITHIN THE RIGHT-OF-WAY SHALL NOT BEGIN UNTIL THE TRAFFIC CONTROL PLAN IS APPROVED.

ANY PAVEMENT MARKINGS THAT ARE REMOVED OR DAMAGED SHALL BE REPLACED BY THE DEVELOPER/CONTRACTOR AS DIRECTED BY CITY TRAFFIC ENGINEERING.

THE LOCATION AND INFORMATION FOR PROPOSED NEW TREES, IN THE PUBLIC RIGHT OF WAY OR ON PUBLIC LANDS ARE APPROXIMATE AND ARE SHOWN FOR REFERENCE ONLY.

THE CONTRACTOR SHALL CONTACT BRIAN MEILLER OF CITY FORESTRY AT LEAST ONE WEEK PRIOR TO PLANTING TO SCHEDULE MARKING THE PLANTING SITE, INSPECTING THE NURSERY STOCK, AND REVIEWING PLANTING SPECIFICATIONS WITH THE LANDSCAPER. CONTACT BRIAN AT (608) 444-2673 OR (608) 266-4890.

NO TREES IN THE RIGHT OF WAY OR ON PUBLIC LANDS SHALL BE TRIMMED, PRUNED, REMOVED OR ADVERSELY AFFECTED IN ANY WAY UNTIL THE DEVELOPER HAS RECEIVED WRITTEN PERMISSION FROM THE CITY ENGINEER OR CITY FORESTER. SAID WRITTEN PERMISSION SHALL INCLUDE LANGUAGE INDICATING THAT SECTION 10.101 OF THE MADISON GENERAL ORDINANCES AND ADMINISTRATIVE PROCEDURE MEMORANDUM NO. 6-2, REFERING TO NOTIFICATION OF PROPERTY OCCUPANTS AND/OR OWNERS, HAS BEEN COMPLIED WITH.

ALL PAVEMENT WITHIN THE DIVISION STREET AND HELENA STREET RIGHT OF WAY SHALL BE TYPE C PAVEMENT.

ALL GUTTERS SHALL DRAIN WITH A MINIMUM GRADES OF 0.5% TOWARD STORM SEWER INLETS.

THE CROSS SLOPE OF SIDEWALKS AND BARRIER FREE SIDEWALK CURB RAMPS SHALL BE 1.5%. THE LONGITUDINAL GRADE OF BARRIER FREE SIDEWALK CURB RAMPS SHALL NOT EXCEED 8.33%. ALL SIDEWALK RAMPS SHALL BE CONSTRUCTED ACCORDING TO S.D.D. 3.03. AT ALL OTHER LOCATIONS THE LONGITUDINAL GRADE OF SIDEWALKS SHALL NOT EXCEED 5.0 % OR THE ADJACENT STREET GRADE WHICHEVER IS GREATER NOR BE LESS THAN 0.5% AND SHALL DRAIN TOWARD STORM SEWER INLETS. SIDE SLOPES WITHIN TEN FEET OF A PUBLIC SIDEWALK SHALL NOT EXCEED 4.00:1. ALL SIDEWALK AND SIDEWALK RAMP ELEVATIONS AND GRADES SHALL BE FIELD VERIFIED AND SET TO COMPLY WITH THE CITY OF MADISON STANDARD SPECIFICATIONS AND THE A.D.A. GUIDELINES.

OBTAIN A PRINT OUT OF THE ALIGNMENT FROM THE CITY ENGINEER PRIOR TO STAKING THIS PROJECT.

CURB STATION AND OFFSETS SHALL BE TO THE FACE OF CURB UNLESS OTHERWISE INDICATED. CURB ELEVATIONS SHALL BE TO THE TOP OF CURB (OR EXTENDED TOP OF CURB FOR DRIVEWAYS OR RAMPS) UNLESS OTHERWISE INDICATED.

POWER POLES AND OTHER OBSTRUCTIONS SHALL BE MOVED TO PROVIDE 2 FEET MINIMUM OF CLEAR DISTANCE FROM ANY FACE OF CURB OR EDGE OF SIDEWALK.

ANY INFORMATION SHOWN ON THIS PLAN, WHICH IS NOT PART OF THIS PROJECT, IS PRELIMINARY AND NOT FOR CONSTRUCTION.

THERE MAY BE EXISTING UTILITIES OR OTHER FEATURES WHICH ARE EITHER NOT SHOWN OR SHOWN INCORRECTLY ON THIS PLAN. IT IS THE RESPONSIBILITY OF THE DEVELOPER TO LOCATE AND IDENTIFY ALL UTILITIES AND TOPOGRAPHY WHICH MAY AFFECT THE CONSTRUCTION OF THESE IMPROVEMENTS.

ALL PERMANENT SIGNING AND POSTING WILL BE DETERMINED AND PROVIDED BY THE TRAFFIC ENGINEERING DIVISION, FOLLOWING CONSTRUCTION OF THESE IMPROVEMENTS.

THE DEVELOPER SHALL PROVIDE, INSTALL AND MAINTAIN ALL STREET END BARRICADES, SIGNING AND TRAFFIC CONTROL, AS REQUIRED BY THE CITY TRAFFIC ENGINEER.

PAVEMENT SAWCUTS SHALL BE AS DIRECTED BY THE CITY CONSTRUCTION ENGINEER. SAWCUTS SHOWN ON THE PLAN ARE APPROXIMATE.

DAMAGE TO ANY EXISTING CURB, PAVEMENT, SIDEWALK, ETC. THAT IS TO REMAIN SHALL BE REPAIRED BY THE DEVELOPER/CONTRACTOR AS DIRECTED BY THE ENGINEER.

PLOT SCALE: _____

PLOT NAME: _____

REV. DATE: _____

ORIGINATOR: CITY OF MADISON, STREETS DIVISION

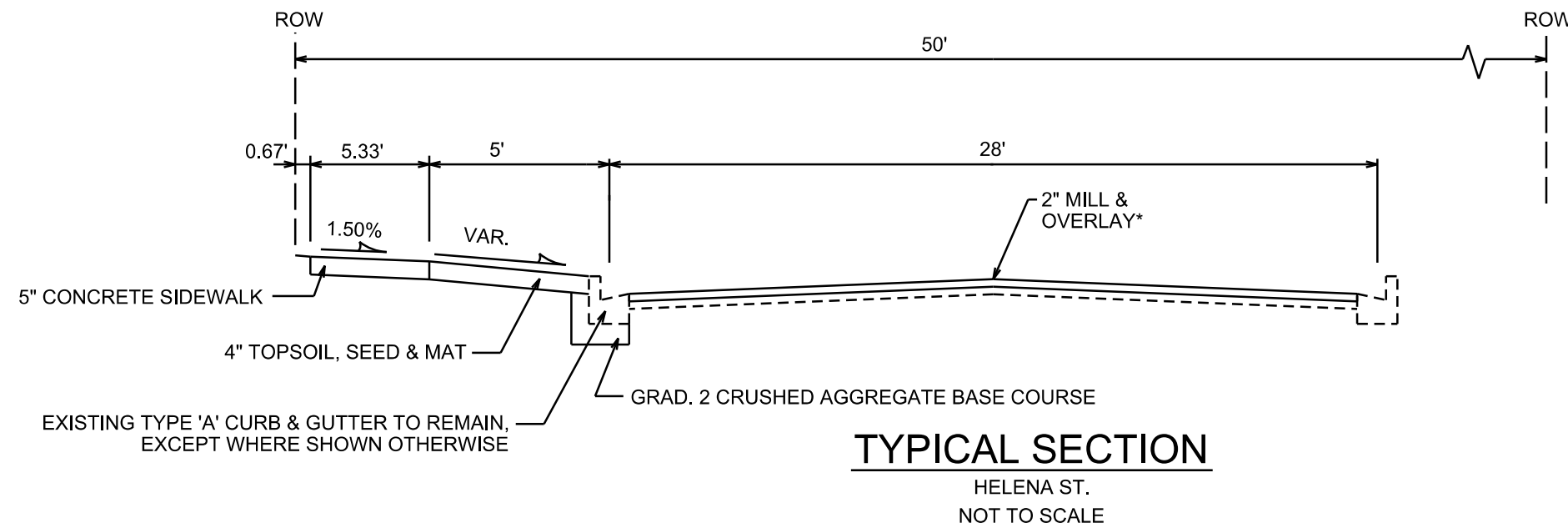
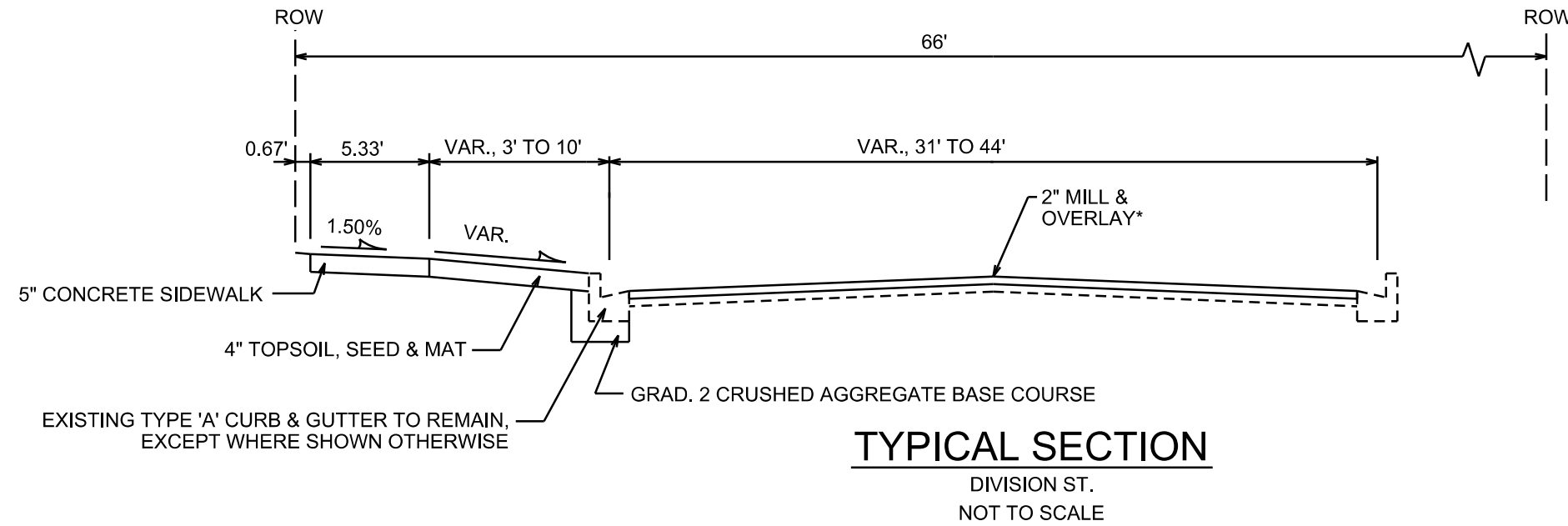

CITY OF MADISON MINIMUM PAVEMENT DESIGN

TYPE	CRUSHED AGG. BASE COURSE		ASPHALTIC CONCRETE PAVEMENT			
	LOWER LAYER GRADATION 1	UPPER LAYER GRADATION 2	LOWER LAYER TYPE	LOWER LAYER THICKNESS	UPPER LAYER TYPE	UPPER LAYER THICKNESS
A	6"	4"	E-0.3	1.75"	E-0.3	1.75"
B	6"	4"	E-1	2.25"	E-1	2"
C	6"	4"	E-3	3.25"	E-3	2"

NOTES:

* MILL & OVERLAY LIMITS ARE APPROXIMATE. PATCH PAVEMENT PER CITY'S PATCHING CRITERIA. FINAL MILL & OVERLAY LIMITS TO BE DETERMINED BY THE CONSTRUCTION ENGINEER.

** DIVISION STREET AND HELENA STREET SHALL BE CONSTRUCTED AS TYPE 'C' PAVEMENT PER CITY OF MADISON MINIMUM PAVEMENT DESIGN.

PLOT SCALE: _____

PLOT NAME: _____

REV. DATE: _____

ORIGINATOR: CITY OF MADISON, STREETS DIVISION

STREET PLAN

DIVISION ST., HELENA ST. CITY OF MADISON

0710-071-1721-3
CITY OF MADISON ENGINEER
WALKWAYS & BIKEPATHS 536
320 DIVISION ST

0710-064-2516-2
CITY OF MADISON ENGINEER
WALKWAYS & BIKEPATHS 536
321 DIVISION ST

0710-064-2504-7
MCFEETERS, ERNEST W
& MILENA MCFEETERS
2102 SOMMERS AVE

0710-064-2505-5
YU, ROBERT LIN-I
2106 SOMMERS AVE

0710-071-1722-1
418 DIVISION LLC
404 DIVISION ST

0710-071-1717-2
SCHOEP'S ICE CREAM CO INC
2066 HELENA ST

0710-064-3010-3
GEHIN TRUST, HAROLD E
& JUDITH M GEHIN
2101 SOMMERS AVE

0710-064-3009-6
VK, NAVEEN
2105 SOMMERS AVE

0710-064-3011-1
NAPOLEONE, PETER & DONNA
409 DIVISION ST

0710-064-3012-9
SYRING, THOMAS J
& DARCY E SYRING
413 DIVISION ST

0710-071-1501-9
SCHOEPS ICE CREAM CO INC
514 DIVISION ST

EASTWOOD DR.

SOMMERS AVE.

DIVISION ST.

HELENA ST.

EXISTING 6' WIDE UNDERGROUND
ELECTRIC EASEMENT DOC. NO. 2412334

TOP OF BANK

BOTTOM OF BANK

MATCH EX. SIDEWALK

854.76 BW/KEYSTONE

NOTE 2

NOTE 1

854.32 BW/MAIN ENTRANCE

PROTECT BASE
AND ALL CONDUIT

MATCH EX. SIDEWALK

853.66 BW/DWAY

853.50 BW/KEYSTONE LO POINT

853.94 BW/HI POINT

INSTALL CONDUIT
PER S.D.D. 6.09

7" CONC. DWAY &
SIDEWALK THRU DWAY

NOTE 2

NOTE 1

NOTES
1. POTENTIAL LIMIT OF MILL & OVERLAY IF PAVEMENT EDGE IS DISTURBED. FINAL LIMITS BY CONSTR. ENGINEER.
2. REMOVE DRIVEWAY APRON. REPLACE ALL TERRACES WITH 4" TOPSOIL, SEED & MAT.

SCALE 1"=30'

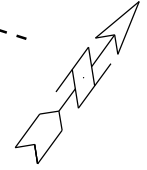

PLOT SCALE: _____

PLOT NAME: _____

REV. DATE: _____

ORIGINATOR: CITY OF MADISON, STREETS DIVISION

CITY OF MADISON BIKE PATH

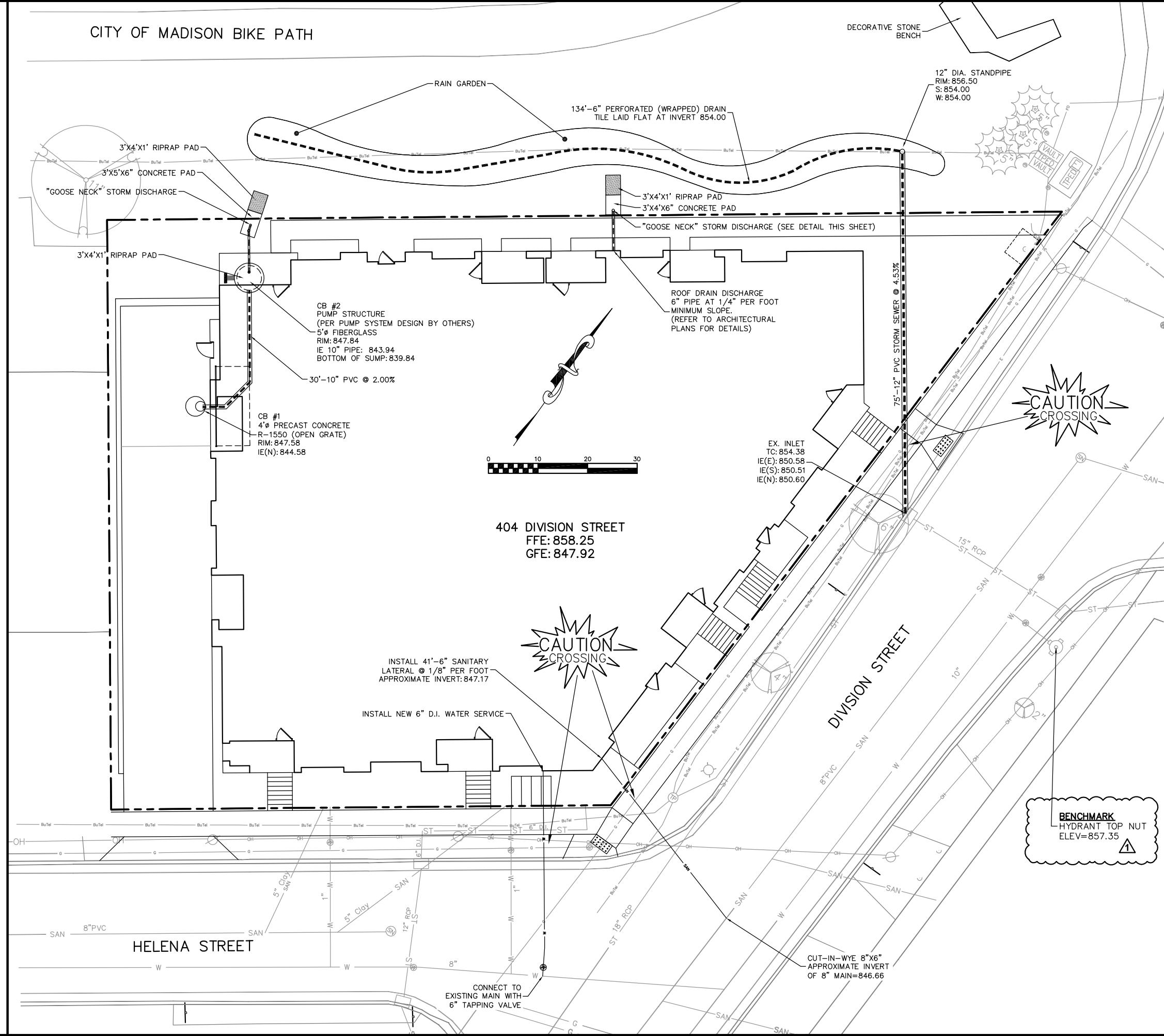

DIGGERS HOTLINE
 Dial 811 or (800) 242-8511
 www.DiggersHotline.com

Burse
 Surveying and Engineering, Inc.
 2801 International Lane, Suite 101
 Madison, WI 53704
 Phone: 608-250-9265
 Fax: 608-250-9266
 e-mail: Mburse@BSE-INC.net
 www.burseurveying.com

- NOTES:
- IT IS THE CONTRACTOR'S RESPONSIBILITY TO VERIFY THE LOCATION OF UNDERGROUND UTILITIES. UTILITIES WERE LOCATED BY OBSERVED EVIDENCE, MARKINGS PROVIDED BY DIGGER'S HOTLINE, AND RECORD DRAWINGS FROM THE CITY OF MADISON.
 - CONTRACTOR SHALL VERIFY THE SIZE, TYPE, SLOPE, AND INVERTS OF ALL EXISTING STORM AND SANITARY LATERALS CALLED OUT TO BE CONNECTED TO. CONTRACTOR SHALL SUBMIT THE INFORMATION ON THE PIPES TO THE CITY INSPECTOR AND PROJECT CIVIL ENGINEER.
 - ANY SIDEWALK, CURB, OR OTHER PUBLIC PROPERTY DAMAGED AS PART OF THE CONSTRUCTION OF THE UTILITIES AND BUILDING SHALL BE REPLACED IN-KIND PER THE CITY OF MADISON'S STANDARD SPECIFICATION.

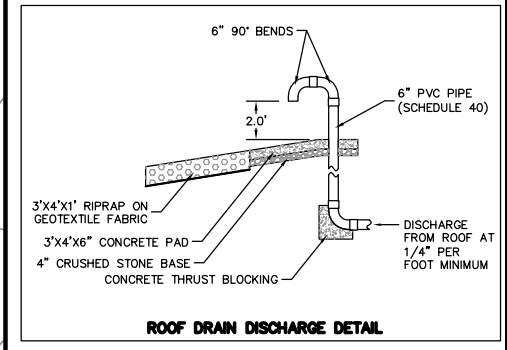

LEGEND

- PROPOSED STORM SEWER
- 6" PERFORATED UNDERDRAIN
- SAN- PROPOSED SANITARY LATERAL
- W- PROPOSED WATER SERVICE
- ST- EXISTING STORM SEWER
- SAN- EXISTING SANITARY SEWER
- W- EXISTING WATER MAIN
- G- EXISTING GAS
- BuTel- EXISTING BURIED PHONE

APPROVALS	DATE
PROJECTED BY	DATE
DESIGNED BY	DATE
CHECKED BY	DATE
APPROVED BY	DATE

404 DIVISION STREET
 404 DIVISION STREET
 MADISON, WI 53704
PRIME URBAN PROPERTIES
 2020 EASTWOOD DRIVE
 MADISON, WI 53704

PROJECT #: 11456
 PLOT DATE: 03/29/2017
 REVISION DATES:
 03/29/2017

ISSUE DATES:
 Construction 12/06/2016
 Benchmark 03/29/2017

WISCONSIN
 PETER D. FORTLAGE
 E-30873
 Madison WI
 PROFESSIONAL ENGINEER

UTILITY PLAN

Burse
 Surveying and Engineering, Inc.

This document contains confidential or proprietary information of Burse Surveying and Engineering, Inc. Neither the document nor the information herein is to be reproduced, distributed, used or disclosed, either in whole or in part, except as specifically authorized by Burse Surveying and Engineering, Inc.

DRAWING NUMBER
U-1

EASTWOOD DRIVE

CITY OF MADISON BIKE PATH

RAIN GARDEN

EXISTING DECORATIVE
STONE MONUMENT

404 DIVISION STREET
FFE: 858.75
GFE: 847.92

DIVISION STREET

Burse
Surveying and Engineering, Inc.
2801 International Lane, Suite 101
Madison, WI 53704
Phone: 608-220-9265
Fax: 608-220-9266
e-mail: Mburse@BSE-INC.net
www.burse-surveying.com

APPROVALS	MLB	PDF	MLB
PROJECTED BY	MLB	CHECKED BY	MLB
DRAWN BY	MLB	APPROVED BY	MLB

404 DIVISION STREET
404 DIVISION STREET
MADISON, WI 53704
PRIME URBAN PROPERTIES
2020 EASTWOOD DRIVE
MADISON, WI 53704

PROJECT #: 11456
PLOT DATE: 03/29/2017
REVISION DATES:
03/29/2017

ISSUE DATES:
Construction 12/06/2016
Benchmark 03/29/2017

RAIN GARDEN PLAN

Burse
Surveying and Engineering, Inc.

This document contains confidential or proprietary information of Burse Surveying and Engineering, Inc. Neither the document nor the information herein is to be reproduced, distributed, used or disclosed, either in whole or in part, except as specifically authorized by Burse Surveying and Engineering, Inc.

DRAWING NUMBER
RG-1

Printed: Mar 29, 2017 - 8:13pm Printed By: Peter

M:\BSE\1066\Engineering\BSE1066Eng.DWG

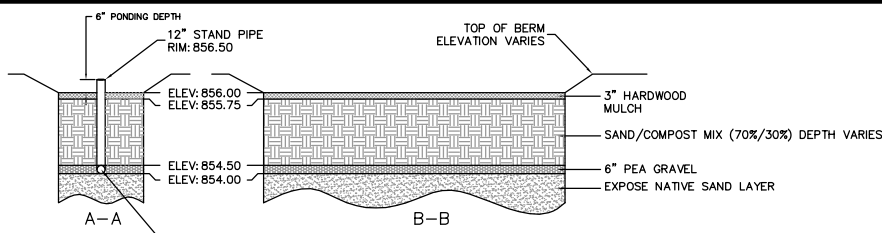

SAND LAYER SHALL COME FROM NATIVE SANDS FROM BUILDING EXCAVATION

RAIN GARDEN DETAIL

LEGEND

--- 854 ---	EXISTING MINOR CONTOUR
--- 855 ---	EXISTING MAJOR CONTOUR
--- 854 ---	PROPOSED MINOR CONTOUR
--- 855 ---	PROPOSED MAJOR CONTOUR
---	STORM SEWER
---	PERFORATED DRAIN TILE (WRAPPED)

BENCHMARK
HYDRANT TOP NUT
ELEV=857.35

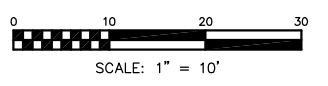

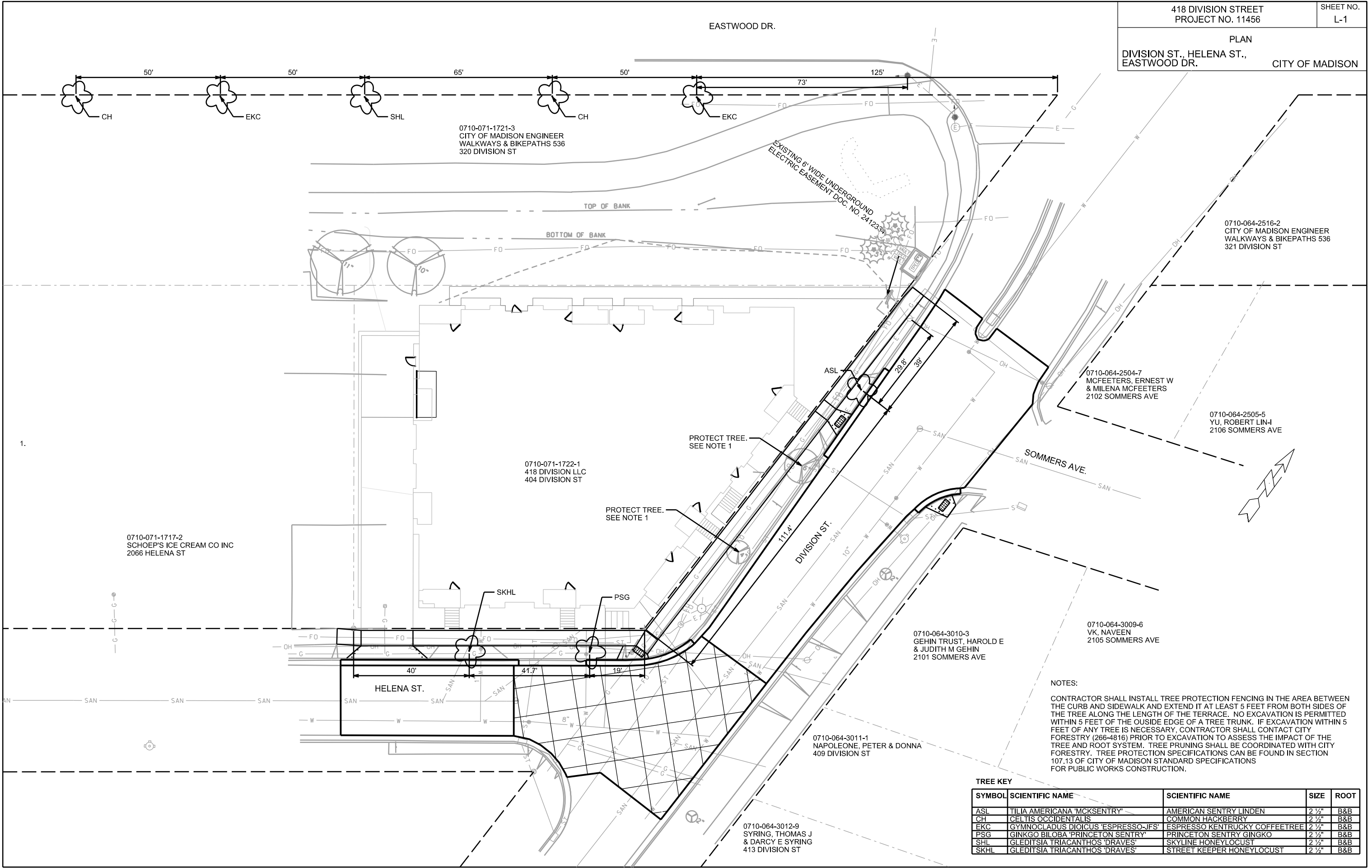

NOTES:
CONTRACTOR SHALL INSTALL TREE PROTECTION FENCING IN THE AREA BETWEEN THE CURB AND SIDEWALK AND EXTEND IT AT LEAST 5 FEET FROM BOTH SIDES OF THE TREE ALONG THE LENGTH OF THE TERRACE. NO EXCAVATION IS PERMITTED WITHIN 5 FEET OF THE OUTSIDE EDGE OF A TREE TRUNK. IF EXCAVATION WITHIN 5 FEET OF ANY TREE IS NECESSARY, CONTRACTOR SHALL CONTACT CITY FORESTRY (266-4816) PRIOR TO EXCAVATION TO ASSESS THE IMPACT OF THE TREE AND ROOT SYSTEM. TREE PRUNING SHALL BE COORDINATED WITH CITY FORESTRY. TREE PROTECTION SPECIFICATIONS CAN BE FOUND IN SECTION 107.13 OF CITY OF MADISON STANDARD SPECIFICATIONS FOR PUBLIC WORKS CONSTRUCTION.

TREE KEY

SYMBOL	SCIENTIFIC NAME	SCIENTIFIC NAME	SIZE	ROOT
ASL	TILIA AMERICANA 'MCKSENTRY'	AMERICAN SENTRY LINDEN	2 1/2"	B&B
CH	CELTIS OCCIDENTALIS	COMMON HACKBERRY	2 1/2"	B&B
EKC	GYMNOCLADUS DIOICUS 'ESPRESSO-JFS'	ESPRESSO KENTUCKY COFFEETREE	2 1/2"	B&B
PSG	GINKGO BILOBA 'PRINCETON SENTRY'	PRINCETON SENTRY GINKGO	2 1/2"	B&B
SHL	GLEDITSIA TRIACANTHOS 'DRAVES'	SKYLINE HONEYLOCUST	2 1/2"	B&B
SKHL	GLEDITSIA TRIACANTHOS 'DRAVES'	STREET KEEPER HONEYLOCUST	2 1/2"	B&B

PLOT SCALE: _____

PLOT NAME: _____

REV. DATE: _____

ORIGINATOR: CITY OF MADISON, STREETS DIVISION