



Madison, Wisconsin

INDEX OF SHEETS - STREETS

SHEET NO.	TITLE
1	NOTES AND DETAILS
DI-D4	SATURN DRIVE
P1	VENUS WAY
P2-P3	

INDEX OF SHEETS - SEWERS

U1	SATURN DRIVE SEWERS
U2-U3	VENUS WAY SEWERS
U4-U5	SEWER SCHEDULES

INDEX OF SHEETS - WATER

W1	SATURN DRIVE WATER
W2-W3	VENUS WAY WATER
W4-W5	WATER IMPACT PLAN & MATERIALS

CITY OF MADISON

CITY ENGINEERING DIVISION

DEPARTMENT OF PUBLIC WORKS

PLAN OF PROPOSED IMPROVEMENT

GRANDVIEW COMMONS

PHASE 22

SATURN DRIVE & VENUS WAY

CITY PROJECT NO. 53B2418

MUNIS NO. 10502

CONTRACT NO. 2418

PHASE LIMITS

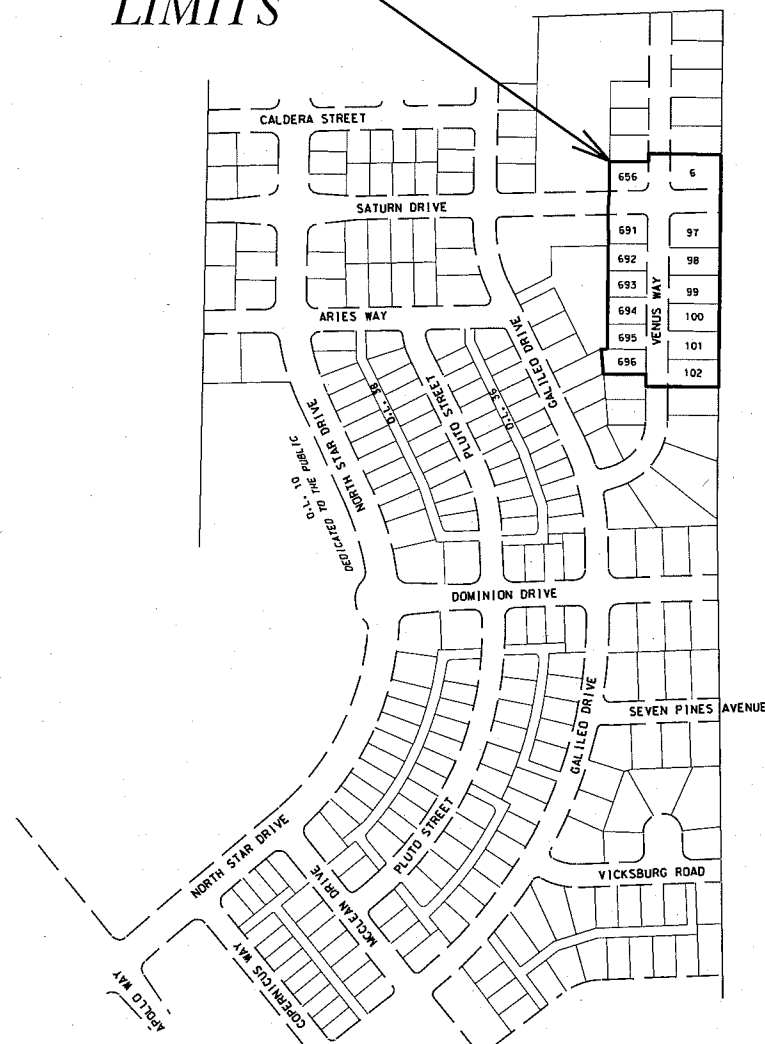

PROJECT LOCATION

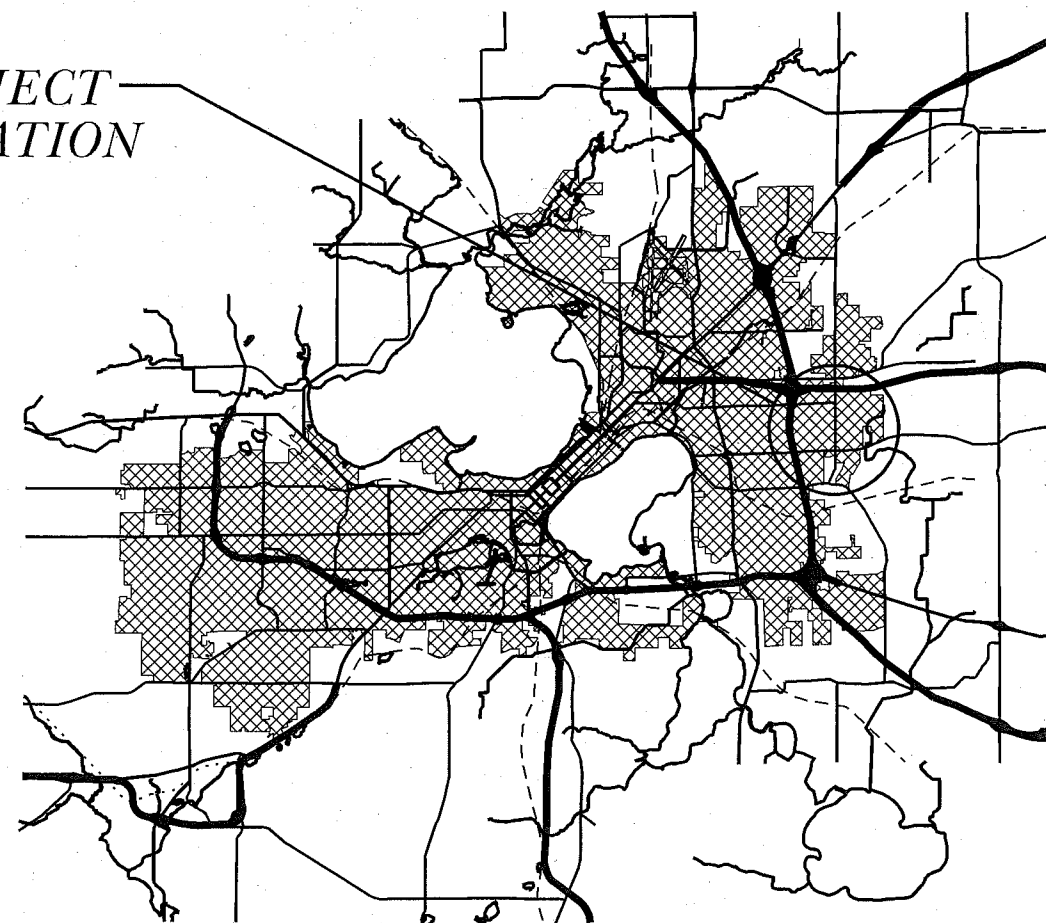
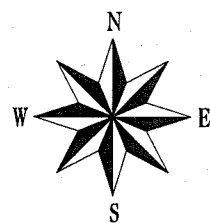

PUBLIC IMPROVEMENT PROJECT APPROVED
FEBRUARY 24, 2015
BY THE COMMON COUNCIL
OF MADISON, WISCONSIN

PUBLIC IMPROVEMENT DESIGN
APPROVED BY:

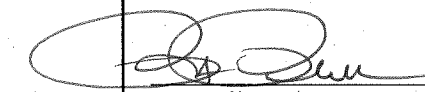
 2/25/15
City Engineer Date

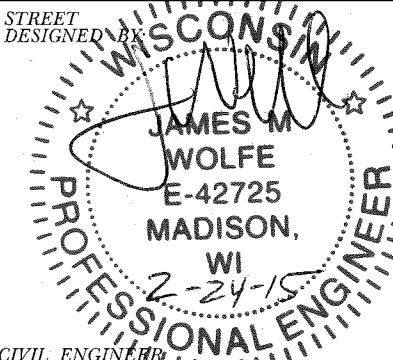
STREET DESIGNED BY:

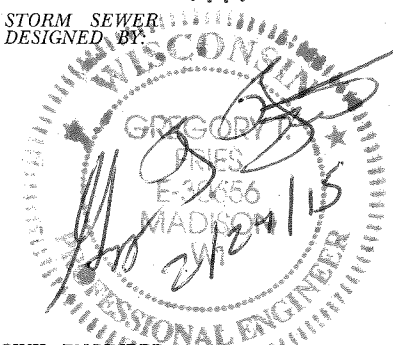
 JAMES M. WOLFE
 E-42725
 MADISON, WI
 2-24-15
 CIVIL ENGINEER

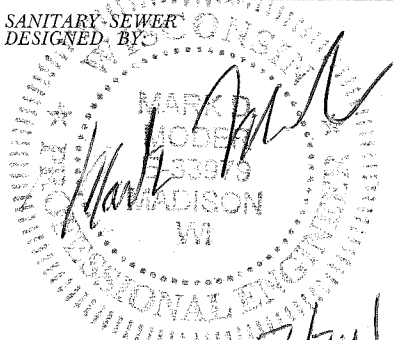
STORM SEWER DESIGNED BY:

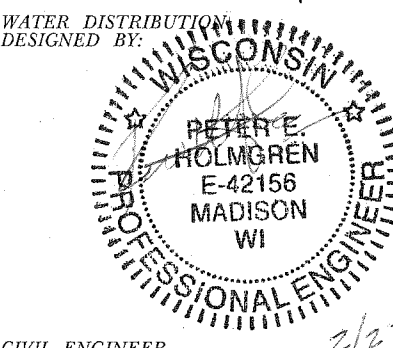
 GREGORY JONES
 E-34656
 MADISON, WI
 2/24/15
 CIVIL ENGINEER

SANITARY SEWER DESIGNED BY:

 MARK M. JONES
 E-33993
 MADISON, WI
 2/24/15
 CIVIL ENGINEER

WATER DISTRIBUTION DESIGNED BY:

 PETER E. HOLMGREN
 E-42156
 MADISON, WI
 2/27/2015
 CIVIL ENGINEER

THE LOCATION AND INFORMATION FOR PROPOSED NEW TREES, IN THE PUBLIC RIGHT OF WAY OR ON PUBLIC LANDS ARE APPROXIMATE AND ARE SHOWN FOR REFERENCE ONLY. THE LOCATIONS, SPECIFICATIONS AND PLANTING METHODS OF ALL PROPOSED NEW OR REPLACEMENT TREES IN THE PUBLIC RIGHT OF WAY OR ON PUBLIC LANDS SHALL BE APPROVED BY THE CITY FORESTER PRIOR TO INSTALLATION.

NO TREES IN THE RIGHT OF WAY OR ON PUBLIC LANDS SHALL BE TRIMMED, PRUNED, REMOVED OR ADVERSELY AFFECTED IN ANY WAY UNTIL THE DEVELOPER HAS RECEIVED WRITTEN PERMISSION FROM THE CITY ENGINEER OR CITY FORESTER. SAID WRITTEN PERMISSION SHALL INCLUDE LANGUAGE INDICATING THAT SECTION 10.101 OF THE MADISON GENERAL ORDINANCES AND ADMINISTRATIVE PROCEDURE MEMORANDUM NO. 6-2, REFERING TO NOTIFICATION OF PROPERTY OCCUPANTS AND/OR OWNERS, HAS BEEN COMPLIED WITH.

ALL PAVEMENT IN THE SATURN DRIVE RIGHT-OF-WAY SHALL BE TYPE "B" AND ALL OTHER PAVEMENT SHALL BE TYPE "A" PER STANDARD DETAIL DRAWING 4.02.

ALL ISLANDS SHALL HAVE TYPE "H" C & G PER S.D.D. 3.08 AND MOUNTABLE NOSES PER S.D.D. 3.13. ALL OTHER C & G SHALL BE TYPE "A" PER S.D.D. 3.06 UNLESS OTHERWISE NOTED.

ISLAND INTERIORS SHALL BE OF SOD WHERE THE BACK TO BACK OF CURB DIMENSION IS GREATER THAN 6'.

UNDERDRAINS SHALL BE INSTALLED, PER STANDARD DETAIL DRAWING 4.05 FOR 75' ON EACH SIDE OF THE LOW POINT, OR TO THE NEAREST CURB HIGH POINT. ALL UNDERDRAIN SHALL BE WRAPPED.

ALL GUTTERS SHALL DRAIN WITH A MINIMUM GRADES OF 0.5% TOWARD STORM SEWER INLETS.

PAVEMENT CROSS SLOPES SHALL BE 2%, TERRACES SHALL SLOPE AT A 4% GRADE TOWARD THE GUTTER, SHOULDERS SHALL HAVE A 4% CROSS SLOPE AND CROSS SLOPES FORMING DITCHES SHALL NOT EXCEED 4.00:1 UNLESS OTHERWISE INDICATED.

THE CROSS SLOPE OF SIDEWALKS AND BARRIER FREE SIDEWALK CURB RAMPS SHALL BE 2%. THE LONGITUDINAL GRADE OF BARRIER FREE SIDEWALK CURB RAMPS SHALL NOT EXCEED 8.33%. ALL SIDEWALK RAMPS SHALL BE CONSTRUCTED ACCORDING TO S.D.D. 3.03. AT ALL OTHER LOCATIONS THE LONGITUDINAL GRADE OF SIDEWALKS SHALL NOT EXCEED 5.0 % OR THE ADJACENT STREET GRADE WHICHEVER IS GREATER NOR BE LESS THAN 0.5% AND SHALL DRAIN TOWARD STORM SEWER INLETS. A 2 FOOT WIDE CONCRETE FLUME SHALL BE INSTALLED BETWEEN THE SIDEWALK AND THE BACK OF CURB AT SIDEWALK LOW POINTS WHICH CANNOT OTHERWISE BE DRAINED DIRECTLY TO THE GUTTER. SIDE SLOPES WITHIN TEN FEET OF A PUBLIC SIDEWALK SHALL NOT EXCEED 4.00:1. THE DESIGN OF SIDEWALK ELEVATIONS AND GRADES IS NOT INCLUDED IN THIS PLAN. ALL SIDEWALK AND SIDEWALK RAMP ELEVATIONS AND GRADES SHALL BE FIELD VERIFIED AND SET TO COMPLY WITH THE CITY OF MADISON STANDARD SPECIFICATIONS AND THE A.D.A. GUIDELINES.

OBTAIN A PRINT OUT OF THE ALIGNMENT FROM THE CITY ENGINEER PRIOR TO STAKING THIS PROJECT.

CURB STATION AND OFFSETS SHALL BE TO THE FACE OF CURB UNLESS OTHERWISE INDICATED. CURB ELEVATIONS SHALL BE TO THE TOP OF CURB (OR EXTENDED TOP OF CURB FOR DRIVEWAYS OR RAMPS) UNLESS OTHERWISE INDICATED.

POWER POLES AND OTHER OBSTRUCTIONS SHALL BE MOVED TO PROVIDE 2 FEET MINIMUM OF CLEAR DISTANCE FROM ANY FACE OF CURB OR EDGE OF SIDEWALK.

ANY INFORMATION SHOWN ON THIS PLAN, WHICH IS NOT PART OF THIS PROJECT, IS PRELIMINARY AND NOT FOR CONSTRUCTION.

THERE MAY BE EXISTING UTILITIES OR OTHER FEATURES WHICH ARE EITHER NOT SHOWN OR SHOWN INCORRECTLY ON THIS PLAN. IT IS THE RESPONSIBILITY OF THE DEVELOPER TO LOCATE AND IDENTIFY ALL UTILITIES AND TOPOGRAPHY WHICH MAY AFFECT THE CONSTRUCTION OF THESE IMPROVEMENTS.

ALL PERMANENT SIGNING AND POSTING WILL BE DETERMINED AND PROVIDED BY THE TRAFFIC ENGINEERING DIVISION, FOLLOWING CONSTRUCTION OF THESE IMPROVEMENTS.

THE DEVELOPER SHALL PROVIDE, INSTALL AND MAINTAIN ALL STREET END BARRICADES, SIGNING AND TRAFFIC CONTROL, AS REQUIRED BY THE CITY TRAFFIC ENGINEER.

PAVEMENT SAWCUTS SHALL BE AS DIRECTED BY THE CITY CONSTRUCTION ENGINEER. SAWCUTS SHOWN ON THE PLAN ARE APPROXIMATE.

CURB ON CUL DE SACS SHALL BE INSTALLED ACCORDING TO SDD 3.05.

PLOT SCALE: _____

PLOT NAME: _____

REV. DATE: _____

ORIGINATOR: CITY OF MADISON, STREETS DIVISION

TYPICAL SECTION - SATURN DRIVE

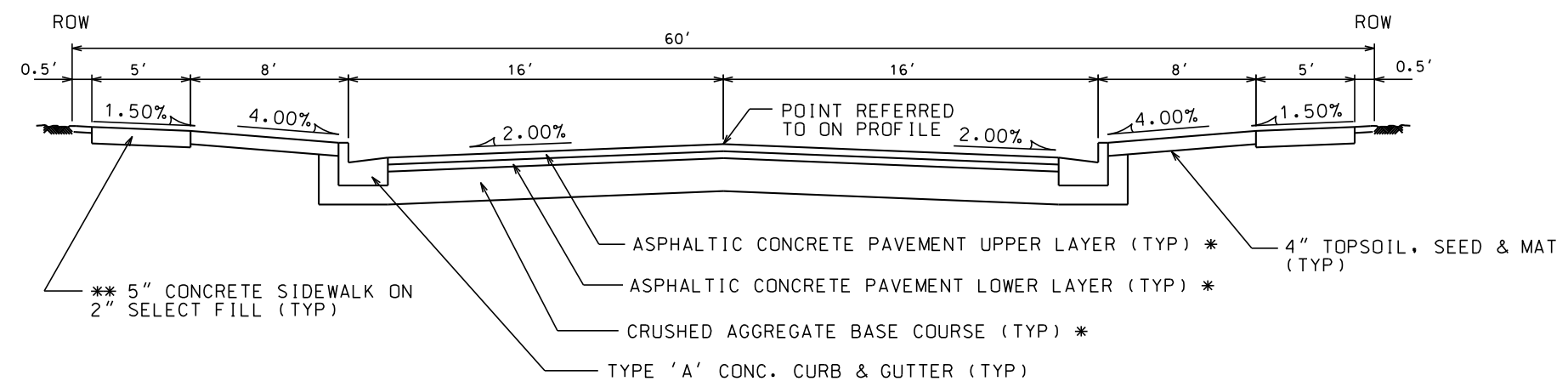

TYPICAL SECTION - VENUS WAY

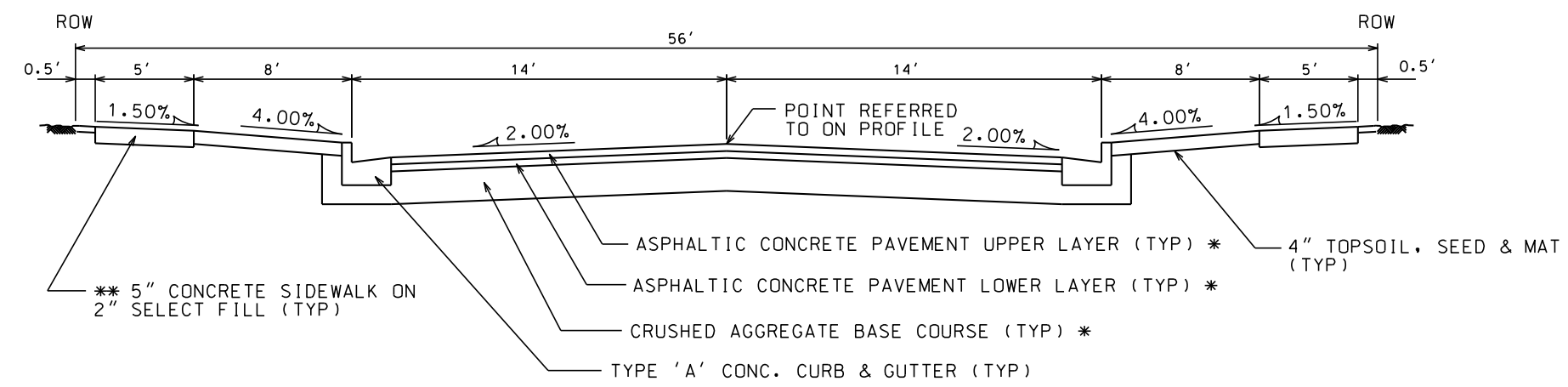

NOTES:

- * A PAVEMENT DESIGN IN ACCORDANCE WITH STANDARD DETAIL DRAWING 4.06 IS REQUIRED ON ALL PROJECTS
- ** 3" OF CRUSHED AGGREGATE BASE COURSE GRADATION 3 SHALL BE PLACED UNDER THE SIDEWALK WHERE THE CENTERLINE GRADE OF THE STREET EXCEEDS 5%

* CITY OF MADISON MINIMUM PAVEMENT DESIGN

TYPE	CRUSHED AGGREGATE BASE COURSE		ASPHALTIC CONCRETE PAVEMENT			
	LOWER LAYER GRADATION 1	UPPER LAYER GRADATION 2	LOWER LAYER TYPE	LOWER LAYER THICKNESS	UPPER LAYER TYPE	UPPER LAYER THICKNESS
A	6"	4"	E-0.3	1.75"	E-0.3	1.75"
B	6"	4"	E-1	2.25"	E-1	2.00"
C	6"	4"	E-3	3.25"	E-3	2.00"

PLOT SCALE: _____
PLOT NAME: _____
REV. DATE: _____

ANY SIDEWALK ELEVATIONS INDICATED ON THE PLAN NEAR THE RAMPS ARE APPROXIMATE AND NOT TO BE USED FOR CONSTRUCTION. ACTUAL SIDEWALK AND RAMP ELEVATIONS SHALL BE DETERMINED BASED ON THE AS BUILT ELEVATIONS OF THE CURB AND GUTTER.

CONTACT THE CITY ENGINEER FOR A SITE SPECIFIC DESIGN IF THIS TYPICAL LAYOUT RESULTS IN ANY NON-COMPLIANCE WITH THE AMERICANS WITH DISABILITIES GUIDELINES OR ANY LOCAL, STATE OR NATIONAL REGULATIONS, CODES, GUIDLINES OR ORDINANCES.

LANDING LAYOUT

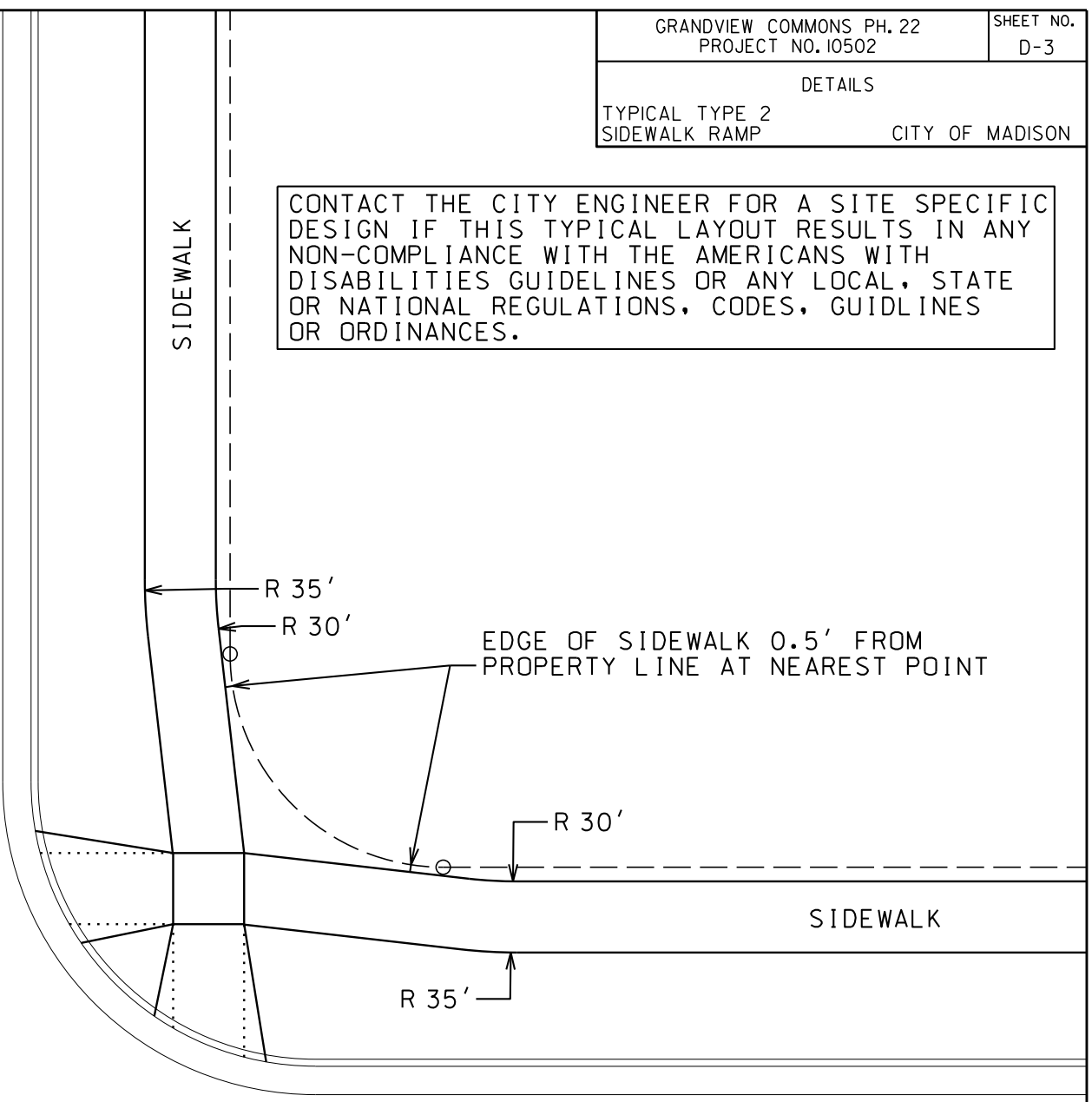
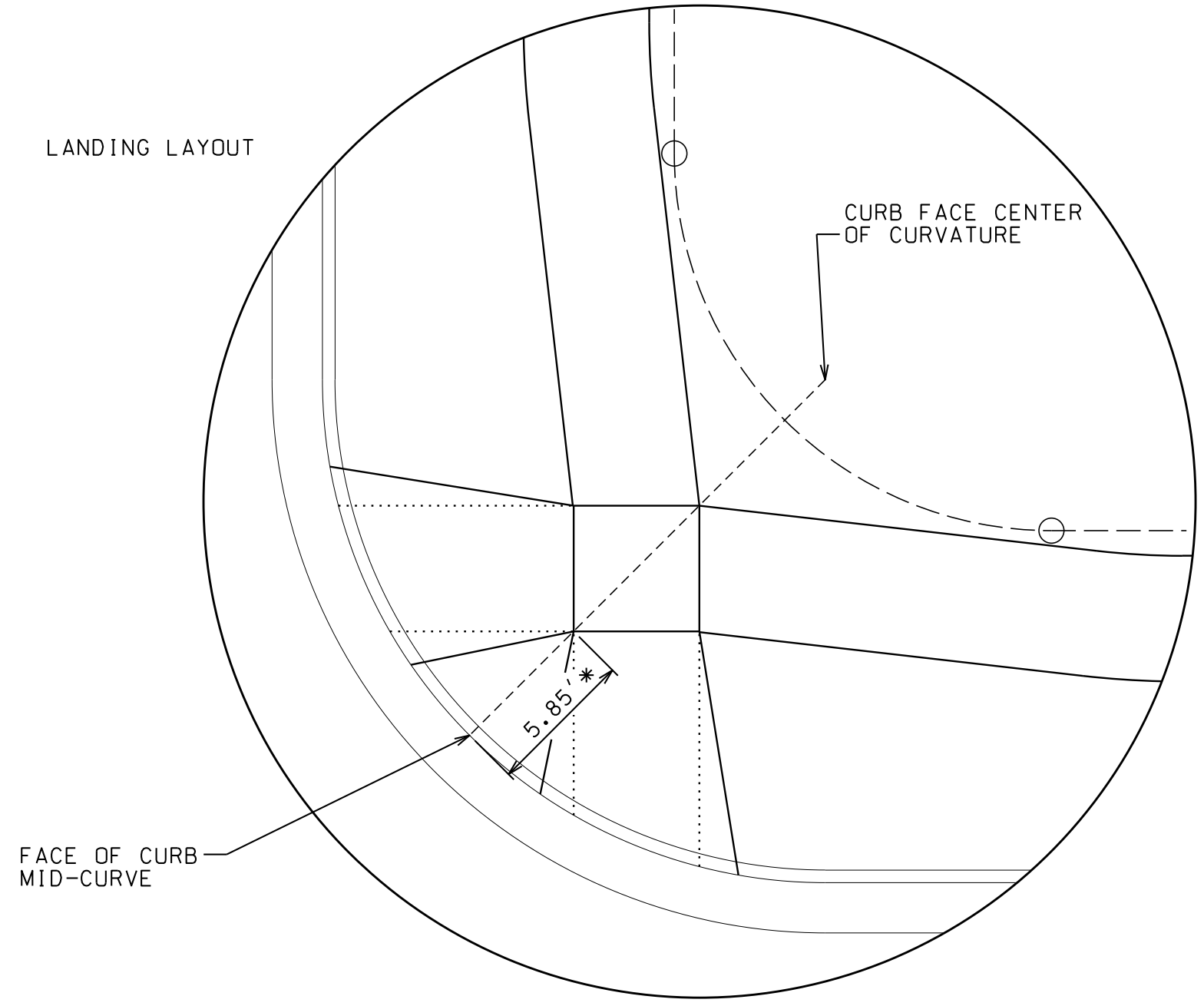

* THE NEAR CORNER OF THE LANDING SHALL BE 5.85' FROM THE FACE OF CURB, UNLESS SPECIFIED OTHERWISE ON THE PLAN. BOTH OPPOSITE CORNERS OF THE LANDING SHALL BE LOCATED ON THE FACE OF CURB RADIUS LINE WHICH PASSES THROUGH THE MIDPOINT OF THE CURB CURVATURE.

LONGITUDINAL RAMP GRADES SHALL NOT EXCEED 1"/12" NOR BE LESS THAN 2.0% AT ANY POINT. THIS NOTE SHALL TAKE PRECEDENCE OVER ANY ELEVATION OR GRADE INDICATED ON THE PLAN.

SIDEWALK LONGITUDINAL GRADES AT ALL LOCATIONS OTHER THAN RAMPS AND WHERE STREET GRADES ARE MORE THAN 5.0% SHALL NOT EXCEED 5.0%. WHERE STREET GRADES EXCEED 5.0%, THE SIDEWALK LONGITUDINAL GRADE SHALL NOT EXCEED THE STREET GRADE.

PLOT SCALE: _____
PLOT NAME: _____
REV. DATE: _____

ORIGINATOR: CITY OF MADISON, STREETS DIVISION

THE RAMPS SHALL ALIGN
WITH THE CROSSINGS.

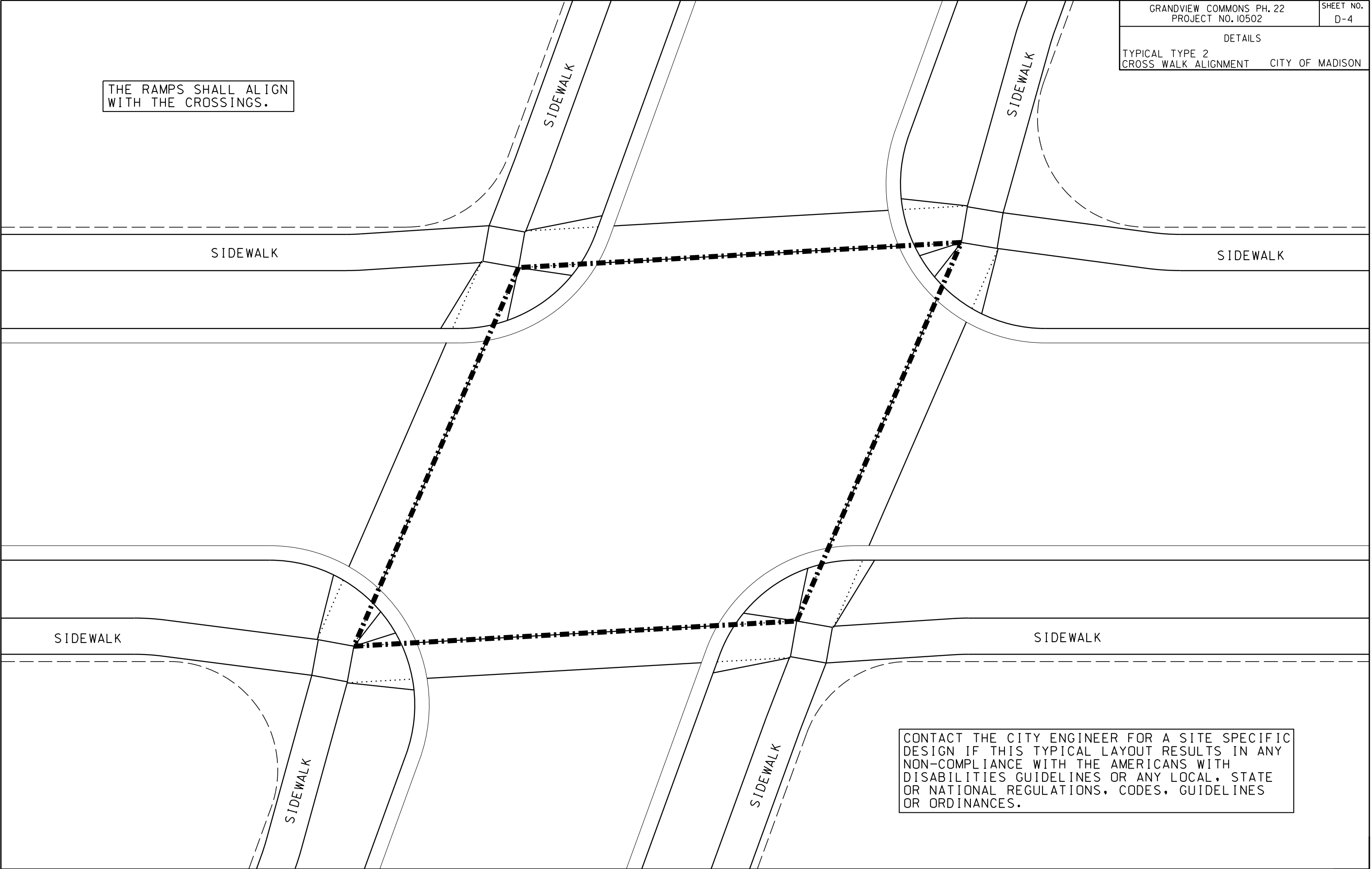

CONTACT THE CITY ENGINEER FOR A SITE SPECIFIC
DESIGN IF THIS TYPICAL LAYOUT RESULTS IN ANY
NON-COMPLIANCE WITH THE AMERICANS WITH
DISABILITIES GUIDELINES OR ANY LOCAL, STATE
OR NATIONAL REGULATIONS, CODES, GUIDELINES
OR ORDINANCES.

PLOT SCALE: _____

PLOT NAME: _____

REV. DATE: _____

ORIGINATOR: CITY OF MADISON, STREETS DIVISION

PLAN AND PROFILE
SATURN DR. CITY OF MADISON

1ST ADD TO NELSON ADD
RUSTIC ACRES

1ST ADD TO NELSON ADD
RUSTIC ACRES

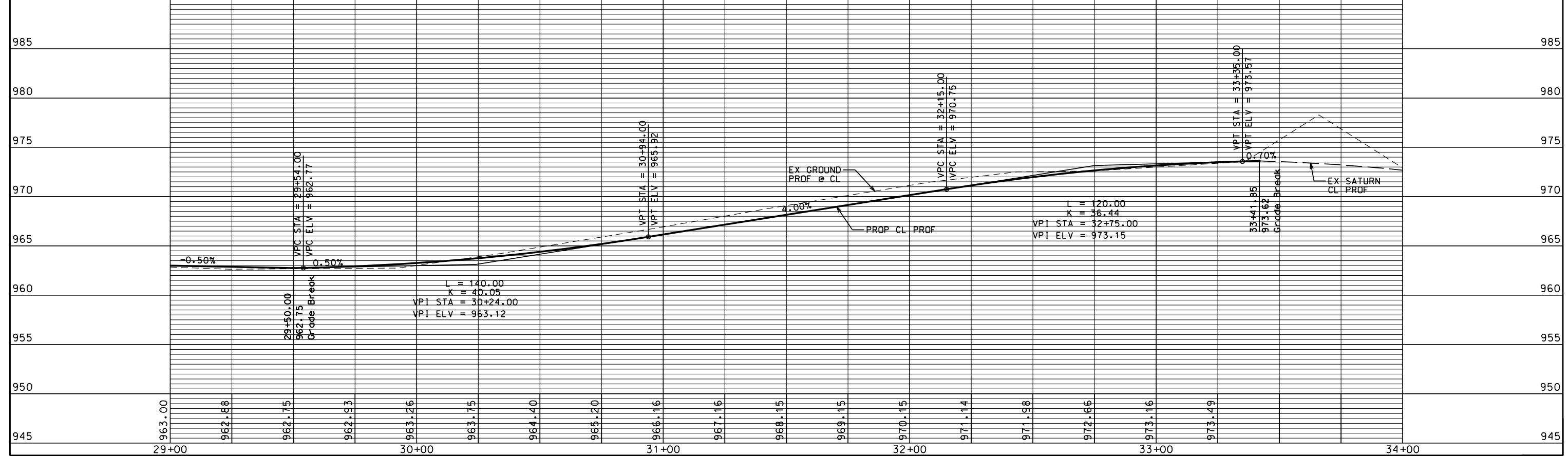
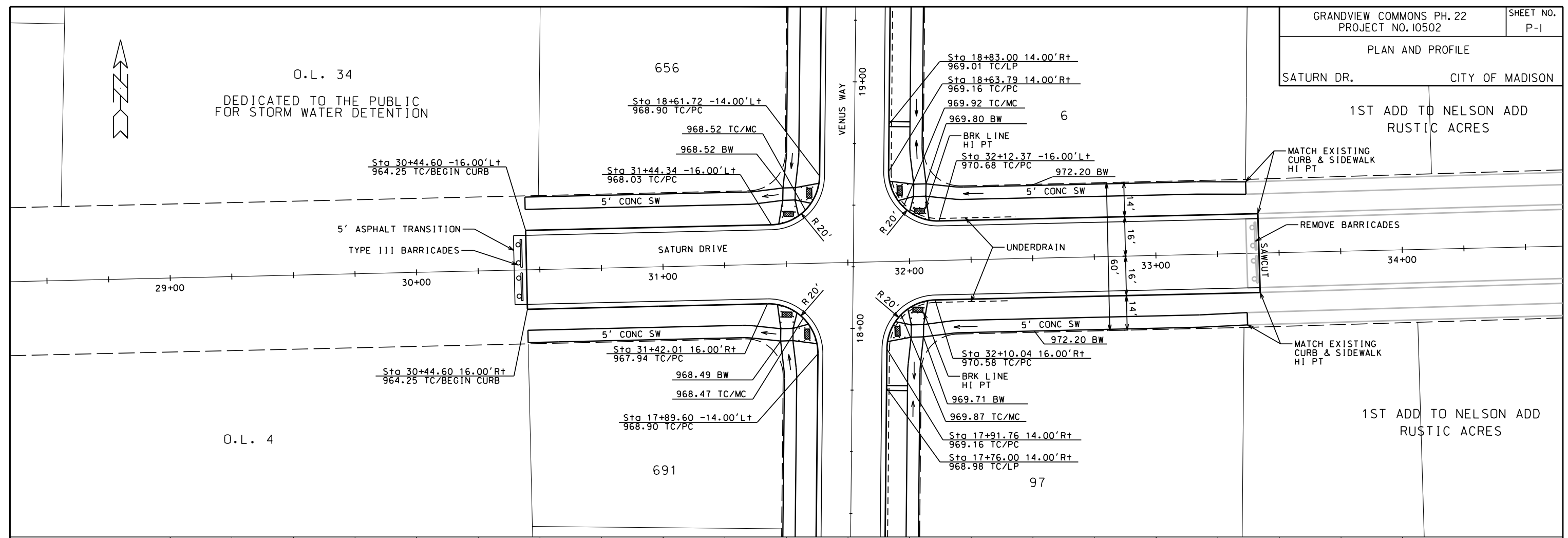

ORIGINATOR: CITY OF MADISON, STREETS DIVISION

PLOT SCALE: _____
PLOT NAME: _____
REV. DATE: _____

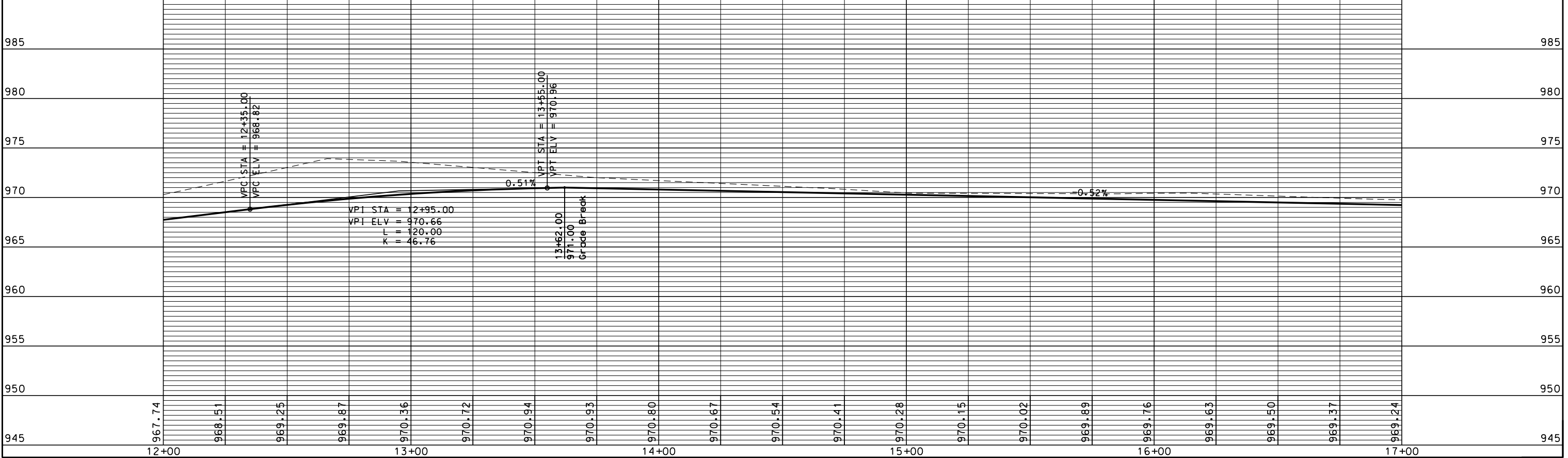
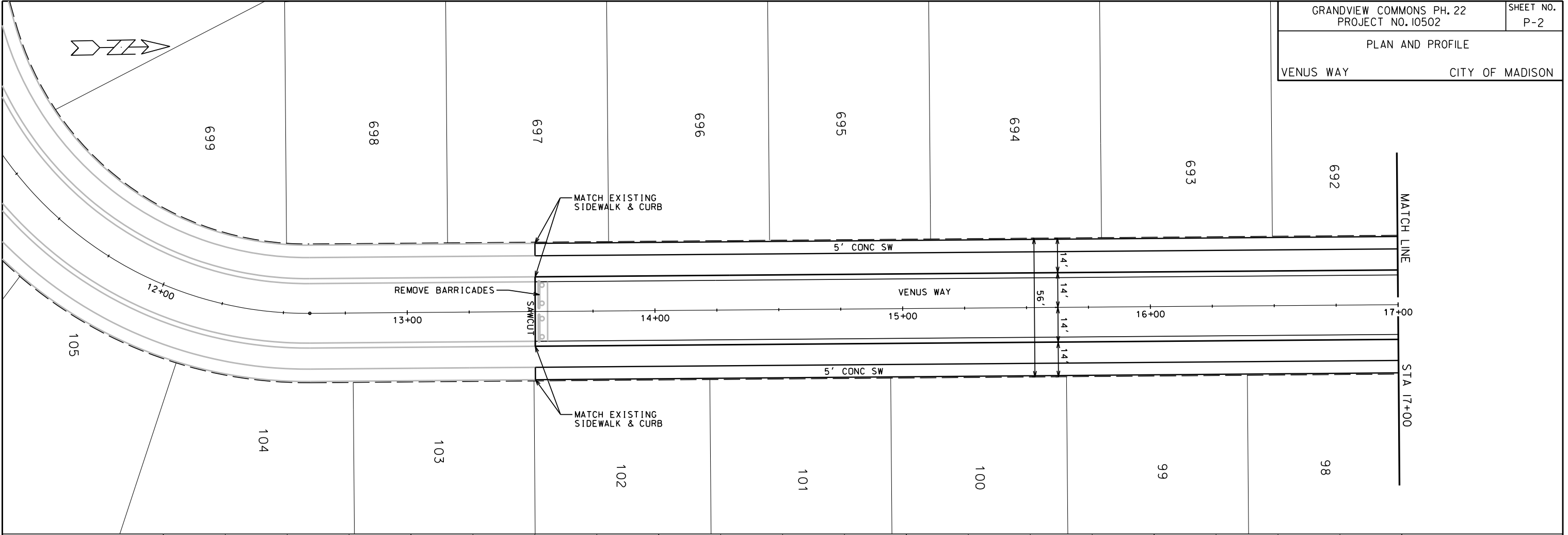

ORIGINATOR: CITY OF MADISON, STREETS DIVISION

1ST ADD TO NELSON ADD
 RUSTIC ACRES

1ST ADD TO NELSON ADD
 RUSTIC ACRES

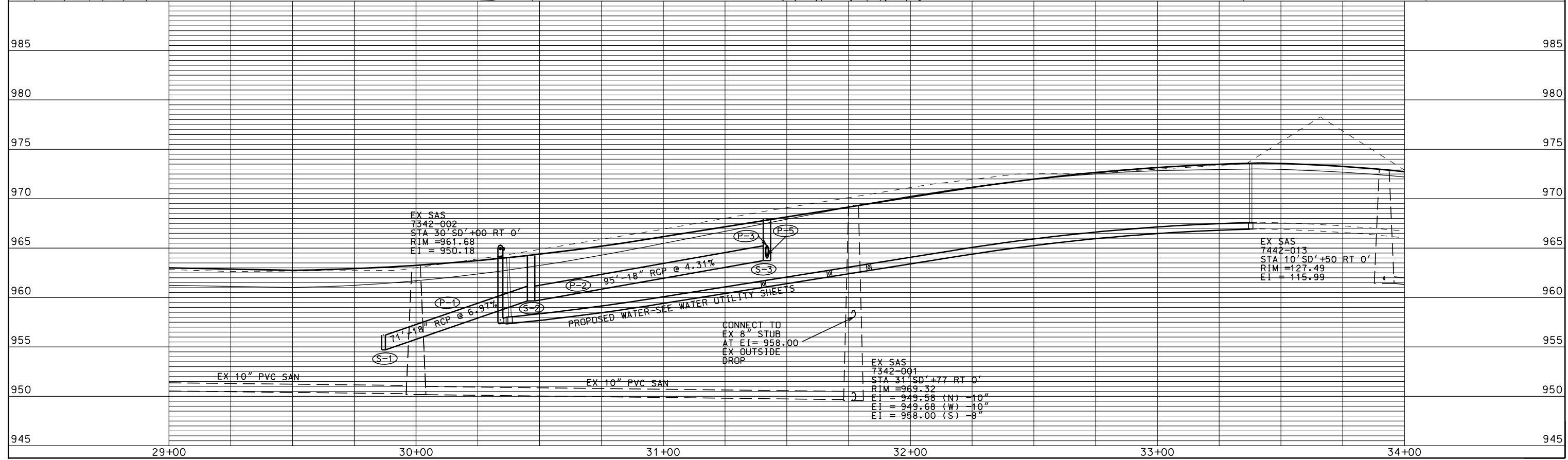
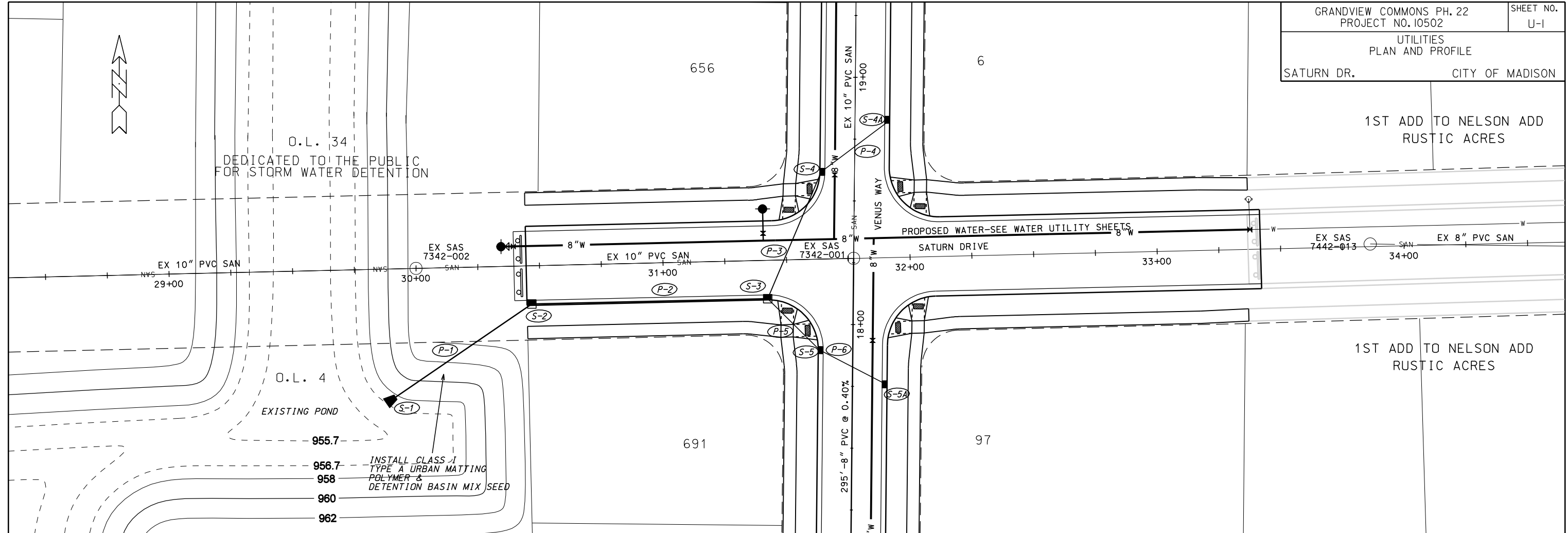

PLOT SCALE:

PLOT NAME:

REV. DATE:

ORIGINATOR: CITY OF MADISON, STREETS DIVISION

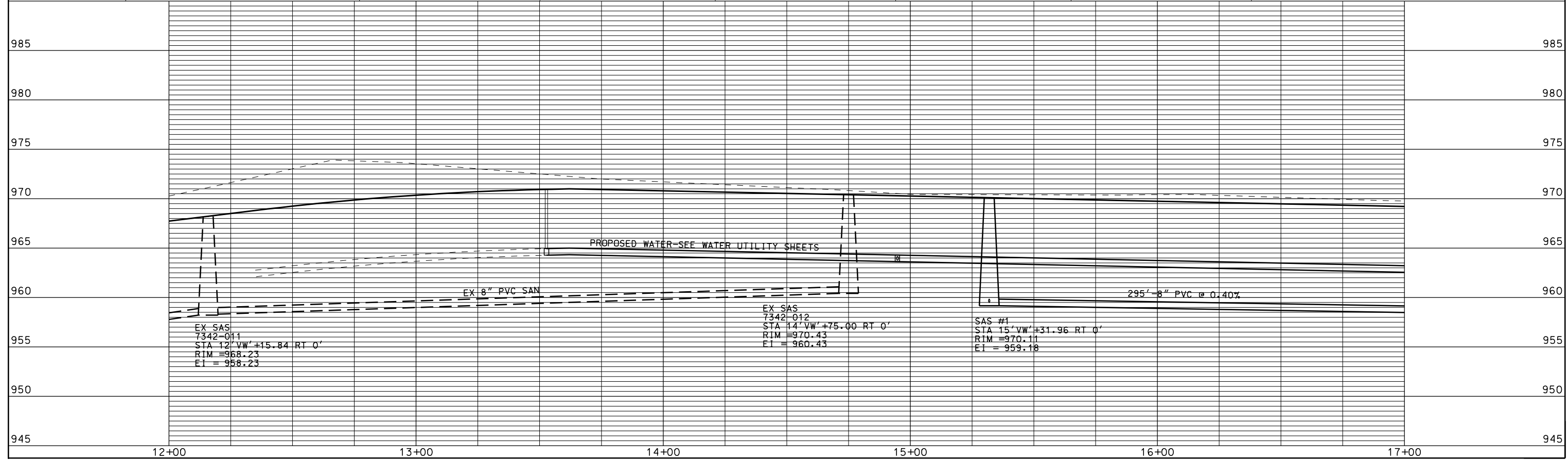
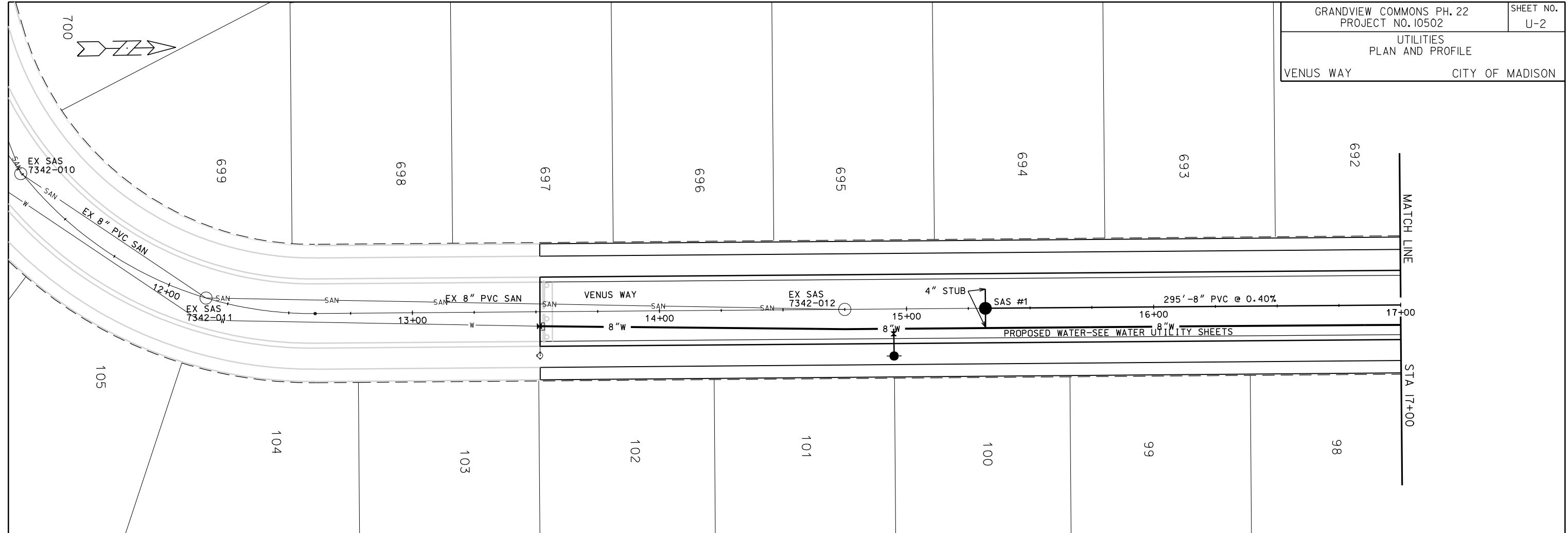

EX SAS
 7342-011
 STA 12+00 VW'+15.84 RT 0'
 RIM = 968.23
 EI = 958.23

EX SAS
 7342-012
 STA 14+00 VW'+75.00 RT 0'
 RIM = 970.43
 EI = 960.43

SAS #1
 STA 15+00 VW'+31.96 RT 0'
 RIM = 970.11
 EI = 959.18

PLOT SCALE:
 PLOT NAME:
 REV. DATE:

ORIGINATOR: CITY OF MADISON, STREETS DIVISION

O.L. 34

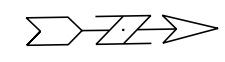

PLOT SCALE: 1" = 40'

PLOT NAME: VENUS WAY

REV. DATE: 2/23/2015

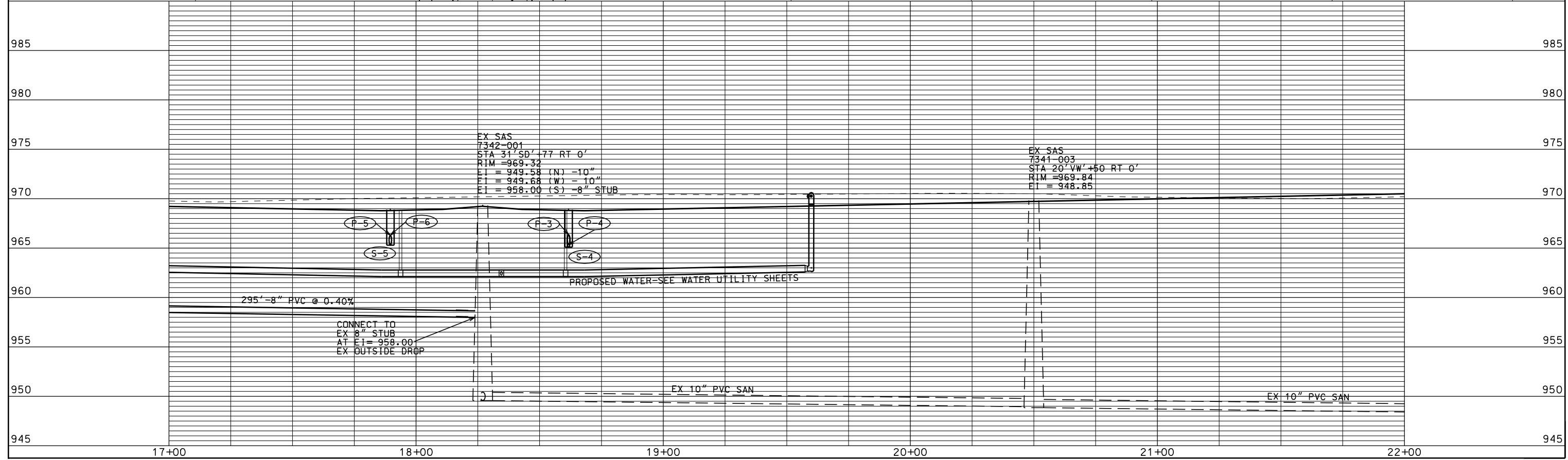
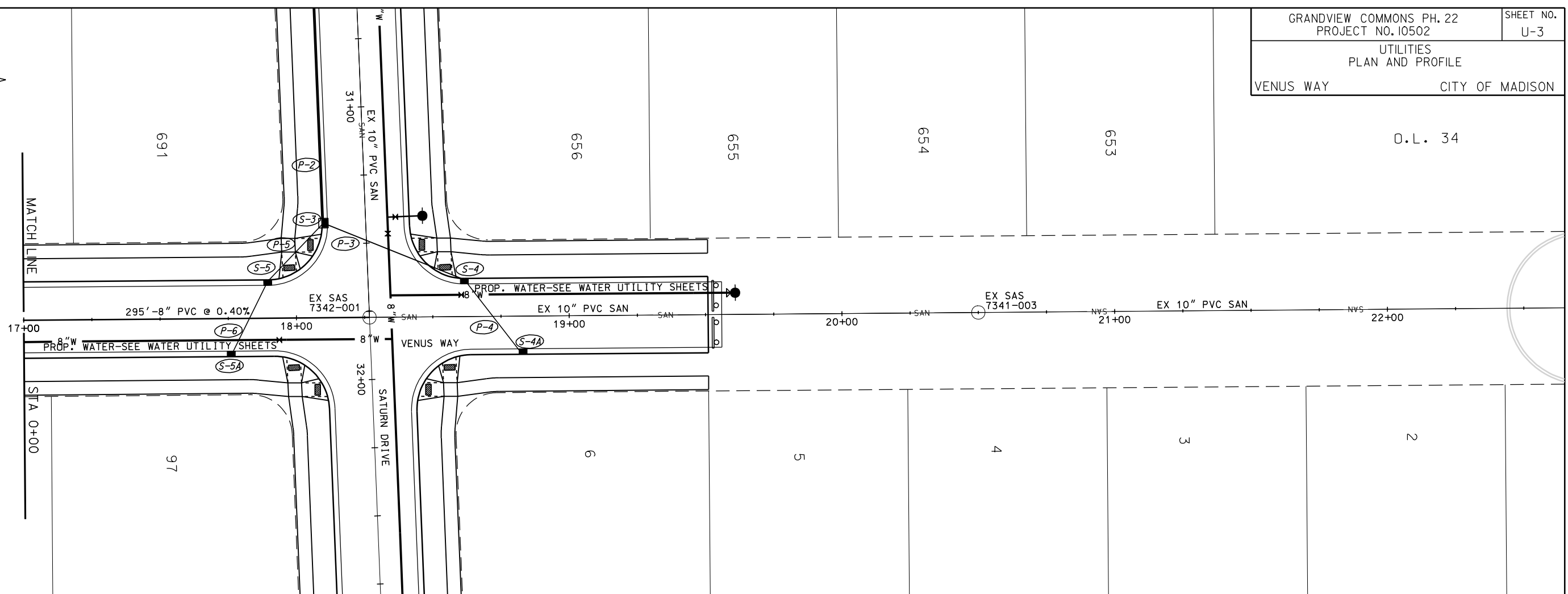

ORIGINATOR: CITY OF MADISON, STREETS DIVISION

SANITARY SCHEDULE

ALIGNMENT CODES:

"VW" = VENUS WAY

GRANDVIEW COMMONS PH 22

SHEET NO.

PROJECT NO. 10502

U-4

SANITARY SEWER SCHEDULE

CITY OF MADISON

PROPOSED SANITARY STRUCTURES

SAS NO.	STATION	LOCATION (OFFSET)	TOP OF CASTING	E.I.	DEPTH	NOTES
SAS#1	15'VW+31.96	CL	970.11	959.18	10.93	-

PROPOSED SANITARY PIPES

FROM SAS (DWNSTRM)	TO SAS (UPSTREAM)	EI # (DWNSTRM)	EI # (UPSTRM)	PLAN LENGTH (FT)	SLOPE (%)	SIZE (DIA)	PVC TYPE	NOTES
EX SAS 7342-001	SAS#1	958.00	959.18	295	0.40%	8"	SDR-35	CONNECT TO EX 8" STUB AT EX OUTSIDE DROP

PLOT SCALE: -----

PLOT NAME: -----

REV. DATE: -----

STORM SEWER SCHEDULE

ALIGNMENT CODES:

'SD' = SATURN DRIVE
'VW' = VENUS WAY

GRANDVIEW COMMONS PHASE 22
PROJECT NO. 10502

SHEET NO.
U-5

STORM SEWER SCHEDULE CITY OF MADISON

STRUCTURES

STRUC. NO.	STATION	LOCATION (OFFSET)	TYPE	TOP OF CASTING	E.I.	DEPTH	NOTES
S-1	29'SD'+86.82	RT-54.30	18" RCP AE	-	954.70	-	W/ GATE
S-2	30'SD'+46.52	RT-15.50	3X3 SAS	964.25	959.65	4.60	W/ R-3067-7004
S-3	31'SD'+42.01	RT-15.50	3X3 SAS	967.94	963.74	4.20	FP; W/ R-3067-7004
S-4	18'VW'+61.72	LT-13.50	H INLET	968.90	965.10	3.80	W/ R-3067-7004
S-4A	18'VW'+83.00	RT-15.50	H INLET	969.01	965.52	3.49	LP; W/ R-3067-7004-VB
S-5	17'VW'+89.60	LT-13.50	H INLET	968.90	965.30	3.60	W/ R-3067-7004
S-5A	17'VW'+76.00	RT-13.50	H INLET	968.98	965.58	3.40	LP; W/ R-3067-7004-VB

PIPES

PIPE NO.	FROM (DNSTM)	TO (UPSTM)	LGTH (FT)	DISCH. E.I.	INLET E.I.	SLOPE (%)	PIPE SIZE	TYPE	NOTES
P-1	S-1	S-2	71	954.70	959.65	6.97%	18"	RCP	-
P-2	S-2	S-3	95	959.65	963.74	4.31%	18"	RCP	-
P-3	S-3	S-4	56	963.99	965.10	1.98%	15"	RCP	-
P-4	S-4	S-4A	34	965.35	965.52	0.50%	12"	RCP	-
P-5	S-3	S-5	29	964.24	965.30	3.66%	12"	RCP	-
P-6	S-5	S-5A	30	965.30	965.58	0.93%	12"	RCP	-

SPECIFIC NOTES

STANDARD NOTES:

- ABBREVIATIONS: AE = APRON ENDWALL; RCP = REINFORCED CONCRETE PIPE; HERCP = HORIZONTAL ELLIPTICAL REINFORCED CONCRETE PIPE; DNA = DOES NOT APPLY; SAS = SEWER ACCESS STRUCTURE; LP = LOW POINT INLET STRUCTURE; FP = FIELD POURED STRUCTURE; TR = TOP OF CONCRETE ROOF; NCM = NO CROWN MATCH FOR PIPES
- APPROXIMATE DISCHARGE E.I. GIVEN, ADJUST E.I. AND PIPE SLOPE IN THE FIELD.
- TOP OF CASTING GRADE GIVEN IS THE TOP OF CURB FOR INLET STRUCTURES AND THE FLOWLINE OF THE CLOSED CASTING FOR SAS's.
- TOP OF CONCRETE ROOF (TR) IS 1.25' BELOW TOP OF CASTING UNLESS OTHERWISE NOTED.
- ALL REINFORCED CONCRETE PIPES TO BE CLASS III UNLESS OTHERWISE NOTED.
- SURVEYOR TO CONFIRM THAT ALL INLET STATION / OFFSETS LINE UP WITH PROPOSED CURB AND GUTTER.
- ALL STRUCTURES CALLED OUT AS FIELD POURED SHALL BE FIELD POURED. ALL OTHER STRUCTURES (NOT INDICATED AS FIELD POURED) SHALL BE SUBMITTED TO CITY ENGINEERING FOR APPROVAL IF PRECAST STRUCTURES ARE PREFERRED. CONTACT ELIA E. ACOSTA OF CITY ENGINEERING AT (608) 266-4096 FOR PRECAST APPROVALS, OR FAX SHOP DRAWINGS TO (608)264-9275.

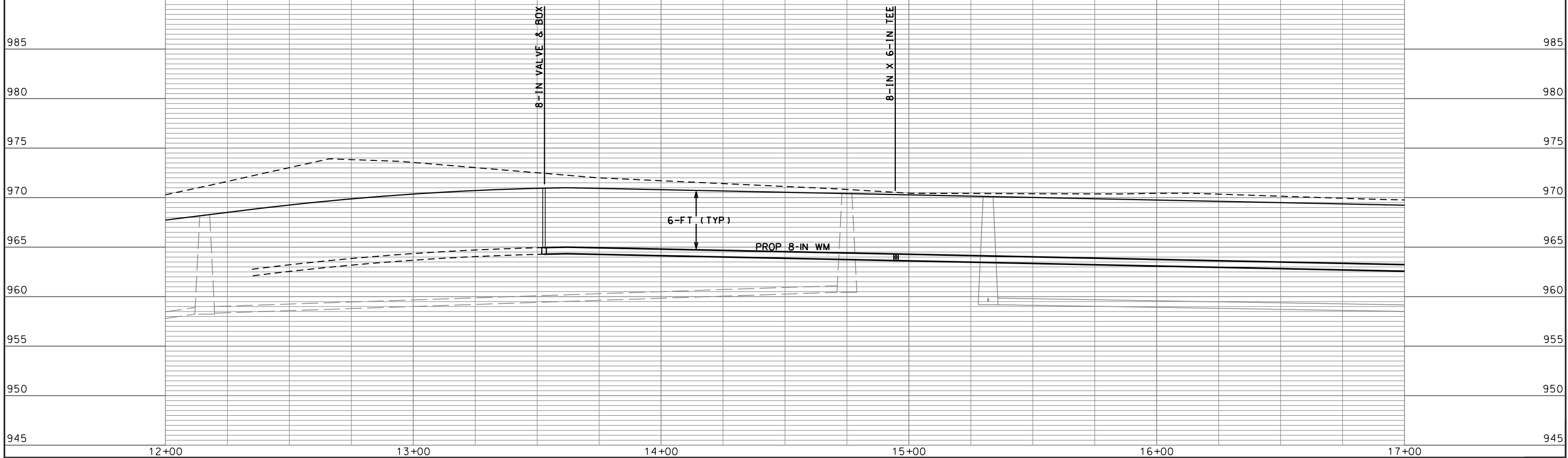
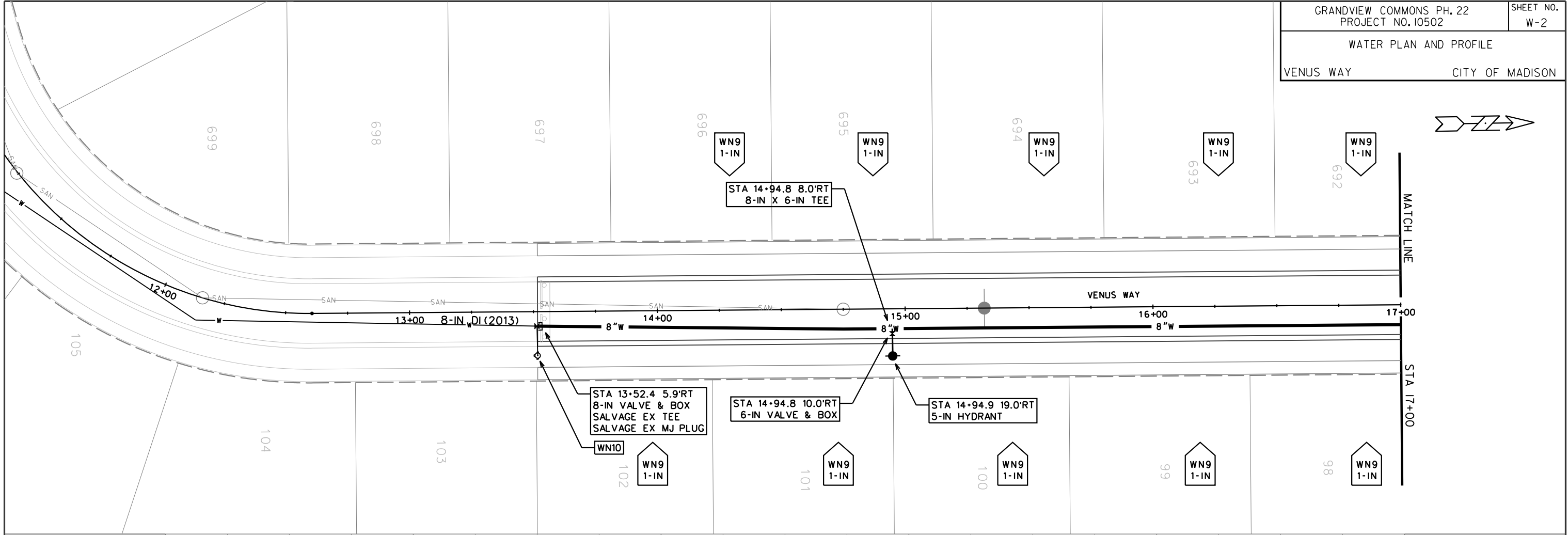

PLOT SCALE:

PLOT NAME:

REV. DATE:

ORIGINATOR: CITY OF MADISON, STREETS DIVISION

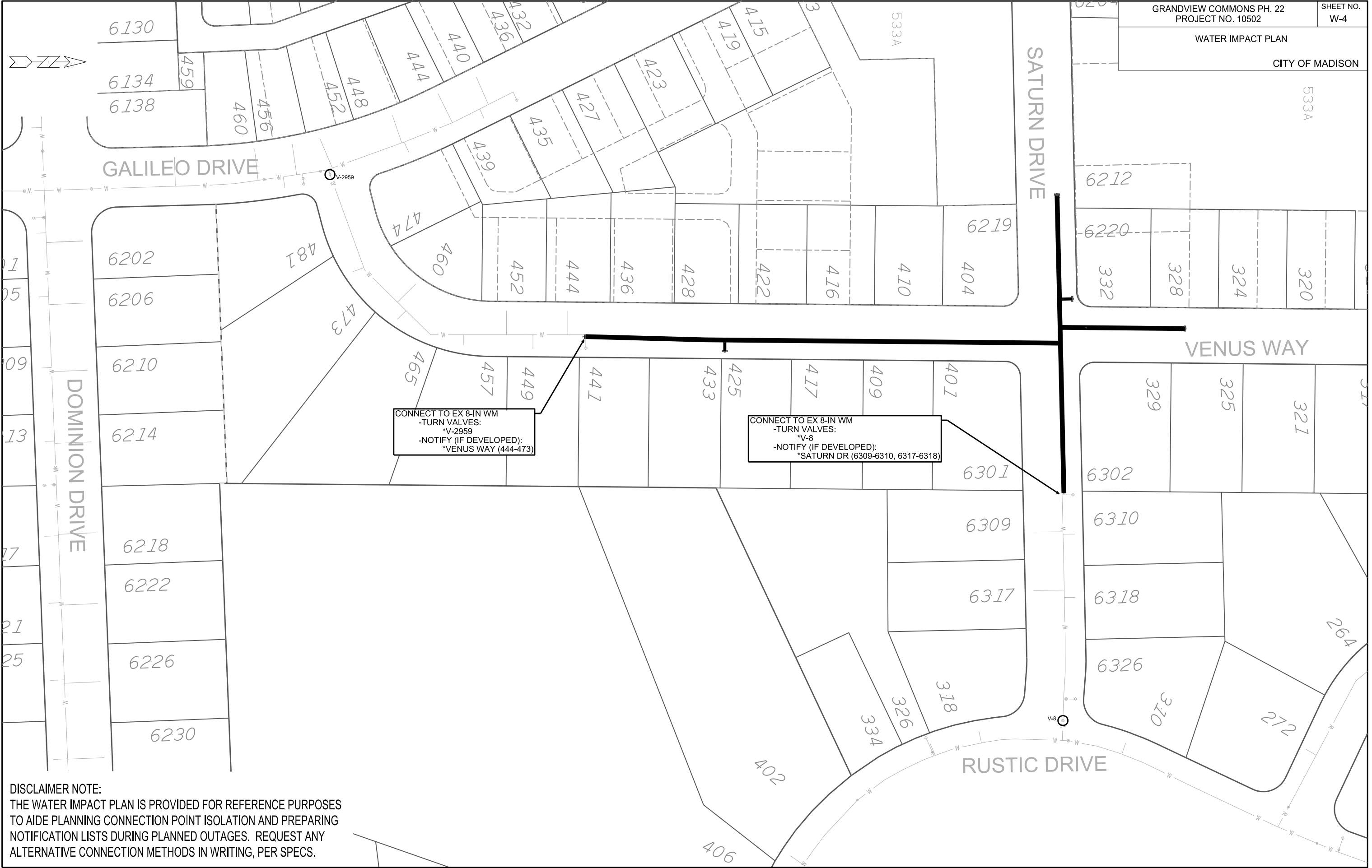

DISCLAIMER NOTE:
THE WATER IMPACT PLAN IS PROVIDED FOR REFERENCE PURPOSES TO AIDE PLANNING CONNECTION POINT ISOLATION AND PREPARING NOTIFICATION LISTS DURING PLANNED OUTAGES. REQUEST ANY ALTERNATIVE CONNECTION METHODS IN WRITING, PER SPECS.

PLOT SCALE:

PLOT NAME:

REV. DATE:

ORIGINATOR: CITY OF MADISON, STREETS DIVISION

FILE NAME:

DATE:

CONSTRUCTION NOTES:

1. CONSTRUCT NEW WATER MAIN 6.0' BELOW FINISHED GRADE, UNLESS OTHERWISE NOTED. INSULATE MAIN WITH POLYSTYRENE BOARD AT UTILITY CROSSINGS OR OTHER AREAS IDENTIFIED BY ENGINEER AS HAVING INADEQUATE COVER.
2. VERIFY SIZE OF EXISTING WATER SERVICES AND RECONNECT SERVICES AS INDICATED.
3. MINIMIZE DISTRUPTION OF SERVICE TO EXISTING CUSTOMERS. NOTIFY PER CONTRACT REQUIREMENTS OF ANY PLANNED WATER OUTAGE.
4. THE EXISTING UTILITIES SHOWN ON THIS PLAN REPRESENT THE BEST INFORMATION AVAILABLE TO THE WATER UTILITY AT THE TIME OF PLAN PREPARATION. CONTRACTOR IS RESPONSIBLE FOR HAVING EACH UTILITY LOCATED PRIOR TO COMMENCING WORK.

- WN1 REPLACE THE EXISTING LEAD SERVICE WITH A NEW COPPER SERVICE.
- WN2 EXTEND AND RECONNECT THE EXISTING COPPER SERVICE TO THE NEW WATER MAIN.
- WN3 EXISTING SERVICE TO BE ABANDONED WHEN THE WATER MAIN IS CUT OFF.
- WN4 DISCONNECT FROM THE OLD WATER MAIN AND RECONNECT THE EXISTING COPPER WATER SERVICE LATERAL TO THE NEW WATER MAIN.
- WN5 RELOCATE THE EXISTING FIRE HYDRANT.
- WN6 ABANDON WATER VALVE ACCESS STRUCTURE.
- WN7 FURNISH AND INSTALL THE NEW TOP SECTION FOR THE WATER ACCESS STRUCTURE.
- WN8 ABANDON THE VALVE BOX.
- WN9 FURNISH THE DITCH, COMPACTION, AND ALL MATERIALS AND LABOR FOR THE INSTALLATION OF NEW SERVICE LATERAL.
- WN10 REMOVE AND SALVAGE EXISTING HYDRANT
- WN11 REPLACE THE EXISTING COPPER SERVICE WITH A COPPER SERVICE

TO OBTAIN LOCATION OF PARTICIPANTS' UNDERGROUND FACILITIES BEFORE YOU DIG IN WISCONSIN

CALL DIGGERS HOTLINE
TOLL FREE
811 OR 1-800-242-8511
FAX-A-LOCATE 1-800-338-3860
TDD (FOR HEARING IMPAIRED) 1-800-542-2289

WIS. STATUTE 182.0175 (1974)
REQUIRES MIN. OF 3 WORK DAYS NOTICE BEFORE YOU EXCAVATE.

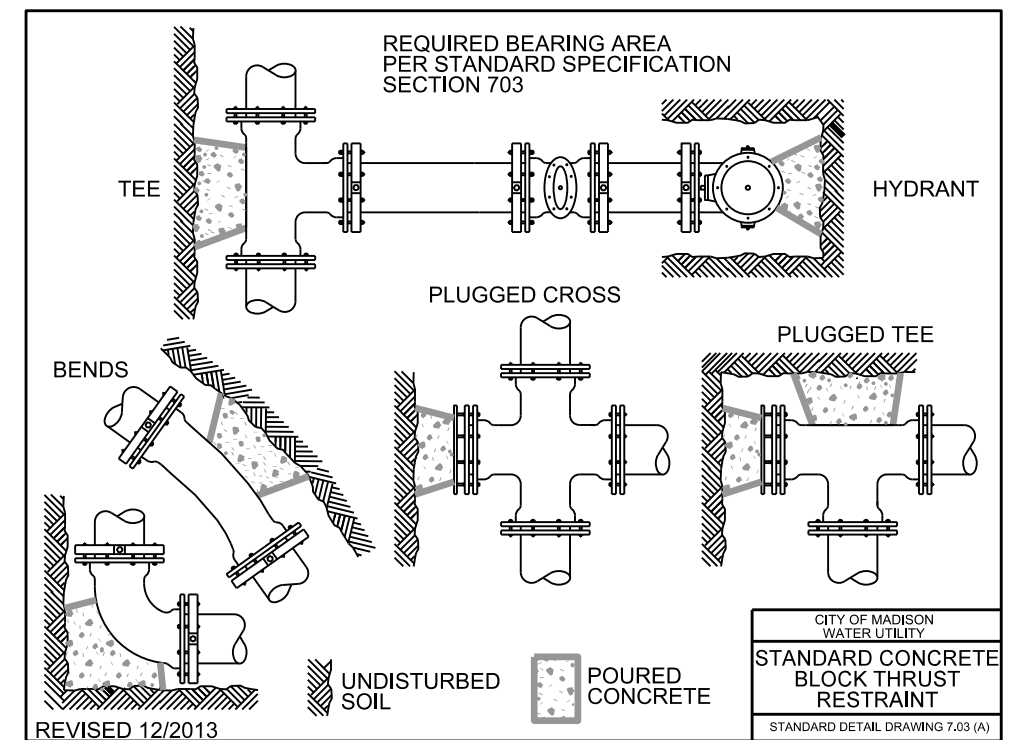
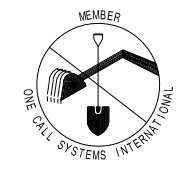

MATERIALS SUPPLIED BY CONTRACTOR*:

- 40-FT - 6-IN PIPE
- 920-FT - 8-IN PIPE
- 1,060-FT - POLYWRAP
- 2 - 6-IN VALVE & BOX
- 5 - 8-IN VALVE & BOX
- 2 - 8-IN X 6-IN TEE
- 2 - 8-IN X 8-IN TEE
- 2 - 8-IN X 6-IN REDUCER
- 4 - 5-IN HYDRANT
- 160-FT - 2-IN STYROFOAM INSULATION

SALVAGED MATERIALS*:

- 2 - 8-IN MJ PLUG
- 2 - 8-IN X 6-IN TEE

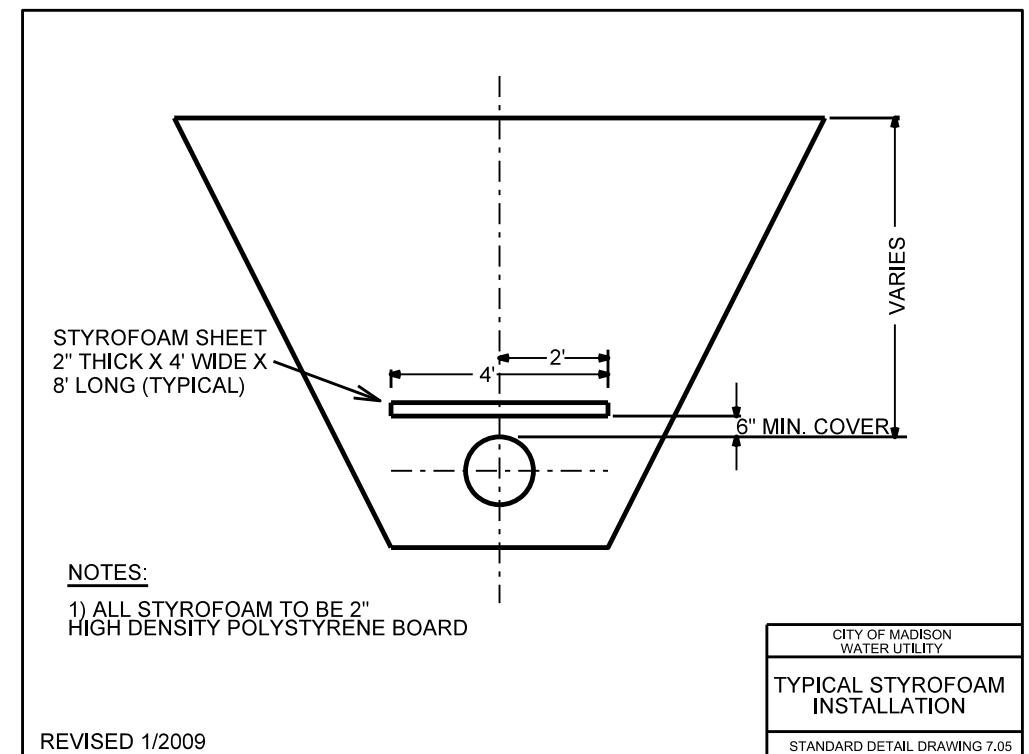
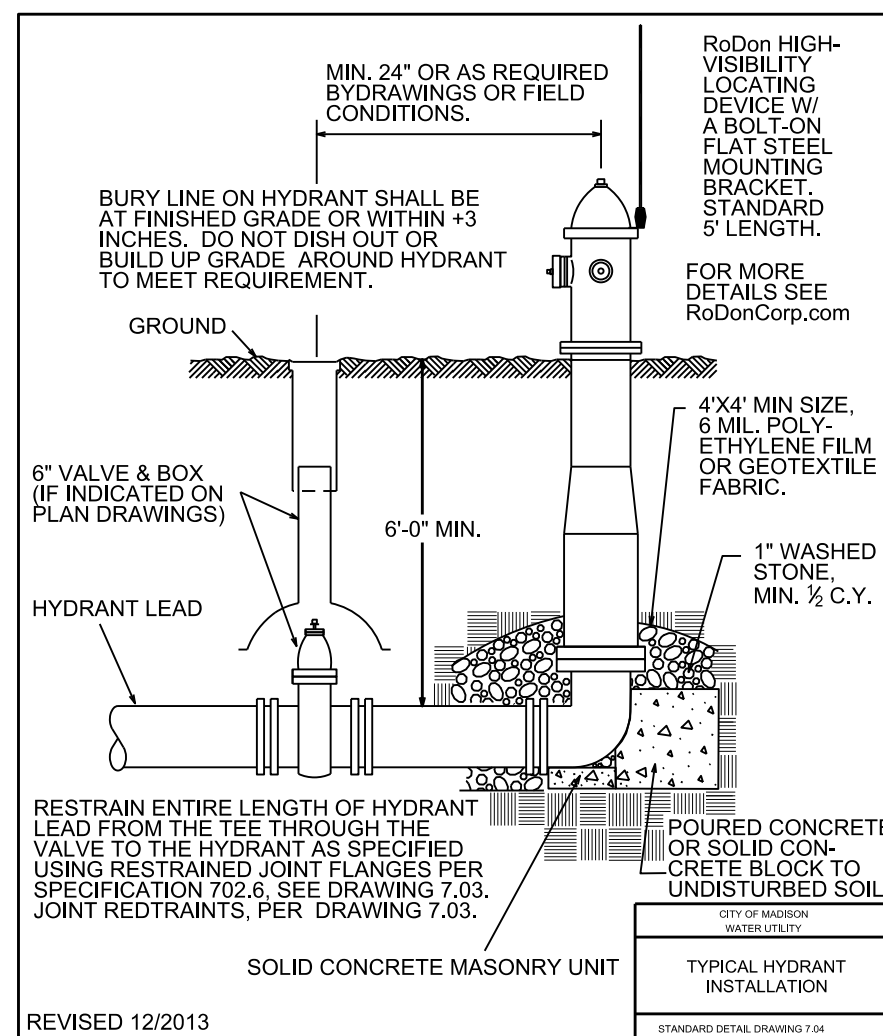

* ESTIMATES FOR INFORMATION ONLY. ENGINEER DOES NOT GUARANTEE ACCURACY OF MATERIAL TAKE-OFFS.