



AMCO

OCT 30 2023

Alcohol and Marijuana Control Office

550 W 7th Avenue, Suite 1600

Anchorage, AK 99501

amco.commoncarrierapproval@alaska.gov

<https://www.commerce.alaska.gov/web/amco>

Phone: 907.269.0350

Alaska Alcoholic Beverage Control Board

Form AB-41: Common Carrier Approval Registration

Why is this form needed?

Registration Fee: \$1,250

Per AS 04.09.750, a common carrier may not transport or deliver alcoholic beverages to a person in the state unless the ABC board has approved the common carrier.

In section two (2) of this form, a detailed diagram (or description) of the secure storage location where alcohol will be held (both prior to and after transport) is required. Your diagram (or description) must include dimensions and must show all entrances and boundaries of the premises and areas of storage.

In section three (3) of this form, you must describe how the carrier will verify age and obtain a signature of the recipient. You must also state where records of shipments of alcoholic beverages will be held and made available for inspection and audit by AMCO Enforcement.

Per AS 04.09.750(c) delivering alcoholic beverages to a person in the state shall ensure that the package containing alcoholic beverages is delivered directly to a person who:

- (1) Presents identification and acceptable proof of age under AS 04.21.050 showing that the person is 21 years of age or older; and
- (2) Provides a signature acknowledging that the person received the package.

Per AS 04.09.750(d) an approved common carrier shall make records of shipments of alcoholic beverages to persons in the state available for inspection and audit by the board.

Section 1 – Carrier Information

Name of carrier:	FedEx Ground Package System, Inc.		
Address:	1000 FedEx Drive, Moon Township, PA 15108		
Address where shipment records will be available:	1000 FedEx Drive, Moon Township, PA 15108		
Contact Name:	Quetta Brown	Contact Email:	FxgAlcoholCompliance@Fedex.com
Contact Phone:	412.859.4761		
Mode of carrier transportation:	<input checked="" type="checkbox"/> Motor Vehicle	<input type="checkbox"/> Watercraft	
	<input checked="" type="checkbox"/> Aircraft	<input type="checkbox"/> Railroad Car	



Alaska Alcoholic Beverage Control Board
Form AB-41: Common Carrier Registration Application

Section 3 - Description of Control Measures

Carrier must clearly indicate how the provisions of AS 04.09.750 (c)(1) and (2) will be met

Accepting ID: AS 04.09.750(c)(1)	FedEx policy requires alcohol shippers to identify that a package contains alcohol and to select the FedEx Adult Signature Required signature service option (ASR), which is automatically selected when a customer uses the FedEx alcohol service code. When ASR is selected, FedEx technology directs delivery personnel to review a Government issued photo identification or toher identification customarily accepted by local authorities. The technology prompts delivery personnel to scan the ID to verify the recipient is 21 or older and record the first initial of the first name and the last name. If the recipient refuses to have the ID scanned, delivery personnel completes a hand ID check, including visually confirming the date of birth on the ID. Delivery personnel cannot close out the delivery without confirming that this is done.	Obtaining signature: AS 04.09.750(c)(2)	When the Adult Signature Requires signature service option is selected, FedEx technology prompts delivery personnel to obtain the signature of the recipient. Delivery personnel cannot close out the delivery without obtaining the signature.
--	---	---	---

AMCO
 OCT 30 2023

I declare that all the information contained in this application, and evidence or other documents submitted are true and correct to the best of my knowledge. I understand that any falsification or misrepresentation of any item or response in this application, or any attachment, or documents to support this application, is sufficient grounds for denying this request for common carrier registration approval. I further understand that it is a Class A misdemeanor under Alaska Statute 11.56.210 to falsify an application and commit the crime of unsworn falsification.

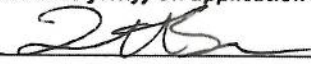
SIGNATURE: 

DATE: 10/27/2024

Board/ Director Review:

Approved Denied

Board/Director Comments:

Signature of AMCO reviewer _____

Date _____

AMCO
NOV - 4 2023

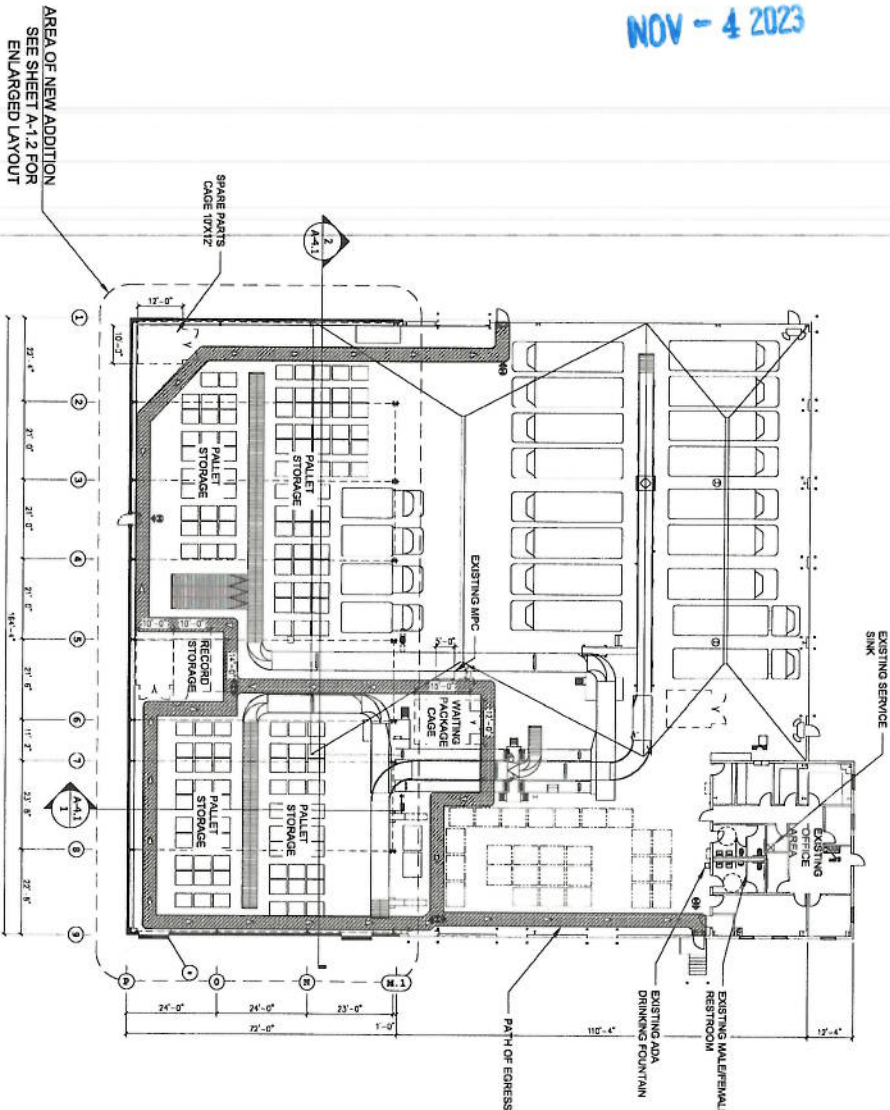

1 Ground Floor Plan
Scale: 1/8" = 1'-0"

Legend

4-3 Emergency Exit Sign with 90 second battery

9 Emergency Exit Sign with 90 minute battery

NOTE: USE HALF INDICATED SCALE FOR 11X17 DRAWINGS

General Notes

1. PERFORM ALL GENERAL CONSTRUCTION AS SHOWN AND IN ACCORDANCE WITH CODE.
2. PROVIDE ALL MECHANICAL WORK IN ACCORDANCE WITH MECHANICAL DRAWINGS PROVIDED AS REFERRED SUBMITTAL.
3. PROVIDE ALL ELECTRICAL WORK IN ACCORDANCE WITH ELECTRICAL DRAWINGS PROVIDED AS REFERRED SUBMITTAL.
4. ADJUSTMENT TO SIGNALIZATION SYSTEM WILL BE ON A REFERRED SUBMITTAL BASIS BY SPECIALTY CONTRACTOR.
5. SEE MECHANICAL DRAWINGS FOR ALL ABOVE.
6. SEE STRUCTURAL DRAWINGS AND STRUCTURAL CALCULATIONS FOR ALL FOUNDATION STRUCTURAL DESIGN.

Sheet Notes

1. *Frame dimensions not to exceed 200 FT

Wall Sections, Building Envelope Requirements-AMC

23.60	Concrete Zone 2	R-Vacuum
	Windows & Sluicings	R-3
	Ceiling	R-30 C.I.
	Exterior Frame Wall	R-20
	Roof & Dishes	R-10 C.I.

AREA OCCUPANTS AND FIXTURE REQUIREMENTS

BUSINESS AREAS	11,800 SF / 100	18 OCC
STORAGE, STOCK, SHIPPING AREAS	28,800 SF / 300	96 OCC
TOTAL OCCUPANTS =		111 OCC
FIXTURES:		
BUSINESS AREAS	8 OCC / 25	0.22 WC
	8 OCC / 40	0.21 LAV
	18 OCC / 100	0.18 DF
PROCESSING OF PRODUCTS AREAS	48 OCC / 100	0.48 WC
	96 OCC / 100	0.24 LAV
	96 OCC / 400	0.24 DF
TOTAL REQUIRED:		1 MALE & 1 FEMALE TOILET & 1 FEMALE LAV
		1 SS
		1 DF
		1 EWS

KEY TO ABBREVIATIONS

OCC-OCCUPANTS

WC-WATER CLOSETS

LAV-LAVATOIRES

DF-DRINKING FOUNTAINS

EWS-EYE WASHING STATION

SS-SERVICE SINK



NORTH

A-1.1

PROJECT TITLE: FedEx Ground Expansion
prepared for Keith A. Mathias, AM Coastal Real Estate Group
New Construction Plan
1550 Ressel Avenue Anchorage, Ak 99518



Spreng Associates Inc., AIA
Architecture & Planning ©1993

2522 Arctic Blvd, Suite #102 / Anchorage, Alaska 99503 / (907)563-5141 / FAX:279-2377
Job No: 1320 Draw By: DHC Check By: GLS Date: 11/14/2019 Revision: 1/23/2014

