



Alaska Alcoholic Beverage Control Board Beverage Dispensary Endorsement(s) Application

The new endorsement application form is required to apply for an endorsement to support your underlying license or pending license application. Applicants should review and become familiar with AS 04.09.400, 3 AAC 305.330, **Title 04 of Alaska Statutes** and **Chapter 305 of the Alaska Administrative Code**. This form must be completed and submitted along with all other required forms and documents before any endorsement application will be considered complete and placed in the queue for our licensing examiners review.

Section 1 – Establishment and Contact Information

Enter information for the **current** licensee and licensed establish.

Licensee:	Salamatof Cannery Lodge LLC	License #:	6111
License Type:	Beverage Dispensary Tourism	Doing Business As:	Salamatof Cannery Lodge
Licensee Mailing Address:	PO Box 1425		
Full Premises Address:	2291 Bowpicker Lane		
City:	Kenai	State:	AK
		ZIP:	99611
Local Governing Body:	Borough	Email:	Kate.schadle@Salamatoftribe.com

Section 2 – Endorsement(s) Requested

		Check Here
Multiple Fixed Counter Endorsement - list the number of fixed counters you will have	AS 04.09.420. A multiple fixed counter endorsement authorizes the holder of a beverage dispensary license or a beverage dispensary tourism license to sell or serve alcoholic beverages on the licensed premises from multiple fixed counters. For each new multiple fixed counter, the fee is \$1,250. The biennial fee for a multiple fixed counter endorsement is \$200	<input type="checkbox"/>
Hotel or Motel Endorsement:	AS 04.09.430. A hotel or motel endorsement authorizes the holder of a beverage dispensary license or a beverage dispensary tourism license that is a hotel, motel, resort, or similar business premises that caters to the traveling public as a substantial part of its business to sell or serve alcoholic beverages on the licensed premises, including in a dining room, banquet room, and other public areas approved by the board, and in guest rooms. The biennial fee for a hotel or motel endorsement is \$200 + \$25 application fee.	<input type="checkbox"/>
Large Resort Endorsement:	AS 04.09.440. A large resort endorsement authorizes the holder of a beverage dispensary license or a beverage dispensary tourism license that is a large resort to sell or serve alcoholic beverages from multiple locations on the resort property to guests for consumption in areas on the site of the large resort, including a dining room, banquet room, guest room, open air venue, and ingress or egress route between those areas. The biennial fee for a large resort endorsement is \$200 + \$25 application fee.	<input checked="" type="checkbox"/>
Bowling Alley Endorsement:	AS 04.09.500. A bowling alley endorsement authorizes the holder of a beverage dispensary license or a beverage dispensary tourism license to sell or serve alcoholic beverages in the concourse or lane areas of the bowling alley adjacent to the main bar area. The biennial fee for a bowling alley endorsement is \$200 + \$25 application fee.	<input type="checkbox"/>
Golf Course Endorsement:	AS 04.09.510. A golf course endorsement authorizes the owner of a golf course who has obtained a beverage dispensary license or a beverage dispensary tourism license to sell or serve alcoholic beverages on the golf course, driving range, club house and other buildings located on the course, and a vending cart carrying beverages or food to, from, or on the course, excluding the parking lot. The biennial fee for a golf course endorsement is \$200 + \$25 application fee.	<input type="checkbox"/>



Alaska Alcoholic Beverage Control Board **Beverage Dispensary Endorsement(s) Application**

The below touches on a few of the many requirements, etc. within the different endorsements. Please familiarize yourself with each of the endorsements outlined within this form.

AS 04.09.420. In addition to the fee under (b) of this section, the initial application fee for each fixed counter covered under the endorsement is \$1,250. An initial application for a **multiple fixed counter endorsement** must include an annotated drawing of the location of each fixed counter in the licensed premises.

AS 04.09.430. The holder of a beverage dispensary license or a beverage dispensary tourism license that is a **hotel, motel, resort, or similar business** premises that caters to the traveling public as a substantial part of its business may serve alcoholic beverages at a secondary location located in a building different than the licensed premises for the beverage dispensary license or a beverage dispensary tourism license if the different building. The holder of a hotel or motel endorsement shall exercise control over conduct of the business in all areas of the licensed premises.

AS 04.09.440. The holder of a **large resort endorsement** shall apply for a multiple fixed counter endorsement under AS 04.09.420 to sell or serve alcoholic beverages from multiple locations within the large resort's proper. For federal income tax purposes, the profit and loss from the licensed business conducted at locations on the resort under a large resort endorsement, other than guest rooms, must be combined or consolidated with the profit and loss from the licensed business conducted under the multiple fixed counter endorsement.

AS 04.09.500. The board may issue a **bowling alley endorsement** only if the concourse or lane areas of the bowling alley or both are (1) designated as part of the licensed premises for the beverage dispensary license or a beverage dispensary tourism license; and (2) adjacent to the main bar area.

AS 04.09.510. An application for a **golf course endorsement** must include a drawing of the golf course with an annotated illustration and a description of the portions of the course that are licensed premises and that are intended to be covered by the endorsement.

Section 3 – Areas Covered by Endorsement

Does the endorsement apply to your entire licensed premises as approved by the ABC Board?

Yes No

Does the requested endorsement expand your currently licensed premises?

Yes No

- If No, attach the approved diagram, no larger than 8 1/2" x 11" of the layout, and identify the portions of the premises covered by various requested endorsements. You must use a solid, contiguous **colored** line in any color other than red to outline the outer perimeter of the area of the premises covered by the requested endorsement(s).
- If endorsements are overlapping, provide a conspicuous means to distinguish each endorsement from the other (e.g., keyed map with varying colors for each requested endorsement).
- Your drawing **MUST** include:
 - Dimensions in feet **not** square feet of all exterior walls and major interior walls (we do not accept diagrams drawn to scale)
 - Include cross-streets
 - A north arrow, and any significant geographical features. Points of reference, such as a compass showing North.
 - All entrances, exits, walls, bars, and fixtures
- If your premises includes multiple floors, please include a separate diagram of each floor. You must identify the stairs between each floor, and each hallway/corridor that leads to each set of stairs.
- **Any endorsement applications that include outdoor space** are required to submit a security plan that includes information about the barriers, practices, and personnel that are to be used to ensure that alcohol is not introduced or removed from the permitted premises and to prevent the access of alcohol by a minor during the permitted event. A security plan may be requested for other proposed locations on a case-by-case basis.



Alcohol and Marijuana Control Office
550 W 7th Avenue, Suite 1600
Anchorage, AK 99501

alcohol.licensing@alaska.gov
<https://www.commerce.alaska.gov/web/amco>
Phone: 907.269.0350

Alaska Alcoholic Beverage Control Board **Beverage Dispensary Endorsement(s) Application**

Section 4 – Attestations

Initial

I certify that I understand that providing a false statement on this form or any other form provided by AMCO is grounds for rejection or denial of this application or revocation of any license issued.

I certify that all licensees, agents, and employees who sell or serve alcoholic beverages or check the identification of a patron will complete an approved alcohol server education course, if required by AS 04.21.025, and while selling or serving alcoholic beverages, will carry or have available to show a current course card or a photocopy of the card certifying completion of approved alcohol server education course, if required by 3AAC 305.340.

I agree to provide all information required by the Alcoholic Beverage Control Board in support of this application.

I hereby certify that I am the person herein named and subscribing to this application and that I have read the complete application, and I know the full content thereof. I declare that all of the information contained herein, and evidence of other documents submitted are true and correct. I understand that any falsification or misrepresentation of any item or response in this application, or any attachment, or documents to support this application, is sufficient grounds for denying or revoking a license, and or endorsement. I further understand that this is a Class A misdemeanor under AS 11.56.210 to falsify an application and commit the crime of unsworn falsification.

Kate Schadle

Printed name of licensee

Signature of licensee

02/20/2024

Date



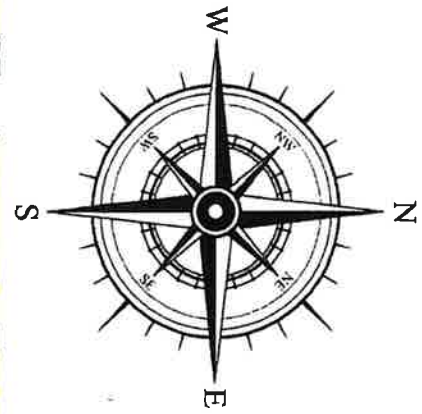

Salamatof Cannery Lodge, LLC
Outside Security Plan

Salamatof Cannery Lodge, LLC d.b.a. Salamatof Cannery Lodge is located at 2291 Bowpicker Lane, Kenai, Alaska 99611. The outside area will be used during the summer months and for special events.

There will be a manager on site at all times, and when the outdoor serving area is open (weather and staffing dependent), there will be staff walking between the indoor area, and outdoor area to monitor alcohol consumption. The outdoor area attached to the old admin building/main bar area has an enclosure that is a chain link fence and is 4 foot fencing all the way around the yard area so no one can take alcohol outside the area.

The stage area outside does not have an enclosure but wait staff and lodge staff monitor the area and a manager is always on site. Staff are always outside watching the stage area and are available for patrons.

We will have the appropriate legal signage posted stating no alcohol beyond this point. When the indoor seating area is open and the outdoor seating area is closed, doors to the outdoor seating area will be closed and used only for emergency egress. Staff in the indoor seating area will monitor, to ensure patrons do not attempt to use the outside area when it is closed.



Alcohol and Marijuana Control Office
 550 W 7th Avenue, Suite 1600
 Anchorage, AK 99501
alcohol.licensing@alaska.gov
<https://www.commerce.alaska.gov/web/amco>
 Phone: 907.269.0350

Alaska Alcoholic Beverage Control Board Form AB-02: Premises Diagram

Why is this form needed?

A detailed diagram of the proposed licensed premises is required for all liquor license applications, per AS 04.11.260 and 3 AAC 304.185. Your diagram must include dimensions and must show all entrances and boundaries of the premises, walls, bars, fixtures, and areas of storage, service, consumption, and manufacturing. If your proposed premises is located within a building or building complex that contains multiple businesses and/or tenants, please provide an additional page that clearly shows the location of your proposed premises within the building or building complex, along with the addresses and/or suite numbers of the other businesses and/or tenants within the building or building complex.

The second page of this form may not be required. Blueprints, CAD drawings, or other clearly drawn and marked diagrams may be submitted in lieu of the second page of this form. The first page must still be completed, attached to, and submitted with any supplemental diagrams. An AMCO employee may require you to complete the second page of this form if additional documentation for your premises diagram is needed.

This form must be completed and submitted to AMCO's Anchorage office before any license application will be considered complete.

Yes No

I have attached blueprints, CAD drawings, or other supporting documents in addition to, or in lieu of, the second page of this form:

Section 1 - Establishment Information

Enter information for the business seeking to be licensed, as identified on the license application.

Licensee:	Salamatof Cannery Lodge LLC	License Number:	6111
License Type:	Outdoor Recreation Lodge		
Doing Business As:	Salamatof Cannery Lodge		
Premises Address:	2291 Bowpicker Lane, Unit 12 2291 Bowpicker Lane		
City:	Kenai	State:	AK ZIP: 99611

RECEIVED
 OCT 12 2023



Alcohol and Marijuana Control Office

550 W 7th Avenue, Suite 1600

Anchorage, AK 99501

alcohol.licensing@alaska.gov

<https://www.commerce.alaska.gov/web/amco>

Phone: 907.269.0350

Alaska Alcoholic Beverage Control Board

Form AB-02: Premises Diagram

Section 2 – Detailed Premises Diagram

Clearly indicate the boundaries of the premises and the proposed licensed area within that property. Clearly indicate the interior layout of any enclosed areas on the proposed premises. Clearly identify all entrances and exits, walls, bars, and fixtures, and outline in red the perimeter of the areas designated for alcohol storage, service, consumption, and manufacturing. Include dimensions, cross-streets, and points of reference in your drawing. You may attach blueprints or other detailed drawings that meet the requirements of this form.

Hydeout

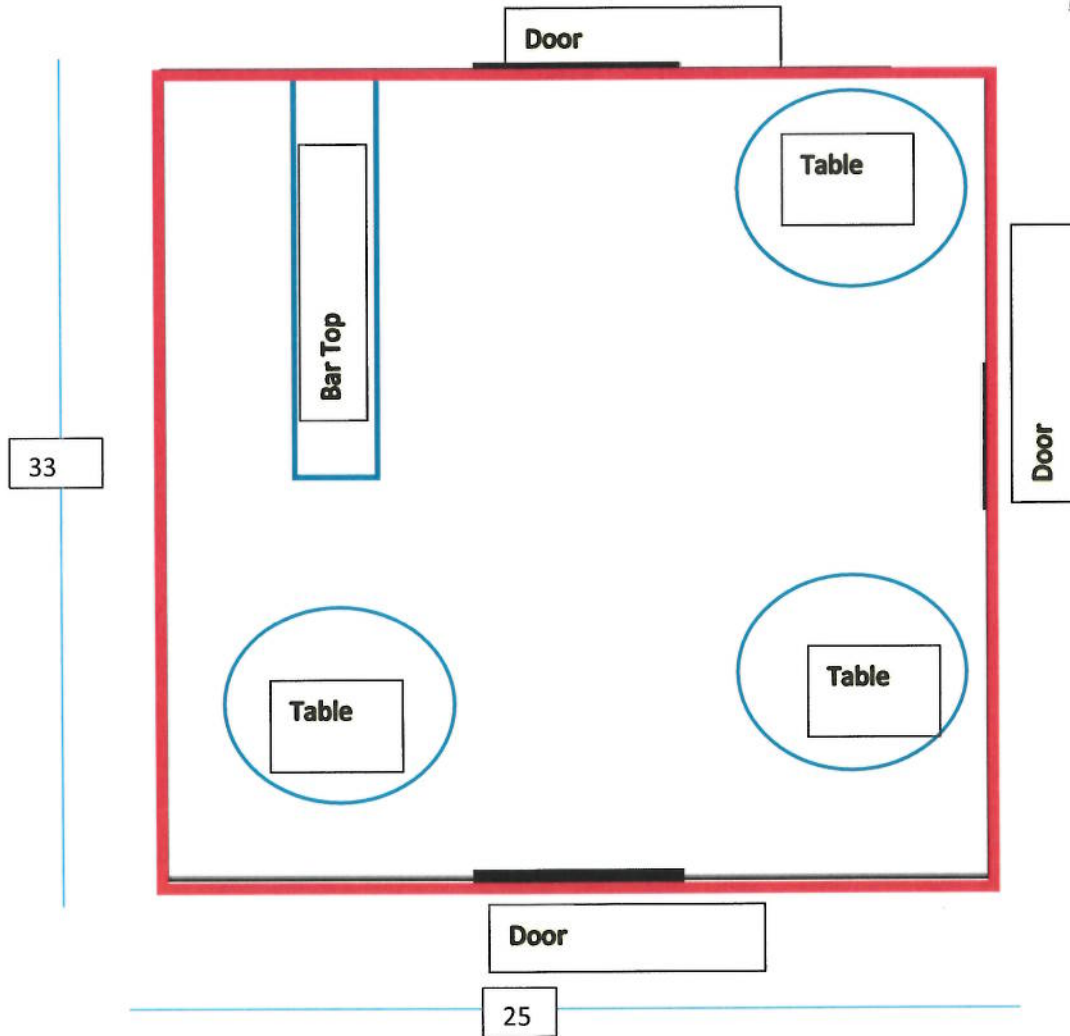
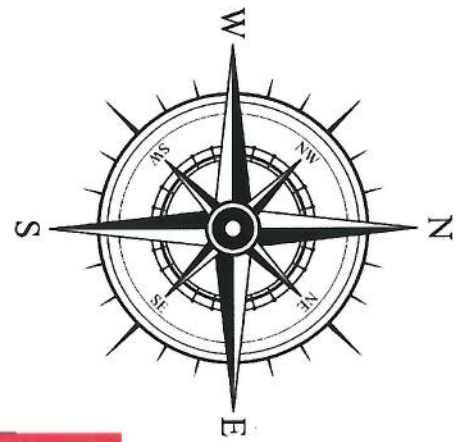

the "Hyde Out" which can be catered for small private events of 30-35 guests.

Spirit Shack

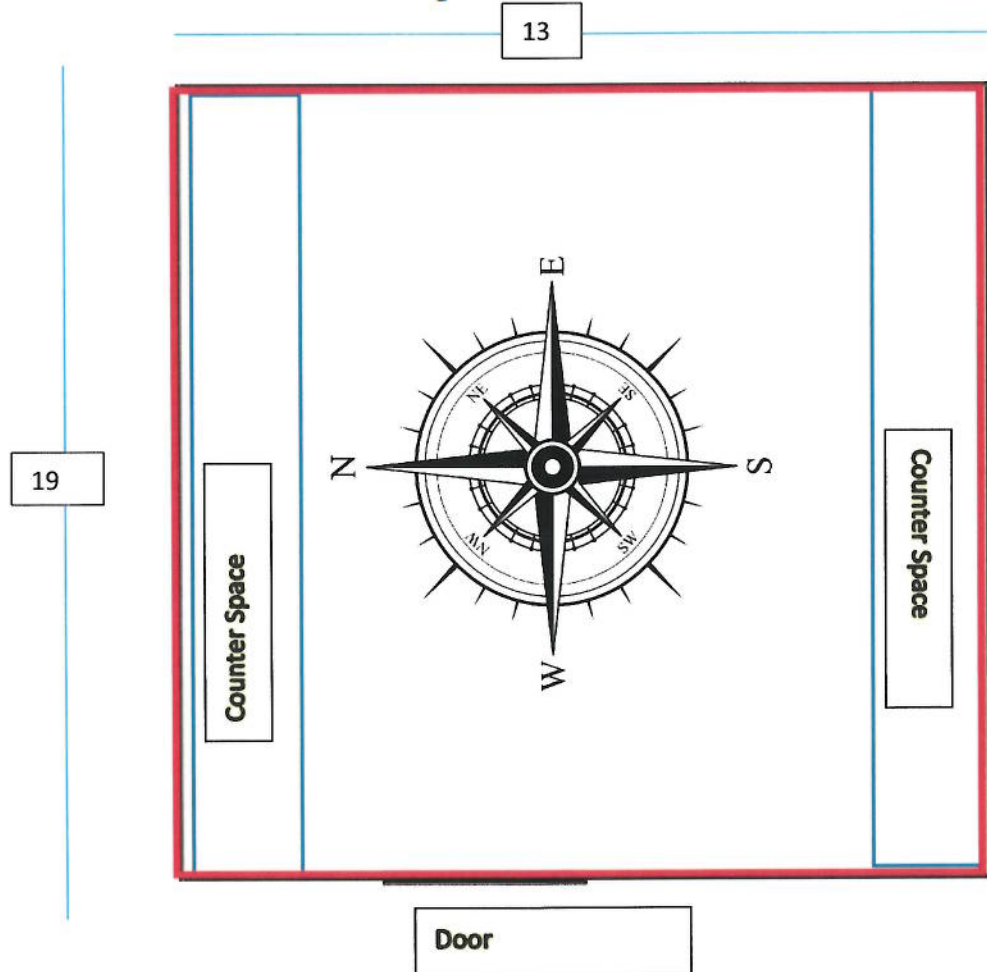

An outdoor venue with a deck overlooking the river with a small "Spirit Shack" for dispensing food and liquor. The outdoor venue space and Spirit Shack are used for weddings, concerts, and corporate parties with a capacity of approximately 300 guests. The covered stage area has a grass amphitheater with seating for 250 guests and is used seasonally for summer concerts or other events. This covered stage area may be serviced by personnel in the Spirit Shack or by a portable bar at the stage site.

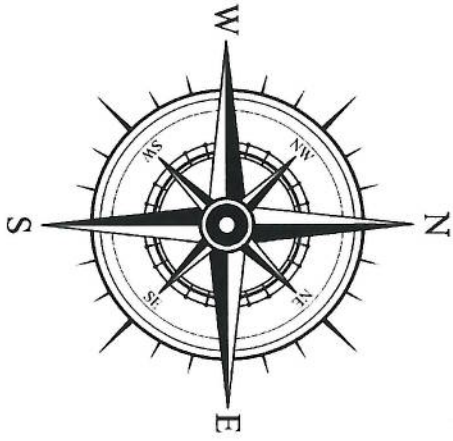

**Old Admin Building
2nd floor**

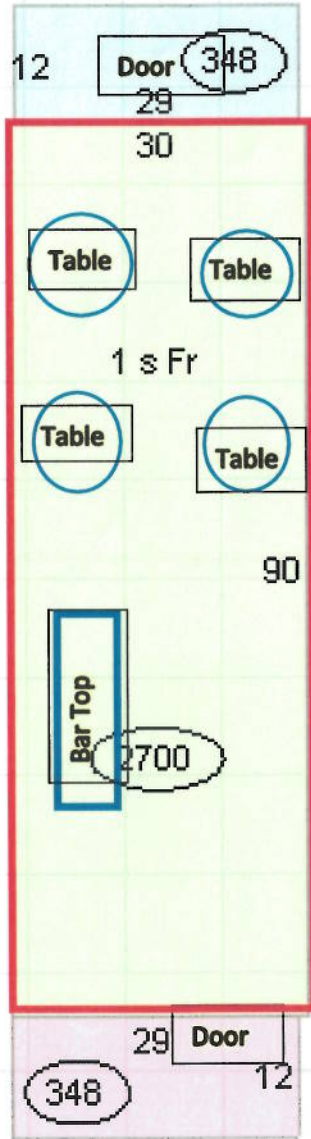

the 2nd floor of the Old Admin with a capacity of 75-100 people and contains a portable bar with approximately 2200 sq. feet of space Is used for event space.

Scale: 10 ft

Old Admin Building

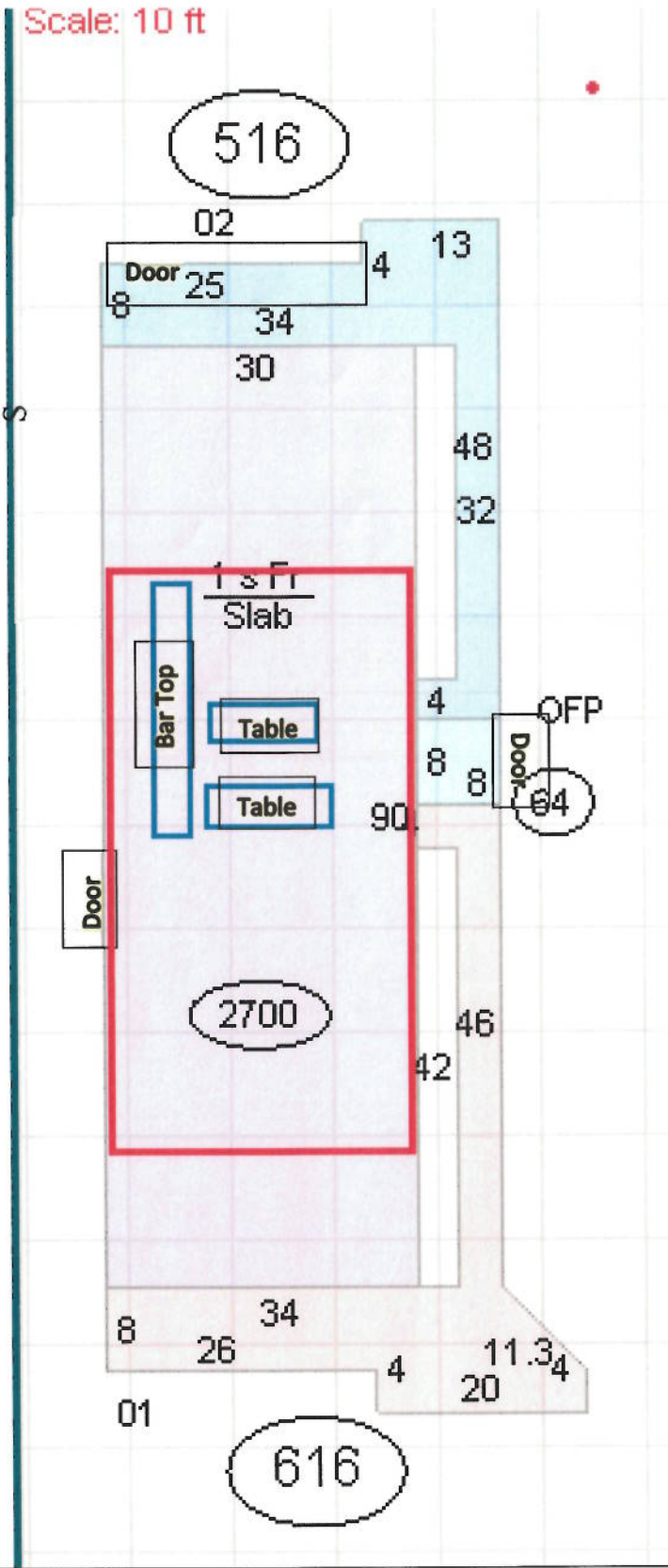
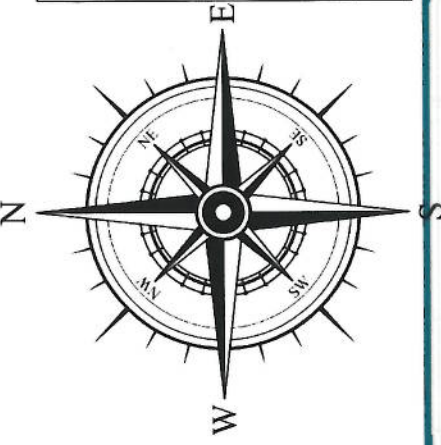

The 1st floor of the old Admin building has a full-service bar and seating for 20 guests with approximately 900 sq. feet of space.

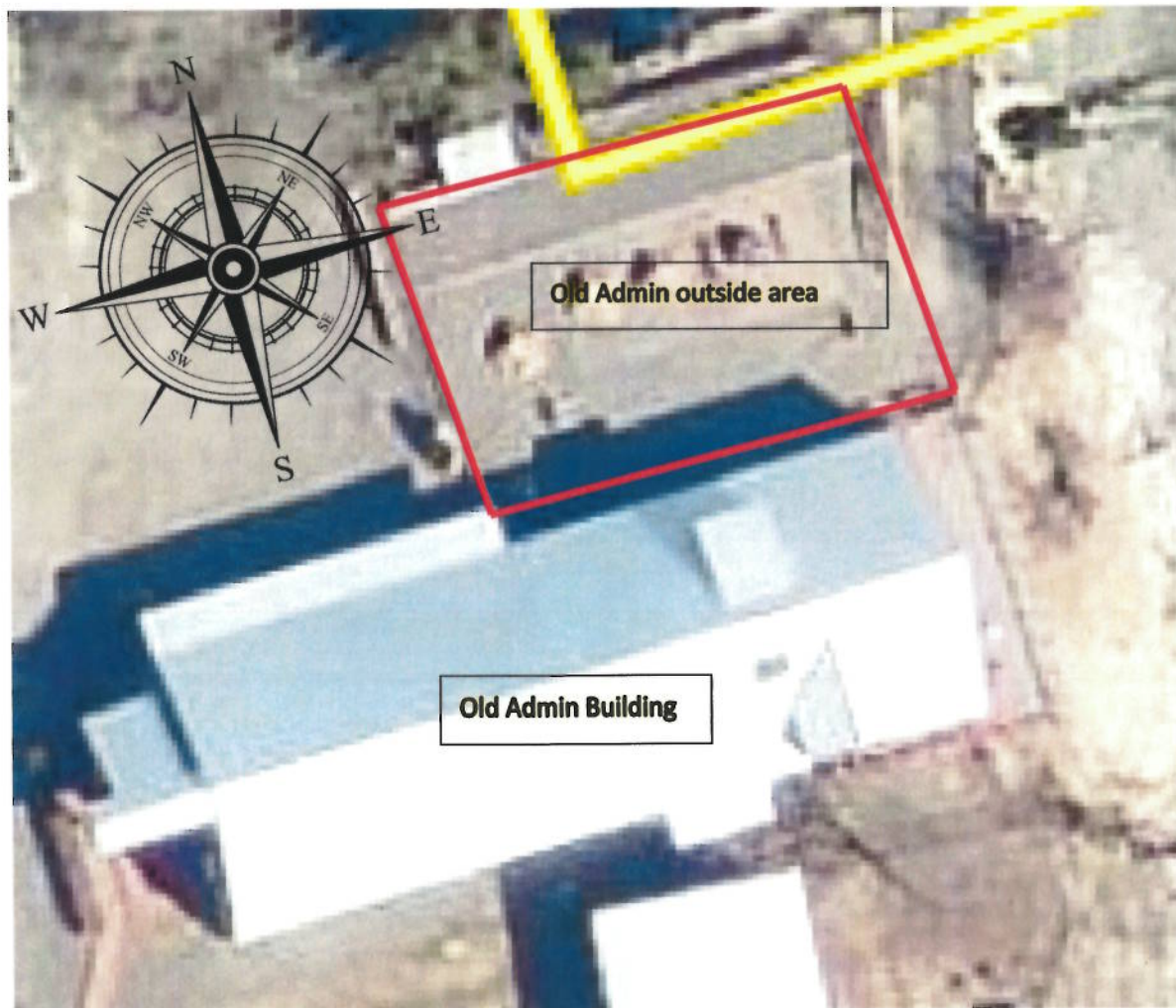

The outdoor area attached to the old admin building/main bar area has an enclosure that is a chain link fence and is 4 foot fencing all the way around the yard area so no one can take alcohol outside the area.



AMCO
12/8/22

GARAGE Alcohol Locking Cabinet

AMCO
DEC 08 2022



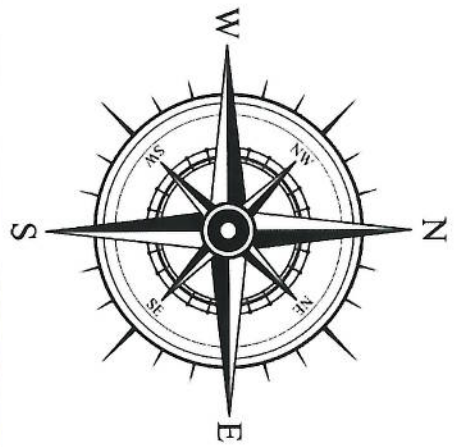

THE CANNERY LODGE – AREAS SERVING ALCOHOL

The main bar is located on the 1st floor of Cannery Lodge, Old Admin building approximately 900 sq feet for 20 guests. The event center is located on the 2nd floor of the Old Admin building with a capacity of 75-100 people and has two separate bar areas, one is portable. Approximately 2200 sq. feet of space. An additional location on the campus the "Hyde Out" can also be catered for small private events 35 people 800 sq ft , and a small "Spirit Shack" for dispensing food and liquor by the outdoor event deck as well as the stage/amphitheater with outdoor seating and covered stage.

Hours of Operation in the Bar are all seasonal variable with variable operating hours.

S/MCO

DEC 6 8 2022

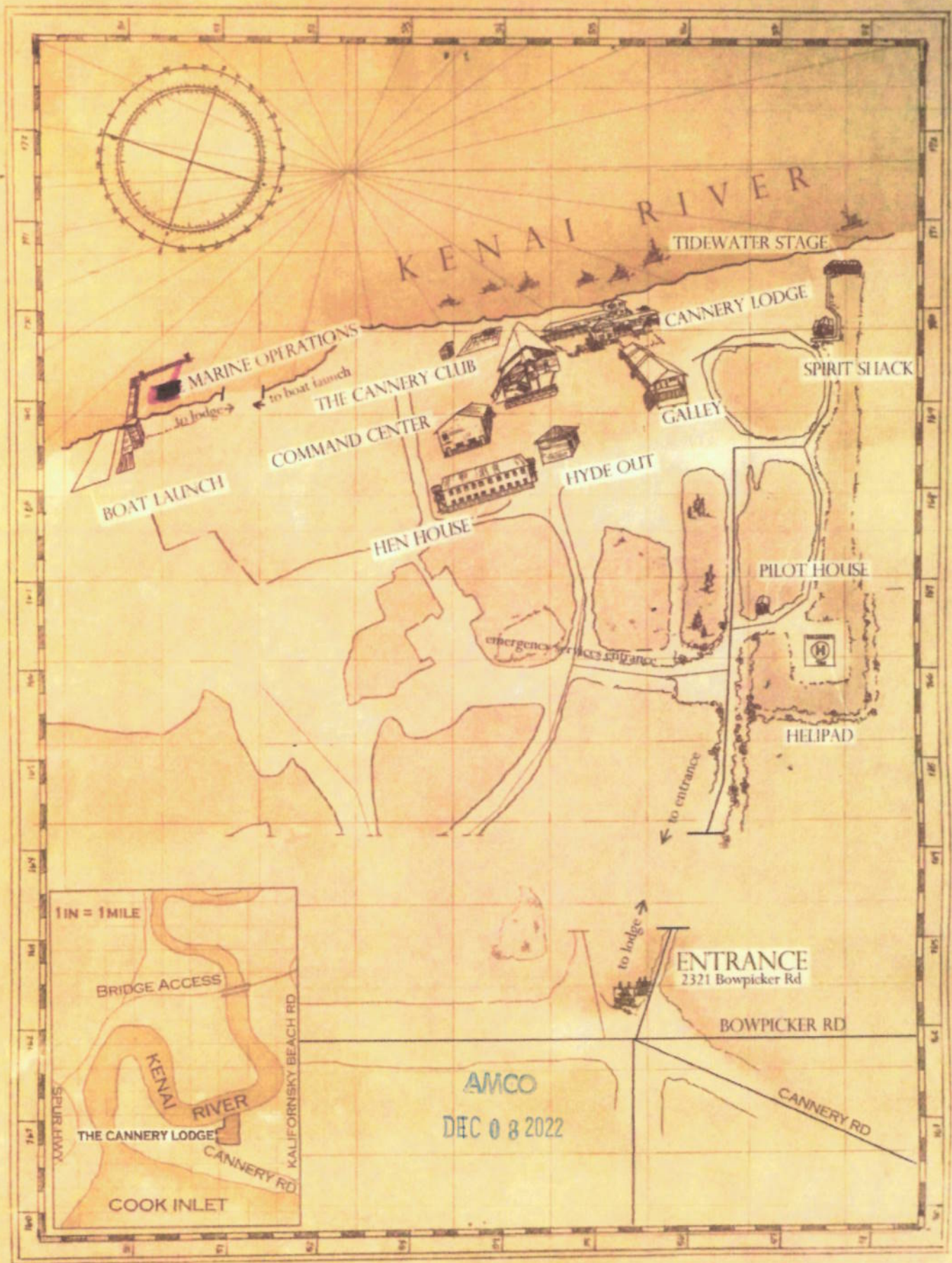

AMCO
DEC 08 2022

Previously Approved
Site map by ABC
for Ref. only

EXHIBIT B

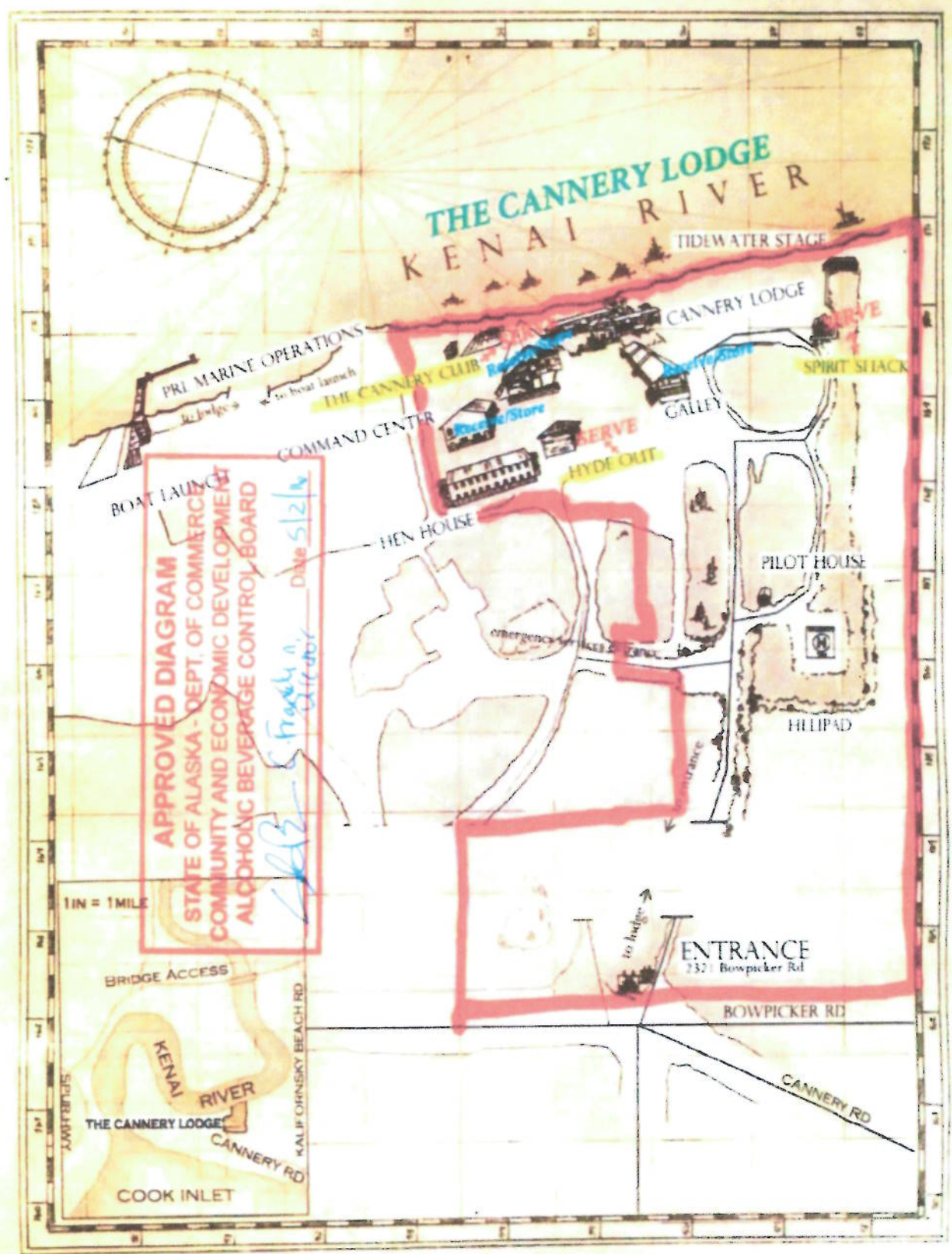

AMCO
DEC 08 2022

SPIRIT
SHACK

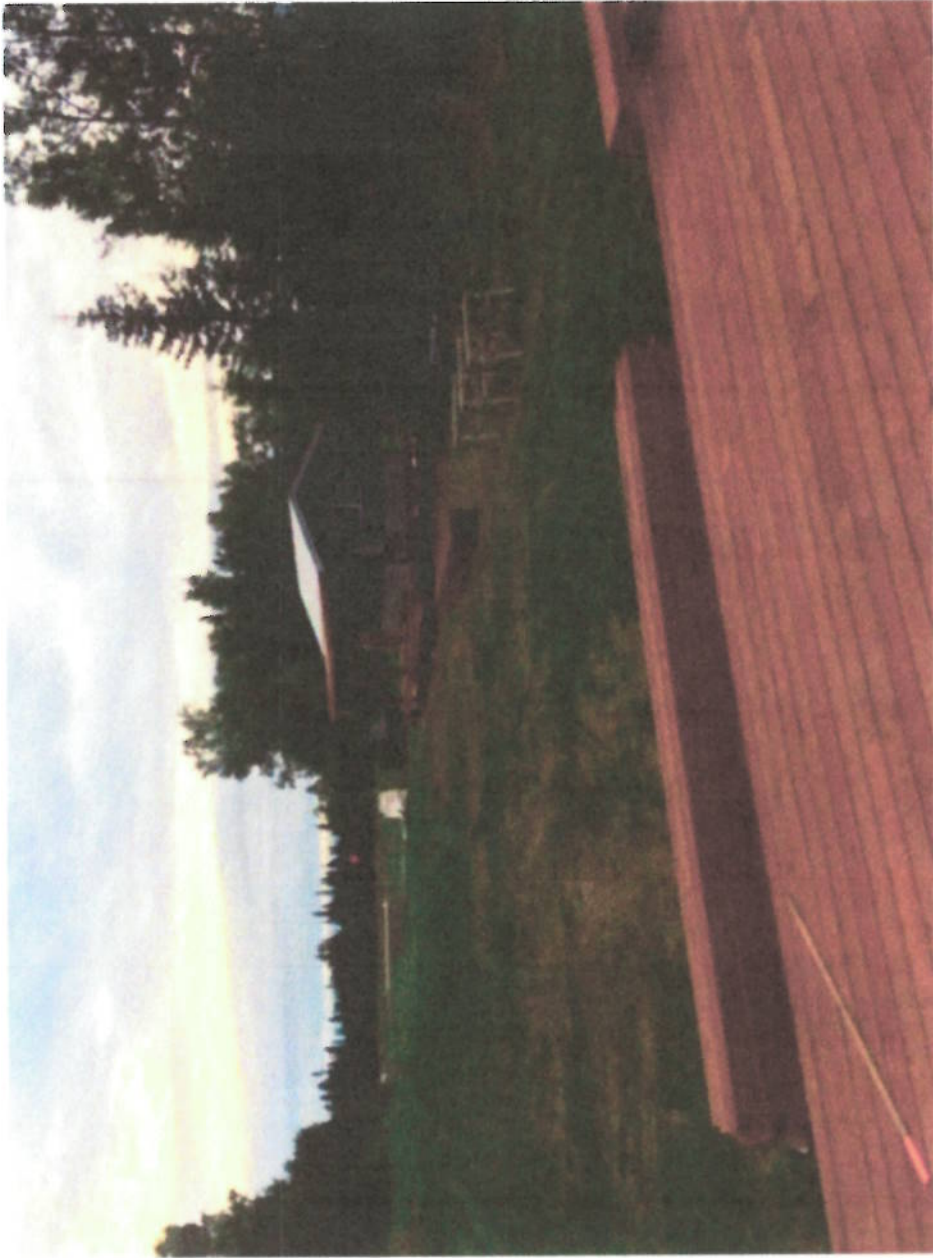

AMCO
DEC 08 2022

STATEMENT OF OPERATION
Salamatof Tribe Cannery Lodge
2022 SUMMARY

In 2022 Salamatof Tribe acquired this commercial facility in Kenai, Alaska on the Kenai River. The setting is a historical cannery site at the old Libby, McNeil and Libby Cannery. The Cannery was eventually sold to Columbia Wards in 1950, becoming Wards Cove Packing in the 1980s.

The previous owner extensively remodeled the various historic cannery buildings. The facility includes an administration building with an event center, several lodging facilities with 38 rooms for client personnel and guests, a kitchen and dining facility for our guests, a small venue event center Hyde-out, several outdoor event areas including a covered stage and amphitheater, an outdoor deck and lawn venue with Spirit House, a garage and warehouse, a private FAA certified Helipad, and a permanent commercial dock on the Kenai River.

The original Lodge opened in early 2015. The current facility is 100% owned by Salamatof Tribe. A new lodge liquor license to sell and dispense alcohol to our guests and for private catered events such as weddings, holiday dinner parties, corporate annual meetings, outdoor concerts and corporate retreats is currently in process.

The Lodge Property is open eight months out of the year generally (May through December), however, special events may be booked at the lodge in the off-season period for private and corporate clients. Staff employees are on site during all operations. The access to the campus is secured with a key-code lock at the front gate. The secure entrance and driveway are exclusively used for this property.

The Event Center is located on the 2nd floor of the Old Admin with a capacity of 75-100 people and contains a portable bar with approximately 2200 sq. feet of space. The 1st floor of the old Admin building has a full-service bar and seating for 20 guests with approximately 900 sq. feet of space. Additional locations on the campus serving alcohol are at the "Hyde Out" which can be catered for small private events of 30-35 guests, an outdoor venue with a deck overlooking the river with a small "Spirit Shack" for dispensing food and liquor. The outdoor venue space and Spirit Shack are used for weddings, concerts, and corporate parties with a capacity of approximately 300 guests. The covered stage area, has a grass amphitheater with seating for 250 guests and is used seasonally for summer concerts or other events. This covered stage area may be serviced by personnel in the Spirit Shack or by a portable bar at the stage site. Several bartenders and several servers work these functions. All personnel involved have completed TAPS training and a bar manager is the administrator for these operations. Hours of operation for these various facilities are variable within the legal liquor service periods of operation.

Several indoor/outdoor concert events may take place. The indoor concerts are generally held in the 2nd floor reception area and the outdoor concert events held on summer weekends are held at the outdoor stage. Gates opening at 4 PM, closing time is generally 11 PM.