



TEANAWAY

Then and Now









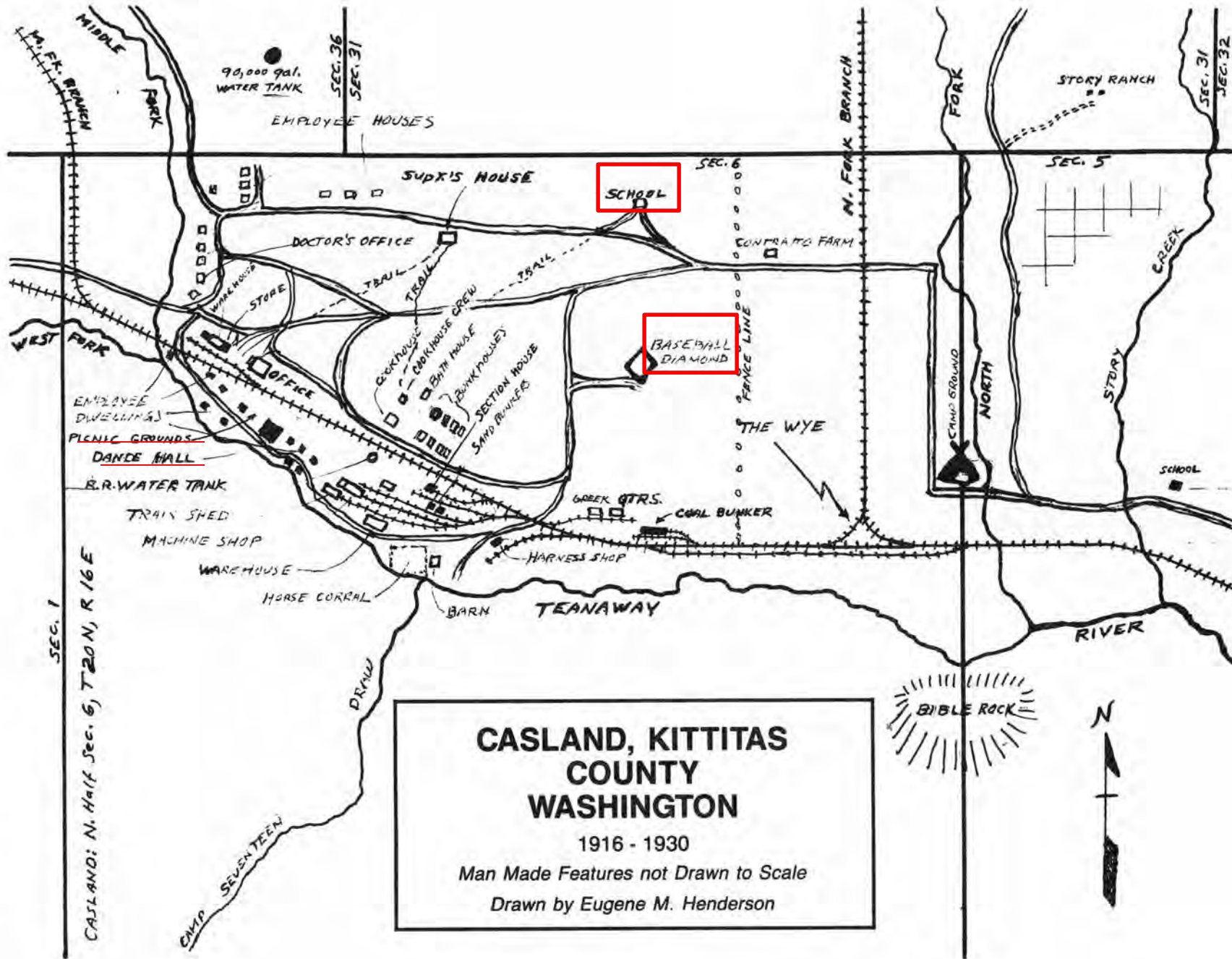

**CASLAND, KITTITAS
 COUNTY
 WASHINGTON**
 1916 - 1930
 Man Made Features not Drawn to Scale
 Drawn by Eugene M. Henderson



Casland School 1928

Mr. & Mrs. Waterhouse, teachers



C.H.
1928



Casland bunkhouse district. Opposite the four visible ones are four more. Building to the left among some trees is the cookhouse. 1926. (Photograph courtesy of Jack Whitnall.)



Casland's railyard. The twin 70 ton Shays on the left. Rod engine No. 489 and caboose on right. Locomotive repair shop in background. The warehouse on left. Section house mid foreground. Sand bunkers to the left. (Photograph by Rolfe Whitnall 1926, courtesy of Jack Whitnall.)



70-ton three-truck Shay, Casland, Washington 1930. (Photograph by Eugene M. Henderson.)



Locomotive repair shop, train shed on left. Casland, Washington about 1920. (Photograph courtesy of Jack Whitnall.)



Company Camp # 30
Lick Creek



Bill Taylor's camp on Lick Creek. 1927. (Photograph courtesy of the Ellensburg Public Library.)



017



017



Teaway Campground

07.02.2017

07.02.2017



2017



17



07.02.2017

Teaway Campground

07.02.2017



West Fork Swimming Hole



West Fork Parking

07.08.2017







Parking at Dickey Creek Road

07.08.2017

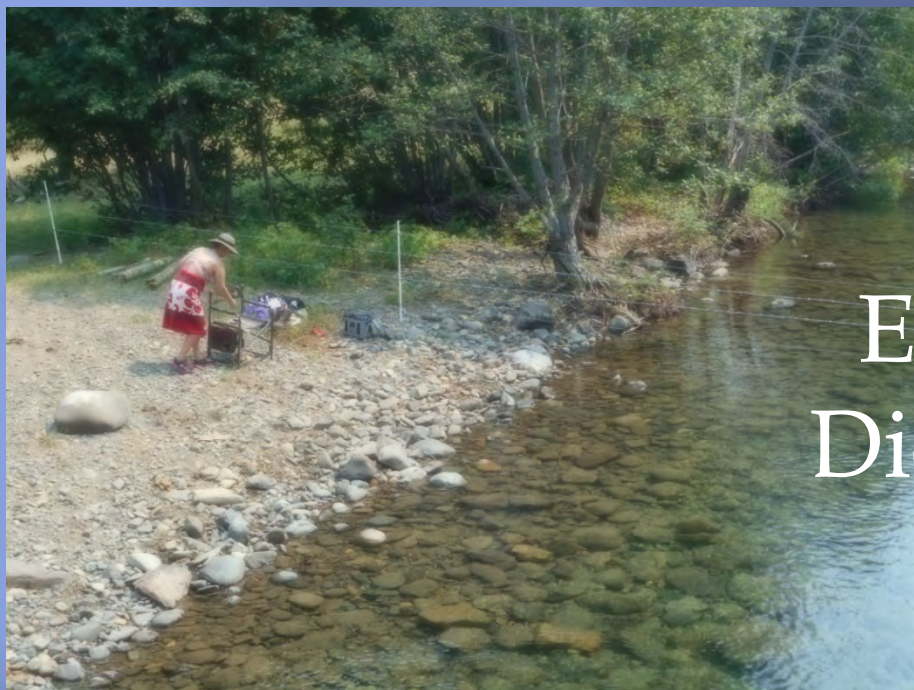

Enjoying river at Dickey Creek Bridge





29 Pines Campground

07.02.2017



29 Pines Campground

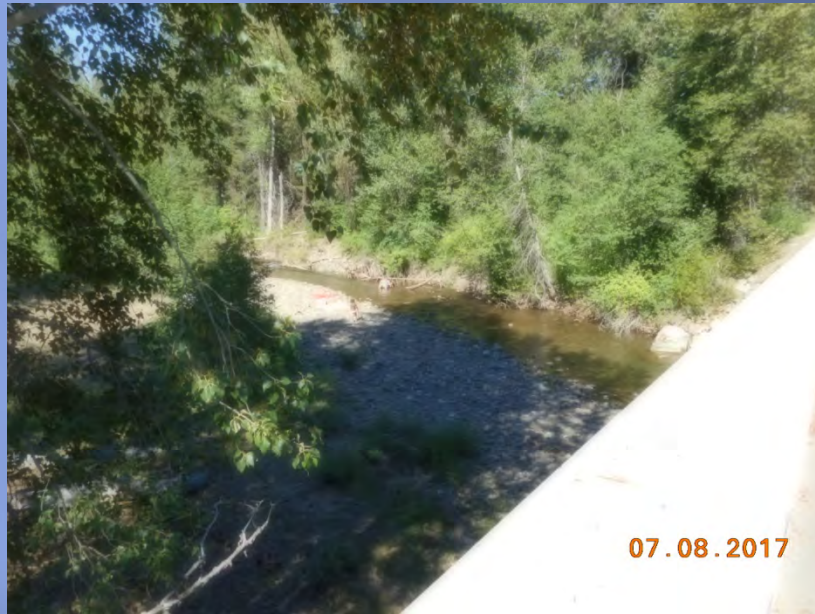

North Fork Bridge at 29 Pines

Parking Lot





Need a Discover Pass?

Discover Pass is required for all vehicles entering state parks and forests. It provides access to over 200 state parks and forests, including Teanaway Community Forest.

For more information, visit www.wa.gov/discoverpass

TEANAWAY COMMUNITY FOREST

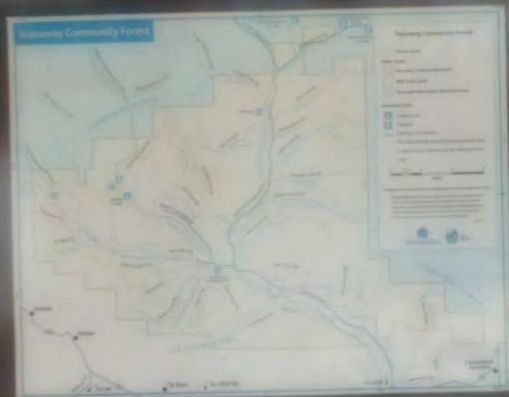

TEANAWAY COMMUNITY FOREST SUMMER RECREATION 2014

Discover the beauty of Teanaway Community Forest with our summer recreation guide. This guide provides information on trails, campsites, and other recreational opportunities available in the forest.

Trails: The forest offers a variety of trails for hikers and equestrians. Popular trails include the Teanaway Loop, the Clear Fork of the Wenatchee River, and the Teanaway Campground Loop.

Campsites: There are several campsites available in the forest, including the Teanaway Campground and the Clear Fork of the Wenatchee River Campground. These campsites offer a variety of amenities, including picnic tables, fire rings, and restrooms.

Other Recreation: In addition to hiking and camping, the forest offers a variety of other recreational opportunities, including fishing, bird watching, and horseback riding.

Rules

Use your common sense and respect. Leave no trace and follow these rules:

- Leave No Trace:** Leave what you find. Take only what you need. Pack out what you bring.
- Wilderness:** Stay on designated trails. Do not cut or break branches.
- Wildlife:** Do not feed or approach wildlife. Observe from a safe distance.
- Fire:** Use fire rings only. Do not burn trash or other debris.
- Alcohol:** No drinking or use of alcohol in designated areas.
- Smoking:** No smoking in designated areas.
- Weapons:** No weapons.

Attention



Horses allowed in horse camping area or day use area only



No Building Rock Fire Rings

FIRES IN DESIGNATED PITS ONLY



NO ORVs

Teanaway Community Forest

Discover the beauty of Teanaway Community Forest with our summer recreation guide. This guide provides information on trails, campsites, and other recreational opportunities available in the forest.

Get Involved

Join our volunteer group and help us maintain the forest. We need your help to keep the forest in good shape and provide a safe and enjoyable experience for all visitors.

Map of Teanaway Community Forest

Download the map of Teanaway Community Forest to your mobile device. This map provides information on trails, campsites, and other recreational opportunities available in the forest.

NOTICE SPRAY AREA

For more information, contact the Forest Ranger at 509-895-2222 or visit www.wa.gov/forests

07.02.2017





Jack Creek Road



Acclimation Ponds





07.05.2017

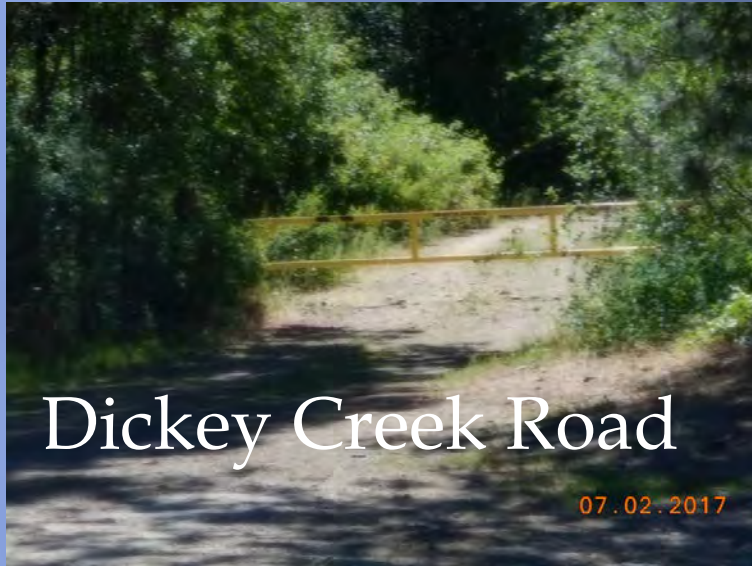

Locked Gates





- Parking at Indian Creek, Dickey Creek, and Middle Creek
- Restrooms at all parking areas
- Open Dickey Creek to Highway 97
- Open West/Middle Fork to Lake Cle Elum
- Preserve History of Casland and Logging in Teanaway
- More signs needed
- Create loops, connector trails in North Fork to relieve some of pressure on Middle Fork and West Fork . Create it and they will come.
- Picnic or Campground at Dickey Creek

Acknowledgements:

- Bussoli, Grace. Interview 2017
- Downs, Lily and Max. Powerpoint assistance
- Henderson, Eugene. PINE TREE EXPRESS 1990
- Workman, Walter. Four L Lumber News April 1931
- Historic Photographs Courtesy of Ellensburg Public Library