



Paralyzed Veterans of America

SUMMIT + EXPO 2024

Promoting Excellence, Supporting Clinicians

Anaheim, CA • August 25-28, 2024

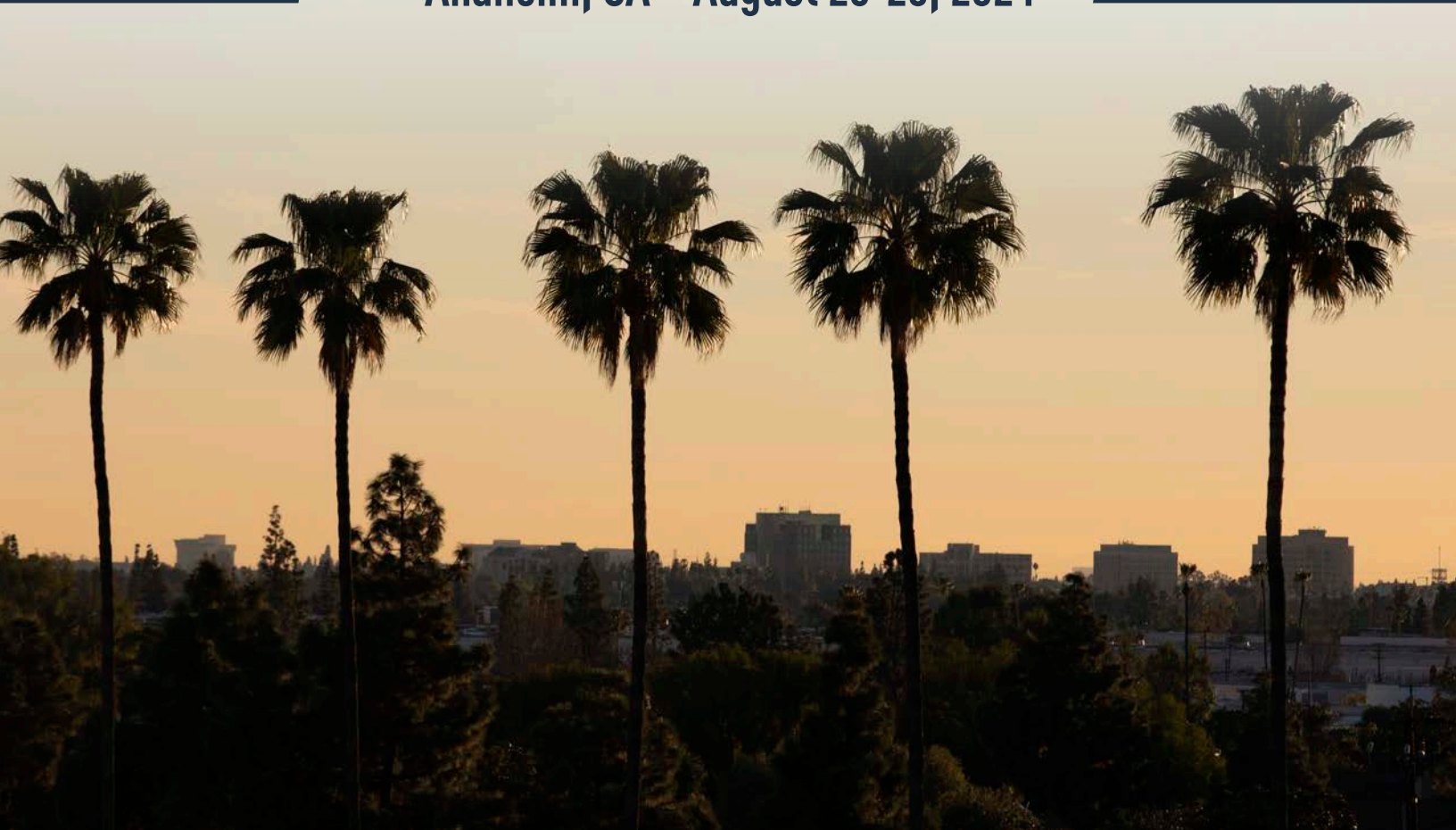

CITY HALL

ANAHEIM CITY HALL
200 S. ANAHEIM BLVD.

TABLE OF CONTENTS

- Welcome Letter 2
- About Summit 4
- Summit Awards 7
- Keynote Speakers 9
- Summit Sponsors 14
- Expo Schedule 15
- Expo Hall & Booths 16
- Summit Agenda 20
- Faculty List 34
- Poster Presentations 40
- Sponsor Symposiums 45
- Continuing Education & Accreditation Statements 46

Table of contents is not reflective of all program content.

PHOTOGRAPHY, SOUND AND VIDEO RECORDING IN PROGRESS

Your attendance and participation at this PVA event constitutes your consent and release to be photographed or recorded on audio or video media during the event. Such photographs, audio recording, or videography may be published, exhibited or displayed in printed or electronic form for purposes of promotion, marketing, education or publicity by PVA, or by third parties to whom PVA provides such photographs, sound or video recordings. By attending and participating in this event, you grant your consent to, and unconditional release and waiver against liability for the use of your likeness, image or sound of your voice, to PVA or such third parties.



WELCOME LETTER

Dear Summit Attendees:

Welcome to Paralyzed Veterans of America's 12th annual Summit and Expo in Anaheim! We are so excited to be here with you this week and to be just an hour south of Birmingham Veterans Administration Hospital, where not only PVA was born 78 years ago, but also where the first group of Veterans with spinal cord injuries from World War II received their treatment and rehabilitation.

PVA's Healthcare Summit began with one goal in mind: to streamline the process for clinicians working in the field of SCI/D – including multiple sclerosis, amyotrophic lateral sclerosis, and neurology – by helping them access the latest in research and technology to better serve their patients. We have maintained that commitment for more than a decade now and have transformed this Summit into one of the nation's premier SCI/D conferences.

As the only healthcare conference in the country that provides continuing education for SCI, MS, and ALS in one event, it is my hope you spend the next few days learning as much as you can about the newest innovations, technology, and research available. I also encourage you to get to know your fellow attendees who care for our most catastrophically injured Veterans and others living with SCI/D, as well as our sponsors and exhibitors who are onsite to help.

PVA takes immense pride in being a leader in SCI/D education and research, and a critical part of that is advocating for and supporting clinicians who provide the best specialized care for our members. As an individual living with SCI, I am eternally grateful that there are people, like you, who are dedicated to making my life and the lives of my peers better.

Whether you provide care within the Department of Veterans Affairs or at a community medical facility, whether you're new to this field or a seasoned expert, thank you for being here. Thank you also for your commitment to helping your patients live independent, meaningful lives. Your presence here matters and the work you do to improve the quality of life of those living with SCI/D matters even more.

SINCERELY,

Robert Thomas, Jr.

National President and Chairman of the Board,
Paralyzed Veterans of America



WELCOME
TO
ANAHEIM



ABOUT SUMMIT

PVA Summit + Expo

Since our founding over 75 years ago, Paralyzed Veterans of America has worked hard to ensure the highest quality, specialized medical care for our nation's Veterans living with spinal cord injuries and diseases, like MS and ALS. We have also expanded that commitment through the annual Healthcare Summit and Expo. PVA's Summit is an intensive, four-day learning and sharing experience that provides the most current and vital information, state of the art research, and emerging science related to SCI/D. Attendees representing multiple disciplines from both the Department of Veterans Affairs and private health-care institutions come together to network, collaborate, and share knowledge, which can be put to immediate use in improving the lives of patients with SCI/D.

With its collaborative, holistic team approach to improving patient care, PVA's Healthcare Summit & Expo is one of the most sought-after SCI/D conferences in America each year. The event offers a platform not only for collaboration among the many professionals who provide SCI/D care, but also for advancing science and treatment. In a concerted effort to support new therapies, treatments, and potential cures for paralysis, as well as advance care and education of SCI/D professionals, PVA's Healthcare Summit has provided more than 2,800 scholarships for clinicians and funded more than 600 presenters to participate in state of the science continuing education.

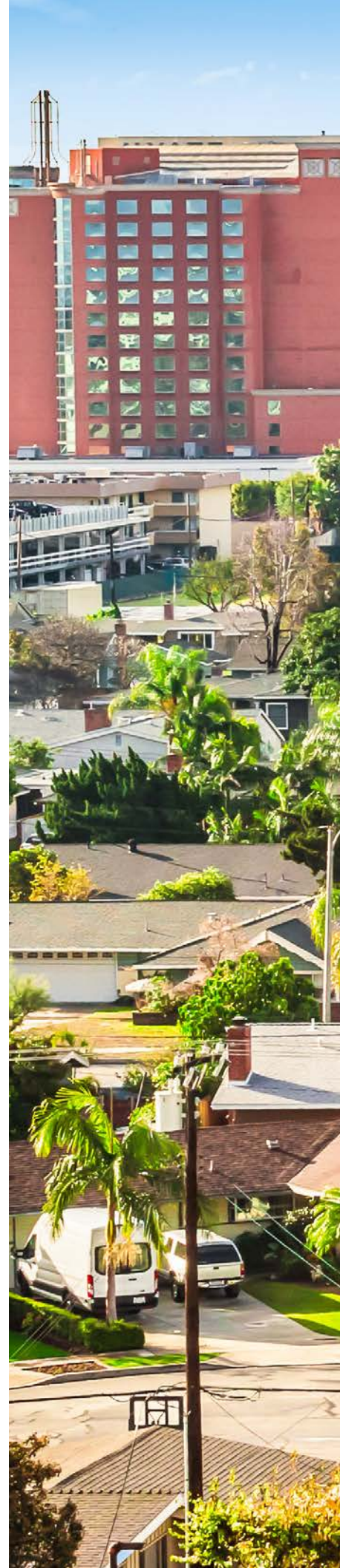



SUMMIT HIGHLIGHTS

PVA Summit + Expo

Interdisciplinary Approach

Often individuals with catastrophic injuries or spinal cord-related diseases must manage secondary conditions that accompany paralysis. When care is not a coordinated team approach, those conditions can reduce quality of life and even become life-threatening. Thus, care for individuals with SCI/D requires a holistic approach. Collaboration among a multidisciplinary team of health professionals is critical.

For more than a decade, PVA's Healthcare Summit has promoted such an approach by convening physicians, nurses, psychologists, social workers, therapists, researchers, pharmacists, dietitians, and educators to present best practices and evidence-based models, share experiences and challenges with fellow peers, and exchange knowledge that advance SCI/D care.

Network

PVA's Summit and Expo encourages learning, advancing science, and building relationships that improve overall patient care. The Summit also offers unmatched opportunities to expand knowledge and provide "take home" practices that will help every attendee immediately integrate care for their patients.

With more than 500 of the world's brightest minds together and dedicated to advancing the care of individuals with SCI/D, virtually every presentation highlights the latest developments in clinical practice, research, and emerging technologies. All attendees are encouraged to build a "lifeline" of resources by accessing their peers' specific areas of expertise and becoming a lifeline for others who share a commitment to optimizing care for the most vulnerable patient population.



DOWNLOAD THE MOBILE APP!

The app is the go-to resource for information about events, speakers, and more.

It offers real-time schedule updates, sponsor symposium times and topics, and an expo floor plan for locating exhibitors/sponsors. Important notifications will be sent out via the app throughout the event.



- **Go-to Resource for Summit Information**
- **Interactive Expo Guide and Floor Plan**
- **Real-time Schedule Updates**
- **Notifications Throughout the Week**

Download Online at: <https://rb.gy/zim3s>
or via the Apple Store
or Google Play Store



SUMMIT AWARDS

Clinical Excellence Awards



Paralyzed Veterans of America established the Clinical Excellence Awards in 2013 to recognize clinicians for exceptional professional achievement, contributions and advocacy in SCI/D including MS and/or ALS healthcare. We selected six individuals who consistently seek to expand care for those who need it, are regularly accessible and available with compassionate care to their patients, are innovative in developing solutions for patients, and who reach their hand out to those coming behind them, mentoring and developing our next generation of caregivers.



Stephanie A. Matthews, LCSW-S
SCI/D Program Coordinator,
ALS Social Worker,
Central Texas VAMC



Dianna L. Neal, MD
Staff Physician,
SCI/D Outpatient Clinic,
Charlie Norwood
VAMC Augusta



**Anna Toth, BAN, RN,
MSN, GNP**
SCI/D Nurse Practitioner,
Minneapolis VA Healthcare
System



Leah Darling, LCSW
ALS Coordinator,
Richard L. Roudebush
VAMC Indianapolis



Cesar A. Colasante-Garrido, MD
SCI/D Physiatrist,
Syracuse VAMC
and SUNY PM&R



Marika Hess, MD
Associate Chief SCI/D Service,
VA Boston Healthcare System

SUMMIT STAFF



Summit Program Committee

- Kenneth Lee, MD
Committee Chair
- April Conway, NP
- Colleen Counsell, MSN
- Jodie Haselkorn, MD
- Jake Herzog, RN
- Maureen Jennings, DPT
- Bill Lawson
- Heidi Maloni, PhD
- Kim Monden, PhD
- Jeri Muse, PhD, DAAPM
- Huned Patwa, MD
- Alicia Sloan, MSW
- Cheryl Vines, MS*
- Angela Weir, RN

PVA Summit Task Force

- Lindsay Perlman, MPH
Summit Task Force Co-Chair
- Hannah Buchholz
Summit Task Force Co-Chair
- Noel Abizo
- Brad Coleman
- Shakira Douglas
- Jonathan Franklin
- Shyanne Hardy
- Jennifer Hill
- Jennifer Massey
- Rachel Nelms
- Kristina Packard
- Marisa Ramos
- Oname Thompson
- Angela Weir
- Joyce Williams

Special thank you to recently retired Cheryl Vines, MS, who led the Summit Task Force from 2016–2024.

Conference Registration Desk Hours

Located at the Platinum Registration Desk

Sunday, August 25	12:00 p.m. – 7:00 p.m.
Monday, August 26	7:00 a.m. – 8:00 a.m.
.....	10:00 a.m. – 5:00 p.m.
Tuesday, August 27	10:00 a.m. – 5:00 p.m.
Wednesday, August 28	10:00 a.m. – 2:00 p.m.



KEYNOTE SPEAKERS

DAVID PUTRINO, PT, PhD

Director of Rehabilitation Innovation,
Mount Sinai Health System, NY, NY

Professor of Rehabilitation and Human Performance,
Icahn School of Medicine at Mount Sinai



David Putrino, PT, PhD, was trained clinically as a physical therapist before completing a PhD in Neuroscience. He worked as a clinician in Australia, before moving to the United States to study computational neuroscience at Harvard Medical School, MIT, and NYU. He is currently a Professor of Rehabilitation and Human Performance at the Icahn School of Medicine at Mount Sinai. He works to develop innovative technology solutions for individuals in need of better healthcare accessibility. His work spans the ability spectrum: ranging from helping completely paralyzed people achieve autonomy using novel brain computer interfaces to partnering with organizations such as the US Olympic Team, the Brooklyn Nets, and Red Bull to enhance athletic performance. He is the author of over 150 peer-reviewed publications and several books and book chapters related to healthcare innovation. In 2019, he was named “Global Australian of the Year” for his contributions to healthcare.

KEYNOTE SPEAKERS

SHEREEF ELNAHAL, MD

Under Secretary for Health,
Department of Veterans Affairs



Shereef Elnahal, MD, the Under Secretary for Health at the United States Department of Veterans Affairs, nominated by President Joseph R. Biden and confirmed by the United States Senate in 2022. He is a physician leader who previously served as President and Chief Executive Officer of University Hospital, a level 1 trauma center in Newark, NJ from 2019 through 2022. Dr. Elnahal led University Hospital through the COVID-19 public health emergency. In addition to his leadership during the pandemic, Dr. Elnahal oversaw substantial improvements in care quality and patient safety at University Hospital, leading to improvements against national benchmarks. He also oversaw a financial turnaround of the hospital and brought his public health background to bear in community-based programming.

Prior to his time at University Hospital, Dr. Elnahal served as New Jersey's 21st Health Commissioner, appointed to the Cabinet post by Governor Phil Murphy and confirmed unanimously by the New Jersey Senate. During his nearly two years as Commissioner, Dr. Elnahal left a lasting impact on the State's healthcare system. He expanded the New Jersey Health Information Network, an interoperability platform that allows for electronic exchange of patient health information among healthcare providers.

Dr. Elnahal also served as Assistant Deputy Under Secretary for Health for Quality, Safety, and Value at the US Department of Veterans Affairs from 2016 through 2018, overseeing national policies around quality of care for the Veterans Health Administration, and as a White House Fellow in the VA from 2015-16. During that time, he co-founded the VHA Innovation Ecosystem, a program that continues to foster the spread of innovation and best practices that improve Veteran care across the nation. Dr. Elnahal also served on the Biden-Harris Transition Team for the US Department of Veterans Affairs.

Dr. Elnahal holds an MD from Harvard Medical School and an MBA with Distinction from Harvard Business School.

KEYNOTE SPEAKERS

MARIA FIDES PACHECO, MD

Chief Operating Officer, SCI Service,
Dallas VA Medical Center, Dallas, TX



Maria Fides Pacheco, MD, is the Interim Chief and Director of Clinical Operations at the Dallas VA SCI Center and the Co-Director of the Multiple Sclerosis Center of Excellence. She completed her PM&R residency and SCI Fellowship at the University of Pittsburgh. She moved to Dallas to do an Advanced Fellowship in Rehab Technology and has been with the VA North Texas Health Care System SCI Center for the past 20 years. She has collaborated with Neurology to develop the MS Clinic into a Regional VA Multiple Sclerosis Center of Excellence. She also serves as the CARF Consultant for the National VA SCI Program Office and has led the Dallas SCI Center in several successful CARF Accreditation Cycles. She has been named “Top Provider in PM&R and SCI” at the Dallas VA, as well as Best Doctor in PM&R in Dallas. Aside from SCI and MS patient care, her expertise is in Program Development and Clinical Operations and lectures on SCI and MS nationally and internationally.

KEYNOTE SPEAKERS

JERI MUSE, PhD, DAAPM

Clinical & Consulting Psychology, San Diego, CA



Jeri Muse, PhD, DAAPM, is a clinical psychologist who served as the Lead Psychologist in VA San Diego Spinal Cord Injury unit for 24 years, where she received numerous clinical and leadership awards, including the National PVA Psychologist Award in 2015. She is an Assistant Clinical Professor at the UC San Diego School of Medicine, Department of Psychiatry, providing supervision to Post Doctoral Fellows and interns. She received her doctorate in Clinical Psychology with a Health Psychology specialty at the California School of Professional Psychology and later became board certified in pain management from the Academy of Integrative Pain Management. She has a prior career as a rehabilitative exercise physiologist and a Certified Preventive and Rehabilitative Exercise Specialist from the American Academy of Sports Medicine.

She has over 30 years of treating various traumatic experiences and is a frequent invited speaker about the impact of trauma on rehabilitation and systems of care. She is a sought-after consultant to various clinical teams on improving team functioning and optimizing delivery of care. She is an enthusiastic, engaging speaker and developed her love of team dynamics through her training in family systems of trauma and coaching Division I women's basketball.

KEYNOTE SPEAKERS



CHRISTINA FOURNIER, MD

Emory University, Atlanta, GA



Christina Fournier, MD, is an Associate Professor of Neurology at Emory University. She is the director of the Atlanta VA ALS Clinic, co-director of the Emory ALS Center, and Emory Neuromuscular Division director. Her clinical work is focused on the care of patients with ALS and neuromuscular disorders, and her research interests include improving outcome measures and research methods for ALS clinical studies. She serves as site investigator for numerous multicenter ALS clinical trials and non-interventional ALS research studies.

SUMMIT SPONSORS

Gold Level Sponsors:



Gold & VIP Reception Sponsor:



EXPO SCHEDULE



SUNDAY, AUGUST 25, 2024 | 11:00AM - 7:30PM

TIME	EVENT
11:00am - 12:00pm	Vehicle Only Check-In
12:00pm - 3:00pm	Exhibitor Only Check-In
12:00pm - 5:00pm	Exhibitor Setup
5:00pm - 7:30pm	Welcome Reception (Expo Open)

MONDAY, AUGUST 26, 2024 | 10:00AM - 3:30PM

10:00am - 10:30am	Coffee Break (Expo Open)
12:00pm - 1:30pm	Lunch (Expo Open)
3:00pm - 3:30pm	Coffee Break (Expo Open)

TUESDAY, AUGUST 27, 2024 | 10:00AM - 3:30PM

10:00am - 10:30am	Coffee Break (Expo Open)
12:00pm - 1:30pm	Lunch (Expo Open)
3:00pm - 3:30pm	Coffee Break (Expo Open)
3:30pm - 5:00pm	Exhibitor Move-Out

EXPO HALL

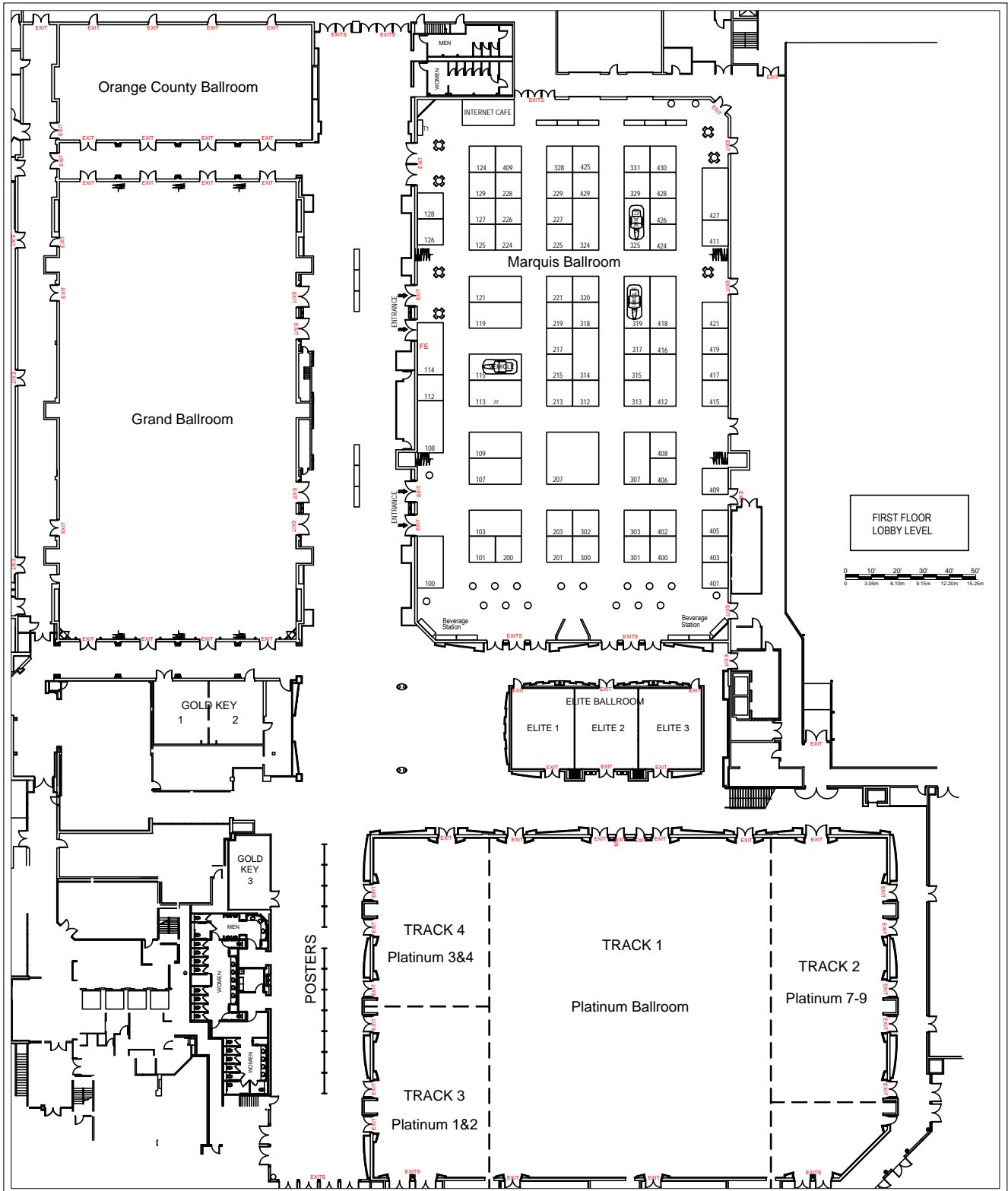



EXPO BOOTHS



GOLD SPONSORS

NAME	Booth
Biogen	107
First Nation Group	103
Genentech	109
Mitsubishi Tanabe Pharma America	119
NMEDA	115
Novartis	121
Onward Medical	113

EXHIBITORS

Accessibility Services, Inc.	315
Advanced Oxygen Therapy, Inc.	430
Advanced Platform Technology (APT) Center	303
ALS Network	424
Altimate Medical	418
Amylior Inc.	331
ANEUVO	217
ARANZ Medical	428
Augmental	227
Avazzia, Inc.	124

EXHIBITORS

NAME	Booth
Best Priced Products, Inc.	307
Bioservo	101
BraunAbility	319
Braze Mobility Inc.	327
Cheelcare	415
Christopher & Dana Reeve Foundation	229
Cionic	329
Coloplast	301
Dejavi Innovation	417
Department of Veterans Affairs - VHA Member Services	427
EyeTech Digital Systems	406
Hollister Incorporated	401
H-Wave	108
Ipsen Biopharmaceuticals, Inc.	226
Lifeward	314
Lifewaters LLC	112
Matia Mobility	228
Maxim Healthcare Services	318
MobilityWorks	325

EXPO BOOTHS



EXHIBITORS	
NAME	Booth
Mobius Mobility	100
Motion Composites	412
National Cemetery Administration	402
National Library Service for the Blind and Print Disabled, Library of Congress	426
National MS Society	320
NATROX Wound Care	419
Neurolumen	114
North American Spinal Cord Injury Consortium	312
Obi Robot - DESIN, LLC	317
Pajunk Medical Systems	405
Partners in Medicine	224
Patriotic Solutions	200
Pentec Health	400
Permobil	203
Pisces Healthcare Solutions	207
Piramal Critical Care	221
Pride Mobility / Quantum Rehab	421
ProBed Medical USA Inc.	129

EXHIBITORS	
NAME	Booth
PVA Research / Architecture / PN Magazine	429
Quest Healthcare, A Division of Quest Products, LLC	213
Raz Design	128
Rehabtronics Inc.	324
Restorative Therapies	302
Smith & Nephew	403
SolutionBased Inc.	409
Solventum	201
Stand Up and Play Foundation	416
StimDesigns / GalileoUSA	125
Sunrise Medical	328
Symmetric Designs	127
Synapse Biomedical, Inc.	219
Tranquility Incontinence Products	215
UI Medical / Quick Change	313
VA Office of Suicide Prevention	225
VA's SCI/D National Program Office	411
Wellspect Healthcare	408

SUMMIT AGENDA



SUMMIT AGENDA

SUNDAY, AUGUST 25

TIME	TRACK 2 PLATINUM 7-9	TRACK 3 PLATINUM 1 & 2	TRACK 4 PLATINUM 3 & 4
12:00pm - 7:00pm	Registration Platinum Registration Desk		
1:00pm - 5:00pm	1:00-3:00pm (PC-241) The Nuts and Bolts: SCI, MS, ALS 101 Speakers: Kevin White, MD Huned Patwa, MD Carolyn Bevan, MD Moderator: Kenneth Lee, MD	1:00-3:00pm (PC-242) Planes, Trains, and Automobiles: Tips and Tricks for Travel for Providers and Individuals with SCI/D Speakers: Rachel M. Hibbs, DPT, NCS, ATP/SMS Lynn Worobey, PhD, DPT, ATP Marshall Lee Tempest, BA Moderator: Angela Weir, RN	1:00-5:00pm (PC-244) ALS: Start Here Speakers: Virginia Kudritzki, PT, DPT, CSRS Laura Mellon, MS, CCC-SLP, ATP Korren Rappisi, RRT Moderator: April Conway, NP
		3:00-5:00pm (PC-243) From Mainstream to Bedside – Using Smart Home Technologies to Enhance Patient Care and Participation Speakers: Lynn Worobey, PhD, DPT, ATP Randy Huzinec, PT Lindsey Morris, OTD, OTR/L Moderator: Angela Weir, RN	
5:00 pm - 7:30 pm	Welcome Reception Expo Hall, Marquis Ballroom		

MONDAY, AUGUST 26

TIME	TRACK 1 PLATINUM 5 & 6	TRACK 2 PLATINUM 7-9	TRACK 3 PLATINUM 1 & 2	TRACK 4 PLATINUM 3 & 4
7:00am - 8:00 am	Registration Platinum Registration Desk			
	Continental Breakfast Platinum Ballroom Foyer			

SUMMIT AGENDA

MONDAY, AUGUST 26

TIME	TRACK 1 PLATINUM 5 & 6	TRACK 2 PLATINUM 7-9	TRACK 3 PLATINUM 1 & 2	TRACK 4 PLATINUM 3 & 4
8:00am - 8:15am	Opening Remarks Robert Thomas, <i>National President, Paralyzed Veterans of America</i> Carl Blake, <i>Chief Executive Officer, Paralyzed Veterans of America</i>			
8:15am - 8:45am	PVA Advocacy / Clinical Excellence Awards Angela Weir, RN, <i>Director of Medical Services, Paralyzed Veterans of America</i>			
8:45am - 10:00am	Opening Keynote Address Homer Townsend, Jr. Memorial Lecture (2401) Brain Computer Interfaces: New Frontiers in Accessibility and Autonomy David Putrino, PT, PhD <i>Director of Rehabilitation Innovation, Mount Sinai Health System, NY, NY</i> <i>Professor of Rehabilitation and Human Performance, Icahn School of Medicine at Mount Sinai</i> Moderator: Kenneth Lee, MD			
10:00am - 5:00pm	Registration Platinum Registration Desk			
10:00am - 10:30am	Coffee Break Marquis Ballroom Foyer & Expo			



SUMMIT AGENDA

MONDAY, AUGUST 26

TIME	TRACK 1 PLATINUM 5 & 6	TRACK 2 PLATINUM 7-9	TRACK 3 PLATINUM 1 & 2	TRACK 4 PLATINUM 3 & 4
10:30am - 12:00pm	<p>(90 mins) (2402) Towards Delivery of Equitable and Inclusive Healthcare to Sexual and Gender Minority Veterans with SCI/D</p> <p>Speakers: B. Jenny Kiratli, PhD Shane Lamba, MPH Megan Neal, PhD</p> <p>Moderator: Kenneth Lee, MD</p>	<p>(45 mins) (2403) My Wheelchair and I Are Always One until We Travel by Air—Empowerment through Preparation</p> <p>Speaker: Peter Axelson, MSME, ATP, RET</p> <p>Moderator: Angela Weir, RN</p>	<p>(45 mins) (2405) Disease-Modifying Therapies at the VA: Updated Guidance from MSCoE and VA Pharmacy Benefits Management</p> <p>Speakers: Rebecca Spain, MD, MSPH, FAAN Christopher Hollen, MD</p> <p>Moderator: Heidi Maloni, PhD, NP</p>	<p>(45 mins) (2407) A More Perfect Union: The VHA ALS System of Care Takes Shape</p> <p>Speaker: Ileana Howard, MD</p> <p>Moderator: Huned Patwa, MD</p>
		<p>(45 mins) (2404) Wheelchair part failures and consequences are linked to wheelchair usage, part damage and user characteristics</p> <p>Speaker: Anand Mhatre, PhD</p> <p>Moderator: Angela Weir, RN</p>	<p>(45 mins) (2406) Biosimilar DMTs for MS: Clinical, Regulatory, and Cost Considerations for Your Practice</p> <p>Speaker: Natasha Antonovich, PharmD, BCPS</p> <p>Moderator: Heidi Maloni, PhD, NP</p>	<p>(45 mins) (2408) Bowel Dysfunction and Management in Persons with Amyotrophic Lateral Sclerosis</p> <p>Speaker: Jessica Vos, BSN, RN</p> <p>Moderator: Huned Patwa, MD</p>
12:00pm - 1:30pm	Lunch Marquis Ballroom Foyer & Expo			
	Expo & Poster Viewing			
12:00pm - 1:00pm	Sponsor Symposium: Track 2, Platinum 7-9 (12:00pm) First Nation Group • Lunch Provided in the Room			
	Sponsor Symposium: Track 3, Platinum 1 & 2 (12:15pm) Novartis • Lunch Provided in the Room			

SUMMIT AGENDA

MONDAY, AUGUST 26

TIME	TRACK 1 PLATINUM 5 & 6	TRACK 2 PLATINUM 7-9	TRACK 3 PLATINUM 1 & 2	TRACK 4 PLATINUM 3 & 4
1:30pm - 3:00pm	<p>(45 mins) (2409) Facilitators to alleviate loneliness as identified by individuals with spinal cord injuries and disorders</p> <p>Speakers: Marissa Wirth, MPH Sherri LaVela, PhD MPH, MBA</p> <p>Moderator: Kenneth Lee, MD</p>	<p>(45 mins) (2411) Clinicians' Perspectives Towards Online Fall Prevention and Management Program in Wheelchair and Scooter Users</p> <p>Speakers: Ziwei Li, MSOT Sahel Moein, MD, MSc</p> <p>Moderator: Jeri Muse, PhD, DAAPM</p>	<p>(45 mins) (2413) Restructuring of the VA Multiple Sclerosis Centers of Excellence</p> <p>Speakers: Glenn D. Graham, MD, PhD Danielle Lawrence, MSC, CCMP, CBSP</p> <p>Moderator: Jodie Haselkorn, MD, MPH</p>	<p>(90 mins) (2415) The Last Breath: Respiratory Failure and End of Life in ALS</p> <p>Speakers: Korren Rappisi, RRT, BA Susie Ryan-Coy, MSW, LICSW</p> <p>Moderator: Jake Herzog, RN</p>
	<p>(45 mins) (2410) Taking care of the provider and preventing burnout: How to say no</p> <p>Speaker: Michelle H. Cameron, MD, PT, MCR</p> <p>Moderator: Kenneth Lee, MD</p>	<p>(45 mins) (2412) Designing a Fall Prevention and Management mHealth App for People Using Wheelchairs and Scooters Full-time</p> <p>Speakers: Sahel Moein, MD, MSc Laura A. Rice, PhD, MPT, ATP</p> <p>Moderator: Jeri Muse, PhD, DAAPM</p>	<p>(45 mins) (2414) Embracing the Humanistic Approach Incorporating Personal Narratives in Multiple Sclerosis HealthCare Delivery</p> <p>Speakers: Carol Gibson-Gill, MD Shanise Henry, RN Sheila Holbert, RN, BSN Jazmin Torres, RN, BSN</p> <p>Moderator: Jodie Haselkorn, MD, MPH</p>	
3:00pm - 3:30pm	Coffee Break Marquis Ballroom Foyer & Expo			

SUMMIT AGENDA

MONDAY, AUGUST 26

TIME	TRACK 1 PLATINUM 5 & 6	TRACK 2 PLATINUM 7-9	TRACK 3 PLATINUM 1 & 2	TRACK 4 PLATINUM 3 & 4
3:30pm - 5:00pm	<p>(45 mins) (2416) Soaring Together: Empowering Our Veterans with SCI/D (Spinal Cord Injury/Disorder) through Indoor Skydiving</p> <p>Speakers: Dukens Pierre, RT Rachel Szymanski, OTR/L, ATP</p> <p>Moderator: Maureen Jennings, DPT, NCS, ATP</p>	<p>(45 mins) (2417) Toward deeper understanding of interactions between chronic pain and recurrent pressure injuries after traumatic SCI</p> <p>Speakers: Kath M. Bogie D.Phil, FAIMBE Letitia Y. Graves, PhD, RN</p> <p>Moderator: Colleen Counsell, MSN</p>	<p>(45 mins) (2419) The Vascular Topography of Lesions in the Brains of People with Newly Diagnosed Multiple Sclerosis</p> <p>Speaker: Ahmad Toubasi, MD</p> <p>Moderator: Angela Weir, RN</p>	<p>(45 mins) (2421) Cognitive Multisensory Rehabilitation for Sensorimotor Recovery in Adults with Spinal Cord Injury: pilot clinical trial.</p> <p>Speaker: Ann Van de Winkel, PhD, MSPT</p> <p>Moderator: April Conway, NP</p>
	<p>(45 mins) (2417) Evidence-based findings demonstrating how configuring a rigid wheelchair improves postural integrity and propulsion mechanics</p> <p>Speakers: Jessica Presperin, OTD, MBA, BSOT, ATP/SMS Jan Furumasu, BS, PT, ATP</p> <p>Moderator: Maureen Jennings, DPT, NCS, ATP</p>	<p>(45 mins) (2418) Reducing UTI Risk: A Comprehensive Model for Patients with Neurogenic Lower Urinary Tract Dysfunction</p> <p>Speaker: Michael Kennelly, MD</p> <p>Moderator: Colleen Counsell, MSN</p>	<p>(45 mins) (2420) Imaging Multiple Sclerosis Beyond the Resolution of the Blood Brain Barrier</p> <p>Speaker: Francesca Bagnato, MD, PhD</p> <p>Moderator: Angela Weir, RN</p>	<p>(45 mins) (2422) Promoting neurological recovery after traumatic spinal cord injury with Trk modulating small molecule</p> <p>Speaker: Arthur Sefiani, PhD</p> <p>Moderator: April Conway, NP</p>
5:00pm - 6:00pm	<p>Sponsor Symposium: Track 2, Platinum 7-9 (5:00pm) Genentech • Refreshments Provided in the Room</p>		<p>MSCoE Meeting (5:15pm)</p>	<p>Poster Viewing (Platinum Foyer) Refreshments Provided</p>

SUMMIT AGENDA

TUESDAY, AUGUST 27

TIME	TRACK 1 PLATINUM 5 & 6	TRACK 2 PLATINUM 7-9	TRACK 3 PLATINUM 1 & 2	TRACK 4 PLATINUM 3 & 4
7:00am - 8:00am	Sponsor Symposium: Track 2, Platinum 7-9 Onward Medical			
7:15am - 8:00am	Continental Breakfast Platinum Ballroom Foyer			
8:00am - 8:15am	Opening Remarks Lindsay Perlman, MPH, <i>Director Research and Education, Paralyzed Veterans of America</i>			
8:15am - 9:00am	Keynote Address: VA Leading the Way Shereef Elnahal, MD, <i>Under Secretary for Health, Department of Veterans Affairs</i> Moderator: Kenneth Lee, MD			
9:00am - 10:15am	John M. Whitaker Memorial Lecture Introduction Jodie Haselkorn, MD (2423) Interdisciplinary Team Care in Multiple Sclerosis: From Assessment to Management <i>Maria Fides Pacheco, MD, Chief Operating Officer, SCI Service, Dallas VA Medical Center, Dallas, TX</i> Moderator: Lindsay Perlman, MPH			
10:00am - 5:00pm	Registration Platinum Registration Desk			
10:15am - 10:30am	Coffee Break Marquis Ballroom Foyer & Expo			



SUMMIT AGENDA

TUESDAY, AUGUST 27

TIME	TRACK 1 PLATINUM 5 & 6	TRACK 2 PLATINUM 7-9	TRACK 3 PLATINUM 1 & 2	TRACK 4 PLATINUM 3 & 4
10:30am - 12:00pm	<p>(45 mins) (2424) The Role of Clinical Reaction Time in Concussion Evaluation of Adaptive Sport Athletes</p> <p>Speakers: Lauren Shuda, MD Eric Bobel, MD</p> <p>Moderator: Maureen Jennings, DPT, NCS, ATP</p>	<p>(45 mins) (2426) Preventing Community Acquired Pressure Injuries in Veterans with Spinal Cord Injury: A Mixed-Methods Study</p> <p>Speakers: Lisa Burkhart, PhD, RN R. Lorie Jacob, MS</p> <p>Moderator: Bill Lawson</p>	<p>(90 mins) (2428) Disease Management Therapies: When to Switch, When to Hold, When to do Nothing</p> <p>Speakers: Mitchell Wallin, MD Bryan Smith, MD Heidi Maloni, PhD, NP Francesca Bagnato, MD, PhD Carey DeLuca, CRNP, MSN</p> <p>Moderator: Jodie Haselkorn, MD, MPH</p>	<p>(90 mins) (2429) Fear of Failure and Ethical Issues Surrounding End of Life</p> <p>Speakers: Catherine Wilson, PsyD, ABPP Ashley Lee, MA Luis Alvarado, MD</p> <p>Moderator: Angela Weir, RN</p>
	<p>(45 mins) (2425) Deep Dive Health: Movement and Mindset Attention to Modify and Provide Sustainable Healthy Lifestyle for Persons with Disability</p> <p>Speakers: Justin Plesnik, CPT Kenneth Lee, MD Suha Muqheet</p> <p>Moderator: Maureen Jennings, DPT, NCS, ATP</p>	<p>(45 mins) (2427) Health provider's beliefs about anti-obesity medication use in persons with spinal cord injuries and disorders</p> <p>Speaker: Sherri LaVela, PhD, MPH, MBA</p> <p>Moderator: Bill Lawson</p>		
12:00pm - 1:30pm	Lunch Marquis Ballroom Foyer & Expo			
	Poster Viewing Platinum Ballroom Foyer			
12:00pm - 1:00pm	Sponsor Symposium: Track 3, Platinum 1 & 2 (12:00pm) Biogen • Lunch Provided in the Room			
	Sponsor Symposium: Track 2, Platinum 7-9 (12:15pm) Mitsubishi Tanabe Pharma America • Lunch Provided in the Room			

SUMMIT AGENDA

TUESDAY, AUGUST 27

TIME	TRACK 1 PLATINUM 5 & 6	TRACK 2 PLATINUM 7-9	TRACK 3 PLATINUM 1 & 2	TRACK 4 PLATINUM 3 & 4
1:30pm - 3:00pm	<p>(45 mins) (2430) Using Wearable Devices and mHealth/eHealth to Promote Physical Activity in People with SCI</p> <p>Speakers: Zijian Huang, MS Dan Ding, PhD</p> <p>Moderator: Jake Herzog, RN</p>	<p>(90 mins) (2432) Updates in VHA Prosthetics: Partnership and Collaboration in Serving the SCI/D Veteran Population</p> <p>Speaker: Martin J. Kilbane, PT, DPT, OCS</p> <p>Moderator: Jodie Haselkorn, MD</p>	<p>(45 mins) (2433) Imaging Multiple Sclerosis: from Experts Recommendations to Day-to-Day Implementation</p> <p>Speaker: Francesca Bagnato, MD, PhD</p> <p>Moderator: Kim Monden, PhD</p>	<p>(15 min) (2435) Effects of sleep apnea on cardiovascular dysfunction in individuals living with chronic spinal cord injury.</p> <p>Speaker: Julio C. Furlan, MD, LLB, MBA, PhD, MSc, FRCPC</p>
	<p>(45 mins) (2431) Integrating Remote Patient Monitoring in Spinal Cord Injury Clinic: Comparison of two Wearable Device Systems</p> <p>Speakers: Amanda Bowen, RN Elizabeth Burkhart, PhD, RN</p> <p>Moderator: Jake Herzog, RN</p>		<p>(45 mins) (2434) Transverse Myelitis and Neuromyelitis Optica Spectrum Diagnosis and Treatment</p> <p>Speaker: Eric Williamson, MD</p> <p>Moderator: Kim Monden, PhD</p>	<p>(15 min) (2436) Emphasis on the psychosocial: Rethinking sexuality for adults with spinal cord injury</p> <p>Speaker: Deanna Tuttle, MS</p>
				<p>(15 min) (2437) Early Functional and MR imaging biomarkers in Asymptomatic C9orf72 Carriers</p> <p>Speaker: Jayakrishnan Nair, PT</p>
				<p>(15 min) (2438) Identifying barriers to healthcare for Veterans with ALS</p> <p>Speaker: John Dolan, MBA</p>
				<p>(15 min) (2439) A Clinical Translational Study: Gene Variants as Determinants of Phantom Limb Pain Development.</p> <p>Speaker: Philip R. Efraim, MD, PhD</p> <p>Moderator: Jeri Muse, PhD, DAAPM</p>

SUMMIT AGENDA

TUESDAY, AUGUST 27

TIME	TRACK 1 PLATINUM 5 & 6	TRACK 2 PLATINUM 7-9	TRACK 3 PLATINUM 1 & 2	TRACK 4 PLATINUM 3 & 4
3:00pm - 3:30pm	Coffee Break Marquis Ballroom Foyer & Expo			
3:30pm - 5:00pm	<p>(45 mins) (2440) Development of an Inpatient Rehabilitation Outcome Measures (SCI-ROM) Toolkit for Veterans with Spinal Cord Injury</p> <p>Speakers: Maureen Jennings, PT, DPT, NCS, ATP Jana LaMarca, OTD, OTR/L, ATP, MSCS</p> <p>Moderator: Jake Herzog, RN</p>	<p>(45 mins) (2442) Bowel and bladder function as spinal cord injury vital signs: A novel electronic tracking tool</p> <p>Speakers: Kristin West, RN, CNL, EBP Christine Krull, MD</p> <p>Moderator: Bill Lawson</p>	<p>(45 mins) (2444) Enhancing high-quality VA MS care; Creation of the MSCoE VA MS Clinical Note template</p> <p>Speakers: Rebecca Spain, MD, MSPH, FAAN Andrew Tarr, MD Mitchell Wallin, MD, MPH</p> <p>Moderator: Heidi Maloni, PhD, NP</p>	<p>(45 mins) (2446) Oropharyngeal Dysphagia in ALS: Updates in Assessment and Treatment by the Speech-Language Pathologist</p> <p>Speakers: Laura Mellon, MS, CCC-SLP, ATP Annette Nicole Askren, CScD, CCC-SLP</p> <p>Moderator: Huned Patwa, MD</p>
	<p>(45 mins) (2441) "Sitting is the new smoking:" Early supported standing following paralysis through complex rehab technology"</p> <p>Speaker: Kristen Cezat, PT, DPT, ATP/SMS, NCS</p> <p>Moderator: Jake Herzog, RN</p>	<p>(45 mins) (2443) Using digital home assistants and smart technologies for older adults with mobility disabilities</p> <p>Speaker: Jaewon Kang, PhD, MSOT</p> <p>Moderator: Bill Lawson</p>	<p>(45 mins) (2445) Learning The System: A New Comprehensive VA MS Social Work Assessment Within The New EHR</p> <p>Speakers: Kaylee Spangenberg, LICSW Alicia Sloan, MPH, MSW, LICSW</p> <p>Moderator: Heidi Maloni, PhD, NP</p>	<p>(45 mins) (2447) Respiratory Muscle Strength Training in ALS: Developing a VA SLP Framework for Promoting Functional Reserve</p> <p>Speakers: Sarah Kiefer Luhring, MA, CC-SLP, ATP, CBIS Annette Nicole Askren, CScD, CCC-SLP</p> <p>Moderator: Huned Patwa, MD</p>
5:00pm - 6:30pm	Poster Viewing (Cocktail Hour) Platinum Ballroom Foyer			
5:15pm - 6:15pm	VA SCI Staff Meeting Track 1 - Platinum 5 & 6			
6:30pm - 8:30pm	PVA Healthcare Appreciation Reception Marquis Ballroom			

SUMMIT AGENDA

WEDNESDAY, AUGUST 28

TIME	TRACK 1 PLATINUM 5 & 6	TRACK 2 PLATINUM 7-9	TRACK 3 PLATINUM 1 & 2	TRACK 4 PLATINUM 3 & 4
7:15am - 8:00am	Continental Breakfast Platinum Ballroom Foyer			
8:00am - 8:15am	Opening Remarks Kenneth Lee, MD, Program Chair			
8:15am - 9:15am	(2448) Trauma Informed Care: A Model to Improve Rehabilitation <i>Jeri Muse, PhD, Clinical & Consulting Psychology, San Diego, CA</i> Moderator: Kenneth Lee, MD			
9:15am - 10:15am	Keynote Address (2449) Diagnosis and Tracking Progression in ALS: Updates and Innovations <i>Christina Fournier, MD, Emory University, Atlanta, GA</i> Moderator: Lindsay Perlman, MPH			
10:00am - 2:00pm	Registration Platinum Registration Desk			
10:15am - 10:30am	Coffee Break Platinum Ballroom Foyer			



SUMMIT AGENDA

WEDNESDAY, AUGUST 28

TIME	TRACK 1 PLATINUM 5 & 6	TRACK 2 PLATINUM 7-9	TRACK 3 PLATINUM 1 & 2	TRACK 4 PLATINUM 3 & 4
10:30am - 12:00pm	<p>(45 mins) (2450) Forging effective collaborations between clinicians and researchers to aid in the translation of new technologies</p> <p>Speakers: Alicia Koontz, PhD, RET, ATP Brooke Slavens, PhD</p> <p>Moderator: Lindsay Perlman, MPH</p>	<p>(45 mins) (2452) Sleep disorders in individuals with spinal cord injury or disease: A wake-up call for change</p> <p>Speaker: Julio C. Furlan, MD, LLB, MBA, PhD, MSc, FRCPC</p> <p>Moderator: Jeri Muse, PhD, DAAPM</p>	<p>(90 mins) (2454) The MS Multi-Disciplinary Team: Perspectives from Social Work, Neuropsychology, and the Neurology Nurse Practitioner</p> <p>Speakers: Carey M. DeLuca, CRNP, MSN Brittany Vazquez, PsyD Bethany Ferguson, LCSW-C</p> <p>Moderator: Alicia Sloan, MPH, MSW, LICSW</p>	<p>(45 mins) (2455) The Bare Bones Podcast: Co-Designing a Podcast Series with Lived Experience Partners using PVA CPG Content</p> <p>Speakers: B. Catharine Craven, BA, MD, FRCPC, MSc Anita Kaiser, PhD (c)</p> <p>Moderator: Huned Patwa, MD</p>
	<p>(45 mins) (2451) The NASCIC Research Advocacy Course: An Overview of Course Effectiveness and Promoting Veteran Participation</p> <p>Speakers: Barry Munro, LLB Emily Giroux, MSc, BSc</p> <p>Moderator: Lindsay Perlman, MPH</p>	<p>(45 mins) (2453) Insulin resistance index for pressure injury risk in people with chronic spinal cord injury</p> <p>Speaker: Yi-Ting Tzen, PhD</p> <p>Moderator: Jeri Muse, PhD, DAAPM</p>		<p>(45 mins) (2456) Putting Bone Health and Osteoporosis Management Guidelines into Practice : our SCI Center's Experience</p> <p>Speakers: Samantha Mendelson, DO Kathryn Fitzgerald PT, DPT, NCS Cassandra Hogan, PT, DPT, NCS</p> <p>Moderator: Huned Patwa, MD</p>
12:00pm - 1:30pm	Lunch Marquis Ballroom Foyer			

SUMMIT AGENDA

WEDNESDAY, AUGUST 28

TIME	TRACK 1 PLATINUM 5 & 6	TRACK 2 PLATINUM 7-9	TRACK 3 PLATINUM 1 & 2	TRACK 4 PLATINUM 3 & 4
1:30pm - 3:00pm	<p>(90 mins) (2457) Implementation Workshop: Building a Successful Caregivers Appreciation Conference for SCI, MS and ALS Caregivers</p> <p>Speakers: Joyce Williams, LCSW, MSCS Carol Gibson-Gill, MD, MSCS Sheila Holbert, RN</p> <p>Moderator: Alicia Sloan, MPH, MSW, LICSW</p>	<p>(45 mins) (2458) From An Initial SCI VA Grant to Helping Patients Breath Worldwide: The Diaphragm Pacing Story</p> <p>Speaker: Raymond Onders, MD, FACS</p> <p>Moderator: Colleen Counsell, MSN</p>	<p>(45 mins) (2460) The ABCs of Cognitive Functioning in Multiple Sclerosis: Assessment, Behavioral Health, and Cognitive Rehabilitation</p> <p>Speakers: Mary A. Fernandes, PhD Ernest Aucone, PhD</p> <p>Moderator: Angela Weir, RN</p>	<p>(90 mins) (2462) VA Medical Clearance: Pearls for VA National Events</p> <p>Speaker: Kenneth Lee, MD</p> <p>Moderator: Lindsay Perlman, MPH</p>
		<p>(45 mins) (2459) Increasing access to pulmonary function testing (PFT) through at home testing for veterans with ALS</p> <p>Speaker: Elamin M. Elamin, MD, MSc Catherine Wilson, PsyD, ABPP</p> <p>Moderator: Colleen Counsell, MSN</p>	<p>(45 mins) (2461) Establishing Short and Mid-Term Research Priorities for Veterans with Multiple Sclerosis: A Modified Delphi Process</p> <p>Speaker: Lindsey Wooliscroft, MD, MSc, MCR</p> <p>Moderator: Angela Weir, RN</p>	



MARRIOTT
ANAHEIM



FACULTY LIST



FACULTY LIST



Luis Alvarado, MD
James A Haley VA Hospital
Luis.Alvarado1@VA.Gov

Hans Anderson, MD, PhD
Medical College of Wisconsin
haanderson@mcw.edu

Natasha Antonovich, PharmD, BCPS
VA Pharmacy Benefits Management
natasha.antonovich@va.gov

Annette Askren, CScD, CCC-SLP
VA Puget Sound Healthcare System
annette.askren@va.gov

Ernest Aucone, PhD
Washington DC VAMC / Multiple Sclerosis
Centers of Excellence-East
ernest.aucone@va.gov

Peter Axelson, MSME, ATP, RET
Beneficial Designs Inc.
pax@beneficialdesigns.com

Francesca Bagnato, MD, PhD
Nashville VA Medical Center and VUMC
francesca.r.bagnato@vumc.org

Eric Bobel, MD
Medical College of Wisconsin
ejbobel@gmail.com

Kath Bogie, D.Phil, FAIMBE
Cleveland VA Medical Center
kmb3@case.edu

Amanda Bowen, BSN, RN
VHA- Jefferson Barracks
Amanda.bowen@va.gov

Elizabeth (Lisa) Burkhardt, PhD, RN
Department of Veterans Affairs
elizabeth.burkhardt@va.gov

Michelle Cameron, MD, PT, MCR
VA Portland HCS
cameromi@ohsu.edu

Kristen Cezat, PT, DPT, NCS, ATP/SMS
Altimate Medical, Inc
KCEzat@altimatemedical.com

Xiaoxue Chen, MPH
EMD Serono
xiaoxue.chen@emdserono.com

Kathleen Chlan, BS
Shriners Hospitals for Children
kchlan@shrinenet.org

**B. Catharine Craven, BA, MD,
FRCPC, MSc, FAISA, FCAHS**
KITE Research Institute,
University Health Network
cathy.craven@uhn.ca

Blair Dellenbach, MSOT, OTR/L
Medical University of South Carolina
stecb@musc.edu

Carey DeLuca, CRNP, MSN
Washington DC Veterans Affairs
Medical Center
carey.deluca@va.gov

Dan Ding, PhD
University of Pittsburgh
dad5@pitt.edu

John Dolan, MBA
Lockheed Martin
phdolan@hotmail.com

Philip Effraim, MD, PhD
Yale School of Medicine/VACT Healthcare
philip.effraim@yale.edu

Elamin M. Elamin, MD, MSc
Bay Pines VA
elamin.elamin@va.gov

Bethany Ferguson, LCSW-C
Baltimore VA Medical Center
Bethany.Ferguson@va.gov

Mary Fernandes, PhD
Washington D.C. VA Medical Center
marycandyfernandes@gmail.com

Kathryn Fitzgerald, PT, DPT, NCS
James A. Haley Veterans' Hospital
Kathryn.Fitzgerald1@va.gov

Krista Fjeld, PhD
Medical University of South Carolina
fjeld@musc.edu

Kevin Foglyano, BSE
Cleveland VA Medical Center
kfoglyano@aptcenter.org

Christina Fournier, MD
Emory University
christina.nicole.fournier@emory.edu

FACULTY LIST



**Julio Furlan, MD, LLB, MBA,
MSc, PhD, FRCPC**

Lyndhurst Centre, Toronto Rehabilitation
Institute and KITE Research Institute;
University of Toronto
jcfurlan@gmail.com

Jan Furumasu, BS, PT, ATP

Ranchos Los Amigos National Rehabilitation
Center, Center for Applied Rehabilitation
Technology CART
jfurumasu@dhs.lacounty.gov

Carol Gibson-Gill, MD

Veterans Hospital Administration
Carol.Gibson-Gill@va.gov

Emily Giroux, MSc, BSc

The University of British Columbia
emily.giroux@ubc.ca

Glenn Graham, MD, PhD

Department of Veterans Affairs
Glenn.Graham@va.gov

Letitia Graves, MSN, PhD

Louis Stokes Cleveland VA Medical Center
legraves@utmb.edu

Jodie Haselkorn, MD, MPH

Veterans Health Administration
jodie.haselkorn@va.gov

Shanise Henry, RN

VA
jodon85@yahoo.com

Rachel Hibbs, DPT, NCS, ATP/SMS

University of Pittsburgh Department of
Rehabilitation Science and Technology
Rachel.Hibbs@pitt.edu

Sheila Holbert, RN, BSN

VANJ Healthcare System
Sheila.holbert@va.gov

Christopher Hollen, MS

Portland VA
hollen@ohsu.edu

Ileana Howard, MD

VA Puget Sound Health Care System
ileana.howard@va.gov

Zijian Huang, MS

University of Pittsburgh School of Health
and Rehabilitation Science
szih15@pitt.edu

Randy Huzinec, PT

University of Pittsburgh Medical Center
huzinecr@upmc.edu

R. Lorie Jacob, PhD

Hines VA
reside.jacob@va.gov

Maureen Jennings, DPT

VA Long Beach Healthcare System
maureen.jennings@va.gov

Anita Kaiser, PhD(c)

University Health Network
Anita.Kaiser@uhn.ca

Jaewon Kang, PhD, MSOT

University of Illinois Urbana-Champaign
jaewon@illinois.edu

Michael Kennelly, MD, FACS

Atrium Health
michael.kennelly@atriumhealth.org

**Sarah Kiefer Luhring,
MA, CCC-SLP, ATP, CBIS**

Cincinnati VA Medical Center
Sarah.KieferLuhring@va.gov

Martin Kilbane, PT, DPT, OCS

Veterans Administration
Martin.Kilbane@va.gov

B. Kiratli, PhD

VA Palo Alto Health Care System
Jenny.Kiratli@va.gov

Alicia Koontz, PhD

Human Engineering Research Laboratories
akoontz@pitt.edu

Vicki Kowal, LPCC, NCC

National Multiple Sclerosis Society
Vicki.Kowal@nmss.org

Christine Krull, MD

VA St. Louis Health Care System &
Washington University in St. Louis
cmpautler@gmail.com

Virginia Kudritzki, PT, DPT, CSRS

Puget Sound Health Care,
Seattle Veterans Administration
Virginia.Kudritzki@va.gov

FACULTY LIST



Jana LaMarca, OTD, ATP, MSCS

Veterans Health Administration Long Beach
jana.lamarca@va.gov

Shane Lamba, MPH

VA Office of Health Equity
shane.lamba@va.gov

Sherri LaVela, PhD, MPH, MBA

Hines VA Hospital
Sherri.lavela@va.gov

Danielle Lawrence, MSC, CCMP, CBSP

Veterans Health Administration
danielle.lawrence2@va.gov

Kenneth Lee, MD

Zablocki VAMC
kenneth.lee8@va.gov

Ashley Lee, MS

EDF
lee.ash85@yahoo.com

Ziwei Li, MSOT

University of Illinois at Urbana- Champaign
ziweil6@illinois.edu

Daniel Lodge, RN, CRRN

Shepherd Center
Daniel.Lodge@Shepherd.org

Lisa Lombardo, MPT

VA North East Ohio Health Care System
lisa.lombardo2@va.gov

Erika Marks, BS

Texas A&M
ecelinem@tamu.edu

Tempest Marshall, BS

University of Pittsburgh Department of
Physical Medicine and Rehabilitation
tempestml@upmc.edu

Laura Mellon, MS, CCC-SLP, ATP

VA Puget Sound Healthcare System
laura0527@gmail.com

Samantha Mendelson, DO

VA
smendels@gmail.com

Anand Mhatre, PhD

Ohio State University
anand.mhatre@osumc.edu

Sahel Moein, MD, MSc

University of Illinois at Urbana-Champaign
smoein2@illinois.edu

Lindsey Morris, OTD, OTR/L

University of Pittsburgh, Department of
Rehabilitation Science and Technology
LLM65@pitt.edu

Barry Munro, BA, LLB

North America Spinal Cord
Injury Consortium
gocampo@nasciconsortium.org

Suha Muqet, Student

Wisconsin Adaptive Sports Associatoin
suhamuqet@gmail.com

Jeri Muse, PhD, DAAPM

Clinical & Consulting Psychology
jerimusephd@gmail.com

Jayakrishnan Nair, PT, PhD

Thomas Jefferson University
jayakrishnan.nair@jefferson.edu

Megan Neal, PhD

Palo Alto Veterans Institute for Research
megan.neal2@va.gov

Raymond Onders, MD, FACS

University Hospitals
Cleveland Medical Center
raymond.onders@uhhospitals.org

Maria Fides Pacheco, MD

Dallas VA Medical Center
MariaFides.Pacheco@va.gov

Huned Patwa, MD

Yale University
huned.patwa@yale.edu

Joseph Peters, PhD

Kansas City University of
Medicine and Bioscience
joseph.peters@kansascity.edu

Alan Phipps, PhD

Medical University of South Carolina
phippisal@musc.edu

Dukens Pierre, RT

VA
Dukens.Pierre@va.gov

Justin Plesnik, CPT

Body by Design
justinplesnik@gmail.com

FACULTY LIST



Jessica Presperin Pedersen, OTD, MBA, BSOT, ATP/SMS

Shirley Ryan AbilityLab/Sunrise Medical
jessica.pedersen@sunmed.com

Jennissa Pressley-Burgin, LCSW-CS

James A Haley Veteran's hospital and Clinics and the Michael Bilirakis VA, Spinal Cord Injury
Jennissa.Pressley-Burgin@va.gov

David Putrino, PT, PhD

Mount Sinai Health System, NY
david.putrino@mountsinai.org

Korren Rappisi, RRT

Puget Sound VA
korren.rappisi@va.gov

Laura Rice, PhD, MPT, ATP

University of Illinois at Urbana-Champaign
ricela@illinois.edu

John Robles, DHSc

Tibor Rubin Veterans Affairs Medical Center
john.robles@va.gov

Grant Runnels, BS

Kansas City University of Medicine and Bioscience
grant.runnels@kansascity.edu

Susie Ryan-Coy, LICSW

VA
suzanne.ryan-coy@va.gov

Sunil Sabharwal, MD

VA Boston Health Care System/
Harvard Medical School
sunil.sabharwal@va.gov

Arthur Sefiani, PhD

NeuroCreis
sefiani@tamu.edu

Suma Shah, MD

Durham VAMC
suma.shah@duke.edu

Afsaneh Shirani, MD

University of Nebraska Medical Center
afsaneh.shirani@unmc.edu

Jo Ann Shoup, PhD

Kaiser Permanente Colorado
jasst109@comcast.net

Lauren Shuda, MD

Medical College of Wisconsin
lshuda@mcw.edu

Brooke Slavens, PhD, MS

University of Wisconsin-Milwaukee
slavens@uwm.edu

Alicia Sloan, MPH, MSW, LICSW

VA Puget Sound Health Care System
alicia.sloan@va.gov

Bryan Smith, MD

DC VA Medical Center
bryan.smith5@va.gov

Rebecca Spain, MD, MSPH

Portland VA Medical Center;
Oregon Health & Science University
spainr@ohsu.edu

Kaylee Spangenberg, MSW

Veteran's Health Administration
kaylee.spangenberg@va.gov

Rachel Szymanski, OTR/L, ATP

James J. Peters VA Medical Center
rachel.szymanski@va.gov

Andrew Tarr, MD

Atlanta VA Multiple Sclerosis
Regional Specialty Center
andrew.tarr@va.gov

Jazmin Torres, BSN, RN

New Jersey Health Care systems
errot.jaz@gmail.com

Ahmad Toubasi, MD

Vanderbilt University Medical Center
ahmad.tubasi@vumc.org

FACULTY LIST



Deanna Tuttle, MS

Shriners Children's Chicago
deanna.tuttle@shrinenet.org

Yi-Ting Tzen, PhD

UT Southwestern Medical Center
YiTing.Tzen@UTSouthwestern.edu

Ann Van de Winckel, PhD, MSPT, PT

Division of Physical Therapy and
Rehabilitation Science, Department of
Family Medicine and Community Health,
Medical School, University of Minnesota
avandewi@umn.edu

Brittany Vazquez, PsyD

Washington DC VA Medical Center
Brittany.vazquez2@va.gov

Jessica Vos, BSN, RN

Veterans Health Administration - Seattle
jessica.va@gov

Mitchell Wallin, MD, MPH

VA/MS Center of Excellence-East
mitchell.wallin@va.gov

Kristin West, RN, CNL, EBP

VHA
Kristin.west2@va.gov

Kevin White, MD

James A Haley Veterans Hospital
Kevin.white2@va.gov

Rafer Willenberg, MD, PhD

VA Boston Healthcare System
rafer.willenberg@va.gov

Joyce Williams, LCSW

VA New Jersey Healthcare System
joyce.williams9@va.gov

Eric Williamson, MD

University of California Los Angeles
and West Los Angeles VA
Ericwilliamsonmd@gmail.com

Cathy Williams-Sledge, PsyD

Central Virginia VA Healthcare
System Richmond VA Medical Center
Cathy.Williams-Sledge@va.gov

Catherine Wilson, PsyD, ABPP

Self Employed
cathywilson929@live.com

Marissa Wirth, MPH

Veteran Health Administration
Marissa.Wirth@va.gov

Lindsey Wooliscroft, MD, MSc, MCR

Multiple Sclerosis Center of Excellence-West
woo_liscr@ohsu.edu

Lynn Worobey, PhD

University of Pittsburgh
Lynn.worobey@pitt.edu

POSTER PRESENTATIONS

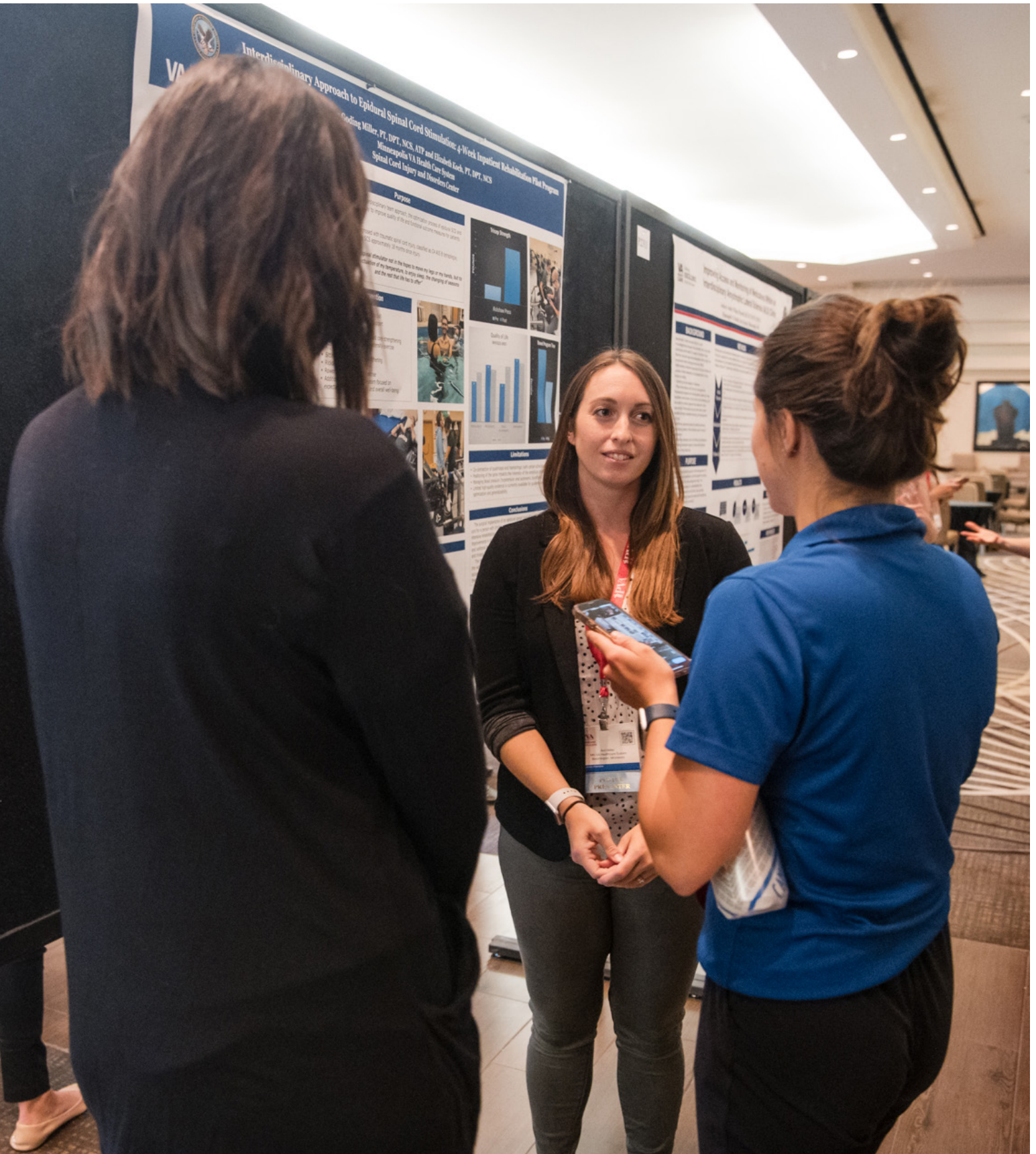

POSTER PRESENTATIONS



P2401: Impact of concomitant traumatic brain injury on the epidemiology, management, and outcomes after spinal cord injury.

Julio J. Furlan, MD, LLB, MBA, MSc, PhD, FRCPC, FAAN
Lyndhurst Centre, Toronto Rehabilitation Institute and KITE Research Institute;
University of Toronto
jcfurlan@gmail.com

P2402: Leveraging the Veteran Spinal Cord Injuries and Disorders (SCI/D) Registry to Evaluate Post-SCI/D Stroke Risk.

Rafer R. Willenberg, MD, PhD
VA Boston Healthcare System
rafer.willenberg@va.gov

P2403: The Burden of Illness Among US Veterans with Multiple Sclerosis.

Xiaoxue X. Chen, MPH
EMD Serono
xiaoxue.chen@emdserono.com

P2404: Rising Prevalence of Multiple Sclerosis in the Veterans Affairs Population.

Xiaoxue X. Chen, MPH
EMD Serono
xiaoxue.chen@emdserono.com

P2405: Vitamin D and Spinal Cord Injury: Do Correlations Exist?

Hans H. Anderson, MD, PhD
Medical College of Wisconsin
haanderson@mcw.edu

P2406: ALS Caregiver Bootcamp.

Jennissa J. Pressley-Burgin, LCSW-QS
James A Haley Veteran's Hospital & Clinics
and The Michael Bilirakis VA,
Spinal Cord Injury
Jennissa.Pressley-Burgin@va.gov

P2407: A Guide to Maximizing Resources and Collaboration: The VHA and National MS Society's Cross-Referral System.

Vicki Kowal, LPCC, NCC
National Multiple Sclerosis Society
Vicki.Kowal@nmss.org

P2408: Spinal cord injury/dysfunction and use of preventive health care services: A scoping review.

Jo Ann J. Shoup, PhD.
Kaiser Permanente Colorado
jasst109@comcast.net

P2409: Evoked potential operant conditioning to improve sensorimotor functions in chronic incomplete spinal cord injury.

Krista K. Fjeld, PhD
Medical University of South Carolina
fjeld@musc.edu

POSTER PRESENTATIONS

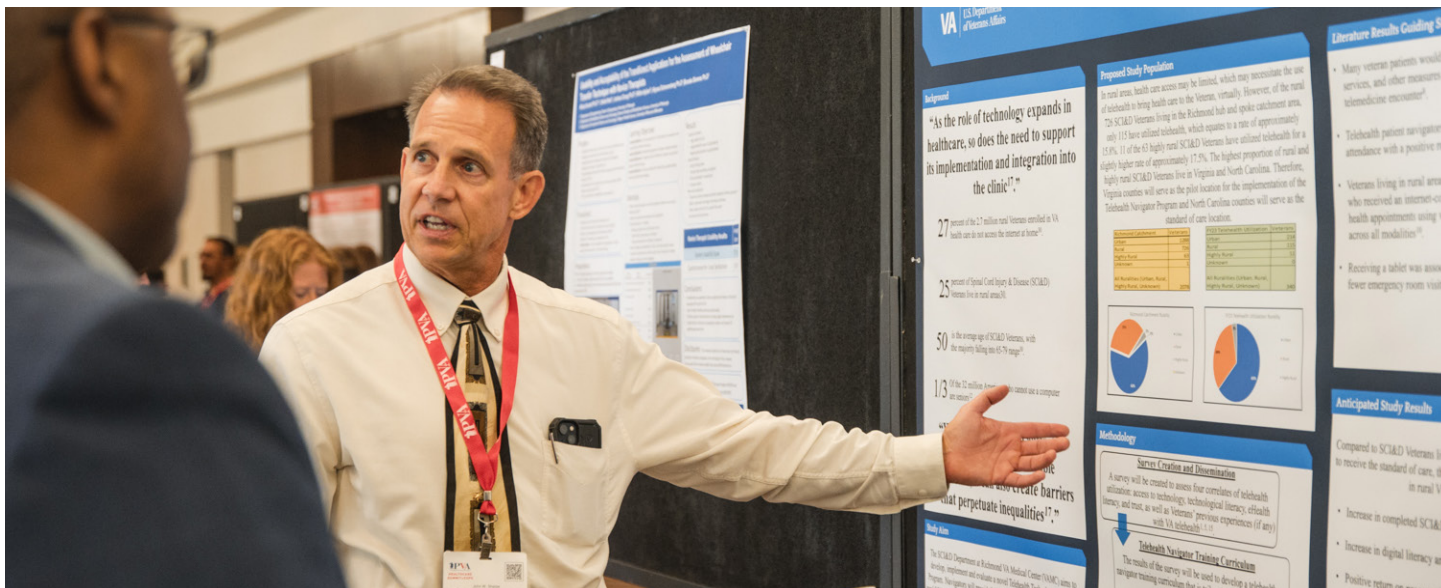

P2410: Does meeting physical activity guidelines for people with multiple sclerosis reduce fatigue?

Joseph J. Peters, PhD
Kansas City University of
Medicine and Bioscience
joseph.peters@kansascity.edu

P2411: Living with Spinal Cord Injury: 35 year medical and psychosocial outcomes.

Kathleen K. Chlan, BS
Shriners Hospitals for Children
kchlan@shrinenet.org

P2412: The Impact of Age on Stem Cell Transplantation and Gene Therapy.

Erika E. Marks, BS
Texas A&M
ecelinem@tamu.edu

P2413: Cardiometabolic Predictors of Cardiovascular Disease Risk in Veterans with Spinal Cord Injuries.

John J. Robles, DHSc
Tibor Rubin Veterans Affairs Medical Center
john.robles@va.gov

P2414: Improving hands-on training compliance for patients and nursing staff.

Daniel D. Lodge, RN, CRRN
Shepherd Center
Daniel.Lodge@Shepherd.org

P2415: Efficacy of abdominal-related manipulations for alleviating gastrointestinal distress in people with SCI, MS, and TBI.

Grant G. Runnels, BS
Kansas City University of
Medicine and Bioscience
grant.runnels@kansascity.edu

P2416: Exaggerated rate-dependent pain enhancement and reduced cutaneous reflexes in chronic incomplete spinal cord injury.

Alan A. Phipps, PhD
Medical University of South Carolina
phippisal@musc.edu

P2417: Should we slow the flow? Blood flow restriction exercise in those with incomplete SCI.

Lisa L. Lombardo, MPT
VA North East Ohio Health Care System
lisa.lombardo2@va.gov

POSTER PRESENTATIONS

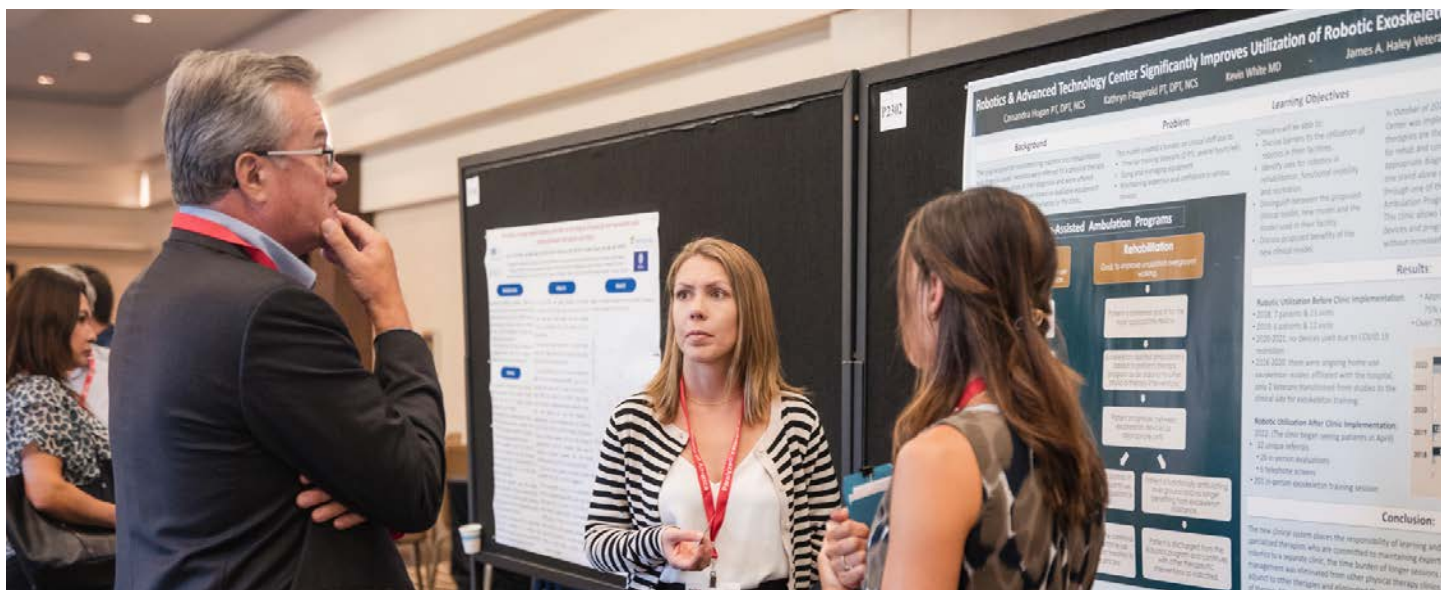

P2418: Virtual Reality Immersion to Enhance Stimulation-Induced Exercise in SCI.

Kevin K. Foglyano, BSE
Cleveland VA Medical Center
kfoglyano@aptcenter.org

P2419: Operant Conditioning of Motor-Evoked Potentials in Upper Extremity Muscles in Individuals with Spinal Cord Injury.

Blair B. Dellenbach, MSOT, OTR/L
Medical University of South Carolina
stecb@muscedu

P2420: Exploring the Association Between Weight-Loss-Inducing Medications and Multiple Sclerosis using the FDA Adverse Event Reporting System Database.

Afsaneh A. Shirani, MD
University of Nebraska Medical Center
afsaneh.shirani@unmc.edu

P2421: Developing an Innovative Wellness Program Spinal Cord Injury Integrated Patient and Staff Wellness Program.

Cathy C. Williams-Sledge, PsyD
Central Virginia VA Healthcare System
Richmond VA Medical Center
Cathy.Williams-Sledge@va.gov

P2422: Engaging the Spinal Cord Injury Inter-Professional Team to Advance Age-Friendly Care.

Sunhil S. Sabharwal, MD
VA Boston Health Care System/ Harvard
Medical School
sunil.sabharwal@va.gov



SPONSOR SYMPOSIUMS

MONDAY, AUGUST 26

TUESDAY, AUGUST 27

First Nation Group

12:00pm, Track 2

RENASYS EDGE, The Next Generation of Negative Pressure Wound Therapy Presented by Smith+Nephew and First Nation Group

Speakers:

Karl Gokenbach, Director Care Continuum, Smith+Nephew

Glenn Munroe, Senior Vice President, Business Development, First Nation Group

Kate Culver, MSN, RN, PCCN, Clinical Resource Specialist

Novartis

12:15pm, Track 3

A Self-Administered B-Cell Therapy for Your Treatment-Naïve Patients With RMS

Speaker:

Stephen Yeung, DO, Medical Director, Novartis Pharmaceuticals Corporation

Genentech

5:00pm, Track 2

Advocacy in Action: Role of Advocacy in Healthcare, Hosted by Genentech

Speakers:

JP Sacksteder, Senior Director, Patient Advocacy Relations, Genentech

Jerrold Harris, PVA, Person living with MS | Patient Thought Leader

Jennifer Kumiyama, City of Long Beach Citywide Accessibility Coordinator and United Spinal Association 2023 Advocate of the Year

Onward Medical

7:00am, Track 2

Non-Invasive Spinal Cord Stimulation Facilitates Arm and Hand Function in Chronic Tetraplegia – Results from the Up-LIFT Pivotal Trial

Speaker:

Candy Tefertiller, PT, DPT, PhD, NCS, Executive Director of Research and Evaluation & Helen Phillips Levin Endowed Chair of Research, Craig Hospital, Denver

Biogen

12:00pm, Track 3

No Veteran Left Behind: Current Guidelines for ALS Genetic Counseling and Testing

Speakers:

Teresa E. Fecteau, PhD, Director of Medical Affairs, Biogen

Rachel Clark, MS, CGC, Medical Science Liaison – MidWest, Biogen

Key Objectives:

1. Increase understanding of elevated risk of ALS in Veterans and the genetics of ALS.
2. Educate on the importance of equitable access to genetic counseling and testing for all people living with ALS.
3. Increase awareness of the 2023 ALS Genetic Counseling and Testing Guidelines and recommended strategies for overcoming implementation challenges.

Mitsubishi Tanabe Pharma America

12:15pm, Track 2

Timely Diagnosis of ALS and a Proven Treatment Option

Speaker:

Jonathan Katz, MD, California Pacific Medical Center

CONTINUING EDUCATION

AffinityCE

Continuing Education Information

This continuing education activity is provided by AffinityCE and the Paralyzed Veterans of America (PVA). This activity provides continuing education credit for physicians, physician assistants, nurses, nurse practitioners, pharmacists, psychologists, social workers, occupational therapists, physical therapists, certified rehabilitation counselors, registered dietitians, and speech-language professionals. A statement of participation is available to other attendees.

Course Registration Link: <https://na.eventscloud.com/ereg/index.php?eventid=777524&>
CE Information: <https://www.summitpva.org/continuing-education>

Learning Objectives

At the end of this activity, participants should be able to:

- Review the state-of-the-art research, and emerging science in helping advance the quality of care in individuals with spinal cord injury/disease (SCI/D), MS, and ALS.
- Recognize the implications for practice and policy in the treatment of SCI/D
- Describe the screening, prevention and monitoring of multiple sclerosis and infections.
- Recognize the differences and similarities between SCI, MS and ALS and key practice issues.
- Discuss effective strategies for delivering online education focused on teaching new technologies to older adults with mobility disabilities
- Describe how the system of care impact trauma symptoms and engagement in rehabilitation
- Recognize how the VA health care system can individualize MS therapy based on the perceptions of risk to benefit, past medical history and future monitoring.
- Describe key themes identified by individuals with SCI/D that reflect their nutrition and eating beliefs and behaviors.
- Recognize the differences and similarities between SCI, MS and ALS and key practice issues
- List two non-pharmacological interventions that increase life expectancy in ALS
- Identify a set up that can be used in your practice setting to demonstrate/provide training in smart home devices
- Identify three risk factors associated with wheelchair part failure.

ACCREDITATION STATEMENTS

- Discuss the significant role of mHealth platforms in improving the accessibility of health interventions for individuals with disabilities who use wheelchairs and scooters full-time.
- Define and categorize the risk factors associated with urinary tract infections (UTIs) in patients with neurogenic lower urinary tract dysfunction (NLUTD) performing clean intermittent catheterization (CIC).
- Explain the benefits and risks of osteoporosis treatments.
- Review the ways that medical devices are approved with the FDA
- Describe 2 key intrinsic risk factors of pressure injury in the population with spinal cord injury.

Disclosures

AffinityCE staff, PVA staff, as well as planners and reviewers, have **no relevant financial or non-financial relationships** with ineligible companies to disclose.

Faculty disclosures are provided for viewing and online access at <https://www.summitpva.org/continuing-education> prior to the launch of the program to participants and stated prior to the start of each presentation.

Mitigation of Relevant Financial and non-Financial Relationships

AffinityCE adheres to the ACCME's Standards for Integrity and Independence in Accredited Continuing Education. Any individuals in a position to control the content of a CME activity, including faculty, planners, reviewers, or others, are required to disclose all relevant financial relationships with ineligible companies. All relevant financial and non-financial relationships for faculty when present, have been mitigated by peer review of content by non-conflicted reviewers prior to the commencement of the program.

Physicians



This activity has been planned and implemented in accordance with the accreditation requirements and policies of the Accreditation Council for Continuing Medical Education (ACCME) through the joint providership of AffinityCE and PVA. AffinityCE is accredited by the ACCME to provide continuing medical education for physicians.

AffinityCE designates this live activity for a maximum of up to 24.50 *AMA PRA Category 1 Credits™*. Physicians should claim only the credit commensurate with the extent of their participation in the activity.

ACCREDITATION STATEMENTS

Physician Assistants



This activity has been planned and implemented in accordance with the accreditation requirements and policies of the Accreditation Council for Continuing Medical Education (ACCME) through the joint providership of AffinityCE and PVA. AffinityCE is accredited by the ACCME to provide continuing medical education for physicians.

AffinityCE designates this live activity for a maximum of up to 24.50 *AMA PRA Category 1 Credits*[™]. Physician assistants should claim only the credit commensurate with the extent of their participation in the activity.

Nurse Practitioners



This activity has been planned and implemented in accordance with the accreditation requirements and policies of the Accreditation Council for Continuing Medical Education (ACCME) through the joint providership of AffinityCE and PVA. AffinityCE is accredited by the ACCME to provide continuing medical education for physicians.

AffinityCE designates this live activity for a maximum of up to 24.50 *AMA PRA Category 1 Credits*[™]. Nurse practitioners should claim only the credit commensurate with the extent of their participation in the activity.

Occupational Therapists



This activity has been planned and implemented in accordance with the accreditation requirements and policies of the Accreditation Council for Continuing Medical Education (ACCME) through the joint providership of AffinityCE and PVA. AffinityCE is accredited by the ACCME to provide continuing medical education for physicians.

AffinityCE designates this live activity for a maximum of up to 24.50 *AMA PRA Category 1 Credits*[™]. Occupational Therapists should claim only the credit commensurate with the extent of their participation in the activity.

Nurses



Continuing Nursing Education is provided for this program through the joint providership between PVA and AffinityCE. AffinityCE is accredited as a provider of nursing continuing professional development by the American Nurses Credentialing Center's Commission on Accreditation (ANCC). This activity provides a maximum of up to 24.50 contact hours of continuing nursing education credit.

ACCREDITATION STATEMENTS

Physical Therapists



This activity has been planned and implemented in accordance with the accreditation requirements and policies of the Accreditation Council for Continuing Medical Education (ACCME) through the joint providership of AffinityCE and PVA. AffinityCE is accredited by the ACCME to provide continuing medical education for physicians.

AffinityCE designates this live activity for a maximum of up to 24.50 *AMA PRA Category 1 Credits™*. Physical Therapists should claim only the credit commensurate with the extent of their participation in the activity.

Speech-Language Professionals



ASHA CE
APPROVED PROVIDER

AffinityCE

Intermediate Level

Up to 2.05 ASHA CEUs

At the end of this activity, speech-language professionals (SLP) should be able to:

1. Define Cognitive Supported Learning (CSL) in the context of Spinal Cord Injury in Acute Inpatient Rehabilitation.
2. Discuss the SLP and interdisciplinary team role in supporting veterans with MS who report fatigue.
3. Explain how ethics intersects with law and policy.
4. Recognize through challenging case studies solutions that help individualize and optimize care.
5. Discuss the salient outcomes associated with healthcare engagement among adults living with Traumatic Spinal Cord Injuries (TSCI).
6. List the benefits of collaboration between the VA and patient advocacy groups.
7. Explain the role of an individual's cognitive appraisal of his or her disability as an influence in health, recovery, and psychosocial well-being.
8. Review the pathophysiological and cognitive mechanisms of fatigue in multiple sclerosis.
9. Recognize the impact of fatigue on all cognitive and linguistic functions.
10. Implement best practices in the management of SCI, MS, and ALS.

ACCREDITATION STATEMENTS

Pharmacists



AffinityCE is accredited by the Accreditation Council for Pharmacy Education as a provider of continuing pharmacy education. This knowledge-based activity will provide a maximum of up to 24.50 contact hours for participants completing all CPE activities. UANs are provided for each session. Participant CE records will be electronically communicated to CPE Monitor. There is no cost to participate in this activity.

Pharmacist Learning Objectives

- List two non-pharmacological interventions that increase life expectancy in ALS
- Identify a set up that can be used in your practice setting to demonstrate/provide training in smart home devices
- Identify three risk factors associated with wheelchair part failure.
- Discuss the significant role of mHealth platforms in improving the accessibility of health interventions for individuals with disabilities who use wheelchairs and scooters full-time.
- Define and categorize the risk factors associated with urinary tract infections (UTIs) in patients with neurogenic lower urinary tract dysfunction (NLUTD) performing clean intermittent catheterization (CIC).
- Explain the benefits and risks of osteoporosis treatments.
- Review the ways that medical devices are approved with the FDA
- Describe 2 key intrinsic risk factors of pressure injury in the population with spinal cord injury.

Psychologists

AffinityCE is approved by the American Psychological Association to sponsor continuing education for psychologists. AffinityCE maintains responsibility for this program and its content.

This activity provides up to 24.50 hours of CE Credit.

The instructional level of this activity is intermediate. The cost to participate in these CE sessions is included in the registration cost for the Program.

Social Workers

This program is Approved by the National Association of Social Workers (Approval # 886551225-1163) for 17 continuing education contact hours.

ACCREDITATION STATEMENTS

Dietitians



This activity has been planned and implemented in accordance with the accreditation requirements and policies of the Accreditation Council for Continuing Medical Education (ACCME) through the joint providership of AffinityCE and PVA. AffinityCE is accredited by the ACCME to provide continuing medical education for physicians.

AffinityCE designates this live activity for a maximum of up to 24.50 *AMA PRA Category 1 Credits™*. Dietitians should claim only the credit commensurate with the extent of their participation in the activity.

Rehabilitation Counselors



This activity has been submitted to the Commission on Rehabilitation Counselor Certification (CRCC) for 17 contact hours.

Other Professionals

All other health care professionals completing this continuing education activity will be issued a statement of participation indicating the number of hours of continuing education credit. This may be used for professional education CE credit. Please consult your accrediting organization or licensing board for their acceptance of this CE activity.

Commercial Support

No commercial support was provided for this activity.

Participation Costs

The cost to participate in these CE sessions is included in the registration cost for the program.

CME Inquiries

For all CME policy-related inquiries, please contact us at ce@affinityced.com.

How to Earn CE Credit

2024 Paralyzed Veterans of America (PVA) Healthcare Summit + Expo

1. Go to the following Web site: pva.cds.affinityced.com.
2. Select the activity: **2024 Paralyzed Veterans of America (PVA) Healthcare Summit + Expo**
3. Enter an e-mail address and password to begin setting up your profile. Select "I Forgot My Password" if you need to reset the password you set up.
4. Verify, correct, or add your information.
5. Proceed to complete activity evaluations for each session you attended.
6. After evaluating all attended sessions, you must complete the **Overall Evaluation** to download your CE certificate.
7. Upon completing your evaluations, you can download your CE certificate. Your CE record will also be stored here for later retrieval.
8. Participants claiming **ASHA CE credits must complete evaluations no later than**

ACCREDITATION STATEMENTS

September 14, 2024, to facilitate credit reporting to ASHA.

9. Participants claiming **Pharmacist CE credits** will need to supply their **Date of birth and NABP number**. Pharmacist CE records will be electronically communicated to CPE Monitor.
10. The Web site is open for completing your evaluation for 30 days after the event, until September 28, 2024.
11. After the Web site has closed, you can come back to the site at any time to print your certificate, but you will not be able to add any evaluations.

Please send any customer service requests to [cgs_support+PVA@affinityced.com](mailto:cds_support+PVA@affinityced.com).

Knowing is strength

Most people with genetic amyotrophic lateral sclerosis (ALS) do not have a family history of the disease.

ALS is a rare, progressive, and fatal disease. For people with ALS, nerve cells in the brain and spinal cord become impaired, leading to loss of muscle function throughout the body. Experts believe ALS may be caused by a combination of genetics and environmental or lifestyle factors.

As of 2023, the American Neurological Association recommends that everyone living with ALS should be offered genetic counseling and testing.



Potential benefits of genetic testing and counseling for people with ALS and their families



May reveal if there is a genetic component to your ALS and help you and your doctor make more informed clinical decisions



Provide information to help you make more informed life choices, including long-term care needs and family planning



Help family members understand if they may be at risk for ALS



Learnings from clinical trials may help inform clinical care and lead to the development of therapies that target the genetic components of ALS



May provide information as to whether the genetic mutation present is associated with the rate of progression of the disease

Talk to your doctor to determine if genetic testing and counseling are right for you or your loved one, or scan here for more information.





YOU WILL ALWAYS BE *FIRST* TO US.

From diagnosis to therapy delivery, First Nation Group's Patient Solutions supports VA healthcare providers in offering a comprehensive remote setup solution for sleep therapy, respiratory therapy, and wound care management.

Be sure to visit our team at Booth #103 and don't miss out on our Product Theater session on Monday, August 26, at 12:00pm.

Thank you for your dedication
to caring for our nation's heroes!



firstnationgroup.com



SBA WOSB
Woman Owned Small Business



Genentech

A Member of the Roche Group

JOIN US FOR A PRODUCT THEATER PRESENTATION

Advocacy in Action: Role of Advocacy in Health Care, Hosted by Genentech

PRESENTED BY:



JP Sacksteder

Senior Director,
Patient Advocacy Relations,
Genentech



Jerrod Harris

Person living with MS,
Patient Thought Leader,
Paralyzed Veterans of America



Jennifer Kumiyama

City of Long Beach Citywide
Accessibility Coordinator
United Spinal Association 2023
Advocate of the Year

August 26, 2024

5:00 PM – 5:45 PM

Location: Platinum 7-10

Come visit us in Booth #109

Genentech
A Member of the Roche Group

© 2024 Genentech USA, Inc. So. San Francisco, CA All rights reserved. M-US-00024783(v1.0) 08/24

PLEASE JOIN US WHILE AT THE 2024 PARALYZED VETERANS
OF AMERICA (PVA) SUMMIT AND EXPO FOR A PRESENTATION ABOUT

Timely Diagnosis of ALS and a Proven Treatment Option

TOPICS COVERED:

- Need for timely diagnosis and clinical intervention
- Role of general neurologists
- RADICAVA ORS[®] clinical evidence

WHEN

Tuesday, August 27, 2024
12:15 pm – 1:00 pm

Registration begins at 12:00 pm.

WHERE

Symposium 2:
Track 2, Platinum 7-10
Anaheim Marriott
700 W. Convention Way
Anaheim, CA 92802

Please stop by the MTPA Booth #119 for more information about RADICAVA ORS[®]

Go to radicavahcp.com for full Prescribing Information.

INDICATION

RADICAVA and RADICAVA ORS are indicated for the treatment of amyotrophic lateral sclerosis (ALS).

IMPORTANT SAFETY INFORMATION

Hypersensitivity Reactions

RADICAVA (edaravone) and RADICAVA ORS (edaravone) are contraindicated in patients with a history of hypersensitivity to edaravone or any of the inactive ingredients of this product. Hypersensitivity reactions (redness, wheals, and erythema multiforme) and cases of anaphylaxis (urticaria, decreased blood pressure, and dyspnea) have occurred with RADICAVA.

Patients should be monitored carefully for hypersensitivity reactions. If hypersensitivity reactions occur, discontinue RADICAVA or RADICAVA ORS, treat per standard of care, and monitor until the condition resolves.

Sulfite Allergic Reactions

RADICAVA and RADICAVA ORS contain sodium bisulfite, a sulfite that may cause allergic-type reactions, including anaphylactic symptoms and life-threatening or less severe asthmatic episodes in susceptible people. The overall prevalence of sulfite sensitivity in the general population is unknown but occurs more frequently in asthmatic people.

Adverse Reactions

The most common adverse reactions ($\geq 10\%$) reported in RADICAVA-treated patients were contusion (15%), gait disturbance (13%), and headache (10%). In an open label study, fatigue was also observed in 7.6% of patients receiving RADICAVA ORS.

Pregnancy

Based on animal data, RADICAVA and RADICAVA ORS may cause fetal harm.

To report suspected adverse reactions or product complaints, contact Mitsubishi Tanabe Pharma America, Inc., at 1-888-292-0058. You may also report suspected adverse reactions to the FDA at 1-800-FDA-1088 or www.fda.gov/medwatch.

Go to radicavahcp.com for full Prescribing Information.

This activity will be held during the PVA Healthcare Summit. It is not part of the official scientific program of the PVA Healthcare Summit.

This is a non-CME event sponsored by Mitsubishi Tanabe Pharma America, Inc.

Food and beverage is provided by PVA.





Join our Expert Session and Live Q&A

Non-Invasive Spinal Cord Stimulation Facilitates Arm and Hand Function in Chronic Tetraplegia - Results from the Up-LIFT Pivotal Trial*



Candy Tefertiller, PT, DPT, PhD, NCS

Executive Director of Research and Evaluation
Helen Phillips Levin Endowed Chair of Research
Craig Hospital, Denver

Tuesday August 27th at 7:00am PT

Breakfast Provided

Gold Sponsor - 2024 PVA Healthcare Summit & Expo

*All ONWARD® Medical devices and therapies, including but not limited to ARC^{IM}®, ARC^{EX}®, ARC^{BCI}™, and ARC Therapy™, alone or in combination with a brain-computer interface (BCI), are investigational and not available for commercial use.

**Learn more at onwd.com or
[@onwdempowered](https://twitter.com/onwdempowered)**



1875 Eye Street, Suite 1100, NW, Washington, DC 20006

PVA.org  **ParalyzedVeterans**   **PVA1946**

See you next year in New Orleans, LA!
August 24–27, 2025