

1
2
3
4
5
6
7
8
9
10
11
12
13
14
15
16
17
18
19
20
21
22
23
24
25
26
27
28

IN THE SUPERIOR COURT OF THE STATE OF ARIZONA
IN AND FOR THE COUNTY OF MARICOPA

IN RE THE GENERAL ADJUDICATION
OF ALL RIGHTS TO USE WATER IN
THE GILA RIVER SYSTEM AND
SOURCE

W-1, W-2, W-3, W-4 (Consolidated)

Contested Case No. W1-11-0212

ORDER TO SET TELEPHONIC STATUS
CONFERENCE
AND
ORDER TO ADWR TO REVIEW
ABSTRACTS FOR *DE MINIMIS* WATER
RIGHTS AND PREPARE MAP

CONTESTED CASE NAME: *In re Pyeatt Group of Cases*
HSR INVOLVED: San Pedro River Watershed Hydrographic Survey Report
DESCRIPTIVE SUMMARY: Telephonic status conference set for **May 20, 2021 at 1:30 p.m.**
NUMBER OF PAGES: 20
DATE OF FILING: March 19, 2016

This case began almost thirty years ago as part of the general adjudication of legal rights to use water. The prior proceedings did not result in an adjudication of rights claimed by the landowner and little activity has occurred with respect to the claimed rights for a number of years.

1 The case will again enter an active phase to determine legal rights to divert water from the
2 Babocomari River for irrigation, domestic, stock watering and stockpond uses.

3
4 **Brief Explanation of the General Adjudication**

5
6 This contested case is one of the many cases in the General Stream Adjudication for the
7 San Pedro River watershed. The purpose of the General Adjudication is to determine the legal
8 rights of those persons who filed statement of claimants to use water from the San Pedro
9 watershed. The Babocomari River is located in the San Pedro watershed.

10 Other cases in which claims have been made to water in the San Pedro River watershed
11 have been completed, are in the process of determining water rights, or awaiting initiation. The
12 General Adjudication will also determine water rights in the Upper Salt, Verde, Upper Gila,
13 Lower Gila, Agua Fria and Upper Santa Cruz watersheds. Persons who fail to timely file
14 statements of claimant will forfeit any rights to the use of water in this river system and source.

15
16 **Claims for Water Rights**

17
18 This contested case will determine water rights investigated by Arizona Department of
19 Water Resources. The claims for water rights are the subject of two reports, which are known
20 as Watershed File Reports, that were published in 1991 as part of the San Pedro Hydrographic
21 Survey Report. Watershed File Reports 111-19-DC-010 and 111-19-DDC-001 are attached as
22 Attachment A.

23
24 **1. Watershed File Report 111-19-DC-010**

25
26 In 1979, James Pyeatt filed Statement of Claimant 39-1609 for a water right for domestic
27 use. Mr. Pyeatt listed the source of water as Lyle Canyon, a tributary to the Babocomri River.
28 He subsequently amended the Statement of Claimant to include claims for water for livestock

1 use. The Watershed File Report found a domestic use of water on the southeastern quarter of
2 the southeastern quarter of the southeastern quarter of section 31 Township 21S R19E, Gila and
3 Salt River Base and Meridian, Cochise County, Arizona. The Watershed File Report also noted
4 that Pyeatt spring provides water for stockwatering uses and further stated that the domestic use
5 includes stockwatering uses.

6 In 2016, the Statement of Claimant was assigned to the trustee of the Pyeatt Living Trust.
7 According to the public records of the Cochise County Treasurer, the south half of the south half
8 of section 31 Township 21S R19E, tax parcel 106-45-002G, is owned by Pyeatt Ranch, LLC. A
9 copy of the Cochise County Treasurer's map is attached as Attachment B. The public records of
10 the Arizona Department of Water Resources do not include an assignment of the Statement of
11 Claimant from Marie Pyeatt, as trustee of the Pyeatt Living Trust, to the Pyeatt Ranch, LLC.

12 Expedited procedures have been adopted to determine water rights in the San Pedro
13 watershed for domestic uses, stock watering, and certain stockponds. See Memorandum
14 Decision, Findings of Fact, and Conclusions of Law for Group 1 Cases involving Stockwatering,
15 Stockponds, and Domestic Uses, dated November 14, 1994, amended February 23, 1995,
16 approved and modified September 27, 2002 ("Decision"). The first step in the process is the
17 preparation of proposed abstracts for the water rights. In accordance with the Decision, proposed
18 abstracts have been prepared for domestic and stock watering uses. The abstracts are attached
19 as Attachment C. Arizona Department of Water Resources shall review the abstracts and provide
20 the parties in this case with its comments along with a map that shows the boundaries of the land
21 investigated by Watershed File Report 111-19-DC-010 and the location of the domestic use and
22 stock watering use.

23 24 **2. Watershed File Report 111-19-DDC-001**

25
26 The Arizona Department of Water Resources also investigated water uses on land located
27 in the southwest quarter of section 31 Township 21S Range 19E and prepared Watershed File
28 Report 111-19-DDC-001. The land is more specifically shown on the map attached as

1 Attachment D. The land involved in this case is labelled as “(1)”. The Watershed File Report
2 identified potential water rights for domestic use, irrigation, and a stockpond on the land.

3 After the Arizona Department of Water Resources issued the Watershed File Report in
4 1991, James Pyeatt filed Statements of Claimant 39-15150, 39-15151 and 39-15152 for domestic
5 and irrigation uses and Statement of Claimant 39-15153 for a stockpond use. These Statements
6 of Claimant were subsequently assigned to Marie Pyeatt, as trustee of the Pyeatt Living Trust.
7 According to the public records of the Cochise County Treasurer, the south half of the south half
8 of section 31 Township 21S R19E, tax parcel 106-45-002G, is owned by Pyeatt Ranch, LLC.
9 The public records of the Arizona Department of Water Resources do not include an assignment
10 of the Statements of Claimant from Marie Pyeatt, as trustee of the Pyeatt Living Trust, to the
11 Pyeatt Ranch, LLC.

12 As explained above, the expedited procedures will be applied to the potential water rights
13 found by ADWR for domestic use and the stockpond. Proposed abstracts for domestic use and
14 for the stock pond are attached as Attachment E. Arizona Department of Water Resources shall
15 review the abstracts and provide the parties in this case with a map that shows the location of the
16 domestic use and the stockpond.

17
18 **IT IS ORDERED:**

19
20 A. Litigants. The litigants in this contested case are the Claimant, Marie Pyeatt, as
21 trustee of the Pyeatt Living Trust, the current landowner, Pyeatt Ranch, LLC, all
22 persons who filed objections to the listed watershed file reports, who are included
23 on Attachment F, and claimants who are allowed to intervene by order.

24
25 B. Court-Approved Mailing List.

26
27 1. The initial Court-approved mailing list for this case shall include all
28 persons listed on Attachment F to this order. The list may be modified

1
2
3
4
5
6
7
8
9
10
11
12
13
14
15
16
17
18
19
20
21
22
23
24
25
26
27
28

only by filing a motion with the Special Master to amend the Court-approved mailing list. Litigants are responsible for using the current Court-approved mailing list.

2. A copy of any pleading filed with the Clerk of the Maricopa County Superior Court in this case shall be served upon each person listed on the Court-approved mailing list.

3. Claimants wishing to be added or removed from the mailing list shall file a motion with the Special Master. Parties allowed to intervene will be automatically added to the mailing list.

C. Courtesy Email List. The Special Master’s office will email courtesy copies of orders and minute entries entered in this case to persons listed on Attachment F. Requests for inclusions on the email list should be sent to Durina Farrall at durina.farrall@jbazmc.maricopa.gov.

D. Review. Arizona Department of Water Resources shall review the attached abstracts, and provide comments and maps. The report and maps shall be filed by ADWR by **May 10, 2021**.

E. Status Conference.

1. An initial status conference shall be held to determine whether the Pyeatt Ranch, LLC intends to pursue claims for water rights and whether Pyeatt Ranch, LLC will obtain assignments of the Statements of Claimant from Marie Pyeatt, as trustee.

- 1 2. If water rights for irrigation use will be pursued with respect to the land,
2 then another purpose of the initial status conference will be to determine
3 whether objections to the potential water rights for irrigation can be
4 settled and the amount of time that the parties will require to discuss the
5 resolution of the objections.
6
7 3. If the objections cannot be settled, then a subsequent date will be set for
8 a scheduling conference to identify issues, file disclosure statements,
9 conduct discovery, submit prehearing motions, and hold a trial. No party
10 shall conduct any discovery or file any motions prior to the Status
11 Conference.

12
13 A telephonic Status Conference shall be held on **May 20, 2021 at 1:30 p.m.**
14

15 Instructions for telephonic appearance:
16 Dial: 602-506-9695 (local)
17 1-855-506-9695 (toll free long distance)
18 Dial Participant Pass Code 357264#

19
20 
21 SUSAN WARD HARRIS
22 Special Master

23 On March 19, 2021, the original of the foregoing was
24 delivered to the Clerk of the Maricopa County Superior
25 Court for filing and distributing a copy to all persons
26 listed on the Court-approved mailing list for this contested
27 case, a copy of which is attached hereto as Attachment E,

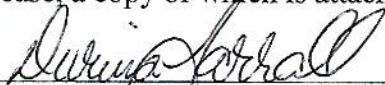
28 
Durina Farrall

ATTACHMENT A

FILED
 May 27, 1995
 JUDITH ALLEN, Clerk
 By *[Signature]*
 Deputy
 W1-11-212

LAND OWNER	WATERSHED FILE REPORT NUMBER
-----	-----
PYEATT, JUDITH E.	111-19-DC-010

A P P L I C A B L E F I L I N G S A N D D E C R E E S

CLEARLY STATED INFORMATION FROM FILINGS AND DECREES

FILING NUMBER	FILING STATUS	USES	QUANTITY IN AFA	USE LOCATION SECTION	TWNP	RNGE	CLAIM DATE	DIVERSION SECTION	LOCATION TWNP	RNGE
20-0207069					31	210S 190E	1928		31	210S 190E
36-0042687		STOCK	.61	SWSW31	210S	190E	1899	SWSW31	210S	190E
39-0001609	QUE.RECD	DOMESTIC	.50	SESE36	210S	180E	1928	SESE36	210S	180E

D W R A N A L Y S I S O F F I L I N G S A N D D E C R E E S

FILING NUMBER	USES CLAIMED OR REFERENCED	USES FOUND BY DWR	APPLIES TO DIVERSIONS	APPLIES TO PWR NUMBERS
20-0207069	STOCK	STOCK	SO2	
36-0042687	STOCK	INCIDENTAL	SO2	
39-0001609	DOMESTIC	DOMESTIC	SO2	D0001

D I V E R S I O N S

DIV #	LOCATION SECTION	TWNP	RNGE	DIVERSION NAME	WATER SOURCE AND CLASSIFICATION
SO2	SESESE31	210S	190E	PYEATT SPRING	SURFACE WATER: BABOCOMARI RIVER SHARED

U S E S

PWR #	LOCATION SECTION	TWNP	RNGE	SUPPLIED BY DIVERSIONS	WATER SOURCES	PHOTO SOURCE DATE	SOURCE CHANGE FACILITY NAME
D0001	SESESE31	210S	190E	SO2	SURFACE WATER		NO

S H A R E D U S E S A N D D I V E R S I O N S

** WATER FROM SO2 FOUND IN FILE (111-19-DDC-1) IS USED IN THIS FILE

P W R S U M M A R Y

PWR #	APPLICABLE ADJ FILINGS	APPLICABLE PRE FILINGS	*APPARENT FIRST USE DATE* DATE BASIS FOR DATE	WATER SOURCES AND CLASSIFICATIONS
D0001	39-0001609	20-0207069 36-0042687		SURFACE WATER: BABOCOMARI RIVER

Q U A N T I T I E S O F U S E

PWR #	QUANTIFICATION TYPE	ACRES	CROP TYPE	EFF	WATER DUTY	ESTIMATED VOLUME	REMARKS
D0001							SEE VOLUME 1 - GENERAL ASSESSMENT

E X P L A N A T I O N

FILINGS AND DECREES
 FILING 39-1609 - A UNIFORM QUESTIONNAIRE WAS RECEIVED WHICH PROVIDED NEW INFORMATION ON THE WATER USE AMOUNT AND CLAIM DATE.
 DECREE 20-0207069 - HENRY PYEATT -VS- HUACHUCA QUEEN MINING COMPANY, ISSUED IN JUNE 1928 STATED THAT THE DEFENDANTS (MCFADDIN AKA HUACHUCA QUEEN MINING CO.) WERE RESTRAINED FROM PUMPING MINE WATERS TO THE EXTENT THAT IT INTERFERED WITH PLAINTIFF PYEATT'S SPRING FLOW. FOR MORE INFORMATION ON THIS DECREE, SEE CHAPTER 1 IN VOLUME 1.

6006

1
2
3
4
5
6
7
8
9
10
11
12
13
14
15
16
17
18
19
20
21
22
23
24
25
26
27
28

DIVERSIONS

S2 - DIVERSION FROM PYEATT SPRING INTO A PIPELINE. THIS SPRING PROVIDES WATER FOR DOMESTIC AND STOCKWATERING USES.

USES AND RESERVOIRS

DM1 - DOMESTIC WATER USE INCLUDES STOCKWATERING USES.

SHARED USES AND DIVERSIONS

S2 - SPRING IS SHARED WITH W.F.R. #111-19-DDC-1.

Attachment to Watershed File Report: 111-19-DC-010

Phoenix objects to Categories 8 and 9 for the reason that: DWR reports that Decree No. 20-0207069 is applicable to DM001 yet DWR fails to report either the decreed volume in the "Quantities of Use" section or the decreed date of first use in "Potential Water Right Summary". (910) (920) (1010)

1
2
3
4
5
6
7
8
9
10
11
12
13
14
15
16
17
18
19
20
21
22
23
24
25
26
27
28

LAND OWNER ----- WATERSHED FILE
 PYEATT, ROLAND ----- REPORT NUMBER
 111-19-DDC-001

FILED
 May 27, 1992
 JUDITH ALLEN, Clerk
 By *[Signature]*
 Deputy
 W1-11-213

APPLICABLE FILINGS AND DECREES

CLEARLY STATED INFORMATION FROM FILINGS AND DECREES

FILING NUMBER	FILING STATUS	USES	QUANTITY IN AFA	USE LOCATION SECTION	TWNP	RNGE	CLAIM DATE	DIVERSION LOCATION SECTION	TWNP	RNGE
20-0207069				31	210S	190E	1928	31	210S	190E
36-0028444		DOMESTIC STOCK	4.60	SWSW31	210S	190E	1899	SWSW31	210S	190E
36-0028529		STOCK	1.10	SWSW25	210S	180E	1905	SWSW25	210S	180E
36-0028734		DOMESTIC STOCK	3.07	SWSW31	210S	190E	1899	SWSW31	210S	190E
36-0042687		STOCK	.61	SWSW31	210S	190E	1899	SWSW31	210S	190E
39-0000586	QUE.RECD	STOCK	1.12	NENWSE36	210S	180E	1979	NENWSE36	210S	180E

DWR ANALYSIS OF FILINGS AND DECREES

FILING NUMBER	USES CLAIMED OR REFERENCED	USES FOUND BY DWR	APPLIES TO DIVERSIONS	APPLIES TO PWR NUMBERS
20-0207069	DOMESTIC	DOMESTIC	SO1,SO2	DMOO1
36-0028444	DOMESTIC STOCK	DOMESTIC SPRING	SO1	DMOO1
36-0028529	STOCK	STOCKWELL		
36-0028734	DOMESTIC STOCK	DOMESTIC STOCK	SO2	DMOO1, SPOO1
36-0042687	STOCK	STOCK	SO2	SPOO1
39-0000586	STOCK	STOCKWELL		

DIVERSIONS

DIV #	LOCATION SECTION TWNP RNGE	DIVERSION NAME	WATER SOURCE AND CLASSIFICATION
SO1	SESWSW31 210S 190E	UNNAMED SPRING	SURFACE WATER: BABOCOMARI RIVER
SO2	SWSWSW31 210S 190E	PYEATT SPRING	SURFACE WATER: BABOCOMARI RIVER SHARED

USES

PWR #	LOCATION SECTION TWNP RNGE	SUPPLIED BY DIVERSIONS	WATER SOURCES	PHOTO SOURCE DATE	CHANGE FACILITY NAME
DMOO1	SWSWSW31 210S 190E	SO1,SO2	SURFACE WATER		NO
IROO1	SWSW31 210S 190E	SO1,SO2	SURFACE WATER	1935	NO

RESERVOIRS

PWR #	LOCATION SECTION TWNP RNGE	SUPPLIED BY DIVERSIONS	WATER SOURCES	PHOTO DATE	RESERVOIR NAME	STORAGE PURPOSE
SPOO1	NWSESW31 210S 190E	SO2	SURFACE WATER	1984	PYEATT SPRING	STOCKWATERING

SHARED USES AND DIVERSIONS

** WATER FROM SO2 IS SHARED WITH THESE ADDITIONAL FILES:
 111-19-DC-10

PWR SUMMARY

PWR #	APPLICABLE ADJ FILINGS	APPLICABLE PRE FILINGS	*APPARENT FIRST USE DATE* DATE BASIS FOR DATE	WATER SOURCES AND CLASSIFICATIONS
DMOO1	NONE	20-0207069 36-0028444 36-0028734		SURFACE WATER: BABOCOMARI RIVER

0007

1
2
3
4
5
6
7
8
9
10
11
12
13
14
15
16
17
18
19
20
21
22
23
24
25
26
27
28

FILE 111-19-DDC-001 (CONTINUED)
P W R S U M M A R Y (CONTINUED)

CONTINUATION OF PAGE: 266

PWR #	APPLICABLE ADJ FILINGS	APPLICABLE PRE FILINGS	*APPARENT FIRST USE DATE* DATE BASIS FOR DATE	WATER SOURCES AND CLASSIFICATIONS
DMOO1		36-0042687		
IROO1	NONE	20-0207069 36-0028444 36-0028734	1899 FILING 36-28444	SURFACE WATER: BABOCOMARI RIVER
SPOO1	NONE	36-0042687 20-0207069 36-0028734 36-0042687	1984 1984 AERIAL PHOTO	SURFACE WATER: BABOCOMARI RIVER
NONE	39-0000586	36-0028529		

Q U A N T I T I E S O F U S E

PWR #	QUANTIFICATION TYPE	ACRES	CROP TYPE	EFF	WATER DUTY	ESTIMATED VOLUME	REMARKS
DMOO1							SEE VOLUME 1 - GENERAL ASSESSMENT
IROO1	MAX. OBSERVED REGIONAL	3.4	FRUIT TREES	48%	6.2 AF/AC	21.1 AFA	
	MAX. POTENTIAL	3.4	AVE. CROP	50%	5.4 AF/AC	18.4 AFA	
SPOO1	MAX. AREA/CAP	LT 2.0	ALFALFA	48%	6.9 AF/AC	23.5 AFA	
						LTE 15.0 AF	

E X P L A N A T I O N

FILINGS AND DECREES

FILING 39-586 - A UNIFORM QUESTIONNAIRE WAS RECEIVED WHICH PROVIDED NEW WATER USE AND DECREE 20-0207069 - HENRY PYEATT -VS- HUACHUCA QUEEN MINING COMPANY, ISSUED IN JUNE 1928, STATED THAT THE DEFENDANT (MCFADDIN AKA HUACHUCA QUEEN MINING CO.), WERE RESTRAINED FROM PUMPING MINE WATERS TO THE EXTENT THAT IT INTERFERED WITH THE NORMAL SPRING FLOW FROM PLAINTIFF PYEATT'S SPRING. FOR MORE INFORMATION ON THIS DECREE, SEE CHAPTER 1 IN VOLUME 1.

DIVERSIONS

S1 & S2 - DIVERSIONS FROM PYEATT SPRING AND AN UNNAMED SPRING INTO A PIPELINE. THESE SPRINGS PROVIDE WATER FOR IRRIGATION, DOMESTIC AND STOCKWATERING USES.

USES AND RESERVOIRS

DM1 - DOMESTIC USE.
IR1 - IRRIGATED FRUIT TREES.
SP1 - PYEATT SPRING STOCKPOND.

SHARED USES AND DIVERSIONS

S2 - SPRING IS SHARED WITH W.F.R. #111-19-DC-10.

1
2
3
4
5
6
7
8
9
10
11
12
13
14
15
16
17
18
19
20
21
22
23
24
25
26
27
28

ATTACHMENT B

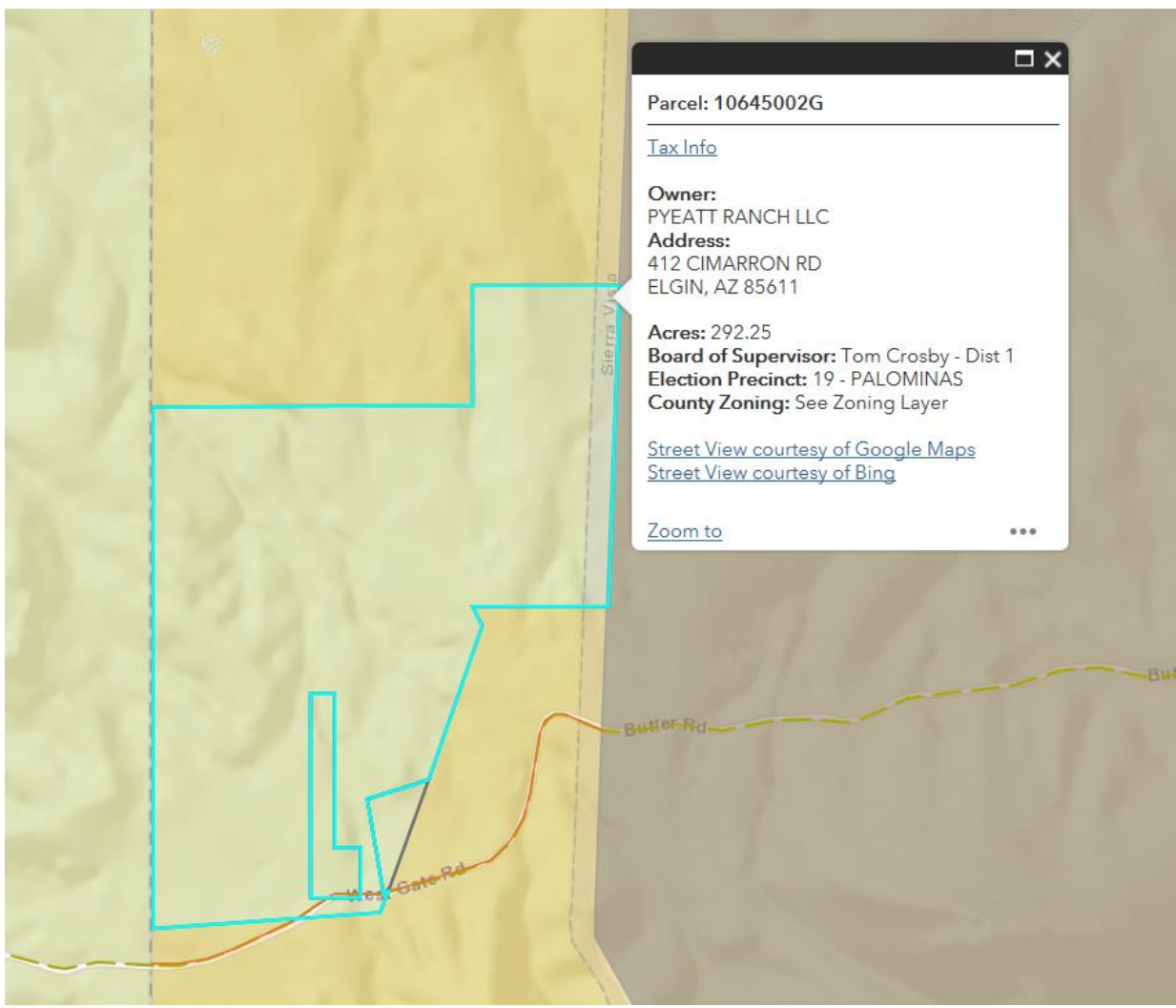

1
2
3
4
5
6
7
8
9
10
11
12
13
14
15
16
17
18
19
20
21
22
23
24
25
26
27
28

ATTACHMENT C

**Proposed Abstract of Water Right
San Pedro Watershed**

Attribute	Proposed Abstract of Water Right	ADWR Comments
1. Proposed Water Right No.:	111-19-DC-001-DM001	
2. Owner of Water Right:		
3. Landowner:	Pyeatt Ranch, LLC	
4. Statement of Claimant No.(s):	39-0001609	
5. Statement of Claimant Name(s):	Pyeatt Living Trust	
6. Lessee or Permittee:	N/A	
7. Basis of Right:	20-0207069 36-0042687	
8. Beneficial Use:	Domestic use	
9. Priority Date:	6/19/1928	
10. Quantity:	Not to exceed (\leq) one acre foot	
11. Place of Use:	SESESE Section 31 T21S R19E Gila and Salt River Base and Meridian, Cochise County, AZ	
12. Point of Diversion:	SESESE Section 31 T21S R19E Gila and Salt River Base and Meridian, Cochise County, AZ	
13. Source of Water:	Surface Water: Pyeatt Spring	

**Proposed Abstract of Water Right
San Pedro Watershed**

Attribute	Proposed Abstract of Water Right	ADWR Comments
1. Proposed Water Right No.:	111-19-DC-001-SW001	
2. Owner of Water Right:		
3. Landowner:	Pyeatt Ranch, LLC	
4. Statement of Claimant No.(s):	39-0001609	
5. Statement of Claimant Name(s):	Pyeatt Living Trust	
6. Lessee or Permittee:	N/A	
7. Basis of Right:	20-0207069 36-0042687	
8. Beneficial Use:	Stock and wildlife watering	
9. Priority Date:	6/19/1928	
10. Quantity:	Reasonable use	
11. Place of Use:	SWSW Section 31 T21S R19E Gila and Salt River Base and Meridian, Cochise County, AZ	
12. Point of Diversion:	SWSW Section 31 T21S R19E Gila and Salt River Base and Meridian, Cochise County, AZ	
13. Source of Water:	Surface Water: Pyeatt Spring	

ATTACHMENT D

1
2
3
4
5
6
7
8
9
10
11
12
13
14
15
16
17
18
19
20
21
22
23
24
25
26
27
28

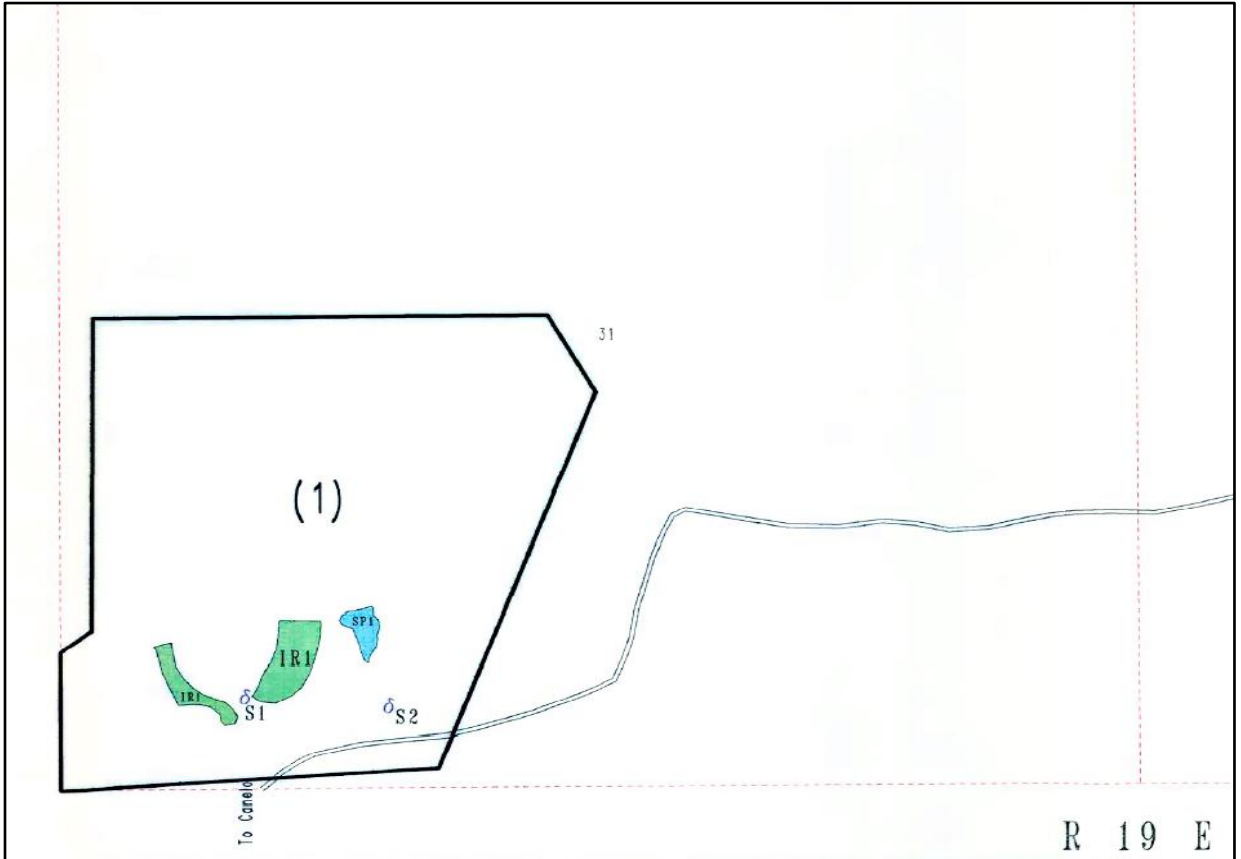

1
2
3
4
5
6
7
8
9
10
11
12
13
14
15
16
17
18
19
20
21
22
23
24
25
26
27
28

ATTACHMENT E

**Proposed Abstract of Water Right
San Pedro Watershed**

Attribute	Proposed Abstract of Water Right	ADWR Comments
1. Proposed Water Right No.:	111-19-DDC-SP001	
2. Owner of Water Right:		
3. Landowner:	Pyeatt Ranch, LLC	
4. Statement of Claimant No.(s):	39-15153	
5. Statement of Claimant Name(s):	Pyeatt Living Trust	
6. Lessee or Permittee:	N/A	
7. Basis of Right:	20-0207069 36-028734 36-42687	
8. Beneficial Use:	Stock watering from a Stock Pond	
9. Priority Date:	12/31/1984	
10. Quantity:	Not to exceed (\leq) 4 acre feet annually with continuous fill	
11. Place of Use:	NWSESW Section 31 T21S R19E Gila and Salt River Base and Meridian, Cochise County, AZ	
12. Point of Diversion:	NWSESW Section 31 T21S R19E Gila and Salt River Base and Meridian, Cochise County, AZ	
13. Source of Water:	Surface Water: Babocomari River	
14. Facility	Spring Stock Pond: Pyeatt Spring	

**Proposed Abstract of Water Right
San Pedro Watershed**

Attribute	Proposed Abstract of Water Right	ADWR Comments
1. Proposed Water Right No.:	111-19-DDC-001-DM001	
2. Owner of Water Right:		
3. Landowner:	Pyeatt Ranch, LLC	
4. Statement of Claimant No.(s):	39-15150 39-15151 39-15152	
5. Statement of Claimant Name(s):	Pyeatt Living Trust	
6. Lessee or Permittee:	N/A	
7. Basis of Right:	20-0207069 36-0028444 36-0028734	
8. Beneficial Use:	Domestic use	
9. Priority Date:	12/31/1899	
10. Quantity:	Not to exceed (\leq) one acre foot	
11. Place of Use:	SWSESW Section 31 T21S R19E Gila and Salt River Base and Meridian, Cochise County, AZ	
12. Point of Diversion:	SWSESW Section 31 T21S R19E Gila and Salt River Base and Meridian, Cochise County, AZ	
13. Source of Water:	Surface Water: Pyeatt Spring	

ATTACHMENT F

1
2
3 Arizona Department of Water Resources
4 Kimberly Parks
5 P. O. Box 36020
6 Phoenix, AZ 85067

6 ASARCO Incorporated
7 Lauren J. Caster
8 Fennemore Craig, P.C.
9 2394 East Camelback Road
10 Suite 600
11 Phoenix, AZ 85016-3429

10 BHP Copper, Inc.
11 John D. Burnside
12 Snell & Wilmer, L.L.P.
13 400 E. Van Buren Street, Ste 1900
14 Phoenix AZ 85004

13 Charles Cahoy
14 City of Phoenix Attorney's Office
15 200 W. Washington 13th Flr.
16 Phoenix, AZ 85003

16 Clerk of the Superior Court
17 Maricopa County
18 Attn: Water Case
19 601 West Jackson Street
20 Phoenix, AZ 85003

20 Gila River Indian Community
21 Linus Everling and Thomas L. Murphy
22 Office of the General Counsel
23 P. O. Box 97
24 Sacaton, AZ 85147

23 Judith G. Pyeatt
24 HCR Box 431
25 Elgin, AZ 85611

25 Joe P. Sparks and Laurel A. Herrmann
26 The Sparks Law Firm, P.C.
27 7503 First Street
28 Scottsdale, AZ 85251-4573

1 Lucas T. Christian & Julian Nava
Rosette, LLP
2 565 W. Chandler Blvd. Suite 212
Chandler, AZ 85225
3
4 Pyeatt Ranch LLC
Manuel R. Murrietta, Statutory Agent
5 415 Cimarron Road
Elgin, Arizona 85611
6
7 S. Montgomery, R. Interpreter, J. Tomkus
Montgomery & Interpreter, Plc
3301 E. Thunderbird Road
8 Phoenix, AZ 85032
9
10 Salt River Valley Water Users Association,
Salt River Project Agricultural Improvement and Power District
John B. Weldon, Jr. and Mark A. McGinnis
11 Salmon, Lewis & Weldon PLC
2850 E Camelback Rd, Ste. 200
12 Phoenix, AZ 85016
13
14 Special Master Susan Ward Harris
Superior Court of Arizona
201 W. Jefferson Street
15 Courtroom 301
Phoenix, AZ 85003
16
17 U. S. Department of Justice
18 Patrick Barry and Emma Blades
Environment and Natural Resources
19 P. O. Box 7611
Washington, D.C. 20044-7611
20
21
22
23
24
25
26
27
28