

1
2
3
4
5
6
7
8
9
10
11
12
13
14
15
16
17
18
19
20
21
22
23
24
25
26
27
28

IN THE SUPERIOR COURT OF THE STATE OF ARIZONA
IN AND FOR THE COUNTY OF MARICOPA

IN RE THE GENERAL ADJUDICATION
OF ALL RIGHTS TO USE WATER IN
THE GILA RIVER SYSTEM AND
SOURCE

W-1, W-2, W-3, W-4 (Consolidated)
Contested Case No. W1-11-1986
ORDER TO INITIATE CONTESTED
CASE

CONTESTED CASE NAME: *In re Max J. and Donna Kartchner*
HSR INVOLVED: San Pedro River Watershed Hydrographic Survey Report
DESCRIPTIVE SUMMARY: Contested case W1-11-1986 initiated, ADWR directed to map location of wells, and status conference set for June 19, 2019.
NUMBER OF PAGES: 16
DATE OF FILING: April 22, 2019

This Order initiates a contested case to consider the claims and resolve objections to Watershed File Report 112-17-BDA-007 ("WFR") published in the Final San Pedro River Watershed Hydrographic Survey Report (1991). The WFR identifies potential water rights for irrigation and small reservoirs for the land described in the WFR as located in sections 23 and 24 Township 17S Range 20E. The identified sources of water for the claimed uses were a diversion into the Pomerene Water Users Association canal from the San Pedro River and

1 wells. A copy of the watershed file report is attached as Attachment A. A copy of the map of
2 section 23 prepared for the WFR is attached as Attachment B.

3
4 **Background**

5 Until October 5, 2018, this case was consolidated and a part of that group of cases
6 known as *In re Pomerene Water Users Association*, contested case no. W1-11-1676. In that
7 case, the court scheduled a status conference for June 28, 2017 to identify the proper parties.
8 At the status conference, counsel for the Pomerene Water Users Association was given until
9 October 2, 2017 to provide documentation concerning the continuing authority of Pomerene
10 Water Users Association to act on its own behalf and on behalf of its members. By order
11 dated July 26, 2017, the court directed the owners of land for which Arizona Department of
12 Water Resources had identified as places of use for water diverted through the Pomerene
13 Canal to file new or amended statements of claimant if they desired to assert a claim for a
14 right to divert water through the Pomerene Users Association Canal for irrigation use. A
15 second status conference was set for October 18, 2017.

16
17
18 At the status conference held on October 18, 2017, the newly elected board of the
19 Pomerene Water Users Association appeared along with its counsel. The court directed the
20 Pomerene Water Users Association to file a list by December 29, 2017 that identified those
21 landowners who were members by the Pomerene Water Users Association and whose
22 interests would be represented by the Pomerene Water Users Association in this adjudication
23 of water rights. The court also set a third status conference for September 6, 2018. On
24 December 21, 2017, the Pomerene Water Users Association timely filed a list of 26
25 landowners. El Dorado Benson LLC and the Kirkpatrick Family Trust were not included on
26 the list filed by Pomerene Water Users Association.
27
28

1 On August 31, 2018, Pomerene Water Users Association filed a Notice of
2 Termination. At the third status conference counsel for the Pomerene Water Users
3 Association provided a list of its members who joined the St. David Irrigation District and
4 those members who declined to join the St. David Irrigation District. El Dorado Benson LLC
5 and the Kirkpatrick Family Trust were not included on either list.

6 By order dated October 5, 2018, the cases previously consolidated into a single case
7 known as *In re Pomerene Water Users Association* were separated into individual cases.

8
9 **Landowners and Sources of Water**

10 The first step to adjudicate the potential water rights identified by the WFR is to
11 identify the current landowners involved in this case. Based on the WFR, the land involved
12 may include the following tax parcels: 124-18-008B and 124-18-008D. According to the
13 Cochise County Assessor the respective owners of those parties are the Kirkpatrick Family
14 Trust and El Dorado Benson LLC. Attached as Attachment C is map of the parcels provided
15 by the Cochise County Assessor. Based on the public records of the Arizona Department of
16 Water Resources neither landowner has filed a statement of claimant or had a statement of
17 claimant assigned to it with respect to claims for water rights for use on the land.

18
19 The stated sources of water for use on the land include in the WFR were diversions of
20 water from the San Pedro River through the Pomerene Water Users Association Canal and
21 wells. Given the termination of the Pomerene Water Users Association and the fact that the
22 lands described by the WFR have apparently not been annexed into the St. David Irrigation
23 District, wells must provide the source of water for the potential water rights.

24
25 **Status Conference**

26 An initial status conference shall be held in this case to determine if the landowners
27 intend to assert claims for the potential water rights included in the WFR. Failure to
28

1 participate at the status conference or file a statement of claimant with the Arizona Department
2 of Water Resources may result in no adjudication of the potential water rights associated with
3 the land described in the WFR. Accordingly,

4 **IT IS ORDERED** that by **May 31, 2019**, the Arizona Department of Water Resources
5 shall file a map that shows the wells identified in the WFR as sources of water for the potential
6 water rights relative to the boundaries of the subflow zone.
7

8 **IT IS FURTHER ORDERED:**

9
10 1. Contested Case. This contested case shall be known as *In re Max J. and Donna*
11 *Kartchner* and it will address the objections that were filed to the watershed file report 112-17-
12 BDA-007 published in the Final San Pedro River Watershed Hydrographic Survey Report
13 (1991). Copies of objections can be found on the following website:

14 2. Litigants. The litigants in this contested case are the claimants, the current
15 landowners, all persons who filed objections to the listed watershed file reports who are listed
16 on Attachment B, and claimants who are allowed to intervene by order.

17 3. Court-Approved Mailing List.

18 A. The initial Court-approved mailing list for this case shall include all
19 persons listed on Attachment B to this order. The list may be modified only by
20 filing a motion with the Special Master to amend the Court-approved mailing
21 list. Litigants are responsible for using the current Court-approved mailing list.
22

23 B. A copy of any pleading filed with the Clerk of the Maricopa County
24 Superior Court in this case shall be served upon each person listed on the Court-
25 approved mailing list.
26
27
28

1 C. Claimants wishing to be added or removed from the mailing list shall file
2 a motion with the Special Master. Parties allowed to intervene will be
3 automatically added to the mailing list.

4 4. Courtesy Email List.

5 The Special Master's office will email courtesy copies of orders and minute
6 entries entered in this case to persons listed on Attachment B. Requests for
7 inclusions on the email list should be sent to Barbara Brown at
8

9 brownb099@superiorcourt.maricopa.gov.

- 10 5. Status Conference. A status conference shall be held on **June 19, 2019**, at 1:30
11 p.m. before:

12 Special Master Susan Ward Harris
13 Superior Court of Arizona
14 201 West Jefferson Street
15 Courtroom 301
Phoenix, AZ 85003-2202

16 Instructions for telephonic appearance:
17 Dial: 602-506-9695 (local)
18 1-855-506-9695 (toll free long distance)
19 Dial Participant Pass Code 357264#

20 
21 _____
22 SUSAN WARD HARRIS
23 Special Master

24 On April 22, 2019, the original of the foregoing was
25 delivered to the Clerk of the Maricopa County Superior
26 Court for filing and distributing a copy to all persons
27 listed on the Court-approved mailing list for this
28 contested case, a copy of which is attached hereto as
Attachment B, and to all persons listed on the Court-
approved mailing list for W-1, W-2, W-3, and W-4
(Consolidated).

ATTACHMENT A

1
2
3
4
5
6
7
8
9
10
11
12
13
14
15
16
17
18
19
20
21
22
23
24
25
26
27
28

LAND OWNER

 KARTCHNER, MAX J.
 & DONNA L. (TRUSTEES)

WATERSHED FILE
 REPORT NUMBER

 112-17-BDA-007

APPLICABLE FILINGS AND DECREES

CLEARLY STATED INFORMATION FROM FILINGS AND DECREES

FILING NUMBER	FILING STATUS	USES	QUANTITY IN AFA	USE SECTION	LOCATION TWP	RNGE	CLAIM DATE	DIVERSION SECTION	LOCATION TWP	RNGE
36-0026558		IRRIGATION STOCK	8.07	SWNE23	170S	200E	1939			
36-0026559		REC/FISH/WLDF IRRIGATION DOMESTIC STOCK	12.90	SWSW24	170S	200E	1977			
36-0026560		REC/FISH/WLDF IRRIGATION	400.00	SWSW24	170S	200E	1977			
36-0026564		IRRIGATION	425.00	SWNE23	170S	200E	1956			
36-0026565		IRRIGATION	50.00	SWNE23	170S	200E	1942			
36-0026566		IRRIGATION DOMESTIC STOCK			33 160S	200E	1900	25	170S	200E
39-0003875		IRRIGATION	300.00	SW24	170S	200E	1910			
39-0003880		IRRIGATION	50.00	NW24	170S	200E	1907	NENE36	170S	200E
39-0003881		IRRIGATION	50.00	NESWSE23	170S	200E	1907	NESWSE23	170S	200E
39-0003882		IRRIGATION	3.00	SWSWNE23	170S	200E	1907	SWSWNE23	170S	200E
39-0003883		STOCK	.34	NESWSW24	170S	200E	1901	NESWSW24	170S	200E
39-0003883		IRRIGATION	8.00	SWSWNE23	170S	200E	1907	SWSWNE23	170S	200E
39-0003885		STOCK	.57							
39-0003886		IRRIGATION	400.00	SW24	170S	200E	1901	SESWSW24	170S	200E
39-0003888		IRRIGATION	425.00	NE23	170S	200E	1907	SESWNE23	170S	200E
39-0003888		IRRIGATION	200.00	SENE23	170S	200E	1954			
39-0006572		IRRIGATION DOMESTIC STOCK	40.00	NW24	170S	200E	1954			
39-0011757		STOCK	.22		23 170S	200E				
		REC/FISH/WLDF	3.11							
		IRRIGATION	20.00							
		STOCK		SE14	170S	200E	1950			
		REC/FISH/WLDF		NE23	170S	200E				

DWR ANALYSIS OF FILINGS AND DECREES

FILING NUMBER	USES CLAIMED OR REFERENCED	USES FOUND BY DWR	APPLIES TO DIVERSIONS	APPLIES TO PWR NUMBERS
36-0026558	IRRIGATION STOCK	IRRIGATION	W05, W08	IR090, IR091, IR092 SRO01, SRO02
36-0026559	RECREATION IRRIGATION DOMESTIC STOCK	INCIDENTAL IRRIGATION NONE	W02	IR004
36-0026560	WILDLIFE IRRIGATION	INCIDENTAL IRRIGATION	W02, W03	IR004
36-0026564	IRRIGATION	IRRIGATION	W05, W06, W08	IR090, IR091, IR092
36-0026565	IRRIGATION	IRRIGATION	W05, W06, W08	IR090, IR091, IR092
36-0026566	IRRIGATION DOMESTIC STOCK	IRRIGATION NONE	DO1	IR090, IR091, IR092 IR004, SRO01, SRO02 SRO03
39-0003875	IRRIGATION	INCIDENTAL IRRIGATION		
39-0003880	IRRIGATION	IRRIGATION	DO1	IR091, IR004
39-0003881	IRRIGATION	IRRIGATION	W07	IR090, IR091, IR092
39-0003882	IRRIGATION	IRRIGATION	W05, W08	IR090, IR091, IR092
39-0003883	STOCK	INCIDENTAL IRRIGATION	W02	IR091, IR004, SRO03
39-0003883	IRRIGATION	IRRIGATION	W05, W08	IR090, SRO01, SRO02
39-0003885	STOCK	INCIDENTAL IRRIGATION		
39-0003886	IRRIGATION	IRRIGATION	W03	IR004
39-0003888	IRRIGATION	IRRIGATION	W06	IR090, IR091, IR092 IR090, IR092, PS002 SRO03
39-0006572	IRRIGATION DOMESTIC	IRRIGATION NONE		IR090, IR092, PS002 SRO03

FILING NUMBER	USES CLAIMED OR REFERENCED	USES FOUND BY DWR	APPLIES TO DIVERSIONS	APPLIES TO PWR NUMBERS
39-0006572	STOCK RECREATION WILDLIFE	INCIDENTAL INCIDENTAL INCIDENTAL		
39-0011757	IRRIGATION STOCK WILDLIFE	IRRIGATION INCIDENTAL INCIDENTAL		IRO90, IRO92, PS002 SRO03

D I V E R S I O N S

DIV #	LOCATION			DIVERSION NAME	WATER SOURCE AND CLASSIFICATION
	SECTION	TWNP	RNGE		
DO1	NWSENE36	170S	200E	POMERENE CANAL	SURFACE WATER: SAN PEDRO RIVER SHARED
WO1	SWSNW24	170S	200E	UNNAMED	GROUNDWATER : ZONE 2 SHARED
WO2	NESWSW24	170S	200E	UNNAMED	GROUNDWATER : ZONE 2 SHARED
WO3	SESWSW24	170S	200E	UNNAMED	GROUNDWATER : ZONE 1 OF THE SAN PEDRO RIVER SHARED
WO4	NWSENE23	170S	200E	UNNAMED	GROUNDWATER : ZONE 2 SHARED
WO5	SWSWNE23	170S	200E	UNNAMED	GROUNDWATER : ZONE 2
WO6	NESWNE23	170S	200E	UNNAMED	GROUNDWATER : ZONE 1 OF THE SAN PEDRO RIVER
WO7	NESWSE23	170S	200E	UNNAMED	GROUNDWATER : ZONE 2 UNUSED
WO8	SWSWNE23	170S	200E	UNNAMED	GROUNDWATER : ZONE 2
WO9	SWSWSE23	170S	200E	UNNAMED	GROUNDWATER : ZONE 2 SHARED
W10	SWNWSE23	170S	200E	UNNAMED	GROUNDWATER : ZONE 2 UNUSED

U S E S

PWR #	LOCATION			SUPPLIED BY DIVERSIONS	WATER SOURCES	PHOTO DATE	SOURCE CHANGE	FACILITY NAME
	SECTION	TWNP	RNGE					
IRO04	NWSW24 SWSW24	170S 170S	200E 200E	DO1, WO1, WO2 WO3	SURFACE WATER GROUNDWATER : ZONE 1 GROUNDWATER : ZONE 2	1983	NO	
IRO90	NWSE23 SWNE24	170S 170S	200E 200E	WO5, WO6, WO8	GROUNDWATER : ZONE 1 GROUNDWATER : ZONE 2	1935	NO	
IRO91	NENW24 NWNE23 SENW24 SWNE23	170S 170S 170S 170S	200E 200E 200E 200E	DO1, WO1, WO5 WO6, WO8	SURFACE WATER GROUNDWATER : ZONE 1 GROUNDWATER : ZONE 2	1955	NO	
IRO92	NWNE23 SWNE23	170S 170S	200E 200E	WO5, WO6, WO8	GROUNDWATER : ZONE 1 GROUNDWATER : ZONE 2	1964	NO	

R E S E R V O I R S

PWR #	LOCATION			SUPPLIED BY DIVERSIONS	WATER SOURCES	PHOTO DATE	RESERVOIR NAME	STORAGE PURPOSE
	SECTION	TWNP	RNGE					
PS002	SWNESW24	170S	200E	DO1, WO1, WO2 WO4	SURFACE WATER GRNDWTR : ZONE 2	1987	UNNAMED	IRRIGATION STOCKWATERING WILDLIFE
SRO01	SWSWNE23	170S	200E	WO5	GRNDWTR : ZONE 2	1935	UNNAMED	IRRIGATION STOCKWATERING WILDLIFE
SRO02	SWSWNE23	170S	200E	WO8	GRNDWTR : ZONE 2	1935	UNNAMED	IRRIGATION STOCKWATERING WILDLIFE
SRO03	SWSNW24	170S	200E	DO1, WO1	SURFACE WATER GRNDWTR : ZONE 2	1979	UNNAMED	IRRIGATION STOCKWATERING WILDLIFE

** DIVERSION DO1 OPERATED BY THE POMERENE WATER USERS ASSOC.
 (FILE 112-17-89) SUPPLIES WATER TO PWRS IN THIS FILE.
 ** WATER FROM WO1 IS SHARED WITH THESE ADDITIONAL FILES:
 112-17-ACB-8, 112-17BDA-14
 ** WATER FROM WO2 IS SHARED WITH THESE ADDITIONAL FILES:
 112-17-ACB-8, 112-17BDA-14
 ** WATER FROM WO3 IS SHARED WITH THESE ADDITIONAL FILES:
 112-17-ACB-8, 112-17BDA-14
 ** WATER FROM WO4 FOUND IN FILE (112-17-BDA-4) IS USED IN THIS FILE
 ** WATER FROM WO9 IS SHARED WITH THESE ADDITIONAL FILES:
 112-17BDA-11

P W R S U M M A R Y

PWR #	APPLICABLE ADJ FILINGS	APPLICABLE PRE FILINGS	*APPARENT FIRST USE DATE* DATE BASIS FOR DATE	WATER SOURCES AND CLASSIFICATIONS
IRO04	39-0003875 39-0003882 39-0003885	36-0026559 36-0026560 36-0026566	1983 1983 AERIAL PHOTO	SURFACE WATER: SAN PEDRO RIVER GROUNDWATER : ZONE 1 OF THE SAN PEDRO RIVER
IRO90	39-0003880 39-0003881 39-0003883 39-0003886 39-0003888 39-0006572 39-0011757	36-0026558 36-0026564 36-0026565 36-0026566	1935 1935 AERIAL PHOTO	GROUNDWATER : ZONE 2 GROUNDWATER : ZONE 1 OF THE SAN PEDRO RIVER GROUNDWATER : ZONE 2
IRO91	39-0003875 39-0003880 39-0003881 39-0003882 39-0003883 39-0003886	36-0026558 36-0026564 36-0026565 36-0026566	1939 FILING 36-26558	SURFACE WATER: SAN PEDRO RIVER GROUNDWATER : ZONE 1 OF THE SAN PEDRO RIVER GROUNDWATER : ZONE 2
IRO92	39-0003880 39-0003881 39-0003883 39-0003886 39-0003888 39-0006572 39-0011757	36-0026558 36-0026564 36-0026565 36-0026566	1956 FILING 36-26564	GROUNDWATER : ZONE 1 OF THE SAN PEDRO RIVER GROUNDWATER : ZONE 2
PSO02	39-0003875 39-0003882 39-0003888 39-0006572 39-0011757	36-0026559 36-0026560 36-0026566	1987 1987 AERIAL PHOTO	SURFACE WATER: SAN PEDRO RIVER GROUNDWATER : ZONE 2
SRO01	39-0003881 39-0003883	36-0026558 36-0026564 36-0026565 36-0026566	1935 1935 AERIAL PHOTO	GROUNDWATER : ZONE 2
SRO02	39-0003881 39-0003883	36-0026558 36-0026564 36-0026565 36-0026566	1935 1935 AERIAL PHOTO	GROUNDWATER : ZONE 2
SRO03	39-0003875 39-0003882 39-0003888 39-0006572 39-0011757	36-0026566	1979 1979 AERIAL PHOTO	SURFACE WATER: SAN PEDRO RIVER GROUNDWATER : ZONE 2

Q U A N T I T I E S O F U S E

PWR #	QUANTIFICATION TYPE	ACRES	CROP TYPE	EFF	WATER DUTY	ESTIMATED VOLUME	REMARKS
IRO04	MAX. OBSERVED REGIONAL	14.6 14.6	ALFALFA AVE. CROP	45% 50%	7.4 AF/AC 5.4 AF/AC	108.0 AFA 78.8 AFA	
IRO90	MAX. POTENTIAL REGIONAL	14.6 20.7	ALFALFA NO CROP	45%	7.4 AF/AC	108.0 AFA	
IRO91	REGIONAL	12.1	NO CROP				DISCONTINUED IRRG.
IRO92	REGIONAL	38.3	NO CROP				DISCONTINUED IRRG.
PSO02	MAX. AREA/CAP	2.6				15.1 AF	DISCONTINUED IRRG.
SRO01	MAX. AREA/CAP	LT 2.0				LTE 15.0 AF	
SRO02	MAX. AREA/CAP	LT 2.0				LTE 15.0 AF	
SRO03	MAX. AREA/CAP	LT 2.0				LTE 15.0 AF	

FILINGS AND DECREES

FILING 39-6572 - CLAIMS IRRIGATION, DOMESTIC, STOCKWATERING, RECREATION, AND WILDLIFE USES.
NO DOMESTIC USE WAS FOUND AT THE CLAIMED LOCATION.

DIVERSIONS

D1 - DIVERSION FROM THE SAN PEDRO RIVER INTO THE POMERENE WATER USERS ASSOCIATION CANAL.
W1-W4 & W9 - WELLS PROVIDE WATER FOR IRRIGATION USES.
W5, W6 & W8 - WELLS PROVIDE WATER FOR IRRIGATION, STOCKWATERING, AND WILDLIFE USES.
W7 & W10 - UNUSED WELLS.

USES AND RESERVOIRS

IR4 - IRRIGATED ALFALFA.
IR90-IR92 - DISCONTINUED IRRIGATION: D.W.R. HAS DETERMINED THAT NO IRRIGATION HAS OCCURRED ON A PORTION OF THIS PROPERTY IN THE LAST FIVE YEARS, BUT THERE HAS BEEN IRRIGATION WITHIN THE PAST TEN YEARS BASED UPON A REVIEW OF HISTORICAL AERIAL PHOTOGRAPHY AND FIELD INVESTIGATIONS.
PS2 - PRIMARY STORAGE RESERVOIR, SUPPLIED BY D1, W1 & W2, IS USED FOR IRRIGATION, STOCKWATERING, AND WILDLIFE PURPOSES.
SR1 - SMALL RESERVOIR, SUPPLIED BY WELL W5, IS USED FOR IRRIGATION, STOCKWATERING, AND WILDLIFE PURPOSES.
SR2 - SMALL RESERVOIR, SUPPLIED BY WELL W8, IS USED FOR IRRIGATION, STOCKWATERING, AND WILDLIFE PURPOSES.
SR3 - SMALL RESERVOIR, SUPPLIED BY DIVERSION D1 AND WELL W1, IS USED FOR IRRIGATION PURPOSES.

SHARED USES AND DIVERSIONS

W1-W3 - WELLS ARE SHARED WITH W.F.R.'S #112-17-ACB-8 & #112-17-BDA-14.
W4 - WELL IS SHARED WITH W.F.R. #112-17-BDA-4.
W9 - WELL IS SHARED WITH W.F.R. #112-17-BDA-11.
PS2 - WATER FROM PS2 IS ALSO USED IN W.F.R.'S #112-17-ACB-8 & #112-17-BDA-14.
PRIMARY STORAGE RESERVOIR PS1, FOUND IN W.F.R. #112-17-ACB-8, PROVIDES WATER TO USES IN THIS W.F.R.

DISPOSITION OF LAND OWNER/CLAIMANT COMMENTS

A COMMENT WAS RECEIVED FROM THE LAND OWNER WHICH INDICATED ONE/HALF OWNERSHIP IN A WELL.

LAND OWNER	ZONE 2 WELL
-----	REPORT NUMBER
KARTCHNER, MAX J.	112-17-BDA-007
& DONNA L. (TRUSTEES)	

WELLS	WELL NAMES	WELL LOCATION			WATER USES SERVED	REMARKS
		SECTION	TWNP	RNGE		
WO1	UNNAMED	SWSENW24	17OS	200E	IR004, IR091, PS002 SRO03	SHARED
WO2	UNNAMED	NESWSW24	17OS	200E	IR004, PS002	SHARED
WO4	UNNAMED	NWSENE23	17OS	200E	PS002	SHARED
WO5	UNNAMED	SWSWNE23	17OS	200E	IR090, IR091, IR092 SRO01	
WO7	UNNAMED	NESWSE23	17OS	200E		UNUSED
WO8	UNNAMED	SWSWNE23	17OS	200E	IR090, IR091, IR092 SRO02	
WO9	UNNAMED	SWSWSE23	17OS	200E		SHARED
W10	UNNAMED	SWNWSE23	17OS	200E		UNUSED

W1-11-1986

WATER USE NUMBERS	WATER USE LOCATION			*** APPARENT FIRST USE ***		APPAR. ANNUAL VOLUME USED	ACRES IRRIGATED
	SECTION	TWNP	RNGE	DATE	BASIS FOR DATE		
IR004	NWSW24	17OS	200E	1983	1983 AERIAL PHOTO	78.8 AFA	14.6
IR090	SWSW24	17OS	200E	1935	1935 AERIAL PHOTO		20.7
	NWSE23	17OS	200E				
IR091	SWNE24	17OS	200E	1939	FILING 36-26558		12.1
	NENW24	17OS	200E				
	NWNE23	17OS	200E				
	SENW24	17OS	200E				
IR092	SWNE23	17OS	200E	1956	FILING 36-26564		38.3
	NWNE23	17OS	200E				
PS002	SWNESW24	17OS	200E	1987	1987 AERIAL PHOTO	15.1 AF	
SRO01	SWSWNE23	17OS	200E	1935	1935 AERIAL PHOTO	LTE 15.0 AF	
SRO02	SWSWNE23	17OS	200E	1935	1935 AERIAL PHOTO	LTE 15.0 AF	
SRO03	SWSENW24	17OS	200E	1979	1979 AERIAL PHOTO	LTE 15.0 AF	

APPLICABLE STATEMENTS OF CLAIMANT	APPLIES TO: WELLS	APPLIES TO: WATER USES
39-0003875		IR091, IR004
39-0003880	WO7	IR090, IR091, IR092
39-0003881	WO5, WO8	IR090, IR091, IR092
39-0003882	WO2	IR004, IR091, IR004 SRO03
39-0003883	WO5, WO8	IR090, SRO01, SRO02
39-0003885		IR004
39-0003886		IR090, IR091, IR092
39-0003888		IR090, IR092, PS002 SRO03
39-0006572		IR090, IR092, PS002 SRO03
39-0011757		IR090, IR092, PS002 SRO03

EXPLANATION

THE APPARENT ANNUAL VOLUME REPORTED FOR IR004 IS PARTIALLY SUPPLIED BY SURFACE WATER AND ZONE 1 GROUNDWATER.

THE APPARENT ANNUAL VOLUME REPORTED FOR IR090 IS PARTIALLY SUPPLIED BY ZONE 1 GROUNDWATER.

THE APPARENT ANNUAL VOLUME REPORTED FOR IR091 IS PARTIALLY SUPPLIED BY SURFACE WATER AND ZONE 1 GROUNDWATER.

THE APPARENT ANNUAL VOLUME REPORTED FOR IR092 IS PARTIALLY SUPPLIED BY ZONE 1 GROUNDWATER.

THE APPARENT ANNUAL VOLUME REPORTED FOR PS002 IS PARTIALLY SUPPLIED BY SURFACE WATER.

ATTACHMENT B

1
2
3
4
5
6
7
8
9
10
11
12
13
14
15
16
17
18
19
20
21
22
23
24
25
26
27
28

22

23

[112-17-ACB]

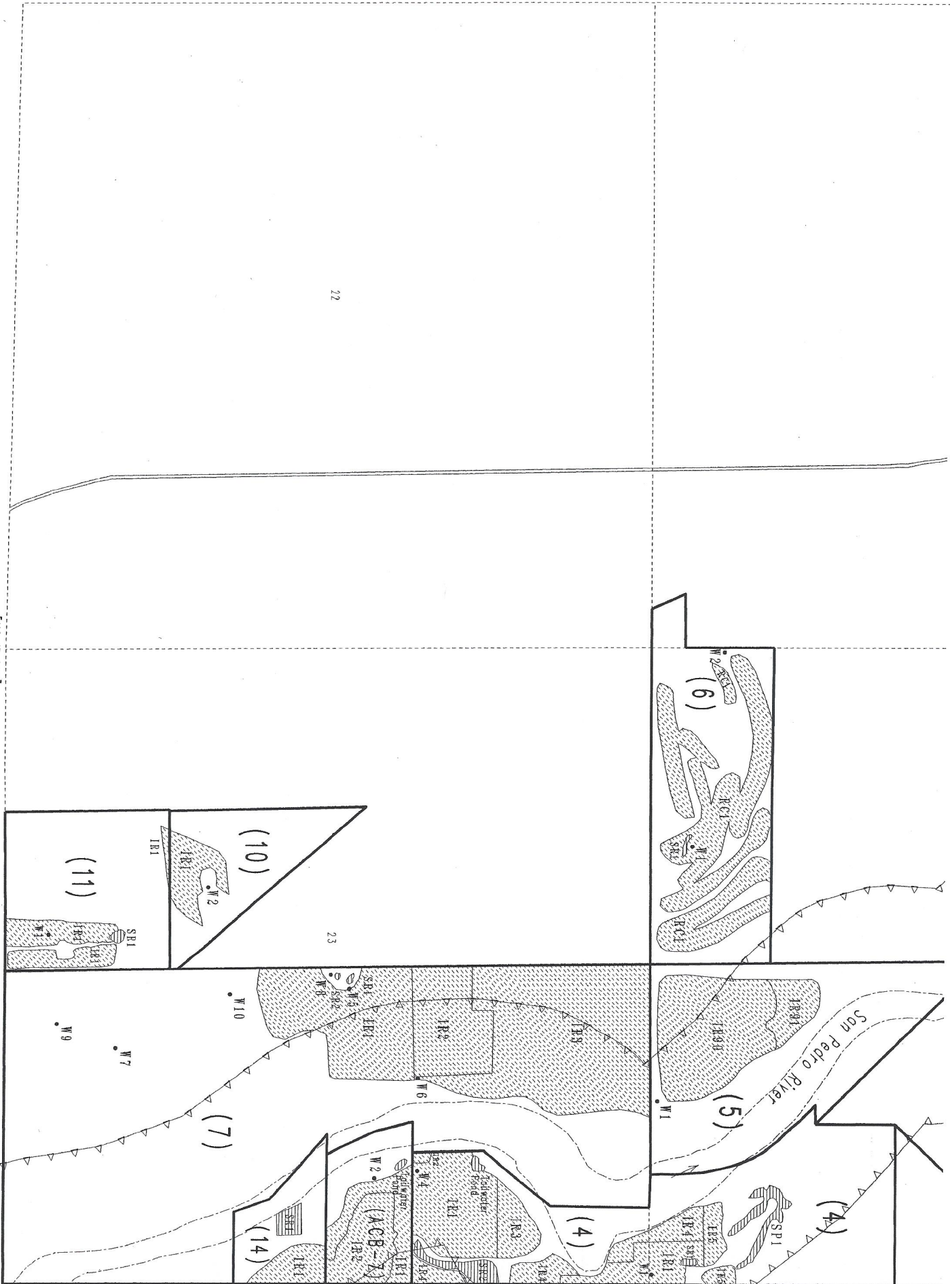

To Sanit David

[112-17-800]

R 20 E

ATTACHMENT C

1
2
3
4
5
6
7
8
9
10
11
12
13
14
15
16
17
18
19
20
21
22
23
24
25
26
27
28

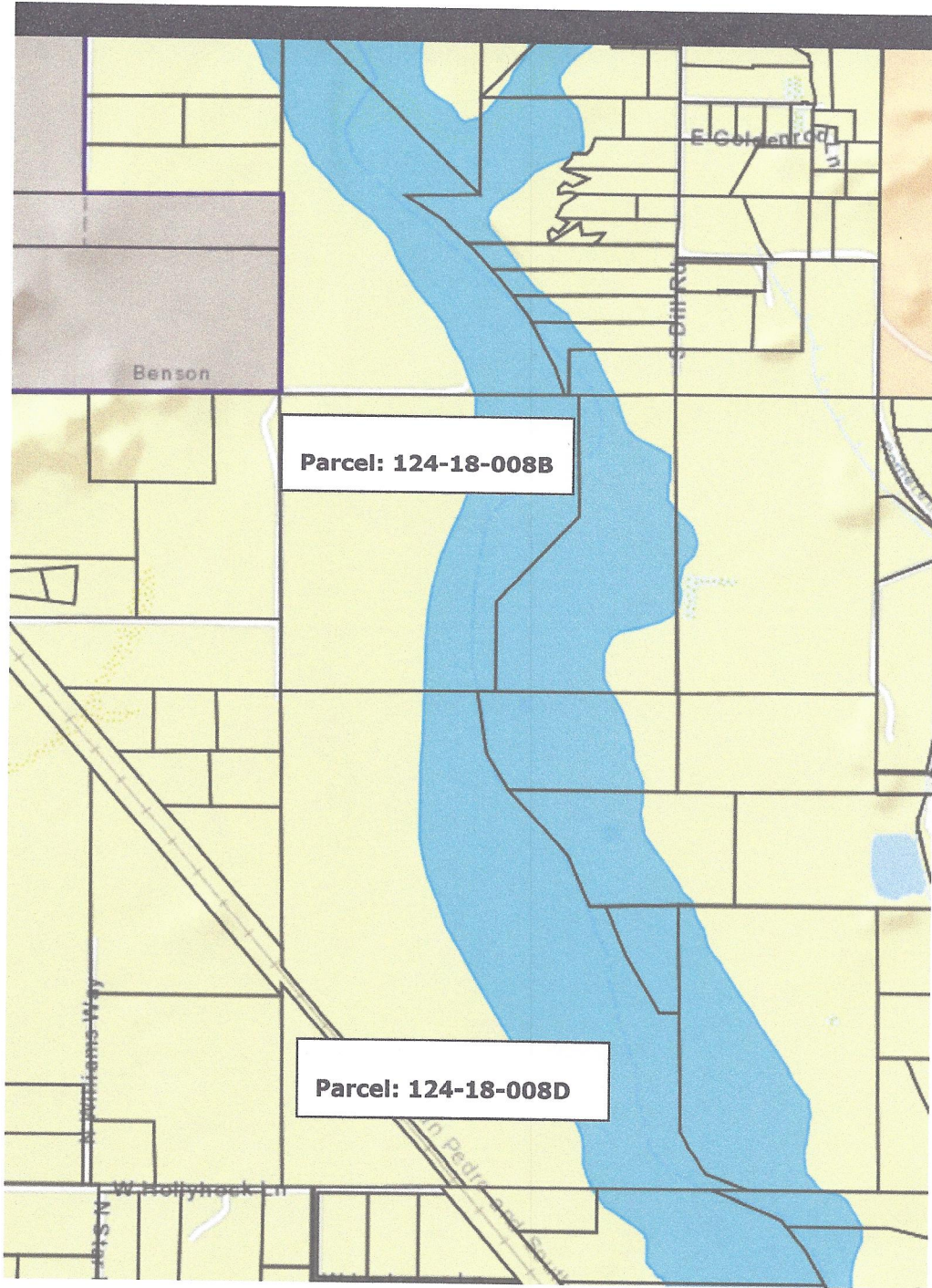

ATTACHMENT D

1
2
3
4
5
6
7
8
9
10
11
12
13
14
15
16
17
18
19
20
21
22
23
24
25
26
27
28

Arizona Department of Water Resources
Kimberly Parks
Janet L. Miller
P. O. Box 36020
Phoenix, AZ 85067

ASARCO Incorporated
Lauren J. Caster
Fennemore Craig, P.C.
2394 East Camelback Road
Suite 600
Phoenix, AZ 85016-3429

City of Phoenix
200 West Washington Street, 13th Floor
Phoenix, AZ 85003-1611

El Dorado Benson LLC
8501 N Scottsdale Rd Ste 120
Scottsdale, AZ 85253

Gila River Indian Community
Linus Everling and Thomas L. Murphy
Office of the General Counsel
P. O. Box 97
Sacaton, AZ 85147

Kirkpatrick Family Trust
c/o Scientific Agri Service
P.O. Box 357
Saint David, AZ 85630

Max Kartchner
Box 2000
Benson, AZ 85602

1 Rancho Rio Vista, Inc. (an inactive corporation)
2 P. O. Box 1996
3 Benson, Az 85602

4 Robert G. Prater
5 P. O. Box 1848
6 Benson, AZ 85602

7 Salt River Valley Water Users Association and the Salt River Project Agricultural
8 Improvement and Power District
9 John B. Weldon, Jr. and Mark A. McGinnis
10 Salmon, Lewis & Weldon PLC
11 2850 E Camelback Rd, Ste 200
12 Phoenix, AZ 85016

13 San Carlos Apache Tribe
14 Tonto Apache Tribe
15 Joe P. Sparks and Laurel A. Hermann
16 The Sparks Law Firm, P.C.
17 7503 First Street
18 Scottsdale, AZ 85251-4573

19 U. S. Department of Justice
20 Patrick Barry and Yosef Negose
21 U.S. Department of Justice
22 Environment and Natural Resources
23 P. O. Box 7611
24 Washington, D.C. 20044-7611

25 Yavapai-Apache Nation
26 Camp Verde Reservation
27 Susan B. Montgomery and Robyn L. Interpreter
28 Montgomery & Interpreter, PLC
3301 E. Thunderbird Road
Phoenix, AZ 85032