

1  
2  
3  
4  
5  
6  
7  
8  
9  
10  
11  
12  
13  
14  
15  
16  
17  
18  
19  
20  
21  
22  
23  
24  
25  
26  
27  
28

IN THE SUPERIOR COURT OF THE STATE OF ARIZONA  
IN AND FOR THE COUNTY OF MARICOPA

IN RE THE GENERAL  
ADJUDICATION OF ALL RIGHTS  
TO USE WATER IN THE GILA  
RIVER SYSTEM AND SOURCE

W-1 (Salt)  
W-2 (Verde)  
W-3 (Upper Gila)  
W-4 (San Pedro)  
Consolidated

CONTESTED CASE NO. W1-11-2666  
ORDER TO INITIATE A CONTESTED CASE  
AND  
ORDER SETTING A TELEPHONIC STATUS  
CONFERENCE

CONTESTED CASE NAME: *In re ASLD – Estate of Hope I. Jones*  
HSR INVOLVED: San Pedro River Watershed Hydrographic Survey Report.  
DESCRIPTIVE SUMMARY: Case initiated to adjudicate claims for rights to water for stockponds and stock watering uses investigated in Watershed File Report 113-12-011. Arizona Department of Water Resources (ADWR) shall review attached abstracts and file a report by **August 3, 2020**. A telephonic status conference is set for **August 10, 2020** at 2:00 p.m.  
NUMBER OF PAGES: 25  
DATE OF FILING: June 5, 2020

1 This Order initiates a contested case to consider the claims filed by the Conservator of the  
2 Estate of Hope I. Jones and the Arizona State Land Department for water rights for stockponds  
3 and stock and wildlife watering and to resolve objections to Watershed File Report 113-12-011  
4 (“WFR”) published in the Final San Pedro River Watershed Hydrographic Survey Report  
5 (1991).  
6

7 The WFR identified potential water rights on land located in Township 11 South Range 19  
8 East, Township 11 South Range 20 East, Township 12 South Range 19 East, and Township 12  
9 South Range 20 East. The WFR further states that the land is owned by the State of Arizona and  
10 leased to the Estate of Hope I. Jones. A copy of the WFR is attached as Attachment A. A copy  
11 of the map that shows the land included within the area investigated by the WFR is attached as  
12 Attachment B. The land involved in this case is labelled as “(11)” on the map. A copy of the  
13 map of the land included within the boundaries of the WFR maintained as a public record by the  
14 Arizona State Land Department is attached as Attachment C.  
15  
16

### 17 **Adjudication of Claims**

18 Under current law, a claimant who asserts claims for water rights for irrigation use and  
19 “Small Water Use Claims” shall have the Small Water Uses Claims determined in conjunction  
20 with the adjudication of the claims for water for irrigation use. A.R.S. §45-257(A)(1). The term  
21 “Small Water Use Claims” includes claims for stock watering and stockponds with a capacity of  
22 not more than 15 acre feet. A.R.S. §45-251(9).  
23

24 C-Spear LLC filed claims for water rights for irrigation that will be adjudicated in *In re*  
25 *Hope Iselin Jones*, contested case no. W1-11-2697 that was initiated on June 4, 2020. It has also  
26 asserted rights to water uses that constitute Small Water Use Claims in Statements of Claimant 39-  
27 13881 and 39-1882. Accordingly, this contested case was initiated to address those Statements of  
28

1 Claimant along with the other Statements of Claimant that ADWR investigated in the same  
2 Watershed File Report.

3  
4 **Expedited Procedures**

5  
6 Claims for rights to water for domestic use, stock watering, and stockponds in the San  
7 Pedro Watershed and the objections to the Watershed File Report that examine those claims are  
8 determined using an expedited process. The process is set forth in the Memorandum Decision,  
9 Findings of Fact, and Conclusions of Law for Group 1 Cases involving Stock watering,  
10 Stockponds, and Domestic Uses, dated November 14, 1994, amended February 23, 1995,  
11 approved and modified September 27, 2002 ("Decision").  
12

13 The first step in the procedure is the preparation of proposed abstracts for each of the  
14 claimed water rights for stock watering and stock ponds analyzed by the watershed file reports.  
15 Drafts of the proposed abstracts have been prepared and are attached as Attachment D. The  
16 drafts are being provided to ADWR for review and comment. Upon receipt of a report and maps  
17 from the Arizona Department of Water Resources, the second step requires the proposed  
18 abstracts to be distributed to all of the parties because the Decision directs that "the litigants will  
19 be provided an opportunity to suggest the correction of mistakes in the proposed abstracts."  
20 Decision, p. 47. After suggested corrections have been received from the parties, the suggested  
21 corrections will be reviewed and any necessary corrections will be made to the proposed  
22 abstracts. The third step in the process is the inclusion of the reviewed and corrected abstracts  
23 into a catalog of proposed water rights where they will be subject to very limited set of  
24 objections and ultimately in a final decree.  
25  
26  
27  
28



1 **IT IS ORDERED:**

2  
3 1. Contested Case. This contested case shall be known as *In re ASLD – Estate of*  
4 *Hope I. Jones* and it will address Statements of Claimant listed in and the objections to Watershed  
5 File Report 113-12-011 published in the Final San Pedro River Watershed Hydrographic Survey  
6 Report (1991). Copies of objections can be found under the case name and number on the  
7 following website:

8 <http://www.superiorcourt.maricopa.gov/SuperiorCourt/GeneralStreamAdjudication/whatsNew.asp>

9 2. Litigants. The litigants in this contested case are the Claimants, all persons who  
10 filed objections to the watershed file report who are included on Attachment E, and claimants who  
11 are allowed to intervene by order.

12  
13 3. Court-Approved Mailing List.

14 A. The initial Court-approved mailing list for this case shall include all persons  
15 listed on Attachment E to this order. The list may be modified only by filing a  
16 motion with the Special Master to amend the Court-approved mailing list. Litigants  
17 are responsible for using the current Court-approved mailing list.

18  
19 B. A copy of any pleading filed with the Clerk of the Maricopa County  
20 Superior Court in this case shall be served upon each person listed on the Court-  
21 approved mailing list.

22  
23 C. Claimants wishing to be added or removed from the mailing list shall file a  
24 motion with the Special Master. Parties allowed to intervene will be automatically  
25 added to the mailing list.



1           4.     Courtesy Email List. The Special Master's office will email courtesy copies of  
2 orders and minute entries entered in this case to persons listed on Attachment E. Requests for  
3 inclusions on the email list should be sent to Barbara Brown at  
4 [brownb099@superiorcourt.maricopa.gov](mailto:brownb099@superiorcourt.maricopa.gov).

5  
6           5.     Arizona State Land Department. The Arizona State Land Department shall be  
7 prepared at the Status Conference to state that it has met with its lessee for the purposes of  
8 determining the ownership of the claimed water rights and whether the parties are in agreement  
9 regarding the ownership of the proposed water rights.

10  
11           6.     Arizona Department of Water Resources. By **August 3, 2020**, ADWR shall review  
12 and file a report with its comments on the draft abstracts attached as Attachment D and prepare  
13 maps regarding the potential water rights.

14           7.     Telephonic Status Conference. The Status Conference shall be held on **August 10,**  
15 **2020**, at 2:00 p.m. to determine whether disputes exist between the Claimants about the ownership  
16 of water rights and to address questions the claimant or the objectors may have about the process.  
17 All parties will be provided with an opportunity to submit written suggested corrections to the  
18 abstracts after the status conference.  
19

20 Instructions for telephonic appearance:  
21 Dial: 602-506-9695 (local)  
22 1-855-506-9695 (toll free long distance)  
23 Dial Participant Pass Code 357264#

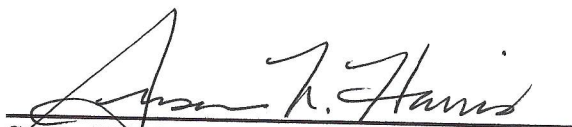
24   
25 \_\_\_\_\_  
26 Susan Ward Harris  
27 Special Master  
28

1 The original of the foregoing was delivered to the Clerk of  
2 the Maricopa County Superior Court on June 5, 2020, for  
3 filing and distributing a copy to all persons listed on the  
4 Court approved mailing list for this contested case which is  
5 attached as Attachment E and to all persons listed on the  
6 Court-approved mailing list for W-1, W-2, W-3, and W-4  
7 (Consolidated).  
8  
9  
10  
11  
12  
13  
14  
15  
16  
17  
18  
19  
20  
21  
22  
23  
24  
25  
26  
27  
28

1

2

3

4

5

6

7

8

**ATTACHMENT A**

9

10

11

12

13

14

15

16

17

18

19

20

21

22

23

24

25

26

27

28



LAND OWNER

WATERSHED FILE  
REPORT NUMBER

LESSEE/ALLOTTEE

LEASE-PERMIT ID

SLD

113-12-011

JONES, HOPE I. (ESTATE)

05-679

APPLICABLE FILINGS AND DECREES

CLEARLY STATED INFORMATION FROM FILINGS AND DECREES

FILING NUMBER	FILING STATUS	USES	QUANTITY IN AFA	USE LOCATION SECTION	TWNP	RNGE	CLAIM DATE	DIVERSION SECTION	LOCATION TWNP	RNGE
33-0094369	APPLICA.	REC/FISH/WLDF	10860.00	NWSW28	110S	200E	1988	NWSW28	110S	200E
33-0094370	APPLICA.	REC/FISH/WLDF	5068.00	SWSW28	110S	200E	1988	SWSW28	110S	200E
36-0004755		STOCK	11.90	SESE29	110S	200E		SESE29	110S	200E
36-0004756		REC/FISH/WLDF	.75	SESW28	110S	200E		SESW28	110S	200E
36-0004757		STOCK	6.80	SWSE28	110S	200E		SWSE28	110S	200E
36-0005512		REC/FISH/WLDF	1.10	NENE32	110S	200E		NENE32	110S	200E
36-0005513		STOCK	.22	NESE18	120S	200E	1884	NESE18	120S	200E
36-0005514		REC/FISH/WLDF	.32	SESE16	120S	200E	1884	SESE16	120S	200E
36-0101567		STOCK	.21	SENE32	110S	200E	1990	SENE32	110S	200E
36-0101665		REC/FISH/WLDF	.21	NENE32	110S	200E	1884	NENE32	110S	200E
36-0101667		STOCK	.21	NWNE32	110S	200E	1884	NWNE32	110S	200E
38-0012064		REC/FISH/WLDF	7.50	SWNE32	110S	200E	1955	SWNE32	110S	200E
38-0012068		STOCK	6.80	SESE16	120S	200E	1965	SESE16	120S	200E
38-0012071		REC/FISH/WLDF	11.90	SENE32	110S	200E	1970	SENE32	110S	200E
38-0094272		STOCK	6.80	SESE16	120S	200E	1965	SESE16	120S	200E
38-0094273		REC/FISH/WLDF	.75	SENE32	110S	200E	1935	SENE32	110S	200E
38-0094274		STOCK	11.90	SESE16	120S	200E	1970	SESE16	120S	200E
38-0094594		REC/FISH/WLDF	1.10	SESE16	120S	200E	1930	SESE16	120S	200E
38-0094595		STOCK	.32	SESE16	120S	200E	1930	SESE16	120S	200E
39-0000609		REC/FISH/WLDF	11.90	SESE16	120S	200E	1970	SESE16	120S	200E
39-0000612		STOCK	.75	SESE16	120S	190E	1965	SESE16	120S	190E
39-0000616	AMENDED	STOCK	1500.00	SESE16	120S	190E	1935	SESE16	120S	190E
39-0004872	AMENDED	REC/FISH/WLDF	6.80	SESE16	120S	190E	1884	SESE16	120S	190E
39-0007267	AMENDED	STOCK	.68	SESE16	120S	200E	1884	SESE16	120S	200E
39-0007268	AMENDED	OTHER	128.00	SESE16	120S	200E	1884	SESE16	120S	200E
39-0007269		REC/FISH/WLDF	.07	SESE16	120S	200E	1884	SESE16	120S	200E
39-0013279		STOCK	10.70	NWSW17	120S	200E	1970	NWSW17	120S	200E
39-0013280		REC/FISH/WLDF	1.20	NWSW17	120S	200E	1970	NWSW17	120S	200E
39-0013281		STOCK	1.10	NESW36	110S	190E	1853	NESW36	110S	190E
39-0013881		REC/FISH/WLDF	.21	NESE31	110S	200E	1883	NESE31	110S	200E
39-0013882		STOCK	.32	NESE31	110S	200E	1883	NESE31	110S	200E
39-0013883		STOCK	1.00	SENE32	110S	200E	1942	SENE32	110S	200E
39-0013951		STOCK	.21	SWSE32	110S	200E	1930	SWSE32	110S	200E
39-0013953		REC/FISH/WLDF	.21	NENE32	110S	200E	1883	NENE32	110S	200E
		STOCK	.21	SENE32	110S	200E	1883	SENE32	110S	200E
		REC/FISH/WLDF	.21	NENE32	110S	200E	1883	NENE32	110S	200E
		STOCK	.21	NWNE32	110S	200E	1883	NWNE32	110S	200E
		REC/FISH/WLDF	.21	NWSW32	110S	200E	1883	NWSW32	110S	200E

FILING NUMBER	USES CLAIMED OR REFERENCED	USES FOUND BY DWR	APPLIES TO DIVERSIONS	APPLIES TO PWR NUMBERS
33-0094369	WILDLIFE	WILDLIFE		
33-0094370	WILDLIFE	WILDLIFE		SW002
36-0004755	STOCK	STOCK		SW003
	WILDLIFE	INCIDENTAL		SPO02
36-0004756	STOCK	STOCK		
36-0004757	WILDLIFE	INCIDENTAL		SPO01
	STOCK	STOCK		
36-0005512	WILDLIFE	WILDLIFE		SW004
	STOCK	STOCK		
36-0005513	WILDLIFE	INCIDENTAL		SPO04
	STOCK	SPRING		
36-0005514	WILDLIFE	INCIDENTAL		SW005
	STOCK	STOCK		
36-0101567	WILDLIFE	INCIDENTAL		SPO06
	STOCK	SPRING		
36-0101665	WILDLIFE	INCIDENTAL		SW001
	STOCK	STOCK		
36-0101667	WILDLIFE	INCIDENTAL		SW002
	STOCK	STOCK		
38-0012064	WILDLIFE	INCIDENTAL		SW003
	STOCK	STOCK		
38-0012068	WILDLIFE	INCIDENTAL		SPO01
	STOCK	STOCK		
38-0012071	WILDLIFE	INCIDENTAL		SPO03
	STOCK	STOCK		
38-0094272	WILDLIFE	INCIDENTAL		SPO02
	STOCK	STOCK		
38-0094273	WILDLIFE	INCIDENTAL		SPO03
	STOCK	STOCK		
38-0094274	WILDLIFE	INCIDENTAL		SPO01
	STOCK	STOCK		
38-0094594	WILDLIFE	INCIDENTAL		SPO02
	STOCK	STOCK		
38-0094595	WILDLIFE	INCIDENTAL		SPO04
	STOCK	STOCK		
39-0000609	WILDLIFE	INCIDENTAL		SPO06
	STOCK	STOCK		
39-0000612	WILDLIFE	INCIDENTAL		SPO02
	STOCK	STOCK		
39-0000616	STOCK	STOCK		SPO03
39-0004872	WILDLIFE	WILDLIFE		SPO01
39-0007267	STOCK	STOCK		SW002, SW003
	WILDLIFE	WILDLIFE		SPO03, SW004
39-0007268	STOCK	STOCK		
	WILDLIFE	INCIDENTAL		SPO01
39-0007269	STOCK	STOCK		
	WILDLIFE	INCIDENTAL		SPO02
	OTHER	NONAPPROPRIABLE		
39-0013279	STOCK	STOCK		
39-0013280	STOCK	SPRING		SPO04
	WILDLIFE	INCIDENTAL		SW005
39-0013281	STOCK	STOCK		
	WILDLIFE	INCIDENTAL		SPO06
39-0013881	STOCK	CATALOGUED WELL		
39-0013882	STOCK	SPRING		
	WILDLIFE	INCIDENTAL		SW001
39-0013951	STOCK	STOCK		
	WILDLIFE	INCIDENTAL		SW003
39-0013953	STOCK	STOCK		
	WILDLIFE	INCIDENTAL		SW002

U S E S

PWR #	SECTION	TWNP	RNGE	SUPPLIED BY DIVERSIONS	WATER SOURCES	PHOTO DATE	SOURCE CHANGE	FACILITY NAME
SW001	SWSE32	110S	200E		SURFACE WATER			
SW002	NE32	110S	200E		SURFACE WATER		NO	CEDAR SPRING
	NW31	110S	200E				NO	INSTREAM USE
	NW32	110S	200E					
	SW32	110S	200E					
SW003	NE32	110S	200E		SURFACE WATER			
SW004	SESENE26	120S	190E		SURFACE WATER		NO	INSTREAM USE
							NO	INSTREAM USE

PWR #	LOCATION			SUPPLIED BY DIVERSIONS	WATER SOURCES	PHOTO DATE	SOURCE CHANGE	FACILITY NAME
	SECTION	TWNP	RNGE					
SWO05	NESE31	110S	200E		SURFACE WATER		NO	WALNUT SPRING

R E S E R V O I R S

PWR #	LOCATION			SUPPLIED BY DIVERSIONS	WATER SOURCES	PHOTO DATE	RESERVOIR NAME	STORAGE PURPOSE
	SECTION	TWNP	RNGE					
SPO01	NWSENE16	120S	200E		SURFACE WATER	1972	BRADBERRY TANK	STOCKWATERING WILDLIFE
SPO02	NWNWSE17	120S	200E		SURFACE WATER	1972	MILLER TANK	STOCKWATERING WILDLIFE
SPO03	NESENW26	120S	190E		SURFACE WATER	1955	MESA TANK	STOCKWATERING WILDLIFE
SPO04	NESW36	110S	190E		SURFACE WATER	1935	REDFIELD TANK	STOCKWATERING WILDLIFE
SPO06	NESE31	110S	200E		SURFACE WATER	1935	WALNUT TANK	STOCKWATERING WILDLIFE

P W R S U M M A R Y

PWR #	APPLICABLE ADJ FILINGS	APPLICABLE PRE FILINGS	*APPARENT FIRST USE DATE*	WATER SOURCES AND CLASSIFICATIONS
			DATE BASIS FOR DATE	
SPO01	39-0000616 39-0007268	36-0004756 38-0012064 38-0094273	1935 FILING 38-94273	SURFACE WATER: SAN PEDRO RIVER
SPO02	39-0000609 39-0007269	36-0004755 38-0012071 38-0094274	1970 38-12071 & 38-94274	SURFACE WATER: SAN PEDRO RIVER
SPO03	39-0000612 39-0007267	38-0012068 38-0094272	1955 1955 AERIAL PHOTO	SURFACE WATER: SAN PEDRO RIVER
SPO04	39-0013279	36-0005512 38-0094594	1930 FILING 38-94594	SURFACE WATER: SAN PEDRO RIVER
SPO06	39-0013281	36-0005514 38-0094595	1930 FILING 38-94595	SURFACE WATER: SAN PEDRO RIVER
SWO01	39-0013882	36-0101567	1990 FILING 36-101567	SURFACE WATER: SAN PEDRO RIVER
SWO02	39-0004872	33-0094369	1884 FILING 36-101665	SURFACE WATER: SAN PEDRO RIVER
SWO03	39-0004872 39-0013951	36-0101665 33-0094370 36-0101667	1884 FILING 36-101667	SURFACE WATER: SAN PEDRO RIVER
SWO04	39-0007267	36-0004757	1884 FILING 36-4757	SURFACE WATER: SAN PEDRO RIVER
SWO05	39-0013280	36-0005513	1884 FILING 36-5513	SURFACE WATER: SAN PEDRO RIVER
NONE	39-0013881	NONE		SURFACE WATER: SAN PEDRO RIVER

Q U A N T I T I E S O F U S E

PWR #	QUANTIFICATION TYPE		ACRES	CROP TYPE	EFF	WATER DUTY	ESTIMATED VOLUME	REMARKS
SPO01	MAX.	AREA/CAP	LT 2.0				LTE 15.0 AF	
SPO02	MAX.	AREA/CAP	LT 2.0				LTE 15.0 AF	
SPO03	MAX.	AREA/CAP	LT 2.0				LTE 15.0 AF	
SPO04	MAX.	AREA/CAP	LT 2.0				LTE 15.0 AF	
SPO06	MAX.	AREA/CAP	LT 2.0				LTE 15.0 AF	
SWO01							LTE 15.0 AF	
SWO02								SEE VOLUME 1 - GENERAL ASSESSMENT
SWO03								SEE VOLUME 1 - GENERAL ASSESSMENT
SWO04								SEE VOLUME 1 - GENERAL ASSESSMENT
SWO05								SEE VOLUME 1 - GENERAL ASSESSMENT



FILINGS AND DECREES

FILINGS 33-94369 & 33-94370 - CLAIM INSTREAM FLOW RIGHTS ALONG REDFIELD AND SWAMP SPRINGS CANYONS. THE BUREAU OF LAND MANAGEMENT (BLM) SUBMITTED THESE CLAIMS FOR THE BENEFIT OF WILDLIFE. THE BLM DOES NOT OWN OR LEASE PROPERTY ALONG THE CLAIMED REACHES.  
FILING 39-4872 - CLAIMS INSTREAM FLOW RIGHTS ALONG REDFIELD AND SWAMP SPRING CANYONS. THE ARIZONA GAME AND FISH DEPARTMENT FILED THESE CLAIMS FOR THE BENEFIT OF WILDLIFE. THE ARIZONA GAME AND FISH DEPARTMENT DOES NOT OWN OR LEASE PROPERTY ALONG THE CLAIMED REACHES.

USES AND RESERVOIRS

- SP1 - BRADBERRY TANK STOCKPOND.
- SP2 - MILLER TANK STOCKPOND.
- SP3 - MESA TANK STOCKPOND.
- SP4 - REDFIELD TANK STOCKPOND.
- SP6 - WALNUT TANK STOCKPOND.
- SW1 - STOCKWATERING AND WILDLIFE USES FROM CEDAR SPRING.
- SW2 - STOCKWATERING AND WILDLIFE USES FROM REDFIELD CANYON.
- SW3 - STOCKWATERING AND WILDLIFE USES FROM SWAMP SPRINGS CANYON.
- SW4 - STOCKWATERING AND WILDLIFE USES FROM MESA TANK WASH.
- SW5 - STOCKWATERING AND WILDLIFE USES FROM WALNUT SPRING.

DISPOSITION OF LAND OWNER/CLAIMANT COMMENTS

AN EXTENSIVE COMMENT WAS RECEIVED FROM THE LESSEE REGARDING WATER USES ON THE PROPERTY.

# ATTACHMENT B

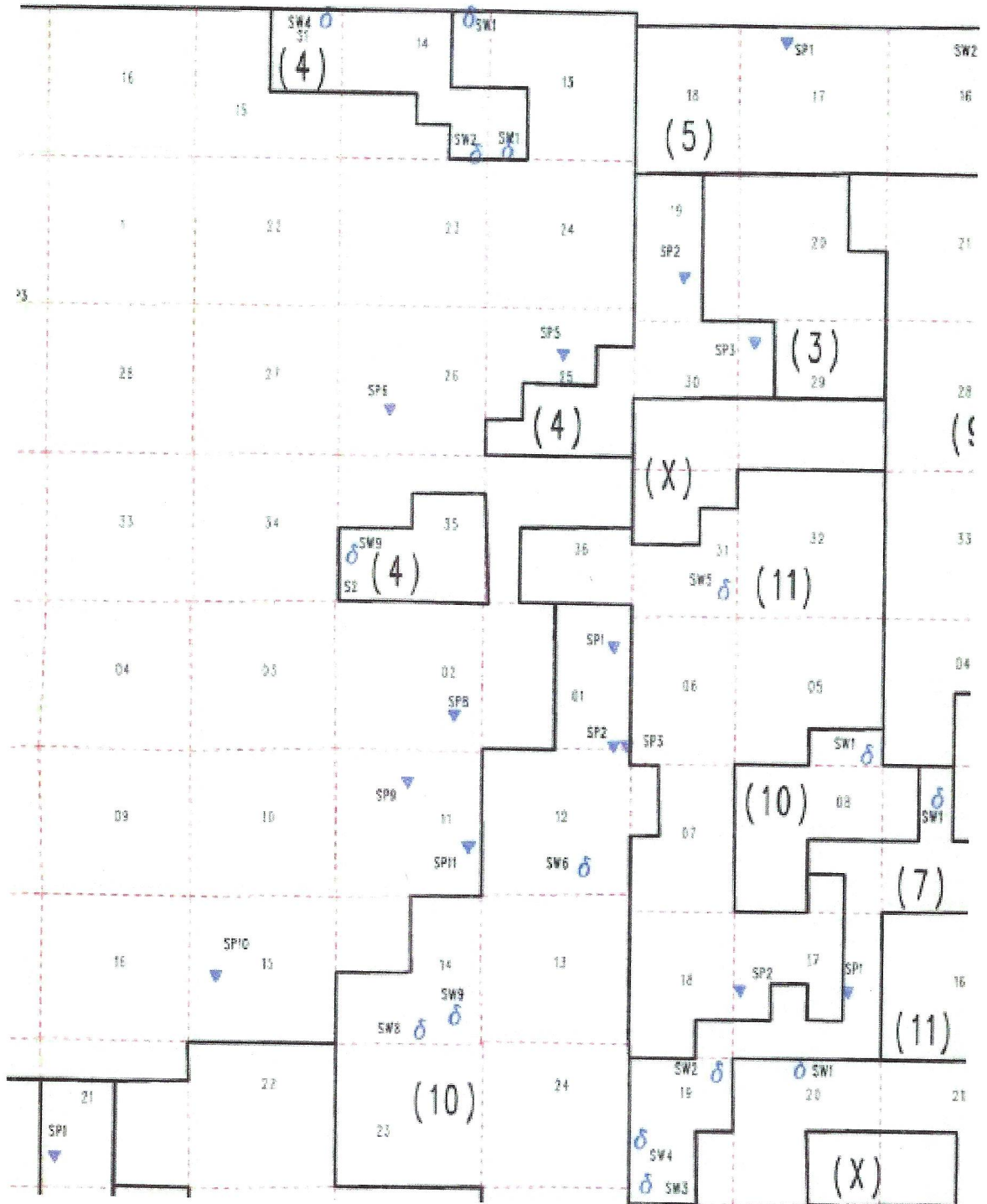

1  
2  
3  
4  
5  
6  
7  
8  
9  
10  
11  
12  
13  
14  
15  
16  
17  
18  
19  
20  
21  
22  
23  
24  
25  
26  
27  
28



# ATTACHMENT C

1  
2  
3  
4  
5  
6  
7  
8  
9  
10  
11  
12  
13  
14  
15  
16  
17  
18  
19  
20  
21  
22  
23  
24  
25  
26  
27  
28

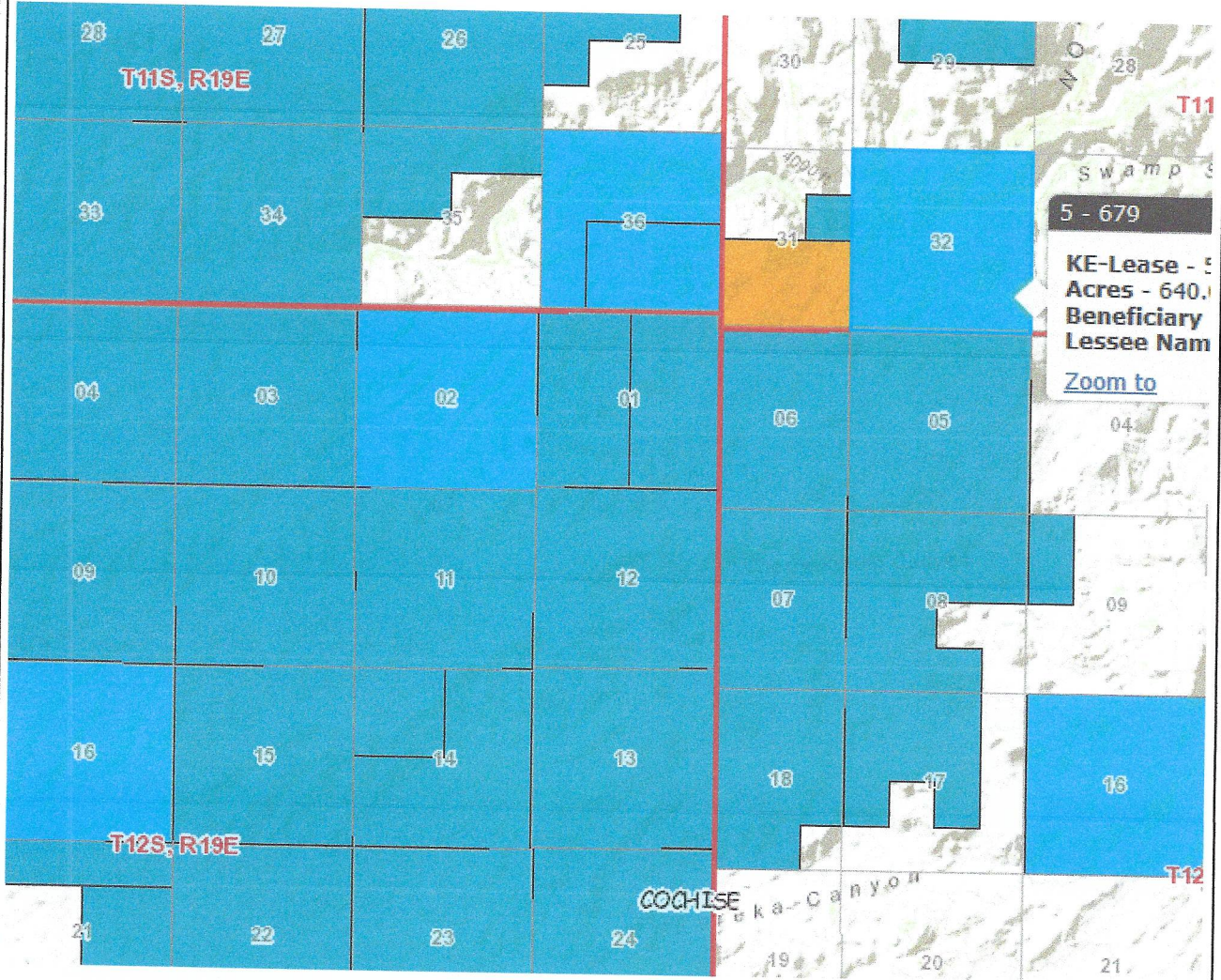



1

2

3

4

5

6

7

8

9

**ATTACHMENT D**

10

11

12

13

14

15

16

17

18

19

20

21

22

23

24

25

26

27

28

# Proposed Abstract of Water Right

## San Pedro Watershed

Attribute	Proposed Abstract of Water Right	ADWR Comments
<b>1. Proposed Water Right No.:</b>	113-12-011-SP001	
<b>2. Owner of Water Right:</b>		
<b>3. Landowner:</b>	State of Arizona	
<b>4. Statement of Claimant No.(s):</b>	39-0000616 39-0007266	
<b>5. Statement of Claimant Name(s):</b>	C-Spear LLC Arizona State Land Department	
<b>6. Lessee or Permittee:</b>	C-Spear LLC	
<b>7. Basis of Right:</b>	36-0004756 38-0012064 38-0094273	
<b>8. Beneficial Use:</b>	Stock watering from a Stock Pond	
<b>9. Priority Date:</b>	07/31/1935	
<b>10. Quantity:</b>	Not to exceed ( $\leq$ ) 4 acre feet annually with continuous fill	
<b>11. Place of Use:</b>	NWSENE 16 T12S R20E	
<b>12. Point of Diversion:</b>	NWSENE 16 T12S R20E	
<b>13. Source of Water:</b>	Bradberry Tank	

# Proposed Abstract of Water Right

## San Pedro Watershed

Attribute	Proposed Abstract of Water Right	ADWR Comments
1. Proposed Water Right No.:	113-12-011-SP002	
2. Owner of Water Right:		
3. Landowner:	State of Arizona	
4. Statement of Claimant No.(s):	39-0000609 39-0007269	
5. Statement of Claimant Name(s):	C-Spear LLC Arizona State Land Department	
6. Lessee or Permittee:	C-Spear LLC	
7. Basis of Right:	36-0004755 38-0012071 38-0094274	
8. Beneficial Use:	Stock watering from a Stock Pond	
9. Priority Date:	06/30/1970	
10. Quantity:	Not to exceed ( $\leq$ ) 4 acre feet annually with continuous fill	
11. Place of Use:	NWNWSE 17 T12S R20E	
12. Point of Diversion:	NWNWSE 17 T12S R20E	
13. Source of Water:	Miller Tank	

# Proposed Abstract of Water Right

## San Pedro Watershed

Attribute	Proposed Abstract of Water Right	ADWR Comments
1. Proposed Water Right No.:	113-12-011-SP003	
2. Owner of Water Right:		
3. Landowner:	State of Arizona	
4. Statement of Claimant No.(s):	39-0000612 39-0007267	
5. Statement of Claimant Name(s):	C-Spear LLC Arizona State Land Department	
6. Lessee or Permittee:	C-Spear LLC	
7. Basis of Right:	38-0012068 38-0094272	
8. Beneficial Use:	Stock watering from a Stock Pond	
9. Priority Date:	12/31/1955	
10. Quantity:	Not to exceed ( $\leq$ ) 4 acre feet annually with continuous fill	
11. Place of Use:	NESENW 26 T12S R19E	
12. Point of Diversion:	NESENW 26 T12S R19E	
13. Source of Water:	Mesa Tank	



# Proposed Abstract of Water Right

## San Pedro Watershed

Attribute	Proposed Abstract of Water Right	ADWR Comments
1. Proposed Water Right No.:	113-12-011-SP004	
2. Owner of Water Right:		
3. Landowner:	State of Arizona	
4. Statement of Claimant No.(s):	39-0013279	
5. Statement of Claimant Name(s):	Arizona State Land Department	
6. Lessee or Permittee:	C-Spear LLC	
7. Basis of Right:	36-0005512 38-0094594	
8. Beneficial Use:	Stock watering from a Stock Pond	
9. Priority Date:	12/31/1930	
10. Quantity:	Not to exceed ( $\leq$ ) 4 acre feet annually with continuous fill	
11. Place of Use:	NESW 36 T11S R19E	
12. Point of Diversion:	NESW 36 T11S R19E	
13. Source of Water:	Redfield Tank	

# Proposed Abstract of Water Right

## San Pedro Watershed

Attribute	Proposed Abstract of Water Right	ADWR Comments
1. Proposed Water Right No.:	113-12-011-SP006	
2. Owner of Water Right:		
3. Landowner:	State of Arizona	
4. Statement of Claimant No.(s):	39-0013281	
5. Statement of Claimant Name(s):	Arizona State Land Department	
6. Lessee or Permittee:	C-Spear LLC	
7. Basis of Right:	36-0005514 38-0094595	
8. Beneficial Use:	Stock watering from a Stock Pond	
9. Priority Date:	12/31/1930	
10. Quantity:	Not to exceed ( $\leq$ ) 4 acre feet annually with continuous fill	Reasonable Use
11. Place of Use:	NESE 31 T11S R20E	
12. Point of Diversion:	NESE 31 T11S R20E	
13. Source of Water:	Walnut Tank	

# Proposed Abstract of Water Right

## San Pedro Watershed

Attribute	Proposed Abstract of Water Right	ADWR Comments
1. Proposed Water Right No.:	113-12-011-SW001	
2. Owner of Water Right:		
3. Landowner:	State of Arizona	
4. Statement of Claimant No.(s):	39-0013882	
5. Statement of Claimant Name(s):	C-Spear LLC	
6. Lessee or Permittee:	C-Spear LLC	
7. Basis of Right:	36-0101567	
8. Beneficial Use:	Stock watering and wildlife	
9. Priority Date:	12/31/1990	
10. Quantity:	Reasonable Use	
11. Place of Use:	SWSE 32 T11S R20E	
12. Point of Diversion:	SWSE 32 T11S R20E	
13. Source of Water:	Cedar Spring	



# Proposed Abstract of Water Right

## San Pedro Watershed

Attribute	Proposed Abstract of Water Right	ADWR Comments
1. Proposed Water Right No.:	113-12-011-SW002	
2. Owner of Water Right:		
3. Landowner:		
4. Statement of Claimant No.(s):	39-0013953	
5. Statement of Claimant Name(s):	Arizona State Land Department	
6. Lessee or Permittee:		
7. Basis of Right:	33-0094369 36-0101665	
8. Beneficial Use:	Stock watering and wildlife	
9. Priority Date:	12/31/1884	
10. Quantity:	Reasonable Use	
11. Place of Use:	NW 31 T11S R20E NE 32 T11S R20E NW 32 T11S R20E SW 32 T11S R20E	
12. Point of Diversion:	NW 31 T11S R20E NE 32 T11S R20E NW 32 T11S R20E SW 32 T11S R20E	
13. Source of Water:	Redfield Canyon	

# Proposed Abstract of Water Right

## San Pedro Watershed

Attribute	Proposed Abstract of Water Right	ADWR Comments
1. Proposed Water Right No.:	113-12-011-SW003	
2. Owner of Water Right:		
3. Landowner:	State of Arizona	
4. Statement of Claimant No.(s):	39-0013951	
5. Statement of Claimant Name(s):	Arizona State Land Department	
6. Lessee or Permittee:	C-Spear LLC	
7. Basis of Right:	33-0094370 36-0101667	
8. Beneficial Use:	Stock watering and wildlife	
9. Priority Date:	12/31/184	
10. Quantity:	Reasonable Use	
11. Place of Use:	NE 32 T11S R20E	
12. Point of Diversion:	NE 32 T11S R20E	
13. Source of Water:	Swamp Springs Canyon	

# Proposed Abstract of Water Right

## San Pedro Watershed

Attribute	Proposed Abstract of Water Right	ADWR Comments
1. Proposed Water Right No.:	113-12-011-SW004	
2. Owner of Water Right:		
3. Landowner:	State of Arizona	
4. Statement of Claimant No.(s):	39-0007267	
5. Statement of Claimant Name(s):	Arizona State Land Department	
6. Lessee or Permittee:	C-Spear LLC	
7. Basis of Right:	36-0004757	
8. Beneficial Use:	Stock watering and wildlife	
9. Priority Date:	12/31/1884	
10. Quantity:	Reasonable Use	
11. Place of Use:	SESENE 26 T12S R19E	
12. Point of Diversion:	SESENE 26 T12S R19E	
13. Source of Water:	Mesa Tank Wash	



# Proposed Abstract of Water Right

## San Pedro Watershed

Attribute	Proposed Abstract of Water Right	ADWR Comments
1. Proposed Water Right No.:	113-12-011-SW005	
2. Owner of Water Right:		
3. Landowner:	State of Arizona	
4. Statement of Claimant No.(s):	39-0013280	
5. Statement of Claimant Name(s):	Arizona State Land Department	
6. Lessee or Permittee:	C-Spear LLC	
7. Basis of Right:	36-0005513	
8. Beneficial Use:	Stock watering and wildlife	
9. Priority Date:	12/31/1884	
10. Quantity:	Reasonable Use	
11. Place of Use:	NESE 31 T11S 20E	
12. Point of Diversion:	NESE 31 T11S 20E	
13. Source of Water:	Walnut Spring	

# ATTACHMENT E

1  
2  
3 Carrie Brennan and Kevin Crestin  
4 Arizona Attorney General  
5 Natural Resources Department  
6 2005 N. Central  
7 Phoenix, AZ 85004

8 City of Benson  
9 P. O. Box 2223  
10 Benson, AZ 85602

11 City of Sierra Vista  
12 2400 E. Tacoma St.  
13 Sierra Vista, AZ 85635

14 Clerk of the Superior Court  
15 Maricopa County  
16 Attn: Water Case  
17 601 West Jackson Street  
18 Phoenix, Az 85003

19 Joe P. Sparks and Laurel A. Herrmann  
20 The Sparks Law Firm, P.C.  
21 7503 First Street  
22 Scottsdale, Az 85251-4573

23 Kimberly R. Parks  
24 Arizona Department Of Water Resources  
25 P. O. Box 36020  
26 Phoenix, Az 85067

27 Linus Everling and Thomas L. Murphy  
28 Gila River Indian Community  
Office Of The General Counsel  
P. O. Box 97  
Sacaton, Az 85147

1 Lucas T. Christian, Julian Nava  
2 Robert Palmer and Jeremiah Weiner  
3 Rosette, LLP  
4 565 W. Chandler Blvd. Suite 212  
5 Chandler, AZ 85225

6 S. Montgomery, R. Interpreter, J. Tomkus, and  
7 Mia A. Montoya Hammersley  
8 Montgomery & Interpreter, PLC  
9 3301 E. Thunderbird Road  
10 Phoenix, AZ 85032

11 Salt River Valley Water Users Association,  
12 Salt River Project Agricultural Improvement and Power District  
13 John B. Weldon, Jr. and Mark A. McGinnis  
14 Salmon, Lewis & Weldon PLC  
15 2850 E Camelback Rd, Ste. 200  
16 Phoenix, AZ 85016

17 Susan Ward Harris  
18 Special Master  
19 Central Court Building, Ste 3a  
20 201 West Jefferson  
21 Phoenix, Az 85003-2205

22 U. S. Department of Justice  
23 Patrick Barry, Josef Negose, and Emmi Blades  
24 Environment and Natural Resources  
25 P. O. Box 7611  
26 Washington, D.C. 20044-7611

27  
28