

1
2
3
4
5
6
7
8
9
10
11
12
13
14
15
16
17
18
19
20
21
22
23
24
25
26
27
28

IN THE SUPERIOR COURT OF THE STATE OF ARIZONA
IN AND FOR THE COUNTY OF MARICOPA

IN RE THE GENERAL
ADJUDICATION OF ALL RIGHTS
TO USE WATER IN THE GILA
RIVER SYSTEM AND SOURCE

W-1 (Salt)
W-2 (Verde)
W-3 (Upper Gila)
W-4 (San Pedro)
Consolidated

CONTESTED CASE NO. W1-11-2760

ORDER TO INITIATE A CASE

AND

ORDER FOR ADWR REVIEW OF
ABSTRACTS FOR *DE MINIMIS* WATER
RIGHTS

AND

ORDER SETTING STATUS CONFERENCE

CONTESTED CASE NAME: *In re ASLD-Woodling II*
HSR INVOLVED: San Pedro River Watershed Hydrographic Survey Report.
DESCRIPTIVE SUMMARY: This contested case no. W1-11-2760 is initiated to adjudicate claims for rights to water for stockponds and stock watering uses investigated in Watershed File Report 113-14-004. Proposed abstracts have been prepared for stockponds and stockwatering for review and mapping by the Arizona Department of Water Resources. A telephonic status conference is set for 2:30 p.m. on **January 15, 2021.**
NUMBER OF PAGES: 57
DATE OF FILING: November 3, 2020

1 This contested case involves 65 Statements of Claimant claims originally filed by Reesor
2 Woodling individually or doing business as Cascabel Land & Cattle Co. and the Arizona State
3 Land Department. They claimed water rights for stockponds and stock watering uses. The
4 public records of the Arizona Department of Water Resources (“ADWR”) contain assignments
5 of 22 Statements of Claimant filed by Cascabel Land & Cattle Co. to David Gard that were
6 subsequently assigned by David Gard to The Cholla Group LLC. Assignments also exist as to
7 an additional 14 Statements of Claimant filed by Cascabel Land & Cattle Co. from David Gard to
8 the Cholla Group LLC.

9 Arizona Department Water Resources investigated the claims and submitted its results
10 in the Watershed File Report 113-14-004 (“WFR”), which was published in the Final San
11 Pedro River Watershed Hydrographic Survey Report (1991). It identified potential water
12 rights on land located in Township 14 South Range 19 East and Township 14 South Range 20
13 East. The WFR states that the land is owned by the State of Arizona and leased to Reesor G.
14 Woodling. A copy of the WFR is attached as Attachment A. A copy of the map that shows
15 the land included within the area investigated by the WFR is attached as Attachment B. The
16 land involved in this case is labelled as “(4)” on the map.

17 18 **Adjudication of Claims**

19 Under current law, a claimant who asserts claims for water rights for irrigation use and
20 “Small Water Use Claims” shall have the Small Water Uses Claims determined in conjunction
21 with the adjudication of the claims for water for irrigation use. A.R.S. §45-257(A)(1). The
22 term “Small Water Use Claims” includes claims for stock watering and stockponds with a
23 capacity of not more than 15 acre feet. A.R.S. §45-251(9).

24 Reesor G. Woodling and Arizona State Land Department filed claims for water rights for
25 irrigation that will be adjudicated in *In re ASLD-Woodling*, contested case no. W1-11-2787 that
26 was initiated on August 12, 2020. Accordingly, this contested case was initiated to address those
27 Statements of Claimant for Small Water Use Claims that ADWR investigated in the WFR.
28

1 **Expedited Procedures**

2 Claims for rights to water for domestic use, stock watering, and stockponds in the San
3 Pedro Watershed and the objections to the Watershed File Reports that examine those claims are
4 determined using an expedited process. The process is set forth in the Memorandum Decision,
5 Findings of Fact, and Conclusions of Law for Group 1 Cases involving Stock watering,
6 Stockponds, and Domestic Uses, dated November 14, 1994, amended February 23, 1995,
7 approved and modified September 27, 2002 (“Decision”).

8 The first step in the procedure is the preparation of proposed abstracts for each of the
9 claimed water rights for stock watering and stockponds analyzed by the watershed file reports.
10 Drafts of the proposed abstracts have been prepared and are attached as Attachment C. The drafts
11 are provided to ADWR for review and mapping. Upon receipt of a report and maps from ADWR,
12 the second step requires the proposed abstracts to be distributed to all of the parties because the
13 Decision directs that “the litigants will be provided an opportunity to suggest the correction of
14 mistakes in the proposed abstracts.” Decision, p. 47. After suggested corrections have been
15 received from the parties, the suggested corrections will be reviewed and any necessary
16 corrections will be made to the proposed abstracts. The third step in the process is the inclusion
17 of the reviewed and corrected abstracts into a catalog of proposed water rights where they will be
18 subject to very limited set of objections and ultimately in a final decree.

19
20

21 **IT IS ORDERED:**

22 1. Contested Case. This contested case shall be known as *In re ASLD –Reesor G.*
23 *Woodling II* and it will address Statements of Claimant listed in and the objections to Watershed
24 File Report 113-14-004 published in the Final San Pedro River Watershed Hydrographic Survey
25 Report (1991). Copies of objections can be found under the case name and number on the
26 following website:
27 <http://www.superiorcourt.maricopa.gov/SuperiorCourt/GeneralStreamAdjudication/whatsNew.asp>

28

1 2. Litigants. The litigants in this contested case are the Claimants, all persons who
2 filed objections to the watershed file report, who are included on Attachment D, and claimants
3 who are allowed to intervene by order.
4

5 3. Court-Approved Mailing List.

6 A. The initial Court-approved mailing list for this case shall include all
7 persons listed on Attachment D to this order. The list may be modified only by
8 filing a motion with the Special Master to amend the Court-approved mailing list.
9 Litigants are responsible for using the current Court-approved mailing list.

10 B. A copy of any pleading filed with the Clerk of the Maricopa County
11 Superior Court in this case shall be served upon each person listed on the Court-
12 approved mailing list.

13 C. Claimants wishing to be added or removed from the mailing list shall file a
14 motion with the Special Master. Parties allowed to intervene will be
15 automatically added to the mailing list.
16

17 4. Courtesy Email List. The Special Master’s office will email courtesy copies of
18 orders and minute entries entered in this case to persons listed on Attachment D. Requests for
19 inclusions on the email list should be sent to Durina Farrall at
20 Durina.Farrall@jbazmc.maricopa.gov.
21

22 5. Arizona State Land Department. The Arizona State Land Department shall be
23 prepared at the Status Conference to state that it has met with its lessee(s) for the purposes of
24 determining the ownership of the claimed water rights and whether the parties are in agreement
25 regarding the ownership of the proposed water rights.
26
27
28

1 4. Courtesy Email List. The Special Master's office will email courtesy copies of
2 orders and minute entries entered in this case to persons listed on Attachment D. Requests for
3 inclusions on the email list should be sent to Durina Farrall at
4 Durina.Farrall@jbazmc.maricopa.gov.

5
6 5. Arizona State Land Department. The Arizona State Land Department shall be
7 prepared at the Status Conference to state that it has met with its lessee(s) for the purposes of
8 determining the ownership of the claimed water rights and whether the parties are in agreement
9 regarding the ownership of the proposed water rights.

10 6. Arizona Department of Water Resources. By **January 8, 2021**, ADWR shall
11 review and file a report with its comments on the draft abstracts attached as Attachment C and
12 prepare maps regarding the potential water rights.

13
14 7. Telephonic Status Conference. The Status Conference shall be held on **January**
15 **15, 2021**, at 2:30 p.m. to determine whether disputes exist between the Claimants about the
16 ownership of water rights. All parties will be provided with an opportunity to submit written
17 suggested corrections to the abstracts after the status conference.

18
19 Instructions for telephonic appearance:
20 Dial: 602-506-9695 (local)
21 1-855-506-9695 (toll free long distance)
22 Dial Participant Pass Code 357264#

23
24 
25 Susan Ward Harris
26 Special Master
27
28

1
2
3
4
5
6
7
8
9
10
11
12
13
14
15
16
17
18
19
20
21
22
23
24
25
26
27
28

Court on November 3, 2020 for filing and distributing a copy to all persons listed on the Court approved mailing list for this contested case which is attached as Attachment D and to all person listed on the Court approved mailing list for W-1, W-2, W-3, and W-4.



Durina Farrall

1
2
3
4
5
6
7
8
9
10
11
12
13
14
15
16
17
18
19
20
21
22
23
24
25
26
27
28

ATTACHMENT A

LAND OWNER	WATERSHED FILE REPORT NUMBER	LESSEE/ALLOTTEE	LEASE-PERMIT ID
SLD	113-14-004	WOODLING, REESOR G.	05-498

A P P L I C A B L E F I L I N G S A N D D E C R E E S

CLEARLY STATED INFORMATION FROM FILINGS AND DECREES

FILING NUMBER	FILING STATUS	USES	QUANTITY IN AFA	USE LOCATION SECTION	TWNP	RNGE	CLAIM DATE	DIVERSION LOCATION SECTION	TWNP	RNGE
10-0224128.1100		IRRIGATION DOMESTIC STOCK				140S 190E	1915		140S	190E
10-0226225.1100		MINING OTHER IRRIGATION DOMESTIC STOCK				140S 190E	1916		140S	190E
36-0005258		MINING OTHER STOCK	1.70	NWNW01	140S	190E	1884	NWNW01	140S	190E
36-0005259		REC/FISH/WLDFL STOCK	2.90	SENE02	140S	190E	1884	SENE02	140S	190E
36-0005260		REC/FISH/WLDFL STOCK	1.65	NESW02	140S	190E	1884	NESW02	140S	190E
36-0005261		REC/FISH/WLDFL STOCK	3.60	NESW04	140S	200E	1884	NESW04	140S	200E
36-0005262		REC/FISH/WLDFL STOCK	.40	SENW07	140S	200E	1884	SENW07	140S	200E
36-0005263		REC/FISH/WLDFL STOCK	1.30	NWNE11	140S	190E	1884	NWNE11	140S	190E
36-0005264		REC/FISH/WLDFL STOCK	.18	SESE11	140S	190E	1884	SESE11	140S	190E
36-0005265		REC/FISH/WLDFL STOCK	1.50	SESE16	140S	190E	1884	SESE16	140S	190E
36-0005266		REC/FISH/WLDFL STOCK	.55	NESE21	140S	190E	1884	NESE21	140S	190E
36-0005267		REC/FISH/WLDFL STOCK	1.40	SENE22	140S	190E	1884	SENE22	140S	190E
36-0005268		REC/FISH/WLDFL STOCK	26.60	SWSW26	140S	190E	1884	SWSW26	140S	190E
36-0005578		REC/FISH/WLDFL STOCK	.18	SWNE04	140S	190E	1884	SWNE04	140S	190E
36-0005579		REC/FISH/WLDFL STOCK	.18	SENE04	140S	190E	1884	SENE04	140S	190E
36-0005582		REC/FISH/WLDFL STOCK	.18	NESE04	140S	190E	1884	NESE04	140S	190E
36-0005584		REC/FISH/WLDFL STOCK	.18	W2NW15	140S	190E	1884	W2NW15	140S	190E
36-0020910		REC/FISH/WLDFL STOCK	.34	SENE16	140S	190E	1884	SENE16	140S	190E
36-0020916		REC/FISH/WLDFL STOCK	.17	NESE16	140S	190E	1884	NESE16	140S	190E
36-0020917		REC/FISH/WLDFL STOCK	.22	SENE21	140S	190E	1884	SENE21	140S	190E
36-0020920		REC/FISH/WLDFL STOCK	.54	NESE21	140S	190E	1884	NESE21	140S	190E
36-0020922		REC/FISH/WLDFL STOCK	.56	NWSW22	140S	190E	1884	NWSW22	140S	190E
36-0020924		REC/FISH/WLDFL STOCK	.31	NWSW27	140S	190E	1884	NWSW27	140S	190E
36-0020925		REC/FISH/WLDFL STOCK	.25	NENE05	140S	200E	1884	NENE05	140S	200E
36-0020926		REC/FISH/WLDFL STOCK	.31	NENE05	140S	200E	1884	NENE05	140S	200E
36-0020927		REC/FISH/WLDFL STOCK	.15	NENE05	140S	200E	1884	NENE05	140S	200E
36-0020928		REC/FISH/WLDFL STOCK	.31	NENE05	140S	200E	1884	NENE05	140S	200E
36-0020929		REC/FISH/WLDFL STOCK	1.53	NENE05	140S	200E	1884	NENE05	140S	200E
36-0020931		REC/FISH/WLDFL STOCK	.15	NENE05	140S	200E	1884	NENE05	140S	200E
36-0020933		REC/FISH/WLDFL STOCK	1.53	NENE05	140S	200E	1884	NENE05	140S	200E
36-0020937		REC/FISH/WLDFL STOCK	.09	NENE05	140S	200E	1884	NENE05	140S	200E
36-0020939		REC/FISH/WLDFL STOCK	.15	NENE05	140S	200E	1884	NENE05	140S	200E
36-0020940		REC/FISH/WLDFL STOCK	.15	NENE05	140S	200E	1884	NENE05	140S	200E
36-0020941		REC/FISH/WLDFL STOCK	.15	NENE05	140S	200E	1884	NENE05	140S	200E
36-0020942		REC/FISH/WLDFL STOCK	.15	NENE05	140S	200E	1884	NENE05	140S	200E
36-0020943		REC/FISH/WLDFL STOCK	.15	NENE05	140S	200E	1884	NENE05	140S	200E

CLEARLY STATED INFORMATION FROM FILINGS AND DECREES

FILING NUMBER	FILING STATUS	USES	QUANTITY IN AFA	USE SECTION	TWNP	RNGE	CLAIM DATE	DIVERSION SECTION	TWNP	LOCATION RNGE
36-0020944		STOCK	.15					NENW02	140S	190E
36-0020945		STOCK	.15				1900	SENE14	140S	190E
36-0022902		STOCK	1.00	SENE25	140S	190E	< 1963	SENE25	140S	190E
		REC/FISH/WLDLF								
36-0022903		STOCK	4.00	NWNE30	140S	200E	< 1963	NWNE30	140S	200E
		REC/FISH/WLDLF								
36-0100068		STOCK	1.89	NESW13	140S	190E	1884	NESW13	140S	190E
		REC/FISH/WLDLF								
36-0100069		STOCK	.79	NENW13	140S	190E	1884	NENW13	140S	190E
		REC/FISH/WLDLF								
36-0100070		STOCK	.44	SENE25	140S	190E	1884	SENE25	140S	190E
		REC/FISH/WLDLF								
36-0100071		STOCK	1.30	SWSE19	140S	200E	1884	SWSE19	140S	200E
		REC/FISH/WLDLF								
36-0100072		STOCK	.44	SWSW20	140S	200E	1884	SWSW20	140S	200E
		REC/FISH/WLDLF								
36-0100073		STOCK	21.40	NWNE30	140S	200E	1884	NWNE30	140S	200E
		REC/FISH/WLDLF								
38-0022902		STOCK	1.00	SENE25	140S	190E	1963	SENE25	140S	190E
		REC/FISH/WLDLF								
38-0061445		STOCK	.12	SENE22	140S	190E	1977	SENE22	140S	190E
38-0061446		STOCK	.05	SENW07	140S	200E	1977	SENW07	140S	200E
38-0061447		STOCK		SESE11	140S	190E	1977	SESE11	140S	190E
38-0061448		STOCK	.07	NESE21	140S	190E	1977	NESE21	140S	190E
38-0061449		STOCK	.24	NWSW27	140S	190E	1976	NWSW27	140S	190E
38-0061450		STOCK	.08	NWNE11	140S	190E	1976	NWNE11	140S	190E
38-0061451		STOCK	.13	NESW02	140S	190E	1977	NESW02	140S	190E
38-0061452		STOCK	.08	NWNW01	140S	190E	1977	NWNW01	140S	190E
38-0061453		STOCK	.05	SENE02	140S	190E	1977	SENE02	140S	190E
38-0061454		STOCK	.16	SWSW26	140S	190E	1977	SWSW26	140S	190E
38-0061455		STOCK	.20	NESW04	140S	200E	1977	NESW04	140S	200E
38-0061456		STOCK	.08	NENE05	140S	200E	1976	NENE05	140S	200E
38-0061457		STOCK	.08	SWSE19	140S	200E	1976	SWSE19	140S	200E
38-0061458		STOCK	.08	NESW13	140S	190E	1976	NESW13	140S	190E
38-0061459		STOCK	.13	NENW13	140S	190E	1976	NENW13	140S	190E
38-0061466		STOCK	.26	NWNE30	140S	200E	1976	NWNE30	140S	200E
38-0088408		STOCK	6.40	SWSW26	140S	190E	1946	SWSW26	140S	190E
		REC/FISH/WLDLF								
38-0088410		STOCK	1.40	SENE22	140S	190E	1949	SENE22	140S	190E
		REC/FISH/WLDLF								
38-0088411		STOCK	1.70	NWNW01	140S	190E	1950	NWNW01	140S	190E
		REC/FISH/WLDLF								
38-0088412		STOCK	2.90	SENE02	140S	190E	1951	SENE02	140S	190E
		REC/FISH/WLDLF								
38-0088413		STOCK	1.50	SESE16	140S	190E	1949	SESE16	140S	190E
		REC/FISH/WLDLF								
38-0088414		STOCK	.10	SESE11	140S	190E	1949	SESE11	140S	190E
		REC/FISH/WLDLF								
38-0088415		STOCK	1.30	NWNE11	140S	190E	1946	NWNE11	140S	190E
		REC/FISH/WLDLF								
38-0088590		STOCK	.40	SENW07	140S	200E	1949	SENW07	140S	200E
		REC/FISH/WLDLF								
38-0088591		STOCK	3.60	NESW04	140S	200E	1955	NESW04	140S	200E
		REC/FISH/WLDLF								
38-0088592		STOCK	1.65	NESW02	140S	190E	1950	SESW02	140S	190E
		REC/FISH/WLDLF								
38-0088652		STOCK	.55	NESE21	140S	190E	1948	NESE21	140S	190E
		REC/FISH/WLDLF								
38-0088911		STOCK	.18	NWNW17	090S	310E	1983	NWNW17	090S	310E
		REC/FISH/WLDLF								
38-0094523		STOCK		SWSW20	140S	200E	1988	SWSW20	140S	200E
		REC/FISH/WLDLF								
38-0094618		STOCK	.18	NWSW27	140S	190E	1976	NWSW27	140S	190E
		REC/FISH/WLDLF								
38-0094619		STOCK	3.03	NENE05	140S	200E	1954	NENE05	140S	200E
		REC/FISH/WLDLF								
38-0094755		STOCK		SWSE19	140S	200E	1989	SWSE19	140S	200E
		REC/FISH/WLDLF								
38-0094756		STOCK		NENW13	140S	190E	1989	NENW13	140S	190E
		REC/FISH/WLDLF								
38-0094757		STOCK		NESW13	140S	190E	1989	NESW13	140S	190E
		REC/FISH/WLDLF								

CLEARLY STATED INFORMATION FROM FILINGS AND DECREES

FILING NUMBER	FILING STATUS	USES	QUANTITY IN AFA	USE LOCATION			CLAIM DATE	DIVERSION LOCATION		
				SECTION	TWNP	RNGE		SECTION	TWNP	RNGE
39-0003629	AMENDED	STOCK	.15	NENW02	140S	190E		NWNE06	140S	200E
39-0003630		STOCK	.15	NWNE22	140S	190E	1919	NESE16	140S	190E
39-0003631		STOCK	.15	SENW23	140S	190E	1919	NWNE22	140S	190E
39-0003632	AMENDED	STOCK	.15	SWSE11	140S	190E	1893	NWNE07	140S	200E
39-0003633		STOCK	.15	NESW14	140S	190E	1919	NWNE22	140S	190E
39-0003634		STOCK	.09	SWNE11	140S	190E	1919	NWSW10	140S	190E
39-0003636	AMENDED	STOCK	1.53	NWSE21	140S	190E	1919	NESE21	140S	190E
39-0003638		STOCK	.15	SENW16	140S	190E	1919	NESE16	140S	190E
39-0003642		STOCK	1.53	SWSE16	140S	190E	1918	NWSW26	130S	190E
39-0003643		STOCK	.31	SWNE04	140S	190E	1919	NESW03	140S	190E
39-0003644		STOCK	.15	SWNE26	140S	190E	1919	SENW20	140S	200E
39-0003645	AMENDED	STOCK	.31	SWSW26	140S	190E	1904	SWNE20	140S	200E
39-0003646	AMENDED	STOCK	.25	SWSW02	140S	190E	1908	SWSE06	140S	200E
39-0003647		STOCK	.34				1954	NESW04	140S	200E
39-0003648		STOCK	.56				1963	SESW19	140S	200E
39-0003651	AMENDED	STOCK	.54				1919	SESW27	140S	190E
39-0003652		STOCK	.22				1955	SENW03	140S	190E
39-0003663		STOCK	.12	SESE16	140S	190E	1949	SESE16	140S	190E
39-0003664		STOCK	.08	SESE11	140S	190E	1949	SESE11	140S	190E
39-0003665		STOCK	.12	SENE22	140S	190E	1949	SENE22	140S	190E
39-0003666		STOCK	.08	NWNW01	140S	190E	1950	NWNW01	140S	190E
39-0003667		STOCK	.28	NWNE30	140S	200E	1938	NWNE30	140S	200E
39-0003668		STOCK	.08	SWSE19	140S	200E	1947	SWSE19	140S	200E
39-0003670		STOCK	.14	NENW13	140S	190E	1951	NENW13	140S	190E
39-0003671		STOCK	.27	NWSW27	140S	190E	1942	NWSW27	140S	190E
39-0003672		STOCK	.22	NESW04	140S	200E	1946	NESW04	140S	200E
39-0003674	AMENDED	STOCK	.08	NENE05	140S	200E	1947	NENE05	140S	200E
39-0003675		STOCK	.08	NESW13	140S	190E	1955	NESW13	140S	190E
39-0003678		STOCK	.17				1956	SWSW10	140S	190E
39-0003682	AMENDED	STOCK	.06	SENW07	140S	200E	1893	SENW07	140S	200E
39-0003683		STOCK	.08	SENW11	140S	190E	1946	SENW11	140S	190E
39-0003684		STOCK	.08	NWSW22	140S	190E	1948	NWSW22	140S	190E
39-0003689		STOCK	.14	NESW02	140S	190E	1950	NESW02	140S	190E
39-0003690		STOCK	.06	SENE02	140S	190E	1951	SENE02	140S	190E
39-0003691		STOCK	.17	SWSW26	140S	190E	1946	SWSW26	140S	190E
39-0003692	AMENDED	STOCK	.31	NENW14	140S	190E	1885	SESW08	140S	200E
39-0003694	AMENDED	STOCK	.15	NESE14	140S	190E	1903	NWSE17	140S	200E
39-0003695		STOCK	.31	SWNW26	140S	190E	1919	SESW26	140S	190E
39-0007445	AMENDED	STOCK	1.50	NWNW01	140S	190E	1884	NWNW01	140S	190E
		REC/FISH/WLDF	.17							
39-0007446	AMENDED	STOCK	2.60	SENE02	140S	190E	1884	SENE02	140S	190E
		REC/FISH/WLDF	.29							
39-0007447	AMENDED	STOCK	1.48	NESW02	140S	190E	1884	NESW02	140S	190E
		REC/FISH/WLDF	.17							
39-0007448	AMENDED	STOCK	3.24	NESW04	140S	200E	1884	NESW04	140S	200E
		REC/FISH/WLDF	.36							
39-0007449	AMENDED	STOCK	.16	NESW04	140S	200E	1955	NESW04	140S	200E
		REC/FISH/WLDF	.20							
39-0007450	AMENDED	STOCK	.36	SENW07	140S	200E	1884	SENW07	140S	200E
		REC/FISH/WLDF	.04							
39-0007452	AMENDED	STOCK	1.70	NWNE11	140S	190E	1884	NWNE11	140S	190E
		REC/FISH/WLDF	.13							
39-0007453	AMENDED	STOCK	.16	SESE11	140S	190E	1884	SESE11	140S	190E
		REC/FISH/WLDF	.02							
39-0007454	AMENDED	STOCK	1.35	SESE16	140S	190E	1883	SESE16	140S	190E
		REC/FISH/WLDF	.15							
39-0007455	AMENDED	STOCK	.50	NESE21	140S	190E	1884	NESE21	140S	190E
		REC/FISH/WLDF	.05							
39-0007456	AMENDED	STOCK	1.26	SENE22	140S	190E	1884	SENE22	140S	190E
		REC/FISH/WLDF	.14							
39-0007457	AMENDED	STOCK	23.94	SWSW26	140S	190E	1884	SWSW26	140S	190E
		REC/FISH/WLDF	2.66							
39-0013348		STOCK	.18	NESE04	140S	190E	1883	NESE04	140S	190E
		REC/FISH/WLDF		SWNE04	140S	190E		SWNE04	140S	190E
				SENE04	140S	190E		SENE04	140S	190E
39-0013349	AMENDED	STOCK	.18	SWSW03	140S	190E		SWSW03	140S	190E
		REC/FISH/WLDF		E2W203	140S	190E		E2W203	140S	190E
				NENW10	140S	190E		NENW10	140S	190E
39-0013352		STOCK	.18	NESE21	140S	190E	1883	NESE21	140S	190E
		REC/FISH/WLDF		SENE21	140S	190E		SENE21	140S	190E
				NWSW22	140S	190E		NWSW22	140S	190E
39-0013354		STOCK	.18	NWSW27	140S	190E	1883	NWSW27	140S	190E

CLEARLY STATED INFORMATION FROM FILINGS AND DECREES

FILING NUMBER	FILING STATUS	USES	QUANTITY IN AFA	USE SECTION	LOCATION TWP	RNGE	CLAIM DATE	DIVERSION SECTION	LOCATION TWP	RNGE
39-0013354		REC/FISH/WLDLF								
39-0013357	AMENDED	STOCK	3.03	NENE05	140S	200E	1883	NENE05	140S	200E
39-0013921		REC/FISH/WLDLF	.47				1971	SESENW03	140S	190E
39-0013922		REC/FISH/WLDLF	.47				1963	NESWSW10	140S	190E
39-0013923		STOCK	1.89	SENE05	140S	190E	1883	SENE05	140S	190E
39-0013924		STOCK	.26				1964	NWSWSE13	140S	190E
39-0013925		REC/FISH/WLDLF	.79	NENENW13	140S	190E	1883	NENENW13	140S	190E
39-0013926		STOCK	.15	SWSENE25	140S	190E	1883	SWSENE25	140S	190E
39-0013927		STOCK	.44				1963	SWSESW19	140S	200E
39-0013928		REC/FISH/WLDLF	1.30	NWSWSE19	140S	200E	1883	NWSWSE19	140S	200E
39-0013929	AMENDED	STOCK	.24	SESW20	140S	200E	1883	SESW20	140S	200E
39-0013930	AMENDED	STOCK		SENWNE30	140S	200E	1883	NENWNE30	140S	200E
		REC/FISH/WLDLF								

DWR ANALYSIS OF FILINGS AND DECREES

FILING NUMBER	USES CLAIMED OR REFERENCED	USES FOUND BY DWR	APPLIES TO DIVERSIONS	APPLIES TO PWR NUMBERS
10-0224128.1100	IRRIGATION	NONE		
	DOMESTIC	NONE		
	STOCK	SPRING		
	MINING	NONE		
	OTHER	NONE		
10-0226225.1100	IRRIGATION	NONE		
	DOMESTIC	NONE		
	STOCK	NONE		
	MINING	NONE		
	OTHER	NONE		
36-0005258	STOCK	STOCK		SW002
	WILDLIFE	INCIDENTAL		
36-0005259	STOCK	STOCK		SW002
	WILDLIFE	INCIDENTAL		
36-0005260	STOCK	STOCK		SW002
	WILDLIFE	INCIDENTAL		
36-0005261	STOCK	STOCK		SW018
	WILDLIFE	INCIDENTAL		
36-0005262	STOCK	STOCK		SW005
	WILDLIFE	INCIDENTAL		
36-0005263	STOCK	STOCK		SW004
	WILDLIFE	INCIDENTAL		
36-0005264	STOCK	STOCK		SW005
	WILDLIFE	INCIDENTAL		
36-0005265	STOCK	STOCK		SW011
	WILDLIFE	INCIDENTAL		
36-0005266	STOCK	STOCK		SW016
	WILDLIFE	INCIDENTAL		
36-0005267	STOCK	STOCK		SW011
	WILDLIFE	INCIDENTAL		
36-0005268	STOCK	STOCK		SW014
	WILDLIFE	INCIDENTAL		
36-0005578	STOCK	STOCK		SW003
	WILDLIFE	INCIDENTAL		
36-0005579	STOCK	STOCK		SW010
	WILDLIFE	INCIDENTAL		
36-0005582	STOCK	STOCK		SW016
	WILDLIFE	INCIDENTAL		
36-0005584	STOCK	STOCK		SW016
	WILDLIFE	INCIDENTAL		
36-0005587	STOCK	STOCK		SW018
	WILDLIFE	INCIDENTAL		
36-0020910	STOCK	STOCK		SW018
	WILDLIFE	INCIDENTAL		
36-0020916	STOCK	CATALOGUED WELL		
36-0020917	STOCK	CATALOGUED WELL		
36-0020920	STOCK	STOCKWELL		

FILING NUMBER	USES CLAIMED OR REFERENCED	USES FOUND BY DWR	APPLIES TO DIVERSIONS	APPLIES TO PWR NUMBERS
36-0020922	STOCK	CATALOGUED WELL		
36-0020924	STOCK	STOCK		SWO14
36-0020925	STOCK	STOCK		SWO02
36-0020926	STOCK	STOCK		SWO15
36-0020927	STOCK	STOCK		SWO13
36-0020928	STOCK	STOCK		SWO03
36-0020929	STOCK	STOCK		SWO10
36-0020931	STOCK	STOCK		SWO06
36-0020935	STOCK	STOCK		SWO09
36-0020937	STOCK	STOCK		SWO16
36-0020939	STOCK	STOCK		SWO04
36-0020940	STOCK	STOCK		SWO07
36-0020941	STOCK	STOCK		SWO05
36-0020942	STOCK	STOCK		SWO12
36-0020943	STOCK	STOCK		SWO11
36-0020944	STOCK	STOCK		SWO01
36-0020945	STOCK	STOCK		SWO08
36-0022902	STOCK	STOCK		SPO16
	WILDLIFE	INCIDENTAL		
36-0022903	STOCK	STOCK		SPO20
	WILDLIFE	INCIDENTAL		
36-0100068	STOCK	STOCK		SWO06
	WILDLIFE	INCIDENTAL		
36-0100069	STOCK	STOCK		SWO06
	WILDLIFE	INCIDENTAL		
36-0100070	STOCK	STOCK		SWO17
	WILDLIFE	INCIDENTAL		
36-0100071	STOCK	STOCK		SWO13
	WILDLIFE	INCIDENTAL		
36-0100072	STOCK	STOCK		SWO15
	WILDLIFE	INCIDENTAL		
36-0100073	STOCK	STOCK		SWO15, SPO20
	WILDLIFE	INCIDENTAL		
38-0022902	STOCK	STOCK		SPO17
	WILDLIFE	INCIDENTAL		
38-0061445	STOCK	STOCK		SPO08
38-0061446	STOCK	STOCK		SPO12
38-0061447	STOCK	STOCK		SPO05
38-0061448	STOCK	STOCK		SPO07
38-0061449	STOCK	STOCK		SPO10
38-0061450	STOCK	STOCK		SPO04
38-0061451	STOCK	STOCK		SPO03
38-0061452	STOCK	STOCK		SPO01
38-0061453	STOCK	STOCK		SPO02
38-0061454	STOCK	STOCK		SPO09
38-0061455	STOCK	STOCK		SPO11
38-0061456	STOCK	STOCK		SPO17
38-0061457	STOCK	STOCK		SPO18
38-0061458	STOCK	STOCK		SPO13
38-0061459	STOCK	STOCK		SPO12
38-0061466	STOCK	STOCK		SPO20
38-0088408	STOCK	STOCK		SPO09
	WILDLIFE	INCIDENTAL		
38-0088410	STOCK	STOCK		SPO08
	WILDLIFE	INCIDENTAL		
38-0088411	STOCK	STOCK		SPO01
	WILDLIFE	INCIDENTAL		
38-0088412	STOCK	STOCK		SPO02
	WILDLIFE	INCIDENTAL		
38-0088413	STOCK	STOCK		SPO06
	WILDLIFE	INCIDENTAL		
38-0088414	STOCK	STOCK		SPO05
	WILDLIFE	INCIDENTAL		
38-0088415	STOCK	STOCK		SPO04
	WILDLIFE	INCIDENTAL		
38-0088590	STOCK	STOCK		SPO12
	WILDLIFE	INCIDENTAL		
38-0088591	STOCK	STOCK		SPO11
	WILDLIFE	INCIDENTAL		
38-0088592	STOCK	STOCK		SPO03
	WILDLIFE	INCIDENTAL		
38-0088652	STOCK	STOCK		SPO07
	WILDLIFE	INCIDENTAL		
38-0088911	STOCK	STOCK		SPO01

FILING NUMBER	USES CLAIMED OR REFERENCED	USES FOUND BY DWR	APPLIES TO DIVERSIONS	APPLIES TO PWR NUMBERS
38-0088911	WILDLIFE	INCIDENTAL		
38-0094523	STOCK	STOCK		SPO19
38-0094618	WILDLIFE	INCIDENTAL		
	STOCK	STOCK		SPO10
38-0094619	WILDLIFE	INCIDENTAL		
	STOCK	STOCK		SPO17
38-0094755	WILDLIFE	INCIDENTAL		
	STOCK	STOCK		SPO18
38-0094756	WILDLIFE	INCIDENTAL		
	STOCK	STOCK		SPO12
38-0094757	WILDLIFE	INCIDENTAL		
	STOCK	STOCK		SPO13
39-0003629	STOCK	STOCK		SW001
39-0003630	STOCK	STOCK		SW011
39-0003631	STOCK	STOCK		SW012
39-0003632	STOCK	STOCK		SW005
39-0003633	STOCK	STOCK		SW007
39-0003634	STOCK	STOCK		SW004
39-0003636	STOCK	STOCK		SW016
39-0003638	STOCK	STOCK		SW009
39-0003642	STOCK	STOCK		SW010
39-0003643	STOCK	STOCK		SW003
39-0003644	STOCK	STOCK		SW013
39-0003645	STOCK	STOCK		SW015
39-0003646	STOCK	STOCK		SW002
39-0003647	STOCK	CATALOGUED WELL		
39-0003648	STOCK	CATALOGUED WELL		
39-0003651	STOCK	CATALOGUED WELL		
39-0003652	STOCK	CATALOGUED WELL		
39-0003663	STOCK	STOCK		SPO06
39-0003664	STOCK	STOCK		SPO05
39-0003665	STOCK	STOCK		SPO08
39-0003666	STOCK	STOCK		SPO01
39-0003667	STOCK	STOCK		SPO05
39-0003668	STOCK	STOCK		SPO03
39-0003670	STOCK	STOCK		SPO06
39-0003671	STOCK	STOCK		SPO10
39-0003672	STOCK	STOCK		SPO11
39-0003674	STOCK	STOCK		SPO17
39-0003675	STOCK	STOCK		SPO01
39-0003678	STOCK	CATALOGUED WELL		
39-0003682	STOCK	STOCK		SPO12
39-0003683	STOCK	STOCK		SPO04
39-0003684	STOCK	STOCK		SPO07
39-0003689	STOCK	STOCK		SPO03
39-0003690	STOCK	STOCK		SPO02
39-0003691	STOCK	STOCK		SPO09
39-0003692	STOCK	STOCK		SW006
39-0003694	STOCK	STOCK		SW008
39-0003695	STOCK	STOCK		SW014
39-0007445	STOCK	STOCK		SPO01, SW002
39-0007446	WILDLIFE	INCIDENTAL		
	STOCK	STOCK		SPO02, SW002
39-0007447	WILDLIFE	INCIDENTAL		
	STOCK	STOCK		SPO03, SW002
39-0007448	WILDLIFE	INCIDENTAL		
	STOCK	STOCK		SPO11, SW018
39-0007449	WILDLIFE	INCIDENTAL		
	STOCK	STOCKWELL		
	WILDLIFE	STOCKWELL		
	OTHER	NONAPPROPRIABLE		
39-0007450	STOCK	STOCK		SPO12, SW005
39-0007452	WILDLIFE	INCIDENTAL		
	STOCK	STOCK		SPO04, SW004
39-0007453	WILDLIFE	INCIDENTAL		
	STOCK	STOCK		SPO05, SW005
39-0007454	WILDLIFE	INCIDENTAL		
	STOCK	STOCK		SPO06
39-0007455	WILDLIFE	INCIDENTAL		
	STOCK	STOCK		SPO07, SW016
39-0007456	WILDLIFE	INCIDENTAL		
	STOCK	STOCK		SPO08, SW011
	WILDLIFE	INCIDENTAL		

FILING NUMBER	USES CLAIMED OR REFERENCED	USES FOUND BY DWR	APPLIES TO DIVERSIONS	APPLIES TO PWR NUMBERS
39-0007457	STOCK	STOCK		SPO09, SW014
	WILDLIFE	INCIDENTAL		
39-0013348	STOCK	STOCK		SW003
	WILDLIFE	INCIDENTAL		
39-0013349	STOCK	STOCK		SW010
	WILDLIFE	INCIDENTAL		
39-0013352	STOCK	STOCK		SW016
	WILDLIFE	INCIDENTAL		
39-0013354	STOCK	STOCK		SPO10, SW016
	WILDLIFE	INCIDENTAL		
39-0013357	STOCK	STOCK		SPO17, SW018
	WILDLIFE	INCIDENTAL		
39-0013921	STOCK	CATALOGUED WELL		
39-0013922	STOCK	CATALOGUED WELL		
39-0013923	STOCK	STOCK		SPO13, SW006
	WILDLIFE	INCIDENTAL		
39-0013924	STOCK	CATALOGUED WELL		
39-0013925	STOCK	STOCK		SPO12, SW006
	WILDLIFE	INCIDENTAL		
39-0013926	STOCK	STOCK		SW017, SPO16
	WILDLIFE	INCIDENTAL		
39-0013927	STOCK	CATALOGUED WELL		
39-0013928	STOCK	STOCK		SPO18, SW013
	WILDLIFE	INCIDENTAL		
39-0013929	STOCK	STOCK		SPO19, SW015
	WILDLIFE	INCIDENTAL		
39-0013930	STOCK	STOCK		SPO20, SW015
	WILDLIFE	INCIDENTAL		

U S E S

PWR #	LOCATION			SUPPLIED BY		PHOTO DATE	SOURCE CHANGE	FACILITY NAME
	SECTION	TWNP	RNGE	DIVERSIONS	WATER SOURCES			
SW001	NWNESW02	140S	190E		SURFACE WATER		NO	INSTREAM USE
SW002	SESWSW02	140S	190E		SURFACE WATER		NO	INSTREAM USE
SW003	SWSWNE04	140S	190E		SURFACE WATER		NO	INSTREAM USE
SW004	SWSWNE11	140S	190E		SURFACE WATER		NO	INSTREAM USE
SW005	SESWSE11	140S	190E		SURFACE WATER		NO	INSTREAM USE
SW006	SENENW14	140S	190E		SURFACE WATER		NO	INSTREAM USE
SW007	NWNESW14	140S	190E		SURFACE WATER		NO	INSTREAM USE
SW008	SENWSE14	140S	190E		SURFACE WATER		NO	INSTREAM USE
SW009	NWSENW16	140S	190E		SURFACE WATER		NO	INSTREAM USE
SW010	SWSWSE16	140S	190E		SURFACE WATER		NO	INSTREAM USE
SW011	SENWNE22	140S	190E		SURFACE WATER		NO	INSTREAM USE
SW012	SENENW23	140S	190E		SURFACE WATER		NO	INSTREAM USE
SW013	NESWNE26	140S	190E		SURFACE WATER		NO	INSTREAM USE
SW014	SESWSW26	140S	190E		SURFACE WATER		NO	INSTREAM USE
SW015	SESESE26	140S	190E		SURFACE WATER		NO	INSTREAM USE
SW016	SWNESW27	140S	190E		SURFACE WATER		NO	INSTREAM USE
SW017	SENE25	140S	190E		SURFACE WATER		NO	INSTREAM USE
SW018	NENE05	140S	200E		SURFACE WATER		NO	INSTREAM USE

R E S E R V O I R S

PWR #	LOCATION			SUPPLIED BY		PHOTO DATE	RESERVOIR NAME	STORAGE PURPOSE
	SECTION	TWNP	RNGE	DIVERSIONS	WATER SOURCES			
SPO01	SWNWNW01	140S	190E		SURFACE WATER	1972	SECTION 1 FENCE TANK	STOCKWATERING WILDLIFE
SPO02	NESENE02	140S	190E		SURFACE WATER	1972	SQUARE TANK	STOCKWATERING WILDLIFE
SPO03	SENESE02	140S	190E		SURFACE WATER	1972	RED TANK	STOCKWATERING WILDLIFE
SPO04	SWNWNW11	140S	190E		SURFACE WATER	1972	NO NAME TANK	STOCKWATERING WILDLIFE
SPO05	SESESE11	140S	190E		SURFACE WATER	1972	UPPER ROCK CNY TANK	STOCKWATERING WILDLIFE
SPO06	SESESE16	140S	190E		SURFACE WATER	1972	LOWER PYRAMID	STOCKWATERING WILDLIFE
SPO07	NENESE21	140S	190E		SURFACE WATER	1972	LOWER MCCORMICK TANK	STOCKWATERING WILDLIFE

PWR #	SECTION	LOCATION TWNP	RNGE	SUPPLIED BY DIVERSIONS	WATER SOURCES	PHOTO DATE	RESERVOIR NAME	STORAGE PURPOSE
SPO08	SWSENE22	140S	190E		SURFACE WATER	1972	PYRAMID CANYON TANK	STOCKWATERING WILDLIFE
SPO09	NESWSW26	140S	190E		SURFACE WATER	1972	#22 TANK	STOCKWATERING WILDLIFE
SPO10	SENWSW27	140S	190E		SURFACE WATER	1972	UNNAMED	STOCKWATERING
SPO11	SWNESW04	140S	200E		SURFACE WATER	1972	KELSEY MILL TANK	STOCKWATERING WILDLIFE
SPO12	NWNEW13	140S	190E		SURFACE WATER	1984	END PIPELINE TANK	STOCKWATERING WILDLIFE
SPO13	SWNESW13	140S	190E		SURFACE WATER	1984	PIPELINE WINDMILL	STOCKWATERING
SPO14	NWNEW08	140S	200E		SURFACE WATER	1972	UNNAMED	STOCKWATERING
SPO15	SWNEW08	140S	200E		SURFACE WATER	1979	UNNAMED	STOCKWATERING
SPO16	SESWNE25	140S	190E		SURFACE WATER	1972	UNNAMED	STOCKWATERING WILDLIFE
SPO17	SENEE05	140S	200E		SURFACE WATER	1955	KELSEY FLAT	STOCKWATERING
SPO18	NWSWSE19	140S	200E		SURFACE WATER	1972	PUMP JACK TANK	STOCKWATERING
SPO19	SESWW20	140S	200E		SURFACE WATER	1972	UNNAMED	STOCKWATERING WILDLIFE
SPO20	SEWNE30	140S	200E		SURFACE WATER	1972	NED ROAD DIKE TANK	STOCKWATERING

P W R S U M M A R Y

PWR #	APPLICABLE ADJ FILINGS	APPLICABLE PRE FILINGS	*APPARENT FIRST USE DATE*	WATER SOURCES AND CLASSIFICATIONS
SPO01	39-0003666 39-0003675 39-0007445	38-0061452 38-0088411 38-0088911	1950 FILING 38-88411	SURFACE WATER: SAN PEDRO RIVER
SPO02	39-0003690 39-0007446	38-0061453 38-0088412	1951 FILING 38-88412	SURFACE WATER: SAN PEDRO RIVER
SPO03	39-0003668 39-0003689 39-0007447	38-0061451 38-0088592	1950 FILING 38-88592	SURFACE WATER: SAN PEDRO RIVER
SPO04	39-0003683 39-0007452	38-0061450 38-0088415	1946 FILING 38-88415	SURFACE WATER: SAN PEDRO RIVER
SPO05	39-0003664 39-0003667 39-0007453	38-0061447 38-0088414	1949 FILING 38-88414	SURFACE WATER: SAN PEDRO RIVER
SPO06	39-0003663 39-0003670 39-0007454	38-0088413	1949 FILING 38-88413	SURFACE WATER: SAN PEDRO RIVER
SPO07	39-0003684 39-0007455	38-0061448 38-0088652	1948 FILING 38-88652	SURFACE WATER: SAN PEDRO RIVER
SPO08	39-0003665 39-0007456	38-0061445 38-0088410	1949 FILING 38-88410	SURFACE WATER: SAN PEDRO RIVER
SPO09	39-0003691 39-0007457	38-0061454 38-0088408	1946 FILING 38-88408	SURFACE WATER: SAN PEDRO RIVER
SPO10	39-0003671 39-0013354	38-0061449 38-0094618	1972 1972 AERIAL PHOTO	SURFACE WATER: SAN PEDRO RIVER
SPO11	39-0003672 39-0007448	38-0061455 38-0088591	1955 FILING 38-88591	SURFACE WATER: SAN PEDRO RIVER
SPO12	39-0003682 39-0007450 39-0013925	38-0061446 38-0061459 38-0088590 38-0094756	1976 FILING 38-61459	SURFACE WATER: SAN PEDRO RIVER
SPO13	39-0013923	38-0061458 38-0094757	1976 FILING 38-61458	SURFACE WATER: SAN PEDRO RIVER
SPO14	NONE	NONE	1972 1972 AERIAL PHOTO	SURFACE WATER: SAN PEDRO RIVER
SPO15	NONE	NONE	1979 1979 AERIAL PHOTO	SURFACE WATER: SAN PEDRO RIVER
SPO16	39-0013926	36-0022902	1963 FILING 36-22902	SURFACE WATER: SAN PEDRO RIVER
SPO17	39-0003674 39-0013357	38-0022902 38-0061456 38-0094619	1954 FILING 38- 94619	SURFACE WATER: SAN PEDRO RIVER
SPO18	39-0013928	38-0061457 38-0094755	1972 1972 AERIAL PHOTO	SURFACE WATER: SAN PEDRO RIVER
SPO19	39-0013929	38-0094523	1972 1972 AERIAL PHOTO	SURFACE WATER: SAN PEDRO RIVER
SPO20	39-0013930	36-0022903 36-0100073 38-0061466	1963 FILING 36-22903	SURFACE WATER: SAN PEDRO RIVER
SW001	39-0003629	36-0020944	1900 FILING 36-20944	SURFACE WATER: SAN PEDRO RIVER
SW002	39-0003646 39-0007445 39-0007446	36-0005258 36-0005259 36-0005260	1884 36-5259 & 36-5260	SURFACE WATER: SAN PEDRO RIVER

PWR #	APPLICABLE ADJ FILINGS	APPLICABLE PRE FILINGS	*APPARENT FIRST USE DATE* DATE BASIS FOR DATE	WATER SOURCES AND CLASSIFICATIONS
SW002	39-0007447	36-0020925		
SW003	39-0003643 39-0013348	36-0005578 36-0020928	1883 FILING 36-5578	SURFACE WATER: SAN PEDRO RIVER
SW004	39-0003634 39-0007452	36-0005263 36-0020939	1884 FILING 36-5263	SURFACE WATER: SAN PEDRO RIVER
SW005	39-0003632 39-0007450 39-0007453	36-0005262 36-0005264 36-0020941	1884 36-5262 & 36-5264	SURFACE WATER: SAN PEDRO RIVER
SW006	39-0003692 39-0013923 39-0013925	36-0020931 36-0100068 36-0100069	1884 FILING 36-100068	SURFACE WATER: SAN PEDRO RIVER
SW007	39-0003633	36-0020940	1900 FILING 36-20940	SURFACE WATER: SAN PEDRO RIVER
SW008	39-0003694	36-0020945	1900 FILING 36-20945	SURFACE WATER: SAN PEDRO RIVER
SW009	39-0003638	36-0020935	1900 FILING 36-20935	SURFACE WATER: SAN PEDRO RIVER
SW010	39-0003642 39-0013349	36-0005579 36-0020929	1883 FILING 36-5579	SURFACE WATER: SAN PEDRO RIVER
SW011	39-0003630 39-0007456	36-0005265 36-0005267 36-0020943	1884 FILING 36-5267	SURFACE WATER: SAN PEDRO RIVER
SW012	39-0003631	36-0020942	1900 FILING 36-20942	SURFACE WATER: SAN PEDRO RIVER
SW013	39-0003644 39-0013928	36-0020927 36-0100071	1884 FILING 36-100071	SURFACE WATER: SAN PEDRO RIVER
SW014	39-0003695 39-0007457	36-0005268 36-0020924	1884 FILING 36-5268	SURFACE WATER: SAN PEDRO RIVER
SW015	39-0003645 39-0013929 39-0013930	36-0020926 36-0100072 36-0100073	1884 FILING 36-100073	SURFACE WATER: SAN PEDRO RIVER
SW016	39-0003636 39-0007455 39-0013352 39-0013354	36-0005266 36-0005582 36-0005584 36-0020937	1884 36-5582 & 36-5584	SURFACE WATER: SAN PEDRO RIVER
SW017	39-0013926	36-0100070	1884 FILING 36-100070	SURFACE WATER: SAN PEDRO RIVER
SW018	39-0007448 39-0013357	36-0005261 36-0005587 36-0020910	1884 FILING 36-5587	SURFACE WATER: SAN PEDRO RIVER
NONE	39-0003647 39-0003648 39-0003651 39-0003652 39-0003678 39-0007449 39-0013921 39-0013922 39-0013924 39-0013927	10-0224128 . 1100 10-0226225 . 1100 36-0020916 36-0020917 36-0020920 36-0020922		

Q U A N T I T I E S O F U S E

PWR #	QUANTIFICATION TYPE	ACRES	CROP TYPE	EFF	WATER DUTY	ESTIMATED VOLUME	REMARKS
SPO01	MAX. AREA/CAP	LT 2.0				LTE 15.0 AF	
SPO02	MAX. AREA/CAP	LT 2.0				LTE 15.0 AF	
SPO03	MAX. AREA/CAP	LT 2.0				LTE 15.0 AF	
SPO04	MAX. AREA/CAP	LT 2.0				LTE 15.0 AF	
SPO05	MAX. AREA/CAP	LT 2.0				LTE 15.0 AF	
SPO06	MAX. AREA/CAP	LT 2.0				LTE 15.0 AF	
SPO07	MAX. AREA/CAP	LT 2.0				LTE 15.0 AF	
SPO08	MAX. AREA/CAP	LT 2.0				LTE 15.0 AF	
SPO09	MAX. AREA/CAP	4.8				26.6 AF	
SPO10	MAX. AREA/CAP	LT 2.0				LTE 15.0 AF	
SPO11	MAX. AREA/CAP	LT 2.0				LTE 15.0 AF	
SPO12	MAX. AREA/CAP	LT 2.0				LTE 15.0 AF	
SPO13	MAX. AREA/CAP	LT 2.0				LTE 15.0 AF	
SPO14	MAX. AREA/CAP	LT 2.0				LTE 15.0 AF	
SPO15	MAX. AREA/CAP	LT 2.0				LTE 15.0 AF	
SPO16	MAX. AREA/CAP	LT 2.0				LTE 15.0 AF	
SPO17	MAX. AREA/CAP	LT 2.0				LTE 15.0 AF	
SPO18	MAX. AREA/CAP	LT 2.0				LTE 15.0 AF	
SPO19	MAX. AREA/CAP	LT 2.0				LTE 15.0 AF	
SPO20	MAX. AREA/CAP	2.5				24.1 AF	
SW001							

SEE VOLUME 1 -
 GENERAL ASSESSMENT
 SEE VOLUME 1 -

SW002

PWR #	QUANTIFICATION TYPE	ACRES	CROP TYPE	EFF	WATER DUTY	ESTIMATED VOLUME	REMARKS
SW003							GENERAL ASSESSMENT SEE VOLUME 1 -
SW004							GENERAL ASSESSMENT SEE VOLUME 1 -
SW005							GENERAL ASSESSMENT SEE VOLUME 1 -
SW006							GENERAL ASSESSMENT SEE VOLUME 1 -
SW007							GENERAL ASSESSMENT SEE VOLUME 1 -
SW008							GENERAL ASSESSMENT SEE VOLUME 1 -
SW009							GENERAL ASSESSMENT SEE VOLUME 1 -
SW010							GENERAL ASSESSMENT SEE VOLUME 1 -
SW011							GENERAL ASSESSMENT SEE VOLUME 1 -
SW012							GENERAL ASSESSMENT SEE VOLUME 1 -
SW013							GENERAL ASSESSMENT SEE VOLUME 1 -
SW014							GENERAL ASSESSMENT SEE VOLUME 1 -
SW015							GENERAL ASSESSMENT SEE VOLUME 1 -
SW016							GENERAL ASSESSMENT SEE VOLUME 1 -
SW017							GENERAL ASSESSMENT SEE VOLUME 1 -
SW018							GENERAL ASSESSMENT SEE VOLUME 1 -

E X P L A N A T I O N

FILINGS AND DECREES

FILING 10-0224128-11 - CLAIMS IRRIGATION, DOMESTIC, STOCKWATERING, MINING, AND OTHER USES FROM LAST CHANCE OR POOL SPRING. NO IRRIGATION, DOMESTIC, MINING, OR OTHER USES WERE FOUND AT THE CLAIMED LOCATION.

FILING 10-0226225-11 - CLAIMS IRRIGATION, DOMESTIC, STOCKWATERING, MINING, AND OTHER WATER USES FROM COTTONWOOD WATER. THE CLAIMED LOCATION IS INCONCLUSIVE, THERE FORE NO WATER USES COULD BE MATCHED TO THIS FILING.

USES AND RESERVOIRS

- SP1 - SECTION 1 FENCE TANK STOCKPOND.
- SP2 - SQUARE TANK STOCKPOND.
- SP3 - RED TANK STOCKPOND.
- SP4 - NO NAME TANK STOCKPOND.
- SP5 - UPPER ROCK CANYON TANK STOCKPOND.
- SP6 - LOWER PYRAMID TANK STOCKPOND.
- SP7 - LOWER MCCORMICK TANK STOCKPOND.
- SP8 - PYRAMID CANYON TANK STOCKPOND.
- SP9 - #22 TANK STOCKPOND.
- SP10 - UNNAMED STOCKPOND.
- SP11 - KELSEY MILL TANK STOCKPOND.
- SP12 - END PIPELINE TANK STOCKPOND.
- SP13 - PIPELINE WINDMILL STOCKPOND.
- SP14-SP16 - UNNAMED STOCKPONDS.
- SP17 - KELSEY FLAT STOCKPOND.
- SP18 - PUMP JACK TANK STOCKPOND.
- SP19 - UNNAMED STOCKPOND.
- SP20 - NED ROAD DIKE TANK STOCKPOND.
- SW1 - INSTREAM STOCKWATERING USE FROM FENCE WASH.
- SW2 - INSTREAM STOCKWATERING USE FROM RED CANYON.
- SW3 - INSTREAM STOCKWATERING USE FROM COLLINS WASH.
- SW4 - INSTREAM STOCKWATERING USE FROM DEEP CANYON.
- SW5 - INSTREAM STOCKWATERING USE FROM ROCK CANYON.
- SW6 - INSTREAM STOCKWATERING USE FROM PIPELINE CANYON WASH.
- SW7 - INSTREAM STOCKWATERING USE FROM THE NORTH FORK OF PYRAMID CANYON.
- SW8 - INSTREAM STOCKWATERING USE FROM LITTLE RINCON MOUNTAIN CANYON.
- SW9 - INSTREAM STOCKWATERING USE FROM IRON FLAT CANYON.
- SW10 - INSTREAM STOCKWATERING USE FROM PAIGE CANYON.

ATTACHMENT B

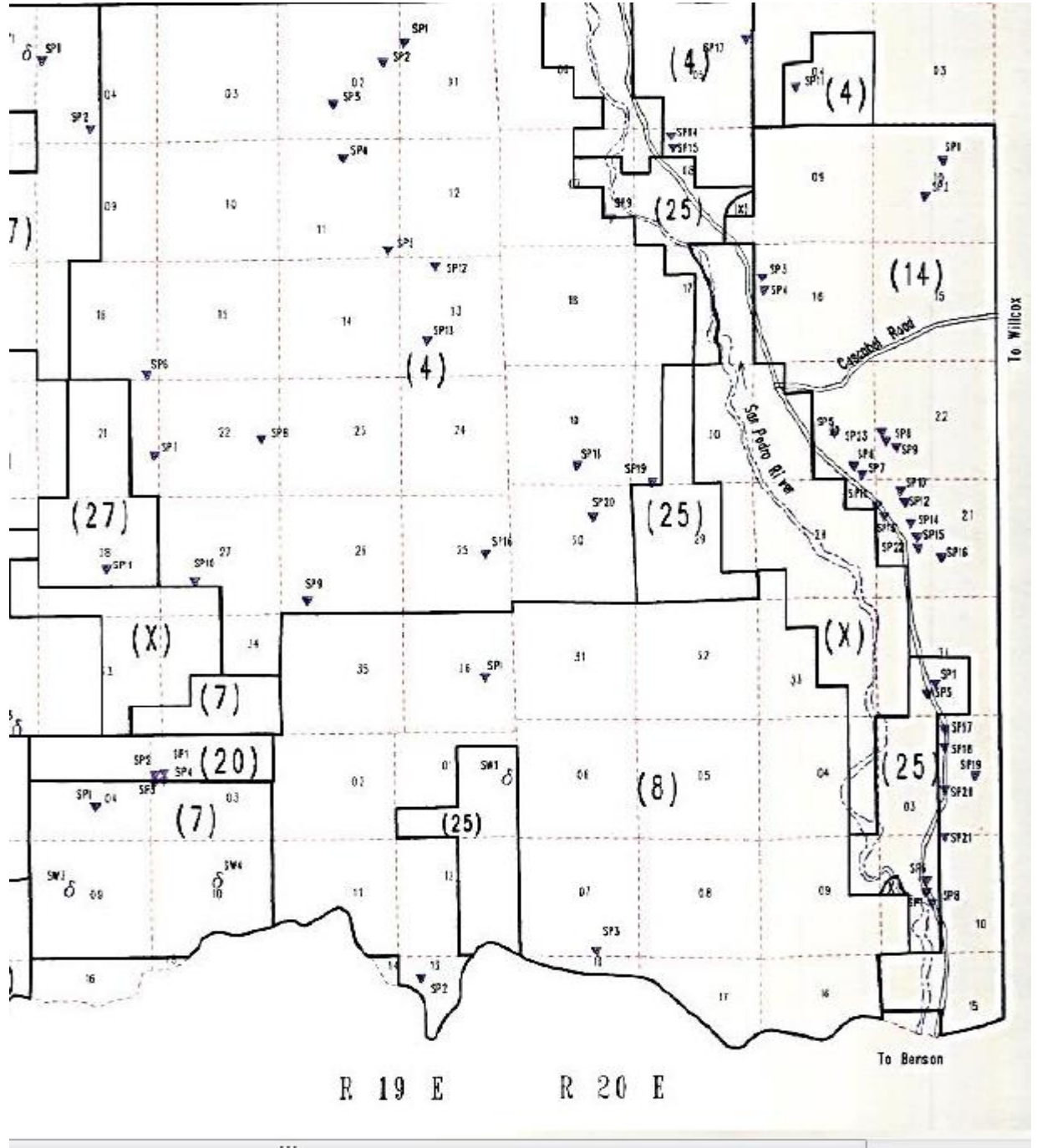

1
2
3
4
5
6
7
8
9
10
11
12
13
14
15
16
17
18
19
20
21
22
23
24
25
26
27
28

ATTACHMENT C

**Proposed Abstract of Water Right
San Pedro Watershed**

Attribute	Proposed Abstract of Water Right	ADWR Comments
1. Proposed Water Right No.:	113-14-004-SP001	
2. Owner of Water Right:		
3. Landowner:	State of Arizona - Arizona State Land Department	
4. Statement of Claimant No.(s):	39-0003666 39-0003675 39-0007445	
5. Statement of Claimant Name(s):	The Cholla Group LLC Arizona State Land Department	
6. Lessee of Permittee:		
7. Basis of Right:	38-0061452 38-0088411 38-0088911	
8. Beneficial Use:	Stock watering from a Stock Pond	
9. Priority Date:	12/31/1950	
10. Quantity:	Not to exceed (\leq) 4 acre feet annually with continuous fill	
11. Place of Use:	SWNWNW 01 14S R19E	
12. Point of Diversion:	SWNWNW 01 14S R19E	
13. Source of Water:	San Pedro River	
14. Facility:	Section 1 Fence Tank	

**Proposed Abstract of Water Right
San Pedro Watershed**

Attribute	Proposed Abstract of Water Right	ADWR Comments
1. Proposed Water Right No.:	113-14-004-SP002	
2. Owner of Water Right:		
3. Landowner:	State of Arizona - Arizona State Land Department	
4. Statement of Claimant No.(s):	39-0003690 39-0007446	
5. Statement of Claimant Name(s):	The Cholla Group LLC Arizona State Land Department	
6. Lessee or Permittee:		
7. Basis of Right:	38-0061453 38-0088412	
8. Beneficial Use:	Stock watering from a Stock Pond	
9. Priority Date:	12/31/1951	
10. Quantity:	Not to exceed (\leq) 4 acre feet annually with continuous fill	
11. Place of Use:	NESENE 02 14S R19E	
12. Point of Diversion:	NESENE 02 14S R19E	
13. Source of Water:	San Pedro River	
14. Facility:	Square Tank	

**Proposed Abstract of Water Right
San Pedro Watershed**

Attribute	Proposed Abstract of Water Right	ADWR Comments
1. Proposed Water Right No.:	113-14-004-SP003	
2. Owner of Water Right:		
3. Landowner:	State of Arizona - Arizona State Land Department	
4. Statement of Claimant No.(s):	39-0003668 39-0003689 39-0007447	
5. Statement of Claimant Name(s):	The Cholla Group LLC Arizona State Land Department	
6. Lessee or Permittee:		
7. Basis of Right:	38-0061451 38-0088592	
8. Beneficial Use:	Stock watering from a Stock Pond	
9. Priority Date:	12/31/1950	
10. Quantity:	Not to exceed (\leq) 4 acre feet annually with continuous fill	
11. Place of Use:	SENE SW 02 14S R19E	
12. Point of Diversion:	SENE SW 02 14S R19E	
13. Source of Water:	San Pedro River	
14. Facility:	Red Tank	

**Proposed Abstract of Water Right
San Pedro Watershed**

Attribute	Proposed Abstract of Water Right	ADWR Comments
1. Proposed Water Right No.:	113-14-004-SP004	
2. Owner of Water Right:		
3. Landowner:	State of Arizona - Arizona State Land Department	
4. Statement of Claimant No.(s):	39-0003683 39-0007452	
5. Statement of Claimant Name(s):	The Cholla Group LLC Arizona State Land Department	
6. Lessee or Permittee:		
7. Basis of Right:	38-0061450 38-0088415	
8. Beneficial Use:	Stock watering from a Stock Pond	
9. Priority Date:	12/31/1946	
10. Quantity:	Not to exceed (\leq) 4 acre feet annually with continuous fill	
11. Place of Use:	SWNWNE 11 14S R19E	
12. Point of Diversion:	SWNWNE 11 14S R19E	
13. Source of Water:	San Pedro River	
14. Facility:	No Name Tank	

**Proposed Abstract of Water Right
San Pedro Watershed**

Attribute	Proposed Abstract of Water Right	ADWR Comments
1. Proposed Water Right No.:	113-14-004-SP005	
2. Owner of Water Right:		
3. Landowner:	State of Arizona - Arizona State Land Department	
4. Statement of Claimant No.(s):	39-0003664 39-0003667 39-0007453	
5. Statement of Claimant Name(s):	Arizona State Land Department	
6. Lessee or Permittee:		
7. Basis of Right:	38-0061447 38-0088414	
8. Beneficial Use:	Stock watering from a Stock Pond	
9. Priority Date:	07/31/1949	
10. Quantity:	Not to exceed (\leq) 4 acre feet annually with continuous fill	
11. Place of Use:	SESESE 11 14S R19E	
12. Point of Diversion:	SESESE 11 14S R19E	
13. Source of Water:	San Pedro River	
14. Facility:	Upper Rock Canyon Tank	

**Proposed Abstract of Water Right
San Pedro Watershed**

Attribute	Proposed Abstract of Water Right	ADWR Comments
1. Proposed Water Right No.:	113-14-004-SP006	
2. Owner of Water Right:		
3. Landowner:	State of Arizona - Arizona State Land Department	
4. Statement of Claimant No.(s):	39-0003663 39-0003670 39-0007454	
5. Statement of Claimant Name(s):	The Cholla Group LLC Arizona State Land Department	
6. Lessee or Permittee:		
7. Basis of Right:	38-0088413	
8. Beneficial Use:	Stock watering from a Stock Pond	
9. Priority Date:	12/31/1949	
10. Quantity:	Not to exceed (\leq) 4 acre feet annually with continuous fill	
11. Place of Use:	SESESE 16 14S R19E	
12. Point of Diversion:	SESESE 16 14S R19E	
13. Source of Water:	San Pedro River	
14. Facility:	Lower Pyramid	

**Proposed Abstract of Water Right
San Pedro Watershed**

Attribute	Proposed Abstract of Water Right	ADWR Comments
1. Proposed Water Right No.:	113-14-004-SP007	
2. Owner of Water Right:		
3. Landowner:	State of Arizona - Arizona State Land Department	
4. Statement of Claimant No.(s):	39-0003684 39-0007455	
5. Statement of Claimant Name(s):	The Cholla Group LLC Arizona State Land Department	
6. Lessee or Permittee:		
7. Basis of Right:	38-0061448 38-0088652	
8. Beneficial Use:	Stock watering from a Stock Pond	
9. Priority Date:	12/31/1948	
10. Quantity:	Not to exceed (\leq) 4 acre feet annually with continuous fill	
11. Place of Use:	NENESE 21 14S R19E	
12. Point of Diversion:	NENESE 21 14S R19E	
13. Source of Water:	San Pedro River	
14. Facility:	Lower McCormick Tank	

**Proposed Abstract of Water Right
San Pedro Watershed**

Attribute	Proposed Abstract of Water Right	ADWR Comments
1. Proposed Water Right No.:	113-14-004-SP008	
2. Owner of Water Right:		
3. Landowner:	State of Arizona - Arizona State Land Department	
4. Statement of Claimant No.(s):	39-0003665 39-0007456	
5. Statement of Claimant Name(s):	The Cholla Group LLC Arizona State Land Department	
6. Lessee or Permittee:		
7. Basis of Right:	38-0061445 38-0088410	
8. Beneficial Use:	Stock watering from a Stock Pond	
9. Priority Date:	12/31/1949	
10. Quantity:	Not to exceed (\leq) 4 acre feet annually with continuous fill	
11. Place of Use:	SWSENE 22 14S R19E	
12. Point of Diversion:	SWSENE 22 14S R19E	
13. Source of Water:	San Pedro River	
14. Facility:	Pyramid Canyon Tank	

**Proposed Abstract of Water Right
San Pedro Watershed**

Attribute	Proposed Abstract of Water Right	ADWR Comments
1. Proposed Water Right No.:	113-14-004-SP009	
2. Owner of Water Right:		
3. Landowner:	State of Arizona - Arizona State Land Department	
4. Statement of Claimant No.(s):	39-0003691 39-0007457	
5. Statement of Claimant Name(s):	The Cholla Group LLC Arizona State Land Department	
6. Lessee or Permittee:		
7. Basis of Right:	38-0061454 38-0088408	
8. Beneficial Use:	Stock watering from a Stock Pond	
9. Priority Date:	12/31/1946	
10. Quantity:	Not to exceed (\leq) 4 acre feet annually with continuous fill	
11. Place of Use:	NESWSW 26 14S R19E	
12. Point of Diversion:	NESWSW 26 14S R19E	
13. Source of Water:	San Pedro River	
14. Facility:	#22 Tank	

**Proposed Abstract of Water Right
San Pedro Watershed**

Attribute	Proposed Abstract of Water Right	ADWR Comments
1. Proposed Water Right No.:	113-14-004-SP010	
2. Owner of Water Right:		
3. Landowner:	State of Arizona - Arizona State Land Department	
4. Statement of Claimant No.(s):	39-0003671 390013354	
5. Statement of Claimant Name(s):	The Cholla Group LLC Arizona State Land Department	
6. Lessee or Permittee:		
7. Basis of Right:	38-0061449 38-0094618	
8. Beneficial Use:	Stock watering from a Stock Pond	
9. Priority Date:	12/31/1972	
10. Quantity:	Not to exceed (\leq) 4 acre feet annually with continuous fill	
11. Place of Use:	SENWSW 27 14S R19E	
12. Point of Diversion:	SENWSW 27 14S R19E	
13. Source of Water:	San Pedro River	
14. Name of Facility:	Unnamed Stockpond	

**Proposed Abstract of Water Right
San Pedro Watershed**

Attribute	Proposed Abstract of Water Right	ADWR Comments
1. Proposed Water Right No.:	113-14-004-SP011	
2. Owner of Water Right:		
3. Landowner:	State of Arizona - Arizona State Land Department	
4. Statement of Claimant No.(s):	39-0003672 39-00074448	
5. Statement of Claimant Name(s):		
6. Lessee or Permittee:		
7. Basis of Right:	38-0061455 38-0088591	
8. Beneficial Use:	Stock watering from a Stock Pond	
9. Priority Date:	12/31/1955	
10. Quantity:	Not to exceed (\leq) 4 acre feet annually with continuous fill	
11. Place of Use:	SWNESW 04 14S R20E	
12. Point of Diversion:	SWNESW 04 14S R20E	
13. Source of Water:	San Pedro River	
14. Name of Facility:	Kelsey Mill Tank	

**Proposed Abstract of Water Right
San Pedro Watershed**

Attribute	Proposed Abstract of Water Right	ADWR Comments
1. Proposed Water Right No.:	113-14-004-SP012	
2. Owner of Water Right:		
3. Landowner:	State of Arizona - Arizona State Land Department	
4. Statement of Claimant No.(s):	39-0003682 39-0007450 39-0013925	
5. Statement of Claimant Name(s):	The Cholla Group LLC Arizona State Land Department	
6. Lessee or Permittee:		
7. Basis of Right:	38-0061446 38-0061459 38-0088590 38-0094756	
8. Beneficial Use:	Stock watering from a Stock Pond	
9. Priority Date:	12/31/1976	
10. Quantity:	Not to exceed (\leq) 4 acre feet annually with continuous fill	
11. Place of Use:	NWNENW 13 14S R19E	
12. Point of Diversion:	NWNENW 13 14S R19E	
13. Source of Water:	San Pedro River	
14. Name of Facility:	End Pipeline Tank	

**Proposed Abstract of Water Right
San Pedro Watershed**

Attribute	Proposed Abstract of Water Right	ADWR Comments
1. Proposed Water Right No.:	113-14-0040SP013	
2. Owner of Water Right:		
3. Landowner:	State of Arizona - Arizona State Land Department	
4. Statement of Claimant No.(s):	39-0013923	
5. Statement of Claimant Name(s):	Arizona State Land Department	
6. Lessee or Permittee:		
7. Basis of Right:	38-0061458 38-0094757	
8. Beneficial Use:	Stock watering from a Stock Pond	
9. Priority Date:	12/31/1976	
10. Quantity:	Not to exceed (\leq) 4 acre feet annually with continuous fill	
11. Place of Use:	SWNESW 13 14S 19E	
12. Point of Diversion:	SWNESW 13 14S 19E	
13. Source of Water:	San Pedro River	
14. Facility	Pipeline Windmill	

**Proposed Abstract of Water Right
San Pedro Watershed**

Attribute	Proposed Abstract of Water Right	ADWR Comments
1. Proposed Water Right No.:	113-14-004-SP016	
2. Owner of Water Right:		
3. Landowner:	State of Arizona – Arizona State Land Department	
4. Statement of Claimant No.(s):	39-0013926	
5. Statement of Claimant Name(s):	Arizona State Land Department	
6. Lessee or Permittee:		
7. Basis of Right:	36-0022902	
8. Beneficial Use:	Stock watering from a Stock Pond	
9. Priority Date:	12/31/1963	
10. Quantity:	Not to exceed (\leq) 4 acre feet annually with continuous fill	
11. Place of Use:	SESWNE 25 14S R19E	
12. Point of Diversion:	SESWNE 25 14S R19E	
13. Source of Water:	San Pedro River	
14. Facility	Unnamed Stockpond	

**Proposed Abstract of Water Right
San Pedro Watershed**

Attribute	Proposed Abstract of Water Right	ADWR Comments
1. Proposed Water Right No.:	113-14-004-SP017	
2. Owner of Water Right:		
3. Landowner:	State of Arizona – Arizona State Land Department	
4. Statement of Claimant No.(s):	39-0003674 39-0013357	
5. Statement of Claimant Name(s):	The Cholla Group, LLC Arizona State Land Department	
6. Lessee or Permittee:		
7. Basis of Right:	38-0022902 38-0061456 38-0094619	
8. Beneficial Use:	Stock watering from a Stock Pond	
9. Priority Date:	12/31/1954	
10. Quantity:	Not to exceed (\leq) 4 acre feet annually with continuous fill	
11. Place of Use:	SENE 05 14S 20E	
12. Point of Diversion:	SENE 05 14S 20E	
13. Source of Water:	San Pedro River	
14. Facility	Kelsey Flat Stockpond	

**Proposed Abstract of Water Right
San Pedro Watershed**

Attribute	Proposed Abstract of Water Right	ADWR Comments
1. Proposed Water Right No.:	113-14-004-SP018	
2. Owner of Water Right:		
3. Landowner:	State of Arizona – Arizona State Land Department	
4. Statement of Claimant No.(s):	39-0013928	
5. Statement of Claimant Name(s):	Arizona State Land Department	
6. Lessee or Permittee:		
7. Basis of Right:	38-0061457 38-0094755	
8. Beneficial Use:	Stock watering from a Stock Pond	
9. Priority Date:	12/31/1972	
10. Quantity:	Not to exceed (\leq) 4 acre feet annually with continuous fill	
11. Place of Use:	NWSWSE 19 14S R20E	
12. Point of Diversion:	NWSWSE 19 14S R20E	
13. Source of Water:	San Pedro River	
14. Facility	Pump Jack Tank Stockpond	

**Proposed Abstract of Water Right
San Pedro Watershed**

Attribute	Proposed Abstract of Water Right	ADWR Comments
1. Proposed Water Right No.:	113-14-004-SP019	
2. Owner of Water Right:		
3. Landowner:	State of Arizona – Arizona State Land Department	
4. Statement of Claimant No.(s):	39-0013929	
5. Statement of Claimant Name(s):	Arizona State Land Department	
6. Lessee or Permittee:		
7. Basis of Right:	38-0094523	
8. Beneficial Use:	Stock watering from a Stock Pond Stock	
9. Priority Date:	12/31/1972	
10. Quantity:	Not to exceed (\leq) 4 acre feet annually with continuous fill	Reasonable Use
11. Place of Use:	SESWSW 20 14S 20E	
12. Point of Diversion:	SESWSW 20 14S 20E	
13. Source of Water:	San Pedro River	
14. Facility:	Unnamed Stockpond	

**Proposed Abstract of Water Right
San Pedro Watershed**

Attribute	Proposed Abstract of Water Right	ADWR Comments
1. Proposed Water Right No.:	113-14-004-SP020	
2. Owner of Water Right:		
3. Landowner:	State of Arizona – Arizona State Land Department	
4. Statement of Claimant No.(s):	39-0013930	
5. Statement of Claimant Name(s):	Arizona State Land Department	
6. Lessee or Permittee:		
7. Basis of Right:	36-0022903 36-0100073 38-0061466	
8. Beneficial Use:	Stock watering from a Stock Pond Stock	
9. Priority Date:	12/31/1963	
10. Quantity:	21.4 acre feet annually with continuous fill	
11. Place of Use:	SEWNNE 30 14S R20E	
12. Point of Diversion:	SEWNNE 30 14S R20E	
13. Source of Water:	San Pedro River	
14. Facility:	Ned Road Dike Tank	

**Proposed Abstract of Water Right
San Pedro Watershed**

Attribute	Proposed Abstract of Water Right	ADWR Comments
1. Proposed Water Right No.:	113-14-004-SW001	
2. Owner of Water Right:		
3. Landowner:	State of Arizona – Arizona State Land Department	
4. Statement of Claimant No.(s):	Cascabel Land & Cattle Co.	
5. Statement of Claimant Name(s):	39-0003629	
6. Lessee or Permittee:		
7. Basis of Right:	36-0020944	
8. Beneficial Use:	Stock watering and wildlife	
9. Priority Date:	12/31/1900	
10. Quantity:	Reasonable Use	
11. Place of Use:	NWNESW 02 14S R19E	
12. Point of Diversion:	NWNESW 02 14S R19E	
13. Source of Water:	Fence Wash	

**Proposed Abstract of Water Right
San Pedro Watershed**

Attribute	Proposed Abstract of Water Right	ADWR Comments
1. Proposed Water Right No.:	113-14-004-SW002	
2. Owner of Water Right:		
3. Landowner:	State of Arizona – Arizona State Land Department	
4. Statement of Claimant No.(s):	39-0003646 39-0007445 39-0007446 39-0007447	
5. Statement of Claimant Name(s):	Cascabel Land & Cattle Co. State of Arizona – Arizona State Land Department	
6. Lessee or Permittee:		
7. Basis of Right:	36-0005258 36-0005259 36-0005260 36-0020925	
8. Beneficial Use:	Stock watering and wildlife	
9. Priority Date:	12/31/1884	
10. Quantity:	Reasonable Use	
11. Place of Use:	SESWSW 02 14S R19E	
12. Point of Diversion:	SESWSW 02 14S R19E	
13. Source of Water:	Red Canyon	

**Proposed Abstract of Water Right
San Pedro Watershed**

Attribute	Proposed Abstract of Water Right	ADWR Comments
1. Proposed Water Right No.:	113-14-004-SW003	
2. Owner of Water Right:		
3. Landowner:	State of Arizona – Arizona State Land Department	
4. Statement of Claimant No.(s):	39-0003643 39-0013348	
5. Statement of Claimant Name(s):	Cascabel Land & Cattle Co. State of Arizona – Arizona State Land Department	
6. Lessee or Permittee:		
7. Basis of Right:	36-0005578 36-0020928	
8. Beneficial Use:	Stock watering and wildlife	
9. Priority Date:	12/31/1883	
10. Quantity:	Reasonable Use	
11. Place of Use:	SWSWNE 04 14S R19E	
12. Point of Diversion:	SWSWNE 04 14S R19E	
13. Source of Water:	Collins Wash	

**Proposed Abstract of Water Right
San Pedro Watershed**

Attribute	Proposed Abstract of Water Right	ADWR Comments
1. Proposed Water Right No.:	113-14-004-SW004	
2. Owner of Water Right:		
3. Landowner:	State of Arizona – Arizona State Land Department	
4. Statement of Claimant No.(s):	39-0003634 39-0007452	
5. Statement of Claimant Name(s):	Cascabel Land & Cattle Co. State of Arizona – Arizona State Land Department	
6. Lessee or Permittee:		
7. Basis of Right:	36-0005263 36-0020939	
8. Beneficial Use:	Stock watering and wildlife	
9. Priority Date:	12/31/1884	
10. Quantity:	Reasonable Use	
11. Place of Use:	SWSWNE 11 14S R19E	
12. Point of Diversion:	SWSWNE 11 14S R19E	
13. Source of Water:	Deep Canyon	

**Proposed Abstract of Water Right
San Pedro Watershed**

Attribute	Proposed Abstract of Water Right	ADWR Comments
1. Proposed Water Right No.:	113-14-004-SW005	
2. Owner of Water Right:		
3. Landowner:	State of Arizona – Arizona State Land Department	
4. Statement of Claimant No.(s):	39-0003632 39-0007450 39-0007453	
5. Statement of Claimant Name(s):	Cascabel Land & Cattle Co. State of Arizona – Arizona State Land Department	
6. Lessee or Permittee:		
7. Basis of Right:	36-0005262 36-0005264 36-0020941	
8. Beneficial Use:	Stock watering and wildlife	
9. Priority Date:	12/31/1884	
10. Quantity:	Reasonable Use	
11. Place of Use:	SESWSE 11 14S R19E	
12. Point of Diversion:	SESWSE 11 14S R19E	
13. Source of Water:	Rock Canyon	

**Proposed Abstract of Water Right
San Pedro Watershed**

Attribute	Proposed Abstract of Water Right	ADWR Comments
1. Proposed Water Right No.:	113-14-004-SW006	
2. Owner of Water Right:		
3. Landowner:	State of Arizona – Arizona State Land Department	
4. Statement of Claimant No.(s):	39-0003692 39-0013923 39-0013925	
5. Statement of Claimant Name(s):	The Cholla Group, LLC Arizona State Land Department	
6. Lessee or Permittee:		
7. Basis of Right:	36-0020931 36-0100068 36-0100069	
8. Beneficial Use:	Stock watering and wildlife	
9. Priority Date:	12/31/1884	
10. Quantity:	Reasonable Use	
11. Place of Use:	SENENW 14 14S R19E	
12. Point of Diversion:	SENENW 14 14S R19E	
13. Source of Water:	Pipeline Canyon Wash	

**Proposed Abstract of Water Right
San Pedro Watershed**

Attribute	Proposed Abstract of Water Right	ADWR Comments
1. Proposed Water Right No.:	113-14-004-SW007	
2. Owner of Water Right:		
3. Landowner:	State of Arizona – Arizona State Land Department	
4. Statement of Claimant No.(s):	39-0003633	
5. Statement of Claimant Name(s):	Cascabel Land & Cattle Co.	
6. Lessee or Permittee:		
7. Basis of Right:	36-0020940	
8. Beneficial Use:	Stock watering and wildlife	
9. Priority Date:	12/31/1900	
10. Quantity:	Reasonable Use	
11. Place of Use:	NWNESW 14 14S R19E	
12. Point of Diversion:	NWNESW 14 14S R19E	
13. Source of Water:	North Fork of Pyramid Canyon	

**Proposed Abstract of Water Right
San Pedro Watershed**

Attribute	Proposed Abstract of Water Right	ADWR Comments
1. Proposed Water Right No.:	113-14-004-SW008	
2. Owner of Water Right:		
3. Landowner:	State of Arizona – Arizona State Land Department	
4. Statement of Claimant No.(s):	39-0003694	
5. Statement of Claimant Name(s):	The Cholla Group, LLC	
6. Lessee or Permittee:		
7. Basis of Right:	36-0020945	
8. Beneficial Use:	Stock watering and wildlife	
9. Priority Date:	12/31/1900	
10. Quantity:	Reasonable Use	
11. Place of Use:	SENWSE 14 14S R19E	
12. Point of Diversion:	SENWSE 14 14S R19E	
13. Source of Water:	Little Rincon Mountain Canyon	

**Proposed Abstract of Water Right
San Pedro Watershed**

Attribute	Proposed Abstract of Water Right	ADWR Comments
1. Proposed Water Right No.:	113-14-004-SW009	
2. Owner of Water Right:		
3. Landowner:	State of Arizona – Arizona State Land Department	
4. Statement of Claimant No.(s):	39-3638	
5. Statement of Claimant Name(s):	Cascabel Land & Cattle Co.	
6. Lessee or Permittee		
7. Basis of Right:	36-0020935	
8. Beneficial Use:	Stock watering and wildlife	
9. Priority Date:	12/31/1900	
10. Quantity:	Reasonable Use	
11. Place of Use:	NWSNW 16 14S R19E	
12. Point of Diversion:	NWSNW 16 14S R19E	
13. Source of Water:	Iron Flat Canyon	

**Proposed Abstract of Water Right
San Pedro Watershed**

Attribute	Proposed Abstract of Water Right	ADWR Comments
1. Proposed Water Right No.:	113-14-004-SW010	
2. Owner of Water Right:		
3. Landowner:	State of Arizona – Arizona State Land Department	
4. Statement of Claimant No.(s):	39-3642 39-13349	
5. Statement of Claimant Name(s):	Cascabel Land & Cattle Co. State of Arizona – Arizona State Land Department	
6. Lessee or Permittee:		
7. Basis of Right:	36-0005579 36-0020929	
8. Beneficial Use:	Stock watering and wildlife	
9. Priority Date:	12/31/1883	
10. Quantity:	Reasonable Use	
11. Place of Use:	SWSWSE 16 14S R19E	
12. Point of Diversion:	SWSWSE 16 14S R19E	
13. Source of Water:	Paige Canyon	

**Proposed Abstract of Water Right
San Pedro Watershed**

Attribute	Proposed Abstract of Water Right	ADWR Comments
1. Proposed Water Right No.:	113-14-004-SW011	
2. Owner of Water Right:		
3. Landowner:	State of Arizona – Arizona State Land Department	
4. Statement of Claimant No.(s):	39-3630 39-7456	
5. Statement of Claimant Name(s):	Cascabel Land & Cattle Co. State of Arizona – Arizona State Land Department	
6. Lessee or Permittee:		
7. Basis of Right:	36-0005265 36-0005267 36-0020943	
8. Beneficial Use:	Stock watering and wildlife	
9. Priority Date:	12/31/1884	
10. Quantity:	Reasonable Use	
11. Place of Use:	SEWNNE 22 14S R19E	
12. Point of Diversion:	SEWNNE 22 14S R19E	
13. Source of Water:	Pyramid Canyon	

**Proposed Abstract of Water Right
San Pedro Watershed**

Attribute	Proposed Abstract of Water Right	ADWR Comments
1. Proposed Water Right No.:	113-14-004-SW012	
2. Owner of Water Right:		
3. Landowner:	State of Arizona – Arizona State Land Department	
4. Statement of Claimant No.(s):	39-3631	
5. Statement of Claimant Name(s):	Cascabel Land & Cattle Co.	
6. Lessee or Permittee:		
7. Basis of Right:	36-0020942	
8. Beneficial Use:	Stock watering and wildlife	
9. Priority Date:	12/31/1900	
10. Quantity:	Reasonable Use	
11. Place of Use:	SENENW 23 14S R19E	
12. Point of Diversion:	SENENW 23 14S R19E	
13. Source of Water:	South Fork of Pyramid Canyon	

**Proposed Abstract of Water Right
San Pedro Watershed**

Attribute	Proposed Abstract of Water Right	ADWR Comments
1. Proposed Water Right No.:	113-14-004-SW013	
2. Owner of Water Right:		
3. Landowner:	State of Arizona – Arizona State Land Department	
4. Statement of Claimant No.(s):	39-3644 39-13928	
5. Statement of Claimant Name(s):	Cascabel Land & Cattle Co. State of Arizona – Arizona State Land Department	
6. Lessee or Permittee:		
7. Basis of Right:	36-0020927 36-0100071	
8. Beneficial Use:	Stock watering and wildlife	
9. Priority Date:	12/31/1884	
10. Quantity:	Reasonable Use	
11. Place of Use:	NESWNE 26 14S R19E	
12. Point of Diversion:	NESWNE 26 14S R19E	
13. Source of Water:	Pump Jack Wash	

**Proposed Abstract of Water Right
San Pedro Watershed**

Attribute	Proposed Abstract of Water Right	ADWR Comments
1. Proposed Water Right No.:	113-14-004-SW014	
2. Owner of Water Right:		
3. Landowner:	State of Arizona – Arizona State Land Department	
4. Statement of Claimant No.(s):	39-3695 39-7457	
5. Statement of Claimant Name(s):	The Cholla Group, LLC State of Arizona – Arizona State Land Department	
6. Lessee or Permittee:		
7. Basis of Right:	36-0005268 36-0020924	
8. Beneficial Use:	Stock watering and wildlife	
9. Priority Date:	12/31/1884	
10. Quantity:	Reasonable Use	Reasonable Use
11. Place of Use:	SESWSW 26 14S R19E	
12. Point of Diversion:	SESWSW 26 14S R19E	
13. Source of Water:	Red Rock Wash	

**Proposed Abstract of Water Right
San Pedro Watershed**

Attribute	Proposed Abstract of Water Right	ADWR Comments
1. Proposed Water Right No.:	113-14-004-SW015	
2. Owner of Water Right:		
3. Landowner:	State of Arizona – Arizona State Land Department	
4. Statement of Claimant No.(s):	39-3645 39-13929 39-13930	
5. Statement of Claimant Name(s):	Cascabel Land & Cattle Co. State of Arizona – Arizona State Land Department	
6. Lessee or Permittee:		
7. Basis of Right:	36-0020926 36-100072 36-100073	
8. Beneficial Use:	Stock watering and wildlife	
9. Priority Date:	12/31/1963	
10. Quantity:	Reasonable Use	
11. Place of Use:	SESESE 26 14S R19E	
12. Point of Diversion:	SESESE 26 14S R19E	
13. Source of Water:	Ned Road Canyon	

**Proposed Abstract of Water Right
San Pedro Watershed**

Attribute	Proposed Abstract of Water Right	ADWR Comments
1. Proposed Water Right No.:	113-14-004-SW016	
2. Owner of Water Right:		
3. Landowner:	State of Arizona – Arizona State Land Department	
4. Statement of Claimant No.(s):	39-3636 39-7455 39-13352	
5. Statement of Claimant Name(s):	Cascabel Land & Cattle Co. State of Arizona – Arizona State Land Department	
6. Lessee or Permittee:		
7. Basis of Right:	36-0005266 36-0005582 36-0005584	
8. Beneficial Use:	Stock watering and wildlife	
9. Priority Date:	12/31/1884	
10. Quantity:	Reasonable Use	
11. Place of Use:	SWNESW 27 14S R19E	
12. Point of Diversion:	SWNESW 27 14S R19E	
13. Source of Water:	McCormick Canyon	

**Proposed Abstract of Water Right
San Pedro Watershed**

Attribute	Proposed Abstract of Water Right	ADWR Comments
1. Proposed Water Right No.:	113-14-004-SW017	
2. Owner of Water Right:		
3. Landowner:	State of Arizona – Arizona State Land Department	
4. Statement of Claimant No.(s):	39-13926	
5. Statement of Claimant Name(s):	State of Arizona – Arizona State Land Department	
6. Lessee or Permittee:		
7. Basis of Right:	36-100070	
8. Beneficial Use:	Stock watering and wildlife	
9. Priority Date:	12/31/1884	
10. Quantity:	Reasonable Use	
11. Place of Use:	SENE 25 14S R19E	
12.	SENE 25 14S R19E	
13. Source of Water:	Wagner Canyon	

**Proposed Abstract of Water Right
San Pedro Watershed**

Attribute	Proposed Abstract of Water Right	ADWR Comments
1. Proposed Water Right No.:	113-14-004-SW018	
2. Owner of Water Right:		
3. Landowner:	State of Arizona – Arizona State Land Department	
4. Statement of Claimant No.(s):	39-7448 39-13357	
5. Statement of Claimant Name(s):	State of Arizona – Arizona State Land Department	
6. Lessee or Permittee:		
7. Basis of Right:	36-0005261 36-005587 36-0020910	
8. Beneficial Use:	Stock watering and wildlife	
9. Priority Date:	12/31/1883	
10. Quantity:	Reasonable Use	
11. Place of Use:	NENE 05 14S R20E	
12. Point of Diversion:	NENE 05 14S R20E	
13. Source of Water:	Kelsey Canyon Wash	

ATTACHMENT D

1
2
3
4
5
6
7
8
9
10
11
12
13
14
15
16
17
18
19
20
21
22
23
24
25
26
27
28

Carla Consoli & Stanley Lutz
Lewis Roca Rothgerber Christie LLP
201 East Washington Street
Suite 1200
Phoenix, Arizona 85004

Cascabel Land and Cattle Company
5970 East San Leandro Drive
Tucson, AZ 85715

Clerk of the Superior Court
Maricopa County
Attn: Water Case
601 West Jackson Street
Phoenix, Az 85003

Joe P. Sparks and Laurel A. Herrmann
The Sparks Law Firm, P.C.
7503 First Street
Scottsdale, Az 85251-4573

John Weldon and Mark McGinnis
Michael Foy
Salmon, Lewis & Weldon
2850 E. Camelback Road
Suite 200
Phoenix, AZ 85016

Kimberly R. Parks
Arizona Department of Water Resources
P. O. Box 36020
Phoenix, Az 85067

Linus Everling and Thomas L. Murphy
Gila River Indian Community
Office of the General Counsel
P. O. Box 97
Sacaton, Az 85147

1 Lucas T. Christian and Julian Nava
Rosette, LLP
2 565 W. Chandler Blvd. Suite 212
3 Chandler, AZ 85225

4 S. Montgomery, R.Interpreter, J. Tomkus
Montgomery & Interpreter, Plc
5 3301 E. Thunderbird Road
Phoenix, Az 85032

6
7 Susan Ward Harris
Special Master
8 Central Court Building, Ste 3a
201 West Jefferson
9 Phoenix, Az 85003-2205

10 The Cholla Group
11 H. Gilbert Lusk
1382 N. Boyce Ave
12 Green valley Arizona 85614

13

14

15

16

17

18

19

20

21

22

23

24

25

26

27

28