

1
2
3
4
5
6
7
8
9
10
11
12
13
14
15
16
17
18
19
20
21
22
23
24
25
26
27
28

IN THE SUPERIOR COURT OF THE STATE OF ARIZONA
IN AND FOR THE COUNTY OF MARICOPA

IN RE THE GENERAL ADJUDICATION
OF ALL RIGHTS TO USE WATER IN THE
GILA RIVER SYSTEM AND SOURCE

W-1 (Salt)
W-2 (Verde)
W-3 (Upper Gila)
W-4 (San Pedro)
(Consolidated)

Contested Case No. **W1-11-3372**

**ORDER APPROVING
PROPOSED WATER RIGHT
ABSTRACTS**

CONTESTED CASE NAME: *In re ASLD – Argo Land and Cattle Company*
HSR INVOLVED: San Pedro River Watershed Hydrographic Survey Report.
DESCRIPTIVE SUMMARY: Three (3) abstracts for proposed water rights approved and added to the Catalog of Proposed Water Rights.
NUMBER OF PAGES: 9
DATE OF FILING: April 7, 2022

On March 28, 2022, the Arizona State Land Department (ASLD) submitted suggested corrections to the proposed abstracts prepared for *de minimis* potential water rights identified in Watershed File Report 115-05-053. No other suggested corrections have been received

1
2
3
4
5
6
7
8
9
10
11
12
13
14
15
16
17
18
19
20
21
22
23
24
25
26
27
28





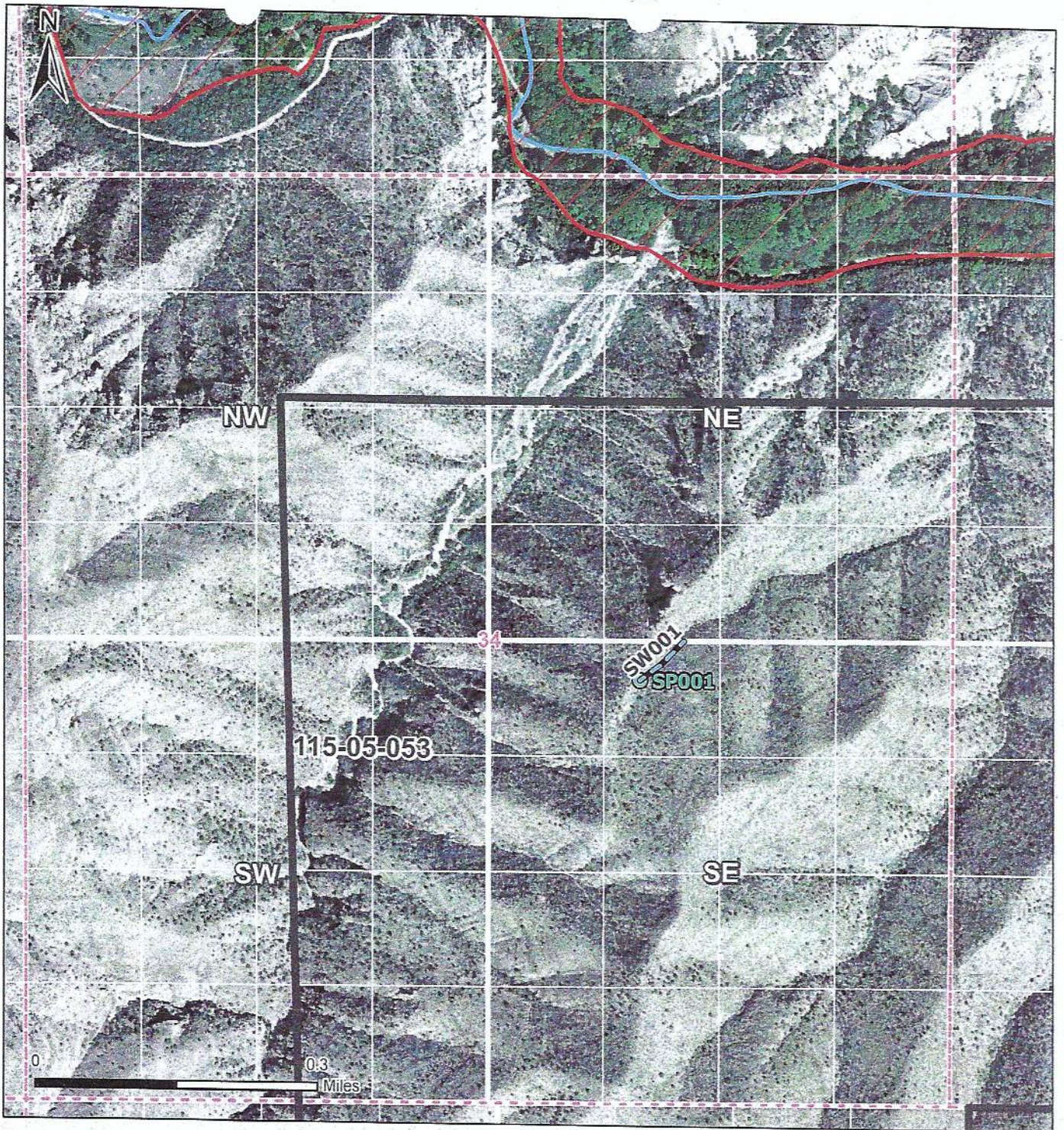

APPENDIX A

**Proposed Abstract of Water Right
San Pedro Watershed**

Attribute	Proposed Abstract of Water Right
1. Proposed Water Right No.:	115-05-053-SW001
2. Owner of Water Right:	State of Arizona – Arizona State Land Department
3. Landowner:	State of Arizona - Arizona State Land Department
4. Statement of Claimant No.(s):	39-6947
5. Statement of Claimant Name(s):	State of Arizona - Arizona State Land Department
6. Lessee:	The Nature Conservancy
7. Basis of Right:	36-100036
8. Beneficial Use:	Stock and wildlife watering
9. Priority Date:	December 31, 1884
10. Quantity:	Reasonable use
11. Place of Use:	NENWSE Sec. 34 T6S R19E of the Gila and Salt River Base and Meridian, Graham County, Arizona (see attached map)
12. Point of Diversion:	NENWSE Sec. 34 T6S R19E of the Gila and Salt River Base and Meridian, Graham County, Arizona (see attached map)
13. Source of Water:	Valenzuela Canyon in the Aravaipa Creek Subwatershed of the San Pedro River



Legend

-  Stockpond
-  Streamside use
-  Subflow Zone
-  San Pedro River
-  WFR
-  Section
- 160 Acres 1/4 Section
- 10 Acres 1/4 1/4 1/4 Section

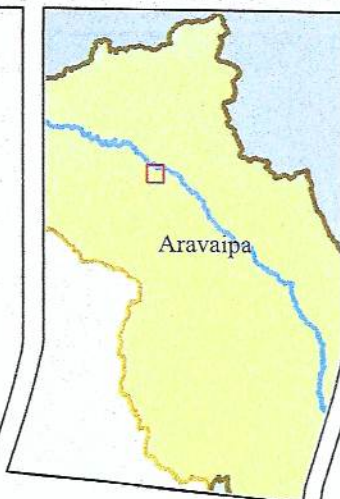

Map of Section 34 Township 6S Range 19E

In re SLD - Argo Land and Cattle Company
 Contested Case W1-11-3372
 Watershed File Report 115-05-053



ADWR January 2022

Data sources include: Aerial Imagery: NAIP 2019

**Proposed Abstract of Water Right
San Pedro Watershed**

Attribute	Proposed Abstract of Water Right
1. Proposed Water Right No.:	115-05-053-SW002
2. Owner of Water Right:	State of Arizona – Arizona State Land Department
3. Landowner:	State of Arizona - Arizona State Land Department
4. Statement of Claimant No.(s):	39-6948
5. Statement of Claimant Name(s):	State of Arizona - Arizona State Land Department
6. Lessee:	The Nature Conservancy
7. Basis of Right:	36-100037
8. Beneficial Use:	Stock and wildlife watering
9. Priority Date:	December 31, 1884
10. Quantity:	Reasonable use
11. Place of Use:	SWSWSW Sec. 3 T7S R19E of the Gila and Salt River Base and Meridian, Graham County, Arizona (see attached map)
12. Point of Diversion:	SWSWSW Sec. 3 T7S R19E of the Gila and Salt River Base and Meridian, Graham County, Arizona (see attached map)
13. Source of Water:	6948 Wash in the Aravaipa Creek Subwatershed of the San Pedro River

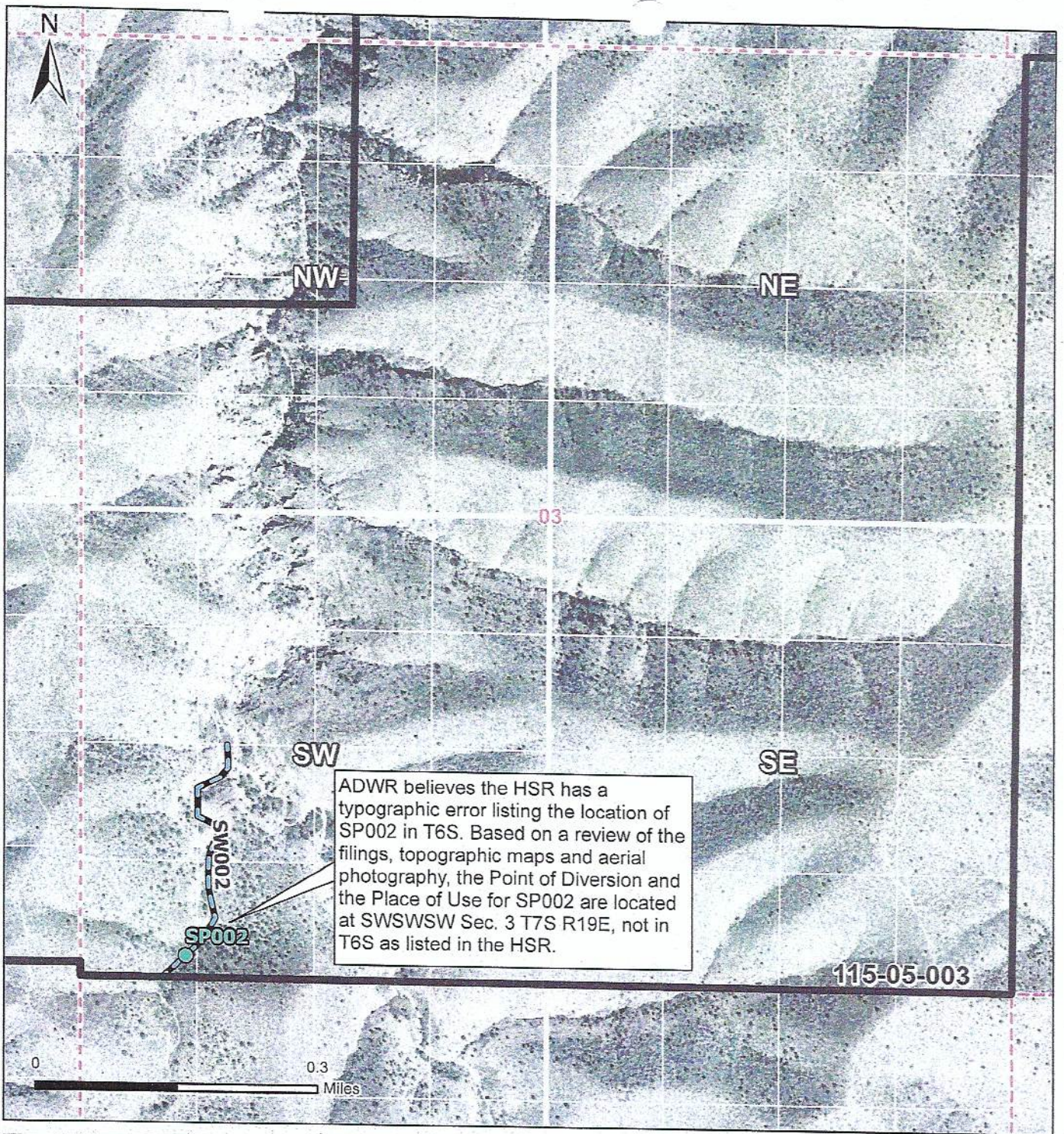

Legend

- Stockpond
- Streamside use
- WFR
- Section
- 160 Acres 1/4 Section
- 10 Acres 1/4 1/4 1/4 Section



Map of Section 3 Township 7S Range 19E

In re SLD - Argo Land and Cattle Company
 Contested Case W1-11-3372
 Watershed File Report 115-05-053



ADWR January 2022

Data sources include: Aerial Imagery: NAIP 2019

**Proposed Abstract of Water Right
San Pedro Watershed**

Attribute	Proposed Abstract of Water Right
1. Proposed Water Right No.:	115-05-053-SP001
2. Owner of Water Right:	State of Arizona – Arizona State Land Department
3. Landowner:	State of Arizona - Arizona State Land Department
4. Statement of Claimant No.(s):	39-6947
5. Statement of Claimant Name(s):	State of Arizona - Arizona State Land Department
6. Lessee:	The Nature Conservancy
7. Basis of Right:	38-88428
8. Beneficial Use:	Stock and wildlife watering from a stock pond
9. Priority Date:	December 31, 1976
10. Quantity:	Not to exceed (\leq) 4-acre feet annually with continuous refill
11. Place of Use:	NENWSE Sec. 34 T6S R19E of the Gila and Salt River Base and Meridian, Graham County, Arizona (see attached map)
12. Point of Diversion:	NENWSE Sec. 34 T6S R19E of the Gila and Salt River Base and Meridian, Graham County, Arizona (see attached map)
13. Source of Water:	Valenzuela Canyon in the Aravaipa Subwatershed of the San Pedro River
14. Facility:	Valenzuela Tank

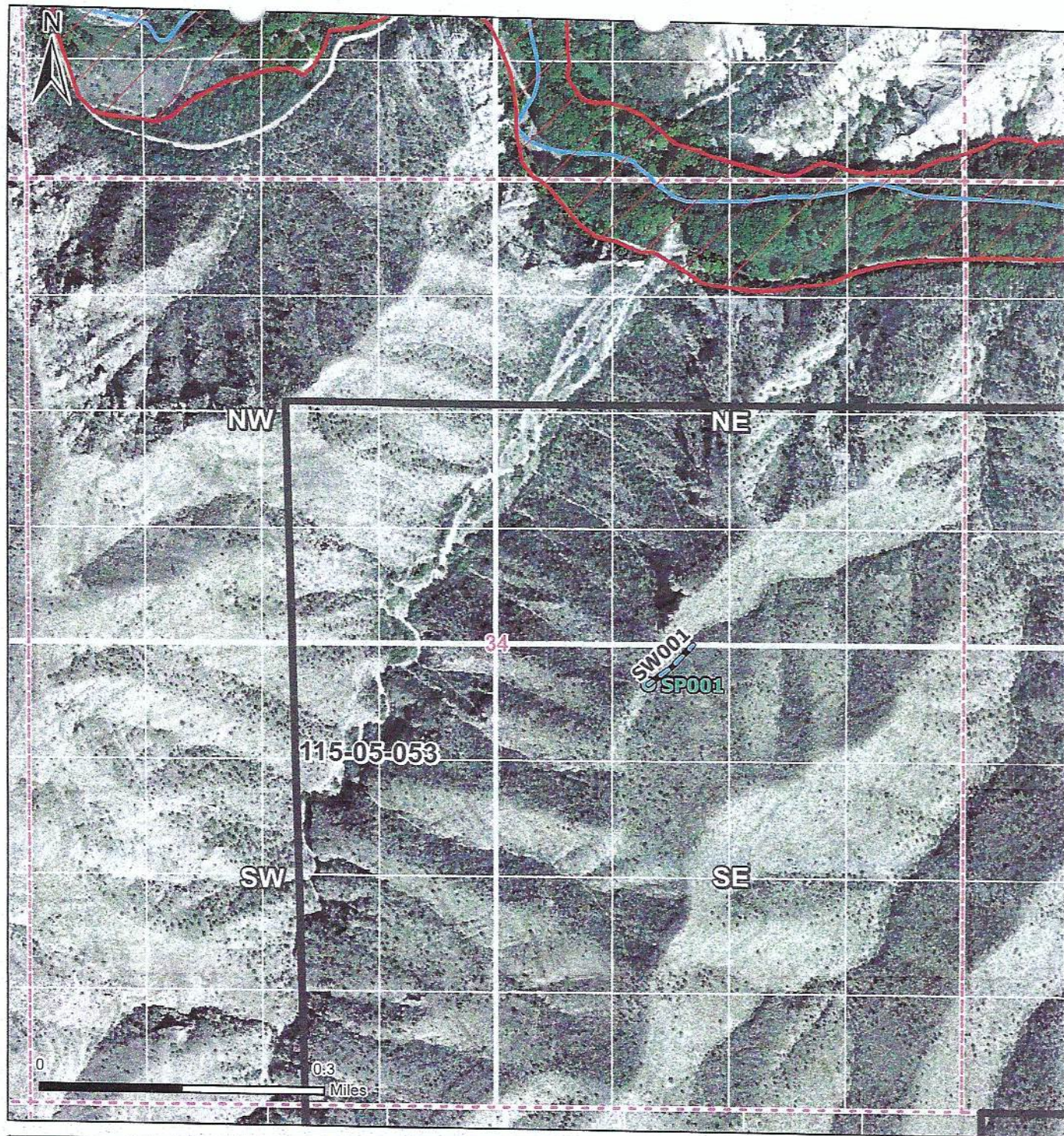

Legend

- Stockpond
- Streamside use
- Subflow Zone
- San Pedro River
- WFR
- Section

160 Acres 1/4 Section
 10 Acres 1/4 1/4 1/4 Section

Data sources include: Aerial Imagery: NAIP 2019

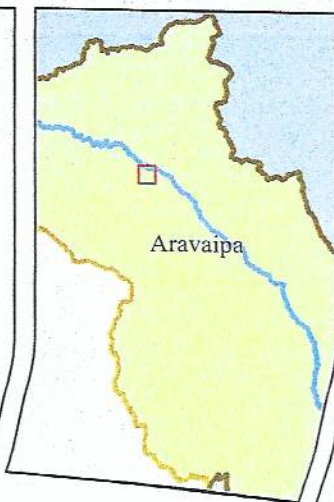

Map of Section 34 Township 6S Range 19E

In re SLD - Argo Land and Cattle Company
 Contested Case W1-11-3372
 Watershed File Report 115-05-053



ADWR January 2022