

Important Tips

Your needs and those of your family should be the primary factors considered when determining the timing of your evacuation. If you must evacuate, do not delay your departure in anticipation of the opening of the contraflow lanes. Should the contraflow be activated, citizens will be advised through local radio and television stations. All citizens should prepare a plan well in advance of the evacuation.

The following steps are recommended:

- ✓ Assemble your disaster supplies kit with items such as flashlights, cell phones, extra batteries, battery chargers, portable radio, first aid kit, emergency water and food, medical supplies and equipment, non-electric can opener, highway map, important documents, such as insurance and medical information, etc.
- ✓ Secure your home against disaster to help reduce damages. Cover windows with shielding materials. Secure or put up any loose objects from around your home.
- ✓ If you cannot take your pets with you, make provisions for them.
- ✓ Know your area's evacuation plan/routes before you leave home (www.texas.gov).
- ✓ Fill your vehicle with gas as early as possible. Take only the vehicle necessary to transport you and your family to safety. Extra vehicles create congestion.
- ✓ Bring extra cash in case banks are closed and ATMs are not working.
- ✓ Notify family and friends (especially those out of the area) of your plan and your destination.
- ✓ Develop an emergency plan in case family members are separated. Instruct all evacuating family members of the name and contact information of your designated out-of-area friend or family.
- ✓ Ensure children know how and when to call 9-1-1.
- ✓ Evacuate, traveling safely to your destination.
- ✓ Expect travel times to destinations to be significantly longer than normal.

After the storm, listen to local officials for the all-clear signal before returning home. Check for information at www.texas.gov.

Do not try to drive through standing water. Just a few inches can float a vehicle.

Fender-Bender?

State law requires motorists to move fender-bender accidents out of the travel lanes to the shoulder of the road. To keep all travel lanes and shoulders clear, however, disabled vehicles on the shoulder will be relocated to the next exit ramp where further assistance may be available.

More information on hurricane preparedness and evacuation safety is available from the following:

Shelters and Special Needs

Call 2-1-1

Emergency Alert Stations

Corpus Christi: KLUX 89.5 FM
San Antonio: WOAI 1200 AM

State of Texas

www.texas.gov

Texas Department of Transportation

www.txdot.gov

Highway Road Conditions and Evacuation Routes

www.drivetexas.org

1-800-452-9292

Texas Department of Public Safety

<https://www.dps.texas.gov/>

Governor's Division of Emergency Management

<https://tdem.texas.gov/>

City of Corpus Christi

www.cctexas.com/eoc

American Red Cross

www.redcross.org

1-800-RED-CROSS (733-2767)

For Emergencies: Call 9-1-1

Rev. 05/20/2021

CORPUS CHRISTI TO SAN ANTONIO

TEXAS



Hurricane Evacuation Contraflow Route

Motorist Advisory

**Evacuation Plans May or May Not
Include Activating Contraflow Lanes**



CORPUS CHRISTI TO SAN ANTONIO

TEXAS



Hurricane Evacuation Contraflow Route

WHO.....This plan will affect motorists evacuating from Corpus Christi.

WHY.....To help move citizens safely and efficiently out of harm's way during large-scale evacuations.

WHAT....If this plan is activated, I-37 southbound lanes will be reversed to carry two lanes of northbound traffic. Traffic in the contraflow lanes will be able to exit I-37 at US 59 and SH 359.

WHEN...The reversal will be considered only when the Corpus Christi area is threatened by a major hurricane and mandatory evacuations are issued. A decision to reverse I-37 will be made by local authorities working with the State Operations Center based on the strength of the storm and projected landfall.

WHERE...In the event of a hurricane evacuation, there is a two stage procedure for TxDOT. Stage 1 is the opening of the Evacuation Lanes (emergency shoulders) on northbound Interstate 37. Contraflow operations are activated in Stage 2. In Stage 2, northbound Interstate 69/US Highway 77 (I-69/US 77) traffic will cross over to the contraflow lanes of I-37 at the I-69/US 77/I-37 interchange, south of the Nueces River. Traffic can also enter contraflow lanes from US 77 and I-37, north of the Nueces River. The contraflow lanes for Stage 2 will end at SH 97 and FM 3006 near Pleasanton, TX. The left contraflow lanes will exit at SH 97 and the right contraflow lanes will exit at FM 3006.

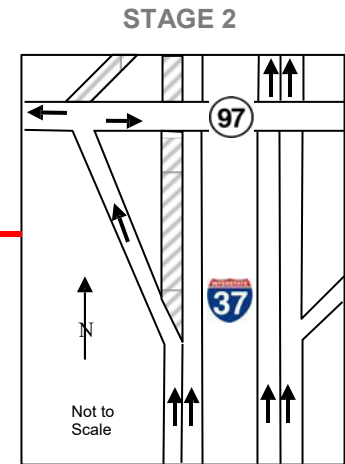
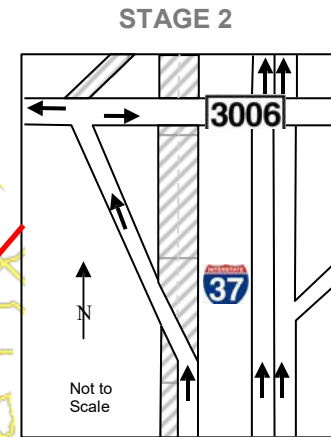
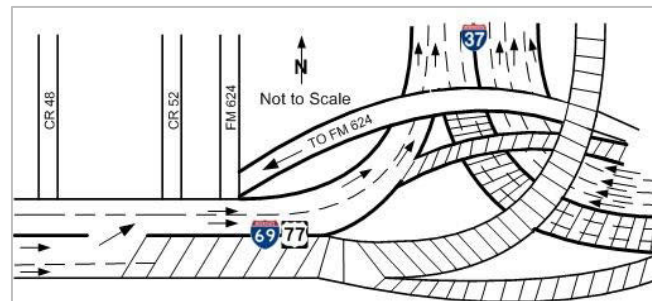
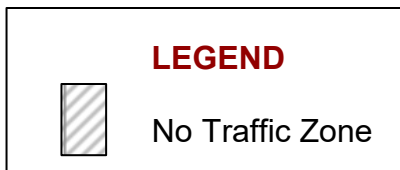

* Exits to and from the I-37 contraflow lanes are located at US 59 at George West and at SH 359 at Mathis.

