



BY  
TIMOTHY OULTON  
&  
MICHAEL YEUNG

## REV MK2 MIR ASSEMBLY INSTRUCTIONS

---

### PARTS ENCLOSED :

- (A) Junction Box (1; not included) 50lbs (22.7kg). MIN.FIXTURE RAED
- (B) Driver( Not included; 1)
- (C) Wall Bracket (1)
- (D) Mirror Body (1)
- (E) Wire Nunts (2)

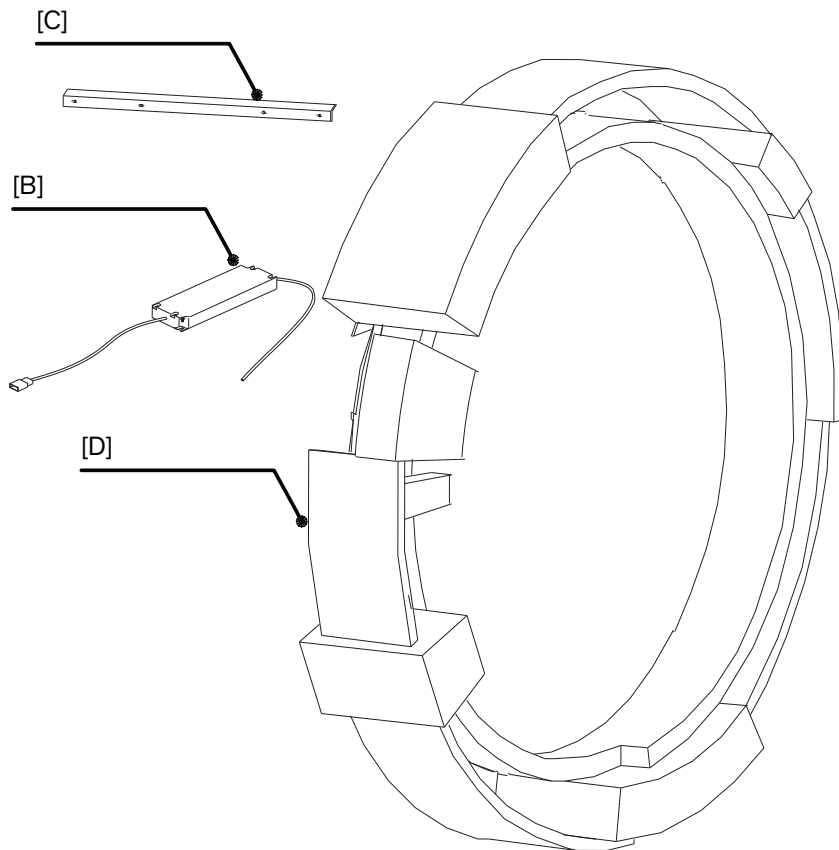

### PRODUCT DESCRIPTION :

General material: raw steel

Length: 97.0cm (38.18IN)

Width: 18.0cm (7.08IN)

Height: 94.0cm (37.0IN)

Weight: 30 kg (66.1lbs)



BY  
TIMOTHY OULTON  
&  
MICHAEL YEUNG

## REV MK2 MIR ASSEMBLY INSTRUCTIONS

Step 1:

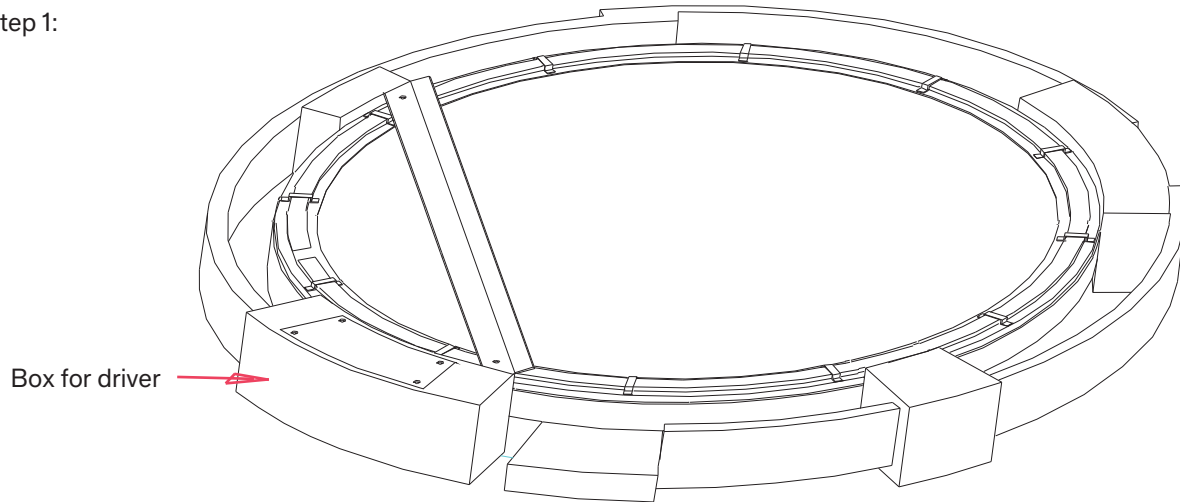

Step 2: Installation for driver inside the steel box

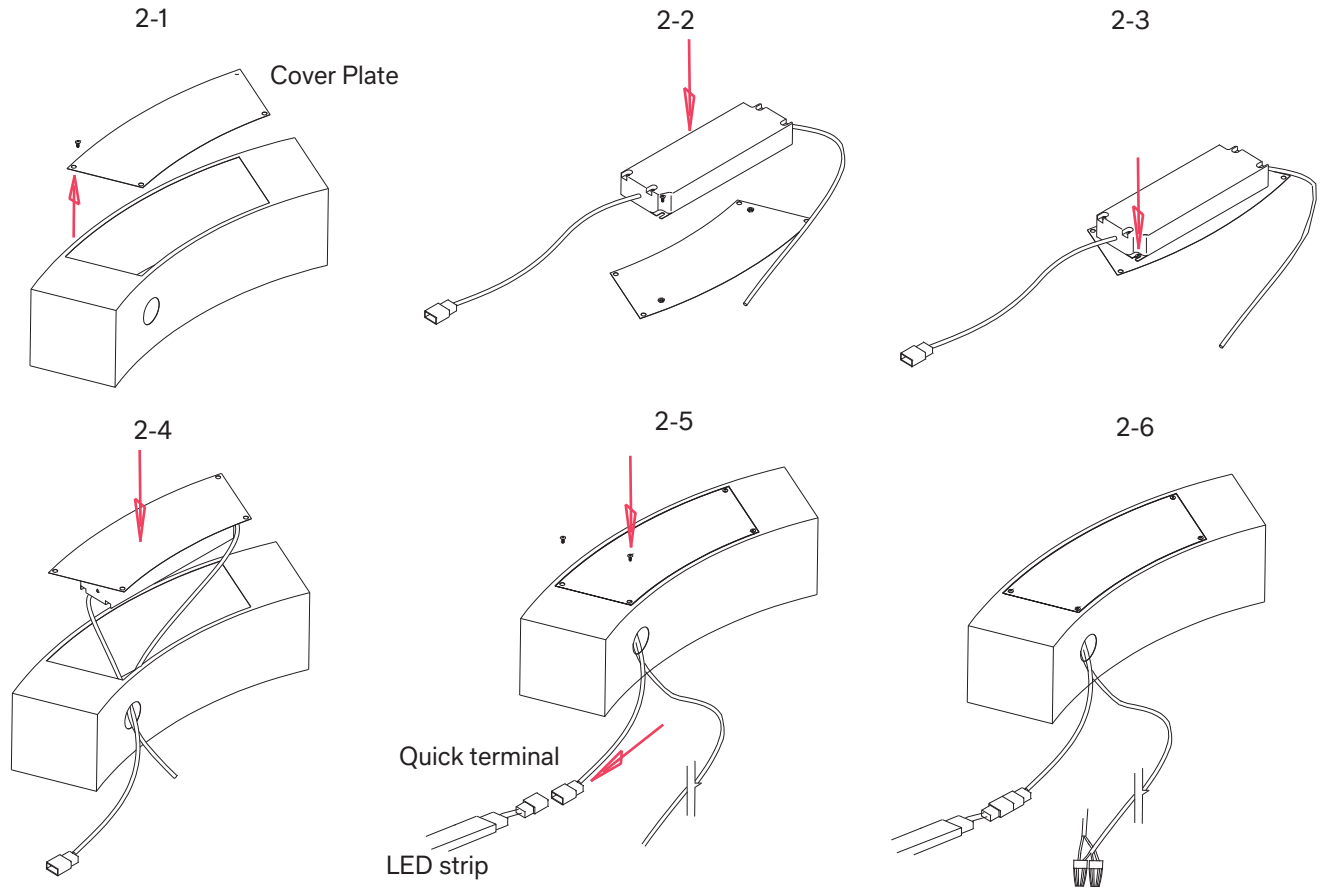



BY  
TIMOTHY OULTON  
AND  
MICHAEL YEUNG

### REV MK2 MIR ASSEMBLY INSTRUCTIONS

Step 3:

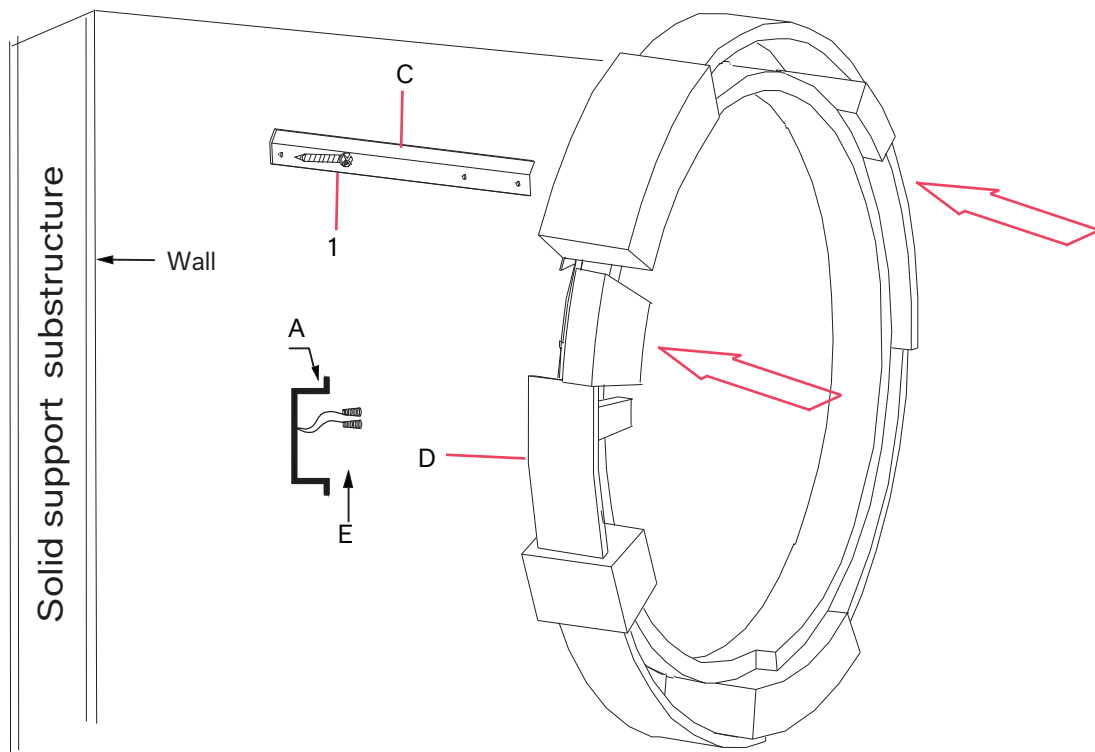

Step 4:

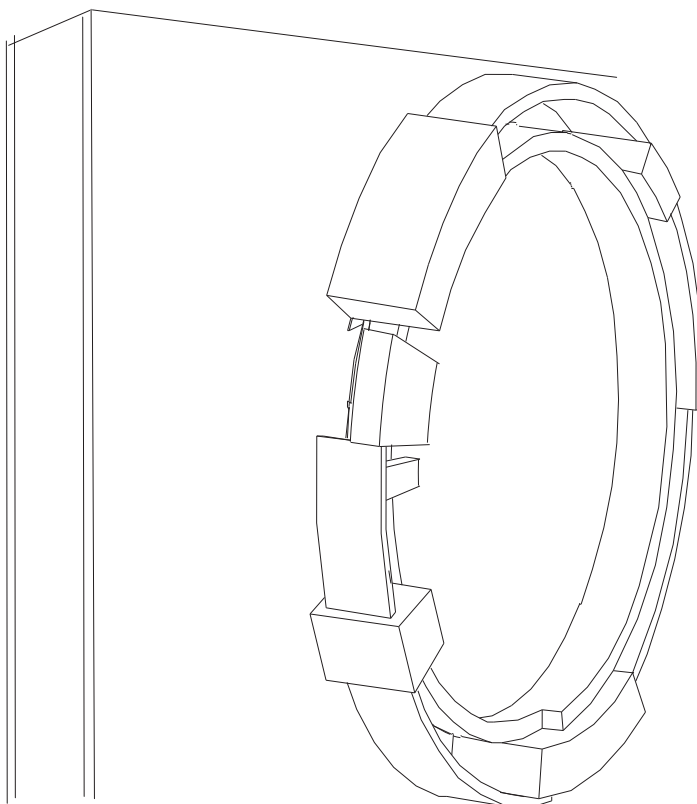



BY  
TIMOTHY OULTON  
&  
MICHAEL YEUNG

## REV MK2 MIR ASSEMBLY INSTRUCTIONS

### IMPORTANT PLEASE READ

#### IMPORTANT SAFETY INSTRUCTIONS:

##### PROFESSIONAL INSTALLATION REQUIRED

1. Use an authorized and certified electrician for consultation and installation. Electrician must be familiar with commercial-type applications of very heavy chandeliers.
2. The screws need to be screwed into a solid support substructure inside the wall, which would require professional.
3. This fixture has been rated for LED strip .
4. To avoid the risk of fire, do not exceed the recommended wattage.
5. The wall must have at least the capacity of 5 times the weight of the mirror. For this light, at least a wall capacity of 125.0kg (275lbs) is required. Please reinforce your wall as necessary.
6. The manufacturer and distributor accepts no liability for incorrect installation.
7. For indoor use only.
8. Keep away from children.

#### WARNINGS:

All wires are connected. When unpacking, be careful not to pull wires, as a bad connection may result. Do not connect electricity until your fixture is fully assembled. To reduce the risk of fire, electrical shock, or personal injury, always turn off fixture and allow it to cool prior to replacing the lightbulb. Do not touch or look directly at the bulb when fixture is illuminated. Keep flammable materials away from lit bulb.

**THIS PRODUCT IS NOT A TOY AND HAS NO PLAY VALUE**

#### ASSEMBLY & INSTALLATION:

1. Please find the corresponding numbered parts before you assemble the Mirror.
2. Carefully remove all parts from the box and remove all covering
3. Turn OFF power to the junction box where the wall mirror will be installed.
4. Upside down the mirror body (D) on a flat surface. Loosen the screw, then remove the cover plate from the steel box of the mirror body.
5. Attach the driver on the cover plate with mounting screw, then fasten the driver to the steel box and through the wire of the driver out the hole as left drawing
6. Connect the hot wire to the junction box wire (usually black or smooth) with a plastic wire nut (E) and wrap the connection with electrical tape. Connect the neutral wire to the neutral junction box wire (usually white or ribbed) with a plastic wire nut (E) and wrap the connection with electrical tape. Connect the driver wire to the LED strip with wire quick terminal as left drawing.
7. Attach the wall bracket (C) to the wall with mounting screw (1; Not included).
8. Hang the mirror body onto the wall bracket.
9. Restore power to the junction box (A) and test mirror light fixture.

#### CARE INSTRUCTIONS:

Do not use polishes or cleaners on the fixture. Wipe clean with a soft, dry cloth.

#### ENVIRONMENT:

Special waste handling may be required. Please contact your local authorities for more information.