



TIMOTHY OULTON

ASSEMBLY INSTRUCTION

ROD TINY FLR LAM

PARTS ENCLOSED

ITEMS	DIAGRAM	DESCRIPTION	QTY.
(A)		Body	1
(B)		Glass Rod+Spare	32+1
(C)		Bulb+Spare (E14 for EU/E12 for US)	6+2
(D)		Glass Covering	1
(E)		Wrench	1

IMPORTANT SAFETY INSTRUCTIONS:

1. Use an authorized and certified electrician for consultation and installation.
2. This fixture has been rated for 6 x 25-watt maximum standard bulb.
3. To avoid the risk of fire, do not exceed the recommended wattage.
4. The manufacturer and distributor accepts no liability for incorrect installation.
5. For indoor use only.
6. Keep away from children.

Warnings:

1. Turn-off electricity supply at main circuit panel before installing. Do not connect electricity supply until your table lamp is fully assembled and installed.
2. All wires are connected. Do not remove the table lamp from its packaging by pulling on the power cord, as a bad connection may result.
3. To reduce the risk of fire, electrical shock, or personal injury, always turn off the table lamp and allow it to cool prior to replacing light bulb. Do not touch bulb when fixture is turned on or look directly at light bulb. Keep flammable materials away from light bulb.
4. Deviation from instructions may result in a risk of fire or electric shock.

PRODUCT DESCRIPTION:

General material: Glass & Iron
 Height: 110 cm (43.31in)
 Diameter: 25.0 cm (9.84in)
 Weight: 29.3Kg (64.6lbs)

TO ASSEMBLE:

1. Carefully remove all parts from the box and remove all plastic covering. If lamp stem tilts or loosens, retighten nut on top of base with wrench (E) as per left.
2. Fasten lightbulbs (C) to the lampholders.
3. Loosen bolts (A1) from body (A) and detach metal ring (A2).
4. Insert glass rod (B) from the mid-section of the **floor** lamp, first by moving the rod upward through the metal ring on top (as in arrow 1), then move downward toward the base of the **floor** lamp (as in arrow 2).
5. Put glass covering (D) onto body (A).
6. Attach metal ring (A2) to body (A) with bolts (A1) .
7. Insert plug into socket and test **floor** lamp fixture.
8. **When you want to replace the lightbulb, pls loosen the bolts (A1), remove the glass covering (D), then take out the glass rod (B), replce the lightbulb.**

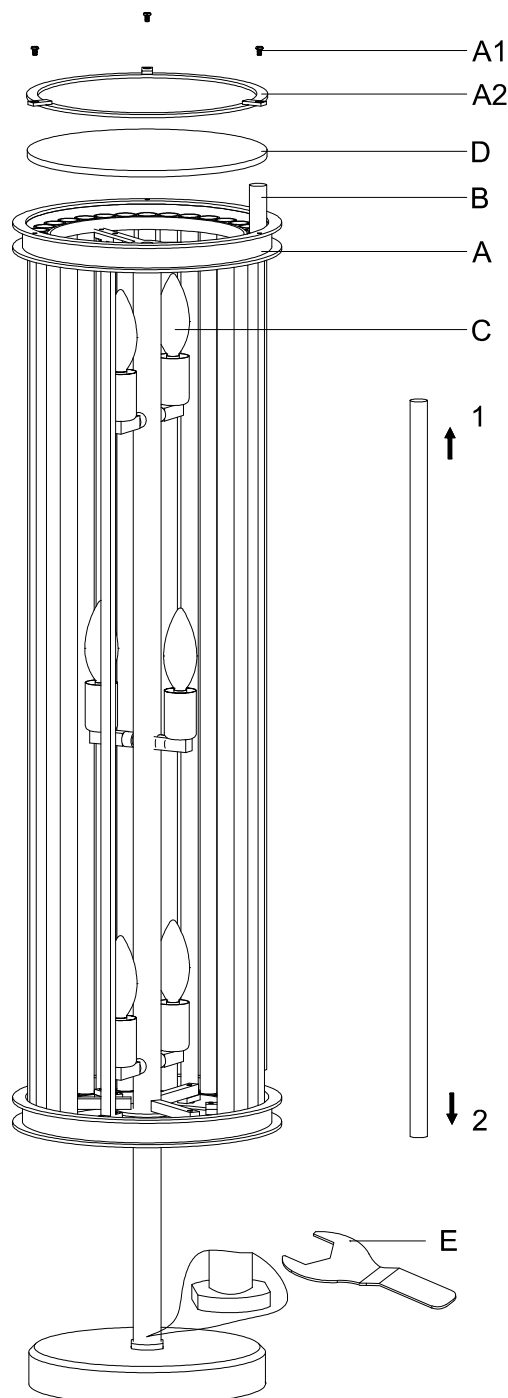

CARE INSTRUCTIONS:

1. Make sure that the power is turned off and bulb has cooled before handling.
2. Wipe clean with a dry cloth / mild soapy solution. Do not use corrosive cleaners.
3. The cable/cord of this floor lamp cannot be replaced: If the cable is damaged, do not use the lamp.

ENVIRONMENT:

Special waste handling may be required. Please contact your local authorities for more information.