

BURIED ROART™ DISTRIBUTION PEDESTALS

# BD4-1032

BD4-1032 is designed for use as an above ground housing for splice case pairs for Telecommunication and CATV Lines

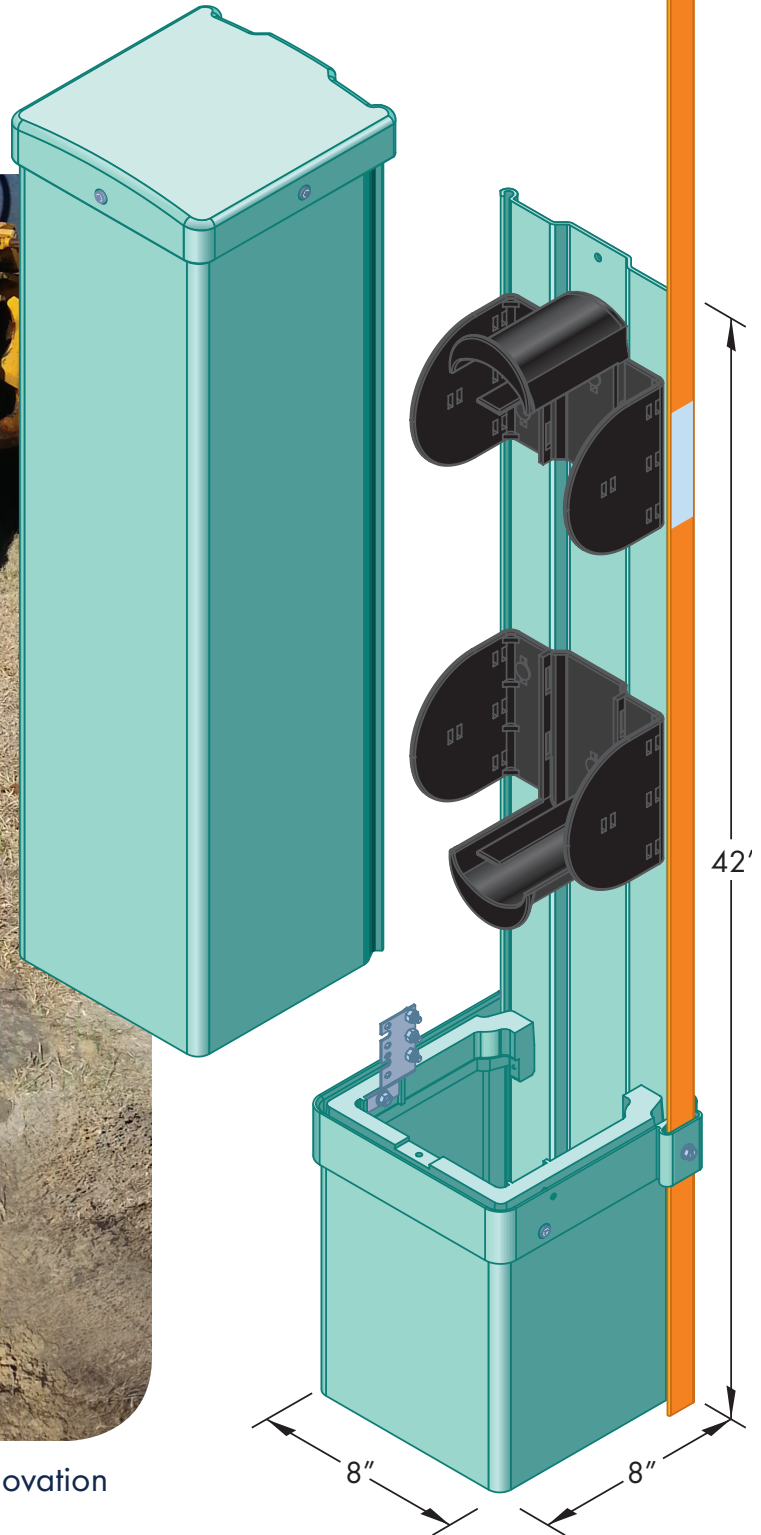
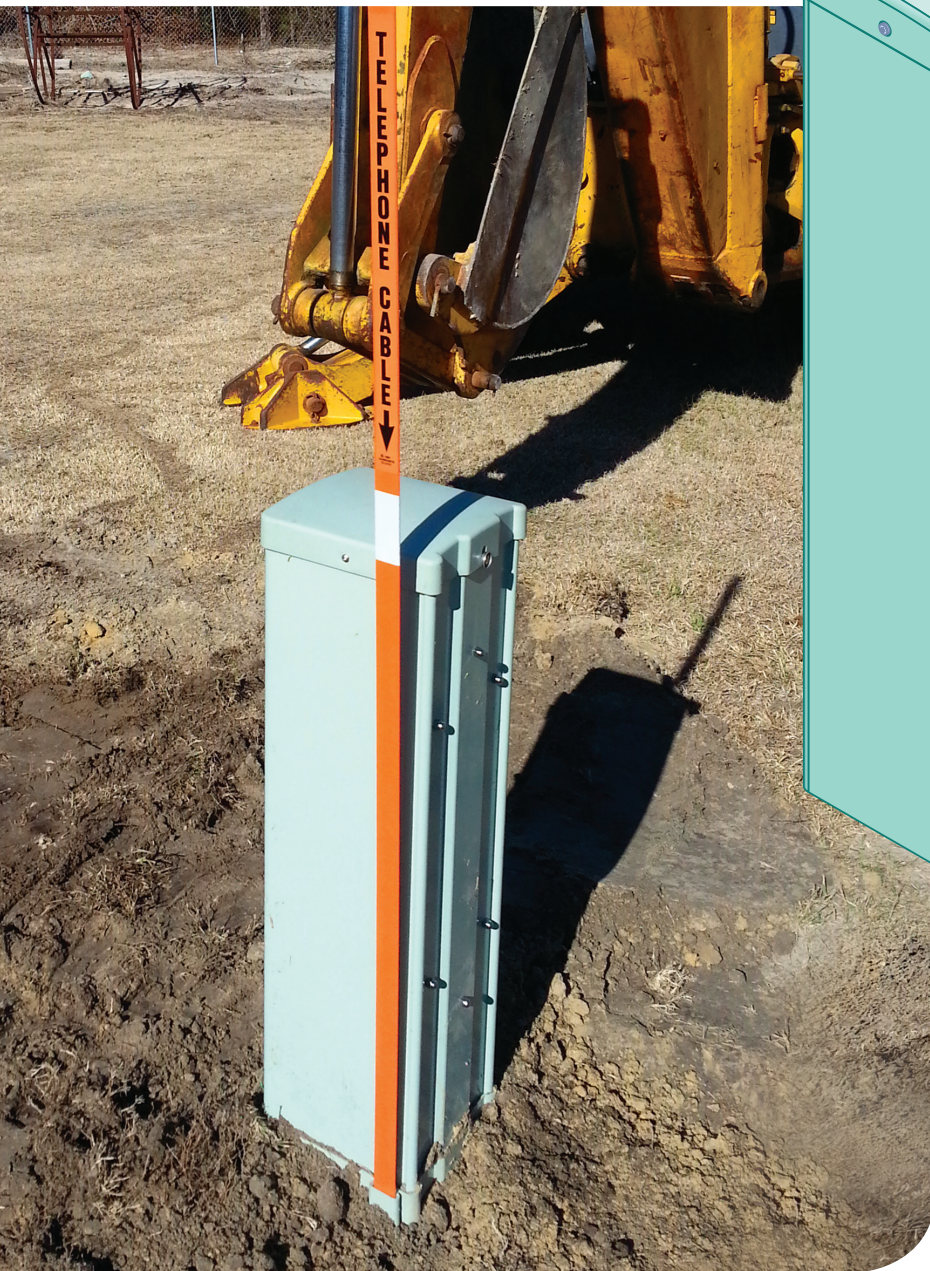

Your Best Source for Quality, Durability, and Innovation

# SPECIFICATIONS

## CARSONITE ROART™ PEDESTALS (BD4)

### ► SCOPE

This specification covers the minimum performance and material specifications for Carsonite Roart™ Pedestals (BD4). This product is designed for use as an above ground housing for splice case pairs for Telecommunication and CATV lines.

### ► GENERAL

#### • MATERIAL

Carsonite's BD4 Pedestals are constructed from a fiberglass reinforced composite material. The material is nonconductive and non-corrosive. The material is resistant to extreme changes in temperature and serviceable within a temperature range of -40 to +180°F.

#### • DESIGN

Carsonite's BD4 Pedestals are available in type H design. Type H enclosures are constructed with a unique interlocking design that reduces intrusion of dirt, insects, and moisture. This design is available with a locking bolt to prevent tampering.

#### • DIMENSIONS

Carsonite's BD4 Pedestal has nominal dimensions of 8" wide x 8" deep x 42" high.

#### • FLAME RESISTANCE

The structural reinforced composite shell has a maximum flame spread index of 25 when tested in accordance with ASTM E84.

### ► COLOR

Carsonite's Roart Pedestal approximates Federal Standard 595B 24410.

### ► WORKMANSHIP

Carsonite's BD4 Pedestals exhibit good workmanship and are free of burns, discolorations, cracks or other objectionable marks that would adversely affect the unit's performance or serviceability.

### ► PHYSICAL AND MECHANICAL PROPERTIES

The properties of the Carsonite BD4 Pedestals are listed below.

#### PROPERTIES OF COMPOSITE SHELL

PROPERTY	ASTM TEST METHOD	MINIMUM VALUE
Flexural Modulus	D-790	1,600,000 psi
Flexural Strength	D-790	57,000 psi
Tensile Strength	D-638	60,000 psi
Tensile Modulus	D-638	3,500,000 psi
Elongation %	D-638	1.9
Compressive Strength	D-695	65,000 psi

# FEATURES

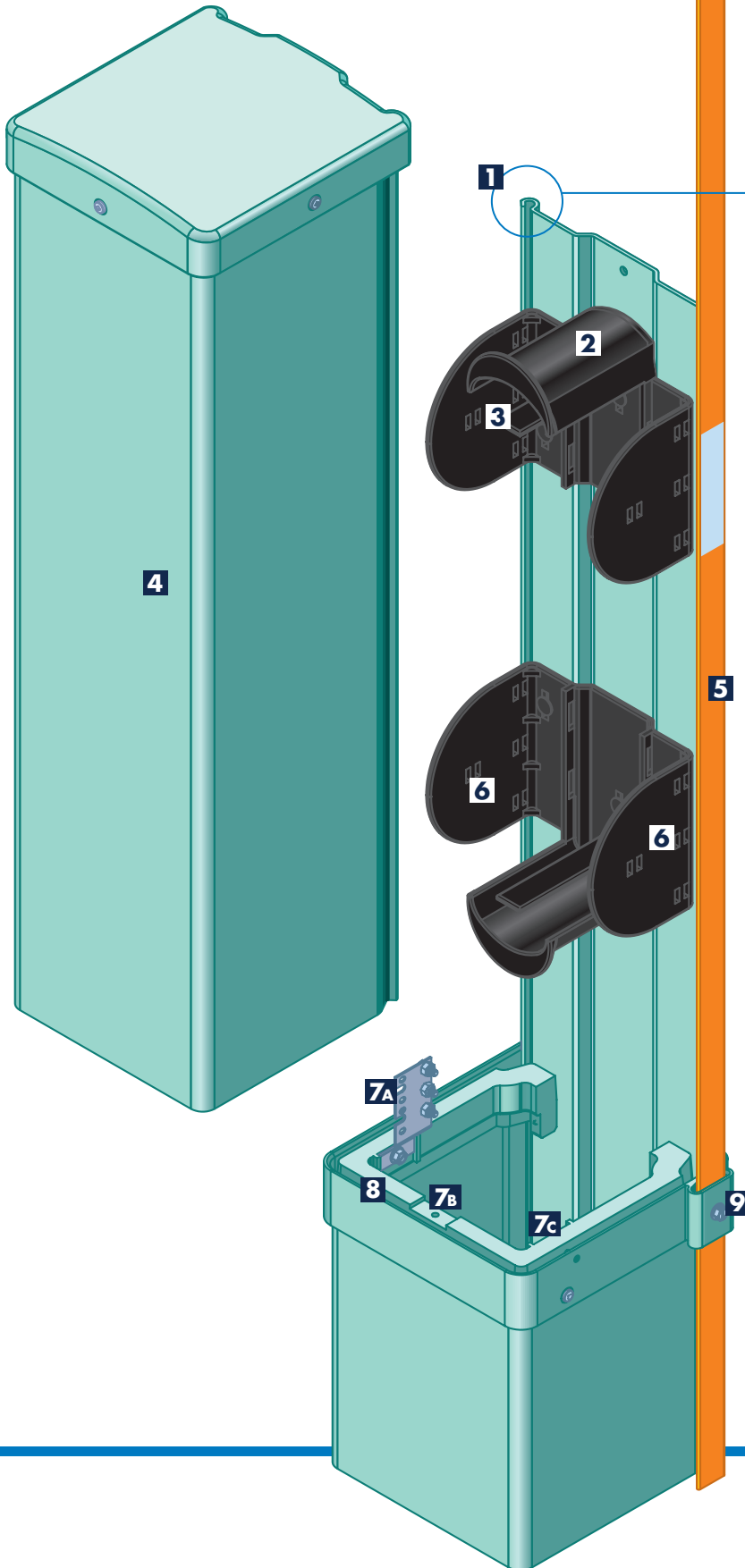

## WEATHERABILITY

Our BD4 Pedestal is pigmented throughout the entire structure. This produces a uniform color which is integral to the material. UV resistant materials are incorporated in the construction to inhibit fading and cracking. The BD4 is painted with a UV resistant coating.

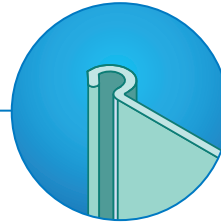

### 1 INTERLOCKING DESIGN

Prevents dust, dirt, rain and insects from intruding.

### 2 LARGE LOOP SUPPORTS

Ideal for 144 Cable with space to wrap 40 feet of tubes.

### 3 SPLICE TRAY SUPPORTS

Built in support ledges provide ample space to install multiple splice trays.

### 4 FIBERGLASS COMPOSITE SHELL

Material is non conductive and will not rot, rust, or corrode. Material is flame retardant and will not support a flame.

### 5 OPTIONAL PEDESTAL MARKER

Carsonite has variety of appropriate markers to choose from depending on your specific application.

### 6 MULTIPLE ZIP TIE LOCATIONS

To help keep tubes neat and manageable.

### 7 BONDING BRACKET

Bonding bracket capable of mounting in three locations (A, B or C).

### 8 RECESSED NESTING GROOVE

Slide tracks and recessed nesting prevents partial closure of pedestal.

### 9 INTEGRAL MOUNTING BRACKET

Is used for mounting optional pedestal markers (markers not included).

# BD4-1032

## BURIED ROART™ DISTRIBUTION PEDESTALS

### HOW TO ORDER:

<b>BD4-</b>	<b>1032</b>
Product number	Height (in.)

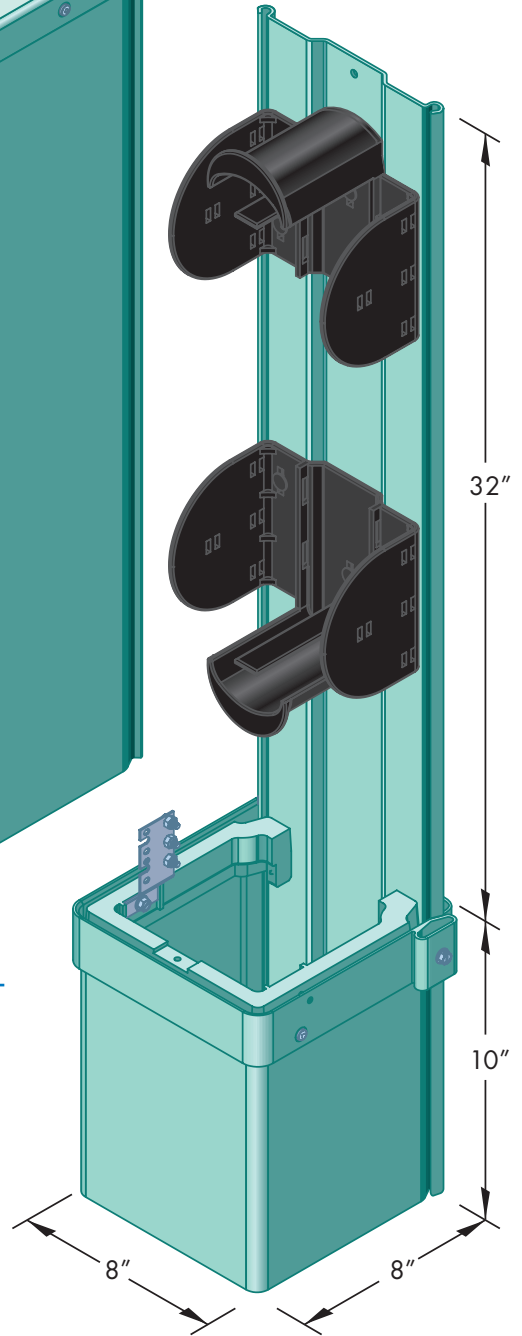
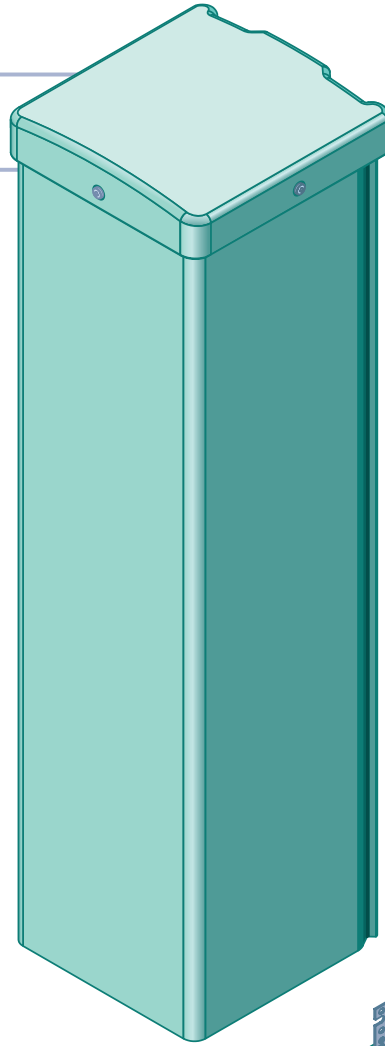
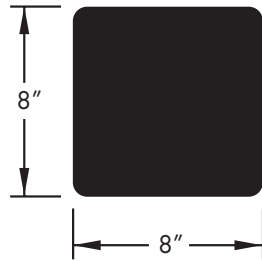
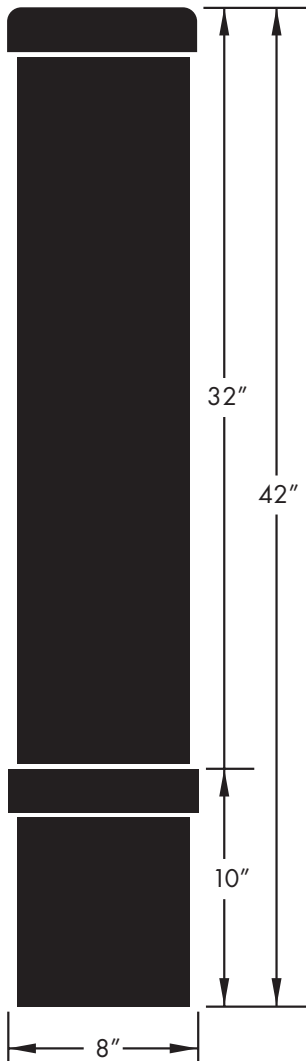

Pedestal comes with 36" mounting stake.  
Pedestal marker not included.

**Material:** Fiberglass Composite  
**Options:** Pedestal markers, call for details