



Refrigerator

User manual

Free Standing Appliance

SAMSUNG



Contents

| | |
|---|-----------|
| Safety information | 3 |
| Important safety symbols and precautions | 6 |
| Severe warning signs for transportation and site | 7 |
| Critical installation warnings | 7 |
| Installation cautions | 11 |
| Critical usage warnings | 12 |
| Usage cautions | 17 |
| Cleaning cautions | 19 |
| Critical disposal warnings | 21 |
| Additional tips for proper usage | 22 |
| Saving Energy Tips | 24 |
| This appliance is intended to be used in household and similar applications such as | 25 |
| Instructions about the WEEE | 25 |
| Installation | 26 |
| Refrigerator at a glance | 26 |
| Step-by-step installation | 28 |
| Operations | 33 |
| Main panel | 33 |
| SmartThings (applicable models only) | 37 |
| Special features | 40 |
| Maintenance | 45 |
| Handle and care | 45 |
| Cleaning | 47 |
| Replacement | 48 |
| Troubleshooting | 49 |
| General | 49 |
| Do you hear abnormal sounds from the refrigerator? | 51 |
| SmartThings (applicable models only) | 53 |
| Open Source Announcement | 54 |



Safety information

- Before using your new Samsung Refrigerator, please read this manual thoroughly to ensure that you know how to operate the features and functions that your new appliance offers safely and efficiently.
- This appliance is not intended for use by persons (including children) with reduced physical, sensory, or mental capabilities, or those who lack experience and knowledge, unless they have been given supervision or instruction concerning the use of the appliance by a person responsible for their safety.
- This appliance can be used by children aged from 8 years and above and persons with reduced physical, sensory or mental capabilities or lack of experience and knowledge if they have been given supervision or instruction concerning use of the appliance in a safe way and understand the hazards involved.
Children shall not play with the appliance. Cleaning and user maintenance shall not be made by children without supervision.
- Warnings and Important Safety Instructions in this manual do not cover all possible conditions and situations that may occur.
It is your responsibility to use common sense, caution, and care when installing, maintaining, and operating your appliance.

Safety information

- Because these following operating instructions cover various models, the characteristics of your refrigerator may differ slightly from those described in this manual and not all warning signs may be applicable. If you have any questions or concerns, contact your nearest service center or find help and information online at www.samsung.com.
- R-600a or R-134a is used as a refrigerant. Check the compressor label on the rear of the appliance or the rating label inside the fridge to see which refrigerant is used for your refrigerator. When this product contains flammable gas (Refrigerant R-600a), contact your local authority in regard to safe disposal of this product.
- In order to avoid the creation of a flammable gas-air mixture if a leak in the refrigerating circuit occurs, the size of the room in which the appliance may be sited depends on the amount of refrigerant used.
- Never start up an appliance showing any signs of damage. If in doubt, consult your dealer. The room must be 1 m³ in size for every 8 g of R-600a refrigerant inside the appliance. The amount of refrigerant in your particular appliance is shown on the identification plate inside the appliance.
- Refrigerant squirting out of the pipes could ignite or cause an eye injury. When refrigerant leaks from the pipe, avoid any naked flames and move anything flammable away from the product and ventilate the room immediately.
 - Failing to do so may result in fire or explosion.
- It is hazardous for anyone other than an Authorized Service Person to service this appliance.

- Do not store explosive substances such as aerosol cans with a flammable propellant in this appliance.
- To avoid contamination of food, please respect the following instructions:
 - Opening the door for long periods can cause a significant increase of the temperature in the compartments of the appliance.
 - Clean regularly surfaces that can come in contact with food and accessible drainage systems.
 - Clean water tanks if they have not been used for 48 h; flush the water system connected to a water supply if water has not been drawn for 5 days.
 - Store raw meat and fish in suitable containers in the refrigerator, so that it is not in contact with or drip onto other food.
 - Two-star frozen-food compartments are suitable for storing pre-frozen food, storing or making icecream and making ice cubes.
 - One-, two- and three-star compartments are not suitable for the freezing of fresh food.
 - If the refrigerating appliance is left empty for long periods, switch off, defrost, clean, dry, and leave the door open to prevent mould developing within the appliance.



WARNING; Risk of fire / flammable materials



Safety information

Important safety symbols and precautions

Please follow all safety instructions in this manual. This manual uses the following safety symbols.

WARNING

Hazards or unsafe practices that may result in **severe personal injury, property damage, and/or death.**

CAUTION

Hazards or unsafe practices that may result in **severe personal injury and/or property damage.**

NOTE

Useful information that helps users understand or benefit from the refrigerator.

These warning signs are here to prevent injury to you and others.

Please follow them carefully.

After reading this section, keep it in a safe place for future reference.



Severe warning signs for transportation and site

WARNING

- When transporting and installing the appliance, care should be taken to ensure that no parts of the refrigerating circuit are damaged.
 - Refrigerant leaking from the pipe work could ignite or cause an eye injury. If a leak is detected, avoid any naked flames or potential sources of ignition and air the room in which the appliance is standing for several minutes.
 - This appliance contains a small amount of isobutane refrigerant (R-600a), a natural gas with high environmental compatibility that is, however, also combustible. When transporting and installing the appliance, care should be taken to ensure that no parts of the refrigerating circuit are damaged.

Critical installation warnings

WARNING

- Do not install the refrigerator in a damp location or place where it may come in contact with water.
 - Deteriorated insulation on electrical parts may cause an electric shock or fire.
- Do not place this refrigerator in direct sunlight or expose it to the heat from stoves, room heaters, or other appliances.

Safety information

- Do not plug several appliances into the same multiple power strip. The refrigerator should always be plugged into its own individual electrical outlet which has a voltage rating that matches the voltage listed on the refrigerator's rating plate.
 - This provides the best performance and also prevents overloading of house wiring circuits, which could cause a fire hazard from overheated wires.
- If the wall socket is loose, do not insert the power plug.
 - There is a risk of electric shock or fire.
- Do not use a power cord that has cracks or abrasion damage along its length or at either end.
- Do not bend the power cord excessively or place heavy objects on it.
- Do not pull or excessively bend the power cord.
- Do not twist or tie the power cord.
- Do not hook the power cord over a metal object, place a heavy object on the power cord, insert the power cord between objects, or push the power cord into the space behind the appliance.
- When moving the refrigerator, be careful not to roll over or damage the power cord.
 - This may result in an electric shock or fire.
- Never unplug your refrigerator by pulling on the power cord. Always grip the plug firmly and pull straight out from the outlet.
 - Damage to the cord may cause a short-circuit, fire, and/or electric shock.
- Do not store explosive substances such as aerosol cans with a flammable propellant in this appliance.

-
- Do not install this appliance near a heater or inflammable material.
 - Do not install this appliance in a location where gas may leak.
 - This may result in an electric shock or fire.
 - This refrigerator must be properly located and installed in accordance with the instructions in this manual before you use it.
 - Connect the power plug in the proper position with the cord hanging down.
 - If you connect the power plug upside down, the wire can get cut off and cause a fire or electric shock.
 - Make sure that the power plug is not crushed or damaged by the back of the refrigerator.
 - Keep the packing materials out of reach of children.
 - There is a risk of death from suffocation if a child puts the packing materials on his or her head.
 - The appliance must be positioned so that the plug is accessible after installation.
 - Failing to do so may result in an electric shock or fire due to electric leakage.
 - Do not install this appliance in a humid, oily or dusty location, in a location exposed to direct sunlight and water (rain drops).
 - Deteriorated insulation of electrical parts may cause an electric shock or fire.
 - If any dust or water is in the refrigerator, pull out power plug and contact your Samsung Electronics service center.
 - Otherwise there is a risk of fire.

Safety information

- Do not stand on top of the appliance or place objects (such as laundry, lighted candles, lighted cigarettes, dishes, chemicals, metal objects, etc.) on the appliance.
 - This may result in an electric shock, fire, problems with the product, or injury.
- You need to remove all the protective plastic film before you initially plug the product in.
- Children should be supervised to ensure that they do not play with the snap rings used for door adjustment or the water tube clips.
 - There is risk of death by suffocation if a child swallows a snap ring or water tube clip. Keep the snap rings and water tube clips out of children's reach.
- The refrigerator must be safely grounded.
 - Always make sure that you have grounded the refrigerator before attempting to investigate or repair any part of the appliance. Power leakages can cause severe electric shock.
- Never use gas pipes, telephone lines, or other potential lightning attractors as an electrical ground.
 - You must ground the refrigerator to prevent any power leakages or electric shocks caused by current leakage from the refrigerator.
 - This may result in an electric shock, fire, explosion, or problems with the product.
- Plug the power plug into the wall socket firmly. Do not use a damaged power plug, damaged power cord, or loose wall socket.
 - This may result in an electric shock or fire.

- If the power cord is damaged, have it replaced immediately by the manufacturer or one of its service agents.
- The fuse on the refrigerator must be changed by a qualified technician or service company.
 - Failing to do so may result in an electric shock or personal injury.
- When positioning the appliance, ensure the supply cord is not trapped or damaged.
- Do not locate multiple portable socket-outlets or portable power supplies at the rear of the appliance.

Installation cautions

CAUTION

- Allow sufficient space around the refrigerator and install it on a flat surface.
 - Keep the ventilation space in the appliance enclosure or mounting structure clear of obstructions.
- Allow the appliance to stand for 2 hours before loading foods after installation and turning on.
- We strongly recommend you have a qualified technician or service company install the refrigerator.
 - Failing to do so may result in an electric shock, fire, explosion, problems with the product, or injury.
- Overload on any one door may fell the refrigerator, causing physical injury.

Safety information

Critical usage warnings

WARNING

- Do not insert the power plug into a wall socket with wet hands.
 - This may result in an electric shock.
- Do not store articles on the top of the appliance.
 - When you open or close the door, the articles may fall and cause personal injury and/or material damage.
- Do not insert hands, feet or metal objects (such as chopsticks, etc.) into the bottom or the back of the refrigerator.
 - This may result in an electric shock or injury.
 - Any sharp edges may cause a personal injury.
- Do not touch the inside walls of the freezer or products stored in the freezer with wet hands.
 - This may cause frostbite.
- Do not put a container filled with water on the refrigerator.
 - If spilled, there is a risk of fire or electric shock.
- Do not keep volatile or flammable objects or substances (benzene, thinner, propane gas, alcohol, ether, LP gas, and other such products) in the refrigerator.
 - This refrigerator is for storing food only.
 - This may result in fire or explosion.
- Children should be supervised to ensure that they do not play with the appliance.
 - Keep fingers out of “pinch point” areas. Clearances between the doors and cabinet are necessarily small. Be careful when you open the doors if children are in the area.

-
- Do not let children hang on the door or door bins. A serious injury may occur.
 - Do not let children go inside the refrigerator. They could become trapped.
 - Do not insert your hands into the bottom area under the appliance.
 - Any sharp edges may cause personal injury.
 - Do not store pharmaceutical products, scientific materials, or temperature sensitive products in the refrigerator.
 - Products that require strict temperature controls must not be stored in the refrigerator.
 - Do not place or use electrical appliance inside the refrigerator/freezer, unless they are of a type recommended by the manufacturer.
 - If you smell pharmaceutical or smoke, pull out power plug immediately and contact your Samsung Electronics service center.
 - If any dust or water is in Refrigerator, pull out power plug and contact your Samsung Electronics service center.
 - Otherwise there is a risk of fire.
 - Do not let children step on a drawer.
 - The drawer may break and cause them to slip.
 - Do not leave the doors of the refrigerator open while the refrigerator is unattended and do not let children enter inside the refrigerator.
 - Do not allow babies or children go inside the drawer.
 - It can cause death from suffocation by entrapment or personal injury.

Safety information

- Do not overfill the refrigerator with food.
 - When you open the door, an item may fall out and cause personal injury or material damage.
- Do not spray volatile material such as insecticide onto the surface of the appliance.
 - As well as being harmful to humans, it may also result in an electric shock, fire, or problems with the product.
- Do not use or place any substances sensitive to temperature such as flammable sprays, flammable objects, dry ice, medicine, or chemicals near or inside of the refrigerator.
- Do not use a hair dryer to dry the inside of the refrigerator. Do not place a lighted candle in the refrigerator for removing bad odours.
 - This may result in an electric shock or fire.
- Do not stand on top of the appliance or place objects (such as laundry, lighted candles, lighted cigarettes, dishes, chemicals, metal objects, etc.) on the appliance. This may result in an electric shock, fire, problems with the product, or injury. Do not put a container filled with water on the appliance.
 - If spilled, there is a risk of fire or electric shock.
- Do not use mechanical devices or any other means to accelerate the defrosting process, other than those recommended by the manufacturer.
- Do not damage the refrigerant circuit.
- Never stare directly at the UV LED lamp for long periods of time.
 - This may result in eye strain due to the ultraviolet rays.

-
- Do not put fridge shelf in upside down. Shelf stopper could not work.
 - It may cause a personal injury because of glass shelf drop.
 - If a gas leak is detected, avoid any naked flames or potential sources of ignition, and air the room in which the appliance is standing for several minutes.
 - Do not touch the appliance or power cord.
 - Do not use a ventilating fan.
 - A spark may result in explosion or fire.
 - Use only the LED Lamps provided by the manufacturer or its service agents.
 - Bottles should be stored tightly together so that they do not fall out.
 - This product is intended only for the storage of food in a domestic environment.
 - Do not attempt to repair, disassemble, or modify the refrigerator yourself.
 - Unauthorized modifications can cause safety problems.
To reverse an unauthorized modification, we will charge the full cost of parts and labor.
 - Do not use any fuse (such as cooper, steel wire, etc.) other than a standard fuse.
 - If your refrigerator needs to be repaired or reinstalled, contact your nearest service center.
 - Failing to do so may result in an electric shock, fire, problems with the product, or injury.
 - If the interior or exterior LED lamp has gone out, contact your nearest service center.

Safety information

- If the refrigerator emits a burning smell or smoke, unplug the refrigerator immediately and contact your Samsung Electronics service center.
 - Failing to do so may result in an electric or fire hazards.
- Pull the power plug out of the socket before changing the interior lamps of the refrigerator.
 - Otherwise, there is a risk of electric shock.
- If you experience difficulty changing a non-LED light, contact a Samsung service center.
- If the product is equipped with LED lamps, do not disassemble the Lamp Covers and LED lamps yourself.
 - Contact a Samsung service center.
- Plug the power plug into the wall socket firmly.
- Do not use a damaged power plug, damaged power cord or loose wall socket.
 - This may result in an electric shock or fire.

Usage cautions

CAUTION

- Do not re-freeze frozen foods that have thawed completely. Do not place carbonated or fizzy drinks in the freezer compartment. Do not put bottles or glass containers in the freezer.
 - When the contents freeze, the glass may break and cause personal injury.
- To get the best performance from the product:
 - Do not place food too close to the vents at the rear of the refrigerator as this can obstruct free air circulation in the refrigerator compartment.
 - Wrap food up properly or place it in airtight containers before putting it into the refrigerator.
 - Please observe maximum storage times and expiration dates of frozen goods.
- Do not place glass or bottles or carbonated beverages into the freezer.
 - The container may freeze and break, and this may result in injury.
- Do not place carbonated or fizzy drinks in the freezer compartment. Do not put bottles or glass containers in the freezer.
 - When the contents freeze, the glass may break and cause personal injury and property damage.

Safety information

- Service Warranty and Modification.
 - Any changes or modifications performed by a 3rd party on this finished appliance are not covered under Samsung warranty service, nor is Samsung responsible for safety issues that result from 3rd party modifications.
- Do not block the air vents inside the refrigerator.
 - If the air vents are blocked, especially with a plastic bag, the refrigerator can be over cooled. If a cooling period lasts too long, the water filter may break and cause water leakage.
- Wipe excess moisture from the inside and leave the doors open.
 - Otherwise, odor and mold may develop.
- If the refrigerator is disconnected from the power supply, you should wait for at least five minutes before plugging it back in.
- When the refrigerator got wet by water, pull out the power plug and contact your Samsung Electronics service center.
- Do not strike or apply excessive force to any glass surface.
 - Broken glass may result in a personal injury and/or property damage.
- Be careful that your fingers are not caught in.
- The lamps in the freezer and refrigerator can be turned off if the doors of the freezer and refrigerator are left open for 2 seconds or longer.
 - The lamps will turn back on when the doors are closed and opened again.

- If the refrigerator is flooded, make sure to contact your nearest service center.
 - There is a risk of electric shock or fire.
- Do not keep vegetable oil in your refrigerator's door bins. The oil can solidify, making it foul-tasting and difficult to use. In addition, the open container can leak and the leaked oil can cause the door bin to crack. After opening an oil container, it is best to keep the container in a cool and shaded place such as a cupboard or pantry.
 - Examples of vegetable oil: olive oil, corn oil, grape-seed oil, etc.

Cleaning cautions

CAUTION

- Do not spray water directly on the inside or outside the refrigerator.
 - There is a risk of fire or electric shock.
- Do not use a hair dryer to dry the inside of the refrigerator.
- Do not place a lighted candle in the refrigerator to remove bad odors.
 - This may result in an electric shock or fire.
- Do not spray cleaning products directly on the display.
 - Printed letters on the display may come off.
- If any foreign substance such as water has entered the appliance, unplug the power plug and contact your nearest service center.
 - Failing to do so may result in an electric shock or fire.

Safety information

- Use a clean, dry cloth to remove any foreign matter or dust from the power plug blades. Do not use a wet or damp cloth when cleaning the plug.
 - Otherwise, there is a risk of fire or electric shock.
- Do not clean the appliance by spraying water directly onto it.
- Do not use benzene, thinner, or Clorox, Chloride for cleaning.
 - They may damage the surface of the appliance and may cause a fire.
- Before cleaning or performing maintenance, unplug the appliance from the wall socket.
 - Failing to do so may result in an electric shock or fire.
- Use a clean sponge or soft cloth and a mild detergent in warm water to clean the refrigerator.
- Do not use abrasive or harsh cleansers such as window sprays, scouring cleansers, flammable fluids, muriatic acid, cleaning waxes, concentrated detergents, bleaches, or cleansers containing petroleum products on exterior surfaces (doors and cabinet), plastic parts, door and interior liners, and gaskets.
 - These can scratch or damage the material.
- Do not clean glass shelves or covers with warm water when they are cold. Glass shelves and covers may break if exposed to sudden temperature changes or impacts such as bumping or dropping.

Critical disposal warnings

WARNING

- Please dispose of the packaging material from this product in an environmentally friendly manner.
- Ensure that none of the pipes on the back of the refrigerator are damaged prior to disposal.
- R-600a or R-134a is used as a refrigerant. Check the compressor label on the rear of the appliance or the rating label inside the fridge to see which refrigerant is used for your refrigerator. If this refrigerator contains flammable gas (Refrigerant R-600a), contact your local authority in regard to safe disposal of this product.
- When disposing of this refrigerator, remove the door/door seals and door latch so that small children or animals cannot become trapped inside. Children should be supervised to ensure that they do not play with the appliance. If trapped inside, a child may get hurt or suffocate to death.
- Cyclopentane is used in the insulation. The gases in the insulation material require a special disposal procedure. Please contact your local authorities in regard to the environmentally safe disposal of this product.
- Keep all packaging materials well out of the reach of children, as packaging materials can be dangerous to children.
 - If a child places a bag over his or her head, the child could suffocate.

Safety information

- DANGER: Risk of child entrapment. Before you throw away your old refrigerator or freezer:
 - Take off the doors.
 - Leave the shelves in place so that children may not easily climb inside.

Additional tips for proper usage

- In the event of a power failure, call the local office of your electric company and ask how long the failure is going to last.
 - Most power failures that are corrected in an hour or two will not affect your refrigerator temperatures. However, you should minimize the number of door openings while the power is off.
 - Should the power failure last more than 24 hours, remove and discard all frozen food.
- The refrigerator might not operate consistently (frozen contents can thaw or temperatures can become too warm in the frozen food compartment) if sited for an extended period of time in a location where ambient air temperatures are constantly below the temperatures for which the appliance is designed.
- In case of particular foods, keeping it under refrigeration can have a bad effect on preservation due to its properties.
- Your appliance is frost free, which means there is no need to manually defrost your appliance. This will be carried out automatically.

-
- Temperature rise during defrosting complies with ISO requirements. If you want to prevent an undue rise in the temperature of frozen food while the appliance defrosts, wrap the frozen food in several layers of newspaper.
 - Do not re-freeze frozen foods that have thawed completely.
 - The temperature of two star section (sections) or compartment (compartments) which have two star symbol (**) is slightly higher than other freezer compartment (compartments).
The two star section (sections) or compartment (compartments) is (are) based on the instruction and/or the condition as delivered.

Safety information

Saving Energy Tips

- Install the appliance in a cool, dry room with adequate ventilation. Ensure that it is not exposed to direct sunlight and never put it near a direct source of heat (a radiator, for example).
- Not to block any vents and grilles is recommended for energy efficiency.
- Allow warm food to cool down before placing it in the appliance.
- Put frozen food in the refrigerator to thaw. You can then use the low temperatures of the frozen products to cool food in the refrigerator.
- Do not keep the door of the refrigerator open for too long when putting food in or taking food out. The shorter the time the door is open, the less frost build-up you'll have in the freezer.
- It is recommended to install the refrigerator with clearance to the back and sides. This will help reduce power consumption and keep your energy bills lower.
- For the most efficient use of energy, please keep the all inner fittings such as baskets, drawers, shelves on the position supplied by manufacturer.

This appliance is intended to be used in household and similar applications such as

- staff kitchen areas in shops, offices and other working environments;
- farm houses and by clients in hotels, motels and other residential type environments;
- bed and breakfast type environments;
- catering and similar non-retail applications.

Instructions about the WEEE



Correct Disposal of This Product (Waste Electrical & Electronic Equipment) (Applicable in countries with separate collection systems)

This marking on the product, accessories or literature indicates that the product and its electronic accessories (e.g. charger, headset, USB cable) should not be disposed of with other household waste at the end of their working life. To prevent possible harm to the environment or human health from uncontrolled waste disposal, please separate these items from other types of waste and recycle them responsibly to promote the sustainable reuse of material resources.

Household users should contact either the retailer where they purchased this product, or their local government office, for details of where and how they can take these items for environmentally safe recycling.

Business users should contact their supplier and check the terms and conditions of the purchase contract. This product and its electronic accessories should not be mixed with other commercial wastes for disposal.

For information on Samsung's environmental commitments and product regulatory obligations, e.g. REACH, WEEE or Batteries, visit our sustainability page available via www.samsung.com

(For products sold in European countries and in the UK only)

Installation

Follow these instructions carefully to ensure a proper installation of this refrigerator and to prevent accidents before using it.

⚠ WARNING

- Use the refrigerator only for its intended purpose as described in this manual.
- Any servicing must be performed by a qualified technician.
- Dispose of the product packaging material in compliance with local regulations.

Refrigerator at a glance

📖 NOTE

The actual image and provided parts of the refrigerator may differ, depending on the model and the country.

Auto Ice Maker model

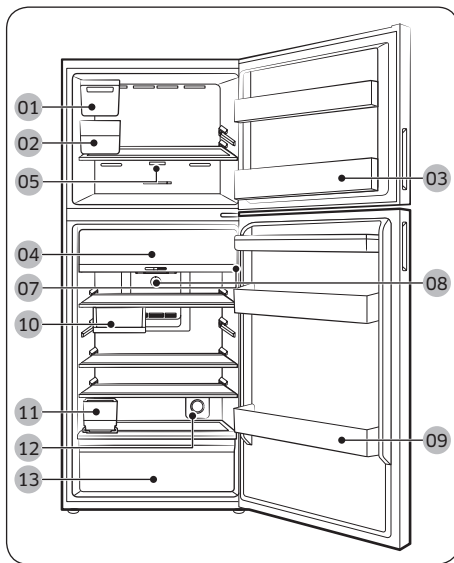

Dispenser model

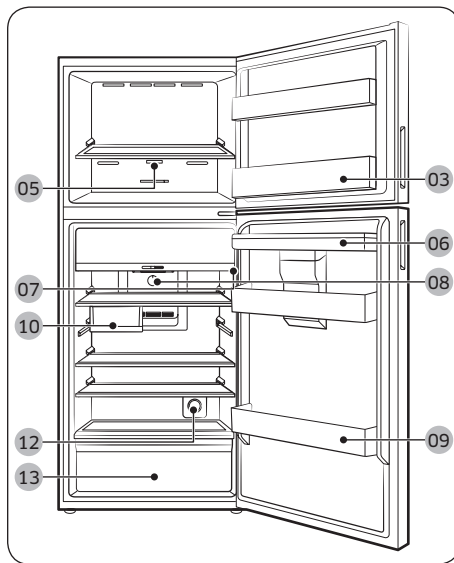



01 Auto Ice Maker ***

03 Freezer door bin

05 Main panel (Analogue - Freezer) *

07 Main panel (Digital - Fridge) *

09 Fridge door bin

11 Water tank for Auto Ice Maker ***

13 Vegetable drawer

02 Ice bucket ***

04 Optimal Fresh Zone *

06 Water tank for Dispenser **

08 Main panel (Analogue - Fridge) *

10 Multi Tray *

12 Active Fresh Filter *

* applicable models only

** Dispenser models only

*** Auto Ice Maker models only

To secure more room for storage in the freezer compartment

Remove one or more optional accessories such as shelf (or shelves), twist ice maker(s), ice storage bin(s), ice bucket(s) and their supports, all of which can be removed manually without a tool.

- These optional accessories do not affect thermal and mechanical performance.
- A declared storage volume of the freezer is based on the nonexistence of those optional accessories.
- For best energy efficiency, make sure all shelves and drawers are placed in their original position.

Load limit indicator (applicable models only)

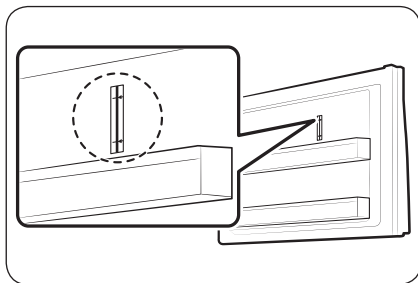

The refrigerator has a load limit indicator on the top right side of the freezer compartment.

⚠ CAUTION

- Do not put or keep food items over the load limit indicator. Otherwise, energy efficiency may be affected.



Installation

Step-by-step installation

STEP 1 Select a site

Site requirements:

- Solid, level surface without carpeting or flooring that may obstruct ventilation
- Away from direct sunlight
- Adequate room for opening and closing the door
- Away from a heat source
- Room for maintenance and servicing
- Temperature range: between 10 °C and 43 °C

Effective temperature range

The refrigerator is designed to operate normally in the temperature range specified by its class rating.

| Class | Symbol | Ambient Temperature range (°C) | |
|--------------------|--------|--------------------------------|------------|
| | | IEC 62552 (ISO 15502) | ISO 8561 |
| Extended Temperate | SN | +10 to +32 | +10 to +32 |
| Temperate | N | +16 to +32 | +16 to +32 |
| Subtropical | ST | +16 to +38 | +18 to +38 |
| Tropical | T | +16 to +43 | +18 to +43 |

NOTE

The cooling performance and power consumption of the refrigerator may be affected by the ambient temperature, the door-opening frequency, and the location of the refrigerator. We recommend adjusting the temperature settings as appropriate.

Clearance

See the pictures and table below for space requirements for installation.

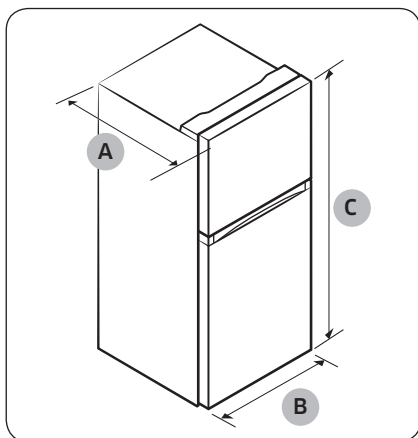

| Model | RT31 | RT35 | RT38 |
|------------|------|------|------|
| Depth "A" | 647 | 709 | 672 |
| Width "B" | 600 | 600 | 700 |
| Height "C" | 1715 | 1715 | 1715 |

(unit : mm)

| Model | RT42 | RT47 |
|------------|------|------|
| Depth "A" | 672 | 717 |
| Width "B" | 700 | 700 |
| Height "C" | 1785 | 1825 |

(unit : mm)

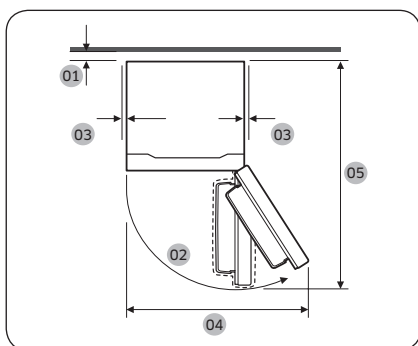

| | RT31 | RT35 | RT38 |
|----|--------------------------------|------|------|
| 01 | more than 50mm recommended | | |
| 02 | 115° (Freezer) / 115° (Fridge) | | |
| 03 | At least 50 mm | | |
| 04 | 850 | 850 | 1006 |
| 05 | 1201 | 1263 | 1311 |

(unit : mm)

| | RT42 | RT47 |
|----|--------------------------------|------|
| 01 | more than 50 mm recommended | |
| 02 | 115° (Freezer) / 115° (Fridge) | |
| 03 | At least 50 mm | |
| 04 | 1006 | 1006 |
| 05 | 1311 | 1356 |

(unit : mm)

Installation

STEP 2 Spacing (applicable models only)

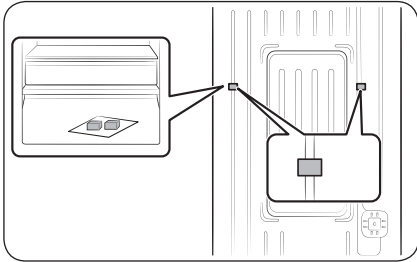

1. Open the door and locate the provided spacers (x2).
2. Unpack both spacers and attach them to the rear of the refrigerator as shown. They help ventilate air to the rear wall and save power consumption.

STEP 3 Flooring

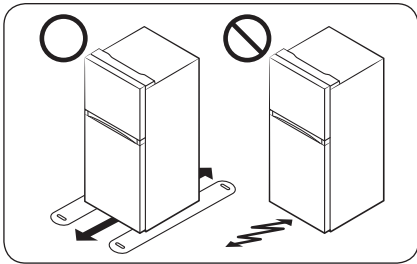

- The surface to install the refrigerator must support a fully loaded refrigerator or approximately 90 kg.
- To protect the floor, put a large piece of cardboard on each leg of the refrigerator.
- Once the refrigerator is in its final position, do not move it unless necessary to protect the floor. If you have to, use thick paper or cloth such as old carpets along the movement path.

STEP 4 Adjust the levelling feet

⚠ CAUTION

- When installed, the refrigerator must be levelled on a flat, solid floor. Not levelling the refrigerator can cause damage to the refrigerator or physical injury.
- Levelling must be performed with the refrigerator empty. Make sure no food items are inside the refrigerator.
- For safety reasons, adjust the front a little higher than the rear. Level the refrigerator using special screws (levellers) on the front legs. Use a flat-head screwdriver to turn the levellers.

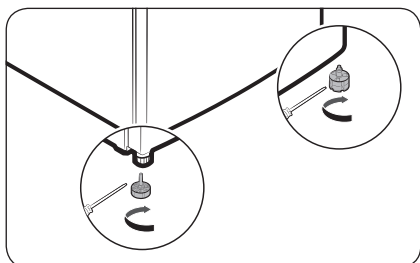

Level the refrigerator by manually adjusting the levelling feet. Turn the levelling feet clockwise to lower the position or turn anticlockwise to raise. For safety reasons, adjust the front side a little higher than the rear side.

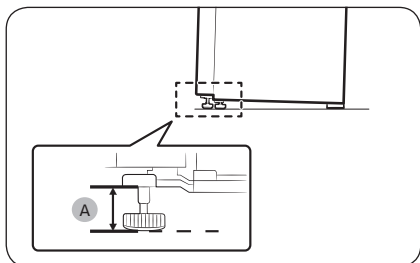

Leave the feet at 41 mm (A) from the floor as shown.

Installation

STEP 5 Initial settings

By completing the following steps, the refrigerator should be fully functioning.

1. Plug the power cord into the wall socket to turn the refrigerator on.
2. Open the door, and check if the interior light lights up.
3. Set the temperature to the coldest, and wait for about an hour. Then, the freezer will be slightly chilled, and the motor will run smoothly.
4. Wait until the refrigerator reaches the set temperature. Now the refrigerator is ready for use.

STEP 6 Final check

When the installation is complete, confirm that:

- The refrigerator is plugged into an electrical outlet and grounded properly.
- The refrigerator is installed on a flat, level surface with a reasonable clearance from the wall or the cabinet.
- The refrigerator is level and is sitting firmly on the floor.
- The door opens and closes freely, and the interior light turns on automatically when you open the door.

Operations

Main panel

Fridge - Digital

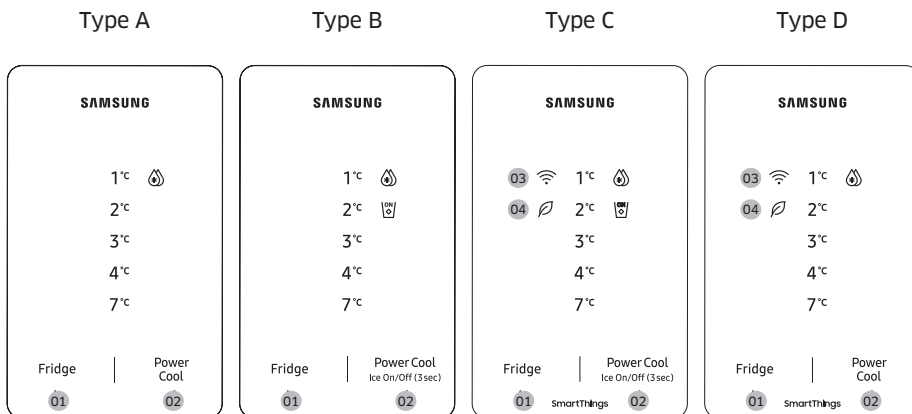

01 Fridge

02 Power Cool / Ice On/Off (3 sec) *

03 Network connection indicator *

04 AI Energy Mode *

* applicable models only

NOTE

The temperature in the refrigerator may rise if you open the door frequently or put a large amount of food into the refrigerator. If this happens, the all LED that display temperature blinks until the refrigerator returns to the specified temperature settings. If the blinking continues for an extended time, contact a local Samsung service center for technical assistance.



- While the temperature display is blinking, an alarm may occur. To stop the alarm, tap any button on the display.
- If you open the door while the temperature display is blinking, the internal light blinks for about a minute.

01 Fridge

| | |
|--------|--|
| Fridge | <p>Press Fridge to select the desired fridge temperature.</p> <p> CAUTION</p> <ul style="list-style-type: none"> • Do not set the fridge temperature to the lowest in winter and highest in summer. It may cause problems with the cooling performance. |
|--------|--|

Operations

02 Power Cool / Ice On/Off (3 sec)

| | |
|---------------------------------------|--|
| Power Cool | <p>Press Power Cool to activate or deactivate Power Cool.</p> <ul style="list-style-type: none">• Power Cool speeds up the cooling process at maximum fan speed. The fridge keeps running at full speed for several hours and then returns to the previous temperature.• When Power Cool activates, the Power Cool icon () turns on, and the refrigerator will speed up the cooling process for you.• To cool large amounts of food completely, activate Power Cool at least 24 hours in advance. <p>NOTE</p> <p>Using Power Cool increases power consumption. Make sure you turn it off and return to the previous temperature if you do not intend to use it.</p> |
| Ice On/Off (Type B, C only) | <p>Press and hold Power Cool for 3 seconds to turn the Auto Ice Maker on or off.</p> <ul style="list-style-type: none">• When the Auto Ice Maker is on, the ice maker icon () turns on. The Auto Ice Maker is set to on by default.• We recommend disabling the function in the following cases:<ul style="list-style-type: none">- The ice bucket is already full of ice.- You want to decrease power consumption. |

03 Network connection (applicable models only)

You can control and monitor your refrigerator on the SmartThings app. For more information, see the **SmartThings (applicable models only)** section.

NOTE



If the refrigerator is not connected to the SmartThings app, the Wi-Fi () icon blinks to alert you when opening the door. If you see the blinking Wi-Fi () icon, we recommend that you connect your refrigerator to the SmartThings app.

04 AI Energy Mode (applicable models only)

- The  icon appears when the AI Energy Mode is operating. You may turn on or off the AI Energy Mode in the SmartThings app. (applicable models only)

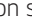
Turning the Wi-Fi on or off (applicable models only)

To turn the Wi-Fi on or off, press and hold **Fridge** for 10 seconds. The Wi-Fi () icon shows the status of the Wi-Fi as shown below.

- Wi-Fi Off: The Wi-Fi () icon blinks for 5 seconds and then turns off.
- Wi-Fi On: The Wi-Fi () icon blinks for 5 seconds and then turns on for 5 seconds.

NOTE

- You must turn on the Wi-Fi to connect the refrigerator to the SmartThings app.
- For more information, see the **SmartThings (applicable models only)** section.

Fridge - Analogue

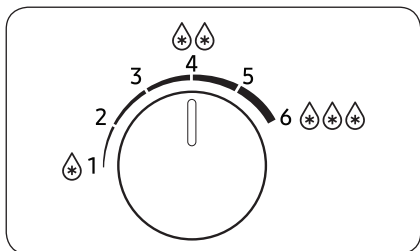

- Turn the dial left and right to set the desired temperature.
- Turn the dial left to raise, and turn it right to lower the temperature.

NOTE

To ensure optimal performance, we recommend setting the temperature to .

CAUTION

- Do not set the fridge temperature higher (1-2) when the room temperature is lower than 10 °C, and lower (4-6) when the temperature is higher than 35 °C. It may cause problems with the cooling performance.

Operations

Freezer - Analogue

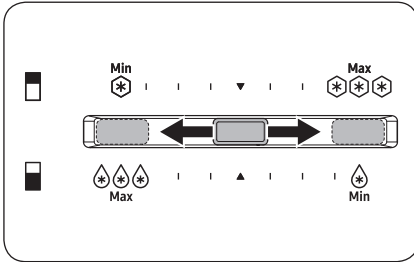

- To increase the temperature, slide the temperature control to the left.
- To decrease the temperature, slide the temperature control to the right. In winter, slide the temperature control to the right-most end.

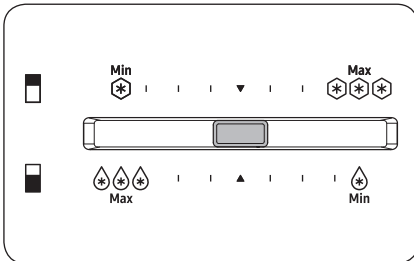

To make ice in summer (above 35 °C), set the freezer temperature to the centre.

NOTE

If the Auto Ice maker is not making enough ice, slide the temperature control to the right.

CAUTION

- To prevent system failure or food spoiling, do not set the temperature to the right-most end (maximum) in summer (above 35 °C).
- Do not store glass bottles containing liquid in the freezer. Glass bottles will crack or break into pieces when the liquid freezes.

SmartThings (applicable models only)

Installation

Visit the Google Play Store, Galaxy Apps, or Apple App Store and search for “SmartThings”. Download and install the SmartThings app provided by Samsung Electronics to your smart device.

NOTE

- The supporting software version of the SmartThings app is subject to change according to the OS supporting policy the manufacturer provides. In addition, as for the SmartThings app or the functions that the app supports, the new application update policy on the existing OS version can be suspended due to usability or security reasons.
- The SmartThings app is subject to change without notice to improve usability or performance. As the mobile phone OS version is updated every year, the SmartThings is also updated continually according to the latest OS. If you have enquiries regarding the items mentioned above, please contact us at st.service@samsung.com
- Recommended encryption systems include WPA/TKIP and WPA2/AES. Any newer or non-standard Wi-Fi authentication protocols are not supported.
- Wireless networks may be affected by the surrounding wireless communication environment.
- If your Internet service provider has registered the MAC address of your PC or modem for identification, your Samsung Smart Refrigerator may fail to connect to the Internet. If this happens, contact your Internet service provider for technical assistance.
- The firewall settings of your network system may prevent your Samsung Smart Refrigerator from accessing the Internet. Contact your Internet service provider for technical assistance. If this symptom continues, contact a local Samsung service centre or retailer.
- To configure the wireless access point (AP) settings, see the user manual of the AP Router.
- Samsung Smart Refrigerators support both Wi-Fi 2.4 GHz with IEEE 802.11 b/g/n and Soft-AP protocols. (IEEE 802.11 n is recommended.)
- Unauthorized Wi-Fi wireless routers may fail to connect to applicable Samsung Smart Refrigerators.

Operations

Samsung account

You are required to register your Samsung account to use the app. If you don't have a Samsung account, follow the app's on-screen instructions to create a free Samsung account.

Getting started

Turn on the device you want to connect, open the SmartThings app on your phone, and then follow the instructions below.

If a pop-up appears saying that a new device has been found, tap **ADD NOW**.

If a pop-up doesn't appear, tap the **+** button, and then select the device you want to connect from the list of available devices.

If your device isn't in the list of available devices, tap **Supported Devices**, select the device type (Refrigerator), and then select the specific device model.

Follow the instructions in the app to set up your device. Once setup is complete, your refrigerator will appear as a "card" on your **Devices** screen.

Refrigerator app

Integrated control

You can monitor and control your refrigerator at home and on the go.

- Tap the refrigerator icon on the SmartThings Dashboard or tap the Devices icon at the bottom of the Dashboard, and then tap the refrigerator "card" to open the Refrigerator page.
- Check the operation status or notifications related to your refrigerator, and then change options or settings if necessary.

NOTE

Some options or settings of the refrigerator may not be available for remote control.

| Category | Item | Description |
|---|--|--|
| Monitoring | Fridge temperature | Displays the current temperature setting of the fridge. |
| | Energy monitoring | Checks the accumulated power consumption of the refrigerator for the last 180 days. |
| Functions | Power Cool | You can turn Power Cool on or off, and check the current settings. |
| Alarms | Abnormally high temperature | This alarm is triggered when the fridge has abnormally high temperatures. |
| | Door opening | This alarm is triggered if the fridge or freezer door is open for more than 2 minutes. |
| AI Energy Mode (applicable models only) | <p>You can turn on or off the AI Energy Mode under the Energy menu in the SmartThings app.</p> <p>You can check the status of the AI Energy Mode on the SmartThings app.</p> <p>On some models, the  icon appears on the main panel to indicate that AI Energy Mode is operating. (applicable models only)</p> <p>Turning on the AI Energy Mode decreases energy consumption, but it may also reduce the cooling performance.</p> | |

Operations

Special features

The actual image and special functions of your refrigerator may differ, depending on the model and the country.

Ice making (applicable models only)

Twist ice maker (applicable models only)

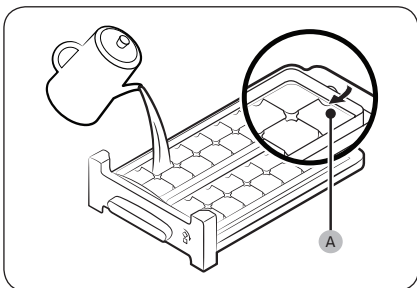

1. Open the freezer door, and slide open the ice tray.
2. Fill the tray with water up to the **maximum level (A)** marked on the inner rear of the tray.
3. Slide the tray back into position.

NOTE

The ice making time depends on your temperature settings.

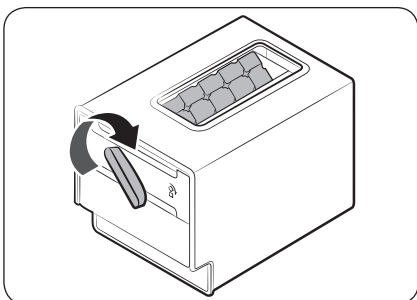

NOTE

- Make sure the ice cube storage bin is in place under the ice tray.
- To dispense the ice cubes, turn the ice tray handle to the right to empty half of the ice cubes into the bin. Then, turn it to the left to empty the other half.
- To take out the bin, pull it forward.
- Put the twist ice maker on the freezer shelf if it does not fit under the shelf.

Water tank for Auto Ice Maker (applicable models only)

To fill the water tank (applicable models only)

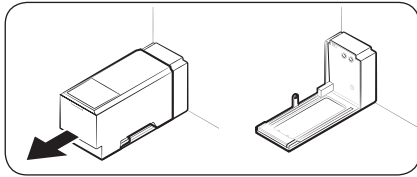

For first-time use, clean the inner side of the water tank and dry well.

1. Hold the handle with both hands, and then pull forward to remove it.

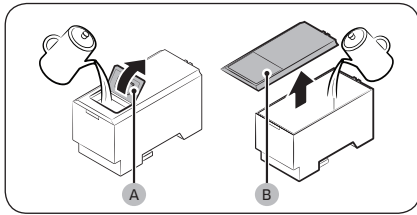

2. Open the lid (A) or the entire cover (B) and fill the tank with water.

⚠ CAUTION

Do not exceed the max line. Water overflows.

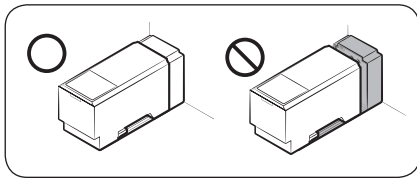

3. Reinsert the water tank and fit it into the dispenser mechanism. Make sure the lid on the cover faces the front.

⚠ CAUTION

- Make sure the water tank fits into the shelf. Otherwise, the water tank may not operate properly.
- Fill the tank only with potable water such as mineral or purified water. Do not use other liquids.
- Full water tank is heavy and therefore, use caution when moving a filled tank. Physical injury may occur if the tank is dropped.
- Do not try to disassemble the internal pump yourself. If the internal pump is damaged or disconnected from the water tank, the Auto Ice Maker does not operate.

📖 NOTE

If you are not using the Auto Ice Maker, you can remove the water tank for more storage space.

Operations

Auto Ice Maker (applicable models only)

The refrigerator has an ice maker that automatically dispenses ice.

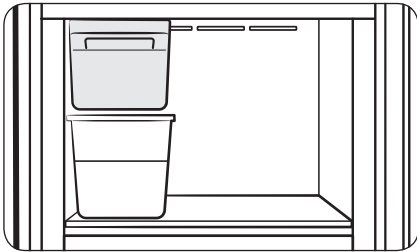

For first-time use

- Fill the water tank and let the ice maker make ice for 1-2 days.
- Discard the first 1-2 buckets of ice to remove impurities in the water supply system.

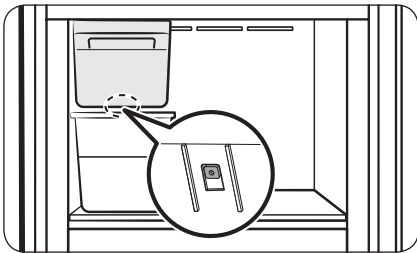

Diagnosis

If the Auto Ice Maker does not make ice, remove the ice bucket and press the **Test** button to check if the Auto Ice Maker operates properly.

⚠ CAUTION

- When the Auto Ice Maker is on, the refrigerator will keep making ice even when you remove the ice bucket. If you are not going to use the Auto Ice Maker, make sure to turn it off.
- When the refrigerator recovers power after a power failure, the ice bucket may contain a mix of melted and jammed ice cubes, which can prevent the ice maker from working properly. To prevent this, make sure to empty the ice bucket before using the refrigerator.
- Do not put fingers or any objects into the ice maker. This can cause physical injury or property damage.
- Due to sublimation, ice stored in the freezer for a long time gets smaller and then forms large ice chunks. Therefore, if it will be a long time before you use ice, turn the ice maker off.

📖 NOTE

If you are not using the Auto Ice Maker, you can remove the ice bucket for more storage space.



Optimal Fresh Zone (applicable models only)

Optimal Fresh Zone is an independently controlled compartment where you can store different items at the optimal temperature.

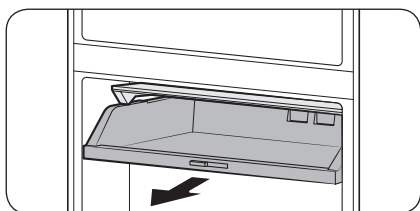

Hold the bottom part of the of the Optimal Fresh Zone and pull to store or take out items.

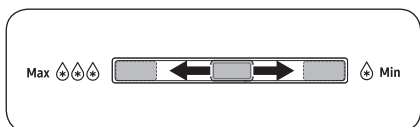

You can adjust the temperature of the Optimal Fresh Zone.

- To increase the temperature, slide the temperature control to the right.
- To decrease the temperature, slide the temperature control to the left.



Water dispenser (applicable models only)

With the water dispenser, you can dispense water without opening the fridge door. The water tank must be filled with potable water before use.

To fill the water tank with potable water

Open the door and locate the water tank that is located in the door bin area.

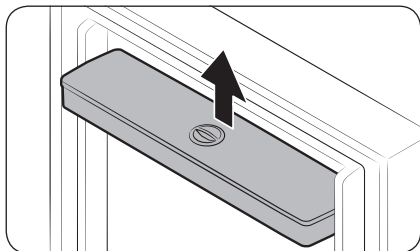

1. Hold both sides of the water tank and lift to remove.



Operations

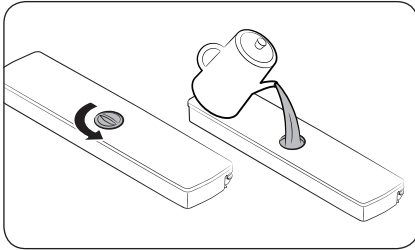

2. Fill the water tank with potable water. Remove the cap and pour water.

NOTE

Before using the water tank for the first time, clean the water tank thoroughly, especially the nozzle. Regularly clean the water tank and the nozzle.

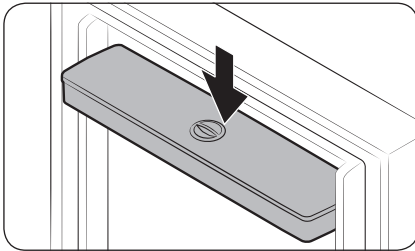

3. Reinsert the water tank and close the door. Make sure the water outlet of the water tank faces forward.

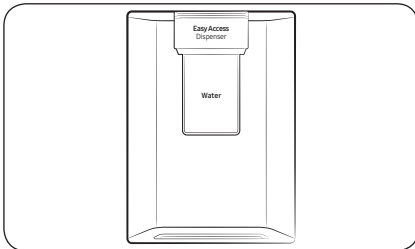

4. Put a water glass under the water outlet of the dispenser, and gently push the dispenser lever to dispense water.

CAUTION

- The water dispenser is designed to dispense potable water. Fill the water tank only with potable water. Do not fill with any other liquids.
- Do not fill the water tank excessively, which causes an overflow.
- Do not try to fill the water tank without removing it from the door.
- Make sure that water tank is seated properly.
- Do not use the refrigerator without the water tank. This may reduce performance and efficiency.
- To prevent water bouncing, make sure the glass is in line with the dispenser lever.

NOTE

To secure more room, you can use the water tank to store food. In this case, remove the lid of the tank.

Maintenance

Handle and care

Shelves (fridge/freezer)

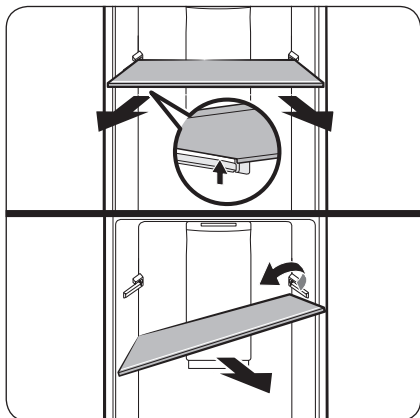

To remove the shelf, hold it with both hands and lift it to release it from the rear hook. Then, tilt it on one side and pull it out.

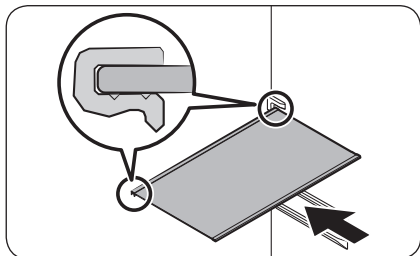

Before you insert the shelf, check the shape of the back of the shelf. Then, insert the shelf in the reverse order of removal.

⚠ CAUTION

- The shelf must be inserted correctly. Do not insert it upside down or back to front.
- Shelves are heavy, therefore be careful when you handle them.

Vegetable drawer

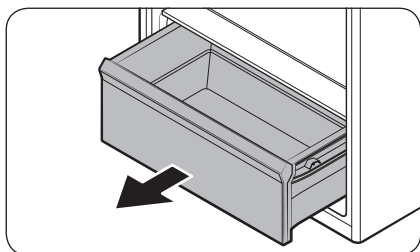

Gently lift up the front of the drawer and slide out.

Maintenance

Vegetable shelf

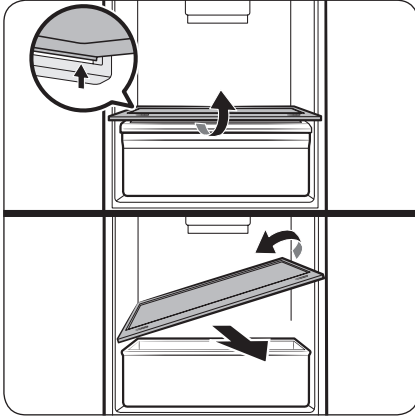

Hold the vegetable shelf with both hands and lift it to release it from the rear hook. Then, tilt it on one side and pull it out.

Door bins

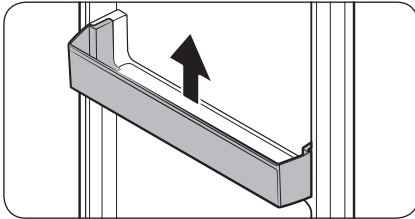

Slightly lift up and pull out the door bins.

⚠ CAUTION

To prevent accidents, empty the door bins before removing them.

Cleaning

WARNING

- Do not use benzene, thinner, or home/car detergent such as Clorox™ for cleaning purposes. They may damage the surface of the refrigerator and cause a fire.
- Do not spray water onto the refrigerator. This may cause electric shock.

Regularly use a dry cloth to remove all foreign substances such as dust or water from the power plug terminals and contact points.

1. Unplug the power cord of the refrigerator.
2. Use a moistened soft lint-free cloth or paper towel to clean the refrigerator's interior and exterior.
3. When done, use a dry cloth or paper towel to dry well.
4. Plug in the power cord of the refrigerator to turn the refrigerator on.

NOTE

If you have removed any removable parts such as shelves for cleaning, refer to the overall layout in the **Refrigerator at a glance** section to make sure you have reinserted correctly.

Maintenance

Replacement

Deodorizer filter (applicable models only)

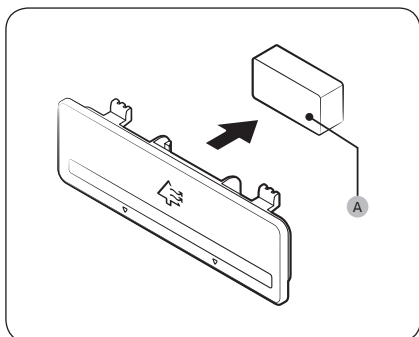

While holding the top and bottom sides of the filter case, unlock the filter case to reveal the **deodorizer filter (A)**. Replace the filter, and then reinsert the case.

Lamps and active fresh filter

Neither lamps nor the active fresh filter is user-serviceable. Do not attempt to replace them yourself. To replace them, contact a local Samsung service centre.

WARNING

- The lamps are not user-serviceable. Do not attempt to replace a lamp yourself. This can cause electric shock.

Lamp (Light Source)

This product contains a light source of energy efficiency class <G>.

The lamp(s) and/or control gear(s) are not user-serviceable. To replace the lamp(s) and/or control gear(s) in the product, contact a local Samsung service centre.

For detailed instructions on replacing lamp(s) or control gear(s) in your product, visit the Samsung website (<http://www.samsung.com>), go to Support > Support home, and then enter the model name.

For detailed instructions on dismantling lamp(s) and/or control gear(s), simply follow the replacement instruction reached as described above.

Troubleshooting

Before calling for service, review the checkpoints below. Any service calls regarding normal situations (No Defect Cases) will be charged to users.

General

Temperature

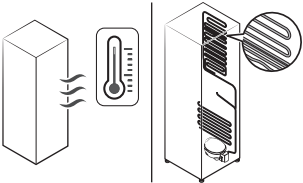
| Symptom | Possible causes | Solution |
|---|--|--|
| Fridge/freezer does not operate. Fridge/freezer temperature is warm. | <ul style="list-style-type: none"> Power cord is not plugged in properly. | <ul style="list-style-type: none"> Properly plug in the power cord. |
| | <ul style="list-style-type: none"> Temperature control is not set correctly. | <ul style="list-style-type: none"> Set the temperature lower. |
| | <ul style="list-style-type: none"> Refrigerator is located near a heat source or direct sunlight. | <ul style="list-style-type: none"> Keep the refrigerator away from direct sunlight or a heat source. |
| | <ul style="list-style-type: none"> Not enough clearance between refrigerator and sides/rear. | <ul style="list-style-type: none"> We recommend that the gap between the refrigerator and nearby walls (or cabinets) is more than 50 mm. |
| | <ul style="list-style-type: none"> Vacation mode is activated. | <ul style="list-style-type: none"> Deactivate vacation mode. |
| | <ul style="list-style-type: none"> The refrigerator is overloaded. Food is blocking the refrigerator vents. | <ul style="list-style-type: none"> Do not overload the refrigerator. Do not allow food to block ventilation. |
| Fridge/freezer is over-cooling. | <ul style="list-style-type: none"> Temperature control is not set correctly. | <ul style="list-style-type: none"> Set the temperature higher. |
| Interior wall is hot. | <ul style="list-style-type: none"> Refrigerator has heat-proof piping in the interior wall. | <ul style="list-style-type: none"> To prevent condensation from forming, the refrigerator has heat-proof piping in the front corners. If the ambient temperature rises, this equipment may not work effectively. This is not a system failure.  |

Troubleshooting

Odours

| Symptom | Possible causes | Solution |
|--------------------------|----------------------------|---|
| Refrigerator has odours. | • Spoiled food. | • Clean the refrigerator and remove any spoiled food. |
| | • Food with strong odours. | • Make sure strong smelling food is wrapped airtight. |

Condensation

| Symptom | Possible causes | Solution |
|---|---|---|
| Condensation forms on the interior walls. | • If door is left open, moisture enters the refrigerator. | • Remove the moisture and do not open the door for a long time. |
| | • Food with high moisture content. | • Make sure food is wrapped airtight. |

Water/Ice (Auto Ice Maker models only)

| Symptom | Possible causes | Solution |
|-------------------------------------|--|---|
| The ice maker does not produce ice. | • The freezer room is not cold enough. | • Make sure the cold air outlet is not clogged. |
| | • The wire connector of the ice maker is not connected properly. | • Make sure the wire connector from the wire housing is connected properly. |
| | • The water line flowing to the ice maker is bent or kinked. | • Make sure the water line in the rear of the refrigerator is not bent or kinked. |

Do you hear abnormal sounds from the refrigerator?

Before calling for service, review the checkpoints below. Any service calls related to normal sounds will be charged to the user.

These sounds are normal.

- When starting or ending an operation, the refrigerator may make sounds similar to a car engine igniting. As the operation stabilizes, the sounds will decrease.

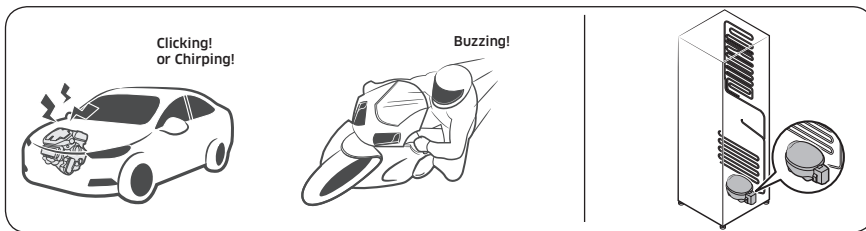

- While the fan is operating, these sounds may occur. When the refrigerator reaches the set temperature, no fan sound will occur.

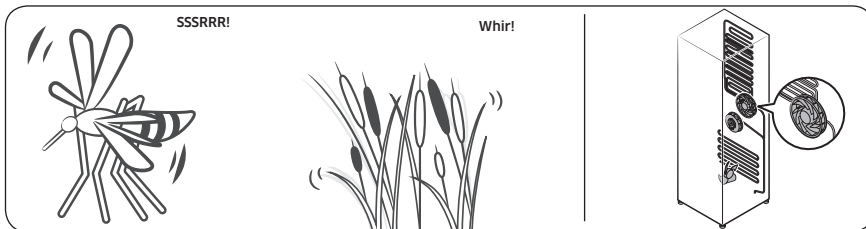

- During a defrost cycle, water may drip on the defrost heater, causing sizzling sounds.



Troubleshooting

- As the refrigerator cools or freezes, refrigerant gas moves through sealed pipes, causing bubbling sounds.

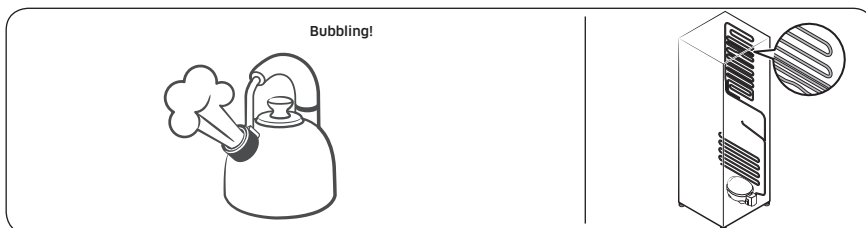

- As the refrigerator temperature increases or decreases, plastic parts contract and expand, creating knocking noises. These noises occur during the defrosting cycle or when electronic parts are working.

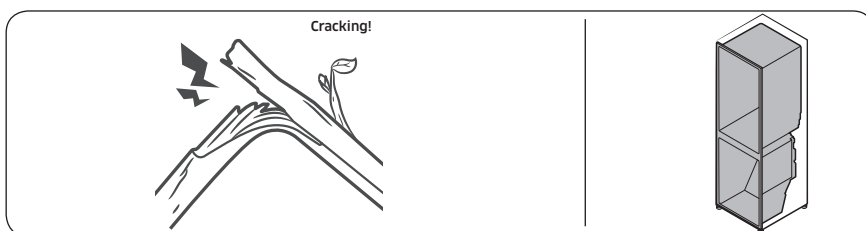

- For ice maker models: When the water valve opens to fill the ice maker, buzzing sounds may occur.
- Because of pressure equalizing when opening and closing the refrigerator door, whooshing sounds may occur.

SmartThings (applicable models only)

| Symptom | Action |
|---|--|
| Could not find "SmartThings" in the app market. | <ul style="list-style-type: none"> The supporting software version of the SmartThings app is subject to change according to the OS supporting policy the manufacturer provides. In addition, as for the SmartThings app or the functions that the app supports, the new application update policy on the existing OS version can be suspended due to usability or security reasons. |
| The SmartThings app fails to operate. | <ul style="list-style-type: none"> The SmartThings app is available for applicable models only. The old Samsung Smart Refrigerator app cannot connect with Samsung Smart Home models. |
| The SmartThings app is installed but is not connected to my refrigerator. | <ul style="list-style-type: none"> You must log into your Samsung account to use the app. Make sure that your router is operating normally. If the Wi-Fi icon on the refrigerator's display is off, this indicates that no network connection has been established yet. In this case, use the SmartThings app to connect and register your refrigerator to the access point (AP) of your house. |
| Could not log into the app. | <ul style="list-style-type: none"> You must log into your Samsung account to use the app. If you don't have a Samsung account, follow the app's onscreen instructions to create one. |
| An error message appears when I try to register my refrigerator. | <ul style="list-style-type: none"> Easy Connection may fail due to the distance from your access point (AP) or electrical interference from the surrounding environment. Wait a moment and try again. |
| The SmartThings app is successfully connected to my refrigerator but does not run. | <ul style="list-style-type: none"> Exit and restart the SmartThings app, or disconnect and reconnect the router. Power off the refrigerator, and then power it on again after 1 minute. |
| The Wi-Fi icon is blinking. () | <ul style="list-style-type: none"> Connect your refrigerator with the SmartThings app before use. When the connection is made successfully, the indicator stops blinking. <ul style="list-style-type: none"> If you fail to make connection or don't want to use the app, press and hold the Fridge button for 10 seconds. The indicator stops blinking. |

Open Source Announcement

The software included in this product contains open source software.

The following URL http://opensource.samsung.com/opensource/SMART_TP1_0/seq/0 leads to open source license information as related to this product.





異丁烷

iso-butane

R600a

Maintenance work must only be carried out at workshop by well-trained maintenance worker.

- The refrigeration system behind and inside the refrigerator contains refrigerant.
- Do not allow any sharp objects to come into contact with the refrigeration system.
- Do not use other electric appliances inside the refrigerator.
- Children should be supervised to ensure that the refrigerator should be used properly.
- Do not use the mechanical devices or other means to accelerate the defrosting process, unless they are of the type recommended by the manufacturer.
- Do not block the openings on the circumstances of the refrigerator.
- In case of having damaged the refrigerant circuit, do not use electric items or fire equipment nearby, and open all windows to provide good ventilation.
Please also contact your local maintenance agent to follow up.

Contact SAMSUNG WORLD WIDE

If you have any questions or comments relating to Samsung products, please contact the SAMSUNG customer care centre.

| Country/Location | Contact Center | Web Site |
|------------------|---|--|
| HONG KONG | 3698 4698 (All Product) 3698 4688 (B2B) 3698 4633 (eStore) 2121 9088 (Samsung pay) | www.samsung.com/hk/support (Chinese) www.samsung.com/hk_en/support (English) |
| MACAU | 0800 333 | www.samsung.com/hk/support (Chinese) www.samsung.com/hk_en/support (English) |



DA68-04657W-00



雪櫃

用戶手冊

全座式電器設備

SAMSUNG

目錄

| | |
|--------------------------------|----|
| 安全資訊 | 3 |
| 重要的安全符號和預防措施 | 5 |
| 用於運輸和現場的嚴重警告標誌 | 6 |
| 重要安裝警告 | 6 |
| 安裝注意事項 | 8 |
| 重要使用警告 | 9 |
| 使用注意事項 | 13 |
| 清潔注意事項 | 14 |
| 重要環保處理警告 | 15 |
| 其他有關正確使用的提示 | 16 |
| 節能提示 | 17 |
| 本設備旨在家用和類似應用·例如 有關 WEEE 的指示 | 18 |
| 安裝 | 19 |
| 雪櫃概覽 | 19 |
| 逐步安裝 | 21 |
| 運作 | 26 |
| 主面板 | 26 |
| SmartThings (僅限適用型號) | 30 |
| 特殊功能 | 33 |
| 維護 | 38 |
| 處理和保養 | 38 |
| 清潔 | 40 |
| 更換 | 41 |
| 故障排除 | 42 |
| 一般 | 42 |
| 您聽到冰箱的異常聲音了嗎？ | 44 |
| SmartThings (僅限適用型號) | 46 |
| Open Source Announcement | 47 |

安全資訊

- 使用全新 Samsung 雪櫃前，請詳讀本手冊，確保了解如何安全且有效率地操作新設備所提供的特性與功能。
- 本設備不適合肢體、感官或心智能力較弱的人（包括兒童）或缺乏經驗和知識的人使用，除非負責其安全的人員已監督或指示他們使用該設備。
- 本設備可供 8 歲或以上的兒童，以及肢體、感官或心智能力較弱，或缺乏經驗和知識的人使用，前提是他們在被監督或指示下以安全方式使用本設備，並且了解所涉及的危害。
兒童不得在本設備玩耍。兒童不得在未監督的情況下進行清潔和用戶維護。
- 本手冊中的警告和重要安全指南並未涵蓋所有可能發生的狀況和處境。
您有責任運用常識，小心謹慎地安裝、維護與操作設備。
- 由於這些操作指南涵蓋各種機型，您的雪櫃特徵和本手冊描述的可能稍有不同，而且並非所有的警告標誌均適用。若您有任何問題或疑慮，請聯絡離您最近的服務中心，或到 www.samsung.com 尋求協助和尋找網上資訊。
- R-600a 或 R-134a 用作製冷劑。檢查設備背後的標籤或雪櫃內部的評級標籤，查看雪櫃使用哪種製冷劑。若本產品包含可燃氣體（製冷劑 R-600a），請向地方當局洽詢有關如何安全處置本產品的細節。
- 為了避免在製冷迴路發生洩漏時產生易燃氣體混合物，電器設備的置放空間大小必須取決於所用製冷劑的數量。
- 切勿啟動有任何損壞跡象的電器設備。如有任何疑問，請洽詢您的經銷商。電器設備內部每 8 g 的 R-600a 製冷劑，必須要有 1 m³ 空間大小。您的特殊設備的製冷劑數量顯示在設備內部的識別牌上。
- 從管路噴出的製冷劑可能點燃或造成眼睛傷害。當製冷劑從管路洩漏時，請不要點火，並立即將易燃物移離產品，讓房間通風。
 - 否則可能會導致火災或爆炸。

安全資訊

- 由非經授權的維修人員進行本電器設備的維修會有危險。
- 請勿在本設備中存放易燃推進劑等易爆物，例如氣霧罐。
- 為避免食物受到污染，請遵守以下指示：
 - 雪櫃門長時間開著會導致電器設備隔間的溫度大幅升高。
 - 定期清潔可能與食物和無障礙排水系統接觸的表面。
 - 如果連續 48 小時未使用水箱，請清洗水箱；如果 5 天未抽水，請沖洗連接水源的供水系統。
 - 將生肉和魚放在雪櫃內合適的容器中，以避免碰觸到或滴落到其他食物。
 - 二星級冷凍食品室適合存放預凍食品、存放或製作雪糕，以及製作冰塊。
 - 一星、二星和三星級隔間不適合用於冷凍鮮食。
 - 如果製冷設備長期空置，請關閉電源、進行除霜、清潔、保持乾燥，並將雪櫃門打開，以防止設備內部發霉。



警告；危險的火/易燃材料

重要的安全符號和預防措施

請遵循本手冊的所有安全指南。本手冊使用以下安全符號。

警告

危險或不安全的操作可能導致嚴重的人身傷害、財產損失和/或死亡。

警示

危險或不安全的操作可能導致嚴重的人身傷害和/或財產損失。

注意

幫助用戶了解或從雪櫃獲益的實用資訊。

這些警告標誌的目的是為防止對您和他人造成傷害。

請密切遵循。

閱讀本節內容後，請將手冊放在安全地方以備日後參考。



安全資訊

用於運輸和現場的嚴重警告標誌

警告

- 在運輸和安裝設備時，務必小心謹慎，確保製冷迴路的任何部分均未損壞。
 - 從管路洩漏的製冷劑可能點燃或造成眼睛傷害。若檢測出洩漏問題，請避開任何明火或可能火源，並讓設備所在室內通風數分鐘。
 - 本設備內含異丁烷製冷劑 (R-600a)，這是一種具高度環境相容性的天然氣，也具易燃性。在運輸和安裝設備時，務必小心謹慎，確保製冷迴路的任何部分均未損壞。

重要安裝警告

警告

- 請勿將雪櫃安裝在潮濕的地點，可能接觸到水的位置。
 - 電氣零件的絕緣劣化可能導致觸電或起火。
- 請勿將本雪櫃置於陽光直射或暴露於灶爐、房間暖氣或其他電器設備的熱氣中。
- 請勿將數個電器設備插頭插入同一個排插插座。雪櫃應一律插到本身專用的電源插座，該插座的額定電壓符合雪櫃定額牌上所列示的電壓。
 - 如此可提供最佳性能，還能防止房屋佈線電路過載，以免因電線過熱而引發火災。
- 如果牆上插座鬆脫，請勿插入電源插頭。
 - 有觸電起火的危險。
- 請勿使用線長本身或線的兩端有裂紋或磨損的電源線。
- 請勿過度彎曲電源線或在線上放置重物。
- 請勿拉扯或過度彎曲電源線。



- 請勿扭結電源線。
- 請勿做以下動作：將電源線鈎掛在金屬物體上、在電源線上放置重物、將電源線插在物體之間，或將電源線推入設備後方空間。
- 移動雪櫃時，請小心勿將其翻轉，亦不可損壞電源線。
 - 這可能會導致觸電或引發火災。
- 切勿透過拉扯電源線拔下雪櫃插頭。始終牢牢抓住插頭，然後直接從插座中拔出。
 - 電源線破損可能導致短路、火災和/或電擊。
- 請勿在本設備中存放易燃推進劑等易爆物，例如氣霧罐。
- 請勿將本設備安裝在加熱器或易燃材料附近。
- 請勿將本設備安裝在可能洩漏氣體之處。
 - 這可能會導致觸電或引發火災。
- 在使用雪櫃之前，必須按照本手冊的說明正確放置和安裝雪櫃。
- 以電源線垂下的方式將電源插頭連接到適當的位置。
 - 如果把電源插頭倒置，電線可能會被截斷，並引發火災或導致觸電。
- 確認電源插頭沒有被雪櫃背面擠壓到變形或損壞。
- 將包裝材料放在兒童無法取得之處。
 - 如果兒童將包裝材料放在頭上玩，恐有窒息死亡的危險。
- 本設備必須定位在適當位置，確保安裝後方便使用插頭。
 - 否則，可能會因為漏電而導致觸電或引起火災。
- 請勿將本設備安裝在潮濕、油膩或多塵地點，避免陽光直射和水淋（雨滴）。
 - 退化的電器零件絕緣材料可能導致觸電或起火。
- 如果雪櫃中有灰塵或水，請拔出電源插頭，並與 Samsung Electronics 服務中心聯繫。
 - 否則，恐有引發火災的風險。
- 請勿站立在設備上頭或將物品（例如衣物、點燃的蠟燭、點燃的香煙、餐盤、化學藥品、金屬物品等）放置在設備上。
 - 這可能會導致觸電、引發火災、造成產品問題或人身傷害。

安全資訊

- 首次為產品插上電源之前，需要先拆卸所有的塑膠保護膜。
- 應該督導兒童，確保他們不去把玩用於調節門的卡環或水管夾。
 - 萬一小孩子不小心將卡環或水管夾吞下，可能有窒息死亡的危險。請將卡環和水管夾放在兒童無法取得之處。
- 雪櫃必須安全接地。
 - 在嘗試檢查或修理設備的任何部分之前，一律先確認已將雪櫃接地。漏電會導致嚴重的電擊事件。
- 千萬不要使用煤氣管、電話線或其他潛在的雷電吸引器用作電氣接地。
 - 必須將雪櫃接地以防止雪櫃電流洩漏而導致漏電或電擊。
 - 這可能會導致觸電、火災、爆炸或產品問題。
- 將電源插頭牢牢地插入牆壁插座。請勿使用損壞的電源插頭、損壞的電源線或鬆弛的牆壁插座。
 - 這可能會導致觸電或引發火災。
- 如果電源線損壞，立刻請製造廠商或其中一家服務代理商來更換。
- 雪櫃的保險絲必須由合格的技術人員或服務公司進行更換。
 - 否則，可能會導致觸電或人身傷害。
- 為電器設備定位時，確保電源線沒有被夾住或損壞。
- 請勿在設備背面放置多個便攜式插座或便攜式電源供應器。

安裝注意事項

⚠ 警示

- 在雪櫃周圍留出足夠的空間，並將其安裝在平坦表面。
 - 在設備外圍或安裝結構中，保持通風口通暢，無阻礙物。
- 在安裝並開啟設備電源後，放置食物之前，先讓設備靜置 2 小時。



- 強烈建議您找合格的技術人員或服務公司來安裝雪櫃。
 - 這可能會導致觸電、引發火災、造成產品問題或人身傷害。
- 任何一側雪櫃門上裝載過重，都可能導致雪櫃翻倒，並且可能導致人身傷害。

重要使用警告

警告

- 請勿用濕手將電源插頭插入牆壁插座。
 - 這可能會導致觸電。
- 請勿將物品存放在設備的頂端。
 - 否則，當打開或關閉門時，物品可能掉落，並造成人身傷害和/或物質損失。
- 請勿將手、腳或金屬物（例如筷子等）插入雪櫃的底部或背面。
 - 這可能會導致觸電或人身傷害。
 - 任何利邊都可能導致人身傷害。
- 請勿用濕手觸摸冰格的內壁或存放在冰格中的產品。
 - 這可能導致凍傷。
- 請勿將盛滿水的容器放在雪櫃上。
 - 如果水滿到溢出，便會有起火或觸電的風險。
- 請勿在雪櫃中保存易揮發或易燃的物體或物質（苯、稀釋劑、丙烷氣、酒精、乙醚、液化石油氣和其他此類產品）。
 - 本雪櫃僅供存放食物用。
 - 這可能會導致起火或爆炸。
- 兒童應接受督導，確保他們不在本設備玩耍。
 - 手指應遠離「夾點」區域。門和機櫃之間間隙必須很小。如果周遭區域有小孩，打開門時請小心。
- 請勿讓兒童懸掛在門或門擱架上，以免造成嚴重傷害。
- 請勿讓兒童進入雪櫃內部，以免卡在裡面出不來。





安全資訊

- 請勿將手插入設備底下的底部區域。
 - 任何利邊都可能導致人身傷害。
- 請勿在雪櫃中存放藥品、科學材料或對溫度敏感的產品。
 - 需要嚴格控溫的產品均不得存放在雪櫃中。
- 請勿在雪櫃/冰格內放置或使用電器，除非是製造商建議使用的類型。
- 如果聞到藥品味或煙味，請立即拔出電源插頭，並與 Samsung Electronics 服務中心聯繫。
- 如果雪櫃中有灰塵或水，請拔出電源插頭，並與 Samsung Electronics 服務中心聯繫。
 - 否則，恐有引發火災的風險。
- 請勿讓兒童踩踏抽屜。
 - 抽屜可能斷裂並導致滑動。
- 請勿在無人看管的情況下讓雪櫃門一直開著，也不要讓兒童進入雪櫃。
- 請勿讓嬰兒或兒童進入抽屜。
 - 以免因卡住而窒息死亡或造成人身傷害。
- 請勿在雪櫃內塞滿食物。
 - 否則，當打開門時，某物品可能掉落而造成人身傷害和/或物質損失。
- 請勿在設備表面噴灑殺蟲劑之類的揮發性物質。
 - 除對人體有害外，還可能導致觸電、起火或產品問題。
- 請勿在雪櫃附近或內部使用或放置任何對溫度敏感的物質，例如易燃噴霧劑、易燃物體、乾冰、藥品或化學製品。
- 請勿使用吹風機吹乾雪櫃內部。請勿為了清除異味而將點燃的蠟燭放在雪櫃中。
 - 這可能會導致觸電或引發火災。



- 請勿站立在設備上頭或將物品（例如衣物、點燃的蠟燭、點燃的香煙、餐盤、化學藥品、金屬物品等）放置在設備上。這可能會導致觸電、引發火災、造成產品問題或人身傷害。請勿將盛滿水的容器放在設備上。
 - 如果水滿到溢出，便會有起火或觸電的風險。
- 請勿使用製造商建議的方法以外的機械裝置或其他任何方法來加速除霜程序。
- 請勿損壞製冷劑迴路。
- 切勿長時間直視 UV LED 燈。
 - 這可能因紫外線的關係造成眼睛疲勞。
- 請勿將雪櫃層板上下倒置。架子擋板無作用。
 - 可能因玻璃架掉落而造成人身傷害。
- 若檢測出瓦斯漏氣問題，請避開任何明火或可能火源，並讓設備所在室內通風數分鐘。
 - 請勿觸摸設備或電源線。
 - 請勿使用排氣扇。
 - 火花可能會引起爆炸或火災。
- 僅使用製造商或其服務代理商所提供的 LED 燈。
- 瓶子應緊密併立存放，以免掉落。
- 本產品僅適合在住家環境儲存食物之用。
- 請勿嘗試自行修理、拆卸或改裝雪櫃。
 - 未經授權的改裝可能會導致安全問題。若要撤銷未經授權的改裝，我們將收取零件和人工全部費用。
- 請勿使用除標準保險絲外的其他任何保險絲（例如銅、鋼絲等）。
- 如果您的雪櫃需要維修或重新安裝，請聯繫離您最近的服務中心。
 - 不這麼做可能會導致觸電、引發火災、造成產品問題或人身傷害。
- 如果內部或外部 LED 燈熄滅，請洽詢離您最近的服務中心。



安全資訊

- 如果雪櫃發出燃燒的氣味或冒煙，請立即拔下雪櫃的電源插頭，並聯繫 Samsung Electronics 服務中心。
 - 否則，可能會有觸電或引發火災的危險。
- 更換雪櫃內部照明之前，請從插座拔出電源插頭。
 - 否則，恐有電擊風險。
- 如果更換非 LED 燈時遇到困難，請聯繫 Samsung 服務中心。
- 如果產品配備 LED 燈，請勿自行拆卸燈罩和 LED 燈。
 - 請聯繫 Samsung 服務中心。
- 將電源插頭牢牢地插入牆壁插座。
- 請勿使用損壞的電源插頭、損壞的電源線或鬆弛的牆壁插座。
 - 這可能會導致觸電或引發火災。





使用注意事項

⚠ 警示

- 請勿重新冷凍完全解凍的冷凍食品。請勿將碳酸或氣泡飲料放入冰格隔間。請勿在冰格內放置瓶子或玻璃容器。
 - 如果內容物凍結，玻璃可能破裂，並造成人身傷害。
- 若要獲得最佳產品功用：
 - 請勿將食物放在雪櫃後方通風口附近，因為這樣會阻礙雪櫃隔間的空氣流通。
 - 在將食物放入雪櫃之前，請正確包裝食物，或將其裝入密閉容器中。
 - 請留意冷凍食品的最長保存時間和有效期。
- 請勿將玻璃或瓶子或碳酸飲料放入冰格。
 - 容器可能凍結和破裂，並可能導致人身傷害。
- 請勿將碳酸或氣泡飲料放入冰格隔間。請勿在冰格內放置瓶子或玻璃容器。
 - 如果內容物凍結，玻璃可能破裂，並造成人身傷害和財產損失。
- 服務保修和條款修訂。
 - 第三方對這個已安裝完成的設備的任何更改或修訂均未涵蓋在 Samsung 保修服務範圍內，Samsung 也不需對第三方修訂結果所產生的安全問題負責。
- 請勿阻塞雪櫃內的通風孔。
 - 如果通風孔被堵塞，尤其是被塑膠袋堵塞的話，則雪櫃可能會過冷。如果冷卻時間過長，則濾水器可能會破裂並導致漏水。
- 將內部多餘的水分擦乾，並讓門保持打開狀態。
 - 否則，可能會產生異味和發霉。
- 如果雪櫃電源已中斷，則應等待至少五分鐘，再重新接上電源。
- 當雪櫃被水浸濕時，請拔掉電源插頭，並聯繫 Samsung Electronics 服務中心。





安全資訊

- 請勿撞擊玻璃表面或施力過大。
 - 玻璃破裂恐導致嚴重的人身傷害和/或財產損失。
- 注意不要夾到手指。
- 如果冰格和雪櫃的門打開 2 秒或更長時間，冰格和雪櫃中的燈會熄滅。
 - 當門關上後再打開，燈就會再亮起。
- 如果雪櫃被水淹沒，請務必與離您最近的服務中心聯繫。
 - 以避免觸電或起火的危險。
- 請勿將植物油放在雪櫃的門擱架上。油會凝固、味道變得難聞，並且難以使用。此外，打開的容器可能會漏油，而漏油會致使門擱架破裂。打開裝油的容器後，最好將容器放在陰涼之處，例如櫥櫃或餐具室。
 - 植物油有橄欖油、玉米油、葡萄籽油等。

清潔注意事項

警示

- 請勿將水直接噴灑在雪櫃的內部或外部。
 - 否則，會有起火或觸電的風險。
- 請勿使用吹風機吹乾雪櫃內部。
- 請勿為了清除異味而將點燃的蠟燭放在雪櫃中。
 - 這可能會導致觸電或引發火災。
- 請勿將清潔用品直接噴灑在顯示幕上。
 - 顯示幕上的列印字母可能會脫落。
- 如果有異物（例如水）進入設備中，請拔掉電源插頭，並聯繫離您最近的服務中心。
 - 不這麼做可能會導致觸電或引發火災。



- 使用乾淨的乾布去除電源插頭金屬片上的異物或灰塵。清潔插頭時，請勿使用浸濕或潮濕的布。
 - 否則，會有起火或觸電的風險。
- 請勿透過直接在設備上噴水的方式清潔設備。
- 清潔時請勿使用苯、稀釋劑或高樂氏氯化物。
 - 這些可能會使設備的表面受損，並可能引發火災。
- 在清潔或維護保養之前，請將牆壁插座上的設備電源插頭拔出。
 - 不這麼做可能會導致觸電或引發火災。
- 準備乾淨的海綿或軟布以及溫和的清潔劑，用溫水清潔雪櫃。
- 請勿在外部表面（門和櫥櫃）、塑膠零件、門和內襯及墊片上使用研磨性或刺激性清潔劑，例如窗戶噴霧劑、洗潔精、易燃液體、鹽酸、清潔蠟、濃縮清潔劑、漂白劑或含石油產品的清潔劑。
 - 這些可能會刮傷或損壞材料。
- 請勿用溫水清潔冰冷的玻璃架或蓋子。玻璃架和蓋子暴若露於突然變溫環境，或在撞擊或跌落等的衝擊下，可能會破裂。

重要環保處理警告

⚠ 警告

- 請以友善環境的方式環保處理本產品包裝材料。
- 在環保處理之前，請確保雪櫃背面的所有管線均未損壞。
- R-600a 或 R-134a 用作製冷劑。檢查設備背後的標籤或雪櫃內部的評級標籤，查看雪櫃使用哪種製冷劑。若此雪櫃包含可燃氣體（製冷劑 R-600a），請向地方當局洽詢有關如何安全處置本產品的細節。
- 環保處理此雪櫃時，請卸下門/門密封條和門門，以免幼童或動物被困在裡面。兒童應接受督導，確保他們不在本設備玩耍。萬一被在裡面，幼童可能會受傷，或窒息死亡。



安全資訊

- 絕緣材料使用的是環戊烷。絕緣材料中的氣體需要使用特殊的處理程序。關於本產品的環保處理訊息，請聯繫您當地相關單位。
- 將所有包裝材料放在兒童無法取得之處，因為包裝材料可能對兒童造成危險。
 - 如果孩子將袋子罩住頭，恐會窒息。
- 危險：兒童受困的危險。在丟棄舊雪櫃或冰格之前：
 - 將門卸下。
 - 將層板留在原處，以防兒童輕易爬入內部。

其他有關正確使用的提示

- 如果發生停電，請致電您當地的電力公司辦事處，詢問停電會持續多長時間。
 - 大多數停電事故只要在一兩小時內恢復，大致不會對雪櫃的溫度造成影響。但是，在電源關閉時，應盡量減少開門次數。
 - 如果停電時間超過 24 小時，請取出並丟棄所有冷凍食品。
- 如果將雪櫃長時間放置在周圍空氣溫度始終低於設備設計的溫度，則雪櫃的運作可能無法保持一致（冷凍的內容物可能解凍，或者冷凍食品室溫度會變得太高）。
- 對於特殊食品，由於其特殊性，將其冷藏保存反而無法保鮮。
- 您的設備無霜，這表示無需以手動方式為設備除霜。這將自動執行。
- 除霜過程的溫升符合 ISO 要求。如果要防止在設備除霜時冷凍食品的溫度過高，請用數層報紙包裹冷凍食品。
- 請勿重新冷凍完全解凍的冷凍食品。
- 兩星部分或有兩個星號 (☆☆) 的隔室的溫度會比其他冰格隔室稍高。
兩星部分或隔室均以所提供的說明和/或條件為準。





節能提示

- 將設備安裝在涼爽乾燥且通風良好的室內。請勿將其暴露在直射陽光下，也不要將其放在直接熱源附近（例如散熱器）。
- 為了提高能源效率，建議不要堵住任何通風孔和格柵。
- 務必先將熱食放涼再放入設備。
- 將冷凍食品放在雪櫃內解凍。如此，便能利用冷凍產品的低溫冷卻雪櫃中的食物。
- 在將食物放入雪櫃或從雪櫃拿出時，請勿讓門打開的時間過長。門打開的時間越短，冰格裡結霜越少。
- 建議將雪櫃安裝在背面和側面有間隙的位置。這有助於減少耗電量，降低電費。
- 為了以最佳效率利用能源，請將所有內部配件（例如籃子、抽屜、層板）維持在製造商提供的位置上。





安全資訊

本設備旨在家用和類似應用，例如

- 商店、辦公室和其他工作環境中的員工廚房區域；
- 農舍以及客戶在酒店、汽車旅館和其他住宅類型環境中的住房；
- 床和早餐類型的環境；
- 餐飲和類似的非零售應用。

有關 WEEE 的指示



正確處理本產品（廢棄電器與電子設備）

（適用於使用垃圾分類系統的國家或地區）

產品、配件或文獻上的這種標記表明產品及其電子配件（如充電器、耳機、USB 連接線）在結束其壽命時，不應與其他家庭廢棄物一起處置。為了防止因廢棄物的不當處理對環境或人體健康造成潛在的危險，請與其他類型的廢棄物分開處理，並進行有責任的回收，促進材料的可持續再利用。

家庭使用者應該聯絡購買此產品的零售商，或當地政府部門瞭解在何處如何處理這些廢棄物，以保證安全環保回收。

商業用戶應該聯絡其供應商，並檢查購買合同的條款和條件。此產品及其電子配件，不應與其他商業廢棄物混在一起處置。

有關 Samsung 的環境承諾和產品監管責任的詳細資訊（如 REACH、WEEE 或電池），請參訪我們的永續發展頁面，網址：
www.samsung.com

（僅限在歐洲國家和英國販售的產品）



安裝

請謹慎遵循這些說明，以確保正確安裝此雪櫃，並防止在使用前發生事故。

⚠ 警告

- 僅將雪櫃用於本手冊中所述之目的。
- 任何維修工作都必須由合格的技術人員負責執行。
- 請按照當地法規處置產品包裝材料。

雪櫃概覽

📖 注意

雪櫃的實圖和提供的零件，可能會因機型和國家/地區而異。

自動製冰機型號

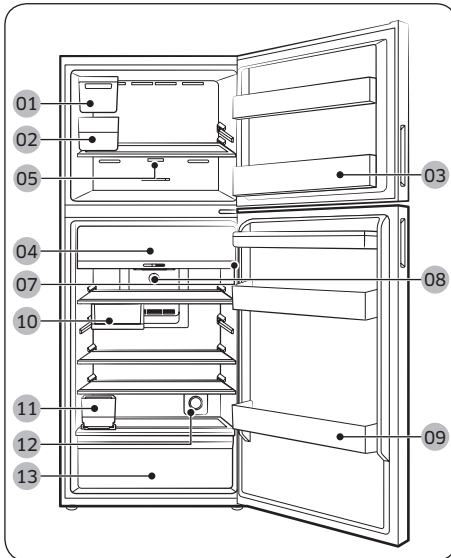

飲水機型號

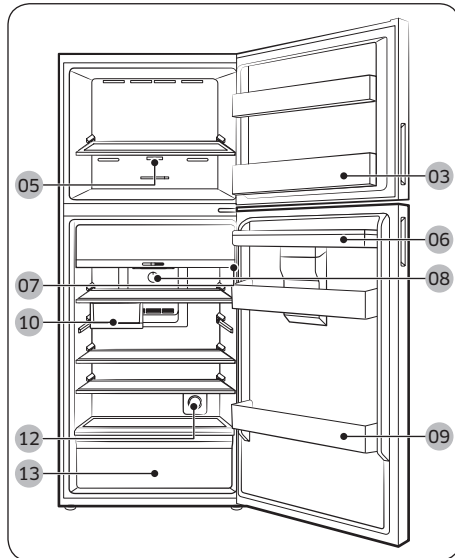

安裝

安裝

- | | |
|--------------------|--------------------|
| 01 自動製冰機 *** | 02 冰桶 *** |
| 03 冰格門層架 | 04 保鮮區 * |
| 05 主面板 (類比 - 冰格) * | 06 飲水機的水箱 ** |
| 07 主面板 (數位 - 雪櫃) * | 08 主面板 (類比 - 雪櫃) * |
| 09 雪櫃門攔架 | 10 多功能托盤 * |
| 11 自動製冰機的水箱 *** | 12 保鮮過濾器 * |
| 13 蔬菜抽屜 | |

* 僅限適用型號

** 僅限飲水機型號

*** 僅限自動製冰機型號

確保冰格隔間裡有更多儲藏空間

卸下一個或多個選購配件，如層板、扭轉式製冰盒、儲冰桶、冰桶及其支架，所有這些都可以在沒有工具的情況下手動拆卸。

- 這些選購配件不會影響熱性能和機械性能。
- 冰格宣稱的儲藏量是以這些選購配件不存在時計算。
- 為擁有最佳效能，請確保所有層板和抽屜皆在其原位。

負載限制指示器 (僅限適用型號)

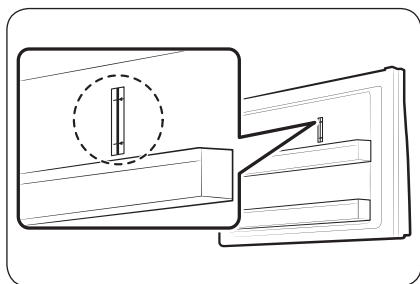

雪櫃在冰格隔間的右上方有一個負載限制指示器。

⚠ 警示

- 請勿將食品放置或保留在負載限制指示器上面。否則，能源效率可能會受到影響。

逐步安裝

步驟 1 選擇場地

場地要求：

- 沒有阻礙通風之地毯或地板的堅固、平坦表面
- 遠離陽光直射
- 足夠空間供開關門
- 遠離熱源
- 維修與保養室
- 溫度範圍：介於 10 °C 與 43 °C 之間

有效的環境溫度範圍

本冰箱設計為在其類別級別指定的溫度範圍下正常使用。

| 類別 | 符號 | 環境溫度範圍 (°C) | |
|-----|----|-----------------------|-----------|
| | | IEC 62552 (ISO 15502) | ISO 8561 |
| 亞溫帶 | SN | +10 至 +32 | +10 至 +32 |
| 溫帶 | N | +16 至 +32 | +16 至 +32 |
| 亞熱帶 | ST | +16 至 +38 | +18 至 +38 |
| 熱帶 | T | +16 至 +43 | +18 至 +43 |

注意

冰箱的冷卻效能和電源消耗受冰箱環境溫度、打開冰箱門的頻率、所在位置等因素的影響。建議將溫度調整至合適範圍。

安裝

空隙

有關安裝空間需求，請參見下圖和表格。

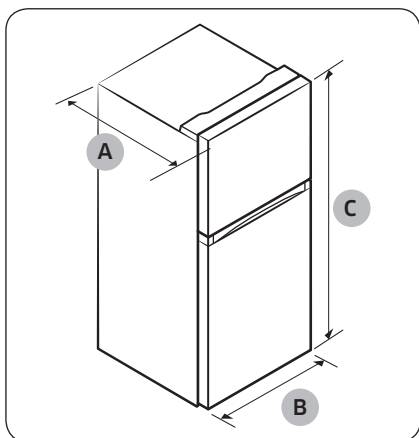

| 機型 | RT31 | RT35 | RT38 |
|-------|------|------|------|
| 深度「A」 | 647 | 709 | 672 |
| 寬度「B」 | 600 | 600 | 700 |
| 高度「C」 | 1715 | 1715 | 1715 |

(單位：mm)

| 機型 | RT42 | RT47 |
|-------|------|------|
| 深度「A」 | 672 | 717 |
| 寬度「B」 | 700 | 700 |
| 高度「C」 | 1785 | 1825 |

(單位：mm)

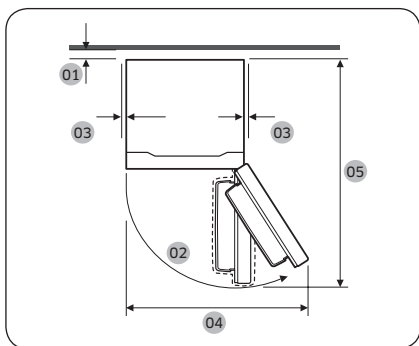

| | RT31 | RT35 | RT38 |
|----|-----------------------|------|------|
| 01 | 建議 50 mm 以上 | | |
| 02 | 115° (冰格) / 115° (雪櫃) | | |
| 03 | 至少 50 mm | | |
| 04 | 850 | 850 | 1006 |
| 05 | 1201 | 1263 | 1311 |

(單位：mm)

| | RT42 | RT47 |
|----|-----------------------|------|
| 01 | 建議 50 mm 以上 | |
| 02 | 115° (冰格) / 115° (雪櫃) | |
| 03 | 至少 50 mm | |
| 04 | 1006 | 1006 |
| 05 | 1311 | 1356 |

(單位：mm)



步驟 2 間距 (僅限適用機型)

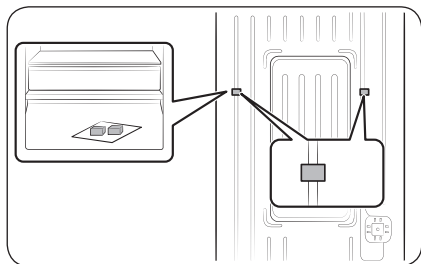

1. 打開門並找到提供的墊片 (x2)。
2. 如圖所示，拆開兩個墊片的包裝並將它們連接到雪櫃的背面。其有助後壁通風，節省用電量。

步驟 3 地板

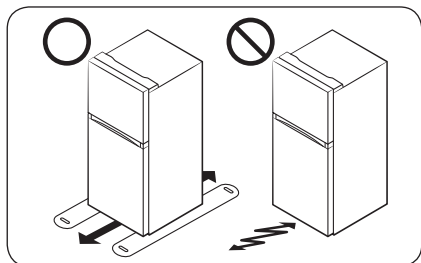

- 安裝雪櫃的表面必須足以支撐滿載的雪櫃或大約 90 kg。
- 為保護地板，請在雪櫃的每個支腳放置一大片硬紙板。
- 雪櫃最終定位後，除非有保護地板的需要，否則不要移動它。如果必須移動，請沿著移動路徑使用厚紙或布料，例如老舊的地毯。



安裝

步驟 4 調整水平腳

⚠ 警示

- 安裝時，雪櫃必須水平置於平坦的堅固地板上。若未將雪櫃調平，可能導致雪櫃損壞或人員受傷。
- 調平作業必須在雪櫃清空的狀態下進行。確定雪櫃內部沒有食品。
- 為安全起見，將前端調到稍微高於後端。使用特殊螺絲（校平器）於前支腳調整水平，將雪櫃調平。使用一字螺絲刀轉動校平器。

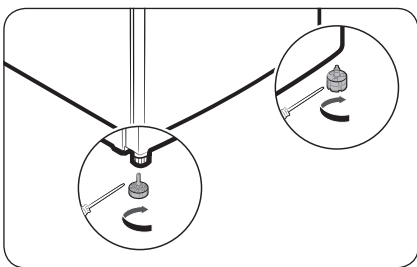

手動調整水平支腳調平雪櫃。順時針旋轉水平支腳以調低，或逆時針旋轉水平支腳以調高。基於安全理由，請將前端調整稍高於後端。

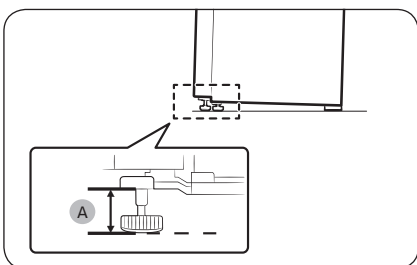

如圖所示，使支腳與地面保持 41 mm (A) 的距離。



步驟 5 初始設定

完成以下步驟後，雪櫃所有功能應可正常運作。

1. 將電源線插入牆壁插座以啟動雪櫃。
2. 打開雪櫃門，檢查內部照明燈是否亮著。
3. 將溫度設定到最冷，然後等候大約一個小時。然後，冰格會稍微變冷，馬達運轉變得順暢。
4. 等到雪櫃達到設定的溫度。現在，可以開始使用雪櫃了。

步驟 6 最後檢查

完成安裝後，請確認：

- 雪櫃已插入電源插座並正確接地。
- 雪櫃安裝在平坦的表面上，與牆壁或櫃子保持適當的間隙。
- 雪櫃是水平的，牢牢地豎立在地板上。
- 門可隨意開啟和關閉，當門開啟時，內部照明燈會自動亮起。

運作

主面板

雪櫃 - 數位

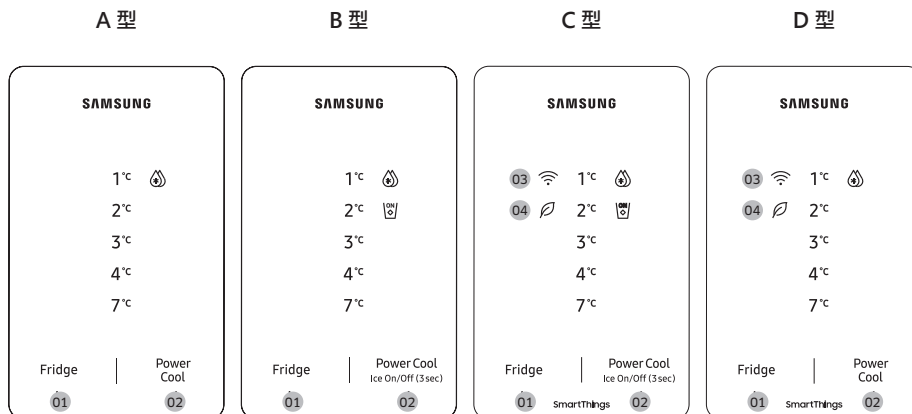

01 Fridge (雪櫃)

02 Power Cool (急速冷藏) /
Ice On/Off (3 sec) (製冰開/關 (3 秒)) *

03 網絡連線指示器 *

04 AI Energy Mode *

* 僅限適用型號

注意

如果打開雪櫃門的次數過於頻繁，或將大量食物放進雪櫃，這時的雪櫃溫度會變高。若是如此，所有顯示溫度的 LED 會閃爍，直到雪櫃回復指定的溫度設定為止。如果持續閃爍一段時間，請洽詢當地 Samsung 服務中心尋求技術援助。



- 當溫度顯示器閃爍時，警示鈴聲會響起。要關閉警示音，請輕觸顯示器上的按鍵。
- 如果在溫度顯示器閃爍時打開雪櫃門，內部指示燈會閃爍約一分鐘之久。

01 雪櫃

| | |
|-------------|--|
| Fridge (雪櫃) | <p>按 Fridge (雪櫃) 選取所需的雪櫃溫度。</p> <p> 警示</p> <ul style="list-style-type: none">請勿將雪櫃溫度設定為冬天最低，夏天最高。否則可能會導致冷卻性能問題。 |
|-------------|--|

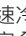

02 急速冷藏 / 製冰開/關 (3 秒)

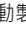
| | |
|---|---|
| <p>Power Cool (急速冷藏)</p> | <p>按 Power Cool (急速冷藏) 以啟用或停用急速冷藏。</p> <ul style="list-style-type: none"> • 急速冷藏會以最大風扇速度加速冷卻過程。雪櫃會保持全速運轉若干小時，然後返回之前的溫度。 • 當急速冷藏啟動，急速冷藏圖示 () 會開啟，雪櫃將會加快冷藏過程。 • 若要完全冷藏大量食物，請預先啟用急速冷藏至少 24 小時。 <p> 注意</p> <p>使用 急速冷藏會增加耗電量。若不要使用，請務必先關閉，再返回先前的溫度。</p> |
| <p>Ice On/Off (製冰開/關) (僅限 B、C 型)</p> | <p>按住 Power Cool (急速冷藏) 3 秒將自動製冰機打開或關閉。</p> <ul style="list-style-type: none"> • 當自動製冰機打開時，製冰機圖示 () 會開啟。自動製冰機預設為開啟。 • 建議在下列狀況時停用此功能： <ul style="list-style-type: none"> - 冰桶已裝滿冰塊。 - 您想要減少耗電量。 |

03 網絡連線 (僅限適用型號)

您可以在 SmartThings 應用程式上控制和監視雪櫃。如需詳細資訊，請參閱 **SmartThings (僅限適用型號)** 一節。

注意

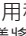
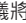
如果雪櫃未與 SmartThings 應用程式連線，Wi-Fi () 圖示會閃爍，提醒雪櫃門已打開。如果看到閃爍的 Wi-Fi () 圖示，建議將雪櫃連線至 SmartThings 應用程式。

04 AI Energy Mode (僅限適用型號)

-  圖示會在 AI Energy Mode 運作時出現。您可以在 SmartThings 應用程式中開啟或關閉 AI Energy Mode。(僅限適用型號)

開啟或關閉 Wi-Fi (僅限適用型號)

若要開啟或關閉 Wi-Fi，請按住 **Fridge (雪櫃)** 10 秒。Wi-Fi () 圖示顯示 Wi-fi 訊號狀態，如下圖所示。

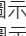
- Wi-Fi 關閉：Wi-Fi () 圖示閃爍 5 秒後關閉。
- Wi-Fi 開啟：Wi-Fi () 圖示閃爍 5 秒，然後開啟 5 秒。

注意

- 您必須開啟 Wi-Fi 才能將雪櫃連線到 SmartThings 應用程式。
- 如需詳細資訊，請參閱 **SmartThings (僅限適用型號)** 一節。



運作

雪櫃 - 類比

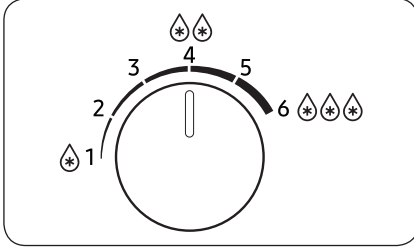

- 左右轉動轉盤以設定所需的溫度。
- 向左轉動轉盤會升高溫度，向右轉動會降低溫度。

ⓘ 注意

為確保最佳性能，建議將溫度設定為 。

⚠ 警示

- 當室溫低於 10 °C 時，請勿將雪櫃溫度設定為較高 (1-2)，當溫度高於 35 °C 時，勿設定為較低 (4-6)。這可能會導致冷卻性能問題。

冰格 - 類比

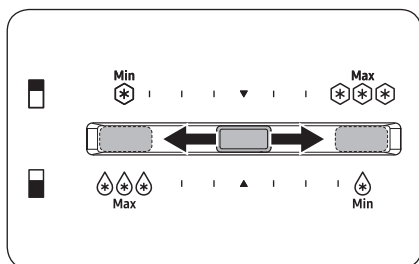

- 若要調高溫度，可將溫控滑桿推向左側。
- 若要調低溫度，可將溫控滑桿推向右側。冬天時，可將溫控滑桿推向最右端。

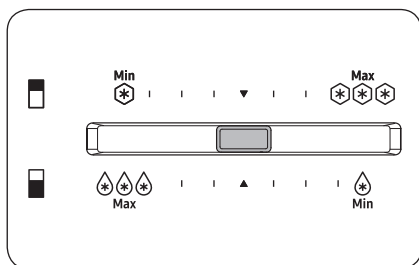

若要在夏天時節（35 °C 以上）製冰，可將冰格溫度設定置中

ⓘ 注意

如果自動製冰機未製造足量的冰，可將溫控裝置推向右側。

⚠ 警示

- 若要避免系統故障或食物變質，請勿在夏天時節（35 °C 以上）將溫度設定至最右端（最大值）。
- 請勿將裝有液體的玻璃瓶存放到冰格中。瓶中液體一旦冷凍，玻璃瓶將會破裂，或爆裂成碎片。

運作

SmartThings (僅限適用型號)

安裝

請參訪 Google Play Store、Galaxy Apps 或 Apple App Store，然後搜尋「SmartThings」。下載並安裝 Samsung Electronics 提供到您的智能裝置的 SmartThings 應用程式。

注意

- 支援的 SmartThings 應用程式軟體版本會依循製造商提供的 OS 支援政策而更改，恕不另行通知。此外，關於 SmartThings 應用程式或應用程式所支援的功能，針對現有的 OS 版本制定的新應用程式更新政策，可能會因實用性或安全性的原因而暫停使用。
- SmartThings 應用程式可能為了改善實用性和效能而隨時更改，恕不另行通知。由於手提電話的 OS 版本每年都會更新，因此 SmartThings 也會隨著最新的 OS 持續更新。如果您對上述項目有任何疑問，請利用以下電子郵件地址和我們聯絡：st.service@samsung.com
- 推薦的加密系統包括 WPA/TKIP 和 WPA2/AES。不支援任何更新或未標準化的 Wi-Fi 授權協定。
- 無線網絡可能會受周圍的無線通訊環境影響。
- 如果互聯網服務供應商已登錄您的電腦或用於身分識別的數據機的 MAC 位址，您的 Samsung 智能雪櫃可能無法連上互聯網。如果發生這種情況，請向您的互聯網服務供應商尋求技術援助。
- 您的網絡系統的防火牆設定可能會阻止您 Samsung 智能雪櫃存取互聯網。向您的互聯網服務供應商尋求技術援助。如果這種症狀持續發生，請洽詢當地的 Samsung 服務中心或零售商。
- 若要配置無線存取點 (AP) 設定，請參閱 AP 路由器的用戶手冊。
- Samsung 智能雪櫃使用 IEEE 802.11 b/g/n 和 Soft-AP 協定支援 Wi-Fi 2.4 Ghz。(建議使用 IEEE 802.11 n)。
- 未經授權的 Wi-Fi 無線路由器可能無法連接適用的 Samsung Smart Refrigerators。



Samsung 帳戶

若要使用應用程式，您需要註冊 Samsung 帳戶。如果沒有 Samsung 帳戶，可按照應用程式畫面上的指示建立免費的 Samsung 帳戶。

快速入門

開啟要連接的裝置，在手機上開啟 SmartThings 應用程式，然後按照以下指示操作。

如果彈出訊息表示已找到新裝置，請輕按 **ADD NOW (立即新增)**。

若未彈出訊息，請輕按 **+** 按鍵，然後從可用裝置清單選取您要連接的裝置。

如果裝置不在可用裝置清單中，請輕按 **Supported Devices (支援裝置)**，選取裝置類型 (雪櫃)，再選取特定的裝置型號。

依循應用程式的指示設定裝置。一旦完成設定，雪櫃將顯示為 **Devices (裝置)** 畫面上的「卡片」。

雪櫃應用程式

整合式控制

您可以在家中或在外活動時監視並控制雪櫃。

- 輕按 SmartThings 儀表板上的雪櫃圖示，或輕按儀表板底部的裝置圖示，然後按雪櫃「卡片」以開啟雪櫃頁面。
- 檢查您的雪櫃相關運作狀態或通知，然後在必要時變更選項或設定。

注意

雪櫃的某些選項或設定可能不能用遠端控制。



運作

| 類別 | 項目 | 說明 |
|----------------------------|------|---|
| 監視 | 雪櫃溫度 | 顯示雪櫃目前的溫度設定。 |
| | 能源監視 | 檢查雪櫃過去 180 天的累計耗電量。 |
| 功能 | 急速冷藏 | 您可以開啟或關閉急速冷藏，並檢查目前的設定。 |
| 警示音 | 異常高溫 | 當雪櫃出現異常高溫，便會觸發警示音。 |
| | 門敞開 | 如果雪櫃或冰格門敞開 2 分鐘以上，便會觸發這個警示。 |
| AI Energy Mode (僅限適用型號) | | 您可以在 SmartThings 應用程式的能源選單下，開啟或關閉 AI Energy Mode。 您可以在 SmartThings 應用程式上檢查 AI Energy Mode 的狀態。 在特定型號上，  圖示出現在控制面板上時意指 AI Energy Mode 正在運作。 (僅限適用型號) 開啟 AI Energy Mode 以降低耗電量，但也可能降低冷卻效能。 |

特殊功能

雪櫃的實圖和特殊功能可能會因機型和國家/地區而異。

製冰 (僅限適用型號)

扭轉製冰盒 (僅限適用型號)

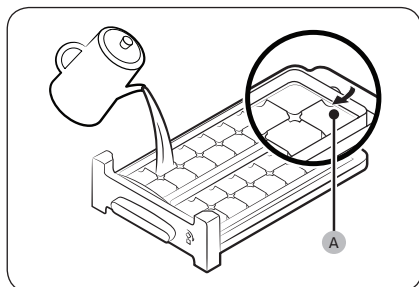

1. 打開冰格門，輕輕推開冰塊盒。
2. 將冰塊盒注滿水至冰塊盒內後方標示的**最高水位 (A)**。
3. 將冰塊盒推回至定位。

注意

製冰時間取決於溫度設定。

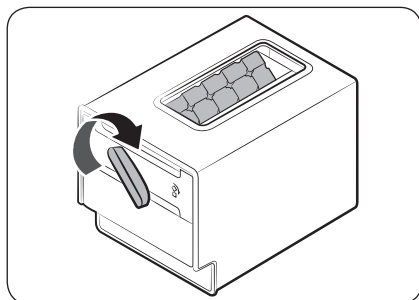

注意

- 確保儲冰桶位於冰塊盒下方。
- 若要分配冰塊，請將冰塊盒把手向右轉動，將一半的冰塊倒入冰桶中。然後再向左轉動以清空另一半冰塊。
- 若要取出冰桶，請往前拉出。
- 如果冰格層板底下放不下扭轉製冰盒，請將其放在層板上。

運作

自動製冰機的水箱 (僅限適用型號)

將水箱注滿飲用水 (僅限適用型號)

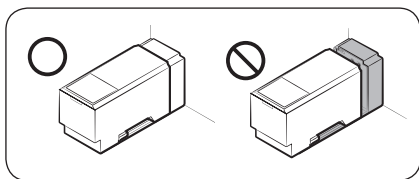
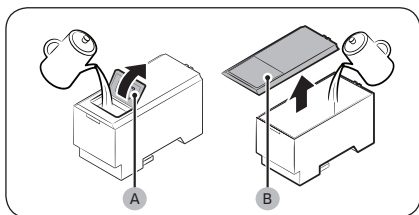
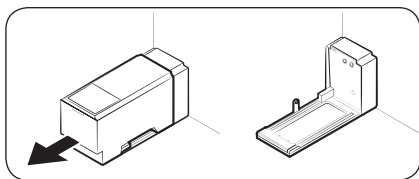

首次使用時，清潔水箱內側，並完全擦乾。

1. 雙手握住手把，然後往前拉，即可取出。

2. 打開蓋子 (A) 或整個外蓋 (B)，將水箱注滿水。

⚠ 警示

請勿超過滿格線。留意水溢出情況。

3. 重新裝入水箱，並將其安裝至飲水機裝置中。確保外蓋上的較小蓋子面朝前。

⚠ 警示

- 確實將水箱置入層板。否則，水箱可能無法正常運作。
- 水箱只能裝飲用水，例如礦泉水或純淨水。請勿使用其他液體。
- 裝滿水的水箱很重，因此在移動裝滿水的水箱時務必小心。如果水箱掉落，可能會造成身體受傷。
- 請勿嘗試自行拆卸內部泵浦。如果內部泵浦損壞或與水箱中斷連接，自動製冰機便無法運作。

📌 注意

如果您沒有使用自動製冰機，可以取出水箱以空出更多貯藏空間。

自動製冰機（僅限適用型號）
雪櫃的製冰機會自動配送冰塊。

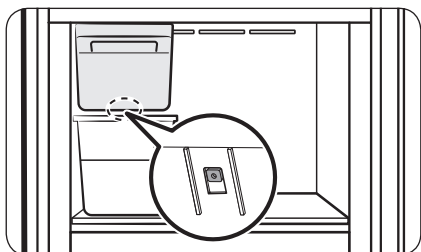
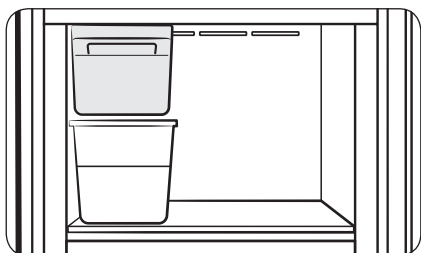

第一次使用時

- 將水箱注滿水後，讓製冰機製冰 1-2 天。
- 丟棄前 1-2 桶的冰塊，以去除供水系統中的雜質。

診斷

如果自動製冰機不製冰，請取出冰桶並按下 **Test（測試）** 按鍵，檢查自動製冰機是否能正常運作。

⚠ 警示

- 當自動製冰機啟動時，即使取出冰桶，雪櫃仍會繼續製冰。如果您不打算使用自動製冰機，請關機。
- 當雪櫃經斷電後再恢復供電時，冰桶中可能混合了融化和卡住的冰塊，這會妨礙製冰機正常運轉。為防止這種情況發生，請務必在使用雪櫃前先清空冰桶。
- 請勿將手指或其他物體放在製冰機中。否則會造成身體受傷或財產損失。
- 由於昇華作用，長時間存放在冰格中的冰會縮小，然後形成大塊冰。因此，如果確定長時間內不需用到冰塊，請將製冰機關閉。

📌 注意

如果您沒有使用自動製冰機，可以取出冰桶以空出更多貯藏空間。

運作

保鮮區 (僅限適用型號)

保鮮區是一個獨立控制的隔間，可以在最佳溫度下儲存不同的物品。

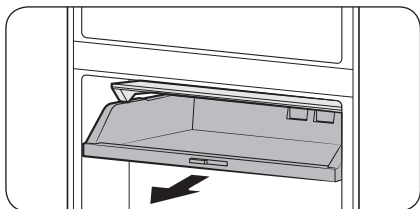

抓住保鮮區底部並拉出，以將食品放入貯存，或從中取出食品。

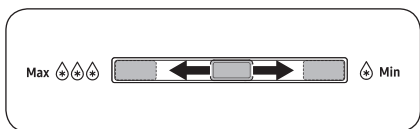

您可以調整保鮮區的溫度。

- 若要調高溫度，可將溫控滑桿推向右側。
- 若要調低溫度，可將溫控滑桿推向左側。

飲水器 (僅限適用機型)

有了飲水器，不需要打開雪櫃門就可以供應水。使用前須將水箱裝滿飲用水。

將水箱裝滿飲用水

打開櫃門，找到位於門層架區域內的水箱。

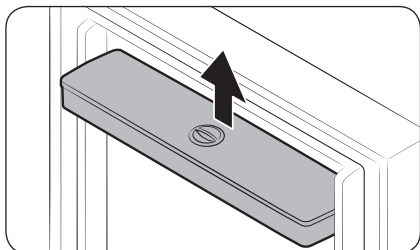

1. 抓住水箱兩端，往上提後取出。

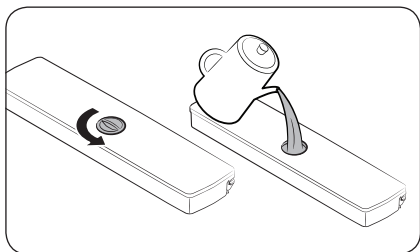

2. 將水箱裝滿飲用水。取下蓋子並倒水。

注意

首次使用水箱前，請徹底清潔水箱，尤其是噴嘴部位。定期清潔水箱和噴嘴。

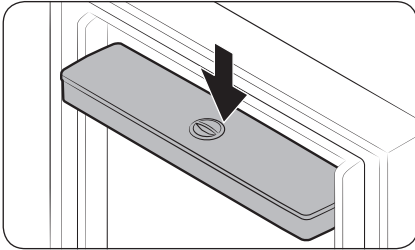

3. 重新裝入水箱並關上雪櫃門。確認水箱出水口朝向前。

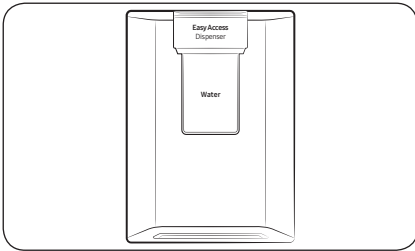

4. 將水杯放在飲水器的出水口下方，然後輕按飲水器手柄即可供應水。

⚠ 警示

- 飲水器設計為供應飲用水。水箱僅裝填飲用水。請勿裝填其他液體。
- 請勿裝填過多飲用水，以免滿溢。
- 未從雪櫃門取下水箱前，不要將水注入水箱。
- 確定水箱安裝正確。
- 請勿使用未附帶水箱的雪櫃。這可能使效能和效率降低。
- 為防止水彈跳，務必將水杯與飲水器手柄對齊。

📖 注意

要挪出更多空間，可使用水箱存放食物。在此情況下，可將水箱蓋移開。

維護

處理和保養

層板 (雪櫃/冰格室)

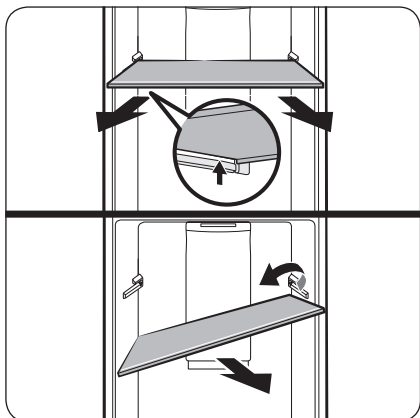

若要取下層板，請用雙手抓住兩端並抬起，再從後掛鉤鬆開。然後，將一側傾斜並拉出。

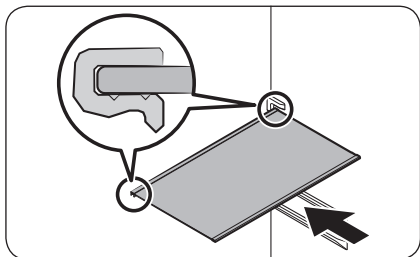

在裝入層板之前，先檢查層板背面的形狀。然後，按照與拆卸相反的順序裝回層板。

⚠ 警示

- 層板必須正確裝入。請勿將其以上下或前後倒置方式裝入。
- 層板很重，請小心處理。

蔬菜抽屜

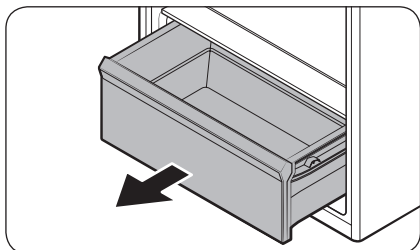

輕輕抬起抽屜前端並滑出。

蔬菜層板

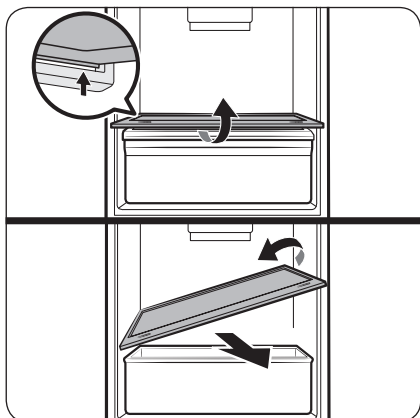

用雙手抓住蔬菜層板，抬起並從後掛鉤鬆開。然後，將一側傾斜並拉出。

櫃門層架

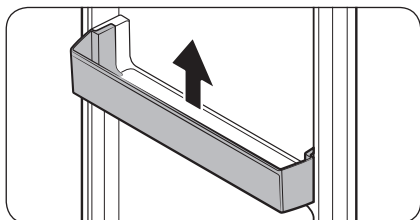

輕輕抬起並向外拉出櫃門層架。

⚠ 警示

為了防止事故，櫃門層架卸下前須先清空。

維護

清潔

⚠ 警告

- 請勿使用苯、稀釋劑或家用/汽車用清潔劑（例如 Clorox™）用於清潔用途。這些可能會使雪櫃的表面受損，以及引發火災。
- 請勿對雪櫃噴水。這可能會造成觸電。

定期使用乾布去除所有異物，像是灰塵或出自插頭和接觸點的水漬。

1. 拔下雪櫃的電源線插頭。
2. 使用一塊濕潤、柔軟且不起毛的布或紙巾，清潔雪櫃的內部和外部。
3. 完成時，請使用乾布或紙巾擦乾。
4. 將雪櫃電源線插入插座，即可啟動雪櫃。

📖 注意

如果您將像層板這類可拆卸零組件拆下來清潔，請參考**雪櫃概覽**一節的總配置圖，確保能正確裝回該零組件。

更換

除臭過濾器 (僅限適用型號)

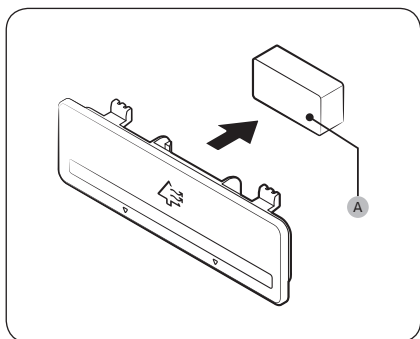

握住過濾器外殼上下兩端，拆開外殼可看到除臭過濾器 (A)。更換過濾器後，裝回外殼。

照明燈和保鮮過濾器

照明燈和保鮮過濾器都不是耐用品。請勿自行更換。若要更換，請洽詢當地 Samsung 服務中心。

⚠ 警告

- 燈號非用戶可自行維修部分。請勿自行換燈。因為可能有觸電風險。

燈 (光源)

本產品包含能源效率等級的光源 <G>。

燈和/或控制裝置都不是耐用品。若要更換產品中的燈泡和/或控制裝置，請洽詢當地的 Samsung 服務中心。

如需有關更換產品中的燈泡或控制裝置的詳細說明，請瀏覽 Samsung 網站 (<http://www.samsung.com>)，前往產品支援 > 產品支援首頁，然後輸入型號名稱。

如需有關拆卸燈和/或控制裝置的詳細說明，只需遵照上述更換說明操作即可。

故障排除

在請求維修服務之前，請先查看以下檢查點。有關正常狀況（無瑕疵案例）的所有叫修均會向用戶收取費用。

一般

溫度

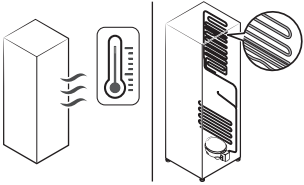
| 症狀 | 可能原因 | 解決方案 |
|--------------------------|-------------------|--|
| 雪櫃/冰格未運轉。 雪櫃/冰格溫度是溫的。 | • 電源線未正確插上。 | • 正確插上電源線。 |
| | • 溫度控制未正確設定。 | • 將溫度設低一點。 |
| | • 雪櫃位置靠近熱源或陽光直射。 | • 使雪櫃免於陽光直射或遠離熱源。 |
| | • 雪櫃與側邊/後面間的空隙不夠。 | • 建議在雪櫃和附近牆壁（或箱體）間的空距超過 50 mm。 |
| | • 假日模式啟用。 | • 停用假日模式。 |
| | • 雪櫃過載。食物堵住雪櫃通風口。 | • 勿使雪櫃過載。勿讓食物堵住通風口。 |
| 雪櫃/冰格過冷。 | • 溫度控制未正確設定。 | • 將溫度設高一點。 |
| 內壁溫度高。 | • 雪櫃在內壁中設有耐熱管道。 | • 為防止產生冷凝，雪櫃在前方角落設有耐熱管道。若周邊溫度升高，此設備可能無法有效運作。這不是系統故障。  |

異味

| 症狀 | 可能原因 | 解決方案 |
|--------|------------|-------------------|
| 雪櫃有異味。 | • 食物變質。 | • 清理雪櫃並取出所有變質的食物。 |
| | • 氣味濃烈的食物。 | • 務必密封包裝氣味強烈的食物。 |

冷凝

| 症狀 | 可能原因 | 解決方案 |
|-----------|------------------|--------------------|
| 內壁出現冷凝現象。 | • 如果門開著，水氣會進入雪櫃。 | • 去除水氣，並且勿讓門長時間開著。 |
| | • 高水分的食物。 | • 務必密封包裝食物。 |

水/冰 (僅限自動製冰機型號)

| 症狀 | 可能原因 | 解決方案 |
|----------|------------------|---------------------|
| 製冰機沒有製冰。 | • 冰格室不夠冷。 | • 確定冷風出口未堵塞。 |
| | • 製冰機的電線接頭沒有接好。 | • 確定電線外殼的電線接頭已正確連接。 |
| | • 流向製冰機的水管彎曲或扭結。 | • 確定雪櫃後面的水管沒有彎曲或扭結。 |

故障排除

您聽到冰箱的異常聲音了嗎？

請求維修服務之前，請查看下面相應檢查點。關於正常聲音的任何服務電話，將向使用者收取費用。

這些聲音是正常的。

- 當開始時間或結束運行時，冰箱可能發出類似汽車發動機點火的聲音。運行穩定時，聲音會減弱。

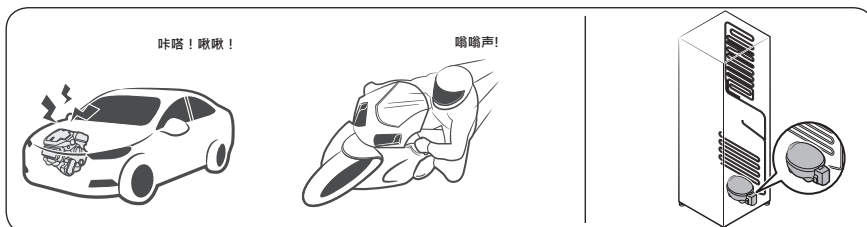

- 當風扇運行時，可能會發出這些聲音。當冰箱達到設定的溫度時，不會發出風扇聲音。



- 在除霜週期中，水可能滴到除霜加熱器上，發出滋滋聲。



- 如冰箱冷卻或冷凍時，製冷劑氣體穿過密封管道，發出冒泡的聲音。



- 當冰箱溫度升高或降低時，塑膠部件收縮和擴張，會發出敲擊的雜音。在除霜週期或當電子部件在運行時，會發出這些雜音。

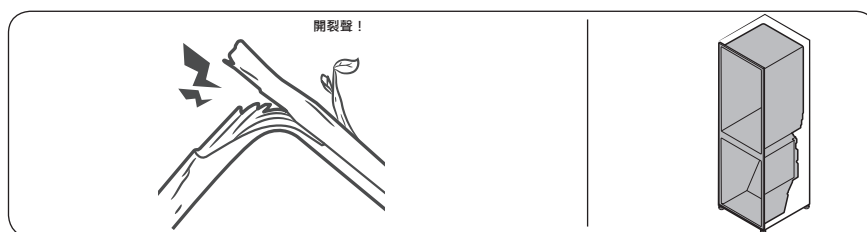

- 對於製冰機型號：當水閥打開，為制冰機充水時，會發出嗡嗡的聲音。
- 當打開和關上冰箱門時，由於壓力均衡的原因，可能會發出嗖嗖的聲音。

故障排除

SmartThings (僅限適用型號)

| 症狀 | 操作 |
|---|--|
| 在應用程式市集中找不到「SmartThings」。 | <ul style="list-style-type: none">支援的 SmartThings 應用程式軟體版本會依循製造商提供的 OS 支援政策而更改，恕不另行通知。此外，關於 SmartThings 應用程式或應用程式所支援的功能，針對現有的 OS 版本制定的新應用程式更新政策，可能會因實用性或安全性的原因而暫停使用。 |
| SmartThings 應用程式無法運作。 | <ul style="list-style-type: none">SmartThings 應用程式僅在適用的型號上可用。舊的 Samsung Smart Refrigerator 應用程式無法與 Samsung Smart Home 型號連線。 |
| SmartThings 應用程式已安裝，但未連線到我的雪櫃。 | <ul style="list-style-type: none">必須登入您的 Samsung 帳戶，才可使用應用程式。請確保路由器運作正常。如果雪櫃顯示幕上的 Wi-Fi 圖示已關閉，表示尚未建立網絡連線。在此情況中，可使用 SmartThings 應用程式連線，並將您的雪櫃登錄到屋子的存取點 (AP)。 |
| 無法登入應用程式。 | <ul style="list-style-type: none">必須登入您的 Samsung 帳戶，才可使用應用程式。如果您沒有 Samsung 帳戶，按照應用程式的螢幕上指示建立一個帳戶。 |
| 當我嘗試登錄我的雪櫃時，出現訊息。 | <ul style="list-style-type: none">簡易連線可能會由於與您的存取點 (AP) 的距離或周圍環境的電氣干擾而造成連線失敗。稍等片刻，然後重試。 |
| SmartThings 應用程式成功連線到我的雪櫃，但無法執行。 | <ul style="list-style-type: none">退出並重新啟動 SmartThings 應用程式，或中斷連線後重新連接路由器。關閉雪櫃電源，1 分鐘後再開啟。 |
| Wi-Fi 圖示在閃爍。 () | <ul style="list-style-type: none">使用前，先用 SmartThings 應用程式連接您的雪櫃。成功連線後，指示器便會停止閃爍。<ul style="list-style-type: none">如果無法連線或不想要使用應用程式，請按住 Fridge (雪櫃) 按鍵 10 秒。指示燈停止閃爍。 |

Open Source Announcement

The software included in this product contains open source software.

The following URL http://opensource.samsung.com/opensource/SMART_TP1_0/seq/0 leads to open source license information as related to this product.





異丁烷
iso-butane
R600a

維修工作只能由維修廠內受過專業訓練的維修人員負責執行。

- 雪櫃背後和內部的製冷系統包含製冷劑。
 - 請勿讓任何尖銳物體接觸製冷系統。
 - 請勿在雪櫃內部使用其他電器設備。
 - 應監督兒童以確保正確使用雪櫃。
 - 請勿使用機械裝置或其他方法加速解凍流程，但廠商建議的方式例外。
 - 請勿堵塞與雪櫃相關的任何出口。
 - 如果製冷劑迴路損壞，請勿在附近使用電器或消防設備，務必打開所有窗戶以保持良好的通風。
- 也請聯絡您當地維修廠，請相關人員協助處理後續事宜。

備忘錄

備忘錄

備忘錄

聯絡三星網站

如果您對我們三星產品有任何問題或意見，歡迎與三星客戶服務中心聯絡。

| 国家或地区 | 聯絡中心 | 網站 |
|-----------|--|--|
| HONG KONG | 3698 4698 (All Product) 3698 4688 (B2B) 3698 4633 (eStore) 2121 9088 (Samsung pay) | www.samsung.com/hk/support (Chinese) www.samsung.com/hk_en/support (English) |
| MACAU | 0800 333 | www.samsung.com/hk/support (Chinese) www.samsung.com/hk_en/support (English) |



DA68-04657W-00