



West Pincer Terrace and Lounge



Room Dimensions

4,000 sq. ft. – West Pincer Terrace
 1,548 sq. ft. – West Lounge
 Mezzanine Level

Overview

Views of the Austin skyline and Town Lake park can be seen from the West Terrace’s open air space, which sits on the west side of the building.

Connected to the lounge is a large lounge space, perfect for reception areas.

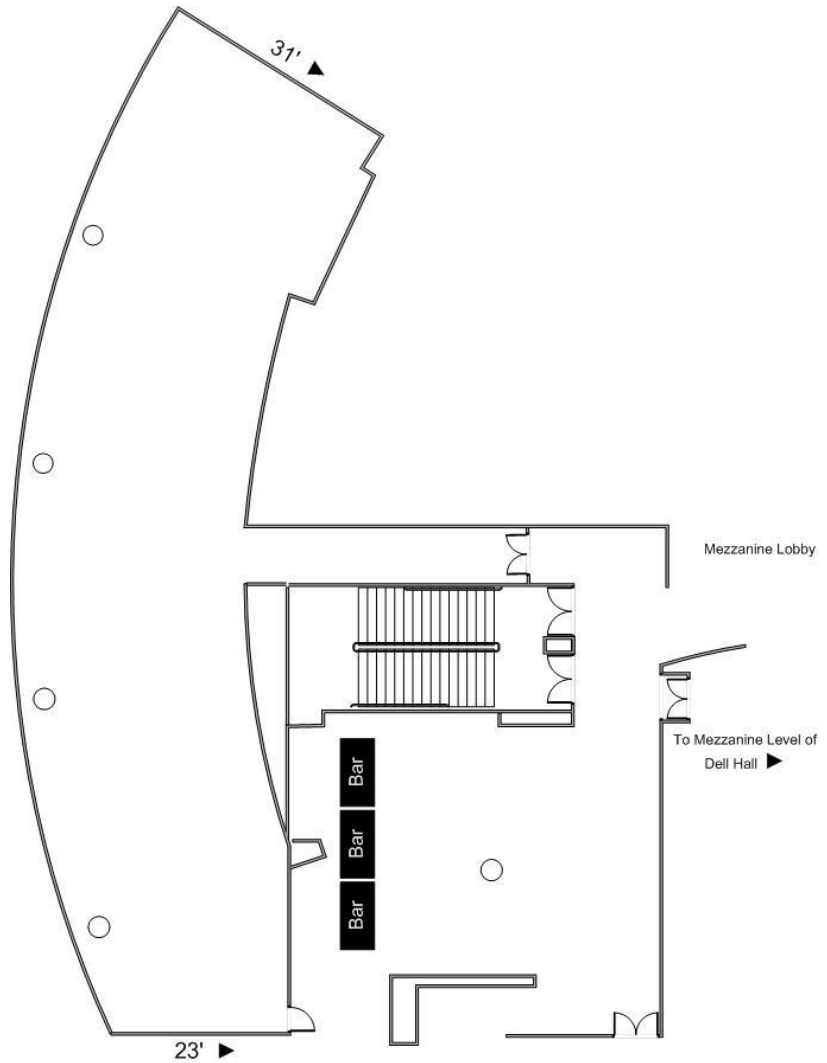

Room Capacities

(all capacities are based on the room with all furniture removed)

	Rounds of 8	Rounds of 10	Reception
West Pincer Terrace	200 people	200 people	250 people
West Lounge	---	---	77 people