

01 BASEMENT PROPOSED FLOOR PLAN
SCALE: 1/4" = 1' - 0"

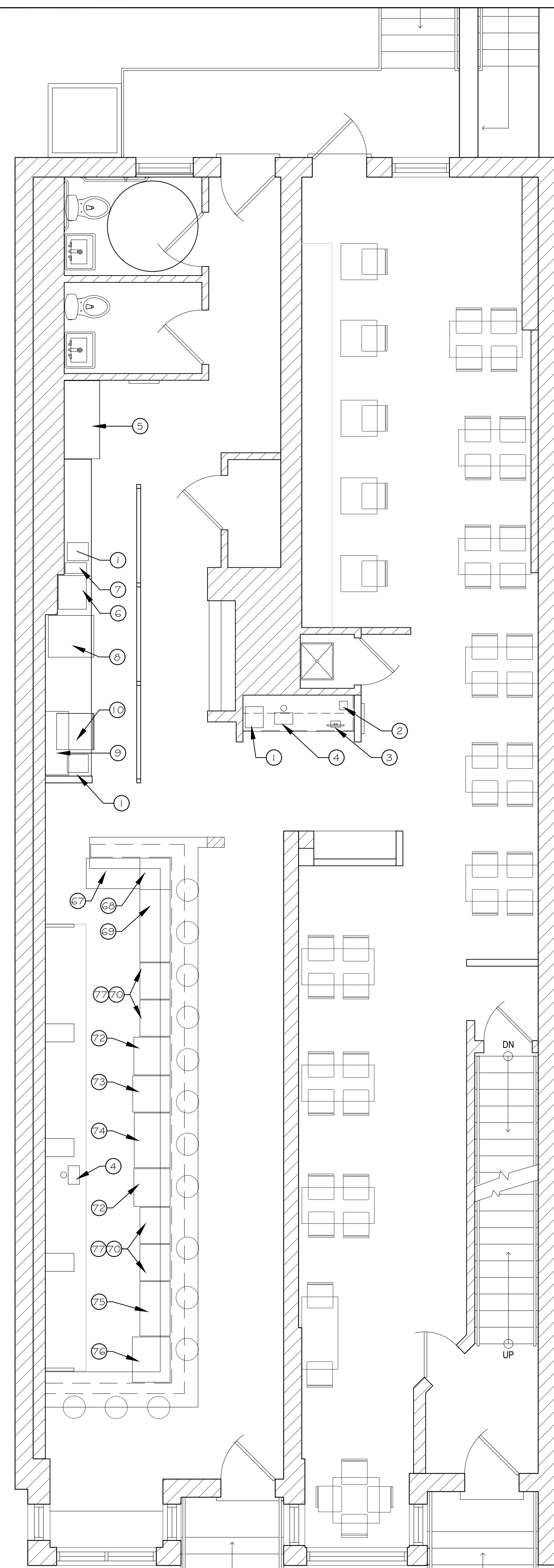

01 BASEMENT PROPOSED FLOOR PLAN
SCALE: 1/4" = 1' - 0"

EQUIPMENT SCHEDULE

EQUIPMENT NUMBER	Q	EQUIPMENT NAME
1	3	DI-1-25 HAND SINK
2	2	EPSON MT-T20II
3	3	TOAST HARDWARE
4	2	VERO TOWER 70
5	1	WINE COOLER
6	1	ESPRESSO MACHINE
7	1	USHW2 BUNN 2 GALLON HOT WATER TOWER
8	1	UNDER COUNTER REFRIGERATOR
9	1	WALL MOUNTED GLASS RACK SHELF
10	1	UNDER COUNTER GLASS WASHING MACHINE (TBD)
11	1	EXISTING ICE MACHINE
12	1	PREP SINK
13	1	HAND SINK
14	2	COMBI OVEN
15	2	ALTO-SHAAM COOK AND HOLD
16	1	HOBART MIXER
17	1	18 BY 36 POT RACK FOR HOBART MIXER
18	1	SHEETER FOR PASTRY
19	1	BLAST CHILLER
20	1	ICE CREAM SPINNER
21	2	72 BY 30 IN PREP TABLES
22	2	72 BY 24 IN PREP TABLE
23	2	SPEED RACKS
24	1	ASC320_320X_420 SHEETER
25	1	APC7 PASTA CART
26	1	AEX30-8 EXTRUDER
27	1	INDUCTION BURNER
28	1	36 BY 84 OPEN BASE WORK TABLE
29	1	DTS-530-72 6 FOOT SOIL DISH DROP TABLE
30	1	WAREWASHER
31	1	DTC-530-24L
32	1	3 COMPARTMENT SINK FROM PREP ROOM TO BE MOVED AND SET HERE
33	1	SLAG-180-X 18 BY 30 TABLE
34	2	HAND SINK
35	1	VCR2 ADANDE (HIGH CASTER BASE)
36	3	EACH LINE LOWBOYS
37	1	PASTA FREEZER
38	2	CEILING MOUNTED SHELF 18 BY 60 WITH FLAT ENDS FOR A TICKET RAIL
39		NOT USED
40	1	TILT SKILLET
41	1	12 INCH OPEN BURNER
42	1	48 INCH HOT TOP
43	1	HESTAN OVEN BASE

EQUIPMENT NUMBER	Q	EQUIPMENT NAME
44	1	HFR118 FRYER
45	1	MICROWAVE
46	1	PASTRY LOWBOY (UNDERCOUNTER CASTER5)
47		NOT USED
48	1	K55-306 WORK TABLE
49	1	60W BY 15D BY 2.5H HEAT LAMP
50	1	42W BY 15D BY 2.5H HEAT LAMP
51	1	SLAG-184-X 18 BY 48 TABLE
52	2	EACH STEAM TABLE
53	1	TTS188-X HOT LINE PASS
54	1	GOODOS189G SHELF ABOVE HOT LINE PASS
55	1	TTS185-X COLD LINE PASS
56	1	54A. GOODO1860 SHELF ABOVE COLD LINE PASS
57	1	POWER PLUG REQUIREMENTS
58	1	POWER PLUG REQUIREMENTS
59	1	POWER PLUG REQUIREMENTS
60	1	COFFEE/TEA BREWER
61	1	EXISTING CHEST FREEZER (ITS IN THE PREP KITCHEN NOW)
62	1	HAND SINK 7-P5-23
63	1	EXISTING MOP SINK
64	2	EACH 30 BY 60 K55-305
65	1	EACH 30 BY 60 K55-305
66	1	EACH 30 BY 60 K55-305
67	1	refrigerator IMDERV25II
68	1	CUSTOM STAINLESS STEEL FILLER SHELF
69	1	bar sink PRB_19-42-C
70	4	PRI-19-24-XD
71		NOT USED
72	2	PRCR-19-24
73	1	glass washer GUXSPECSHEET
74	1	IMD-ERV3GIIGD
75	1	PRB-19-32R
76	1	PLD-2530
77	4	SKR-2
78	1	EXISTING TOP DOOR REFRIGERATOR
100	1	36" MOUNTED SHELF
101	1	30" HEAT LAP

JON HENSLEY ARCHITECTS

JON HENSLEY ARCHITECTS, P.L.L.C.
ARCHITECT
927 SOUTH WALTER REED DRIVE
SUITE 3
ARLINGTON, VA 22204

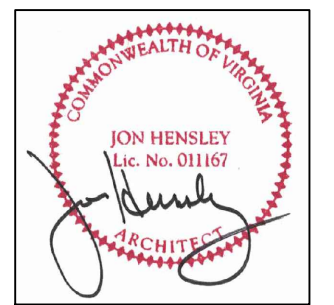

THOMPSON ITALIAN
1024 KING STREET
ALEXANDRIA VA 22314

EQUIPMENT SCHEDULE

PROJECT NUMBER: 772

ISSUED:

PERMIT SET 05/12/2022
CONTRACTOR SET 06/9/2022

COPYRIGHT. © 2022

A-002