

**GENERAL NOTES**

1. THE CITY OF ALEXANDRIA TAX ASSESSMENT MAP NUMBERS FOR THIS SITE ARE 078.02-01-08, 078.02-01-09, 078.02-01-13, 078.02-01-22, 078.02-01-23, 072.02-02-12, 072.04-03-26, 072.04-03-38 072.03-04-08 AND 072.04-04-09.
2. THE SITE CONTAINS APPROXIMATELY 78.90 ACRES (ENTIRE CDD #2).
3. THE BOUNDARY SURVEY WAS PREPARED BY christopher consultants, Ltd. BETWEEN THE YEARS OF 1998 AND 2021.
4. THE TOPOGRAPHIC SURVEY WAS OBTAINED FROM christopher consultants, Ltd. BETWEEN THE DATES OF 1998 AND 2021.
5. THE SITE IS CURRENTLY DEVELOPED AS THE HOFFMAN TOWN CENTER. THERE ARE NO NATURAL FEATURES ON THE SITE THAT NEED TO BE PRESERVED OR PROTECTED. THERE IS A RESOURCE PROTECTION AREA (RPA) BUFFER ON SITE. MODIFICATIONS TO THIS AREA WILL BE IN ACCORDANCE WITH CURRENT CITY OF ALEXANDRIA REQUIREMENTS FOR REDEVELOPMENT WITHIN THE RPA. THERE IS A WETLAND OF MINIMAL ECOLOGICAL VALUE ON THE PROPERTY AND ANY PERMITS REQUIRED FROM THE COE WILL BE OBTAINED.
6. ADVERSE IMPACTS TO NEIGHBORING PROPERTIES FROM INTENSITY OF DEVELOPMENT RESULTING FROM A FUTURE DSUP WILL BE MITIGATED THROUGH GREEN BUILDING PRACTICES, TMPS, AFFORDABLE HOUSING, DEVELOPER CONTRIBUTIONS, NEW ROADWAYS AND STREETSCAPES, OPEN SPACE, DEVELOPMENT CONDITIONS, ETC. ALL SPECIFIED DURING THE DSUP PUBLIC REVIEW PROCESS.
7. REFER TO THE TABLE ON SHEET C200 FOR THE MAXIMUM HEIGHT OF ANY BUILDING ON THIS SITE.
8. THE PROJECT WILL MEET THE PARKING REQUIREMENTS AS PART OF THE DSUP PROCESS FOR EACH BLOCK. (5-604-C (8)).
9. SIGNIFICANT GROUND LEVEL PUBLIC OPEN SPACE TO BE CREATED AS PART OF THE PROJECT. SUSTAINABILITY GOALS, STORMWATER MANAGEMENT IMPROVEMENTS AND SPECIFIC AMENITIES FOR EACH BLOCK TO BE DETERMINED AT EACH DSUP SUBMISSION. (5-604-C (9)), (5-604-C (11)). REFER TO THE CHART ON SHEET C200 FOR AMOUNT OF OPEN SPACE PROVIDED. AS PART OF THIS CDD, THERE WILL BE PEDESTRIAN AND BICYCLE NETWORK IMPROVEMENTS. THE DETAILS OF THE IMPROVEMENTS WILL BE PROVIDED AT THE TIME OF THE DSUP PROCESS FOR EACH BLOCK, BUT REFER TO SHEET C500 FOR A SCHEMATIC LAYOUT OF BICYCLE NETWORK IMPROVEMENTS.
10. TO THE BEST OF OUR KNOWLEDGE THERE ARE NO MARINE CLAYS ON SITE. (5-604-C (14)).
11. TO THE BEST OF OUR KNOWLEDGE CONTAMINATED SOIL MAY BE ON SITE. (5-604-C (15)).
12. FOR BLOCKS 2, 3 AND 9 THERE MAY BE UNUSUAL AND SPECIFIC SITUATIONS, SUCH AS BLOCK SHAPE, SIZE, AND GEOMETRY, WHERE THE APPLICANT CAN DEMONSTRATE IT IS INFEASIBLE TO PROVIDE ACTIVE SCREENING OR ARCHITECTURAL TREATMENTS THAT ARE INDISTINGUISHABLE FROM ACTIVE SCREENING AS RECOMMENDED BY THE PLAN. IN THOSE CASES THE APPLICANT WILL DEMONSTRATE HOW THE PROJECT MEETS THE SAP URBAN DESIGN GOALS.

**COORDINATED DEVELOPMENT DISTRICT #2  
CONCEPTUAL DESIGN PLAN  
ALEXANDRIA, VIRGINIA**

VICINITY MAP  
SCALE 1"= 350'



**PROJECT NARRATIVE**

THE APPLICANTS ARE FILING THIS CDD CONCEPT PLAN FOR CDD #2 TO ADDRESS BLOCKS 2, 3, 7, 9, 11, 12, 14 AND 20. THIS AREA INCLUDED AS PART OF CDD SHALL STILL COMPLY WITH THE GUIDELINES SET FORTH IN THE EISENHOWER EAST SMALL AREA PLAN (EESAP). THE APPLICANT SEES AN OPTION TO REMOVE BLOCK 3 ROAD, OPEN SPACE, BIKE CONNECTIONS, AND COMPLETE STREETS WILL BE PROVIDED IN THIS CDD PER THE EESAP GUIDELINES TO PROMOTE GROWTH AND CONNECTIVITY BETWEEN THE BLOCKS WITHIN THE EISENHOWER EAST AREA.

ALL OTHER BLOCKS WITHIN THIS CDD THAT ARE NOT PART OF THIS APPLICATION AND ARE INCLUDED FOR REFERENCE ONLY.

SHEET INDEX

C000	COVER SHEET
C100	EXISTING CONDITIONS PLAN
C200	PROPERTY OWNERSHIP INFORMATION
C300	CDD CONCEPT PLAN
C301	BLOCK 3 ALTERNATE LAYOUT EXHIBIT
C400	OPEN SPACE EXHIBIT
C500	BIKE CONNECTION EXHIBIT
C600	STREET CROSS SECTION EXHIBIT
C700	STREET HIERARCHY
C701	SOUTHERN STREET UNDER WMATA TRACKS EXHIBIT

PROFESSIONAL SEAL AND SIGNATURE	DATE	REVISION
	02-11-2022	FIRST SUBMISSION
	07-07-2022	SECOND SUBMISSION
	09-25-2023	THIRD SUBMISSION
	11-03-2023	FOURTH SUBMISSION

<p>APPLICANT</p> <p><b>HOFFMAN FAMILY, LLC</b> 2034 EISENHOWER AVE, SUITE 290 ALEXANDRIA, VA. 22331</p>	<p>APPLICANT</p> <p><b>PARADIGM DEVELOPMENT COMPANY, LLC</b> 1515 NORTH COURTHOUSE ROAD, SUITE 600 ARLINGTON, VA 22201</p>
<p>CIVIL ENGINEER</p> <p><b>CHRISTOPHER CONSULTANTS, LTD.</b> 4035 RIDGE TOP ROAD SUITE 601 FAIRFAX, VIRGINIA 22030</p>	<p>ATTORNEY</p> <p><b>WIRE GILL</b> 700 N FAIRFAX ST SUITE 600 ALEXANDRIA, VA 22314 <small>(NEW WIRE REPRESENTING HOFFMAN FAMILY, LLC) (MARY CATHY RINE CROSS REPRESENTING PARADIGM DEVELOPMENT COS)</small></p>
	<p>ARCHITECT</p> <p><b>COOPER CARRY</b> 625 N WASHINGTON ST., STE. 200, ALEXANDRIA, VA 22314</p>

Block	Principal Land Use	Minimum Percentage Commercial	Maximum Building Height (ft.)	Minimum Building Height (ft.)	Required On-Site Accessible Open Space (sq. ft.)	Approximate Block Area (Ac.)	Approximate Block Area (sq. ft.)	Project Total GSF Without GSF Garage (sq. ft.)	Retail Focus Areas	Proposed For Redevelopment
Block 1	Residential and Commercial	N/A	150'	N/A	18,500	2.79	121,532	101,000	No	No
Block 2A/B	Residential and Commercial	30%	300'	150'	41,500	4.2	384,694	1,500,000	No	Yes
Block 3A/B	Residential and Commercial	30%	150'	125'		3.0	129,809	1,250,000	No	Yes
Block 4/5	Residential and Commercial	30%	150'	125'	10,900	5.1	220,849	1,755,000	Yes	No
Block 6A	Residential	0%	300'	150'	0	1.5	64,033	665,512	Yes	No
Block 6B/C	Residential and Commercial	60%	300'	150'	16,000	3.1	136,712	162,066	Yes	No
Block 7	Commercial	100%	300'	150'	0	2.3	91,040	79,000	Yes	No
Block 8	Commercial	100%	350'	175'	0	1.8	77,517	697,471	Yes	No
Block 9A	Residential and Commercial	30%	300'	150'	200'	1.5	68,647	600,000	No	Yes
Block 9B	Residential and Commercial	60%	400'	200'	24,000	1.8	78,408	1,600,000	Yes	Yes
Block 10A	U/I/Open Space	0%	50'	N/A	0	3.1	133,424	8,000	No	Yes
Block 10B	U/I/Open Space	0%	50'	N/A	64,000	0.2	10,716	0	No	No
Block 11	Residential and Commercial	0%	400'	200'	40,000	2.4	104,544	1,300,000	No	Yes
Block 12	Residential and Commercial	0%	350'	175'	0	1.3	56,182	1,250,000	No	Yes
Block 13	Residential	0%	300'	150'	0	1.3	57,194	490,000	No	No
Block 14	Commercial	100%	250'	125'	0	2.8	120,661	18,000	No	No
Block 15/15A	Residential and Commercial	30%	200'	100'	0	2.3	100,188	490,772	No	No
Block 16	Commercial	100%	150'	75'	0	0.8	33,062	127,000	No	No
Block 17	Commercial	100%	250'	125'	0	1.3	54,450	406,000	No	No
Block 18	Residential	0%	300'	150'	0	1.5	63,598	525,000	No	No
Block 19	Residential	0%	300'	150'	55,000	2.3	101,495	432,000	No	No
Block 20	Residential and/or Commercial	0%	300'	150'	35,300	3.0	132,422	385,000	No	Yes
Block 21	Residential and/or Commercial	0%	250'	125'	0	1.2	53,979	402,000	No	No

Notes:  
 1. Minimum percentage commercial area can be allocated between blocks to achieve minimum commercial area above.  
 2. Open space can be transferred among blocks.  
 3. Blocks highlighted in gray are included in this CDD Conceptual Design Plan.  
 4. All properties above are located in CDD #2 zone.

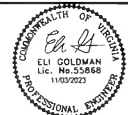
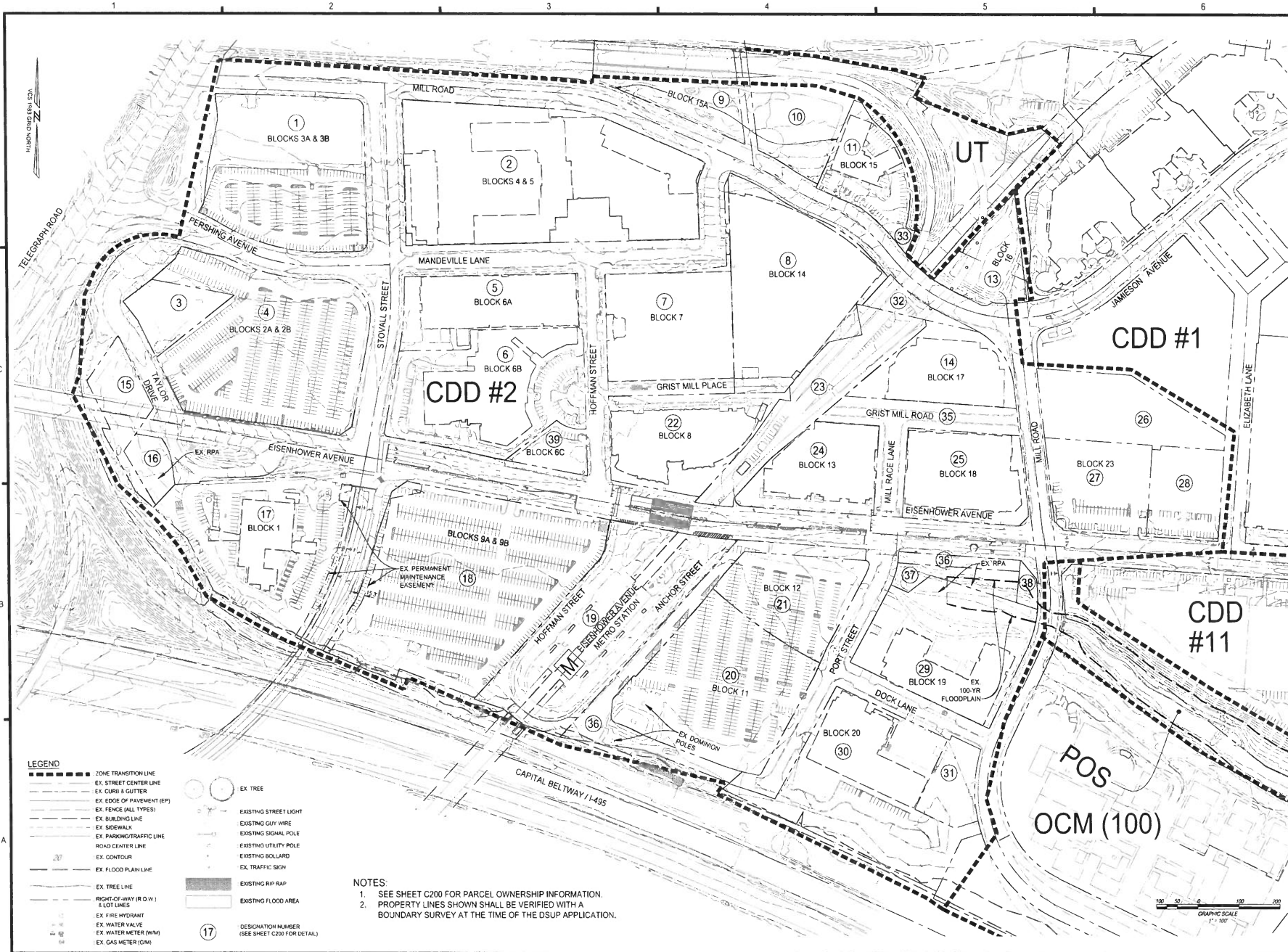

**COORDINATED DEVELOPMENT  
 DISTRICT #2  
 CONCEPTUAL DESIGN PLAN  
 CITY OF ALEXANDRIA, VIRGINIA**

NO.	DATE	DESCRIPTION
1	03/11/2022	CDD AMENDMENT SUBMISSION #1
2	07/14/2022	CDD AMENDMENT SUBMISSION #2
3	06/26/2023	CDD AMENDMENT SUBMISSION #3
4	11/03/2023	CDD AMENDMENT SUBMISSION #4

PROJECT No. 20005.005.00  
 DRAWING No. 111404  
 DATE 02/11/22  
 SCALE: SEE SHEET  
 DESIGN: EG  
 DRAWN: HQ  
 CHECKED: QMW

**EXISTING CONDITIONS PLAN**

SHEET No. **C100**

**CURRENT PROPERTY OWNERS**

DESIGNATION	BLOCK	MAP #	ADDRESS	OWNER	USES	PROPOSED FOR REDEVELOPMENT
1	Blocks 3A & 3B	072.02-02-12	2425 Mill Rd.	Hoffman Family LLC	Vacant Land Commerc. (941)	YES
2	Blocks 4 & 5	072.04-03-41	2424 Mill Rd.	HTC 4/5 Project Owner LLC	General Commercial (400)	NO
3	Blocks 2A & 2B	072.03-04-09	312 Taylor Dr.	Hoffman Management Inc.	Vacant Land Commerc. (941)	YES
4	Blocks 2A & 2B	072.04-04-08	315 Stoval Sr.	Hoffman Family LLC	Vacant Land Commerc. (941)	YES
5	Block 6A	072.04-03-35	2472 Mandeville La.	Foundry Associates Owner LLC	Hi-Rise (7 ST and Up (330))	NO
6	Block 6B	072.04-03-34	2461 Eisenhower Av.	2461 Eisenhower Acquisitions LLC	Office Buildings (487)	NO
7	Block 7	072.04-03-38	206 Hoffman St.	Hoffman Family LLC	General Commercial (400)	NO
8	Block 14	072.04-03-26	2380 Mill Rd.	Town Center Garage LLC	Parking Garage (449)	NO
9	Block 15A	072.02-02-22	2425 Mill Rd.	Washington Metropolitan Area Transit Authority	Currently Not Available	NO
10	Block 15A	072.02-02-21	2401 Mill Rd.	Washington Metropolitan Area Transit Authority	Currently Not Available	NO
11	Block 15	072.02-02-10	2355 Mill Rd.	City of Alexandria	City Govt Bldgs (730)	NO
12	-	072.02-02-20	2395 Mill Rd.	Currently Not Available	Currently Not Available	NO
13	Block 16	072.04-02-19	2345 Mill Rd.	MFH Alexandria V LLC	Extended Stay (472)	NO
14	Block 17	072.04-0A-00	2318 Mill Rd.	Carlyle Overlook Condominium	Currently Not Available	NO
-	-	072.04-0A-ASCO-A	2318 Mill Rd.	American Society of Clinical Oncology Inc.	Currently Not Available	NO
-	-	072.04-0A-ASCO-B	2318 Mill Rd.	American Society of Clinical Oncology Inc.	Currently Not Available	NO
-	-	072.04-0A-RETAIL	2318 Mill Rd.	Carlyle Overlook Owner LLC	Currently Not Available	NO
-	-	072.04-0A-RP-MRP	2318 Mill Rd.	Carlyle Overlook Owner LLC	Currently Not Available	NO
15	-	072.03-04-11	310 Telegraph Rd.	Alexandria VA hotel Partners LLC	Vacant Land Commerc. (941)	NO
16	-	072.03-04-10	2468 Eisenhower Av.	Alexandria VA hotel Partners LLC	Vacant Land Commerc. (941)	NO
17	Block 1	072.04-04-07	2460 Eisenhower Av.	Alexandria VA hotel Partners LLC	Hotel and Motel (470)	NO
18	Blocks 9A & 9B	078.02-01-08	2400 Eisenhower Av.	Hoffman Family LLC	Vacant Land Commerc. (941)	YES
19	BLOCK 10A	078.02-01-02	2390 Eisenhower Av.	Washington Metropolitan Area Transit Authority	Wash Metro Tran Auth (750)	YES
20	Block 11	078.02-01-13	2300 Dock La.	Hoffman Towers Block 11 LLC	Vacant Land - APT (930)	YES
21	Block 12	078.02-01-09	2356 Eisenhower Av.	Hoffman Towers Block 12 LLC	Vacant Land - APT (930)	YES
22	Block 8	072.04-03-32	2415 Eisenhower Av.	USGBF NSF LLC	Office Buildings (487)	NO
23	-	072.04-03-12	2391 Eisenhower Av.	Washington Metropolitan Area Transit Authority	Wash Metro Tran Auth (750)	NO
24	Block 13	072.04-03-23	2351 Eisenhower Av.	Eisenhower Residential LP	Hi-Rise (7 ST and Up (330))	NO
25	Block 18	072.04-03-21	2251 Eisenhower Av.	Carlyle Place Associates LLC	Hi-Rise (7 ST and Up (330))	NO
26	Block 23	073.03-01-07	2331 Mill Rd.	Eisenhower Mill Properties LLC	Currently Not Available	NO
27	Block 23	073.03-01-09	2121 Eisenhower Av.	Simpson Development Co.	Office Buildings (487)	NO
28	Block 23	073.03-01-08	2111 Eisenhower Av.	211 Eisenhower Avenue Limited Partnership	Office Buildings (487)	NO
29	Block 19	078.02-01-21	750 Port St.	Paradigm 2250 Mill LLC	Hi-Rise (7 ST and Up (330))	NO
30	Block 20	078.02-01-22	2250 Dock La.	Mill Road Block 20 LLC, C/O Paradigm Development Company, LLC	Hi-Rise (7 ST and Up (330))	YES
31	Block 20	078.02-01-23	2200 Dock La.	Block 20 A LLC, C/O Paradigm Development Company, LLC	Hi-Rise (7 ST and Up (330))	YES
32	-	072.04-03-08	2360 Mill Rd.	Washington Metropolitan Area Transit Authority	Wash Metro Tran Auth (750)	NO
33	BLOCK 15B	072.04-02-14	2375 Mill Rd.	City of Alexandria	City Govt Bldgs (730)	NO
34	-	072.04-02-20	2365 Mill Rd.	Washington Metropolitan Area Transit Authority	Wash Metro Tran Auth (750)	NO
35	-	072.04-03-22	2316 Mill Rd.	Mill Race Property Oners Association	Vacant Land Com Area (980)	NO
36	BLOCK 19	078.02-01-19	2310 Eisenhower Av.	Hoffman Family LLC	Vacant Land - APT (930)	NO
37	BLOCK 19	078.02-01-15	2250 Eisenhower Av.	Hoffman Family LLC	Vacant Land - APT (930)	NO
38	BLOCK 19	078.02-01-07	2290 Mill Rd.	City of Alexandria	City Pks/Playgrounds (731)	NO
39	Block 6C	072.04-03-33	2425 Eisenhower Av.	2425 Eisenhower Acquisitions LLC	Vacant Land Commerc. (941)	NO

**NOTES :**

- ALL PROPERTIES LISTED ABOVE ARE LOCATED IN THE CDD #2 ZONE.
- BLOCKS HIGHLIGHTED IN GRAY ARE INCLUDED IN THIS CDD CONCEPTUAL DESIGN PLAN.

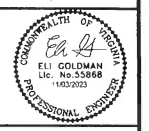

COORDINATED DEVELOPMENT  
DISTRICT #2  
CONCEPTUAL DESIGN PLAN  
CITY OF ALEXANDRIA, VIRGINIA

NO.	DATE	DESCRIPTION
1	02/11/2022	CDD AMENDMENT SUBMISSION #1
2	07/27/2022	CDD AMENDMENT SUBMISSION #2
3	06/26/2023	CDD AMENDMENT SUBMISSION #3
4	11/03/2023	CDD AMENDMENT SUBMISSION #4

PROJECT No. 8885-065-00  
DRAWING No. 111404  
DATE: 02.11.22  
SCALE: N/A  
DESIGN: EC  
DRAWN: MQ  
CHECKED: MMW

PROPERTY OWNERSHIP INFORMATION

SHEET No.  
**C200**

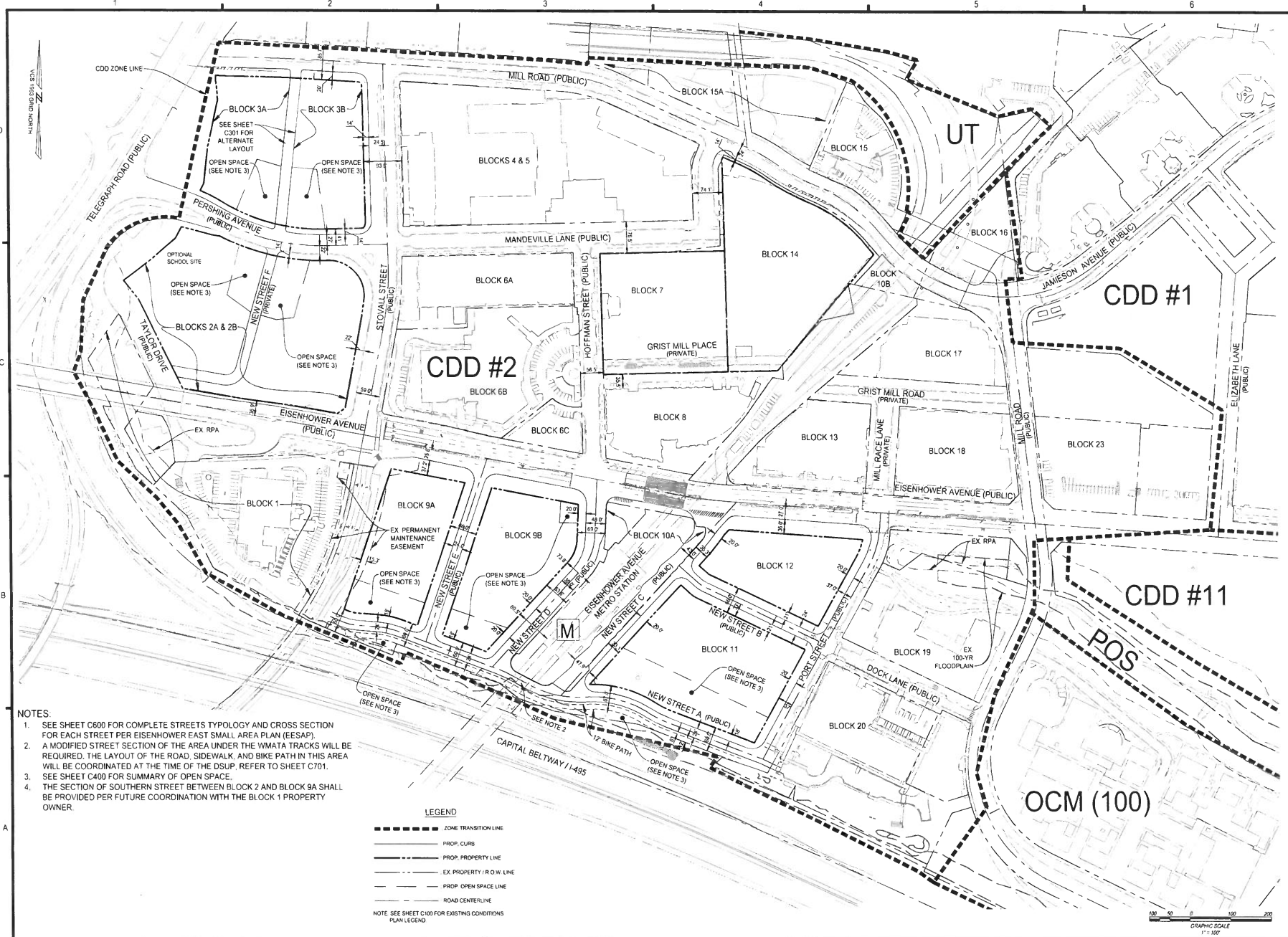

- NOTES**
- SEE SHEET C600 FOR COMPLETE STREETS TYPOLOGY AND CROSS SECTION FOR EACH STREET PER EISENHOWER EAST SMALL AREA PLAN (EESAP).
  - A MODIFIED STREET SECTION OF THE AREA UNDER THE WMATA TRACKS WILL BE REQUIRED. THE LAYOUT OF THE ROAD, SIDEWALK, AND BIKE PATH IN THIS AREA WILL BE COORDINATED AT THE TIME OF THE DSUP. REFER TO SHEET C701.
  - SEE SHEET C400 FOR SUMMARY OF OPEN SPACE.
  - THE SECTION OF SOUTHERN STREET BETWEEN BLOCK 2 AND BLOCK 9A SHALL BE PROVIDED PER FUTURE COORDINATION WITH THE BLOCK 1 PROPERTY OWNER.

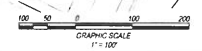
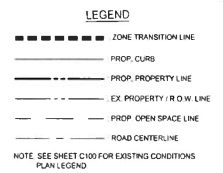

**christopher consultants**  
 4035 edge top rd p 103.271.8520  
 Fairfax, VA 22030  
 engineering • surveying • land planning

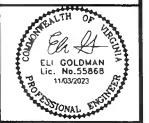

**COORDINATED DEVELOPMENT DISTRICT #2**  
**CONCEPTUAL DESIGN PLAN**  
 CITY OF ALEXANDRIA, VIRGINIA

NO.	DATE	DESCRIPTION
1	02/13/2022	CDD AMENDMENT SUBMISSION #1
2	07/17/2022	CDD AMENDMENT SUBMISSION #2
3	08/26/2023	CDD AMENDMENT SUBMISSION #3
4	11/03/2023	CDD AMENDMENT SUBMISSION #4

PROJECT No. 98085.065.00  
 DRAWING No. 111404  
 DATE 02/11/22  
 SCALE: SEE SHEET  
 DESIGN: EJD  
 DRAWN: MJD  
 CHECKED: WJW

SHEET TITLE  
**CDD CONCEPT PLAN**

SHEET No.  
**C300**

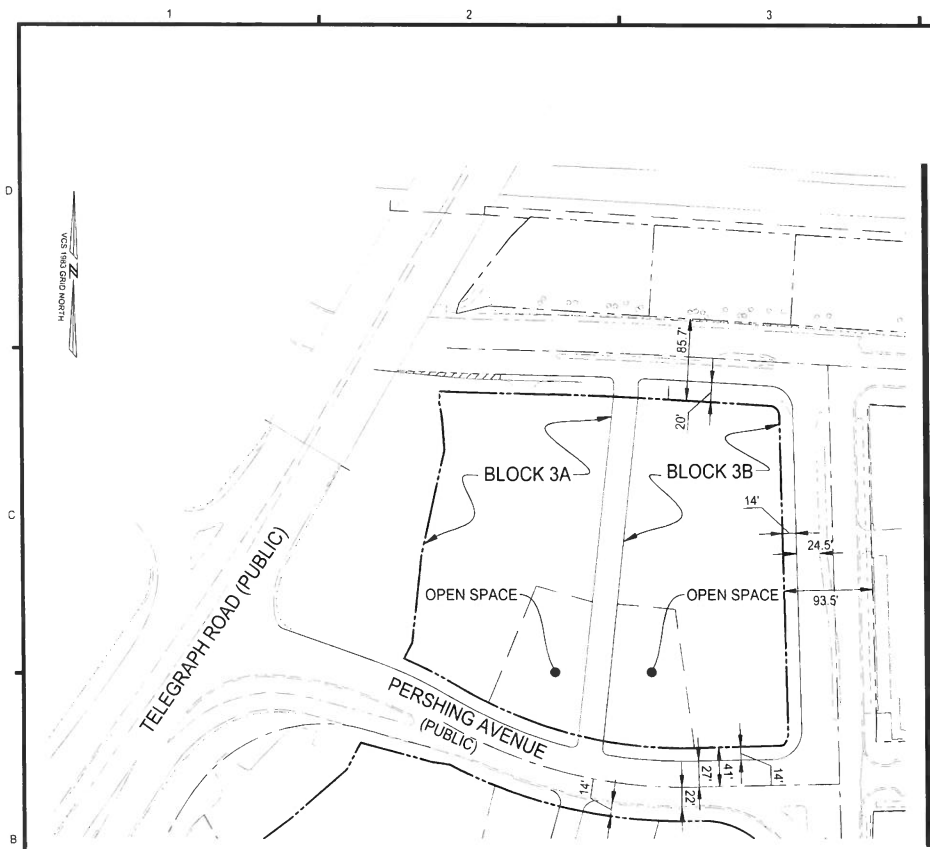

BLOCK 3 LAYOUT - WITH ROAD

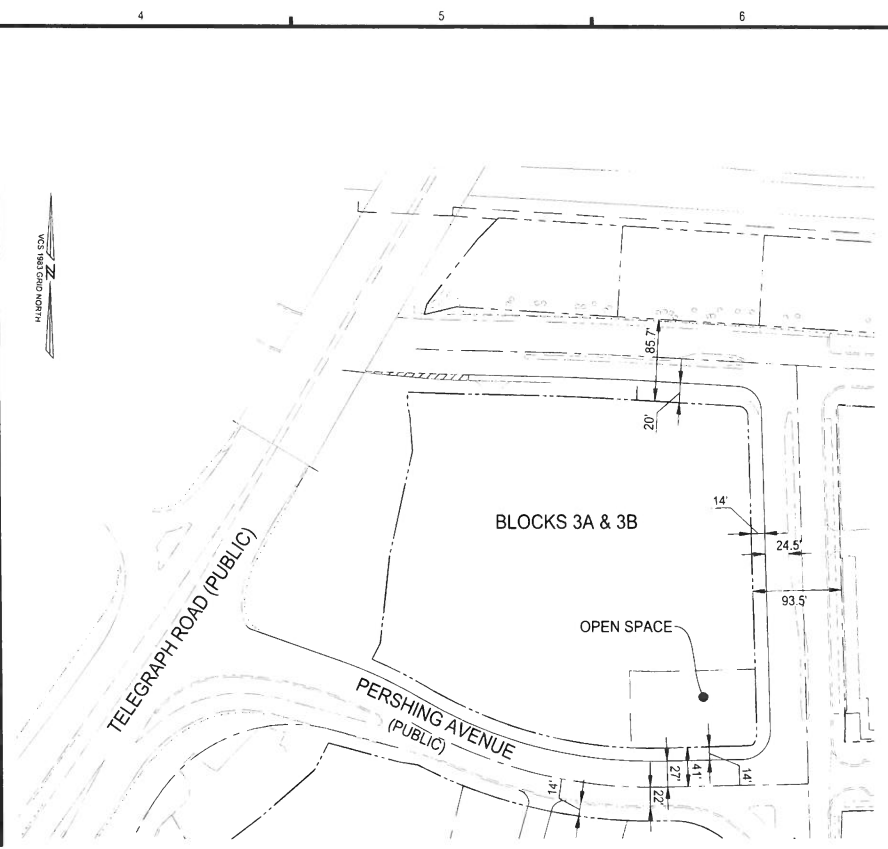

BLOCK 3 LAYOUT - WITHOUT ROAD

NOTE: INTERNAL ROAD NOT REQUIRED PROVIDED THAT PROPOSED DEVELOPMENT PROVIDES 45,000 SF OF GROUND FLOOR OR MULTI-FLOOR NON-RESIDENTIAL USE AND 10,000 SF OF AT-GRADE OPEN SPACE.

- LEGEND**
- ZONE TRANSITION LINE
  - PROP. CURB
  - PROP. PROPERTY LINE
  - EX. PROPERTY / R.O.W. LINE
  - PROP. OPEN SPACE LINE
  - ROAD CENTERLINE
- NOTE: SEE SHEET C100 FOR EXISTING CONDITIONS PLAN LEGEND.

**christopher consultants**  
 8035 Ridge Top Rd  
 Suite 200  
 Fairfax, VA 22039  
 703.273.6620  
 engineering • surveying • land planning

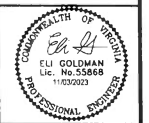

COORDINATED DEVELOPMENT  
 DISTRICT #2  
 CONCEPTUAL DESIGN PLAN  
 CITY OF ALEXANDRIA, VIRGINIA

NO.	DATE	DESCRIPTION
1	02/11/2022	CDD AMENDMENT SUBMISSION #1
2	07/01/2022	CDD AMENDMENT SUBMISSION #2
3	05/26/2023	CDD AMENDMENT SUBMISSION #3
4	11/03/2023	CDD AMENDMENT SUBMISSION #4

PROJECT No.: 98085-065-00  
 DRAWING No.: 111404  
 DATE: 02/11/22  
 SCALE: SEE SHEET  
 DESIGN: EG  
 DRAWN: MQ  
 CHECKED: MMW

SHEET TITLE:  
**BLOCK 3  
 ALTERNATE  
 LAYOUT**

SHEET No.  
**C301**

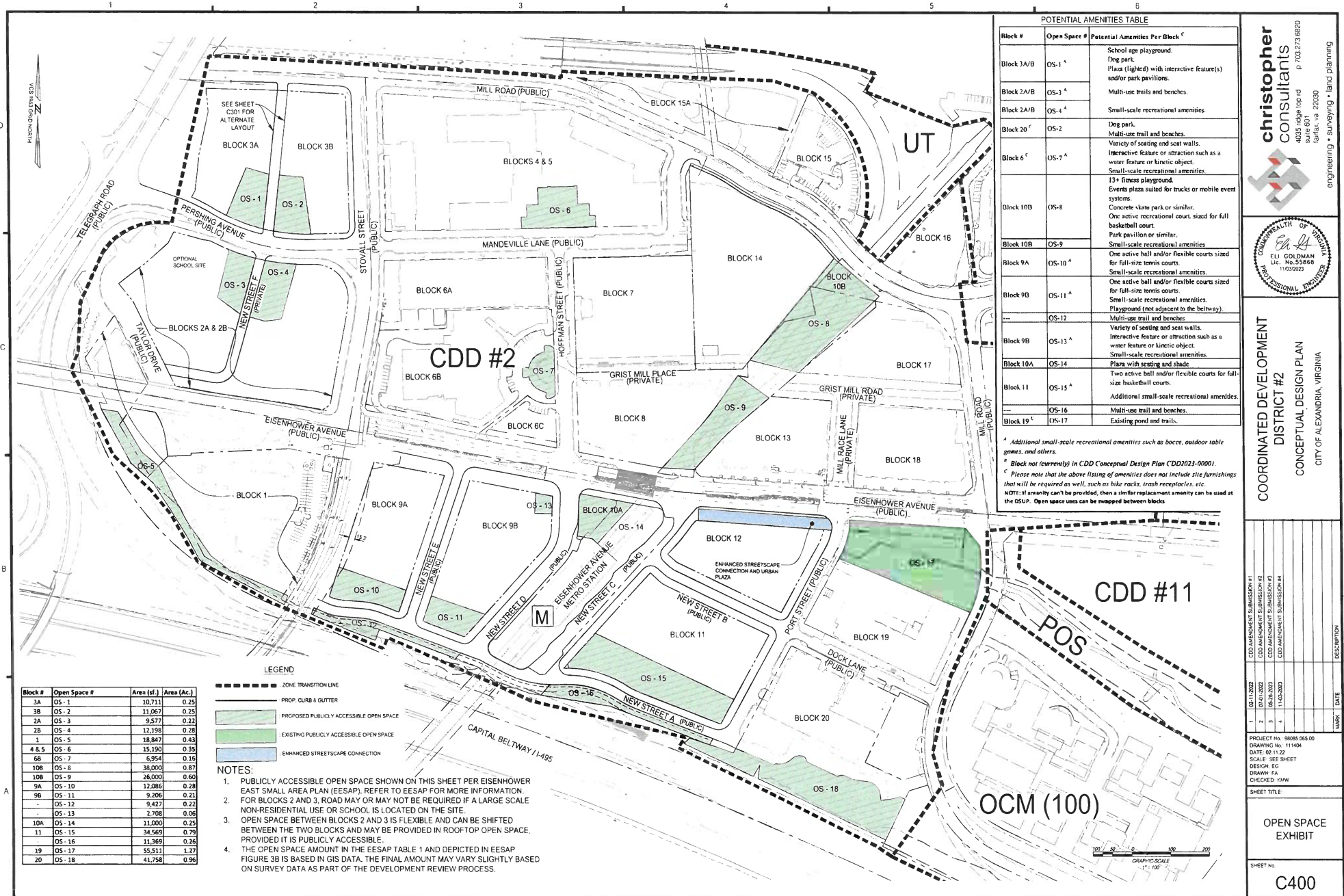

Block #	Open Space #	Potential Amenities For Block <sup>c</sup>
Block 3A/B	OS-1 <sup>a</sup>	School age playground. Dog park. Plaza (lighted) with interactive feature(s) and/or park pavilions.
Block 2A/B	OS-3 <sup>a</sup>	Multi-use trails and benches.
Block 2A/B	OS-4 <sup>a</sup>	Small-scale recreational amenities.
Block 20 <sup>c</sup>	OS-2	Dog park. Multi-use trail and benches.
Block 6 <sup>c</sup>	OS-7 <sup>a</sup>	Variety of seating and seat walls. Interactive feature or attraction such as a water feature or kinetic object. Small-scale recreational amenities. 13+ fitness playground. Events plaza suited for trucks or mobile event systems.
Block 10B	OS-8	Concrete skate park or similar. One active recreational court, sized for full basketball court.
Block 10B	OS-9	Park pavilion or similar. Small-scale recreational amenities.
Block 9A	OS-10 <sup>a</sup>	One active ball and/or flexible courts sized for full-size tennis courts. Small-scale recreational amenities.
Block 9B	OS-11 <sup>a</sup>	One active ball and/or flexible courts sized for full-size tennis courts. Small-scale recreational amenities. Playground (not adjacent to the beltway).
---	OS-12	Multi-use trail and benches. Variety of seating and seat walls.
Block 9B	OS-13 <sup>a</sup>	Interactive feature or attraction such as a water feature or kinetic object. Small-scale recreational amenities.
Block 10A	OS-14	Plaza with seating and shade
Block 11	OS-15 <sup>a</sup>	Two active ball and/or flexible courts for full-size basketball courts. Additional small-scale recreational amenities.
---	OS-16	Multi-use trail and benches.
Block 19 <sup>d</sup>	OS-17	Existing pond and trails.

<sup>a</sup> Additional small-scale recreational amenities such as bocce, outdoor table games, and others.  
<sup>b</sup> Block not (currently) in CDD Conceptual Design Plan CDD2023-00001.  
<sup>c</sup> Please note that the above listing of amenities does not include site furnishings that will be required as well, such as bike racks, trash receptacles, etc.  
 NOTE: If an amenity can't be provided, then a similar replacement amenity can be used as the USUP. Open space uses can be swapped between blocks.

Block #	Open Space #	Area (sq. ft.)	Area (Ac.)
3A	OS-1	10,711	0.25
3B	OS-2	11,067	0.25
2A	OS-3	9,577	0.22
2B	OS-4	17,198	0.39
1	OS-5	18,847	0.43
4 & 5	OS-6	15,150	0.35
6B	OS-7	6,954	0.16
10B	OS-8	38,000	0.87
10B	OS-9	26,000	0.60
9A	OS-10	17,086	0.39
9B	OS-11	9,206	0.21
---	OS-12	9,427	0.22
---	OS-13	2,708	0.06
10A	OS-14	11,000	0.25
11	OS-15	34,569	0.79
---	OS-16	11,369	0.26
19	OS-17	55,511	1.27
20	OS-18	41,758	0.95

**LEGEND**

- ZONE TRANSITION LINE
- PROP. CURB & GUTTER
- PROPOSED PUBLICLY ACCESSIBLE OPEN SPACE
- EXISTING PUBLICLY ACCESSIBLE OPEN SPACE
- ENHANCED STREETScape CONNECTION

- NOTES**
- PUBLICLY ACCESSIBLE OPEN SPACE SHOWN ON THIS SHEET PER EISENHOWER EAST SMALL AREA PLAN (EESAP). REFER TO EESAP FOR MORE INFORMATION.
  - FOR BLOCKS 2 AND 3, ROAD MAY OR MAY NOT BE REQUIRED IF A LARGE SCALE NON-RESIDENTIAL USE OR SCHOOL IS LOCATED ON THE SITE.
  - OPEN SPACE BETWEEN BLOCKS 2 AND 3 IS FLEXIBLE AND CAN BE SHIFTED BETWEEN THE TWO BLOCKS AND MAY BE PROVIDED IN ROOFTOP OPEN SPACE PROVIDED IT IS PUBLICLY ACCESSIBLE.
  - THE OPEN SPACE AMOUNT IN THE EESAP TABLE 1 AND DEPICTED IN EESAP FIGURE 3B IS BASED IN GIS DATA. THE FINAL AMOUNT MAY VARY SLIGHTLY BASED ON SURVEY DATA AS PART OF THE DEVELOPMENT REVIEW PROCESS.

**christopher consultants**  
 4035 ridge top rd  
 Fairfax, VA 22030  
 engineering • surveying • land planning

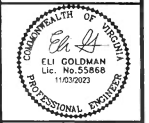

COORDINATED DEVELOPMENT DISTRICT #2  
 CONCEPTUAL DESIGN PLAN  
 CITY OF ALEXANDRIA, VIRGINIA

NO.	DATE	DESCRIPTION
1	03/11/2022	CDD AMENDMENT SUBMISSION #1
2	07/21/2022	CDD AMENDMENT SUBMISSION #2
3	08/24/2023	CDD AMENDMENT SUBMISSION #3
4	11/02/2023	CDD AMENDMENT SUBMISSION #4

PROJECT No. 98085/06500  
 DRAWING No. 111404  
 DATE: 02/11/22  
 SCALE: SEE SHEET  
 DESIGN: EG  
 DRAWN: FA  
 CHECKED: JMW

SHEET TITLE  
**OPEN SPACE EXHIBIT**  
 SHEET NO.  
**C400**

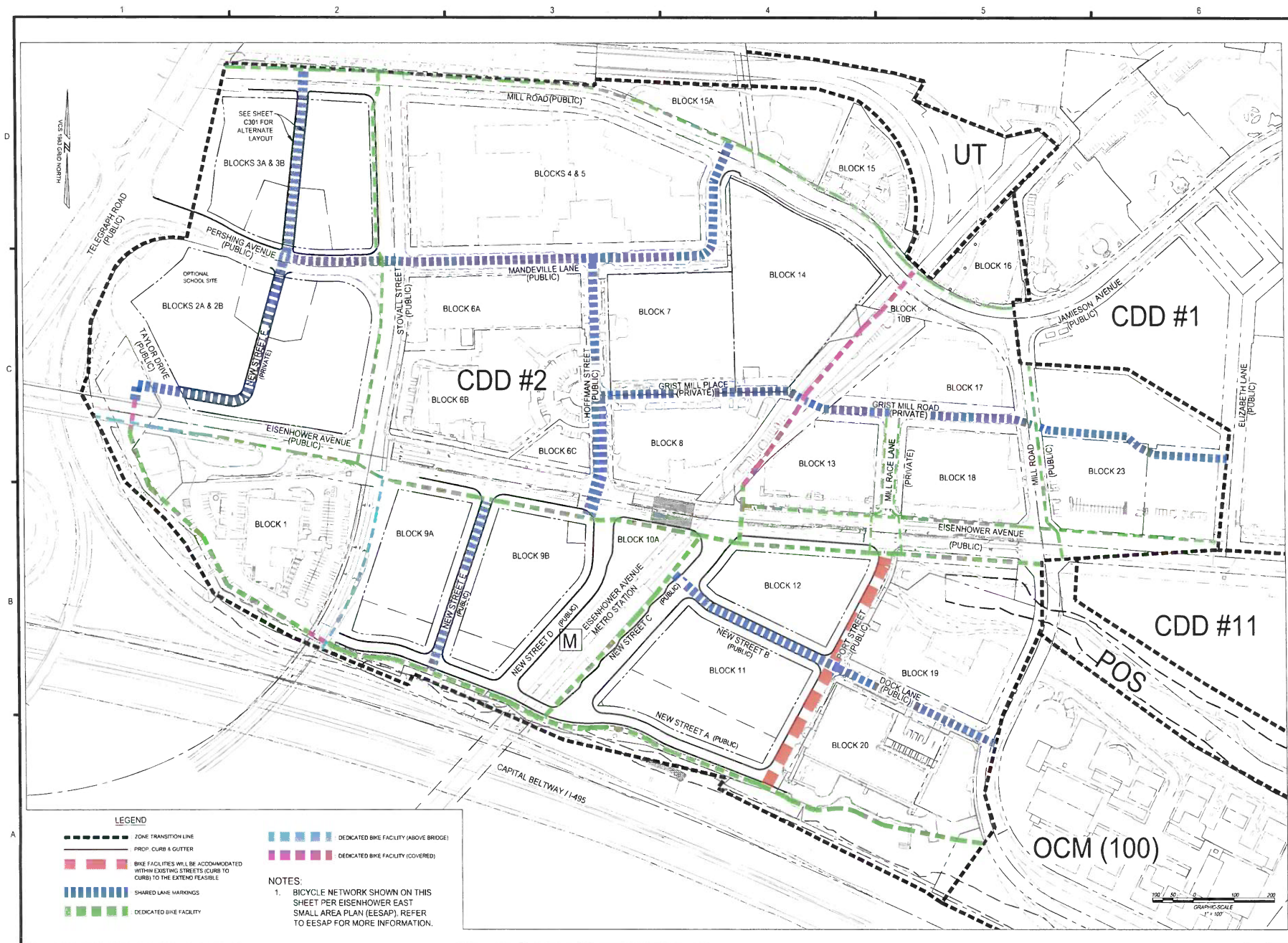

- LEGEND**
- ZONE TRANSITION LINE
  - PROP' CURB & GUTTER
  - BIKE FACILITIES WILL BE ACCOMMODATED WITH EXISTING STREETS (CURB TO CURB) TO THE EXTENT FEASIBLE
  - SHARED LANE MARKINGS
  - DEDICATED BIKE FACILITY
  - DEDICATED BIKE FACILITY (ABOVE BRIDGE)
  - DEDICATED BIKE FACILITY (COVERED)
- NOTES:**
- BICYCLE NETWORK SHOWN ON THIS SHEET PER EISENHOWER EAST SMALL AREA PLAN (EESAP). REFER TO EESAP FOR MORE INFORMATION.

**christopher consultants**  
 4008 edge top rd p 103.273.6620  
 Fairfax, VA 22030  
 engineering • surveying • land planning



**COORDINATED DEVELOPMENT DISTRICT #2**  
**CONCEPTUAL DESIGN PLAN**  
 CITY OF ALEXANDRIA, VIRGINIA

NO.	DATE	DESCRIPTION
1	05/11/2022	CDD AMENDMENT SUBMISSION #1
2	07/01/2022	CDD AMENDMENT SUBMISSION #2
3	08/25/2023	CDD AMENDMENT SUBMISSION #3
4	11/03/2023	CDD AMENDMENT SUBMISSION #4

PROJECT No: 98085.065.00  
 DRAWING No: 111404  
 DATE: 02/11/22  
 SCALE: SEE SHEET  
 DESIGN: EC  
 DRAWN: FA  
 CHECKED: KHW

**BIKE CONNECTION EXHIBIT**

SHEET No: **C500**

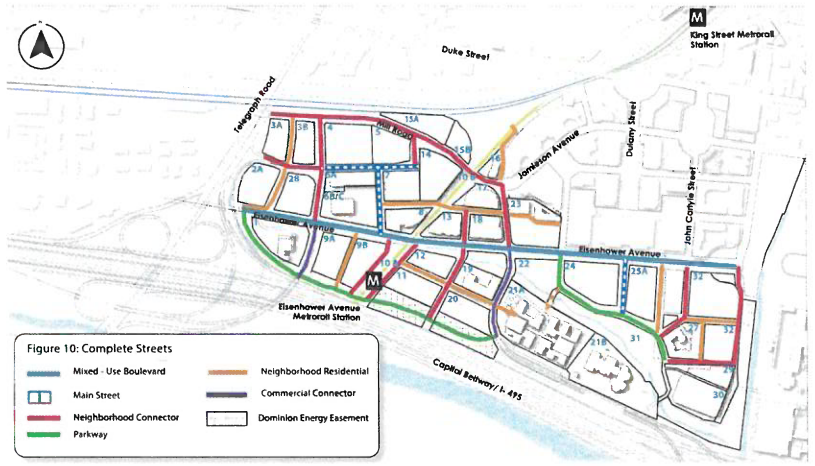
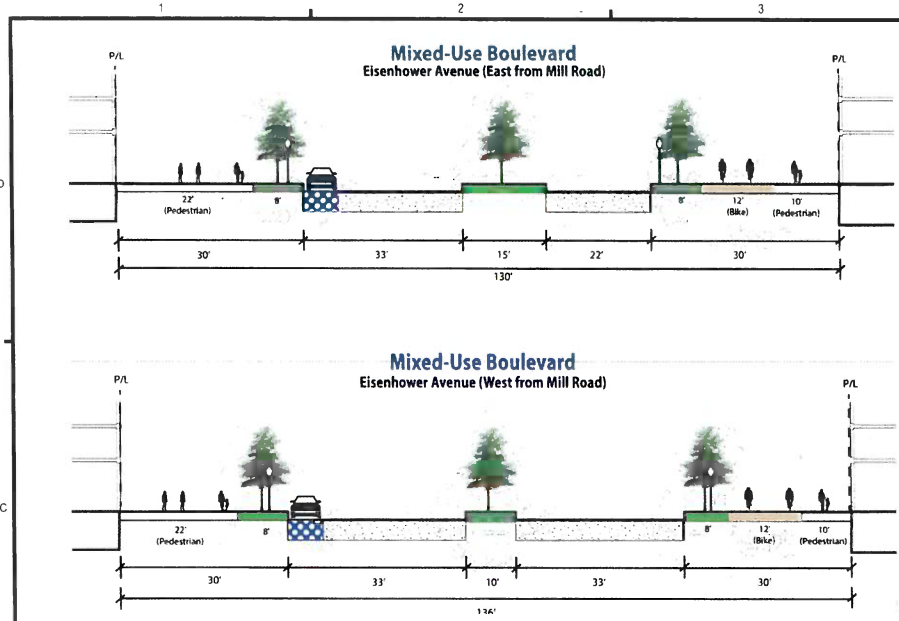

NOTE: THE STREET SECTIONS ADJACENT TO THE EISENHOWER METRO WILL BE MODIFIED VERSIONS OF THE NEIGHBORHOOD CONNECTOR AND PARKWAY STREET SECTIONS. THE STREET SECTIONS WILL NEED TO BE COORDINATED AND AGREED UPON WITH WMATA.

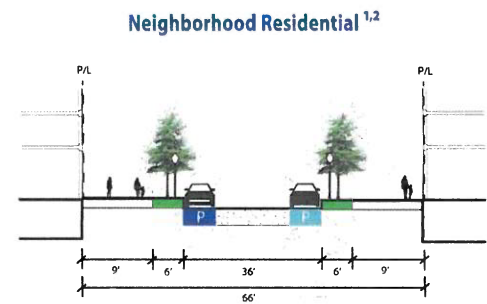
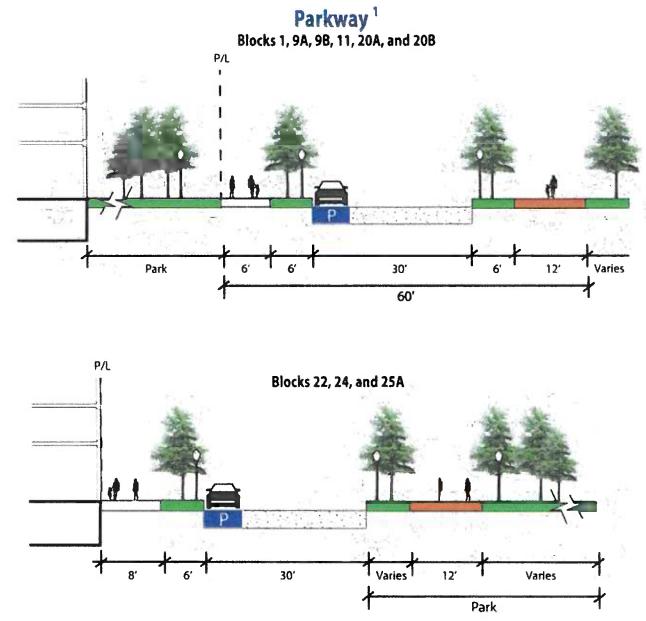
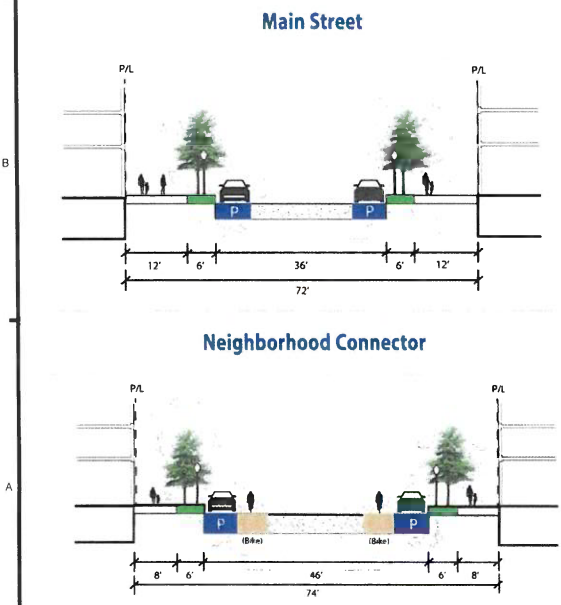

**christopher consultants**  
 4035 edge top rd  
 Fairfax, va 22030  
 p 703.273.6620  
 engineering • surveying • land planning



COORDINATED DEVELOPMENT  
 DISTRICT #2  
 CONCEPTUAL DESIGN PLAN  
 CITY OF ALEXANDRIA, VIRGINIA

NO.	DATE	MARK	DESCRIPTION
1	05/11/2022		CDD AMENDMENT SUBMISSION #1
2	07/01/2022		CDD AMENDMENT SUBMISSION #2
3	05/26/2023		CDD AMENDMENT SUBMISSION #3
4	11/02/2023		CDD AMENDMENT SUBMISSION #4

PROJECT No. 98085.000.00  
 DRAWING No. 111404  
 DATE 02/11/22  
 SCALE N.A.  
 DESIGN EC  
 DRAWN HQ  
 CHECKED PMW

SHEET TITLE  
**STREET CROSS SECTION EXHIBIT**

SHEET No.  
**C600**



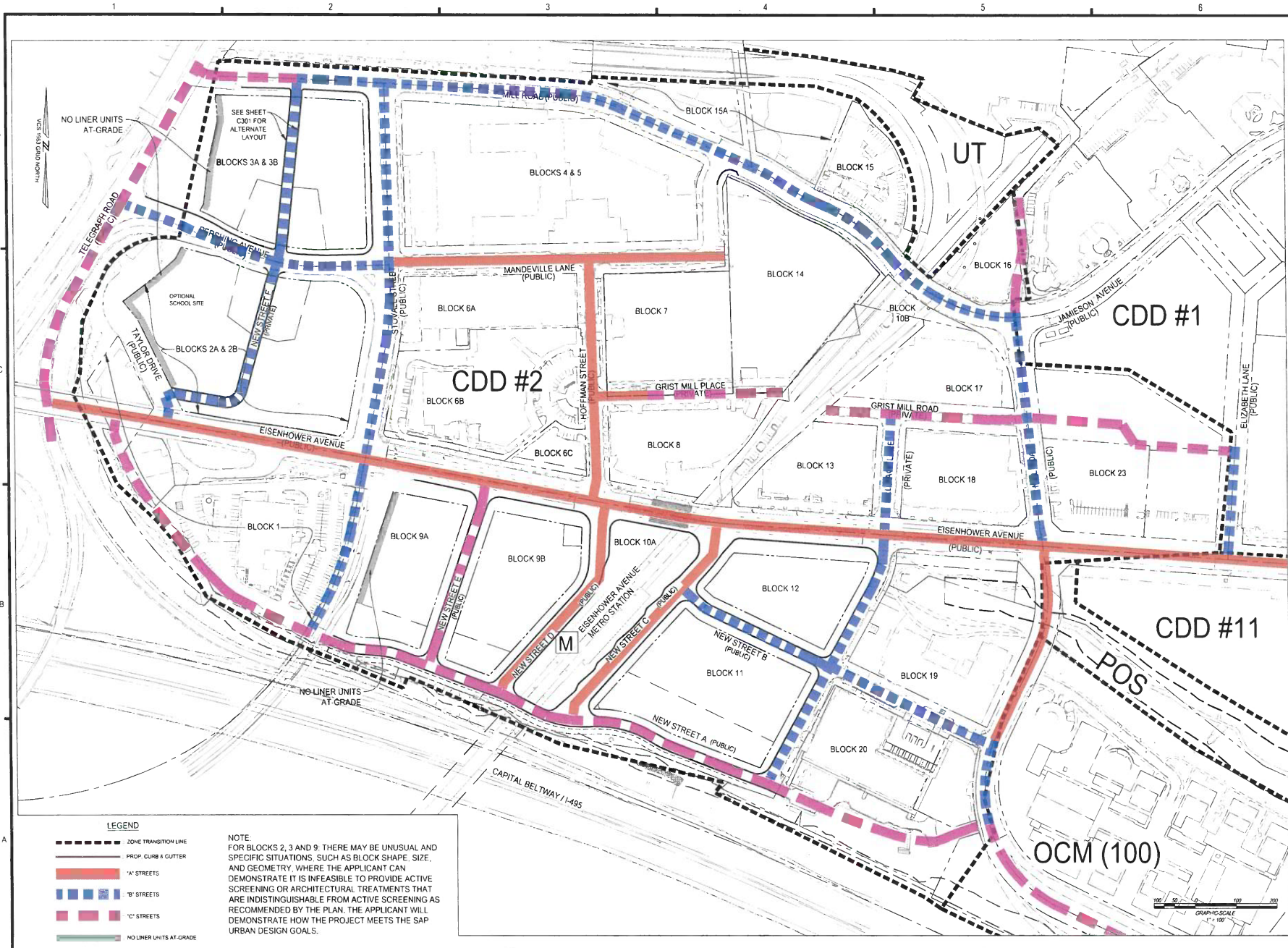

**LEGEND**

- ZONE TRANSITION LINE
- PROP. CURB & GUTTER
- 'A' STREETS
- 'B' STREETS
- 'C' STREETS
- NO LINER UNITS AT-GRADE

NOTE:  
FOR BLOCKS 2, 3 AND 9, THERE MAY BE UNUSUAL AND SPECIFIC SITUATIONS, SUCH AS BLOCK SHAPE, SIZE, AND GEOMETRY, WHERE THE APPLICANT CAN DEMONSTRATE IT IS INFEASIBLE TO PROVIDE ACTIVE SCREENING OR ARCHITECTURAL TREATMENTS THAT ARE INDISTINGUISHABLE FROM ACTIVE SCREENING AS RECOMMENDED BY THE PLAN. THE APPLICANT WILL DEMONSTRATE HOW THE PROJECT MEETS THE SAP URBAN DESIGN GOALS.

**christopher consultants**  
 4035 ridge top rd  
 Suite 601  
 Fairfax, VA 22030  
 engineering • surveying • land planning



**COORDINATED DEVELOPMENT DISTRICT #2**  
**CONCEPTUAL DESIGN PLAN**  
 CITY OF ALEXANDRIA, VIRGINIA

NO.	DATE	DESCRIPTION
1	05-11-2022	CDD AMENDMENT SUBMISSION #1
2	07-01-2022	CDD AMENDMENT SUBMISSION #2
3	06-29-2023	CDD AMENDMENT SUBMISSION #3
4	11-03-2023	CDD AMENDMENT SUBMISSION #4

PROJECT No.: 98085.006.00  
 DRAWING No.: 111404  
 DATE: 02/11/22  
 SCALE: SEE SHEET  
 DESIGN: EG  
 DRAWN: HL  
 CHECKED: KAW

**STREET HIERARCHY EXHIBIT**

SHEET No. **C700**

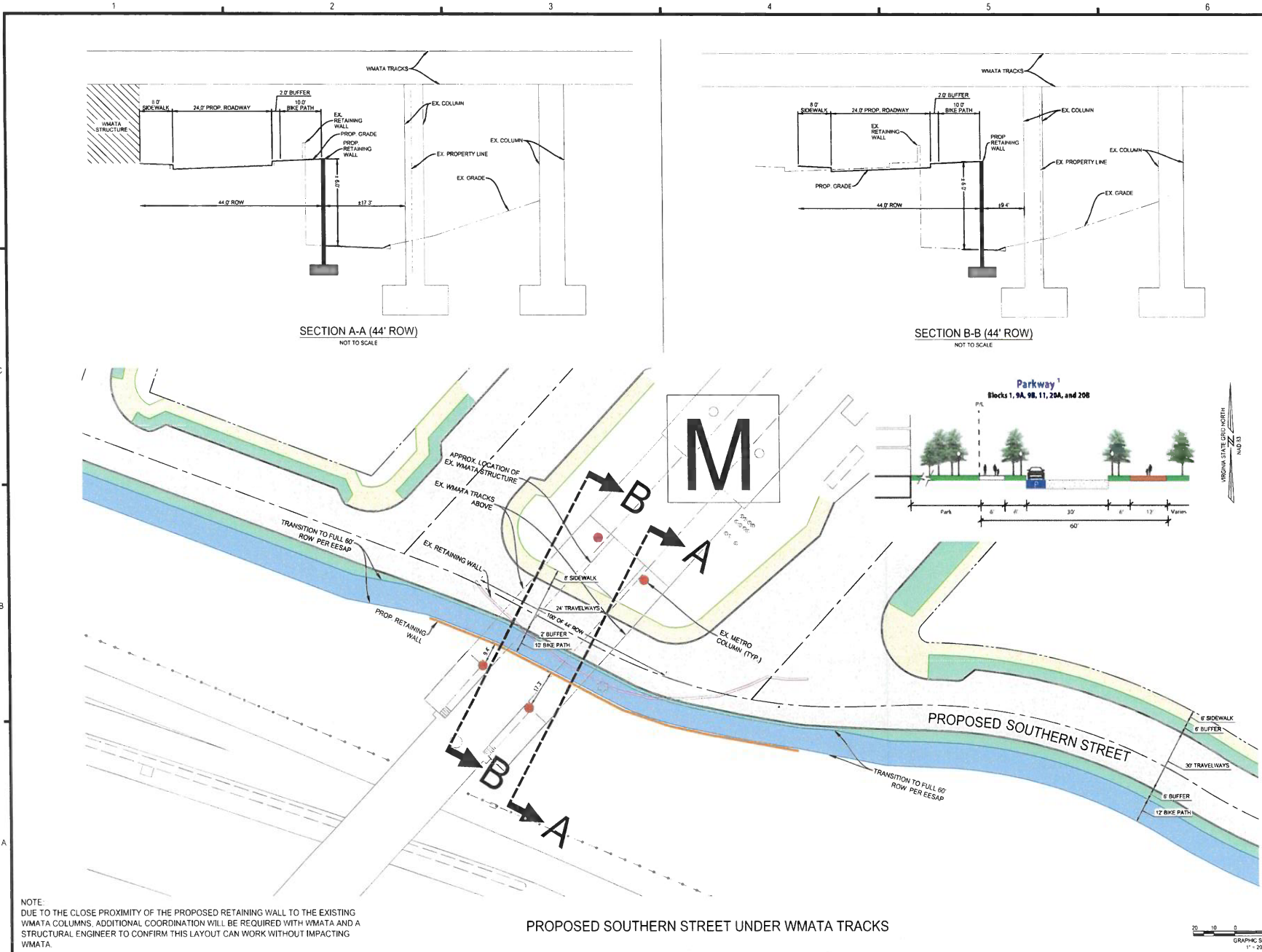

SECTION A-A (44' ROW)  
NOT TO SCALE

SECTION B-B (44' ROW)  
NOT TO SCALE

PROPOSED SOUTHERN STREET UNDER WMATA TRACKS

NOTE:  
DUE TO THE CLOSE PROXIMITY OF THE PROPOSED RETAINING WALL TO THE EXISTING WMATA COLUMNS, ADDITIONAL COORDINATION WILL BE REQUIRED WITH WMATA AND A STRUCTURAL ENGINEER TO CONFIRM THIS LAYOUT CAN WORK WITHOUT IMPACTING WMATA.

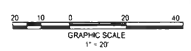

**christopher consultants**  
4035 ridge top rd  
alexandria, va 22304  
engineering • surveying • land planning

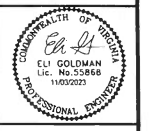

COORDINATED DEVELOPMENT  
DISTRICT #2  
CONCEPTUAL DESIGN PLAN  
CITY OF ALEXANDRIA, VIRGINIA

NO.	DATE	DESCRIPTION
1	03/11/2022	CDD AMENDMENT SUBMISSION #1
2	07/21/2022	CDD AMENDMENT SUBMISSION #2
3	05/16/2023	CDD AMENDMENT SUBMISSION #3
4	11/03/2023	CDD AMENDMENT SUBMISSION #4

PROJECT No. 9806.006.00  
DRAWING No. 111404  
DATE: 02/11/22  
SCALE: SEE SHEET  
DESIGN: EG  
DRAWN: JGD  
CHECKED: RMW

SHEET TITLE  
**SOUTHERN STREET UNDER WMATA TRACKS EXHIBIT**

SHEET No.  
**C701**