

Madison, Wisconsin

CITY OF MADISON

CITY ENGINEERING DIVISION

DEPARTMENT OF PUBLIC WORKS

PLAN OF PROPOSED IMPROVEMENT

PUBLIC IMPROVEMENT DESIGN
APPROVED BY:

City Engineer

Date

RIGHT-OF-WAY IMPROVEMENTS
DESIGNED BY:

SEE
SHEETS

INDEX OF SHEETS

SHEET NO.	TITLE & GENERAL NOTES
1-2	DEMOLITION PLAN
P1	UTILITY PLAN (REVISED FROM UTILITY ONLY PLANS)
P2	STREET RESTORATION PLAN
P3	STREET GRADES
P4	LANDSCAPING PLAN
P5	ELECTRICAL PLAN
E1-E2	DETAILS
C500-C501	

715 W. DAYTON STREET (UW SERF PROJECT)

PROJECT NO. 11580

WORK TO BE COMPLETED UNDER
PERMIT TO EXCAVATE IN THE RIGHT-OF-WAY

FULL RIGHT-OF-WAY
PLAN SET

PROJECT
LOCATION

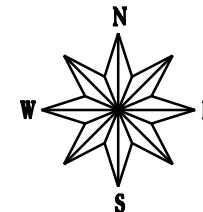
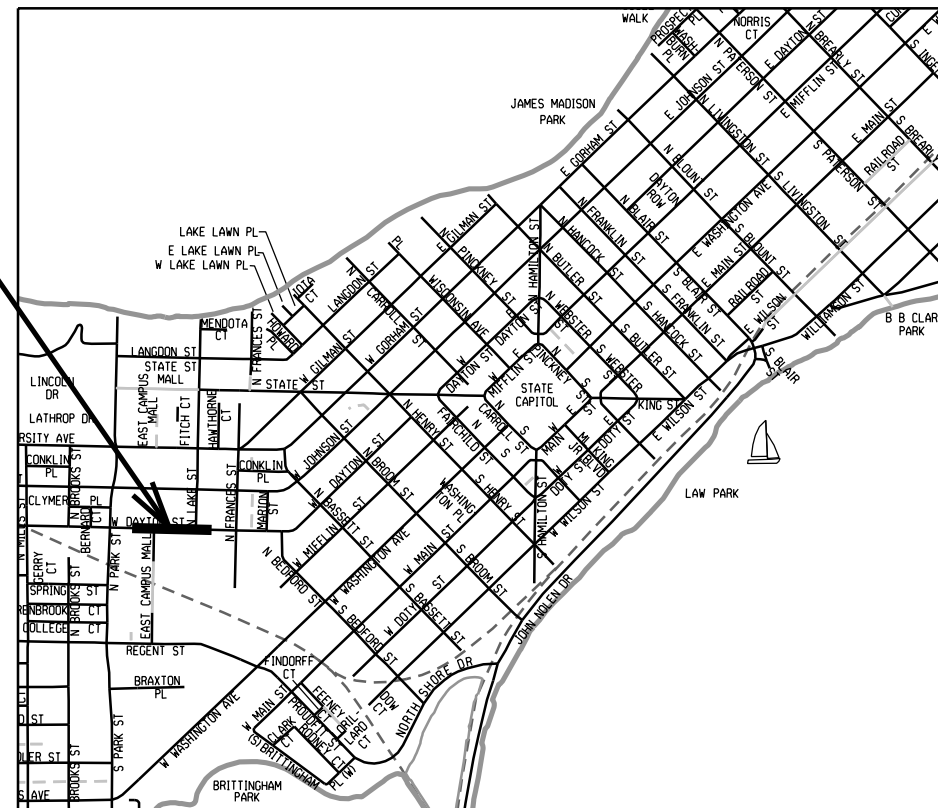

CONVENTIONAL SIGNS	
FIELD VERIFY ALL UTILITY LOCATIONS	
GAS	G
STORM SEWER	ST
SANITARY SEWER	SAN
WATER	W
OVERHEAD ELECTRIC	OH
BURIED ELECTRIC	E
LIGHT POLE	(Light Pole Symbol)

PLOT SCALE:

PLOT NAME:

REV. DATE:

ORIGINATOR: CITY OF MADISON, STREETS DIVISION

DETAIL

STANDARD NOTES
AND COMMENTS

CITY OF MADISON

CONTRACTOR/DEVELOPER SHALL SUBMIT A TRAFFIC CONTROL PLAN TO CITY TRAFFIC ENGINEERING AT LEAST 10 WORKING DAYS PRIOR TO THE START OF WORK. WORK WITHIN THE RIGHT-OF-WAY SHALL NOT BEGIN UNTIL THE TRAFFIC CONTROL PLAN IS APPROVED.

ANY PAVEMENT MARKINGS THAT ARE REMOVED OR DAMAGED SHALL BE REPLACED BY THE DEVELOPER/CONTRACTOR AS DIRECTED BY CITY TRAFFIC ENGINEERING.

THE LOCATION AND INFORMATION FOR PROPOSED NEW TREES, IN THE PUBLIC RIGHT OF WAY OR ON PUBLIC LANDS ARE APPROXIMATE AND ARE SHOWN FOR REFERENCE ONLY. COORDINATE WITH CITY FORESTRY FOR LOCATION OF ANY NEW TREE GRATES; SOME EXCAVATION MAY BE NECESSARY WHEN PLACING NEW GRATES TO VERIFY THAT THE SITE IS APPROPRIATE FOR TREE PLANTING.

CONTRACTOR SHALL CONTACT BRAD HOFFMAN WITH CITY FORESTRY (267-4908 OR 220-6796) AT LEAST ONE WEEK PRIOR TO PLANTING TO ALLOW FORESTRY TO MARK THE PLANTING SITES AND REVIEW PLANTING SPECIFICATIONS WITH THE LANDSCAPING CONTRACTOR. TREE PLANTING WITHIN THE PUBLIC RIGHT OF WAY OR ON PUBLIC LANDS SHALL BE APPROVED BY THE CITY FORESTER PRIOR TO INSTALLATION.

NO TREES IN THE RIGHT OF WAY OR ON PUBLIC LANDS SHALL BE TRIMMED, PRUNED, REMOVED OR ADVERSELY AFFECTED IN ANY WAY UNTIL THE DEVELOPER HAS RECEIVED WRITTEN PERMISSION FROM THE CITY ENGINEER OR CITY FORESTER. SAID WRITTEN PERMISSION SHALL INCLUDE LANGUAGE INDICATING THAT SECTION 10.101 OF THE MADISON GENERAL ORDINANCES AND ADMINISTRATIVE PROCEDURE MEMORANDUM NO. 6-2, REFERING TO NOTIFICATION OF PROPERTY OCCUPANTS AND/OR OWNERS, HAS BEEN COMPLIED WITH.

TRAFFIC CONTROL REQUIREMENTS RELATED TO THIS PROJECT:

SUBMIT A TRAFFIC CONTROL PLAN TO CITY TRAFFIC ENGINEERING AT LEAST 14 DAYS PRIOR TO THE START OF WORK. WORK SHALL NOT PROCEED UNTIL AN APPROVED TRAFFIC CONTROL PLAN IS IN PLACE.

MAINTAIN TWO-WAY TRAVEL ON ALL STREETS AT ALL TIMES.

PROVIDE APPROPRIATE SIGNAGE, INCLUDING FOR ANY BIKE LANE CLOSURES OR DETOURS AS REQUIRED BY THE APPROVED TRAFFIC CONTROL PLAN

INSTALL TEMPORARY TRENCH PATCHES AND TEMPORARY SIDEWALK AS NECESSARY TO MEET THE TRAFFIC CONTROL REQUIREMENTS AS SET FORTH IN THE PERMIT TO EXCAVATE.

ALL PAVEMENT WITHIN THE RIGHT-OF-WAY SHALL BE TYPE C PAVEMENT.

ALL GUTTERS SHALL DRAIN WITH A MINIMUM GRADES OF 0.5% TOWARD STORM SEWER INLETS.

THE CROSS SLOPE OF SIDEWALKS AND BARRIER FREE SIDEWALK CURB RAMPS SHALL BE 1.5%. THE LONGITUDINAL GRADE OF BARRIER FREE SIDEWALK CURB RAMPS SHALL NOT EXCEED 8.33%. ALL SIDEWALK RAMPS SHALL BE CONSTRUCTED ACCORDING TO S.D.D. 3.03. AT ALL OTHER LOCATIONS THE LONGITUDINAL GRADE OF SIDEWALKS SHALL NOT EXCEED 5.0 % OR THE ADJACENT STREET GRADE WHICHEVER IS GREATER NOR BE LESS THAN 0.4% AND SHALL DRAIN TOWARD STORM SEWER INLETS. SIDE SLOPES WITHIN TEN FEET OF A PUBLIC SIDEWALK SHALL NOT EXCEED 4.00:1. ALL SIDEWALK AND SIDEWALK RAMP ELEVATIONS AND GRADES SHALL BE FIELD VERIFIED AND SET TO COMPLY WITH THE CITY OF MADISON STANDARD SPECIFICATIONS AND THE A.D.A. GUIDELINES.

POWER POLES AND OTHER OBSTRUCTIONS SHALL BE MOVED TO PROVIDE 2 FEET MINIMUM OF CLEAR DISTANCE FROM ANY FACE OF CURB OR EDGE OF SIDEWALK.

THERE MAY BE EXISTING UTILITIES OR OTHER FEATURES WHICH ARE EITHER NOT SHOWN OR SHOWN INCORRECTLY ON THIS PLAN. IT IS THE RESPONSIBILITY OF THE DEVELOPER TO LOCATE AND IDENTIFY ALL UTILITIES AND TOPOGRAPHY WHICH MAY AFFECT THE CONSTRUCTION OF THESE IMPROVEMENTS.

ALL PERMANENT SIGNING AND POSTING WILL BE DETERMINED AND PROVIDED BY THE TRAFFIC ENGINEERING DIVISION, FOLLOWING CONSTRUCTION OF THESE IMPROVEMENTS.

THE DEVELOPER SHALL PROVIDE, INSTALL AND MAINTAIN ALL STREET END BARRICADES, SIGNING AND TRAFFIC CONTROL, AS REQUIRED BY THE CITY TRAFFIC ENGINEER.

PAVEMENT SAWCUTS SHALL BE AS DIRECTED BY THE CITY CONSTRUCTION ENGINEER. SAWCUTS SHOWN ON THE PLAN ARE APPROXIMATE.

DAMAGE TO ANY EXISTING CURB, PAVEMENT, SIDEWALK, ETC. THAT IS TO REMAIN SHALL BE REPAIRED BY THE DEVELOPER/CONTRACTOR AS DIRECTED BY THE ENGINEER.

DEVELOPER/CONTRACTOR SHALL COORDINATE WITH ALL UTILITY COMPANIES TO ADJUST STRUCTURES, MANHOLES, HANDHOLES, ETC. AS NEEDED TO MATCH THE GRADE OF THE NEW PAVEMENT.

PLOT SCALE: _____

PLOT NAME: _____

REV. DATE: _____

ORIGINATOR: CITY OF MADISON, STREETS DIVISION



- NOTES (CONT.):**
20. REMOVE & SALVAGE ALL STANDARD TRASH CANS, RECYCLING CONTAINERS, AND ASH URNS. RETURN THE UW-MADISON.
 21. ALL WORK IN THE PUBLIC RIGHT OF WAY SHALL BE PERFORMED BY A CITY-LICENSED CONTRACTOR.
 22. ALL DAMAGE TO THE PAVEMENT ON W. DAYTON STREET ADJACENT TO THE PROJECT SHALL BE RESTORED IN ACCORDANCE WITH THE CITY OF MADISON'S PAVEMENT PATCHING CRITERIA.
 23. IF CONTAMINATED SOIL IS ENCOUNTERED AS PART OF THE PROJECT EXCAVATION, ALL WDNR AND DSPS REGULATIONS MUST BE FOLLOWED FOR PROPER HANDLING AND DISPOSAL OF THE MATERIAL.
 24. THE CONTRACTOR IS RESPONSIBLE FOR MARKING THE EXTENT OF THE FRIABLE ASBESTOS CONTAINING MATERIAL (ACMs) IDENTIFIED IN GENERAL REQUIREMENTS ARTICLE 5 THAT WILL BE DISTURBED BY THE CONTRACTOR'S WORK AND COORDINATION WITH THE ASBESTOS ABATEMENT CONTRACTOR (AAC). THE AAC WILL REMOVE ACM PIPING INSULATION FROM PIPING BEING DEMOLISHED IN BOX CONDUITS OUTSIDE OF THE BUILDING UNDER SEPARATE CONTRACT WITH THE STATE. THE AAC WILL REQUIRE SOLE OCCUPANCY OF THE WORK SPACE DURING ASBESTOS ABATEMENT WORK. CONTRACTOR SHALL COMMUNICATE WITH THE AAC AND MAKE ADEQUATE ALLOWANCE FOR THE ASBESTOS ABATEMENT WORK IN THE WORK SCHEDULE. CONTRACTOR SHALL ISOLATE ELECTRICAL, PLUMBING, AND MECHANICAL SYSTEMS NECESSARY FOR AAC TO PERFORM ASBESTOS ABATEMENT WORK. THE CONTRACTOR IS RESPONSIBLE FOR EXCAVATING AND REMOVAL OF BOX CONDUIT LIDS TO MAKE INSIDE OF BOX CONDUIT AVAILABLE TO THE AAC TO REMOVE PIPING INSULATION.
 25. FOR SALVAGED ART SCULPTURE SEE REQUIREMENTS IN SECTION 02 41 13 - DEMOLITION AND SITE LAYOUT PLAN C200.
 26. THE CONTRACTOR SHALL DELIVER SALVAGED TREE GRATES NOT BEING REUSED TO CITY OF MADISON GOODMAN PARK MAINTENANCE FACILITY AT 1402 WINGRA CREEK PARKWAY, MADISON, WI. CONTACT DEAN KAHL AT 608-266-4894 TO COORDINATE DELIVERY OF SALVAGED MATERIALS.
 27. ACCESSIBLE ACCESS MUST BE MAINTAINED TO ENTRY DOORS OF OGG HALL AT ALL TIMES DURING CONSTRUCTION (WHEN CLASS IS IN SESSION). CONTRACTOR TO COORDINATE WITH CONSTRUCTION SCHEDULE AND CONSTRUCTION STAGING WITH UW-MADISON PRIOR TO STARTING.

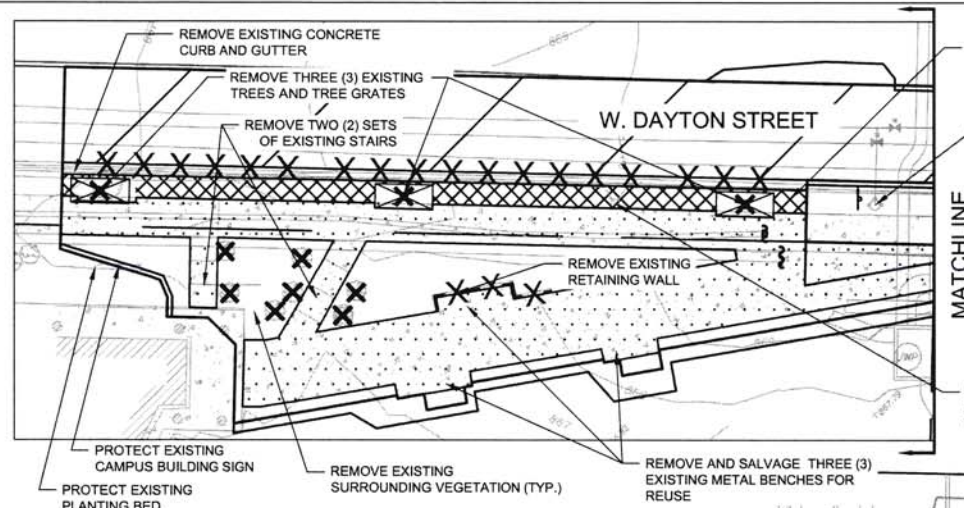

REMOVALS AT WEST BUS PULL OFF

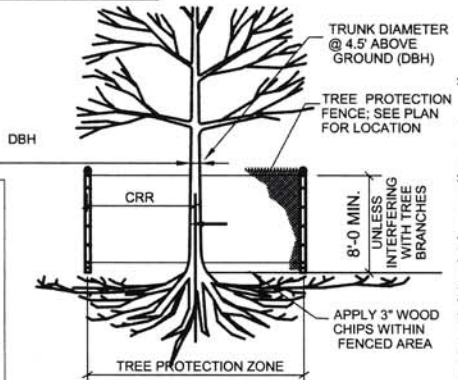

- LEGEND**
- SITE LIMITS
 - UTILITY/FENCE/WALL/ CURB & GUTTER REMOVAL
 - TREE PROTECTION FENCE (CHAIN LINK)
 - PAVEMENT SAWCUT (FULL DEPTH)
 - PAVEMENT/SIDEWALK/BASE REMOVAL (FULL DEPTH)
 - REMOVING ASPHALTIC SURFACE MILLING, 2"
 - UNDERGROUND UTILITY LOCATE (ULO) REQUIRED - SEE SPECIFICATION SECTION 31 23 16.13

TREE PROTECTION ZONE FENCING SHALL BE THE CRR, DRIPLINE OF THE TREE OR AS SHOWN ON THE PLANS, WHICHEVER IS GREATER.
 CRITICAL ROOT RADIUS (CRR) IN FEET = 1.5 x DBH IN INCHES

- PROHIBITED WITHIN TREE PROTECTION ZONE:**
1. NO CONSTRUCTION STAGING OR MATERIALS STORAGE
 2. NO DISPOSAL OF CONSTRUCTION MATERIALS, BYPRODUCTS, OR SOLUTIONS
 3. NO GRADING
 4. NO TRENCHING; UTILITY PIPES MUST BE TUNNELED
 5. HAND EXCAVATION ONLY
 6. SEE SPECIFICATION SECTION 31-13-16 FOR MORE INFORMATION

TREE PROTECTION DETAIL

- NOTES:**
1. UNLESS OTHERWISE NOTED, ALL REMOVED ITEMS SHALL BE PROPERLY DISPOSED OF BY THE CONTRACTOR.
 2. REMOVE AND REPLACE CONCRETE PAVEMENTS, SIDEWALKS, AND CURB AND GUTTER JOINT-TO-JOINT TO THE NEAREST EXISTING JOINT. SAWCUT EXISTING PAVEMENTS TO MAKE A FLUSH MATCH TO NEW PAVEMENTS.
 3. ANY ITEMS DAMAGED DURING CONSTRUCTION SHALL BE REMOVED AND REPLACED TO THE SPECIFICATIONS OF THE OWNER/ENGINEER.
 4. ALL CAMPUS BENCHMARKS, CONTROL POINTS, AND PROPERTY IRONS SHALL BE PROTECTED AND CONTRACTOR SHALL REPLACE ANY THAT ARE DISTURBED DURING CONSTRUCTION.
 5. CONTRACTOR SHALL LEAVE AND PROTECT ALL EXISTING SITE STRUCTURES AND UTILITIES NOT NOTED FOR REMOVAL OR ABANDONMENT.
 6. CONTRACTOR TO REMOVE MATERIALS AS NECESSARY TO COMPLETE PROJECT WORK. ALL SITE RESTORATION SHALL BE TO LIMITS OF ACTUAL REMOVALS.
 7. UNLESS OTHERWISE INDICATED, LIMIT DEMOLITION AND REMOVALS ONLY AS NEEDED FOR PROPOSED SITE IMPROVEMENTS.
 8. ALL WORK SHALL COMPLY WITH UNIVERSITY OF WISCONSIN - MADISON TECHNICAL GUIDELINES.
 9. ALL WORK IN CITY OF MADISON RIGHT-OF-WAY SHALL CONFORM TO CITY OF MADISON STANDARDS, SPECIFICATIONS, PERMIT CONDITIONS, AND ORDINANCES.
 10. COORDINATE DEMOLITION OF ELECTRICS WITH ELECTRICAL CONTRACTOR.
 11. CONTRACTOR SHALL OBTAIN ALL NECESSARY PERMITS FROM THE CITY OF MADISON FOR WORK IN THEIR RIGHT-OF-WAY AND ON CITY-OWNED UTILITIES. THIS INCLUDES, BUT IS NOT LIMITED TO, EXCAVATION IN THE RIGHT-OF-WAY, PARTIAL STREET CLOSURES, SIDEWALK CLOSURES, SANITARY AND STORM SEWER CONNECTIONS, AND WATER MAIN CONNECTIONS.
 12. CONTRACTOR SHALL OBTAIN ANY PERMITS REQUIRED AND PAY FOR ALL COSTS ASSOCIATED WITH TAKING EXISTING CITY OF MADISON PARKING STALLS OUT OF SERVICE FOR CONSTRUCTION ACTIVITIES.
 13. CONTRACTOR SHALL OBTAIN ANY PERMITS REQUIRED AND PAY FOR ALL COSTS ASSOCIATED FOR REMOVING AND REPLACING EXISTING PARKING METERS, SIGNS OR PAY STATIONS.
 14. CONTRACTOR SHALL REMOVE AND REPLACE, IN KIND OR AS OTHERWISE INDICATED ON THE DRAWINGS, ALL EXISTING SIGNS/POSTS WITHIN THE PROJECT LIMITS.
 15. ALL BIKE RACKS WITHIN PROJECT LIMITS SHALL BE REMOVED AND DELIVERED TO THE UNIVERSITY FOR SALVAGING
 16. ALL SIGNS ON THE SERF PROPERTY SHALL BE REMOVED AND DELIVERED TO THE UNIVERSITY FOR SALVAGING
 17. SALVAGE EXISTING UNIT PAVERS IN EAST CAMPUS MALL DISTURBED BY CONSTRUCTION. TO BE REUSED AS SHOWN IN SITE PLAN.
 18. SITE LIGHTING SYSTEM SHALL BE REMOVED PER E050 SITE PLAN ELECTRIC. LIGHT POLES, MAST ARMS AND LUMINAIRES TO BE REMOVED SHALL BE SALVAGED AND DELIVERED TO THE UNIVERSITY.
 19. THE CONTRACTOR SHALL CONTACT THE UW-MADISON GROUNDS CREW TO HAVE THEM REMOVE THE CONCRETE PLANTERS ON THE WEST SIDE OF EAST CAMPUS MALL A MINIMUM OF 10 DAYS PRIOR TO CONSTRUCTION OF THE CONSTRUCTION FENCE IN EAST CAMPUS MALL.

NOTES CONTINUED AT TOP OF PAGE

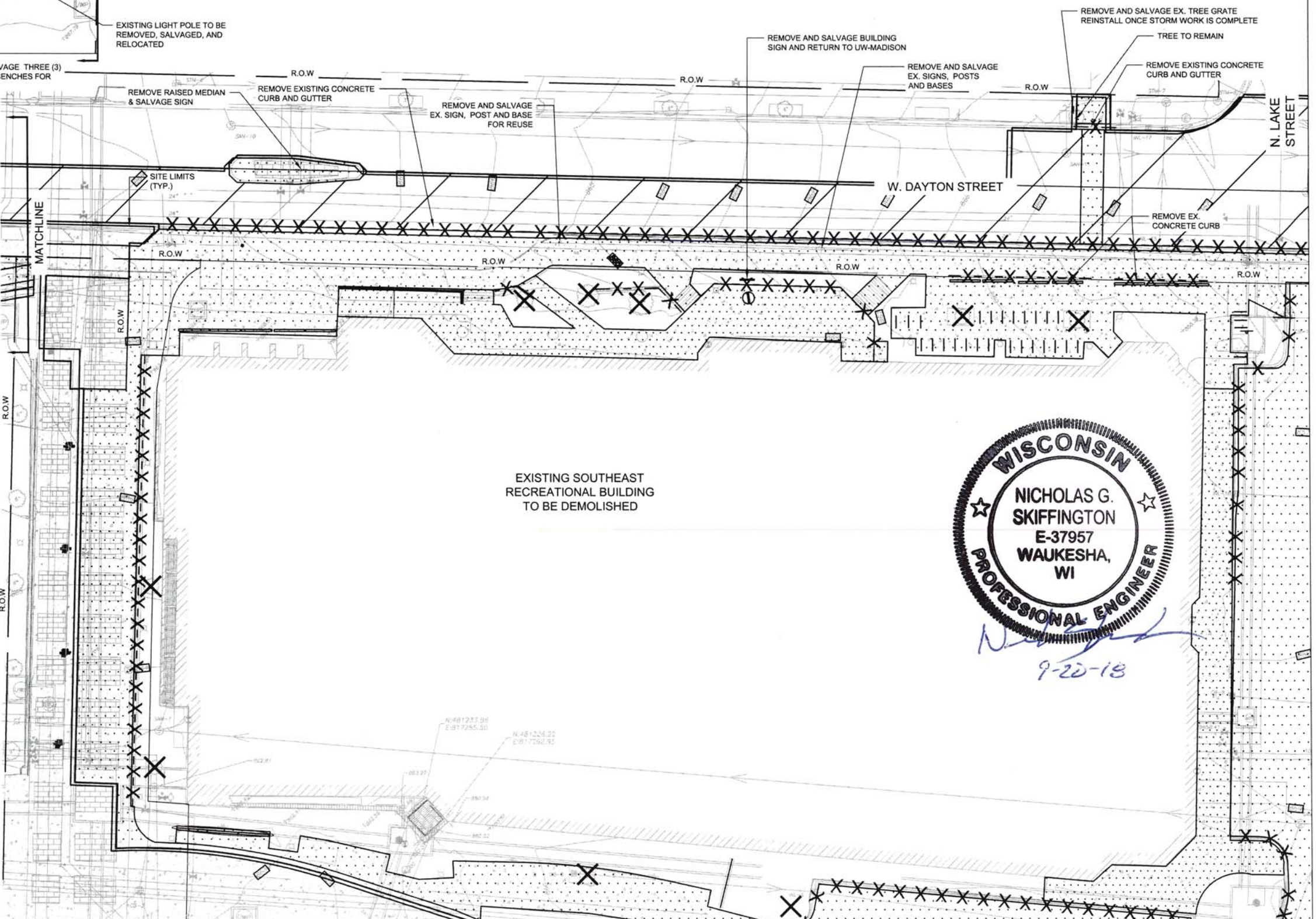

PLOT SCALE:

PLOT NAME:

REV. DATE:

ORIGINATOR: CITY OF MADISON, STREETS, DIVISION

REV 5-10-19

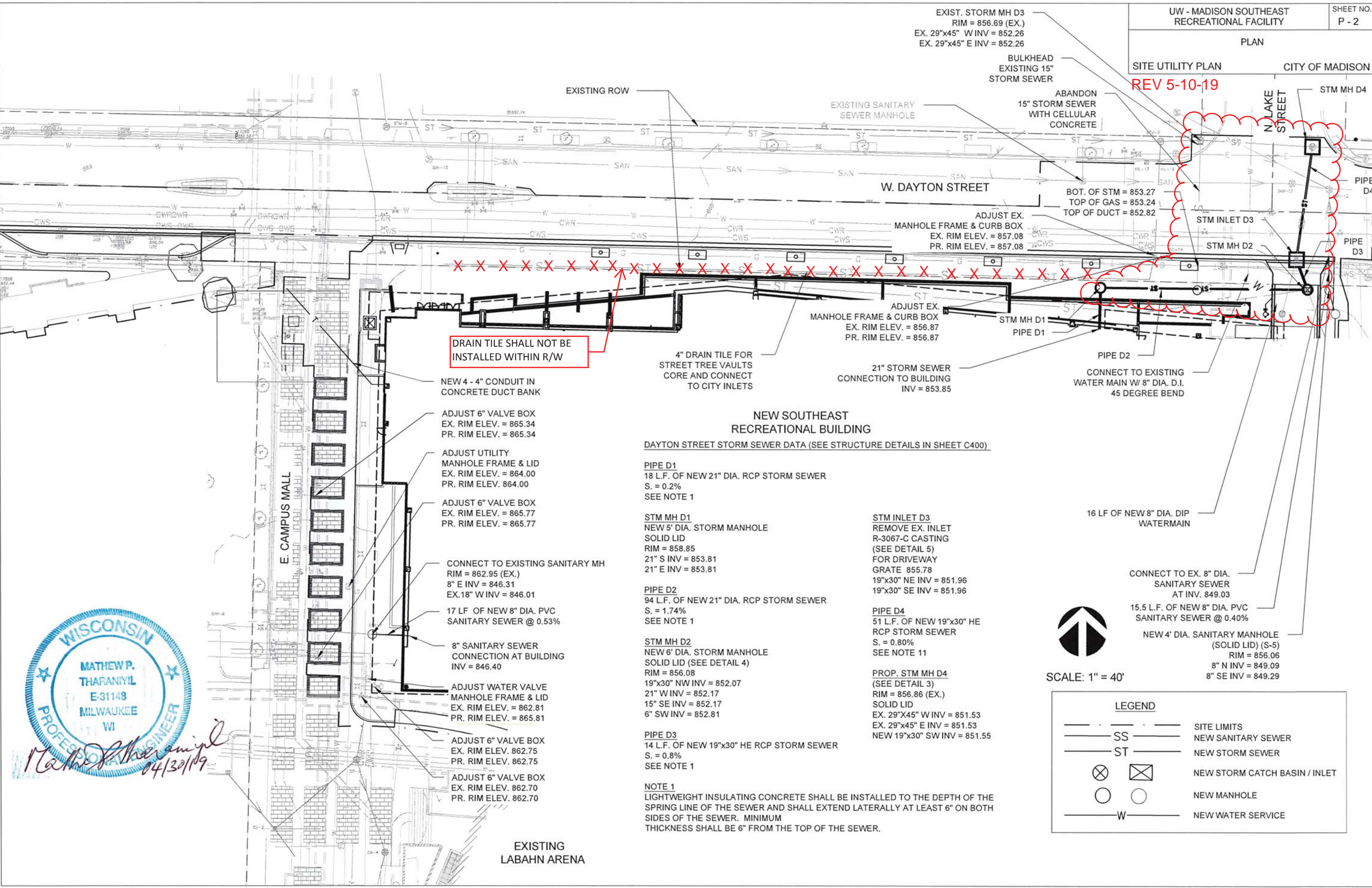

DRAIN TILE SHALL NOT BE INSTALLED WITHIN R/W

NEW SOUTHEAST RECREATIONAL BUILDING

DAYTON STREET STORM SEWER DATA (SEE STRUCTURE DETAILS IN SHEET C400)

PIPE D1
18 L.F. OF NEW 21" DIA. RCP STORM SEWER
S. = 0.2%
SEE NOTE 1

STM MH D1
NEW 5' DIA. STORM MANHOLE
SOLID LID
RIM = 858.85
21" S INV = 853.81
21" E INV = 853.81

PIPE D2
94 L.F. OF NEW 21" DIA. RCP STORM SEWER
S. = 1.74%
SEE NOTE 1

STM MH D2
NEW 6' DIA. STORM MANHOLE
SOLID LID (SEE DETAIL 4)
RIM = 856.08
19"x30" NW INV = 852.07
21" W INV = 852.17
15" SE INV = 852.17
6" SW INV = 852.81

PIPE D3
14 L.F. OF NEW 19"x30" HE RCP STORM SEWER
S. = 0.8%
SEE NOTE 1

NOTE 1
LIGHTWEIGHT INSULATING CONCRETE SHALL BE INSTALLED TO THE DEPTH OF THE SPRING LINE OF THE SEWER AND SHALL EXTEND Laterally AT LEAST 6" ON BOTH SIDES OF THE SEWER. MINIMUM THICKNESS SHALL BE 6" FROM THE TOP OF THE SEWER.

STM INLET D3
REMOVE EX. INLET R-3067-C CASTING (SEE DETAIL 5) FOR DRIVEWAY GRATE 855.78
19"x30" NE INV = 851.96
19"x30" SE INV = 851.96

PIPE D4
51 L.F. OF NEW 19"x30" HE RCP STORM SEWER
S. = 0.80%
SEE NOTE 11

PROP. STM MH D4
(SEE DETAIL 3)
RIM = 856.86 (EX.)
SOLID LID
EX. 29"x45" W INV = 851.53
EX. 29"x45" E INV = 851.53
NEW 19"x30" SW INV = 851.55

16 LF OF NEW 8" DIA. DIP WATERMAIN

CONNECT TO EX. 8" DIA. SANITARY SEWER AT INV. 849.03

15.5 L.F. OF NEW 8" DIA. PVC SANITARY SEWER @ 0.40%

NEW 4' DIA. SANITARY MANHOLE (SOLID LID) (S-5)
RIM = 856.06
8" N INV = 849.09
8" SE INV = 849.29



LEGEND	
---	SITE LIMITS
SS	NEW SANITARY SEWER
ST	NEW STORM SEWER
⊗	NEW STORM CATCH BASIN / INLET
○	NEW MANHOLE
W	NEW WATER SERVICE



PLOT SCALE:

PLOT NAME:

REV. DATE:

ORIGINATOR: CITY_OF_MADISON_STREETS_DIVISION

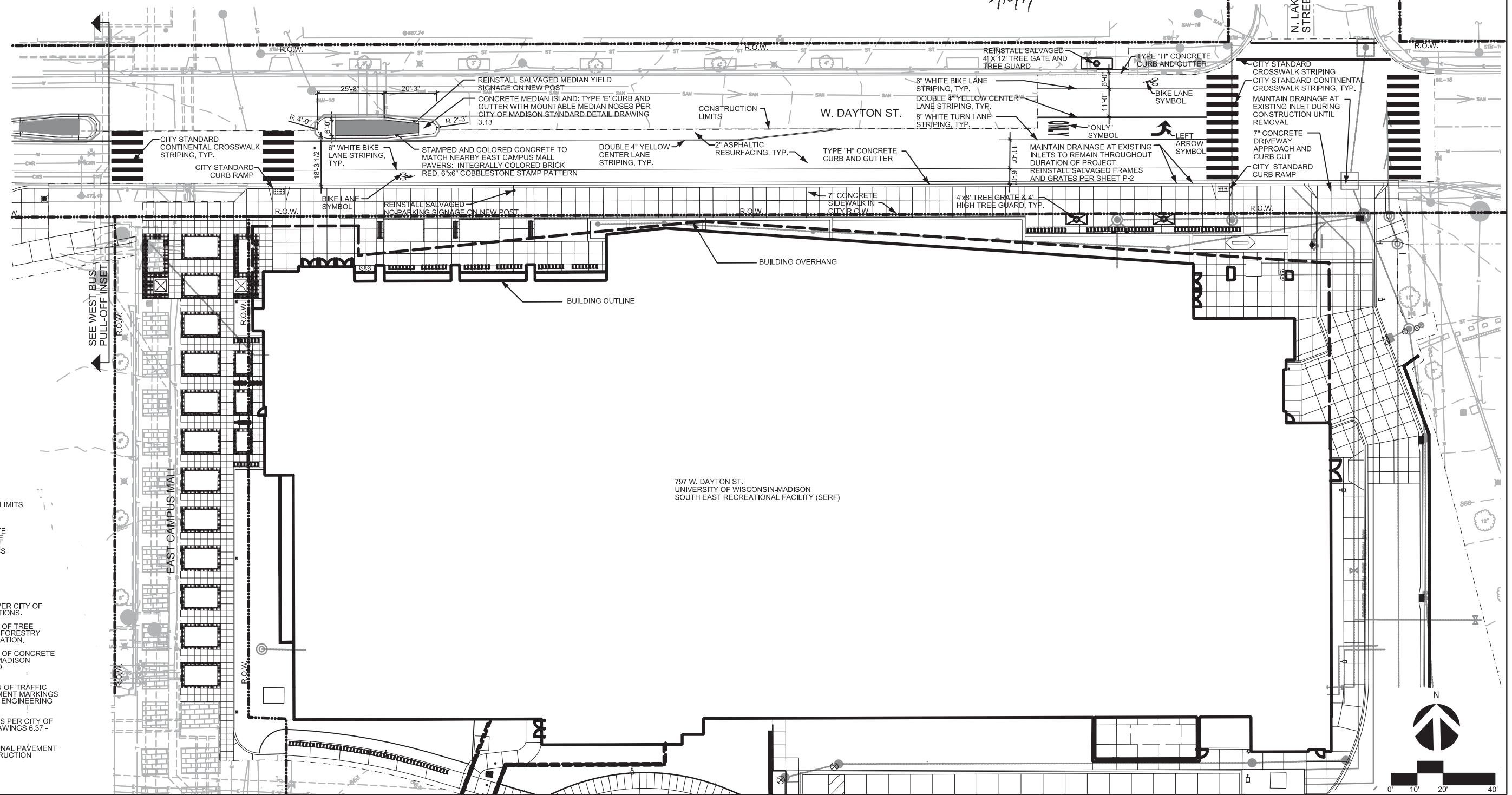
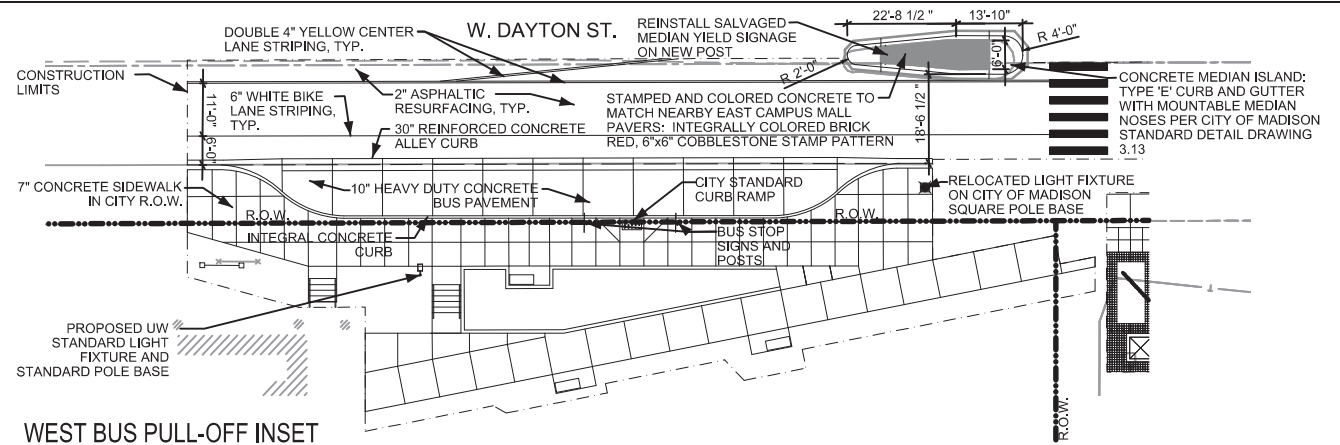

LEGEND

--- CONSTRUCTION LIMITS

4' x 8' TREE GRATE AND 4' HIGH TREE GUARD PER CITY STANDARD SPECS

NOTES:

1. PROVIDE EXPANSION JOINTS PER CITY OF MADISON STANDARD SPECIFICATIONS.
2. COORDINATE FINAL LOCATION OF TREE GRATES WITH CITY OF MADISON FORESTRY DEPARTMENT PRIOR TO INSTALLATION.
3. COORDINATE FINAL LOCATION OF CONCRETE MEDIAN ISLANDS WITH CITY OF MADISON TRAFFIC ENGINEERING PRIOR TO CONSTRUCTION.
4. COORDINATE FINAL LOCATION OF TRAFFIC SIGNAGE AND LAYOUT OF PAVEMENT MARKINGS WITH CITY OF MADISON TRAFFIC ENGINEERING PRIOR TO CONSTRUCTION.
5. PROVIDE PAVEMENT MARKINGS PER CITY OF MADISON STANDARD DETAIL DRAWINGS 6.37 - 6.40.
6. REPLACE IN KIND ANY ADDITIONAL PAVEMENT MARKINGS DAMAGED BY CONSTRUCTION ACTIVITIES.

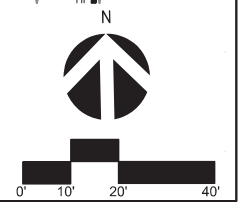

PLOT SCALE: _____
 PLOT NAME: _____
 REV. DATE: _____
 ORIGINATOR: CITY_OF_MADISON_STREETS_DIVISION

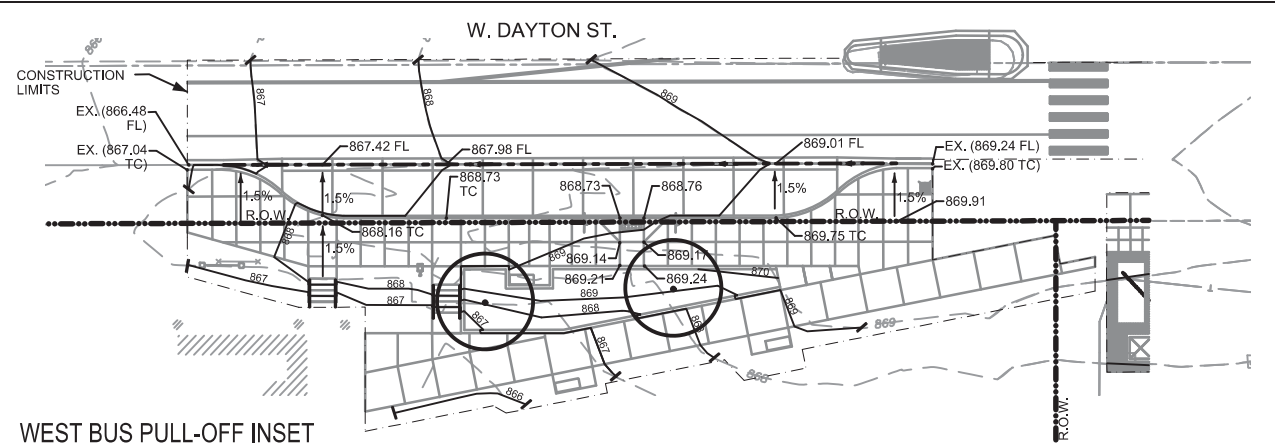

WEST BUS PULL-OFF INSET

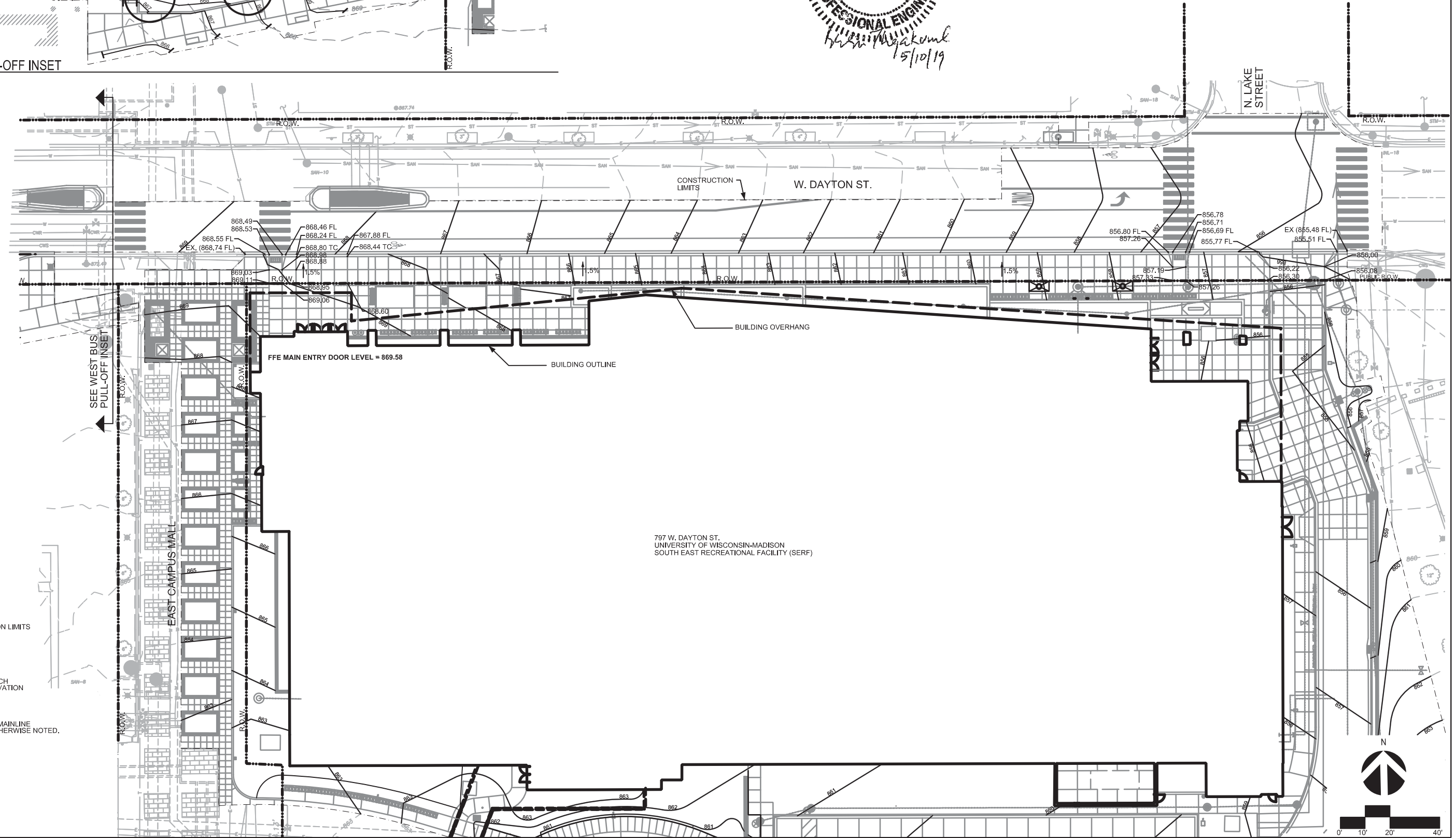

797 W. DAYTON ST.
UNIVERSITY OF WISCONSIN-MADISON
SOUTH EAST RECREATIONAL FACILITY (SERF)

- LEGEND**
- CONSTRUCTION LIMITS
 - EX EXISTING
 - FL FLOW LINE
 - TC TOP OF CURB
 - () VERIFY & MATCH EXISTING ELEVATION

NOTES:
1. TYPICAL CROSS SLOPE ON MAINLINE SIDEWALK IS 1.5% UNLESS OTHERWISE NOTED.

PLOT SCALE: _____
 PLOT NAME: _____
 REV. DATE: _____
 ORIGINATOR: CITY_OF_MADISON_STREETS_DIVISION

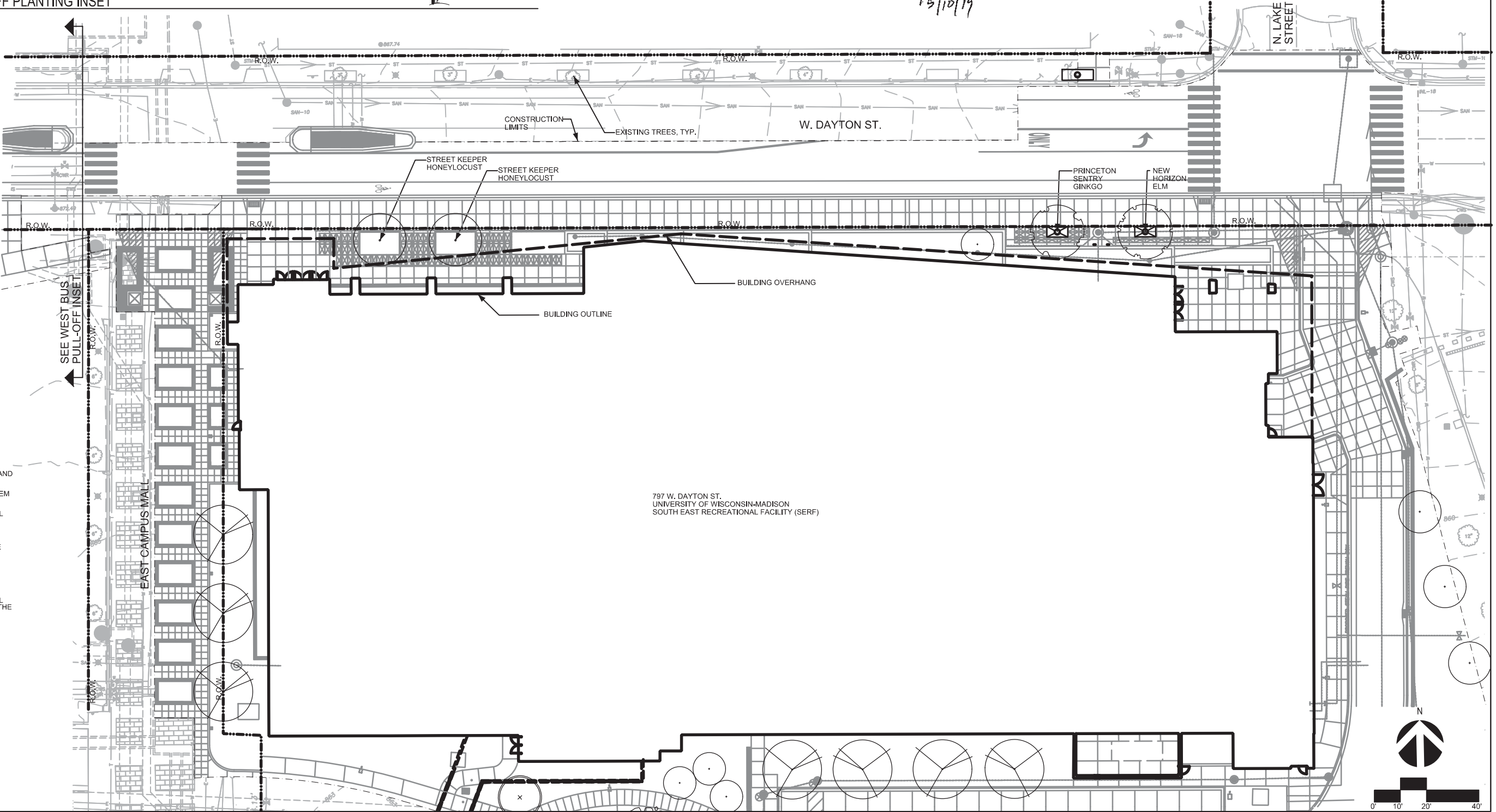
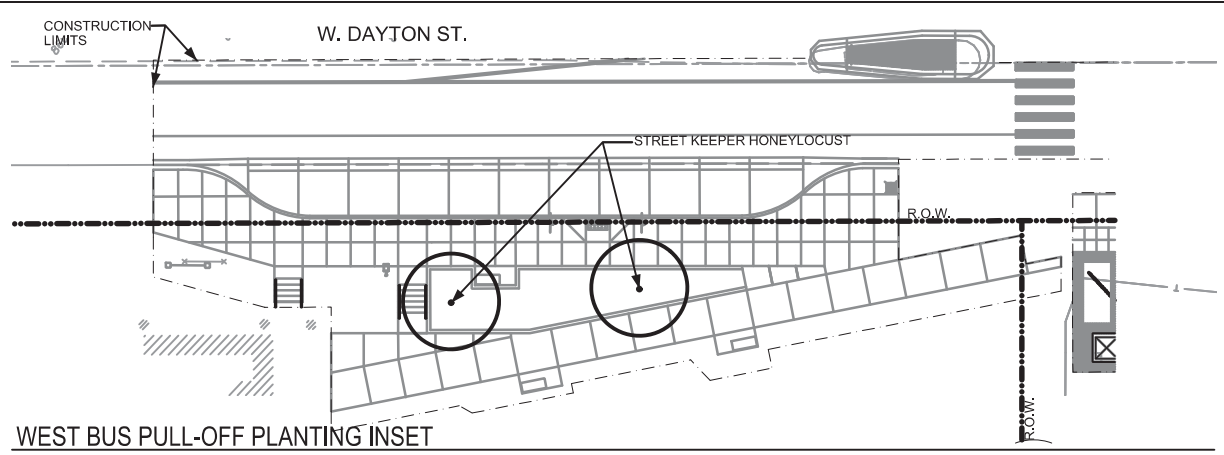

- LEGEND**
- 4' x 8' TREE GRATE AND 4' HIGH TREE GUARD PER CITY STANDARD SPECS WITH NEW TREE PLANTING. SPECIES AS NOTED
 - SUSPENDED PAVEMENT SYSTEM

- NOTES:**
1. COORDINATE FINAL TREE LOCATIONS AND PLANTING WITH CITY FORESTRY.
 2. INSTALL SUSPENDED PAVEMENT SYSTEM PER MANUFACTURER SPECIFICATIONS.
 3. SUSPENDED PAVEMENT SYSTEM SHALL INCLUDE GEOGRID AS REQUIRED BY THE MANUFACTURER'S SPECIFICATIONS.
 4. A MINIMUM 6" GAP, CENTERED ON THE TREE GRATE OPENING, SHALL BE PROVIDED FOR TREE PLANTING.
 5. BACKFILL THE SUSPENDED PAVEMENT SYSTEM WITH THE AMENDED PLANTING SOIL MIXTURE AS SPECIFIED WITH THE CONTRACT DOCUMENTS.
 6. SUSPENDED PAVEMENT SYSTEM SHALL BE LOCATED A MINIMUM OF 1 FOOT OFF THE BACK OF CURB, IN ALL LOCATIONS.

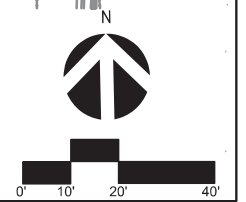

PLOT SCALE: _____
 PLOT NAME: _____
 REV. DATE: _____
 ORIGINATOR: CITY_OF_MADISON_STREETS_DIVISION

COORDINATE ELECTRICAL WORK
WITH CITY TRAFFIC ENGINEERING -
CONTACT: TROY VANT 608-395-1975.

CONDUIT TO BE PLACED PER CITY
STANDARD SPECIFICATIONS - S.D.D.
6.46

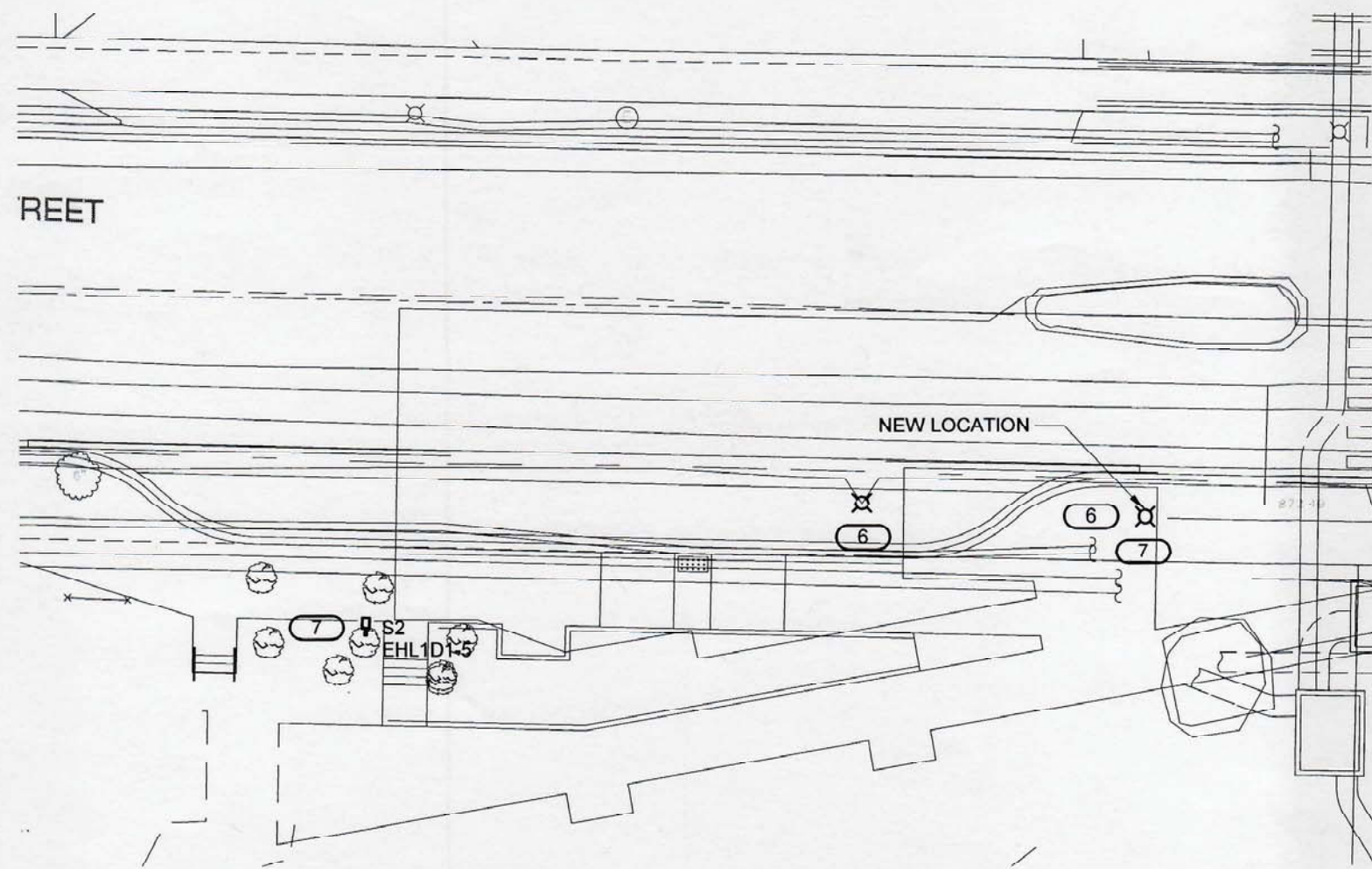

11-29-18

- KEYNOTES:** #
5. DEMO EXISTING SITE LIGHTING.
 6. DISCONNECT AND REMOVE EXISTING SITE LIGHTING; PROTECT AND RETAIN FOR RE-INSTALLATION AFTER COMPLETION OF OTHER WORK IN THIS AREA. FIXTURE TO BE CLEANED AND RELAMPED PRIOR TO RE-INSTALLATION IN NEW LOCATION. REFER TO 5/E401 FOR BASE DETAIL. EXTEND CONDUIT AND WIRE TO NEW LOCATION, MATCHING CONDUIT AND WIRE SIZE.
 7. PROVIDE A SPARE CONDUIT FOR FUTURE OUT OF POLE BASE.



SITE PLAN - ELECTRICAL

1" = 20'-0"

PLOT SCALE:
 PLOT NAME:
 REV. DATE:
 ORIGINATOR: CITY OF MADISON, STREETS DIVISION

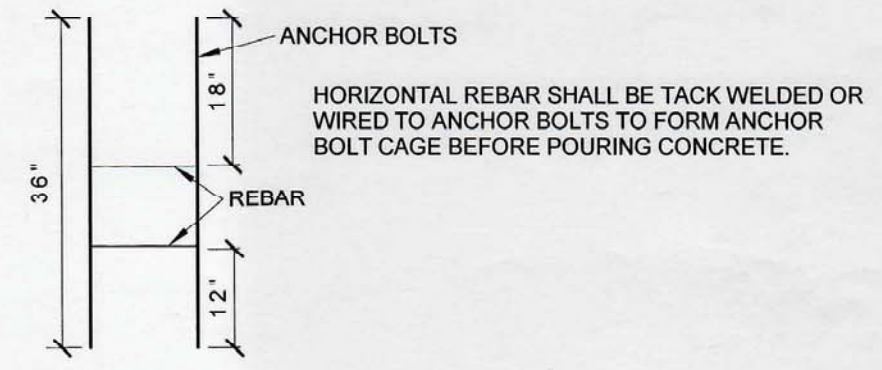
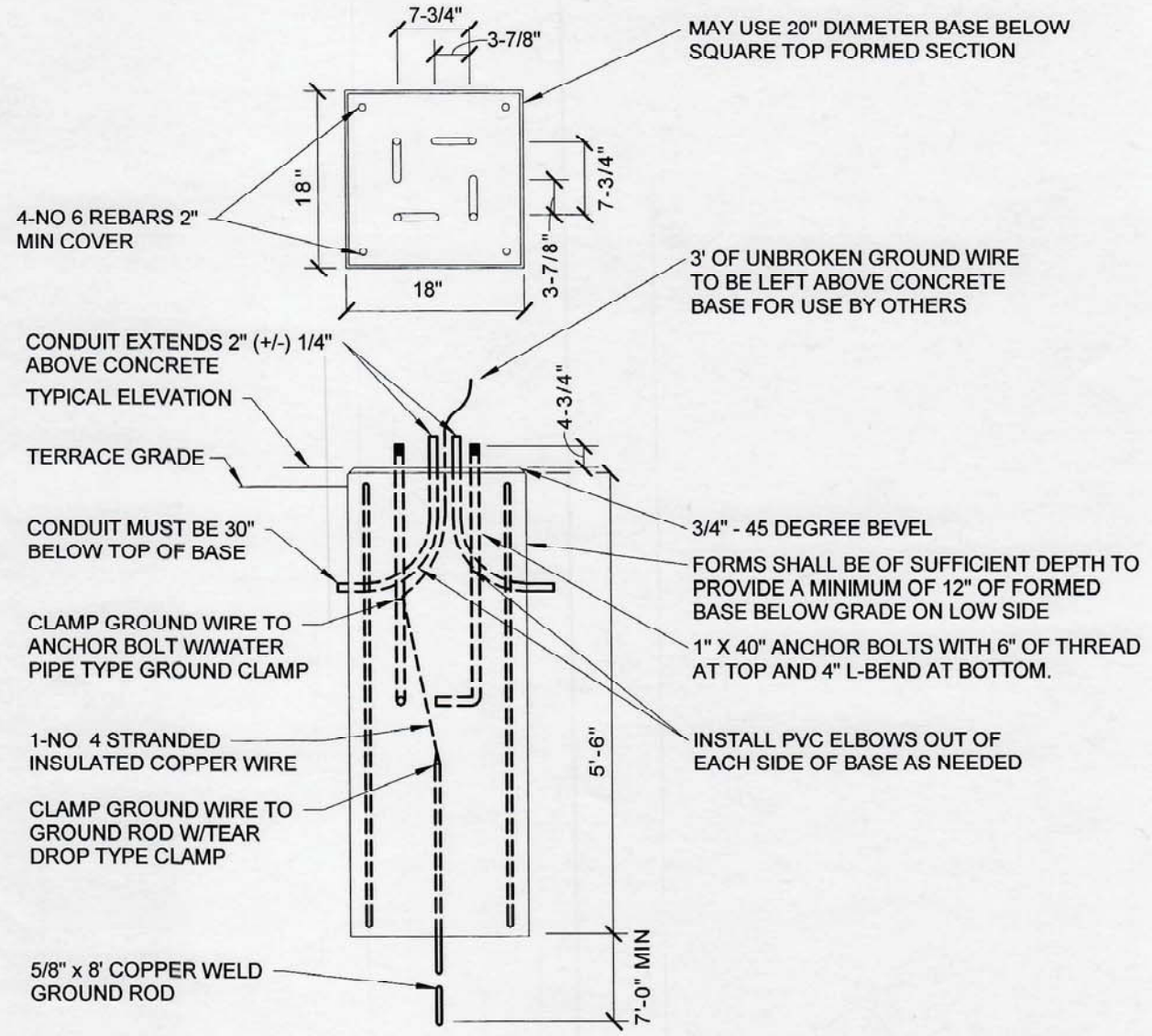

1 CITY OF MADISON – SQUARE POLE BASE DETAIL
NO SCALE



PLOT SCALE:
 PLOT NAME:
 REV. DATE:
 ORIGINATOR: CITY_OF_MADISON_STREETS_DIVISION

N/A TO R/W DOCS

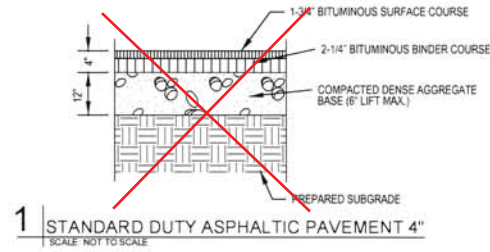

N/A TO R/W DOCS

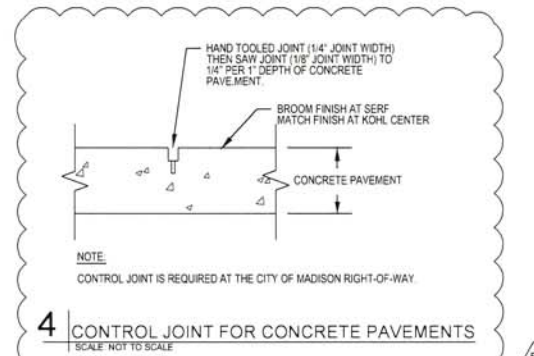
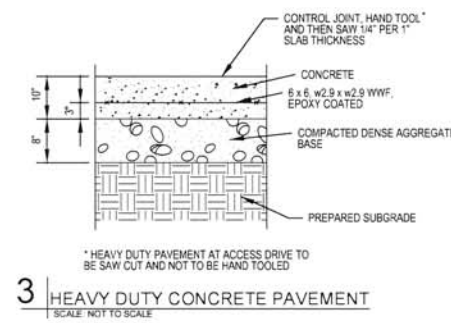
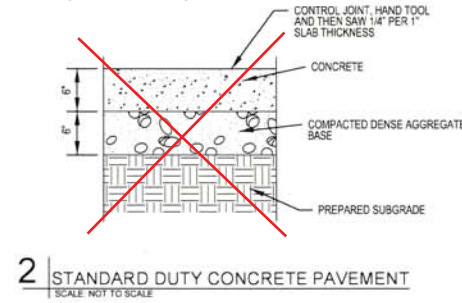

N/A TO R/W DOCS

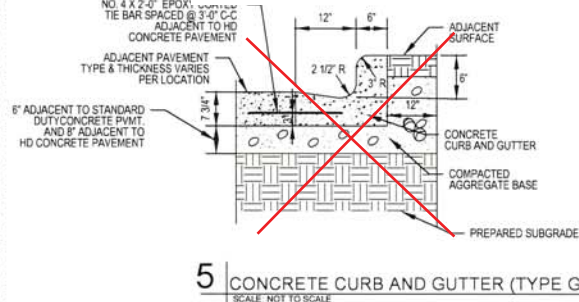

N/A TO R/W DOCS

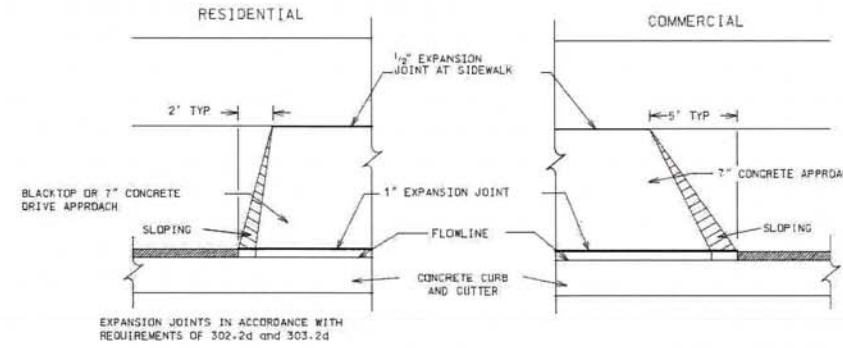
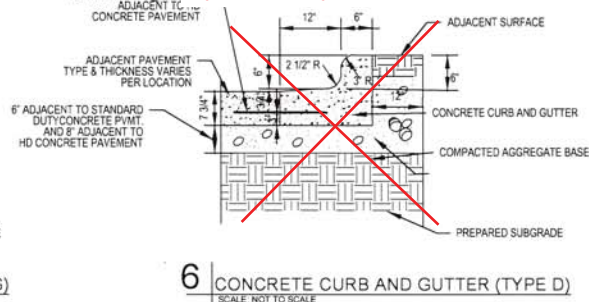

N/A TO R/W DOCS

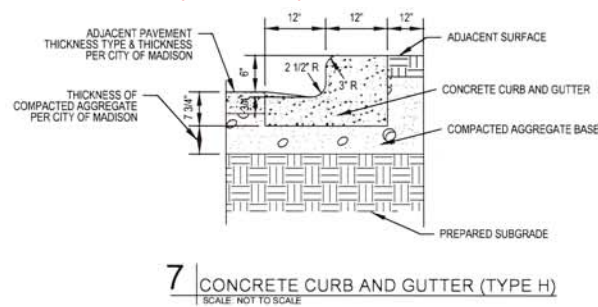

N/A TO R/W DOCS

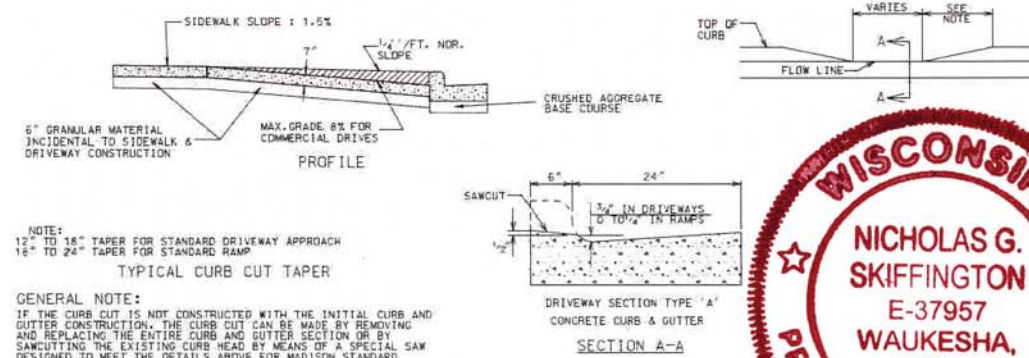
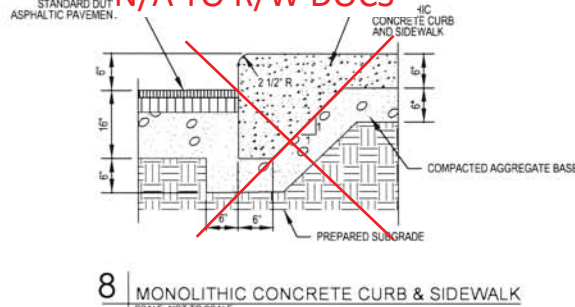

9 CONCRETE DRIVEWAY APPROACH AND CURB CUT

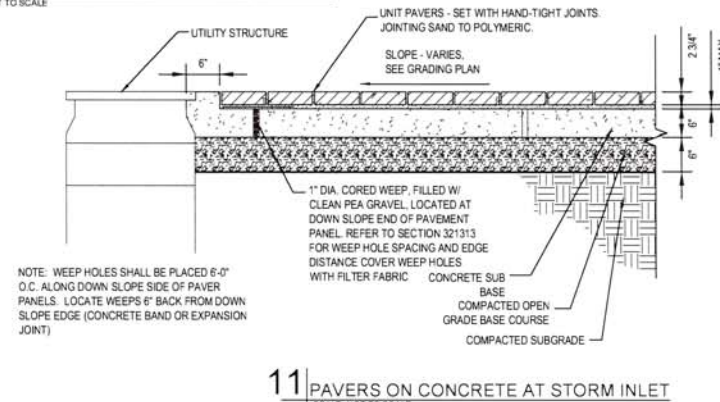
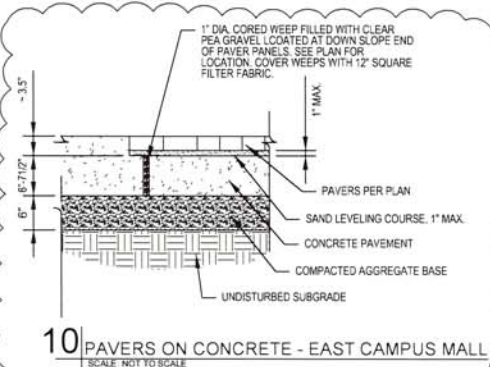

12 PAVERS IN CITY OF MADISON RIGHT OF WAY

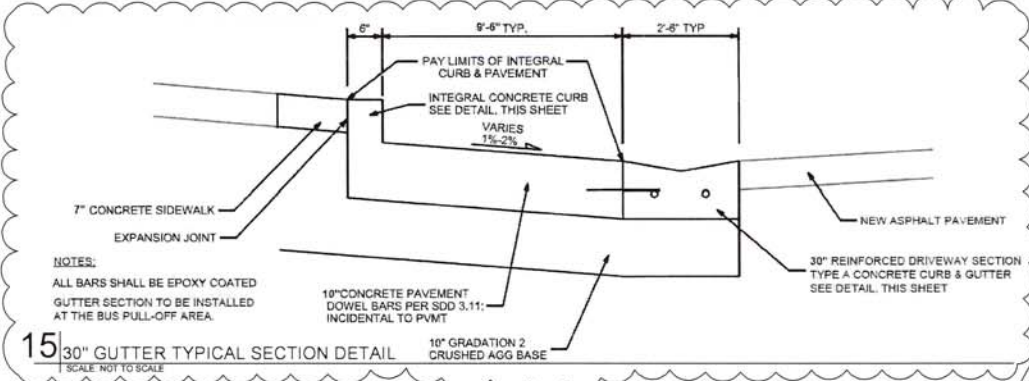
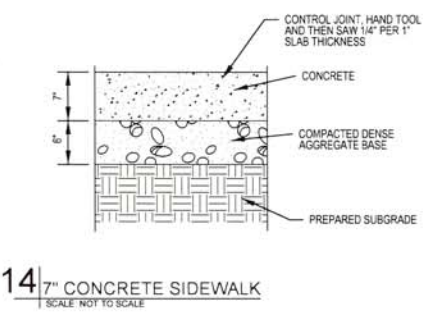
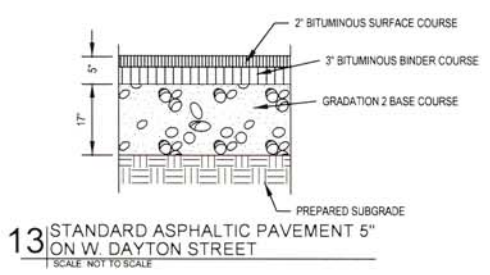

WORKSHOP
101k

Hellmuth, Obata + Kassabaum, Inc.
300 West 22nd Street
Kansas City, MO 64108 USA
1-816-472-3360 F+1-816-472-2100

BLOOM COMPANIES, LLC
Infrastructure Innovation and Expertise
1001 P. Highway 200 • Waukesha, WI 53188
Phone: (414) 771-0200 Fax: (414) 771-4800

State of Wisconsin
Department of Administration
Division of Facilities Development

UNIVERSITY OF WISCONSIN - MADISON
Agency/Institution

SOUTHEAST RECREATIONAL FACILITY REPLACEMENT
797 W DAYTON STREET
MADISON, WI 53715

Sheet Title: SITE CIVIL DETAILS

Revisions	No.	Date	Description
	1	07/25/17	14L2T
	2	07/28/17	14L2T
	3	08/21/17	14L2T
	4	01/03/18	14L2T
	5	03/09/18	14L2T

Scale: 0' 5' 10' 20' 30'

Graphic Scale

Sheet Number: 14L2T

Set Type: CD

Date Issued: 09/22/2017

Sheet Number: C500

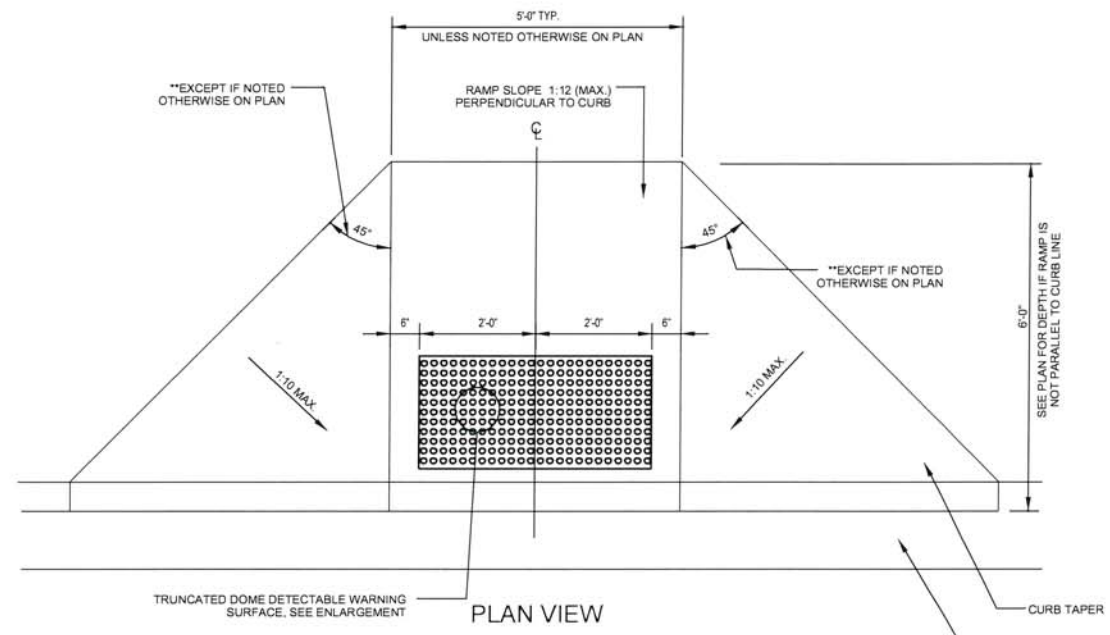

1 STANDARD CURB RAMP
SCALE: NOT TO SCALE

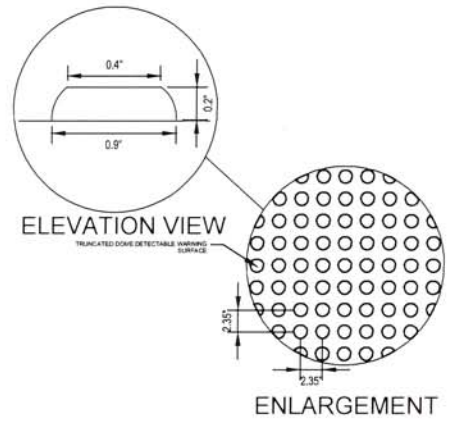

NOTES:
 1. DETECTABLE WARNING SURFACE SHALL BE A TRUNCATED DOME PANEL.
 2. DETECTABLE WARNING COATING SHALL BE NATURAL CAST-IRON COLOR/FINISH.
 3. PANELS SHALL BE EMBEDDED IN CONCRETE CURB RAMP IN ACCORDANCE WITH ADAAG REGULATIONS.

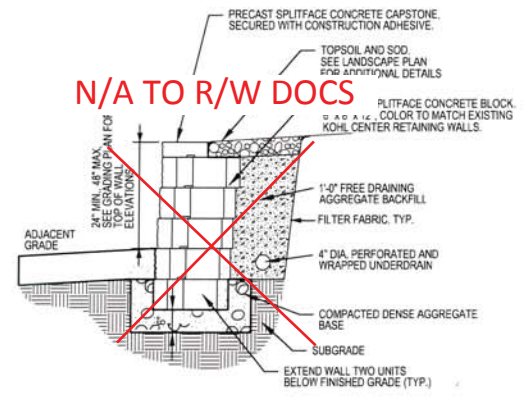

2 CONCRETE BLOCK RETAINING WALL
SCALE: NOT TO SCALE

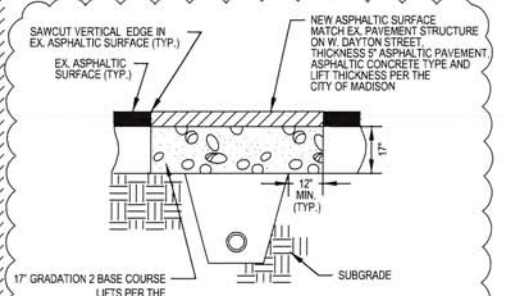

3 PAVEMENT PATCH (TYPE III)
SCALE: NOT TO SCALE

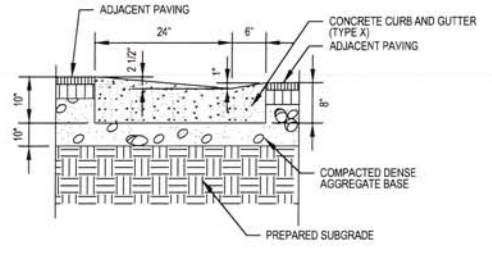

4 CONCRETE CURB & GUTTER (TYPE X)
SCALE: NOT TO SCALE

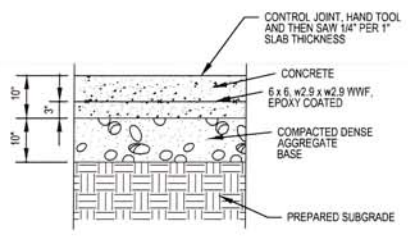

5 HEAVY DUTY CONCRETE BUS PAVEMENT
SCALE: NOT TO SCALE

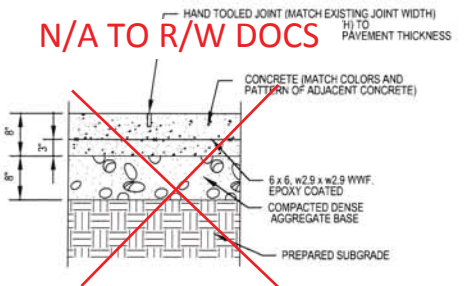

6 HEAVY DUTY CONCRETE PAVEMENT, KOHL CENTER CONTROL JOINT
SCALE: NOT TO SCALE

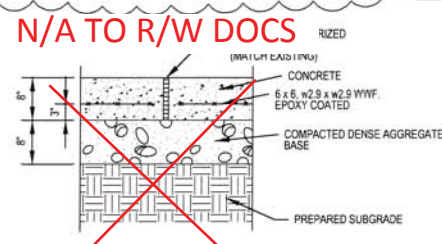

7 HEAVY DUTY CONCRETE PAVEMENT, KOHL CENTER EXPANSION JOINT
SCALE: NOT TO SCALE

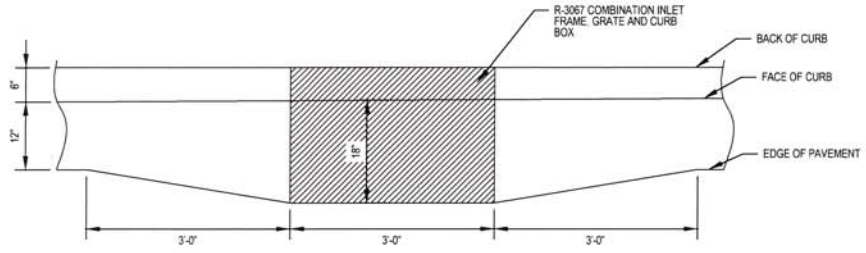

8 PLAN VIEW GUTTER WIDENING AT R-3067 CASTING DETAIL
SCALE: NOT TO SCALE

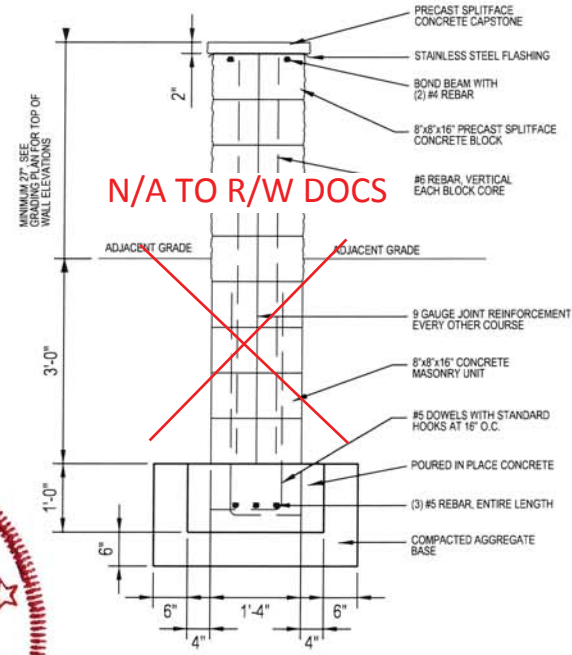

10 SITE SECURITY WALL DETAIL
SCALE: NOT TO SCALE

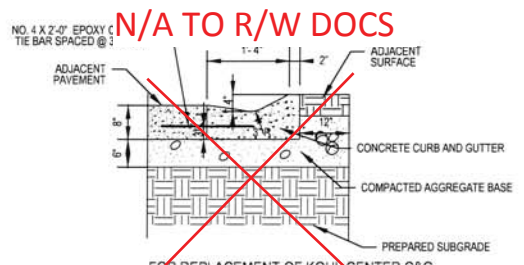

9 CONCRETE CURB AND GUTTER (SPECIAL)
SCALE: NOT TO SCALE

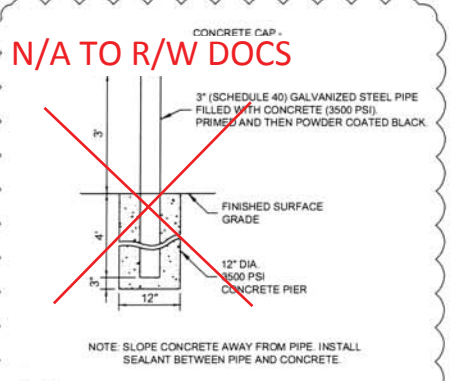

11 SITE BOLLARD DETAIL
SCALE: NOT TO SCALE



No.	Date	Description	Rev. Set
1	10/28/17	ADDENDUM NO. 2	
2	10/28/17	CONSTRUCTION SET	1009