

Madison, Wisconsin

CITY OF MADISON

CITY ENGINEERING DIVISION

DEPARTMENT OF PUBLIC WORKS

PLAN OF PROPOSED IMPROVEMENT

PUBLIC IMPROVEMENT PROJECT APPROVED

JANUARY 8, 2019

BY THE COMMON COUNCIL OF MADISON, WISCONSIN

PUBLIC IMPROVEMENT DESIGN APPROVED BY:

[Signature] 8/27/19
City Engineer Date

STREET & SANITARY SEWER DESIGNED BY:

WISCONSIN
[Signature]
JAMES M WOLFE
E-42725
MADISON, WI
PROFESSIONAL ENGINEER
8-26-19

ELECTRICAL DESIGNED BY:

WISCONSIN
[Signature]
BRIAN J. SMITH
E-37284
MADISON, WI
PROFESSIONAL ENGINEER
8-26-19

INDEX OF SHEETS

SHEET NO.	TITLE
1	NOTES & DETAILS
DI-D2	ELECTRICAL PLAN
E1-E2	STREET PLAN AND PROFILES
PI-P3	LANDSCAPING PLAN
LI	UTILITIES PLAN

211 N. CARROLL STREET

CITY PROJECT NO. 11973

CITY CONTRACT NO. 8281

MUNIS NO. 11973

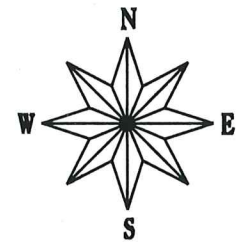

PROJECT LOCATION

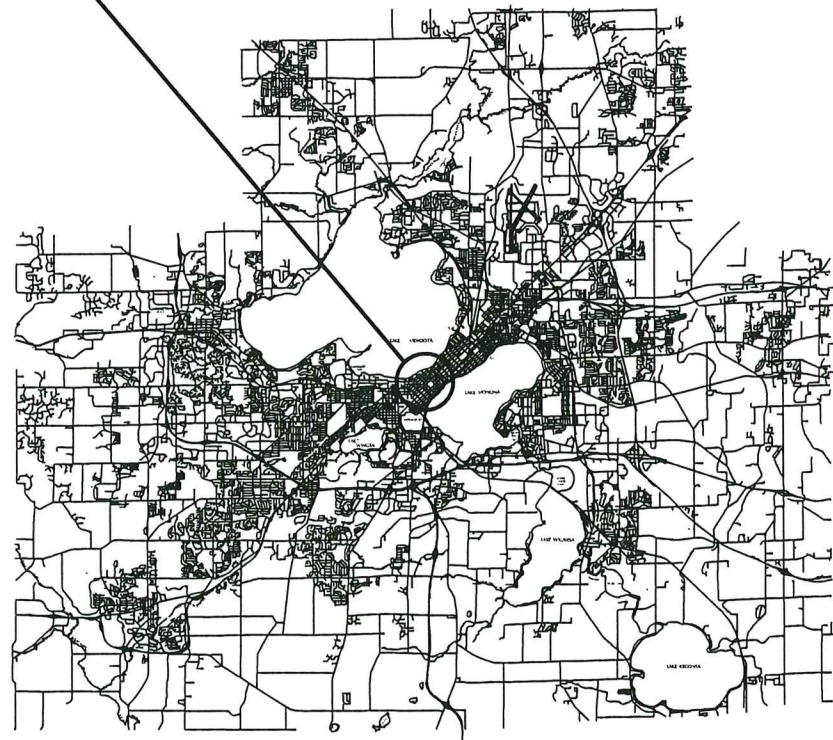
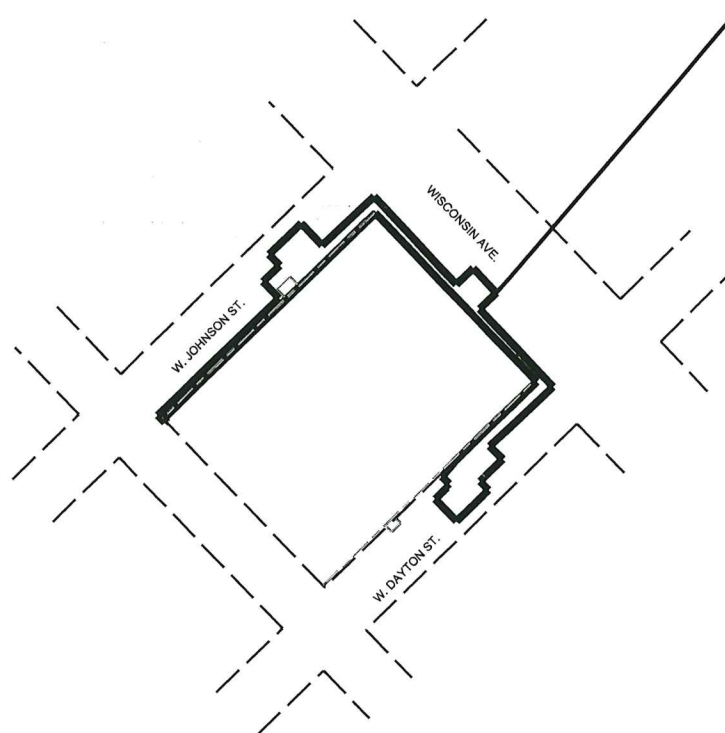

PLOT SCALE: _____

PLOT NAME: _____

REV. DATE: _____

ORIGINATOR: CITY OF MADISON, STREETS DIVISION

ALL ASPHALT PAVEMENT WITHIN THE PROJECT LIMITS SHALL MAX EXISTING THICKNESSES OR MEET TYPE "C" ASPHALT PAVEMENT PER S.D.D. 4.06, WHICHEVER IS GREATER.

THE DEVELOPER SHALL REPLACE ALL CURB & GUTTER AND SIDEWALK THAT IS DAMAGED OR DETERMINED TO BE IN UNSATISFACTORY CONDITION.

ALL GUTTERS SHALL DRAIN WITH A MINIMUM GRADES OF 0.5% TOWARD STORM SEWER INLETS.

ALL DISTURBED TERRRACE AREAS SHALL BE RESTORED WITH 6-INCHES OF TOP SOIL AND SEED UNLESS DIRECTED OTHERWISE ON THE PLAN OR BY THE CITY CONSTRUCTION ENGINEER.

TYPICAL PAVEMENT CROSS SLOPES SHALL BE 2% AND TERRACES SHALL SLOPE AT A 4% GRADE TOWARD THE GUTTER.

THE CROSS SLOPE OF SIDEWALKS AND BARRIER FREE SIDEWALK CURB RAMPS SHALL BE 1.5%. THE LONGITUDINAL GRADE OF BARRIER FREE SIDEWALK CURB RAMPS SHALL NOT EXCEED 8.33%. ALL SIDEWALK RAMPS SHALL BE CONSTRUCTED ACCORDING TO S.D.D. 3.03. AT ALL OTHER LOCATIONS THE LONGITUDINAL GRADE OF SIDEWALKS SHALL NOT EXCEED 5.0 % OR THE ADJACENT STREET GRADE WHICHEVER IS GREATER NOR BE LESS THAN 0.5% AND SHALL DRAIN TOWARD STORM SEWER INLETS. CONCRETE TERRACE SHALL BE INSTALLED BETWEEN THE SIDEWALK AND THE BACK OF CURB AT SIDEWALK LOW POINTS WHICH CANNOT OTHERWISE BE DRAINED DIRECTLY TO THE GUTTER. SIDE SLOPES WITHIN TEN FEET OF A PUBLIC SIDEWALK SHALL NOT EXCEED 4.00:1. ALL SIDEWALK AND SIDEWALK RAMP ELEVATIONS AND GRADES SHALL BE FIELD VERIFIED AND SET TO COMPLY WITH THE CITY OF MADISON STANDARD SPECIFICATIONS AND THE A.D.A. GUIDELINES.

OBTAIN A PRINT OUT OF THE ALIGNMENT FROM THE CITY ENGINEER PRIOR TO STAKING THIS PROJECT.

CURB STATION AND OFFSETS SHALL BE TO THE FACE OF CURB UNLESS OTHERWISE INDICATED. CURB ELEVATIONS SHALL BE TO THE TOP OF CURB (OR EXTENDED TOP OF CURB FOR DRIVEWAYS OR RAMPS) UNLESS OTHERWISE INDICATED.

POWER POLES AND OTHER OBSTRUCTIONS SHALL BE MOVED TO PROVIDE 2 FEET MINIMUM OF CLEAR DISTANCE FROM ANY FACE OF CURB OR EDGE OF SIDEWALK.

ANY INFORMATION SHOWN ON THIS PLAN, WHICH IS NOT PART OF THIS RIGHT-OF-WAY PROJECT, IS PRELIMINARY AND NOT FOR CONSTRUCTION.

THERE MAY BE EXISTING UTILITIES OR OTHER FEATURES WHICH ARE EITHER NOT SHOWN OR SHOWN INCORRECTLY ON THIS PLAN. IT IS THE RESPONSIBILITY OF THE DEVELOPER TO LOCATE AND IDENTIFY ALL UTILITIES AND TOPOGRAPHY WHICH MAY AFFECT THE CONSTRUCTION OF THESE IMPROVEMENTS.

ALL PERMANENT SIGNING AND POSTING WILL BE DETERMINED AND PROVIDED BY THE TRAFFIC ENGINEERING DIVISION, FOLLOWING CONSTRUCTION OF THESE IMPROVEMENTS.

THE DEVELOPER SHALL PROVIDE, INSTALL AND MAINTAIN ALL STREET END BARRICADES, SIGNING AND TRAFFIC CONTROL, AS REQUIRED BY THE CITY TRAFFIC ENGINEER.

PAVEMENT SAWCUTS AND FINAL PAVEMENT PATCHING LIMITS SHALL BE AS DIRECTED BY THE CITY CONSTRUCTION ENGINEER. SAWCUTS AND LIMITS SHOWN ON THE PLAN ARE BASED ON ANTICIPATED DISTURBANCE AND THE PATCHING CRITERIA BUT SHALL BE CONSIDERED APPROXIMATE. ALL PAVEMENT PATCHING SHALL BE PER THE CITY'S PATCHING CRITERIA.

THE LOCATION AND INFORMATION FOR PROPOSED NEW TREES, IN THE PUBLIC RIGHT OF WAY OR ON PUBLIC LANDS ARE APPROXIMATE AND ARE SHOWN FOR REFERENCE ONLY. THE LOCATIONS, SPECIFICATIONS AND PLANTING METHODS OF ALL PROPOSED NEW OR REPLACEMENT TREES IN THE PUBLIC RIGHT OF WAY OR ON PUBLIC LANDS SHALL BE APPROVED BY THE CITY FORESTER PRIOR TO INSTALLATION.

NO TREES IN THE RIGHT OF WAY OR ON PUBLIC LANDS SHALL BE TRIMMED, PRUNED, REMOVED OR ADVERSELY AFFECTED IN ANY WAY UNTIL THE DEVELOPER HAS RECEIVED WRITTEN PERMISSION FROM THE CITY ENGINEER OR CITY FORESTER. SAID WRITTEN PERMISSION SHALL INCLUDE LANGUAGE INDICATING THAT SECTION 10.101 OF THE MADISON GENERAL ORDINANCES AND ADMINISTRATIVE PROCEDURE MEMORANDUM NO. 6-2, REFERING TO NOTIFICATION OF PROPERTY OCCUPANTS AND/OR OWNERS, HAS BEEN COMPLIED WITH.

ALL TREES WITHIN THE RIGHT-OF-WAY THAT ARE TO REMAIN, SHALL BE PROTECTED THROUGHOUT CONSTRUCTION. MATERIALS SHALL NOT BE STORED AROUND THE TREES AND SOILS SHALL NOT BE COMPACTED FURTHER THAN THE CONDITION PRIOR TO CONSTRUCTION.

COORDINATE WITH CITY FORESTRY PRIOR TO INSTALLATION OF PROPOSED TREE GRATES. TREE GRATE INSTALLATION INCLUDES PRELIMINARY EXCAVATION OF PROPOSED SITES TO ENSURE THAT IT IS APPROPRIATE FOR A NEW TREE PLANTING.

THE CONTRACTOR SHALL SUBMIT A TRAFFIC CONTROL PLAN FOR REVIEW TO THE CITY TRAFFIC ENGINEERING DIVISION AT LEAST 10 WORKING DAYS PRIOR TO WORK BEGINNING WITHIN THE UNIVERSITY AVE OR GRAND AVE RIGHT OF WAY. THE TRAFFIC CONTROL PLAN SHALL COMPLY WITH ALL MUTCD REQUIREMENTS. WORK SHALL NOT PROCEED ON UNIVERSITY AVE OR GRAND AVE UNTIL THE TRAFFIC CONTROL PLAN HAS BEEN APPROVED. THE TRAFFIC CONTROL PLAN MAY INCLUDE BUT IS NOT LIMITED TO: LANE CLOSURE RESTRICTIONS, PEAK HOUR WORKING RESTRICTIONS, ACCESS REQUIREMENTS, ETC. THE CONTRACTOR SHALL BE RESPONSIBLE FOR PHASING WORK AS NECESSARY TO MEET THE REQUIREMENTS OF THE APPROVED TRAFFIC CONTROL PLAN.

Pavement Patching Criteria

Criteria use on:

Streets with pavement rating > 6
Arterial Streets

1. Length of Patch

- a. Minimum 50 feet long
- b. Minimum of 15 feet beyond the excavation
- c. Where multiple patches are created and the separation between them is less than 100 feet, the patches shall be combined into a single patch.
- d. The patches shall be adjusted in the field to meet special conditions such as previous paving or patching limits.

2. Width of Patch (all dimensions are curb face to curb face)

- a. All Streets Except Divided or one way roadways
 - i. Street Width 0 to 24 feet wide - Patch entire street width
 - ii. Street Width 25 to 37 feet wide - Patch one half the street width (curb to centerline of roadway). Note - Utility Engineer may adjust paving limit to correspond with a painted centerline in situations where the painted centerline is not in the center of the street.
 - iii. Street Width 38 feet and up - Patch width of entire lane for each lane which was disturbed by the excavation.
 - 1. If the lane is adjacent to a bike lane, include the bike lane. (except when there is a parking lane between the bike lane and the curb)
 - 2. If the lane is a bike lane and adjacent to a parking lane, include the parking lane.
 - 3. If the lane is a bike lane and not adjacent to a parking lane, include the adjacent travel lane.
- b. Divided Roadways and One Way Streets
 - i. Street 0 to 19 feet wide - Patch entire street width
 - ii. Street Width 20 feet and up - Patch width of entire lane for each lane which was disturbed by the excavation.
 - 1. If the lane is adjacent to a bike lane, include the bike lane. (except when there is a parking lane between the bike lane and the curb)
 - 2. If the lane is a bike lane and adjacent to a parking lane, include the parking lane.
 - 3. If the lane is a bike lane and not adjacent to a parking lane, include the adjacent travel lane.

STREET RATINGS

STREET NAME	CLASSIFICATION	PAVEMENT RATING
W. JOHNSON ST.	ARTERIAL	6
W. DAYTON ST.	ARTERIAL	8
WISCONSIN AVE.	COLLECTOR	6

PLOT SCALE:

PLOT NAME:

REV. DATE:

ORIGINATOR: CITY OF MADISON, STREETS DIVISION

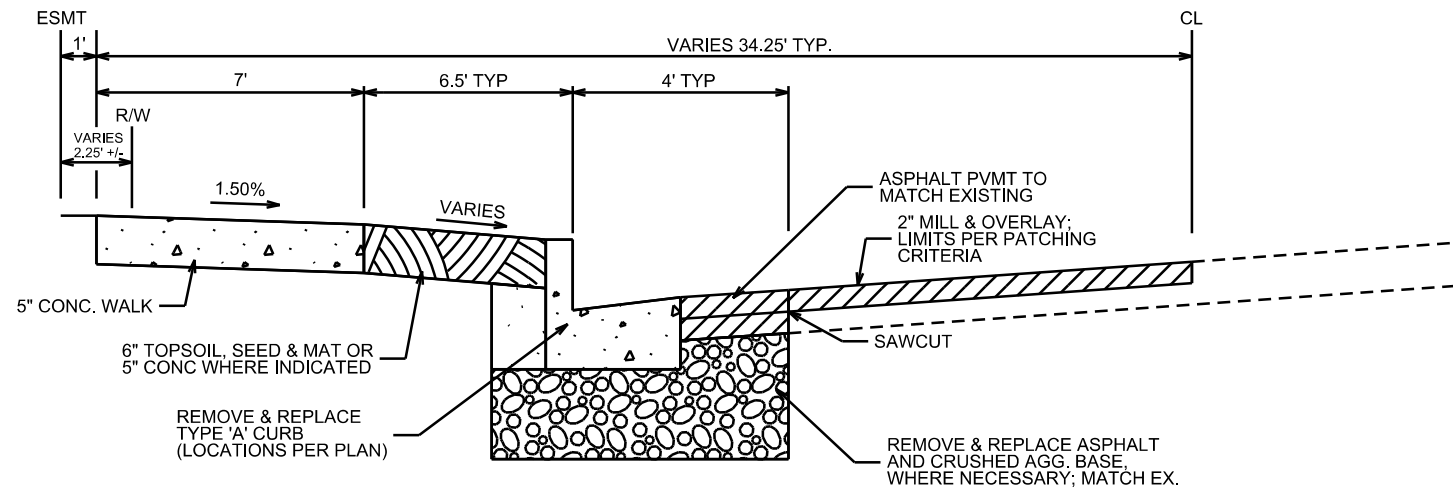

TYPICAL SECTION - W. JOHNSON ST.
NOT TO SCALE

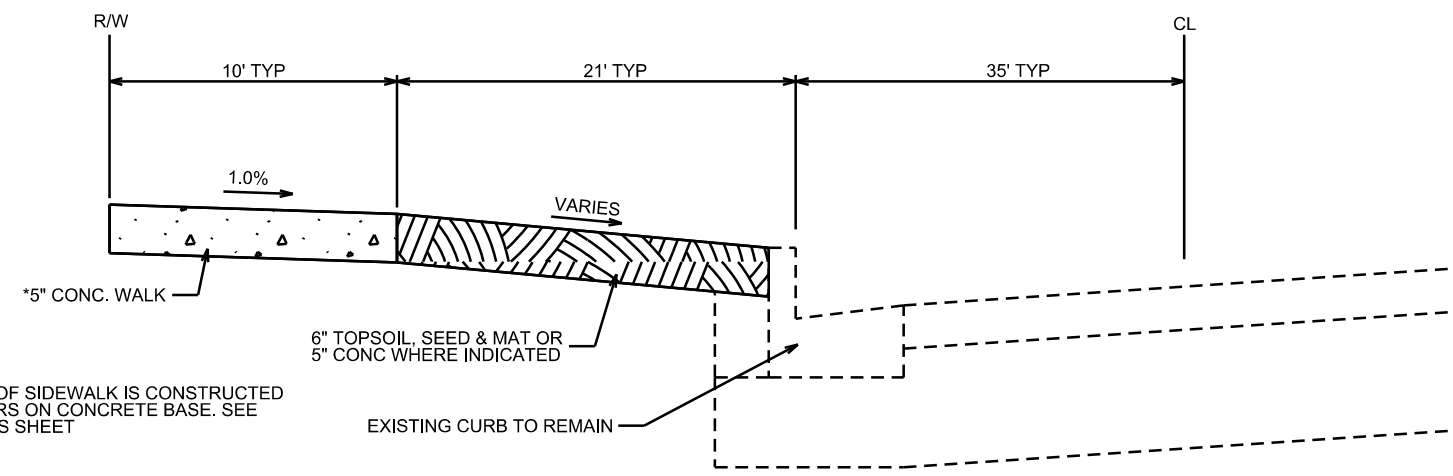

* PORTION OF SIDEWALK IS CONSTRUCTED WITH PAVERS ON CONCRETE BASE. SEE DETAIL, THIS SHEET

TYPICAL SECTION - WISCONSIN AVE.
NOT TO SCALE

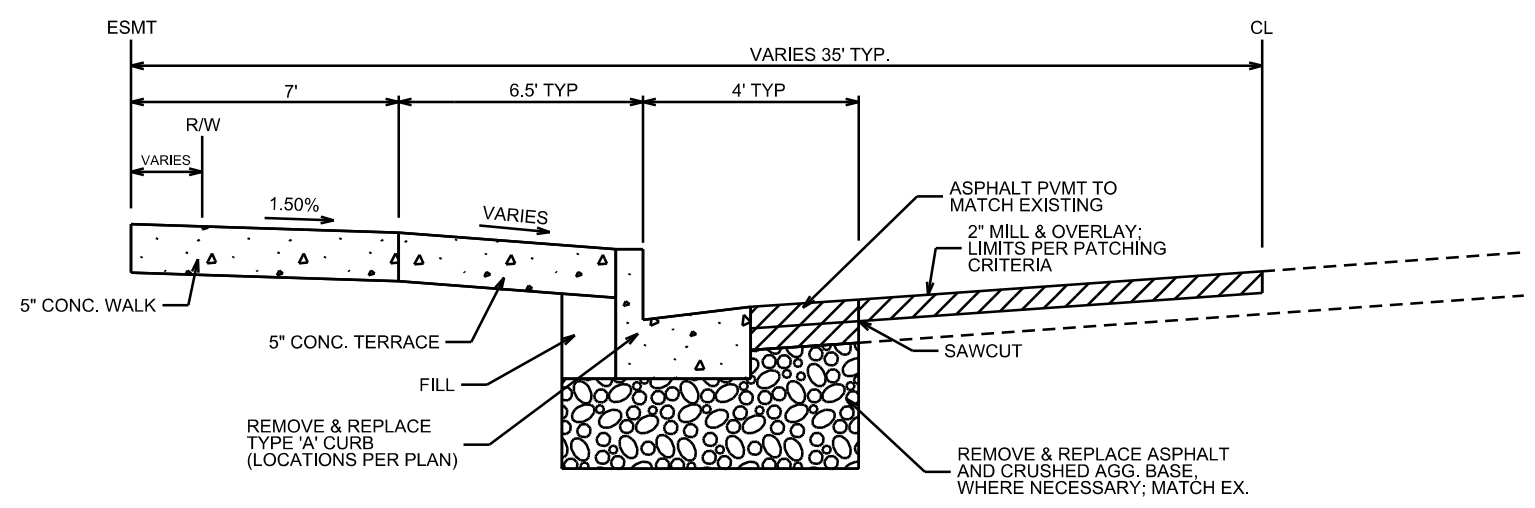

TYPICAL SECTION - W. DAYTON ST.
NOT TO SCALE

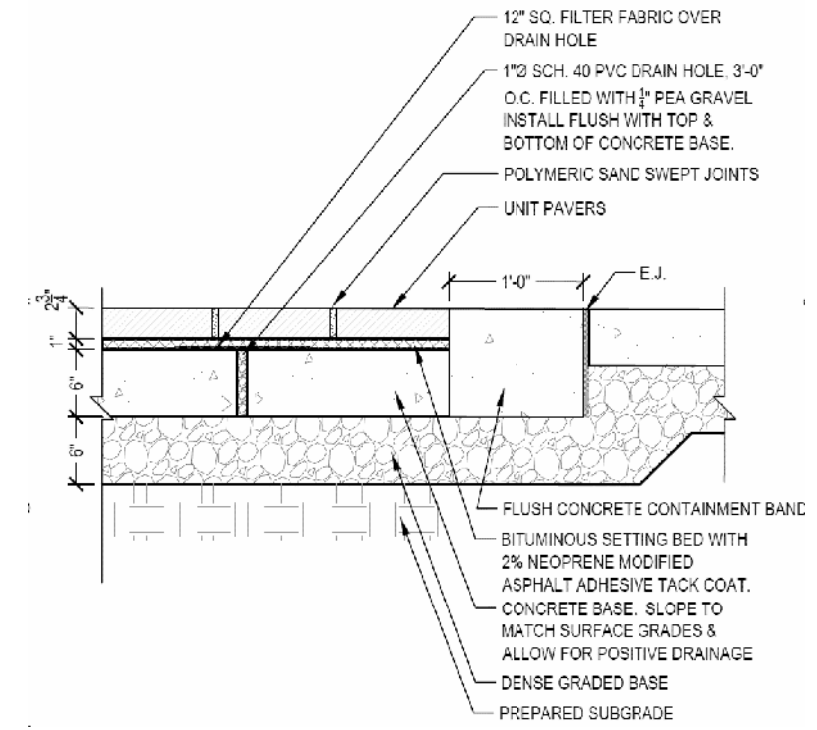

PAVERS ON CONCRETE BASE DETAIL
NOT TO SCALE

PLOT SCALE:

PLOT NAME:

REV. DATE:

ORIGINATOR: CITY OF MADISON, STREETS DIVISION

ELECTRICAL PLAN

W JOHNSON ST. CITY OF MADISON

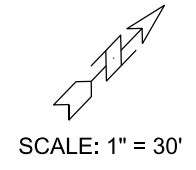

GENERAL ELECTRICAL NOTES:

1. ALL LOCATIONS ARE APPROXIMATE. THE TRAFFIC ENGINEER SHALL APPROVE FINAL LOCATIONS INCLUDING SETBACK IN THE FIELD. AFTER CONTRACTOR SURVEYS STAKING, THE CONTRACTOR SHALL NOTIFY GRETCHEN AVILES PINEIRO (266-4899) CITY TRAFFIC ENGINEERING, AT LEAST 24-HOURS IN ADVANCE OF NEEDING BASE LOCATIONS MARKED.
2. THE CONTRACTOR SHALL DO ALL WORK IN ACCORDANCE WITH CITY OF MADISON STANDARD SPECIFICATIONS FOR PUBLIC WORKS CONSTRUCTION 2019 EDITION AND ALL ADDENDUMS THERETO. ALL CONDUIT SHALL BE PVC SCHEDULE 80 UNDER PAVEMENT OR SCHEDULE 40 OTHERWISE. PULL WIRE REQUIRED AS PER STANDARD SPECIFICATIONS.
3. THE CONTRACTOR SHALL CALL TROY VANT (266-4767) AT THE TRAFFIC ENGINEERING SHOP AT LEAST 24-HOURS IN ADVANCE OF POURING BASES, BURYING CONDUIT AND CONSTRUCTING ELECTRICAL HANDHOLES TO ARRANGE FOR INSPECTION.
4. ALL EXISTING CONDUITS AND STREET LIGHTS ARE TO REMAIN UNLESS AND UNTIL AUTHORIZED TO REMOVE BY TRAFFIC ENGINEERING. EXISTING CONDUITS CROSSING ENDEAVOR LN.
5. THE FOLLOWING CITY FURNISHED MATERIALS ARE TO BE PICKED UP AT THE TRAFFIC TRAFFIC OPERTION SHOP, 1120 SAYLE STREET. NOTIFY ED SMITH AT 266-9034 TWENTY FOUR (24) HOURS PRIOR TO PICKING UP THE MATERIAL:

3/4"X24" ANCHOR BOLTS: 6 SETS OF 4 FOR LB-1 BASES
1-1/4"X48" ANCHOR BOLTS: 1 SETS OF 4 FOR LB-8 BASES

LEGEND

- PLACE STREET LIGHTING (1) -2" PVC CONDUIT, UNLESS NOTED AS OTHER
- PLACE SIGNAL/COMMUNICATION (2) -3" PVC COUNDITS, UNLESS NOTED AS OTHER
- ☐ CONSTRUCT TYPE-1 ELECTRICAL HANDHOLE
- ☑ CONSTRUCT TYPE 5 ELECTRICAL HANDHOLE
- ☼ CONSTRUCT LB-1 CONCRETE BASE
- ⊙ CONSTRUCT LB-8 CONCRETE BASE
- ⊕ EXISTING BASE TO BE MAINTAINED

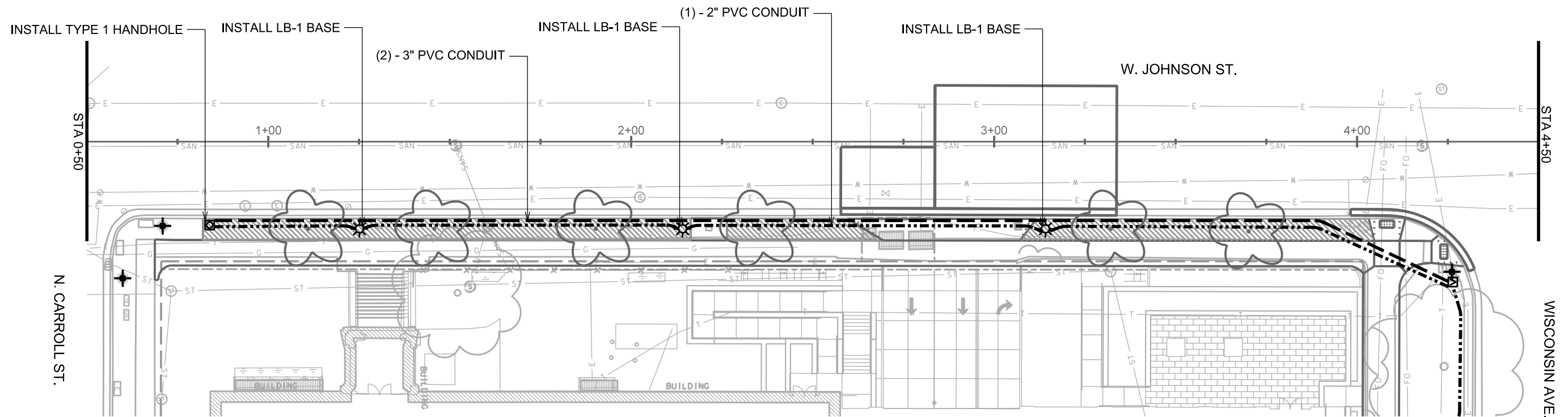

PLOT SCALE:

PLOT NAME:

REV. DATE:

ORIGINATOR: CITY OF MADISON, TRAFFIC ENG. DIV.

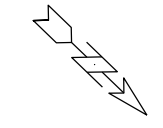

SCALE: 1" = 30'

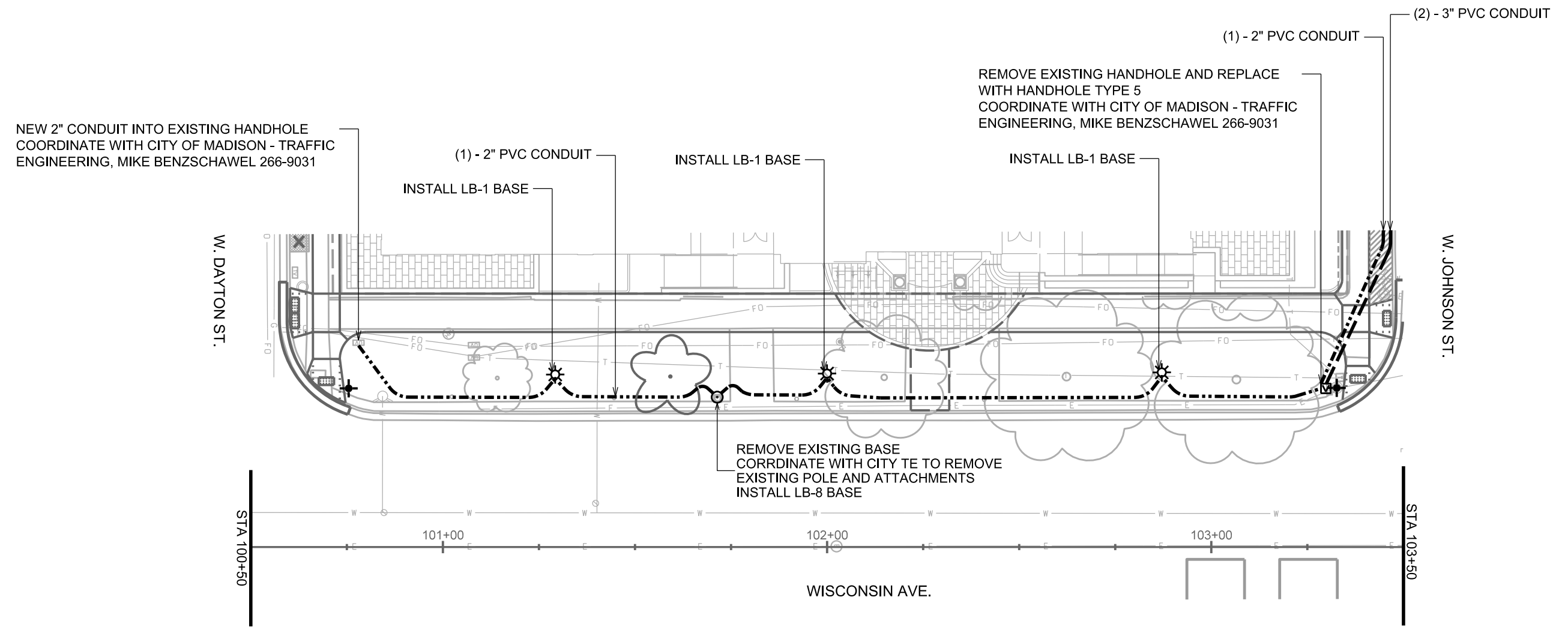



LEGEND

- PLACE STREET LIGHTING (1) -2" PVC CONDUIT, UNLESS NOTED AS OTHER
- PLACE SIGNAL/COMMUNICATION (2) -3" PVC CONDUITS, UNLESS NOTED AS OTHER
- ☐ CONSTRUCT TYPE-1 ELECTRICAL HANDHOLE
- ☑ CONSTRUCT TYPE 5 ELECTRICAL HANDHOLE
- ☼ CONSTRUCT LB-1 CONCRETE BASE
- ⊙ CONSTRUCT LB-8 CONCRETE BASE
- ✦ EXISTING BASE TO BE MAINTAINED

PLOT SCALE:
PLOT NAME:
REV. DATE:
ORIGINATOR: CITY OF MADISON, TRAFFIC ENG. DIV.

PLAN AND PROFILE

W. JOHNSON STREET CITY OF MADISON

-  REMOVE EX CONCRETE TERRACE.
REPLACE CONCRETE TERRACE
WITH 6" TOPSOIL, SEED & MAT.
-  APPROXIMATE LIMITS OF 2" MILL &
OVERLAY (TO CENTERLINE),
ASSUMING DISTURBANCE OF
PAVEMENT FOR CURB WORK
-  2" MILL & OVERLAY, FULL WIDTH
FOR PROPOSED UTILITY WORK.

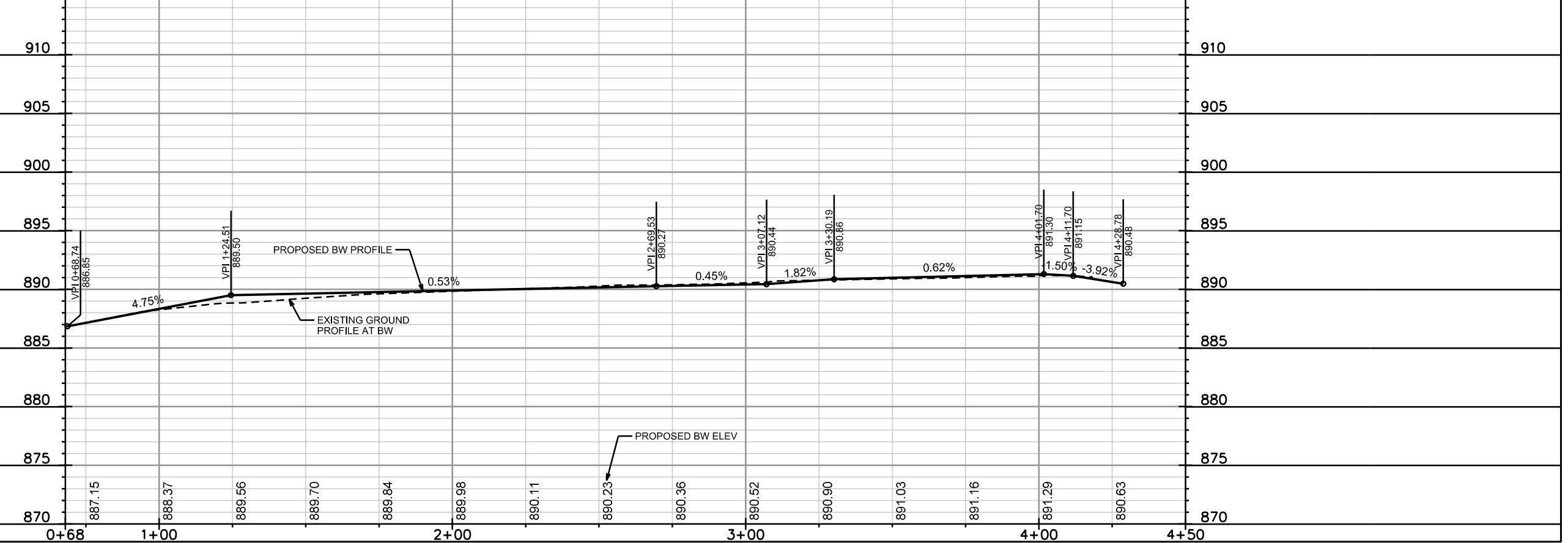
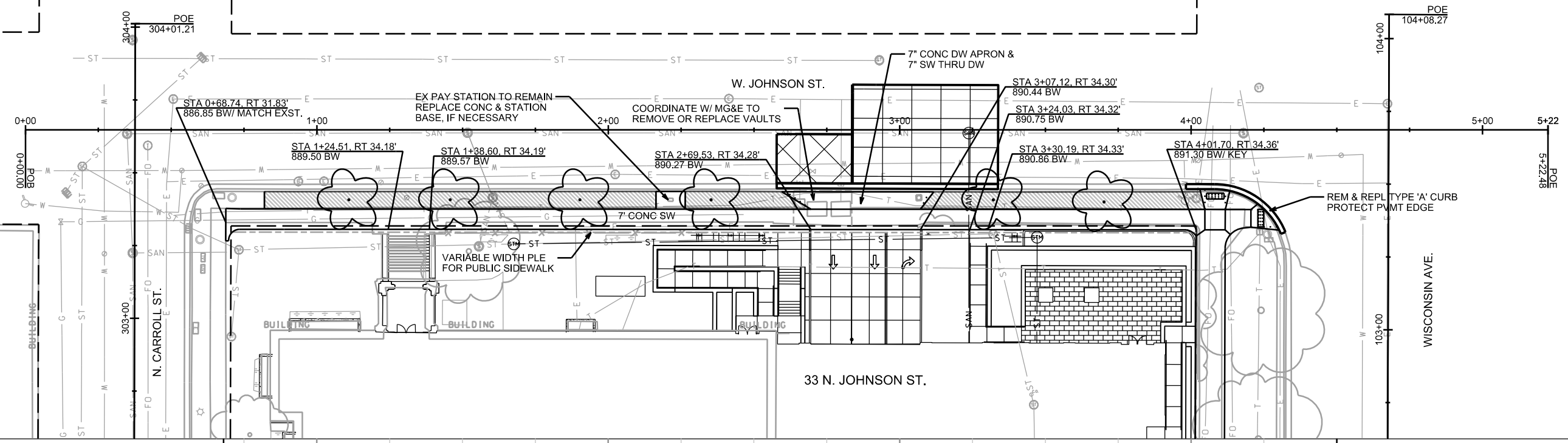
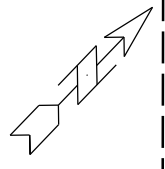

PLOT SCALE: _____

PLOT NAME: _____

REV. DATE: _____

ORIGINATOR: CITY OF MADISON, STREETS DIVISION

PLAN AND PROFILE
WISCONSIN AVENUE CITY OF MADISON

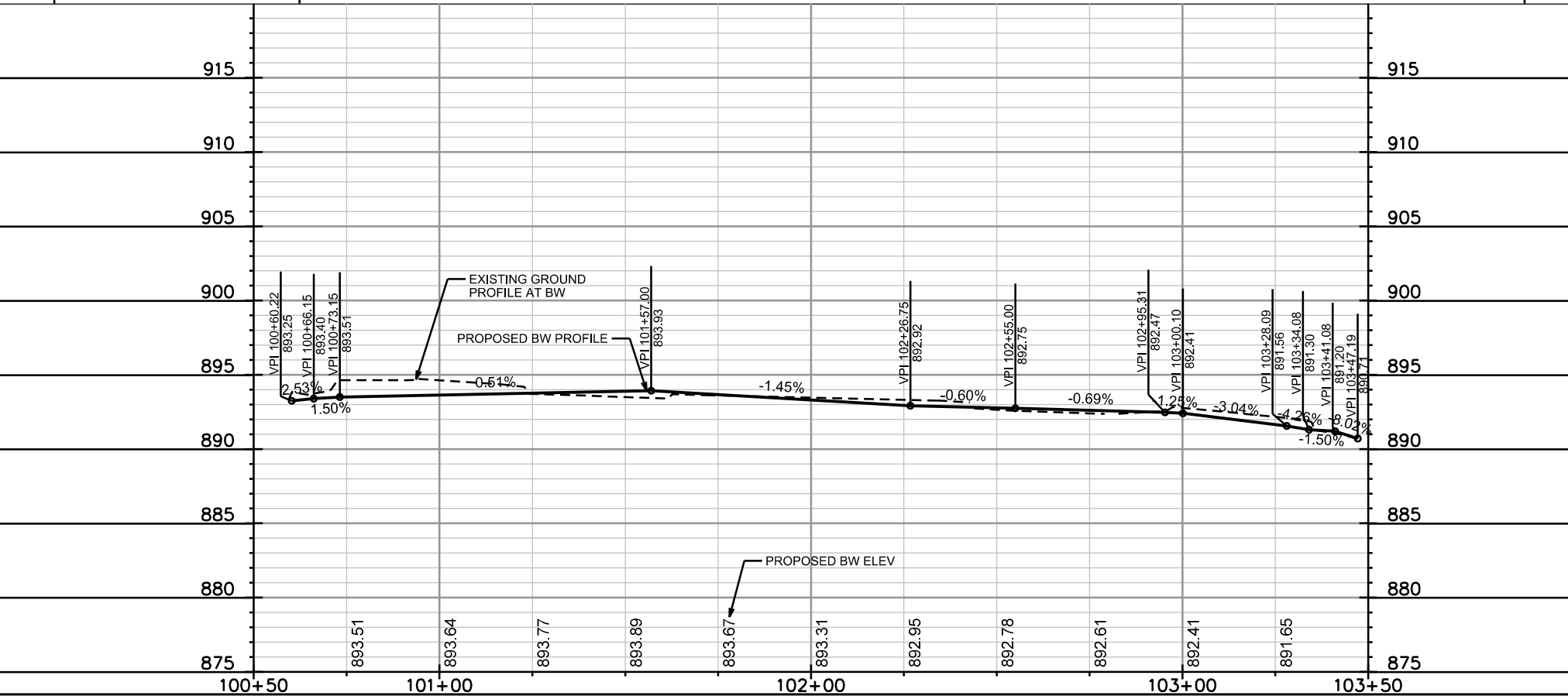
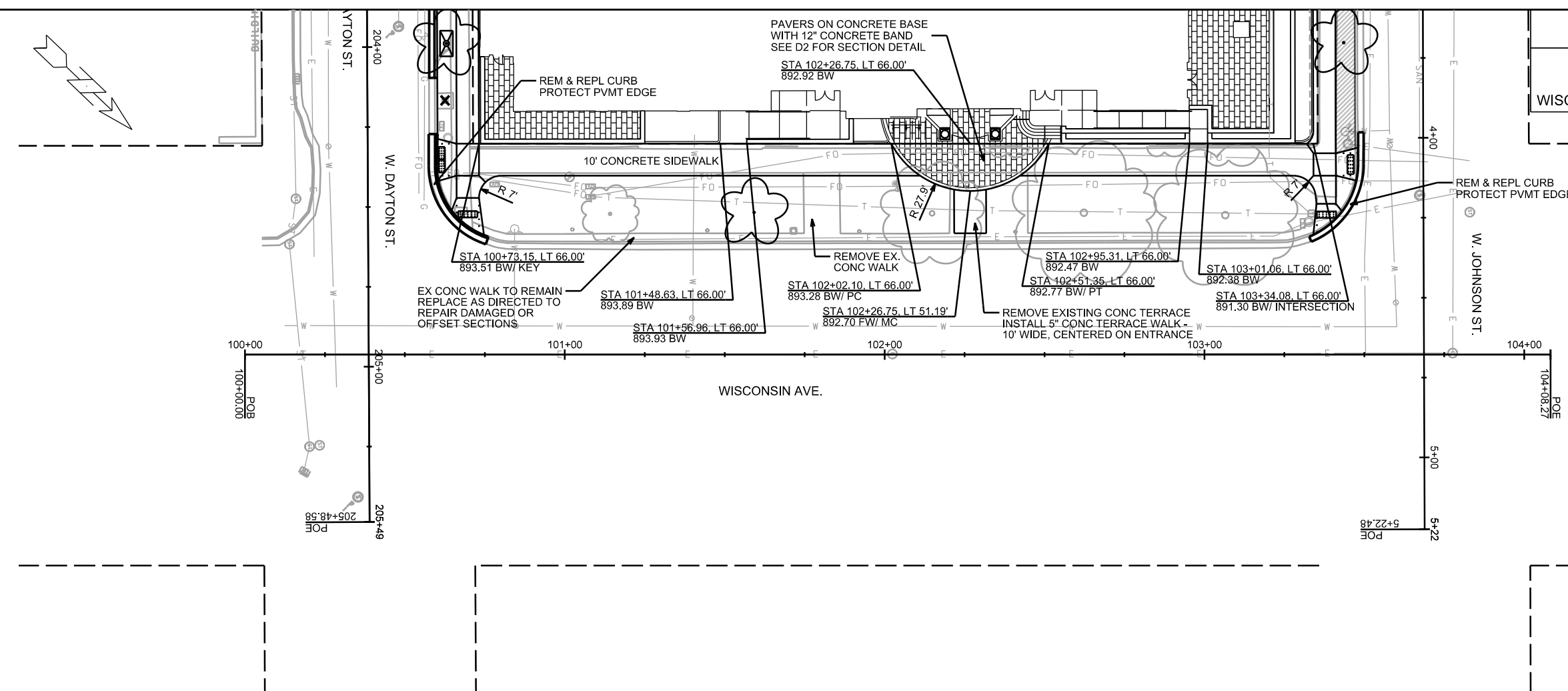

PLOT SCALE: _____

PLOT NAME: _____



REV. DATE: _____

ORIGINATOR: CITY OF MADISON, STREETS DIVISION

PLAN AND PROFILE

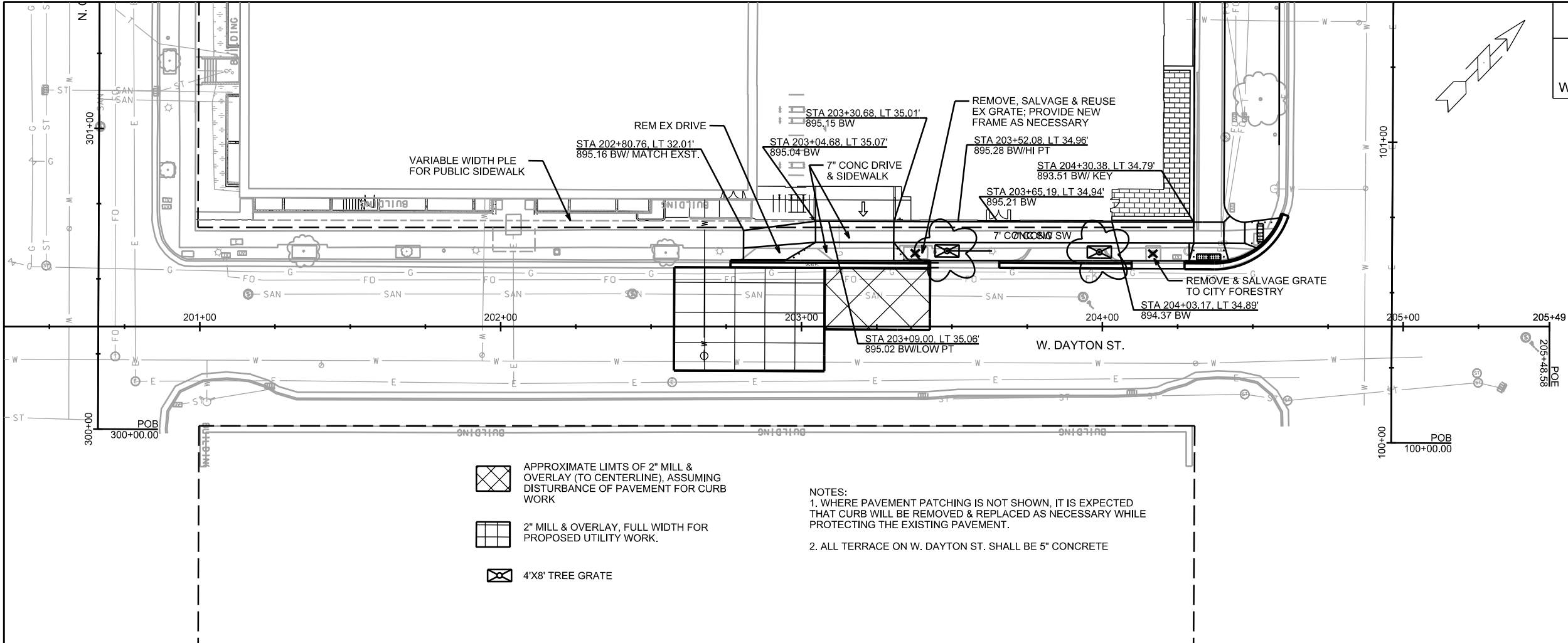
W. DAYTON STREET CITY OF MADISON



-  APPROXIMATE LIMITS OF 2" MILL & OVERLAY (TO CENTERLINE), ASSUMING DISTURBANCE OF PAVEMENT FOR CURB WORK
-  2" MILL & OVERLAY, FULL WIDTH FOR PROPOSED UTILITY WORK.
-  4'X8' TREE GRATE

NOTES:
1. WHERE PAVEMENT PATCHING IS NOT SHOWN, IT IS EXPECTED THAT CURB WILL BE REMOVED & REPLACED AS NECESSARY WHILE PROTECTING THE EXISTING PAVEMENT.
2. ALL TERRACE ON W. DAYTON ST. SHALL BE 5" CONCRETE

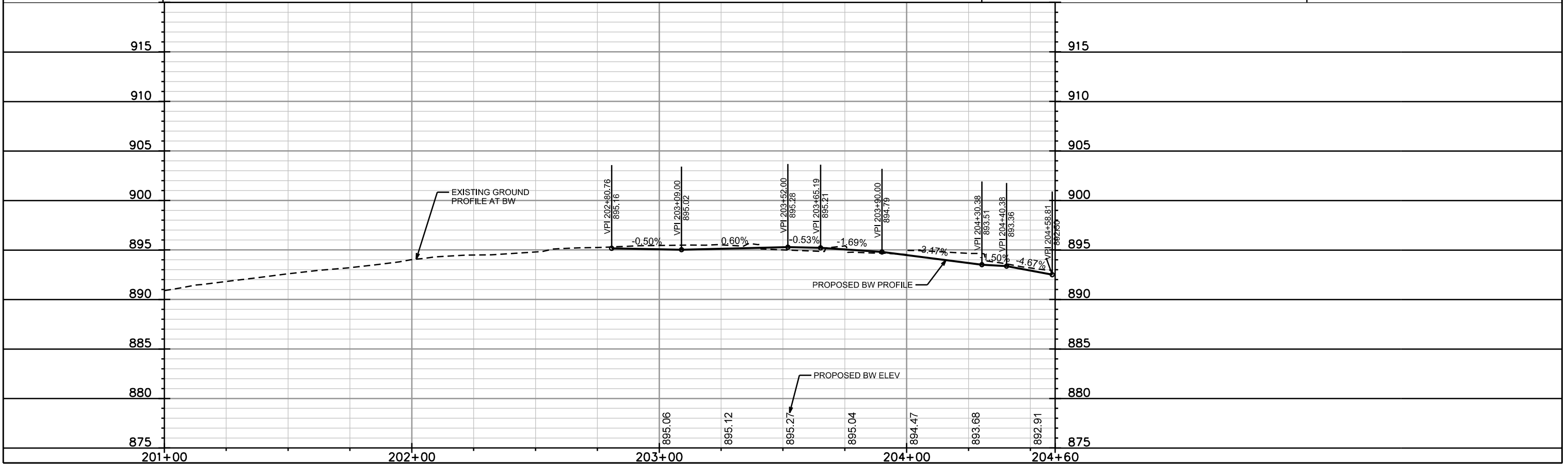

PLOT SCALE: _____

PLOT NAME: _____

REV. DATE: _____

ORIGINATOR: CITY OF MADISON, STREETS DIVISION

LANDSCAPING PLAN
W. JOHNSON ST, WISCONSIN AVE
& W. DAYTON ST.
CITY OF MADISON

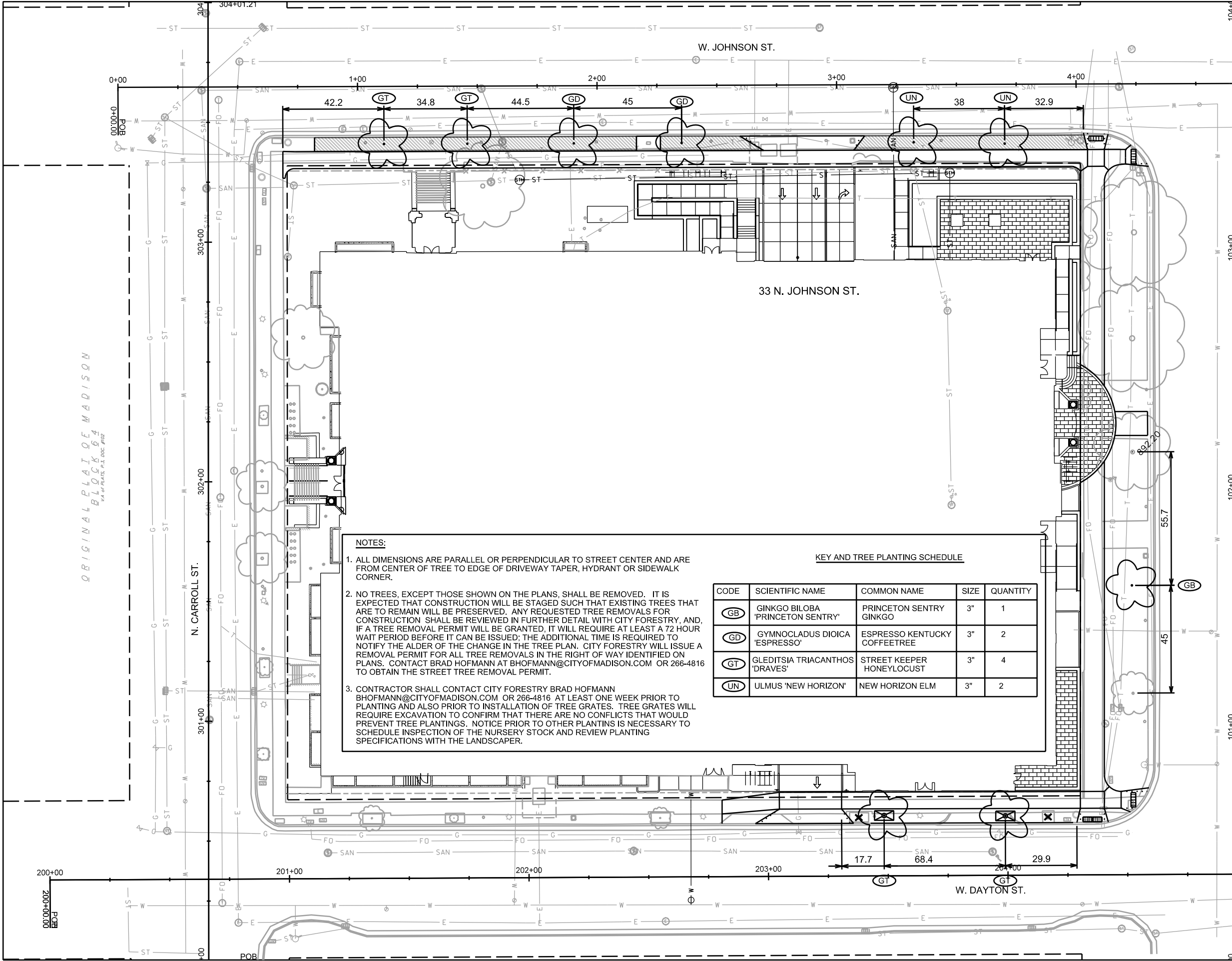

NOTES:

1. ALL DIMENSIONS ARE PARALLEL OR PERPENDICULAR TO STREET CENTER AND ARE FROM CENTER OF TREE TO EDGE OF DRIVEWAY TAPER, HYDRANT OR SIDEWALK CORNER.
2. NO TREES, EXCEPT THOSE SHOWN ON THE PLANS, SHALL BE REMOVED. IT IS EXPECTED THAT CONSTRUCTION WILL BE STAGED SUCH THAT EXISTING TREES THAT ARE TO REMAIN WILL BE PRESERVED. ANY REQUESTED TREE REMOVALS FOR CONSTRUCTION SHALL BE REVIEWED IN FURTHER DETAIL WITH CITY FORESTRY, AND, IF A TREE REMOVAL PERMIT WILL BE GRANTED, IT WILL REQUIRE AT LEAST A 72 HOUR WAIT PERIOD BEFORE IT CAN BE ISSUED; THE ADDITIONAL TIME IS REQUIRED TO NOTIFY THE ALDER OF THE CHANGE IN THE TREE PLAN. CITY FORESTRY WILL ISSUE A REMOVAL PERMIT FOR ALL TREE REMOVALS IN THE RIGHT OF WAY IDENTIFIED ON PLANS. CONTACT BRAD HOFMANN AT BHOFMANN@CITYOFMADISON.COM OR 266-4816 TO OBTAIN THE STREET TREE REMOVAL PERMIT.
3. CONTRACTOR SHALL CONTACT CITY FORESTRY BRAD HOFMANN BHOFMANN@CITYOFMADISON.COM OR 266-4816 AT LEAST ONE WEEK PRIOR TO PLANTING AND ALSO PRIOR TO INSTALLATION OF TREE GRATES. TREE GRATES WILL REQUIRE EXCAVATION TO CONFIRM THAT THERE ARE NO CONFLICTS THAT WOULD PREVENT TREE PLANTINGS. NOTICE PRIOR TO OTHER PLANTINGS IS NECESSARY TO SCHEDULE INSPECTION OF THE NURSERY STOCK AND REVIEW PLANTING SPECIFICATIONS WITH THE LANDSCAPER.

KEY AND TREE PLANTING SCHEDULE

CODE	SCIENTIFIC NAME	COMMON NAME	SIZE	QUANTITY
GB	GINKGO BILOBA 'PRINCETON SENTRY'	PRINCETON SENTRY GINKGO	3"	1
GD	GYMNOCLADUS DIOICA 'ESPRESSO'	ESPRESSO KENTUCKY COFFEETREE	3"	2
GT	GLEDITSIA TRIACANTHOS 'DRAVES'	STREET KEEPER HONEYLOCUST	3"	4
UN	ULMUS 'NEW HORIZON'	NEW HORIZON ELM	3"	2

ORIGINAL PLAN OF MADISON
BLOCK 64
MAP OF PLATS, P.L. DOC. #102

C.S.M. #11920
LOI 1
V.23 of CSM's, P.139-144, DOC. #4236480

ORIGINATOR: CITY OF MADISON, STREETS DIVISION
REV. DATE: _____
PLOT SCALE: _____

PLAN

W. JOHNSON ST. & W. DAYTON ST. CITY OF MADISON

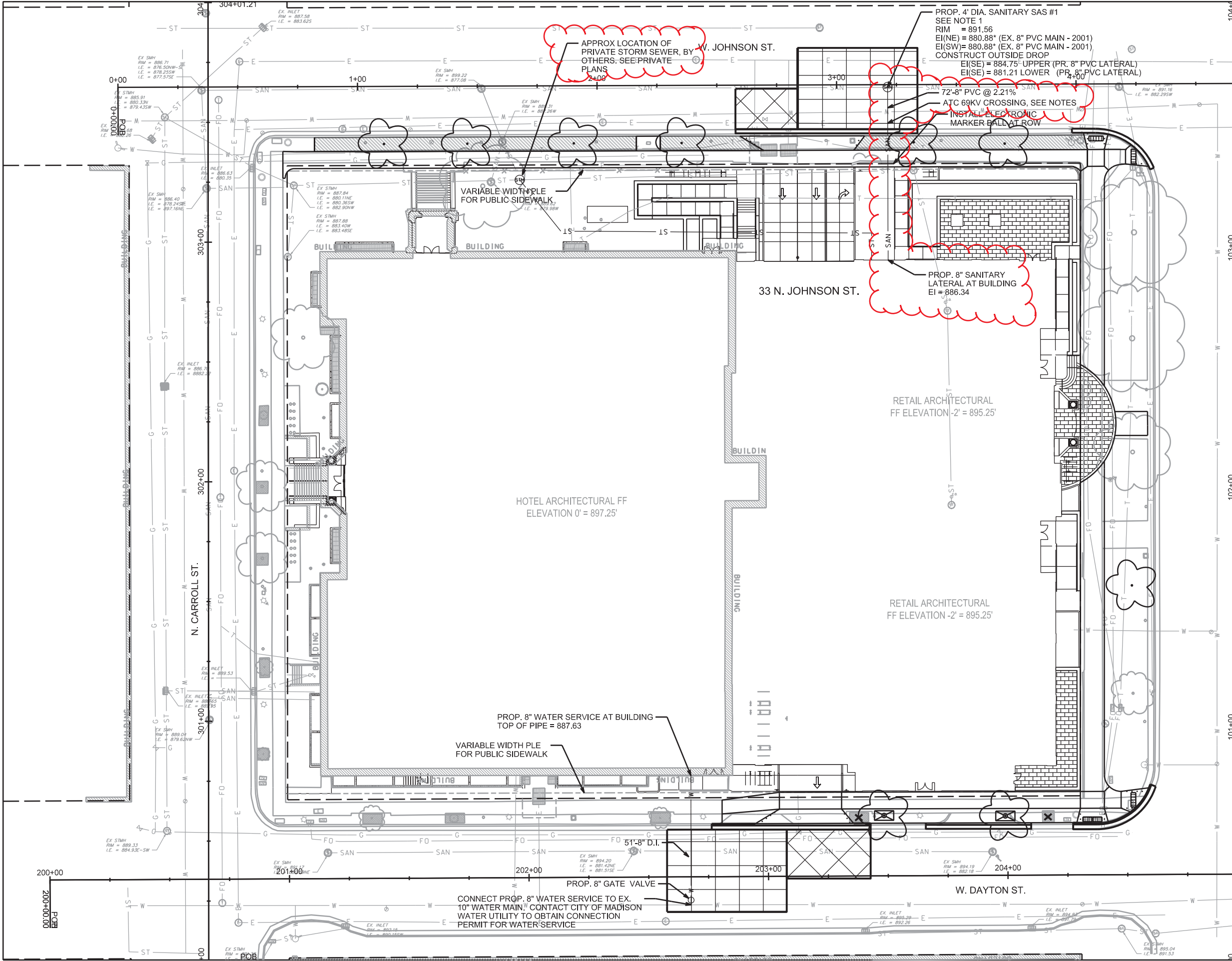

- NOTES:
- * = INVERT INTERPOLATED FROM UPSTREAM AND DOWNSTREAM INVERTS AT EXISTING STRUCTURES
 - PERFORM ULO AS NECESSARY. ANY EXPOSURE OF ATC PIPE SHALL BE VACUUM EXCAVATED OR HAND DUG. REPLACE THERMAL BACKFILL AS REQUIRED BY ATC SPECS. CONTACT RON LATUS (262-364-9048) AT LEAST 3 DAYS PRIOR TO WORK IN THIS AREA.
- ☒ = 2" MILL & OVERLAY FOR THE FULL WIDTH OF STREET IS NECESSARY FOR UTILITY WORK
- ☒ = POTENTIAL 2" MILL & OVERLAY TO CENTERLINE IF PAVEMENT EDGE IS DAMAGED DURING CURB REPLACEMENT. TAKE CARE TO NOT DAMAGE PAVEMENT EDGE. FINAL PAVING LIMITS BY CONSTRUCTION ENGINEER.

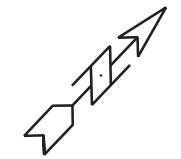

WISCONSIN AVE.

PLOT SCALE: _____

REV. DATE: _____

ORIGINATOR: CITY OF MADISON, STREETS DIVISION