



Madison, Wisconsin

CITY OF MADISON

CITY ENGINEERING DIVISION

DEPARTMENT OF PUBLIC WORKS

PLAN OF PROPOSED IMPROVEMENT

908 E MAIN STREET

CITY PROJECT NO. 13246
CONTRACT NO. 8954

INDEX OF SHEETS

SHEET NO. 2	NOTES & LEGEND
SHEET NO. 3-4	SIDEWALK PLAN & PROFILE
SHEET NO. U1-U2	UTILITY CONNECTIONS
NO MAINTENANCE PLAN	

PUBLIC IMPROVEMENT PROJECT
APPROVED

SEPTEMBER 15, 2020

BY THE COMMON COUNCIL
OF MADISON, WISCONSIN

PUBLIC IMPROVEMENT DESIGN
APPROVED BY:

CN- Greg Fries Oct 19, 2021

City Engineer Date

STREET GRADES
DESIGNED BY:

SEE INDIVIDUAL SHEET

WATER
DESIGNED BY:

LATERALS ONLY

STORM & SANITARY SEWER
DESIGNED BY:

LATERALS ONLY

PROJECT LOCATION

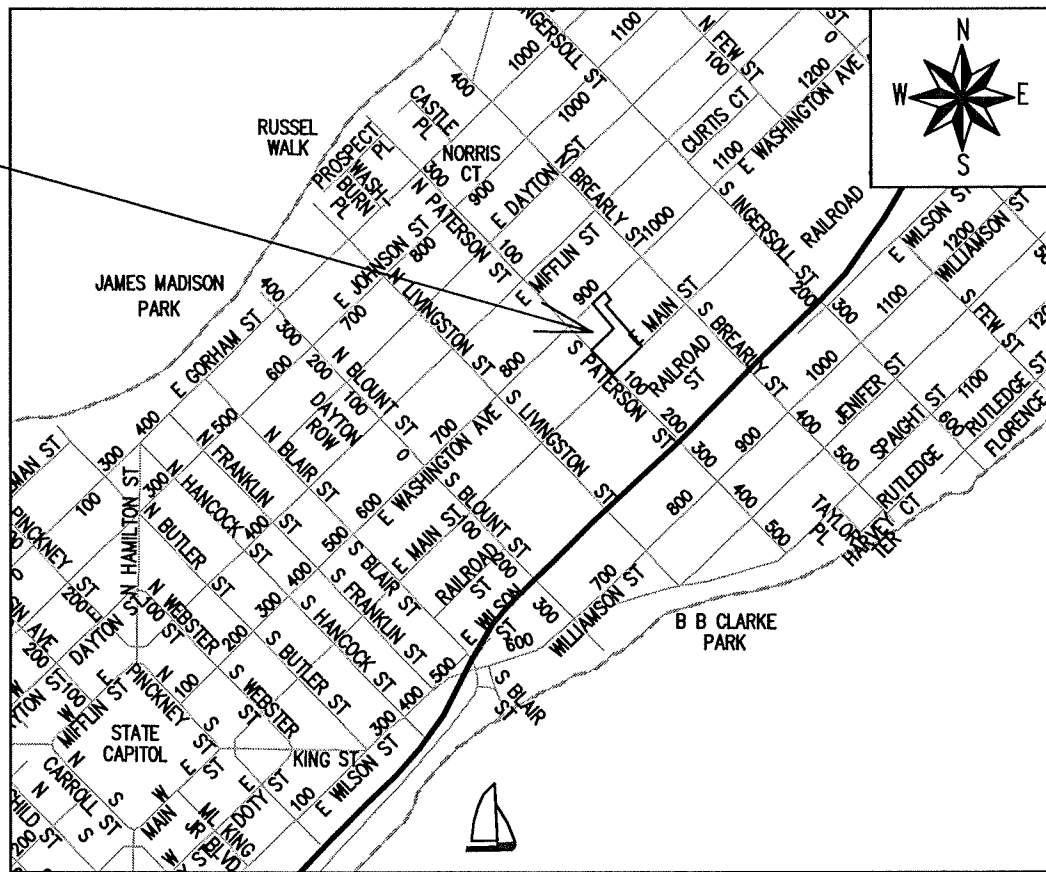

PLOT SCALE: 1 IN. = 1 FT. XREF

PLOT NAME: ---

REV. DATE: 10/15/2021 8:07 AM

ORIGINATOR: CITY OF MADISON

NOTES

1. THE DEVELOPER SHALL REPLACE ALL CURB & GUTTER AND SIDEWALK THAT IS DAMAGED OR DETERMINED TO BE IN UNSATISFACTORY CONDITION.
2. ALL GUTTERS SHALL DRAIN WITH A MINIMUM GRADES OF 0.5% TOWARD STORM SEWER INLETS.
3. ALL DISTURBED TERRACE AREAS SHALL BE RESTORED WITH 6-INCHES OF TOP SOIL AND SEED UNLESS DIRECTED OTHERWISE ON THE PLAN OR BY THE CITY CONSTRUCTION ENGINEER.
4. TYPICAL PAVEMENT CROSS SLOPES SHALL BE 1.5% AND TERRACES SHALL SLOPE AT A 4% GRADE TOWARD THE GUTTER.
5. THE CROSS SLOPE OF SIDEWALKS AND BARRIER FREE SIDEWALK CURB RAMPS SHALL BE 1.5%. THE LONGITUDINAL GRADE OF BARRIER FREE SIDEWALK CURB RAMPS SHALL NOT EXCEED 8.33%. ALL SIDEWALK RAMPS SHALL BE CONSTRUCTED ACCORDING TO S.D.D. 3.03. AT ALL OTHER LOCATIONS THE LONGITUDINAL GRADE OF SIDEWALKS SHALL NOT EXCEED 5.0 % OR THE ADJACENT STREET GRADE WHICHEVER IS GREATER NOR BE LESS THAN 0.5% AND SHALL DRAIN TOWARD STORM SEWER INLETS. CONCRETE TERRACE SHALL BE INSTALLED BETWEEN THE SIDEWALK AND THE BACK OF CURB AT SIDEWALK LOW POINTS WHICH CANNOT OTHERWISE BE DRAINED DIRECTLY TO THE GUTTER. SIDE SLOPES WITHIN TEN FEET OF A PUBLIC SIDEWALK SHALL NOT EXCEED 4.00:1. ALL SIDEWALK AND SIDEWALK RAMP ELEVATIONS AND GRADES SHALL BE FIELD VERIFIED AND SET TO COMPLY WITH THE CITY OF MADISON STANDARD SPECIFICATIONS AND THE A.D.A. GUIDELINES.
6. CURB STATION AND OFFSETS SHALL BE TO THE EDGE OF PAVEMENT UNLESS OTHERWISE INDICATED. CURB ELEVATIONS SHALL BE TO THE EDGE OF PAVEMENT UNLESS OTHERWISE INDICATED.
7. ANY INFORMATION SHOWN ON THIS PLAN, WHICH IS NOT PART OF THIS RIGHT-OF-WAY PROJECT, IS PRELIMINARY AND NOT FOR CONSTRUCTION.
8. THERE MAY BE EXISTING UTILITIES OR OTHER FEATURES WHICH ARE EITHER NOT SHOWN OR SHOWN INCORRECTLY ON THIS PLAN. IT IS THE RESPONSIBILITY OF THE DEVELOPER TO LOCATE AND IDENTIFY ALL UTILITIES AND TOPOGRAPHY WHICH MAY AFFECT THE CONSTRUCTION OF THESE IMPROVEMENTS.
9. ALL PERMANENT SIGNING AND POSTING WILL BE DETERMINED AND PROVIDED BY THE TRAFFIC ENGINEERING DIVISION, FOLLOWING CONSTRUCTION OF THESE IMPROVEMENTS.
10. THE CONTRACTOR SHALL SUBMIT A TRAFFIC CONTROL PLAN FOR REVIEW TO THE CITY TRAFFIC ENGINEERING DIVISION AT LEAST 10 WORKING DAYS PRIOR TO WORK BEGINNING. THE TRAFFIC CONTROL PLAN SHALL COMPLY WITH ALL MUTCD REQUIREMENTS. WORK SHALL NOT PROCEED UNTIL THE TRAFFIC CONTROL PLAN HAS BEEN APPROVED. THE TRAFFIC CONTROL PLAN MAY INCLUDE BUT IS NOT LIMITED TO: LANE CLOSURE RESTRICTIONS, PEAK HOUR WORKING RESTRICTIONS, ACCESS REQUIREMENTS, ETC. THE CONTRACTOR SHALL BE RESPONSIBLE FOR PHASING WORK AS NECESSARY TO MEET THE REQUIREMENTS OF THE APPROVED TRAFFIC CONTROL PLAN.

11. PAVEMENT SAWCUTS AND FINAL PAVEMENT PATCHING LIMITS SHALL BE AS DIRECTED BY THE CITY CONSTRUCTION ENGINEER. SAWCUTS AND LIMITS SHOWN ON THE PLAN ARE BASD ON ANTICIPATED DISTURBANCE AND THE PATCHING CRIETERIA BUT SHALL BE CONSIDERED APPROXIMATE. ALL PAVEMENT PATCHING SHALL BE PER THE CITY'S PATCHING CRITERIA.
12. NO TREES, EXCEPT THOSE SHOWN ON THE PLANS, SHALL BE REMOVED. IT IS EXPECTED THAT CONSTRUCTION WILL BE STAGED SUCH THAT EXISTING TREES THAT ARE TO REMAIN WILL BE PRESERVED. ANY REQUESTED TREE REMOVALS FOR CONSTRUCTION SHALL BE REVIEWED IN FURTHER DETAIL WITH CITY FORESTRY, AND, IF A TREE REMOVAL PERMIT WILL BE GRANTED, IT WILL REQUIRE AT LEAST A 72 HOUR WAIT PERIOD BEFORE IT CAN BE ISSUED; THE ADDITIONAL TIME IS REQUIRED TO NOTIFY THE ALDER OF THE CHANGE IN THE TREE PLAN. CITY FORESTRY WILL ISSUE A REMOVAL PERMIT FOR ALL TREE REMOVALS IN THE RIGHT OF WAY IDENTIFIED ON CONTACT CITY FORESTRY AT 266-4816 TO OBTAIN THE STREET TREE REMOVAL PERMIT.
13. CONTRACTOR SHALL CONTACT CITY FORESTRY AT 266-4816 AT LEAST ONE WEEK PRIOR TO PLANTING AND ALSO PRIOR TO INSTALLATION OF TREE GRATES. TREE GRATES WILL REQUIRE EXCAVATION TO CONFIRM THAT THERE ARE NO CONFLICTS THAT WOULD PREVENT TREE PLANTINGS. NOTICE PRIOR TO OTHER PLANTINGS IS NECESSARY TO SCHEDULE INSPECTION OF THE NURSERY STOCK AND REVIEW PLANTING SPECIFICATIONS WITH THE LANDSCAPER.

LEGEND

	SANITARY MANHOLE		CATCH CURB
	YARD CLEANOUT		REJECT CURB
	STORM MANHOLE		BURIED WATER MAIN
	STORM INLET		SANITARY SEWER
	STORM CATCH BASIN		STORM SEWER
	APRON ENDWALL		SILT FENCE
	WATER MANHOLE		ROOF DRAIN
	HYDRANT		OVERHEAD WIRES
	WATER VALVE		BURIED CABLE TV LINES
	GAS METER		BURIED ELECTRIC
	GAS VALVE		BURIED TELEPHONE
	LIGHT POLE		FIBER OPTIC
	TRAFFIC SIGNAL		BURIED GAS MAIN
	MONITORING WELL		CAUTION
	ELECTRICAL OUTLET		PROPERTY LINE
	UTILITY POLE		UTILITY EASEMENT
	GUY WIRE / DEAD MAN		SETBACK LINE
	ELECTRIC PEDESTAL		SPOT ELEVATION
	ELECTRIC MANHOLE		SPOT ELEVATION, TOP WALL
	CABLE PEDESTAL		SPOT ELEVATION, BOTTOM WALL
	BOLLARD		SPOT ELEVATION, TOP CURB
	SIGN		BUILDING
	HANDICAP RAMP		ADA TRUNCATED DOMES
	HANDICAP STALL		AREA NOT INCLUDED IN THE WHEDA DEVELOPMENT
	STONE WALL		



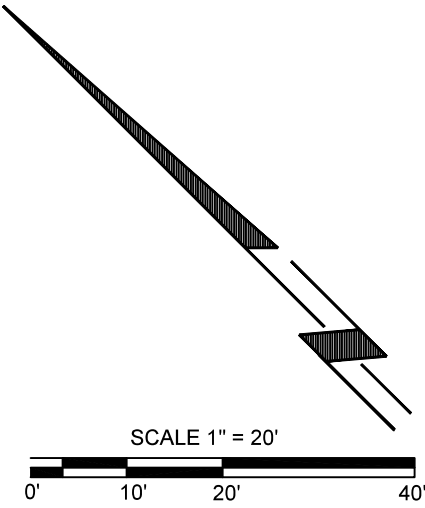
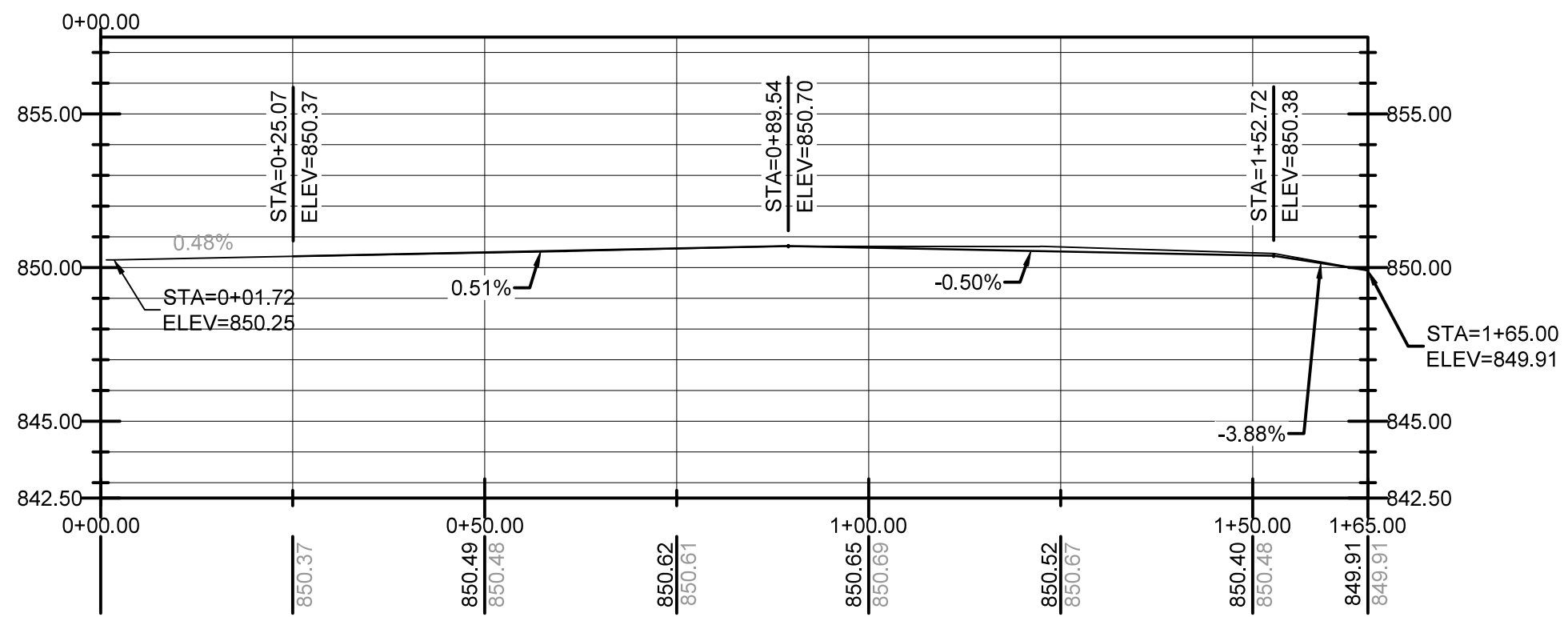
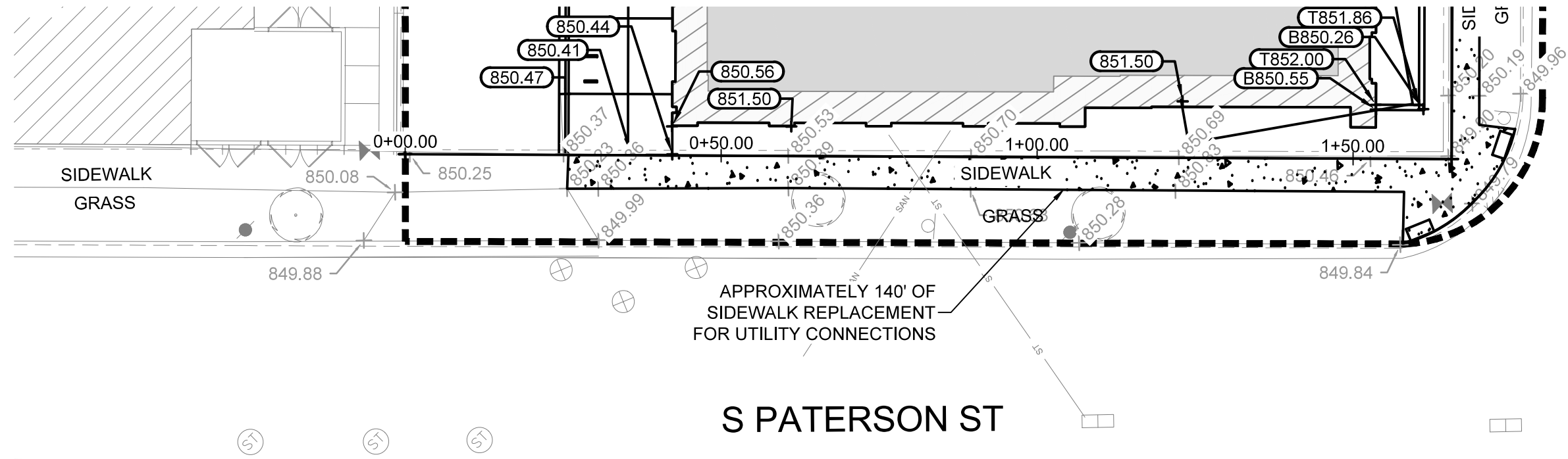

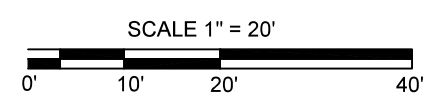
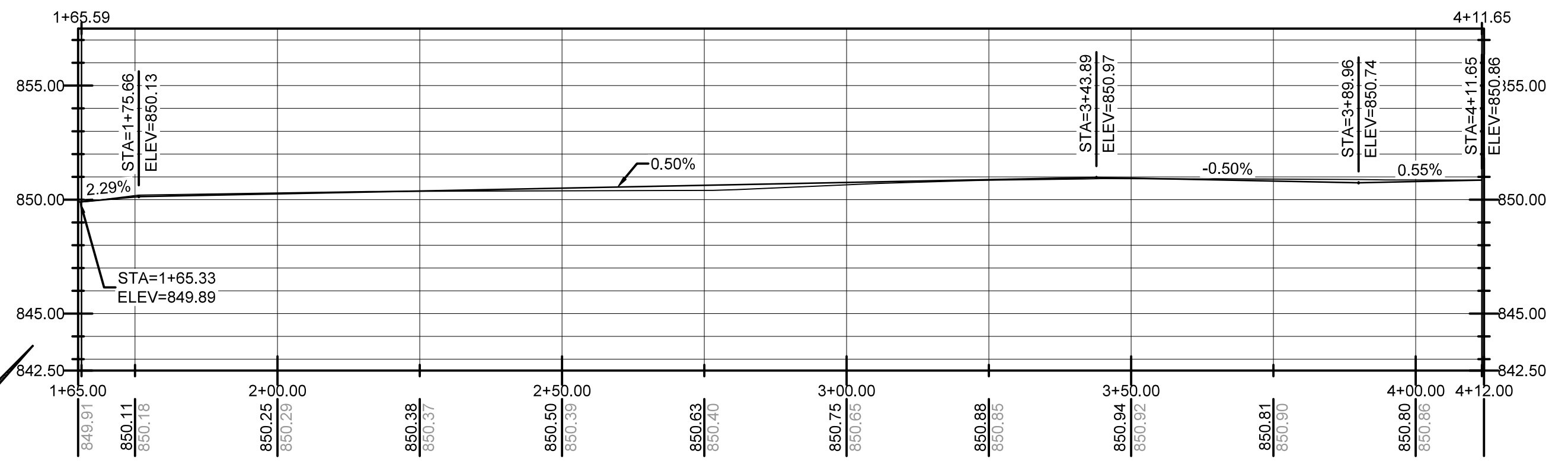
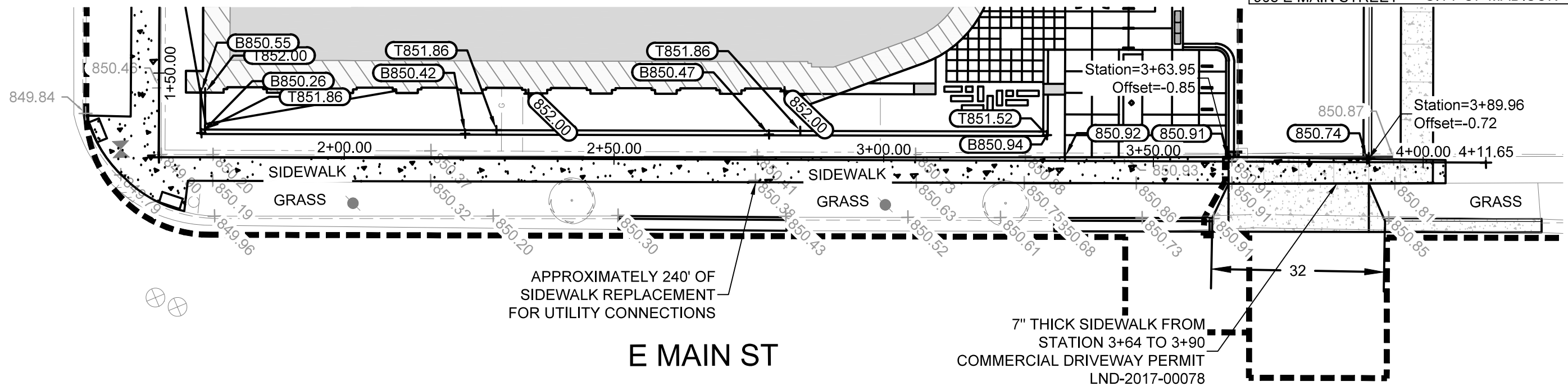

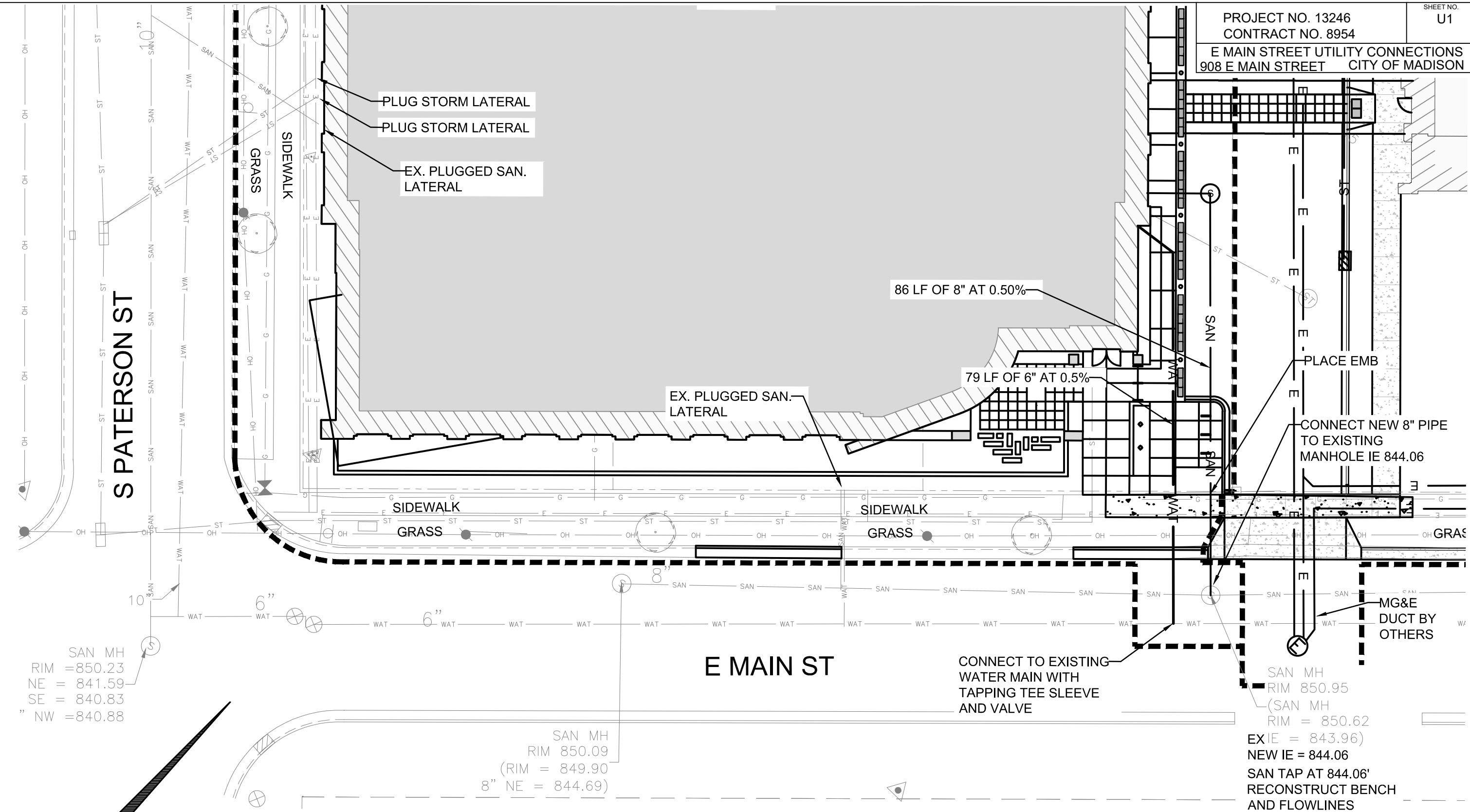

SAN MH
 RIM = 850.23
 NE = 841.59
 SE = 840.83
 NW = 840.88

SAN MH
 RIM 850.09
 (RIM = 849.90
 8" NE = 844.69)

SAN MH
 RIM 850.95
 (SAN MH
 RIM = 850.62
 EX IE = 843.96)
 NEW IE = 844.06
 SAN TAP AT 844.06'
 RECONSTRUCT BENCH
 AND FLOWLINES

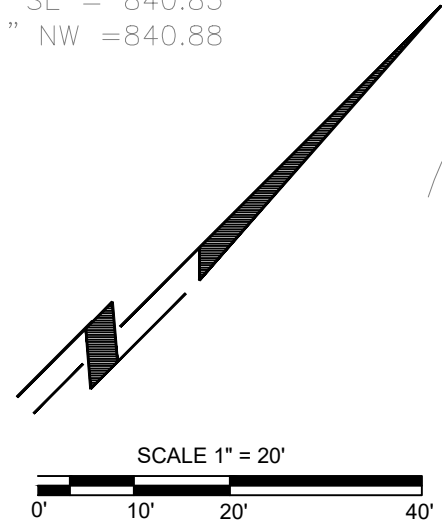

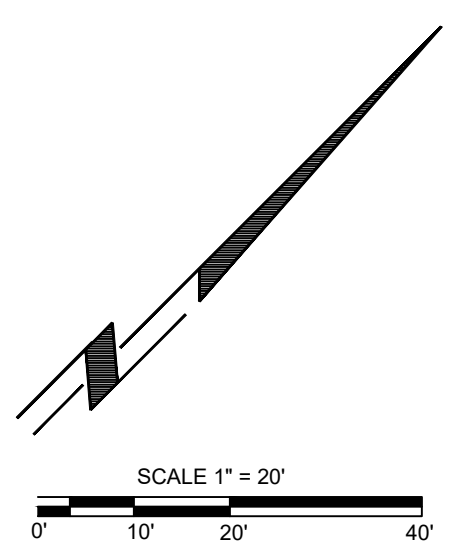
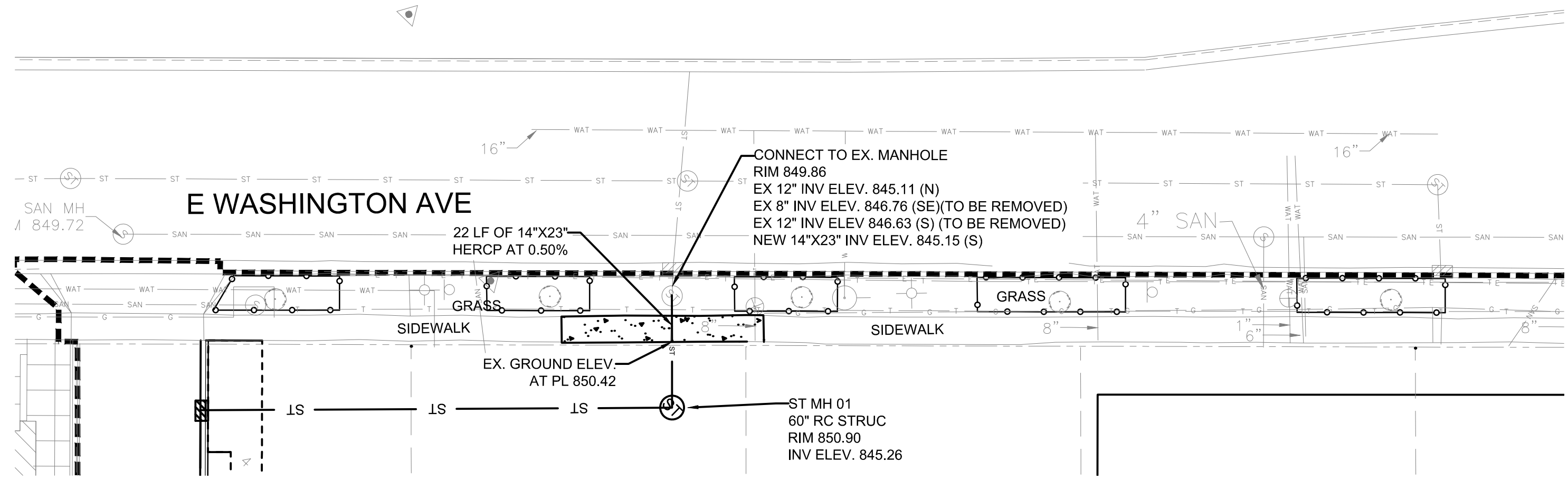

5100 Eastpark Blvd., Suite 300, Madison, WI
 53718, ph. 608-243-6470 Job# 2017136