

Madison, Wisconsin

CITY OF MADISON

CITY ENGINEERING DIVISION

DEPARTMENT OF PUBLIC WORKS

PLAN OF PROPOSED IMPROVEMENT

INDEX OF SHEETS

SHEET NO.	GENERAL NOTES
SHEET NO.D1	GENERAL NOTES
SHEET NO.D2	TYPICAL SECTION
SHEET NO.P1-P3	STREET PLAN & PROFILES
SHEET NO. U1	UTILITY PLAN
SHEET NO.C6.1	STORM SEWER PROFILE
SHEET NO.C8.1	DETAIL SHEET
SHEET NO.C8.3	BIORETENTION DETAIL
SHEET NO. X1-X3	CROSS SECTION
NO MAINTENANCE PLAN	

2651 EAST SPRINGS DRIVE

CITY PROJECT NO. 14045
CONTRACT NO. 9153

PUBLIC IMPROVEMENT PROJECT
APPROVED

MARCH 01, 2022

BY THE COMMON COUNCIL
OF MADISON, WISCONSIN

PUBLIC IMPROVEMENT DESIGN
APPROVED BY:

Greg Fries

Jun 13, 2022

City Engineer

Date

STREET
DESIGNED BY:



Jun 13, 2022

SANITARY SEWER
DESIGNED BY:

LATERAL
ONLY

STORM SEWER
DESIGNED BY:

LATERAL
ONLY

WATER
DESIGNED BY:

LATERAL
ONLY

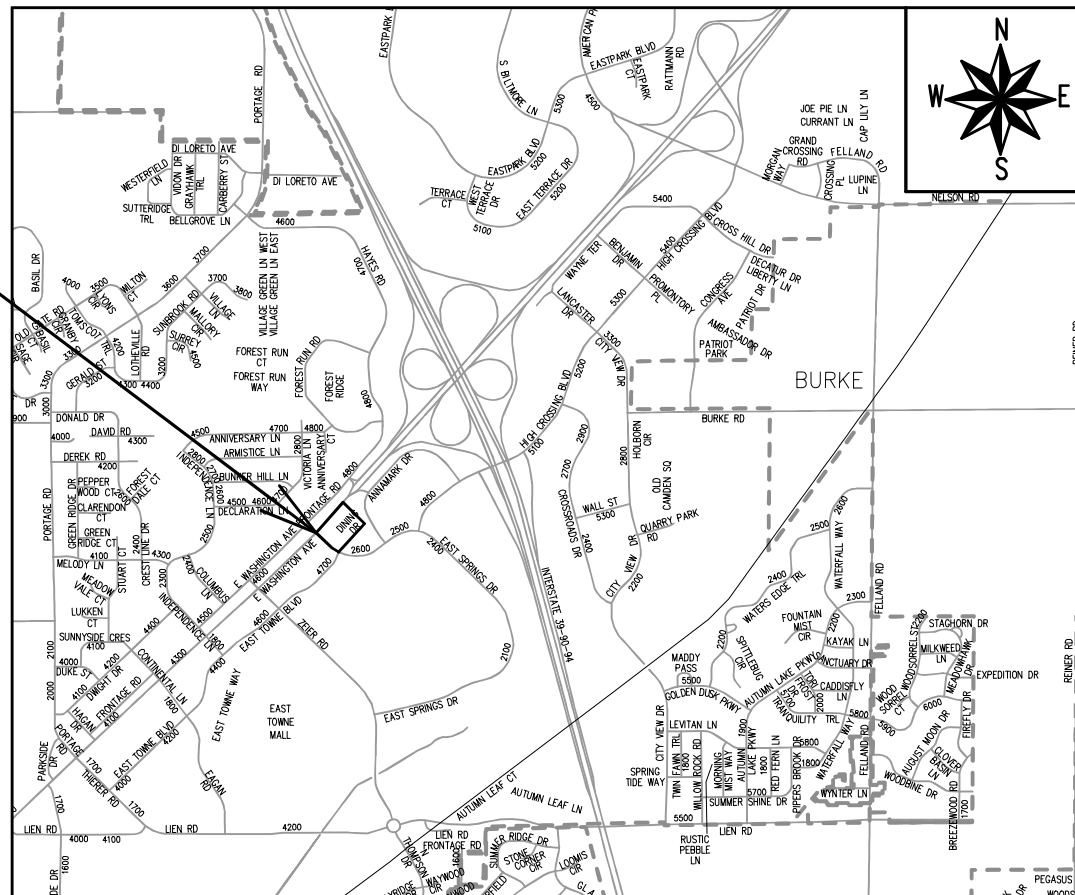

PROJECT
LOCATION

PLOT SCALE: 1:1_XREF

PLOT NAME: ---

REV. DATE: 6/6/2022 1:42 PM



ORIGINATOR: CITY_OF_MADISON

ALL PROPOSED STREET TREE REMOVALS WITHIN THE RIGHT OF WAY SHALL BE REVIEWED BY CITY FORESTRY BEFORE THE PLAN COMMISSION MEETING. STREET TREE REMOVALS REQUIRE APPROVAL AND A TREE REMOVAL PERMIT ISSUED BY CITY FORESTRY. ANY STREET TREE REMOVALS REQUESTED AFTER THE DEVELOPMENT PLAN IS APPROVED BY THE PLAN COMMISSION OR THE BOARD OF PUBLIC WORKS AND CITY FORESTRY WILL REQUIRE A MINIMUM OF A 72-HOUR REVIEW PERIOD WHICH SHALL INCLUDE THE NOTIFICATION OF THE ALDERPERSON WITHIN WHO'S DISTRICT IS AFFECTED BY THE STREET TREE REMOVAL(S) PRIOR TO A TREE REMOVAL PERMIT BEING ISSUED.

AS DEFINED BY THE SECTION 107.13 OF CITY OF MADISON STANDARD SPECIFICATIONS FOR PUBLIC WORKS CONSTRUCTION: NO EXCAVATION IS PERMITTED WITHIN 5 FEET OF THE TRUNK OF THE STREET TREE OR WHEN CUTTING ROOTS OVER 3 INCHES IN DIAMETER. IF EXCAVATION IS NECESSARY, THE CONTRACTOR SHALL CONTACT CITY OF MADISON FORESTRY (266-4816) PRIOR TO EXCAVATION. CITY OF MADISON FORESTRY PERSONNEL SHALL ASSESS THE IMPACT TO THE TREE AND TO ITS ROOT SYSTEM PRIOR TO WORK COMMENCING. TREE PROTECTION SPECIFICATIONS CAN BE FOUND ON THE FOLLOWING WEBSITE:
[HTTPS://WWW.CITYOFMADISON.COM/BUSINESS/PW/SPECS.CFM](https://www.cityofmadison.com/business/pw/specs.cfm)

DEVELOPER MUST SUBMIT A TRAFFIC CONTROL PLAN TO CITY TRAFFIC ENGINEERING AT LEAST 14 DAYS PRIOR TO THE START OF WORK. WORK SHALL NOT PROCEED UNTIL AN APPROVED TRAFFIC CONTROL PLAN IS IN PLACE.

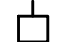
CONTACT PROJECT ENGINEER AND STREET DESIGNER DAYENU SIMON AT DSIMON@CITYOFMADISON.COM FOR CAD AND ALIGNMENT DATA PRIOR TO STAKING.

CONVENTIONAL SIGNS	
FIELD VERIFY ALL UTILITY LOCATIONS	
GAS	—— G ——
STORM SEWER	—— ST ——
SANITARY SEWER	—— SN ——
WATER	—— W ——
BURIED ELECTRIC	—— E ——
OVERHEAD ELECTRIC	—— OH ——
POWER POLE	
ADA COMPLIANT RAMP W/ DETECTABLE WARNING FIELD	
COMBUSTIBLE FLUIDS	

UNDERDRAINS SHALL BE INSTALLED PER STANDARD DETAIL DRAWING 4.05 FOR 75' ON EACH SIDE OF THE LOW POINT, OR TO THE NEAREST CURB HIGH POINT. ALL UNDERDRAIN SHALL BE WRAPPED.

ALL GUTTERS SHALL DRAIN WITH A MINIMUM GRADE OF 0.5% TOWARD STORM SEWER INLETS.

ALL DITCHES SHALL DRAIN WITH A MINIMUM GRADE OF 0.5%

THE CROSS SLOPE OF SIDEWALKS AND BARRIER FREE SIDEWALK CURB RAMPS SHALL TYPICALLY BE 1.5%. THE LONGITUDINAL GRADE OF BARRIER FREE SIDEWALK CURB RAMPS SHALL NOT EXCEED 8.33%. ALL SIDEWALK RAMPS SHALL BE CONSTRUCTED ACCORDING TO S.D.D. 3.04. AT ALL OTHER LOCATIONS THE LONGITUDINAL GRADE OF SIDEWALKS SHALL NOT BE LESS THAN 0.5% AND SHALL DRAIN TOWARD STORM SEWER INLETS. ALL SIDEWALK AND SIDEWALK RAMP ELEVATIONS AND GRADES SHALL BE FIELD VERIFIED AND SET TO COMPLY WITH THE CITY OF MADISON STANDARD SPECIFICATIONS AND THE A.D.A. GUIDELINES.

CURB STATION AND OFFSETS SHALL BE TO THE EDGE OF PAVEMENT UNLESS OTHERWISE INDICATED. CURB ELEVATIONS SHALL BE TO THE EDGE OF PAVEMENT UNLESS OTHERWISE INDICATED.

POWER POLES AND OTHER OBSTRUCTIONS SHALL BE MOVED TO PROVIDE 2 FEET MINIMUM OF CLEAR DISTANCE FROM ANY FACE OF CURB OR EDGE OF SIDEWALK.

ANY INFORMATION SHOWN ON THIS PLAN, WHICH IS NOT PART OF THIS RIGHT-OF-WAY PROJECT, IS PRELIMINARY AND NOT FOR CONSTRUCTION.

THERE MAY BE EXISTING UTILITIES OR OTHER FEATURES WHICH ARE EITHER NOT SHOWN OR SHOWN INCORRECTLY ON THIS PLAN. IT IS THE RESPONSIBILITY OF THE DEVELOPER TO LOCATE AND IDENTIFY ALL UTILITIES AND TOPOGRAPHY WHICH MAY AFFECT THE CONSTRUCTION OF THESE IMPROVEMENTS.

ALL PERMANENT SIGNING AND POSTING WILL BE DETERMINED AND PROVIDED BY THE TRAFFIC ENGINEERING DIVISION, FOLLOWING CONSTRUCTION OF THESE IMPROVEMENTS.

THE DEVELOPER SHALL PROVIDE, INSTALL AND MAINTAIN ALL STREET END BARRICADES, SIGNING AND TRAFFIC CONTROL, AS REQUIRED BY THE CITY TRAFFIC ENGINEER.

PAVEMENT SAWCUTS SHALL BE AS DIRECTED BY THE CITY CONSTRUCTION ENGINEER. SAWCUTS SHOWN ON THE PLAN ARE APPROXIMATE.

ALL WORK IN THE RIGHT OF WAY AND PUBLIC EASEMENTS SHALL BE IN ACCORDANCE WITH THE CITY OF MADISON STANDARD SPECIFICATIONS FOR PUBLIC WORKS CONSTRUCTION

MARK	REVISION	DATE	BY
13840		6/6/2022 2:00 PM	
Designed By: DS	Scale: #####		D-1

14045
 MADISON, WI
 2651 EAST SPRINGS DRIVE
 CONTRACT NO: 9153
 M:\DESIGN\Projects\14045\CAD\Streets\14045EN-Details.dwg



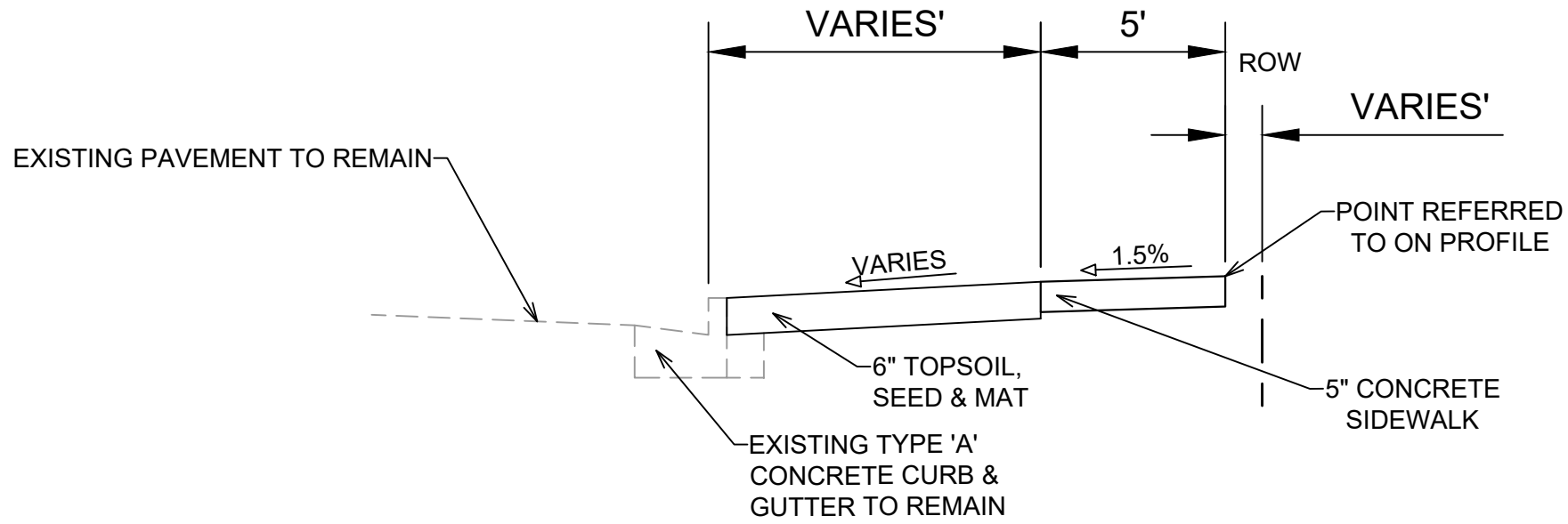

TYPICAL SECTION
 E SPRINGS DRIVE
 NOT TO SCALE

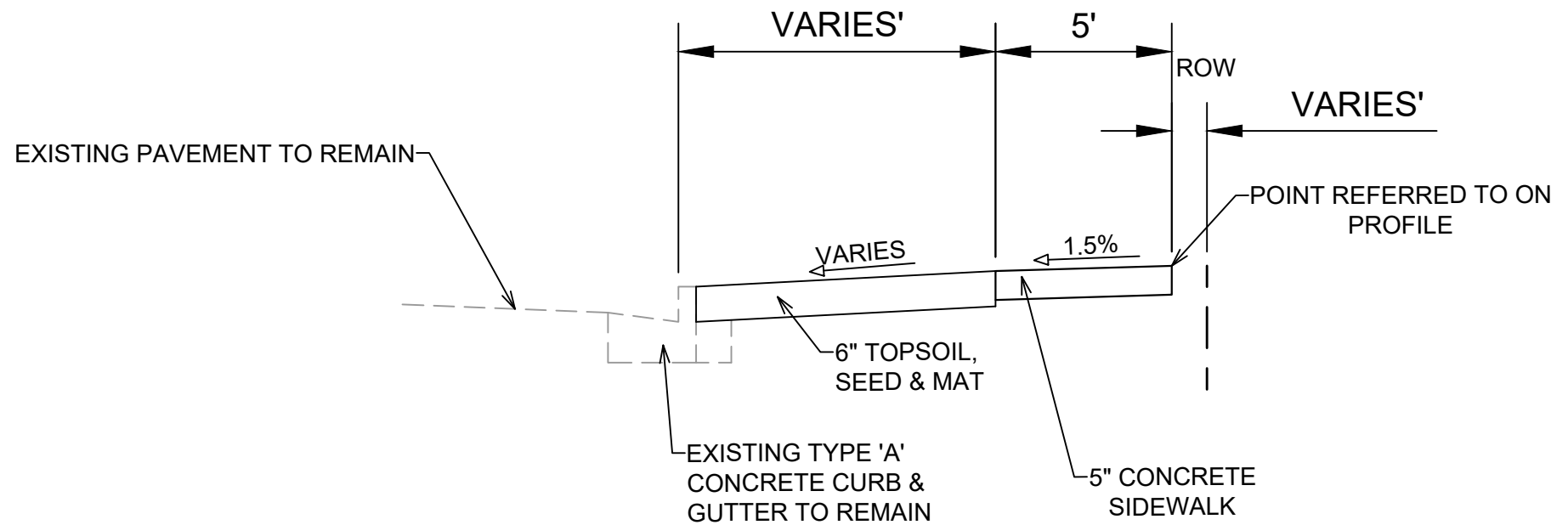

TYPICAL SECTION
 E WASHINGTON AVE
 NOT TO SCALE

DATE	BY
REVISION	
Designed By: DS	Date: 6/6/2022 2:00 PM
Scale: #####	
MARK	
14045	
14045	
D-2	

14045
 MADISON, WI
 9153
 CONTRACT NO:

TYPICAL SECTION
 2651 EAST SPRINGS DRIVE
 M:\DESIGN\Projects\14045\CAD\Streets\14045EN-Details.dwg



13840
 D-2

- NOTES -**
- 5" CONCRETE SIDEWALK
 - EXISTING SIDEWALK TO REMAIN
 - EXISTING RAMP TO REMAIN
 - CONTACT MGE FOR POSSIBLE CONFLICT WITH GAS MAIN LINE

- LEGENDS**
- X -CLEAR AND GRUB
 - ← -DRAINAGE PATH DIRECTION

-FORESTRY

- CONTRACTOR SHALL CONTACT CITY OF MADISON FORESTRY DEPARTMENT AT 608-266-4816 TO ISSUE A TREE REMOVAL PERMIT FOR THREE (3) NORWAY MAPLE TREES ON EAST SPRING DRIVE.

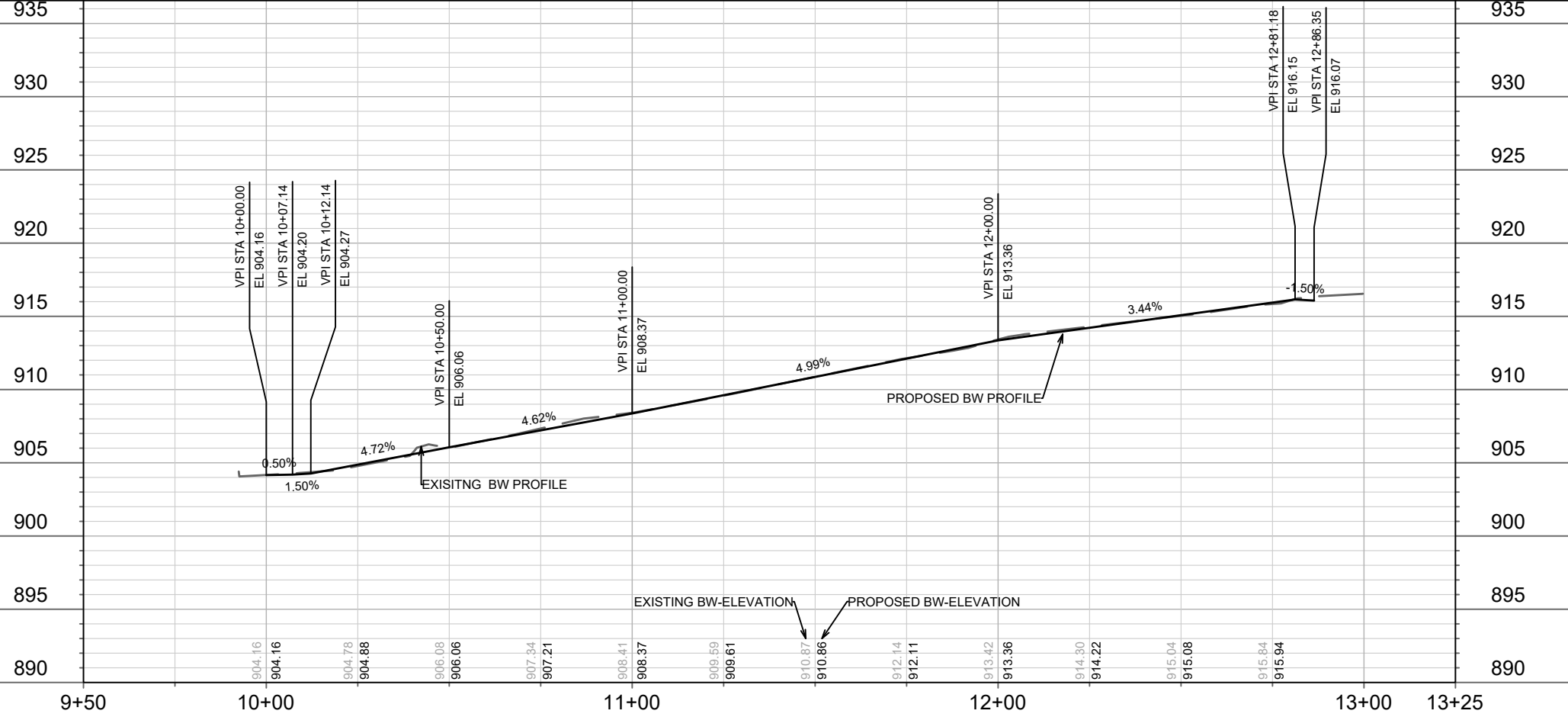
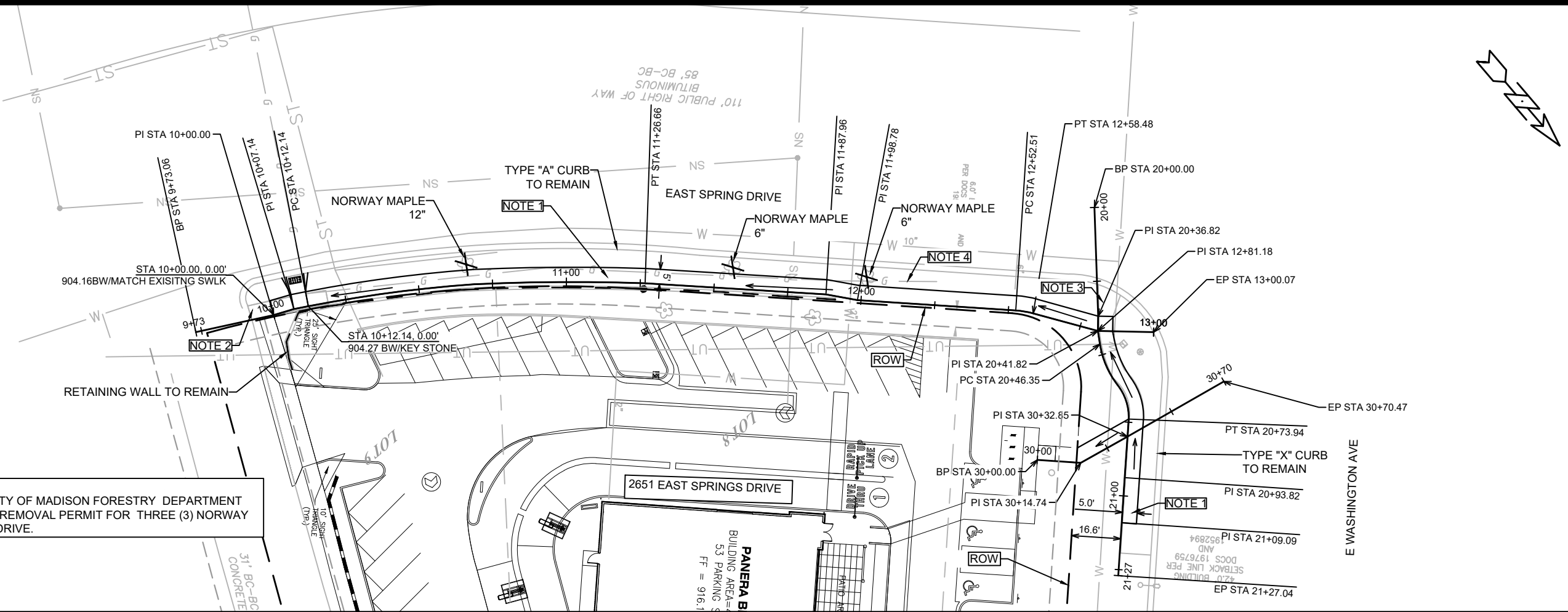

14045	MADISON, WI	9153	CONTRACT NO:
<p>PLAN & PROFILE- EAST SPRING DRIVE</p> <p>2651 EAST SPRINGS DRIVE</p> <p>M:\DESIGN\Projects\14045\CAD\Streets\14045EN-PnP.dwg</p>			
14045	P-1		

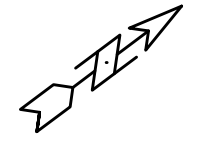

NOTES-

- 5" CONCRETE SIDEWALK
- BUS PAD TO REMAIN. METRO TRANSIT WILL LIKELY NEED FIVE WORKING DAYS NOTICE, PRIOR TO START OF CONSTRUCTION-TO ESTABLISH AN ALTERNATE CURBSIDE BUS STOP ZONE.

LEGENDS

X - CLEAR & GRUB

↙ - DRAINING DIRECTION

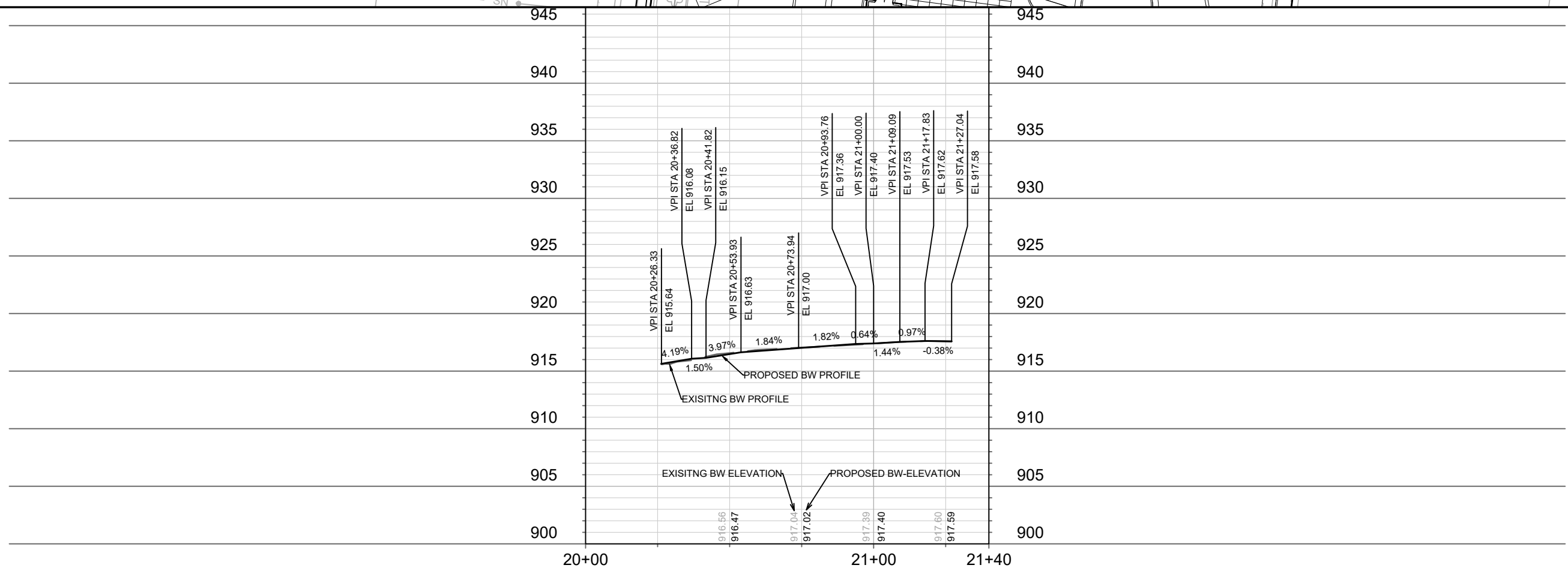
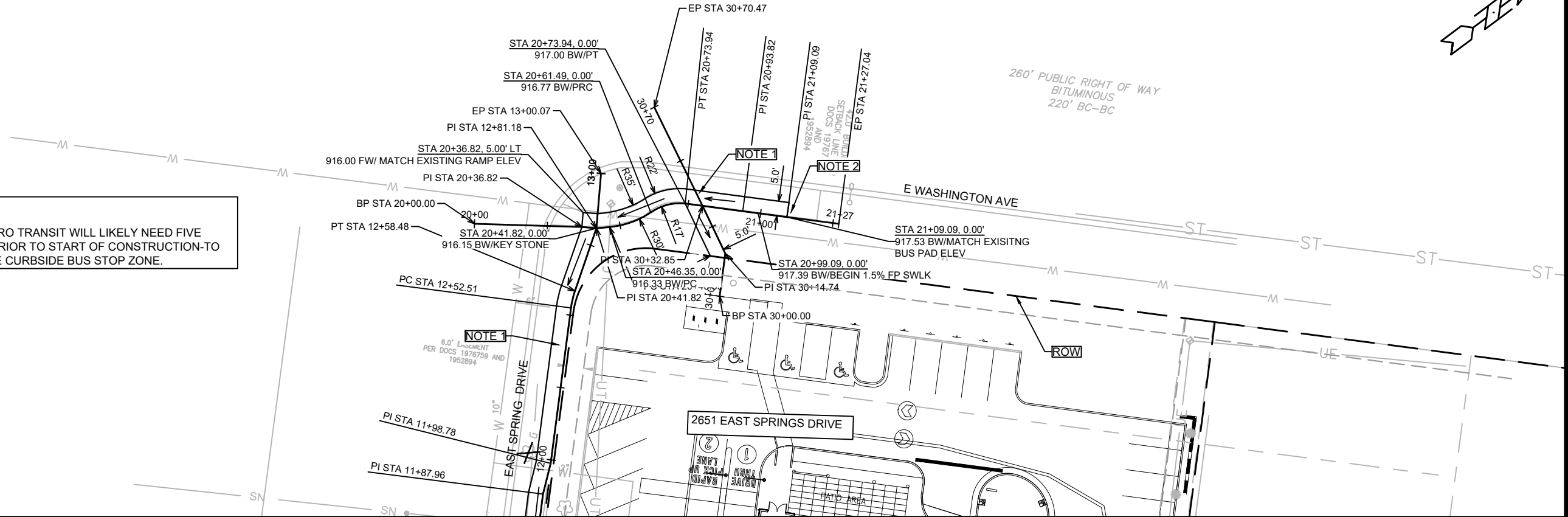

DATE	BY
REVISION	
DESIGNED BY: DS	DATE: 6/27/2022 8:21 AM
14045	Scale: 1" = 40'
14045	P-2

14045
MADISON, WI
9153
CONTRACT NO:



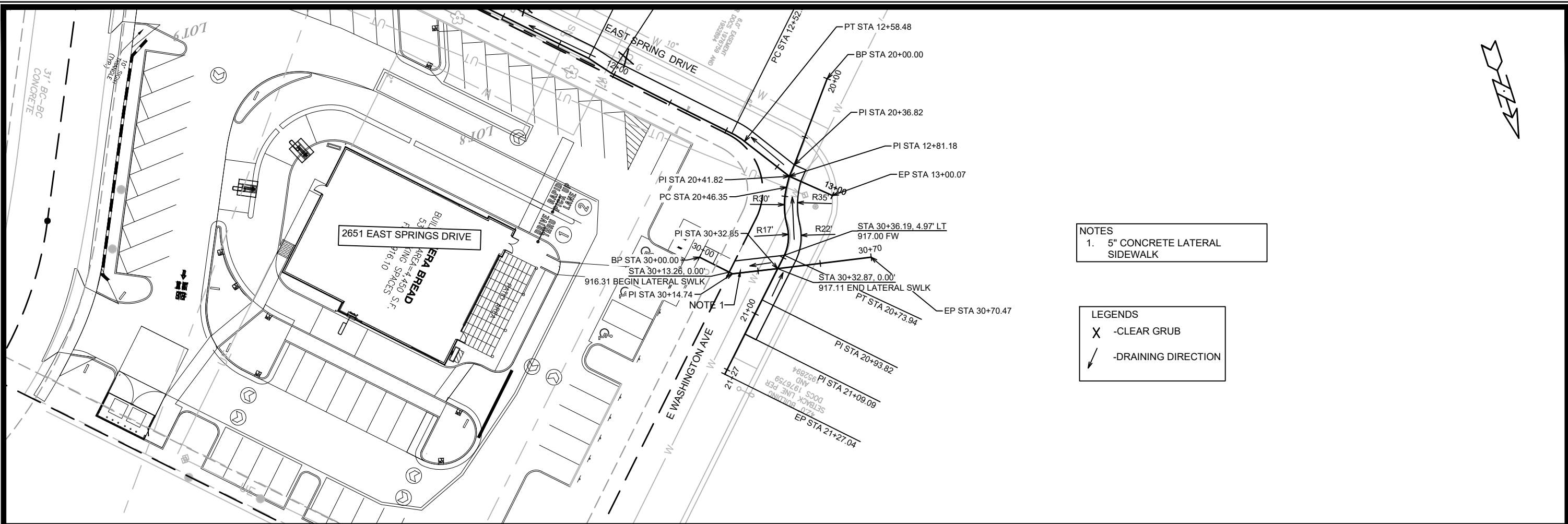

NOTES
 1. 5" CONCRETE LATERAL SIDEWALK

LEGENDS
 X - CLEAR GRUB
 ↘ - DRAINING DIRECTION

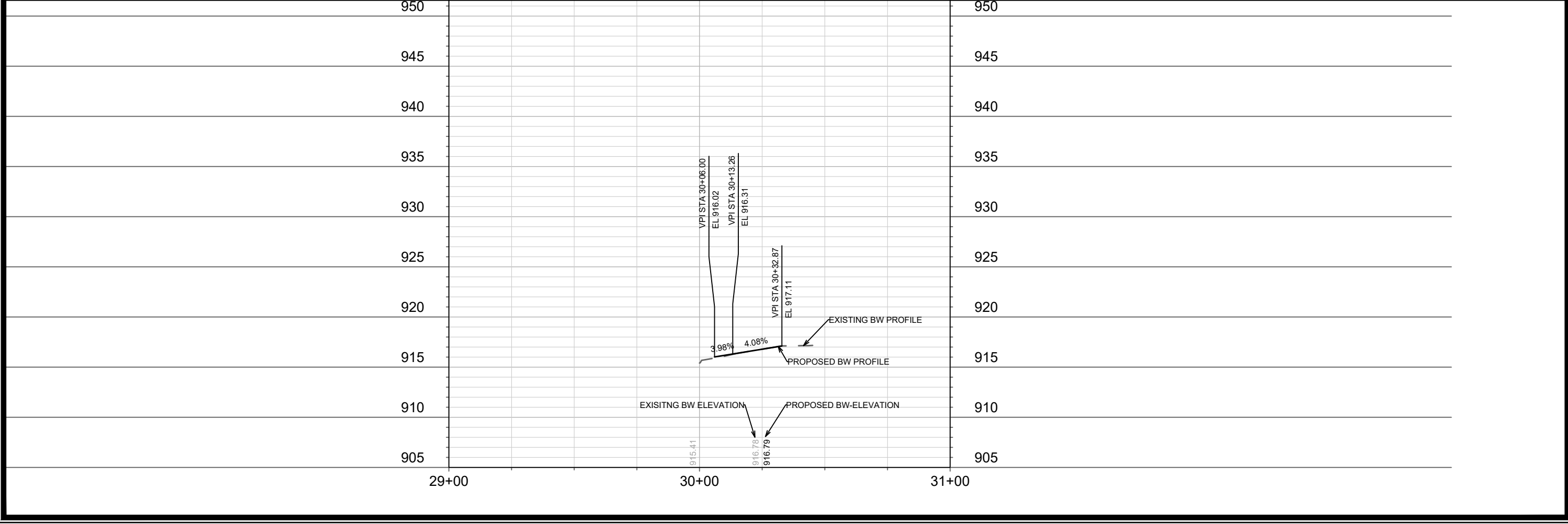

MARK	REVISION	DATE	BY
14045	14045	6/27/2022 8:21 AM	P-3

14045
 MADISON, WI
 CONTRACT NO: 9153

PLAN & PROFILE -LATERAL SIDEWALK CONNECTION
 2651 EAST SPRINGS DRIVE
 M:\DESIGN\Projects\14045\CAD\Streets\14045EN-PrP.dwg

14045
 P-3

260' PUBLIC RIGHT OF WAY
BITUMINOUS
220' BC-BC

US HIGHWAY 151/ E WASHINGTON AVE

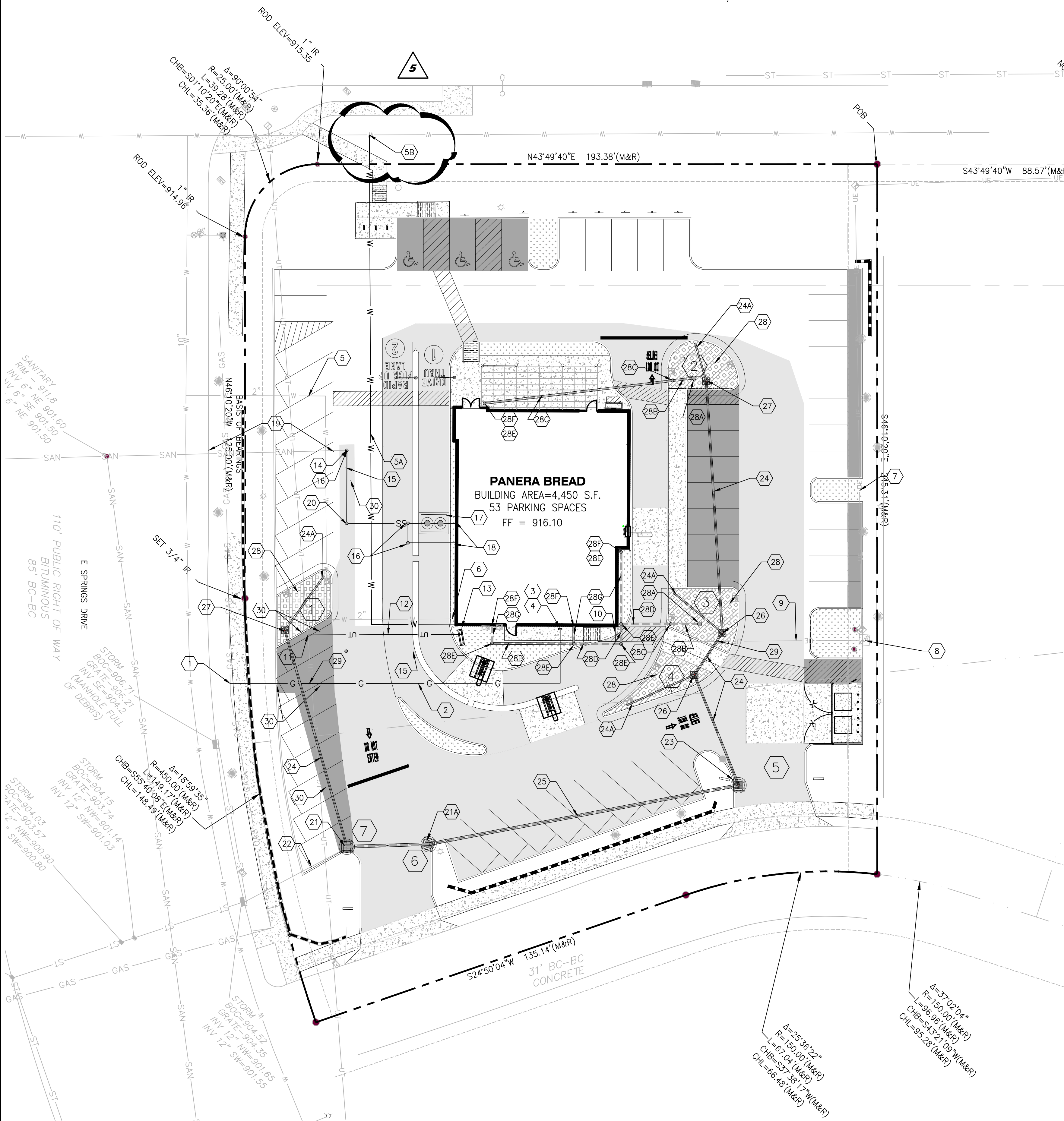
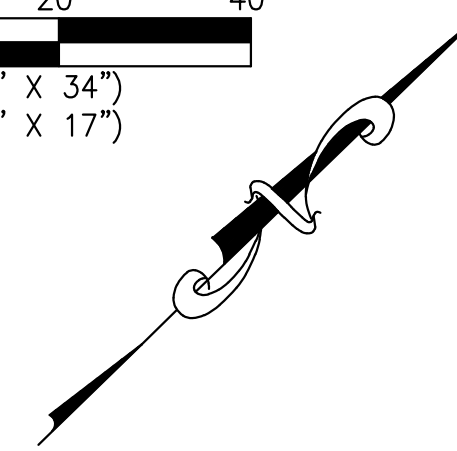
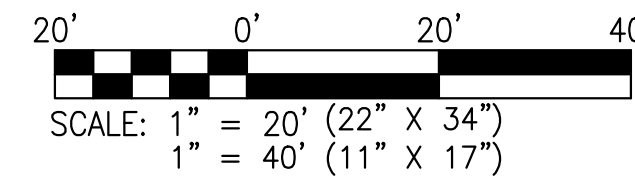

KEYED NOTES

- GAS SERVICE**
- NEW GAS SERVICE POINT OF CONNECTION. ALL MATERIAL AND INSTALLATION BY AT THE CONTRACTORS EXPENSE. THE CONTRACTOR SHALL CONTACT AS SOON AS POSSIBLE TO ACCOMMODATE REQUIRED LEAD TIME FOR DESIGN AND COORDINATION OF THE NEW SERVICE.
 - NEW 2" GAS SERVICE. ALL MATERIAL AND INSTALLATION BY GAS UTILITY AT THE CONTRACTOR'S EXPENSE.
 - NEW GAS METER. ALL MATERIAL AND INSTALLATION BY GAS UTILITY AT THE CONTRACTORS EXPENSE.
 - REFER TO ARCHITECTURAL PLANS FOR EXACT LOCATION AND CONTINUATION OF GAS SERVICE.
- WATER SERVICE**
- NOT USED.
 - NEW 6" FIRE/DOMESTIC WATER SERVICE. WATER SERVICE LINE TO BE DUCTILE IRON PIPE FROM MAIN TO RIGHT-OF-WAY LINE AND PVC FROM RIGHT-OF-WAY LINE TO BUILDING. FINAL FIRE SERVICE LINE SIZE SHALL BE VERIFIED BY THE FIRE SPRINKLER CONTRACTOR PRIOR TO THE START OF CONSTRUCTION.
 - CONTRACTOR TO COORDINATE WITH THE UTILITY COMPANY FOR A LIVE TAP TO THE EXISTING WATER MAIN.
 - REFER TO ARCHITECTURAL PLANS FOR EXACT LOCATION AND CONTINUATION OF DOMESTIC WATER SERVICE.
- ELECTRIC SERVICE**
- EXISTING PRIMARY UNDERGROUND ELECTRIC SERVICE TO BE USED IN PLACE.
 - EXISTING GROUND MOUNTED TRANSFORMER TO BE USED IN PLACE.
 - EXISTING SECONDARY UNDERGROUND ELECTRIC SERVICE TO BE USED IN PLACE.
 - REFER TO ARCHITECTURAL PLANS FOR EXACT LOCATION AND CONTINUATION OF ELECTRIC SERVICE.
- COMMUNICATIONS SERVICE**
- NEW COMMUNICATIONS SERVICE POINT OF CONNECTION. ALL MATERIAL AND INSTALLATION BY UTILITY COMPANY AT THE CONTRACTORS EXPENSE. THE CONTRACTOR SHALL CONTACT COMMUNICATIONS UTILITY AS SOON AS POSSIBLE TO ACCOMMODATE REQUIRED LEAD TIME FOR DESIGN AND COORDINATION OF NEW SERVICE.
 - NEW PVC COMMUNICATION SERVICE CONDUIT. CONTRACTOR TO COORDINATE WITH UTILITY COMPANY FOR CONDUIT SIZING. THE CONTRACTOR SHALL BE RESPONSIBLE FOR PROVIDING AND INSTALLING THE CONDUIT AND PULLWIRE. ALL OTHER MATERIAL AND INSTALLATION BY COMMUNICATIONS UTILITY AT THE CONTRACTOR'S EXPENSE.
 - REFER TO ARCHITECTURAL PLANS FOR EXACT LOCATION AND CONTINUATION OF COMMUNICATIONS SERVICE.
- SANITARY SEWER SERVICE**
- NEW SANITARY SEWER SERVICE POINT OF CONNECTION TO EXISTING SANITARY LATERAL PER SANITARY SEWER UTILITY STANDARDS. INVERT ELEVATION = 908.46 (CONTRACTOR TO LOCATE EXISTING SANITARY SEWER AND VERIFY ELEVATION AT PROPOSED CONNECTION. REPORT FINDINGS TO ENGINEER). ALL MATERIAL AND INSTALLATION BY THE CONTRACTOR AT THE CONTRACTORS EXPENSE.
 - NEW 6" SANITARY SEWER SERVICE WITH 2.0% MINIMUM SLOPE AND 36" MINIMUM COVER.
 - NEW SANITARY SEWER CLEANOUT. REFER TO DETAIL ON SHEET C8.1.
 - NEW SANITARY SEWER POINT OF BUILDING ENTRY (INVERT ELEVATION = 912.60). REFER TO ARCHITECTURAL PLANS FOR EXACT LOCATION AND CONTINUATION OF SANITARY SEWER SERVICE.
 - EXISTING 6" SANITARY SEWER TO REMAIN.
 - NEW SANITARY SAMPLING TEE. REFER TO DETAIL ON SHEET C8.1.
- STORM SEWER SERVICE**
- NEW 2"-GRATE INLET WITH SIDE INTAKE AND WITH ADS FLEXSTORM PURE INLET FILTER WITH PC & FILTER BAG (OR APPROVED EQUAL). [EXISTING INVERT (SW)= 902.60]. CONTRACTOR TO VERIFY ELEVATION. REFER TO PROFILES ON SHEET C6.1.
 - NEW 2"-GRATE INLET WITH SIDE INTAKE AND WITH ADS FLEXSTORM PURE INLET FILTER WITH PC & FILTER BAG (OR APPROVED EQUAL). REFER TO PROFILES ON SHEET C6.1.
 - EXISTING 12" STORM SEWER TO REMAIN.
 - NEW 2"-GRATE INLET WITH SIDE INTAKE. REFER TO DETAIL ON SHEET C8.3 AND PROFILES ON SHEET C6.1.
 - NEW 8" PVC STORM SEWER. REFER TO PROFILES ON SHEET C6.1.
 - NEW 6" PVC PERFORATED UNDERDRAIN. REFER TO SHEET C8.3.
 - NEW 12" PVC STORM SEWER. REFER TO PROFILES ON SHEET C6.1.
 - NEW 12" NYLOPLAST DRAIN BASIN WITH DOME GRATE. REFER TO DETAIL ON SHEET C8.3 AND PROFILES ON SHEET C6.1.
 - NEW 12" NYLOPLAST DRAIN BASIN WITH DOME GRATE. REFER TO DETAIL ON SHEET C8.3 AND PROFILES ON SHEET C6.1.
 - NEW BIOTENTION BASIN. REFER TO DETAIL ON SHEET C8.3.
 - NEW PVC ROOF DRAIN RISER WITH PERFORATED SUMP WITH FILTER FABRIC SLEEVE IN BIOTENTION BASIN. REFER TO DETAIL 10 ON SHEET C8.1.
 - NEW 6" PERFORATED PVC ROOF DRAIN WITH FILTER FABRIC SLEEVE UNDER BIOTENTION BASIN ENGINEERED SOIL LAYER. REFER TO DETAIL 10 ON SHEET C8.1.
 - NEW ROOF DRAIN BIOTENTION CLEAN OUT. REFER TO DETAIL 10 ON SHEET C8.1.
 - NEW 6" PVC ROOF DRAIN WITH 2.00% MINIMUM SLOPE AND 36" MINIMUM COVER.
 - NEW STORM SEWER CLEAN OUT.
 - NEW ROOF DRAIN DOWNSPUT CONNECTION (INVERT = 914.10). REFER TO MEP PLANS FOR EXACT LOCATION.
 - NEW 4" PP ROOF DRAIN WITH 2.00% MINIMUM SLOPE AND 36" MINIMUM COVER.
 - NEW CANOPY DRAIN POINT OF CONNECTION (INVERT = 914.10) REFER TO MEP PLANS FOR EXACT LOCATION.
- MISCELLANEOUS ITEMS**
- THE CONTRACTOR SHALL MAINTAIN 18" MINIMUM VERTICAL CLEARANCE AT ALL UTILITY CROSSINGS.
 - REMOVE AND REPLACE EXISTING PAVEMENT, SIDEWALK, AND CURB IN KIND AS NECESSARY TO INSTALL THE PROPOSED UTILITIES. THE RIGHT-OF-WAY IS THE SOLE JURISDICTION OF THE CITY OF MADISON AND IS SUBJECT TO CHANGE AT ANY TIME PER THE RECOMMENDATION/PLAN OF TRAFFIC ENGINEERING AND CITY ENGINEERING DEPARTMENTS.

NO	REVISION DESCRIPTION	DATE
1	PER CITY COMMENTS	11/24/21
2	PER CITY COMMENTS	11/24/21
3	PER CITY COMMENTS	12/09/21
4	PER CITY COMMENTS	12/09/21
5	REVISE PER UTILITY DEPARTMENT COMMENTS	05/11/22

DEVELOPER/OWNER:
PANERA LLC
3630 SOUTH GEVER ROAD SUITE 100
ST. LOUIS, MO 63127
(314) 984-1000

THE PROFESSIONAL ENGINEER'S SEAL AND PROFESSIONAL ENGINEER'S SIGNATURE SHALL BE PLACED ON THIS PLAN. THE PROFESSIONAL ENGINEER ASSUMES RESPONSIBILITY ONLY FOR WHAT APPEARS ON THIS PLAN. THE PROFESSIONAL ENGINEER DOES NOT ASSUME RESPONSIBILITY FOR ANY OTHER PLANS, SPECIFICATIONS, OR CONTRACT DOCUMENTS. THE PROFESSIONAL ENGINEER'S SEAL AND SIGNATURE SHALL BE PLACED ON THIS PLAN. THE PROFESSIONAL ENGINEER ASSUMES RESPONSIBILITY ONLY FOR WHAT APPEARS ON THIS PLAN. THE PROFESSIONAL ENGINEER DOES NOT ASSUME RESPONSIBILITY FOR ANY OTHER PLANS, SPECIFICATIONS, OR CONTRACT DOCUMENTS.

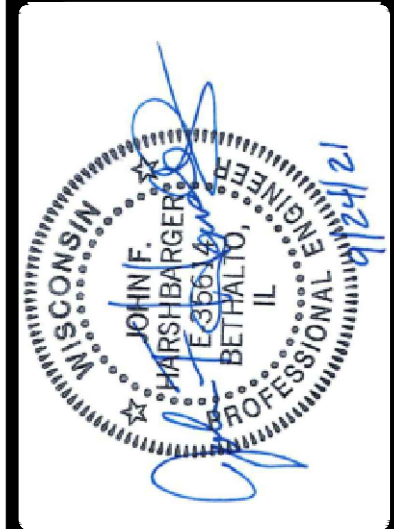

PANERA BAKERY CAFE #1551
2651 EAST SPRINGS DRIVE
MADISON, WI 53704

UTILITY PLAN

cole
+ ST. LOUIS
CIVIL ENGINEERING / SURVEYING / PLANNING / LANDSCAPE ARCHITECTURE
314.444.4444
www.cole-engineering.com

DESIGN/CALC BY: LFD
DRAWN BY: LFD
CHECKED BY: AMG
DRAWING SCALE: AS SHOWN
DATE: 11/24/21

Job Number
20-0003
Sheet Number
U-1

USER: Christine Wilson TAB: UTILITY PLAN
DRAWING: S:\Users\chrisw\OneDrive\Documents\20-0003\CAD\Utility\20-0003.dwg

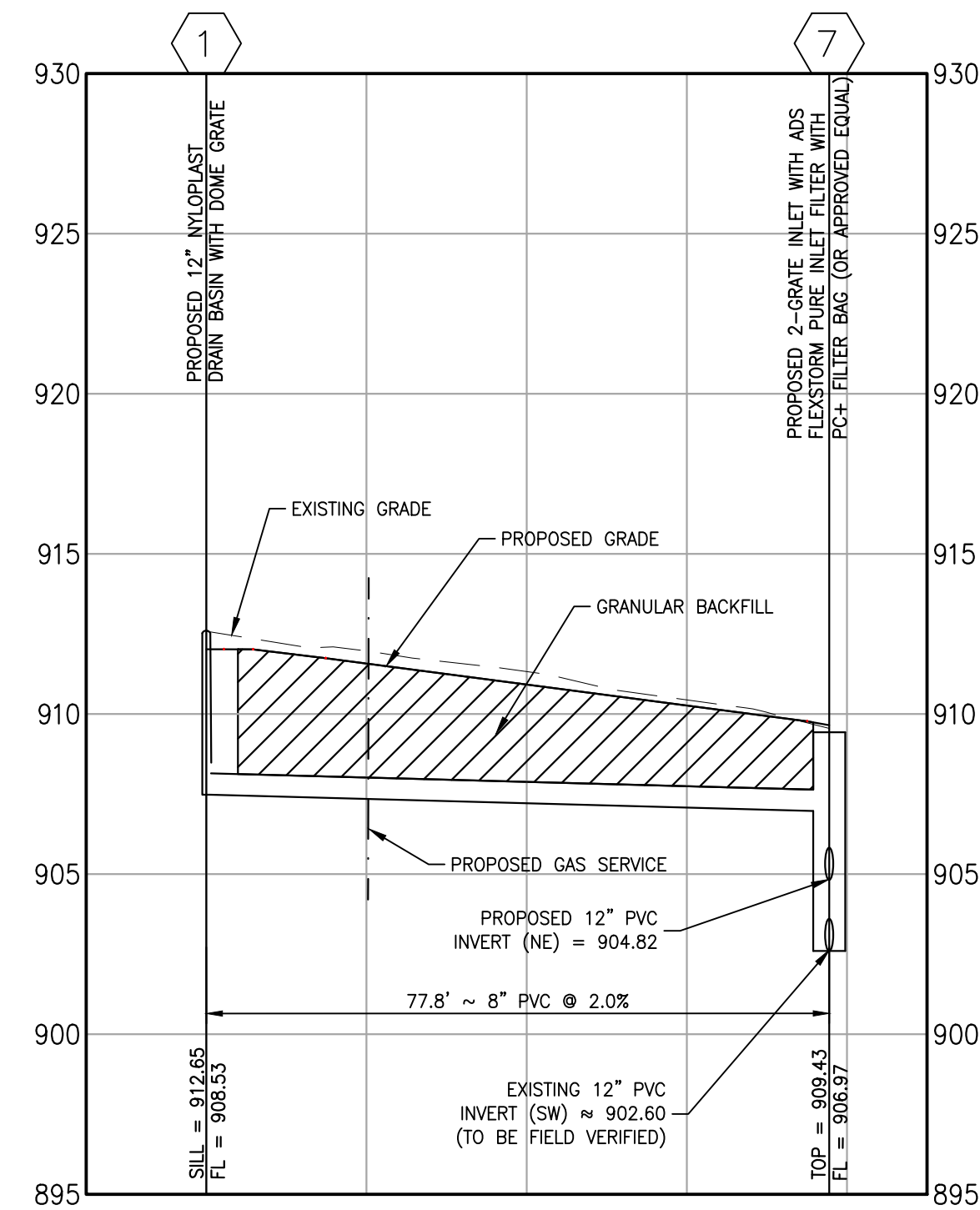
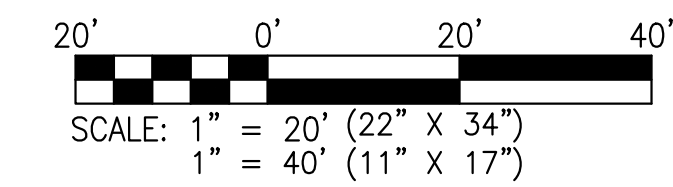

1 LINE 1 STORM SEWER PROFILE
 SCALE: 1"=20' HORIZ. 1"=5' VERT. REF. DWG. C6.0

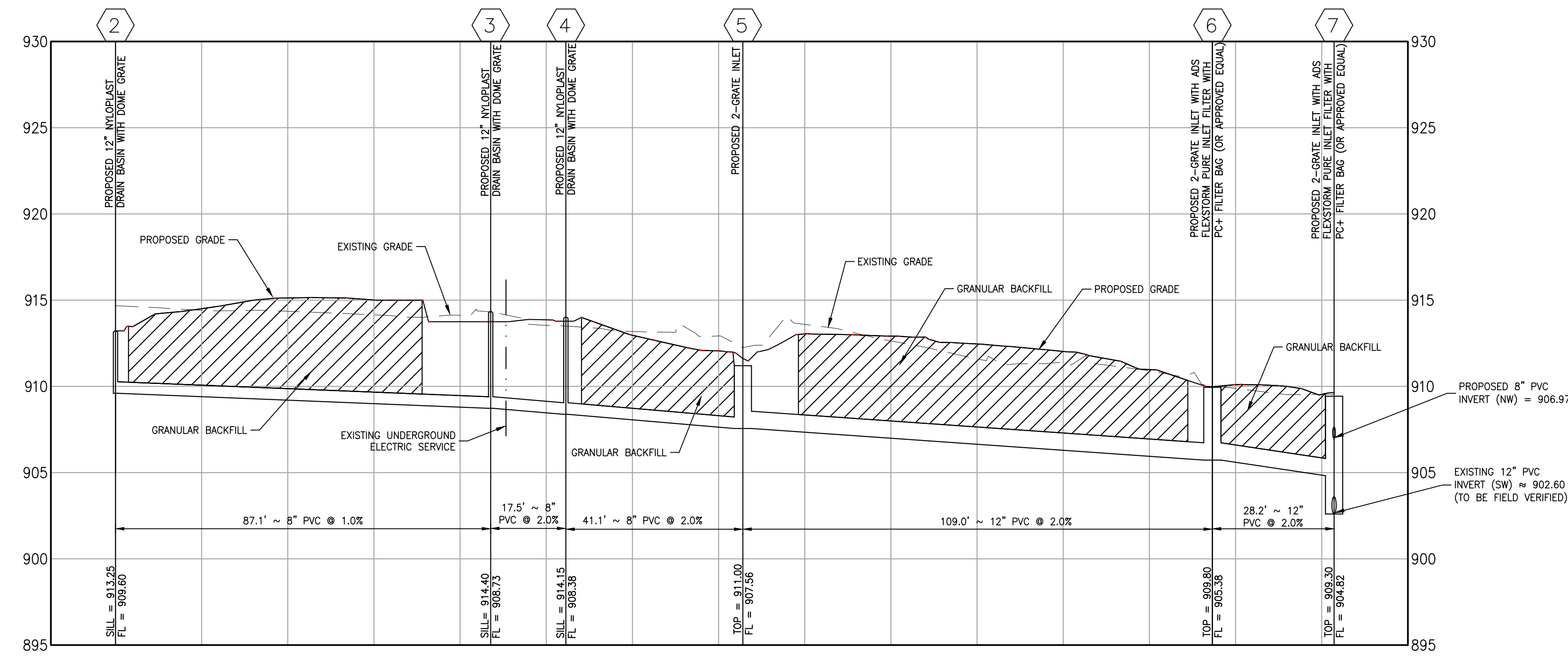

2 LINE 2 STORM SEWER PROFILE
 SCALE: 1"=20' HORIZ. 1"=5' VERT. REF. DWG. C6.0

USER: Paul_Henderson TAB: STORM_SEWER_PROFILES
 DATE: 11/24/21 10:58:20 AM
 DRAWING: S:\JBS\Arch2021\20-0003\CAD\1\C-Plan\PlusSheets\C-Plan_UTILITY_20-0003.dwg

NO	DATE	REVISION DESCRIPTION
1	11/24/21	PER CITY COMMENTS
2	12/08/21	PER CITY COMMENTS
3	1/26/22	PER CITY COMMENTS
4	4/6/22	REVISE SANITARY/DOWNSPOUTS

DEVELOPER/OWNER:
PANERA LLC
 3630 SOUTH GEYER ROAD SUITE 100
 ST. LOUIS, MO 63127
 (314) 984-1000

THE PROFESSIONAL ENGINEER'S SEAL AND SIGNATURE ARE NECESSARY TO APPEAR HEREON. THE ENGINEER ASSUMES RESPONSIBILITY ONLY FOR WHAT APPEARS ON THIS PAGE, AND DISCLAIMS RESPONSIBILITY FOR ALL OTHER PAGES. THIS DRAWING IS TO BE USED ONLY FOR THE PROJECT AND FOR THE PURPOSES SPECIFIED HEREON. IT IS NOT TO BE REPRODUCED OR TRANSMITTED IN ANY FORM OR BY ANY MEANS, ELECTRONIC OR MECHANICAL, INCLUDING PHOTOCOPYING, RECORDING, OR BY ANY INFORMATION STORAGE AND RETRIEVAL SYSTEM, WITHOUT THE WRITTEN PERMISSION OF THE ENGINEER.

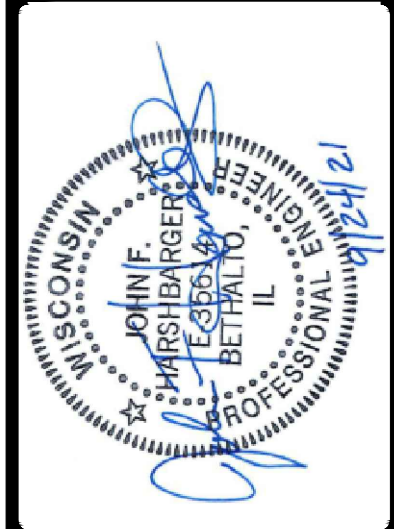

PANERA BAKERY CAFE #1551
 2651 EAST SPRINGS DRIVE
 MADISON, WI 53704

STORM SEWER PROFILES



DESIGN/CALC BY	LFD
DRAWN BY	LFD
CHECKED BY	AMG
DRAWING SCALE	AS SHOWN
DATE	11/24/21
Job Number	20-0003
Sheet Number	C6.1

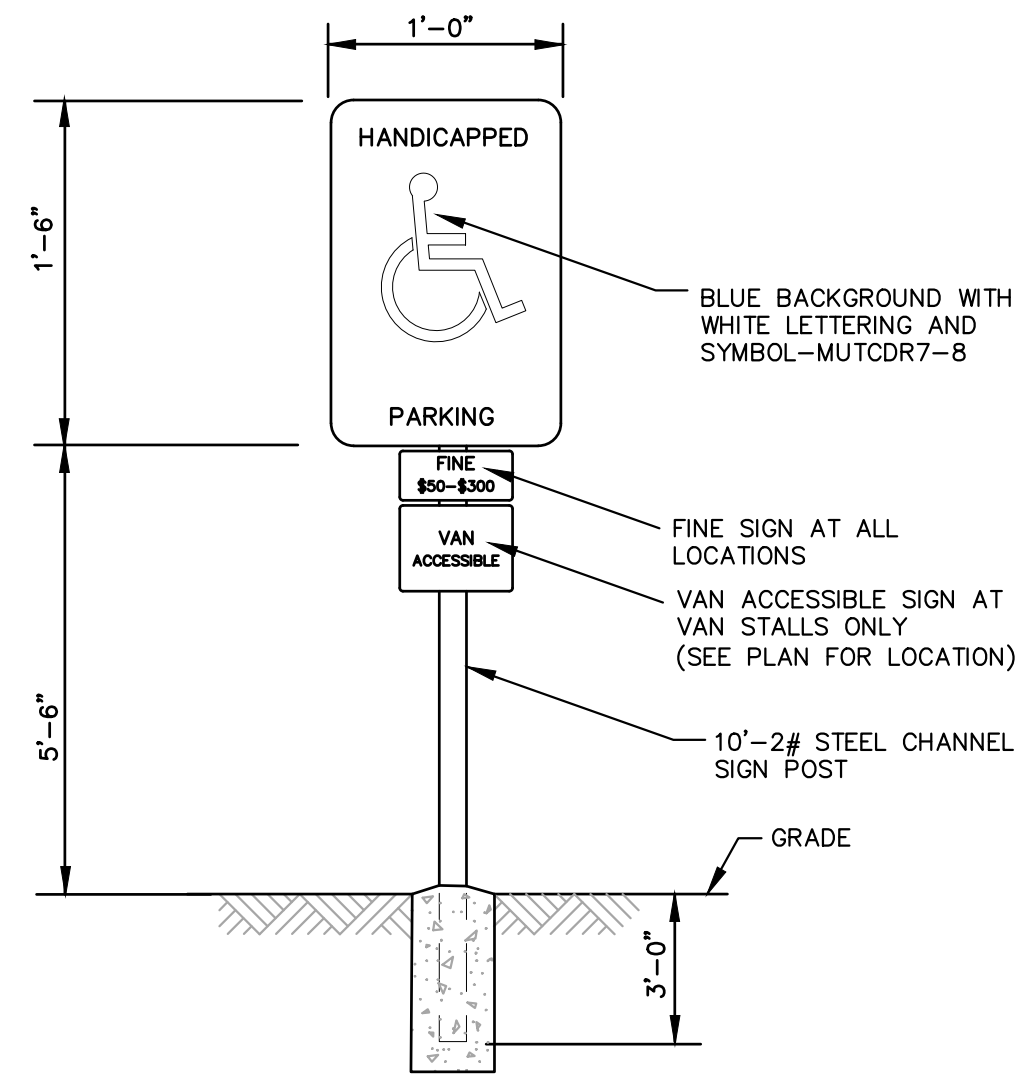

1 VAN ACCESSIBLE PARKING SIGN DETAIL
SCALE: N.T.S. REF. DWG. C4.0

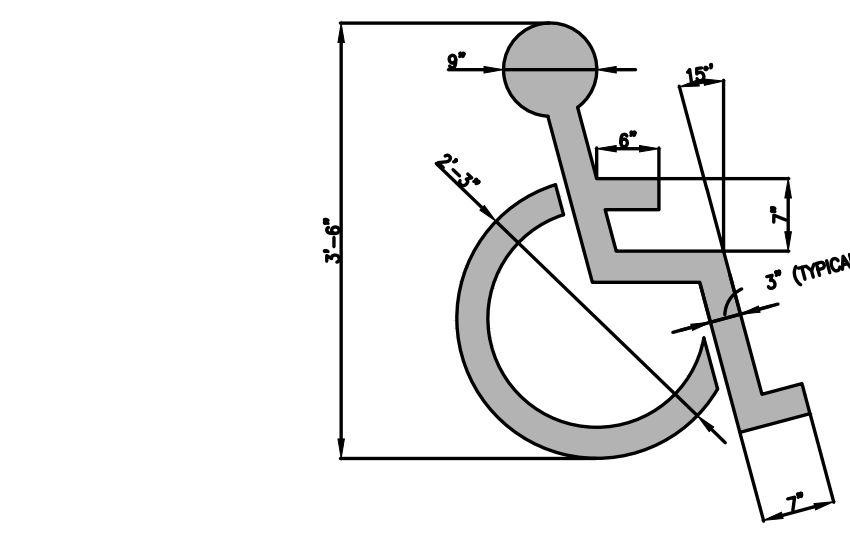

2 ACCESSIBLE PARKING SYMBOL DETAIL
SCALE: N.T.S. REF. DWG. C4.0

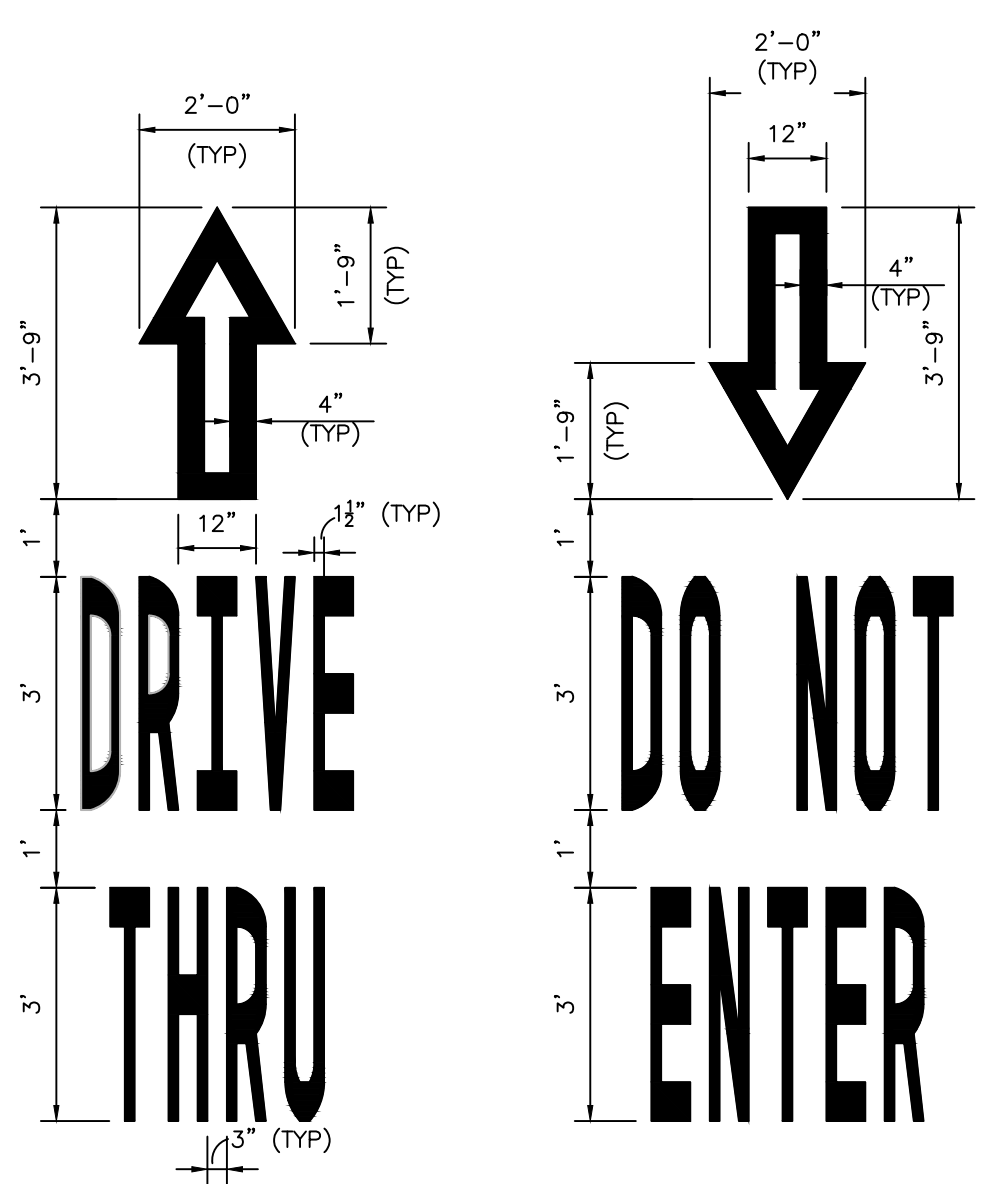

4 DRIVE-THRU/DO NOT ENTER DETAIL
SCALE: N.T.S. REF. DWG. C4.0

DETAIL NOTES:
1. ARROWS SHALL BE PAINTED SOLID REFLECTIVE YELLOW OR PER LOCAL CODES.

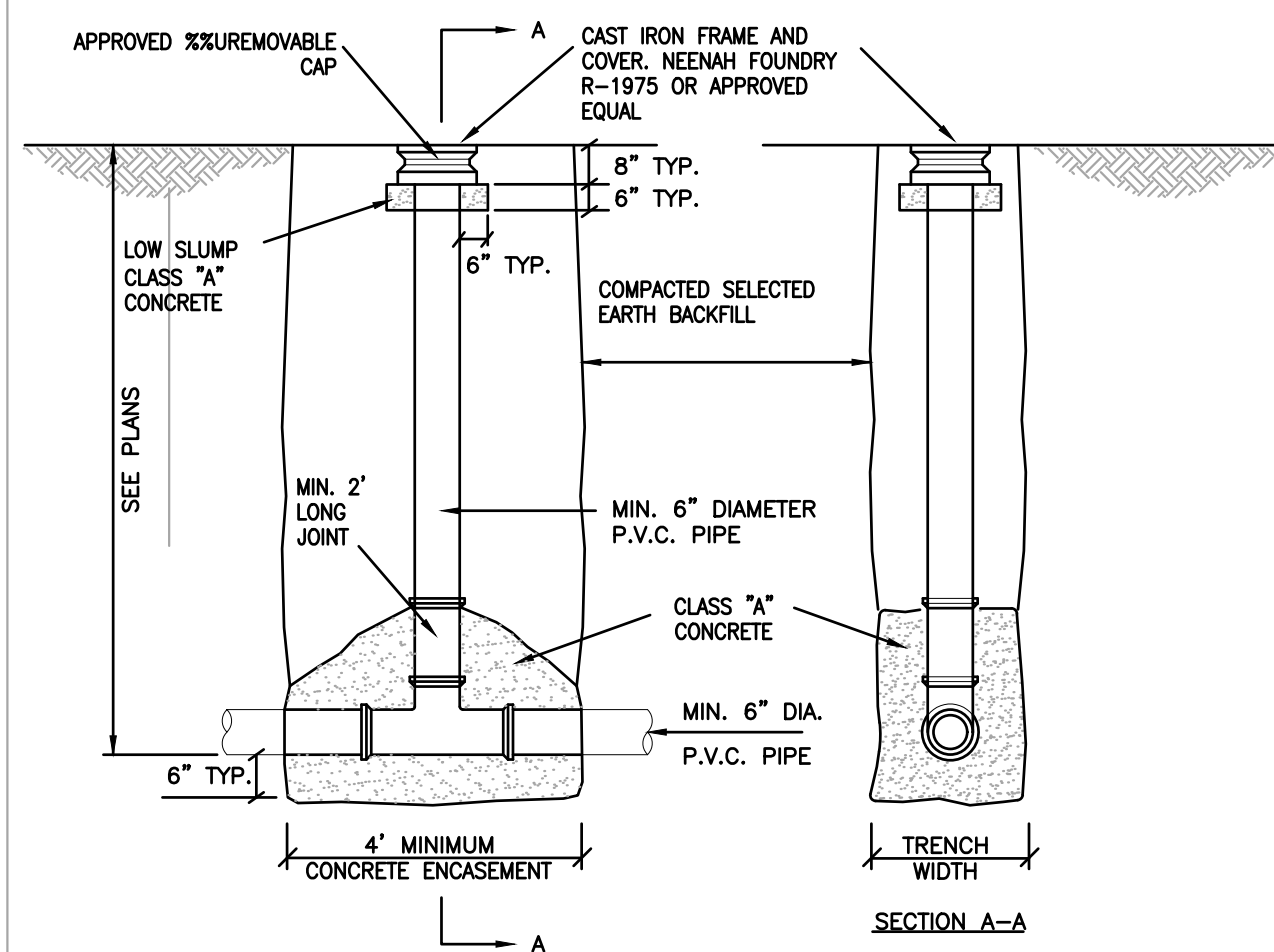

5 SAMPLING TEE DETAIL
SCALE: N.T.S. REF. DWG. C6.0

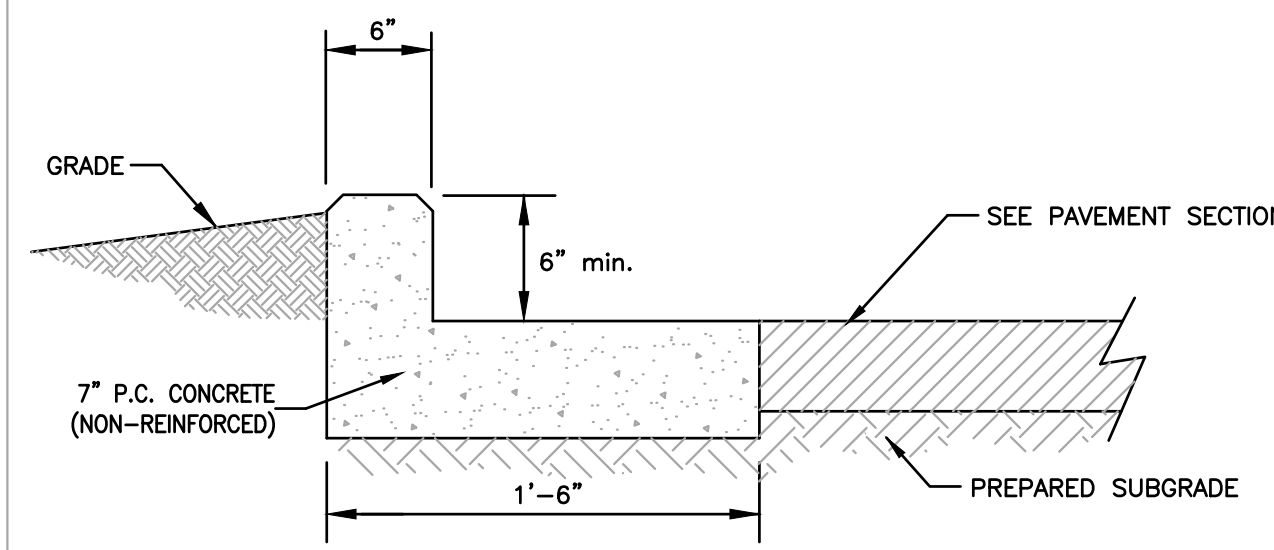

8 CONCRETE CURB AND GUTTER DETAIL
SCALE: N.T.S. REF. DWG. C4.0

- NOTES:
1. ALL CONCRETE SHALL BE MIN. FC.=4,000 P.S.I. (UNLESS OTHERWISE NOTED)
2. ANY UNSUITABLE SOIL (AS DETERMINED BY SOILS ENGINEER) BELOW STRUCTURE SHALL BE REMOVED AND REPLACED WITH SELECT EARTHEN MATERIAL COMPACTED IN PLACE WITH VIBRATORY TAMPER.
3. ALL EXPOSED CONCRETE EDGES TO HAVE 3/4" CHAMFER.
4. DIMENSIONS SHOWN ARE TO FACE OF CURB.

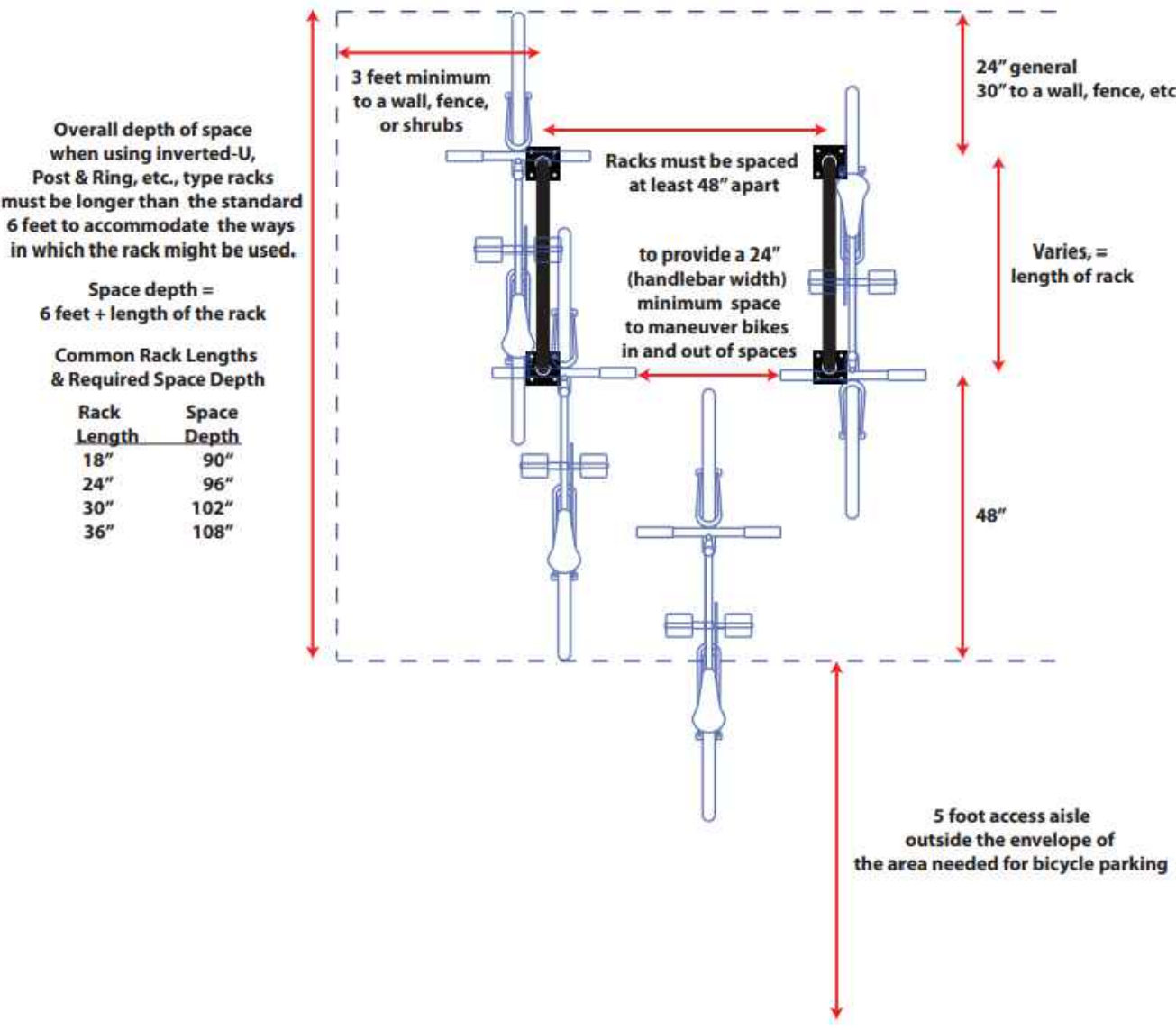
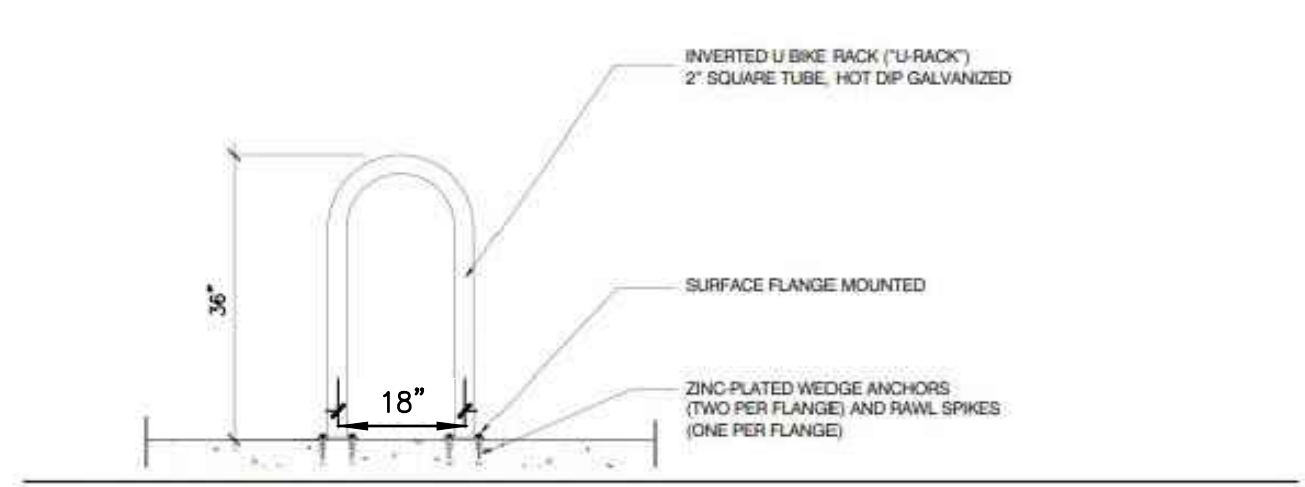

3 BIKE RACK DETAIL
SCALE: N.T.S. REF. DWG. C4.0

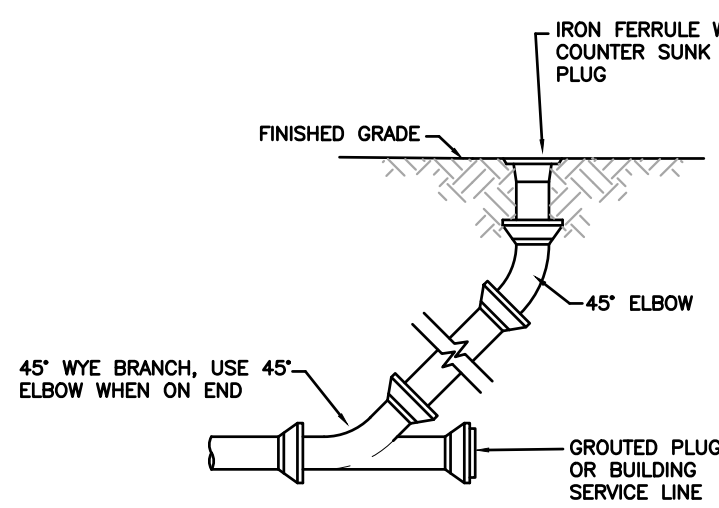

6 CLEANOUT DETAIL
SCALE: N.T.S. REF. DWG. C6.0

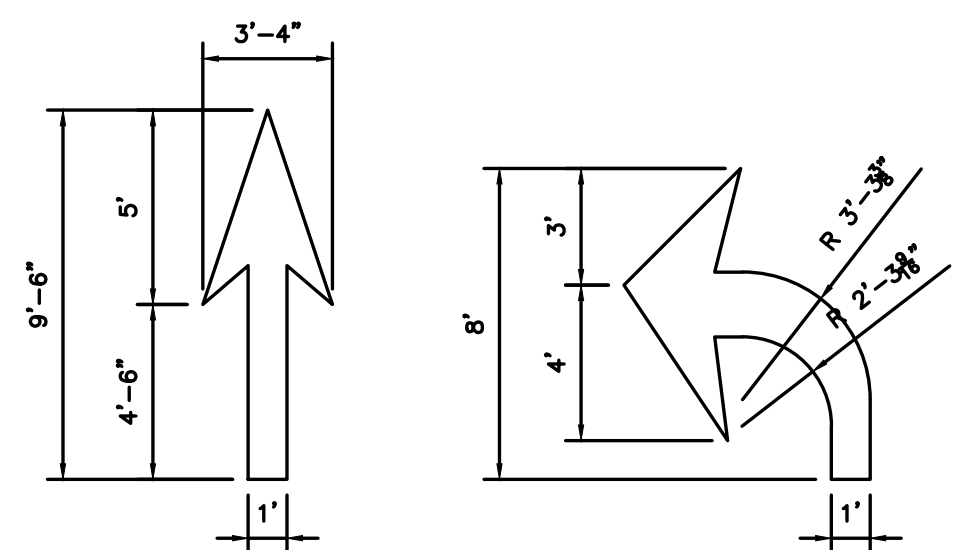

9 TRAFFIC FLOW ARROW DETAIL
SCALE: N.T.S. REF. DWG. C4.0

- DETAIL NOTES:
1. RIGHT TURN ARROW TO BE THE REVERSE OF TURN LANE ARROW SHOWN ABOVE.
2. ARROWS SHALL BE PAINTED REFLECTIVE WHITE.
3. ARROWS SHALL BE APPLIED PER CHAPTER 3B OF THE MUTCD, LATEST EDITION.

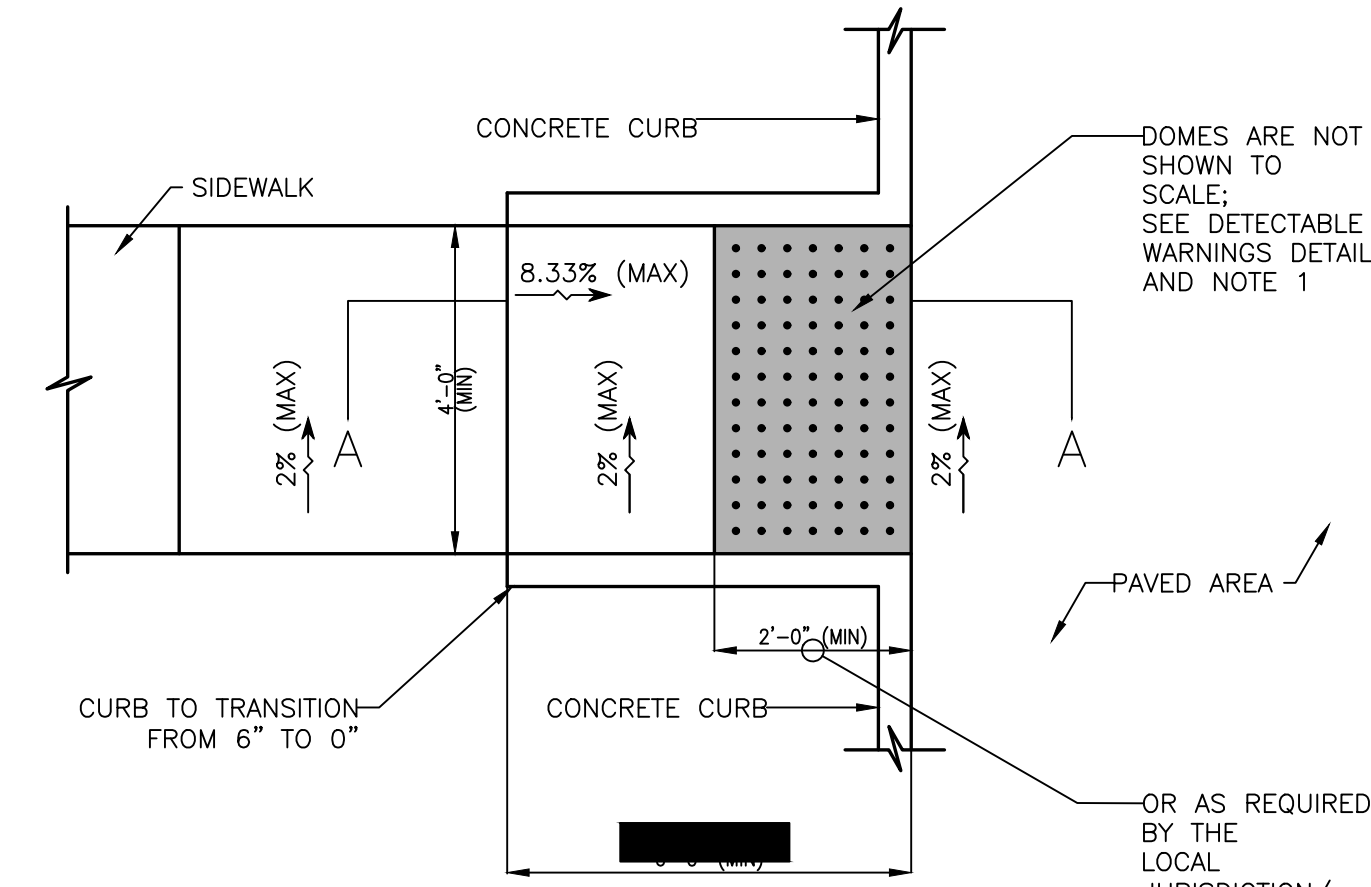

7 CURB RAMP DETAIL
SCALE: N.T.S. REF. DWG. C4.0

- DETAIL NOTES:
1. THE SURFACE OF RAMP SHALL HAVE DETECTABLE WARNINGS AS SHOWN. DETECTABLE WARNINGS SHALL CONSIST OF RAISED TRUNCATED DOMES. SEE DETECTABLE WARNINGS DETAIL.
2. RAMP SIDE SLOPE VARIES UNIFORMLY FROM A MAXIMUM OF UP TO 10% AT CURB TO CONFORM WITH LONGITUDINAL SIDEWALK SLOPE ADJACENT TO TOP OF THE RAMP.
3. CONSTRUCT PER A.D.A. STANDARDS.
4. REFER TO PLANS FOR ADJACENT SLOPES.
5. THE CROSS SLOPE OF THE RAMP SURFACE SHALL BE NO GREATER THAN 1:50.

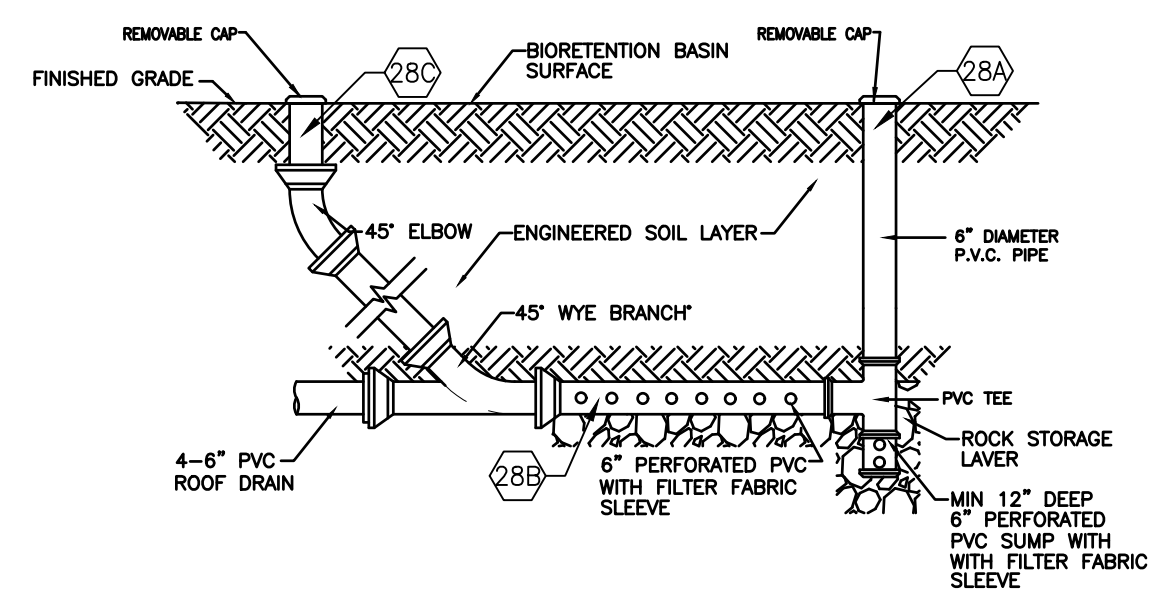

10 BIORETENTION CLEANOUT DETAIL
SCALE: N.T.S. REF. DWG. C6.0

NO	REVISION DESCRIPTION	DATE
1 <td>PER CITY COMMENTS</td> <td>11/24/21</td>	PER CITY COMMENTS	11/24/21
2 <td>PER CITY COMMENTS</td> <td>12/09/21</td>	PER CITY COMMENTS	12/09/21
3 <td>PER CITY COMMENTS</td> <td>1/26/22</td>	PER CITY COMMENTS	1/26/22
4 <td>REVISE SANITARY/DOWNSPOUTS</td> <td>4/6/22</td>	REVISE SANITARY/DOWNSPOUTS	4/6/22

DEVELOPER/OWNER:
PANERA LLC
3630 SOUTH GEVER ROAD SUITE 100
ST. LOUIS, MO 63127
(314) 984-1000

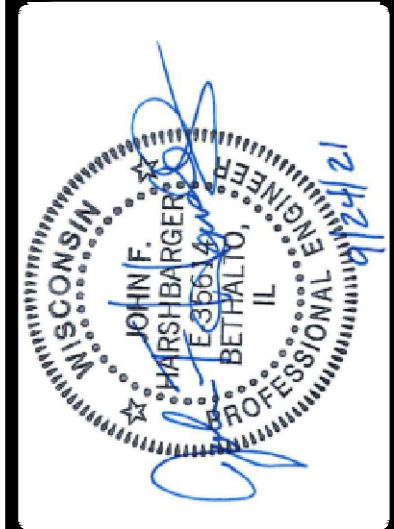

PANERA BAKERY CAFE #1551
2651 EAST SPRINGS DRIVE
MADISON, WI 53704

cole
CIVIL ENGINEERING / SURVEYING / PLANNING / LANDSCAPE ARCHITECTURE
1001 S. W. 10th Street
St. Louis, MO 63104
314.666.0000
www.colearch.com

DESIGN/CALC BY: LFD
DRAWN BY: LFD
CHECKED BY: AMG
DRAWING SCALE: AS SHOWN
DATE: 11/24/21

Job Number: **20-0003**
Sheet Number: **C8.1**

USER: Paul_Henderson_T05_C01_P01
DRAWING: S:\0831\Arch2020\C01-0003\CADD\C-Plan\PlotSheets\C-PLAN_DETAIL_20-0003.dwg

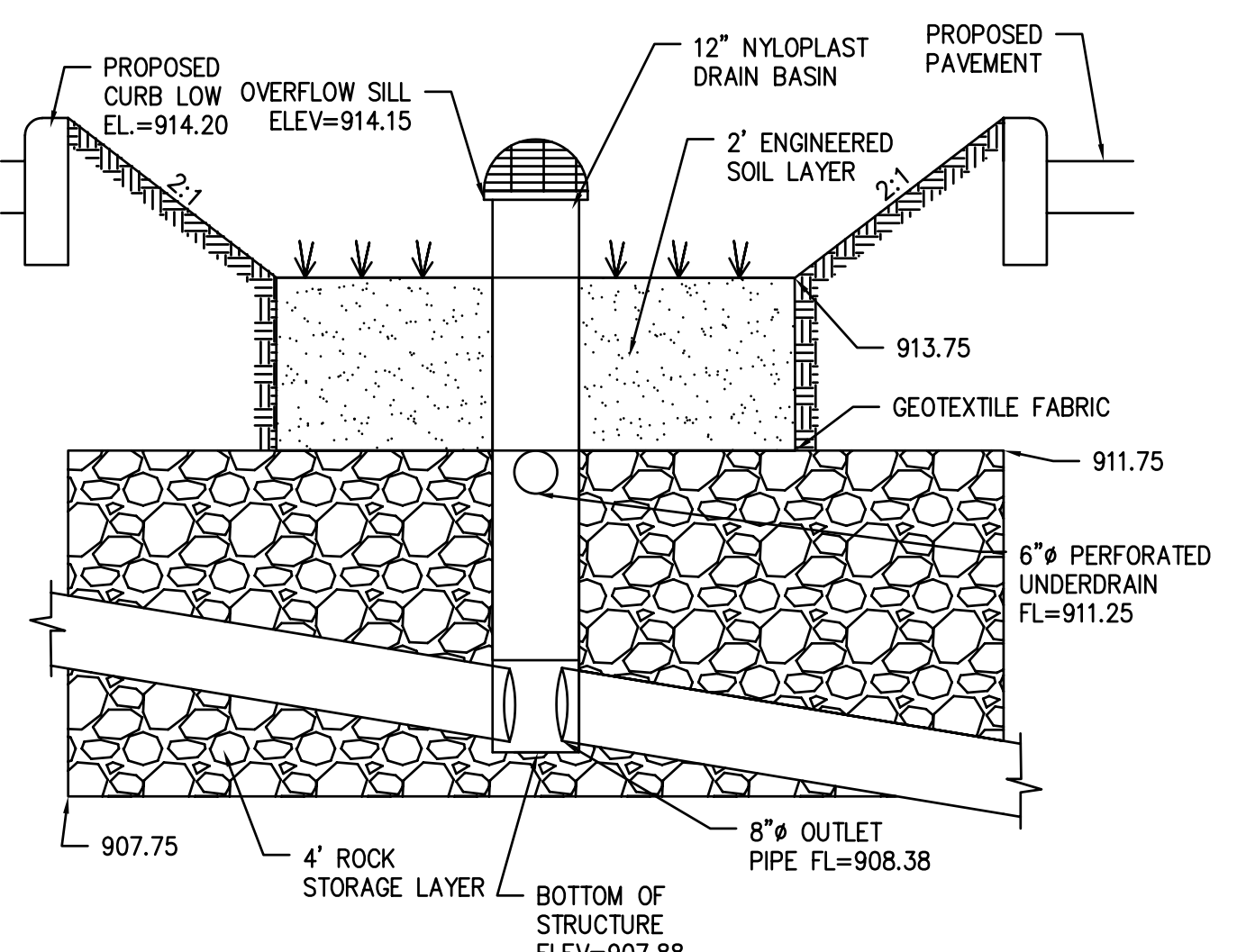
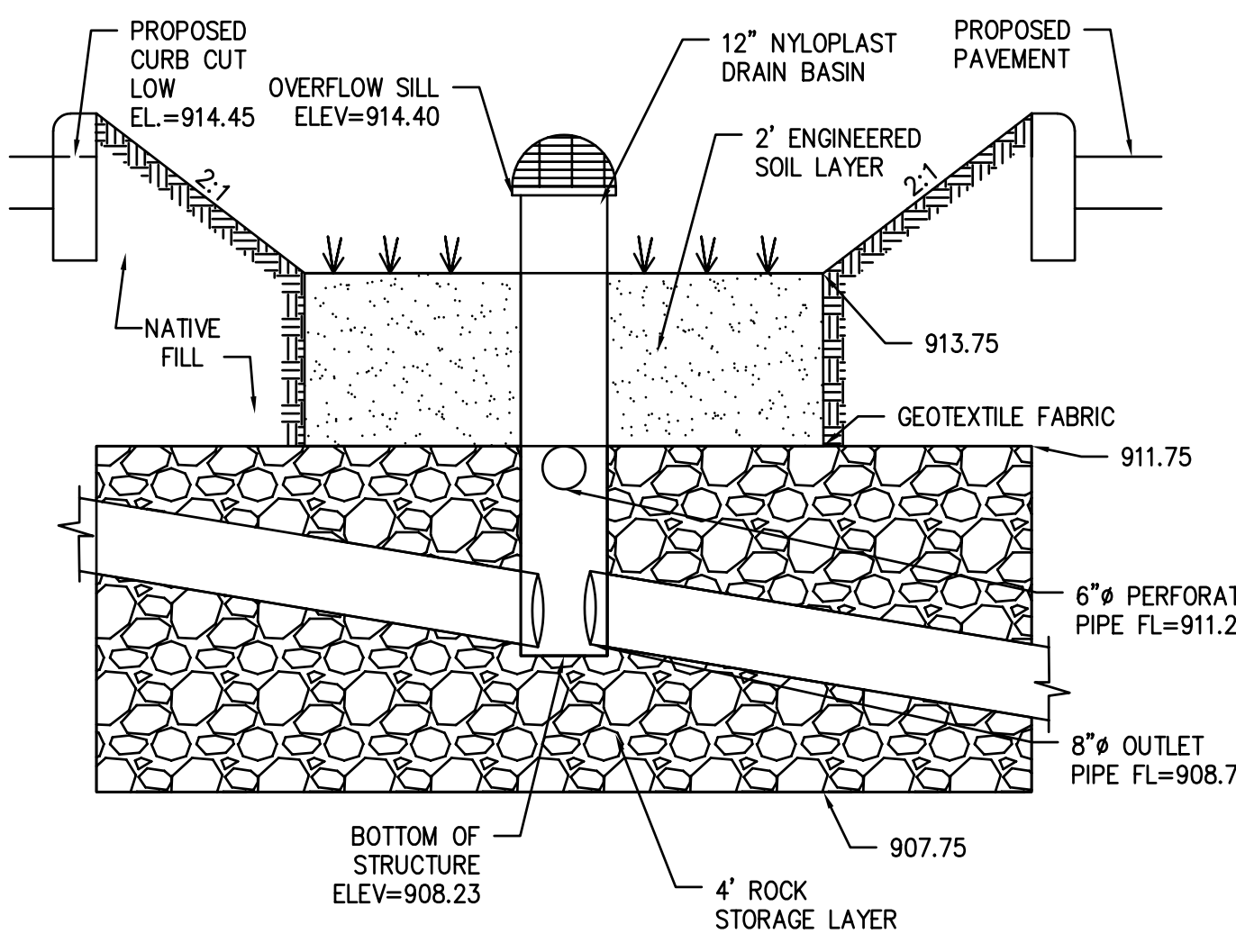
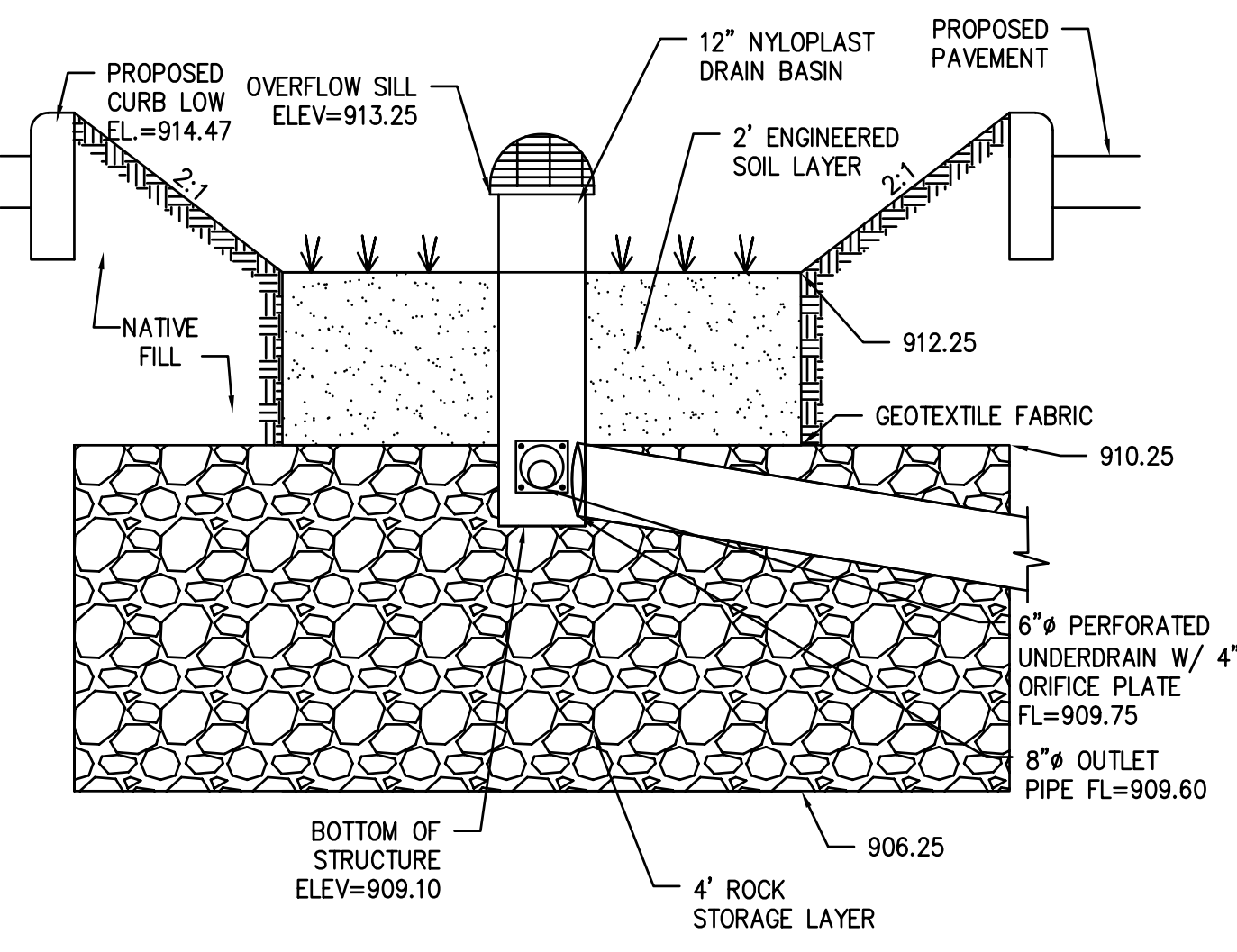
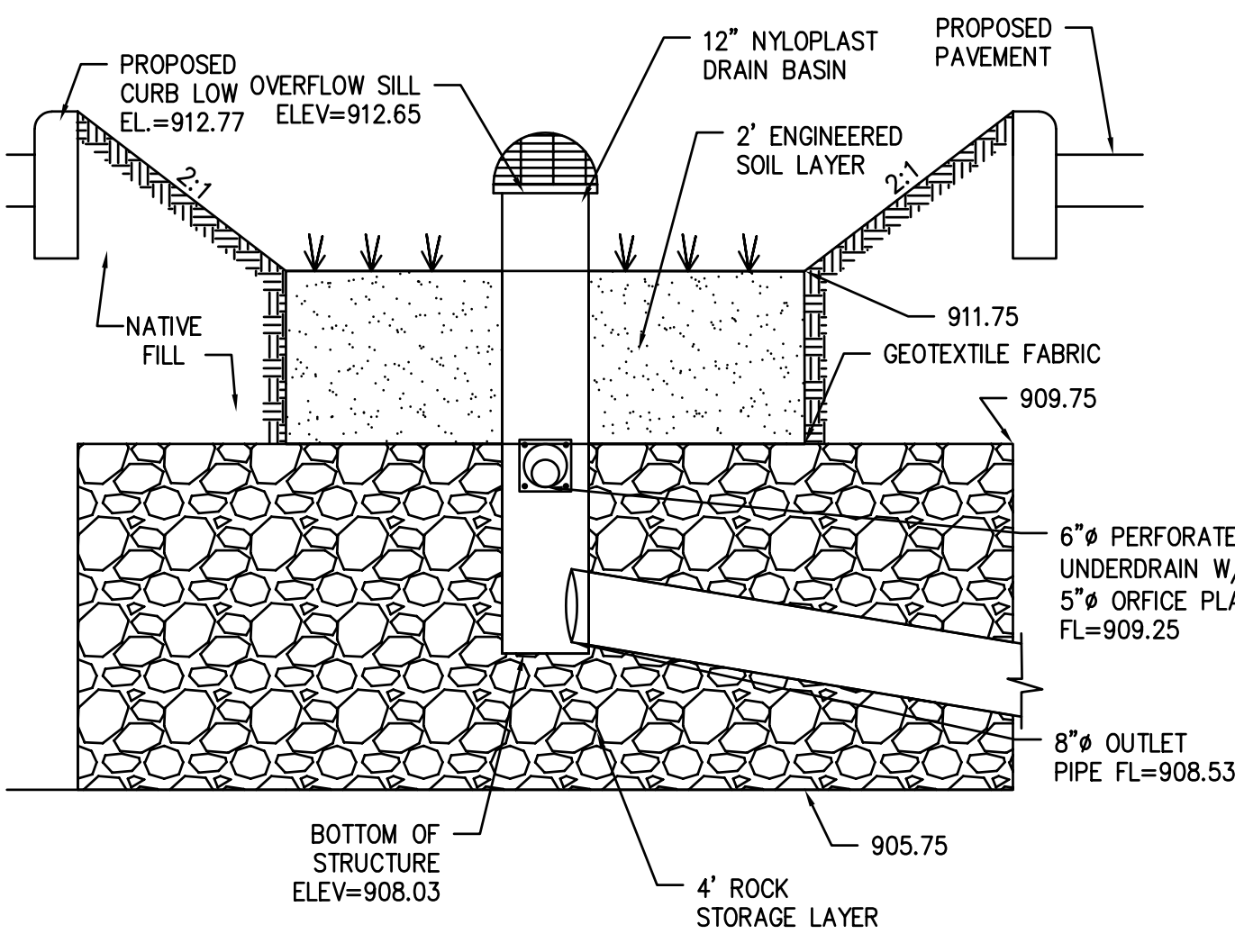
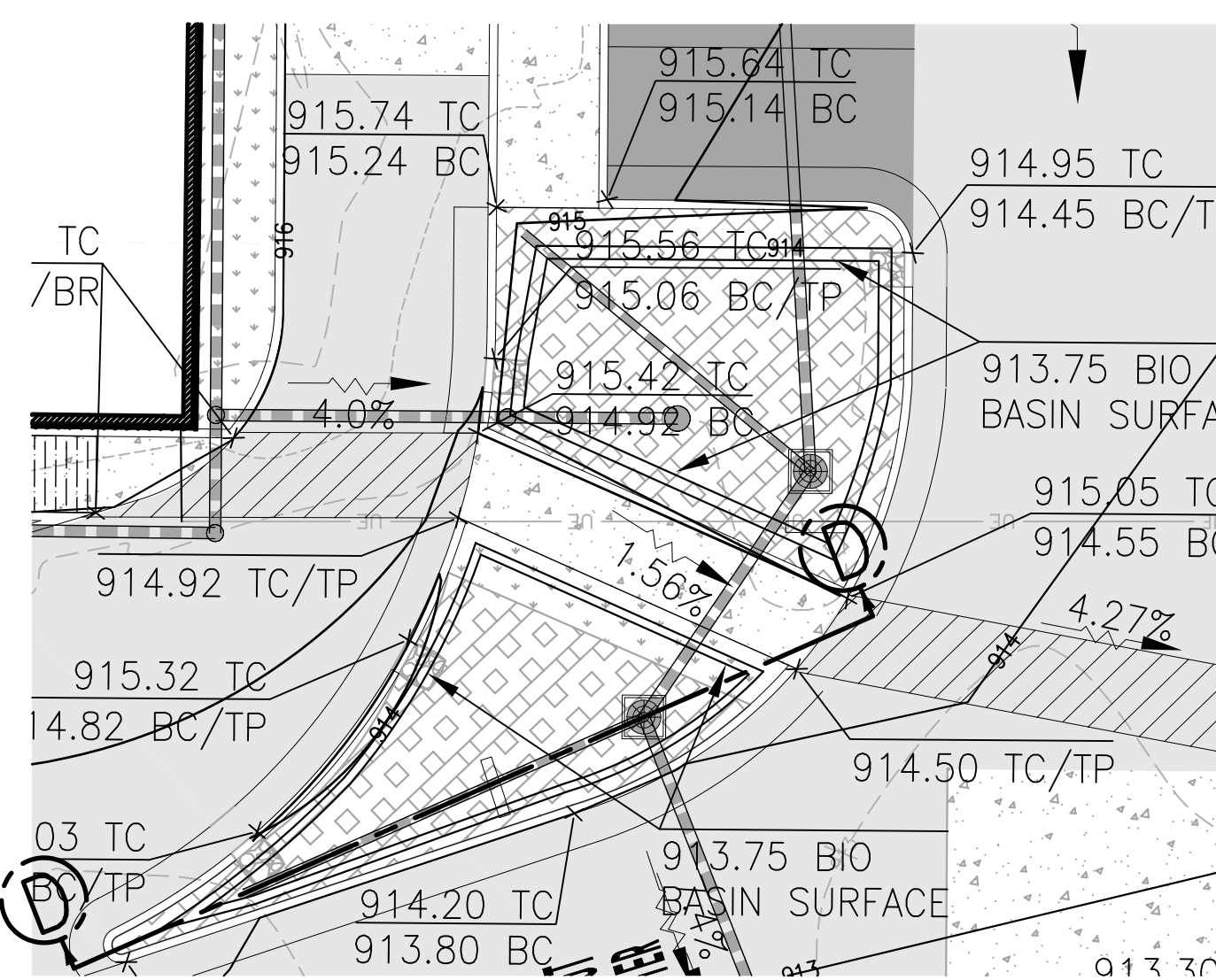
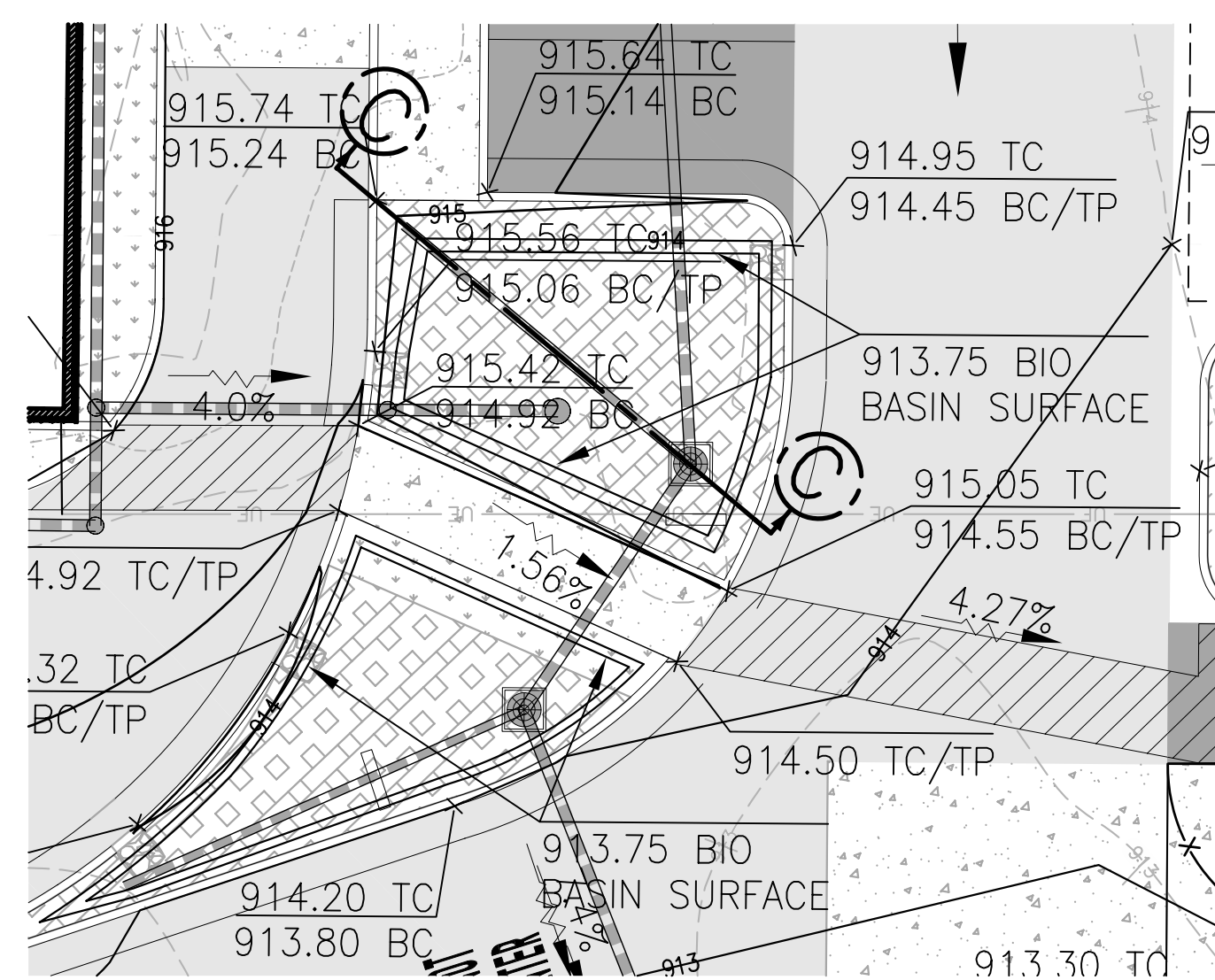
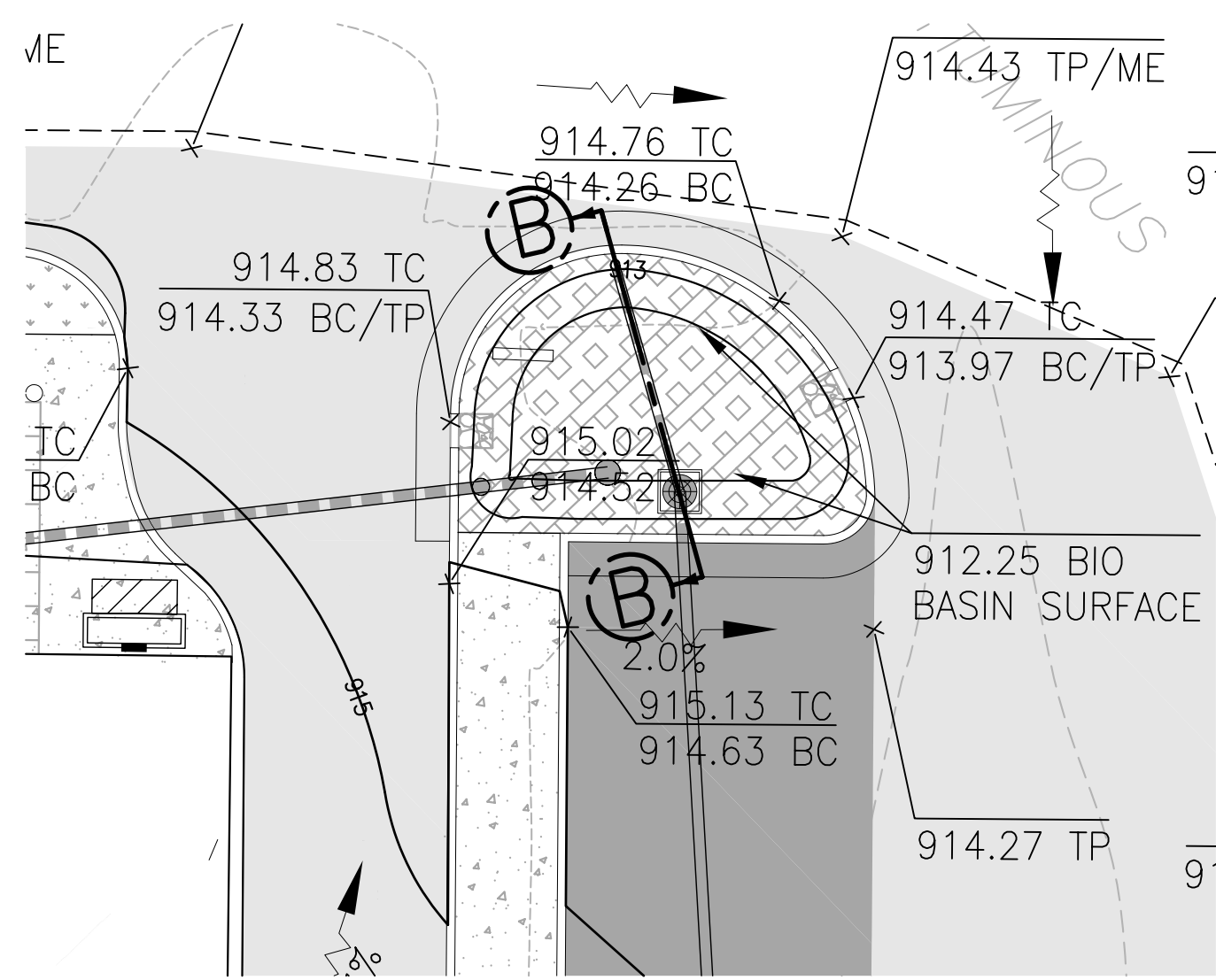
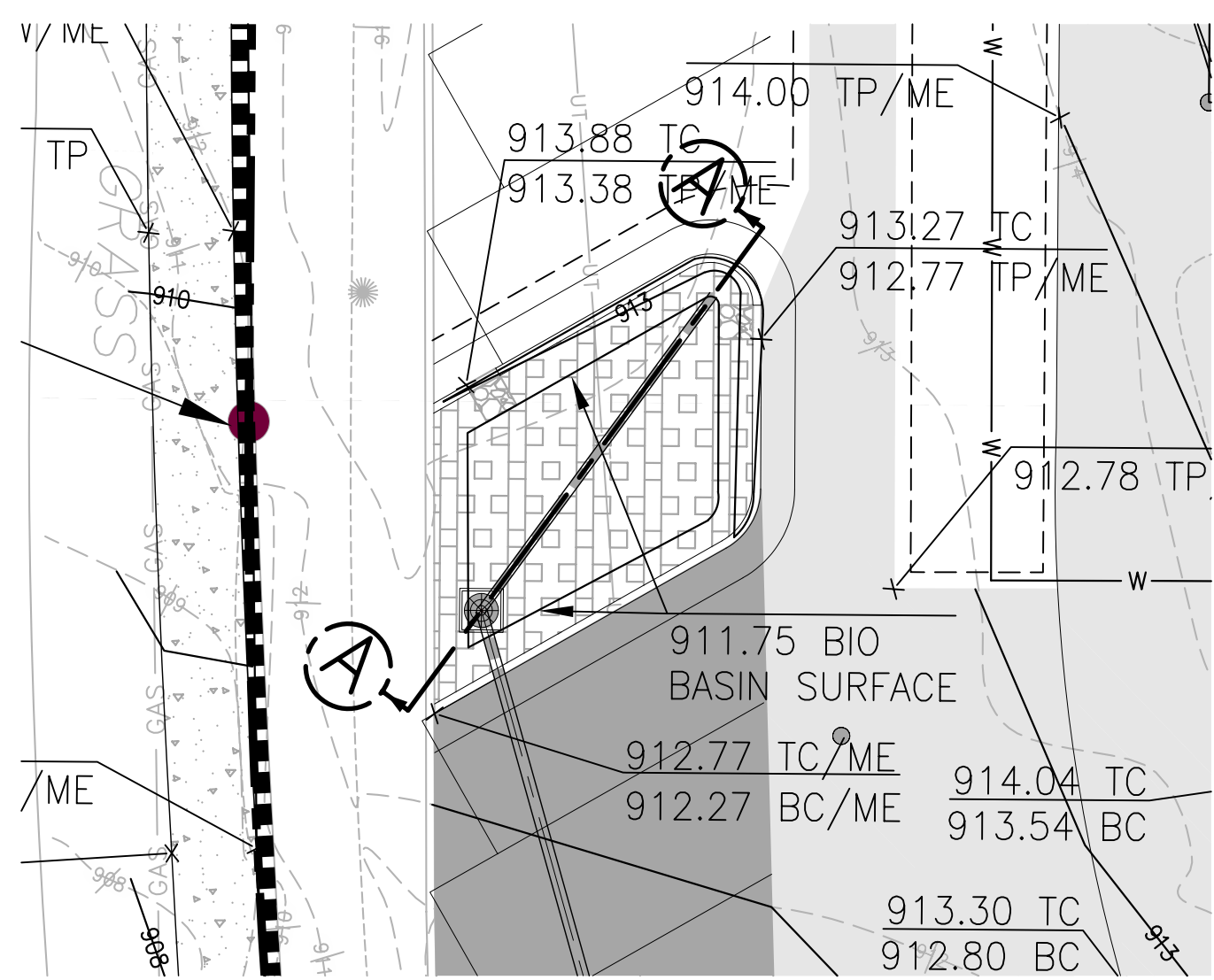

A-A BIORETENTION BASIN 1
SCALE: N.T.S. REF. DWG. C6.0

B-B BIORETENTION BASIN 2
SCALE: N.T.S. REF. DWG. C6.0

C-C BIORETENTION BASIN 3
SCALE: N.T.S. REF. DWG. C6.0

D-D BIORETENTION BASIN 4
SCALE: N.T.S. REF. DWG. C6.0

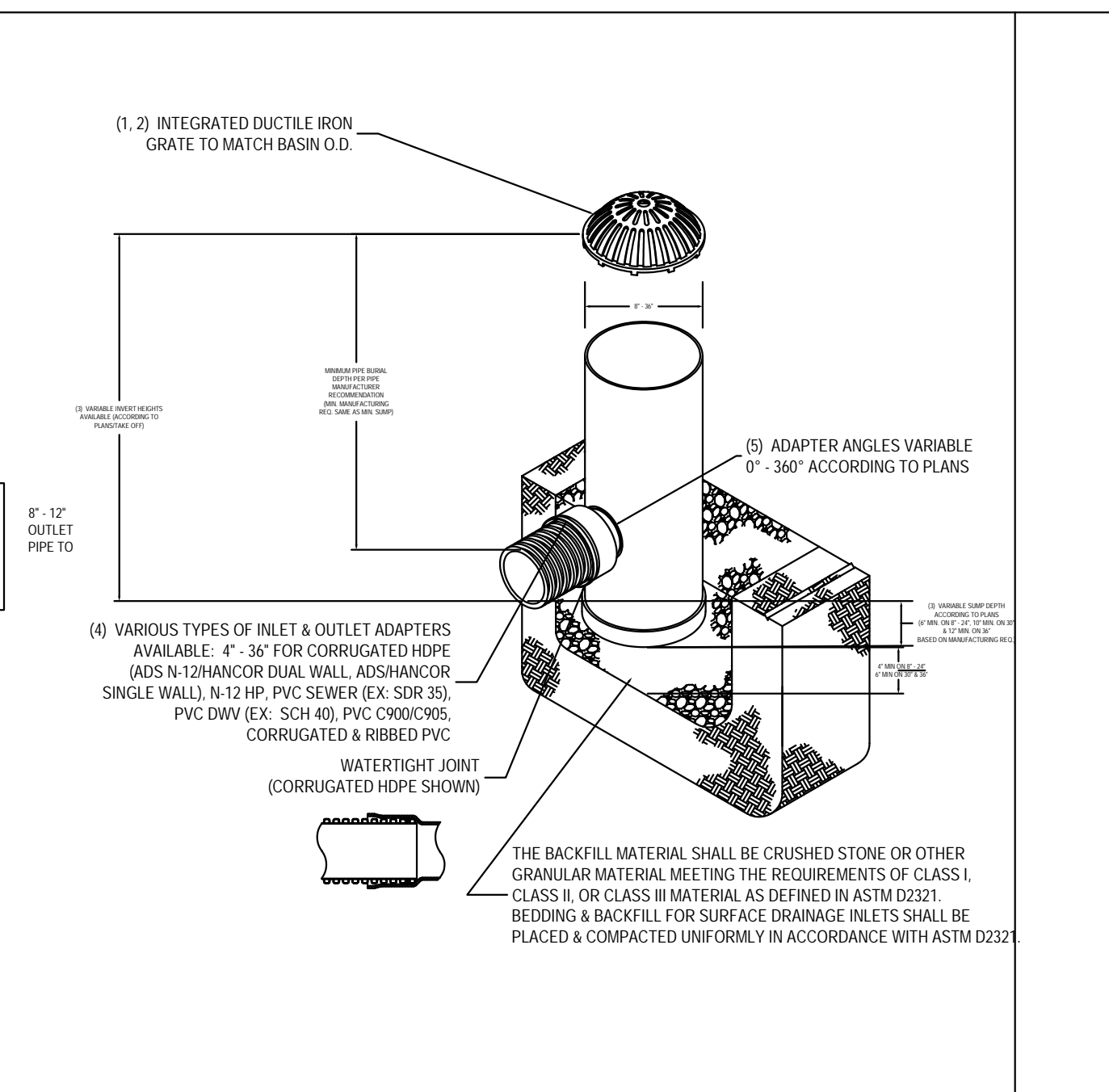
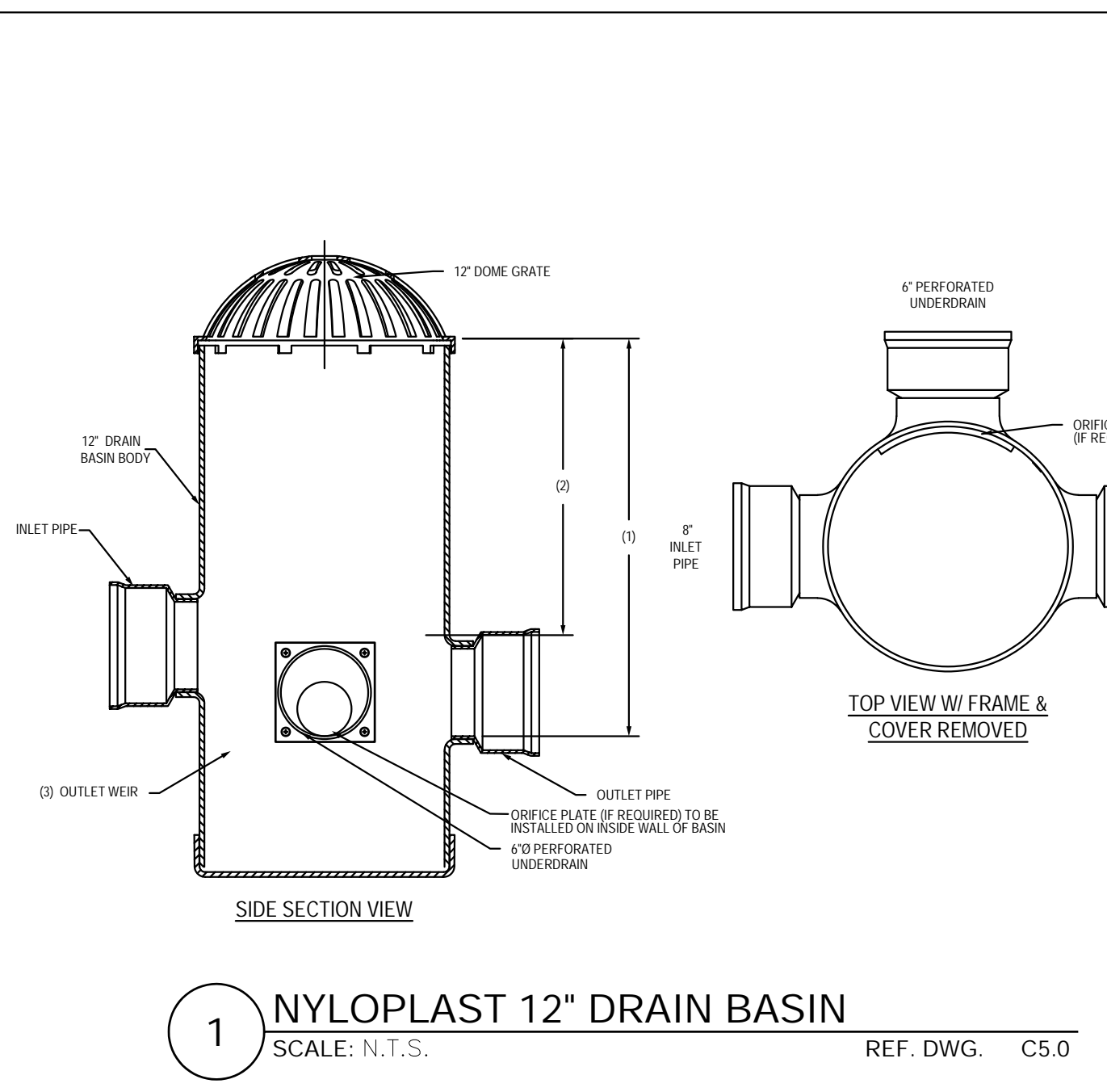

1 NYLOPLAST 12" DRAIN BASIN
SCALE: N.T.S. REF. DWG. C5.0

2 TWO GRATE INLET DETAIL
SCALE: N.T.S. REF. DWG. C6.0

BIORETENTION NOTES:

1. RECOMMENDED ENGINEERED SOIL PLANTING DEPTH IS 24.0". SHALLOWER PLANTING DEPTH IS ALLOWED WHEN SITE CONDITIONS ARE LIMITED. SOIL PLANTING DEPTH SHALL BE MINIMUM OF 18.0"
2. GEOTEXTILE FILTER FABRIC TO BE PLACED OVER PERFORATED DRAIN PIPE
3. GRAVEL/SAND STORAGE LAYER TO BE MAXIMUM OF 48.0" BELOW PERFORATED UNDER-DRAIN PIPE.
4. ALL UNDERDRAIN PIPES TO HAVE GEOTEXTILE SLEEVE.
5. ORIFICE PLATES TO BE ATTACHED TO INSIDE WALL OF DRAIN BASIN INLINE WITH UNDERDRAIN CONNECTION
6. ROCK STORAGE LAYER TO EXTEND HORIZONTALLY TO ISLAND'S BACK OF CURB LINE.

SCALE FOR PLAN VIEW ONLY
SCALE: 1" = 10' (22" X 34")
1" = 20' (11" X 17")

NO	REVISION DESCRIPTION	DATE
1 <td>PER CITY COMMENTS</td> <td>11/24/21</td>	PER CITY COMMENTS	11/24/21
2 <td>PER CITY COMMENTS</td> <td>12/09/21</td>	PER CITY COMMENTS	12/09/21
3 <td>PER CITY COMMENTS</td> <td>12/09/21</td>	PER CITY COMMENTS	12/09/21
4 <td>REVISE SANITARY/DOWNSPOUTS</td> <td>4/6/22</td>	REVISE SANITARY/DOWNSPOUTS	4/6/22

DEVELOPER/OWNER:
PANERA LLC
3630 SOUTH GEYER ROAD SUITE 100
ST. LOUIS, MO 63127
(314) 984-0000

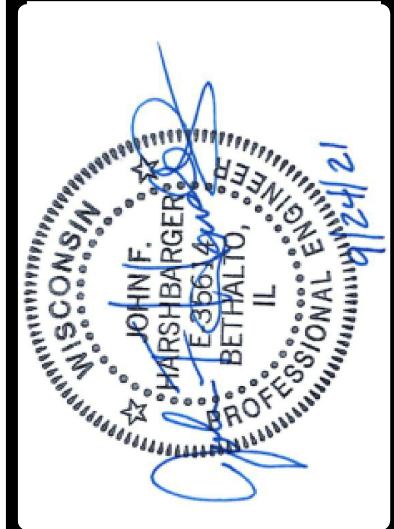

PANERA BAKERY CAFE #1551
2651 EAST SPRINGS DRIVE
MADISON, WI 53704

BIORETENTION DETAIL SHEET



DESIGN/CALC BY: LFD
DRAWN BY: LFD
CHECKED BY: AMG
DRAWING SCALE: AS SHOWN
DATE: 11/24/21
Job Number: 20-0003
Sheet Number: C8.3

USER: Paul Handerson TAB_C8.3.dwg
DRAWING: S:\Users\paulh\OneDrive\Documents\20-0003\CAD\1\C-Plan\PlusSheets\C-Plan_Bioreten_Detail_20-0003.dwg

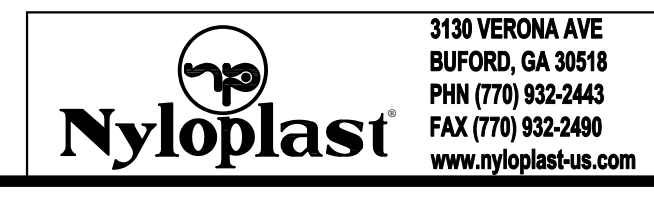

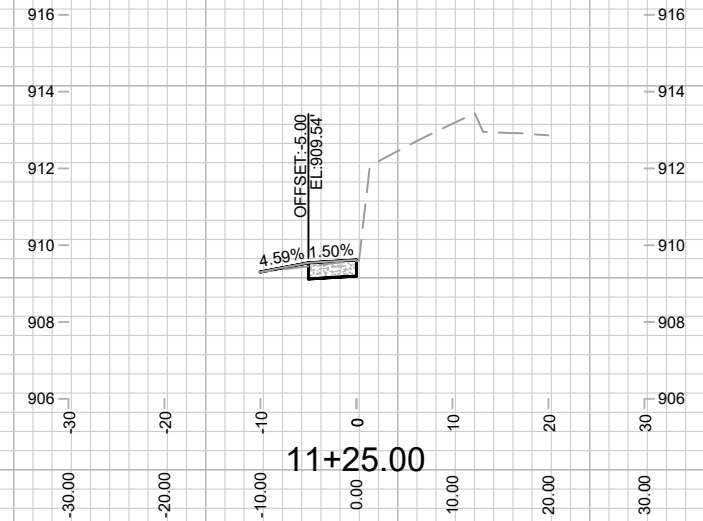
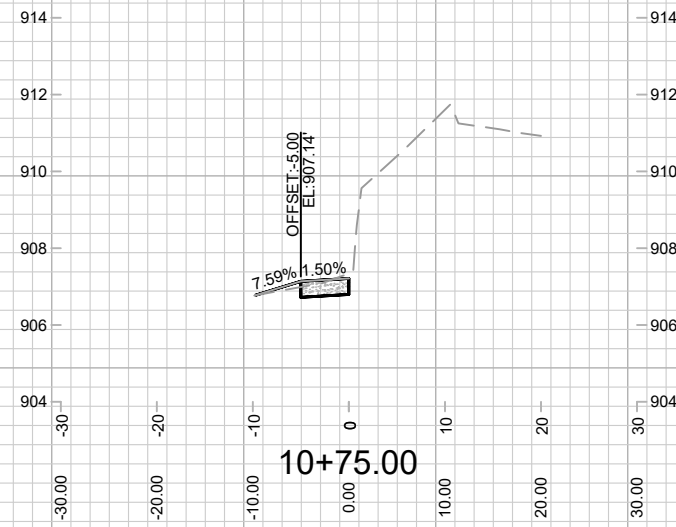
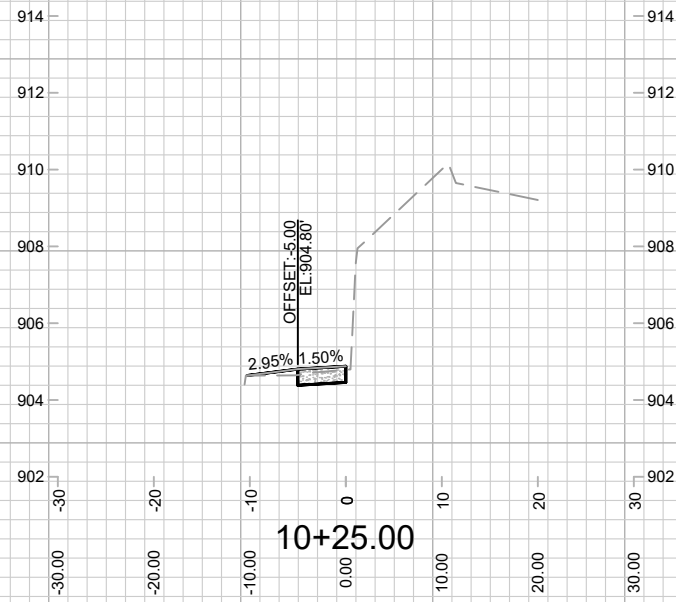
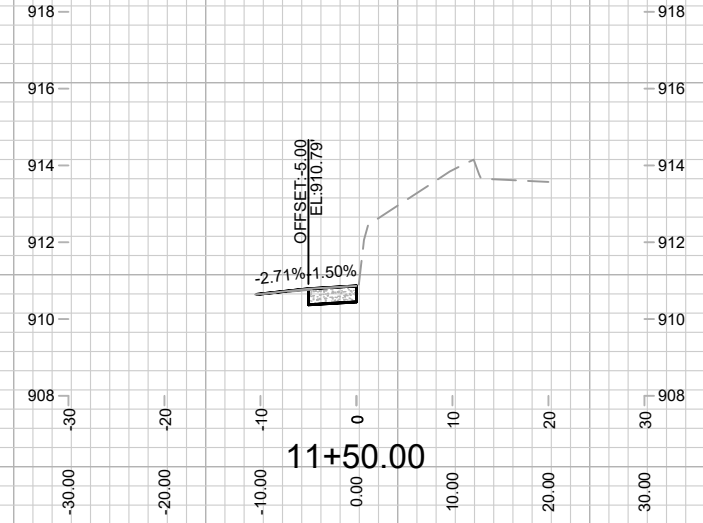
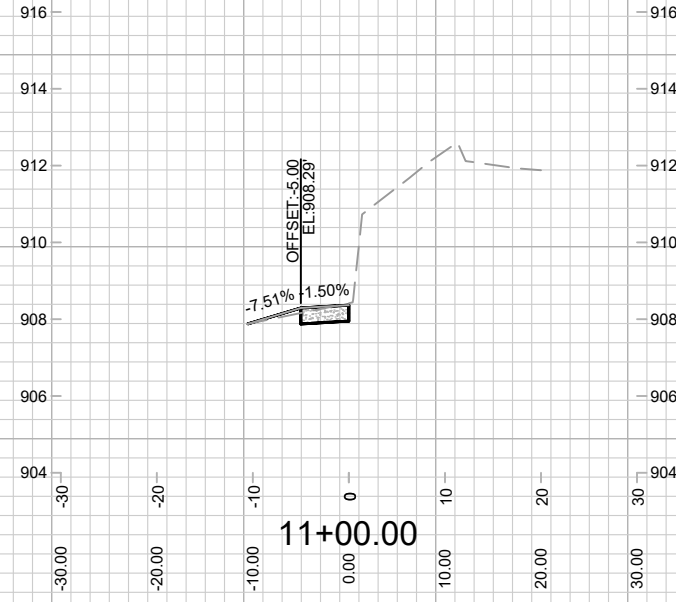
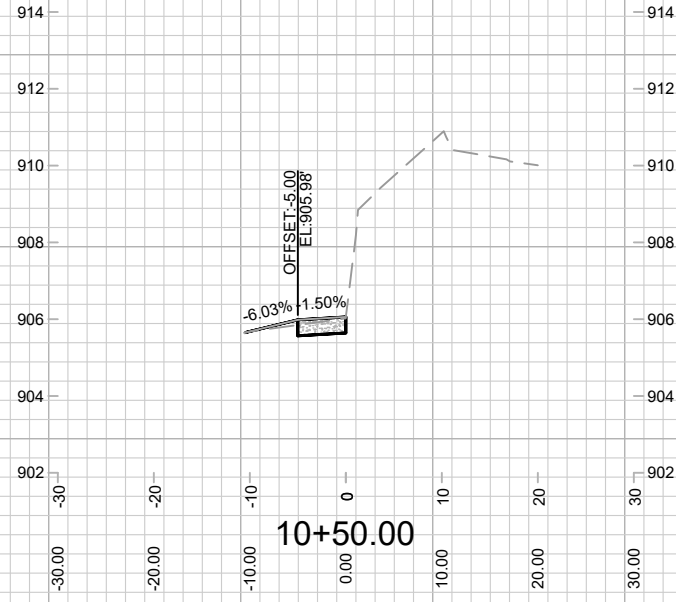

MARK	REVISION	DATE	BY
14045	6/6/2022 3:04 PM		
Designed By: DS		Scale: #####	
14045		X-1	

14045
MADISON, WI
9153
CONTRACT NO:

CROSS SECTIONS-EAST SPRINGS DRIVE
2651 EAST SPRINGS DRIVE
M:\DESIGN\Projects\14045\CAD\Streets\14045EN-AIIProf&Corridor_Setup.dwg



14045
X-1

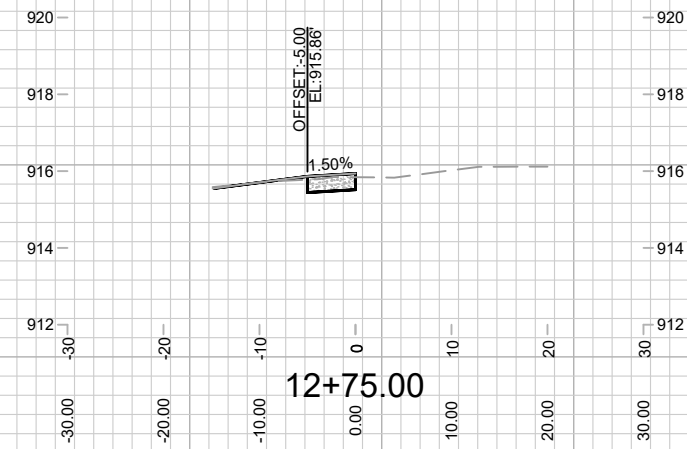
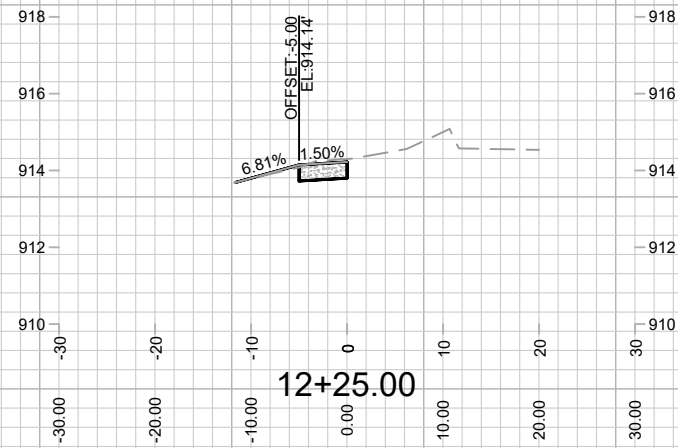
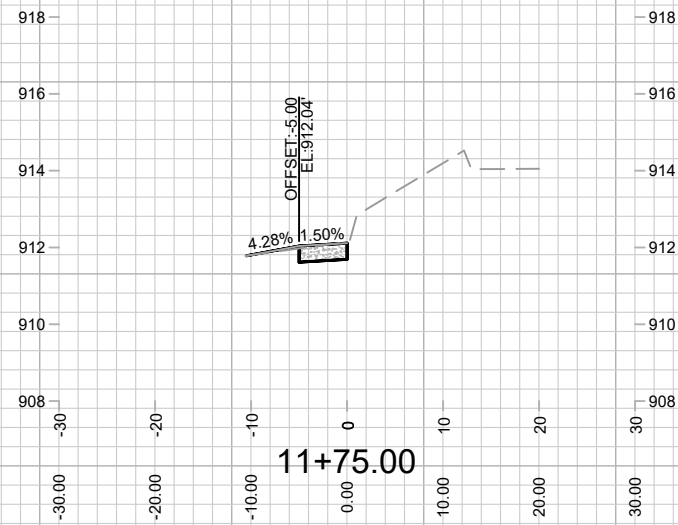
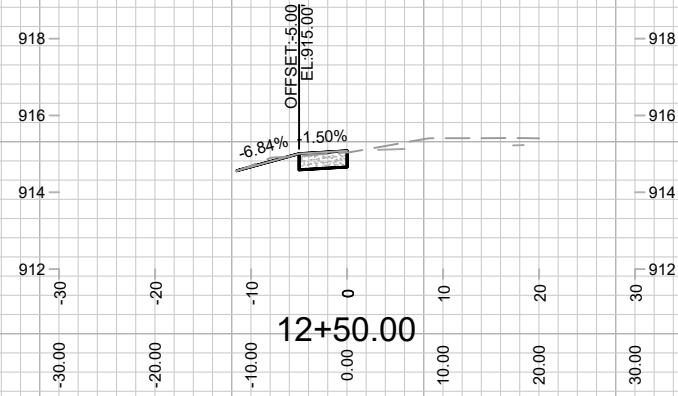
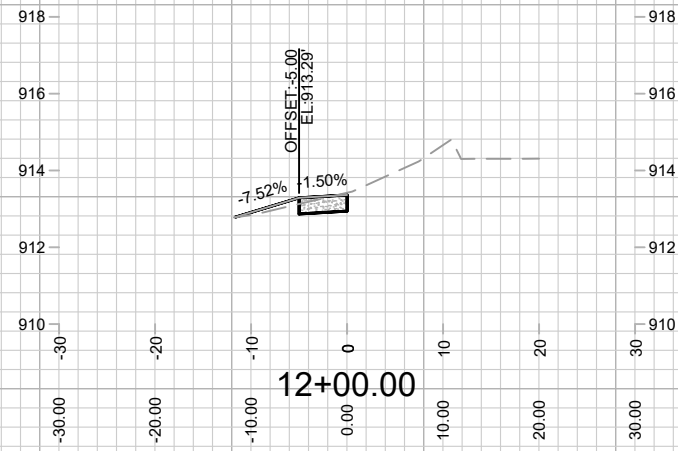

MARK	REVISION	DATE	BY
14045	14045	6/6/2022	2:06 PM

14045
MADISON, WI
9153
CONTRACT NO:

CROSS SECTIONS-EAST SPRINGS DRIVE
2651 EAST SPRINGS DRIVE
M:\DESIGN\Projects\14045\CAD\Streets\14045EN-AI\Prof&Corridor_Setup.dwg



14045
X-2

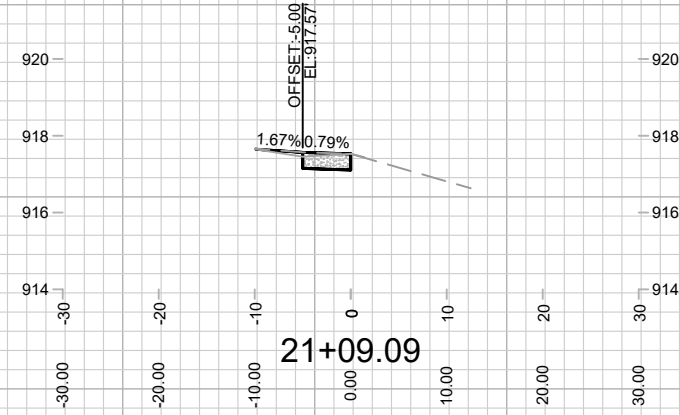
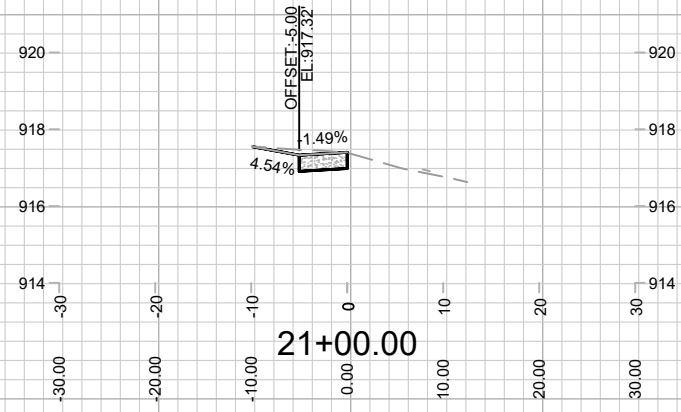

14045
X-3

CROSS SECTIONS-EAST WASHINGTON AVENUE

2651 EAST SPRINGS DRIVE

M:\DESIGN\Projects\14045\CAD\Streets\14045EN-AIP\Prof&Corridor_Setup.dwg

14045

MADISON, WI

9153

CONTRACT NO:

MARK	REVISION	DATE	BY
14045	14045	6/6/2022 2:07 PM	Scale: #####
			X-3