



Madison, Wisconsin

# CITY OF MADISON

## CITY ENGINEERING DIVISION

### DEPARTMENT OF PUBLIC WORKS

# PLAN OF PROPOSED IMPROVEMENT

PUBLIC IMPROVEMENT PROJECT  
APPROVED

MARCH 29, 2022

BY THE COMMON COUNCIL  
OF MADISON, WISCONSIN

PUBLIC IMPROVEMENT DESIGN  
APPROVED BY:

Oct 24, 2023

City Engineer

Date

#### INDEX OF SHEETS

SHEET NO. D1	GENERAL NOTES
SHEET NO. D2	TYPICAL SECTION
SHEET NO. P1-P2	SIDEWALK PLAN & PROFILE
SHEET NO. U1	UTILITY PLAN
SHEET NO. X1-X5	CROSS SECTIONS
NO MAINTENANCE PLAN REQUIRED	

## 1959 E MIFFLIN STREET

CITY PROJECT NO. 14047  
CONTRACT NO. 9158

STREET  
DESIGNED BY:



Oct 24, 2023

SANITARY SEWER  
DESIGNED BY:

LATERAL  
ONLY

WATER  
DESIGNED BY:

LATERAL  
ONLY

STORM SEWER  
DESIGNED BY:

LATERAL  
ONLY

PROJECT  
LOCATION

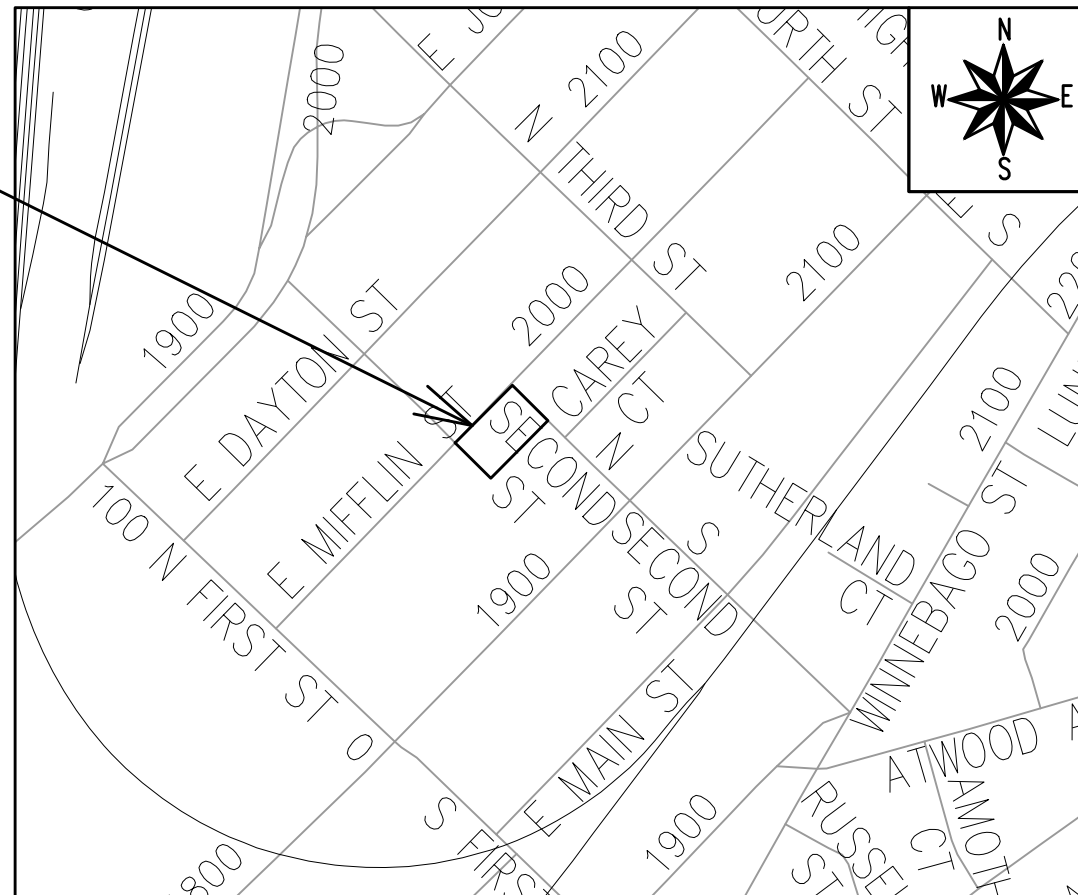

PLOT SCALE: 1:1\_XREF

PLOT NAME: ---

REV. DATE: 2/1/2023 1:56 PM

ORIGINATOR: CITY\_OF\_MADISON

REVISION #2 - 10/19/23 - IO  
- SHEET ADDED.

ALL PROPOSED STREET TREE REMOVALS WITHIN THE RIGHT OF WAY SHALL BE REVIEWED BY CITY FORESTRY BEFORE THE PLAN COMMISSION MEETING. STREET TREE REMOVALS REQUIRE APPROVAL AND A TREE REMOVAL PERMIT ISSUED BY CITY FORESTRY. ANY STREET TREE REMOVALS REQUESTED AFTER THE DEVELOPMENT PLANS ARE APPROVED BY THE PLAN COMMISSION OR THE BOARD OF PUBLIC WORKS AND CITY FORESTRY WILL REQUIRE A MINIMUM OF A 72-HOUR REVIEW PERIOD WHICH SHALL INCLUDE THE NOTIFICATION OF THE ALDERPERSON WITHIN WHO'S DISTRICT IS AFFECTED BY THE STREET TREE REMOVAL(S) PRIOR TO A TREE REMOVAL PERMIT BEING ISSUED.

AS DEFINED BY SECTION 107.13 OF THE CITY OF MADISON STANDARD SPECIFICATIONS FOR PUBLIC WORKS CONSTRUCTION, LATEST EDITION: NO EXCAVATION IS PERMITTED WITHIN 5 FEET OF THE TRUNK OF THE STREET TREE OR WHEN CUTTING ROOTS OVER 3 INCHES IN DIAMETER. IF EXCAVATION IS NECESSARY, THE CONTRACTOR SHALL CONTACT MADISON CITY FORESTRY (266-4816) PRIOR TO EXCAVATION. CITY OF MADISON FORESTRY PERSONNEL SHALL ASSESS THE IMPACT TO THE TREE AND TO ITS ROOT SYSTEM PRIOR TO WORK COMMENCING. TREE PROTECTION SPECIFICATIONS CAN BE FOUND ON THE FOLLOWING WEBSITE: [www.cityofmadison.com/engineering/developers-contractors/standard-specifications](http://www.cityofmadison.com/engineering/developers-contractors/standard-specifications)

THE LOCATION AND INFORMATION FOR PROPOSED NEW TREES, IN THE PUBLIC RIGHT OF WAY OR ON PUBLIC LANDS ARE APPROXIMATE AND ARE SHOWN FOR REFERENCE ONLY. THE LOCATIONS, SPECIFICATIONS AND PLANTING METHODS OF ALL PROPOSED NEW OR REPLACEMENT TREES IN THE PUBLIC RIGHT OF WAY OR ON PUBLIC LANDS SHALL BE APPROVED BY THE CITY FORESTER PRIOR TO INSTALLATION.

NO TREES IN THE RIGHT OF WAY OR ON PUBLIC LANDS SHALL BE TRIMMED, PRUNED, REMOVED OR ADVERSELY AFFECTED IN ANY WAY UNTIL THE DEVELOPER HAS RECEIVED WRITTEN PERMISSION FROM THE CITY ENGINEER OR CITY FORESTER. SAID WRITTEN PERMISSION SHALL INCLUDE LANGUAGE INDICATING THAT SECTION 10.101 OF THE MADISON GENERAL ORDINANCES AND ADMINISTRATIVE PROCEDURE MEMORANDUM NO. 6-2, REFERRING TO NOTIFICATION OF PROPERTY OCCUPANTS AND/OR OWNERS, HAS BEEN COMPLIED WITH.

DEVELOPER MUST SUBMIT A TRAFFIC CONTROL PLAN TO CITY TRAFFIC ENGINEERING AT LEAST 14 DAYS PRIOR TO THE START OF WORK. WORK SHALL NOT PROCEED UNTIL AN APPROVED TRAFFIC CONTROL PLAN IS IN PLACE.

CONTACT THE PROJECT ENGINEER AND DESIGNER, IKE OKAFOR, AT IOKAFOR@CITYOFMADISON.COM FOR CAD FILES AND ALIGNMENT DATA PRIOR TO STAKING.

UNDERDRAINS SHALL BE INSTALLED PER STANDARD DETAIL DRAWING 4.05 FOR 75' ON EACH SIDE OF THE LOW POINT, OR TO THE NEAREST CURB HIGH POINT. ALL UNDERDRAIN SHALL BE WRAPPED.

ALL GUTTERS SHALL DRAIN WITH A MINIMUM GRADE OF 0.5% TOWARD STORM SEWER INLETS.

ALL DITCHES SHALL DRAIN WITH A MINIMUM GRADE OF 0.5%

THE CROSS SLOPE OF SIDEWALKS AND BARRIER FREE SIDEWALK CURB RAMPS SHALL TYPICALLY BE 1.5%. THE LONGITUDINAL GRADE OF BARRIER FREE SIDEWALK CURB RAMPS SHALL NOT EXCEED 8.33%. ALL SIDEWALK RAMPS SHALL BE CONSTRUCTED ACCORDING TO S.D.D. 3.04. AT ALL OTHER LOCATIONS THE LONGITUDINAL GRADE OF SIDEWALKS SHALL NOT EXCEED 5.0 % OR THE ADJACENT STREET GRADE WHICHEVER IS GREATER NOR BE LESS THAN 0.5% AND SHALL DRAIN TOWARD STORM SEWER INLETS. SIDE SLOPES WITHIN TEN FEET OF A PUBLIC SIDEWALK SHALL NOT EXCEED 4:1. ALL SIDEWALK AND SIDEWALK RAMP ELEVATIONS AND GRADES SHALL BE FIELD VERIFIED AND SET TO COMPLY WITH THE CITY OF MADISON STANDARD SPECIFICATIONS AND THE A.D.A. GUIDELINES.

CURB STATION AND OFFSETS SHALL BE TO THE EDGE OF PAVEMENT UNLESS OTHERWISE INDICATED. CURB ELEVATIONS SHALL BE TO THE EDGE OF PAVEMENT UNLESS OTHERWISE INDICATED.

POWER POLES AND OTHER OBSTRUCTIONS SHALL BE MOVED TO PROVIDE 2 FEET MINIMUM OF CLEAR DISTANCE FROM ANY FACE OF CURB OR EDGE OF SIDEWALK UNLESS OTHERWISE INDICATED ON THE PLANS.

ANY INFORMATION SHOWN ON THIS PLAN, WHICH IS NOT PART OF THIS RIGHT-OF-WAY PROJECT, IS PRELIMINARY AND NOT FOR CONSTRUCTION.

THERE MAY BE EXISTING UTILITIES OR OTHER FEATURES WHICH ARE EITHER NOT SHOWN OR SHOWN INCORRECTLY ON THIS PLAN. IT IS THE RESPONSIBILITY OF THE DEVELOPER TO LOCATE AND IDENTIFY ALL UTILITIES AND TOPOGRAPHY WHICH MAY AFFECT THE CONSTRUCTION OF THESE IMPROVEMENTS.

ALL PERMANENT SIGNING AND POSTING WILL BE DETERMINED AND PROVIDED BY THE TRAFFIC ENGINEERING DIVISION, FOLLOWING CONSTRUCTION OF THESE IMPROVEMENTS.

THE DEVELOPER SHALL PROVIDE, INSTALL AND MAINTAIN ALL STREET END BARRICADES, SIGNING AND TRAFFIC CONTROL, AS REQUIRED BY THE CITY TRAFFIC ENGINEER.

PAVEMENT SAWCUTS SHALL BE AS DIRECTED BY THE CITY CONSTRUCTION ENGINEER. SAWCUTS SHOWN ON THE PLAN ARE APPROXIMATE.

CURB ON CUL DE SACS SHALL BE INSTALLED ACCORDING TO S.D.D 3.05.



ALL WORK IN THE RIGHT OF WAY AND PUBLIC EASEMENTS SHALL BE IN ACCORDANCE WITH THE CITY OF MADISON STANDARD SPECIFICATIONS FOR PUBLIC WORKS CONSTRUCTION, LATEST EDITION.

ALL PROPOSED IMPROVEMENTS IN THE RIGHT-OF-WAY ARE BASED ON SURVEY DATA PROVIDED BY THE DEVELOPER OR ITS CONSULTANT. IN THE CASE THAT THE PROPOSED IMPROVEMENTS CAN NOT BE INSTALLED PER THESE PLANS OR THE CITY OF MADISON STANDARD SPECIFICATION FOR PUBLIC WORKS CONSTRUCTION, LATEST EDITION, THE DEVELOPER SHALL BE RESPONSIBLE FOR THE COST OF EXTRA WORK DUE TO INACCURACIES OF THE SURVEY.

ALL UTILITY VERIFICATIONS AND ACCURACY OF THE DRAWINGS ARE THE RESPONSIBILITY OF THE DEVELOPER. ANY CONFLICTS THAT ARISE FROM MISSING OR ERRONEOUS INFORMATION WILL BE AT THE EXPENSE OF THE DEVELOPER. NO PRECAST STRUCTURES WILL BE APPROVED FOR STORM OR SANITARY SEWER UNTIL ALL POTENTIAL UTILITY CONFLICTS ARE RESOLVED.

IN LOCATIONS WHERE PAVEMENT RESTORATION IS NOT IDENTIFIED ADJACENT TO CURB AND GUTTER REPLACEMENT, IT IS ASSUMED THAT CURB AND GUTTER WILL BE REPLACED WITHOUT DAMAGING ADJACENT PAVEMENT. IF DAMAGED, THE MILL AND OVERLAY LIMITS SHALL BE EXTENDED BY THE CITY CONSTRUCTION ENGINEER AS NECESSARY TO MEET THE STANDARD PATCHING CRITERIA.

**CONVENTIONAL SIGNS**  
*FIELD VERIFY ALL UTILITY LOCATIONS*

<i>GAS</i>	—— G ——
<i>STORM SEWER</i>	—— ST ——
<i>SANITARY SEWER</i>	—— SAN ——
<i>WATER</i>	—— W ——
<i>BURIED ELECTRIC</i>	—— E ——
<i>OVERHEAD ELECTRIC</i>	—— OH ——
<i>POWER POLE</i>	
<i>ADA COMPLIANT RAMP W/ DETECTABLE WARNING FIELD</i>	
<i>COMBUSTIBLE FLUIDS</i>	

MARK	DATE
DESIGNED BY: IO	DATE: 10/25/2023 2:33 PM
14047	D-1

14047  
MADISON, WI  
1959 E MIFFLIN STREET - THE AVENUE  
M:\DESIGN\Projects\14047\CAD\Streets\14047\EN-Details.dwg



14047  
D-1

REVISION #2 - 10/19/23 - IO  
- SHEET ADDED.

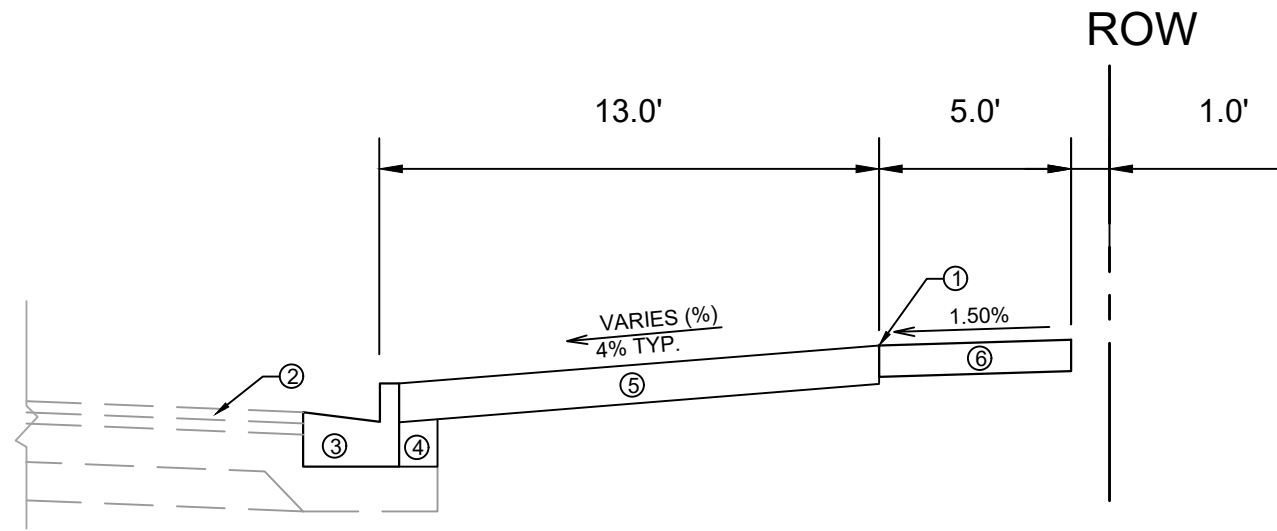

**TYPICAL SECTION**  
E MIFFLIN STREET

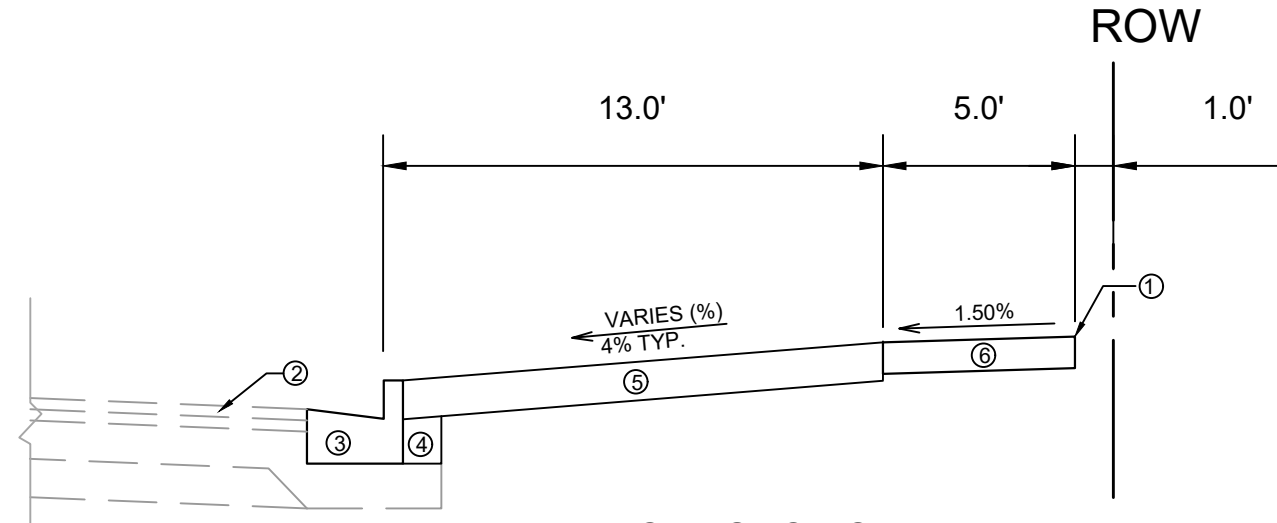

**TYPICAL SECTION**  
N SECOND STREET  
STA 50+50 - STA 51+65

- ① POINT REFERRED TO ON PROFILE
- ② EXISTING PAVEMENT TO REMAIN.
- ③ CONCRETE CURB AND GUTTER TYPE 'A' TO REMAIN.\*
- ④ FILL
- ⑤ 6" TOPSOIL, SEED AND MATTING
- ⑥ 5" CONCRETE SIDEWALK

**SPECIAL NOTES:**

\* SPOT REPLACEMENTS AS SHOWN IN PLAN SHEETS. SPOT REPLACEMENT SHALL ALSO BE REQUIRED WHERE EXISTING CURB IS DAMAGED DURING CONSTRUCTION.

MARK	REVISION	DATE	BY
14047			
Designed By: IO	Date: 10/31/2023 9:16 AM	Scale:	D-2

14047  
MADISON, WI  
CONTRACT NO: 9158  
M:\DESIGN\Projects\14047\CAD\Streets\14047EN-Details.dwg



14047  
D-2

REVISION #2 - 10/19/23 - IO  
- SHEET ADDED.

BLOCK 311 LOT 14  
BLOCK 317 LOT 26 LOT 25 LOT 24 LOT 23

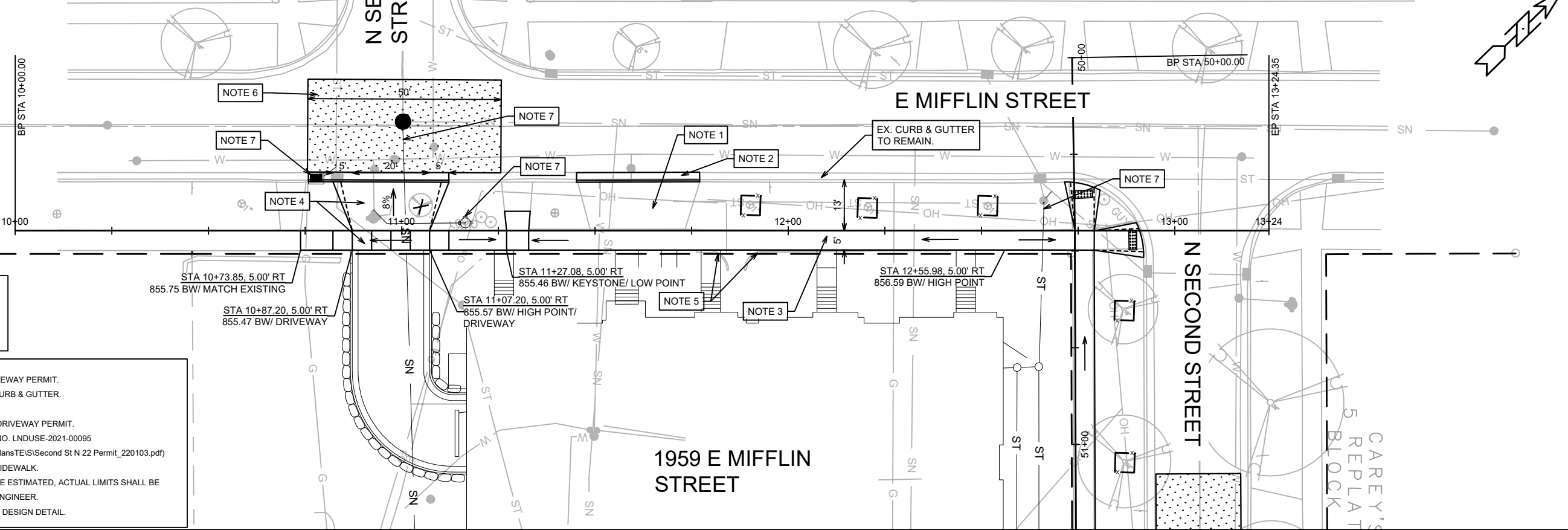

**LEGEND**

- SIDEWALK DRAINAGE PATH
- 2" MILL & OVERLAY (4 LT 58-28 S)
- TREE PROTECTION FENCING
- CLEAR & GRUB

- NOTE**
1. REMOVE EXISTING DRIVEWAY PER DRIVEWAY PERMIT.
  2. REMOVE AND REPLACE WITH TYPE 'A' CURB & GUTTER.
  3. 5" CONCRETE SIDEWALK.
  4. 7" DRIVEWAY APRON & SIDEWALK PER DRIVEWAY PERMIT.  
(SEE COMMERCIAL DRIVEWAY PERMIT NO. LNDUSE-2021-00095  
M:\DESIGN\Traffic\Maps\_Plans\ParkingLotPlans\T\ES\Second St N 22 Permit\_220103.pdf)
  5. REMOVE EXISTING CURB AT BACK OF SIDEWALK.
  6. LIMITS SHOWN FOR MILL & OVERLAY ARE ESTIMATED, ACTUAL LIMITS SHALL BE DETERMINED BY THE CONSTRUCTION ENGINEER.
  7. SEE SHEET U-1 FOR PROPOSED UTILITY DESIGN DETAIL.

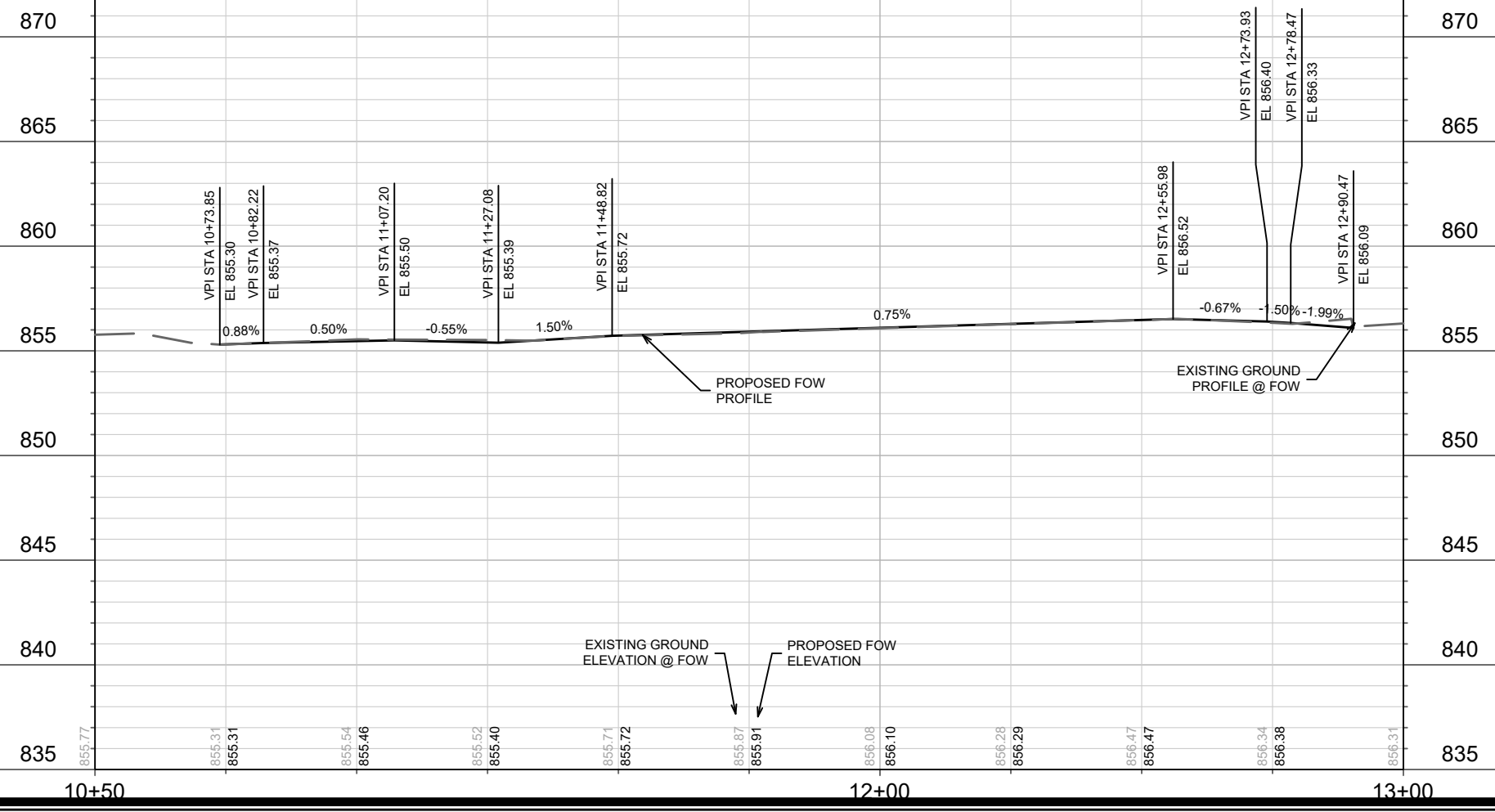

MARK	REVISION	DATE	BY
14047		10/24/2023 9:34 AM	P-1

14047  
MADISON, WI  
CONTRACT NO: 9158

SIDEWALK PLAN & PROFILE - E MIFFLIN STREET  
1959 E MIFFLIN STREET - THE AVENUE  
M:\DESIGN\Projects\14047\CAD\Streets\14047EN-PrP.dwg

14047  
P-1

REVISION #2 - 10/19/23 - IO  
- SHEET ADDED.

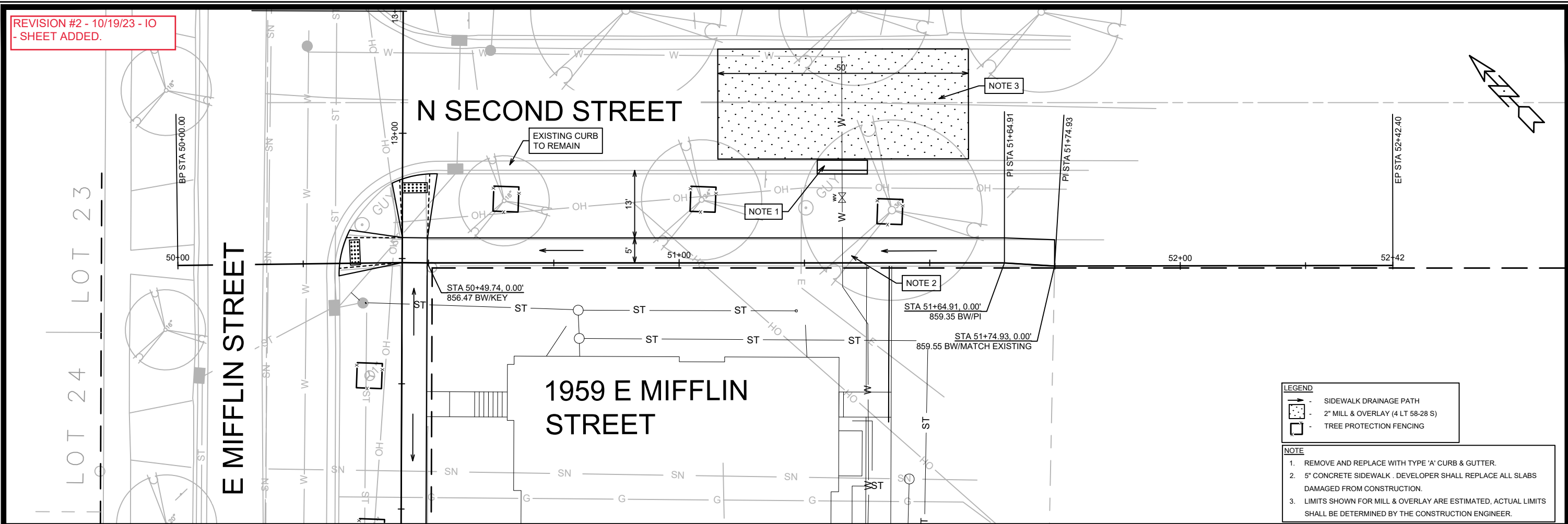

**LEGEND**

- SIDEWALK DRAINAGE PATH
- 2" MILL & OVERLAY (4 LT 58-28 S)
- TREE PROTECTION FENCING

- NOTE**
1. REMOVE AND REPLACE WITH TYPE 'A' CURB & GUTTER.
  2. 5" CONCRETE SIDEWALK . DEVELOPER SHALL REPLACE ALL SLABS DAMAGED FROM CONSTRUCTION.
  3. LIMITS SHOWN FOR MILL & OVERLAY ARE ESTIMATED, ACTUAL LIMITS SHALL BE DETERMINED BY THE CONSTRUCTION ENGINEER.

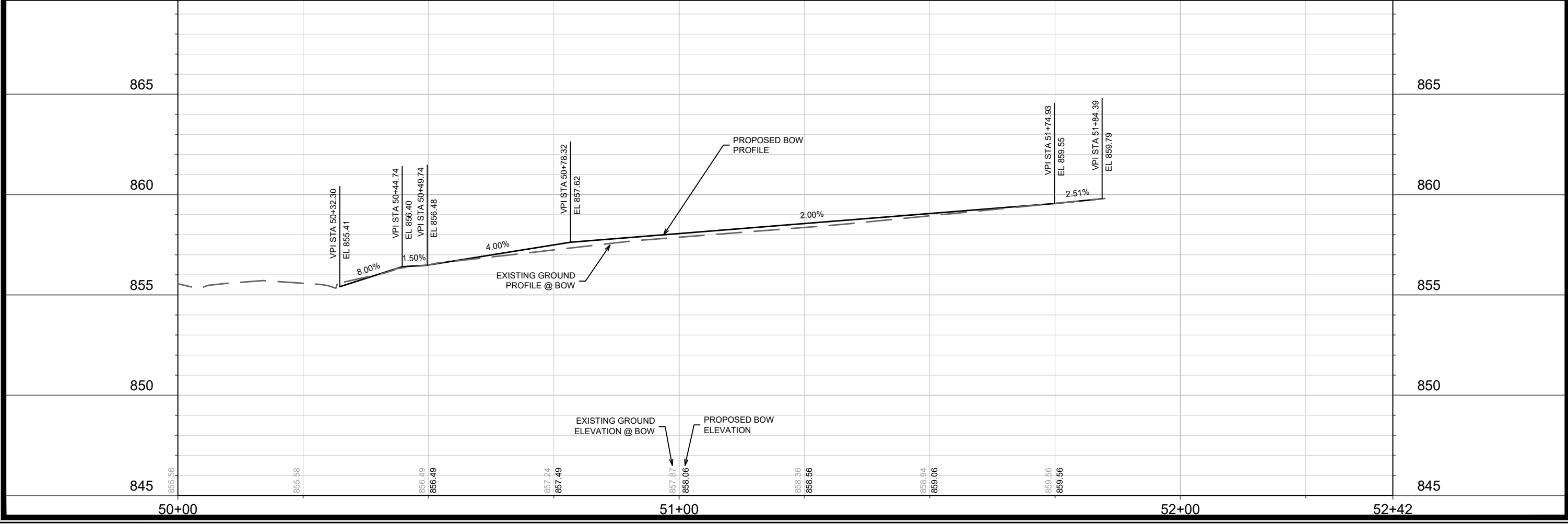

DATE	BY
REVISION	
Designed By: IO	Date: 10/19/2023 3:09 PM
14047	Scale: 1/20
P-2	

14047  
MADISON, WI  
CONTRACT NO: 9158

SIDEWALK PLAN & PROFILE - N SECOND STREET  
1959 E MIFFLIN STREET - THE AVENUE  
M:\DESIGN\Projects\14047\CAD\Streets\14047\EN-PnP.dwg

14047  
P-2



APPROVALS	DATE
PROJECT ENGINEER	DATE
DRH	DATE
DRH	DATE
CHECKED BY	DATE
DATE	DATE

**THE AVENUE EXPANSION**  
1959 E MIFFLIN ST  
MADISON, WI 53704  
**MADISON DEVELOPMENT CORPORATION**  
550 W WASHINGTON AVE  
MADISON, WI 53703

PROJECT #: BSE2055-21  
PLOT DATE: 03/22/2023  
REVISION DATES:  
03/22/2023

ISSUE DATES:  
12/29/2022  
03/22/2023

UTILITY PLAN

This document contains confidential or proprietary information of Burse Surveying and Engineering, Inc. Neither the document nor the information herein is to be reproduced, distributed, used or disclosed in any way or in part, except as specifically authorized by Burse Surveying and Engineering, Inc.

DRAWING NUMBER

**U-1**

Printed: Mar 22, 2023 - 4:07pm Printed By: Peter

M:\BSE2055\2021.dwg Engineering\BSE2055 Eng.dwg

**FORESTRY:**

- ALL PROPOSED STREET TREE REMOVALS WITHIN THE RIGHT OF WAY SHALL BE REVIEWED BY CITY FORESTRY BEFORE THE PLAN COMMISSION MEETING. STREET TREE REMOVALS REQUIRE APPROVAL AND A TREE REMOVAL PERMIT ISSUED BY CITY FORESTRY. ANY STREET TREE REMOVALS REQUESTED AFTER THE DEVELOPMENT PLAN IS APPROVED BY THE PLAN COMMISSION OR THE BOARD OF PUBLIC WORKS AND CITY FORESTRY WILL REQUIRE A MINIMUM OF A 72-HOUR REVIEW PERIOD WHICH SHALL INCLUDE THE NOTIFICATION OF THE ALDERPERSON WITHIN WHOSE DISTRICT IS AFFECTED BY THE TREE REMOVAL(S) PRIOR TO A TREE REMOVAL PERMIT BEING ISSUED.
- AS DEFINED BY THE SECTION 107.13 OF CITY OF MADISON STANDARD SPECIFICATIONS FOR PUBLIC WORKS CONSTRUCTION: NO EXCAVATION IS PERMITTED WITHIN 5 FEET OF THE TRUNK OF THE STREET TREE OR WHEN CUTTING ROOTS OVER 3 INCHES IN DIAMETER. IF EXCAVATION IS NECESSARY, THE CONTRACTOR SHALL CONTACT MADISON CITY FORESTRY (266-4816) PRIOR TO EXCAVATION. CITY OF MADISON FORESTRY PERSONNEL SHALL ASSESS THE IMPACT TO THE TREE AND TO ITS ROOT SYSTEM PRIOR TO WORK COMMENCING. TREE PROTECTION SPECIFICATIONS CAN BE FOUND ON THE FOLLOWING WEBSITE: [HTTPS://WWW.CITYOFMADISON.COM/BUSINESS/PW/SPECS.CFM](https://www.cityofmadison.com/business/pw/specs.cfm)
- CONTRACTOR SHALL TAKE PRECAUTIONS DURING CONSTRUCTION TO NOT DISFIGURE, SCAR, OR IMPAIR THE HEALTH OF ANY STREET TREE. CONTRACTOR SHALL OPERATE EQUIPMENT IN A MANNER AS TO NOT DAMAGE THE BRANCHES OF THE STREET TREE(S). THIS MAY REQUIRE USING SMALLER EQUIPMENT AND LOADING AND UNLOADING MATERIALS IN A DESIGNATED SPACE AWAY FROM TREES ON THE CONSTRUCTION SITE. ANY DAMAGE OR INJURY TO EXISTING STREET TREES (EITHER ABOVE OR BELOW GROUND) SHALL BE REPORTED IMMEDIATELY TO CITY FORESTRY AT 266-4816. PENALTIES AND REMEDIATION SHALL BE REQUIRED.
- SECTION 107.13(G) OF CITY OF MADISON STANDARD SPECIFICATIONS FOR PUBLIC WORKS CONSTRUCTION ADDRESSES SOIL COMPACTION NEAR STREET TREES AND SHALL BE FOLLOWED BY CONTRACTOR. THE STORAGE OF PARKED VEHICLES, CONSTRUCTION EQUIPMENT, BUILDING MATERIALS, REFUSE, EXCAVATED SPOILS OR DUMPING OF POISONOUS MATERIALS ON OR AROUND TREES AND ROOTS WITHIN FIVE (5) FEET OF THE TREE OR WITHIN THE PROTECTION ZONE IS PROHIBITED.
- ON THIS PROJECT, STREET TREE PROTECTION ZONE FENCING IS REQUIRED. THE FENCING SHALL BE ERECTED BEFORE THE DEMOLITION, GRADING OR CONSTRUCTION BEGINS. THE FENCE SHALL INCLUDE THE ENTIRE WIDTH OF TERRACE AND, EXTEND AT LEAST 5 FEET ON BOTH SIDES OF THE OUTSIDE EDGE OF THE TREE TRUNK. DO NOT REMOVE THE FENCING TO ALLOW FOR DELIVERIES OR EQUIPMENT ACCESS THROUGH THE TREE PROTECTION ZONE.
- STREET TREE PRUNING SHALL BE COORDINATED WITH MADISON FORESTRY AT A MINIMUM OF TWO WEEKS PRIOR TO THE START OF CONSTRUCTION FOR THIS PROJECT. ALL PRUNING SHALL FOLLOW THE AMERICAN NATIONAL STANDARDS INSTITUTE (ANSI) A300 - PART 1 STANDARDS FOR PRUNING.
- CALL CITY FORESTRY 608-266-4816 BEFORE EXCAVATION FOR SIDEWALK INSTALLATION.

**TRAFFIC CONTROL:**

- ALL PERMANENT SIGNING AND POSTING WILL BE DETERMINED AND PROVIDED BY THE TRAFFIC ENGINEERING DIVISION, FOLLOWING CONSTRUCTION OF THESE IMPROVEMENTS.
- THE DEVELOPER SHALL PROVIDE, INSTALL AND MAINTAIN ALL STREET END BARRICADES, SIGNING AND TRAFFIC CONTROL, AS REQUIRED BY THE CITY TRAFFIC ENGINEER.
- THE CONTRACTOR SHALL SUBMIT A TRAFFIC CONTROL PLAN FOR REVIEW TO THE CITY TRAFFIC ENGINEERING DIVISION AT LEAST 10 WORKING DAYS PRIOR TO WORK BEGINNING. THE TRAFFIC CONTROL PLAN SHALL COMPLY WITH ALL MUTCD REQUIREMENTS. WORK SHALL NOT PROCEED UNTIL THE TRAFFIC CONTROL PLAN HAS BEEN APPROVED. THE TRAFFIC CONTROL PLAN MAY INCLUDE BUT IS NOT LIMITED TO: LANE CLOSURE RESTRICTIONS, PEAK HOUR WORKING RESTRICTIONS, ACCESS REQUIREMENTS, ETC. THE CONTRACTOR SHALL BE RESPONSIBLE FOR PHASING WORK AS NECESSARY TO MEET THE REQUIREMENTS OF THE APPROVED TRAFFIC CONTROL PLAN.

**UTILITIES:**

- POWER POLES AND OTHER OBSTRUCTIONS SHALL BE MOVED TO PROVIDE 2 FEET MINIMUM OF CLEAR DISTANCE FROM ANY FACE OF CURB OR EDGE OF SIDEWALK.
- THERE MAY BE EXISTING UTILITIES OR OTHER FEATURES WHICH ARE EITHER NOT SHOWN OR SHOWN INCORRECTLY ON THIS PLAN. IT IS THE RESPONSIBILITY OF THE DEVELOPER TO LOCATE AND IDENTIFY ALL UTILITIES AND TOPOGRAPHY WHICH MAY AFFECT THE CONSTRUCTION OF THESE IMPROVEMENTS.
- RELOCATION OR ADJUSTING OF PRIVATE UTILITY FACILITIES, SUCH AS POLES, PEDESTALS, BOXES, STRUCTURES, CASTINGS OR HANDHOLES, WITH PRIVATE UTILITY COMPANIES.
- ALL WORK WITHIN THE CITY RIGHT OF WAY AND EASEMENTS SHALL BE COMPLIANT WITH THE CITY OF MADISON STANDARD SPECIFICATIONS CURRENT AT THE TIME OF CONSTRUCTION.
- UTILITY INSTALLATION SHALL BE COORDINATED WITH ENGINEER AT LEAST 4 WEEKS PRIOR TO INSTALLATION TO ENSURE BUILDING INSPECTION APPROVAL IS OBTAINED.
- SANITARY SEWER AND WATER MAIN CONSTRUCTION AND MATERIALS SHALL CONFORM WITH THE CITY OF MADISON STANDARD SPECIFICATIONS.
- ALL UNUSED EXISTING WATER AND SANITARY LATERALS SERVING THE SUBJECT PROPERTY SHALL BE CAPPED/ABANDONED PER THE CITY OF MADISON STANDARD SPECIFICATIONS.
- PRIOR TO WORK ON MADISON WATER UTILITY FACILITIES, CONTACT CITY OF MADISON CONSTRUCTION DEPARTMENT AT LEAST 1 WEEK PRIOR TO BEGINNING CONSTRUCTION

CITY OF MADISON  
CONSTRUCTION SUPERVISOR  
JEFF BELSHAW  
OFFICE PHONE: 608-261-9835  
MOBILE PHONE: 608-206-3856

FOR NEW WATER SERVICE AND METER APPLICATION CONTACT:

CITY OF MADISON  
MWU ENGINEERING OPERATION CLERK  
AMY JONES  
OFFICE PHONE: 608-266-6466

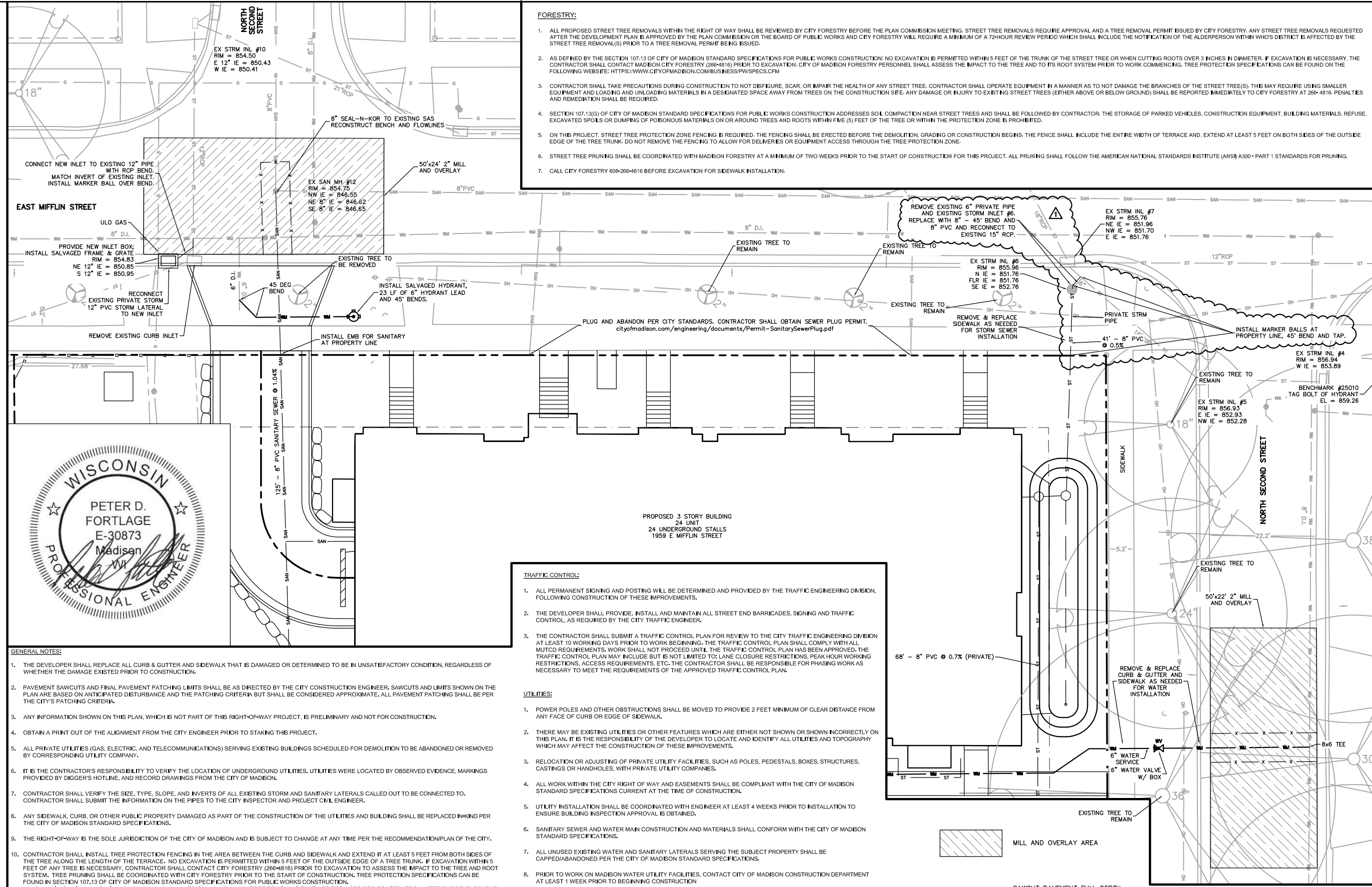

**GENERAL NOTES:**

- THE DEVELOPER SHALL REPLACE ALL CURB & GUTTER AND SIDEWALK THAT IS DAMAGED OR DETERMINED TO BE IN UNSATISFACTORY CONDITION, REGARDLESS OF WHETHER THE DAMAGE EXISTED PRIOR TO CONSTRUCTION.
- PAVEMENT SAWCUTS AND FINAL PAVEMENT PATCHING LIMITS SHALL BE AS DIRECTED BY THE CITY CONSTRUCTION ENGINEER. SAWCUTS AND LIMITS SHOWN ON THE PLAN ARE BASED ON ANTICIPATED DISTURBANCE AND THE PATCHING CRITERIA BUT SHALL BE CONSIDERED APPROXIMATE. ALL PAVEMENT PATCHING SHALL BE PER THE CITY'S PATCHING CRITERIA.
- ANY INFORMATION SHOWN ON THIS PLAN, WHICH IS NOT PART OF THIS RIGHT-OF-WAY PROJECT, IS PRELIMINARY AND NOT FOR CONSTRUCTION.
- OBTAIN A PRINT OUT OF THE ALIGNMENT FROM THE CITY ENGINEER PRIOR TO STAKING THIS PROJECT.
- ALL PRIVATE UTILITIES (GAS, ELECTRIC, AND TELECOMMUNICATIONS) SERVING EXISTING BUILDINGS SCHEDULED FOR DEMOLITION TO BE ABANDONED OR REMOVED BY CORRESPONDING UTILITY COMPANY.
- IT IS THE CONTRACTOR'S RESPONSIBILITY TO VERIFY THE LOCATION OF UNDERGROUND UTILITIES. UTILITIES WERE LOCATED BY OBSERVED EVIDENCE, MARKINGS PROVIDED BY DIGGER'S HOTLINE, AND RECORD DRAWINGS FROM THE CITY OF MADISON.
- CONTRACTOR SHALL VERIFY THE SIZE, TYPE, SLOPE, AND INVERTS OF ALL EXISTING STORM AND SANITARY LATERALS CALLED OUT TO BE CONNECTED TO. CONTRACTOR SHALL SUBMIT THE INFORMATION ON THE PIPES TO THE CITY INSPECTOR AND PROJECT C/M ENGINEER.
- ANY SIDEWALK, CURB, OR OTHER PUBLIC PROPERTY DAMAGED AS PART OF THE CONSTRUCTION OF THE UTILITIES AND BUILDING SHALL BE REPLACED IN-KIND PER THE CITY OF MADISON STANDARD SPECIFICATIONS.
- THE RIGHT-OF-WAY IS THE SOLE JURISDICTION OF THE CITY OF MADISON AND IS SUBJECT TO CHANGE AT ANY TIME PER THE RECOMMENDATION/PLAN OF THE CITY.
- CONTRACTOR SHALL INSTALL TREE PROTECTION FENCING IN THE AREA BETWEEN THE CURB AND SIDEWALK AND EXTEND IT AT LEAST 5 FEET FROM BOTH SIDES OF THE TREE ALONG THE LENGTH OF THE TERRACE. NO EXCAVATION IS PERMITTED WITHIN 5 FEET OF THE OUTSIDE EDGE OF A TREE TRUNK. IF EXCAVATION WITHIN 5 FEET OF ANY TREE IS NECESSARY, CONTRACTOR SHALL CONTACT CITY FORESTRY (266-4816) PRIOR TO EXCAVATION TO ASSESS THE IMPACT TO THE TREE AND ROOT SYSTEM. TREE PRUNING SHALL BE COORDINATED WITH CITY FORESTRY PRIOR TO THE START OF CONSTRUCTION. TREE PROTECTION SPECIFICATIONS CAN BE FOUND IN SECTION 107.13 OF CITY OF MADISON STANDARD SPECIFICATIONS FOR PUBLIC WORKS CONSTRUCTION. <http://www.cityofmadison.com/business/pw/specs/2018/part1.pdf> ANY TREE REMOVALS THAT ARE REQUIRED FOR CONSTRUCTION AFTER THE DEVELOPMENT PLAN IS APPROVED WILL REQUIRE AT LEAST A 72 HOUR WAIT PERIOD BEFORE A TREE REMOVAL PERMIT CAN BE ISSUED BY FORESTRY, TO NOTIFY THE ALDER OF THE CHANGE IN THE TREE PLAN
- POWER POLES AND OTHER OBSTRUCTIONS SHALL BE MOVED TO PROVIDE 2 FEET MINIMUM OF CLEAR DISTANCE FROM ANY FACE OF CURB OR EDGE OF SIDEWALK.
- THERE MAY BE EXISTING UTILITIES OR OTHER FEATURES WHICH ARE EITHER NOT SHOWN OR SHOWN INCORRECTLY ON THIS PLAN. IT IS THE RESPONSIBILITY OF THE DEVELOPER TO LOCATE AND IDENTIFY ALL UTILITIES AND TOPOGRAPHY WHICH MAY AFFECT THE CONSTRUCTION OF THESE IMPROVEMENTS.
- RELOCATION OR ADJUSTING OF PRIVATE UTILITY FACILITIES, SUCH AS POLES, PEDESTALS, BOXES, STRUCTURES, CASTINGS OR HANDHOLES, WITH PRIVATE UTILITY COMPANIES.

REVISION #2 - 10/19/23 - IO  
- SHEET ADDED.

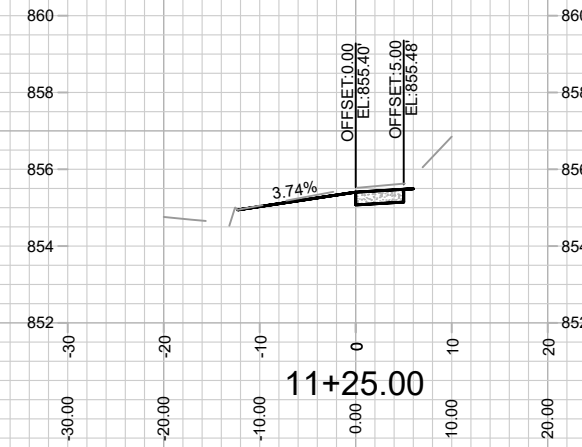
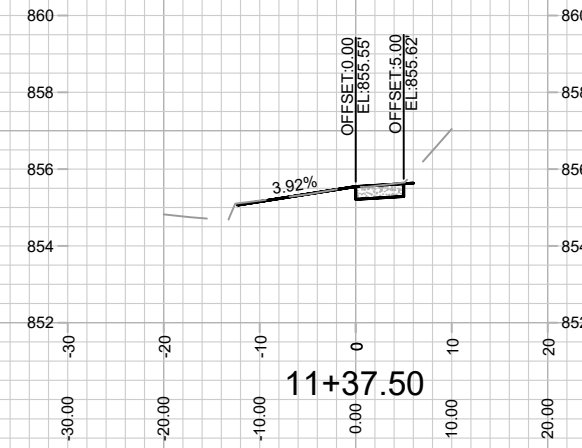
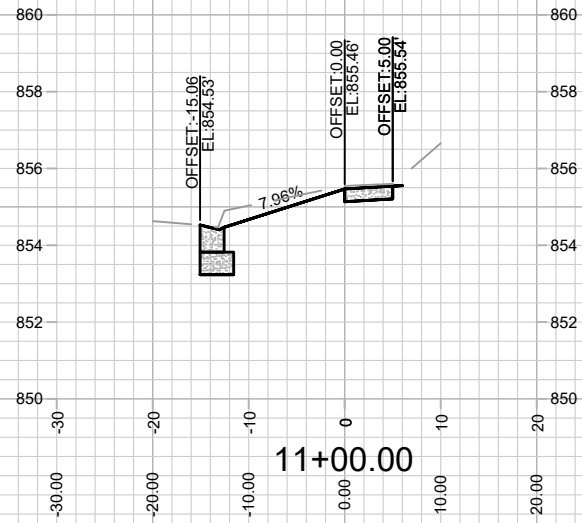
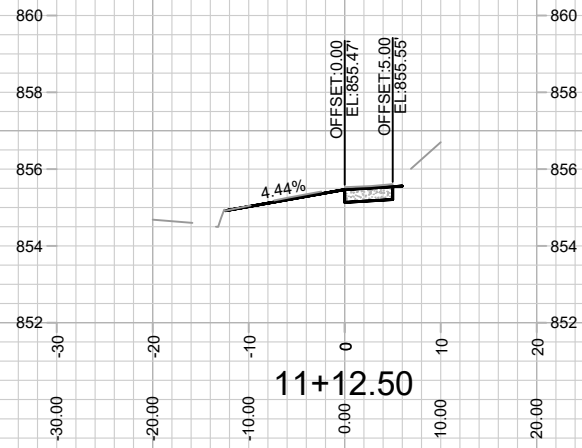
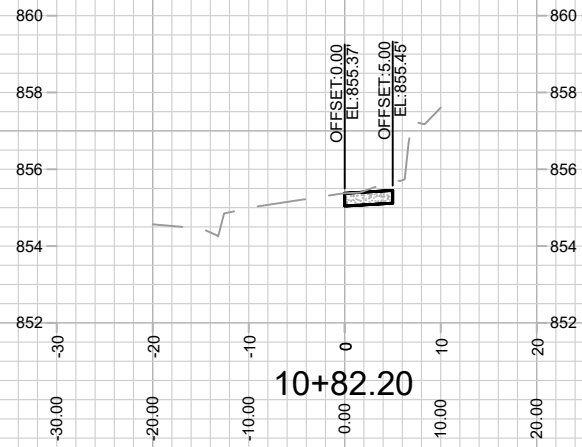
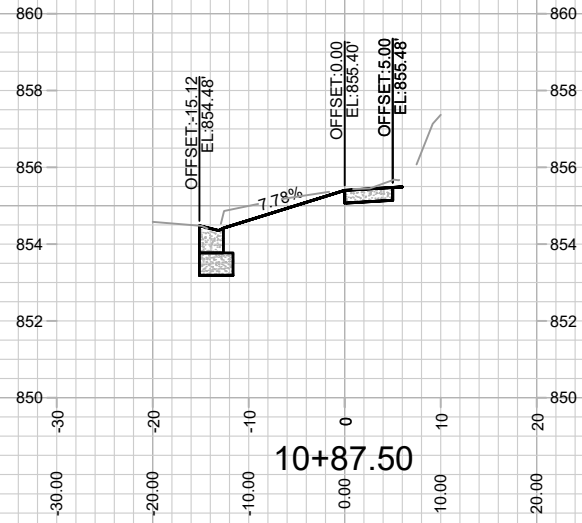

14047  
X-1

CROSS SECTIONS - E MIFFLIN STREET  
1959 E MIFFLIN STREET - THE AVENUE

14047  
MADISON, WI  
CONTRACT NO: 9158

MARK	REVISION	DATE	BY
14047 <td></td> <td>10/19/2023 3:14 PM<td></td></td>		10/19/2023 3:14 PM <td></td>	

Designed By: IO  
Date: 10/19/2023 3:14 PM  
Scale: 1" = 20'  
X-1

REVISION #2 - 10/19/23 - IO  
- SHEET ADDED.

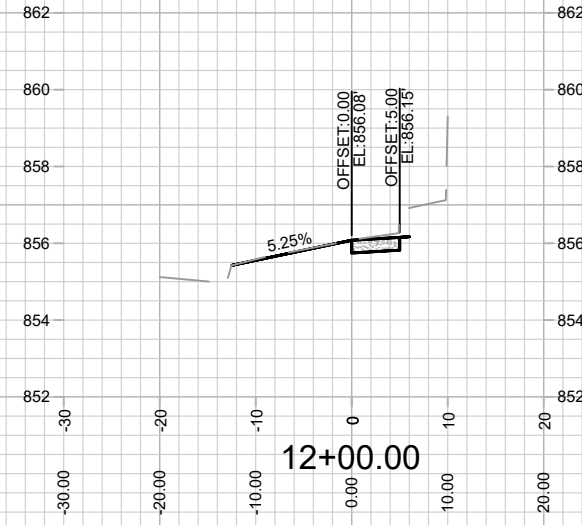
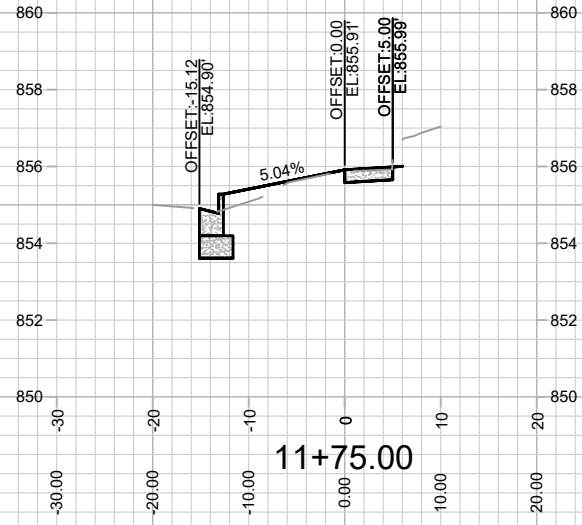
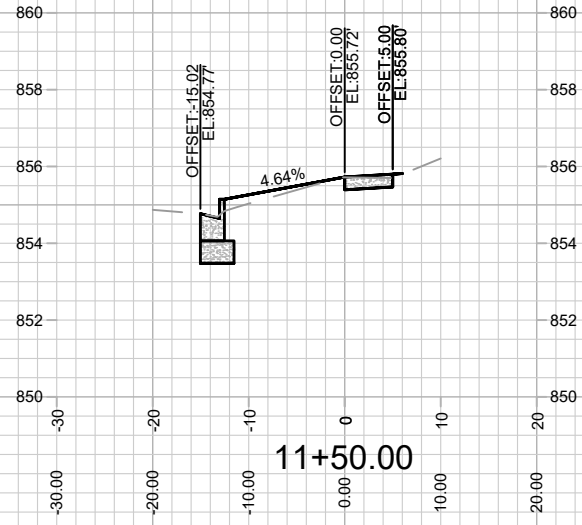
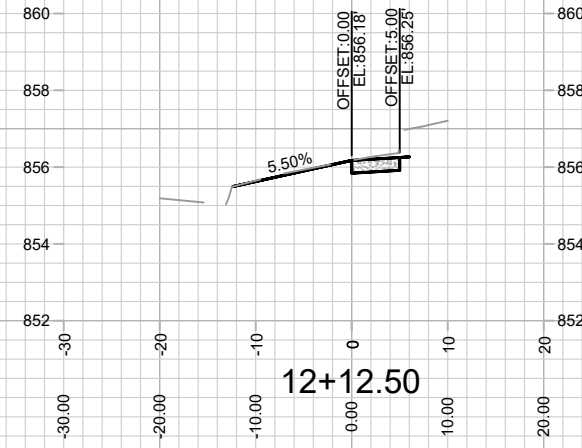
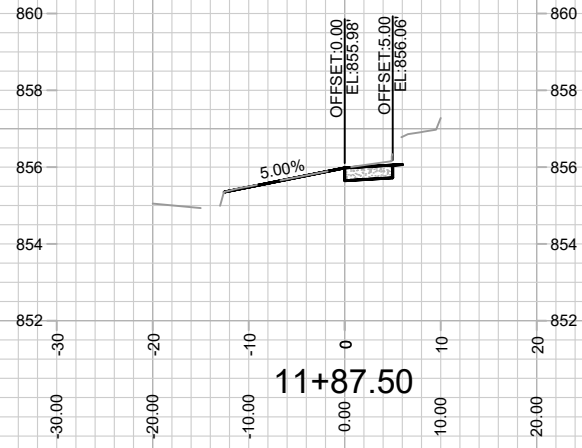
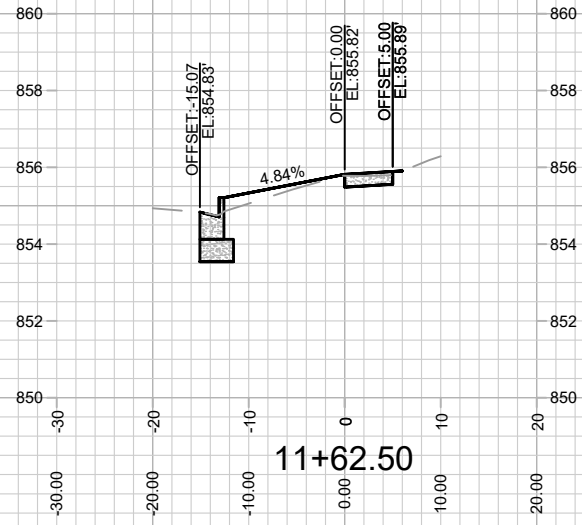

MARK	REVISION	DATE	BY
14047		2/17/2023 10:54 AM	
Designed By: IO			Scale: 1" = 20'
Date: 2/17/2023 10:54 AM			X-2

14047  
MADISON, WI  
9158  
CONTRACT NO:

CROSS SECTIONS - E MIFFLIN STREET  
1959 E MIFFLIN STREET - THE AVENUE  
M:\DESIGN\Projects\14047\CAD\Streets\14047\EN-AIP\Prof&Corridor\_Setup.dwg



14047  
X-2



REVISION #2 - 10/19/23 - IO  
- SHEET ADDED.

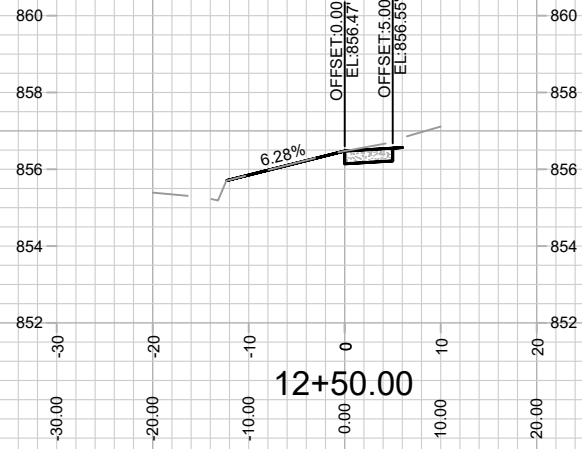
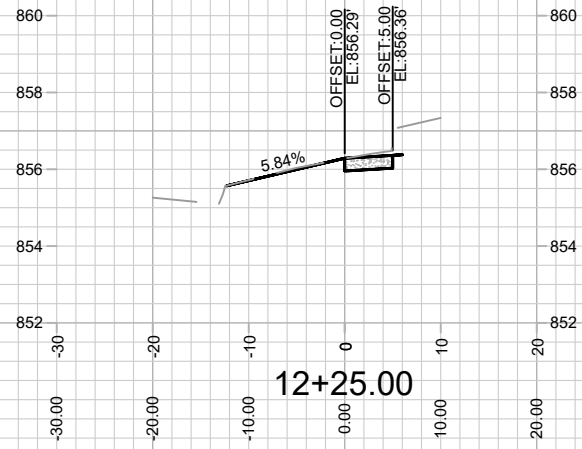
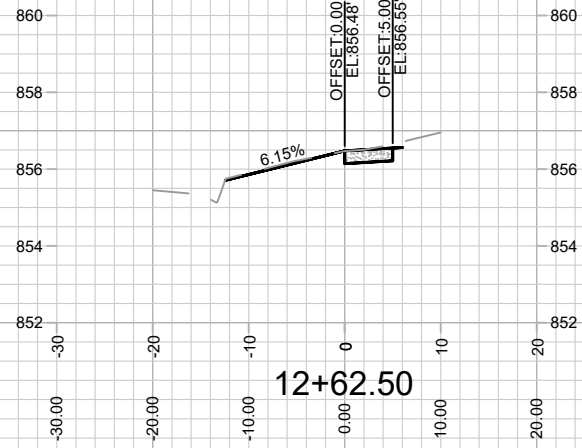
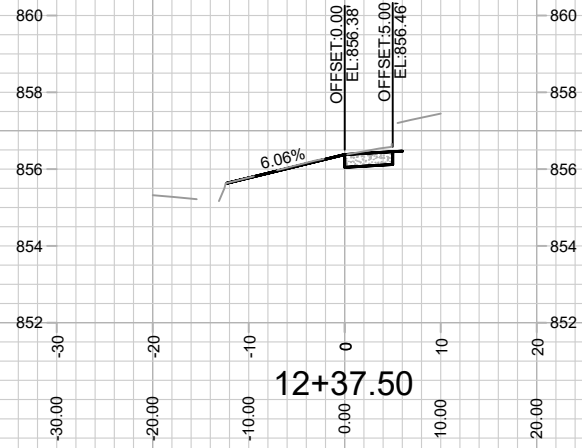

14047  
X-3

CROSS SECTIONS - E MIFFLIN STREET  
1959 E MIFFLIN STREET - THE AVENUE

M:\DESIGN\Projects\14047\CAD\Streets\14047EN-AIP\Prof&Corridor\_Setup.dwg

14047  
MADISON, WI  
CONTRACT NO: 9158

MARK	REVISION	DATE	BY
14047		10/19/2023 3:20 PM	

X-3

REVISION #2 - 10/19/23 - IO  
- SHEET ADDED.

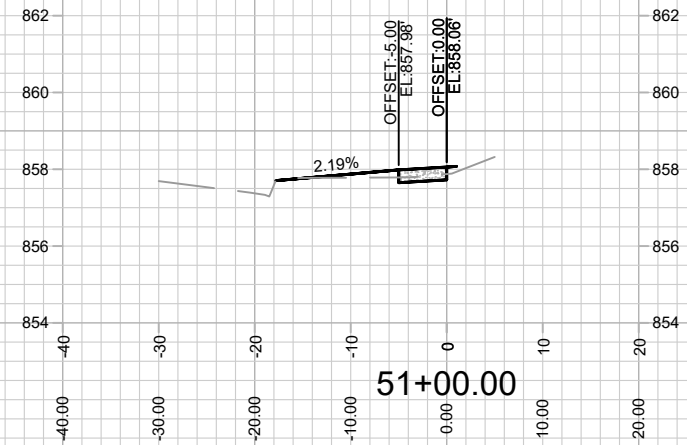
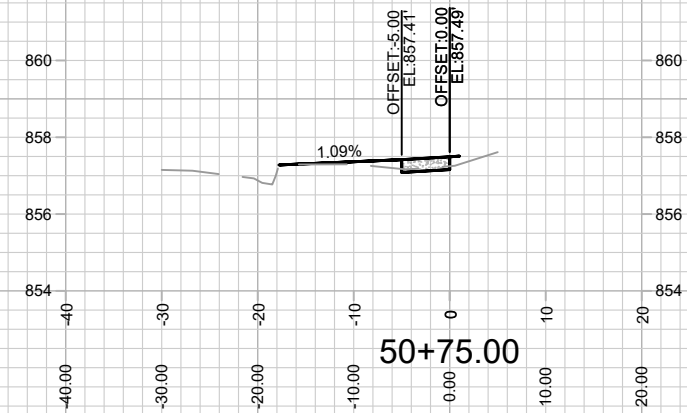
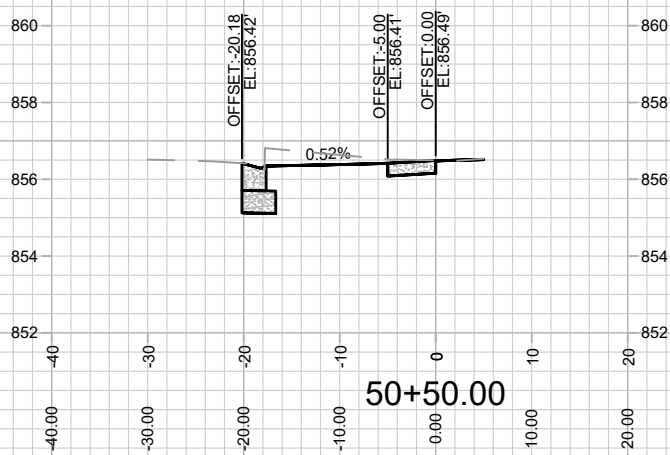
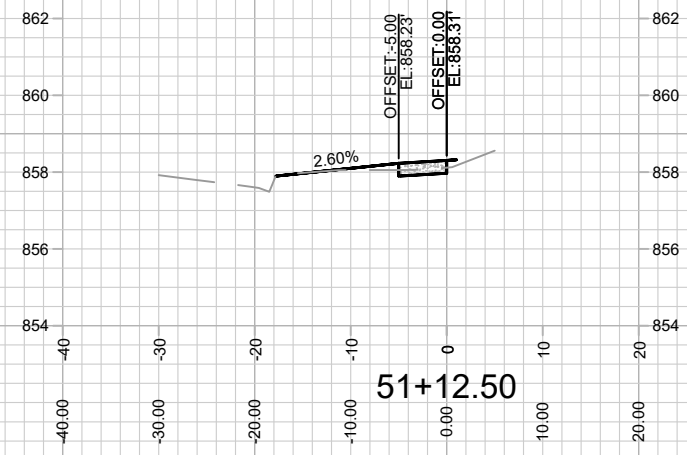
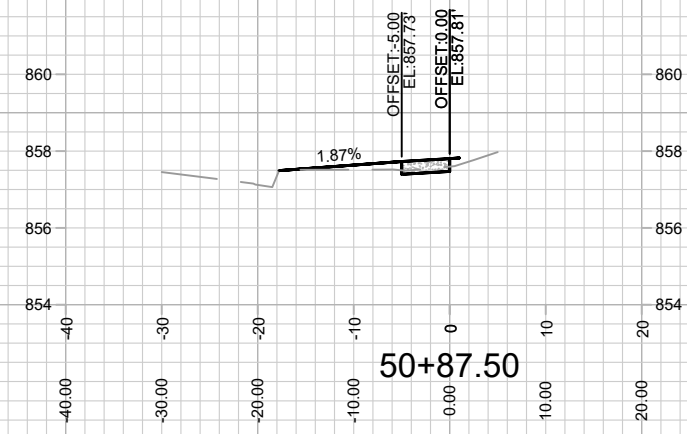
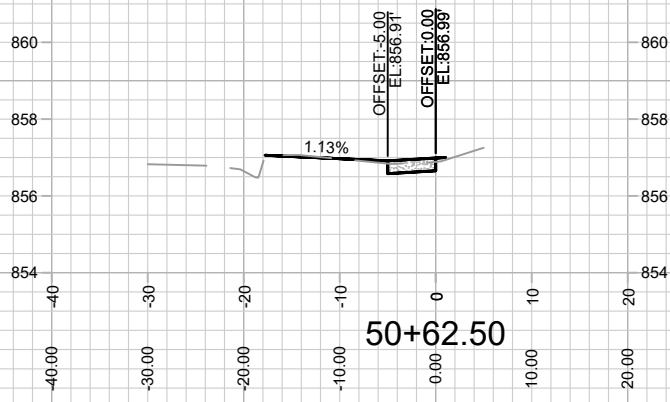

MARK	REVISION	DATE	BY
14047		10/19/2023 3:12 PM	

14047  
MADISON, WI  
1959 E MIFFLIN STREET - THE AVENUE  
CONTRACT NO: 9158

CROSS SECTIONS - N SECOND STREET  
M:\DESIGN\Projects\14047\CAD\Streets\14047\EN-A\IPof&Corridor\_Setup.dwg

14047  
X-4

REVISION #2 - 10/19/23 - IO  
- SHEET ADDED.

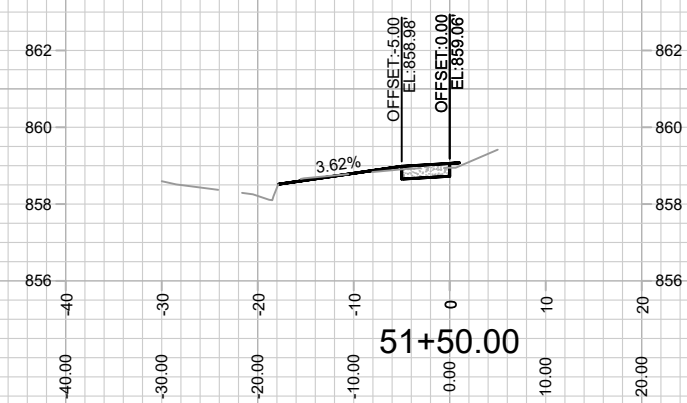
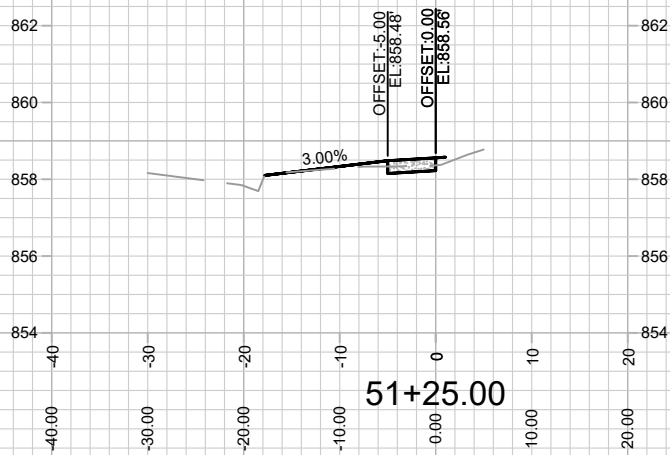
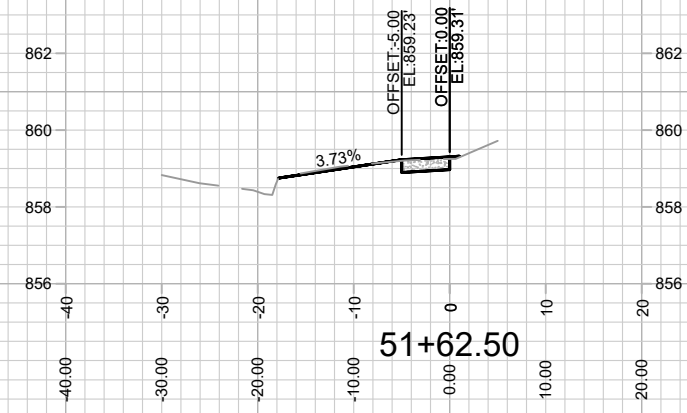
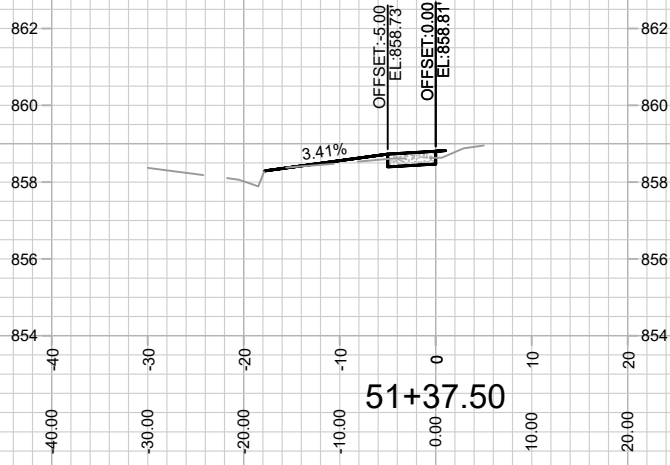

MARK	REVISION	DATE	BY
14047		10/19/2023	3:12 PM
		Scale: 1" = 20'	X-5

14047  
MADISON, WI  
CONTRACT NO: 9158

CROSS SECTIONS - N SECOND STREET  
1959 E MIFFLIN STREET - THE AVENUE  
M:\DESIGN\Projects\14047\CAD\Streets\14047\EN-A\IPof&Corridor\_Setup.dwg



14047  
X-5