



Madison, Wisconsin

CITY OF MADISON

CITY ENGINEERING DIVISION

DEPARTMENT OF PUBLIC WORKS

PLAN OF PROPOSED IMPROVEMENT

INDEX OF SHEETS

SHEET NO. D1	GENERAL NOTES
SHEET NO. D2	TYPICAL SECTIONS
SHEET NO. P1-P2	STREET PLAN & PROFILES
SHEET NO. U1	OVERALL UTILITY PLAN
SHEET NO. U2-U3	UTILITY PLAN
SHEET NO. X1-X5	CROSS SECTIONS
SHEET NO. EX1	STORM PLAN & PROFILE
NO MAINTENANCE PLAN REQUIRED	

REVISION
 REV#1 - 9/18/23 - U3 revised.
 REV#2 - 1/18/24 - U3 revised, EX1 added.

3005 UNIVERSITY AVENUE

CITY PROJECT NO. 14202
 CONTRACT NO. 9187

PROJECT LOCATION

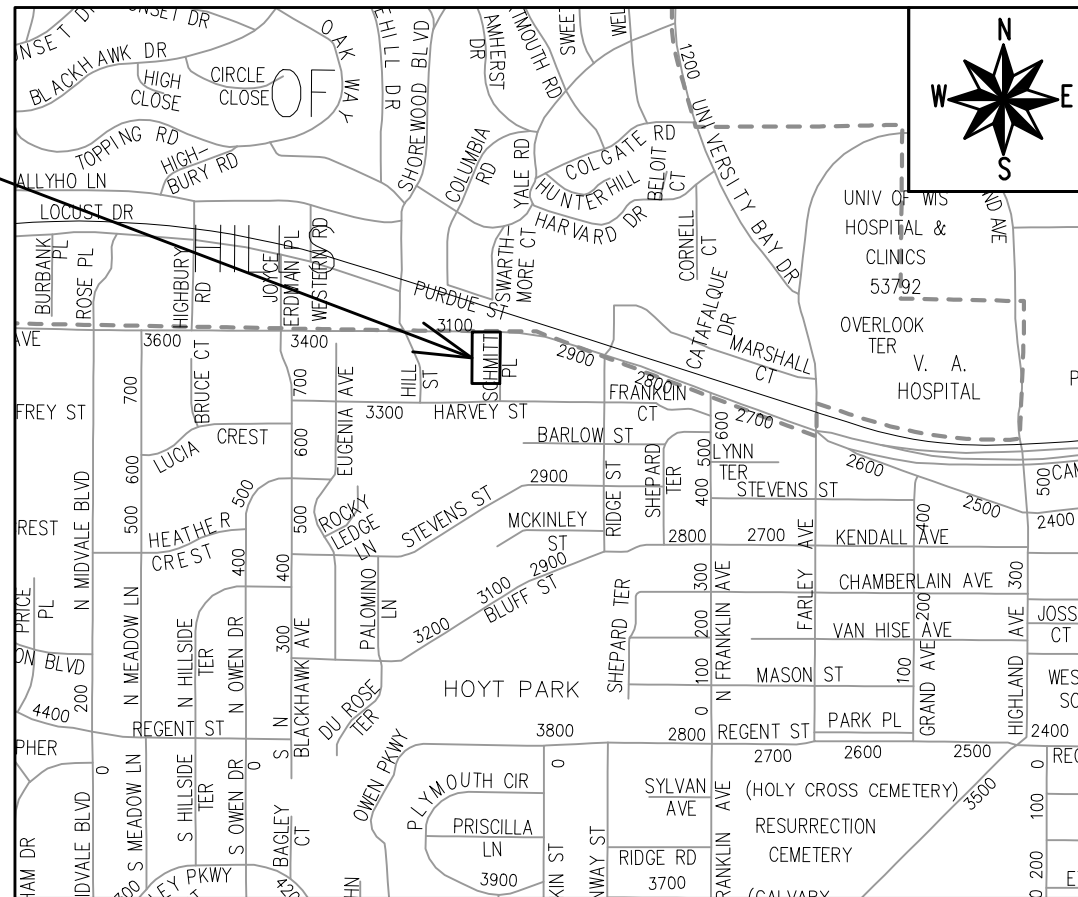

PUBLIC IMPROVEMENT PROJECT APPROVED

MAY 24, 2022

BY THE COMMON COUNCIL OF MADISON, WISCONSIN

PUBLIC IMPROVEMENT DESIGN APPROVED BY:

Jun 21, 2023

City Engineer

Date

STREET DESIGNED BY:

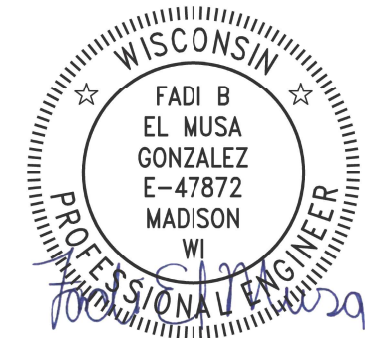

Jun 21, 2023

STORM & SANITARY SEWER DESIGNED BY:

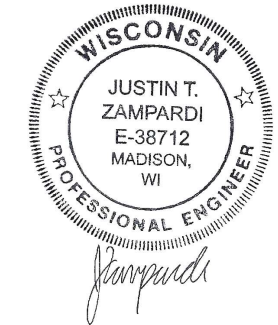

Jun 21, 2023

PLOT SCALE: 1:1_XREF

PLOT NAME: ---



REV. DATE: 6/12/2023 9:14 AM

ORIGINATOR: CITY_OF_MADISON

THE LOCATION AND INFORMATION FOR PROPOSED NEW TREES, IN THE PUBLIC RIGHT OF WAY OR ON PUBLIC LANDS ARE APPROXIMATE AND ARE SHOWN FOR REFERENCE ONLY. THE LOCATIONS, SPECIFICATIONS AND PLANTING METHODS OF ALL PROPOSED NEW OR REPLACEMENT TREES IN THE PUBLIC RIGHT OF WAY OR ON PUBLIC LANDS SHALL BE APPROVED BY THE CITY FORESTER PRIOR TO INSTALLATION.

NO TREES IN THE RIGHT OF WAY OR ON PUBLIC LANDS SHALL BE TRIMMED, PRUNED, REMOVED OR ADVERSELY AFFECTED IN ANY WAY UNTIL THE DEVELOPER HAS RECEIVED WRITTEN PERMISSION FROM THE CITY ENGINEER OR CITY FORESTER. SAID WRITTEN PERMISSION SHALL INCLUDE LANGUAGE INDICATING THAT SECTION 10.101 OF THE MADISON GENERAL ORDINANCES AND ADMINISTRATIVE PROCEDURE MEMORANDUM NO. 6-2, REFERRING TO NOTIFICATION OF PROPERTY OCCUPANTS AND/OR OWNERS, HAS BEEN COMPLIED WITH.

DEVELOPER MUST SUBMIT A TRAFFIC CONTROL PLAN TO CITY TRAFFIC ENGINEERING AT LEAST 14 DAYS PRIOR TO THE START OF WORK. WORK SHALL NOT PROCEED UNTIL AN APPROVED TRAFFIC CONTROL PLAN IS IN PLACE.

CONVENTIONAL SIGNS	
<i>FIELD VERIFY ALL UTILITY LOCATIONS</i>	
GAS	—— G ——
STORM SEWER	—— ST ——
SANITARY SEWER	—— SAN ——
WATER	—— W ——
BURIED ELECTRIC	—— E ——
OVERHEAD ELECTRIC	—— OH ——
POWER POLE	
ADA COMPLIANT RAMP W/ DETECTABLE WARNING FIELD	
COMBUSTIBLE FLUIDS	

UNDERDRAINS SHALL BE INSTALLED PER STANDARD DETAIL DRAWING 4.05 FOR 75' ON EACH SIDE OF THE LOW POINT, OR TO THE NEAREST CURB HIGH POINT. ALL UNDERDRAIN SHALL BE WRAPPED.

ALL GUTTERS SHALL DRAIN WITH A MINIMUM GRADE OF 0.5% TOWARD STORM SEWER INLETS.

ALL DITCHES SHALL DRAIN WITH A MINIMUM GRADE OF 0.5%

THE CROSS SLOPE OF SIDEWALKS AND BARRIER FREE SIDEWALK CURB RAMPS SHALL TYPICALLY BE 1.5%. THE LONGITUDINAL GRADE OF BARRIER FREE SIDEWALK CURB RAMPS SHALL NOT EXCEED 8.33%. ALL SIDEWALK RAMPS SHALL BE CONSTRUCTED ACCORDING TO S.D.D. 3.04. AT ALL OTHER LOCATIONS THE LONGITUDINAL GRADE OF SIDEWALKS SHALL NOT EXCEED 5.0 % OR THE ADJACENT STREET GRADE WHICHEVER IS GREATER NOR BE LESS THAN 0.5% AND SHALL DRAIN TOWARD STORM SEWER INLETS. SIDE SLOPES WITHIN TEN FEET OF A PUBLIC SIDEWALK SHALL NOT EXCEED 4:1. ALL SIDEWALK AND SIDEWALK RAMP ELEVATIONS AND GRADES SHALL BE FIELD VERIFIED AND SET TO COMPLY WITH THE CITY OF MADISON STANDARD SPECIFICATIONS AND THE A.D.A. GUIDELINES.

OBTAIN A PRINT OUT OF THE ALIGNMENTS FROM THE CITY PROJECT ENGINEER PRIOR TO STAKING THIS PROJECT. THE CITY PROJECT ENGINEER IS IKE OKAFOR, EMAIL: IOKAFOR@CITYOFMADISON.COM

CURB STATION AND OFFSETS SHALL BE TO THE EDGE OF PAVEMENT UNLESS OTHERWISE INDICATED. CURB ELEVATIONS SHALL BE TO THE EDGE OF PAVEMENT UNLESS OTHERWISE INDICATED.

POWER POLES AND OTHER OBSTRUCTIONS SHALL BE MOVED TO PROVIDE 2 FEET MINIMUM OF CLEAR DISTANCE FROM ANY FACE OF CURB OR EDGE OF SIDEWALK UNLESS OTHERWISE INDICATED ON THE PLANS.

ANY INFORMATION SHOWN ON THIS PLAN, WHICH IS NOT PART OF THIS RIGHT-OF-WAY PROJECT, IS PRELIMINARY AND NOT FOR CONSTRUCTION.

THERE MAY BE EXISTING UTILITIES OR OTHER FEATURES WHICH ARE EITHER NOT SHOWN OR SHOWN INCORRECTLY ON THIS PLAN. IT IS THE RESPONSIBILITY OF THE DEVELOPER TO LOCATE AND IDENTIFY ALL UTILITIES AND TOPOGRAPHY WHICH MAY AFFECT THE CONSTRUCTION OF THESE IMPROVEMENTS.

ALL PERMANENT SIGNING AND POSTING WILL BE DETERMINED AND PROVIDED BY THE TRAFFIC ENGINEERING DIVISION, FOLLOWING CONSTRUCTION OF THESE IMPROVEMENTS.

THE DEVELOPER SHALL PROVIDE, INSTALL AND MAINTAIN ALL STREET END BARRICADES, SIGNING AND TRAFFIC CONTROL, AS REQUIRED BY THE CITY TRAFFIC ENGINEER.

PAVEMENT SAWCUTS SHALL BE AS DIRECTED BY THE CITY CONSTRUCTION ENGINEER. SAWCUTS SHOWN ON THE PLAN ARE APPROXIMATE.

CURB ON CUL DE SACS SHALL BE INSTALLED ACCORDING TO S.D.D 3.05.

ALL WORK IN THE RIGHT OF WAY AND PUBLIC EASEMENTS SHALL BE IN ACCORDANCE WITH THE CITY OF MADISON STANDARD SPECIFICATIONS FOR PUBLIC WORKS CONSTRUCTION LATEST EDITION.

ALL PROPOSED IMPROVEMENTS IN THE RIGHT-OF-WAY ARE BASED ON SURVEY DATA PROVIDED BY THE DEVELOPER OR ITS CONSULTANT. IN THE CASE THAT THE PROPOSED IMPROVEMENTS CAN NOT BE INSTALLED PER THESE PLANS OR THE CITY OF MADISON STANDARD SPECIFICATION FOR PUBLIC WORKS CONSTRUCTION, LATEST EDITION, THE DEVELOPER SHALL BE RESPONSIBLE FOR THE COST OF EXTRA WORK DUE TO INACCURACIES OF THE SURVEY.

ALL UTILITY VERIFICATIONS AND ACCURACY OF THE DRAWINGS ARE THE RESPONSIBILITY OF THE DEVELOPER. ANY CONFLICTS THAT ARISE FROM MISSING OR ERRONEOUS INFORMATION WILL BE AT THE EXPENSE OF THE DEVELOPER. NO PRECAST STRUCTURES WILL BE APPROVED FOR STORM OR SANITARY SEWER UNTIL ALL POTENTIAL UTILITY CONFLICTS ARE RESOLVED.

DATE	BY
11/14/23	BT
REVISION	
Date: 3/20/2023 11:47 AM	
MARK	
Designed By: IO	
14202	
Scale:	D-1

14202
MADISON, WI
9187
CONTRACT NO:

GENERAL NOTES
3005 UNIVERSITY AVENUE
M:\DESIGN\Projects\14202\CAD\Streets\14202EN-Details.dwg



14202
D-1

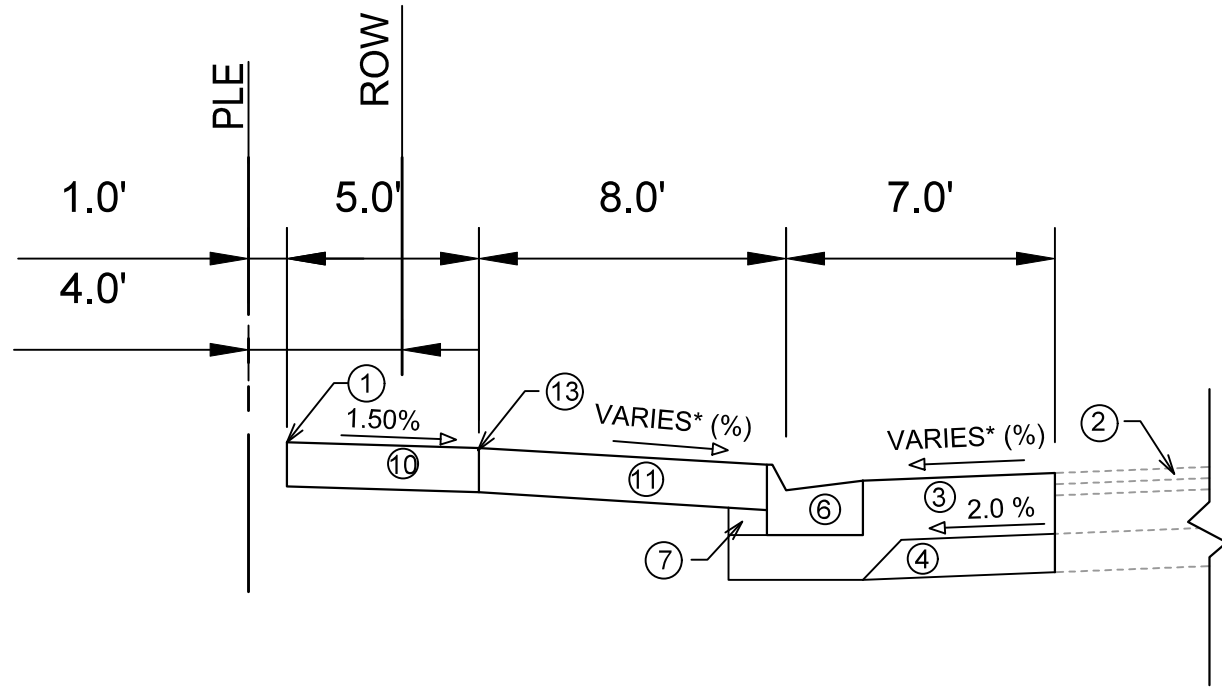

TYPICAL SECTION
 SCHMITT PLACE
 STA 101+16 TO STA 101+61
 (NOT TO SCALE)

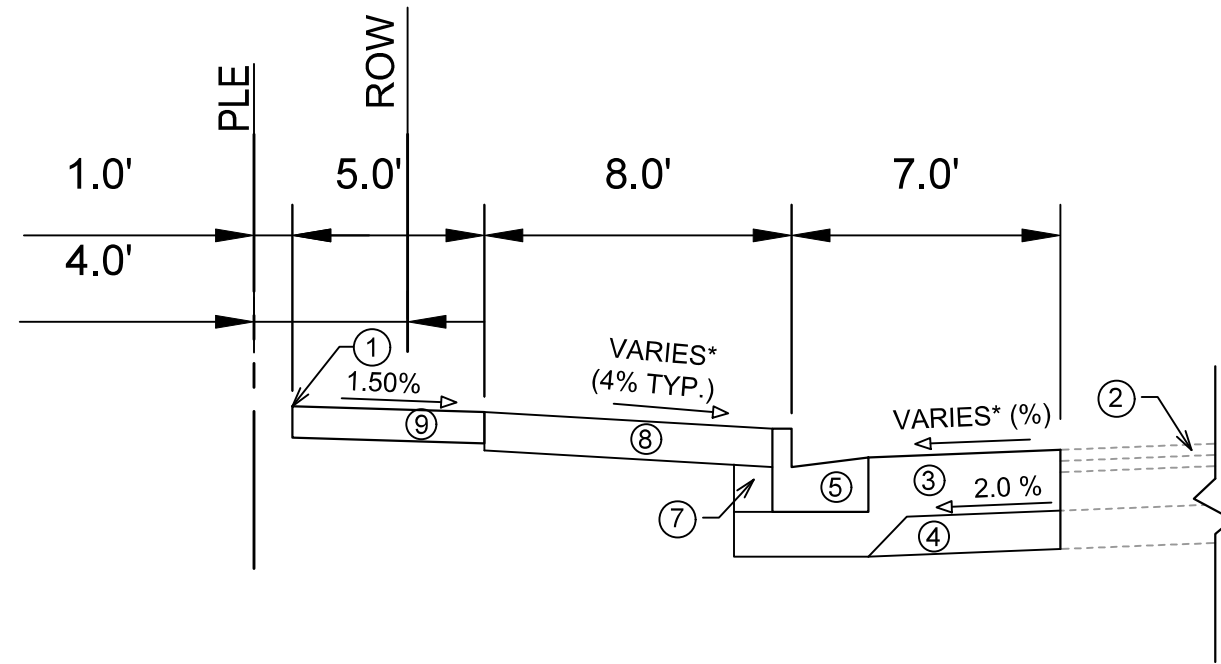

TYPICAL SECTION
 SCHMITT PLACE
 STA 100+60 TO STA 101+16
 STA 101+61 TO STA 103+00
 (NOT TO SCALE)

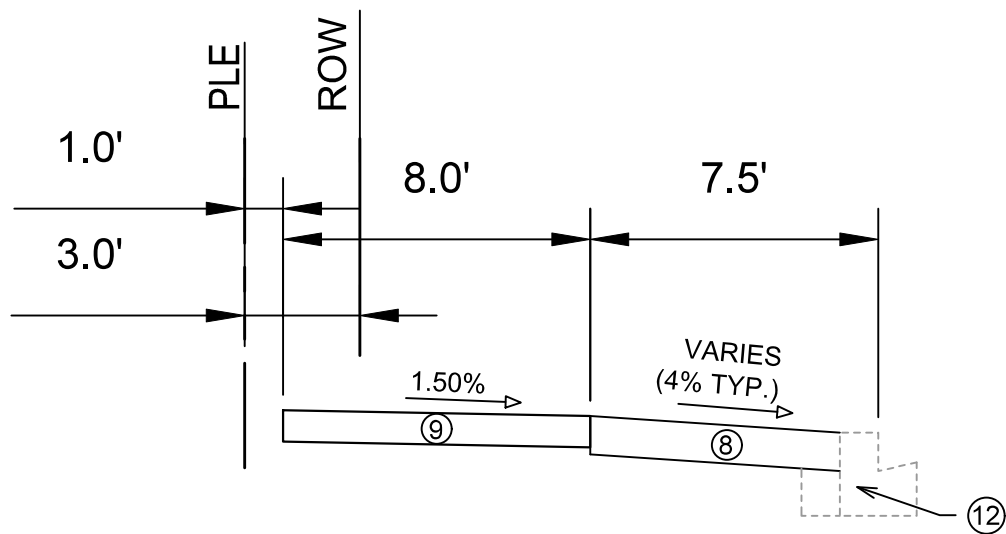

TYPICAL SECTION
 UNIVERSITY AVENUE
 STA 103+29 TO STA 104+00
 (NOT TO SCALE)

SPECIAL NOTES:

* SEE X SHEETS FOR SLOPE.

- ① POINT REFERRED TO ON PROFILE.
- ② EXISTING PAVEMENT TO REMAIN.
- ③ CRUSHED AGGREGATE BASE COURSE GRADATION 2 (DEPTH VARIES).
- ④ 6" CRUSHED AGGREGATE BASE COURSE GRADATION 1 (GRADE BASE TO MATCH FUTURE CROSS SLOPE).
- ⑤ CONCRETE CURB AND GUTTER TYPE 'A'.
- ⑥ MOUNTABLE CONCRETE CURB AND GUTTER TYPE 'A'.
- ⑦ FILL.
- ⑧ 6" TOPSOIL, SEED AND MATTING.
- ⑨ 5" CONCRETE SIDEWALK.
- ⑩ 7" CONCRETE SIDEWALK.
- ⑪ 7" CONCRETE TERRACE.
- ⑫ FINAL CURB BY OTHERS.
- ⑬ PLACE JOINT FILLER AND SEALER.

MARK	REVISION	DATE	BY
14202	6/20/2023 9:22 AM		
Designed By: ID	Scale:		
14202			D-2

14202
 MADISON, WI
 CONTRACT NO: 9187

TYPICAL SECTIONS
 3005 UNIVERSITY AVENUE
 M:\DESIGN\Projects\14202\CAD\Streets\14202EN-Details.dwg



14202
 D-2

3005 UNIVERSITY AVENUE

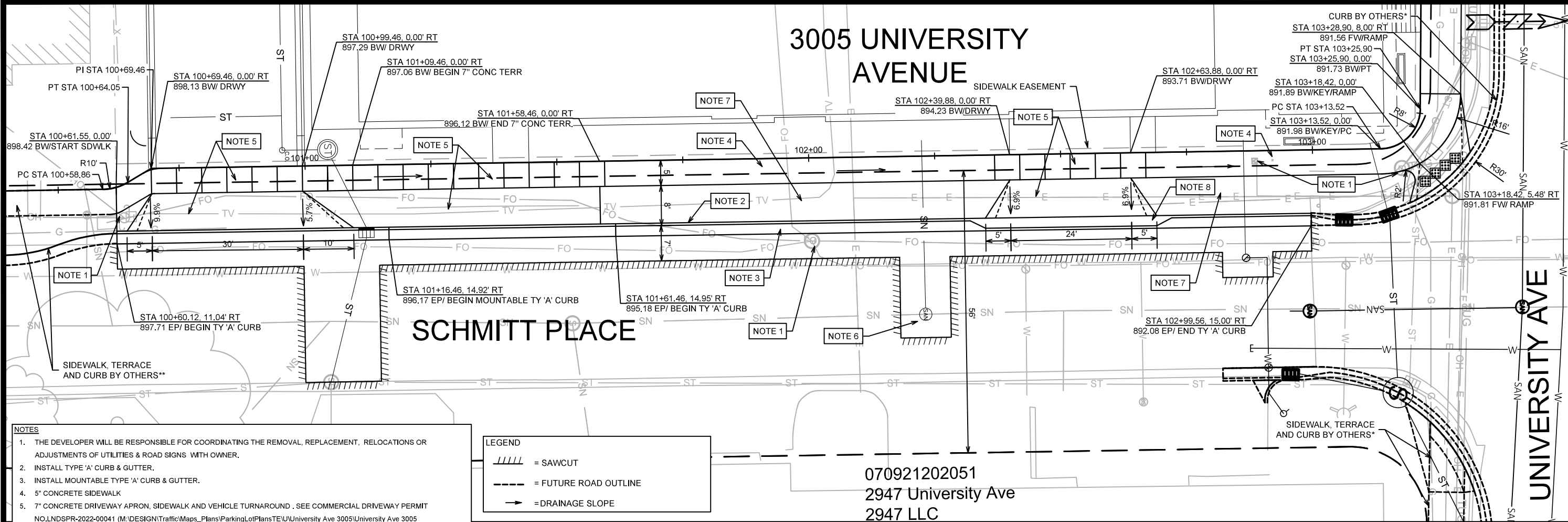

- NOTES**
- THE DEVELOPER WILL BE RESPONSIBLE FOR COORDINATING THE REMOVAL, REPLACEMENT, RELOCATIONS OR ADJUSTMENTS OF UTILITIES & ROAD SIGNS WITH OWNER.
 - INSTALL TYPE 'A' CURB & GUTTER.
 - INSTALL MOUNTABLE TYPE 'A' CURB & GUTTER.
 - 5" CONCRETE SIDEWALK
 - 7" CONCRETE DRIVEWAY APRON, SIDEWALK AND VEHICLE TURNAROUND . SEE COMMERCIAL DRIVEWAY PERMIT NO.LNDSR-2022-00041 (M:\DESIGN\Traffic\Maps_Plans\ParkingLotPlans\TE\U\University Ave 3005\University Ave 3005 Permit_221116.pdf)
 - CONSTRUCT TEMPORARY GRAVEL PAVEMENT PER DETAIL SHEET, FINAL LIMITS AND TYPE SHALL BE DETERMINED BY CONSTRUCTION ENGINEER.
 - 6" TOPSOIL, SEED AND MATTING.
 - INSTALL TYPE 'X' DRIVEWAY SECTION CURB & GUTTER.
- * FINAL PAVEMENT AND CURB SHALL BE CONSTRUCTED BY UNIVERSITY AVE PROJECT (SEE PROJECT NO.11168 FOR DETAILS).
 ** FINAL PAVEMENT AND CURB SHALL BE CONSTRUCTED BY HARVEY ST & SCHMITT PL PROJECT (SEE PROJECT NO.14081 FOR DETAILS).

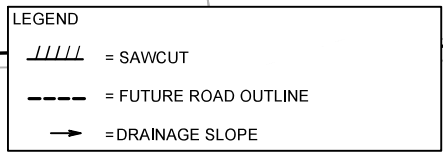

070921202051
 2947 University Ave
 2947 LLC

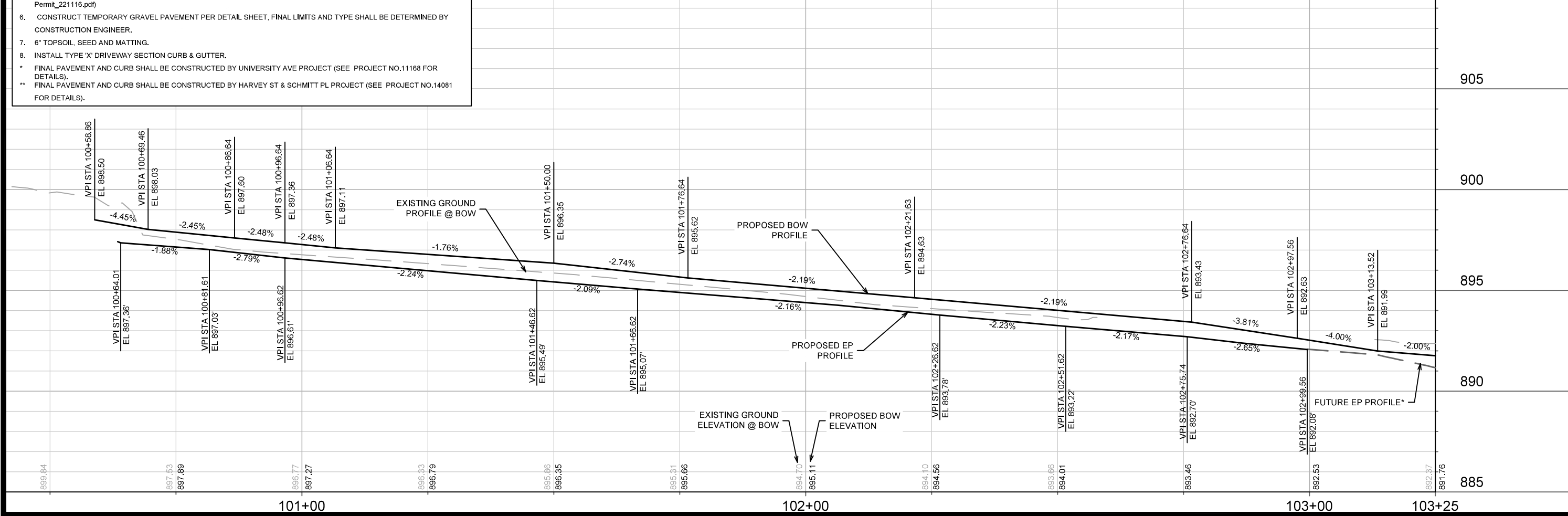

MARK	REVISION	DATE	BY
14202		6/20/2023 9:17 AM	
<p>14202 MADISON, WI CONTRACT NO: 9187</p>			<p>14202 P-1</p>

STREET PLAN & PROFILE - SCHMITT PLACE
 3005 UNIVERSITY AVENUE
 M:\DESIGN\Projects\14202\CAD\Streets\14202EN-PrP.dwg

CITY OF MADISON WISCONSIN

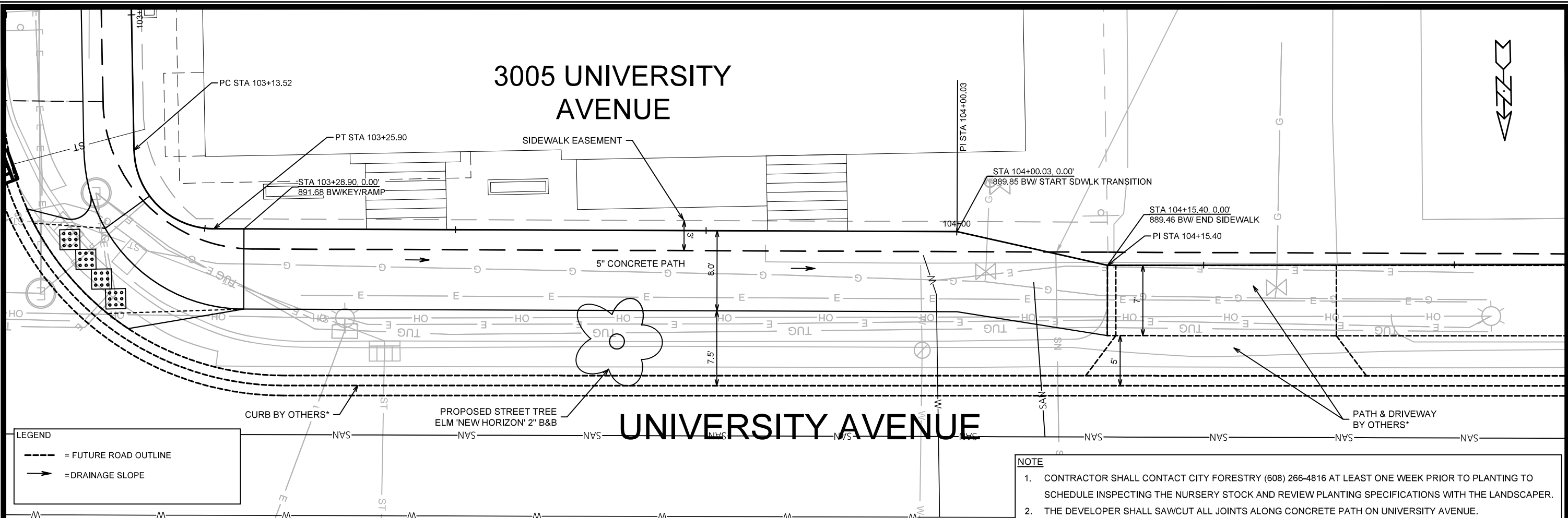

LEGEND

- - - = FUTURE ROAD OUTLINE
- = DRAINAGE SLOPE

NOTE

- CONTRACTOR SHALL CONTACT CITY FORESTRY (608) 266-4816 AT LEAST ONE WEEK PRIOR TO PLANTING TO SCHEDULE INSPECTING THE NURSERY STOCK AND REVIEW PLANTING SPECIFICATIONS WITH THE LANDSCAPER.
- THE DEVELOPER SHALL SAWCUT ALL JOINTS ALONG CONCRETE PATH ON UNIVERSITY AVENUE.

* FINAL PAVEMENT AND CURB SHALL BE CONSTRUCTED BY UNIVERSITY AVE PROJECT (SEE PROJECT NO.11168 FOR DETAILS).

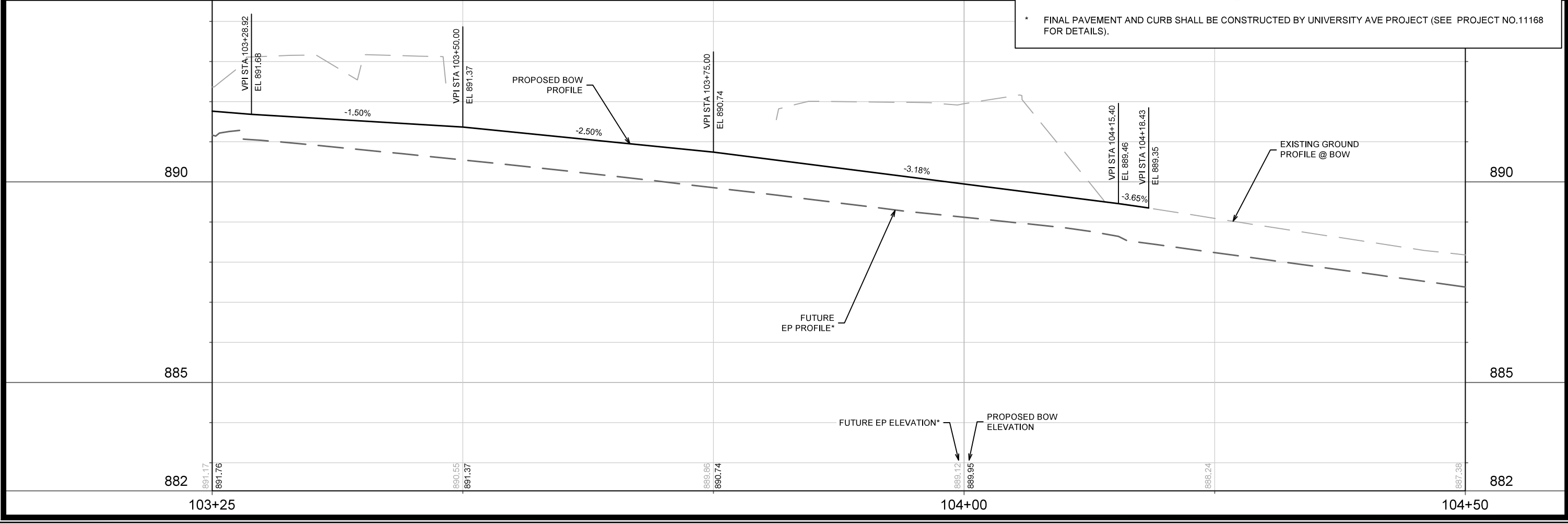

14202	MADISON, WI	9187	CONTRACT NO:
STREET PLAN & PROFILE - UNIVERSITY AVENUE			
3005 UNIVERSITY AVENUE			
M:\DESIGN\Projects\14202\CAD\Streets\14202EN-PrP.dwg			
14202		P-2	

15 Jan 2024 - 4:35pm M:\ltd development\190018_2005 university avenue\190018_Site Utility Plans.dwg by: zdre

SEE SHEET 4.1 - UTILITY PLAN - NORTH

SEE SHEET 4.2 - UTILITY PLAN - SOUTH

NOTE: PROPOSED SIDEWALK IMPROVEMENTS ALONG UNIVERSITY AVE TO TIE INTO FUTURE UNIVERSITY AVE IMPROVEMENTS PER WISDOT PROJECT #5992-11-31 PLANS

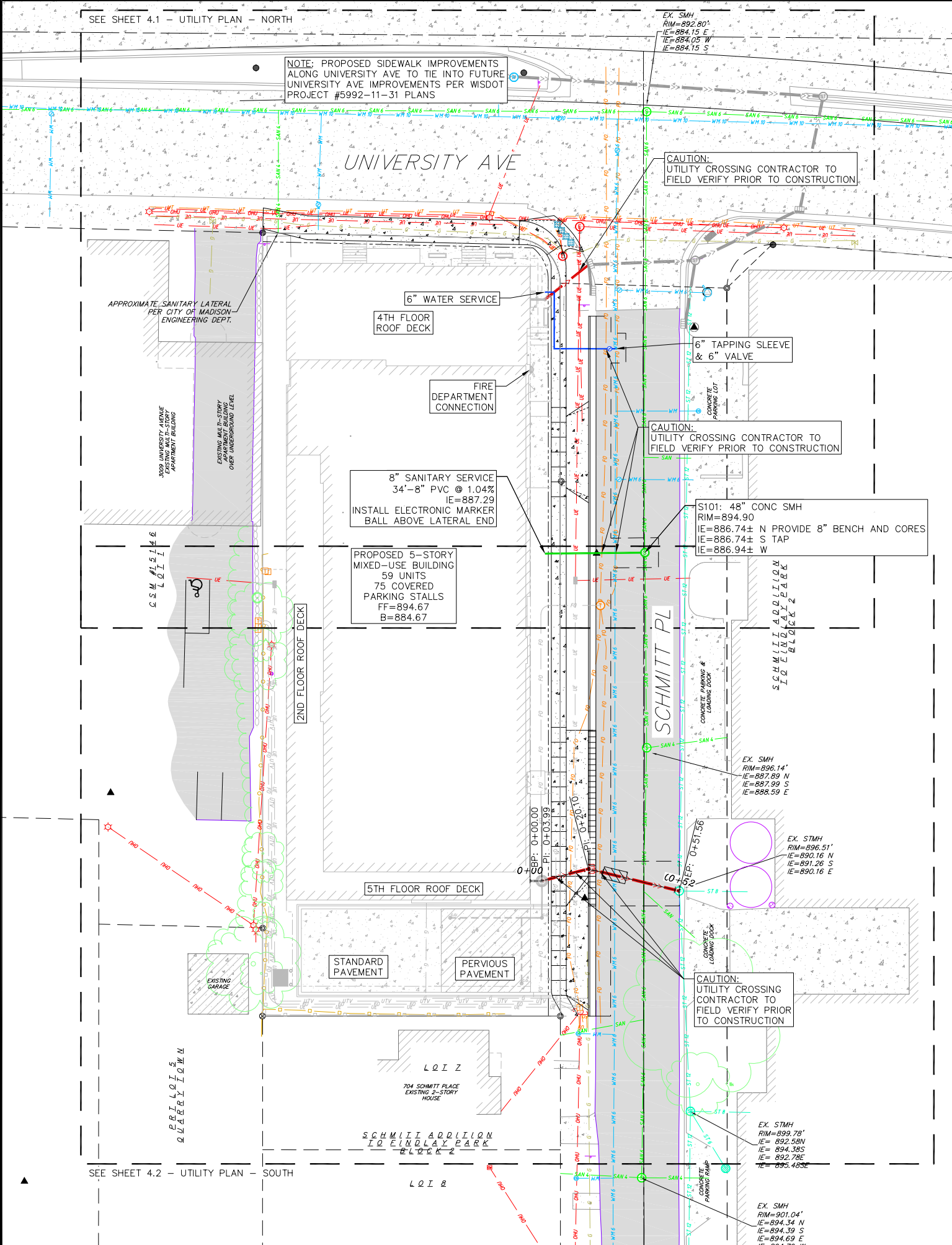

TOPOGRAPHIC SYMBOL LEGEND

- EXISTING BOLLARD
EXISTING POST
EXISTING SIGN (TYPE NOTED)
EXISTING CURB INLET
EXISTING FIELD INLET RECTANGULAR
EXISTING FIELD INLET
EXISTING ROOF DRAIN
EXISTING STORM MANHOLE
EXISTING STORM MANHOLE RECTANGULAR
EXISTING SANITARY MANHOLE
EXISTING FIRE HYDRANT
EXISTING WATER MAIN VALVE
EXISTING CURB STOP
EXISTING WATER MANHOLE
EXISTING GAS VALVE
EXISTING GAS METER
EXISTING AIR CONDITIONING PEDESTAL
EXISTING DOWN GUY
EXISTING ELECTRIC MANHOLE
EXISTING ELECTRIC RECTANGULAR MANHOLE
EXISTING ELECTRIC PEDESTAL
EXISTING TRANSFORMER
EXISTING ELECTRIC METER
EXISTING GUY POLE
EXISTING LIGHT POLE
EXISTING GENERIC LIGHT
EXISTING UTILITY POLE
EXISTING TV MANHOLE
EXISTING TV RECTANGULAR MANHOLE
EXISTING TV PEDESTAL
EXISTING TELEPHONE MANHOLE
EXISTING TELEPHONE PEDESTAL
EXISTING UNIDENTIFIED MANHOLE
EXISTING UNIDENTIFIED UTILITY VAULT
EXISTING HANDICAP PARKING
EXISTING TRAFFIC SIGNAL
EXISTING SHRUB
EXISTING CONIFEROUS TREE
EXISTING DECIDUOUS TREE

TOPOGRAPHIC LINEWORK LEGEND

- EXISTING UNDERGROUND CABLE TV
EXISTING OVERHEAD CABLE TV
EXISTING FIBER OPTIC LINE
EXISTING OVERHEAD TELEPHONE LINE
EXISTING UNDERGROUND TELEPHONE
EXISTING RETAINING WALL
EXISTING CHAIN LINK FENCE
EXISTING GENERAL FENCE
EXISTING WIRE FENCE
EXISTING WOOD FENCE
EXISTING GAS LINE
EXISTING UNDERGROUND ELECTRIC LINE
EXISTING GUY LINE
EXISTING OVERHEAD ELECTRIC LINE
EXISTING OVERHEAD GENERAL UTILITIES
EXISTING SANITARY SEWER LINE (SIZE NOTED)
EXISTING STORM SEWER LINE (SIZE NOTED)
EXISTING WATER MAIN (SIZE NOTED)

PROPOSED UTILITY LEGEND

- STORM SEWER PIPE
STORM SEWER MANHOLE
STORM SEWER CURB INLET
STORM SEWER FIELD INLET
ROOF DRAIN CLEANOUT
SANITARY SEWER LATERAL PIPE
SANITARY SEWER CLEANOUT
WATER SERVICE LATERAL PIPE
FIRE HYDRANT
WATER VALVE
PROPOSED PIPE INSULATION
GAS MAIN
ELECTRIC SERVICE

ABBREVIATIONS

- STMH - STORM MANHOLE
FI - FIELD INLET
CI - CURB INLET
CB - CATCH BASIN
EW - ENDWALL
SMH - SANITARY MANHOLE

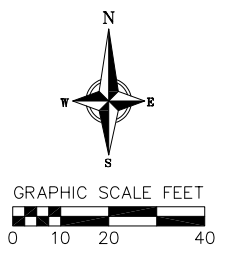

UTILITY NOTES:

- 1. CONTRACTOR SHALL OBTAIN ANY NECESSARY WORK IN RIGHT OF WAY, EXCAVATION, UTILITY CONNECTION, PLUGGING AND ABANDONMENT PERMITS PRIOR TO CONSTRUCTION.
2. CONTRACTOR TO VERIFY EXISTING UTILITY LOCATIONS AND ELEVATIONS PRIOR TO STARTING WORK.
3. SANITARY & STORM SEWER LENGTHS SHOWN ARE FROM CENTER OF STRUCTURE TO CENTER OF STRUCTURE. STORM SEWER END SECTIONS ARE INCLUDED IN THE LENGTH AND SLOPE OF THE PIPE.
4. CONTRACTOR SHALL INVESTIGATE ALL UTILITY CROSSINGS PRIOR TO CONSTRUCTION AND NOTIFY ENGINEER OF ANY CONFLICTS.
5. CONTRACTOR SHALL BE RESPONSIBLE FOR ADJUSTING ALL UTILITY STRUCTURES TO FINISHED GRADE (MANHOLE RIMS, WATER VALVES, AND CURB STOPS), IF NECESSARY.
6. IF DEWATERING OPERATIONS EXCEED 70 GALLONS PER MINUTE OF PUMPING CAPACITY, A DEWATERING WELL PERMIT SHALL BE OBTAINED PRIOR TO STARTING ANY DEWATERING ACTIVITIES.
7. A COPY OF THE APPROVED UTILITY PLANS, SPECIFICATIONS AND PLUMBING PERMIT APPROVAL LETTER SHALL BE ON-SITE DURING CONSTRUCTION AND OPEN TO INSPECTION BY AUTHORIZED REPRESENTATIVES OF THE DEPARTMENT OF SAFETY AND PROFESSIONAL SERVICES AND OTHER LOCAL INSPECTORS.
8. PROPOSED UTILITY SERVICE LINES SHOWN ARE APPROXIMATE. COORDINATE THE EXACT LOCATIONS WITH THE PLUMBING DRAWINGS. COORDINATE THE LOCATION WITH THE PLUMBING CONTRACTOR AND/OR OWNER'S CONSTRUCTION REPRESENTATIVE PRIOR TO INSTALLATION OF ANY NEW UTILITIES.
9. STORM BUILDING SEWER PIPE SHALL CONFORM TO ONE OF THE STANDARDS LISTED IN TABLE 384.30-6 OF SPS 384.30(3)(c).
10. UNDERGROUND DRAIN AND VENT PIPE/TUBING SHALL CONFORM TO ONE OF THE STANDARDS LISTED IN TABLE 384.30-2 OF SPS 384.30(2).
11. PRIVATE WATER SERVICES AND PRIVATE WATER MAINS SHALL CONFORM TO ONE OF THE STANDARDS LISTED IN TABLE 384.30-7 OF SPS 384.30(4)(d).
12. PRIVATE SANITARY SEWER AND LATERALS SHALL BE POLYVINYL CHLORIDE (PVC) ASTM D3034 - SDR 35 OR APPROVED EQUAL MATERIAL THAT CONFORMS TO ONE OF THE STANDARDS LISTED IN TABLE 384.30-3 OF SPS 384.30(2)(c).
13. A MEANS TO LOCATE BURIED UNDERGROUND EXTERIOR NON METALLIC SEWERS/MAINS AND WATER SERVICES/MAINS MUST BE PROVIDED WITH TRACER WIRE OR OTHER METHODS IN ORDER TO BE LOCATED PER SPS 382.10(11)(h) AND SPS 382.40(8)(k).

- 14. EXTERIOR WATER SUPPLY PIPING SETBACKS AND CROSSINGS SHALL BE IN ACCORDANCE WITH SPS 382.40(8)(b).
15. NO PERSON MAY ENGAGE IN PLUMBING WORK IN THE STATE UNLESS LICENSED TO DO SO BY THE DEPARTMENT OF SAFETY AND PROFESSIONAL SERVICES PER S.145.06.
16. SITE CONTRACTOR SHALL LEAVE SANITARY AND WATER LATERALS FIVE (5) FEET SHORT (HORIZONTALLY) FROM THE BUILDING. BUILDING PLUMBER SHALL VERIFY SIZE, LOCATION, AND INVERT ELEVATION OF PROPOSED SANITARY AND WATER LATERALS.
17. IT IS THE CONTRACTOR'S RESPONSIBILITY TO VERIFY THAT THE EXISTING VALVES WILL HOLD THE PRESSURE TEST PRIOR TO CONNECTION. THE CITY IS NOT RESPONSIBLE FOR ANY COSTS INCURRED DUE TO THE CONTRACTOR NOT VERIFYING THAT THE EXISTING VALVE WILL HOLD THE PRESSURE TEST PRIOR TO CONNECTION. IF A NEW VALVE IS REQUIRED, THE APPLICANT WILL BE REQUIRED TO INSTALL ONE AT THEIR EXPENSE, AT THE POINT OF CONNECTION.
18. CONTRACTOR TO CHLORINATE AND BACTERIA TEST BEFORE DOMESTIC SUPPLY PURPOSES
19. CLEAN OUT ALL EXISTING AND PROPOSED STORM INLETS AND CATCH BASINS AT THE COMPLETION OF CONSTRUCTION.
20. SANITARY SEWER MAIN AT BURY DEPTHS GREATER THAN 15' SHALL BE SDR 21. ALL OTHER SANITARY SEWER MAIN SHALL BE SDR 26.
21. CONTRACTOR SHALL COORDINATE WITH DRY UTILITY COMPANY'S REGARDING ANY POTENTIAL CONFLICTS AND COORDINATE RELOCATIONS AS MAY BE REQUIRED. CONTRACTOR SHALL ALSO COORDINATE THE PROPOSED INSTALLATION OF NEW FACILITIES AS REQUIRED.
22. ALL WATER MAIN AND SERVICES SHALL BE INSTALLED AT A MINIMUM DEPTH OF 6.5' FROM TOP OF FINISHED GRADE ELEVATION TO TOP OF MAIN. PROVIDE 1.5' CLEAR SEPARATION IF WATER CROSSES BELOW SEWER AND MINIMUM 0.5' IF WATER CROSSES ABOVE.

RIGHT-OF-WAY NOTES:

- 1. ALL WORK WITHIN THE PUBLIC RIGHT-OF-WAY AND ALL PUBLIC IMPROVEMENTS NECESSARY TO SERVE THE PROJECT ARE TO BE COMPLETED PER THE CITY/DEVELOPER AGREEMENT AND THE CITY ISSUED PLANS, PROJECT #14202, CONTRACT #9187.
2. THE RIGHT-OF-WAY IS THE SOLE JURISDICTION OF THE CITY OF MADISON AND IS SUBJECT TO CHANGE AT ANYTIME PER THE RECOMMENDATION/PLAN OF TRAFFIC ENGINEERING AND CITY ENGINEERING DEPTS.

Table with columns for REVISIONS (NO., DATE, REMARKS) and PROJECT NO. (190018). Includes a date of 06/14/2023 and drafter name ZDRE.

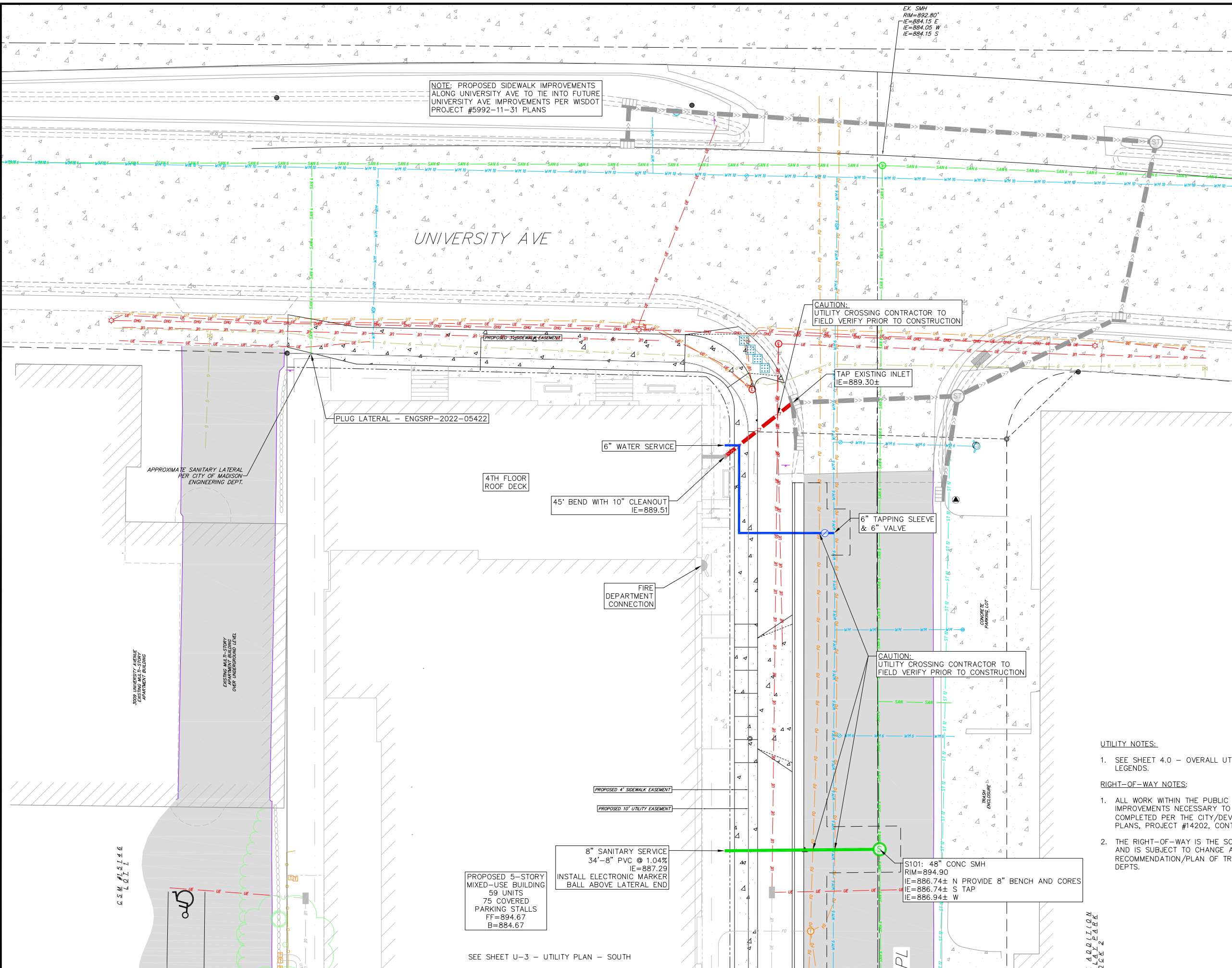

NOTE: PROPOSED SIDEWALK IMPROVEMENTS ALONG UNIVERSITY AVE TO TIE INTO FUTURE UNIVERSITY AVE IMPROVEMENTS PER WISDOT PROJECT #5992-11-31 PLANS

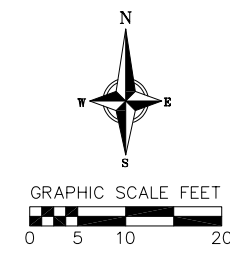

CAUTION: UTILITY CROSSING CONTRACTOR TO FIELD VERIFY PRIOR TO CONSTRUCTION

TAP EXISTING INLET IE=889.30±

PLUG LATERAL - ENSRP-2022-05422

6" WATER SERVICE

45' BEND WITH 10" CLEANOUT IE=889.51

6" TAPPING SLEEVE & 6" VALVE

FIRE DEPARTMENT CONNECTION

CAUTION: UTILITY CROSSING CONTRACTOR TO FIELD VERIFY PRIOR TO CONSTRUCTION

PROPOSED 4" SIDEWALK EASEMENT

PROPOSED 10' UTILITY EASEMENT

PROPOSED 5-STORY MIXED-USE BUILDING 59 UNITS 75 COVERED PARKING STALLS FF=894.67 B=884.67

8" SANITARY SERVICE 34'-8" PVC @ 1.04% IE=887.29 INSTALL ELECTRONIC MARKER BALL ABOVE LATERAL END

S101: 48" CONC SMH RIM=894.90 IE=886.74± N PROVIDE 8" BENCH AND CORES IE=886.74± S TAP IE=886.94± W

- UTILITY NOTES:**
- SEE SHEET 4.0 - OVERALL UTILITY PLAN FOR UTILITY NOTES AND LEGENDS.
- RIGHT-OF-WAY NOTES:**
- ALL WORK WITHIN THE PUBLIC RIGHT-OF-WAY AND ALL PUBLIC IMPROVEMENTS NECESSARY TO SERVE THE PROJECT ARE TO BE COMPLETED PER THE CITY/DEVELOPER AGREEMENT AND THE CITY ISSUED PLANS, PROJECT #14202, CONTRACT #9187.
 - THE RIGHT-OF-WAY IS THE SOLE JURISDICTION OF THE CITY OF MADISON AND IS SUBJECT TO CHANGE AT ANYTIME PER THE RECOMMENDATION/PLAN OF TRAFFIC ENGINEERING AND CITY ENGINEERING DEPTS.

SEE SHEET U-3 - UTILITY PLAN - SOUTH

REVISIONS		REVISIONS		DATE	
NO.	DATE	NO.	DATE	NO.	DATE

DATE: 06/14/2023
DRAFTER: ZDRE
CHECKED: JZAM
PROJECT NO.: 190018

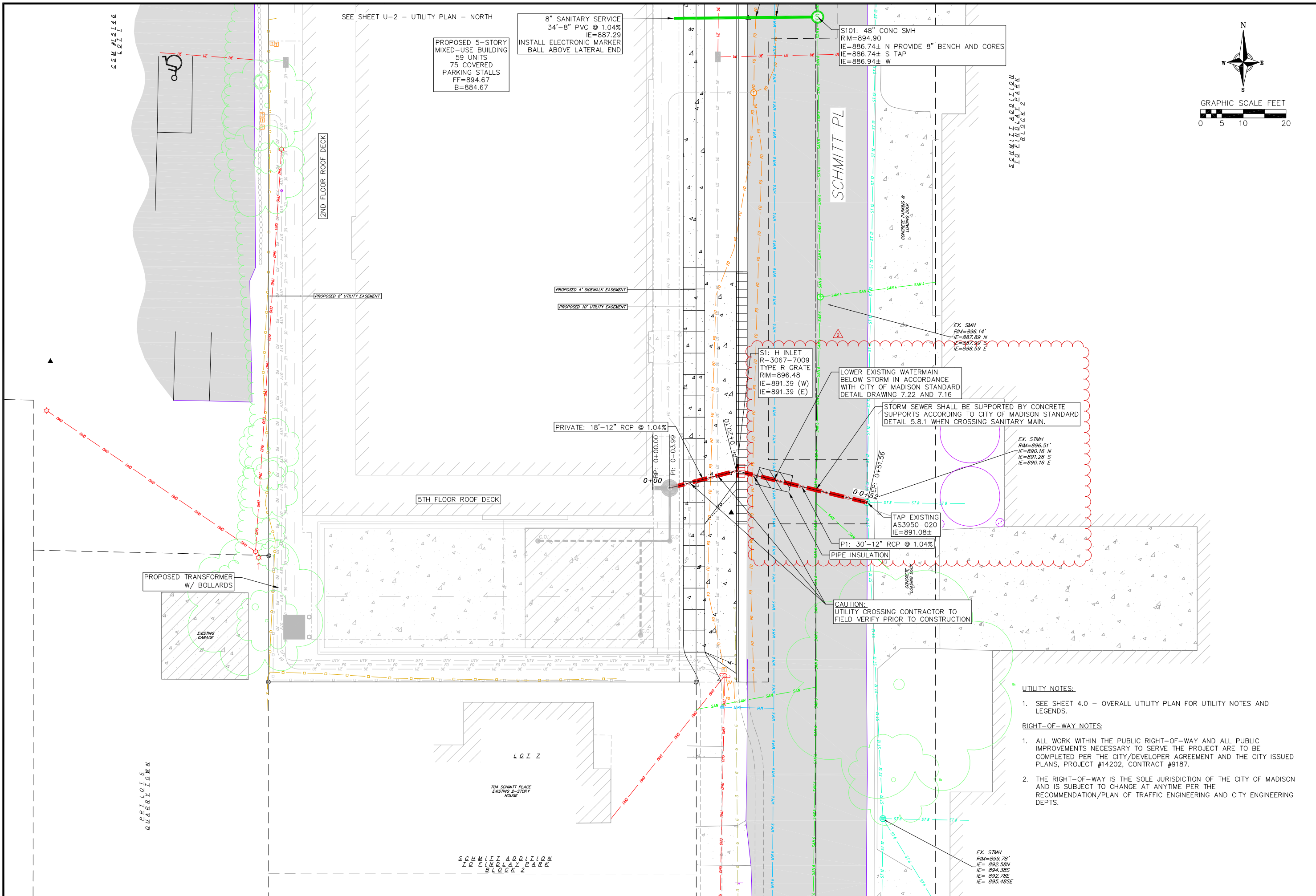

REVISIONS		REVISIONS	
NO.	DATE	NO.	DATE
1	09/18/2023		
2	01/15/2024		

DATE: 06/14/2023
DRAFTER: ZDRE
CHECKED: JZAM
PROJECT NO.: 190018

NOTE:
 1. FINAL PAVEMENT SURFACE BY HARVEY ST & SCHMITT
 PL PROJECT (SEE PROJECT NO.14081 FOR DETAILS).

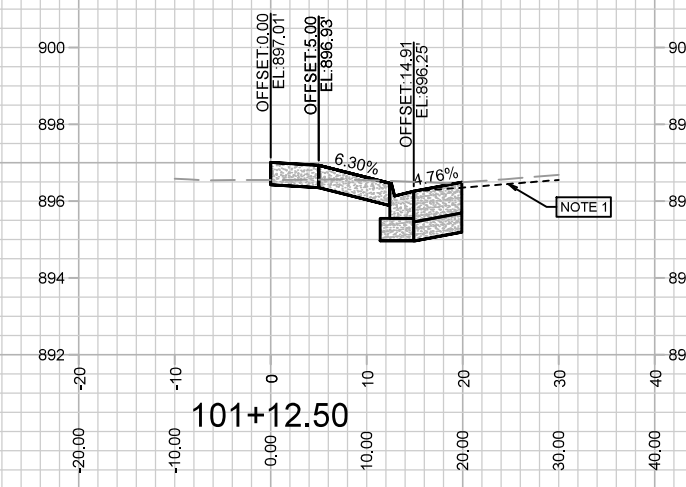
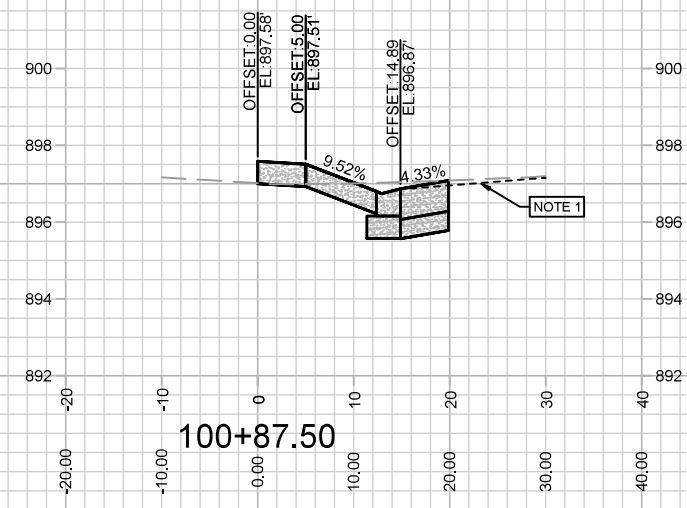
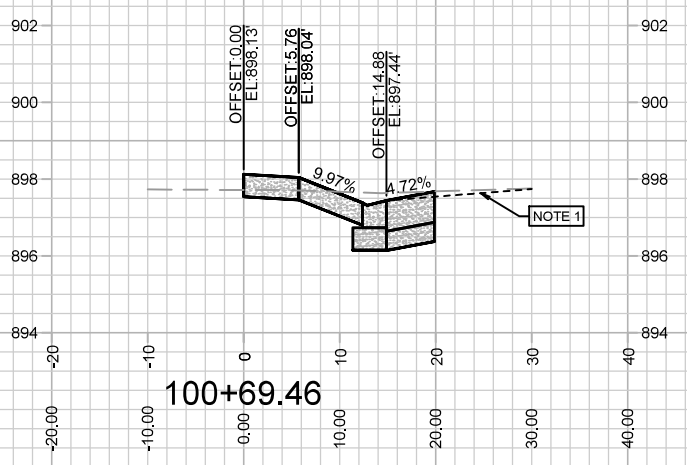
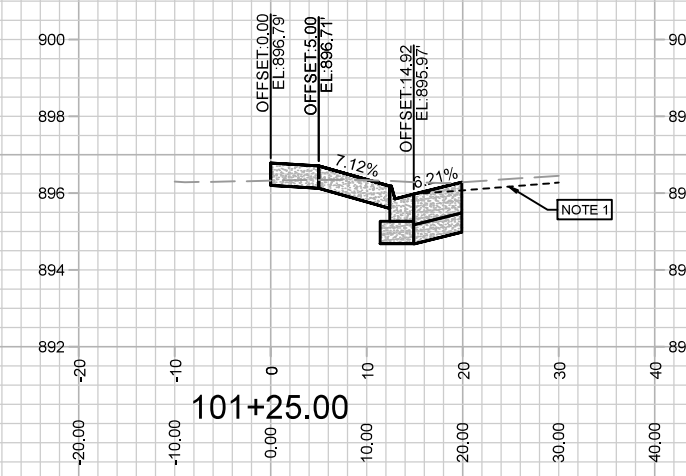
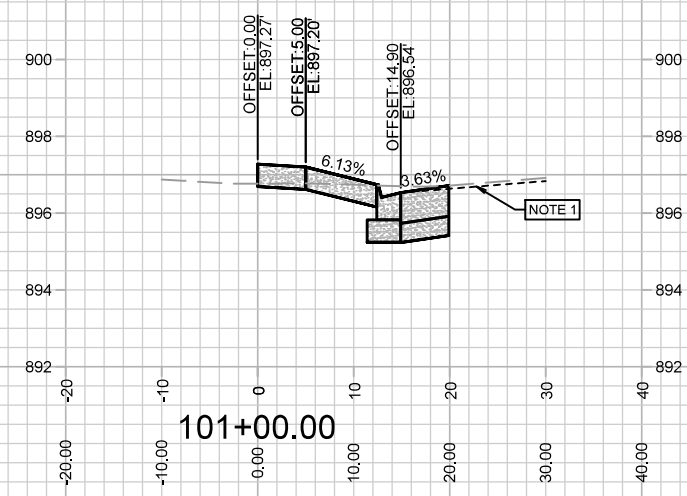
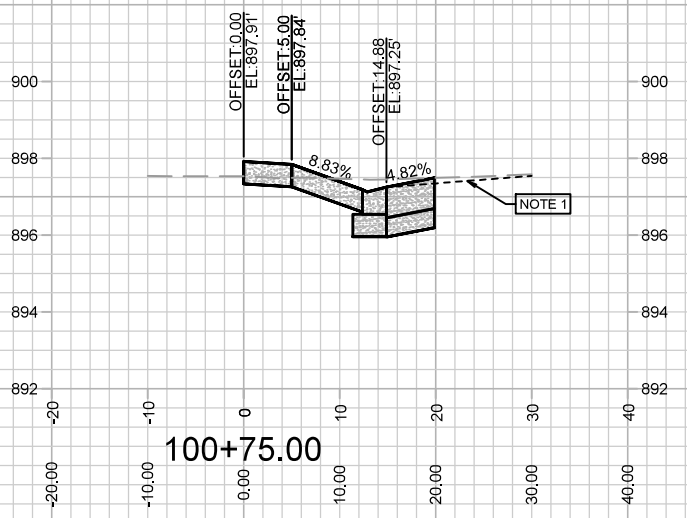

MARK	REVISION	DATE	BY

CROSS SECTIONS
 14202
 3005 UNIVERSITY AVENUE
 MADISON, WI
 9187
 CONTRACT NO:

M:\DESIGN\Projects\14202\CAD\Streets\14202EN-AI\Prof&Corridor_Setup.dwg

14202
 X-1

NOTE:
 1. FINAL PAVEMENT SURFACE BY HARVEY ST & SCHMITT
 PL PROJECT (SEE PROJECT NO.14081 FOR DETAILS).

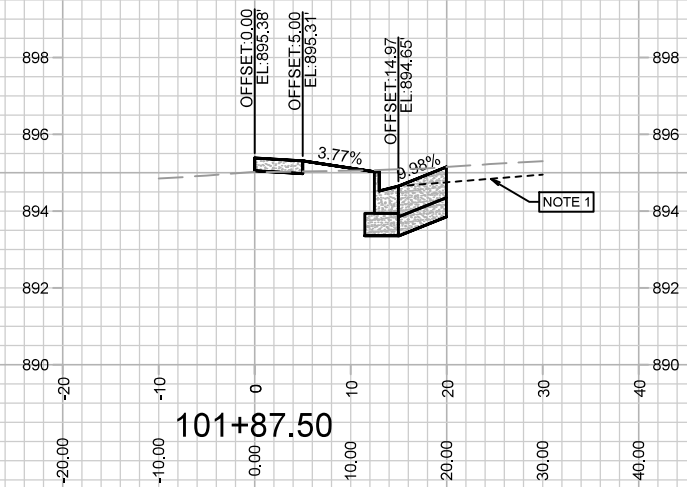
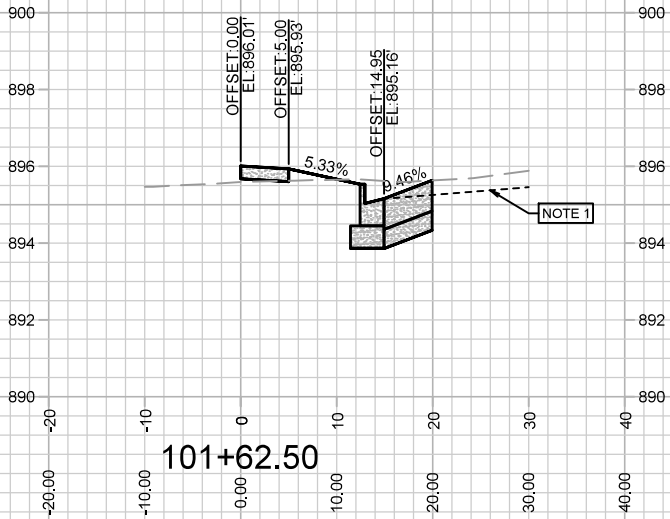
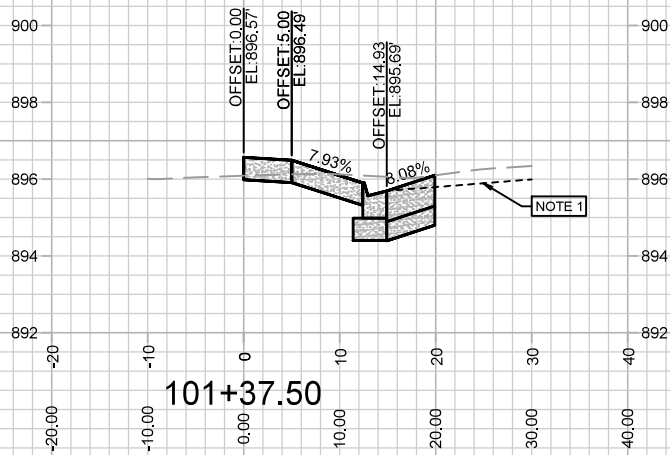
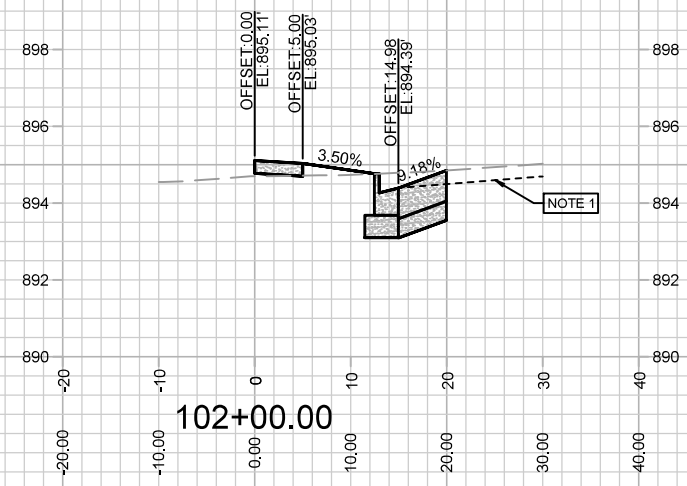
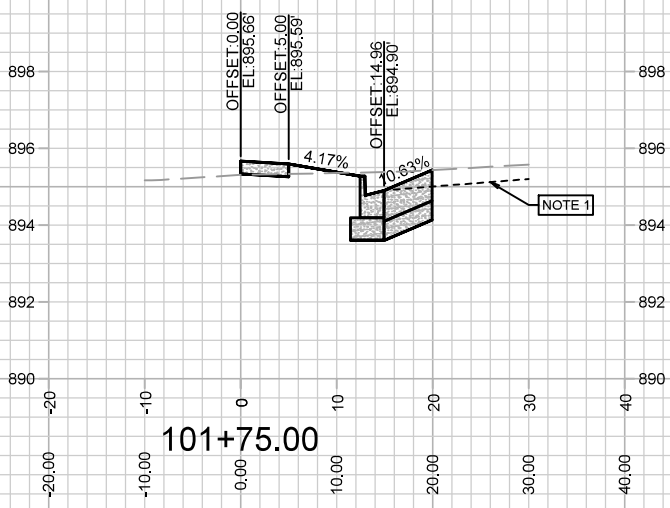
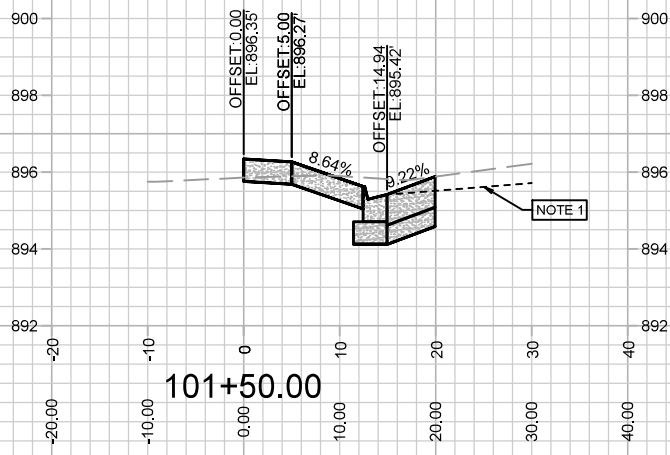

MARK	REVISION	DATE	BY
14202	6/16/2023 1:38 PM		

Scale: 1" = 20'

CROSS SECTIONS
 14202
 3005 UNIVERSITY AVENUE
 MADISON, WI
 CONTRACT NO: 9187

M:\DESIGN\Projects\14202\CAD\Streets\14202EN-AIP\Prof&Corridor_Setup.dwg

NOTE:
 1. FINAL PAVEMENT SURFACE BY HARVEY ST & SCHMITT
 PL PROJECT (SEE PROJECT NO.14081 FOR DETAILS).

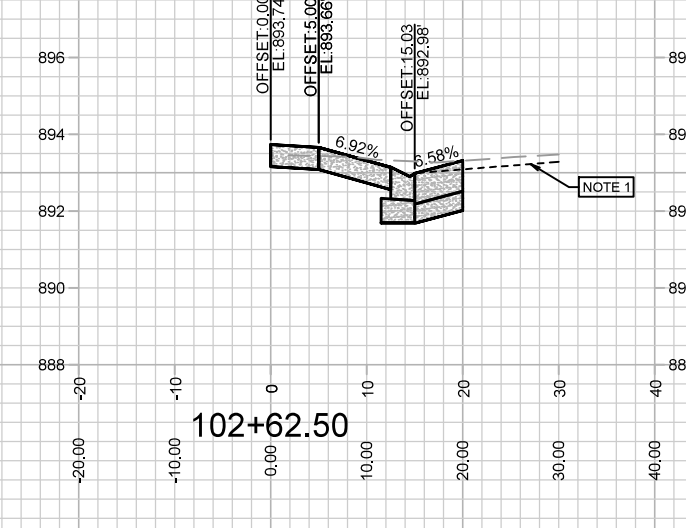
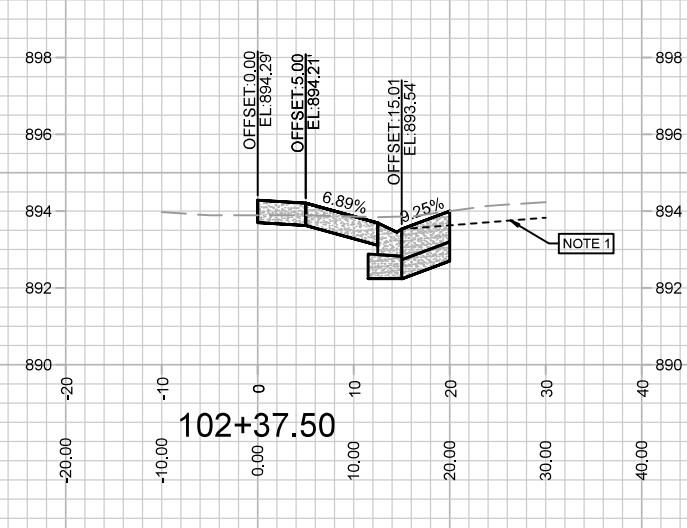
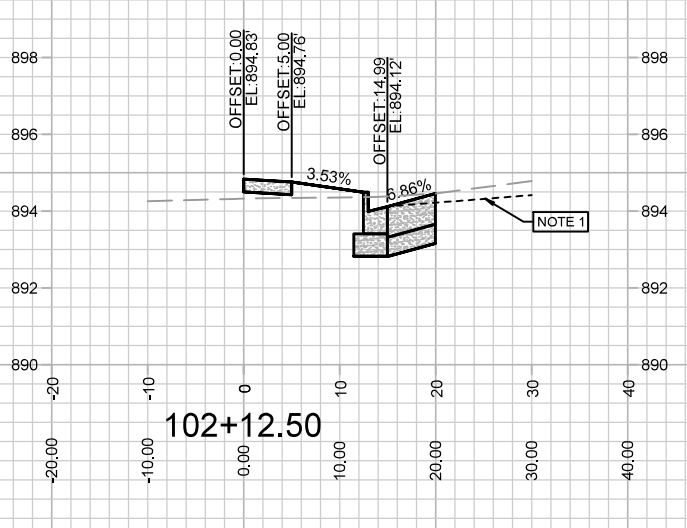
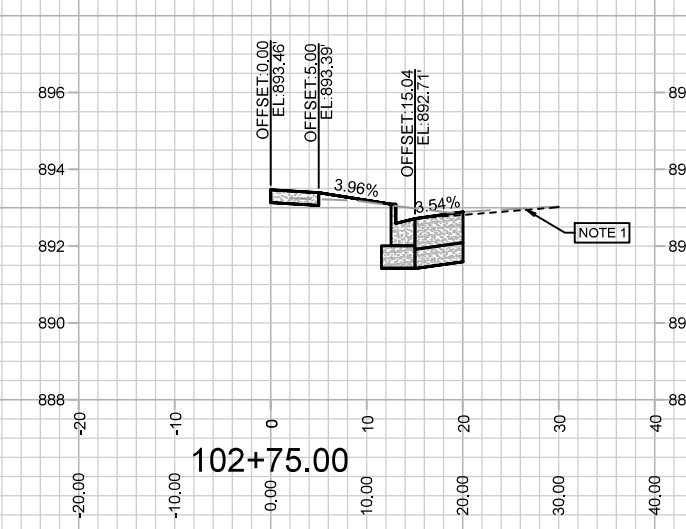
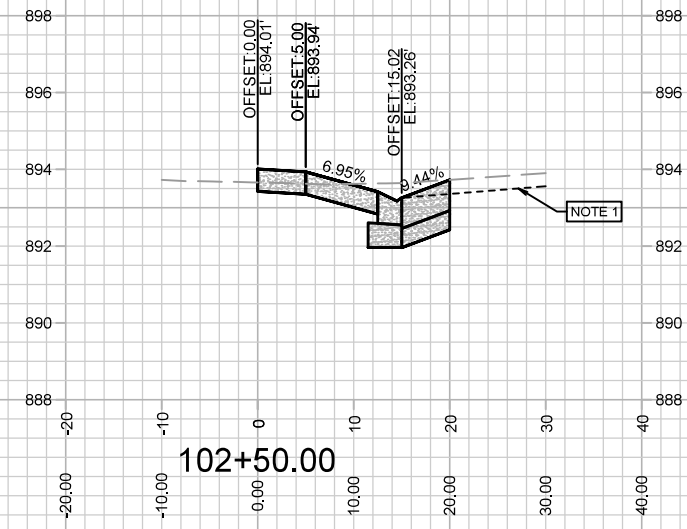
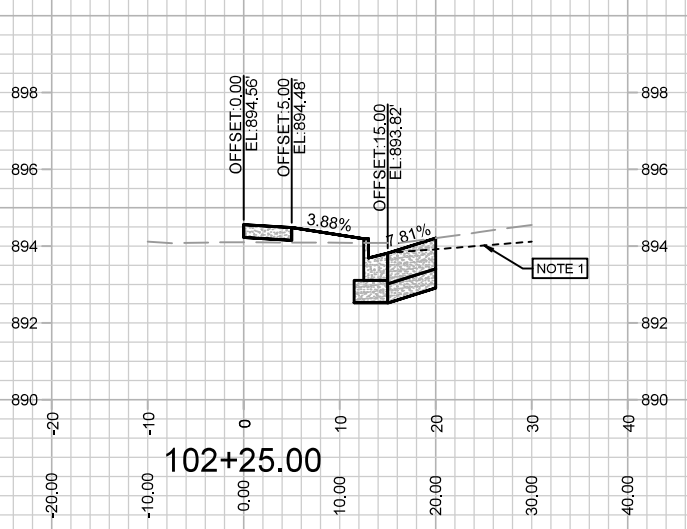

MARK	REVISION	DATE	BY
14202 <td></td> <td>6/20/2023 10:17 AM <td></td> </td>		6/20/2023 10:17 AM <td></td>	

Scale: 1" = 20'

CROSS SECTIONS
 14202
 3005 UNIVERSITY AVENUE
 MADISON, WI
 CONTRACT NO: 9187

M:\DESIGN\Projects\14202\CAD\Streets\14202EN-AIP\Prof&Corridor_Setup.dwg

NOTE:
 1. FINAL PAVEMENT AND CURB BY UNIVERSITY AVE PROJECT (SEE PROJECT NO.11168 FOR DETAILS).

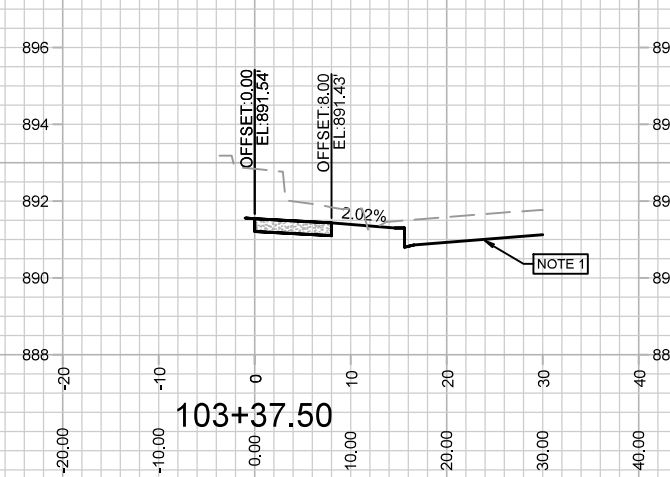
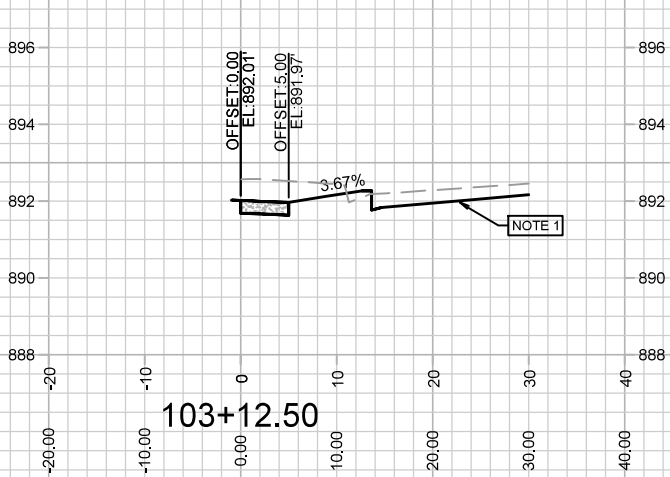
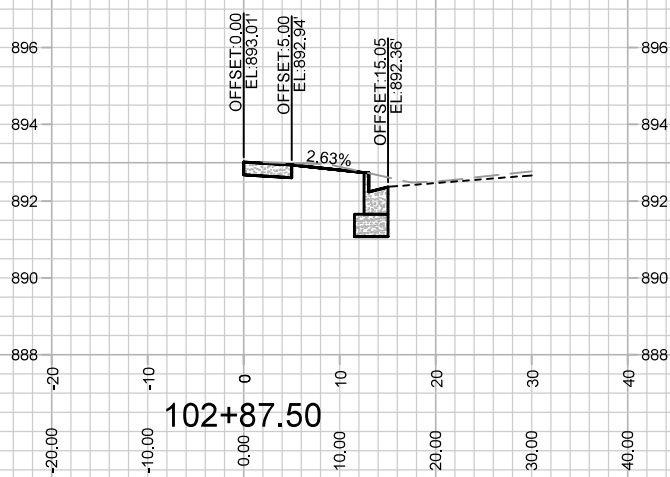
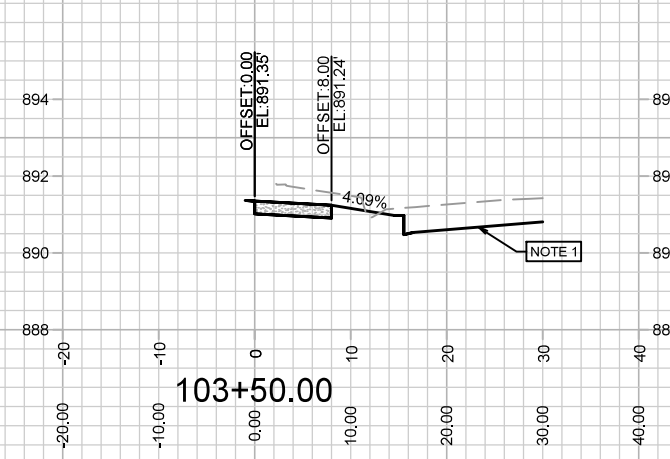
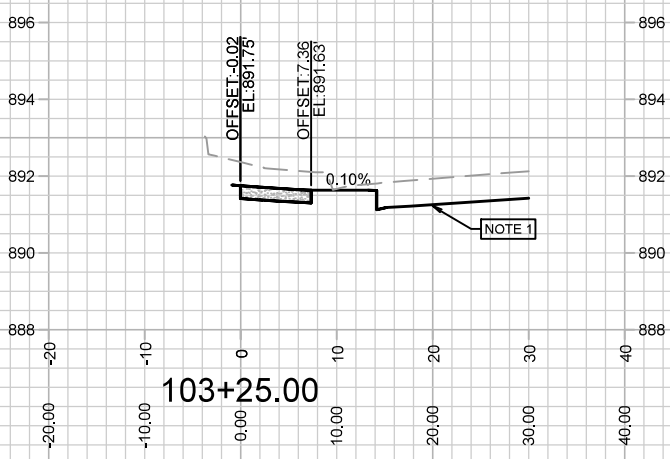
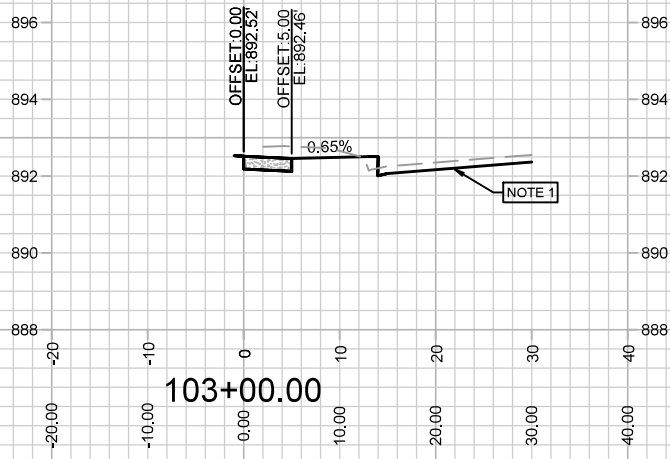

MARK	REVISION	DATE	BY
---	---	---	---
---	---	---	---
---	---	---	---

14202
 MADISON, WI
 9187

CONTRACT NO:
 14202EN-AIProf&Corridor_Setup.dwg



14202
 X-4

NOTE:
 1. FINAL PAVEMENT AND CURB BY UNIVERSITY AVE
 PROJECT (SEE PROJECT NO.11168 FOR DETAILS).

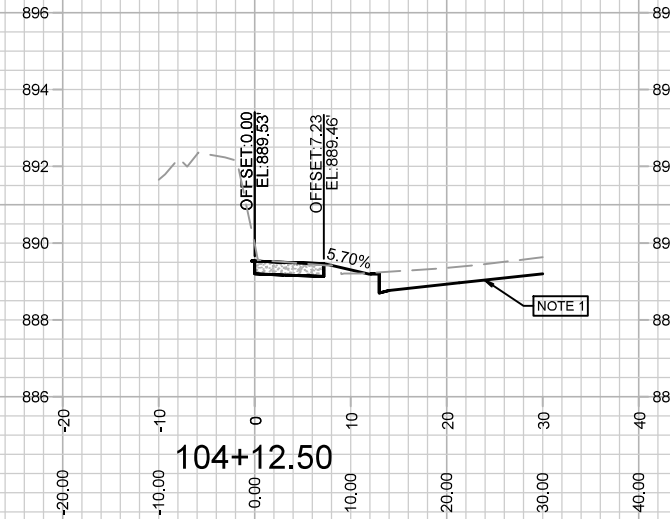
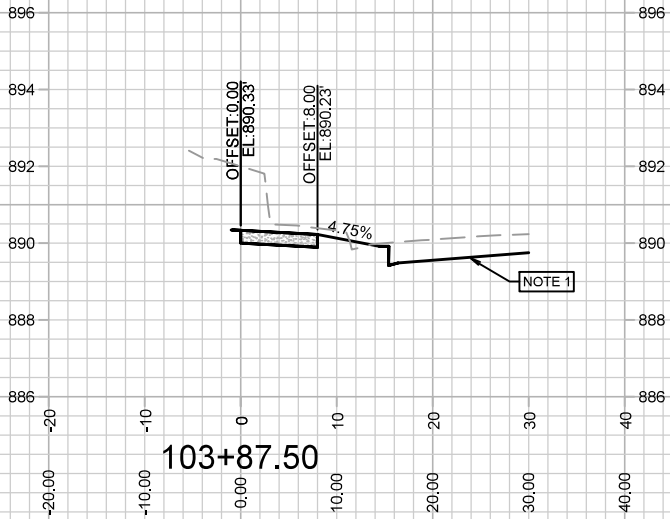
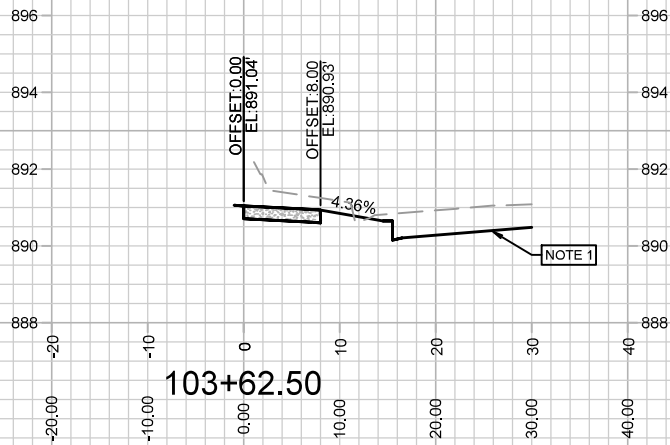
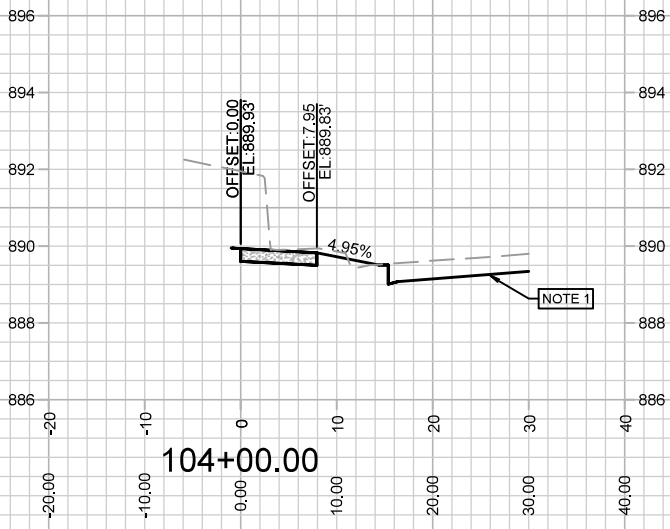
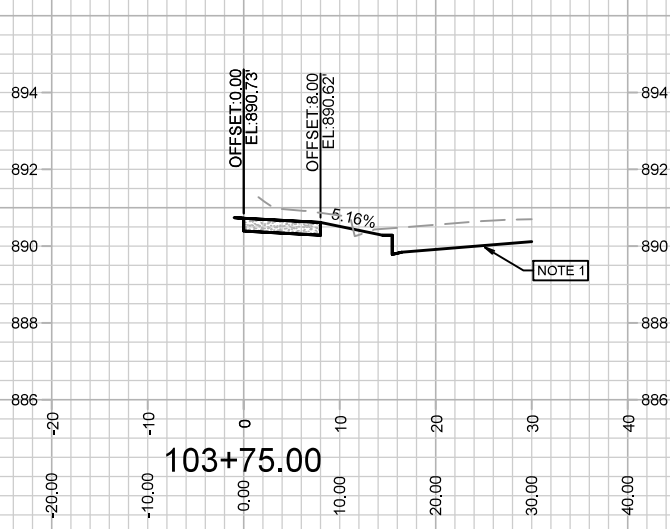

MARK	REVISION	DATE	BY

14202
 MADISON, WI
 9187
 CONTRACT NO:

CROSS SECTIONS
 3005 UNIVERSITY AVENUE
 M:\DESIGN\Projects\14202\CAD\Streets\14202EN-AIP\Prof&Corridor_Setup.dwg



14202
 X-5

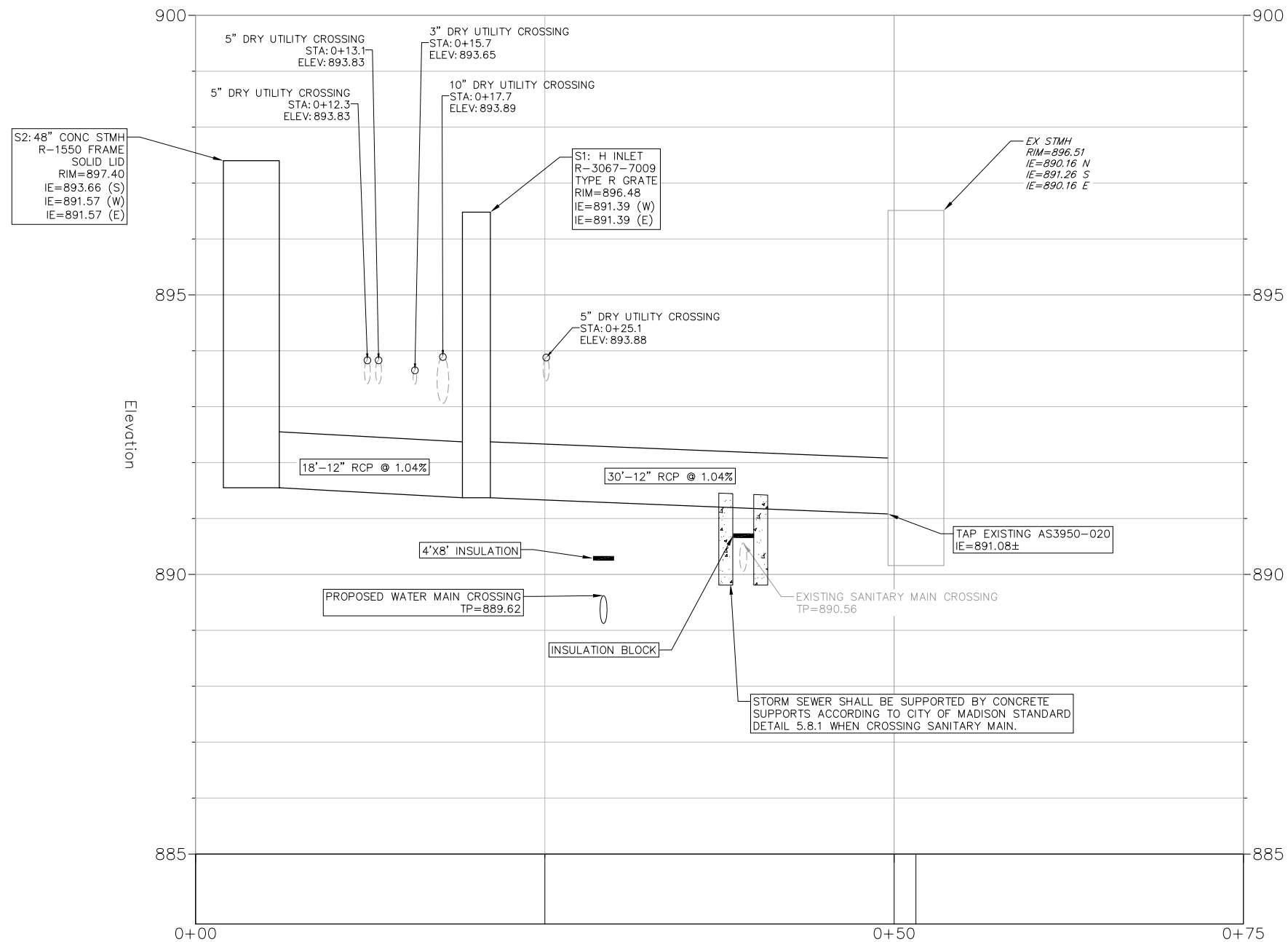
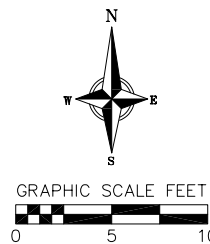
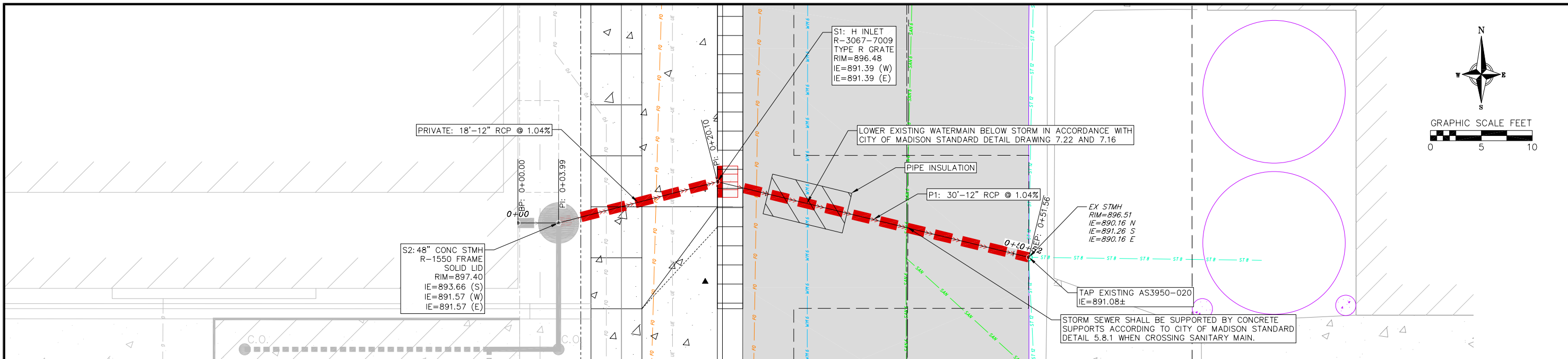

Storm Sewer Profile
3007 University Avenue
City of Madison
Dane County, Wisconsin

REVISIONS		REVISIONS	
NO.	DATE	NO.	DATE

DATE: 01/11/2024
DRAFTER: ZDRE
CHECKED: JZAM
PROJECT NO.: 190018