



Madison, Wisconsin

CITY OF MADISON

CITY ENGINEERING DIVISION

DEPARTMENT OF PUBLIC WORKS

PLAN OF PROPOSED IMPROVEMENT

INDEX OF SHEETS

SHEET NO.	NOTES & TYPICAL SECTION
D1	OHMEDA DRIVE PLAN & PROFILES
PI-P2	STORM SEWER SCHEDULE
U1	FEMRITE DRIVE SIDEWALK CROSS SECTIONS
X1-X8	

PLAN REV #1 1-5-2024
- ADDED WATER MAIN SHEET

3030 OHMEDA DRIVE CSM

(SIDEWALK PLAN ALONG FEMRITE DRIVE)

CITY PROJECT NO. 13825

CONTRACT NO. 9802

PROJECT LOCATION

CONVENTIONAL SIGNS	
FIELD VERIFY ALL UTILITY LOCATIONS	
GAS	— G —
STORM SEWER	— ST —
SANITARY SEWER	— SN —
WATER	— W —
BURIED ELECTRIC	— E —
OVERHEAD ELECTRIC	— OH —
POWER POLE	□
ADA COMPLIANT RAMP W/ DETECTABLE WARNING FIELD	▤
COMBUSTIBLE FLUIDS	☀

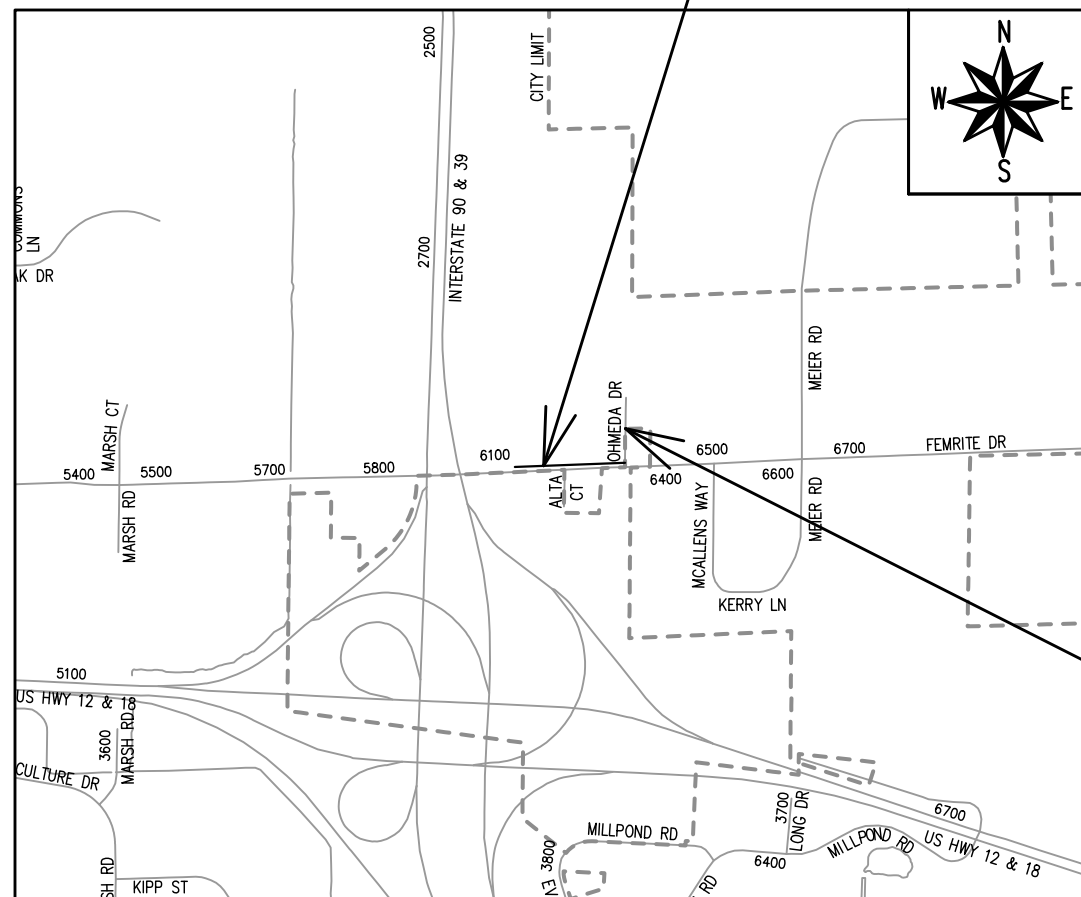

OHMEDA DRIVE STREET PLANS
(SEE PROJECT NO. 13810, CONTRACT NO. 8631)

PUBLIC IMPROVEMENT PROJECT APPROVED

APPROVED DATE: November 16, 2021

BY THE COMMON COUNCIL OF MADISON, WISCONSIN

PUBLIC IMPROVEMENT DESIGN APPROVED BY:

Sep 25, 2023

City Engineer

Date

STREET DESIGNED BY:

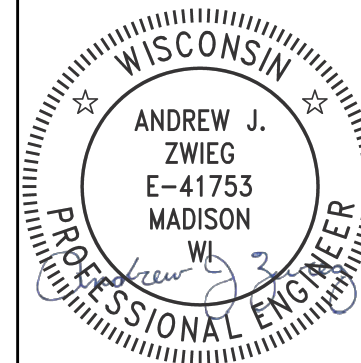

Sep 25, 2023

STORM SEWER DESIGNED BY:

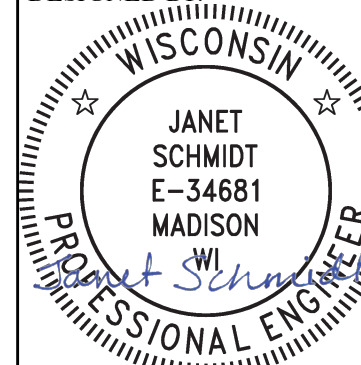

Sep 25, 2023

NOTES:

- ALL GUTTERS SHALL DRAIN WITH A MINIMUM GRADE OF 0.50% TOWARD STORM SEWER INLETS.
- SIDEWALK RAMPS SHALL HAVE A MAXIMUM SLOPE OF 1" PER 12". SIDEWALK AND CURB RAMPS SHALL BE CONSTRUCTED WITH A SIDE SLOPE OF 1.50%. SIDEWALK SHALL HAVE A MINIMUM LONGITUDINAL SLOPE OF 0.50% AND A MAXIMUM LONGITUDINAL SLOPE OF 5.00% EXCEPT WHERE STREET GRADES EXCEED 5.00%.
- CITY MAINTENANCE PLAN NOT REQUIRED.

PLOT SCALE: 1" IN: 1 FT_XREF

PLOT NAME: ---

REV. DATE: 9/18/2023 12:39 PM

ORIGINATOR: CITY_OF_MADISON

THE LOCATION AND INFORMATION FOR PROPOSED NEW TREES, IN THE PUBLIC RIGHT OF WAY OR ON PUBLIC LANDS ARE APPROXIMATE AND ARE SHOWN FOR REFERENCE ONLY. THE LOCATIONS, SPECIFICATIONS AND PLANTING METHODS OF ALL PROPOSED NEW OR REPLACEMENT TREES IN THE PUBLIC RIGHT OF WAY OR ON PUBLIC LANDS SHALL BE APPROVED BY THE CITY FORESTER PRIOR TO INSTALLATION.

NO TREES IN THE RIGHT OF WAY OR ON PUBLIC LANDS SHALL BE TRIMMED, PRUNED, REMOVED OR ADVERSELY AFFECTED IN ANY WAY UNTIL THE DEVELOPER HAS RECEIVED WRITTEN PERMISSION FROM THE CITY ENGINEER OR CITY FORESTER. SAID WRITTEN PERMISSION SHALL INCLUDE LANGUAGE INDICATING THAT SECTION 10.101 OF THE MADISON GENERAL ORDINANCES AND ADMINISTRATIVE PROCEDURE MEMORANDUM NO. 6-2, REFERRING TO NOTIFICATION OF PROPERTY OCCUPANTS AND/OR OWNERS, HAS BEEN COMPLIED WITH.

DEVELOPER MUST SUBMIT A TRAFFIC CONTROL PLAN TO CITY TRAFFIC ENGINEERING AT LEAST 14 DAYS PRIOR TO THE START OF WORK. WORK SHALL NOT PROCEED UNTIL AN APPROVED TRAFFIC CONTROL PLAN IS IN PLACE.

THE DEVELOPER SHALL PROVIDE, INSTALL AND MAINTAIN ALL STREET END BARRICADES, SIGNING AND TRAFFIC CONTROL, AS REQUIRED BY THE CITY TRAFFIC ENGINEER.

ALL PERMANENT SIGNING AND POSTING WILL BE DETERMINED AND PROVIDED BY THE TRAFFIC ENGINEERING DIVISION, FOLLOWING CONSTRUCTION OF THESE IMPROVEMENTS.

POWER POLES AND OTHER OBSTRUCTIONS SHALL BE MOVED TO PROVIDE 2 FEET MINIMUM OF CLEAR DISTANCE FROM ANY FACE OF CURB OR EDGE OF SIDEWALK.

THERE MAY BE EXISTING UTILITIES OR OTHER FEATURES WHICH ARE EITHER NOT SHOWN OR SHOWN INCORRECTLY ON THIS PLAN. IT IS THE RESPONSIBILITY OF THE DEVELOPER TO LOCATE AND IDENTIFY ALL UTILITIES AND TOPOGRAPHY WHICH MAY AFFECT THE CONSTRUCTION OF THESE IMPROVEMENTS.

ANY INFORMATION SHOWN ON THIS PLAN, WHICH IS NOT PART OF THIS RIGHT-OF-WAY PROJECT IS NOT FOR CONSTRUCTION BY THE DEVELOPMENT TEAM.

NO WORK REQUIRED WITHIN THE OHMEDA DRIVE AND FEMRITE DRIVE PAVEMENT.

UNDERDRAINS SHALL BE INSTALLED PER STANDARD DETAIL DRAWING 4.05 FOR 75' ON EACH SIDE OF THE LOW POINT, OR TO THE NEAREST CURB HIGH POINT. ALL UNDERDRAIN SHALL BE WRAPPED.

ALL GUTTERS SHALL DRAIN WITH A MINIMUM GRADE OF 0.5% TOWARD STORM SEWER INLETS.

ALL DITCHES SHALL DRAIN WITH A MINIMUM GRADE OF 0.5%

THE CROSS SLOPE OF SIDEWALKS AND BARRIER FREE SIDEWALK CURB RAMPS SHALL TYPICALLY BE 1.5%. THE LONGITUDINAL GRADE OF BARRIER FREE SIDEWALK CURB RAMPS SHALL NOT EXCEED 8.33%. ALL SIDEWALK RAMPS SHALL BE CONSTRUCTED ACCORDING TO S.D.D. 3.04. AT ALL OTHER LOCATIONS THE LONGITUDINAL GRADE OF SIDEWALKS SHALL NOT EXCEED 5.0 % OR THE ADJACENT STREET GRADE WHICHEVER IS GREATER NOR BE LESS THAN 0.5% AND SHALL DRAIN TOWARD STORM SEWER INLETS. SIDE SLOPES WITHIN TEN FEET OF A PUBLIC SIDEWALK SHALL NOT EXCEED 4:1. ALL SIDEWALK AND SIDEWALK RAMP ELEVATIONS AND GRADES SHALL BE FIELD VERIFIED AND SET TO COMPLY WITH THE CITY OF MADISON STANDARD SPECIFICATIONS AND THE A.D.A. GUIDELINES.

OBTAIN A PRINT OUT OF THE ALIGNMENTS FROM THE CITY PROJECT ENGINEER PRIOR TO STAKING THIS PROJECT.

CURB STATION AND OFFSETS SHALL BE TO THE EDGE OF PAVEMENT UNLESS OTHERWISE INDICATED. CURB ELEVATIONS SHALL BE TO THE EDGE OF PAVEMENT UNLESS OTHERWISE INDICATED.

PAVEMENT SAWCUTS SHALL BE AS DIRECTED BY THE CITY CONSTRUCTION ENGINEER. SAWCUTS SHOWN ON THE PLAN ARE APPROXIMATE.

ALL WORK IN THE RIGHT OF WAY AND PUBLIC EASEMENTS SHALL BE IN ACCORDANCE WITH THE CITY OF MADISON STANDARD SPECIFICATIONS FOR PUBLIC WORKS CONSTRUCTION.

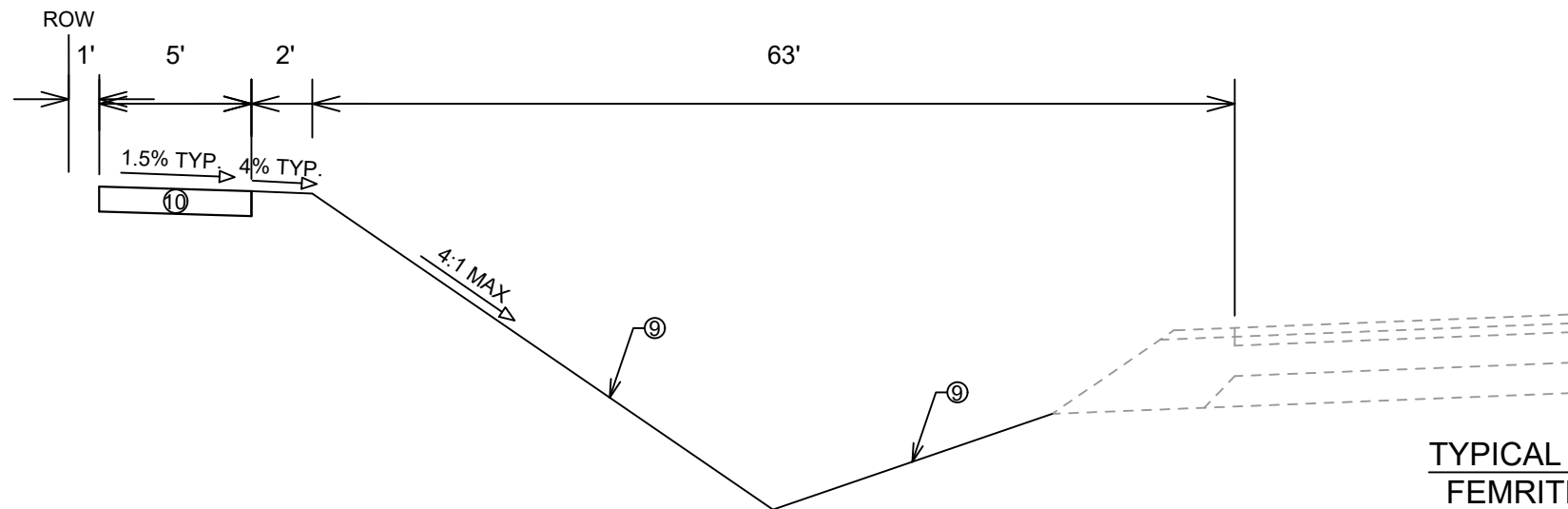

TYPICAL SECTION
FEMRITE DRIVE
STA 71+05.00 TO STA 82+00.27

- ⑨ RESTORE DISTURBED AREAS W/ 6" TOPSOIL, TERRACE SEED, AND EROSION MATTING
- ⑩ 5" CONCRETE SIDEWALK

DATE	BY
REVISION	
Designed By: ALZ	Date: 9/18/2023 12:43 PM
13825	Scale: 1:6
D-1	

13825
MADISON, WI
9802
CONTRACT NO:
FEMRITE DRIVE SIDEWALK NOTES & TYPICAL SECTIONS
3030 OHMEDA DRIVE CSM
M:\DESIGN\Projects\13825\CAD\Streets\13825EN-Details.dwg



13825
D-1

NOTES
 - OHMEDA DR PARCEL (NORTH) DEVELOPER DATUM SET 0.20' ABOVE CITY DATUM.
 - ALL DRIVEWAYS BETWEEN CURB AND GUTTER AND SIDEWALK SHALL BE CONCRETE 7-INCH
 - ALL SIDEWALK ALONG DRIVEWAYS SHALL BE CONCRETE SIDEWALK 7-INCH
 - ALL CURB RAMPS SHALL BE CONCRETE SIDEWALK 7-INCH
 - ALL WORK ALONG OHMEDA DRIVE TO BE CONSTRUCTED BY OTHERS AS PART OF PROJECT #13825, CONTRACT #9362

LEGEND
 X CLEARING & GRUBBING
 TTT SAWING ASPHALT
 -WET- WETLAND DELINEATED BOUNDARY

CSM 15956
 LOT1

****THIS SHEET IS DESIGNED OFF THE CITY DATUM.
 OHMEDA DR PARCEL (NORTH) DEVELOPER DATUM SET 0.20' ABOVE CITY DATUM.****

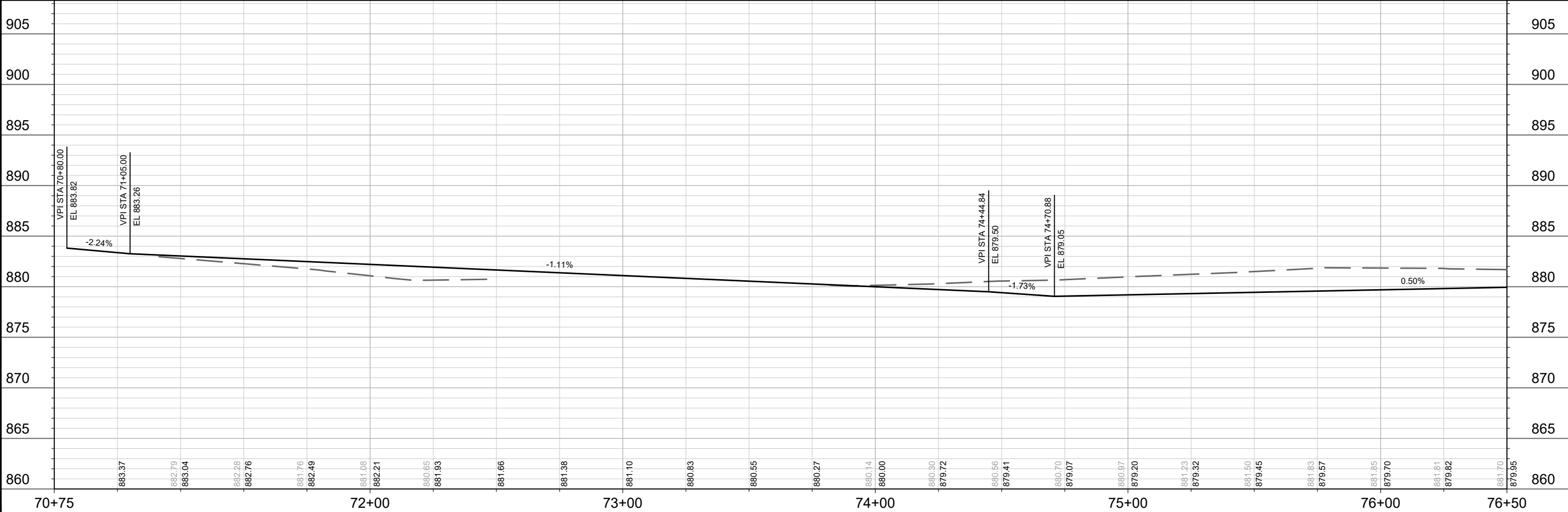
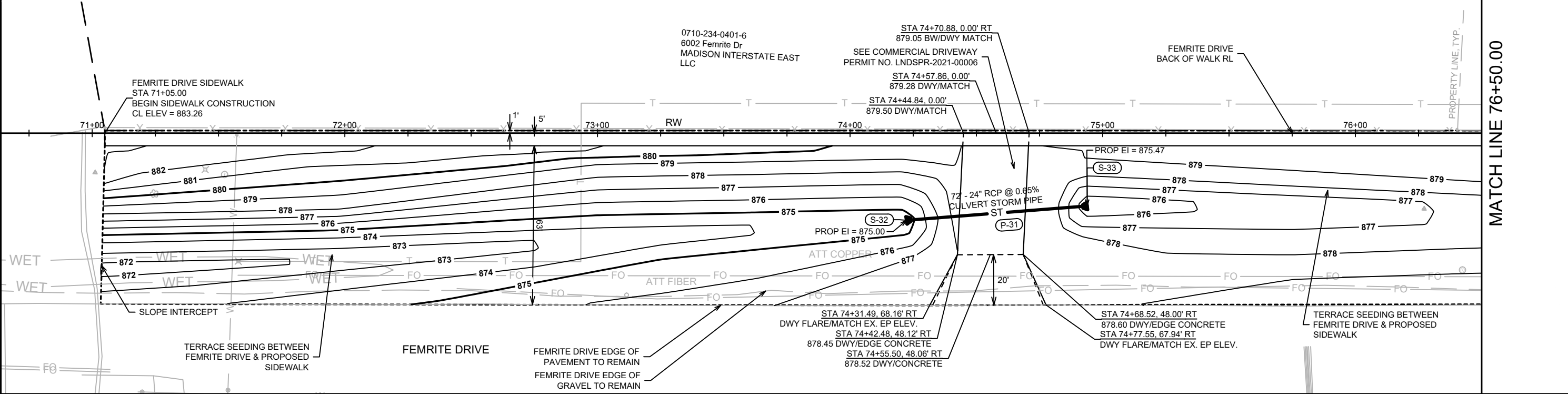

MARK	REVISION	DATE	BY

13825
 MADISON, WI
 9802
 CONTRACT NO:

FEMRITE DRIVE BACK OF SIDEWALK PLAN AND PROFILE
 3030 OHMEDA DRIVE CSM
 M:\DESIGN\Projects\13825\CAD\Streets\13825EN-PnP\FemriteD\SW.dwg



13825
 P-1

NOTES
 - OHMEDA DR PARCEL (NORTH) DEVELOPER DATUM SET 0.20' ABOVE CITY DATUM.
 - ALL DRIVEWAYS BETWEEN CURB AND GUTTER AND SIDEWALK SHALL BE CONCRETE 7-INCH
 - ALL SIDEWALK ALONG DRIVEWAYS SHALL BE CONCRETE SIDEWALK 7-INCH
 - ALL CURB RAMPS SHALL BE CONCRETE SIDEWALK 7-INCH
 - ALL WORK ALONG OHMEDA DRIVE TO BE CONSTRUCTED BY OTHERS AS PART OF PROJECT #13825, CONTRACT #9362

LEGEND
 X CLEARING & GRUBBING
 TTT SAWING ASPHALT
 -WET- WETLAND DELINEATED BOUNDARY

CSM 16276
 LOT1

****THIS SHEET IS DESIGNED OFF THE CITY DATUM.
 OHMEDA DR PARCEL (NORTH) DEVELOPER DATUM
 SET 0.20' ABOVE CITY DATUM.****

SEE SHEET P-1 FOR
 OHMEDA DRIVE, (PROJECT #13810,
 CONTRACT #9362, BUILT BY OTHERS)
 SIDEWALK & INTERSECTION GRADES

MATCH LINE 76+50.00

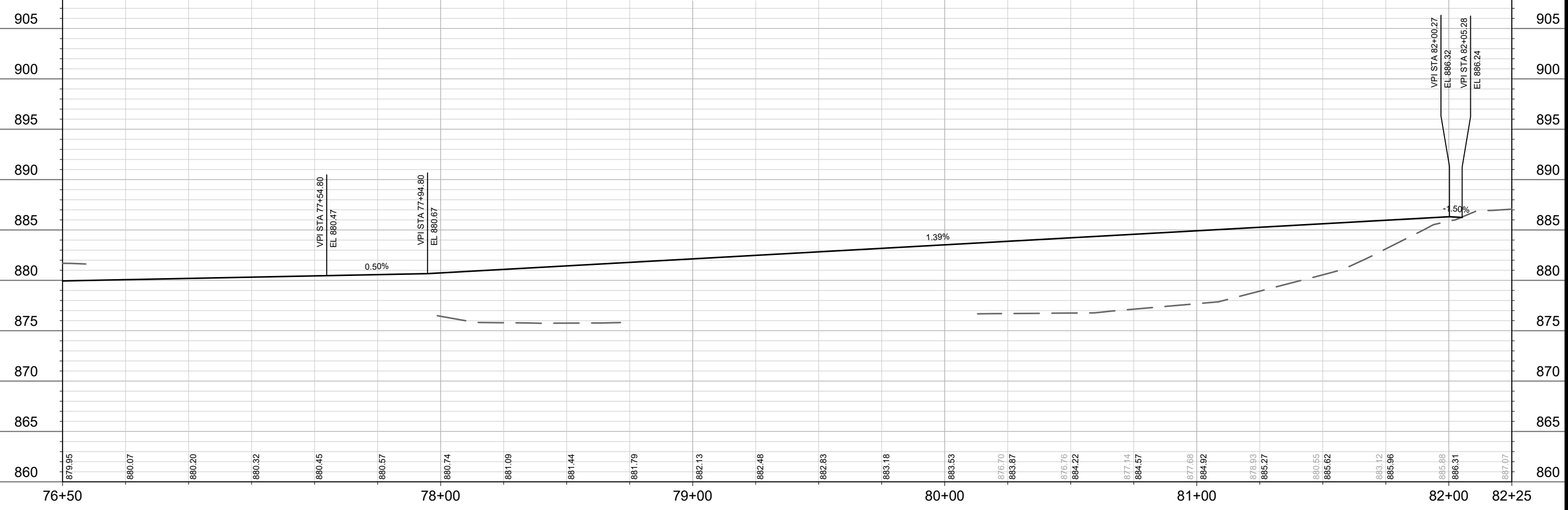
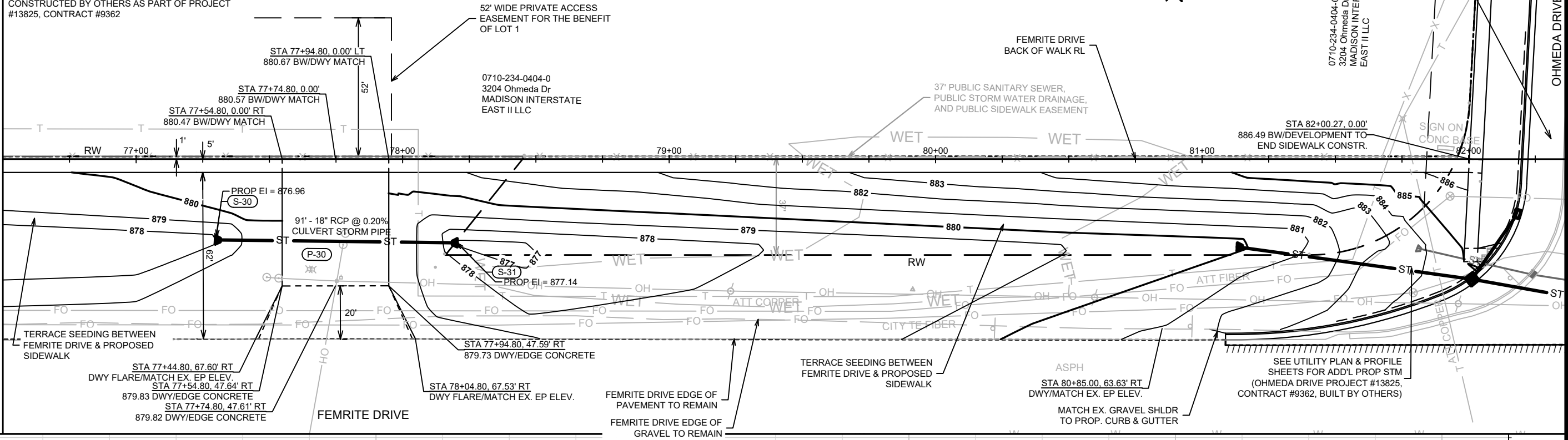

DATE	BY
REVISION	
MARK	
DESIGNED BY: ALZ	DATE: 9/18/2023 10:22 AM
SCALE: 1" = 40'	
PROJECT NO:	P-2
PROJECT NO:	13825
PROJECT NO:	9802
PROJECT NO:	13825
PROJECT NO:	MADISON, WI
PROJECT NO:	13825
PROJECT NO:	9802
PROJECT NO:	CONTRACT NO:
PROJECT NO:	13825
PROJECT NO:	P-2

FEMRITE DRIVE BACK OF SIDEWALK PLAN AND PROFILE

3030 OHMEDA DRIVE CSM

M:\DESIGN\Projects\13825\CAD\Streets\13825EN-PnP\FemriteD\SW.dwg

CITY OF MADISON
 WISCONSIN

13825

P-2

STORM SEWER SCHEDULE

PROPOSED STORM STRUCTURES

STRUC. NO.	STATION	LOCATION (OFFSET)	TYPE	TOP OF CASTING	E.I.	DEPTH	NOTES
FEMRITE DR - DRIVEWAY CULVERTS							
S-30	77+29.77	RT-30.34	18" AE (NO GATE)	-	876.96	-	
S-31	78+20.47	RT-31.44	18" AE (NO GATE)	-	877.14	-	
S-32	74+22.31	RT-34.50	24" AE (NO GATE)	-	875.00	-	
S-33	74+93.87	RT-28.81	24" AE (NO GATE)	-	875.47	-	

PROPOSED STORM PIPES

PIPE NO.	FROM (DNSTM)	TO (UPSTM)	DISCH. E.I.	INLET E.I.	PLAN (PAY) LGTH (FT)	PIPE LGTH (FT)	SLOPE (%)	PIPE SIZE	TYPE	NOTES
FEMRITE DR - DRIVEWAY CULVERTS										
P-30	S-30	S-31	876.96	877.14	91	91	0.20%	18"	RCP	
P-31	S-32	S-33	875.00	875.47	72	72	0.65%	24"	RCP	

FEMRITE DRIVE
PROJECT NO. 13825

SHEET NO.
U-1

STORM SEWER SCHEDULE

FEMRITE DR

CITY OF MADISON

U-1

STANDARD NOTES:

-PLAN LENGTH (PAY LENGTH) IS FROM CENTER OF STRUCTURE TO CENTER OF STRUCTURE. PIPE LENGTH IS ACTUAL LENGTH OF PIPE FROM STRUCTURE WALL TO STRUCTURE WALL. SLOPE CALCULATED USING PIPE LENGTH.

- ABBREVIATIONS: AE = APRON ENDWALL; RCP = REINFORCED CONCRETE PIPE; HERCP = HORIZONTAL ELLIPTICAL REINFORCED CONCRETE PIPE; DNA = DOES NOT APPLY; SAS = SEWER ACCESS STRUCTURE; LP = LOW POINT INLET STRUCTURE; FP = FIELD POURED STRUCTURE; TR = TOP OF CONCRETE ROOF; NCM = NO CROWN MATCH FOR PIPES; UD = UNDERDRAIN

- APPROXIMATE DISCHARGE E.I. GIVEN, ADJUST E.I. AND PIPE SLOPE IN THE FIELD.

- TOP OF CASTING GRADE GIVEN IS THE TOP OF CURB FOR INLET STRUCTURES AND THE FLOWLINE OF THE CLOSED CASTING FOR SAS's.

- ALL STRUCTURES CALLED OUT AS FIELD POURED SHALL BE FIELD POURED. ALL OTHER STRUCTURES (NOT INDICATED AS FIELD POURED) SHALL BE SUBMITTED TO CITY ENGINEERING FOR APPROVAL IF PRECAST STRUCTURES ARE PREFERRED. CONTACT DANIEL OLIVARES OF CITY ENGINEERING AT (608) 261-9285 FOR PRECAST APPROVALS OR EMAIL SHOP DRAWINGS TO DAOLIVARES@CITYOFMADISON.COM.

- ALL REINFORCED CONCRETE PIPES TO BE CLASS III UNLESS OTHERWISE NOTED.

- SURVEYOR TO CONFIRM THAT ALL INLET STATION / OFFSETS LINE UP WITH PROPOSED CURB AND GUTTER.

DISCLAIMER NOTE:
 TO BE ABLE TO PREFORM THE WATER WORK FOR THIS CSM, THE CONTRACTOR WILL HAVE TO DO THE FOLLOWING **FIRST**.

- FILL OUT AND SUBMIT A "MODIFY MAIN/SERVICE APPLICATION" FORM. THE LINK TO THIS FORM CAN BE FOUND ON THE MADISON WATER UTILITY WEBPAGE UNDER THE "PLUMBERS & CONTRACTORS" TAB.
- WHEN DOING THE WATER WORK, THE CONTRACTOR WILL NEED TO CONTACT JEFF BELSHAW FIRST SO THAT AN INSPECTOR CAN OVERSEE THAT WORK BEING DONE. CONTACT INFO: (608) - 261 - 9835

CSM 15956
 LOT1

Revision 1 - RJN 1/5/24
 - Relocate hydrant due to sidewalk conflict
 - Must complete modify mains application before water work starts.

0710-234-0401-6
 6002 Femrite Dr
 MADISON INTERSTATE EAST
 LLC

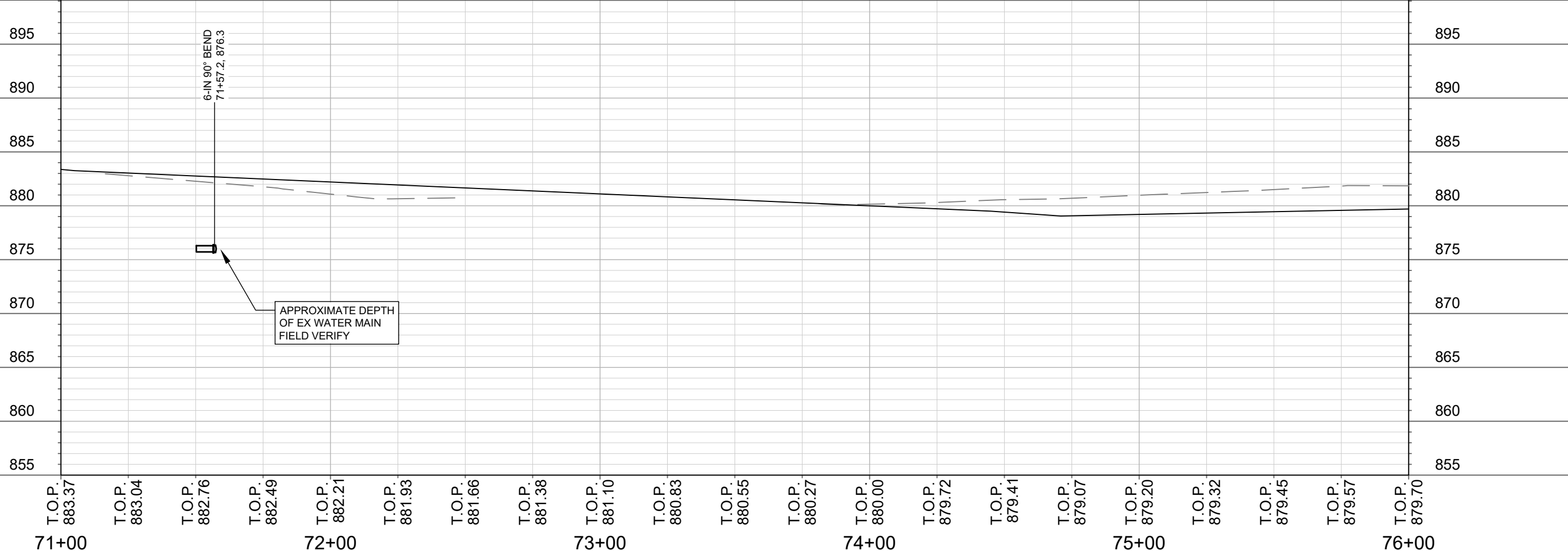
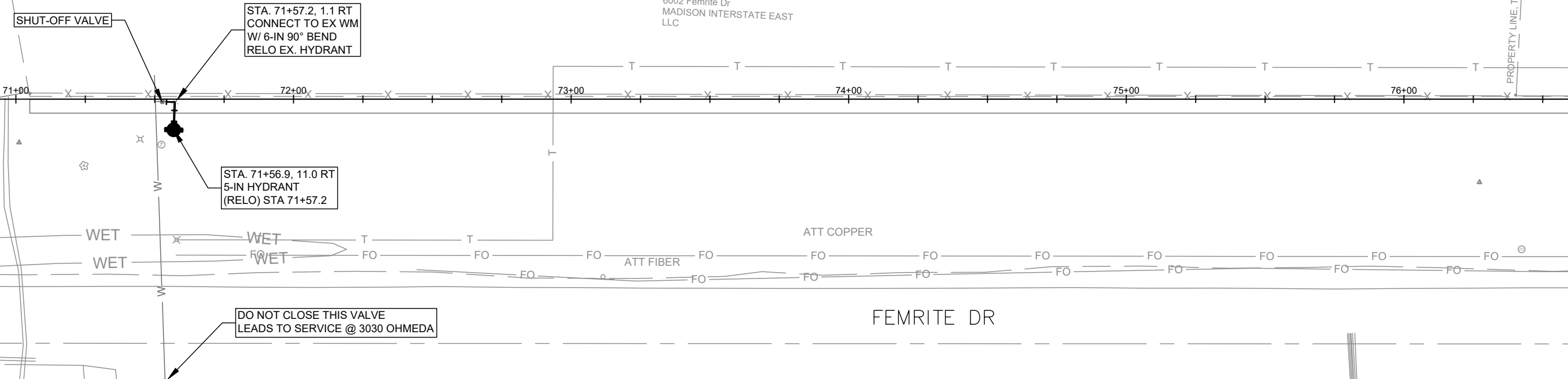

MARK	REVISION	DATE	BY
13825 <td>W-1 <td>12/29/2023 8:12 AM <td></td> </td></td>	W-1 <td>12/29/2023 8:12 AM <td></td> </td>	12/29/2023 8:12 AM <td></td>	

13825
 MADISON, WI
 CONTRACT NO: 9802

FEMRITE DR - WATER PLAN & PROFILE
 3030 OHMEDA DRIVE CSM
 M:\DESIGN\Projects\13825\CAD\Water\13825 - Water - Femrite Dr CSM.dwg

13825
 W-1

NOTES:
 **THIS SHEET IS DESIGNED OFF THE CITY DATUM.
 OHMEDA DR PARCEL (NORTH) DEVELOPER DATUM
 SET 0.20' ABOVE CITY DATUM.**

MARK	REVISION	DATE	BY
13825	9/17/2023 10:22 AM		X-1

13825
 MADISON, WI
 9802
 CONTRACT NO:

FEMRITE DRIVE SIDEWALK CROSS SECTIONS
 3030 OHMEDA DRIVE CSM
 M:\DESIGN\Projects\13825\CAD\Streets\13825EN-Corridor.dwg



13825
 X-1

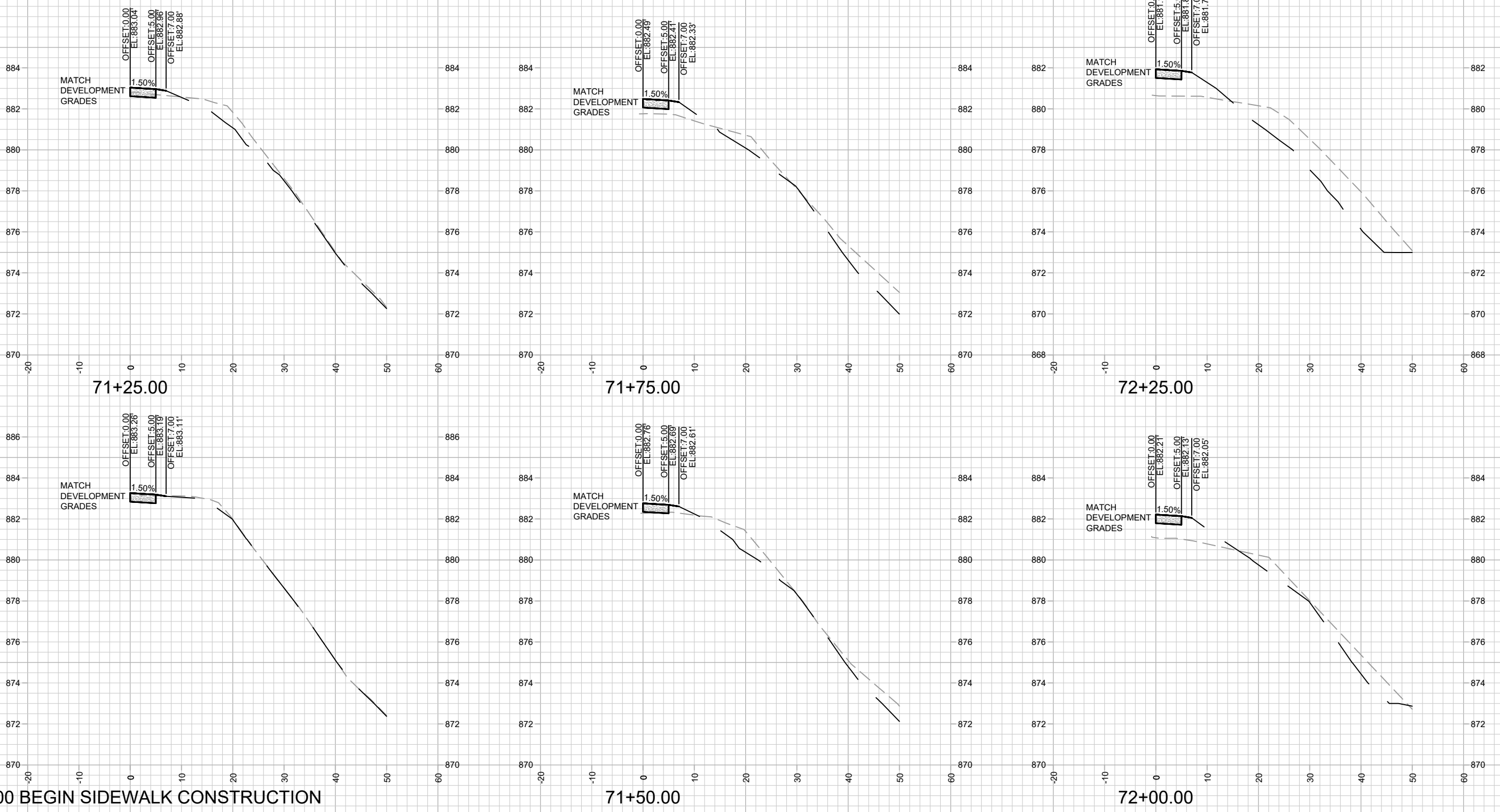

71+05.00 BEGIN SIDEWALK CONSTRUCTION

NOTES:
 **THIS SHEET IS DESIGNED OFF THE CITY DATUM.
 OHMEDA DR PARCEL (NORTH) DEVELOPER DATUM
 SET 0.20' ABOVE CITY DATUM.**

MARK	REVISION	DATE	BY
13825	9/17/2023 10:23 AM		
Designed By: ALZ			Scale: 1" = 20'
			X-2

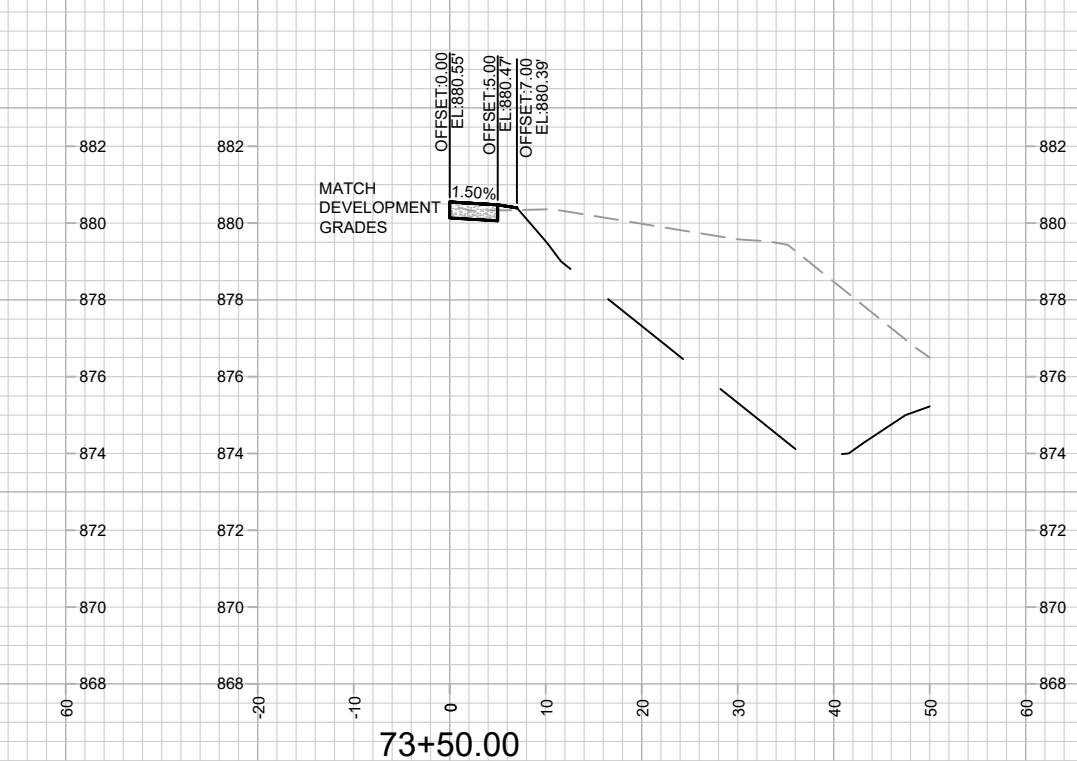
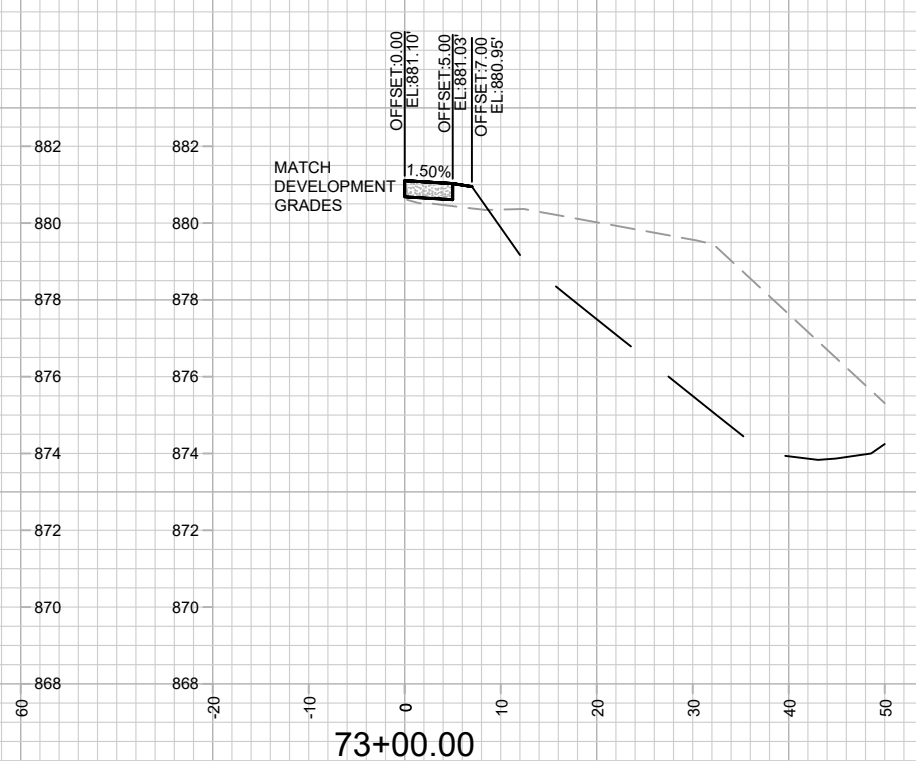
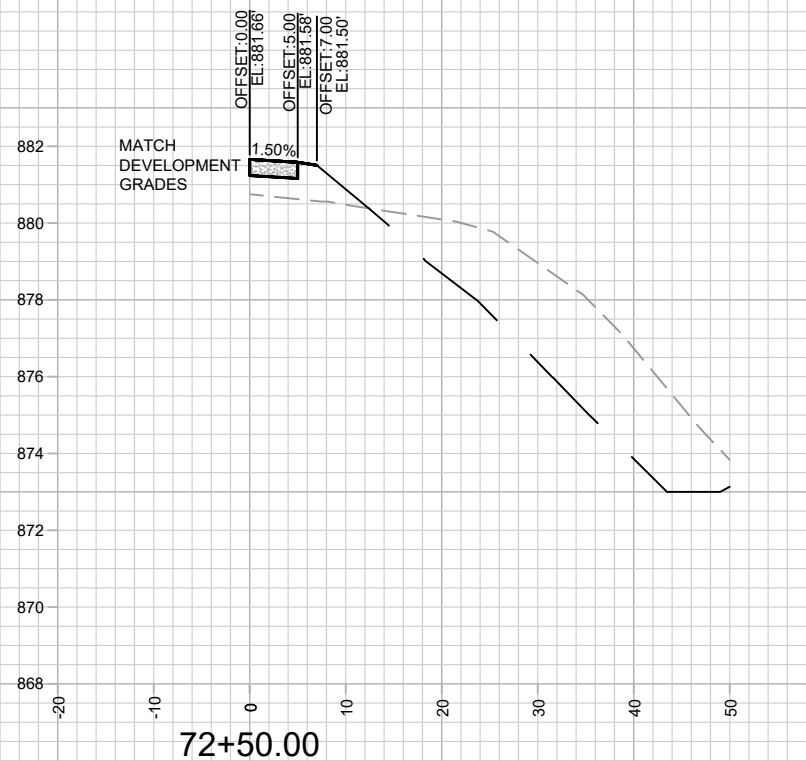
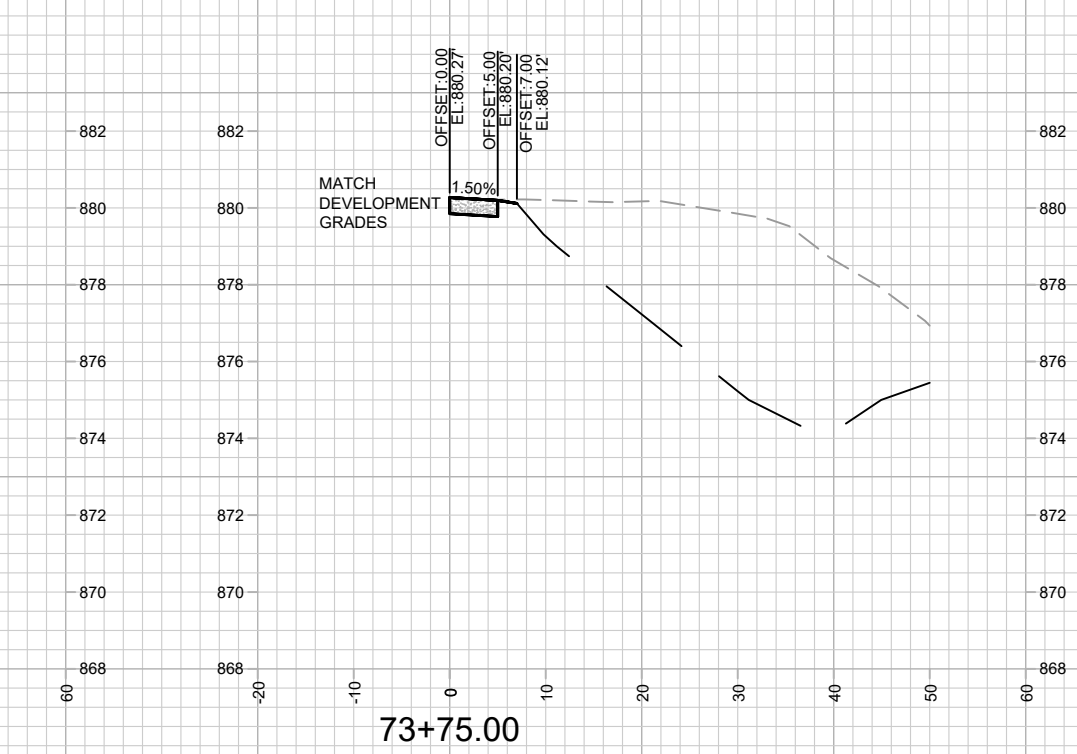
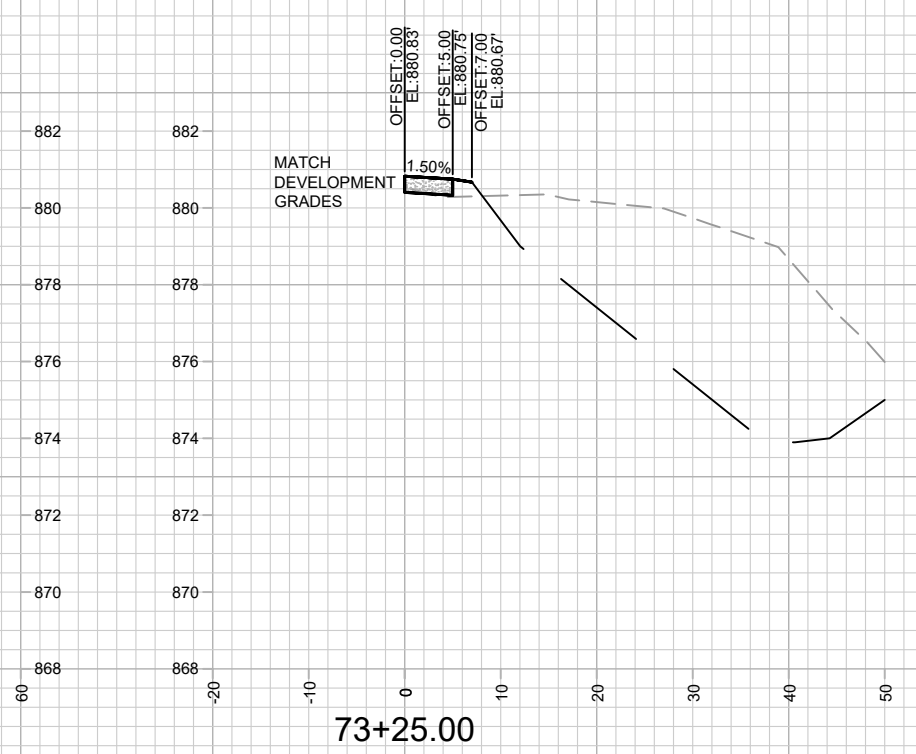
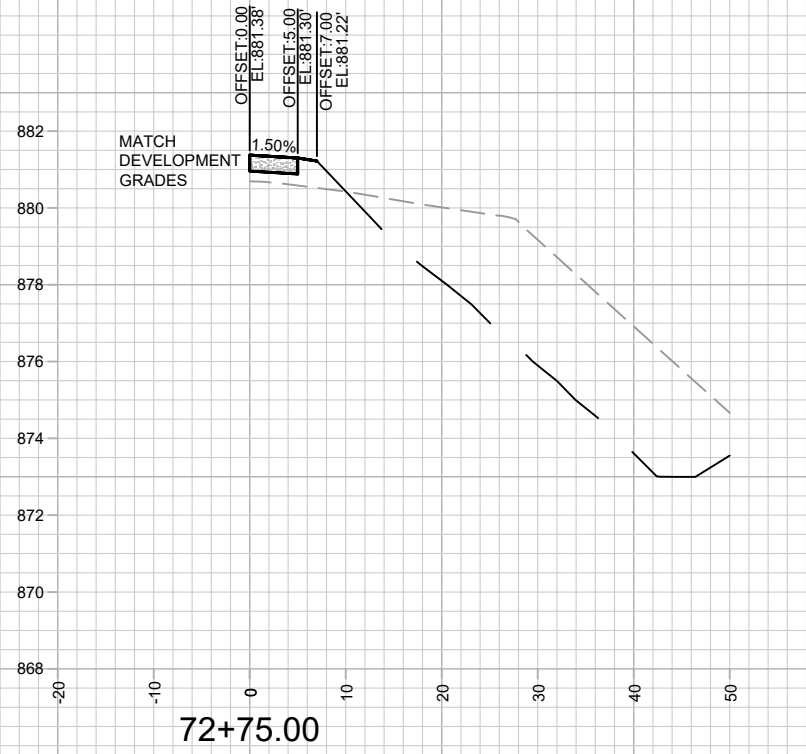

13825
 MADISON, WI
 9802
 CONTRACT NO:
 FEMRITE DRIVE SIDEWALK CROSS SECTIONS
 3030 OHMEDA DRIVE CSM
 M:\DESIGN\Projects\13825\CAD\Streets\13825EN-Corridor.dwg



13825
 X-2

NOTES:
 **THIS SHEET IS DESIGNED OFF THE CITY DATUM.
 OHMEDA DR PARCEL (NORTH) DEVELOPER DATUM
 SET 0.20' ABOVE CITY DATUM.**

MARK	REVISION	DATE	BY
13825	9/18/2023 10:23 AM		
Designed By: ALZ			Scale: 1" = 20'
			X-3

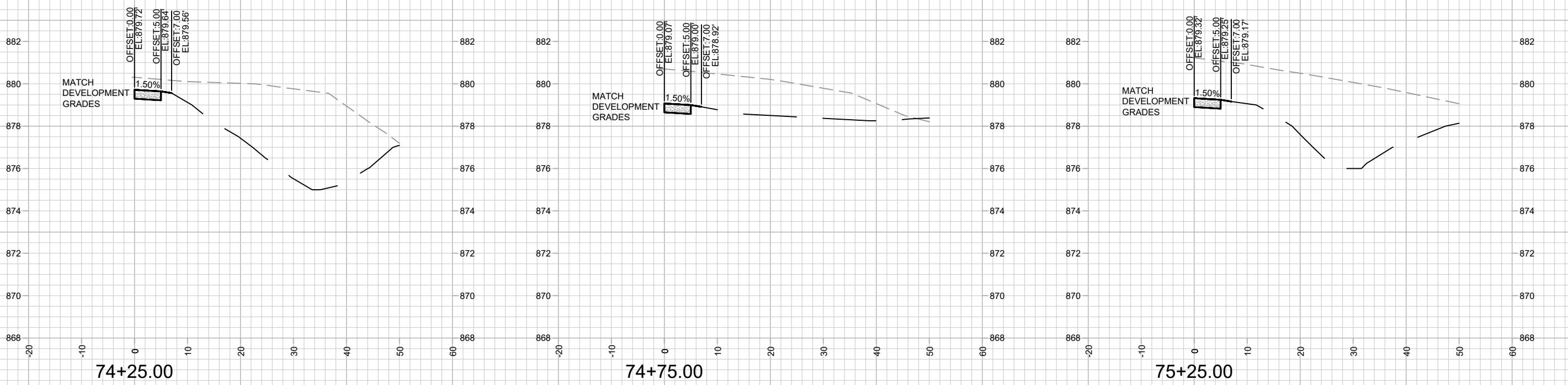

13825
 MADISON, WI
 9802
 CONTRACT NO:

FEMRITE DRIVE SIDEWALK CROSS SECTIONS
 3030 OHMEDA DRIVE CSM
 M:\DESIGN\Projects\13825\CAD\Streets\13825EN-Corridor.dwg



13825
 X-3

NOTES:
 **THIS SHEET IS DESIGNED OFF THE CITY DATUM.
 OHMEDA DR PARCEL (NORTH) DEVELOPER DATUM
 SET 0.20' ABOVE CITY DATUM.**

MARK	REVISION	DATE	BY
13825	9/17/2023 10:23 AM		
Designed By: ALZ			Scale: 1" = 20'
			X-4

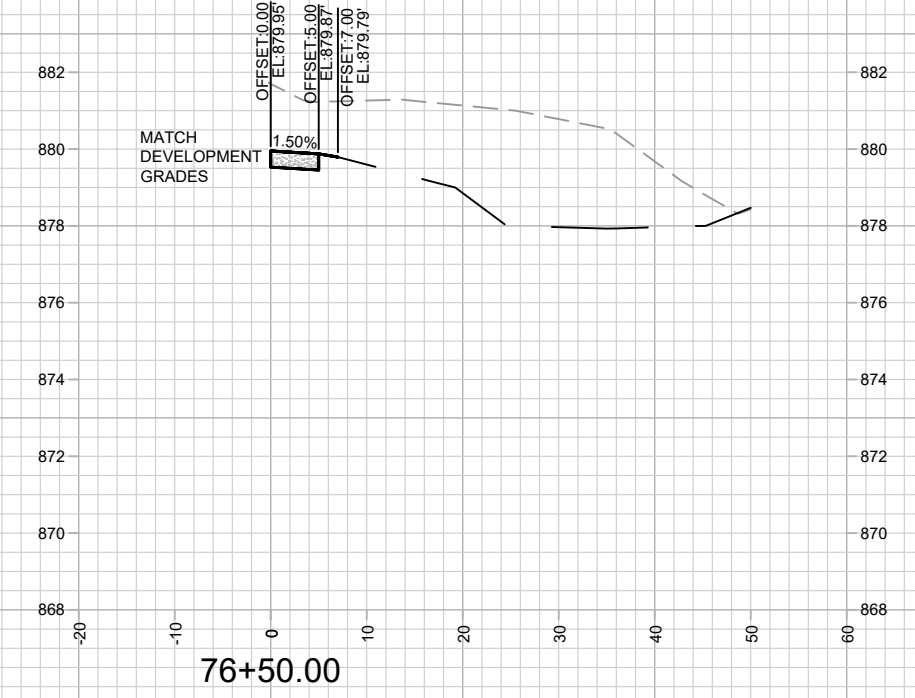
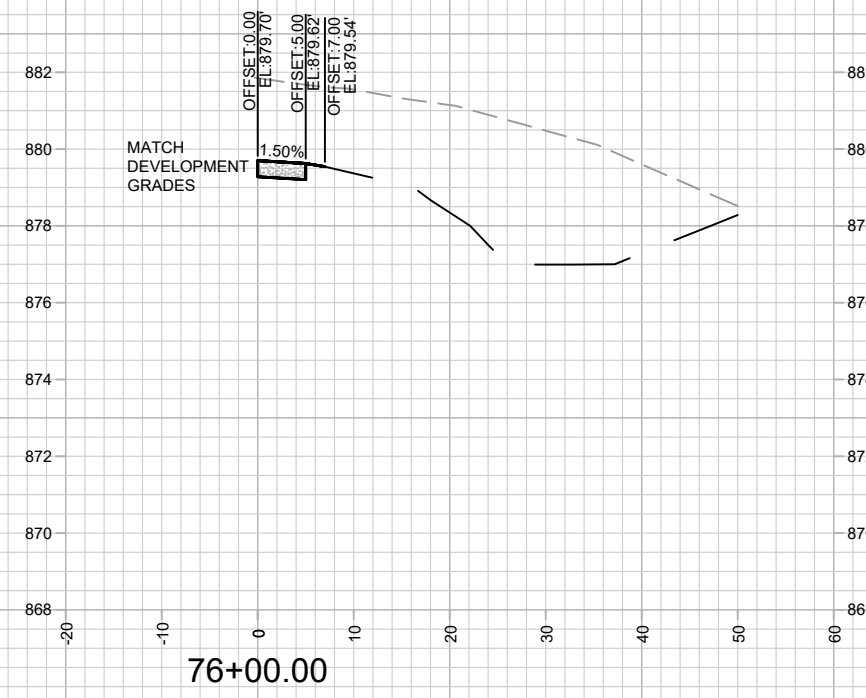
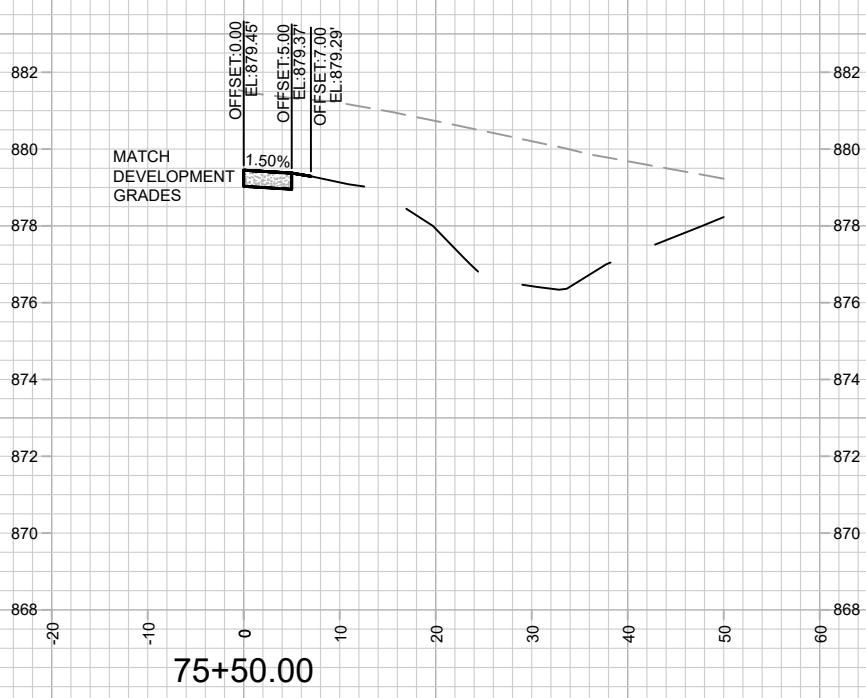
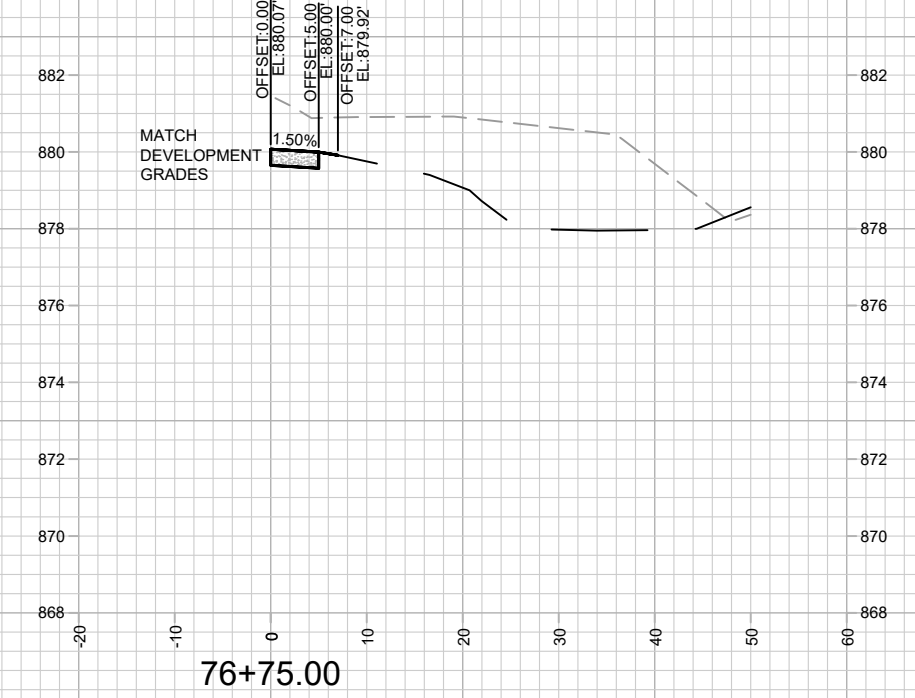
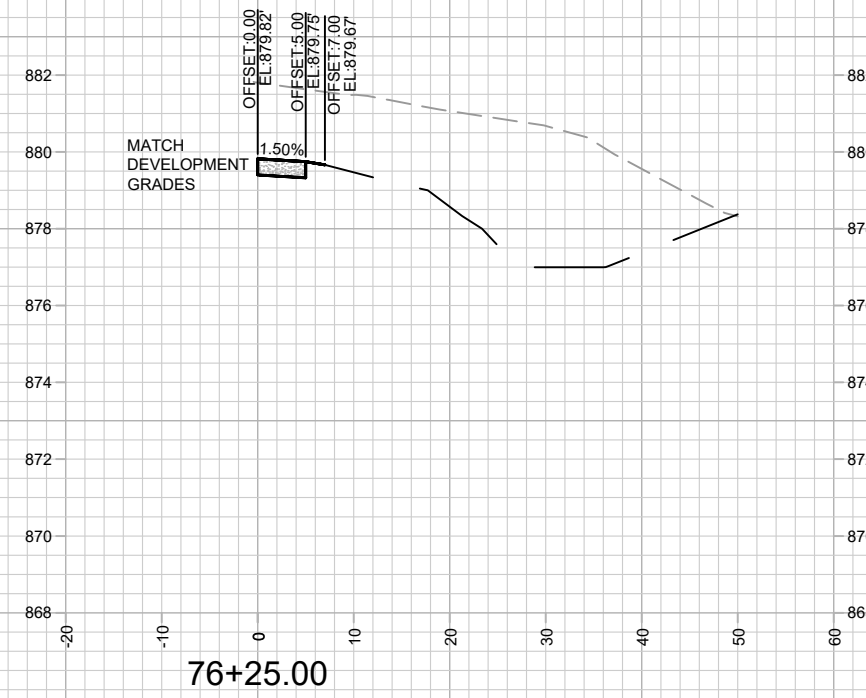
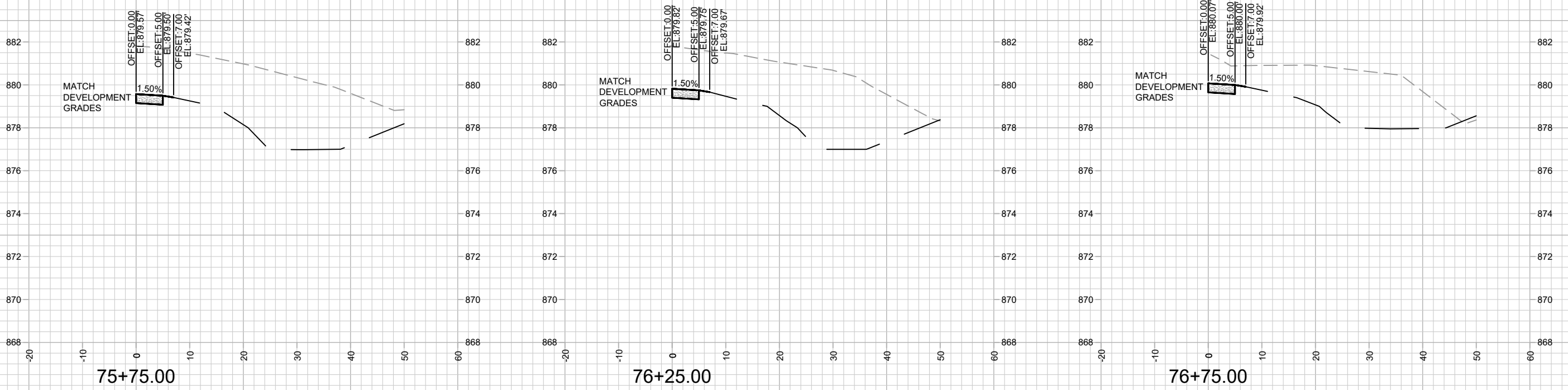

13825
 MADISON, WI
 9802
 CONTRACT NO:

FEMRITE DRIVE SIDEWALK CROSS SECTIONS
 3030 OHMEDA DRIVE CSM
 M:\DESIGN\Projects\13825\CAD\Streets\13825EN-Corridor.dwg



13825
 X-4

NOTES:
 **THIS SHEET IS DESIGNED OFF THE CITY DATUM.
 OHMEDA DR PARCEL (NORTH) DEVELOPER DATUM
 SET 0.20' ABOVE CITY DATUM.**

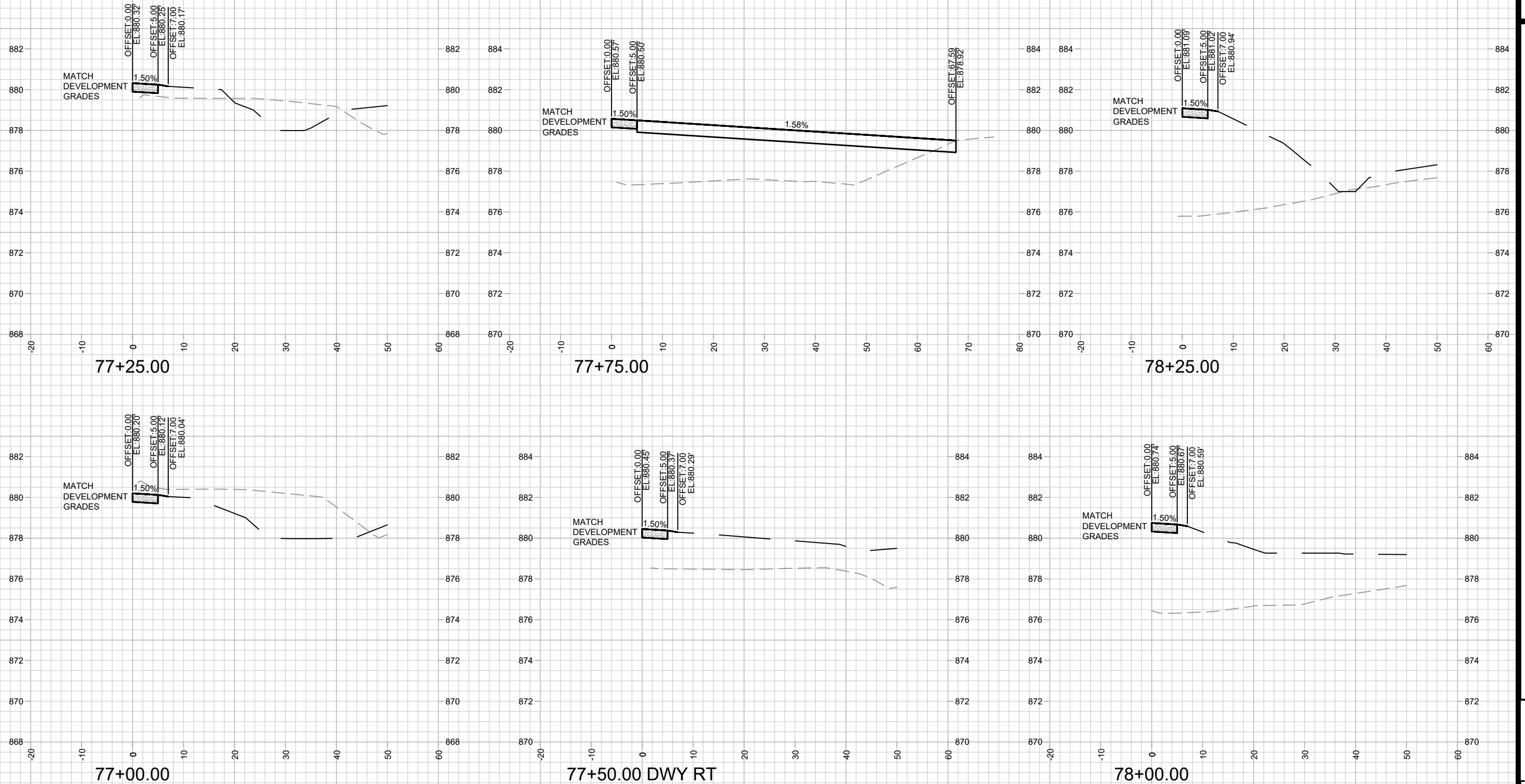

MARK	REVISION	DATE	BY

13825
 MADISON, WI
 9802
 CONTRACT NO:

FEMRITE DRIVE SIDEWALK CROSS SECTIONS
 3030 OHMEDA DRIVE CSM
 M:\DESIGN\Projects\13825\CAD\Streets\13825EN-Corridor.dwg



13825
 X-5

NOTES:
 **THIS SHEET IS DESIGNED OFF THE CITY DATUM.
 OHMEDA DR PARCEL (NORTH) DEVELOPER DATUM
 SET 0.20' ABOVE CITY DATUM.**

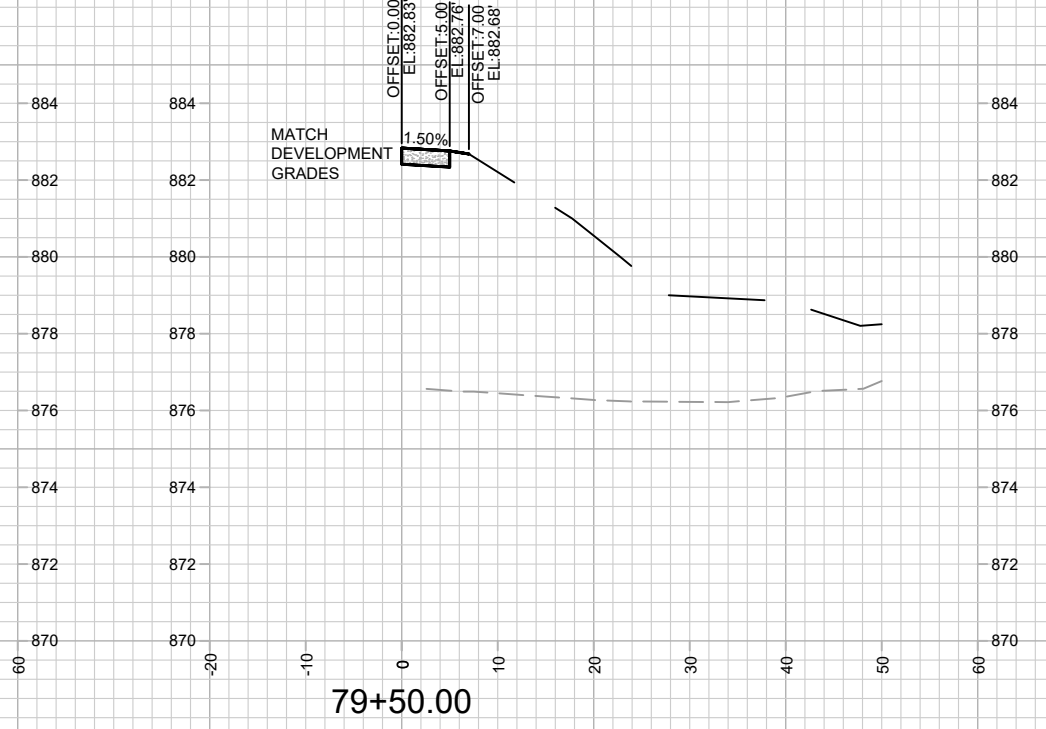
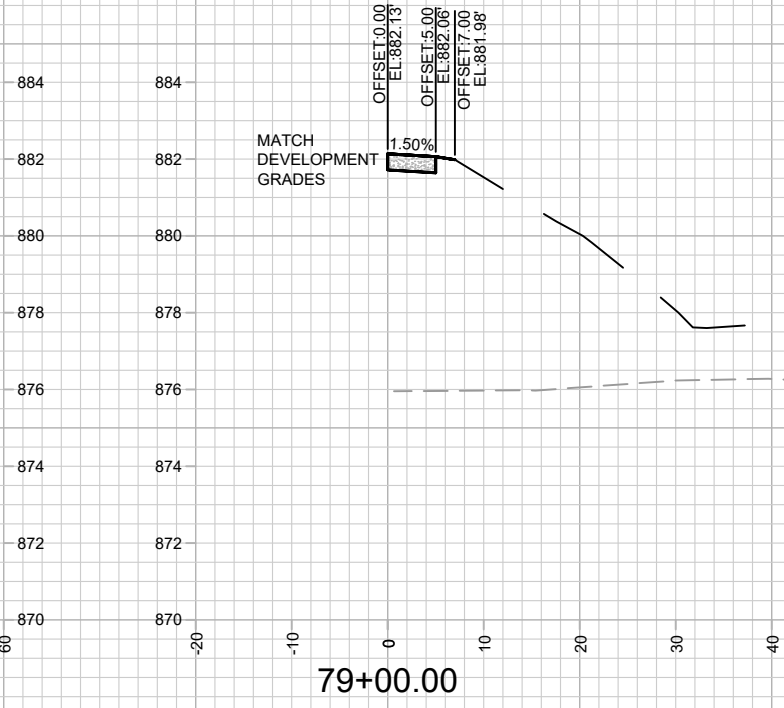
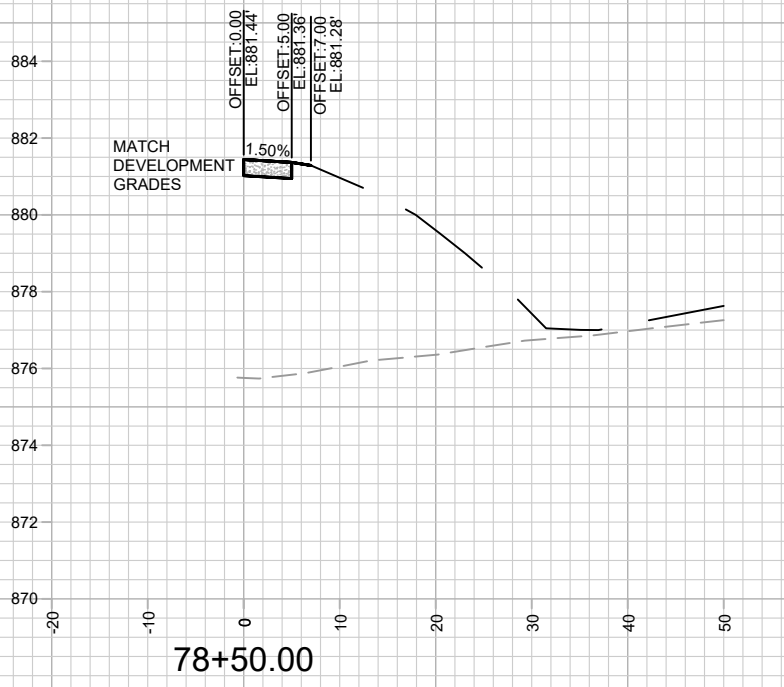
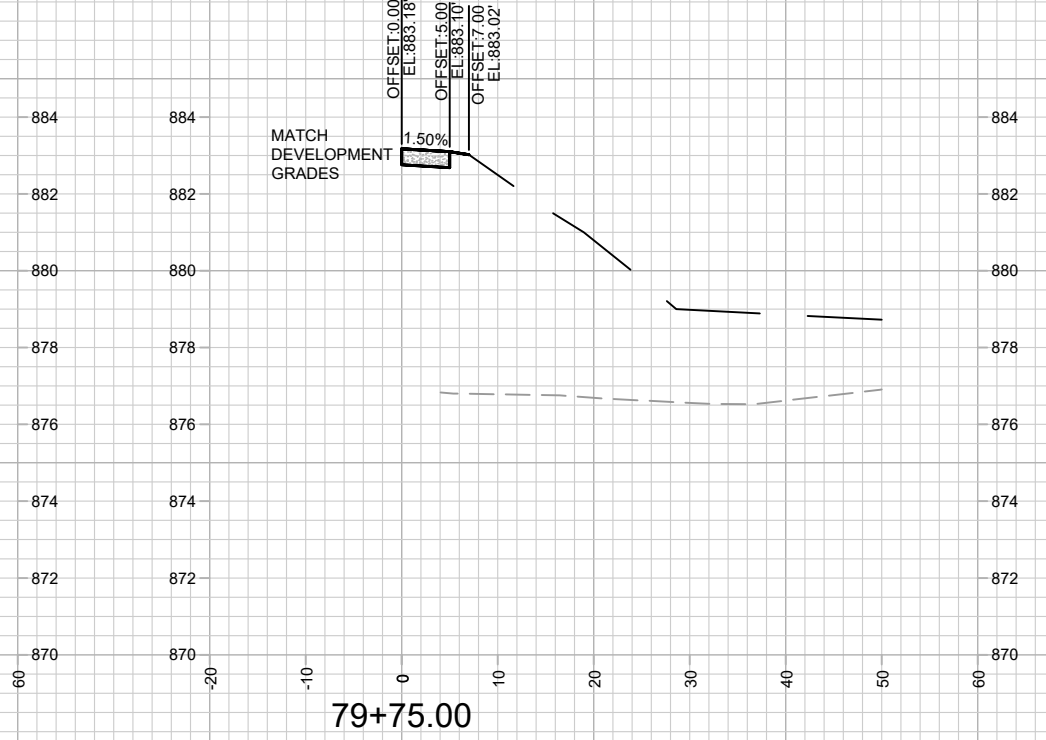
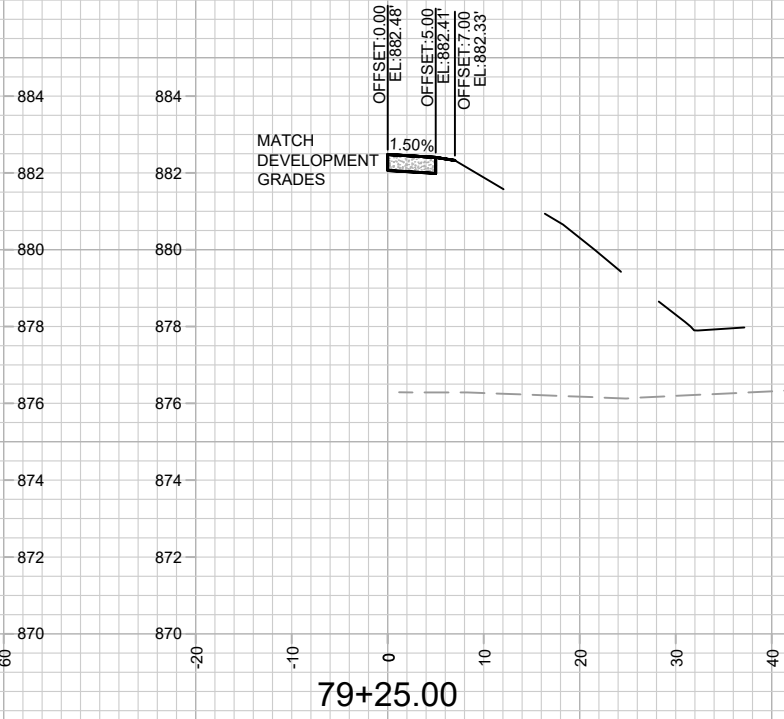
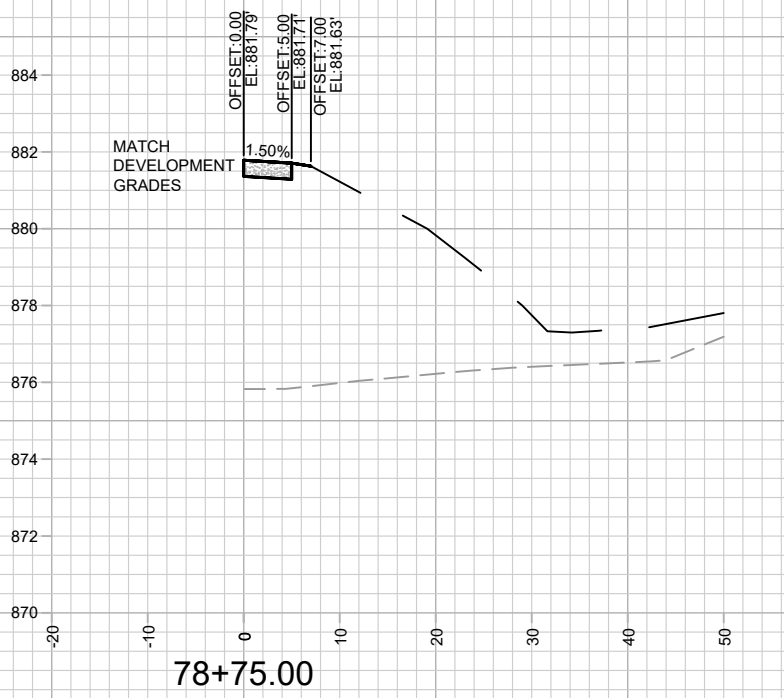

MARK	REVISION	DATE	BY
13825	9/17/2023 10:23 AM		

13825
 MADISON, WI
 9802
 CONTRACT NO:

FEMRITE DRIVE SIDEWALK CROSS SECTIONS
 3030 OHMEDA DRIVE CSM
 M:\DESIGN\Projects\13825\CAD\Streets\13825EN-Corridor.dwg



13825
 X-6

NOTES:
 **THIS SHEET IS DESIGNED OFF THE CITY DATUM.
 OHMEDA DR PARCEL (NORTH) DEVELOPER DATUM
 SET 0.20' ABOVE CITY DATUM.**

MARK	REVISION	DATE	BY
13825	9/18/2023 10:23 AM		X-7

13825
 MADISON, WI
 9802
 CONTRACT NO:

FEMRITE DRIVE SIDEWALK CROSS SECTIONS
 3030 OHMEDA DRIVE CSM
 M:\DESIGN\Projects\13825\CAD\Streets\13825EN-Corridor.dwg



13825
 X-7

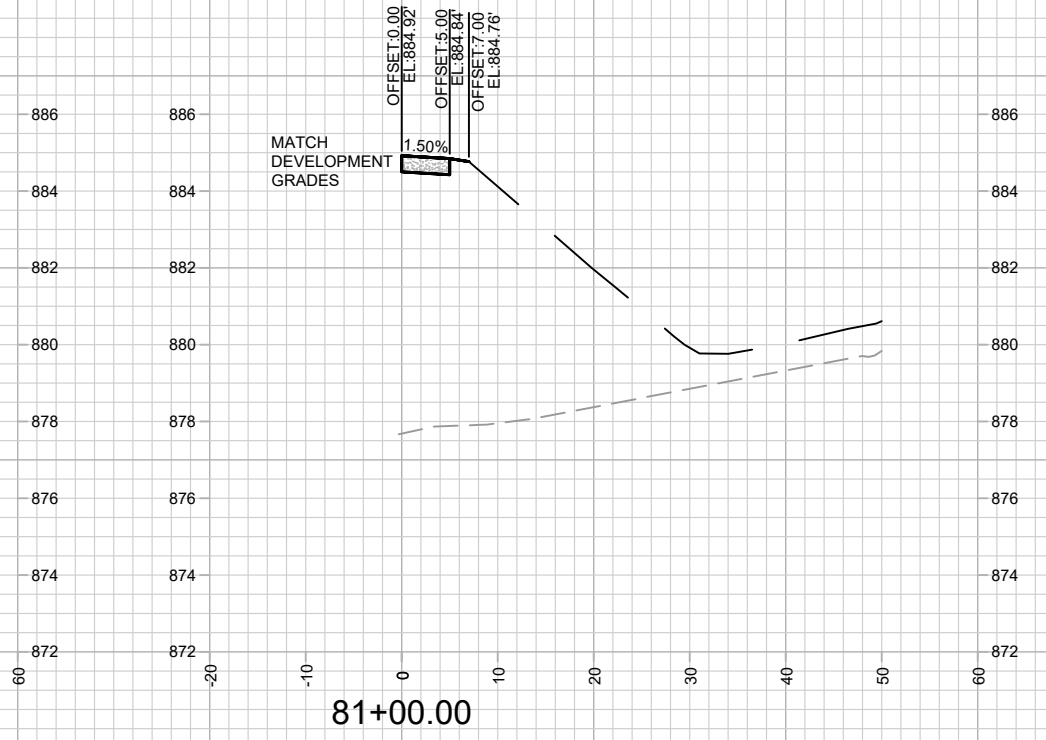
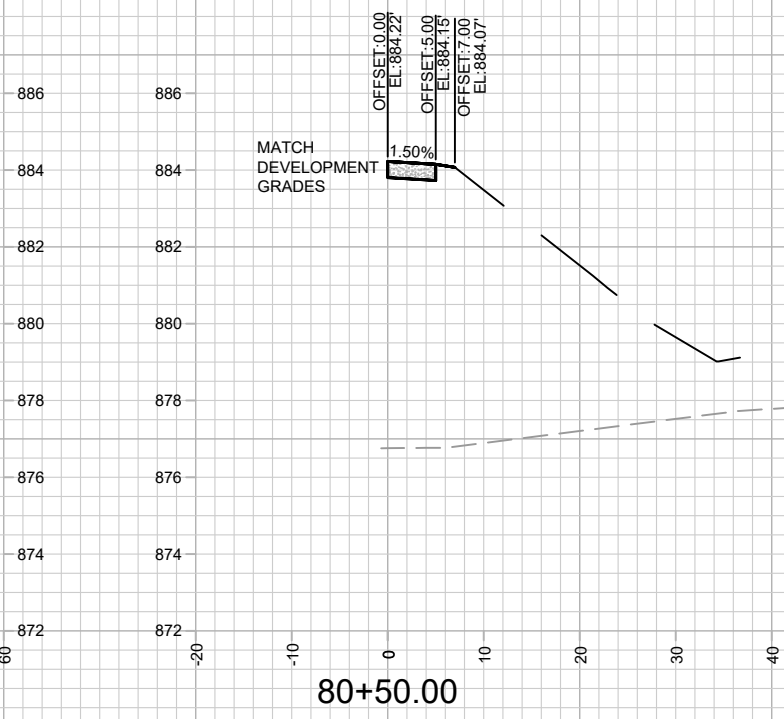
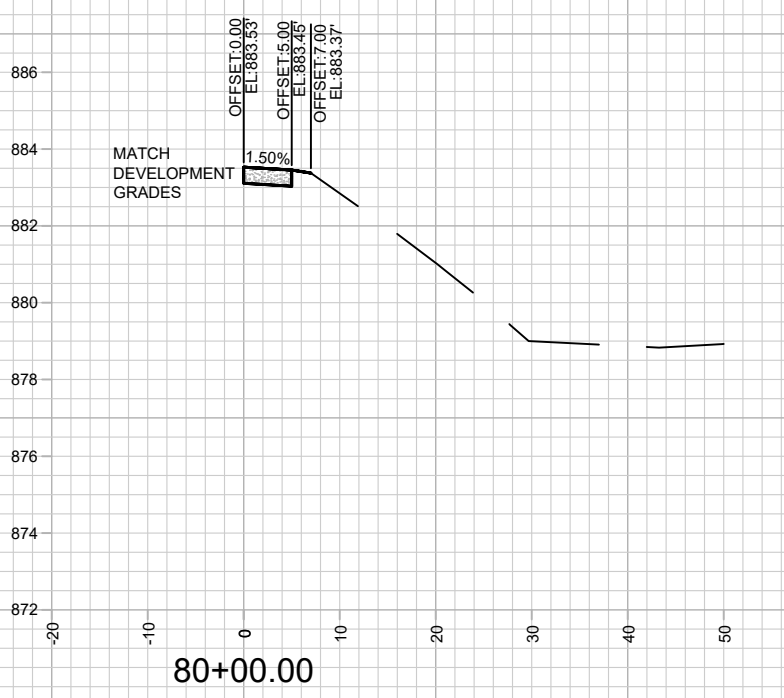
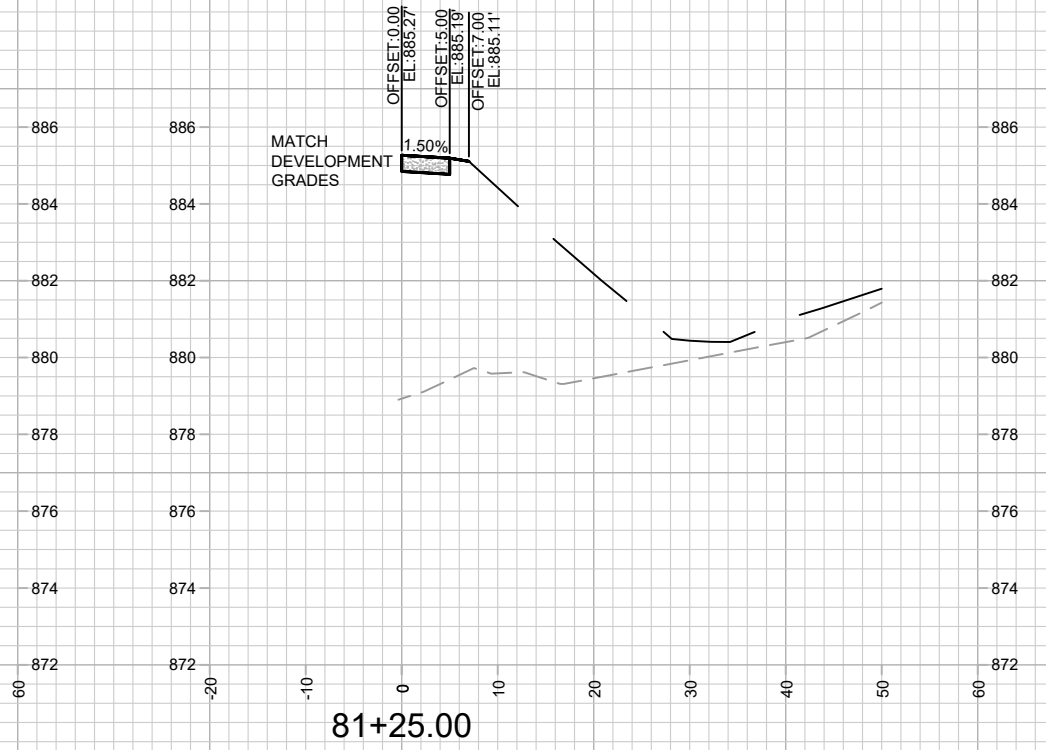
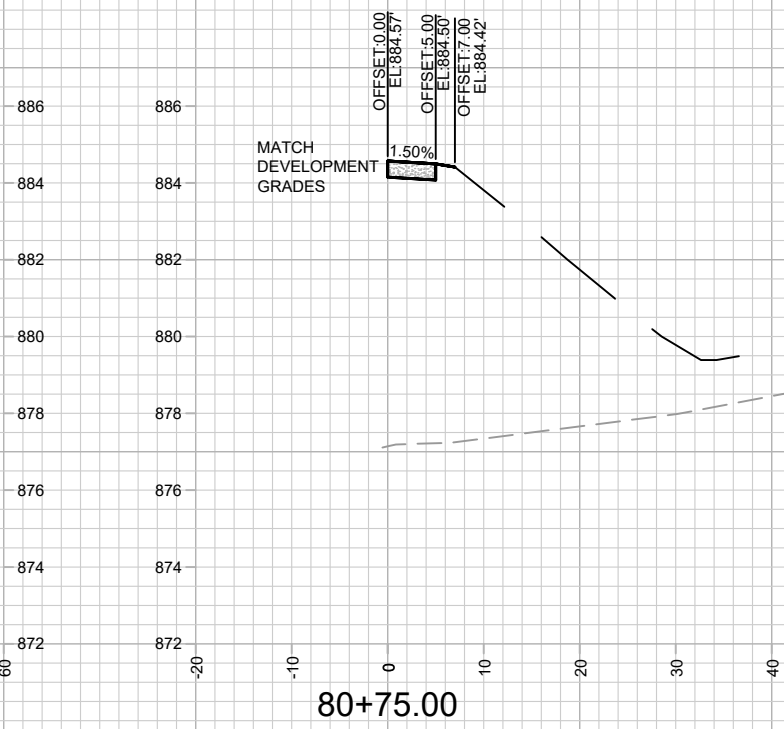
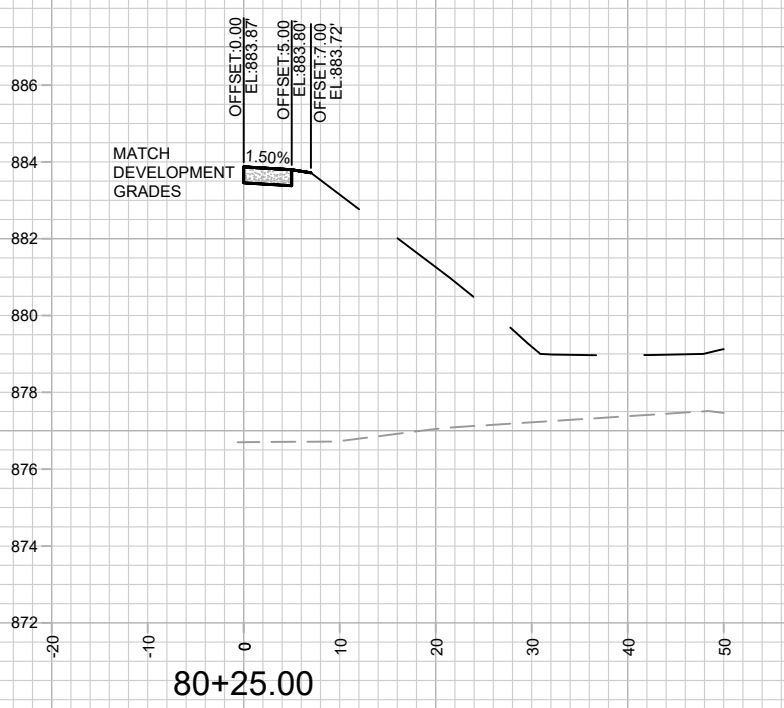

NOTES
 **THIS SHEET IS DESIGNED OFF THE CITY DATUM.
 OHMEDA DR PARCEL (NORTH) DEVELOPER DATUM
 SET 0.20' ABOVE CITY DATUM.**

MARK	REVISION	DATE	BY
13825	9/17/2023	10:24 AM	Scale: 1" = 20'
Designed By: ALZ			X-8

13825
 MADISON, WI
 9802
 CONTRACT NO:
 FEMRITE DRIVE SIDEWALK CROSS SECTIONS
 3030 OHMEDA DRIVE CSM
 M:\DESIGN\Projects\13825\CAD\Streets\13825EN-Corridor.dwg



13825
 X-8

