

Madison, Wisconsin

CITY OF MADISON

CITY ENGINEERING DIVISION

DEPARTMENT OF PUBLIC WORKS

PLAN OF PROPOSED IMPROVEMENT

4103 - 4119 PORTAGE ROAD

PHASE THREE

CITY PROJECT NO. 12946

CONTRACT NO. 8890

INDEX OF SHEETS

SHEET NO.	1	TITLE
SHEET NO.	D1	STANDARD NOTES & COMMENTS
SHEET NO.	D2	TYPICAL SECTIONS & DETAILS
SHEET NO.	EC1	EROSION CONTROL PLAN
SHEET NO.	P1	STREET PLAN & PROFILE
SHEET NO.	U1-U2	RETENTION DETAILS
SHEET NO.	U3-U4	CONCRETE FLUME DETAILS
SHEET NO.	W1	WATER PLAN & PROFILE
SHEET NO.	X1-X2	CROSS SECTIONS

PROJECT LOCATION

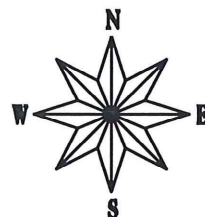

CONVENTIONAL SIGNS	
FIELD VERIFY ALL UTILITY LOCATIONS	
GAS	— G —
STORM SEWER	— ST —
SANITARY SEWER	— SAN —
WATER	— W —
OVERHEAD ELECTRIC	— OH —
POWER POLE	⊥

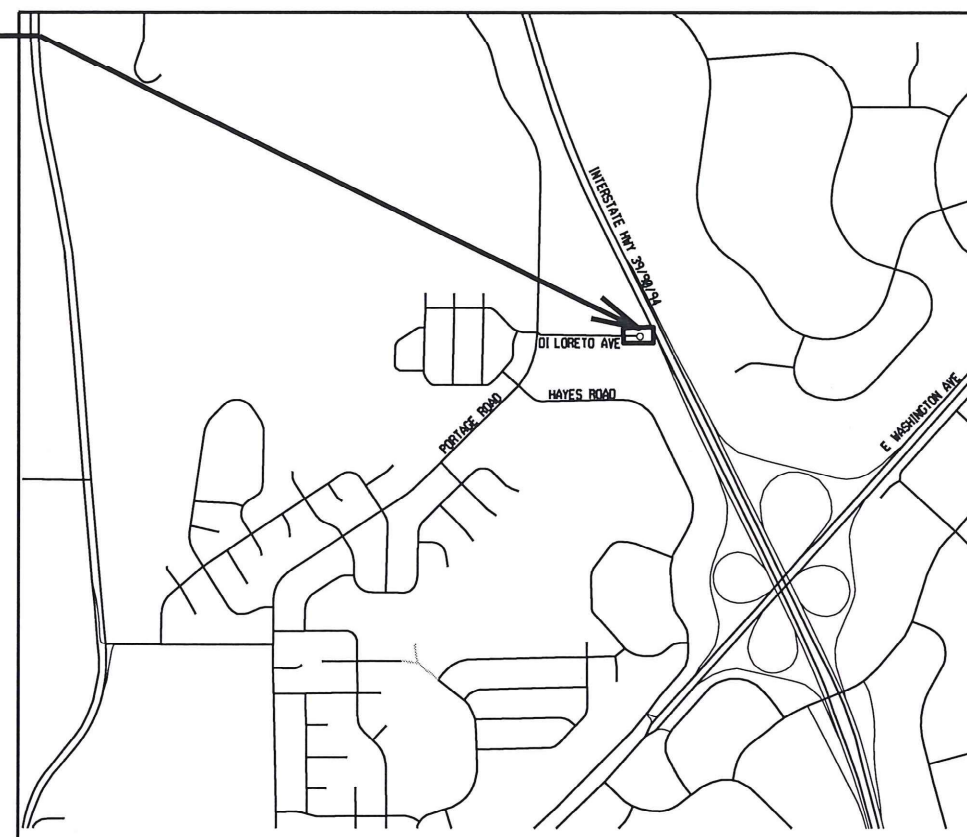

NOTES:

ALL GUTTERS SHALL DRAIN WITH A MINIMUM GRADE OF 0.50% TOWARD STORM SEWER INLETS.

SIDEWALK RAMPS AND CURB THRU SIDEWALK RAMPS SHALL HAVE A MAXIMUM SLOPE OF 1" PER 12". SIDEWALK AND CURB RAMPS SHALL BE CONSTRUCTED WITH A SIDE SLOPE OF 1.5%. SIDEWALK SHALL HAVE A MINIMUM LONGITUDINAL SLOPE OF 0.50% AND A MAXIMUM LONGITUDINAL SLOPE OF 5.00%

PUBLIC IMPROVEMENT PROJECT APPROVED

JUNE 2, 2020

BY THE COMMON COUNCIL OF MADISON, WISCONSIN

PUBLIC IMPROVEMENT DESIGN APPROVED BY:

Greg Fries Jun 16, 2020
City Engineer Date

STREET DESIGNED BY:

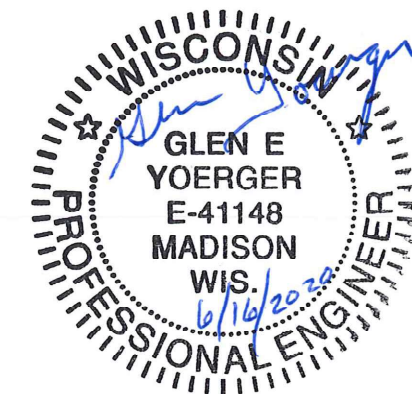

STORM SEWER DESIGNED BY:

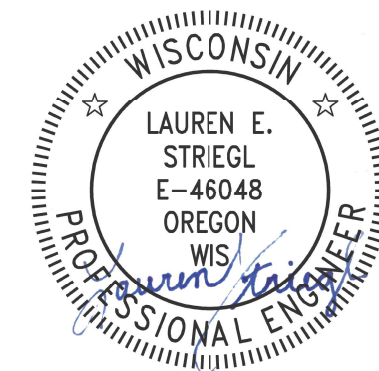

Jun 19, 2020

WATER MAIN DESIGNED BY:

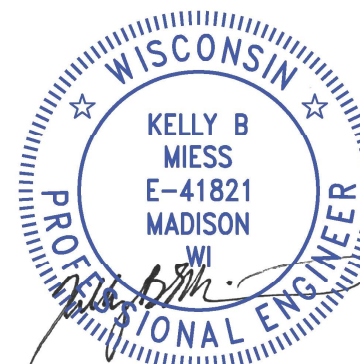

Jun 16, 2020

PLOT SCALE: _____

PLOT NAME: _____

REV. DATE: _____

ORIGINATOR: CITY OF MADISON, STREETS DIVISION

DETAILS

STANDARD NOTES
AND COMMENTS

CITY OF MADISON

ASPHALT PAVEMENT ON DILORETO AVENUE SHALL BE TYPE 'B' PAVEMENT PER S.D.D. 4.06.

ALL ISLANDS SHALL HAVE TYPE "H" CURB & GUTTER PER S.D.D. 3.08 UNLESS NOTED OTHERWISE IN THE PLAN. ALL ISLANDS SHALL HAVE MOUNTABLE NOSES PER S.D.D. 3.13. ALL OTHER CURB & GUTTER SHALL BE TYPE "A" PER S.D.D. 3.06.

ISLAND INTERIORS SHALL BE OF SOD WHERE THE BACK TO BACK OF CURB DIMENSION IS GREATER THAN 6'.

ALL GUTTERS SHALL DRAIN WITH A MINIMUM GRADES OF 0.5% TOWARD STORM SEWER INLETS.

PAVEMENT CROSS SLOPES SHALL BE 2%, TERRACES SHALL SLOPE AT A 4% GRADE TOWARD THE GUTTER, SHOULDERS SHALL HAVE A 4% CROSS SLOPE AND CROSS SLOPES FORMING DITCHES SHALL NOT EXCEED 4.00:1 UNLESS OTHERWISE INDICATED.

THE CROSS SLOPE OF SIDEWALKS AND BARRIER FREE SIDEWALK CURB RAMPS SHALL BE 1.5%. THE LONGITUDINAL GRADE OF BARRIER FREE SIDEWALK CURB RAMPS SHALL NOT EXCEED 8.33%. ALL SIDEWALK RAMPS SHALL BE CONSTRUCTED ACCORDING TO S.D.D. 3.03. AT ALL OTHER LOCATIONS THE LONGITUDINAL GRADE OF SIDEWALKS SHALL NOT EXCEED 5.0 % OR THE ADJACENT STREET GRADE WHICHEVER IS GREATER NOR BE LESS THAN 0.5% AND SHALL DRAIN TOWARD STORM SEWER INLETS. CONCRETE TERRACE SHALL BE INSTALLED BETWEEN THE SIDEWALK AND THE BACK OF CURB AT SIDEWALK LOW POINTS WHICH CANNOT OTHERWISE BE DRAINED DIRECTLY TO THE GUTTER. SIDE SLOPES WITHIN TEN FEET OF A PUBLIC SIDEWALK SHALL NOT EXCEED 4.00:1. ALL SIDEWALK AND SIDEWALK RAMP ELEVATIONS AND GRADES SHALL BE FIELD VERIFIED AND SET TO COMPLY WITH THE CITY OF MADISON STANDARD SPECIFICATIONS AND THE A.D.A. GUIDELINES.

OBTAIN A PRINT OUT OF THE ALIGNMENT FROM THE CITY ENGINEER PRIOR TO STAKING THIS PROJECT.

CURB STATION AND OFFSETS SHALL BE TO THE FACE OF CURB UNLESS OTHERWISE INDICATED. CURB ELEVATIONS SHALL BE TO THE TOP OF CURB (OR EXTENDED TOP OF CURB FOR DRIVEWAYS OR RAMPS) UNLESS OTHERWISE INDICATED.

POWER POLES AND OTHER OBSTRUCTIONS SHALL BE MOVED TO PROVIDE 2 FEET MINIMUM OF CLEAR DISTANCE FROM ANY FACE OF CURB OR EDGE OF SIDEWALK.

ANY INFORMATION SHOWN ON THIS PLAN, WHICH IS NOT PART OF THIS PROJECT, IS PRELIMINARY AND NOT FOR CONSTRUCTION.

THERE MAY BE EXISTING UTILITIES OR OTHER FEATURES WHICH ARE EITHER NOT SHOWN OR SHOWN INCORRECTLY ON THIS PLAN. IT IS THE RESPONSIBILITY OF THE DEVELOPER TO LOCATE AND IDENTIFY ALL UTILITIES AND TOPOGRAPHY WHICH MAY AFFECT THE CONSTRUCTION OF THESE IMPROVEMENTS.

ALL PERMANENT SIGNING AND POSTING WILL BE DETERMINED AND PROVIDED BY THE TRAFFIC ENGINEERING DIVISION, FOLLOWING CONSTRUCTION OF THESE IMPROVEMENTS.

THE DEVELOPER SHALL PROVIDE, INSTALL AND MAINTAIN ALL STREET END BARRICADES, SIGNING AND TRAFFIC CONTROL, AS REQUIRED BY THE CITY TRAFFIC ENGINEER.

PAVEMENT SAWCUTS SHALL BE AS DIRECTED BY THE CITY CONSTRUCTION ENGINEER. SAWCUTS SHOWN ON THE PLAN ARE APPROXIMATE.

CURB ON CUL DE SACS SHALL BE INSTALLED ACCORDING TO SDD 3.05.

THE LOCATION AND INFORMATION FOR PROPOSED NEW TREES, IN THE PUBLIC RIGHT OF WAY OR ON PUBLIC LANDS ARE APPROXIMATE AND ARE SHOWN FOR REFERENCE ONLY. THE LOCATIONS, SPECIFICATIONS AND PLANTING METHODS OF ALL PROPOSED NEW OR REPLACEMENT TREES IN THE PUBLIC RIGHT OF WAY OR ON PUBLIC LANDS SHALL BE APPROVED BY THE CITY FORESTER PRIOR TO INSTALLATION.

NO TREES IN THE RIGHT OF WAY OR ON PUBLIC LANDS SHALL BE TRIMMED, PRUNED, REMOVED OR ADVERSELY AFFECTED IN ANY WAY UNTIL THE DEVELOPER HAS RECEIVED WRITTEN PERMISSION FROM THE CITY ENGINEER OR CITY FORESTER. SAID WRITTEN PERMISSION SHALL INCLUDE LANGUAGE INDICATING THAT SECTION 10.101 OF THE MADISON GENERAL ORDINANCES AND ADMINISTRATIVE PROCEDURE MEMORANDUM NO. 6-2, REFERING TO NOTIFICATION OF PROPERTY OCCUPANTS AND/OR OWNERS, HAS BEEN COMPLIED WITH.

STREET TREES SHALL BE REPLACED AS SHOWN IN THE PLAN OR AS DIRECTED BY THE CITY FORESTER. COORDINATE STREET TREE PLANTING, LOCATIONS, QUANTITY, SPECIES AND SIZE WITH JEFF HEINECKE OF CITY FORESTRY, 266-4890.

THE DEVELOPER SHALL REPLACE ALL CURB & GUTTER AND SIDEWALK THAT IS DAMAGED BY CONSTRUCTION OR DETERMINED TO BE IN UNSATISFACTORY CONDITION.

THESE PLANS ARE FOR WORK WITHIN THE PUBLIC RIGHT-OF-WAY ONLY. INFORMATION SHOWN ON PRIVATE LANDS IS FOR REFERENCE ONLY.

ALL PAVEMENT SHALL BE PATCHED IN ACCORDANCE WITH CITY PAVEMENT PATCHING CRITERIA AND SHALL BE ACCOMPLISHED AS DIRECTED BY THE CITY CONSTRUCTION ENGINEER. ALL SAWCUTS FOR PAVEMENT PATCHES SHALL BE LOCATED AS DIRECTED BY THE CITY CONSTRUCTION ENGINEER.

ALL DISTURBED TERRACE AREAS SHALL BE RESTORED WITH 4-INCHES OF TOP SOIL AND SEED UNLESS DIRECTED OTHERWISE ON THE PLAN OR BY THE CITY CONSTRUCTION ENGINEER.

THE CONTRACTOR SHALL SUBMIT A TRAFFIC CONTROL PLAN FOR REVIEW TO THE CITY TRAFFIC ENGINEERING DIVISION AT LEAST 10 WORKING DAYS PRIOR TO WORK BEGINNING WITHIN PUBLIC RIGHT-OF-WAYS. THE TRAFFIC CONTROL PLAN SHALL COMPLY WITH ALL MUTCD REQUIREMENTS. WORK SHALL NOT PROCEED UNTIL THE TRAFFIC CONTROL PLAN HAS BEEN APPROVED. THE TRAFFIC CONTROL PLAN MAY INCLUDE BUT IS NOT LIMITED TO: LANE CLOSURE RESTRICTIONS, PEAK HOUR WORKING RESTRICTIONS, ACCESS REQUIREMENTS, ETC. THE CONTRACTOR SHALL BE RESPONSIBLE FOR PHASING WORK AS NECESSARY TO MEET THE REQUIREMENTS OF THE APPROVED TRAFFIC CONTROL PLAN. CONTACT JEREMY NASH WITH THE CITY TRAFFIC ENGINEERING DIVISION AT (608) 266-6585 TO COORDINATE THE TRAFFIC CONTROL PLAN.

Pavement Patching Criteria

Criteria use on:

Streets with pavement rating > 6
Arterial Streets

1. Length of Patch

- a. Minimum 50 feet long
- b. Minimum of 15 feet beyond the excavation
- c. Where multiple patches are created and the separation between them is less than 100 feet, the patches shall be combined into a single patch.
- d. The patches shall be adjusted in the field to meet special conditions such as previous paving or patching limits.

2. Width of Patch (all dimensions are curb face to curb face)

a. All Streets Except Divided or one way roadways

- i. Street Width 0 to 24 feet wide - Patch entire street width
- ii. Street Width 25 to 37 feet wide - Patch one half the street width (curb to centerline of roadway). Note - Utility Engineer may adjust paving limit to correspond with a painted centerline in situations where the painted centerline is not in the center of the street.
- iii. Street Width 38 feet and up - Patch width of entire lane for each lane which was disturbed by the excavation.
 1. If the lane is adjacent to a bike lane, include the bike lane. (except when there is a parking lane between the bike lane and the curb)
 2. If the lane is a bike lane and adjacent to a parking lane, include the parking lane.
 3. If the lane is a bike lane and not adjacent to a parking lane, include the adjacent travel lane.

b. Divided Roadways and One Way Streets

- i. Street 0 to 19 feet wide - Patch entire street width
- ii. Street Width 20 feet and up - Patch width of entire lane for each lane which was disturbed by the excavation.
 1. If the lane is adjacent to a bike lane, include the bike lane. (except when there is a parking lane between the bike lane and the curb)
 2. If the lane is a bike lane and adjacent to a parking lane, include the parking lane.
 3. If the lane is a bike lane and not adjacent to a parking lane, include the adjacent travel lane.

DETAILS

TYPICAL SECTIONS CITY OF MADISON

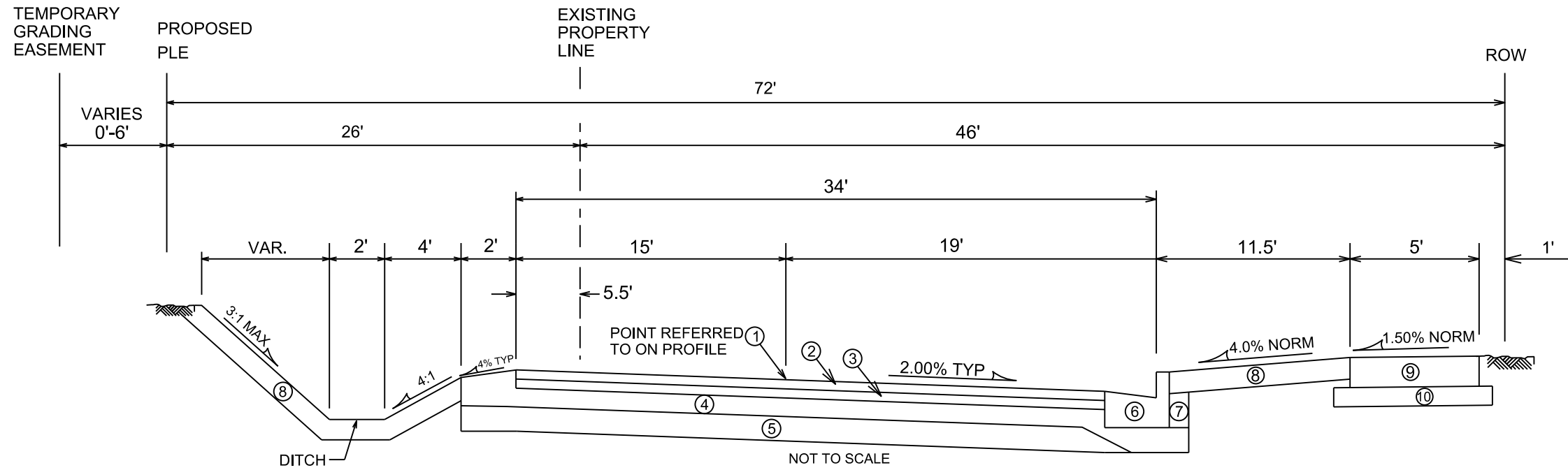

- ① POINT REFERRED TO ON PROFILE
- ② 2" BITUMINOUS UPPER LAYER (4 LT 58-28 S)
- ③ 2 1/2" BITUMINOUS LOWER LAYER (3 LT 58-28 S)
- ④ 6" GRADATION 2 CRUSHED STONE
- ⑤ 6" GRADATION 1 CRUSHED STONE
- ⑥ TYPE 'A' CONCRETE CURB & GUTTER
- ⑦ FILL, INCIDENTAL
- ⑧ 6" TOPSOIL, SEED & MAT
- ⑨ 5" CONCRETE SIDEWALK
- ⑩ MIN. 2" SELECT FILL

SEE CROSS SECTION SHEETS FOR
CROSS SLOPES AND TOP OF
CURB ELEVATIONS.

*CITY OF MADISON MINIMUM PAVEMENT DESIGN
1) ALL PAVEMENT ON DILORETO AVE SHALL BE TYPE 'B' PER
STANDARD SPECIFICATIONS

TYPICAL FINISHED SECTION
DILORETO AVENUE
STATION 18+50 to STATION 20+25

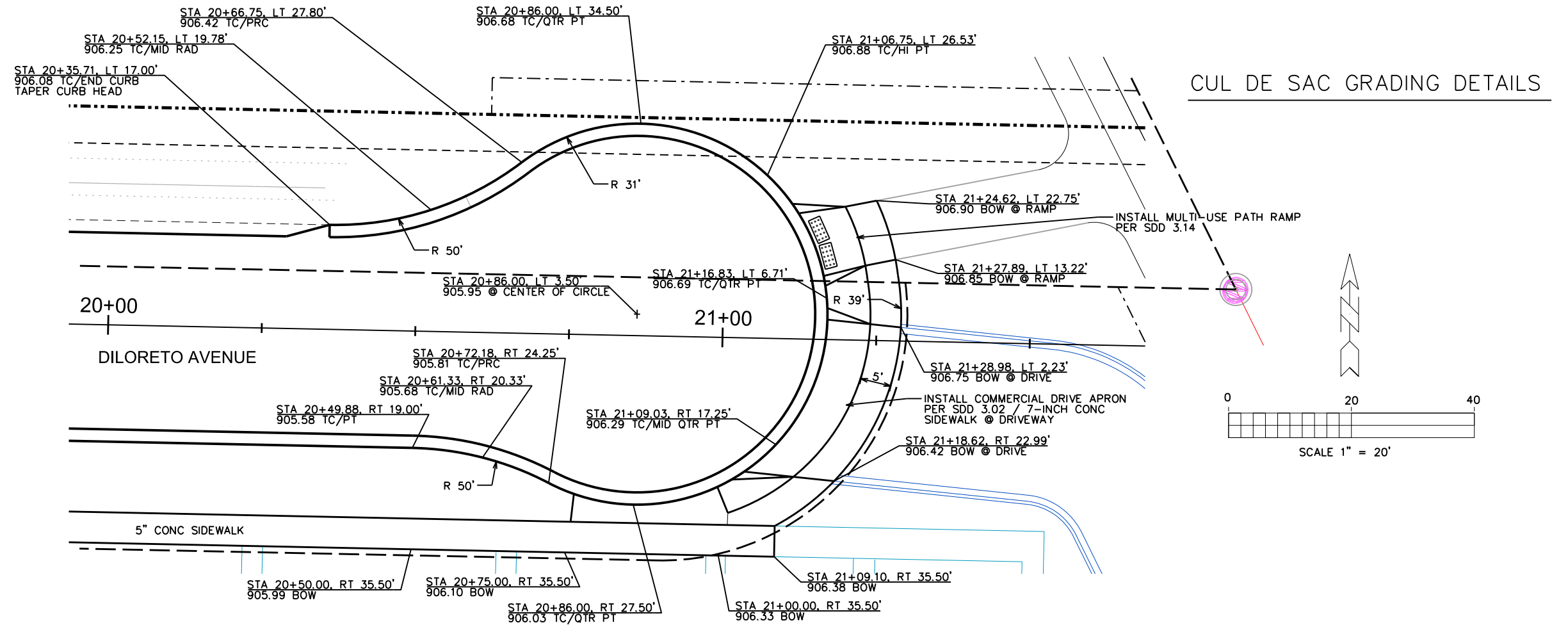

CUL DE SAC GRADING DETAILS

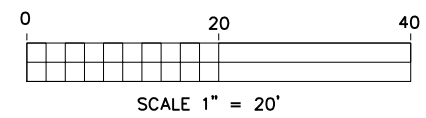

PLOT SCALE: _____

PLOT NAME: _____

REV. DATE: _____

ORIGINATOR: CITY OF MADISON, STREETS DIVISION

0810-222-9170-0
BETTY'S REAL ESTATE LLC

NOTE: PLACE SILT SOCK OR WATTLES @ DOWNSTREAM APRON END INLETS AS DIRECTED BY THE ENGINEER

PLACE SILT SOCK OR WATTLES @ 100 FOOT INTERVALS PER WDNR SPECIFICATIONS

RESTORE AND STABILIZE DITCH SLOPES AND BOTTOM WITH 6" TOPSOIL, TERRACE SEEDING & EROSION MATTING (CLASS I, TYBE B)

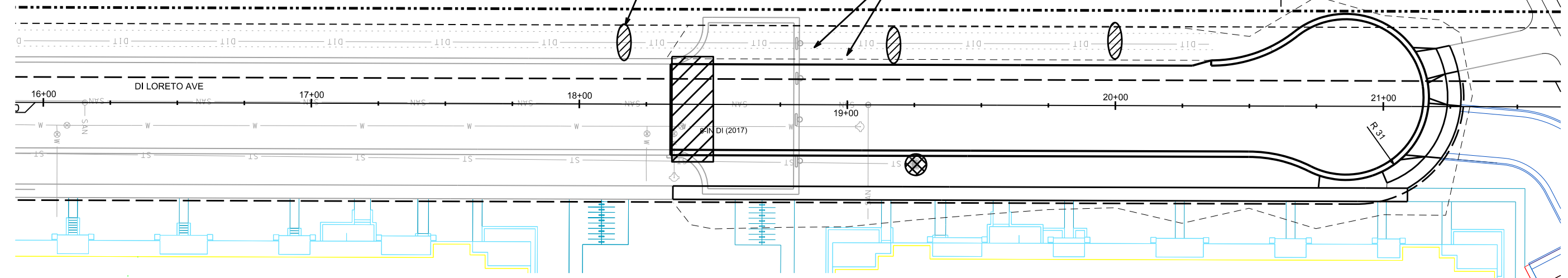

0810-2220-201-4
5422 PORTAGE ROAD LLC
4119 PORTAGE RD

- STREET CONSTRUCTION ENTRANCE BERM
- CONSTRUCTION ENTRANCE
- TYPE D HYBRID INLET PROTECTION
- TYPE A INLET PROTECTION
- SILT SOCK (VELOCITY CHECK)
- STREET CONSTRUCTION STONE BERM

EROSION CONTROL NOTES:

EROSION CONTROL MEASURES SHALL BE IN PLACE PRIOR TO ANY OTHER CONSTRUCTION ACTIVITY.

THE CONTRACTOR IS RESPONSIBLE FOR THE CONSTRUCTION AND MAINTENANCE OF ALL EROSION CONTROL MEASURES UNTIL FINAL ACCEPTANCE BY THE CITY OF MADISON.

THE CONTRACTOR SHALL INSTALL AND MAINTAIN EROSION CONTROL MEASURES IN ACCORDANCE WITH THE WDNR SOC STANDARDS AND CITY OF MADISON STANDARD SPECIFICATIONS.

THE CONTRACTOR SHALL PROVIDE STREET CLEANING AS NEEDED ON A DAILY BASIS TO KEEP TRACKING TO A MINIMUM.

INLET PROTECTION SHALL BE INSTALLED WITHIN THE CONSTRUCTION LIMITS. ADDITIONAL INLET PROTECTION SHALL BE INSTALLED AS DIRECTED.

POLYMER SHALL BE APPLIED TO DISTURBED AREAS AS DIRECTED BY THE CONSTRUCTION ENGINEER.

NOTES: 1) SEE SHEET D-2 FOR CURB GRADES AND DETAILS AT CUL DE SAC.
2) IMPROVEMENTS SHOWN ON PRIVATE PROPERTY ARE BY OTHERS AND ARE SHOWN FOR REFERENCE ONLY.

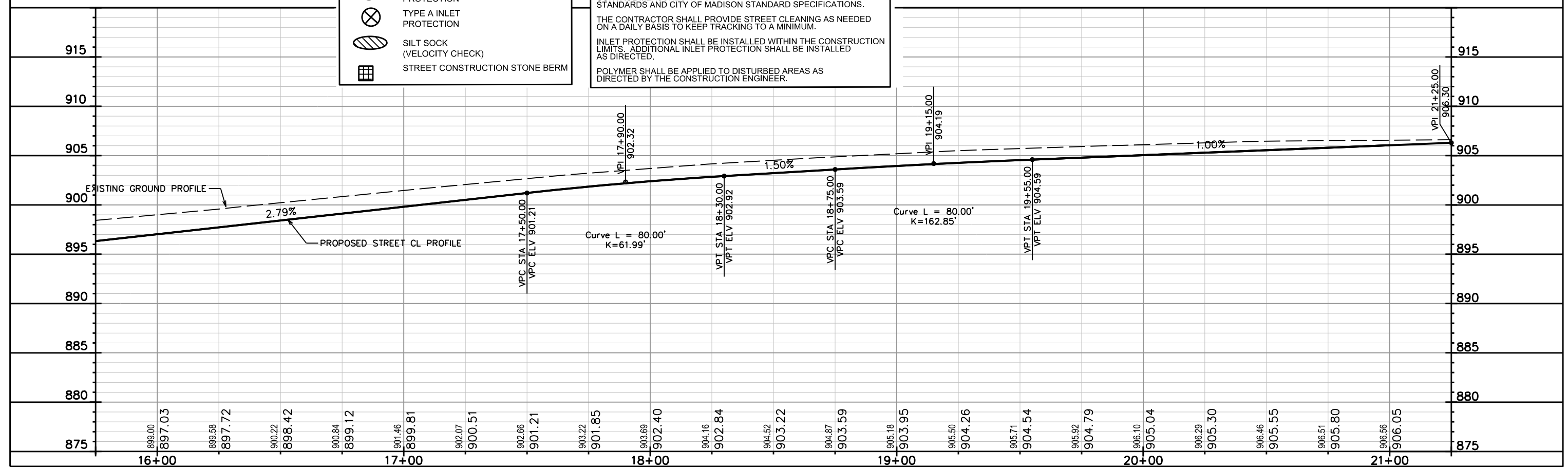

PLOT SCALE: _____

PLOT NAME: _____

REV. DATE: _____

ORIGINATOR: CITY OF MADISON, STREETS DIVISION

0810-222-9170-0
BETTY'S REAL ESTATE LLC

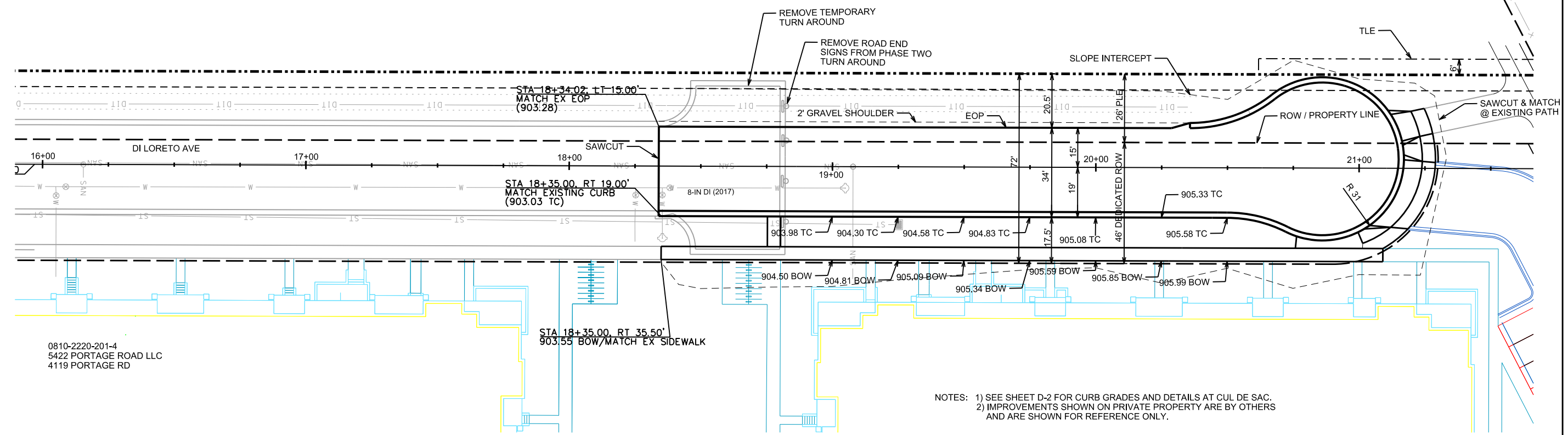

0810-2220-201-4
5422 PORTAGE ROAD LLC
4119 PORTAGE RD

NOTES: 1) SEE SHEET D-2 FOR CURB GRADES AND DETAILS AT CUL DE SAC.
2) IMPROVEMENTS SHOWN ON PRIVATE PROPERTY ARE BY OTHERS AND ARE SHOWN FOR REFERENCE ONLY.

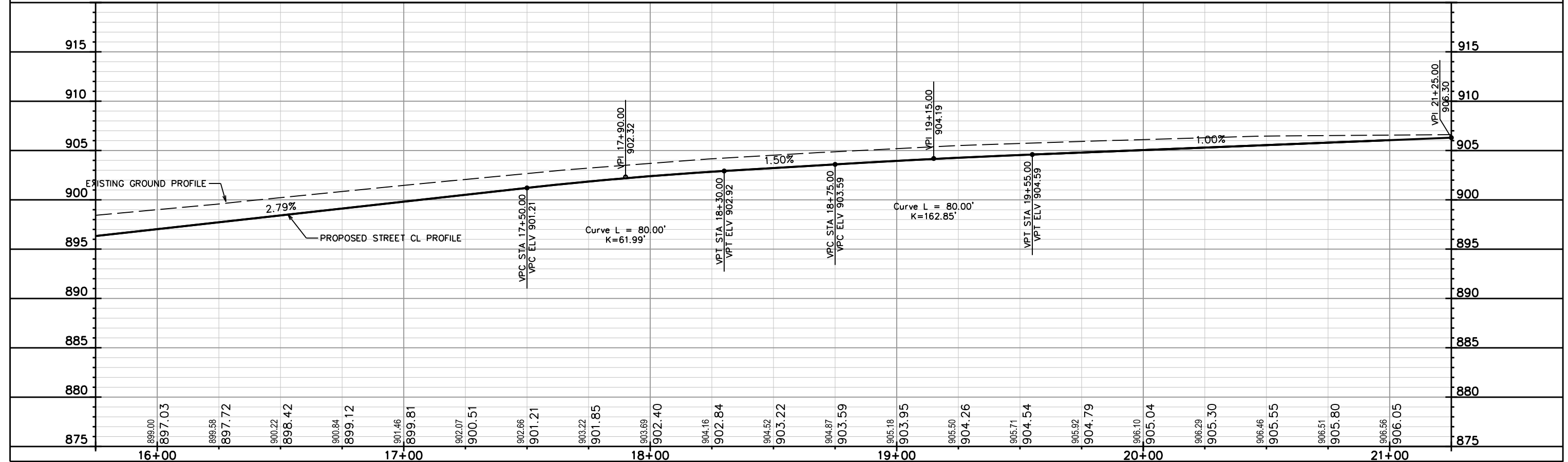

PLOT SCALE: _____

PLOT NAME: _____

REV. DATE: _____

ORIGINATOR: CITY OF MADISON, STREETS DIVISION

ALL BIORETENTION LIMITS TO BE 1'
OFF SIDEWALK AND BACK OF CURB.
SLOPES TO BE 3:1, WORK PER
BIORETENTION/UNDERDRAIN DETAIL



PLOT SCALE:

PLOT NAME:

REV. DATE:

ORIGINATOR: CITY OF MADISON, STREETS DIVISION

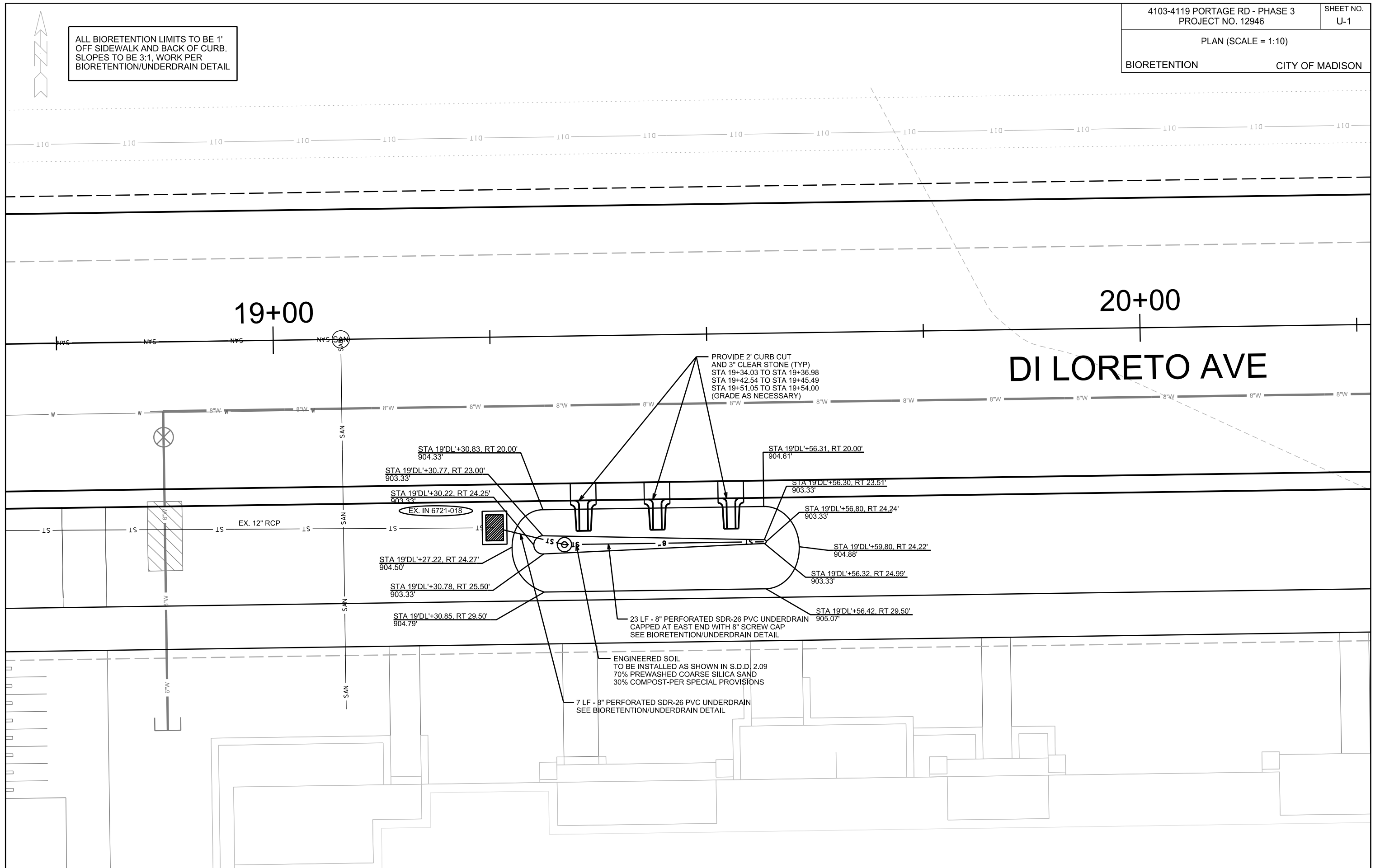

4103-4119 Portage Rd Rain Garden - Di Loreto Ave				
RAIN GARDEN PLANTING SCHEDULE				
COMMON PLANT NAME	SCIENTIFIC NAME	SIZE	P O T T D	Q t y
NOTE: All plugs shall be spaced 1'-0" on center				
Forbs				
Iris	Iris versicolor (or shreiveii)	2.5" Plug	X	20
Spiderwort	Tradescantia ohiensis	2.5" Plug	X	20
Obedient plant	Physostegia virginiana	2.5" Plug	X	20
Purple meadow rue	Thalictrum dasycarpum	2.5" Plug	X	20
Blue vervain	Verbena hastata	2.5" Plug	X	20
Purple giant hyssop	Agastache scrophulariaefolia	2.5" Plug	X	20
Bergamot	Monarda fistulosa	2.5" Plug	X	20
Butterfly milkweed	Asclepias tuberosa	2.5" Plug	X	20
White false indigo	Baptisia alba	2.5" Plug	X	20
Golden Alexander	Zizia aurea	2.5" Plug	X	20
Riddell's goldenrod	Solidago riddellii	2.5" Plug	X	20
Smooth blue aster	Symphotrichum laeve	2.5" Plug	X	20
Sedges and Grasses				
Brown fox sedge	Carex vulpinoidea	2.5" Plug	X	20
Virginia wild rye	Elymus virginica	2.5" Plug	X	20
Little bluestem	Schizachyrium scoparium	2.5" Plug	X	20
TOTAL PLANTS				300

CONCRETE FLUME OPENING DETAIL (NOT TO SCALE)

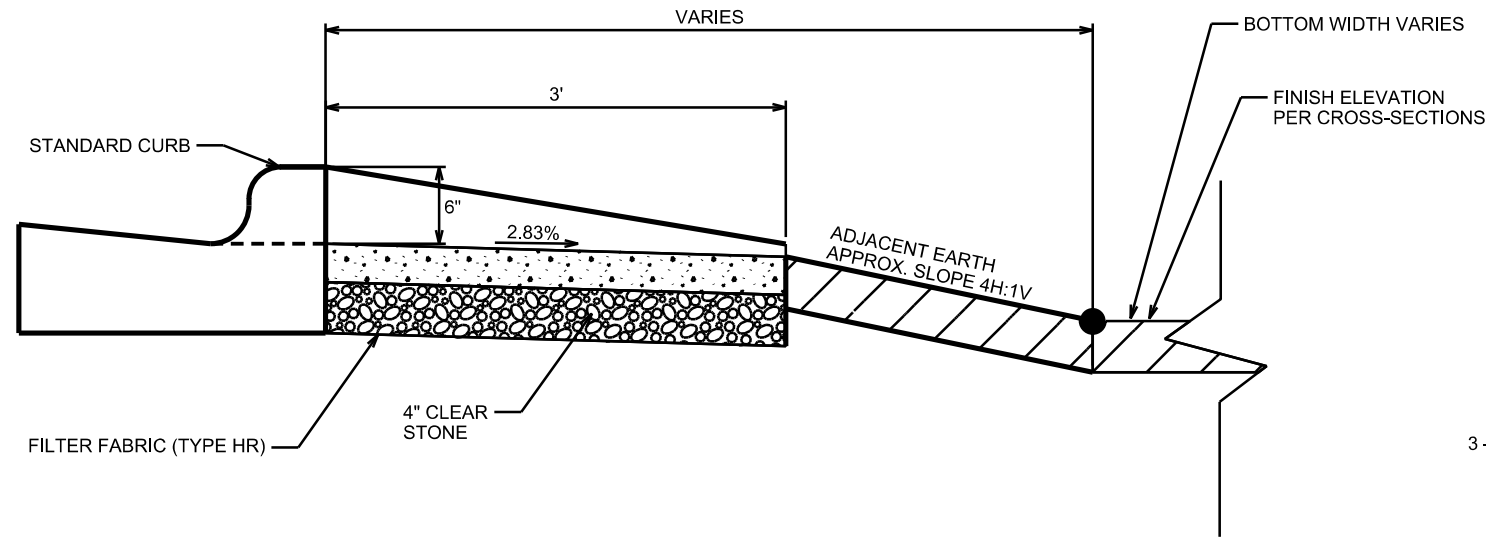

CONCRETE FLUME DETAIL (NOT TO SCALE)

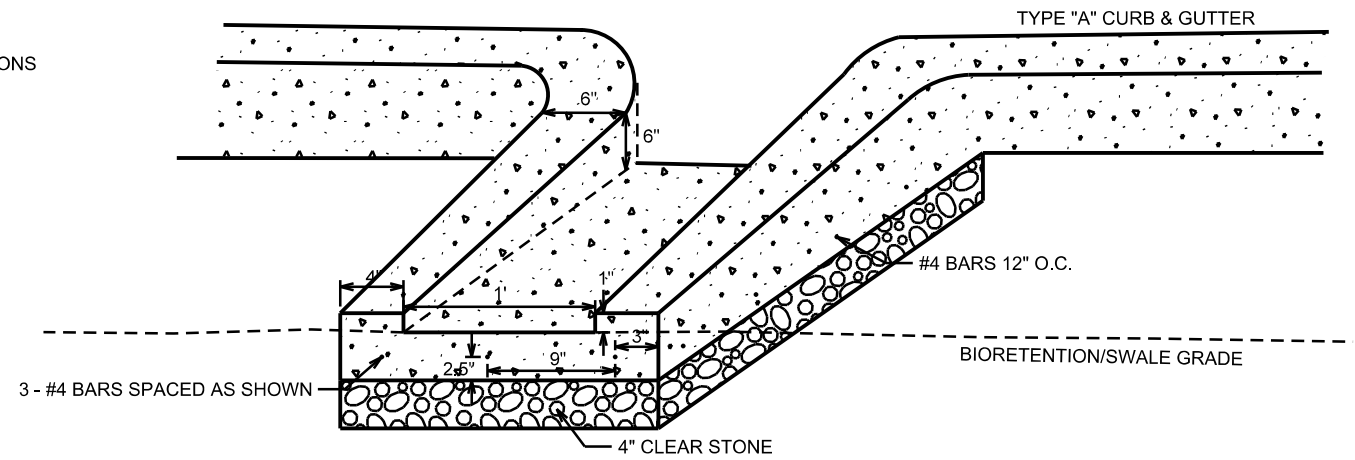

PLOT SCALE: _____

PLOT NAME: _____

REV. DATE: _____

ORIGINATOR: CITY OF MADISON, STREETS DIVISION

BIORETENTION CROSS SECTION (TYP.)
(NOT TO SCALE)

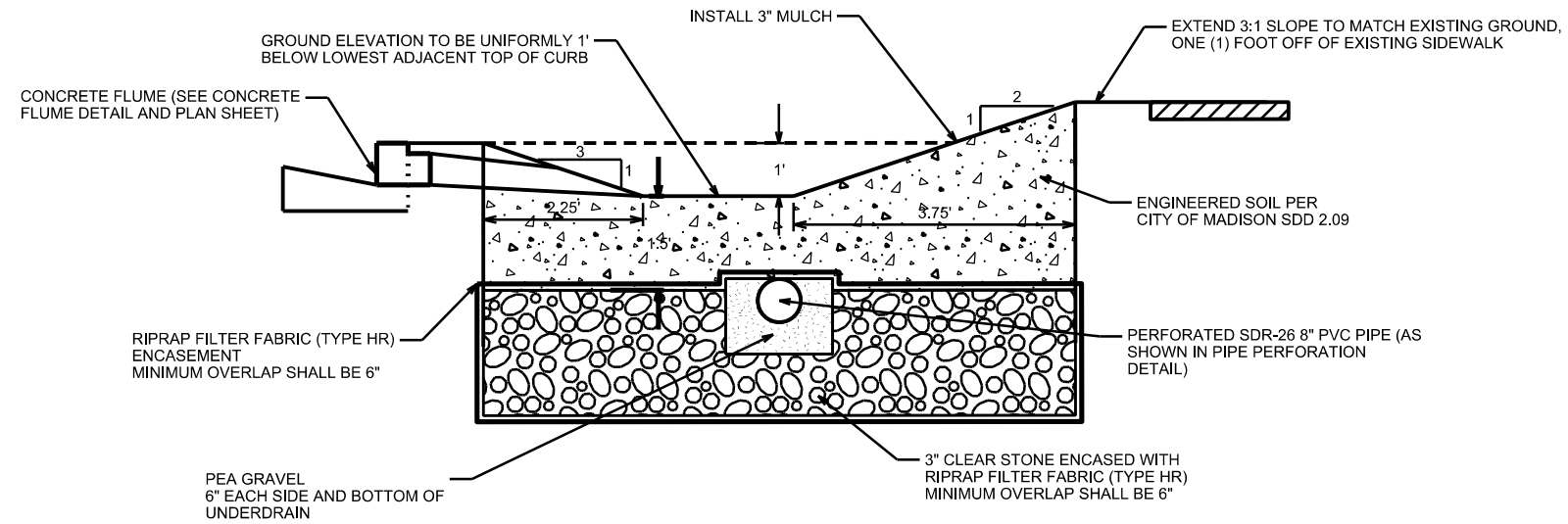

UNDERDRAIN DRILL PATTERN DETAIL
(NOT TO SCALE)

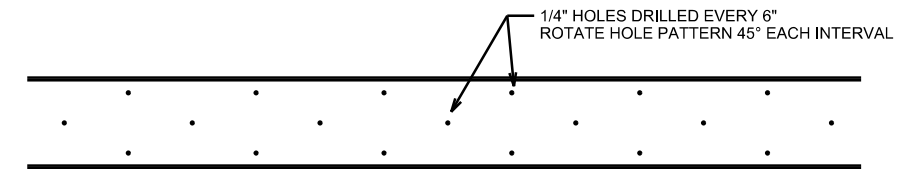

DRILL PATTERN PROFILE (ABOVE)



DRILL PATTERN CROSS-SECTION (ABOVE)

UNDERDRAIN PROFILE
(NOT TO SCALE)

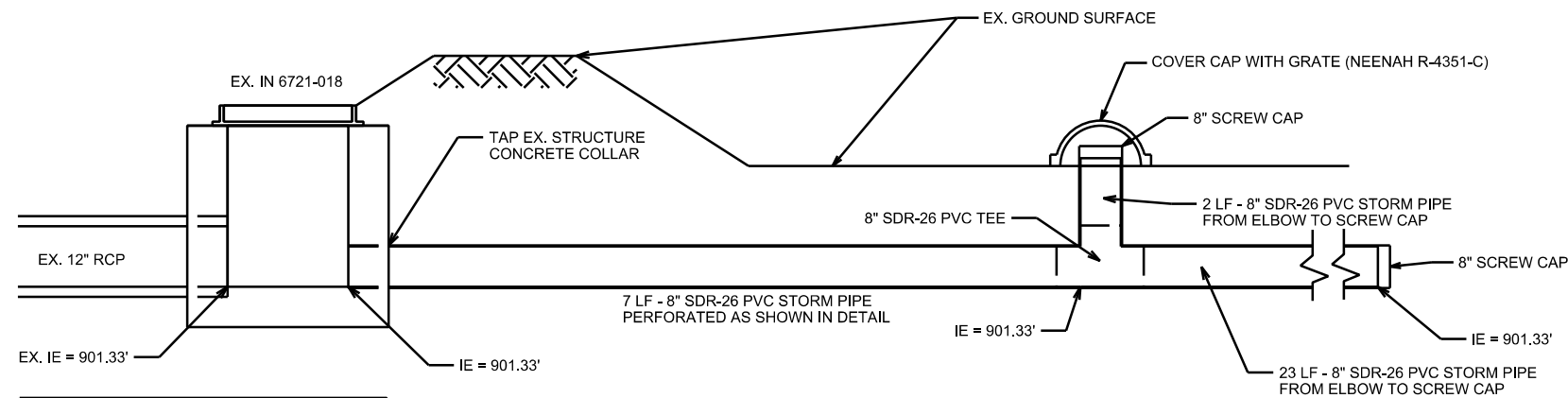

NOTE:
TOTAL PERFORATED UNDERDRAIN QUANTITY:
32 LF 8" SDR-26 PVC UNDERDRAIN
INCLUDES ALL FITTINGS AS SHOWN IN DETAILS

PLOT SCALE: _____

PLOT NAME: _____

REV. DATE: _____

ORIGINATOR: CITY OF MADISON, STREETS DIVISION

0810-222-9170-0
BETTY'S REAL ESTATE LLC

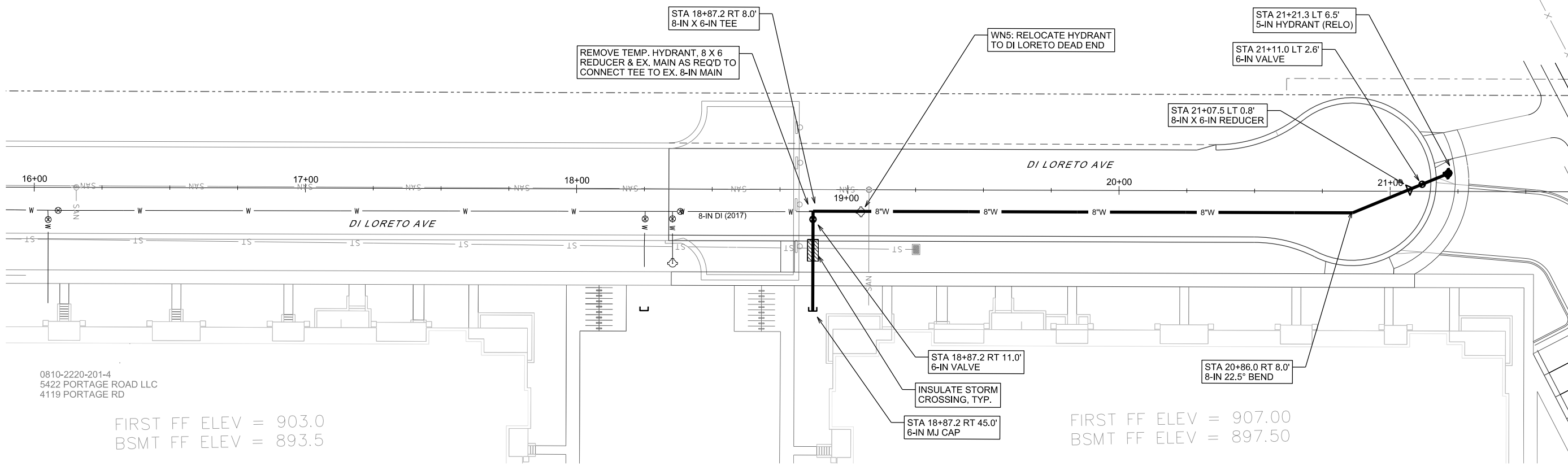

0810-2220-201-4
5422 PORTAGE ROAD LLC
4119 PORTAGE RD

FIRST FF ELEV = 903.0
BSMT FF ELEV = 893.5

FIRST FF ELEV = 907.00
BSMT FF ELEV = 897.50

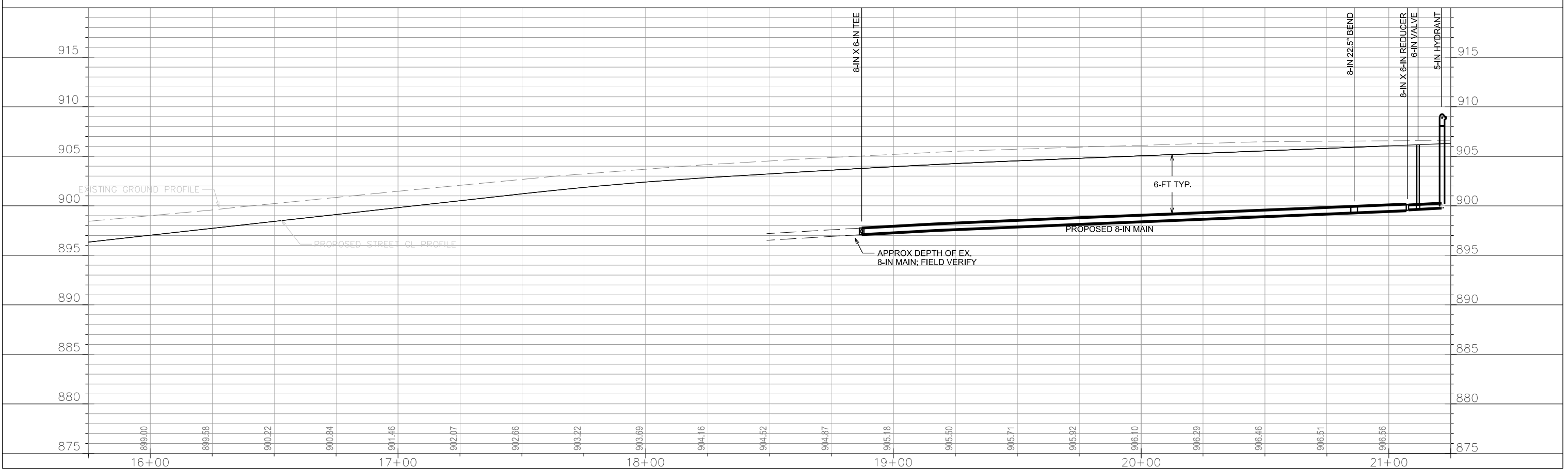

PLOT SCALE: _____

PLOT NAME: _____

REV. DATE: _____

ORIGINATOR: CITY OF MADISON, STREETS DIVISION

CROSS SECTIONS
DI LORETO AVENUE CITY OF MADISON

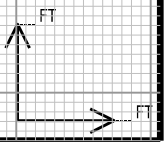
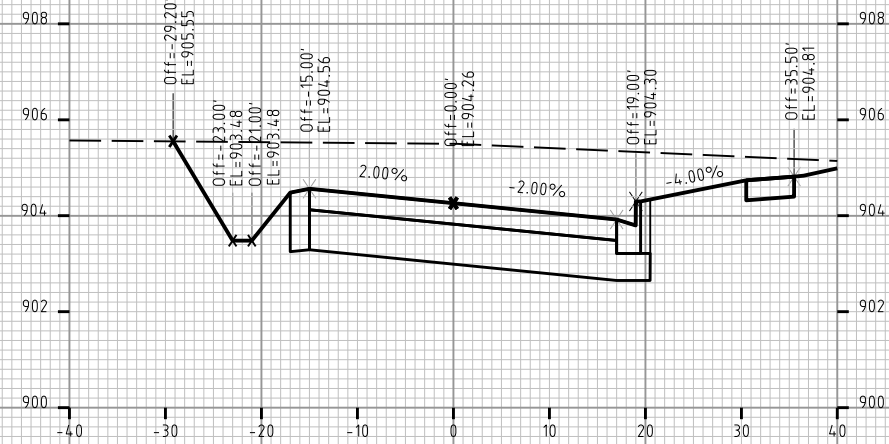
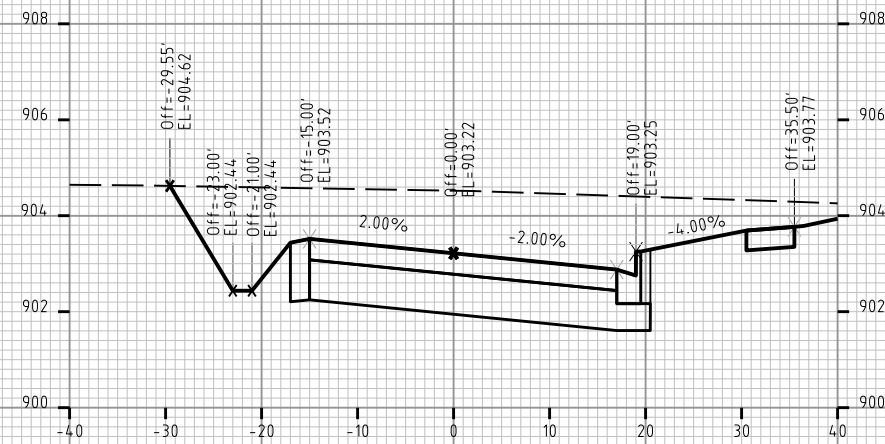
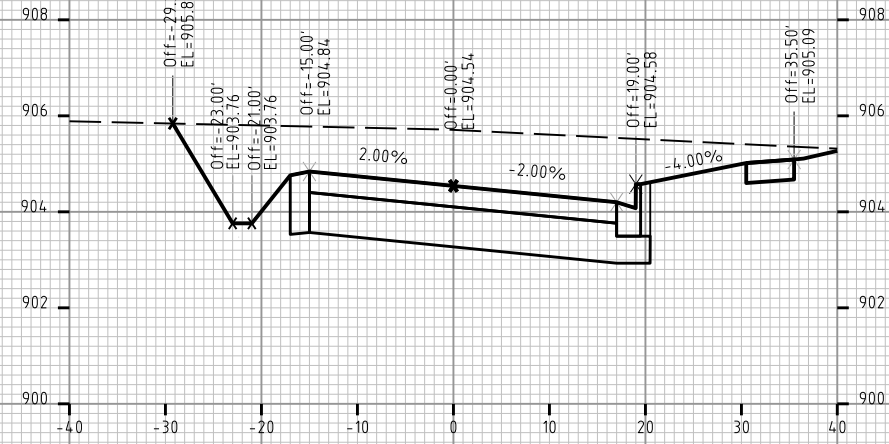
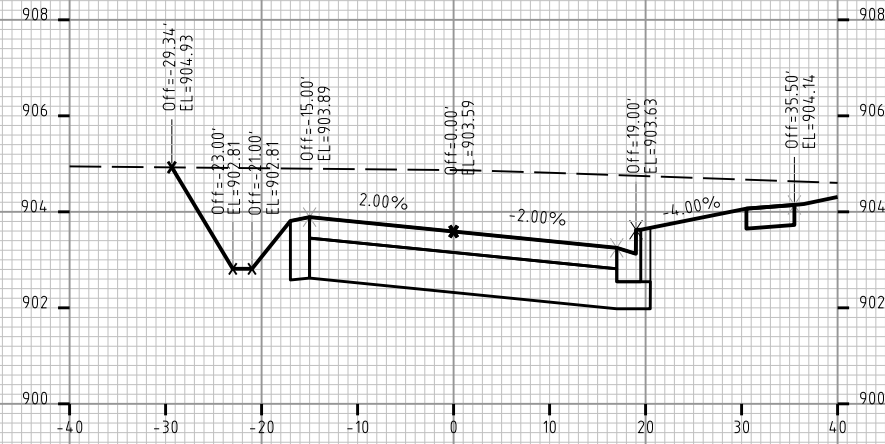
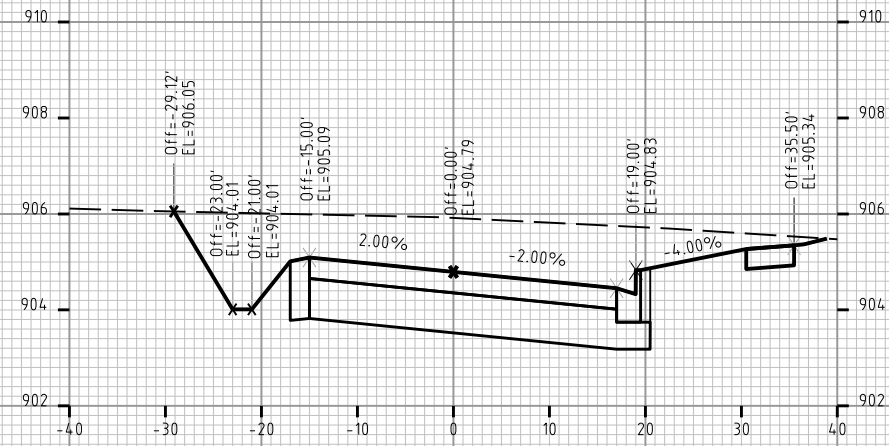
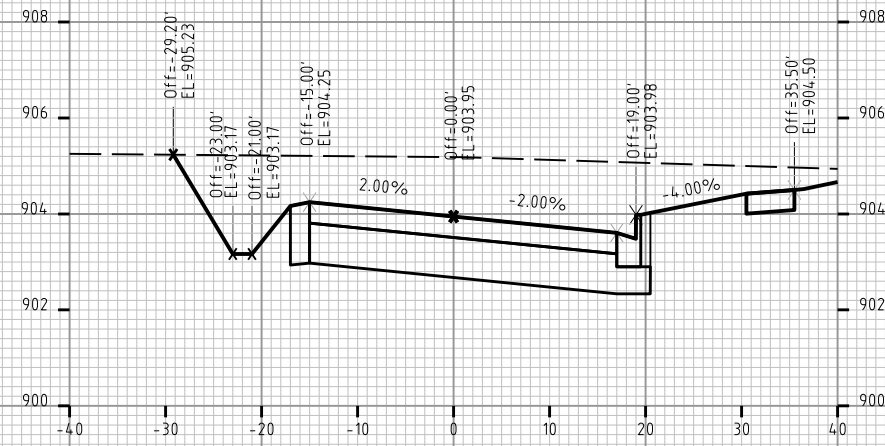

PLOT SCALE: _____

PLOT NAME: _____

REV. DATE: _____

ORIGINATOR: CITY OF MADISON, STREETS DIVISION

CROSS SECTIONS
DI LORETO AVENUE CITY OF MADISON

PLOT SCALE: _____

PLOT NAME: _____

REV. DATE: _____

ORIGINATOR: CITY OF MADISON, STREETS DIVISION

