

Dropbox Guide: Logging into Dropbox

The following guide will cover the different ways of logging into your CUNY Dropbox account.

Via Mobile Device

1. Open the Dropbox app.
2. Select **Sign In**.
3. On the Sign-in page, enter your CUNY Login username. Do **NOT** enter your password.
4. Click the **SIGN IN** button.
5. The Web Applications Login page will appear.
6. Re-enter your CUNY Login username.
7. Enter your CUNY Login password.
8. Click Login.

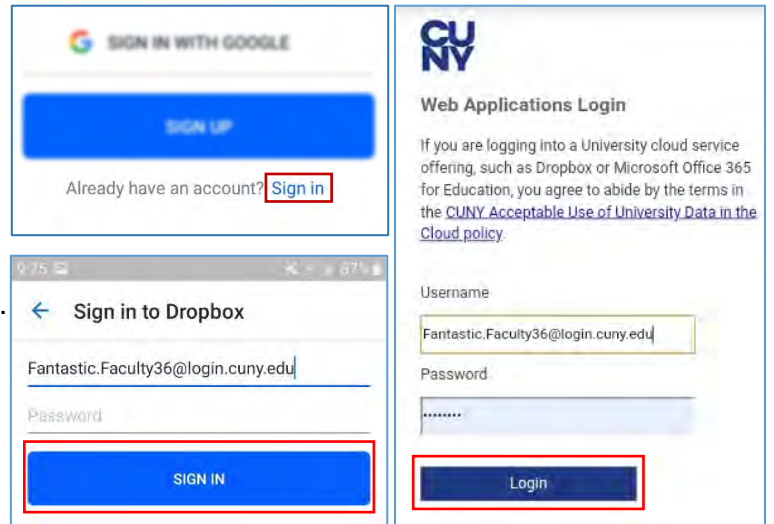

Via Workstation/Browser

1. Open your browser and navigate to dropbox.cuny.edu
2. The Web Applications Login page will appear.
3. Enter your CUNY Login username.
4. Enter your CUNY Login password.
5. Click the **Login** button.

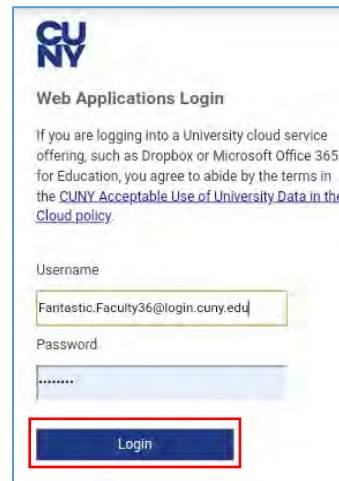

OR

1. Open your browser and navigate to Dropbox.com
2. Click the **Sign in** link.
3. Enter your CUNY Login username. The password field will disappear.
4. Click **Continue**.

