

TOP VIEW

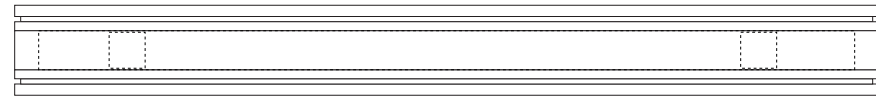

SIDE A

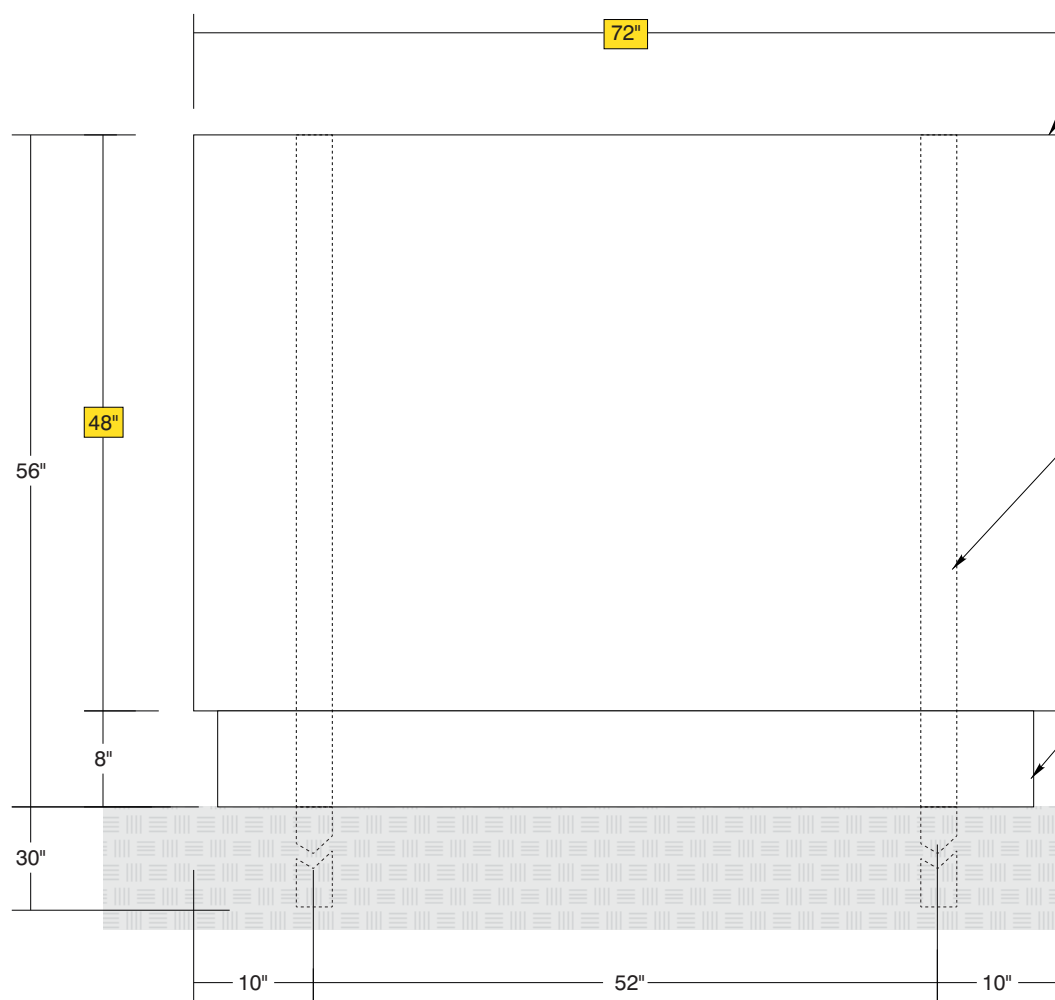

• **Sign System: (I-Flex Flush Face)**
 • (2) .080" Aluminum Panels: (H) 48" x (L) 72"

• **Paint:**
 ○ Standard White - Frame, Panel, Baseskirt

• **Double Internal Post Mount**
 • (2) Post Size: 3" x 3" x (L) 86"

• **Removable Base Skirt**
 • .080" Aluminum (H) 8" x (L) 68" x (D) 3 1/4"

SIDE VIEW

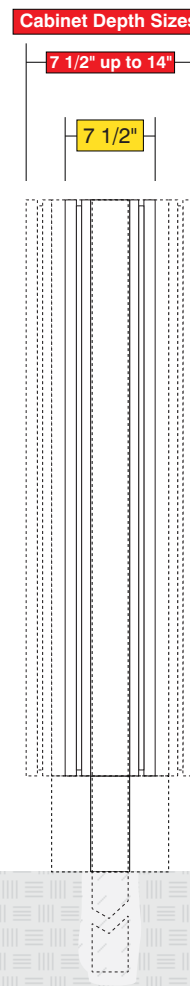

SIDE B

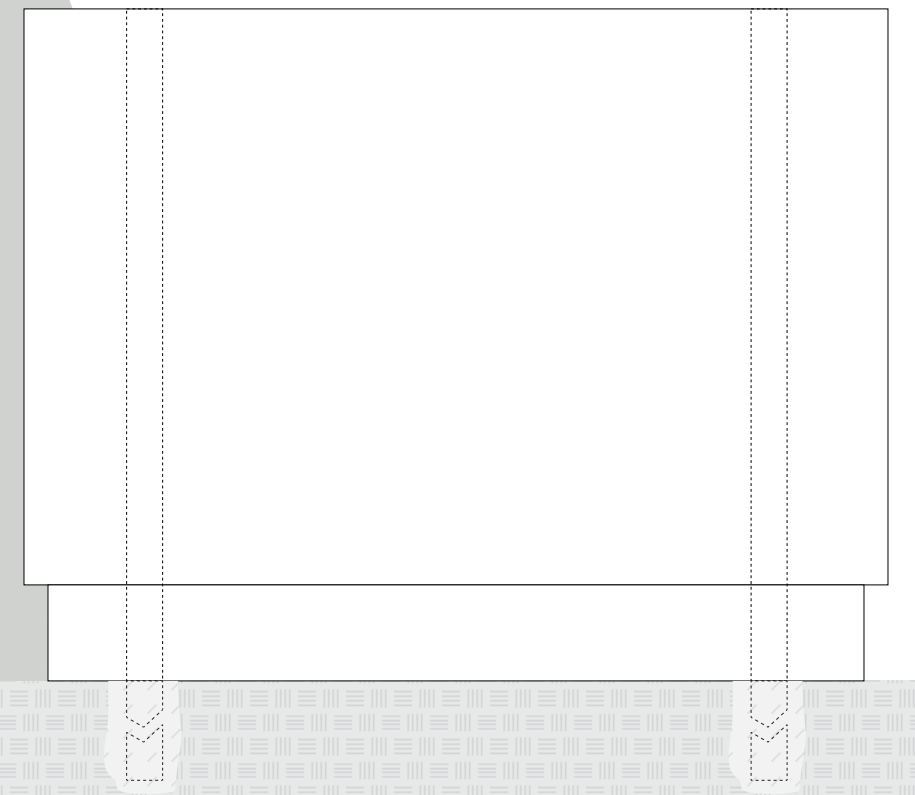

Date	DWG# I-Flex_FF_Pylon	Scale: 3/4" = 1'	Customer	Mounting SF/DF	Double Post Mount Double Face		Quote #
XX.XX.XX			Location	Illuminated	NO	UL	Sales Rep.
Quantity			System	Voltage	N/A	Amp N/A	Illustrator:
1			I-Flex Flush Face 48x72 Pylon Sign System	ADA	No		Reviewed By:
Page				*Due to the ADA/ANSI's wide interpretation and other factors that may exist, we cannot affirm compliance in all situations and is hereby removed from responsibility regarding these issues.			
1 of 1							



• 6400 Howard Drive, Fairview PA 16415 • Toll Free 800.458.0591 •
 • PA 814.833.7000 • Fax 814.838.0011 •
 www.howardindustries.com

All concepts and designs represented by this drawing are the property of Howard Industries and may not be reproduced or used in any manner without written consent. ©Copyright 2020 Howard Industries.