



FOR IMMEDIATE RELEASE

Thursday, March 17, 2022

Media Contacts:

German Vigil – (202) 306-1668, german.vigil@dc.gov

**I-295 Corridor Projects - Weekly Closures
March 21 through March 28, 2022**

(Washington, D.C.) – The District Department of Transportation (DDOT) will temporarily close roadways, lanes, ramps, and shoulders on the following corridors to perform construction activities along I-295 / DC 295 and nearby local roads. These closures are contingent on suitable weather, field conditions, and/or adjacent construction activities. Daily closures will take place between 9:30 a.m. and 3:30 p.m. Nightly closures will take place between 9:00 p.m. and 5:00 a.m. the following day (unless otherwise stated below).

Single left or right lane closures will occur anytime daily and nightly during off-peak periods on northbound and southbound I-295 between the merge from Malcolm X Avenue and I-695.

Single left or right lane closures will occur daily and nightly in both directions on South Capitol Street SE/SW between Firth Sterling Avenue SE and N Street SE. Single lane closures will take place during weekday off-peak hours, and during the weekend from 7:00 a.m. to 7:00 p.m.

Single left or right lane closures will occur daily and nightly in both directions Suitland Parkway SE between the Martin Luther King, Jr. Avenue SE overpass and South Capitol Street SE. These single lane closures along these roadways will take place during off-peak hours.

No other closures on South Capitol Street SE/SW or Suitland Parkway SE will take place on weekdays between 5:00 a.m. and 9:30 a.m. and between 3:30 p.m. and 9:00 p.m.

Daily and nightly single lane closures will also occur during off-peak hours on Firth Sterling Avenue SE, Howard Road SE, Potomac Avenue SE/SW, Half Street SW, Q Street SW, and R Street SW.

The following full ramp closures will also occur as described below:

- Exit 4 from I-295 Northbound (South Capitol Street / Suitland Parkway) – Saturday, March 26, between 4:00 a.m. and 8:00 p.m.
- Exit 4A from I-295 Southbound (Suitland Parkway) – weeknights between 9:00 p.m. and 5:00 a.m.

Southbound South Capitol St SW between Suitland Parkway and Firth Sterling Avenue SE will be closed nightly from 9:00 p.m. to 5:00 a.m. the following morning for roadway construction. When southbound South Capitol Street is closed, eastbound Suitland Parkway and southbound Firth Sterling Avenue will remain open to traffic. A marked detour will be in place during these closures.

Southbound South Capitol St SE Closure & Detour



Eastbound Suitland Parkway from South Capitol Street SE to Martin Luther King Jr. Avenue SE will be closed on Saturday, March 26 from 4:00 a.m. to 8:00 p.m. for re-construction. This will include the closure of (1) Exit 4A from southbound I-295 to outbound Suitland Parkway and (2) Exit 4 from northbound I-295 to Suitland Parkway. When eastbound Suitland Parkway is closed, Firth Sterling Avenue SE and South Capitol Street SE will remain open to all traffic. In the event of weather or other unforeseen issues the closure will occur on Sunday, March 27. Marked detours will be in place during these closures.

Eastbound Suitland Parkway Closure & Detour

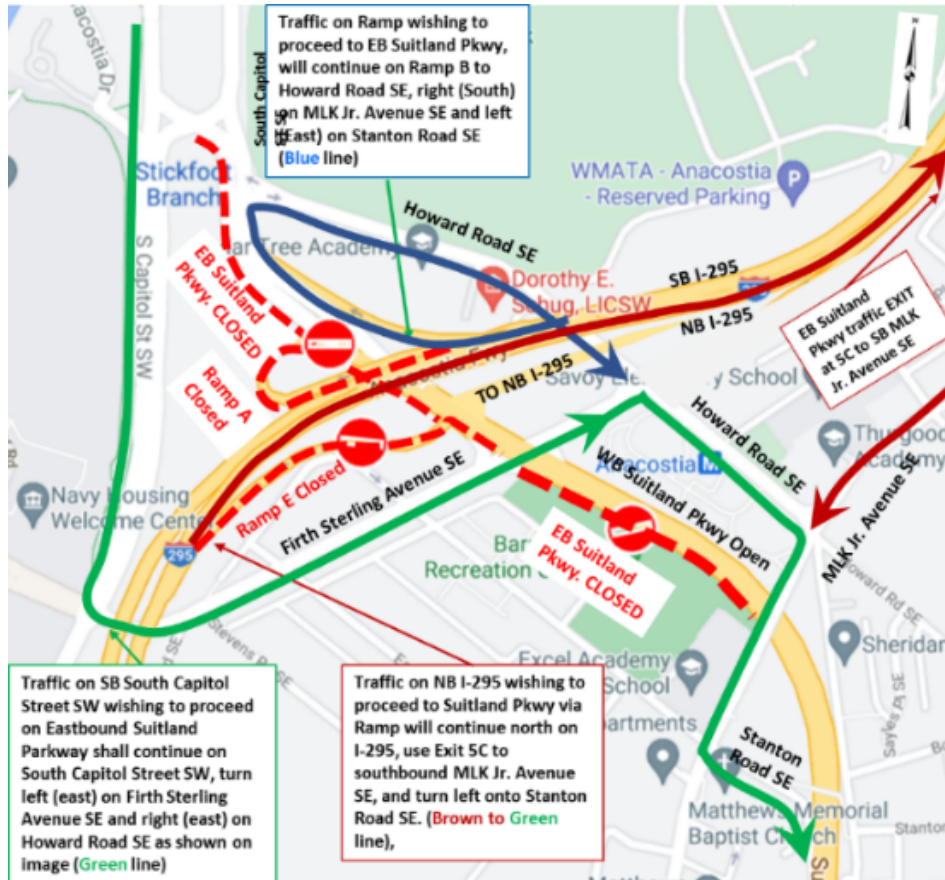

Firth Sterling Avenue SE between Suitland Parkway and Howard Road SE will be closed on Saturday, March 26 and Sunday, March 27 from 7:00 a.m. to 7:00 p.m. for re-construction. When Firth Sterling Avenue SE is closed, Suitland Parkway and South Capitol Street will remain open to traffic. Marked detours will be in place during these closures.

Firth Sterling Avenue SE Closure & Detour

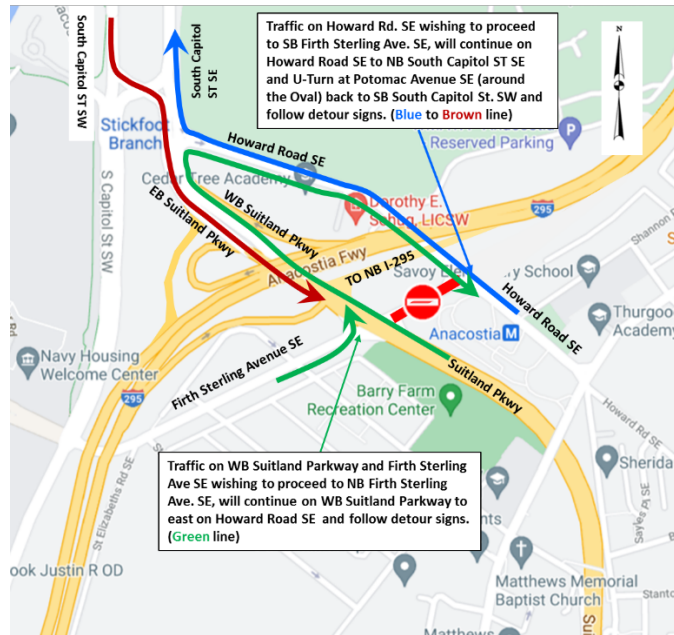

These closures are required for construction activities associated with the following DDOT project:

South Capitol Street Corridor Project - Frederick Douglass Memorial Bridge

The South Capitol Street Corridor Project calls for replacing the Frederick Douglass Memorial Bridge and transforming related sections of the urban freeway into a beautiful scenic boulevard that increases pedestrian and vehicular safety, improves multimodal transportation options, increases community accessibility, and supports economic development on both sides of the Anacostia River.

Traffic controls will be in place to guide all users of the roadway through the work zones safely. Motorists should expect delays due to the lane closures and are advised to stay alert and be observant of signage and road work crews while traveling in this area.

For more information about efforts to improve the 295 corridors and to stay up to date on traffic related impacts and construction progress, please visit www.improving295dc.com.

###

The mission of the District Department of Transportation (DDOT) is to enhance the quality of life for District residents and visitors by ensuring that people, goods, and information move efficiently and safely with minimal adverse impact on residents and the environment.

Follow us on [Twitter](#), like us on [Facebook](#), and visit the website at www.ddot.dc.gov to find out about DDOT's work across all eight wards of the District. Visit goDCgo.com for more information on transportation options in the District.