



FOR IMMEDIATE RELEASE

Thursday, April 7, 2022

Media Contacts:

German Vigil – (202) 306-1668, german.vigil@dc.gov

Mariam Nabizad – (202) 359-2678, mariam.nabizad@dc.gov

Temporary Closures on Southbound South Capitol Street SW Eastbound Suitland Parkway, and Firth Sterling Ave. SE April 11 to April 18, 2022

(Washington, D.C.) - The District Department of Transportation (DDOT) will temporarily close southbound South Capitol Street SW between Suitland Parkway and Firth Sterling Avenue SE nightly from 9:00 p.m. to 5:00 a.m. the following morning for roadway construction. *When southbound South Capitol Street is closed, eastbound Suitland Parkway and southbound Firth Sterling Avenue will remain open to traffic.* Marked detours will be in place during these closures.

Southbound South Capitol St SE Closure & Detour



Eastbound Suitland Parkway from South Capitol Street SE to Martin Luther King Jr. Avenue SE will be closed nightly from 9:00 p.m. to 5:00 a.m. the following morning for re-construction. This will include the closure of (1) Exit 4A from I-295 southbound to eastbound Suitland Parkway and (2) Exit 4 from I-295 northbound to Suitland Parkway. In addition, exit 4 from I-295 northbound to Suitland Parkway will have extended closures over the weekend. **When eastbound Suitland Parkway is closed, South Capitol Street SE and Firth Sterling Avenue SE will remain open to traffic.** Marked detours will be in place during these closures.

Eastbound Suitland Parkway Closure & Detour

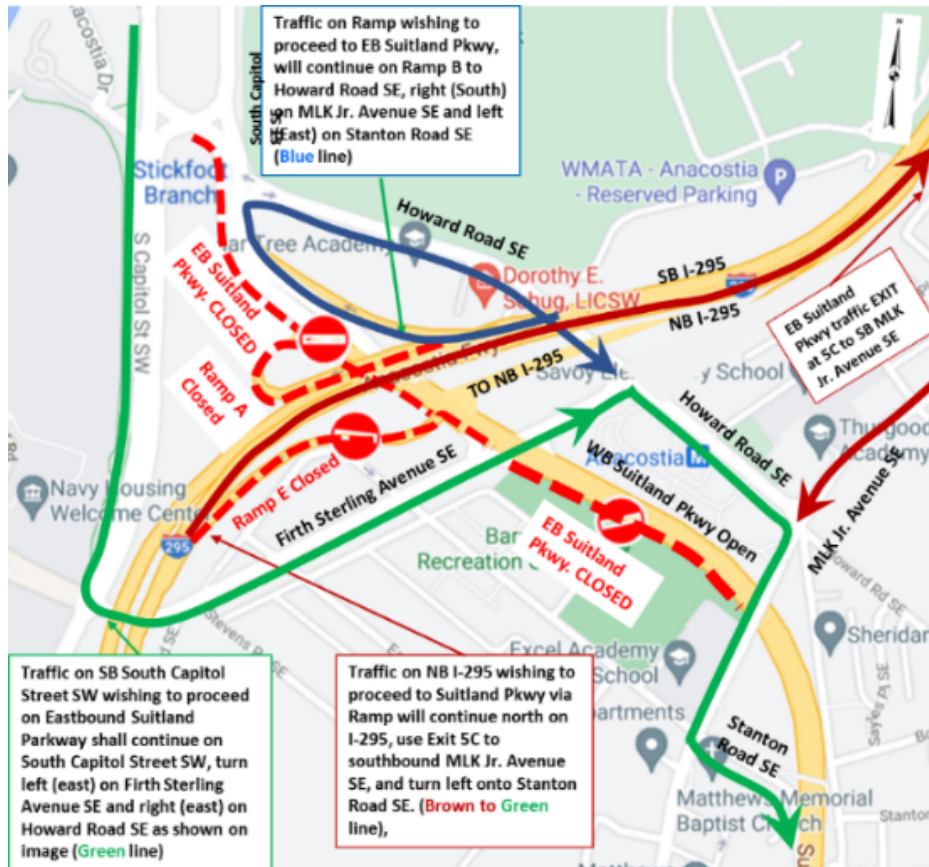

Firth Sterling Avenue SE between Suitland Parkway and Howard Road SE will be closed on Friday night, April 15 and Saturday night, April 16 between 9:00 p.m. and 5:00 a.m. the following morning for re-construction. Marked detours will be in place during these closures.

Firth Sterling Avenue Closure & Detour

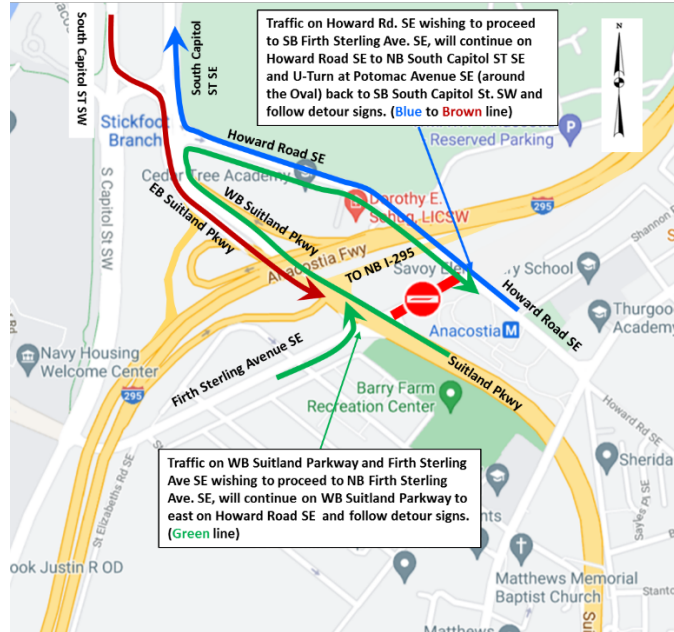

Due to the scheduled DC United game at Audi Field on Saturday, April 16, lane closures will not occur between 5:30 p.m. and 11:30 p.m. Due to the scheduled Washington Nationals game at Nationals Park on Monday, April 18, lane closures will not occur between 5:00 p.m. and 12:00 a.m. If either of these events are cancelled, lane closures will occur during the typical times. Additionally, any nighttime full roadway closures that are prohibited on these event days will take place in the event of an event cancellation.

These closures are necessary for construction activities associated with the South Capitol Street Corridor Project, which includes construction of the New Frederick Douglass Memorial Bridge and the reconstruction of the I-295/Suitland Parkway interchange.

Please observe the posted speed limit and proceed through the construction area with caution. Pedestrians and cyclists are advised to stay alert and follow signage when traveling through this area.

For more information about DDOT's ongoing efforts to improve the 295 corridors, visit www.improving295dc.com.

###

The District Department of Transportation's mission is to equitably deliver a safe, sustainable, and reliable multimodal transportation network for all residents and visitors of the District of Columbia.

Follow us on [Twitter](#) for transportation-related updates and more, like us on [Facebook](#), and follow us on [Instagram](#). Visit the website at www.ddot.dc.gov. Visit goDCgo.com for more information on transportation options in the District.