



ADDENDUM NO. 2

TO: Interested Parties

FROM: Brennan Garrett, Senior Architectural Project Manager
Division of Engineering

DATE: Thursday, September 24, 2020

PROJECT: HAGERSTOWN REGIONAL AIRPORT
HANGAR 21 VESTIBULE ADDITION
COUNTY CONTRACT NO. MS-VA-082-18

Acknowledge receipt of this **Addendum No. 2** by signing in the space provided below and returning with your Bid.

Failure to sign and return with your Bid may subject the Bidder to disqualification. This **Addendum No. 2** forms a part of the Bid Documents, it supplements and modifies them as outlined herein.

This **Addendum No. 2** consists of **37 pages**, including this page and all attachments.

I hereby acknowledge receipt of **Addendum No. 2**:

By: _____ Date _____
Signed Name

Typed Name

Title

For (Firm): _____

Phone Number: _____

ADDENDUM NO. 2
Page 1 of 21

ADDENDUM NO. 2

**HAGERSTOWN REGIONAL AIRPORT
HANGAR 21 VESTIBULE ADDITION**

COUNTY CONTRACT NO. MS-VA-082-18

Date Issued:

Thursday, September 24, 2020

Bids Due (REVISED):

Wednesday, September 30, 2020
2:00 p.m., Local Time

The following addendum material is hereby made a part of the Bid Documents.

Please note the following changes, information, and/or instructions in connection with the proposed work and submit proposals accordingly.



Brennan Garrett
Senior Architectural Project Manager
Division of Engineering

By Authority of:
Board of County Commissioners
Washington County, Maryland

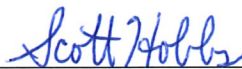

Scott Hobbs, P.E.
Director
Division of Engineering

ADDENDUM NO. 2

HAGERSTOWN REGIONAL AIRPORT HANGAR 21 VESTIBULE ADDITION

COUNTY CONTRACT NO. MS-VA-082-18

TO: All prime Contractors and all others to whom specifications have been issued.

ITEM 2.01 **Pre-Bid Conference** held Wednesday, September 2, 2020:
A Record of the Pre-Bid Teleconference (consisting of 7 pages) (**Attachment A**), and the Teleconference Registration Sheet (consisting of 2 pages) (**Attachment B**), shall be incorporated into the Contract Documents.

ITEM 2.02 **SUBMITTED QUESTIONS AND RESPONSES** shall be incorporated into the Bid Documents.

Question No. 1: Will you accept electronic submission of bids?

Response: No, sealed bids must be mailed or delivered.

Question No.2: From visiting the site it is obvious that some demolition of sidewalk and asphalt is required. Can you provide the extent of this demolition limit and if saw cutting is required?

Response: Existing sidewalk and asphalt shall be removed only to the extent required to complete the construction work. Existing surfaces shall be saw cut in a straight line to facilitate the installation of new asphalt and concrete surfaces by others.

Question No. 3: Who is responsible for locating utilities outside of the Miss Utility One call? Has the County reviewed as-builts to identify any utilities in the excavation area??

Response: The contractor is responsible for locating all utilities before beginning construction. As-builts have not been reviewed by the County.

Question No. 4: Under Material Testing – it calls for soil testing and bearing verification. This appears to be non-applicable to this project. If this requirement stands, please explain how the process will work since the excavation is typically quickly followed by placement of rebar and concrete. If the soils are to be tested as indicated, the excavation will be open for several days and project will be essentially on hold pending the outcome of the soils test and your review. If soils are not as expected, what is the process for moving forward?

Response: The contractor shall retain a Maryland licensed Geotechnical Engineer to verify the soil net bearing pressure prior to placement of the concrete footings. Should the actual allowable bearing pressure at the planned bottom of footing elevation be found to be less than assumed, the width or depth of the footing shall be adjusted at the direction of the engineer. The

ADDENDUM NO. 2

HAGERSTOWN REGIONAL AIRPORT HANGAR 21 VESTIBULE ADDITION

COUNTY CONTRACT NO. MS-VA-082-18

Geotechnical Engineer must submit a report of the findings to the Engineer for review.

Question No. 5: Under specification section 01 71 23 - FIELD ENGINEERING it is indicated that a surveyor is required to stake out the building and to draft as-builts. Is this really necessary for a small addition?

Response: Due to the size and placement of the proposed addition, a surveyor will not be required to stake out the addition or to draft as-builts.

Question No. 6: Are there any stipulations on hoisting due to work near an air field?

Response: A flag will be required to be placed on the boom of the hoist and the airport tower shall be notified prior to the start of hoisting operations.

Question No. 7: Who is responsible for special inspections.

Response: The contractor is responsible for special inspections where applicable.

Question No. 8: Do the stairs receive any type of flooring?

Response: The stair treads shall be covered with rubber as indicated in Part-2, Section 2.7 of the Resilient Flooring specification. Please note that the second floor stair landing shall receive the same VCT flooring as specified for the entry level.

Question No. 9: Will door hardware require access readers or electric locks.?

Response: Access readers or electric locks are not required under this contract.

Question No. 10: Can you provide the specifications for metal siding, ie. Gauge and profile

Response: The contractor is responsible for matching the existing metal siding, gauge, profile and color.

Question No. 11: Is there a start date set for work to begin?

Response: Notice to proceed is anticipated to be issued at the beginning of November.

ADDENDUM NO. 2

HAGERSTOWN REGIONAL AIRPORT HANGAR 21 VESTIBULE ADDITION

COUNTY CONTRACT NO. MS-VA-082-18

Question No. 12: Are there any union/labor requirements?

Response: There are not any labor or union requirements on this project.

Question No. 13: Is there a proprietary fire alarm company?

Response: The fire alarm company appears to be Teleplus.

Question No. 14: What Fire alarm panel manufacturer exists?

Response: The fire alarm company appears to be Teleplus. See photograph attached as Attachment E.

Question No. 15: Are there specs for awnings?

Response: A specification has not been provided for awnings. The contractor is responsible for matching the existing awning construction and color and pattern.

Question No. 16: Is there an electrical drawing?

Response: Electrical information can be found on the MEP plan, page 7 of 8 (see also this drawing sheet that is in this Addendum) and in the specification.

Question No. 17: Is there a mechanical drawing?

Response: Mechanical information can be found on the MEP plan, page 7 of 8 and in the specification.

Question No. 18: Can wiring be ran in MC?

Response: All electrical wiring shall be concealed and shall be run in MC.

Question No. 19: How far is panel from UHWA heater?

Response: The UHWA heater has been deleted from the project and has been replaced with a wall mounted mini-split heat pump system. The electrical panel is approximately 100 feet away.

Question No. 20: I assume stairs are metal pan poured concrete?

Response: Yes.

ADDENDUM NO. 2

HAGERSTOWN REGIONAL AIRPORT HANGAR 21 VESTIBULE ADDITION

COUNTY CONTRACT NO. MS-VA-082-18

Question No. 21: Are there MBE requirements?

Response: There are not any MBE requirements for this project.

Question No. 22: Is this a scale job?

Response: This is not a scale job.

Question No. 23: Are there any special security requirements?

Response: Security requirements, if any, shall be worked out with the Hagerstown Regional Airport and the owner and building tenant and the Engineer before construction begins. Review the FOD management requirements elsewhere in this addendum.

Question No. 24: Will independent testing be required? IE; Compaction tests, concrete cylinders, Etc.

Response: The contractor will be responsible for providing independent testing as required on pages TP-2, TP-3 and TP-4.

Question No. 25: Who will obtain the building permit?

Response: The building permit has already been obtained and will be provided to the successful contractor.

Question No. 26: Does current building have a fire alarm or sprinkler?

Response: The current building is equipped with a fire alarm system and is not equipped with a sprinkler system.

CHANGES/REVISIONS, AS NOTED:

ITEM 2.03

Incorporate the following into the Bid Document;

ADD: Hardware Schedule:

- Heavy Duty, Grade-1 DORMA (9000 series) medium stile exit devices, locksets, closers and cylinders shall be provided. See attached product information.
- Hardware finish shall be Stainless Steel (Satin).
- Key system shall match existing keying system.

ADDENDUM NO. 2

HAGERSTOWN REGIONAL AIRPORT HANGAR 21 VESTIBULE ADDITION

COUNTY CONTRACT NO. MS-VA-082-18

Set: 1 – Door 100

- 1 Entry Panic Bar Exit Device
- 3 Hinges (Heavy Weight)
- 3 Door Silencers
- 1 Door Stop
- 1 Door Closer

Set: 2 - Door 101

- 1 Entry Panic Bar Exit Device
- 3 Hinges (Heavy Weight)
- 3 Door Silencers
- 1 Door Closer

Set: 3 – Door 102

- 1 Entry Panic Bar Exit Device
- 3 Hinges (Heavy Weight)
- 3 Door Silencers
- 1 Door Stop
- 1 Door Closer

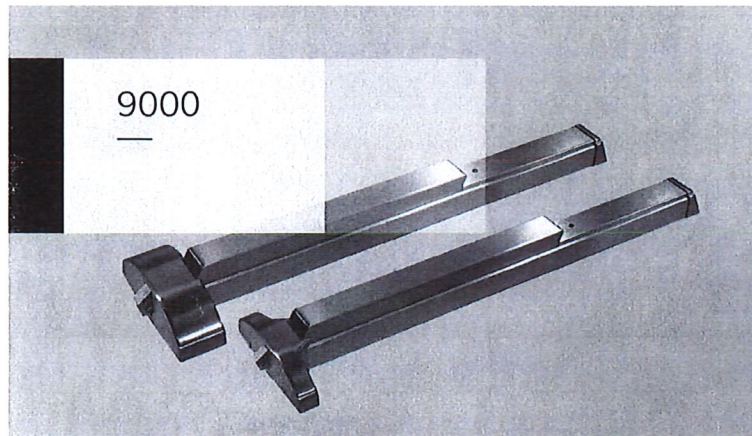

Grade 1 Exit Device

ADDENDUM NO. 2

HAGERSTOWN REGIONAL AIRPORT HANGAR 21 VESTIBULE ADDITION

COUNTY CONTRACT NO. MS-VA-082-18

GRADE 1 EXIT DEVICE 9000

DORMA 9000 SERIES PREMIUM EXIT DEVICES

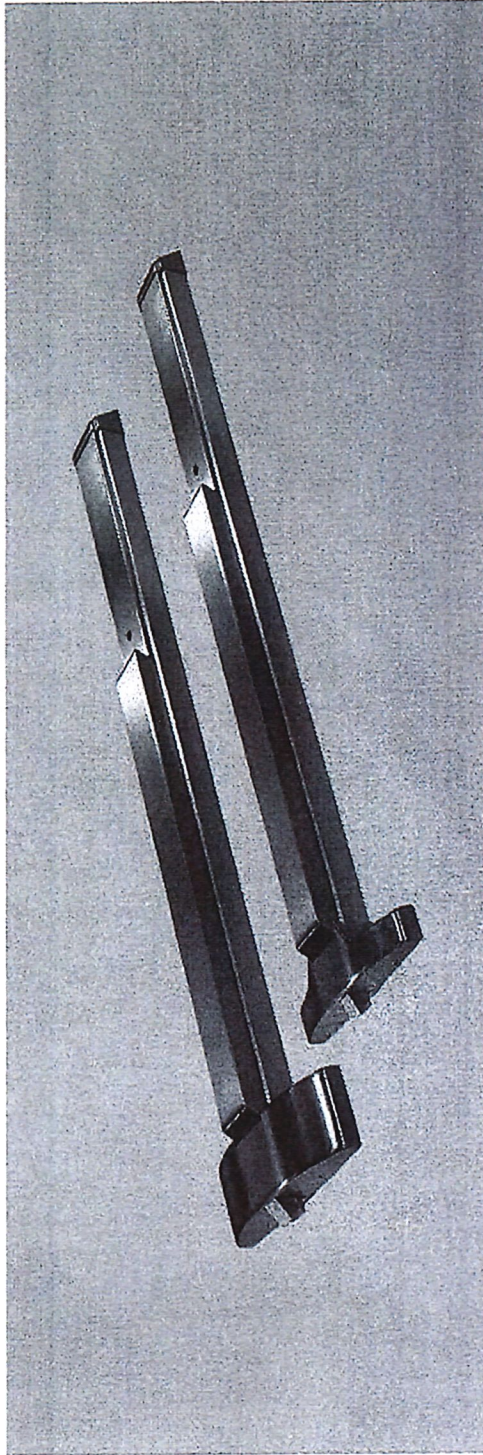

Premium exit devices available in medium or narrow stile for high impact applications such as schools, universities, and other institutional or commercial buildings.

DORMA 9000 Series exit devices reliably secure egress doors in compliance with all applicable fire/life safety code requirements. Medium and narrow stile exit devices for high-impact applications are available in rim, mortise, and surface or concealed rod configurations in both fire- and panic-rated versions. The DE9000 Series delayed egress exit device is available when security and safety are a concern.

9000 Series exit devices offer the specifier a selection of true architectural finishes and a full complement of electrified

options, including alarmed exit, delayed egress exit, electric latch retraction, and device monitoring.

Medium Stile

The DORMA 9000 Series medium stile exit device features a heavy-duty cast chassis for superior durability, while the smooth reduced projection touchbar assembly minimizes catch hazards. The partial length touchpad permits field installation of options such as cylinder dogging and exit alarm. A full complement of free wheeling lever trim is available in a wide range of architectural finishes.

Narrow Stile

DORMA 9000 Series narrow stile exit device with a shortened touchbar is the ultimate solution when narrow stile doors require an exit device.

The heavy-duty cast chassis design permits installation on narrow stile doors where a standard device may not fit. The smooth projection touchbar assembly minimizes catch hazards. The partial length touchpad permits field installation of options such as cylinder dogging and exit alarm.

The DORMA 9000 Series narrow stile exit devices are available in a wide range of models and offer a full complement of free wheeling lever trim to meet most narrow stile door applications.

Delayed Egress

The DE9000 Series delayed egress exit device maximizes features for uncompromising security and safety and offers ease of installation, job site function flexibility, and years of trouble free service.

The DE9000 is intended for low level egress security applications such as healthcare facilities, assisted living centers, hospitals, or retail. For applications requiring higher levels of egress security such as juvenile detention centers, developmentally challenged adult incarceration facilities, or other types of more challenging environments, it is recommended that a standard exit device be used in conjunction with DORMA's EMDE Series delayed egress magnetic door locks.

ADDENDUM NO. 2

HAGERSTOWN REGIONAL AIRPORT HANGAR 21 VESTIBULE ADDITION

COUNTY CONTRACT NO. MS-VA-082-18

GRADE 1 EXIT DEVICE 9000

DORMA 9000 SERIES MEDIUM & NARROW STILE EXIT DEVICES

Certification

- Certified/listed to:
 (ANSI/BHMA 156.3, Grade 1 for exit devices).
- U.L. and C.U.L. listed under their continuing reinspection programs and conforms to standard U.L. 10C positive pressure testing.
- Complies with NFPA 101 life safety code. Fire rated devices comply with NFPA 80 fire doors and windows.
- Devices, trim, pulls, and levers comply with the Americans for Disabilities Act, 1994, and ANSI 117.1-2003 for accessible and usable buildings and facilities.
- Contributes to U.S. Green Building Council, LEED MR Credits 2.1, 4.1, 4.2 and 5.1.
- Listed with the California Department of Forestry and Fire Protection, Office of the State Fire Marshal (medium stile devices only).
- Hurricane-code approved to Miami-Dade County Florida and Florida State Building Code acceptance (9300, 9400, 9500, 9700).

Specification

- All devices to have heavy-duty cast chassis.
- All device touchbar, rail, and cover assemblies shall be constructed of heavy gauge solid wrought materials for true architectural finishes or color coated finishes.
- The partial-length touchpad assembly accommodates field

installation of options such as cylinder dogging and exit alarm.

Non-labeled units to have hex-key dogging standard. Fire rated versions available for labeled applications.

Surface vertical rod devices shall have pullman type top latch bolts and round slidebolt bottom latches.

All devices to have deadlocking latch bolts with 3/4" throw.

All units shall offer a full range of free wheeling operational trim, except mortise devices. All units shall offer optional rigid and clutch-style trim, where applicable.

All devices to be furnished with appropriate mounting hardware including both wood and machine screws, as well as sex nuts where required.

Optional Specifications

Non-labeled devices to have cylinder dogging. Mortise cylinder included. Specify CD.

All surface/concealed vertical rod devices to have pullman type bottom latch bolt. Specify PB.

All surface/concealed vertical rod devices to have extended top rod up to 10". Specify ETR for 8", 9", or 10".

All surface/concealed vertical rod devices to be furnished less bottom rod. Specify LB.

Devices to have motorized latch bolt retraction to provide remote access from the secure side of door. Can also be pushed to electrically dog/hold the exit push bar in a retracted position during non-secure hours (latch bolt is

retracted). Specify MLR. (MLR is powered by the DORMA PS610 or PS532 power supply.)

Devices to have electric latch bolt retraction to provide remote access from the secure side of door. Can also be used in conjunction with low energy/automatic door operator. Specify ES. (ES must be powered by PS-501 power supply and use ES-105 power transfer)

Devices to have electric latch retraction option for battery back-up power supply (requires PS406BB or PS426BB power supply and ES105 power transfer). Specify ESB.

Devices to have a controlled-delayed egress while simultaneously sounding a local and remote audible alarm. After the delay time has elapsed, unrestricted emergency egress is available. Specify DE. (Not available with 9400 or 9800.)

Devices to have a latch monitor to report the latch bolt status. Specify LM.

Devices to be furnished with two switches in the touchbar to provide notification when touchbar is depressed. Specify MS.

Devices to have latch monitor with monitor switches in touchbar.

Specify LM/MS. Devices to have latch monitor with monitor switches and a bypass to permit authorized exit. Specify LM/MS BP.

Devices to have one of the following exit alarm options: battery-powered exit alarm (BPA), battery-powered exit alarm with a 4-minute reset (BPAR), or direct hard-wired exit alarm (DWA).

Devices to use a vision lite shim kit to raise the device from the door surface to accommodate glass light molding. Specify GK9000 (medium stile) or GK9200 (narrow stile).

All devices for labeled wood or composite doors to be furnished with sex bolts. Specify SNB.

All concealed vertical rod devices installed in aluminum doors to be furnished with appropriate brackets for aluminum door applications. Specify ALD (9100) or NS (9600).

All devices to use tamper-resistant security screws. Specify TX.

All devices to be furnished with rigid trim. Specify R after trim.

All devices to be furnished with clutch-style lever trim. Specify C after lever trim.

Finishes:

Architectural Finishes

Brass: 605 (Bright) or 606 (Satin).
Bronze: 611 (Bright), 612 (Satin), or 613 (Oxidized Satin).
Nickel: 619 (Satin).
Black: 693.
Chrome: 625 (Bright) or 626 (Satin).
Stainless Steel: 630 (Satin).

Powder Coated Finishes

Aluminum: 689.
Bronze: 691 (Dull) or 695 (Dark Duranodic).
Black: 693.
Gold: 696.
Clear Powder Coating: Specify P.
Anti-Microbial: Specify AM.

Warranty 10 years mechanical; 2 years on electronic components and accessories.

ADDENDUM NO. 2

HAGERSTOWN REGIONAL AIRPORT
HANGAR 21 VESTIBULE ADDITION

COUNTY CONTRACT NO. MS-VA-082-18

ITEM 2.04 ADD PASSIVE INFRARED OCCUPANCY SENSOR(S); one at top of stairs and one at bottom of stairs. See attached product information. Coordinate installation details with Engineer in field.

CX-105

PIR Occupancy Sensor

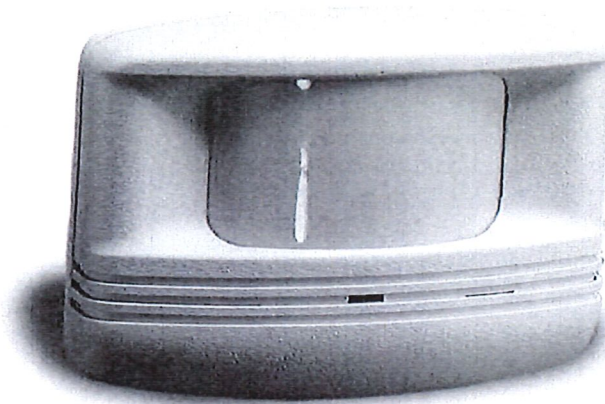

Installation Instructions

SPECIFICATIONS

Voltage 24VDC
Current Consumption 8mA*
Power Supply Power Pack
 B series power packs supply power for up to 14 CX-105 sensors
 A series power packs supply power for up to 8 CX-105 sensors
Time Adjustment..... 15 seconds—30 minutes
Sensitivity Adjustment Minimum—Maximum

*Current consumption can be slightly higher when only one sensor per power pack is used.

WattStopper®

Santa Clara, CA 95050

ADDENDUM NO. 2

HAGERSTOWN REGIONAL AIRPORT HANGAR 21 VESTIBULE ADDITION

COUNTY CONTRACT NO. MS-VA-082-18

UNIT DESCRIPTION

The CX-105 is a 24VDC passive infrared (PIR) occupancy sensor which controls lighting and HVAC systems based on occupancy.

PIR sensing systems are passive systems which react to changes in infrared energy (moving body heat) within the coverage area. PIR sensors must directly "see" motion of an occupant to detect them, so careful consideration must be given to sensor placement.

COVERAGE PATTERNS

Coverages shown are maximum and represent coverage for walking motion. Actual coverage will vary slightly depending on mounting height and furnishings.

Masking the lens: Opaque adhesive tape is supplied so that sections of the sensor's lens can be masked. This restricts the sensor's view and allows you to eliminate coverage in unwanted areas.

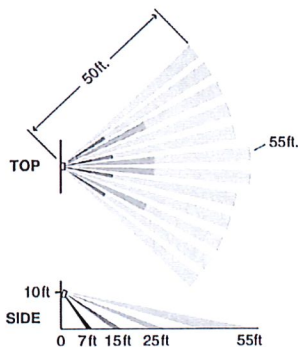

Dense Wide Angle Lens (Standard)
up to 2000 sq ft for walking motion
up to 1000 sq ft for desktop motion

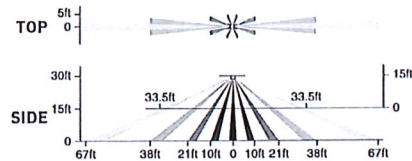

Two-Sided Aisleway Lens (-3)
up to 134 linear ft for walking motion

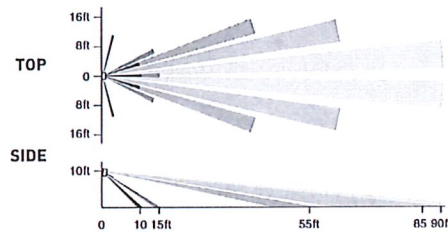

Long Range Lens (-1)
up to 90 linear ft for walking motion

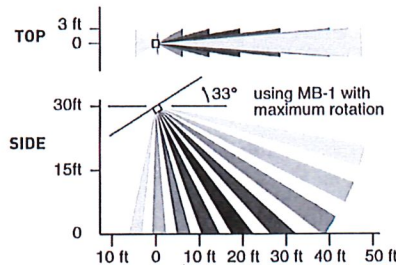

One-Sided Aisleway Lens (-4)
up to 50 linear ft for walking motion

Call 800.879.8585 for Technical Support

ADDENDUM NO. 2

HAGERSTOWN REGIONAL AIRPORT HANGAR 21 VESTIBULE ADDITION

COUNTY CONTRACT NO. MS-VA-082-18

ITEM 2.05 CLARIFICATION OF EXTERIOR WALL MOUNTED LIGHT FIXTURES; The light fixture to be mounted on the 30-foot long wall shall be a 75 Watt, 4000K wall pack with photocontrol, manufactured by Sylvania (or approved equal). See attached product information. The light fixture to be mounted on the 9-foot long wall shall be a 30 Watt, 4000K wall pack with photocontrol, manufactured by Sylvania (or approved equal). See attached product information. Coordinate installation details with Engineer in field.



SYLVANIA Luminaires Wall Pack Non-Cutoff



Product Features

The Wall Pack luminaires are environmentally preferable LED alternatives to traditional HID luminaires, offering up to 77% in energy savings. Ideal in place of traditional luminaires, or as new installations, the Wall Pack series is offered in several wattages/lumen packages for illuminating building exteriors, outdoor corridors, walkways, and stairwells. The housing is a perfect fit for replacing existing traditional luminaires. The luminaires are available with optional photo control. SYLVANIA luminaires assure optimum light engine performance for extended service and rated life (≥150,000 hours L70).

Wattage Comparison Chart

Non-Cutoff Wall Packs (UNV/347)			
Traditional Source	Traditional System Wattage	LED System Wattage	Energy Savings
70W HPS	91	30 / 36 / 40	67% / 60% / 56%
100W HPS	120	30 / 36 / 40	75% / 70% / 67%
100W MH	130	30 / 36 / 40	77% / 72% / 69%
70W HPS	91	50 / 55	45% / 40%
100W HPS	120	50 / 55	58% / 54%
100W MH	130	50 / 55	62% / 58%
150W HPS	170	50 / 55	71% / 68%
150W MH	188	50 / 55	73% / 71%
175W MH	210	50 / 55	76% / 74%
175W MH	210	75 / 80	64% / 62%
250W MH	290	75 / 80	74% / 72%
250W HPS	295	75 / 80	75% / 73%
320W MH	370	105	72%
400W HPS	460	105	77%
400W MH	450	105	77%

Ordering Guide

Item Number:

WALPAK	XX	/	XXX	XXX	7	XX	/	NC	/	BZ	/	X
Product Name	Generation		Wattage (UNV)	Voltage	7 => 70	Color Temp (CCT)		Optics		Color/Finish		Options
WALPAK	1N		030 = 30 Watts	UNV = 120-277V		40 = 4000K*		NC = Non-cutoff Distribution		BZ = Bronze		Blank = No Options
	2N		036 = 36 Watts	347 = 347V		50 = 5000K						P = Photocontrol
	3N		050 = 50 Watts									E = Emergency**
			075 = 75 Watts									
			105 = 105 Watts									
			Wattage (347V)									
			040 = 40 Watts									
			055 = 55 Watts									
			080 = 80 Watts									

* Available in UNV only
** Made to order (MTO). Available in 80W UNV only

LEDLUM005R11 10-17

Catalog #	Type
Project	
Notes	
Date	
Prepared by	

Dimensions

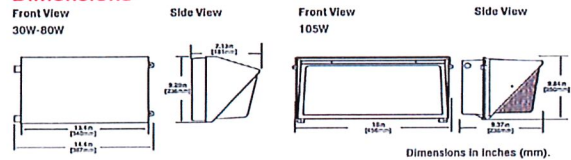

Specifications

Weight: UNV: 13.8lbs (6.3kg) 347V: 15lbs (6.8kg)
UNV (105W): 16.5lbs (6.8kg)

Construction: Two-piece cast aluminum alloy housing with powder coat paint finish and a glass lens. The standard color is bronze.

LED System: LED system with a life rating of ≥150,000 hours at L70 @25°C. Luminaire efficacy up to 125 LPW.

Electrical: Offered in 30, 36, 50, 75 and 105 Watts, the luminaire is designed to operate through the 120-277 Vac universal voltage range. Offered in 40, 55, and 80 Watts, the luminaire is designed to operate at the 347Vac voltage range. The LED driver has a 4kV inherent surge suppression and is a constant current device, meeting UL1310 and UL48 Class 2 with built-in over temperature protection. The power factor is ≥90% and THD is ≤20%.

Color Characteristics: CRI>70; CCT of 4000K or 5000K.

Optics: Non-cutoff distribution with a borosilicate glass lens (top visor accessory available).

Options Available: Photocontrol, Emergency Battery Backup (MTO).

Installation: Luminaire mounts to exterior wall.

Operating Temperature: -40°F to +104°F (-40°C to +40°C);
EM: +32°F to +104°F (0°C to +40°C).

Listings: cULus listed to UL159B standards for wet locations.

Warranty: Standard 5-year luminaire warranty (LEDLUM001).

Note: Specifications subject to change without notice. IES files available online.



* DLC Premium only applicable on 2N 30W versions



ADDENDUM NO. 2

HAGERSTOWN REGIONAL AIRPORT HANGAR 21 VESTIBULE ADDITION

COUNTY CONTRACT NO. MS-VA-082-18

Photometric Data (UNV/347V)

WALPAK2N/030UNV750/NC
Isofootcandle Lines at
15' Mounting Height

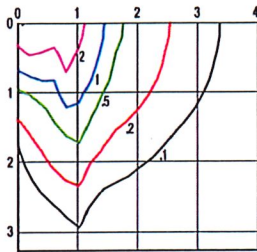

WALPAK2N/050UNV750/NC
Isofootcandle Lines at
18' Mounting Height

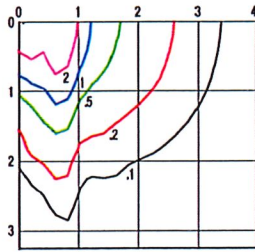

WALPAK2N/075UNV750/NC
Isofootcandle Lines at
20' Mounting Height

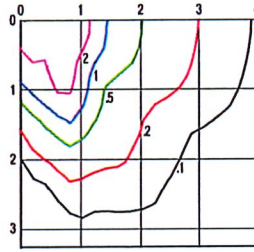

WALPAK3N/105UNV740/NC
Isofootcandle Lines at
25' Mounting Height

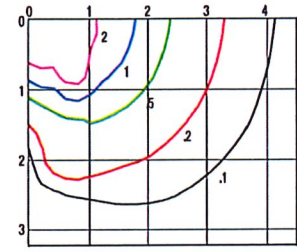

For other mounting heights apply the following multipliers:

Mounting Height	12'	15'	18'	20'	22'
Multiplier	1.56	1.00	0.69	0.56	0.46

Mounting Height	15'	18'	20'	22'	25'
Multiplier	1.44	1.00	0.81	0.67	0.52

Mounting Height	15'	18'	20'	22'	25'
Multiplier	1.78	1.23	1.00	0.83	0.64

Mounting Height	22'	25'	30'	32'	35'
Multiplier	1.29	1.00	0.69	0.61	0.51

Ordering Information

Item Number	Ordering Abbreviation	Power (W)	Input Voltage	CRI	Color Temp (CCT)	Distribution	Total Fixture Lumens	LPW*	DLC**	BUG Rating	Options
74201	WALPAK1N/036UNV750/NC/BZ	36	120-277V	>70	5000K	Type IV	3300	95	-	B1-U3-G3	-
74202	WALPAK1N/050UNV750/NC/BZ	50	120-277V	>70	5000K	Type IV	5300	108	-	B1-U4-G3	-
74203	WALPAK1N/075UNV750/NC/BZ	75	120-277V	>70	5000K	Type IV	8600	115	-	B1-U5-G5	-
74219	WALPAK1N/036UNV750/NC/BZ/P	36	120-277V	>70	5000K	Type IV	3300	95	-	B1-U3-G3	Photocontrol
74217	WALPAK1N/050UNV740/NC/BZ/P	50	120-277V	>70	4000K	Type IV	5000	104	-	B1-U4-G3	Photocontrol
74220	WALPAK1N/050UNV750/NC/BZ/P	50	120-277V	>70	5000K	Type IV	5300	108	-	B1-U4-G3	Photocontrol
74221	WALPAK1N/075UNV750/NC/BZ/P	75	120-277V	>70	5000K	Type IV	8600	115	-	B1-U5-G5	Photocontrol
72996	WALPAK1N/040347750/NC/BZ	40	347V	>70	5000K	Type IV	4300	102	-	B1-U4-G3	-
72997	WALPAK1N/055347750/NC/BZ	55	347V	>70	5000K	Type IV	6300	108	-	B1-U4-G3	-
72998	WALPAK1N/080347750/NC/BZ	80	347V	>70	5000K	Type IV	9400	120	Std	B1-U5-G5	-
74499	WALPAK1N/050UNV740/NC/BZ/E (MTO)	50	120-277V	>70	4000K	Type IV	5000	104	Std	B1-U4-G3	Emergency Battery Backup
74500	WALPAK1N/050UNV750/NC/BZ/E (MTO)	50	120-277V	>70	5000K	Type IV	5300	108	Std	B1-U4-G3	Emergency Battery Backup
74386	WALPAK2N/030UNV740/NC/BZ	30	120-277V	>70	4000K	Type IV	3400	122	Prm	B1-U4-G3	-
74482	WALPAK2N/030UNV750/NC/BZ	30	120-277V	>70	5000K	Type IV	3500	125	Prm	B1-U3-G3	-
74485	WALPAK2N/050UNV740/NC/BZ	50	120-277V	>70	4000K	Type IV	5500	113	Std	B1-U4-G3	-
74486	WALPAK2N/050UNV750/NC/BZ	50	120-277V	>70	5000K	Type IV	5600	116	Std	B1-U4-G3	-
74489	WALPAK2N/075UNV740/NC/BZ	75	120-277V	>70	4000K	Type IV	8900	118	Std	B1-U5-G5	-
74490	WALPAK2N/075UNV750/NC/BZ	75	120-277V	>70	5000K	Type IV	9200	121	Std	B1-U5-G5	-
74387	WALPAK2N/030UNV740/NC/BZ/P	30	120-277V	>70	4000K	Type IV	3400	122	Prm	B1-U4-G3	Photocontrol
74483	WALPAK2N/030UNV750/NC/BZ/P	30	120-277V	>70	5000K	Type IV	3500	125	Prm	B1-U3-G3	Photocontrol
74487	WALPAK2N/050UNV740/NC/BZ/P	50	120-277V	>70	4000K	Type IV	5500	113	Std	B1-U4-G3	Photocontrol
74488	WALPAK2N/050UNV750/NC/BZ/P	50	120-277V	>70	5000K	Type IV	5600	116	Std	B1-U4-G3	Photocontrol
74491	WALPAK2N/075UNV740/NC/BZ/P	75	120-277V	>70	4000K	Type IV	8900	118	Std	B1-U5-G5	Photocontrol
74492	WALPAK2N/075UNV750/NC/BZ/P	75	120-277V	>70	5000K	Type IV	9200	121	Std	B1-U5-G5	Photocontrol
74528	WALPAK3N/105UNV740/NC/BZ	105	120-277V	>70	4000K	Type IV	12500	119	Std	B3-U4-G4	-
74529	WALPAK3N/105UNV750/NC/BZ	105	120-277V	>70	5000K	Type IV	12400	118	Std	B2-U4-G5	-

*LPW per LM79 report.

**Prm for DLC Premium, Std for DLC Standard

***Standard lead time for MTO is 1-2 weeks.

For further information and to learn more about utility rebates, contact your local SYLVANIA sales representative.

ADDENDUM NO. 2

HAGERSTOWN REGIONAL AIRPORT HANGAR 21 VESTIBULE ADDITION

COUNTY CONTRACT NO. MS-VA-082-18

ITEM 2.06: OTHER LIGHT FIXTURES DOCUMENTATION

SYLVANIA Luminaires Edge-Lit Panel

Catalog #	Type
Project	
Notes	
Date	
Prepared by	

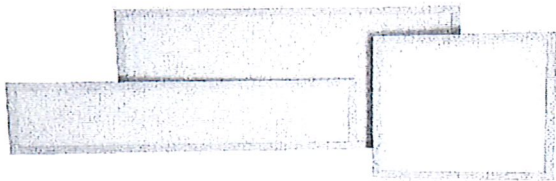

Product Features

The Edge-Lit Panels are environmentally preferable LED alternatives to traditional fluorescent luminaires, offering up to 47% in energy savings. Ideal in place of traditional luminaires, or as new installations, the Edge-Lit Panels are offered in three sizes for illuminating offices, retail or hospitality areas.

The slim design of these luminaires is beneficial for installation in tight ceilings spaces and they offer low glare and uniform illumination. SYLVANIA luminaires assure optimum light engine performance for extended service and rated life (≥50,000 hours L₇₀).

Dimensions

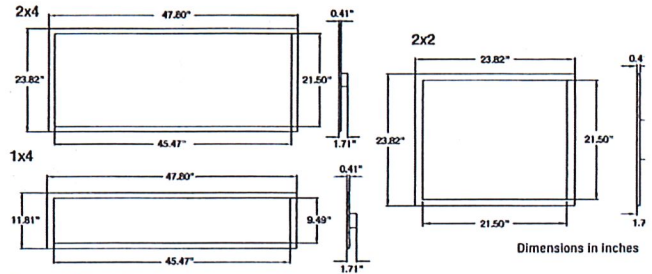

Specifications

- Weight:** 1x4 & 2x2: 7.96lbs (3.6 kg) Standard 2x4: 14.33lbs (6.5 kg) Standard
1x4 & 2x2: 10.14lbs (4.6 kg) Emergency 2x4: 16.54lbs (7.5 kg) Emergency
- Construction:** Extruded aluminum frame with sheet metal back plate, earthquake clips and diffused flat lens. The standard color is white.
- LED System:** LED system with a life rating of ≥50,000 hours at L₇₀ @ 25°C. Luminaire efficacy up to 114 LPW.
- Electrical:** Offered in 32 and 40 Watts, the luminaire is designed to operate through the 120-277 VAC universal voltage range. The LED driver has a 0.5kV inherent surge suppression and is a constant current device. The power factor is ≥90% and THD is ≤20%.
- Dimming:** The driver is 0-10V dimmable (down to 10%). Please reference the dimmer compatibility document (LEDLUM012).
- Color Characteristics:** CRI>80; CCT of 3500K, 4000K or 5000K.
- Optics:** White flat edge-lit PMMA diffuser lens.
- Options Available:** Emergency Battery Backup.
- Installation:** Luminaire lays in standard 15/16" and 9/16" T-grid ceilings.
- Operating Temperature:** -4°F to +104°F (-20°C to +40°C);
EM: +32°F to +104°F (0°C to +40°C).
- Listings:** cETLus listed to UL1598 standards, IC and damp rated.
- Note:** Suitable for use in closets, compliant with NFPA 70, NEC section 410.16 (A)(3) and 410.16 (C)(5).
- Warranty:** Standard 5-year luminaire warranty (LEDLUM001).
- Note:** Specifications subject to change without notice. IES files available online.

Wattage Comparison Chart

Edge-Lit Panel Size	Traditional Source	Traditional System Wattage	LED System Wattage	Energy Savings
1x4	2x28W T8	49	32	35%
	2x32W T8	56	32	43%
2x2	3x17W T8	48	32	33%
	2U31 T8	56	32	43%
2x4	2x28W T8	49	32	35%
	2x32W T8	56	32	43%
	3x28W T8	58	40	31%
	3x32W T8	75	40	47%



**DLC not applicable to emergency versions

Ordering Guide

Item Number: [REDACTED]

PANELF	1A	/	XXX	XXX	D	8	XX	/	XX	G	/	WH	/	X
Product Name	Generation		Wattage	Voltage	Dimming	CRI	Color Temp (CCT)		Dimension	Mounting		Color/Finish		Option
PANELF	1A		032 = 32 Watts 040 = 40 Watts*	UNV = 120-277V	D = 0-10V	8 ≥ 80	35 = 3500K 40 = 4000K 50 = 5000K		14 = 1x4 22 = 2x2 24 = 2x4	G = Grid		WH = White		Blank = No Option E = Emergency

*Only available in 2x4 size.

LEDLUM010R14 2-20



ADDENDUM NO. 2

HAGERSTOWN REGIONAL AIRPORT HANGAR 21 VESTIBULE ADDITION

COUNTY CONTRACT NO. MS-VA-082-18

recipient of this email or if you received this e-mail in error, please immediately notify the sender by reply email and delete this e-mail and any attachments from your system. Thank you.

SYLVANIA Luminaires Edge-Lit Panel

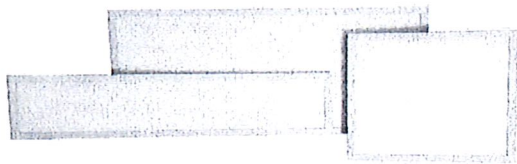

Product Features

The Edge-Lit Panels are environmentally preferable LED alternatives to traditional fluorescent luminaires, offering up to 47% in energy savings. Ideal in place of traditional luminaires, or as new installations, the Edge-Lit Panels are offered in three sizes for illuminating offices, retail or hospitality areas.

The slim design of these luminaires is beneficial for installation in tight ceilings spaces and they offer low glare and uniform illumination. SYLVANIA luminaires assure optimum light engine performance for extended service and rated life (≥50,000 hours L₇₀).

Wattage Comparison Chart

Edge-Lit Panel Size	Traditional Source	Traditional System Wattage	LED System Wattage	Energy Savings
1x4	2x28W T8	49	32	35%
	2x32W T8	56	32	43%
2x2	3x17W T8	48	32	33%
	2U31 T8	56	32	43%
2x4	2x28W T8	49	32	35%
	2x32W T8	56	32	43%
	3x28W T8	58	40	31%
	3x32W T8	75	40	47%

Catalog #	Type
Project	
Notes	
Date	
Prepared by	

Dimensions

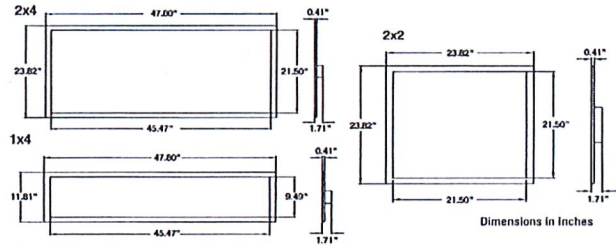

Specifications

Weight: 1x4 & 2x2: 7.96lbs (3.6 kg) Standard 2x4: 14.33lbs (6.5 kg) Standard
1x4 & 2x2: 10.14lbs (4.6 kg) Emergency 2x4: 16.54lbs (7.5 kg) Emergency

Construction: Extruded aluminum frame with sheet metal back plate, earthquake clips and diffused flat lens. The standard color is white.

LED System: LED system with a life rating of ≥50,000 hours at L₇₀ @ 25°C. Luminaire efficacy up to 114 LPW.

Electrical: Offered in 32 and 40 Watts, the luminaire is designed to operate through the 120-277 Vac universal voltage range. The LED driver has a 0.5kV inherent surge suppression and is a constant current device. The power factor is ≥90% and THD is ≤20%.

Dimming: The driver is 0-10V dimmable (down to 10%). Please reference the dimmer compatibility document (LEDLUM012).

Color Characteristics: CRI>80; CCT of 3500K, 4000K or 5000K.

Optics: White flat edge-lit PMMA diffuser lens.

Options Available: Emergency Battery Backup.

Installation: Luminaire lays in standard 15/16" and 9/16" T-grid ceilings.

Operating Temperature: -4°F to +104°F (-20°C to +40°C);
EM: +32°F to +104°F (0°C to +40°C).

Listings: cETLus listed to UL1598 standards, IC and damp rated.

Note: Suitable for use in closets, compliant with NFPA 70, NEC section 410.16 (A)(3) and 410.16 (C)(5).

Warranty: Standard 5-year luminaire warranty (LEDLUM001).

Note: Specifications subject to change without notice. IES files available online.



**DLC not applicable to emergency versions

Ordering Guide

Item Number:

PANELF	1A	/	XXX	XXX	D	B	XX	/	XX	G	/	WH	/	X
Product Name	Generation		Wattage	Voltage	Dimming	CRI	Color Temp (CCT)		Dimension	Mounting		Color/Finish		Option
PANELF	1A		032 = 32 Watts 040 = 40 Watts*	UNV = 120-277V	D = 0-10V	8 ≥ 80	35 = 3500K 40 = 4000K 50 = 5000K		14 = 1x4 22 = 2x2 24 = 2x4	G = Grid		WH = White		Blank = No Option E = Emergency

*Only available in 2x4 size.

LEDLUM010R14 2-20



ADDENDUM NO. 2

HAGERSTOWN REGIONAL AIRPORT HANGAR 21 VESTIBULE ADDITION

COUNTY CONTRACT NO. MS-VA-082-18

Photometric Data

Average Illuminance (FC) at 30" AFF and avg/min uniformity
80/50/20 Reflectances

			8 ft Mounting Height			10 ft Mounting Height			12 ft Mounting Height		
			On Center Fixture Spacing			On Center Fixture Spacing			On Center Fixture Spacing		
			8'x10'	10'x10'	10'x12'	8'x10'	10'x10'	10'x12'	8'x10'	10'x10'	10'x12'
1'x4'	32W	PANELF1A/032UNVD835/14G/WH	44fc / 3.2	36fc / 2.9	32fc / 2.0	43fc / 2.7	35fc / 2.4	31fc / 1.8	42fc / 2.5	34fc / 2.3	31fc / 1.8
		PANELF1A/032UNVD840/14G/WH									
2'x2'	32W	PANELF1A/032UNVD835/22G/WH	47fc / 3.2	39fc / 2.9	35fc / 2.0	46fc / 2.7	38fc / 2.4	33fc / 1.8	44fc / 2.4	37fc / 2.3	33fc / 1.8
		PANELF1A/032UNVD840/22G/WH									
2'x4'	32W	PANELF1A/032UNVD835/24G/WH	44fc / 3.3	36fc / 2.8	32fc / 2.0	43fc / 2.7	35fc / 2.4	31fc / 1.8	42fc / 2.5	34fc / 2.3	31fc / 1.7
		PANELF1A/032UNVD840/24G/WH									
	40W	PANELF1A/040UNVD835/24G/WH	62fc / 3.3	51 fc / 2.8	46fc / 2.0	60fc / 2.7	50fc / 2.4	44fc / 1.8	59fc / 2.5	48fc / 2.3	43fc / 1.7
		PANELF1A/040UNVD840/24G/WH									

*Table also applicable to emergency versions.

Ordering Information

Item Number	Ordering Abbreviation	Power (W)	Input Voltage	Dimming	CRI	Color Temp (CCT)	Size	Total Fixture Lumens	LPW*	DLC**	Options	Case Qty
74243'	PANELF1A/032UNVD835/14G/WH	32	120-277V	0-10V	>80	3500K	1x4	3200	102	Std	-	5
61600	PANELF1A/032UNVD835/14G/WH	32	120-277V	0-10V	>80	3500K	1x4	3200	102	Std	-	6
74244'	PANELF1A/032UNVD840/14G/WH	32	120-277V	0-10V	>80	4000K	1x4	3300	104	Std	-	5
61601	PANELF1A/032UNVD840/14G/WH	32	120-277V	0-10V	>80	4000K	1x4	3300	104	Std	-	6
74938'	PANELF1A/032UNVD850/14G/WH	32	120-277V	0-10V	>80	5000K	1x4	3500	110	Std	-	5
61602	PANELF1A/032UNVD850/14G/WH	32	120-277V	0-10V	>80	5000K	1x4	3500	110	Std	-	6
74251'	PANELF1A/032UNVD835/22G/WH	32	120-277V	0-10V	>80	3500K	2x2	3500	110	Std	-	5
61596	PANELF1A/032UNVD835/22G/WH	32	120-277V	0-10V	>80	3500K	2x2	3500	110	Std	-	6
74252'	PANELF1A/032UNVD840/22G/WH	32	120-277V	0-10V	>80	4000K	2x2	3500	110	Std	-	5
61597	PANELF1A/032UNVD840/22G/WH	32	120-277V	0-10V	>80	4000K	2x2	3500	110	Std	-	6
74797'	PANELF1A/032UNVD850/22G/WH	32	120-277V	0-10V	>80	5000K	2x2	3500	114	Std	-	5
61598	PANELF1A/032UNVD850/22G/WH	32	120-277V	0-10V	>80	5000K	2x2	3500	114	Std	-	6
74247'	PANELF1A/032UNVD835/24G/WH	32	120-277V	0-10V	>80	3500K	2x4	3300	104	Std	-	3
61591	PANELF1A/032UNVD835/24G/WH	32	120-277V	0-10V	>80	3500K	2x4	3300	104	Std	-	4
74248'	PANELF1A/032UNVD840/24G/WH	32	120-277V	0-10V	>80	4000K	2x4	3300	104	Std	-	3
61592	PANELF1A/032UNVD840/24G/WH	32	120-277V	0-10V	>80	4000K	2x4	3300	104	Std	-	4
74935'	PANELF1A/032UNVD850/24G/WH	32	120-277V	0-10V	>80	5000K	2x4	3500	112	Std	-	3
61593	PANELF1A/032UNVD850/24G/WH	32	120-277V	0-10V	>80	5000K	2x4	3500	112	Std	-	4
74249'	PANELF1A/040UNVD835/24G/WH	40	120-277V	0-10V	>80	3500K	2x4	4200	109	Std	-	3
61594	PANELF1A/040UNVD835/24G/WH	40	120-277V	0-10V	>80	3500K	2x4	4200	109	Std	-	4
→ 74250'	PANELF1A/040UNVD840/24G/WH	40	120-277V	0-10V	>80	4000K	2x4	4200	110	Std	-	3
61599	PANELF1A/040UNVD840/24G/WH	40	120-277V	0-10V	>80	4000K	2x4	4200	110	Std	-	4
74934'	PANELF1A/040UNVD850/24G/WH	40	120-277V	0-10V	>80	5000K	2x4	4300	113	Std	-	3
61595	PANELF1A/040UNVD850/24G/WH	40	120-277V	0-10V	>80	5000K	2x4	4300	113	Std	-	4
74245	PANELF1A/032UNVD835/14G/WH/E	32	120-277V	0-10V	>80	3500K	1x4	3200	102	-	Emergency Battery Backup	5
74246	PANELF1A/032UNVD840/14G/WH/E	32	120-277V	0-10V	>80	4000K	1x4	3300	104	-	Emergency Battery Backup	5
74939	PANELF1A/032UNVD850/14G/WH/E	32	120-277V	0-10V	>80	5000K	1x4	3500	110	-	Emergency Battery Backup	5
74253	PANELF1A/032UNVD835/22G/WH/E	32	120-277V	0-10V	>80	3500K	2x2	3500	110	-	Emergency Battery Backup	5
74254	PANELF1A/032UNVD840/22G/WH/E	32	120-277V	0-10V	>80	4000K	2x2	3500	110	-	Emergency Battery Backup	5
74798	PANELF1A/032UNVD850/22G/WH/E	32	120-277V	0-10V	>80	5000K	2x2	3500	114	-	Emergency Battery Backup	5
74239	PANELF1A/032UNVD835/24G/WH/E	32	120-277V	0-10V	>80	3500K	2x4	3300	104	-	Emergency Battery Backup	3
74240	PANELF1A/032UNVD840/24G/WH/E	32	120-277V	0-10V	>80	4000K	2x4	3300	104	-	Emergency Battery Backup	3
74937	PANELF1A/032UNVD850/24G/WH/E	32	120-277V	0-10V	>80	5000K	2x4	3500	112	-	Emergency Battery Backup	3
74241	PANELF1A/040UNVD835/24G/WH/E	40	120-277V	0-10V	>80	3500K	2x4	4200	109	-	Emergency Battery Backup	3
→ 74242	PANELF1A/040UNVD840/24G/WH/E	40	120-277V	0-10V	>80	4000K	2x4	4200	110	-	Emergency Battery Backup	3
74936	PANELF1A/040UNVD850/24G/WH/E	40	120-277V	0-10V	>80	5000K	2x4	4300	113	-	Emergency Battery Backup	3

*LPW per LM79 report
 **Std for DLC Standard
 †Indicates that the product is discontinued with inventory
 For further information and to learn more about utility rebates, contact your local SYLVANIA sales representative.

Options Information

Emergency Battery Backup:
 Activates when normal power supply to the fixture fails, providing a minimum of 650 lumens (700 nominal lumens) for at least 90 minutes.

ADDENDUM NO. 2

HAGERSTOWN REGIONAL AIRPORT HANGAR 21 VESTIBULE ADDITION

COUNTY CONTRACT NO. MS-VA-082-18

Location of Emergency Test Switch

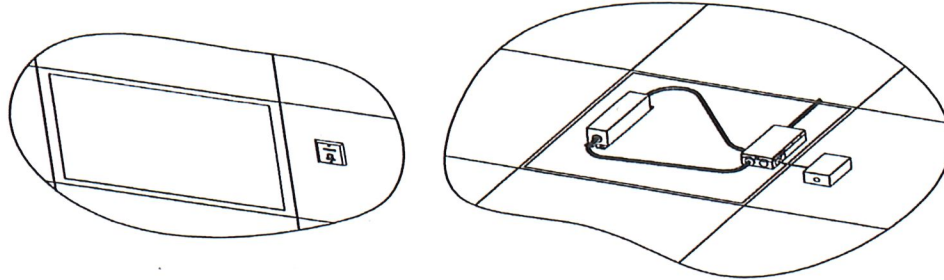

Accessories and Replacement Parts

Item Number	Ordering Abbreviation	Item Description
70132	SMKIT1A/14A/WH	1x4 Surface Mount Kit, White Finish
70380	SMKIT1A/22A/WH	2x2 Surface Mount Kit, White Finish
70381	SMKIT1A/24A/WH	2x4 Surface Mount Kit, White Finish
60457	FK1A14GWH	1x4 Flange Kit, White Finish
60458	FK1A22GWH	2x2 Flange Kit, White Finish
60459	FK1A24GWH	2x4 Flange Kit, White Finish

*Please see Surface Mount Kit installation manual for instructions (not compatible with emergency battery back-up versions).

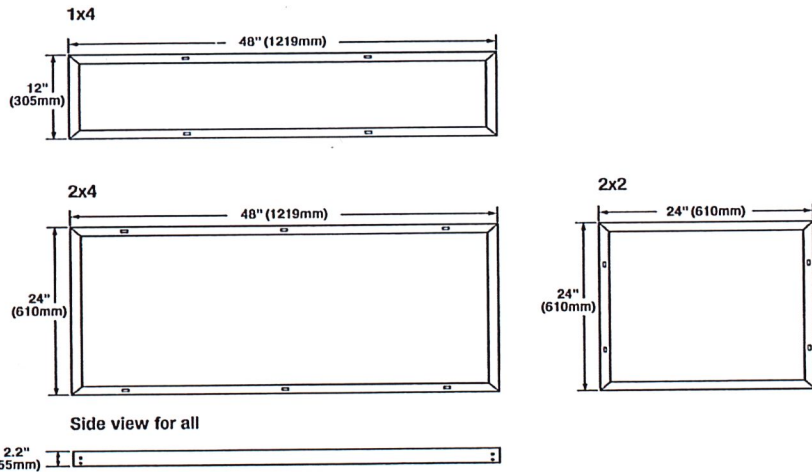

LEDVANCE LLC
200 Ballardvale Street
Wilmington, MA 01887 USA
Phone 1-800-LIGHTBULB (1-800-544-4828)
www.sylvania.com

SYLVANIA and LEDVANCE are registered trademarks.
All other trademarks are those of their respective owners.
Product Licensee of Trademark SYLVANIA in General Lighting.
Specifications subject to change without notice.

/sylvania /sylvania



© 2020 LEDVANCE LLC

ADDENDUM NO. 2

HAGERSTOWN REGIONAL AIRPORT
HANGAR 21 VESTIBULE ADDITION

COUNTY CONTRACT NO. MS-VA-082-18

www.sylvania.com

SYLVANIA LEDVANCE

Luminaires Installation Guide

EDGE-LIT PANEL

SURFACE MOUNT KIT

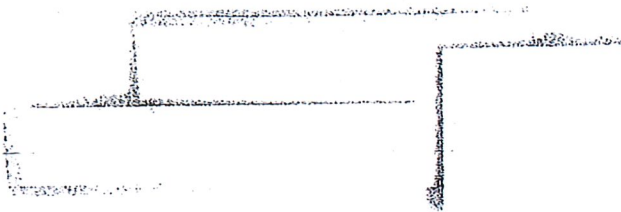

The Edge-Lit Panels are environmentally preferable LED alternatives to traditional fluorescent luminaires, offering up to 47% in energy savings. Ideal in place of traditional luminaires, or as new installations, the Edge-Lit Panels are offered in three sizes for illuminating offices, retail or hospitality areas.

For warranty coverage, please register at www.sylvania.com/warrantyregistration.

▲WARNING

- TO PREVENT PERSONAL INJURY OR PRODUCT DAMAGE ONLY LICENSED ELECTRICIANS SHOULD PROVIDE ALL INSTALLATION SERVICES.
- TO AVOID ELECTRIC SHOCK OR COMPONENT DAMAGE DISCONNECT POWER BEFORE ATTEMPTING INSTALLATION OR SERVICING.
- THIS PRODUCT MUST BE INSTALLED IN ACCORDANCE WITH THE NATIONAL ELECTRIC CODE (NEC) AND ALL APPLICABLE FEDERAL, STATE AND LOCAL ELECTRIC CODES AND SAFETY STANDARDS.
- USE CAUTION WHEN HANDLING THIS PRODUCT DURING OR AFTER OPERATION AS IT MAY BECOME HOT AND CAUSE BURNS. DISCONNECT PRODUCT AND ALLOW COOLING PRIOR TO SERVICING.
- ANY ALTERATION OR MODIFICATION OF THIS PRODUCT IS EXPRESSLY FORBIDDEN AS IT MAY CAUSE SERIOUS PERSONAL INJURY, DEATH, PROPERTY DAMAGE AND/OR PRODUCT MALFUNCTION.
- TO PREVENT PRODUCT MALFUNCTION AND / OR ELECTRICAL SHOCK THIS PRODUCT MUST BE PROPERLY GROUNDED.
- THIS LUMINAIRE IS DESIGNED TO OPERATE IN AMBIENT TEMPERATURES RANGING FROM -4°F TO +104°F (-20°C TO +40°C) EMERGENCY BACKUP +32°F TO +104°F (0°C TO +40°C) AND TO BE MOUNTED WITH THE LEDS FACING DOWN.

SYLVANIA 

ADDENDUM NO. 2

HAGERSTOWN REGIONAL AIRPORT HANGAR 21 VESTIBULE ADDITION

COUNTY CONTRACT NO. MS-VA-082-18

SAFETY PRECAUTIONS:

IMPORTANT: READ CAREFULLY BEFORE INSTALLING THE FIXTURE. RETAIN FOR FUTURE REFERENCE.

GENERAL: Upon receipt of the fixture, thoroughly inspect for any freight damage which should be brought to the attention of the delivery carrier.

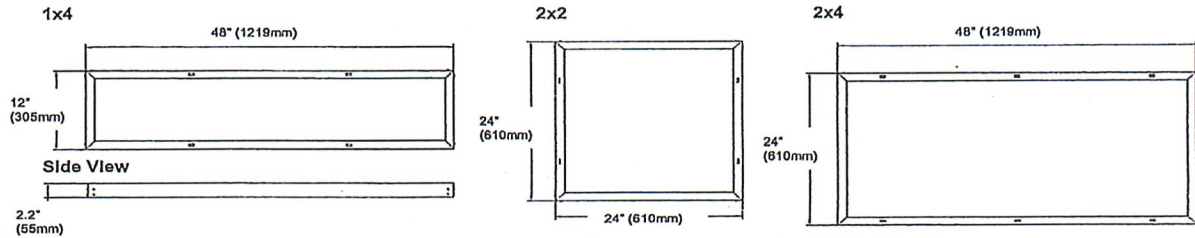

INSTALLATION:

1. Disconnect power where fixture is going to be installed.
2. Completely assemble kit on flat surface.
3. Lift assembled kit to the desired installation location and mark where holes need to be drilled.
4. Drill ceiling holes and drive appropriate anchors into the holes.
5. Mount the kit to the ceiling with fasteners.
6. Remove 4 screws of the kit to remove one side that is not secured to the ceiling (see Figure 1)
7. Slide panel into open kit deep enough to that is stable and secure.
8. Make all electrical connections. See panel installation guide for wiring instructions.
9. Replace the removed side and screw back into place.
10. Turn power back on, installation is now complete.

Figure 1

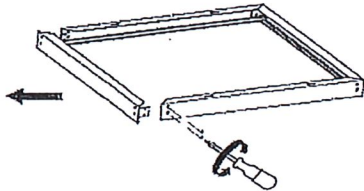

CLEANING AND MAINTENANCE

- To maintain the fixture efficacy occasional cleaning of the outer lens surface may be needed.
- Use a mild soap or detergent, which is essentially neutral pH (pH approximately 6 to 8), nonabrasive, and which contains no chlorinated or aromatic hydrocarbons.
- Wash thoroughly, using a soft cloth.
- Rinse with clean, cold water and wipe dry.



TROUBLE SHOOTING CHECKLIST: If luminaire does not work

- Check your power source.
- Check electrical connections.

E22379

LEDVANCE LLC
200 Ballardvale Street
Wilmington, MA 01887

ADDENDUM NO. 2

HAGERSTOWN REGIONAL AIRPORT HANGAR 21 VESTIBULE ADDITION

COUNTY CONTRACT NO. MS-VA-082-18

ITEM 2.07 Reference to the Washington County Division of Public Works or the Division of Environmental Management shall also refer to the Division of Engineering.

ITEM 2.08: It is required that documentation submitted in tabular format (e.g. schedule of values, application for payment, submittal itemization; submittal schedule) shall include these tables / documents in Excel worksheet format (Microsoft Office Excel format, Office 365 / latest compatible version as determined by the Engineer). Such tables shall include the data required by the Engineer (e.g. for applications for payment, similar to AIA documents G702 and G703); for submittals, item description, specification and drawings references, supplier / manufacturer and supplier / manufacturer's contact person with phone number(s) and e-mail addresses, confirmation of compliance with the drawings and specifications and other contract documents, identification of any aspect not in compliance with the drawings and specifications and other contract documents, etc. Preprinted submittal documentation from suppliers / manufacturers that is in tabular format is not required to be in Excel worksheet format, unless so noted elsewhere. Confirmation of compliance with the drawings and specifications and other contract documents and identification of any and all aspects not in compliance with the drawings and specifications and other contract documents, etc. shall be provided by the contractor on each and every paper or electronic submittal. The objective is to have 'useable' data via the Excel format, throughout the construction period. Confirmation of compliance with the drawings and specifications and other contract documents and identification of any and all aspects not in compliance with the drawings and specifications and other contract documents, etc. shall be provided by the contractor on each and every paper or electronic submittal.

ITEM 2.09 **REVISIONS TO THE CONTRACT PLAN DRAWINGS:** shall be incorporated into the Bid Documents. Replace the following Plan Sheet: (Attachment C) (consisting of 1 Page / Sheet)

The following Construction Drawing has been revised per this Addendum:

Replace Sheet 7 of 8 with Sheet 7 of 8, Rev. 1:

- PARTIAL FIRST FLOOR MEP PLAN
- PARTIAL SECOND FLOOR MEP PLAN
- REFLECTED CEILING PLAN

ADDENDUM NO. 2

HAGERSTOWN REGIONAL AIRPORT HANGAR 21 VESTIBULE ADDITION

COUNTY CONTRACT NO. MS-VA-082-18

The revised sheet includes, but may not be limited to, one or more of each of the following:

- 2 X 4 SURFACE MOUNTED FLAT PANEL LED LIGHT FIXTURE (4000K)
- 2 X 4 SURFACE MOUNTED FLAT PANEL LED EMERGENCY BATTERY BACKUP LIGHT FIXTURE (4000K)
- WALL MOUNTED LED EXIT SIGN LIGHT WITH BATTERY BACKUP
- 120 VOLT DUPLEX RECEPTACLE
- MANUAL PULL STATION (SHALL BE CONNECTED TO EXISTING FIRE ALARM SYSTEM)
- EXTERIOR APPROXIMATE LOCATION OF OUTDOOR MINI-SPLIT UNIT
- INTERIOR LOCATION OF WALL MOUNTED MINI-SPLIT SYSTEM UNIT

ITEM 2.20 The date for the acceptance of bids is changed as follows:

The Board of County Commissioners of Washington County, Maryland, will accept sealed bids for the Hagerstown Regional Airport Hangar 21 Vestibule Addition, Contract No. MS-VA-082-18 until September 30, 2020 at 2:00 p.m.

Summary of Attachments:

Attachment A: Pre-Bid Tele-Conference Meeting Minutes (consisting of 7 pages)

Attachment B: Pre-Bid Tele-Conference Registered Attendees (consisting of 2 pages)

Attachment C: Construction Drawing(s) (consisting of 1 page/sheet)

Attachment D: Interior Light Fixtures (consisting of 5 pages)

Attachment E: Photograph of Fire Alarm Panel

END OF ADDENDUM NO. 2



ADDENDUM NO. 2
ATTACHMENT "A"

HAGERSTOWN REGIONAL AIRPORT
HANGAR 21 VESTIBULE ADDITION

Washington County Contract No. MS-VA-082-18; Project No. 18-082

RECORD OF PRE-BID TELECONFERENCE (VIRTUAL)

Wednesday, September 2, 2020; 3:00 p.m., Local Time

MEETING LOCATION: VIA TELECONFERENCE / VIRTUAL MEANS, FROM:
Washington County Administrative Annex Building
80 West Baltimore Street, Hagerstown, MD 21740

PRE-BID CONFERENCE AGENDA

- PB1. Welcome & Introductions**
- PB2. Project Overview**
- PB3. Project Classification**
- PB4. Invitation to Bid, Time of Completion & Liquidated Damages**
- PB5. Contract Provisions**
- PB6. Bid Due Date & Location**
- PB7. Preparation of Bid, Bid Forms, Bid Security**
- PB8. Addenda and Interpretations**
 - Email: [ECBidQuestions @washco-md.net](mailto:ECBidQuestions@washco-md.net)
 - Fax no.: (240) 313-2401
- PB9. Questions (submit 'in writing')**
- PB10. Project Site Meetings**
- PB11. Meeting Adjournment**

80 West Baltimore Street | Hagerstown, MD 21740-6003 | P: 240.313.2460 | TDD: 711

PRE-BID CONFERENCE RECORD

PB1. WELCOME & INTRODUCTIONS:

On behalf of the Board of County Commissioners of Washington County and its Division of Engineering and its Division of Construction, a welcome and a thank you for the interest shown in this project was extended to all in attendance.

Introductions of all persons in attendance were made. See 'sign-in' sheet (Attachment B).

- Washington County Project Team Members include:
 - Scott Hobbs, P.E., Director of Engineering
 - Rich Eichelberger, Director of Construction
 - Blair Reynolds, Chief Project Manager, Division of Engineering
 - Brennan Garrett, Senior Architectural Project Manager, Division of Engineering
 - Michael (Mike) Armel, Project Manager, Division of Engineering
 - Greg Jones, Engineering Technician / CADD, Division of Engineering
 - Monica Lindsay, Administrative Assistant, Division of Engineering

- The pre-bid conference is provided as a courtesy to assist potential bidders with becoming familiar with the project. A record of today's conference will be issued to plan holders via addendum. The project addenda as well as the Bid Documents shall serve as the basis for the construction contract.

PB2. PROJECT OVERVIEW:

- Reference the "The Project" section of Bid Document for a description of the project.
- This is a locally funded project.
- The project will include, but may not be limited to:
 - A building addition (of approximately 280 SF) providing a vestibule and egress stairs;
 - Reinforced concrete, and concrete masonry unit (CMU), foundations and slabs and related compacted subgrades;
 - Steel pipe columns and appurtenances thereto;
 - Metal stud walls with ribbed metal panel siding (prefinished to match existing metal siding);
 - Metal roof rafters with continuous rigid and fiberglass batt insulation;
 - Galvalume roof sheeting and metal decking;
 - Painted steel stairway;
 - New doors and windows (horizontal aluminum sliding windows with screens);
 - A fire wall separation between the existing building and the addition;
 - Electrical, mechanical and fire alarm systems;
 - Related demolition and repairs.

PB2. PROJECT OVERVIEW (continued):

- Refer to Specification Section 01 21 00 – ALLOWANCES; there is a \$5,000 Contingency Allowance.
- Road access to the project site can be made from roads that do not need to cross the airport (fenced) security perimeter (where no badging is required).
- For HAGERSTOWN REGIONAL AIRPORT, point of contact: Garrison A. Plessinger, Airport Director.
- Hangar 21 is occupied by Royal Aircraft; point of contact Pamela Heffernan.
- There will be an addendum addressing:
 - Hardware schedule
 - Exit signs
 - HVAC system (a split system)
 - Electric panel for power feed that is on 2nd floor

Key Dates

Advertisement	August 20, 2020		
Pre Bid TeleConference	September 2, 2020	3:00 pm	
Questions Due	September 9, 2020	4:00 pm	In writing, faxed 240.313.2401 Email – ECBidQuestions@washco-md.net
Bids Due	September 23, 2020	4:00 pm	<i>[revised to Wednesday, September 30, 2020, 2:00 pm]</i>
Anticipated NTP	Mid November 2020	180 consecutive calendar day project	
Anticipated Completion	Mid May 2021		

PB3. PROJECT CLASSIFICATION:

- The project classification is Cost Group Letter Class "A", up to \$100,001 to \$500,000 in accordance with MDOT SHA Project Classification. (ITB-3)

PB4. INVITATION TO BID, TIME OF COMPLETION & LIQUIDATED DAMAGES:

- This is a 180 consecutive calendar day contract; (ITB 1.10)
- Liquidated Damages are in the amount of **\$500.00** for each consecutive calendar days. (ITB 1.10)
- Bids are irrevocable and may not be withdrawn 90 calendar days following Bid Opening. (ITB 1.04)

PB5. CONTRACT PROVISIONS:

- *Reference also the "General Conditions", "Special Provisions", et.al. sections of the Bid Document for additional information.*
- The Contract Documents do not contain:
 - Davis-Bacon Wage Rates
 - MBE / DBE participation percentage (ITB-4)
- Comply with requirements of the Building Permit / Fire Marshal requirements/comments.

PB6. BID DUE DATE & LOCATION:

- Sealed Bids with proper designation are due by ~~4:00 pm, Wednesday, September 23, 2020~~ **[NOTE: revised to Monday, September 30, 2020, 2:00 pm]** at the **Division of Engineering, County Administrative Annex Building, 80 West Baltimore Street, Hagerstown, Maryland 21740-6003. In the vestibule of the building main/front entrance, there will be an appropriately marked receptacle in which to place hand-delivered bids.**
- *Those bidders who wish to hear a reading of the bids shall call 240-313-2412 to receive instructions prior to the bid opening. (ITB-3).*

PB7. PREPARATION OF BID, BID FORMS, BID SECURITY:

- *The separate set of blank bid forms included with the bid documents shall be used in submitting contractor bids. (ITB 1.03)*
- *A bid security in the amount of 5% of the total bid price made payable to the Board of County Commissioners of Washington County, Maryland shall accompany each submitted bid. (ITB-1.05)*

PB8. ADDENDA AND INTERPRETATIONS (ITB 1.11):

- Submit additional bid inquiries **in writing by 4:00 p.m. on Wednesday, September 9, 2020** for delivery to the Division of Engineering, County Administrative Annex Building, 80 West Baltimore Street, Hagerstown, Maryland 21740-6003, or via email to ECBidQuestions@washco-md.net; or faxed to (240) 313-2401.
- Addenda will be issued to all plan holders via email and will also be uploaded to eMaryland Marketplace. Addenda will include minutes from today's pre-bid conference.
- **Email:** ECBidQuestions@washco-md.net
- **Fax no.:** (240) 313-2401

PB9. DISCUSSIONS FROM QUESTIONS AT PRE-BID MEETING & RESPONSES (at meeting and subsequently) (bidders to submit questions in writing also)

Regardless of discussion at this pre-bid conference, submission of any question posed at this pre-bid conference is required; submit as indicated in PB8 above.

1. QUESTION: Is there a need for perimeter fencing?

RESPONSE: The contractor is responsible for safety and security on the project site, including, as necessary, maintenance of traffic in the construction vicinity.

COMPLY WITH THE REQUIREMENTS OF THE FAA FOREIGN OBJECT DEBRIS (FOD) PROGRAM. A MOST SIGNIFICANT RESPONSIBILITY OF THE CONTRACTOR IS TO PROPERLY DISPOSE OF ALL TRASH AND DEBRIS AND TO PREVENT ANY TRASH OR DEBRIS FROM BECOMING DEPOSITED ON THE ENVIRONMENT OF THE HAGERSTOWN REGIONAL AIRPORT PROPERTY (RUNWAYS, TAXIWAYS, ADJACENT AREAS, BUILDING – INTERIOR AND EXTERIOR, ETC.).

NOTE THE FOLLOWING:

"As defined in [AC 150/5210-24, Airport Foreign Object Debris \(FOD\) Management](#), FOD is any object, live or not, located in an inappropriate location in the airport environment that has the capacity to injure airport or air carrier personnel and damage aircraft.

The presence of FOD is a continuing concern at our nation's airports. FOD creates safety hazards and can ultimately impact safe operations by damaging aircraft. Airports, Airlines, and the General Aviation community have taken the necessary steps to minimize FOD by engaging in successful FOD management programs, as per AC 150/5210-24."

The contractor will, at all times, take immediate action to properly prevent, handle, capture, remove, control, dispose etc. of any FOD or other debris, etc. and will accordingly, at all times, respond to any information or direction given by Hagerstown Regional Airport authorities, Royal Aircraft personnel, the Engineer, other authorities of competent jurisdiction.

No posts (e.g. for fencing) or other materials shall penetrate or otherwise damage the existing asphalt surfaces (e.g. in the 'lay down' area) except for necessary (as determined by the Engineer, e.g. as depicted in the contract documents) excavation in the immediate vicinity of the foundations and footings construction for the building.

2. QUESTION: Please address the extent of asphalt and/or concrete perimeter disturbance at the building construction, and its restoration.

RESPONSE: Asphalt restoration in the immediate vicinity of the foundations and footings construction for the building is not a requirement of the project. Exterior to the reinforced concrete and CMU foundations and footings, there will be properly prepared and compacted subgrade and above that subgrade will be 12" of properly placed graded aggregate base (GAB). The existing asphalt pavement at excavations will be saw cut to full depth in straight lines to facilitate paving restoration by others. Existing concrete at excavations will be saw cut to full depth in straight lines to facilitate restoration by others.

3. QUESTION: Are there any existing underground utilities; only 'gas' is shown on the drawings?

RESPONSE: Contractor to interface with Miss Utility and property owner(s). At this time, other than the 'gas' line, no other underground utility is known.

4. QUESTION: Are there any temporary facilities required?

RESPONSE: Contractor is to provide normal temporary sanitary facilities.

5. QUESTION: Are there any areas available for a 'lay down' area (e.g. for sand, aggregate, CMU, box/flat trailers)?

RESPONSE: See aerial photo with notes that follows:



Note the FOD management requirements (question #1 above).

Grass along fence and asphalt and concrete sidewalk along fence are to be undisturbed. There are two paved parking spaces (a pair, 'head to toe') along the grass nearest to the fence that are to be accessible to the public and undisturbed. Paved access to the shipping / receiving doors is to be maintained and undisturbed.

The available 'lay down' area is six (6) adjacent pairs ('head to toe') of parking spaces in the 'center' of the parking areas, north of the Hangar 21 building. Do not damage the asphalt paving; any damages must be repaired by the contractor; restoration of the white painted line striping will be required. Contractor may use the 3 parking spaces north of the building where the vestibule building addition is to be constructed. White painted line striping and blue HC emblem painting will be required by the contractor.

PB10. PROJECT SITE MEETINGS

Contact the Division of Engineering, Brennan Garrett (or, in his absence, Michael Armel), directly if you wish to meet a representative at the project site. **Any discussion or questions at the site meeting must be posed per item PB8 above for an official reply; oral interpretations to a bidder(s) at a site meeting are not sufficient.**

PB11. MEETING ADJOURNMENT: 3:25 p.m.



ADDENDUM NO. 2 - ATTACHMENT "B"

REGISTERED ATTENDEES AT

HAGERSTOWN REGIONAL AIRPORT - HANGAR 21 VESTIBULE ADDITION

Washington County Contract No. MS-VA-082-18; Project No. 18-082

PRE-BID TELECONFERENCE (VIRTUAL)

Wednesday, September 2, 2020; 3:00 p.m., Local Time

Name	Company	Phone	Email
Brian Barnes	Myers Building Systems	301-582-4200	bbarnes@myersbuildingsystems.com
Jennifer Mouchantaf	Building Concepts	703-780-6688	Jen@bcconstructiongroup.com
Richard Hillringhouse	Cooper Building Services	202-391-2717	rhillringhouse@cooperbuilds.com
Don Pyatt	Callas Contractors, Inc.	301-739-8400	dpyatt@callascontractors.com
Chris Parcel	Contour Construction	240-405-0820	cparsell@contour-gc.com
Jim Hill	R. A. Hill, Inc.	717-264-7413	jim@rahillinc.com
Brock Bumbaugh	GRC General Contractor	717-762-1116	brock@grcgc.com
Kevin Blanchette	Hawkeye Construction	410-984-5931	kblanchette@hcmil.us
Kayla Hernandez	Tejy, Inc.	202-465-4830	knathalie@tejy.com

80 West Baltimore Street | Hagerstown, MD 21740-6003 | P: 240.313.2460 | TDD: 711



ADDENDUM NO. 2 - ATTACHMENT "B"

REGISTERED ATTENDEES AT

HAGERSTOWN REGIONAL AIRPORT - HANGAR 21 VESTIBULE ADDITION

Washington County Contract No. MS-VA-082-18; Project No. 18-082

PRE-BID TELECONFERENCE (VIRTUAL)

Wednesday, September 2, 2020; 3:00 p.m., Local Time

Name	Company	Phone	email
Scott Hobbs, P.E., Director of Engineering	Washington County Division of Engineering		
Rich Eichelberger, Director of Construction	Washington County Division of Construction		
Blair Reynolds, Chief Project Manager	Washington County Division of Engineering	O: 240.313.2420	breynolds@washco-md.net
Michael (Mike) Armel, Project Manager,	Washington County Division of Engineering	C: 240.675.0130 O: 301.240.2411	marmel@washco-md.net
Brennan Garrett, Senior Architectural Project Manager,	Washington County Division of Engineering	O: 240.675.2474	bgarrett@washco-md.net
Greg Jones, Engineering Technician / CADD	Washington County Division of Engineering	O: 240.313.2409	GJones@washco-md.net
Monica Lindsay, Administrative Assistant,	Washington County Division of Engineering	O: 240.313.2412	mlindsay@washco-md.net

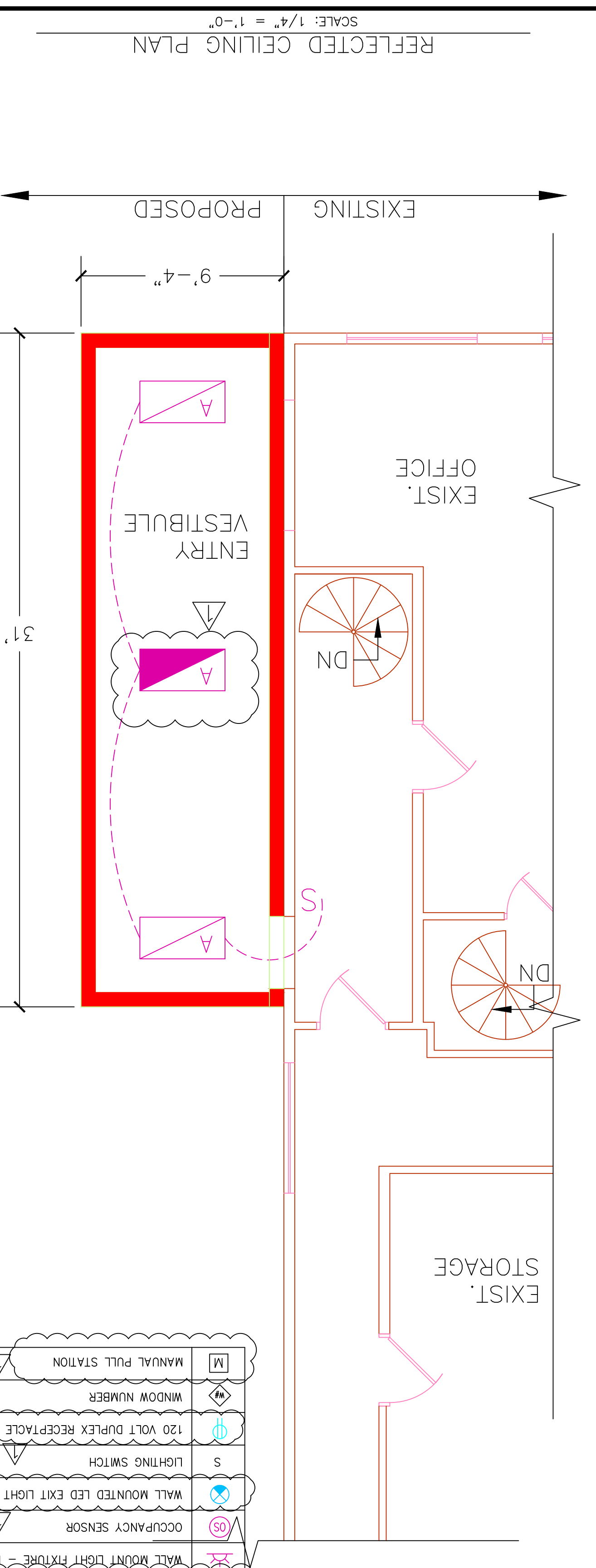
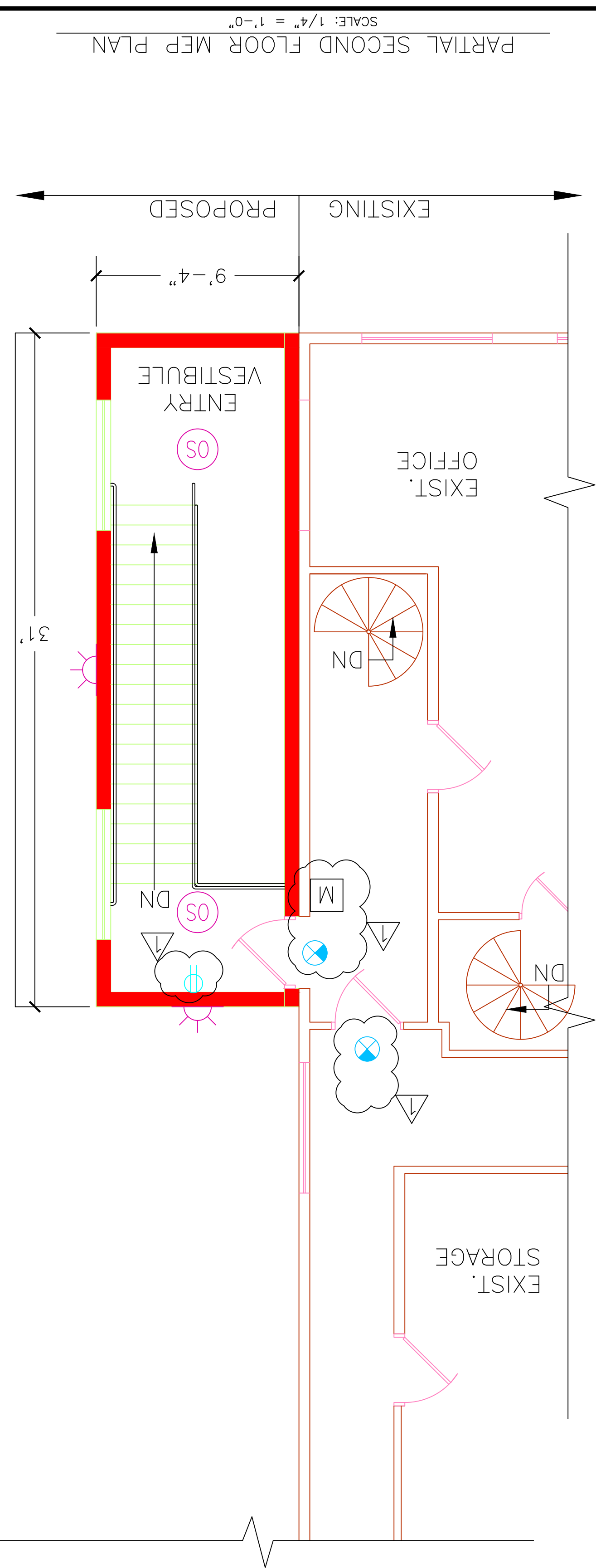
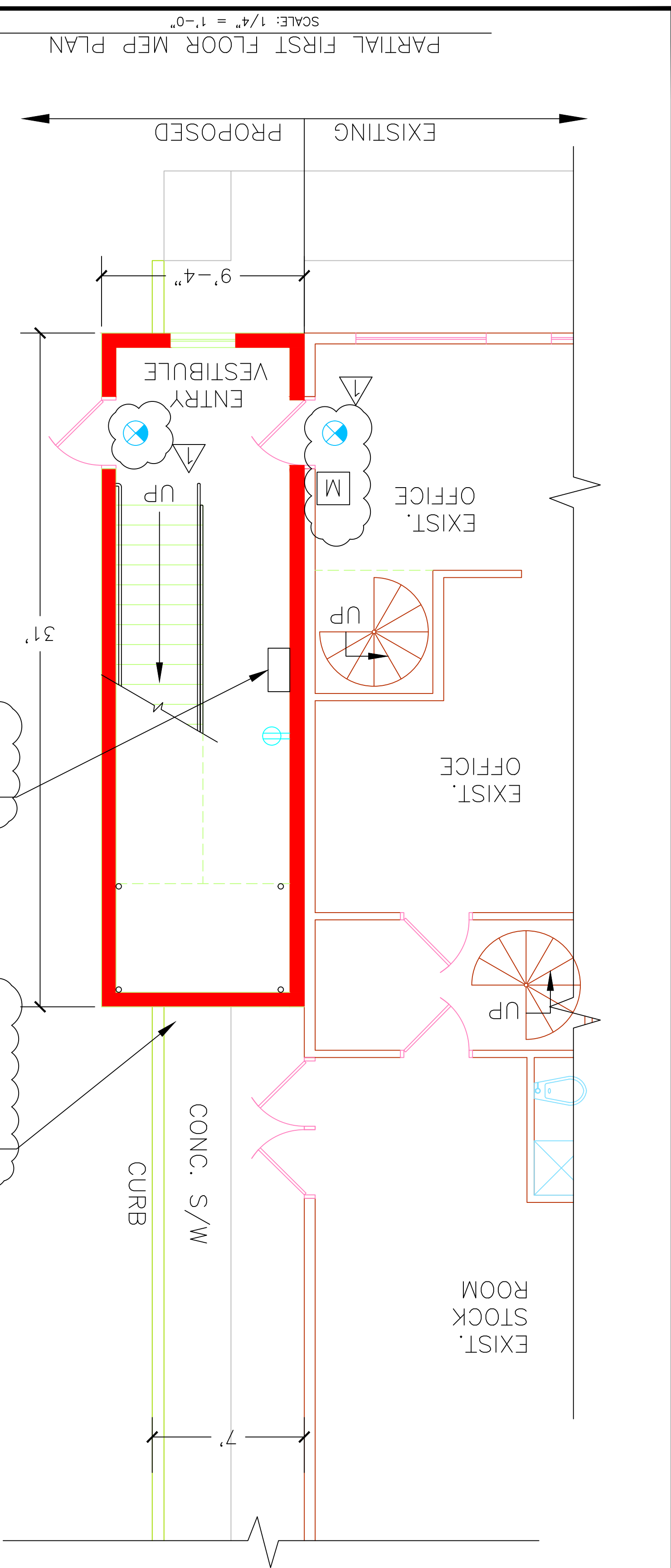

SYMBOL LEGEND

[Red Line]	PROPOSED WALLS
[Orange Line]	EXISTING WALLS TO REMAIN
[Circle with '1']	DOOR NUMBER
[Circle with '2']	2'x4 LIGHT FIXTURE - LED SURFACE MOUNTED FLAT PANEL
[Circle with '3']	2'x4 LIGHT FIXTURE - LED SURFACE MOUNTED FLAT PANEL
[Circle with '4']	WALL MOUNTED LED EXIT LIGHT w/ BATTERY BACKUP
[Circle with '5']	LIGHTING SWITCH
[Circle with '6']	120 VOLT DUPLEX RECEPTACLE
[Circle with '7']	WINDOW NUMBER
[Circle with '8']	MANUAL PULL STATION

PROFESSIONAL CERTIFICATION: I HEREBY CERTIFY THAT THESE DOCUMENTS WERE PREPARED BY ME OR UNDER MY CLOSE PERSONAL SUPERVISION AND THAT I AM A LICENSED PROFESSIONAL ENGINEER UNDER THE LAWS OF THE STATE OF MARYLAND.

EXPIRATION DATE: _____

LICENSE NO. _____

PROJECT NO.	7 OF 8
SHEET NO.	AS SHOWN
SCALE	
WASHINGTON COUNTY REGIONAL AIRPORT - HANGAR 21 MEP PLAN REFLECTED CEILING PLAN	
WASHINGTON COUNTY, MARYLAND DIVISION OF ENGINEERING Washington County Administrative Annex, Building 80 W. Baltimore St., Hagerstown, MD 21740 Phone: 240.313-2460 Fax: 240.313-2401	DESIGNED BY: JLA DRAWN BY: JLA CHECKED BY: JLA DATE: 06-16-2020
BY: BG	DATE: 06/24/2020
REVISION DESCRIPTION	
1	Exit lights, manual Pull Stations, Receptacle, Emergency Light, Mini-Split System

Attachment D

SYLVANIA Luminaires Edge-Lit Panel

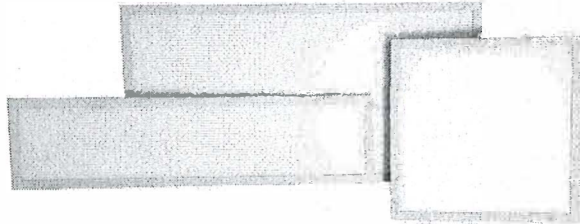

Product Features

The Edge-Lit Panels are environmentally preferable LED alternatives to traditional fluorescent luminaires, offering up to 47% in energy savings. Ideal in place of traditional luminaires, or as new installations, the Edge-Lit Panels are offered in three sizes for illuminating offices, retail or hospitality areas.

The slim design of these luminaires is beneficial for installation in tight ceiling spaces and they offer low glare and uniform illumination. SYLVANIA luminaires assure optimum light engine performance for extended service and rated life ($\geq 50,000$ hours L_{70}).

Wattage Comparison Chart

Edge-Lit Panel Size	Traditional Source	Traditional System Wattage	LED System Wattage	Energy Savings
1x4	2x28W T8	49	32	35%
	2x32W T8	56	32	43%
2x2	3x17W T8	48	32	33%
	2U31 T8	56	32	43%
2x4	2x28W T8	49	32	35%
	2x32W T8	56	32	43%
	3x28W T8	58	40	31%
	3x32W T8	75	40	47%

Catalog #	Type
Project	
Notes	
Date	
Prepared by	

Dimensions

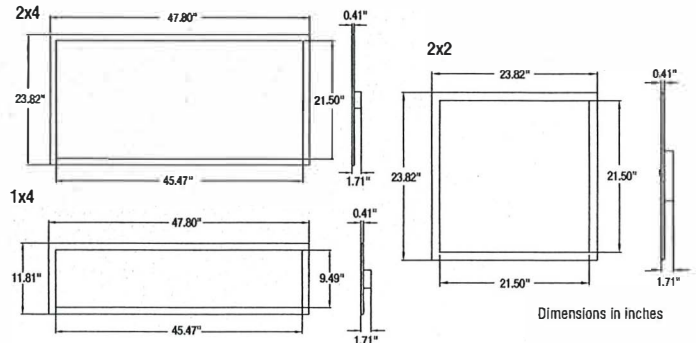

Specifications

- Weight:** 1x4 & 2x2: 7.96lbs (3.6 kg) Standard 2x4: 14.33lbs (6.5 kg) Standard
1x4 & 2x2: 10.14lbs (4.6 kg) Emergency 2x4: 16.54lbs (7.5 kg) Emergency
- Construction:** Extruded aluminum frame with sheet metal back plate, earthquake clips and diffused flat lens. The standard color is white.
- LED System:** LED system with a life rating of $\geq 50,000$ hours at L_{70} @ 25°C. Luminaire efficacy up to 114 LPW.
- Electrical:** Offered in 32 and 40 Watts, the luminaire is designed to operate through the 120-277 Vac universal voltage range. The LED driver has a 0.5kV inherent surge suppression and is a constant current device. The power factor is $\geq 90\%$ and THD is $\leq 20\%$.
- Dimming:** The driver is 0-10V dimmable (down to 10%). Please reference the dimmer compatibility document (LEDLUM012).
- Color Characteristics:** CRI > 80 ; CCT of 3500K, 4000K or 5000K.
- Optics:** White flat edge-lit PMMA diffuser lens.
- Options Available:** Emergency Battery Backup.
- Installation:** Luminaire lays in standard 15/16" and 9/16" T-grid ceilings.
- Operating Temperature:** -4°F to +104°F (-20°C to +40°C);
EM: +32°F to +104°F (0°C to +40°C).
- Listings:** cETLus listed to UL1598 standards, IC and damp rated.
- Note:** Suitable for use in closets, compliant with NFPA 70, NEC section 410.16 (A)(3) and 410.16 (C)(5).
- Warranty:** Standard 5-year luminaire warranty (LEDLUM001).
- Note:** Specifications subject to change without notice. IES files available online.



**DLC not applicable to emergency versions

Ordering Guide

Item Number:

PANELF	1A	/	XXX	XXX	D	8	XX	/	XX	G	/	WH	/	X
Product Name	Generation		Wattage	Voltage	Dimming	CRI	Color Temp (CCT)		Dimension	Mounting		Color/Finish		Option
PANELF	1A		032 = 32 Watts 040 = 40 Watts*	UNV = 120-277V	D = 0-10V	8 \geq 80	35 = 3500K 40 = 4000K 50 = 5000K		14 = 1x4 22 = 2x2 24 = 2x4	G = Grid		WH = White		Blank = No Option E = Emergency

*Only available in 2x4 size.



Photometric Data

Average Illuminance (FC) at 30" AFF and avg/min uniformity
80/50/20 Reflectances

			8 ft Mounting Height			10 ft Mounting Height			12 ft Mounting Height		
			On Center Fixture Spacing			On Center Fixture Spacing			On Center Fixture Spacing		
			8'x10'	10'x10'	10'x12'	8'x10'	10'x10'	10'x12'	8'x10'	10'x10'	10'x12'
1'x4'	32W	PANELF1A/032UNVD835/14G/WH	44fc / 3.2	36fc / 2.9	32fc / 2.0	43fc / 2.7	35fc / 2.4	31fc / 1.8	42fc / 2.5	34fc / 2.3	31fc / 1.8
		PANELF1A/032UNVD840/14G/WH									
2'x2'	32W	PANELF1A/032UNVD835/22G/WH	47fc / 3.2	39fc / 2.9	35fc / 2.0	46fc / 2.7	38fc / 2.4	33fc / 1.8	44fc / 2.4	37fc / 2.3	33fc / 1.8
		PANELF1A/032UNVD840/22G/WH									
2'x4'	32W	PANELF1A/032UNVD835/24G/WH	44fc / 3.3	36fc / 2.8	32fc / 2.0	43fc / 2.7	35fc / 2.4	31fc / 1.8	42fc / 2.5	34fc / 2.3	31fc / 1.7
		PANELF1A/032UNVD840/24G/WH									
	40W	PANELF1A/040UNVD835/24G/WH	62fc / 3.3	51 fc / 2.8	46fc / 2.0	60fc / 2.7	50fc / 2.4	44fc / 1.8	59fc / 2.5	48fc / 2.3	43fc / 1.7
		PANELF1A/040UNVD840/24G/WH									

*Table also applicable to emergency versions.

Ordering Information

Item Number	Ordering Abbreviation	Power (W)	Input Voltage	Dimming	CRI	Color Temp (CCT)	Size	Total Fixture Lumens	LPW*	DLC**	Options	Case Qty
74243†	PANELF1A/032UNVD835/14G/WH	32	120-277V	0-10V	>80	3500K	1x4	3200	102	Std	-	5
61600	PANELF1A/032UNVD835/14G/WH	32	120-277V	0-10V	>80	3500K	1x4	3200	102	Std	-	6
74244†	PANELF1A/032UNVD840/14G/WH	32	120-277V	0-10V	>80	4000K	1x4	3300	104	Std	-	5
61601	PANELF1A/032UNVD840/14G/WH	32	120-277V	0-10V	>80	4000K	1x4	3300	104	Std	-	6
74938†	PANELF1A/032UNVD850/14G/WH	32	120-277V	0-10V	>80	5000K	1x4	3500	110	Std	-	5
61602	PANELF1A/032UNVD850/14G/WH	32	120-277V	0-10V	>80	5000K	1x4	3500	110	Std	-	6
74251†	PANELF1A/032UNVD835/22G/WH	32	120-277V	0-10V	>80	3500K	2x2	3500	110	Std	-	5
61596	PANELF1A/032UNVD835/22G/WH	32	120-277V	0-10V	>80	3500K	2x2	3500	110	Std	-	6
74252†	PANELF1A/032UNVD840/22G/WH	32	120-277V	0-10V	>80	4000K	2x2	3500	110	Std	-	5
61597	PANELF1A/032UNVD840/22G/WH	32	120-277V	0-10V	>80	4000K	2x2	3500	110	Std	-	6
74797†	PANELF1A/032UNVD850/22G/WH	32	120-277V	0-10V	>80	5000K	2x2	3500	114	Std	-	5
61598	PANELF1A/032UNVD850/22G/WH	32	120-277V	0-10V	>80	5000K	2x2	3500	114	Std	-	6
74247†	PANELF1A/032UNVD835/24G/WH	32	120-277V	0-10V	>80	3500K	2x4	3300	104	Std	-	3
61591	PANELF1A/032UNVD835/24G/WH	32	120-277V	0-10V	>80	3500K	2x4	3300	104	Std	-	4
74248†	PANELF1A/032UNVD840/24G/WH	32	120-277V	0-10V	>80	4000K	2x4	3300	104	Std	-	3
61592	PANELF1A/032UNVD840/24G/WH	32	120-277V	0-10V	>80	4000K	2x4	3300	104	Std	-	4
74935†	PANELF1A/032UNVD850/24G/WH	32	120-277V	0-10V	>80	5000K	2x4	3500	112	Std	-	3
61593	PANELF1A/032UNVD850/24G/WH	32	120-277V	0-10V	>80	5000K	2x4	3500	112	Std	-	4
74249†	PANELF1A/040UNVD835/24G/WH	40	120-277V	0-10V	>80	3500K	2x4	4200	109	Std	-	3
61594	PANELF1A/040UNVD835/24G/WH	40	120-277V	0-10V	>80	3500K	2x4	4200	109	Std	-	4
→ 74250†	PANELF1A/040UNVD840/24G/WH	40	120-277V	0-10V	>80	4000K	2x4	4200	110	Std	-	3
61599	PANELF1A/040UNVD840/24G/WH	40	120-277V	0-10V	>80	4000K	2x4	4200	110	Std	-	4
74934†	PANELF1A/040UNVD850/24G/WH	40	120-277V	0-10V	>80	5000K	2x4	4300	113	Std	-	3
61595	PANELF1A/040UNVD850/24G/WH	40	120-277V	0-10V	>80	5000K	2x4	4300	113	Std	-	4
74245	PANELF1A/032UNVD835/14G/WH/E	32	120-277V	0-10V	>80	3500K	1x4	3200	102	-	Emergency Battery Backup	5
74246	PANELF1A/032UNVD840/14G/WH/E	32	120-277V	0-10V	>80	4000K	1x4	3300	104	-	Emergency Battery Backup	5
74939	PANELF1A/032UNVD850/14G/WH/E	32	120-277V	0-10V	>80	5000K	1x4	3500	110	-	Emergency Battery Backup	5
74253	PANELF1A/032UNVD835/22G/WH/E	32	120-277V	0-10V	>80	3500K	2x2	3500	110	-	Emergency Battery Backup	5
74254	PANELF1A/032UNVD840/22G/WH/E	32	120-277V	0-10V	>80	4000K	2x2	3500	110	-	Emergency Battery Backup	5
74798	PANELF1A/032UNVD850/22G/WH/E	32	120-277V	0-10V	>80	5000K	2x2	3500	114	-	Emergency Battery Backup	5
74239	PANELF1A/032UNVD835/24G/WH/E	32	120-277V	0-10V	>80	3500K	2x4	3300	104	-	Emergency Battery Backup	3
74240	PANELF1A/032UNVD840/24G/WH/E	32	120-277V	0-10V	>80	4000K	2x4	3300	104	-	Emergency Battery Backup	3
74937	PANELF1A/032UNVD850/24G/WH/E	32	120-277V	0-10V	>80	5000K	2x4	3500	112	-	Emergency Battery Backup	3
74241	PANELF1A/040UNVD835/24G/WH/E	40	120-277V	0-10V	>80	3500K	2x4	4200	109	-	Emergency Battery Backup	3
→ 74242	PANELF1A/040UNVD840/24G/WH/E	40	120-277V	0-10V	>80	4000K	2x4	4200	110	-	Emergency Battery Backup	3
74936	PANELF1A/040UNVD850/24G/WH/E	40	120-277V	0-10V	>80	5000K	2x4	4300	113	-	Emergency Battery Backup	3

- offer 2

Emer. ltr
later
fixture

*LPW per LM79 report
**Std for DLC Standard.
†Indicates that the product is discontinued with inventory.
For further information and to learn more about utility rebates, contact your local SYLVANIA sales representative.

Options Information

Emergency Battery Backup:

Activates when normal power supply to the fixture fails, providing a minimum of 650 lumens (700 nominal lumens) for at least 90 minutes.

Location of Emergency Test Switch

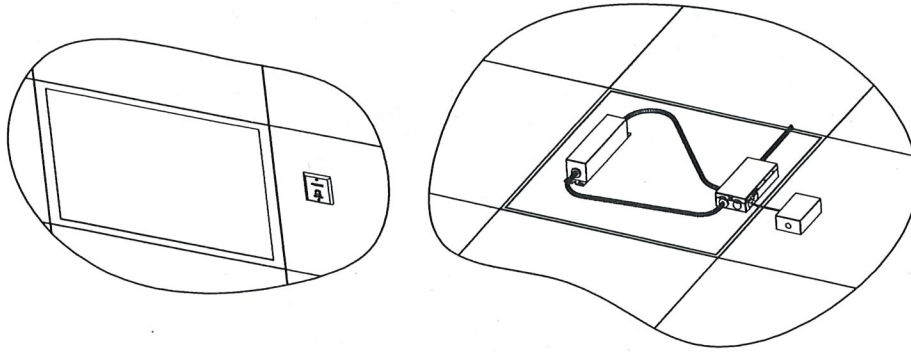

Accessories and Replacement Parts

Item Number	Ordering Abbreviation	Item Description
70132	SMKIT1A/14A/WH	1x4 Surface Mount Kit, White Finish
70380	SMKIT1A/22A/WH	2x2 Surface Mount Kit, White Finish
70381	SMKIT1A/24A/WH	2x4 Surface Mount Kit, White Finish
60457	FK1A14GWH	1x4 Flange Kit, White Finish
60458	FK1A22GWH	2x2 Flange Kit, White Finish
60459	FK1A24GWH	2x4 Flange Kit, White Finish

*Please see Surface Mount Kit installation manual for instructions (not compatible with emergency battery back-up versions).

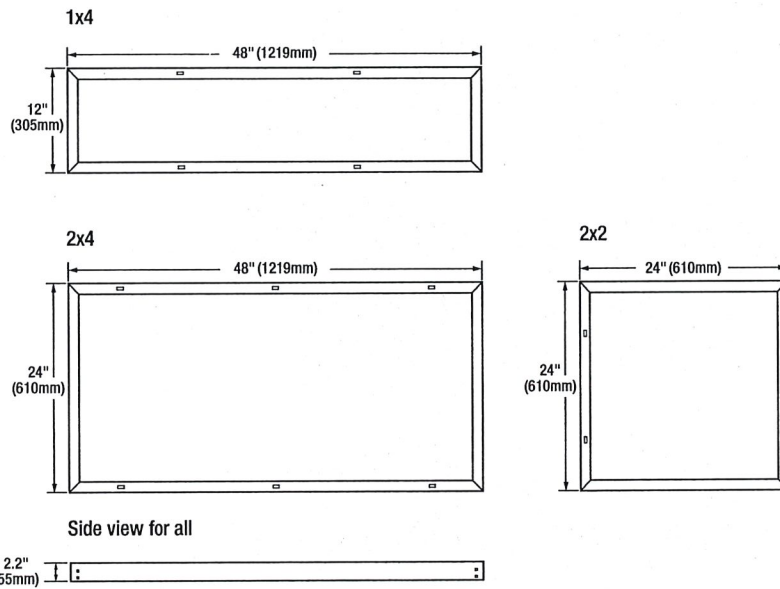

LEDVANCE LLC
 200 Ballardvale Street
 Wilmington, MA 01887 USA
 Phone 1-800-LIGHTBULB (1-800-544-4828)
www.sylvania.com

SYLVANIA and LEDVANCE are registered trademarks.
 All other trademarks are those of their respective owners.
 Product Licensee of Trademark SYLVANIA in General Lighting.
 Specifications subject to change without notice.

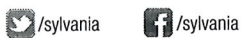

SYLVANIA LEDVANCE

Luminaires Installation Guide

EDGE-LIT PANEL

SURFACE MOUNT KIT

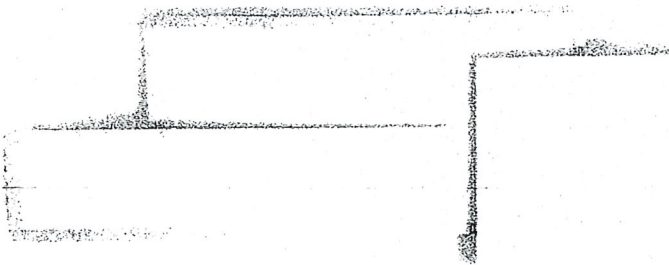

The Edge-Lit Panels are environmentally preferable LED alternatives to traditional fluorescent luminaires, offering up to 47% in energy savings. Ideal in place of traditional luminaires, or as new installations, the Edge-Lit Panels are offered in three sizes for illuminating offices, retail or hospitality areas.

For warranty coverage, please register at www.sylvania.com/warrantyregistration.

⚠ WARNING

- TO PREVENT PERSONAL INJURY OR PRODUCT DAMAGE ONLY LICENSED ELECTRICIANS SHOULD PROVIDE ALL INSTALLATION SERVICES.
- TO AVOID ELECTRIC SHOCK OR COMPONENT DAMAGE DISCONNECT POWER BEFORE ATTEMPTING INSTALLATION OR SERVICING.
- THIS PRODUCT MUST BE INSTALLED IN ACCORDANCE WITH THE NATIONAL ELECTRIC CODE (NEC) AND ALL APPLICABLE FEDERAL, STATE AND LOCAL ELECTRIC CODES AND SAFETY STANDARDS.
- USE CAUTION WHEN HANDLING THIS PRODUCT DURING OR AFTER OPERATION AS IT MAY BECOME HOT AND CAUSE BURNS. DISCONNECT PRODUCT AND ALLOW COOLING PRIOR TO SERVICING.
- ANY ALTERATION OR MODIFICATION OF THIS PRODUCT IS EXPRESSLY FORBIDDEN AS IT MAY CAUSE SERIOUS PERSONAL INJURY, DEATH, PROPERTY DAMAGE AND/OR PRODUCT MALFUNCTION.
- TO PREVENT PRODUCT MALFUNCTION AND / OR ELECTRICAL SHOCK THIS PRODUCT MUST BE PROPERLY GROUNDED.
- THIS LUMINAIRE IS DESIGNED TO OPERATE IN AMBIENT TEMPERATURES RANGING FROM -4°F TO +104°F (-20°C TO +40°C) EMERGENCY BACKUP +32°F TO +104°F (0°C TO +40°C) AND TO BE MOUNTED WITH THE LEDS FACING DOWN.

SAFETY PRECAUTIONS:

IMPORTANT: READ CAREFULLY BEFORE INSTALLING THE FIXTURE. RETAIN FOR FUTURE REFERENCE.

GENERAL: Upon receipt of the fixture, thoroughly inspect for any freight damage which should be brought to the attention of the delivery carrier.

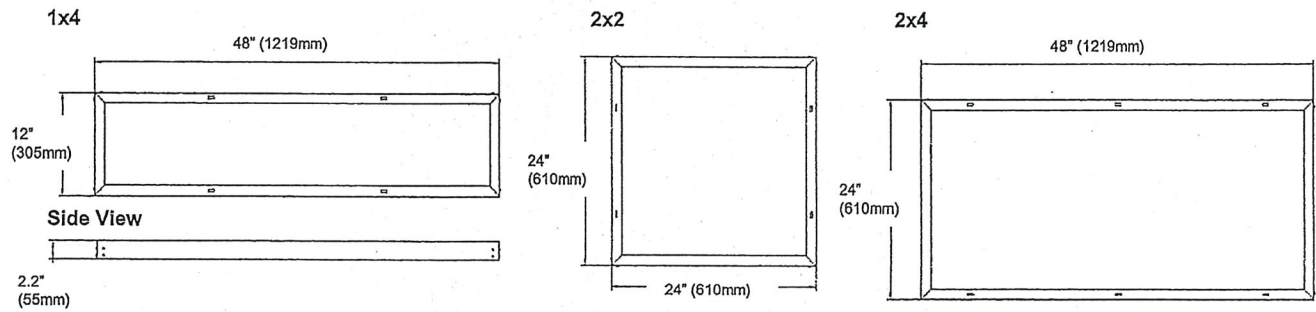

INSTALLATION:

1. Disconnect power where fixture is going to be installed.
2. Completely assemble kit on flat surface.
3. Lift assembled kit to the desired installation location and mark where holes need to be drilled.
4. Drill ceiling holes and drive appropriate anchors into the holes.
5. Mount the kit to the ceiling with fasteners.
6. Remove 4 screws of the kit to remove one side that is not secured to the ceiling (see Figure 1)
7. Slide panel into open kit deep enough to that is stable and secure.
8. Make all electrical connections. See panel installation guide for wiring instructions.
9. Replace the removed side and screw back into place.
10. Turn power back on, installation is now complete.

Figure 1

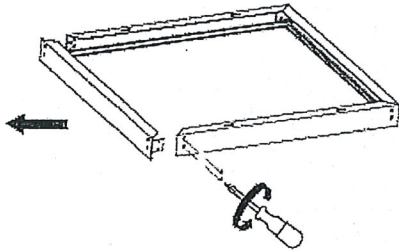

CLEANING AND MAINTENANCE

- To maintain the fixture efficacy occasional cleaning of the outer lens surface may be needed.
- Use a mild soap or detergent, which is essentially neutral pH (pH approximately 6 to 8), nonabrasive, and which contains no chlorinated or aromatic hydrocarbons.
- Wash thoroughly, using a soft cloth.
- Rinse with clean, cold water and wipe dry.

WARNING.
Risk of electric shock
Disconnect power before servicing

TROUBLE SHOOTING CHECKLIST: If luminaire does not work

- Check your power source.
- Check electrical connections.

E22379

LEDVANCE LLC
200 Ballardvale Street
Wilmington, MA 01887

Attachment E



Hangar-21 Existing Fire Alarm Panel